



52M01SE0166 63.3718 BALL TWP

010



Diamond
Drilling
Log

MEAP RL-83

Fill in on every page → Hole No. 80-1 Page No. 1 of 2

Drilling Company Kenora Diamond Drilling Ltd.		Collar Elevation 10' above lake	Bearing of hole from true North 235°	Total Footage 471'	Dip of Hole at Collar 50°	Location of hole in relation to a fixed point on the claim. 600' south 500' west of #1 post KRL.448437	Map Reference No. M.2136	Claim No. KRL.448437	
Date Hole Started February 13, 1980	Date Completed March 4, 1980	Date Logged March 19/80	Logged by W. Hermiston				Location (Twp., Lot, Con. or Lat. and Long.)		
Exploration Co., Owner or Optionee W. Hermiston		Date Submitted	Submitted by (Signature)					Ball Township	
							Property Name Hermiston-Wood		

Footage		Rock Type	Description Colour, grain size, texture, minerals, alteration, etc.	Planar Feature Angle *	Core Specimen Footage †	Your Sample No.	Sample Footage		Sample Length	Assays †	
From	To						From	To			
0.0	21.0		casing								
21.0	88.0	SILICEOUS FLOW (DACITE?)	dark grey fine-grained, porphyritic in places, quite siliceous; cut by narrow veinlets of quartz and carbonate; contains varying amounts of chlorite and biotite; alteration of rock on either side of small veinlets; larger veinlets do not exhibit alteration of wallrocks; mineralization consists of pyrite as cubes and narrow veinlets; larger veins are open fracture fillings and are predominately quartz; slickensides on one veinlet.								
88.0	115.8	QUARTZ VEIN	light grey-white; mottled, colloform texture; definitely banded; from 86.7 to 88.0 is carbonatized andesite that is dark grey in colour; it is light greenish grey, where it has been silicified; vein itself is quartz-carbonate; patches of chlorite and crystals of tan-coloured scheelite; possibly some tourmaline; many small microfaults within the vein; probably several generations of quartz deposition; mineralization is very minor (pyrite); pyrite is fairly abundant in siliceous andesite around 104-108.								
115.8	180.0	PORPHYRITIC (CHLORITE) DACITE	dark grey to black; mottled look; cut by narrow quartz and carbonate veinlets; some sections have chlorite clots; phenocrysts of feldspar in places.								
180.0	471.0	SILICEOUS (DACITE?) VOLCANIC FLOW w/ QUARTZ PHENOCRYSTS	dark grey to black; very fine-grained; very hard, contains small (1-2 cm) quartz phenocrysts; a few 0.5-1.0 cm quartz veinlets at 55° to c.a.; pyrite is associated with quartz veinlets; some very narrow carbonate veinlets that have not altered wall rock as in porphyritic dacites; spots of chlorite at 230'; more chlorite around 240'-								

63.3718



Fill in on
every page →

Drilling Company		Collar Elevation	Bearing of hole from true North	Total Footage	Dip of Hole at Collar °	Location of hole in relation to a fixed point on the claim.	Map Reference No.	Claim No.
Date Hole Started	Date Completed	Date Logged	Logged by		Ft.		Location (Twp., Lot, Con. or Lat. and Long.)	Property Name
Exploration Co., Owner or Optionee		Date Submitted	Submitted by (Signature)		Ft.			
				Ft.				
				Ft.				

Footage		Rock Type	Description <small>Co'our, grain size, texture, minerals, alteration, etc.</small>	Planar Feature Angle *	Core Specimen Footage †	Your Sample No.	Sample Footage		Sample Length	Assays †		
From	To						From	To				
			250' as spots; quartz eyes up to 3 mm. Later carbonate veinlets cross cut early quartz veins; rock becomes slightly darker around 270'; quantity of quartz phenocrysts varies slightly down the hole; 2cm. quartz vein at 391'; 409'-413' is altered (epidotized?) and is light green in colour; this section contains up to 10% pyrite; talcose alteration from 448.5-457.0 produces a lighter grey blotchy colour; talcose section is well mineralized with pyrite; may represent an interflow unit.									
			471.0 END OF HOLE									

Diamond Drill Hole # 80-1 "Location Sketch"
Ball T.M.P.

63.3718

RL-83

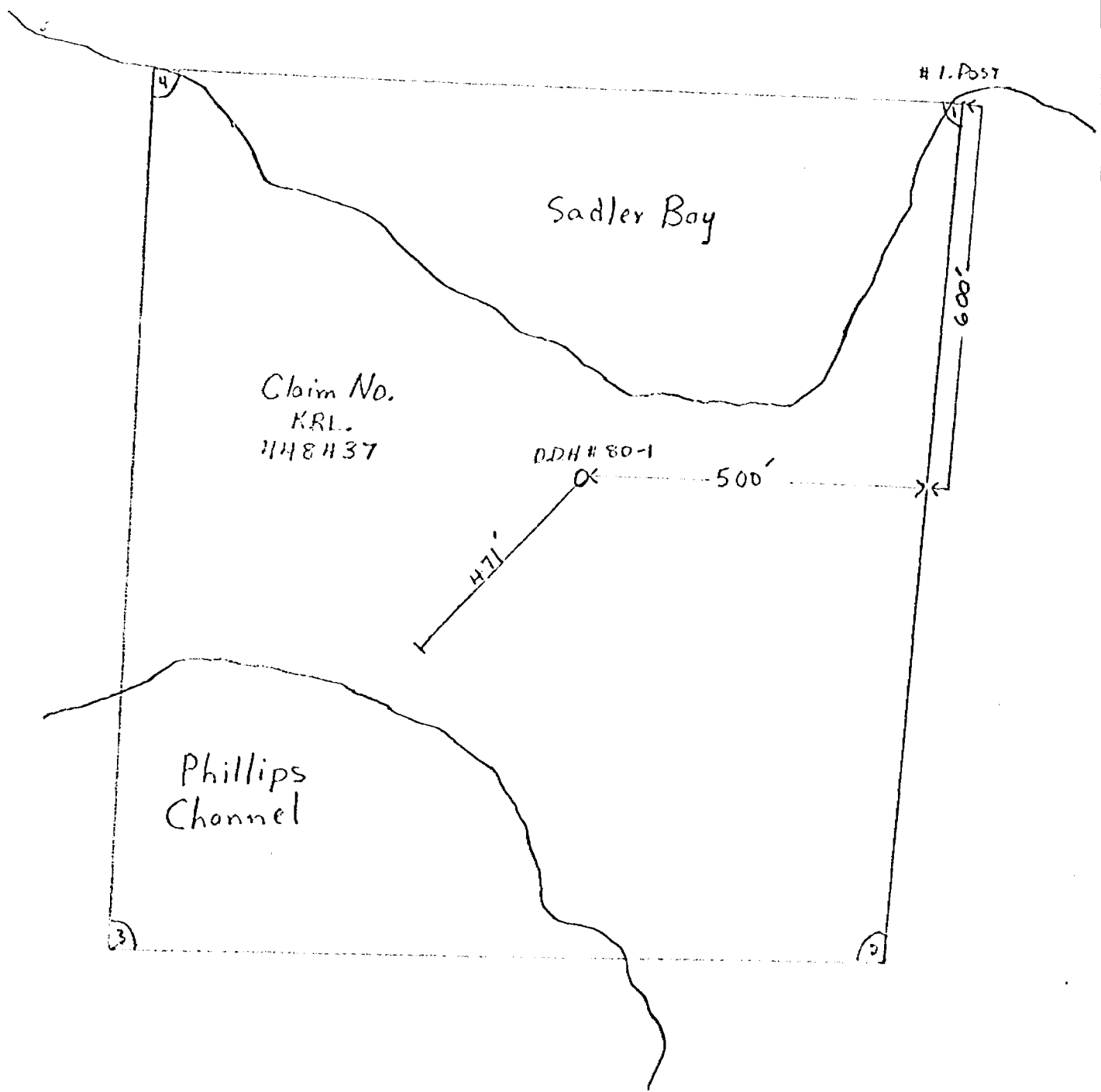
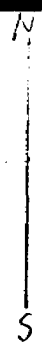

Claim No.
KRL.
1148437

DDH # 80-1

500'

471'

1. Post

Sadler Bay

Phillips
Channel

600'

4

3

2