

Diamond Drilling



52M01SE0176 33 BALL TWP

010

Township of BALL

Report NO: 33

Work performed by: Wm. Stupak

Claim NO	Hole NO	Footage	Date	Note
KRL 32177	1	100.0'	Nov/54	2000813 Stupak (1) 8/6
	6	160.0'	Oct/52	
	-	90.0'	-	

Notes: (1) Hole number and date not known.

Stupak

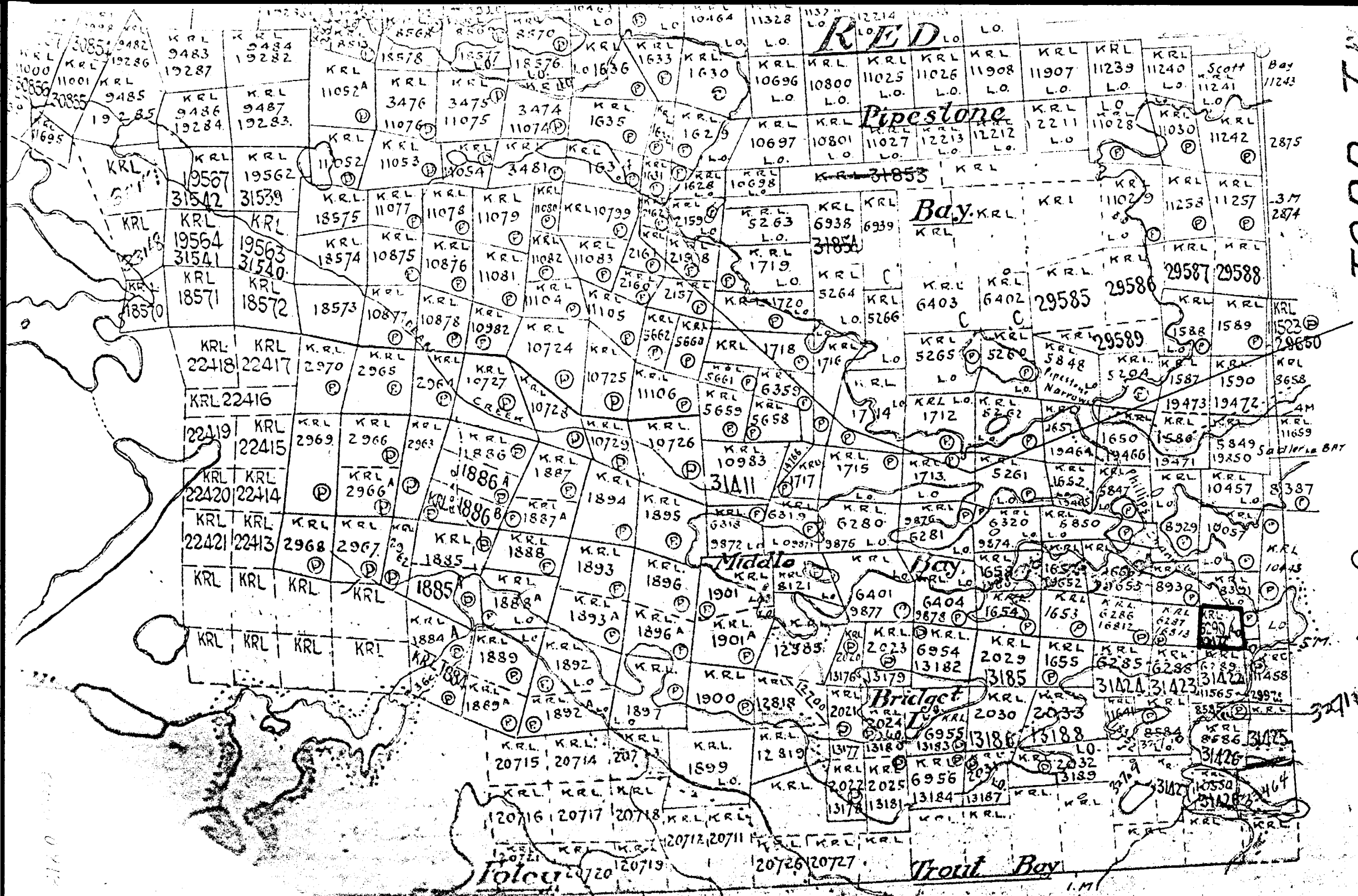

ROLL TOP M. 2136

James H. ...

RED

Pipestone

Bay

Middle Bay

Bridget

Trout Bay

Scott Bay

Sablier Bay

Tolou

I.M.

Core Log.
Hole #. 6. Ball Lerp.
Claim - No. ^{KFL} 32177
Depth - 160 ft
Angle - 40°
Core size - 3/4 in.
Scale = 1 in = 15 ft.

41 ft. Quartz porphyry
8 ft. White quartz stringers 1 in to 5 in
containing *Chalcos pyritas*

45 ft. waxy porphyry

13 ft. altered porphyry

28 ft. Iron formation with stringers
of cherty quartz

25 ft. Carbonated rocks.

Thm. Stupack. Oct. 28/52

Hole #1 - Claim KRL32177 - Ball Swamp

- Depth 100 ft.
- Angle 40°
- Core size = 3/4 in.
- Spaced = 1 in = 10 ft.

13 ft. greenstone
 7 ft. schist greenstone

14 ft. carbonates

13 ft. schist porphyry
 7 ft. quartz stringers
 in porphyry 1-3 in.

14 ft. quartz porphyry
 4 ft. schist porphyry

11 ft. carbonates
 6 ft. quartz containing
 chert pyrites &
 galena.
 11 ft. porphyry

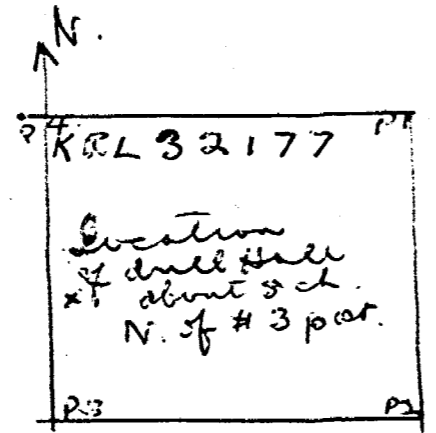

Nov. 13 & 14 - 1954

2000815

Core Log
Claim KRL 32177
Ball Juv.
Depth 90 ft
Angle 40°
 Scale 10 ft = 1 in.

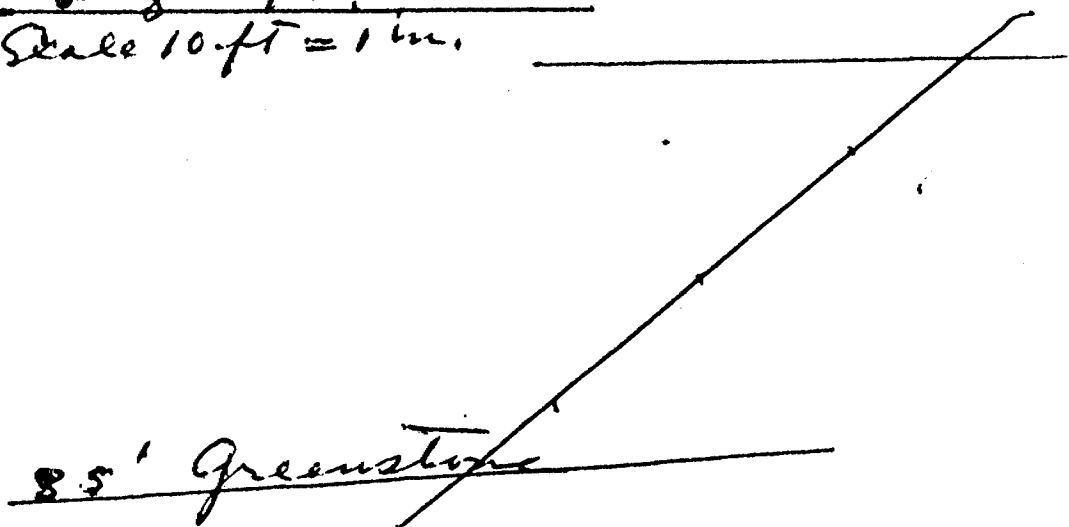
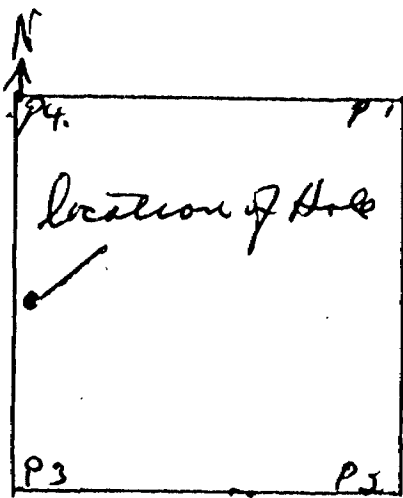

35 ft Carbonated rocks
 5 ft quartz stringers 1-3 inch. slightly mineral

13 ft Carbonates

12 ft porphyry.
90 ft.

Drill owned & operated
 by Wm Stupack, Red Lake
 Ont.