

DIAMOND DRILLING



52M01SE0501 43 BALL TWP

010

TOWNSHIP: Ball

REPORT No.: 43

WORK PERFORMED BY: Dome Exploration Ltd.

<u>CLAIM No.</u>	<u>HOLE No.</u>	<u>FOOTAGE</u>	<u>DATE</u>	<u>NOTE</u>
KRL 503046	135B - 1	407.0	Apr/80	(1)

NOTES: (1) #128-81

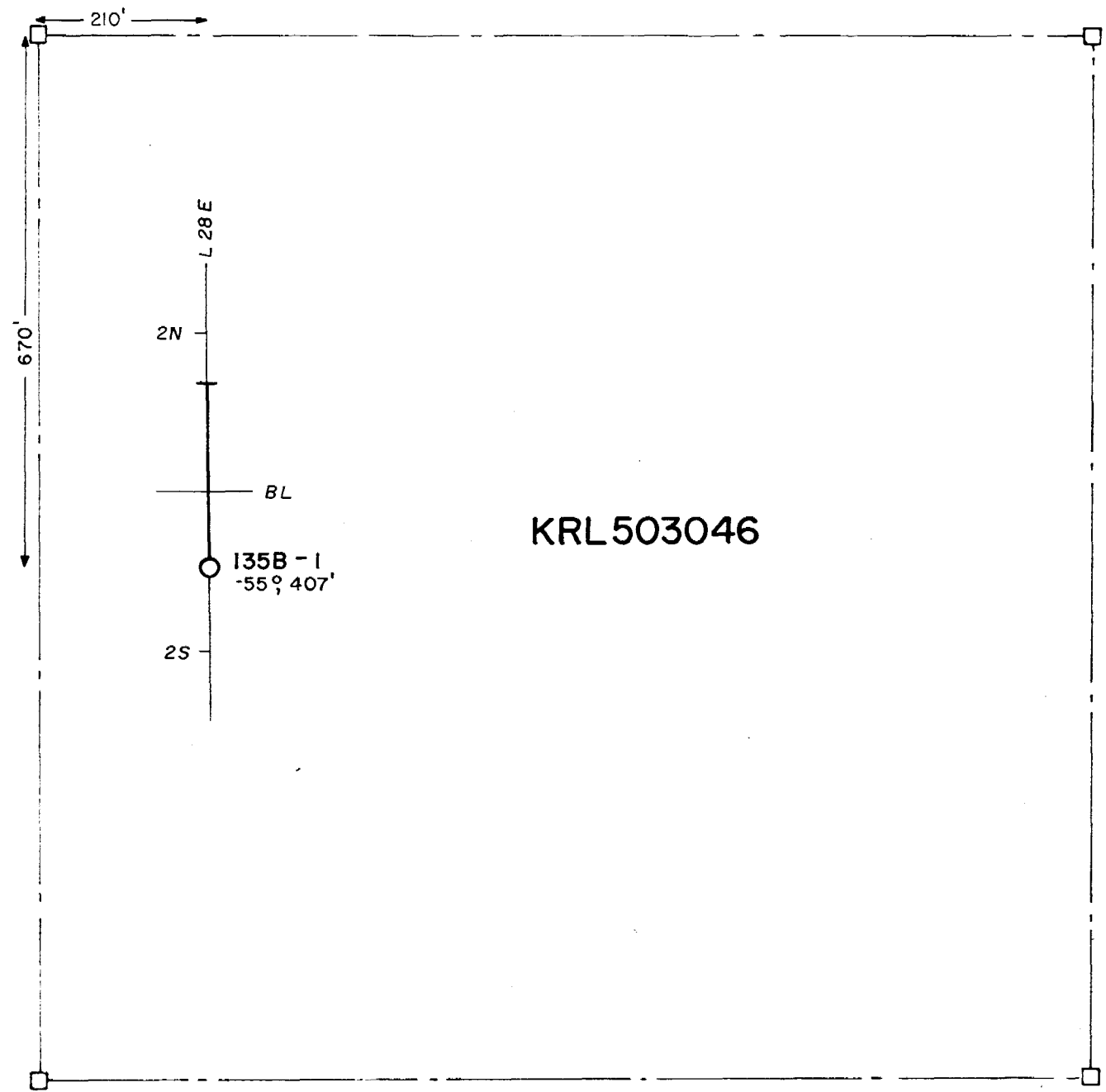

KRL 503046

L 28 E

2N

BL

135B-1
-55°, 407'

2S

210'

670'



52M01SE0501 43 BALL TWP

AE
E & M
RIGHTS

900
MINING RIGHTS ONLY

LEASE, SURFACE & MINING RIGHTS ONLY
" SURFACE RIGHTS ONLY
" MINING RIGHTS ONLY
LICENCE OF OCCUPATION
ORDER-IN-COUNCIL
RESERVATION
CANCELLED
SAND & GRAVEL

NOTE: MINING RIGHTS IN PARCELS 1913, VESTED IN ORIGINAL LANDS ACT, R.S.O. 1970,

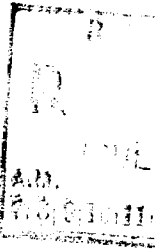
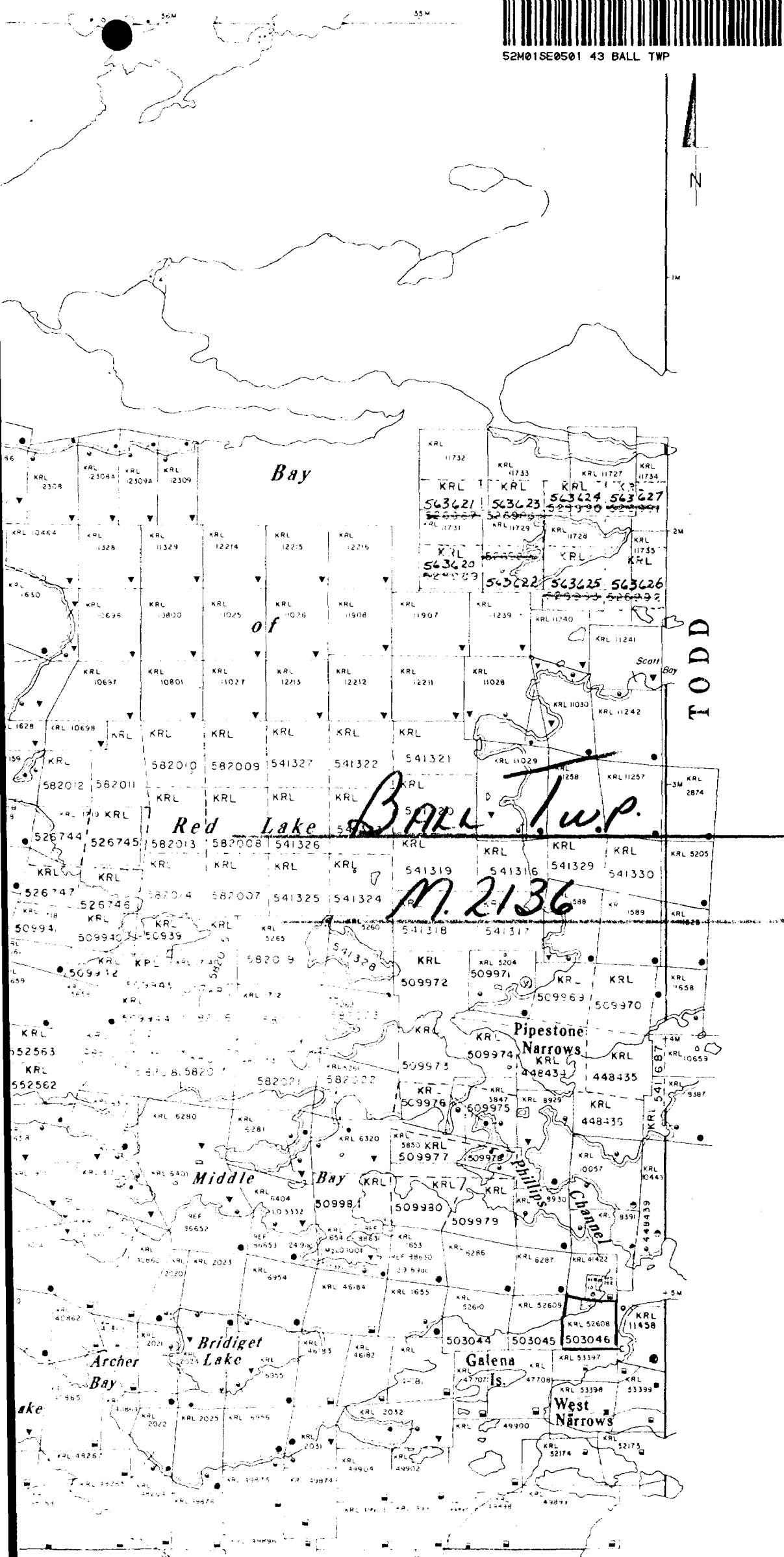

400' surface rights reservation along

SCALE: 1 INCH = 40 CHAINS

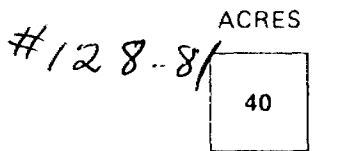
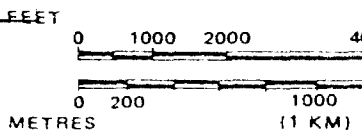

TOWNSHIP OF
BA
DISTRICT **KJ**
PATRICIA
MINING DIVISION
RED



Date 8/2/80

National Topographic Series