



52M01SE8101 63.5728 BALL

010

GEOLOGICAL REPORT

LOCATION - THIS GROUP OF THREE MINING CLAIMS (KAL-870130, KAL-870131, KAL-870132) IS SITUATED APPROX. 18 MILES WEST OF THE TOWN OF RED LAKE AND IS ACCESSIBLE BY WATER.

OBSERVATIONS - THE WAXX STRIPPING ON AND NEAR A TRENCH ON LINE 8°00'W/1°00'N TO 1°30'N UNCOVERED CARBONITIZED INTERMEDIATE VOLCANICS WITH MINOR FUSITE ALTERATION - QUARTZ/QUARTZ-CARBONATE TENSION FRACTURES OBLIQUE TO STRIKE OF GEOLOGY. MINERALIZATION WAS ONLY MINOR PYRITE AND SPARSE CHALCO-PYRITE.

THE STRIPPING + DRILLING AND BLASTING ON L-0/1°15'N TO 1°30'N ENCOUNTERED DIFFICULTIES IN THE STRIPPING PROCESS. THE SOIL WAS CLAY WITH SEVERAL LARGE BOULDERS THAT COULD ONLY BE DRILLED AND BLASTED (SAND BLASTING WAS INEFFECTIVE AND CONTRIBUTED GREATLY TO CAVE-INS). THE END RESULT WAS AN AVERAGE WIDTH OF 2 METRES AND AVE. DEPTH OF 2 M BEFORE DRILLING + BLASTING IN BEDROCK.

THE HOST ROCK IS STRONGLY SHEARED HIGHLY ALTERED CARBONITIZED MAFIC-ULTRAMAFIC ROCK (TALC-SHIST), WITH VERY MINOR PY AND CP TO NO MINERALIZATION AT ALL.

THE OTHER TWO ATTEMPTS AT L-4°00'W/3°50'N AND L-12°00'E/0°50'N WERE BOTH FLOODED WITH GROUND WATER AND THE WATER COULD BE OBSERVED SEEPING IN RAPIDLY WHEN BAILED OUT. SCALING BARS WOULD NOT BOTTOM OUT AND IT WAS DECIDED THAT WITH PRESENT CONDITIONS FURTHER WORK WOULD BE FUTILE (HIGH WATER TABLE - PLENTY OF GROUND WATER)

AUTHOR OF REPORT

A. J. Maciejewski *A. J. Maciejewski*

ANTONY JAMES MACIEJEWSKI

AV. - OZ/TON

SAMPLE # TYPE OF SAMPLE ROCK TYPE MINERALIZATION ASSAY RESULTS

1 CHIP (1.5 M.) HIGHLY CARBONITIZED SPARSE PY, CP TR.
INTERMEDIATE VOLCANICS
QTZ. + QTZ CARBONATE VEINING

2 CHIP (2.0 M.) HIGHLY CARBONITIZED SPARSE TO TR.
ULTRA MAFIC VOLCANICS NEGLIGIBLE PY
TALCOSE - SHEARED

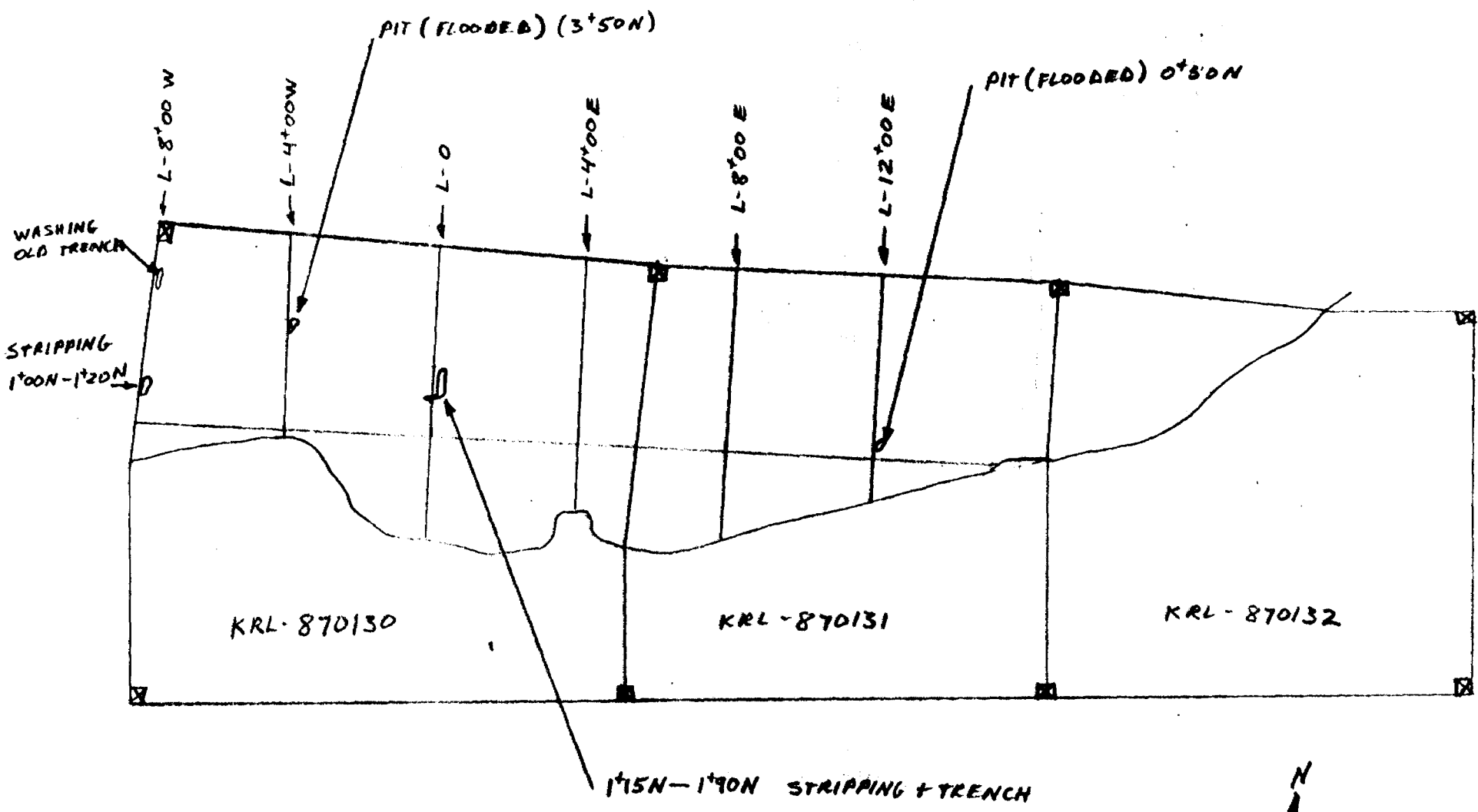

SCALE: 400' per INCH

* FOR STRIPPING + TRENCH DETAIL SEE ATTACHED SKETCHES



TROUT BAY GROUP

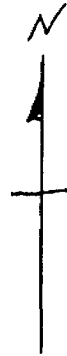

L-8°00W/1°50N

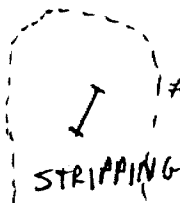

#1 SAMPLE

HIGHLY

CARBONITIZED INTERMEDIATE VOLCANICS

MINOR FUCHSITE ALTERATION

QUARTZ/QUARTZ-CARBONATE TENSION

FRACTURES OBLIQUE TO STRIKE

MINOR PY, CP

L-8°00W/1°00N



SCALE:

1" = 10'

TROUT BAY GROUP

L-0/2+00N



ULTRA-MAFIC

116°

STRONGLY SHEARED
HIGHLY ALTERED TO TALC-SHIST
MAFIC - ULTRAMIC
CARBONITIZED
MINOR PY, CP

SAMPLE "Z"

L-0/1+50N

0-7

SCALE: 1" = 10'

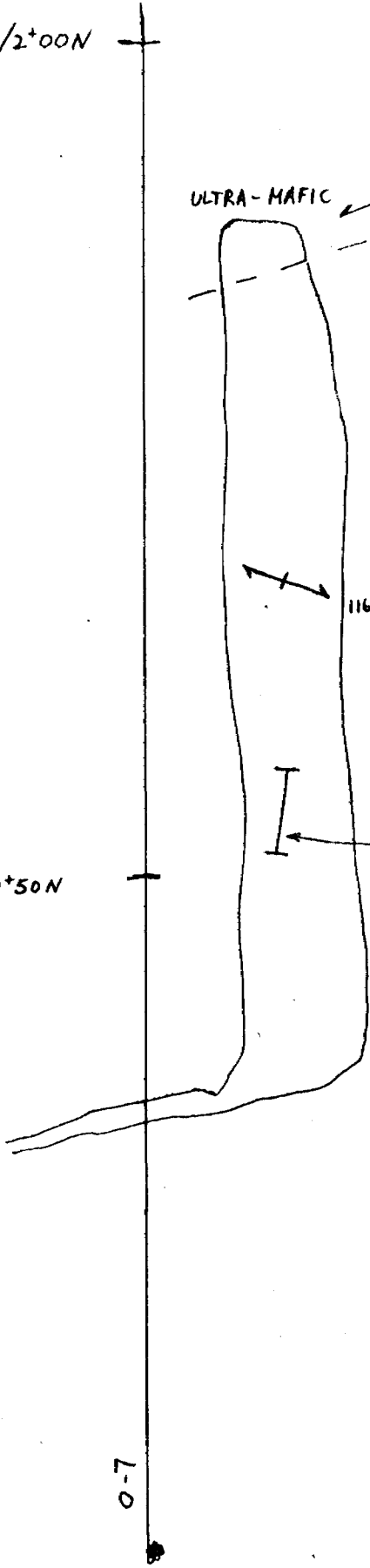

LEGEND

- GRANITE - GRANODIORITE PLUTONS
- FELSIC INTRUSIVE ROCKS
- INTERMEDIATE INTRUSIVE ROCKS
- MAFIC-ULTRAMAFIC INTRUSIVE ROCKS
- CHEMICAL SEDIMENTARY ROCKS
- CLASTIC SEDIMENTARY ROCKS
- FELSIC VOLCANIC ROCKS
- INTERMEDIATE VOLCANIC ROCKS
- MAFIC-ULTRAMAFIC VOLCANIC ROCKS
- GEOLOGICAL CONTACT
- - - FAULT AND/OR SHEAR ZONE
- HYDROTHERMALLY ALTERED ROCK
- - - BOUNDARY BETWEEN GREENSCHIST FACIES AND AMPHIBOLITE FACIES
- - - POSTULATED BOUNDARY BETWEEN GREENSCHIST FACIES AND AMPHIBOLITE FACIES

- PRODUCER
- PAST PRODUCER
- DEVELOPED PROSPECT
- RAW PROSPECT
- OCCURRENCE

— APPROXIMATE LIMITS OF DEFORMATION ZONES

Compilation by M.E. Durocher and P.S. Burchell 1984
 Geology from published maps of the Ontario Geological Survey, unpublished data of mining companies and additional unpublished data from H. Wallace (geologist, Ontario Geological Survey, Toronto)
 Scale 1:31680

BALL TWP.
 TROUT BAY GROUP

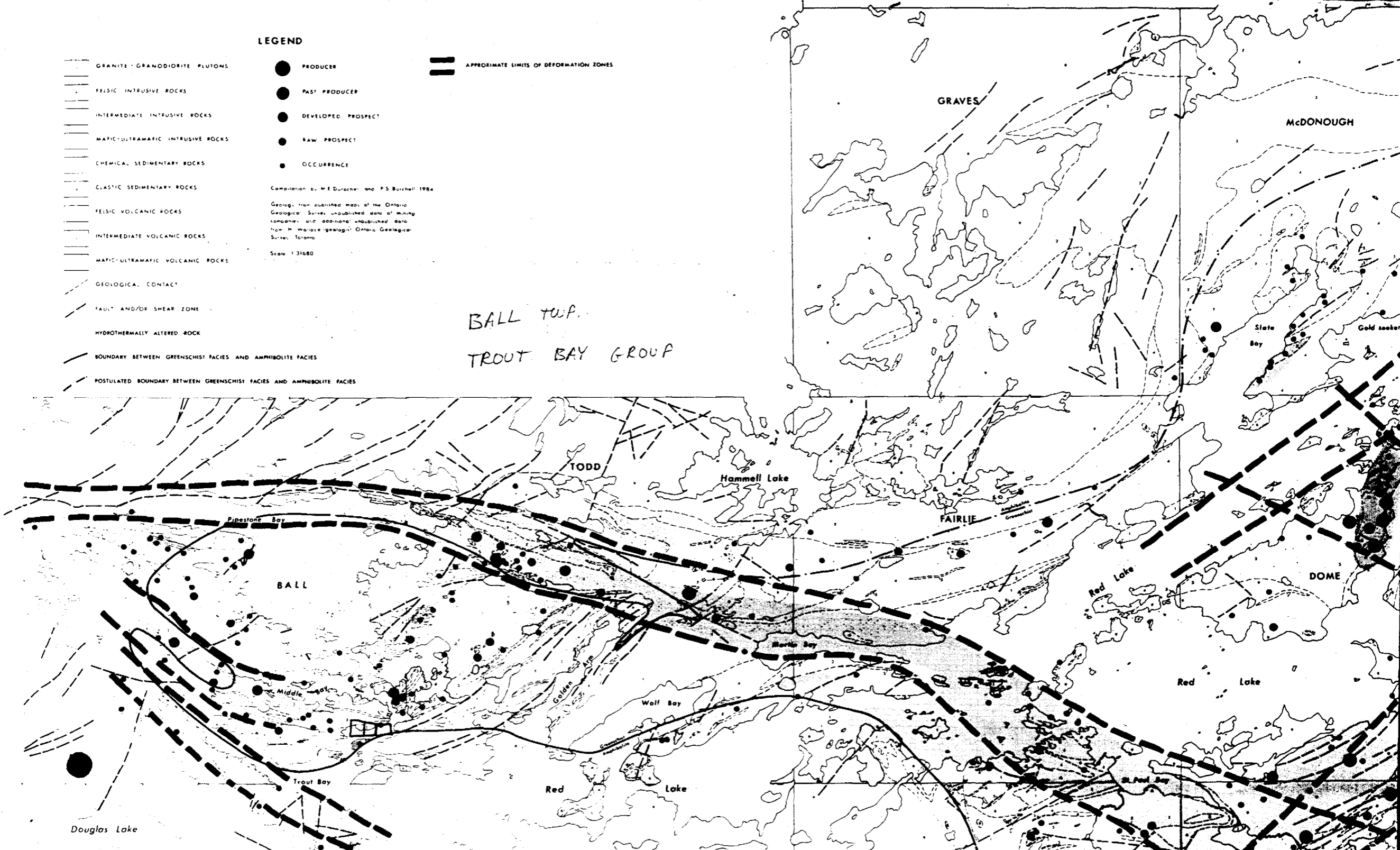

TROUT BAY GROUP

RECOMMENDATIONS:

THE TWO PIT AREAS, LOCATED AT L-4⁰⁰W/3⁵⁰N AND L-12⁰⁰E/0⁵⁰N WHICH COULD NOT BE COMPLETED DUE TO FLOODING, SHOULD WITH DRY CONDITIONS BE COMPLETED AND TESTED FOR Au ~~g~~ CONTENT AS THESE TWO AREAS WERE MAGNETICALLY (MAG SURVEY) ANOMALOUS.

THESE THREE MINING CLAIMS (KRL 870130, KRL 870131 AND KRL 870132) SHOULD ALSO BE PROSPECTED ALONG THE LENGTH OF THE SEDIMENTARY BELTS (CHERT) FOR FURTHER GOLD MINERALIZATION ALONGSIDE THE CONTACTS WITH THE INTERMEDIATE AND ULTRA-MAFIC (CONTACTS) VOLCANICS.

A. J. Mangum

LOCATION TR. # 1 + # 2

L-3 W

2+50 N

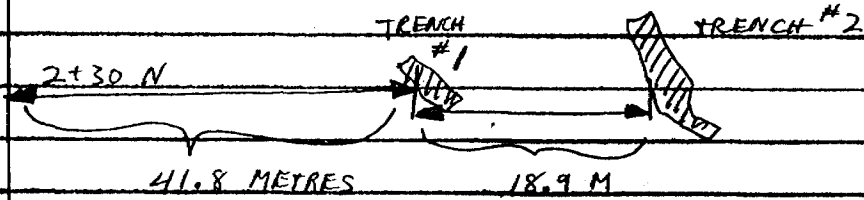

2+25 N

LOCATION TRENCH #3

L-4W

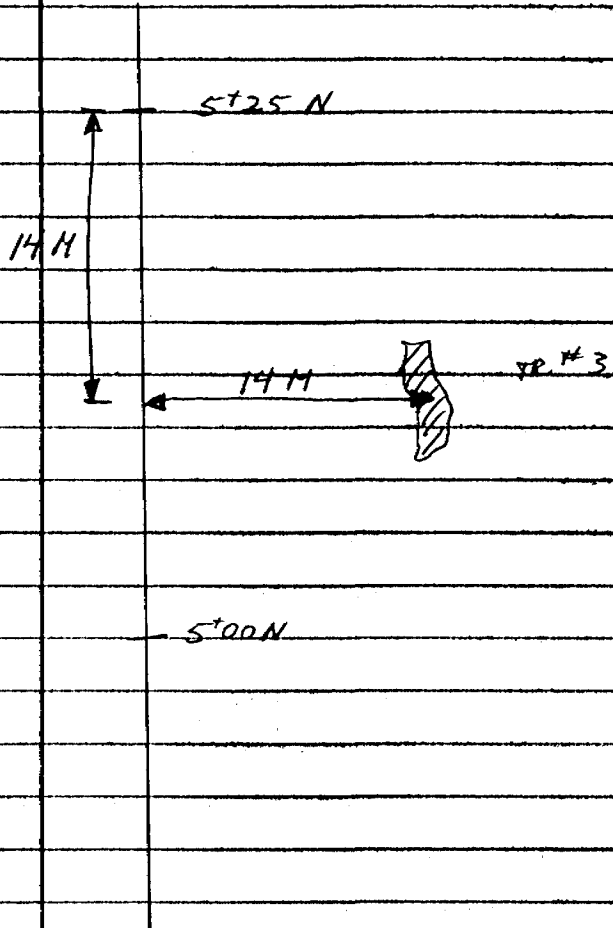

LOCATION TRENCHES # 4 + # 5

L-2 W

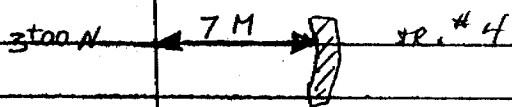
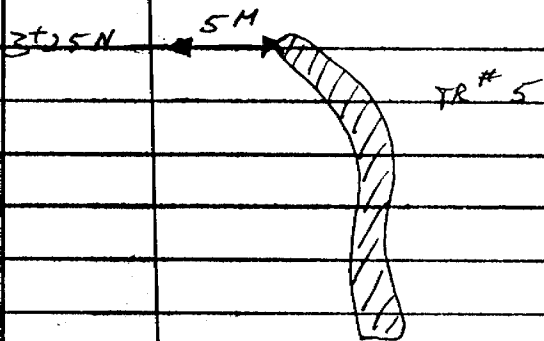

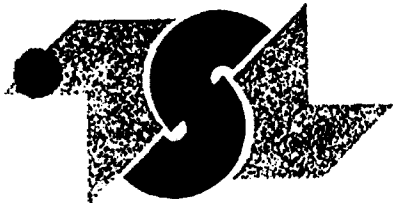

TECHNICAL SERVICE LABORATORIES

DIVISION OF BURGNER TECHNICAL ENTERPRISES LIMITED

1301 FEWSTER DRIVE
MISSISSAUGA, ONTARIO
L4W 1A2

☎ (416) 625-1544 FAX: (416) 625-8368

CERTIFICATE OF ANALYSIS

SAMPLE(S) FROM Gold Fields Canadian Mining Ltd.
University Place
123 Front Street West, Suite 909
Toronto, Ont. M5J 2M2

REPORT No.
M7581

SAMPLE(S) OF Rock

INVOICE #:
P.O.:

Shipment No. WB-90-27R

Gold
Au ppb

Gold
Au oz/t

RO 1782	20	
RO 1783	15	<0.005
RO 1784	>1000	0.091 (0.090, 0.092, 0.090)
RO 1785	80	<0.005
RO 1786	20	
RO 1787	240	
RO 1788	35	
RO 1789	10	

COPIES TO: B. Bond
INVOICE TO: Toronto

Aug 16/90

Gold Fields disclaims responsibility for the accuracy of this core (s), log (s), assay (s) and/or other documents.

SIGNED *Daniel J. Baloch*





ACCURASSAY LABORATORIES LTD.

P.O. BOX 604
KIRKLAND LAKE, ONTARIO, CANADA P2N 3J5
TEL.: (705) 567-6343

President: Dr. GEORGE DUNCAN, M.Sc., Ph. D., C. Chem (Ont.), C. Chem (U.K.), M.C.I.C., M.R.S.C., A.R.C.S.T.

Certificate of Analysis

Page: 1

28475 ANTONY MACEJEWSKI
BOX 707
RED LAKE, ONTARIO
POV 2M0

Date: October 22 19 00

Work Order # : 181590
Project :

SAMPLE NUMBERS		Copper	Nickel	Zinc
Accurassay	Customer	ppm	ppm	ppm
279529	90-1	18	Forwarded	33



ACCURASSAY LABORATORIES LTD.

P.O. BOX 604
KIRKLAND LAKE, ONTARIO, CANADA P2N 3J5
TEL.: (705) 567-6343

President: Dr. GEORGE DUNCAN, M.Sc., Ph. D., C. Chem (Ont.), C. Chem (U.K.), M.C.I.C., M.R.S.C., A.R.C.S.T.

Certificate of Analysis

Page: 1

28486 ANTONY MACEJEWSKI
BOX 707
RED LAKE, ONTARIO
POV 2MO

Date: October 26 19 90

Work Order # : 181590

SAMPLE NUMBERS		Nickel	Iron
Accurassay	Customer	ppm	ppm
279529	90-1	128	13,200

Handwritten notes:
1/20/90
1/20/90
1/20/90

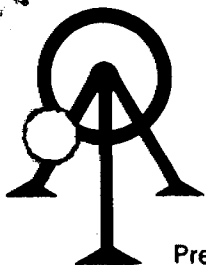

ACCURASSAY LABORATORIES LTD.

P.O. BOX 604
KIRKLAND LAKE, ONTARIO, CANADA P2N 3J5
TEL.: (705) 567-6343

President: Dr. GEORGE DUNCAN, M.Sc., Ph. D., C. Chem (Ont.), C. Chem (U.K.), M.C.I.C., M.R.S.C., A.R.C.S.T.

Certificate of Analysis

Page: 1

28474

ANTONY MACEJEWSKI
BOX 707
RED LAKE, ONTARIO
POV 2M0

Date: October 22 19 00

Work Order # : 181590
Project :

SAMPLE NUMBERS		Gold
Accurassay	Customer	ppb
279529	90-1	<5
279529	90-1	<5 Check

DM OP90-100

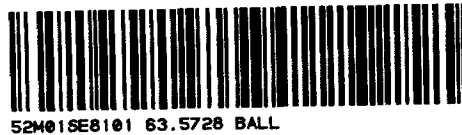

900

THIS SUBMITTAL CONSISTED OF VARIOUS REPORTS, SOME OF WHICH HAVE BEEN CULLED FROM THIS FILE. THE CULLED MATERIAL HAD BEEN PREVIOUSLY SUBMITTED UNDER THE FOLLOWING RECORD SERIES (THE DOCUMENTS CAN BE VIEWED IN THESE SERIES):

- 1) Geological Survey of Baird Twp → see file # 2.13678
with Geological Map Row W9120.036,
by M.J. Maciejewski, 1990 W9002.110, W9002.114, W9002.116
- 2) Geophysical Survey of Baird Twp → see file # 2.13678
with Magnetometer Survey Map Row W9120.036, W9002.110,
by M.J. Maciejewski, 1990 W9002.114, W9002.116
- 3) Stripping, Trenching, Assays on → see file # 2.13678
Baird Twp Row 9120.036, W9002.110,
by M.J. Maciejewski, 1990 W9002.114, W9002.116