



52M01SW0187 13 BALL TWP

010

Diamond Drilling

Township of BALL

Report No 13

Work performed by: Stupack and Johnson

Claim No	Hole No	Footage	Date	Note
KRL 47917	AWL-43	102.0'	May/61	4
	55	101.0'	July/62	
KRL 47916	AWL-54	103.0'	July/62	
KRL-52276 (re-staking of 47917)	AWL-65-1	122.0'	May/65	4
	67-1	105.0'	May/67	
	69-2	120.0'	June/69	
KRL-52275 (re-staking of 47916)	AWL-WS68-1	104.0'	May/68	A
KRL 50647	AWL-69-1	121.0'	May/69	4

Notes:

DRILL LOG BY STUPACK-JOHNSON

(recopied by Assessment Work Library)

Claim No: KRL.47917

AWL Hole No: 43

S.J. Hole No: 1

Total Footage: 102

Date Started: May 1, 1961

Dip: 45°

Date Finished: May 4, 1961

Log:

<u>From</u>	<u>To</u>	<u>Description</u>
0	44	carbonates with few quartz stringers
44	61	carbonates
61	71	schisted porphyry mineralized
71	78	porphyry with quartz stringers containing chalco pyrites
78	102	porphyry

DRILL LOG BY STUPACK-JOHNSON

(recopied by Assessment Work Library)

Claim No: KRL.47916

AWL Hole No: 54

S.J. Hole No: 1

Total Footage: 103

Date Started: July 20, 1962

Dip: 40°

Date Finished: July 23, 1962

Log:

<u>From</u>	<u>To</u>	<u>Description</u>
0	45	quartz porphyry
45	53	feldspar porphyry mineralized
53	75	greenstone with fine mineral in spots
75	77	quartz
77	89	porphyry with few quartz stringers
89	103	carbonates with quartz stringers

200 0713

DRILL LOG BY STUPACK-JOHNSON

(recopied by Assessment Work Library)

Claim No: KRL.47917

AWL Hole No: 55

S.J. Hole No: 2

Total Footage: 101

Date Started: July 26, 1962

Dip: 45°

Date Finished:

Log:

<u>From</u>	<u>To</u>	<u>Description</u>
0	5	porphyry containing ^{lime} pyrites
5	55	porphyry
55	71	porphyry and quartz stringers mineralized
71	92	carbonates with mineralized quartz stringers
92	101	porphyry and quartz stringers, quartz containing chalcopyrites.

BALL TWP

DIAMOND DRILL RECORD

PROPERTY Stupack Johnson Group HOLE NO. 65-1

SHEET NUMBER One SECTION FROM 0 TO 122 STARTED May 24, 1965.

LATITUDE _____ DATUM _____ COMPLETED May 30, 1965.

DEPARTURE _____ BEARING South (180°) ULTIMATE DEPTH 122.0'

ELEVATION Surface DIP Minus 45° PROPOSED DEPTH 120.0'

DEPTH FEET	FORMATION	SAMPLE NO.	WIDTH OF SAMPLE	GOLD \$	SLUDGE GOLD \$
3.0 - 11.5	Porphyrytized Lava - slight banding, some pencil lead wide quartz stringers filling fractures				
11.5 - 18.5	Quartz Porphyry - white phenocrysts - white quartz veinlets @ 13.5 to 14.5-16.5-17.5 to 18.0				
18.5 - 19.0	Porphyrytized lava - as above				
19.0 - 21.0	Grey green, silicified, same as above por. lava				
21.0 - 33.6	Porphyrytized lava - few white quartz stringers				
33.6 - 34.0	Silicified section as above				
34.0 - 35.5	Porphyrytized lava				
35.5 - 37.0	Silicified section - grey green				
37.0 - 37.2	1/2" white quartz stringer - barren 60° to core				
37.2 - 44.5	Porphyrytized lava				
44.5 - 45.0	Porphyrytized lava, some Epidote stringers				
45.0 - 50.0	Porphyrytized lava				
50.0 - 52.0	Silicified lava - white quartz stringer @ 52.0				
52.0 - 55.0	Fine grained grey lava - few pheno crystals				
55.0 - 60.0	Silicified Porphyrytized lava - grey green - in some sections waxy appearance.				
60.0 - 62.0	Greenish white Breccia with white quartz vein @ 8 inches and 3 inches - few blueish grey				

RED LAKE
MINING DIV.
RECEIVED
JUN 1 1965

DRILLED BY Wm Stupack

SIGNED [Signature]

DIAMOND DRILL RECORD

PROPERTY _____ HOLE NO. _____

SHEET NUMBER Two SECTION FROM _____ TO _____ STARTED _____
 LATITUDE _____ DATUM _____ COMPLETED _____
 DEPARTURE _____ BEARING _____ ULTIMATE DEPTH _____
 ELEVATION _____ DIP _____ PROPOSED DEPTH _____

DEPTH FEET	FORMATION	SAMPLE NO.	WIDTH OF SAMPLE	GOLD \$	SLUDGE GOLD \$		
	quartz veinlets sparse mineral						
62.0 - 63.5	Silicified as above						
63.5 - 64.0	Breccia section, white quartz vein with ladder like cross fractures filled with later quartz						
64.0 - 71.0	Porphyrytized lava - few narrow qtz. Stringers						
71.0 - 72.5	Silicified section - some breccia						
72.5 - 109.0	Grey Porphyrytized lava - few quartz veinlets						
	@ 83.8-85.6-87.8-90.2-91.4-100.0-107.0 @						
	100.6 - some pyrite & chalc on fracture						
109.0 - 109.8	Lost core						
109.8 - 112.4	Grey Porphyrytized Lava						
112.4 - 112.8	Lost Core						
112.8 - 118.0	Grey Porphyrytized Lava						
118.0 - 118.3	Lost core (Ground)						
118.8 - 122.0	Grey Porphyrytized lava						

RED LAKE
MINING DIV.

RECEIVED

AM 7:20 PM

N.M.P. TORONTO-STOCK FORM NO. 501 REV. 12/51

DRILLED BY Wim Stupack

SIGNED J. R. ...

DIAMOND DRILL RECORD-COCHENOUR EXPLORATIONS LTD.

HOLE NO.		BEARING		LAT.		DATE START		LOGGED BY		
PROPERTY:		DIP		DEP.		COMPLETED				
CORE SIZE:		ELEV.		DEPTH:		SECTION ____ TO ____		DATE:		
DEPTH				SAMPLES		ASSAYS				
FROM	TO	GEOLOGICAL DESCRIPTION		NO	FROM	TO	WIDTH			GRAPHIC LOG
15.5	48.0	35.0-36.5 - fine grained carbonated blebs of brassy pyrite 2% - few stringers quartz & carbonate								
		35.5-48.0 - fine grained carbonated lava? few narrow Q.C. stringers - pencil like to 1/2". 39.0-40.5 - lighter color, more quartz/carbonate stringers. 40.5-41.5 - fine grained, less quartz/carb. stringers 41.5-47.0 - lighter color, more qtz/carb. stringers on alteration.								
		47.0-48.0 - light green, very silicious few qtz.-carb. stringers - no mineral								
48.0	62.0	Dark grey porphory - sheared, slightly waxy - few quartz eyes - few minute quartz stringers filling joint - at 55.0 1" white quartz stringers - 58.3-59.1 3/4" white quartz & carbonate stringer cutting core at -55° to contorted at 60.7 - 1" yellow waxy alteration 62.0-1" waxy alteration.								

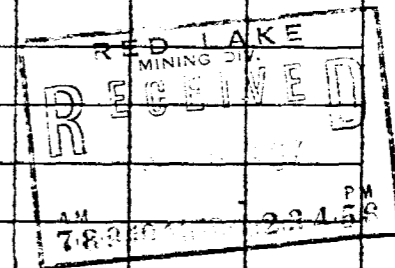

DIAMOND DRILL RECORD-COCHENOUR EXPLORATIONS LTD

HOLE NO.		BEARING	LAT.	DATE START		LOGGED BY	
PROPERTY:		DIP	DEP.	COMPLETED			
CORE SIZE:		ELEV.	DEPTH:	SECTION _____ TO _____		DATE:	
DEPTH		SAMPLES		ASSAYS			
FROM	TO	GEOLOGICAL DESCRIPTION	NO	FROM	TO	WIDTH	GRAPHIC LOG
82.4	83.6	Altered lava - quartz-carbonate with chlorite 3% blue quartz in stringers and blebs					
83.6	87.7	Altered lava - finer grained more chloritic					
87.7	88.8	Dark grey porphory dyke					
88.8	93.4	Altered lava - quartz carbonate 89.5-90.4 - brown biotitic alteration					
83.4	105.0	Dark grey porphory - quartz-carb. onate stringers 96.0-96.5 - and at 101.0					
SAMPLES							
3.5	7.5	Altered lava, light, due to silicification, brecciated, 20% quartz & carbonate, about 1% sulphides, mostly pyrite	STU4	3.5	7.5	4.0'	

RED LAKE
 MINING DIV.
RECEIVED
 AM 788 1961 12 13 4 58 PM

DIAMOND DRILL RECORD-COCHENOUR EXPLORATIONS LTD

HOLE NO.	67-1	BEARING	LAT.	DATE START	LOGGED BY
PROPERTY:	Stupack	DIP	DEP.	COMPLETED	
CORE SIZE:	EXT	ELEV.	DEPTH:	SECTION ____ TO ____	DATE:

DEPTH		GEOLOGICAL DESCRIPTION	NO	SAMPLES			ASSAYS				GRAPHIC LOG
FROM	TO			FROM	TO	WIDTH					
7.5	8.5	Altered lava (grey altered) 10% white quartz in stringers - 1% fine pyrite, few cube pyrite	STU1	7.5	8.5	1.0					
35.0	36.5	Altered lava, as above, only darker 3 to 5% quartz in stringers 2-3% pyrite, in blebs and scattered crystals, some may be pyrrhotite? - some arsenopyrite? original rock could be basic lava	STU2	35.0	36.5	1.5					
72.0	73.5	Altered lava, as above, darker 1-2% quartz & carbonate stringers 1-2% sulphides. Mostly chalcopyrite Some pyrite & some white sulphide may be arsenopyrite - some biotite pencil line stringers	STU3	72.0	73.5	1.5					

RED LAKE
MINING DIV.
RECEIVED
JAN 10 1967
AM 7:28 12:34 PM 58

DIAMOND DRILL HOLE LOG

Stupack-Cochenour

50647

LOCATION -		Middle Bay		CORRECTED BY -		DATE May	DATE May	HOLE No Middle Bay
HOLE SIZE - EX		BEARING - North	DIP -45	DEPTH - 121.0	M-	M-	STARTED - 26/69	
ELEVATION -		LATITUDE -		DEPARTURE -		LOGGED BY - J.E. Durham		DATE June 2, 1962
						SAMPLES		ASSAYS
FROM	TO	GEOLOGICAL DESCRIPTION			No.	FROM	TO	WIDTH
0.0	16.0	Casing.						
16.0	27.0	Talcose - carbonated lava. 16.0-17.0 - some greenish alteration 1/2" qtz. strg. @ 17.2. @ 18.3 - 1/2" carb. strg. @ 20.0, 1" qtz- epidote strg. @ 22.5, carb-epidote alteration. 17.0-27.0 - blue grey phase.						
27.0	31.0	Talcose-carb. lava. Rusty phases @ 27.4 to 27.7 and 40.0 to 40.4? few narrow qtz-carb strgs. Brecciated appearance, magnetic grains throughout.						
31.0	33.5	Blue grey phase, as above, 2 - 1/2" qtz-carb. strgs.						
33.5	39.5	Same as section 27.0 - 31.0 above @ 36.5 - 1" qtz-carb strg. no mineral @ 45 Ø. Rusty at 37.5 - 38.5						
39.5	48.0	Blue grey phase, as 16.0-27.0 section, qtz-carb strg. @ 42.0, 43.0, 43.5, 45.5 from 46.0 to 48.0 numerous pencil line to 1/8" qtz-carb strgs. Rusty section 44.7 to 46.0. This section could be altered basic rock.						
48.0	66.0	Lighter blue phase of talcose carbonated lava, finer grained banded appearance in places, possibly original rock sheared numerous qtz-carb strgs. Longer ones at 50.1 to 50.6, 50.8, 55.8, 56.6 to 56.7, 58.0, 58.5 - rust at 51.5, 53.5 to 55.3. Very red at 54.2. Rusty section contact 53.4 @ nearly 90° to core, other contact at 55.25. @ 60° to core axis - 64.0-66.0 rustly 1/8" qtz. strg. @ 64.8 (red garnet or Hematite)						
66.0	66.6	Ground core						

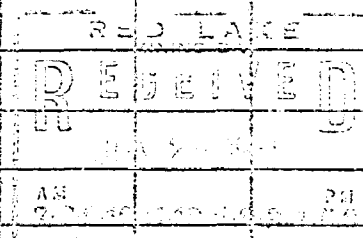

LOCATION -				DRILLED BY -	DATE STARTED -	DATE FINISHED -	HOLE No.
PIPE SIZE -	BEARING -	DIP	DEPTH -	M -	N -	LOGGED BY -	DATE.
ELEVATION -	LATITUDE -	DEPARTURE -	SAMPLES			ASSAYS	

FROM	TO	GEOLOGICAL DESCRIPTION	No.	FROM	TO	WIDTH
66.6	76.0	Light green phase with bluish banding @ 45° to core axis, rusty throughout. 67.0 to 68.8 very rust few 1/8" narrow qtz-carb strgs.				
76.0	76.3	Core ground				
76.3	78.2	As above, 66.6 to 76.0 section very rusty				
78.2	79.7	Core ground				
78.9	121	Light blue phase, Talc-carb'd lava remnant banding - 40° to 60° to core axis, rust staining at 78.9 to 80.5. 80.5-87.0 some rusty staining. 87.0-90.6 - blue phase little or not rust 90.6-95.4 - Rusty staining. 95.4-108.4 - light blue phase. 108.4-113.2 slight rusty staining. 113.2-118.1 very red rusty staining. 118.1 to 121.0 grey green talc-carbonated lava.				

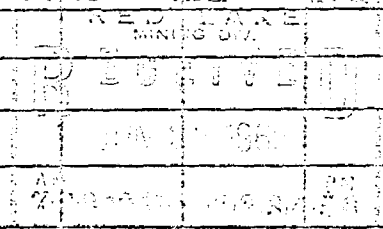

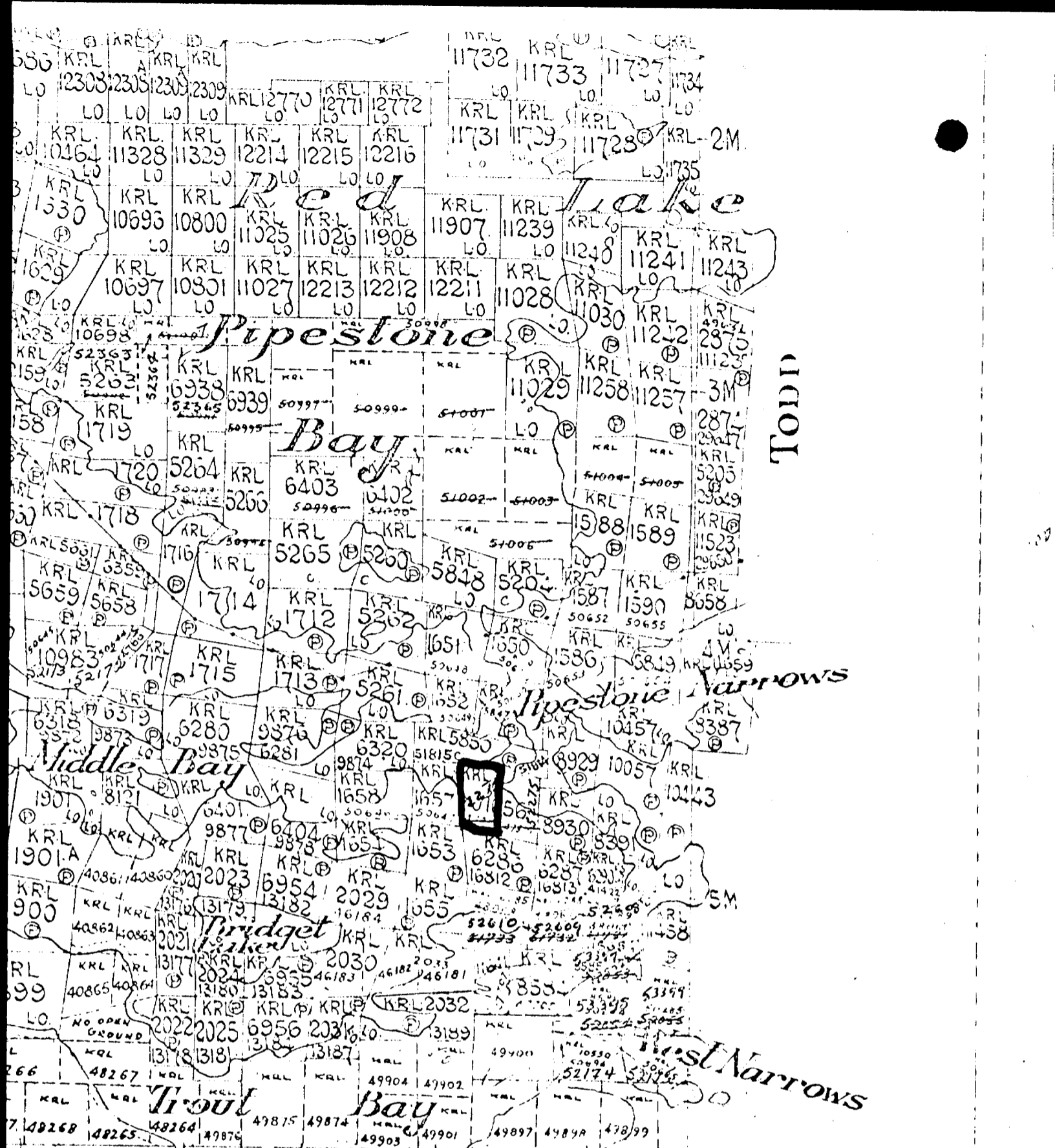

2M.

1M.

Bald Twp.

M 2136

DIAMOND DRILL HOLE LOG

MIDDLE BAY

Bar - TND

LOCATION - MIDDLE BAY

DRAILED BY -

DATE May
STARTED - 28/69

DATE May
FINISHED 30/69

HOLE No. 69-2

ORE SIZE - EX

BEARING - N25W

DIP -45

DEPTH - 120' H- N-

LOGGED BY - J.E. Durham

DATE June 2, 1969

ELEVATION -

LATITUDE -

DEPARTURE -

SAMPLES

ASSAYS

FROM	TO	GEOLOGICAL DESCRIPTION	No.	FROM	TO	WIDTH
0.0	9.0	Casing				
9.0	26.0	Qtz. Porphyry - bluish qtz. eyes 1/8" diameter, matrix greenish grey.				
26.0	32.6	Silicified lava.				
32.6	48.5	Brecciated lava. Silicified heavily carbonated grey green color				
48.5	61.0	Dark basic rock, possibly diorite? silicified, sparse cube pyrite.				
61.0	78.0	Fine grained, lava, rhyolitic in composition, considerable sericite alteration, highly silicified, 1/2" white qtz. vein @ 72.0, 1" white qtz. & carbonate veinlet at 75' - 1/2" white qtz. & carb vein at 76.5 and 1" white qtz & carb veinlet at contact at 78.0'				
78.0	80.5	Black dyke, silicified, some cube pyrite				
80.5	90.0	Qtz porphyry - grey green color				
90.0	102.0	Lava, silicified, some narrow qtz-carb strgs., in sections porphyrytized slight pyrite min.				
102.0	106.0	Qtz porphyry - some sericitization few narrow qtz-carb strgs.				
106.0	120.0	Lava, silicified, porphyrytized dark bluish in color, at 116.0 - 6" qtz-carb vein, no mineral - ground core at 56.0 to 57.0 and 90.0 to 90.8				
		Samples - Black dike - 1% pyrite	69-2-1	79.5	80.5	12"
		lava as above 1% pyrite	69-2-2	91.5	92.0	6"

RECEIVED
 REEVE
 JUN 17 1969
 PM
 2:45

DIAMOND DRILL RECORD

Ball Twp

PROPERTY Middle Bay Group. HOLE NO. W.S. 68-1

SHEET NUMBER One SECTION FROM _____ TO _____ STARTED May 20, 1968
 LATITUDE Claim MRL 52275 DATUM _____ COMPLETED May 25, 1968
 DEPARTURE _____ BEARING South ULTIMATE DEPTH 104.0 ft.
 ELEVATION Lake Level plus 6 ft. DIP - 45° PROPOSED DEPTH 100.0 ft.

DEPTH FEET	FORMATION	SAMPLE NO.	WIDTH OF SAMPLE	GOLD \$	SLUDGE GOLD \$
00 - 5.0	Casing.				
5.0 - 9.5	Altered Lava, fine grained, chloritic, carbonated.				
9.5 - 10.5	Altered Lava, same as above, 50% quartz-carbonate, in veins and alteration, sparse minerals.	68-1-1	1.0'		
10.5 - 34.0	Altered Lava, Fine grained, chloritic, carbonated, few quartz carbonate veinlets 1/8 to 1/2 inch wide, some sections quite massive.				
34.0 - 35.5	Altered Lava, as above, 50% quartz carbonate in veins and alteration, some bluish quartz. very sparse mineralization, mostly pyrite.	68-1-2	1.5'		
35.5 - 38.2	Altered lava, fine grained, chloritic, carbonated, possibly dioritic or tuffaceous.				
38.2 - 39.0	Altered Lava, as above, 50% quartz carbonate	68-1-3	1.0'		
39.0 - 41.-	fine grained, chloritic, carbonated, dioritic looking, fine grained toward end.				
41.0 - 50.0	green, chloritic, crushed, brecciated, 25-35% quartz carbonate as veinlets and as filling in breccia, 2-3% fine pyrite, mineralized throughout, 1/2% chalcopyrite, some small veinlets of bluish quartz, in fractures in white quartz.	68-1-4 68-1-5 68-1-6	3.0' 3.0' 2.5'		

RED LAKE
MINING DIV.

RECEIVED

MAY 27 1968

AM

68-1-1-2 123.456

N.M.P. - TORONTO - STOCK FORM NO. 501 REV. 12/51

DRILLED BY Wm. Stupack

SIGNED *J. Durham*





COCHENOUR-WILLANS GOLD MINES LIMITED
DRILL HOLE RECORD

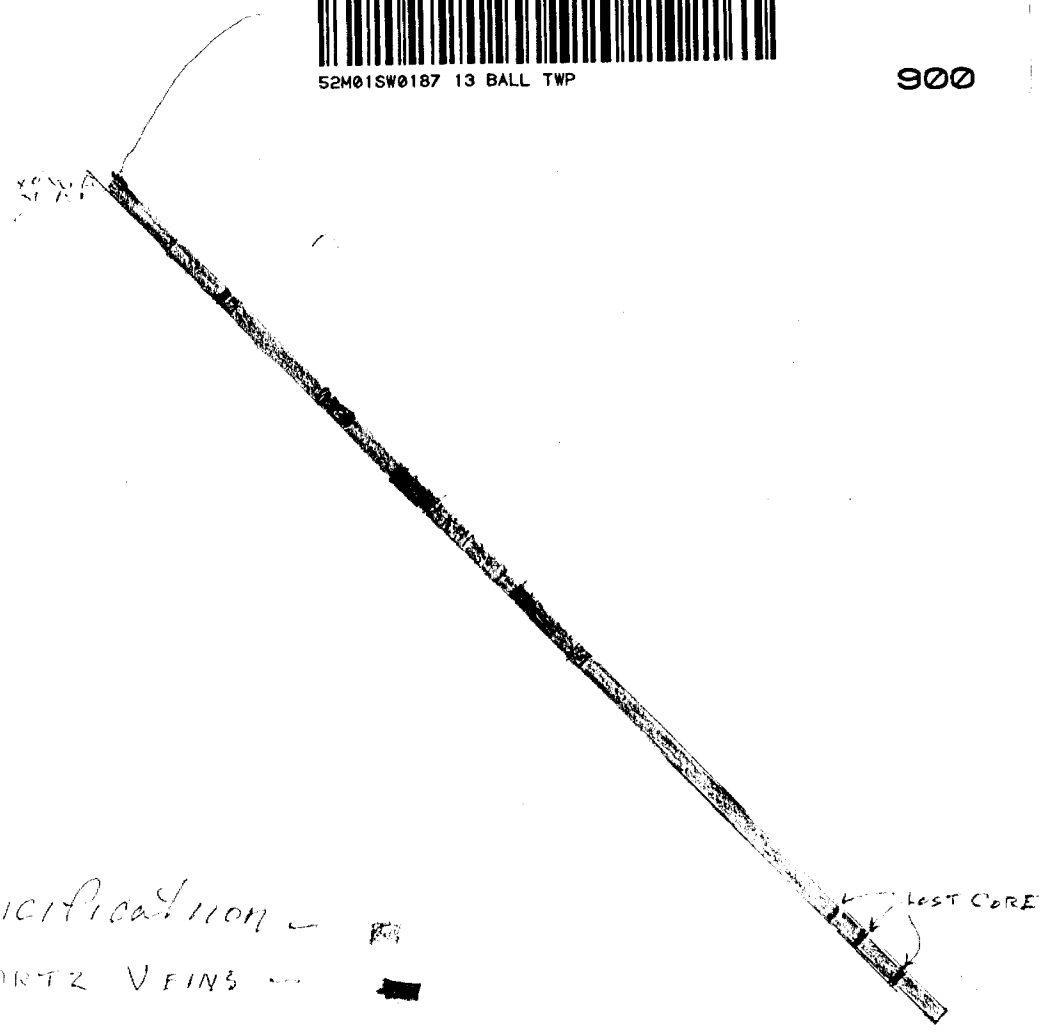

52M01SW0187 13 BALL TWP

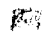
900



- Silicification — 
- QUARTZ VEINS — 
- Porphyritic lava. — 
- Basalt Porphyry — 
- Grey lava — 

PROPERTY Stupack-Johnson Group.
HOLE NO. 65-1
BEARING South. (180°)
DEPTH 122'0"
SCALE 1" = 20'
DATE June 3 1965



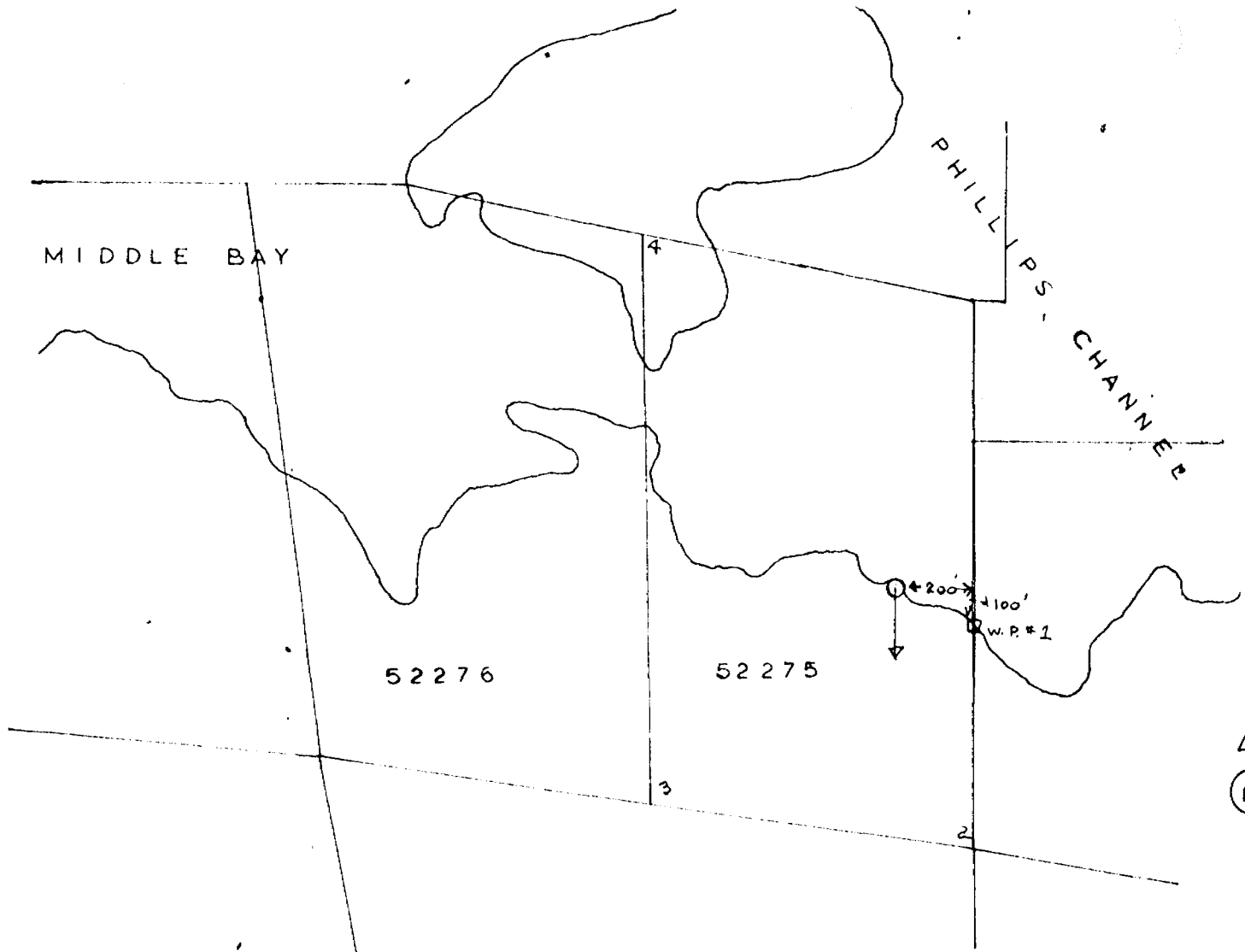

MIDDLE BAY GROUP
 BALL TOWNSHIP
 D.D.HOLE LOCATION SKETCH
 HOLE W-S 68-1
 DIP - 45°
 DEPTH 104.0 ft
 BEARING South

Scale 1 inch = 400 feet.

RED LAKE
 MINING DIV.
RECEIVED
 MAY 27 1968
 AM 7 8 9 10 11 12 1 2 3 4 5 6 PM

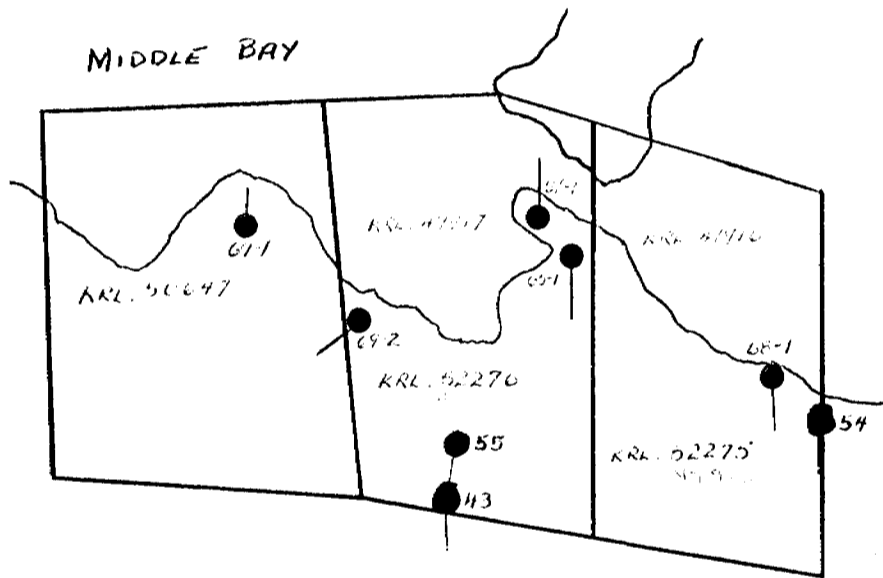

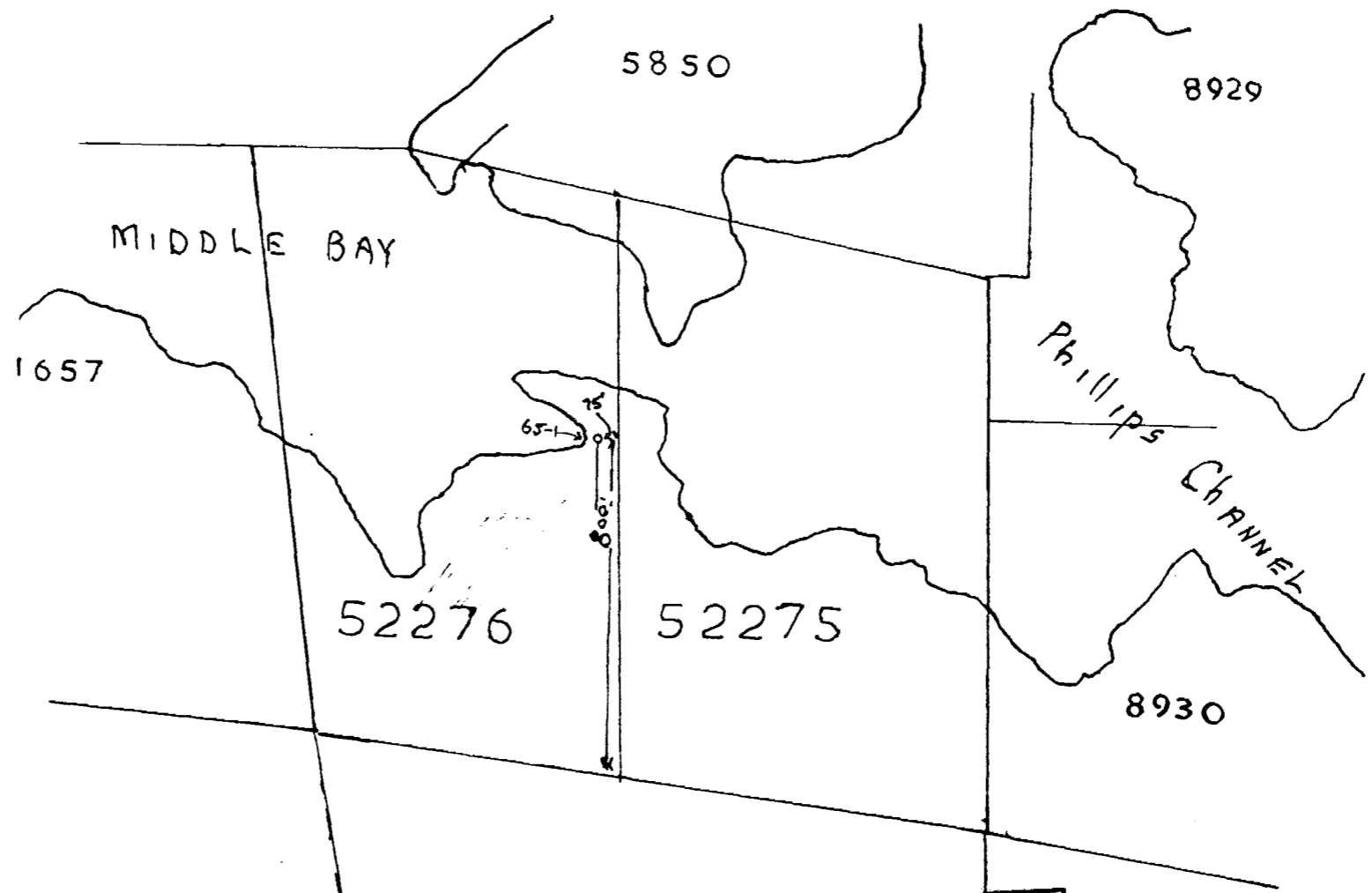

1653
Stupack-Johnson Group
BALL Twp.
D.D.H. LOCATION

RED LAKE
MINING DIV.
RECEIVED
AM 7:89
PH 3:34

16812

16813

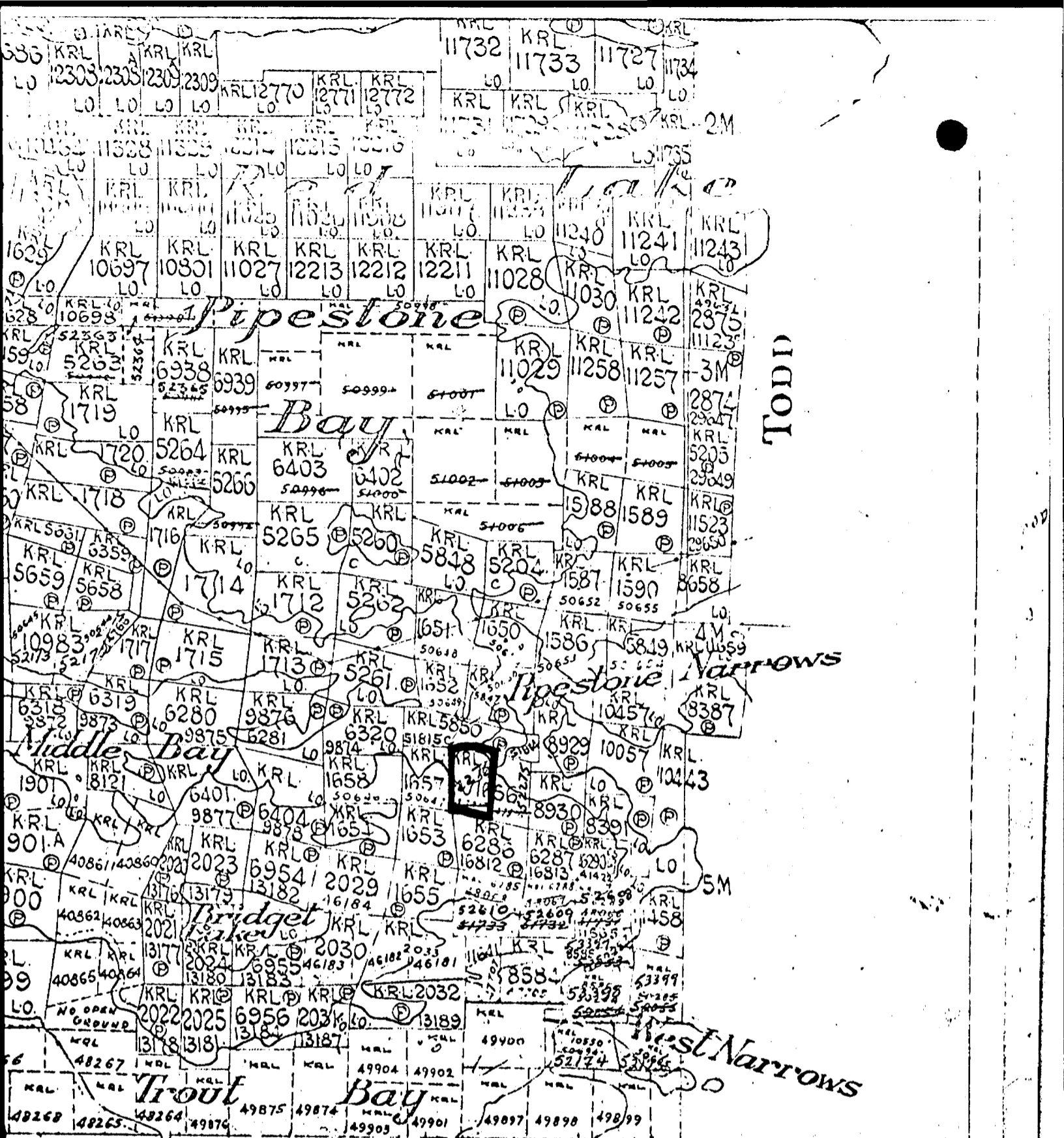

TODD



Ball Twp.
M 2136

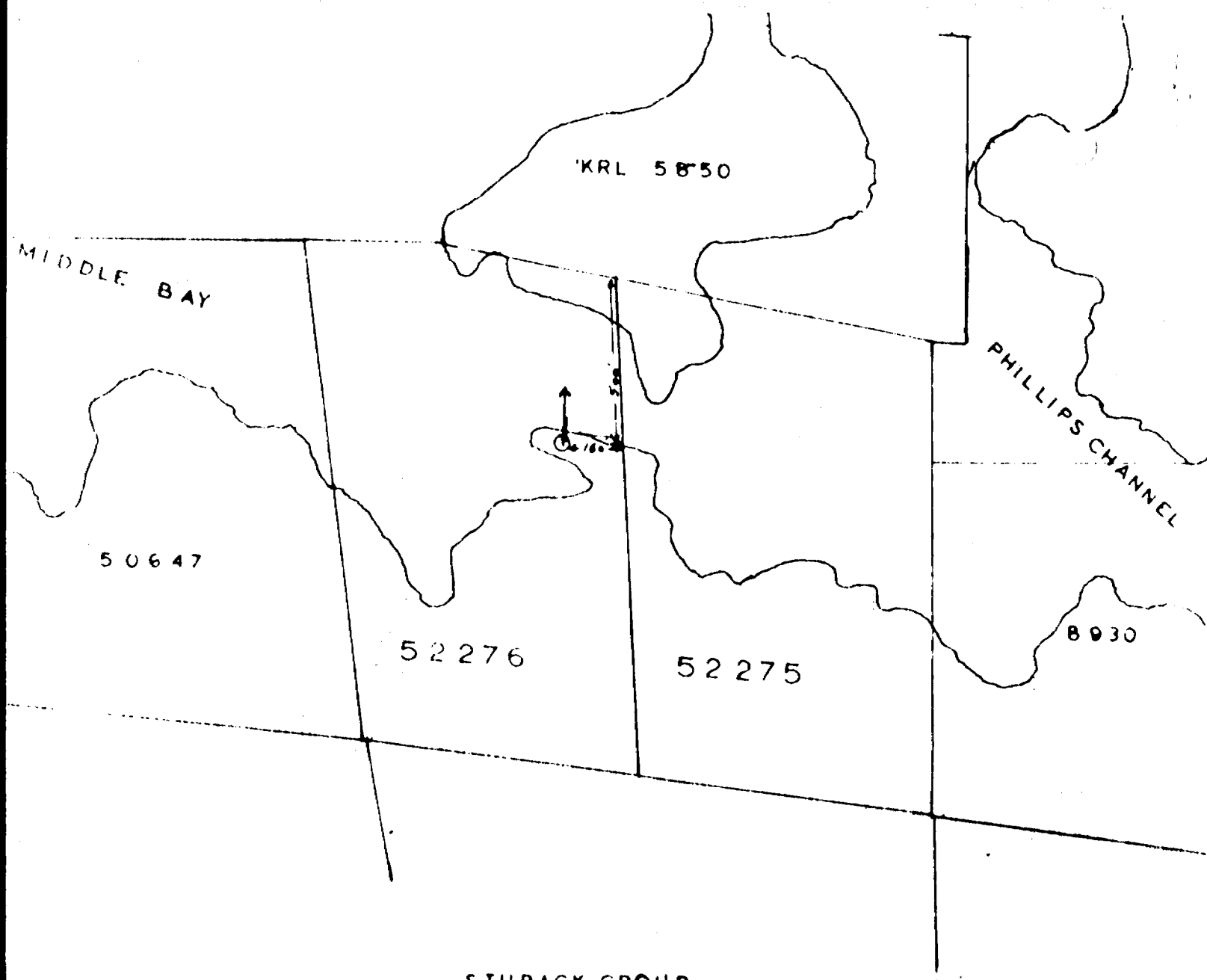

STUPACK GROUP,
 DRILL HOLE LOCATION SKETCH
 BALL TOWNSHIP.

RED LAKE
 MINING DIV.
RECEIVED
 MAY 20 1967
 AM 7:00 PM 4:56

MAY 1967.
 Scale 1 in. = 400 ft

200-116

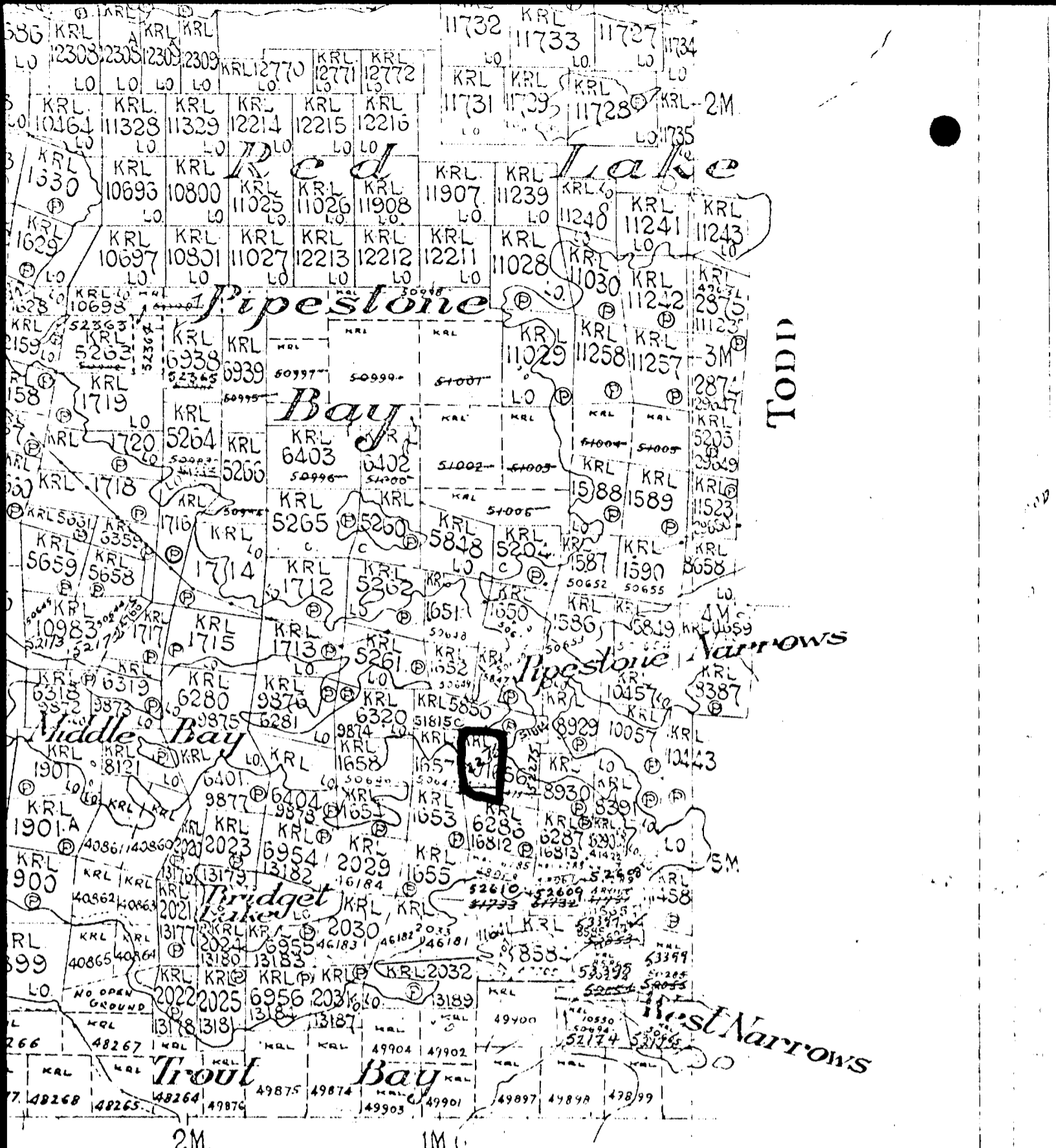

TODD



Ball Twp.
M 2136

RED LAKE
MINING CO.
RECEIVED
JUN 20 1907
AM
7:00 AM

3880 000

BALL TWP.
DD HOLE 69-1 & 69-2

MIDDLE BAY

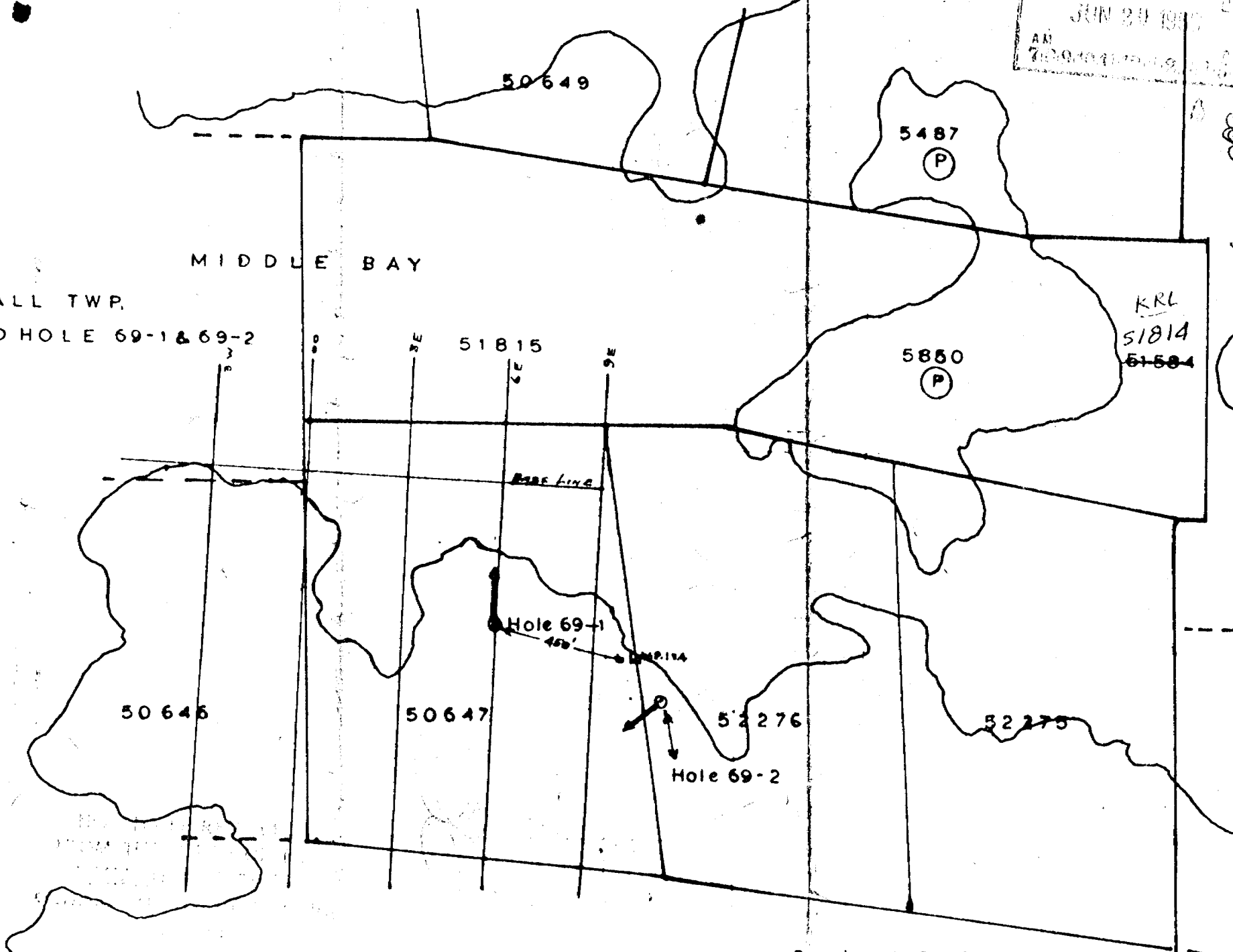

KRL
51814
51584

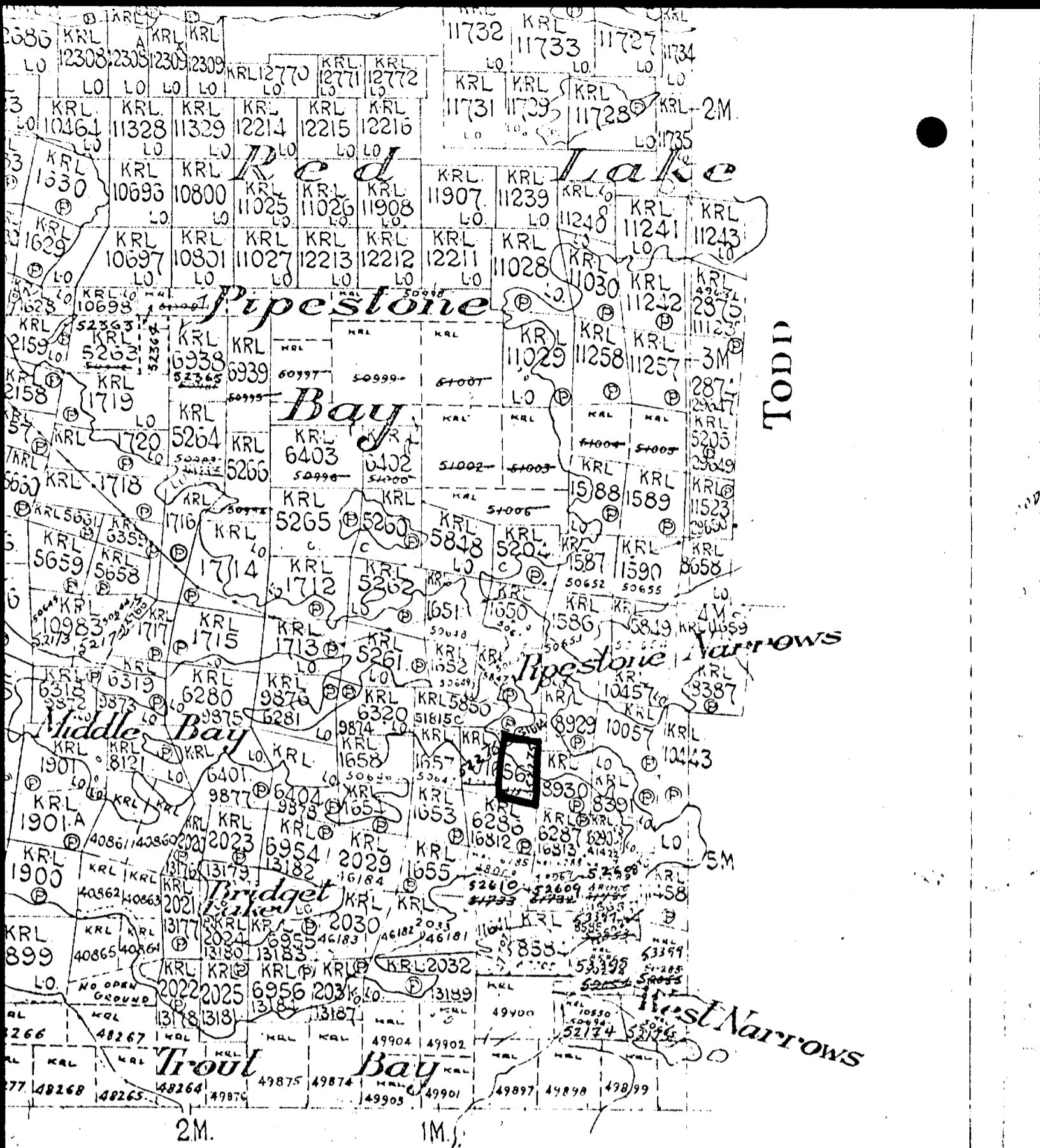

Ball Twp.
M. 2136

Core Log

Claim 4791B Ball Top.

Depth 102. angle 45° S.

Core 7/8 inch

Dates	Footage	Holes #	Materials
May 1.	0 - 44 ¹⁷ ft.	102 ft	Carbonates with few quartz stringers.
" 2	44 ¹⁷ - 61 ¹⁷ ft.		Carbonates
" 2	61 ¹⁷ - 71 ¹⁷ ft.		Schistose porphyry, min.
" 3	71 ¹⁷ - 78 ¹⁷ ft.		Porphyry with quartz stringers
" 4.	78 ¹⁷ - 102 ¹⁷ ft.		porphyry containing chalcopyrite.

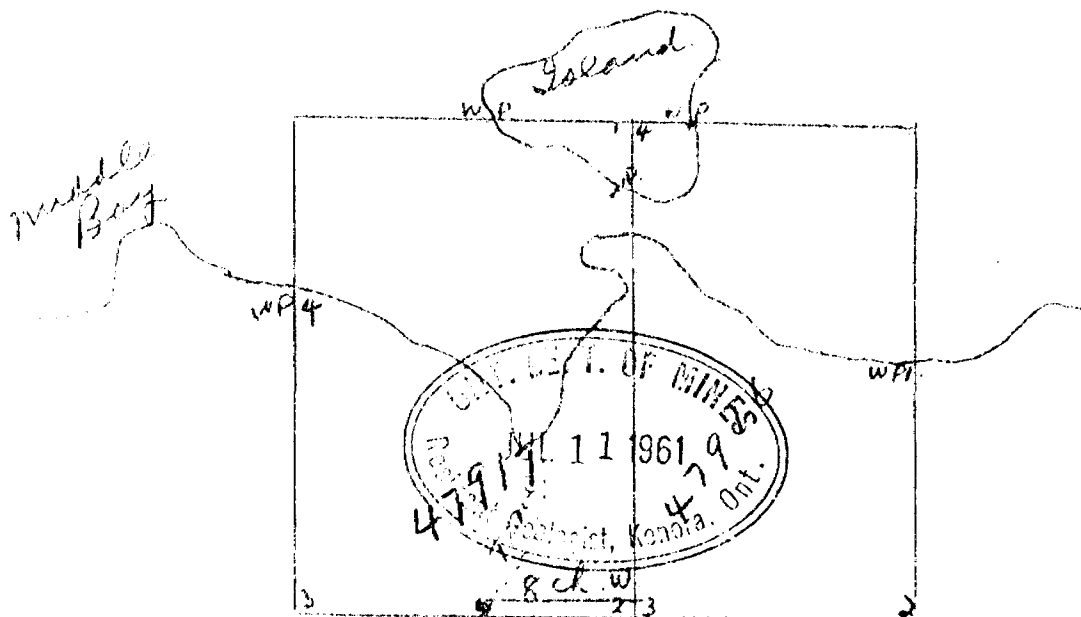

Location of drill
hole 8 ch. W. of no 2 P.
45° - South

MAY 17 1961
KENORA, ONT.

200 2776

Core Log - Claims & RL 47916 & 47
 Ball Twp.

Hole # 1. 103 ft. 40° - 7/8" core
 Hole # 2. 101" 45° - 7/8" core

Dates	Footage	Hole Angle		Materials
		Hole #	Angle	
July 20	0' - 45'	# 1	40°	Quartz porphyry
	45' - 53'			Feldspar porphyry mineralized
July 21	53' - 75'			Greenstone with fine mineral in sp.
	75' - 77'			Quartz
July 23	77' - 89'			Porphyry with few quartz stringers
	89' - 103'			Carbonates with quartz stringers
July 26	0 - 5'	Hole 2	45°	Porphyry containing fine pyrites
	5' - 5.5'			Porphyry
	5.5' - 71'			Porphyry and quartz str. mineralized
	71' - 92'			Carbonates with min. quartz stringers.
	92' - 101'			Porphyry and quartz stringers. quartz containing chalcopyrites.

Location of Drill Holes.

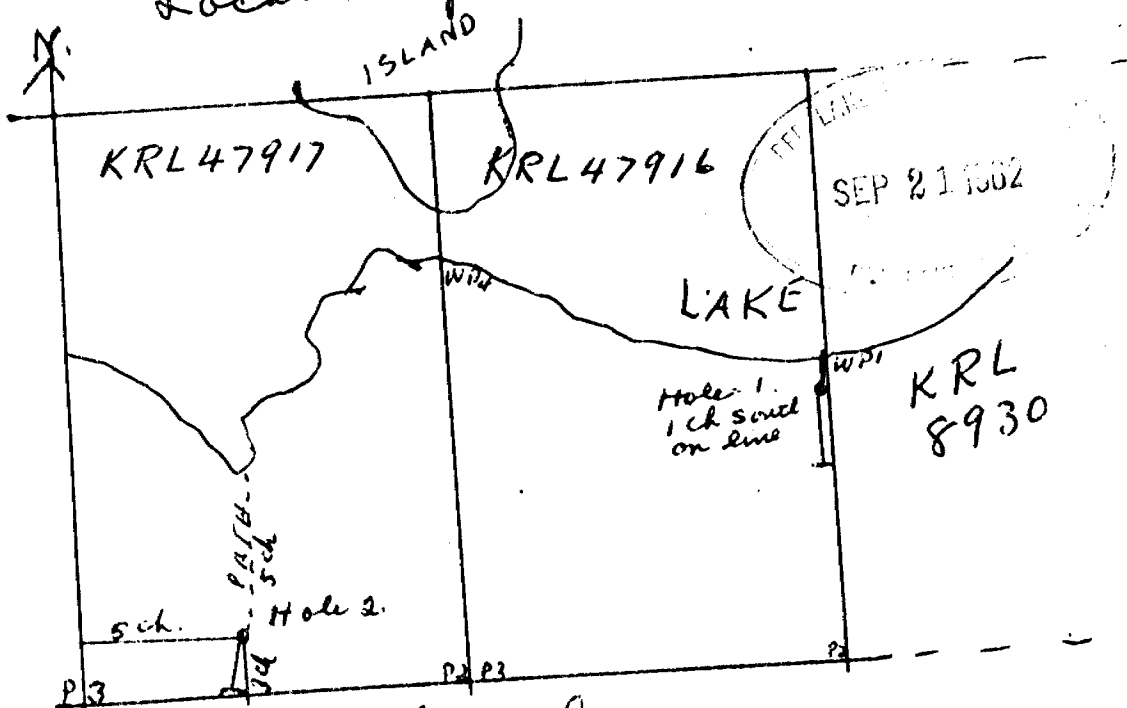

Wm. Stupack

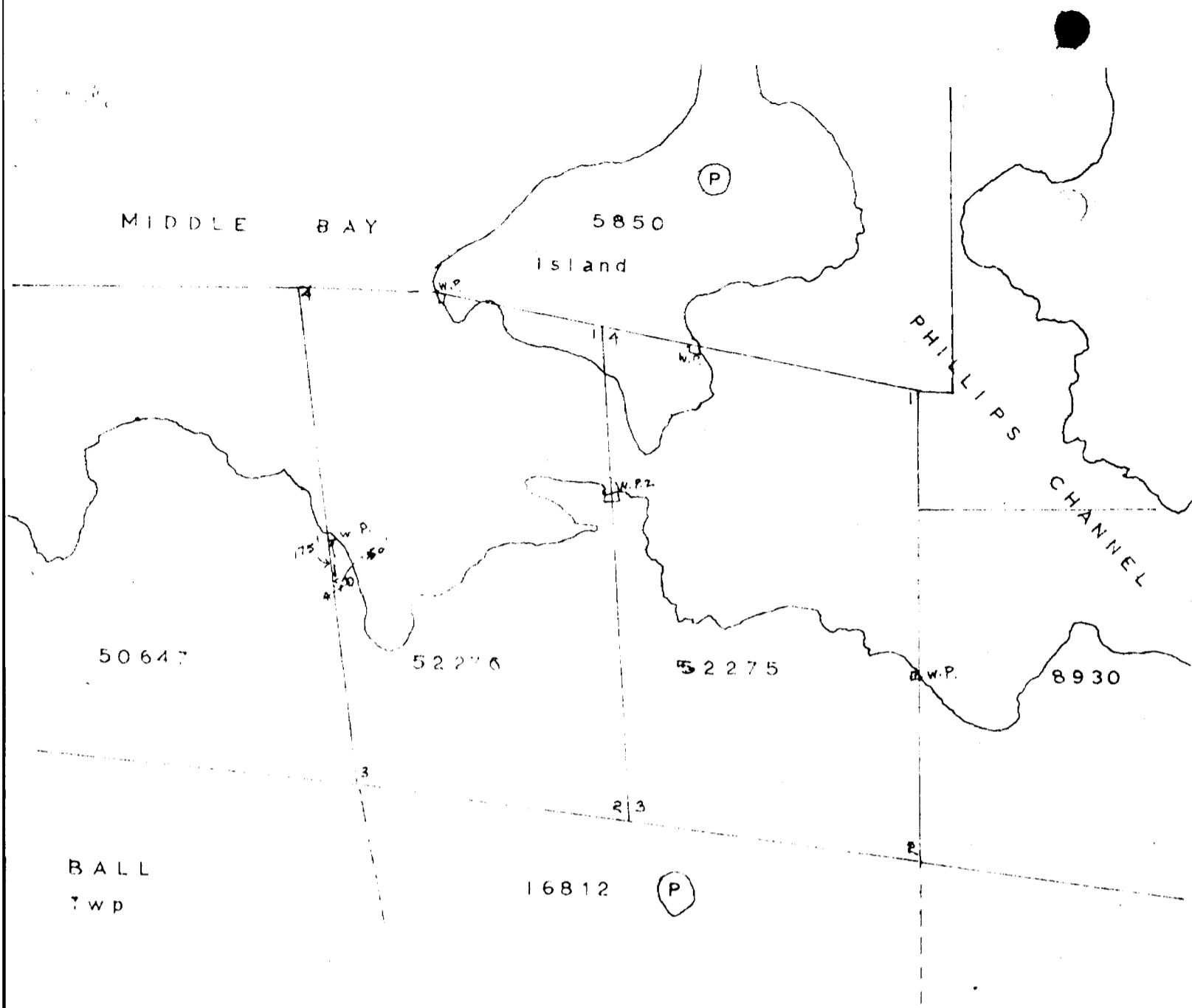

DRILL HOLE LOCATION SKETCH
 CLAIM KRL 52276
 DIP - 45°
 DEPTH 121.0 ft
 BEARING S 40 West

Scale 1" = 400'

200 0/00