



52M01SW0401 14 BALL TWP

010

Diamond Drilling

Township of BALL

Report NO 14

Work performed by: BIRON BAY GOLD MINES

Claim NO	Hole NO	Footage	Date	Note
KRL 43075	2	314.0'	Sept/58	

Notes:

KRL 43075

Ball Twp.

DIAMOND DRILL RECORD

PROPERTY BIRON BAY GOLD MINES HOLE NO. 2.

SHEET NUMBER 1 SECTION FROM _____ TO _____ STARTED SEPT 13, 1958
 LATITUDE 230' NORTH OF A POINT DATUM _____ COMPLETED SEPT 15, 1958
 DEPARTURE 230' EAST OF post III BEARING 203° T. ULTIMATE DEPTH 314'
 ELEVATION CLAIM KRL 43075 ALONG SOUTH BOUNDARY. DIP -36° PROPOSED DEPTH _____

DEPTH FEET	FORMATION	SAMPLE NO.	WIDTH OF SAMPLE	GOLD \$	SLUDGE GOLD \$
0 - 12	CASING.				
12 - 43	DACITE: DARK GREY, FINE GRAINED, MASSIVE APPEARANCE EXCEPT FROM 31 - 32 FEET WHICH IS BANDED AND SHEARED. SOME QUARTZ CARBONATE RIBBONS THROUGH OUT.				
16.5 - 17.5	BLuish GREY QUARTZ ZONE WITH SOME DISSEMINATED CHALCOPYRITE	3	1'	NIL.	
43 - 61	QUARTZ TONALITE PORPHYRY: LIGHT GREY COLOR, FINE TEXTURE, SMALL BLUE QUARTZ PHENOCRYSTS IN A FINE GRAY MATRIX, MASSIVE. SOME QUARTZ STRINGERS.				
46.5 - 47.5	BLuish QUARTZ VEIN @ ABOUT 45° TO ORE - A LITTLE PYRITE	4	1'	NIL.	
58 - 58.5	"DRY LOOKING" WHITE QUARTZ	5	.5'	NIL.	
61 - 140	DACITE: LIGHT TO DARK GREY, FINE GRAINED AND MASSIVE WITH				

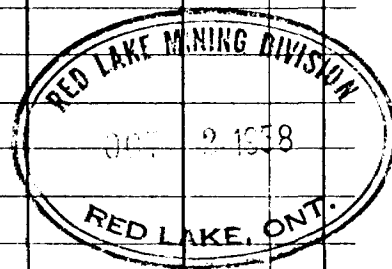

DIAMOND DRILL RECORD

PROPERTY BIRCH BAY GOLD MINES HOLE NO. 2

SHEET NUMBER 2 SECTION FROM _____ TO _____ STARTED _____

LATITUDE _____ DATUM _____ COMPLETED _____

DEPARTURE _____ BEARING _____ ULTIMATE DEPTH _____

ELEVATION _____ DIP _____ PROPOSED DEPTH _____

DEPTH FEET	FORMATION	SAMPLE NO.	WIDTH OF SAMPLE	GOLD \$	SLUDGE GOLD \$
	SOME MINUTE QUARTZ CARBONATE STRINGERS THROUGHOUT. ONE INCH OF WHITE QUARTZ @ 80.4 FEET.				
134 - 148	BLuish GRASSY QUARTZ WITH SOME COARSE DISSEMINATED PYRITE.	6	.8'	NIL	
109 - 111	BLuish QUARTZ	7	2'	NIL	
140 - 145	TONALITE PORPHYRY: LIGHT GREY IN COLOUR, FINE TEXTURE WITH LIGHT GREY FELDSPAR PHENOCRYSTS				
145 - 197	DIORITE: LIGHT TO DARK GREY TIGHTLY SHEARED AND ALTERED BY SILICIFICATION AND SOME CHALKITIZATION. CORE HAS A BANDED APPEARANCE DUE TO SHEARING.				
	SEISTOSITY @ 70' TO CORE. WHITE QUARTZ VEINS @ 146.5 - 147, 149.5 - 150, 151.5 - 152.5, 168 - 168.5, 169 - 171, 172 - 172.5, 183.5 - 184.5				
151.5 - 152.5	WHITISH GREY QUARTZ	8	1'	NIL	



DIAMOND DRILL RECORD

PROPERTY BIRCH BAY GOLD MINES HOLE NO. 2

SHEET NUMBER 3 SECTION FROM _____ TO _____ STARTED _____

LATITUDE _____ DATUM _____ COMPLETED _____

DEPARTURE _____ BEARING _____ ULTIMATE DEPTH _____

ELEVATION _____ DIP _____ PROPOSED DEPTH _____

DEPTH FEET	FORMATION	SAMPLE NO.	WIDTH OF SAMPLE	GOLD \$	SLUDGE GOLD \$
118 - 172.5	MOSTLY QUARTZ IN SILICIFIED DACITE	9	4.5'	NIL	
183.5 - 184.5	DARK BROWNISH GREY QUARTZ	10	1'	NIL	
197 - 205	TONALITE PORPHYRY: SIMILAR TO SECTION 140-145. PROBABLY DIAGENETIC SHEARING AND SILICIFICATION AT CONTACTS AND BEYOND.				
205 - 223	DACITE: MASSIVE, FINE GRAINED DARK GREY, HEAVILY SILICIFIED FROM 205 - 207				
223 - 273.5	GRANODIORITE: GREY IN COLOR WITH SOME SECTIONS SLIGHTLY REDDISH DUE TO FELDSPAR CRYSTALS. FRESH LOOKING, MEDIUM GRAINED TEXTURE, A LITTLE DISSEMINATED PYRITE AND CHALCO PYRITE THROUGHOUT. NUMEROUS 1/2 TO 1 INCH RIBBONS OF QUARTZ. INCUSIONS OF DACITE FROM 225 TO 227 AND 228 - 228.5.				

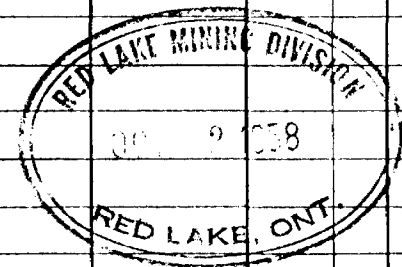

DIAMOND DRILL RECORD

PROPERTY BIRON BAY GOLD MINES HOLE NO. 2

SHEET NUMBER A SECTION FROM _____ TO _____ STARTED _____

LATITUDE _____ DATUM _____ COMPLETED _____

DEPARTURE _____ BEARING _____ ULTIMATE DEPTH _____

ELEVATION _____ DIP _____ PROPOSED DEPTH _____

DEPTH FEET	FORMATION	SAMPLE NO.	WIDTH OF SAMPLE	GOLD \$	SLUDGE GOLD \$
	CONTACT IS FINE GRAINED AT 273.5				
	QUARTZ VEINLETS CROSSING C&S				
	@ 30' 45° AT 234, 239, 246				
	252 256.5, 259.5, 260.5				
	261 & 269, ALSO FROM 265.5-266.5				
265.5-266.5	WHITISH QUARTZ @ 30' TO C&S, FRACTURED // WITH 'PLATY' PYRITE ALONG FRACTURES SERPENTINE ALTERATION ALONG CONTACTS		1'	NIL	
273.5 - 291	HORNBLÉNDE DIORITE: DARK GREEN, FINE TO MEDIUM GRAINED, BASIC LICKING. 5% DISSEMINATED PYRITE THROUGH OUT.				
284.5-285	BLUSH QUARTZ AS BRECCIA FILLING SOME PYRITE AND PYRRHOTITE	12	.5'	NIL	
291 - 314	GRANODIORITE: SIMILAR TO SECTION 223 - 273.5. HORNBLÉNDE DIORITE FROM 296 - 296.2				
314	END OF HOLE.				

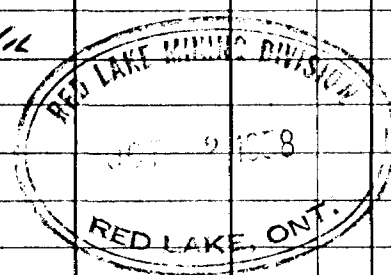

900



52M01SW0401 14 BALL TWP

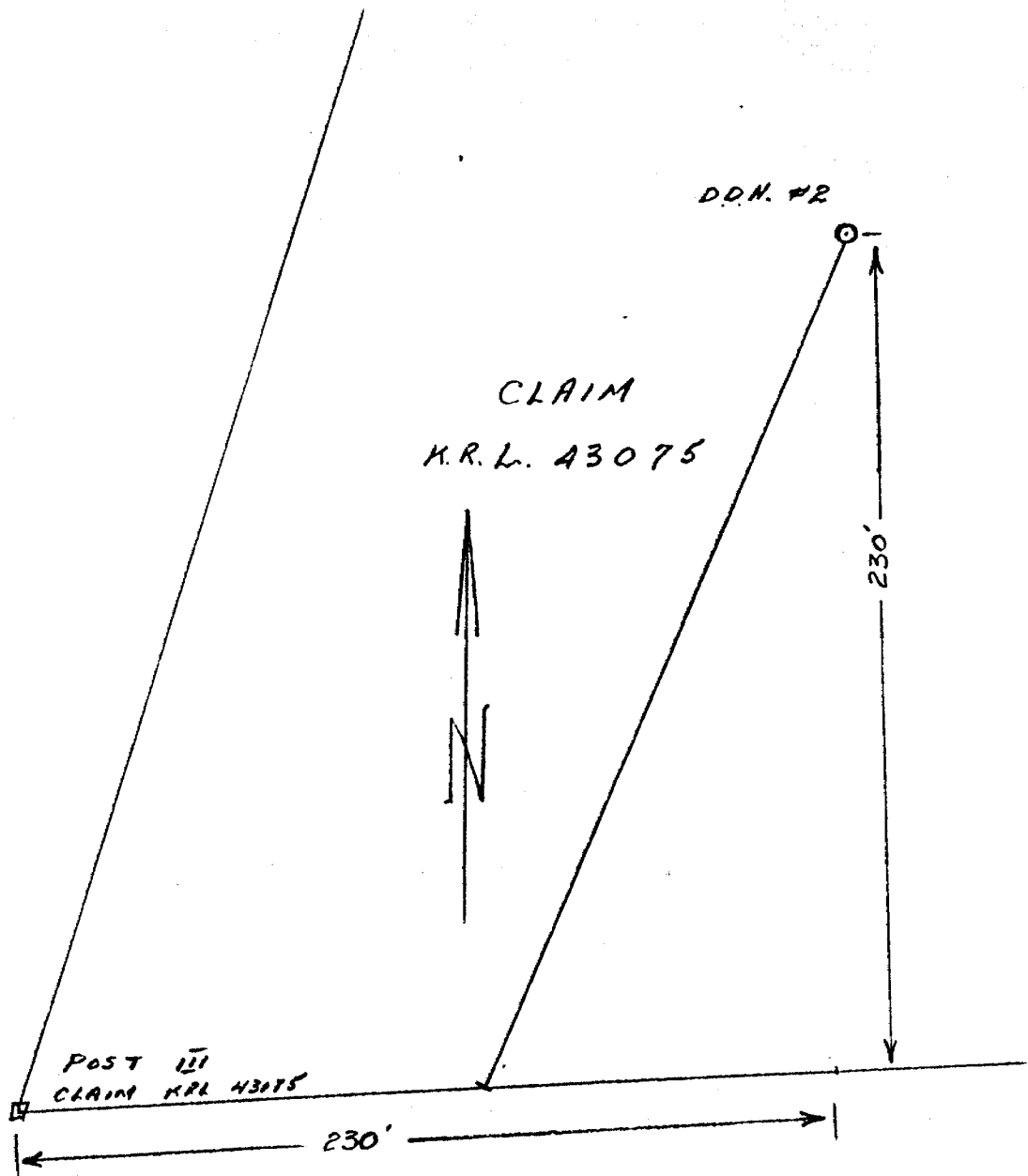

D.O.N. #

Scale: