



52N02SE0008 2.13567 AGNEW

010

2.13567

LAC MINERALS LTD.

REPORT ON A GEOLOGICAL SURVEY
UCHI LAKE PROPERTY

CLAIM NOS: K.R.L. 977385-397
K.R.L. 977399-409

UCHI LAKE, NORTHWESTERN ONTARIO
NTS SHEET NO. 52N/2

RECEIVED

SEP 27 1990

MINING LANDS SECTION

INTRODUCTION

The following is a geological report on a mapping survey conducted by LAC Minerals Ltd. between July 12- July 28, 1990 on claims K.R.L. 977385-397 inclusive and K.R.L. 977399-409 inclusive, a part of LAC's Uchi Lake Property.

PROPERTY DESCRIPTION, LOCATION AND ACCESS

The property consists of 24 unpatented mining claims totalling 960 acres and is divided into two claim blocks, north and south, with 14 and 10 claims respectively. These two claim blocks are both contiguous with LAC's patented claims immediately to the west (see property map).

The property is located 88km east of the town of Red Lake in Earngey township, northwestern Ontario. The south claim block straddles a portion of the central part of Uchi Lake and its western shore, while the north claim block is situated 100 to 800m west of the northern tip of Uchi Lake. The property is within NTS sheet 52N/2.

Access is afforded by float-equipped aircraft chartered from Red Lake or Ear Falls to the property.

All of the claims are registered in the name of:

LAC Minerals Ltd.
1100 - 20 Adelaide Street East
Toronto, Ontario
M5C 2T6

HISTORY

Exploration and mining interests in the area began with the Woman Lake Gold Rush of 1926 which led to the development of five main mines. These include the Uchi, J-M Consolidated, Hudson Patricia, Sol D'Or and Argosy. These together produced 245,582 ounces of gold and 42,612 ounces of silver from 1,150,690 tons milled during the period 1929-1943. In the immediate vicinity of Uchi Lake, extensive exploration and development work was conducted by Uchi Lake Gold Mines (LAC Minerals) from 1927 to 1943. This includes five shafts; Uchi #1, Uchi #2, Jalda, Hanalda and Grassett. The vast majority of production came from the Uchi #1 and #2. This production totalled 114,000 ounces of gold from 750,000 tons of ore. Exploration was resumed intermittently in 1980 to the present by LAC Minerals Ltd. Exploration work has consisted of linecutting, geological mapping, humus sampling, ground geophysics (VLF, Mag and IP), prospecting, overburden drilling and diamond drilling.

AGNEW TWP.

FOR STATUS REFER TO TWP PLAN.

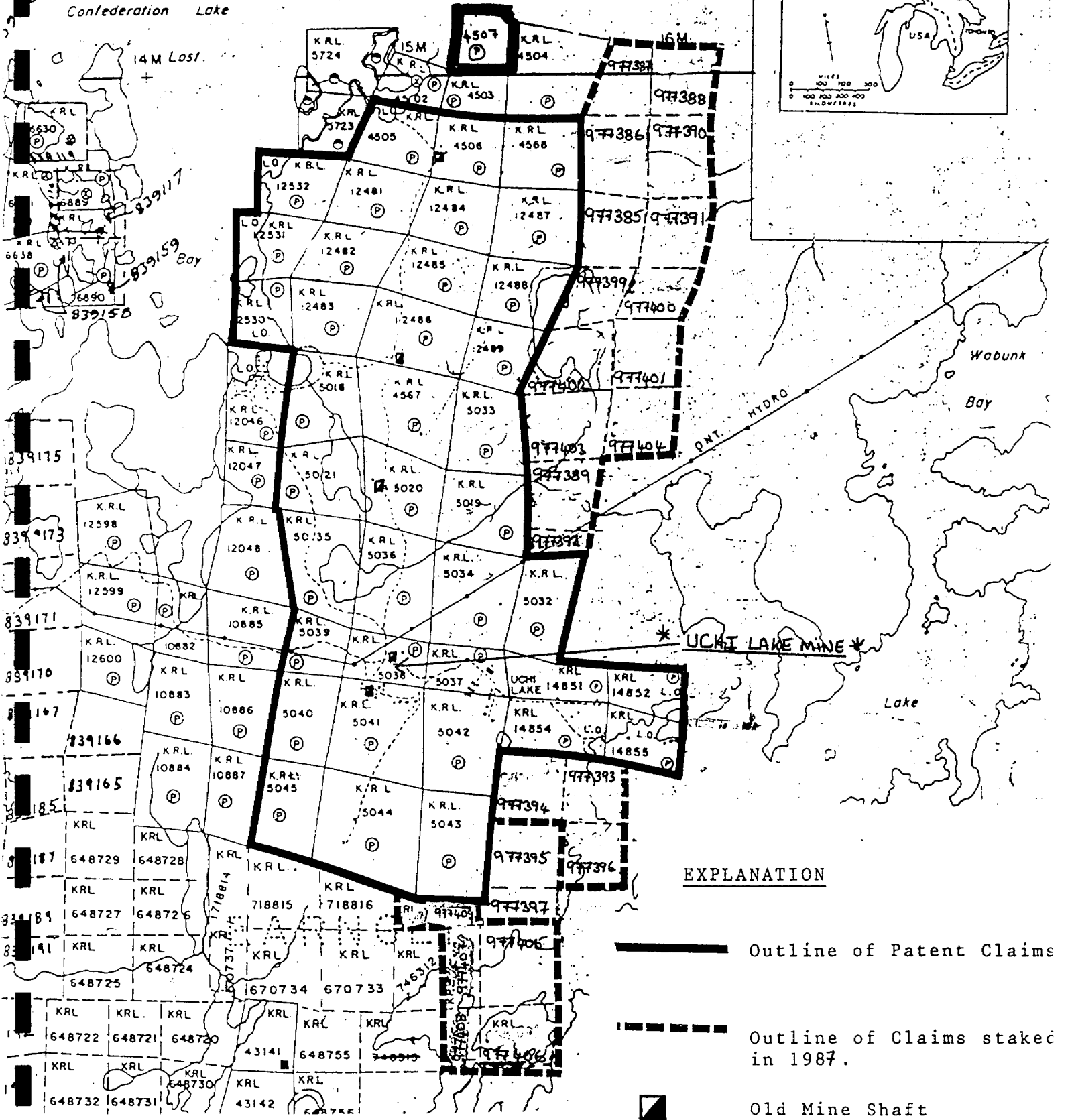
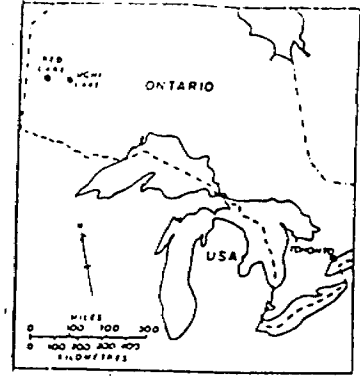

Figure 1. Location of Uchi Lake Property and Outline of Claims

Previous work conducted on the claims covered by this report has been limited to trenching and sampling in the 1920's, 1930's and 1940's. No known gold or sulfide showings have been documented.

REGIONAL GEOLOGY

The property is underlain by a part of the Birch-Uchi greenstone belt within the east-trending Uchi sub-province of the Archean Canadian Shield. The Birch-Uchi greenstone belt as described by Thurston (1980) trends north to northeast, dips steeply west and is approximately 130 by 65km. It consists of interbanded mafic, intermediate and felsic metavolcanic and metasedimentary rocks. Tops face to the west and the rocks are interpreted by Thurston(1980) to be on the east limb of a syncline whose axis runs through Confederation Lake. The belt rocks are at the greenschist facies of metamorphism and have been transected by granitic intrusions (Goodwin, 1967). The belt is bounded to the north, east and west by granitic rocks and to the south by metasedimentary rocks of the English River sub-province. The contact with the English River terrain is marked by the Sydney Lake deformation zone (Thurston, 1980a).

MAPPING SURVEY

The survey was conducted between July 12-28, 1990 by:

R.A. Campbell
18 Donegel Pl.
Hamilton, Ont.
L9C 4Z6

Jane Wegenast
89 Niagara St. Apt. 306
Box #6
Toronto, Ont.
M5V 1C3

Mike Rosetelli
10 Fallingbrook St.
Whitby, Ont.
L1R 1H3

Data from the mapping survey has been plotted at the scale of 1:2000 on Plans 1 and 2, located in the back pocket of this report.

An east-west grid with north-south crosslines and baseline was established over the claims for mapping control. A total of 36.1km of linecutting was completed with lines spaced 100m apart and stations every 25m along the lines.

PROPERTY GEOLOGY

The claims are underlain by a sequence of predominantly intermediate pyroclastic rocks with lesser amounts of mafic and felsic volcanic flows and tuffs.

The intermediate pyroclastic rocks consist of fine grained tuff, lapilli tuff and tuff-breccia. These rocks underly the vast majority of the study area. The rocks are characterized by medium

greenish grey colour, are medium to fine-grained, and exhibit a well foliated fabric.

The mafic volcanic rocks consist predominantly of massive flows. These flows underly the eastern edge of claims K.R.L. 977390, 977391, 977400, 977401 and 977404. The rocks are medium to dark green in colour, medium to fine-grained and have a well developed foliation. The rocks are composed of amphibole, plagioclase and chlorite with minor epidote. Carbonate alteration occurs as randomly oriented veinlets and overgrowths of matrix minerals.

The felsic pyroclastic rocks consist of fine-grained tuff and underly the western half of claims K.R.L. 977400, 977401 and 977404. The rocks are pale to light yellowish-green, fine-grained and thinly banded in places. The rocks are composed of feldspar, quartz and sericite with only minor to trace amounts of pyrite.

Mineralization on the claims is very minor and occurs as disseminated pyrite. This mineralization can be hosted by all the above mentioned rock types. Although quartz veins are common on the property varying from a few centimetres to about 1.0m in width, no anomalous gold values were returned from reconnaissance sampling carried out during the mapping program.

RECOMMENDATIONS

It is recommended that no further work be done on these claims at the present time.

Submitted by

R.A. Campbell
Toronto, Ontario
August 17, 1990

RAC/td

Goodwin, A.M., 1967. Volcanic Studies in the Birch - Uchi Lakes Area of Ontario. Ontario Department of Mines Miscellaneous Paper MPG., 96P

Thurston, P.C., 1980. Volcanology and Trace Element Geochemistry of Cyclical Volcanism in the Archaen Confederation Lake Area, Northwestern Ontario. Ph.D. Dissertation, University of Western Ontario.

Thurston, P.C., 1980a. Earngey and Birkett Townships. Geological Survey Map 2428 Precambrian Geology series, scale: 1 inch to 1/2 miles, Geology 1974.

CERTIFICATE

I R.A. Campbell, of the City of Hamilton, Province of Ontario,
do hereby certify that:

- 1) I reside at 18 Donegel Place, Hamilton, Ontario.
- 2) I have worked as a geologist for the last twelve years.
- 3) I am a graduate of the University of California at Santa Barbara with a Bachelor of Arts Degree (1978) in Geology and the University of Western Ontario with a Master of Science Degree (1985) in Geology.
- 5) I supervised and helped carry out the geological survey. The map preparation was done under my supervision. I have written the report.

R. Anderson Campbell
R.A. Campbell

Dated at Toronto This twentieth day of August 1990.

2.6609



52N02SE0008 2.13567 AGNEW

900

Type of Geological	Mining RE.	Earnings	Prospector's Licence No. Agnew Twp T-3608-664
Recorded Holder(s) LAC MINERALS LTD		Telephone No. 367-1031	
Address 1100-70 ADELAIDE ST. E. TORONTO M5C 2T6			
Survey Company			

Name and Address of Author (of Geo-Technical Report) R. ANDERSON CAMPBELL (AS ABOVE)	Date of Survey (from & to) 12 07 90 27 07 90 Day Mo. Yr. Day Mo. Yr.
--	--

Credits Requested per Each Claim in Columns at right

Mining Claims Traversed (List in numerical sequence)

Special Provisions	Geophysical	Days per Claim
For first survey: Enter 40 days. (This includes line cutting)	- Electromagnetic - Magnetometer	
For each additional survey: using the same grid: Enter 20 days (for each)	- Other Geological Geochemical	40
Man Days Complete reverse side and enter total(s) here	Geophysical - Electromagnetic - Magnetometer - Other Geological Geochemical	Days per Claim
Airborne Credits Note: Special provisions credits do not apply to Airborne Surveys.	Electromagnetic Magnetometer Other	Days per Claim
Total miles flown over claim(s).		
Date July 30/90	Recorded Holder or Agent (Signature) <i>Robin Jowett</i>	

Mining Claim		Mining Claim		Mining Claim	
Prefix	Number	Prefix	Number	Prefix	Number
KRL	977385	KRL	977403		
	977386		977404		
	977387		977405		
	977388		977406		
	977389		977407		
	977390		977408		
	977391		977409		
	977392				
	977393				
	977394				
	977395				
	977396				
	977397				
	977399				
	977400				
	977401				
	977402				
2.13567					
				Total number of mining claims covered by this report of work.	
				24	

I hereby certify that I have a personal and intimate knowledge of the facts set forth in this Report of Work, having performed the work or witnessed same during and/or after its completion and annexed report is true.

Name and Address of Person Certifying ROBIN JOWETT 1100-70 ADELAIDE ST. E. TORONTO			
M5C 2T6		Telephone No. 367-1031	Date JULY 30 90
		Certified By (Signature) <i>Robin Jowett</i>	

For Office Use Only

Total Days Cr. Recorded 960	Date Recorded Aug 1, 1990	Mining Recorder <i>[Signature]</i>
	Date Approved as Recorded <i>see revised work statement</i>	Provincial Mining Recorder

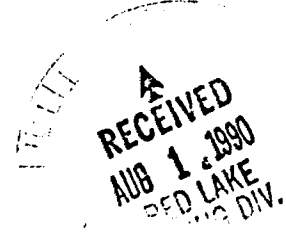



File 2.13567
Mining Recorder's Report of Work No. W9002-089

Date Oct. 9/90

Recorded Holder Lac Minerals Ltd.
Township or Area Earngey Twp & Agnew Twp.

Type of survey and number of Assessment days credit per claim	Mining Claims Assessed
Geophysical Electromagnetic _____ days Magnetometer _____ days Radiometric _____ days Induced polarization _____ days Other _____ days Section 77 (19) See "Mining Claims Assessed" column Geological <u>32.9</u> days Geochemical _____ days Man days <input type="checkbox"/> Airborne <input type="checkbox"/> Special provision <input checked="" type="checkbox"/> Ground <input checked="" type="checkbox"/> <input checked="" type="checkbox"/> Credits have been reduced because of partial coverage of claims. <input type="checkbox"/> Credits have been reduced because of corrections to work dates and figures of applicant.	KRL 977385 - 397 incl. 977399 - 405 incl. 977407 977409

Special credits under section 77 (16) for the following mining claims

--

No credits have been allowed for the following mining claims

<input checked="" type="checkbox"/> not sufficiently covered by the survey <input type="checkbox"/> insufficient technical data filed KRL 977406 & 977408
--

The Mining Recorder may reduce the above credits if necessary in order that the total number of approved assessment days recorded on each claim does not exceed the maximum allowed as follows: Geophysical - 80; Geological - 40; Geochemical - 40; Section 77(19) - 60.



Ministry of
Northern Development
and Mines

Ministère du
Développement du Nord
et des Mines

Mining Lands Section
159 Cedar Street, 4th Floor
SUDBURY, Ontario
P3E 6A5

Telephone: (705) 670-7264
Fax: (705) 670-7262

Your File: W9002.089
Our File : 2.13567

November 15, 1990

Mining Recorder
Ministry of Northern Development and Mines
Ontario Government Building
P. O. Box 324
RED LAKE, Ontario
POV 2MO

Dear Madam/Sir:

RE: Notice of Intent dated October 9, 1990 for Geological
Survey submitted on Mining Claims KRL 977385 et al in
Earngey and Agnew Twp.

The assessment work credits, as listed with the above
mentioned Notice of Intent have been approved as of the above
date.

Please inform the recorded holder of these mining claims and
so indicate on your records.

Yours sincerely

R. C. Gashinski
A/Provincial Manager, Mining Lands
Mines and Minerals Division

LJ/dvl
Enclosure

cc: Mr. W. D. Tieman
Mining and Lands Commissioner
Toronto, Ontario

Resident Geologist
Red Lake, Ontario

Lac Minerals Ltd.
Toronto, Ontario

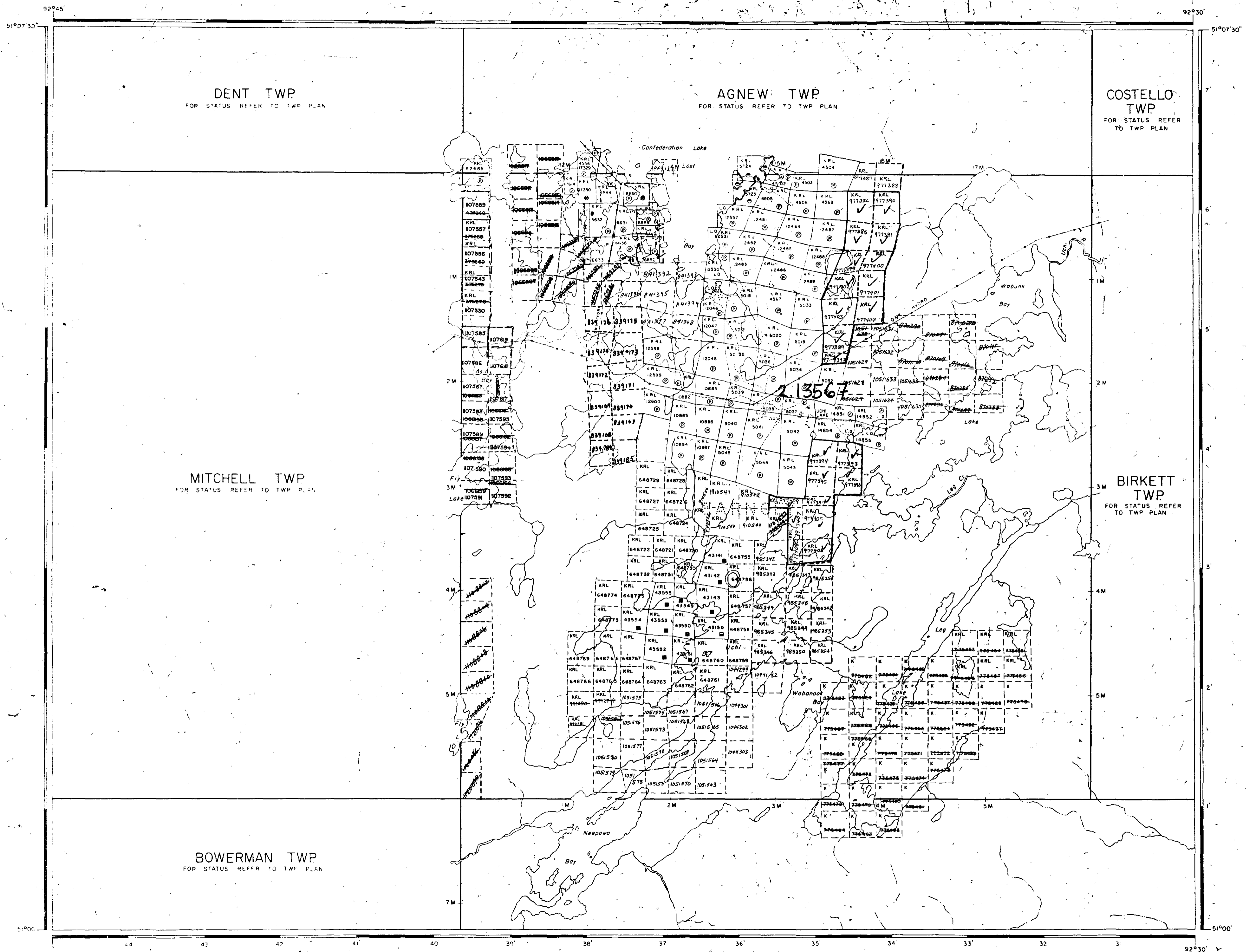

LITTLE BEAR LAKE KNOTT TWP. G-1809

JUBILEE LAKE G-1798

REFERENCES

AREAS WITHDRAWN FROM DISPOSITION

M.R.O. - MINING RIGHTS ONLY
 S.R.O. - SURFACE RIGHTS ONLY
 M.+S. - MINING AND SURFACE RIGHTS

Description	Order No.	Date	Disposition	File
ONT. HYDRO LINE				
* FILE: 119 40 - 100' WIDE				

THE INFORMATION THAT APPEARS ON THIS MAP HAS BEEN COMPILED FROM VARIOUS SOURCES, AND ACCURACY IS NOT GUARANTEED. THOSE WISHING TO STAKE MINING CLAIMS SHOULD CONSULT WITH THE MINING RECORDER, MINISTRY OF NORTHERN DEVELOPMENT AND MINES, FOR ADDITIONAL INFORMATION ON THE STATUS OF THE LANDS SHOWN HEREON.

LEGEND

HIGHWAY AND ROUTE No.	
OTHER ROADS	
TRAILS	
SURVEYED LINES	
TOWNSHIPS, BASE LINES, ETC.	
LOTS, MINING CLAIMS, PARCELS, ETC.	
UNSURVEYED LINES	
LOT LINES	
PARCEL BOUNDARY	
MINING CLAIMS ETC.	
RAILWAY AND RIGHT OF WAY	
UTILITY LINES	
NON-PERENNIAL STREAM	
FLOODING OR FLOODING RIGHTS	
SUBDIVISION OR COMPOSITE PLAN	
RESERVATIONS	
ORIGINAL SHORELINE	
MARSH OR MUSKEG	
MINES	
TRAVERSE MONUMENT	

DISPOSITION OF CROWN LANDS

TYPE OF DOCUMENT	SYMBOL
PATENT, SURFACE & MINING RIGHTS	
SURFACE RIGHTS ONLY	
MINING RIGHTS ONLY	
LEASE, SURFACE & MINING RIGHTS	
SURFACE RIGHTS ONLY	
MINING RIGHTS ONLY	
LICENCE OF OCCUPATION	
ORDER-IN-COUNCIL	
RESERVATION	
CANCELLED	
SAND & GRAVEL	

NOTE: MINING RIGHTS... TENTATIVE TO MAY 8, 1912, VESTED IN ORIGINAL PATRIE BY THE PUBLIC LANDS ACT, R.S.O. 1970, CHAP. 387, SEC. 2, 3, 4, 5, 6, 7, 8, 9, 10, 11, 12, 13, 14, 15, 16, 17, 18, 19, 20, 21, 22, 23, 24, 25, 26, 27, 28, 29, 30, 31, 32, 33, 34, 35, 36, 37, 38, 39, 40, 41, 42, 43, 44, 45, 46, 47, 48, 49, 50, 51, 52, 53, 54, 55, 56, 57, 58, 59, 60, 61, 62, 63, 64, 65, 66, 67, 68, 69, 70, 71, 72, 73, 74, 75, 76, 77, 78, 79, 80, 81, 82, 83, 84, 85, 86, 87, 88, 89, 90, 91, 92, 93, 94, 95, 96, 97, 98, 99, 100.

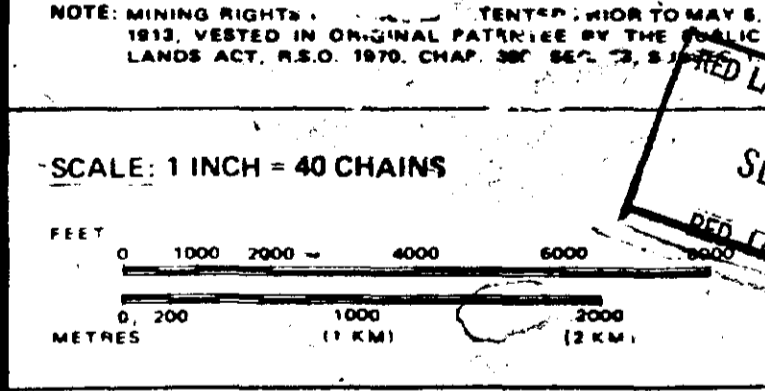

AREA
UCHI LAKE & EARNGEY TWP.
 M.N.R. ADMINISTRATIVE DISTRICT
 RED LAKE
 MINING DIVISION
 RED LAKE
 LAND TITLES / REGISTRY DIVISION
 KENORA / PATRICIA

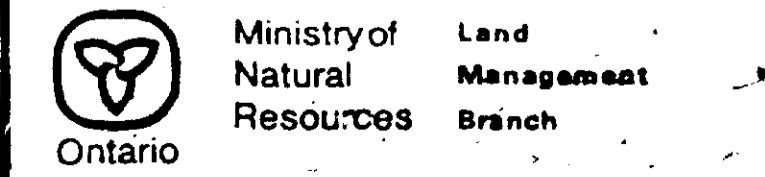

Date: FEB. 1983
 Number: G-1901





R. Anderson Campbell
 2,13567
 Lac Minerals Ltd.
Uchi Project
 Trout Lake Area, Northwestern Ontario
 N.T.S. 52 N
GEOLOGY & SAMPLE LOCATION MAP
 North Grid
 DATE: JULY 1990 SCALE: 1:1000 MAP# Plan 1

