



52N04SW9950 63.6209 DOME

## PETERSON. SKOOKUM. BAY. PROPERTY

## LOCATION

THE SKOOKUM BAY PROPERTY IS LOCATED AT THE SOUTHWEST CORNER OF DOME TOWNSHIP, THE PROPERTY INCLUDES BLASED CLAIMS, KRL. 526497, 526498, 526283, 526284, AND 526005, TO 526008, CLAIM KRL. 526007, LIES LARGELY IN HEYSON TOWNSHIP, TO THE SOUTH OF DOME TOWNSHIP. THE CENTRE OF THE PROPERTY IS SITUATED AT:  
 LATITUDE  $51^{\circ}01'$ . LONGITUDE  $93^{\circ}51'W$ .

## ACCESS.

THE PROPERTY IS LOCATED 3 KM WEST OF THE TOWN OF RED LAKE. ACCESS FROM RED LAKE IS VIA FORESTRY ROAD TO THE GOLD SHORE MINE, THEN WEST ALONG AN EXPLORATION ROAD TO THE PETERSON SKOOKUM BAY PROPERTY FOR 3 KM.

## GEOLOGY.

THE PROPERTY IS ENTIRELY UNDERLAIN BY MEDIUM TO COARSE GRAINED BIOTITE GRANODIORITE OF THE DOME STOCK, AN ELLIPSOIDAL STOCK THAT INVADDES THE CENTRAL PART OF THE RED LAKE GREENSTONE BELT. THE PETERSON SKOOKUM BAY PROPERTY IS LOCATED APPROXIMATELY 1800 METERS WEST OF THE "GOLD SHORE MINE" PAST GOLD PRODUCER, ALSO LOCATED IN THE "DOME STOCK". THE PETERSON SKOOKUM BAY PROPERTY, HOSTS A NUMBER OF NNW TRENDING QUARTZ VEINS WHICH CARRY PYRITE CHALCOPYRITE AND NATIVE GOLD MINERALIZATION. GOLD IS MOST OFTEN ASSOCIATED WITH CHALCOPYRITE. SEVERAL DIKES OF BASIC COMPOSITION OCCUR ON THE PROPERTY, THE LARGEST OF THESE LOCALLY REFERRED TO AS THE "GREAT DIKE".

TRENDS NORTH EASTERLY TOWARDS THE "GOLD SHORE MINE" DIAMOND DRILLING BY CHEVRON MINERALS LTD. HAS IDENTIFIED GOLD MINERALIZATION. WITH THIS DIKE. A MODERATE DEGREE OF SHEARING IS ASSOCIATED WITH QUARTZ VEINING IN THE GRANODIORITE, AS MY LAST SUMMER'S WORK WAS, DIRECTED TO FURTHER EXPLORE THIS STOCK, I FEEL THAT FURTHER EXPLORATION IS NEEDED. AS I FEEL VERY WELL SATISFIED WITH MY 1991 PROGRAM, GOD WILTING I WILL BE AT ANOTHER PROGRAM THIS COMING SUMMER

Charles Peterson.

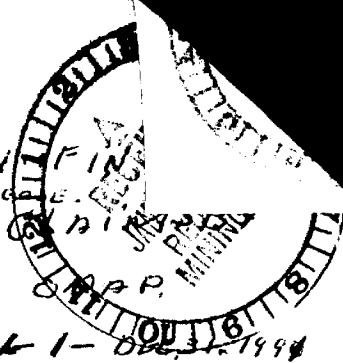

● FINAL SUMMARY CONCLUSIONS, AND FIN  
AND RESULTS OF WORK DONE ON LEASED <sup>21 YEARS</sup> ~~21 YEARS~~   
PETERSON. DOME TWP. SPONSORSHIP OF OPAP.  
FILE NO. O.P. 91-120. 1990. DESIGNATION PERIOD APRIL 1 - DEC 31 1990

STARTING APRIL 22, IN SERVING 1010, JOHN DEERE  
BULLDOZER. GETTING GAS OIL FROM PETRO CANADA  
BULK STATION. AND CLEARING ROAD TO PROPERTY  
OF WINDFALLS. FOR TO MAKE IT PASSABLE, FOR BRONCO  
4X4. FOR TRANSPORTATION. THIS DONE I WAS ABLE  
TO GO TO PROPERTY. THE MOST ADVANCED WORK ON THE  
PROPERTY BEING NO. 5. GOLD VEIN. QUITE A NUMBER OF  
WINDFALLS WERE CLEARED AWAY FROM THE TRENCH.  
AS A LOT OF GOLD VALUES HAVE BEEN HAD FROM THE TRENCH  
THAT WERE IN QUARTZ. "BUT I WAS AFTER GOLD  
VALUES, IN SHEARED GRANODIORITE" AFTER CLEANING  
THE TRENCH. I FOUND AND TOOK A GRAB SAMPLE OF A  
SHEARED & ALTERED GRANODIORITE AND HAD IT ASSAYED  
AND IT CARRIED 28.96 OZ IN GOLD. RIGHT THERE AND  
THEN I THOUGHT THIS SHOULD BE DRILLED. AS I HAVE  
MY OWN DRILL. BUT DURING MY 1990 OPAP PROGRAM  
MY DRILL PLAYED OUT ON ME. AS THE FINAL DRIVE  
CROWN GEAR BEARINGS BUSHING'S, PINION SHAFT  
AND PINION ALL HAD TO BE REPLACED. SO I COULD  
NOT TAKE IT OUT TO DRILL WITH, SO THE NEXT  
BEST WAS TO USE MY 1010 JOHN DEERE BULLDOZER THAT  
I, ALREADY HAD OUT ON THE PROPERTY AND DO  
SOME STRIPPING. 8 AREAS IN ALL. WERE WORKED  
ON. NO. 1, 2, 3. ARE ON CLAIM NO KRL 526005.  
NO 1, AND 2, AREA BEING ON VEIN NO. 7, THAT WAS  
MARKED ON BY SKOOKUM. MINES SOME 50 YEARS AGO

AND NO 3, AREA. WAS, A NEW AREA.  
AS NO 7, VEIN IS A NARROW QUARTZ VEIN WITH VERY  
ERRATIC GOLD VALUES IT WAS THOUGHT THAT PERHAPS  
SOME STRIPPING WOULD DISCOVER SOME STRONG SHEARING  
AND PERHAPS GET SOME ENCOURAGING RESULTS. HOWEVER  
AFTER THE SNOW, AND RAIN THIS COMING SOMMER THINGS  
MAY LOOK DIFFERENT SOME SAMPLES WERE TAKEN BUT NO  
IMPORTANT RESULTS. THE BULLDOZER WAS MOVED BACK  
TO CLAIM KR6526006, THE TOP AND SOUTH END OF VEIN NO. 1.  
"AREA STRIPPING NO. 4" AS NO. 1. VEIN NARROW. 2" TO 6" WIDE  
AND EXTENDS SOME 1700' TO THE NORTH. NARROW AND VERY  
ERRATIC. IT SEEMS TO FAULT OFF TO THE WEST AT STRIPPING  
NO. 4. AS THE STRIKE OF THESE VEINS SEEMS TO BE  
NORTH. 30° WEST. THIS IS ALSO THE STRIKE OF NO. 5. VEIN  
ONLY SOME 300' TO THE WEST. IT COULD BE SO THAT  
VEIN NO. 1. AND VEIN NO. 5. MAY VERY WELL OF  
BEEN THE SAME VEIN. BUT FAULTED, AND OFFSET.  
AS THIS COULD VERY WELL BE A POSSIBILITY. THE AREA  
BETWEEN THESE BOTH VEINS. COULD BE VERY IMPORTANT.  
ESPECIALLY AFTER FINDING THAT HIGH GOLD VALUE IN A  
'SHEARED & ALTERED GRANODIORITE' SOME OF THIS CONDITION  
MAY BE PRESENT BETWEEN NO. 1. AND NO. 5. VEINS  
NO. 5. STRIPPING IS THE SOUTH. END OF NO. 5. VEIN ITS ON THE  
EDGE OF A LARGE SWAMP. THE SWAMP IN SIZE IS.  
ABOUT '80-100' ACRES IN SIZE. A DRAW OR LOW GROUND  
EAST TO THE OLD "GOLD SHORE MINE." POSSIBLE "EAST  
AND WEST FAULT." THE GRANODIORITE ROCKS ARE  
SHEARED, AND LYING AT 20° AND DIPPING WEST. AS IT  
IS A LITTLE PREMATURE. IN DRAWING CONCLUSIONS  
IN WHAT DIRECTION. THE FAULTING AND MOVEMENT  
EITHER EAST OR WEST. STOOK PLACE

NO 3, SHEET.

THE BULLDOZER WAS MOVED WEST TO CLAIM NO. 6, AREA. KRL 526007, AS THIS AREA IS ALSO, BORDERING THE LARGE SWAMP AREA, AT THIS AREA, THE VOLCANICS HAVE BEEN EXPOSED FOR SOME 50' AND CONTACT THE GRANODIORITE OR DOME STOCK. AGAIN THE TREND EAST THROUGH THE SWAMP, AS YOU CAN SEE THE GOLD SHORE WATER TANK, AND THE TREND OF THE VOLCANICS IS IN THAT DIRECTION. NO 7, STRIPPING CONFIRMS THE TREND OF THE VOLCANICS AND CONTACT THE DOME STOCK AND NO 8 STRIPPING IS A NEW AREA BORDERING SKOOKUM, BAY. VERY INTERESTING BUT A LOT OF WORK IS REQUIRED. ALL LOCATIONS OF WORK AREA MAY BE SEEN ON LOCATION MAP. AS MY FANTASTIC AND EXITING HIGH ASSAY IN TRENCH NO. 5, OF 28.96 OZ. IN SHEARED AND ALTERED GRANODIORITE KEPT BOTHERING ME, SO I HAD TO REPAIR MY DRILL AND GET A COUPLE OF HOLES IN THE GROUND AND TO DRILL AT LEAST 1. HOLE UNDERNEATH THE NO. 5 VEIN, AND ANOTHER ONE UNDERNEATH THE CREEK SUMMARY AND VALUATION THE BOTH, ARE ATTACHED TO DRILL LOG. NO. 2. HOLE WAS DRILLED AT A 30° TO TREND OF VEIN AND SHEARING AS IT WAS KNOWN THAT THIS HOLE WOULD BE A LOT OF PROBLEMS, BUT AT <sup>THE</sup> SAME TIME IT COULD GIVE A LOT OF INFORMATION, AND <sup>GIVE</sup> US A BULK SAMPLE OF THE VEIN AS, THE HOLE FROM 35' TO 45' ARE VERY ENCOURAGING, AND DEMONSTRATE THAT THE "GOLD VALUES, ARE NOT ONE BLIP IN THE HILL. AS ALL THIS WORK IS ONE MORE STEP IN TRYING TO UNRAVINE THE MYSTERY OF THE "GOLD" BEING IN THE DOME STOCK, GOD WILLING I INTEND TO HAVE ANOTHER GO AT IT NEXT YEAR.

SINCERELY, Chas. Peterson.

SUMMARY OF DDH NO. 1.

THE PURPOSE OF DRILLING NO. 1. DDHOLE.

WAS TO EXPLORE A EAST AND WEST TRENDED  
'QUARTZ CARBONATE' DYKE, BEING 12" THICK, AND EXPOSED  
ON SURFACE FOR SOME 40' FT. THE <sup>DYKE</sup> WAS MINERALIZED  
WITH PYRITE ONLY, IT IS THOUGHT THAT THE DYKE  
HAD COME IN AT SOME LATER TIME.

IT COULD BE POSSIBLE THAT NO. 1. VEIN AND NO. 5 VEIN  
THAT IS SOME ~~...~~ 300' FT TO THE WEST ARE THE SAME  
VEIN, AS THE TOP & SOUTH END OF NO. 1. VEIN.

AND THE BOTTOM AND NORTH <sup>END</sup> OF NO. 5, COULD BE  
FAULTED. IN A EAST & WEST DIRECTION, THE QUARTZ  
CARBONATE DYKE MAY HAVE COME IN AT THIS FAULTED  
AND WEAKENED ZONE, AND BROUGHT IN THE MINERALIZATION  
& 'GOLD' WITH IT. MY THINKING IS THAT ANY CRUSHED  
AND ALTERED ROCKS, WOULD BE RECEPTIVE AND ADJACENT

TO THE FAULT ZONE. - WOULD BE A POSSIBLE TARGET  
FOR FURTHER EXPLORATION, AS THE SAMPLE THAT WAS  
ASSAYED FROM NO. 5 VEIN WAS A ALTERED AND  
CRUSHED GRANODIORITE, THE SAMPLE WAS RUSTY  
AND ALTERED, THE ONLY MINERAL WAS 'GOLD' IN THE  
SAMPLE, NO QUARTZ OF ANY KIND. THIS AREA WILL  
HAVE TO BE REEXPLORED. THIS COMING SOMMER.

AS MAY BE SEEN FROM DRILL LOG 7, SPLIT CORE  
WERE TAKEN FROM DDHOLE NO. 1, BUT NO VALUES  
THE DYKE MAY NOT CARRY GOLD, BUT THE AREA BETWEEN  
VEIN 1, AND VEIN NO. 5. MAY VERY WELL BE POTENTIAL.

*Chase*





Ontario

Ministry of Natural Resources

# Diamond Drilling Log

Fill in on every page

Hole No. 1. Page No. 1.

Drilling Company <b>CHARLIE PETERSEN</b>		Collar Elevation <b>328</b>	Bearing of hole from true North <b>EAST 10° N</b>	Total Footage <b>65 FT.</b>	Dip of Hole at Collar <b>45%</b>	Location of hole in relation to a fixed point on the claim. <b>KR2. 526006</b> <i>W15E 200' 52' 6006 EAST NO. 4 POST</i>	Map Reference No. <b>DOME TWP.</b>	Claim No.
Date Hole Started <b>Aug 7 1991</b>	Date Completed <b>Aug 19 1991</b>	Date Logged <b>Aug 20 1991</b>	Logged by <b>CHARLES PETERSON</b>		Ft.		Location (Twp., Lot, Con. or Lat. and Long.) <b>CHARLES PETERSON</b>	Property Name
Exploration Co., Owner or Optionee <b>DRILL SELF.</b>		Date Submitted <b>DEC. 31. 1991</b>	Submitted by (Signature) <i>Charles Peterson</i>		Ft.			
					Ft.			

Footage		Rock Type	Description Colour, grain size, texture, minerals, alteration, etc.	Planar Feature Angle *	Core Specimen Footage †	Your Sample No.	Sample Footage		Sample Length	Assays †	
From	To						From	To			
CASING		SHEARED	GRANODIORITE, CASING			NONE	32.00	65 FT			
5 FT	32'	GRANODIORITE	MINERALIZED, PYRITIC, PRIMARY								
32'	35'	GRANODIORITE	GRANODIORITE & BROWN EMBODS, VEINS, 2" TO 3" WIDE "DIKE" 12 FT WIDE			10573			3'	TRACE	
35'	38'	GRANODIORITE	"			10574			3'	"	
38'	42.5'	GRANODIORITE	"			10575			4.5'	"	
42.5'	45'	"	"			10576			4'	"	
45'	48'	"	"			10585			3.8'	"	
48'	52'	"	"			10586			3.7'	"	
52'	65'	GRANODIORITE, SLUDGE	END OF HOLE BAD CORE UNABLE TO DRILL WITHOUT CEMENTING, SLUDGE SAMPLE FROM HOLE BIT COLLARS			10587				11	
<p>DRILL HOLE DRILLED EAST, AT 45° DIP. DRILL HOLE HAD TO BE ABANDONED DUE TO BAD CORE. FAULT? THE PURPOSE OF HOLE WAS TO SEE IF ANY MINERALIZATION WAS TRENDS "NORTH &amp; SOUTH" AS ALL EXPOSED VEINS CARRY GOLD VALUES NORTH &amp; SOUTH</p> <p>7. SAMPLES FROM HOLE.</p>											

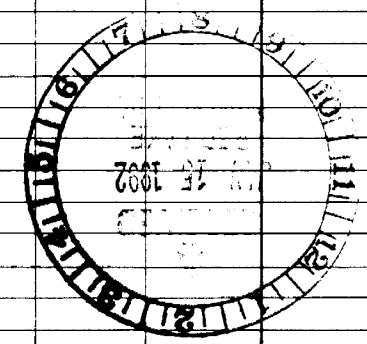

KRL 526284

SKOOKUM EAST  
KRL 526006

KRL 526005

KRL 526008

SKOOKUM E.D.Y.

TRACTOR ROAD

NO. 1. DDH. 65' DEEP 45° DIP.  
BED ROCK SEPAR.  
EAST 10° NORTH

DDHOLE NO. 1. 65' DEEP. 45° DIP ANGLE  
DIR. EAST 10° NORTH. COLAR BED ROCK.

NO. 2. DD.H. 257' DEEP 45° DIP. DIR. NORTH.

DDHOLE NO. 2. 257' DEEP. 45° DIP ANGLE

DIR. 1. NORTH. COLAR. BED ROCK

VALUES NO DDHOLE

SAMPLE NO. 2646	35' - 42'	341
" " 2647	42 - 45	338
" " 2648	45 - 50	051

DDHOLE NO. 2.

IMPORTANT VALUES QUARTZ. VEIN NO. 5 VEIN

DEME  
TWP. LINE  
MEYSON TWP.

KRL 526007

DIAMOND  
DRILL HOLE  
NO. 2.

SHAFT

750'

550'

NO. 5 VEIN

NO. 1 VEIN

1100' - 4'



## SUMMARY OF DDH. NO. 2

### THE PURPOSE OF DRILLING NO. 2. HOLE.

THE HOLE WAS COLLARED ON BED ROCK. ON THE WEST SIDE OF NO. 5. VEIN. DIP 45° DIR. TRUE NORTH. AND TO CUT THE VEIN AT 20° TO VEIN DIRECTION. AS THE VEIN DIRECTION IS 20° WEST OF NORTH. AS IT WAS ANTICIPATED THAT DRILLING A DDH. INTO A SHEERING AT 20° INTO THE SHEERING STRIKE THIS WOULD CAUSE A LOT OF PROBLEMS. BUT IF SUCCESSFUL IT WOULD BE WORTH IT. AS THIS WOULD GIVE US A BULK SAMPLE OF THE VEIN, AND GIVE US AN IDEA. OF HOW ERRATIC THE GOLD DISTRIBUTION. IN THE VEIN IS. AS I KNOW. THAT THE RULE OF THUMB IS TO DRILL A DDHOLE. AT RIGHT ANGLE TO A VEIN. WELL THE HOLE WAS SOMEWHAT SUCCESSFUL. AS AT 35<sup>ft</sup> TO 45<sup>ft</sup> IN THE DRILL HOLE THE QUARTZ AND SLEARED GRANODIORITE, WERE FOUND AND A CORE LENGTH OF 7<sup>ft</sup> SAMPLE NO. 2646. CARRIED 341. IN GOLD. AND A CORE LENGTH OF 2<sup>ft</sup> SAMPLE NO 2647. " 338 IN GOLD. THIS IS A CORE LENGTH OF TEN. FT. THAT IS A INTERESTING RESULT. AS THIS IS AT SHALLOW DEPTH. AND THIS CAN BE TESTED BY A SHALLOW DDH ANY TIME. TEN CORE SAMPLES. WERE SPLIT AND ASSAYED AT THIS INTERSECTION. ALL LISTED ON CORE LOG. I DECIDED TO CONTINUE THE HOLE FURTHER DOWN TO SEE IF THE "EAST WEST QUARTZ CARBONATE DYKE" COULD BE FOUND. HOWEVER AT. 108'-139'. SOME ACTION TOOK PLACE. 10. SPLIT CORE SAMPLES WERE ASSAYED WITH VERY LITTLE RESULTS. THE HOLE WAS, CONTINUED TO 257<sup>ft</sup> BUT NOTHING OF INTEREST WAS FOUND HOWEVER I AM VERY HAPPY & PLEASED WITH MY DRILLING RESULTS. GOD WILLING I WILL DRILL A NUMBER OF HOLES. INTO NO. 5 VEIN THIS COMING SUMMER.

Chas

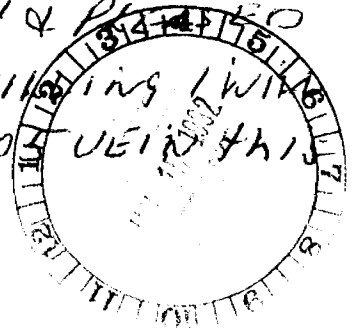



Drilling Company <b>SELF CHARLES PETERSON.</b>		Collar Elevation <b>BEDROCK</b>	Bearing of hole from true North <b>NORTH.</b>	Total Footage <b>257 FT</b>	Dip of Hole at <b>45°</b> Collar	Location of hole in relation to a fixed point on the claim. <b>750' EAST OF Pst #3. ON SOUTH CLAIM LINE ARL. 526006.</b>	Map Reference No. <b>DOME TWP</b>	Claim No. <b>KRL 526006</b>
Date Hole Started <b>SEPT 5, 1991.</b>	Date Completed <b>OCT 1, 1991</b>	Date Logged <b>OCT 2<sup>ND</sup></b>	Logged by <b>CHARLES PETERSON</b>		Ft.		Location (Twp., Lot, Con. or Lat. and Long.) <b>DOME TWP. LEASE CHAS. PETERSON.</b>	
Exploration Co., Owner or Optionee <b>OWNER.</b>		Date Submitted	Submitted by (Signature) <i>Charles Peterson</i>		Ft.			
					Ft.			

Footage		Rock Type	Description Colour, grain size, texture, minerals, alteration, etc.	Planar Feature Angle *	Core Specimen Footage †	Your Sample No.	Sample Footage		Sample Length	Assays †	
From	To						From	To			
0	5	SHEARED.	GRANODIORITE, MINERALIZED PYRITE HAD TO REAM CASING BADLY FRACTURED.			2639	0	5	5		004
0	10	GRANODIORITE	" " "			2640	0	10	5		003
10	15	"	" "			2641	10	15	5		001
15	20	"	" "			2642	15	20	5		008
20	25	"	SOME <del>VERY</del> NARROW QUARTZ STRINGERS 1/4" WIDE. PYRITE			2643	20	25	5		016
25	30	"	AS ABOVE.			2644	25	30	5		018
30	35	"	LESS QUARTZ STRINGERS. LESS MINERAL. SOME GROUND CORE.			2645	30	35	5		007
35	42	QUARTZ VEIN	NO 5 VEIN WEST SIDE CONTACT QUARTZ 10% TO CORE AXIS			2646	35	42	7		341
42	45	"	NO 5 VEIN EAST SIDE CONTACT QUARTZ 20% TO CORE AXIS.			2647	42	45	3		338
45	50	GRANODIORITE	WEST SIDE OF NO 5 VEIN			2648	45	50	5		051
CHECK ON 2648.											
50	52	GRANODIORITE	WEST CONTACT WALL NO 5 VEIN			2649	50	52	2		046
			FROM 52' FT TO 108' GRANITE WITH GRANODIORITE INTROUSIONS,								
52	108		POOR CORE RECOVERY.								

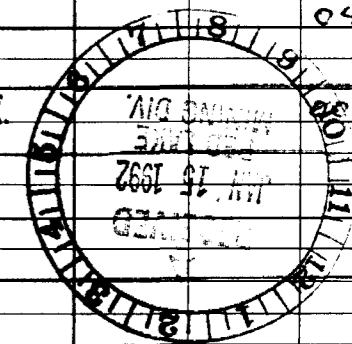



**Diamond  
Drilling  
Log**

Fill in on  
every page

Hole No. 2 Page No. 2

Drilling Company <u>SELF CHARLES PETERSON</u>		Collar Elevation <u>BED ROCK</u>	Bearing of hole from true North <u>NORTH</u>	Total Footage <u>257</u>	Dip of Hole at Collar <u>45°</u>	Location of hole in relation to a fixed point on the claim.  <u>750' EAST OF POST #3, ON SOUTH CLAIM LINE KRL. 526006.</u>	Map Reference No.	Claim No. <u>KRL. 526006.</u>
Date Hole Started <u>SEPT 5. 1991.</u>	Date Completed <u>OCT 1. 1991.</u>	Date Logged <u>OCT 3</u>	Logged by <u>CHAS. PETERSON</u>		Ft.		Location (Twp., Lot, Con. or Lat. and Long.)  <u>DOME TWP. PETERSON.</u>	
Exploration Co., Owner or Optionee  <u>OWNER.</u>		Date Submitted	Submitted by (Signature)  <u>[Signature]</u>		Ft.			
					Ft.			

Footage		Rock Type	Description Colour, grain size, texture, minerals, alteration, etc.	Planar Feature Angle *	Core Specimen Footage †	Your Sample No.	Sample Footage		Sample Length	Assays †	
From	To						From	To			
<u>108.5</u>	<u>110</u>	<u>SHEARED</u>	<u>GRANODIORITE.</u>			<u>2517</u>	<u>108.5</u>	<u>110</u>	<u>18"</u>		<u>001</u>
<u>110</u>	<u>112.5</u>	<u>"</u>	<u>"</u>			<u>2649</u>	<u>110</u>	<u>112.5</u>	<u>2.5</u>		<u>001</u>
<u>112.5</u>	<u>116.5</u>	<u>"</u>	<u>"</u>			<u>2651</u>	<u>112.5</u>	<u>116.5</u>	<u>4.5</u>		<u>001</u>
<u>116.5</u>	<u>122.8</u>	<u>GRANODIORITE MINERALIZED SPINGER 1/2 IN" WIDE PARALLEL TO CORE AXIS</u>	<u>THIS COULD BE SOME PART OF NO 5 VEIN, PYRITE SOME TOURMALINE.</u>			<u>2652</u>	<u>116.5</u>	<u>122.5</u>	<u>5"</u>		<u>002</u>
<u>122.8</u>	<u>124.8</u>	<u>GROUND CORE, POSSIBLE FAULT</u>				<u>2653</u>	<u>SLUDGE SAMPLE</u>				<u>001</u>
<u>124</u>	<u>127</u>	<u>SHEARED GRANITE BLEACHED &amp; ALTERED 10° TO CORE AXIS.</u>				<u>2654</u>	<u>124</u>	<u>127</u>	<u>3'</u>		<u>001</u>
<u>127</u>	<u>133</u>	<u>AS ABOVE WITH SMALL QUARTZ, VEINS 1/2" WIDE MINER. PYRITE</u>				<u>2655</u>	<u>127</u>	<u>133</u>	<u>6'</u>		<u>005</u>
<u>133</u>	<u>137</u>	<u>FAULT VERY LITTLE CORE RECOVERY. SLUDGE COLLECTED</u>				<u>2656</u>	<u>133</u>	<u>137</u>	<u>4'</u>		<u>006</u>
<u>137</u>	<u>139</u>	<u>GRANODIORITE, MINOR PYRITE</u>				<u>2657</u>	<u>137</u>	<u>139</u>	<u>2'</u>		<u>005</u>
<u>139</u>	<u>247</u>	<u>GRANODIORITE MINOR MINERALIZATION PYRITE</u>	<u>CHANGE PYRITE SOME SILICIFICATION IN THE BLEACHED GRANITE</u>								
			<u>" THIS CORE WILL HAVE TO BE LOOKED AT AGAIN NEXT SPRING, AND PERHAPS SOME SPOTCHECK SAMPLES"</u>								
<u>247</u>	<u>250</u>	<u>GROUND CORE. FAULT.</u>									
<u>250</u>	<u>257</u>	<u>GRANITE</u>	<u>ALOT OF BIOTITE, IN SEAMS.</u>								
			<u>END OF HOLE. 257 FT.</u>								
			<u>20 SAMPLES ASSAYED FROM THIS HOLE</u>								
			<u>VERY POOR CORE RECOVERY</u>								

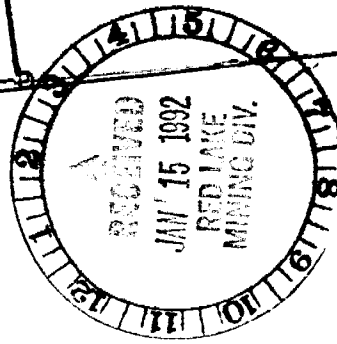
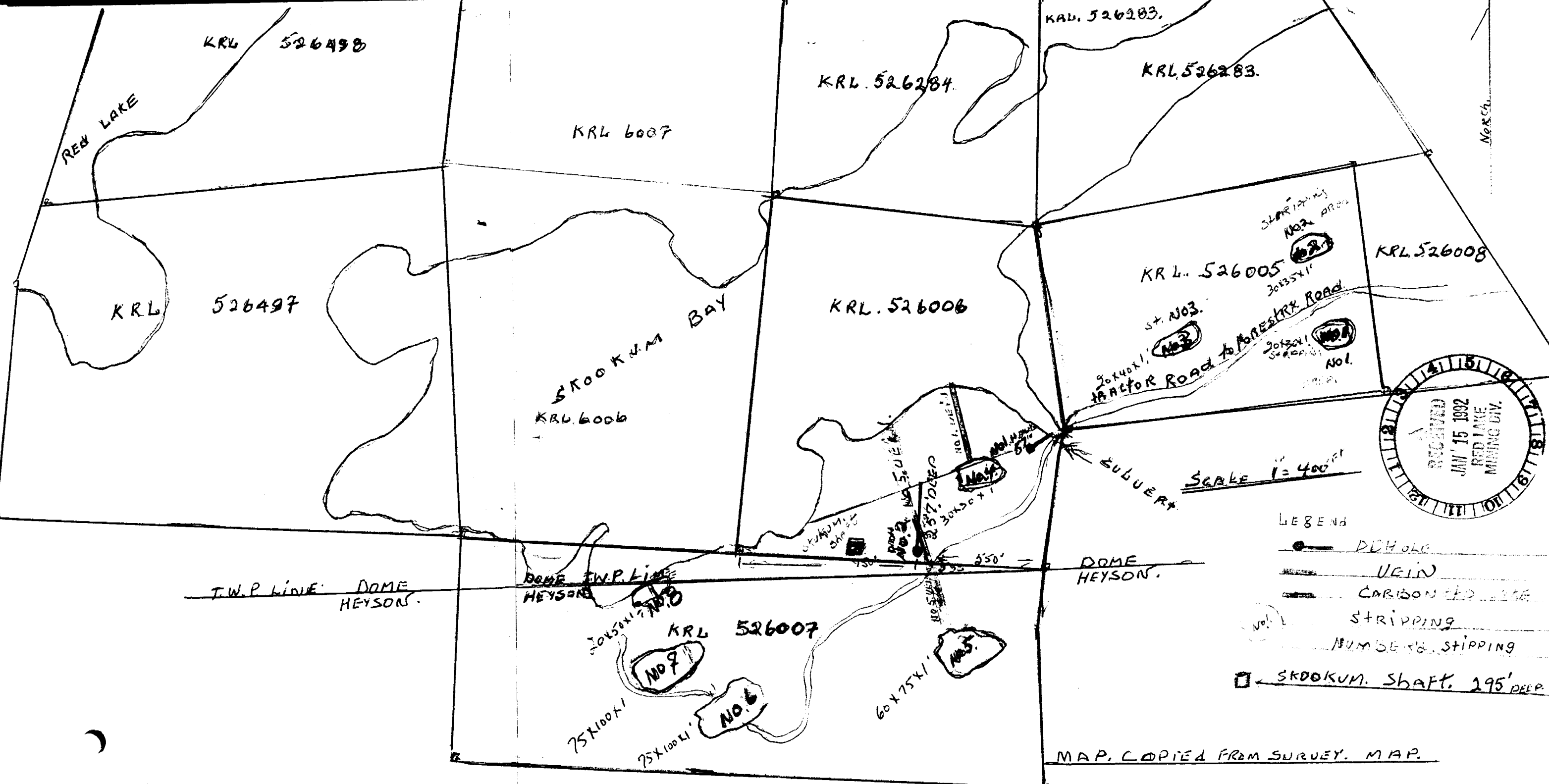

SCALE 1" = 400'

- LEGEND
- D.HOLE
  - VEIN
  - CARBONATED ZONE
  - STRIPPING NUMBER
  - SKOOKUM SHAFT 295' DEEP

MAP COPIED FROM SURVEY MAP.

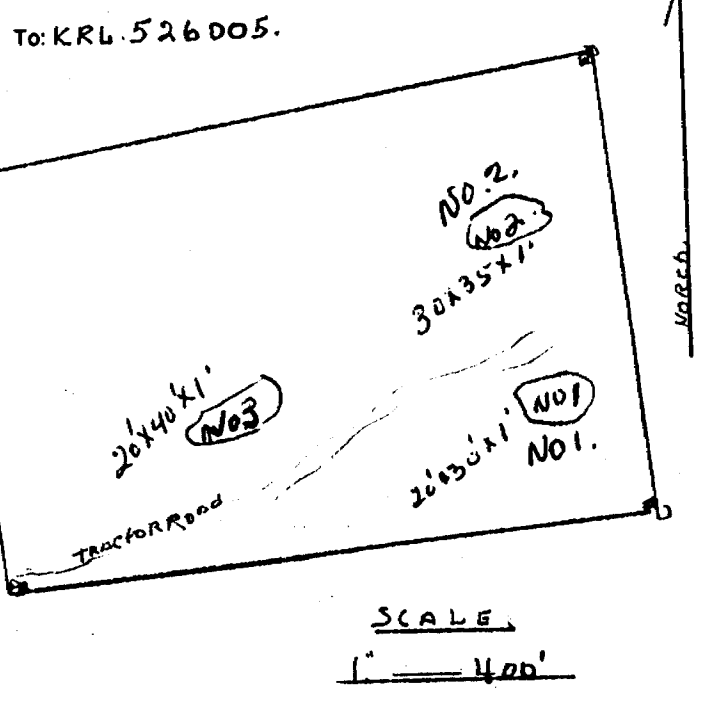
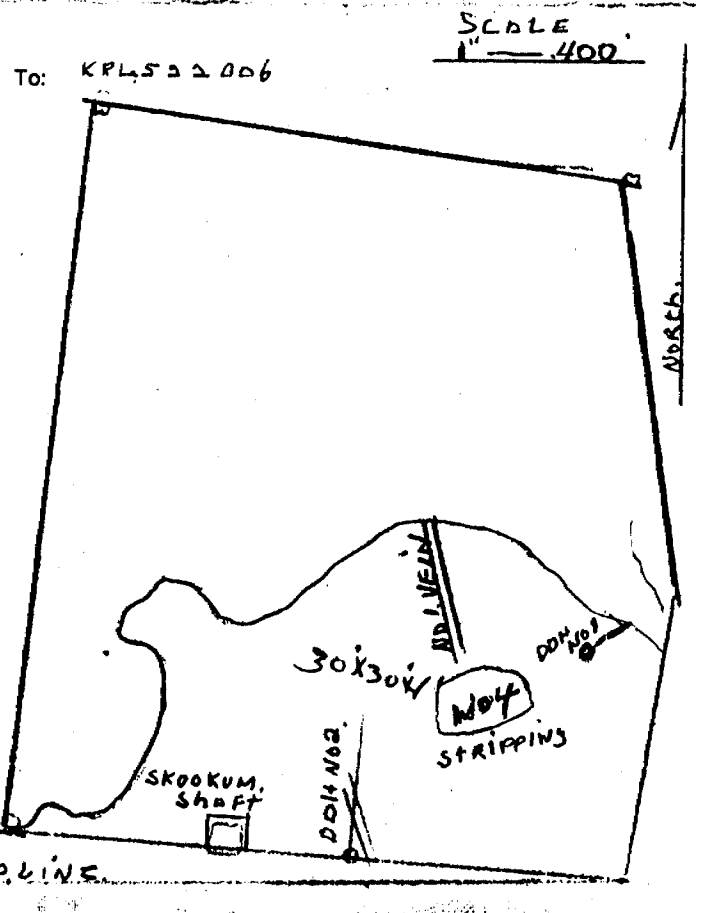
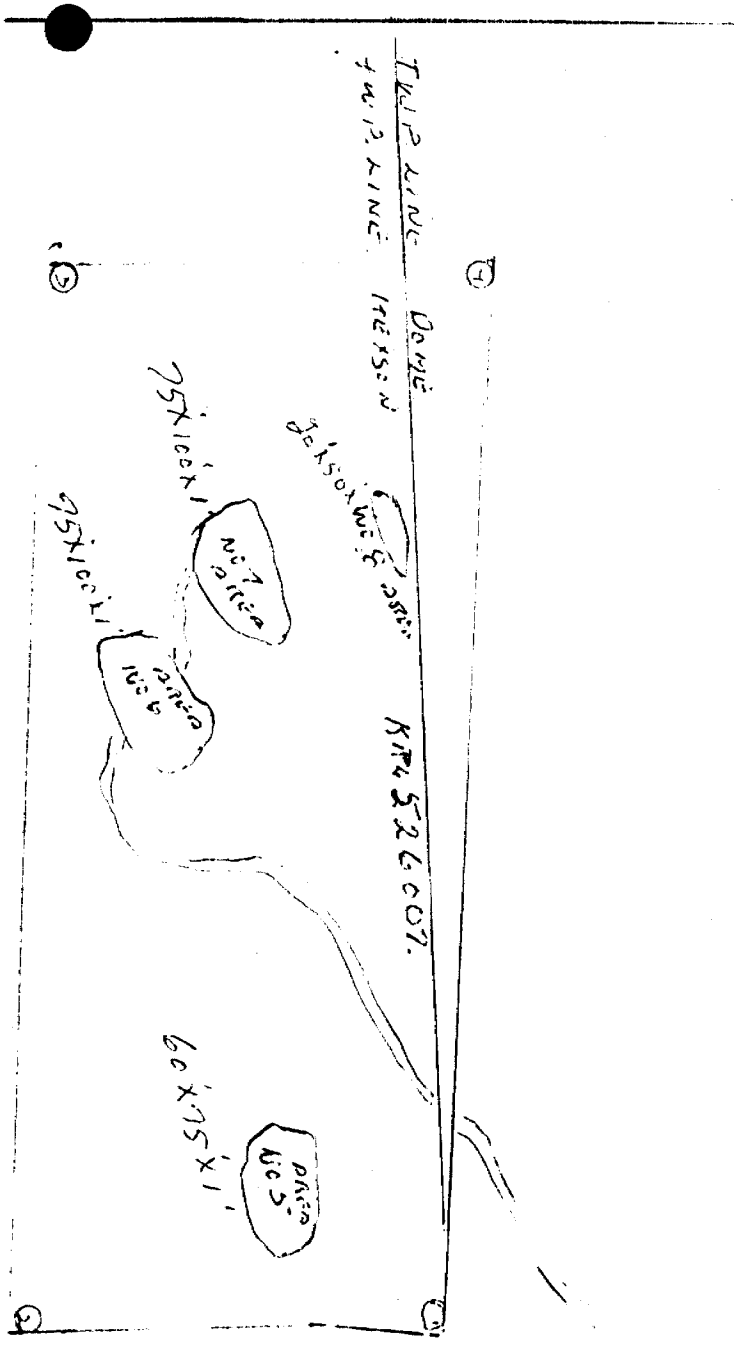

DOME TWP.

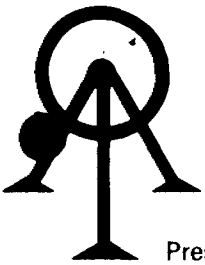

# ACCURASSAY LABORATORIES

A DIVISION OF BARRINGER LABORATORIES LIMITED, REXDALE, ONTARIO  
BOX 426  
KIRKLAND LAKE, ONTARIO, CANADA P2N 3J1  
TEL.: (705) 567-3361

President: Dr. GEORGE DUNCAN, M.Sc., Ph. D., C. Chem (Ont.), C. Chem (U.K.), M.C.I.C., M.R.S.C., A.R.C.S.T.

48297

## Certificate of Analysis

Page: 1

*CHAS*  
*D.B.*  
~~Chris~~ Peterson  
P.O.Box 533  
RED LAKE, ON  
POV 2M0

October 29

91

Work Order # : 181833  
Project :

Accurassay	SAMPLE NUMBERS Customer	Gold ppb	Gold Oz/T
288463	2639	128	0.004
288464	2640	103	0.003
288465	2641	28	0.001
288466	2642	276	0.008
288467	2643	547	0.016
288468	2644	607	0.018
288469	2645	232	0.007
288470	2646	11703	0.341
288471	2647	11624	0.338
288472	2648	1743	0.051
288472	2648	1584	0.046

*SPLIT CORE SAMPLES*

*NO. 2, DDH.*

Check

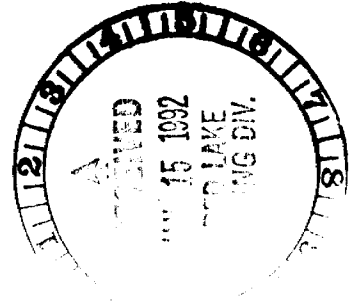

Per: 

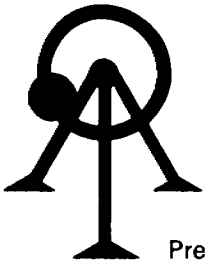

# ACCURASSAY LABORATORIES

A DIVISION OF BARRINGER LABORATORIES LIMITED, REXDALE, ONTARIO

BOX 426

KIRKLAND LAKE, ONTARIO, CANADA P2N 3J1

TEL.: (705) 567-3361

President: Dr. GEORGE DUNCAN, M.Sc., Ph. D., C. Chem (Ont.), C. Chem (U.K.), M.C.I.C., M.R.S.C., A.R.C.S.T.

48224

## Certificate of Analysis

Page: 1

*Charley AH*  
Chris Peterson  
P.O. Box 533  
RED LAKE, ON  
POV 2M0

November 22

91

Work Order # : 181853  
Project :

SAMPLE NUMBERS		Gold	Gold
Accurassay	Customer	ppb	Oz/T
289499	2517	17	<0.001
289500	2649	39	0.001
289501	2650	43	0.001
289502	2651	10	<0.001
289503	2652	81	0.002
289504	2653	51	0.001
289505	2654	18	0.001
289506	2655	193	0.006
289507	2656	177	0.005
289508	2657	177	0.005
289508	2657	175	0.005

*SPLIT CORE  
NO 2. 140LB*

Check

Per: *Abund R...*

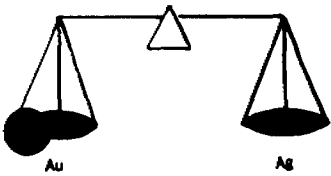

# PAUL'S CUSTOM FIRE ASSAYING LTD.

Phone: Bus. (807) 662-8171

Res. (807) 662-3361

Fax: (807) 662-1155

PAUL OKANSKI, Assayer  
Box 253, Cochenour, Ontario P0V 1L0

C. Peterson

## ASSAY CERTIFICATE

Date: may 10-91

Sample No.	Description	oz/ton Au	oz/ton Ag
1 10571	No. 1 STRIPPING PREP	Trace	
2 72	No. 1 STRIPPING PREP	"	
3			
4			
5			
6			
7			
8			
9			
10			
11			
12			
13			
14			
15			
16			
17			
18			
19			
20			
21			
22			
23			
24			
25			

Assayer: *Paul Okanski*



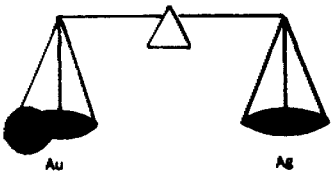

**PAUL'S CUSTOM FIRE ASSAYING LTD.**

Phone: Bus. (807) 662-8171

Res. (807) 662-3361

Fax: (807) 662-1155

PAUL OKANSKI, Assayer  
Box 253, Cochenour, Ontario P0V 1L0

C. Peterson

**ASSAY CERTIFICATE**

Date: may 10-91

Sample No.	Description	oz/ton Au	oz/ton Ag
1	10571	Trace	
2	72	"	
3			
4			
5			
6			
7			
8			
9			
10			
11			
12			
13			
14			
15			
16			
17			
18			
19			
20			
21			
22			
23			
24			
25			

Assayer: *Paul Okanski*

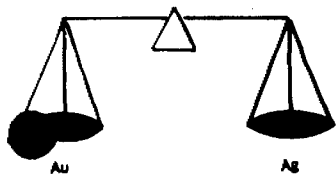

# PAUL'S CUSTOM FIRE ASSAYING LTD.

Phone: Bus. (807) 662-8171

Res. (807) 662-3361

Fax: (807) 662-1155

PAUL OKANSKI, Assayer  
Box 253, Cochenour, Ontario P0V 1L0

## ASSAY CERTIFICATE

Date: May 16-91

C. Peterson

Sample No.	Description	oz/ton Au	oz/ton Ag
1 2621	SAMPLE NO. 5, VEIN FROM FRENCH	28.96	
2	SHEPRED AND ALTERED GRANODIORITE		
3	WELL OXIDIZED GOLD IN SHEAR, NO QUARTZ,		
4	AND NO VISIBLE MINERAL, OTHER THAN		
5	VERY FINE GOLD IN SHEAR PLANES, OF SHEARING.		
6			
7			
8			
9			
10			
11			
12			
13			
14			
15			
16			
17			
18			
19			
20			
21			
22			
23			
24			
25			

Assayer:

A handwritten signature in black ink, appearing to read 'Paul Okanski', written over a horizontal line.

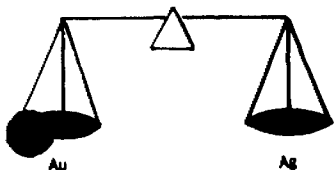

# PAUL'S CUSTOM FIRE ASSAYING LTD.

Phone: Bus. (807) 662-8171

Res. (807) 662-3361

Fax: (807) 662-1155

PAUL OKANSKI, Assayer  
Box 253, Cochenour, Ontario P0V 1L0

## ASSAY CERTIFICATE

Date: May 16-91

C. Peterson

Sample No.	Description	oz/ton Au	oz/ton Ag
1		28.96	
2			
3			
4			
5			
6			
7			
8			
9			
10			
11			
12			
13			
14			
15			
16			
17			
18			
19			
20			
21			
22			
23			
24			
25			

Assayer:

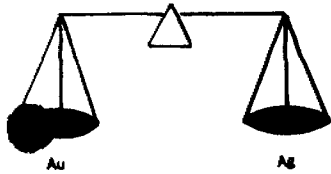

# PAUL'S CUSTOM FIRE ASSAYING LTD.

Phone: Bus. (807) 662-8171

Res. (807) 662-3361

Fax: (807) 662-1155

PAUL OKANSKI, Assayer  
Box 253, Cochenour, Ontario P0V 1L0

C. Peterson

## ASSAY CERTIFICATE

Date: May 23-91

Sample No.	Description	oz/ton Au	oz/ton Ag
1	2622		
	No. 2. STRIPPING CONTACT. NARROW	Trace	
2	VULCANIC ROCK		
3			
4			
5			
6			
7			
8			
9			
10			
11			
12			
13			
14			
15			
16			
17			
18			
19			
20			
21			
22			
23			
24			
25			

Assayer:

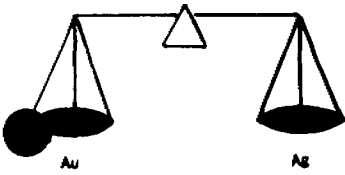

# PAUL'S CUSTOM FIRE ASSAYING LTD.

Phone: Bus. (807) 662-8171

Res. (807) 662-3361

Fax: (807) 662-1155

PAUL OKANSKI, Assayer  
Box 253, Cochenour, Ontario P0V 1L0

J. Peterson

## ASSAY CERTIFICATE

Date: May 23-91

	Sample No.	Description	oz/ton Au	oz/ton Ag
1	2622		Trace	
2				
3				
4				
5				
6				
7				
8				
9				
10				
11				
12				
13				
14				
15				
16				
17				
18				
19				
20				
21				
22				
23				
24				
25				

Assayer:

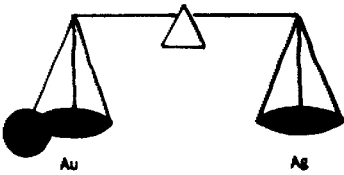

# PAUL'S CUSTOM FIRE ASSAYING LTD.

Phone: Bus. (807) 662-8171

Res. (807) 662-3361

Fax: (807) 662-1155

PAUL OKANSKI, Assayer  
Box 253, Cochenour, Ontario P0V 1L0

C. Petersen

## ASSAY CERTIFICATE

Date: June 14-91

Sample No.	Description	oz/ton Au	oz/ton Ag
1	2623	Trace	
2	24	"	
3	25	"	
4	26	"	
5	27	"	
6	28	"	
7	29	"	
8	30	"	
9	31	"	
10	32	"	
11	33	"	
12	34	"	
13			
14			
15			
16			
17			
18			
19			
20			
21			
22			
23			
24			
25			

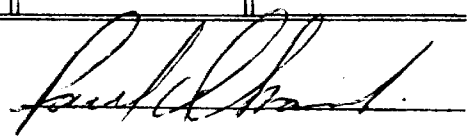
Assayer: 

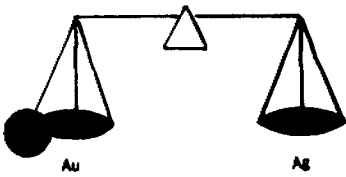

**PAUL'S CUSTOM FIRE ASSAYING LTD.**

Phone: Bus. (807) 662-8171

Res. (807) 662-3361

Fax: (807) 662-1155

PAUL OKANSKI, Assayer  
Box 253, Cochenour, Ontario P0V 1L0

C. Petersen

**ASSAY CERTIFICATE**

Date: June 14-91

Sample No.	Description	oz/ton Au	oz/ton Ag
1	2623	Trace	
2	24	"	
3	25	"	
4	26	"	
5	27	"	
6	28	"	
7	29	"	
8	30	"	
9	31	"	
10	32	"	
11	33	"	
12	34	"	
13			
14			
15			
16			
17			
18			
19			
20			
21			
22			
23			
24			
25			

Assayer: *Paul Okanski*

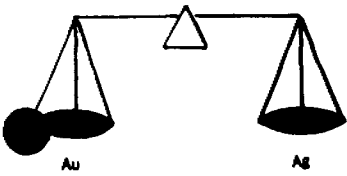

**PAUL'S CUSTOM FIRE ASSAYING LTD.**

Phone: Bus. (807) 662-8171

Res. (807) 662-3361

Fax: (807) 662-1155

PAUL OKANSKI, Assayer  
Box 253, Cochenour, Ontario POV 1L0

C. Peterson

**ASSAY CERTIFICATE**

Date: July 31-91

Sample No.	Description	oz/ton Au	oz/ton Ag
1	2606 GRAB.	.01	
2	2635 "	Trace	
3	36 "	.01	
4			
5			
6			
7			
8			
9			
10	NEW DRILL NO. 8 STRIPPING		
11	QUARTZ VEIN 1' FT WIDE 3 GRAB SAMPLES		
12			
13	KRL 526007. AT LAKE SHORE.		
14			
15			
16			
17			
18			
19			
20			
21			
22			
23			
24			
25			

Assayer: *Paul Okanski*



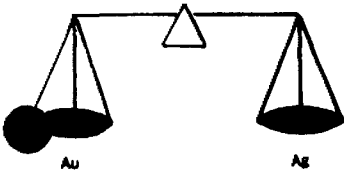

# PAUL'S CUSTOM FIRE ASSAYING LTD.

Phone: Bus. (807) 662-8171

Res. (807) 662-3361

Fax: (807) 662-1155

PAUL OKANSKI, Assayer  
Box 253, Cochenour, Ontario P0V 1L0

C. Peterson

## ASSAY CERTIFICATE

Date: July 31-91

Sample No.	Description	oz/ton Au	oz/ton Ag
1	2606	.01	
2	2635	Trace	
3	36	.01	
4			
5			
6			
7			
8			
9			
10	NEW DREG NO. 8 STRIPPINGS		
11	Quartz vein 1' wide 6 FT. B. SAMPLE		
12			
13			
14			
15			
16			
17			
18			
19			
20			
21			
22			
23			
24			
25			

Assayer:

A handwritten signature in cursive script that reads "Paul Okanski".

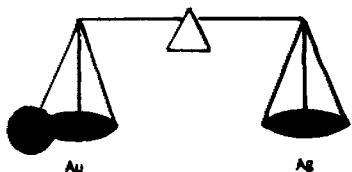

# PAUL'S CUSTOM FIRE ASSAYING LTD.

Phone: Bus. (807) 662-8171

Res. (807) 662-3361

Fax: (807) 662-1155

PAUL OKANSKI, Assayer  
Box 253, Cochenour, Ontario P0V 1L0

C. Peterson

## ASSAY CERTIFICATE

Date: Aug. 22-91

Sample No.	Description	oz/ton Au	oz/ton Ag
1 10573	SPLIT CORE 32 - 35'	Trace	
2 74	35 - 38'	"	
3 75	38 - 42.5'	"	
4 76	42.5 - 45'	"	
5 10585	45 - 48.5'	"	
6 86	48.5 - 52'	"	
7 87	GRAB SAMPLE SLUDGE NO. 2 HOPE	"	
8			
9			
10			
11			
12			
13			
14			
15			
16			
17			
18			
19			
20			
21			
22			
23			
24			
25			

*DD/18/91*

Assayer: Paul Okanski

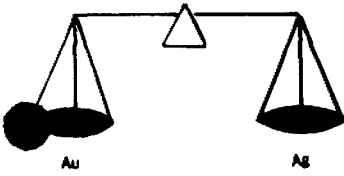

# PAUL'S CUSTOM FIRE ASSAYING LTD.

Phone: Bus. (807) 662-8171

Res. (807) 662-3361

Fax: (807) 662-1155

PAUL OKANSKI, Assayer  
Box 253, Cochenour, Ontario P0V 1L0

C. Peterson

## ASSAY CERTIFICATE

Date: Aug. 22-91

Sample No.	Description	oz/ton Au	oz/ton Ag
1	10573	Trace	
2	74	"	
3	75	"	
4	76	"	
5	10585	"	
6	86	"	
7	87	"	
8			
9			
10			
11			
12			
13			
14			
15			
16			
17			
18			
19			
20			
21			
22			
23			
24			
25			

Assayer: Paul Okanski

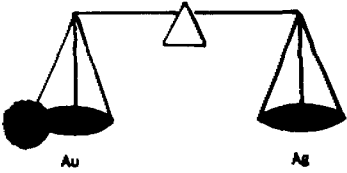

# PAUL'S CUSTOM FIRE ASSAYING LTD.

Phone: Bus. (807) 662-8171

Res. (807) 662-3361

Fax: (807) 662-1155

PAUL OKANSKI, Assayer  
Box 253, Cochenour, Ontario P0V 1L0

C. Peterson

## ASSAY CERTIFICATE

Date: Oct. 15-91

Sample No.	Description	oz/ton Au	oz/ton Ag
1 2607	SAMPLES NO 6	Trace	
2 08	NO. 6 STRIPPING DREG	"	
3 09	NO 6 " "	"	
4 10	NO 7. STRIPPING DREG	"	
5 11	NO 7. " "	"	
6 2637	NO 7. " "	"	
7 38	NO 7. " "	"	
8	SOME ROCK WORK WILL HAVE		
9	TO BE DONE IN THESE DREG'S.		
10			
11			
12			
13			
14			
15			
16			
17			
18			
19			
20			
21			
22			
23			
24			
25			

Assayer: *Paul Okanski*

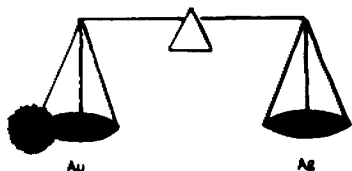

# PAUL'S CUSTOM FIRE ASSAYING LTD.

Phone: Bus. (807) 662-8171

Res. (807) 662-3361

Fax: (807) 662-1155

PAUL OKANSKI, Assayer  
Box 253, Cochenour, Ontario P0V 1L0

C. Peterson

## ASSAY CERTIFICATE

Date: Oct. 15-91

Sample No.	Description	oz/ton Au	oz/ton Ag
1	2607	Trace	
2	08	"	
3	09	"	
4	10	"	
5	11	"	
6	2637	"	
7	38	"	
8			
9			
10			
11			
12			
13			
14			
15			
16			
17			
18			
19			
20			
21			
22			
23			
24			
25			

Assayer: