

LES RELEVÉS

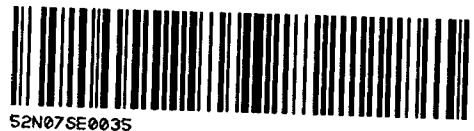

SURVEYS INC.

11, rue Nelson
Val d'Or, Qué. J9P 2Z5
Tél.: (819) 825-6263



52N07SE0035

010

REPORT
ON
GEOPHYSICAL WORK
ON THE
SIGNAL GROUP
SWAIN LAKE AREA
OF
LABRADOR MINING EXPLORATION CO. LTD.

March 15, 1984

REJEAN GOSSELIN M.Sc.
Consulting Geologist.

26272

LOCATION MAP

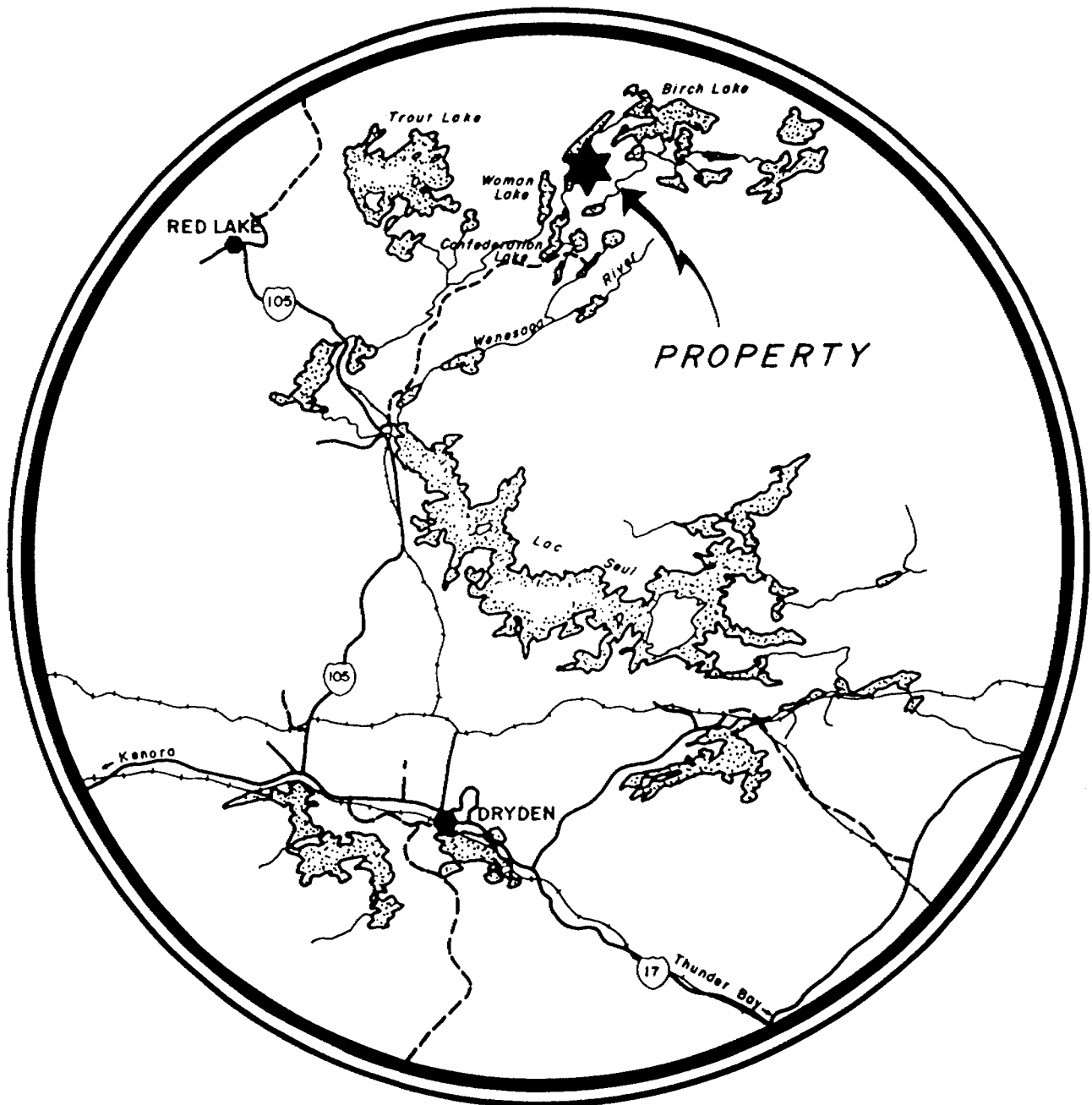

1" = 12 miles



52N07SE0035

010C

TABLE OF CONTENTS

Table of contents.....page 1

Introduction.....page 2

Location and access.....page 2

Geology.....page 2

Geophysical work.....page 3

Results.....page 4

Conclusions and recommendations.....page 5

Certificate.....page 6

IN POCKET :

- Magnetometer survey map.
- HEM survey map, Maxmin profiles
- Magnometer survey detailed map.
- HEM survey detailed map, Maxmin Profiles.

INTRODUCTION

The present report describes the results of the electromagnetic (HEM-MAXMIN) and magnetic surveys that were recently performed on the Signal Group of Labrador Mining and Exploration Co. Ltd, in Swain Lake area, Ontario. The property consists of 24 contiguous mining claims covering an area of approximately 960 acres.

The property has been entirely covered by both the magnetic and electromagnetic (HEM-MAXMIN) surveys.

LOCATION AND ACCESS

The property of Labrador Mining and Exploration Co. Ltd. is located on the northeast shore of Swain Lake, in the Red Lake Mining Division, Northeastern Ontario.

The Signal Group lies at approximately 55 miles northeast of the town of Red Lake. The easiest mean of access is by bush - plane from either Uchi Lake or Confederation Lake (South Bay), where aircraft facilities are available, to Swain Lake that covers a limited area in the southwest part of the property. This represents a distance of approximately 13 air-miles from Confederation Lake (South Bay) and 16 air-miles from Uchi Lake.

GEOLOGY

The property under study is mostly underlain by Archean metasedimentary rocks consisting of mixed greywacke, tuffaceous metasediments, sandstone and conglomerate. Basic volcanic and intrusive rocks are also inferred to occur on the property. The rocks have been metamorphosed to the greenschist facies and are affected by a regional schistosity striking roughly east-west in the area of interest. The rocks have been folded and cut by faults and shears.

One gold showing and one copper showing are reported to occur on the group of claims. They should be located near the southeast shore of Swain Lake in the west-central part of the property.

The geological information, summarized above, has been taken from the Ontario Geological Survey Preliminary Map P.2386. This compilation map at a scale of 1 inch to 2 miles has been prepared by P. C. Thurston and J. R. Bartlett and published in 1981 by the Ontario Ministry of Natural Resources.

GEOPHYSICAL WORK

A grid of lines have been cut to cover all the claims forming the Signal Group. A base line (BL-10+00N), 9600 feet long, was established at an azimuth of 102° with one parallel tie line (TL-16+00N) located 600 meters (1968 feet) to the north. Perpendicular lines at an azimuth of 012° were cut at a spacing of 400 feet except from L-152W to L-180W between the base line and the tie line where 200 foot spaced lines were cut. A total of approximately 24 line-miles were cut and chained with stations every 25 meters (82 feet).

The magnetic and the electromagnetic (HEM-MAXMIN) surveys were carried out along the north-south lines with readings recorded every 25 meters for both surveys. The readings were taken every 3 meters (10 feet) where detail 200-foot spacing lines have been established.

The magnetic survey was conducted with a Geometrics, Unimag II unit. Base stations were located on the base line and the readings were corrected for the diurnal variations. The readings were contoured and the results are presented in pocket on the Magnetometer Survey map, at a scale of 1:2,500, that covers the whole claim group.

A Magnetometer Survey detailed map at a scale of 1:1,000 is also presented in pocket to illustrate the close reading survey done on the 200-foot spaced lines.

The electromagnetic (HEM) survey was conducted with a MAXMIN II instrument using a cable of 25 meters and the frequency of 1777 Hz. The HEM readings were recorded every 25 meters along the lines except for the 200-foot spaced lines where measurements were taken every 3 meters (10 feet). Two MAXMIN Survey maps are presented in pocket; one covering the whole grid at a scale of 1:2,500 and another one at a scale of 1:1,000 that represents the detail surveyed area.

RESULTS

The results of the electromagnetic (HEM-MAXMIN) survey are very disappointing. No anomalies have been detected on the property. The author believes that a longer cable should have been used.

The magnetic survey was able to detect two features of high magnetic susceptibility. A semicircular feature characterized by background readings above 2000 gammas. was found on the southwest corner of the property, centered over Swain Lake. This magnetic feature may represent the northeast edge of a mafic intrusive body. The second magnetic feature that was detected is a long east-west striking zone that crosses the grid line from L-100W at 7+00N to L-180W at 12+00N. This magnetic anomaly seems to be displaced, possibly by northeast striking faults, in the vicinity of the lines 152W and 160W. This magnetic feature is believed to represent mafic volcanic rocks surrounded by low magnetic susceptibility sedimentary units.

CONCLUSIONS AND RECOMMENDATIONS

The electromagnetic (HEM-MAXMIN) survey failed to indicate conductive zones on the Signal Group of Labrador Mining Exploration Co. Ltd. Two magnetic features have been outlined by the magnetic survey. One of them seems to be displaced by northeast striking faults.

An electromagnetic (VLF-EM16) survey using two transmitting stations (NAA and NSS) and an induced polarization survey should be performed on the property, specially in the southeast quarter of the claim group in order to outline favorable structures for gold mineralizations. Intense prospecting, detailed geological mapping and soil geochemical sampling are also recommended to define drill targets.

March 15, 1984



REJEAN GOSSELIN, M.Sc.
Consulting Geologist.

CERTIFICATE

THIS IS TO CERTIFY THAT:

- I am resident of Val D'or, province of Québec since 1979.

- I have been engaged in mining exploration since 1979 and have been consulting as a professional geologist since 1979.

- I am graduate of Université Laval in Québec City (M.Sc, Geol.)

- I am a member of the Association des Géologues du Québec, of the Prospectors and Developers Association, of the Canadian Institute of Mining and Metallurgy and also director of the Québec Prospectors Association.

- This report is based on the data furnished by C.D.I. Surveys Inc. and believed to be reliable, and on the author's experience on gold exploration.

- I have not received, directly or indirectly, or expect to receive any interest direct or indirect in Signal Group, Property of Labrador Mining Exploration Co. Ltd.

March 15, 1984

BY: 
REJEAN GOSSELIN, M.Sc.
Consulting Geologist.



52N07SE0035

900

Mining Lands Section

File No 2.6583

Control Sheet

TYPE OF SURVEY GEOPHYSICAL
 GEOLOGICAL
 GEOCHEMICAL
 EXPENDITURE

MINING LANDS COMMENTS:

LO

[Handwritten Signature]
 Signature of Assessor

2/06/84
 Date

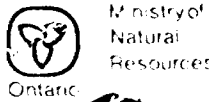

Report of Work
(Geophysical, Geological,
Geochemical and Expenditures)

#84-17

2.6583
Instructions: - Please type or print
- If number of mining claims traversed exceeds space on this form, attach a list
Note: - Only days credits calculated in the "Expenditures" section may be entered in the "Expend Days Cr." columns.
- Do not use shaded areas below.

F.O.U.M.

Mining Act

Type of Survey(s) <i>Loccuting, E.M., Magnetometer</i>	Township or Area <i>Shabumari Lake Area - M-2665</i>
Claim Holder(s) <i>Lobader Exploration (Ontario) Ltd.</i>	Prospector's Licence No. <i>A37516</i>
Address <i>4600 Toronto-Dominion Centre, Toronto, Ontario, M5R 1E5</i>	
Survey Company <i>CDI Surveys Inc.</i>	Date of Survey (from & to) 10 12 83 30 01 84 Day Mo. Yr. Day Mo. Yr.
Name and Address of Author (of Geo-Technical report) <i>J.P. Ryan + CDI Surveys (as above)</i>	Total Miles of line Cut <i>29 miles</i>

Credits Requested per Each Claim in Columns at right

Mining Claims Traversed (List in numerical sequence)

Special Provisions	Geophysical	Days per Claim
For first survey: Enter 40 days. (This includes line cutting)	- Electromagnetic	40
	- Magnetometer	20
For each additional survey: using the same grid: Enter 20 days (for each)	- Radiometric	
	- Other	
	Geological	
	Geochemical	
Man Days	Geophysical	Days per Claim
Complete reverse side and enter (in red) the MAKE MINING DIV. RECEIVED MAR - 9 1984 A.M. P.M. 7 8 9 10 11 12 1 2 3 4 5 6	- Electromagnetic	
	- Magnetometer	
	- Radiometric	
	- Other	
	Geological	
	Geochemical	
Airborne Credits	Geophysical	Days per Claim
Note: Special provisions credits do not apply to Airborne Surveys.	- Electromagnetic	
	- Magnetometer	
	- Radiometric	

Mining Claim			Mining Claim		
Prefix	Number	Expend. Days Cr.	Prefix	Number	Expend. Days Cr.
KRL	706094	60	KRL	696806	60
	706095	60			
	706096	60			
	706097	60			
	706098	60			
	706099	60			
	706100	60			
	706101	60			
	706102	60			
	706103	60			
	706104	60			
	706105	60			
	706106	60			
	706107	60			
	706108	60			
	706109	60			
	706110	60			
	706111	60			
	706112	60			
	696802	60			
	696803	60			
	696804	60			
	696805	60			

RECEIVED
MAY 14 1984
MINING LANDS SECTION

Expenditures (excludes power stripping)

Type of Work Performed

Performed on Claim(s)

Calculation of Expenditure Days Credits

Total Expenditures \$ ÷ 15 = Total Days Credits

Instructions
Total Days Credits may be apportioned at the claim holder's choice. Enter number of days credits per claim selected in columns at right.

Total number of mining claims covered by this report of work. **74**

For Office Use Only

Total Days Cr. Recorded **1440** Date Recorded **Mar. 9/84** Mining Recorder *[Signature]*

Date Approved as Recorded **8.7.24** Branch Director *[Signature]*

Date **March 6/84** Recorded Holder or Agent (Signature) *[Signature]*

Certification Verifying Report of Work

I hereby certify that I have a personal and intimate knowledge of the facts set forth in the Report of Work annexed hereto, having performed the work or witnessed same during and/or after its completion and the annexed report is true.

Name and Postal Address of Person Certifying
TERRANCE P. RYAN
410 SATOK CROS, MILTON, ONTARIO, L9T 3P5

Date Certified **March 6, 1984** Certified by (Signature) *[Signature]*

KRL 696802

1984 04 09

Your File:
Our File: 2.6583

Albert Scott Rivett
Mining Recorder
Ministry of Natural Resources
Ontario Government Building
Box 5003
Red Lake, Ontario
P0V 2M0

Dear Sir:

We have received reports and maps for a Geophysical (Electromagnetic and Magnetometer) Survey submitted under Special Provisions (credit for Performance and Coverage) on Mining Claims KRL 696802 et al in the Area of Shabumeni Lake.

This material will be examined and assessed and a statement of assessment work credits will be issued.

We do not have a copy of the report of work which is normally filed with you prior to the submission of this technical data. Please forward a copy as soon as possible.

Yours sincerely,

S.E. Yundt
Director
Land Management Branch

Whitney Block, Room 6643
Queen's Park
Toronto, Ontario
M7A 1W3
Phone:(416)965-6918

A.Barr:mc

cc: Labrador Mining and Exploration Company Limited
Suite 4600
Toronto Dominion Centre
M5K 1E5

cc: Rejean Gosselin
11 Rue Nelson
Val d'Or, Quebec
J9P 2Z5



Mining Lands Comments

To: Geophysics

Comments			
<input type="checkbox"/> Approved	<input type="checkbox"/> Wish to see again with corrections	Date	Signature

To: Geology - Expenditures

Comments			
<input type="checkbox"/> Approved	<input type="checkbox"/> Wish to see again with corrections	Date	Signature

To: Geochemistry

Comments			
<input type="checkbox"/> Approved	<input type="checkbox"/> Wish to see again with corrections	Date	Signature

To: Mining Lands Section, Room 6462, Whitney Block. (Tel: 5-1380)

033331

Approved Reports of Work
sent out

Notice of Intent filed

Approval after Notice of Intent
sent out

Duplicate sent to Resident
Geologist

Duplicate sent to A.F.R.D.

P.C. Finlay, Q.C.
Chairman

LABRADOR MINING AND EXPLORATION COMPANY LIMITED

Executive Office

4600 Toronto-Dominion Centre
Toronto, Ontario M5K 1E5
(416) 947-4000

C.B. Ross
President

April 3, 1984

REGISTERED MAIL

Mining Lands
99 Wellesley Street West
Whitney Block, Room 6610
Queen's Park
Toronto, Ontario
M7A 1W3

Dear Sir,

Pursuant to our recently submitted "Report of Work" forms, please find enclosed duplicate copies of the following reports:

"Report on Geophysical Work on the Shelter Group - Caviar
Lake Area of Labrador Mining Exploration Company Limited"
- Rejean Gosselin

"Report on Geophysical Work on the Signal Group - Swain
Lake Area of Labrador Mining Exploration Company Limited"
- Rejean Gosselin.

We trust these meet with your approval.

Yours truly,

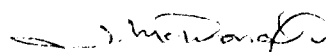

J. McDonald
Labrador Exploration Ontario
Limited

JMcD:jc
Enclosures

RECEIVED
APR - 4 1984
MINING LANDS SECTION

#17

2.6583

EM MAG

	EM	MAG							
KRL 706 094	✓	✓							
095	✓	✓							
096	✓	✓							
097	✓	✓							
098	✓	✓							
099	✓	✓							
100	✓	✓							
101	✓	✓							
102	✓	✓							
103	✓	✓							
104	✓	✓							
105	✓	✓							
106	✓	✓							
107	✓	✓							
108	✓	✓							
109	✓	✓							
110	✓	✓							
111	✓	✓							
112	✓	✓							
646 802	✓	✓							
803	✓	✓							
804	✓	✓							
805	✓	✓							
806	✓	✓							

LITTLE SHABUMENI LAKE G-1810

REFERENCES

AREAS WITHDRAWN FROM DISPOSITION

M.R.O. - MINING RIGHTS ONLY
 S.R.O. - SURFACE RIGHTS ONLY
 M+S - MINING AND SURFACE RIGHTS

Description	Order No.	Date	Disposition	File



200

LEGEND

- HIGHWAY AND ROUTE No.
- OTHER ROADS
- TRAILS
- SURVEYED LINES:
 - TOWNSHIPS, BASE LINES, ETC.
 - LOTS, MINING CLAIMS, PARCELS, ETC.
- UNSURVEYED LINES:
 - LOT LINES
 - PARCEL BOUNDARY
 - MINING CLAIMS ETC.
- RAILWAY AND RIGHT OF WAY
- UTILITY LINES
- NON-PERENNIAL STREAM
- FLOODING OR FLOODING RIGHTS
- SUBDIVISION OR COMPOSITE PLAN RESERVATIONS
- ORIGINAL SHORELINE
- MARSH OR MUSKEG
- MINES
- TRAVERSE MONUMENT

DISPOSITION OF CROWN LANDS

TYPE OF DOCUMENT	SYMBOL
PATENT, SURFACE & MINING RIGHTS	●
" SURFACE RIGHTS ONLY	○
" MINING RIGHTS ONLY	◐
LEASE, SURFACE & MINING RIGHTS	◑
" SURFACE RIGHTS ONLY	◒
" MINING RIGHTS ONLY	◓
LICENCE OF OCCUPATION	◔
ORDER-IN-COUNCIL	OC
RESERVATION	○
CANCELLED	⊙
SAND & GRAVEL	⊚

NOTE: MINING RIGHTS IN PARCELS PATENTED PRIOR TO MAY 6, 1913, VESTED IN ORIGINAL PATENTEE BY THE PUBLIC LANDS ACT, R.S.O. 1970, CHAP. 380, SEC. 63, SUBSEC. 1.

SCALE: 1 INCH = 40 CHAINS

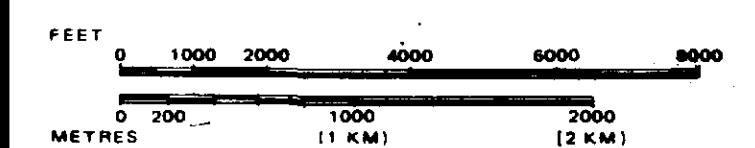

DATE OF ISSUE
 JUL 14 1991
 Ministry of Natural Resources
 TORONTO

AREA
SHABUMENI LAKE
 M.N.R. ADMINISTRATIVE DISTRICT
RED LAKE
 MINING DIVISION
RED LAKE
 LAND TITLES / REGISTRY DIVISION
KENORA / PATRICIA

Ministry of Natural Resources
 Land Management Resources Branch
 Ontario

Date FEB. 1983 Number **G-1881**

SHABU LAKE G-1880

SATTERLY LAKE G-1874

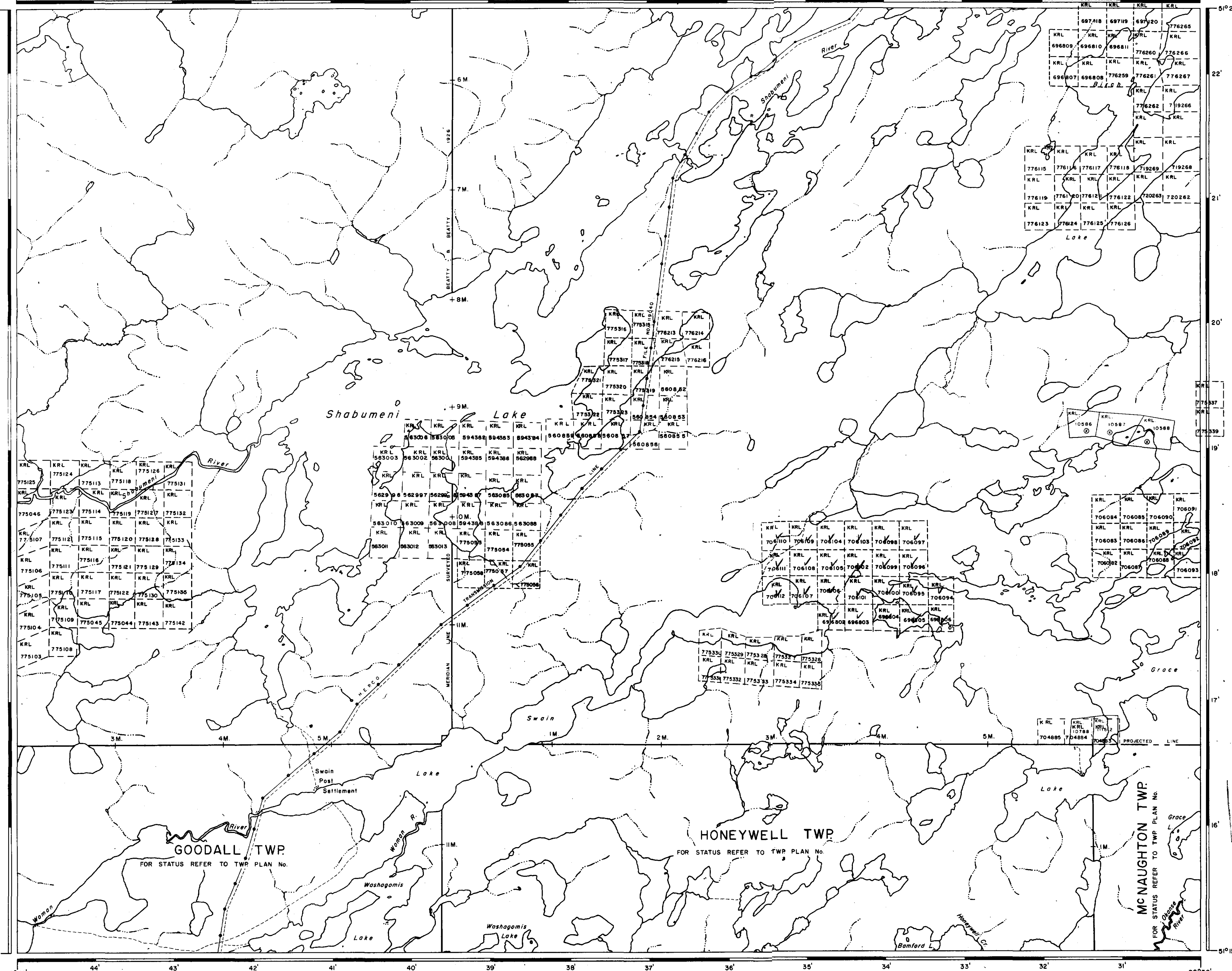

92°45' 92°30' 51°22'30" 22' 21' 20' 19' 18' 17' 16' 15' 51°15'

6M 7M 8M 9M 10M 11M 12M 13M 14M 15M 16M 17M 18M 19M 20M 21M 22M 23M 24M 25M 26M 27M 28M 29M 30M 31M 32M 33M 34M 35M 36M 37M 38M 39M 40M 41M 42M 43M 44M 45M 46M 47M 48M 49M 50M 51M 52M 53M 54M 55M 56M 57M 58M 59M 60M 61M 62M 63M 64M 65M 66M 67M 68M 69M 70M 71M 72M 73M 74M 75M 76M 77M 78M 79M 80M 81M 82M 83M 84M 85M 86M 87M 88M 89M 90M 91M 92M 93M 94M 95M 96M 97M 98M 99M 100M

BEATTY & BEATTY

Woron River

Shabumeni Lake

Swain Lake

Washagamis Lake

Honeywell Lake

Goodall TWP

HONEYWELL TWP

McNAUGHTON TWP

FOR STATUS REFER TO TWP PLAN No.

Woron

Honeywell C.

Banford L.

PROJECTED LINE

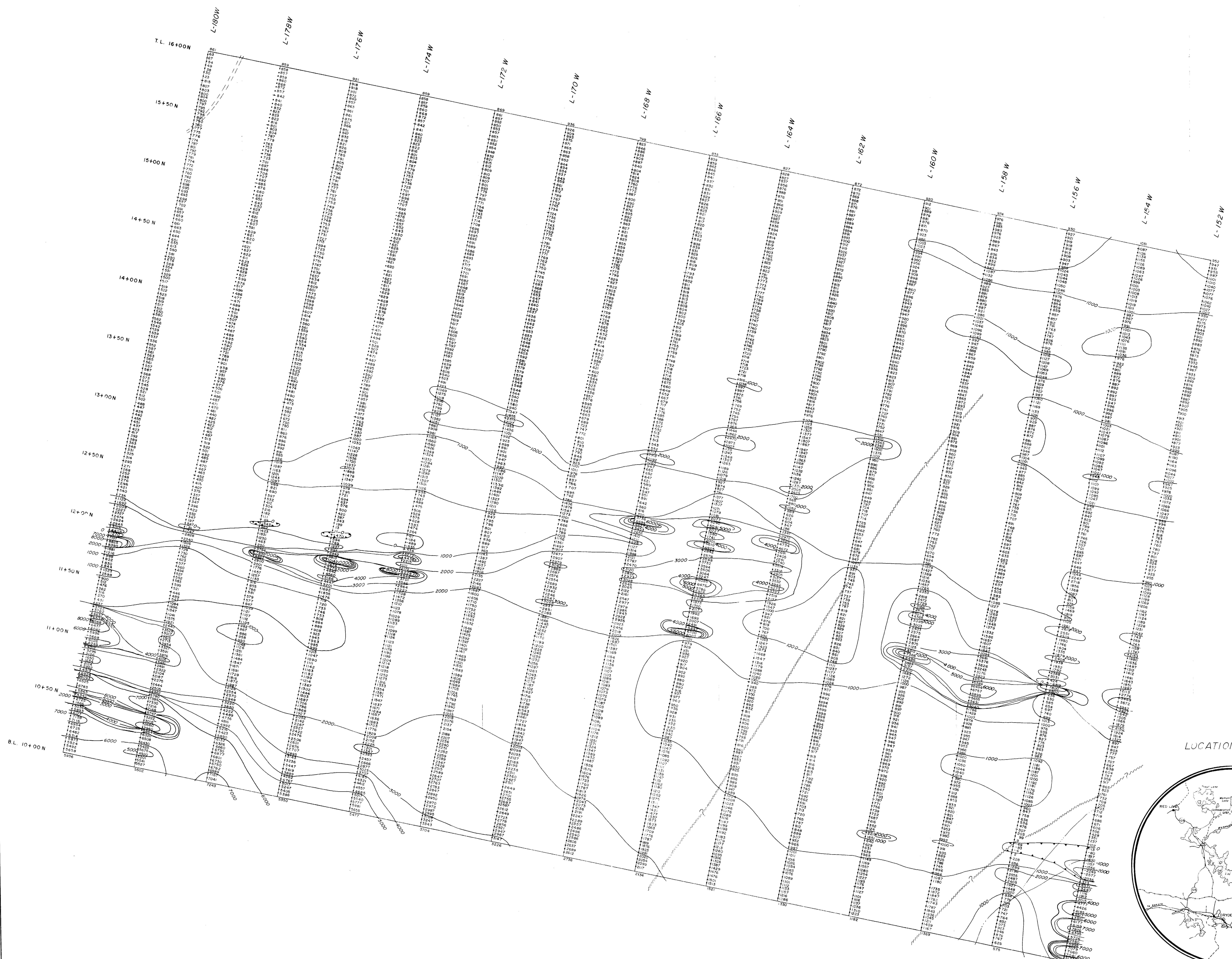

LEGEND

- MAG CALCULATION OVER 59,000 GAMMAS
- LESS THAN BACKGROUND
 - LESS - 1000
 - 1000 - 2000
 - 2000 - 3000
 - 3000 - 4000
 - 4000 - 5000
 - 5000 - 6000
 - 6000 - 7000
 - 7000 - 8000
 - 8000 - 9000
 - 9000 - 10000
 - 10000 - MORE

- LAKE
- ROAD
- RIVER

210
**LABRADOR MINING
 EXPLORATION Co. Ltd.**

SIGNAL GROUP
 SWAIN LAKE AREA
 ONTARIO
DETAILED MAP
 MAGNETOMETER SURVEY

INSTRUMENT: UNIMAG II
 SCALE: 1:1,000

EXECUTED BY: *CDI surveys inc.*
 COMPILED & DRAWN BY: *R.B. CARFELL*
 APPROVED BY: *[Signature]*

26583

LOCATION MAP

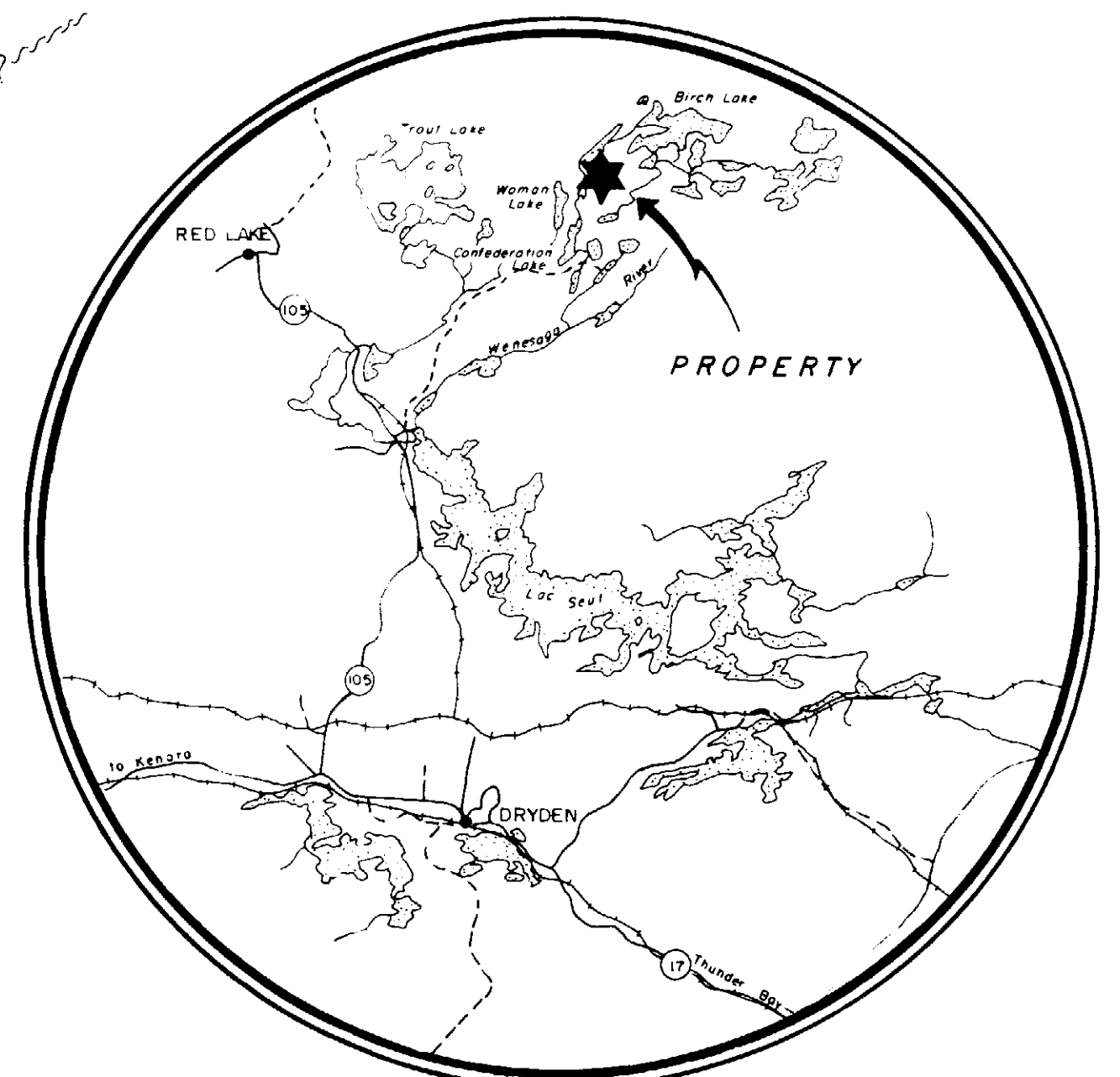

SCALE: 1:12,000


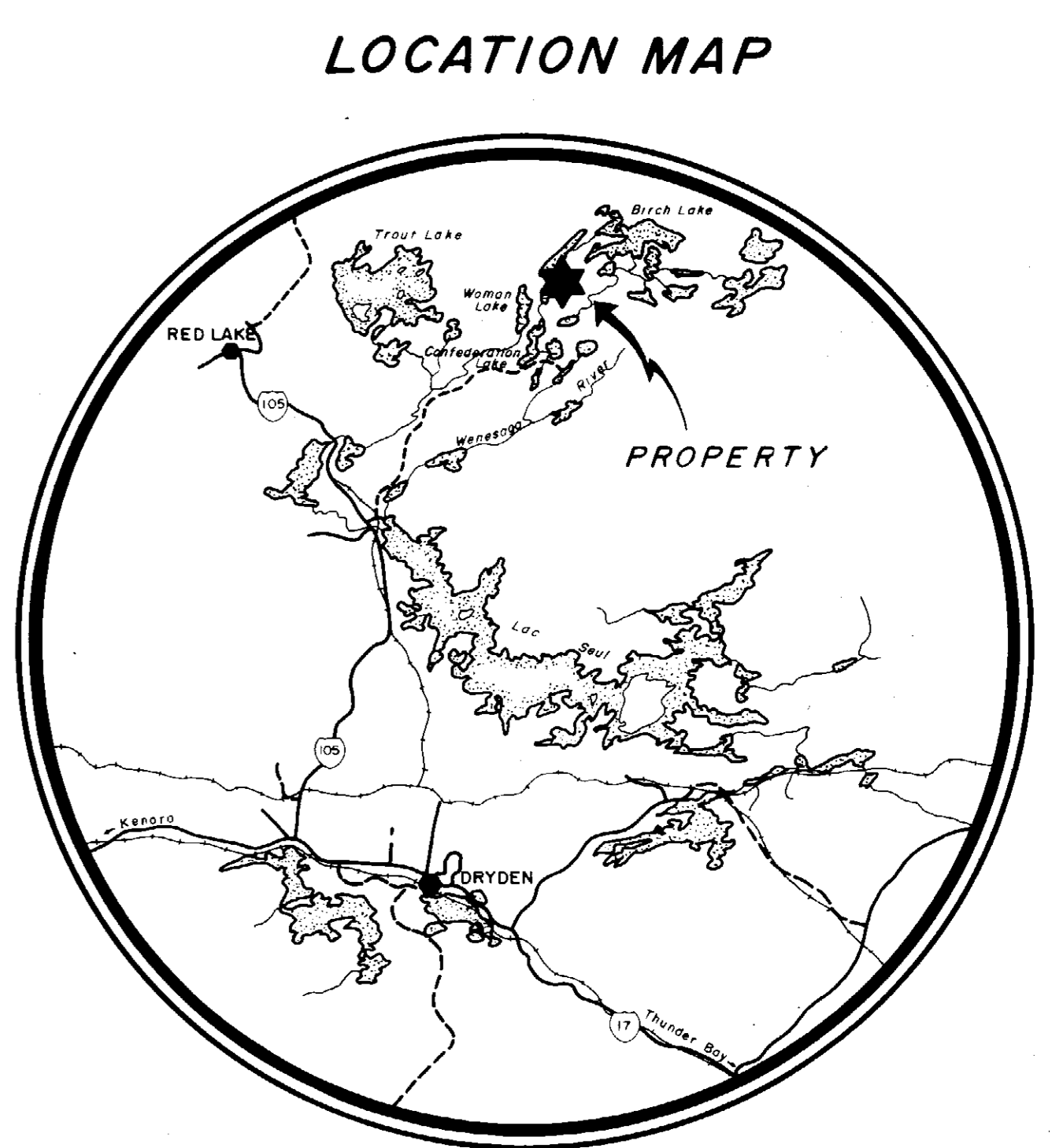

**LABRADOR MINING
EXPLORATION Co. Ltd.**

**SIGNAL GROUP
SWAIN LAKE AREA
ONTARIO**

MAGNETOMETER SURVEY

Inst: UNIMAG II
SCALE
1:2500 meters

LEGEND

MAG CALCULATION OVER 99,000 GAMMAS

[Symbol]	LESS THAN BACKGROUND
[Symbol]	1000
[Symbol]	2000
[Symbol]	3000
[Symbol]	4000
[Symbol]	5000
[Symbol]	6000
[Symbol]	7000
[Symbol]	8000
[Symbol]	9000
[Symbol]	10000
[Symbol]	11000
[Symbol]	MORE

[Symbol] LAKE
[Symbol] RIVER
[Symbol] ROAD

EXECUTED BY: **CDI surveys inc.**
COMPILED & DRAWN BY: S. Rhéaume, G. Lefebvre, Y. Lefebvre
APPROVED BY: *[Signature]*

21583

**LABRADOR MINING
EXPLORATION Co. Ltd.**

**SIGNAL GROUP
SWAIN LAKE AREA
ONTARIO**



MAXMIN PROFILES

Inst: MAXMIN II Freq: 1777 Cable: 25 m.

SCALE

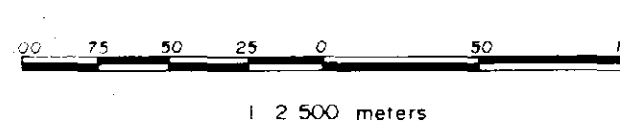

EXECUTED BY **CDI surveys inc.**

COMPILED & DRAWN BY: S. Rhéaume, G. Lefebvre, Y. Lefebvre

APPROVED BY: *[Signature]* 2.135.910

26583

LEGEND

MAXMIN PROFILES
+10% In Phase -10% Out of Phase

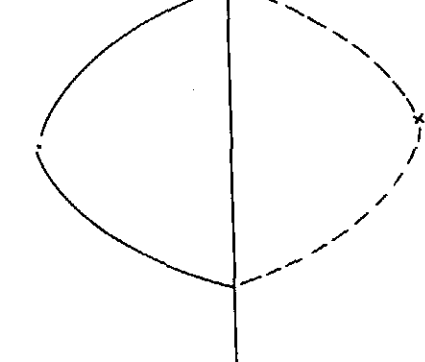

Horizontal Scale: 1" = 10%
Vertical Scale: 1" = 2500

- LAKE
- RIVER
- ROAD



LOCATION MAP

