



52N07SE0038 2.4834 SHABUMENI LAKE

900

#300 - 82

1983 06 27

Recorded Holder	ANDREW HAGER
Township or Area	SHABUMENI LAKE AREA

Type of survey and number of Assessment days credit per claim	Mining Claims Assessed
Geophysical Electromagnetic _____ days Magnetometer _____ days Radiometric _____ days Induced polarization _____ days Section 86(19) 77(19) _____ days XXXXXX Geological _____ days Geochemical _____ days Man days <input type="checkbox"/> Airborne <input type="checkbox"/> Special provision <input type="checkbox"/> Ground <input type="checkbox"/> <input type="checkbox"/> Credits have been reduced because of partial coverage of claims. <input type="checkbox"/> Credits have been reduced because of corrections to work dates and figures of applicant.	<p>\$3,465.00 spent on sample assays 231 assessment work days are allowed, and the credits are to be recorded as follows:</p> <p>KRL 526522 - 36 days 526526 - 27 days 526527 - 14 days 526528 - 60 days 541163 - 24 days 560857 - 29 days 560858 - 21 days 560859 - 20 days</p>

Special credits under section 86 (15a) for the following mining claims

No credits have been allowed for the following mining claims

not sufficiently covered by the survey Insufficient technical data filed

The Mining Recorder may reduce the above credits if necessary in order that the total number of approved assessment days recorded on each claim does not exceed the maximum allowed as follows: Geophysical — 80; Geological — 40; Geochemical — 40; Section 86(18)-60:

1983 06 27

2.4834

Andrew Hager
Box 236
Red Lake, Ontario
POV 2M0

Dear Sir:

RE: Sample assay expenditures submitted on Mining Claims
KRL 526522 et al in the Area of Shabumeni Lake

Assessment work credits will be allowed for the sample assay expenditures on Mining Claims KRL 526522 et al.

This acceptance without signed receipts nor cancelled cheques nor a duplicate sample location map is not to be considered a precedent and future submissions must have a complete duplicate set of maps as well as adequate proof of expenditures.

Yours very truly,

E.F. Anderson
Director
Land Management Branch

Whitney Block, Room 6450
Queen's Park
Toronto, Ontario
M7A 1W3
Phone: (416) 965-1380

D. Kinvig:mc

cc: Minorex Limited
Thetford Mines, Quebec

cc: Mining Recorder
Red Lake, Ontario

1983 06 27

2.4834

Resident Geologist
Ministry of Natural Resources
P.O. Box 860
Government Building
Red Lake, Ontario
POV 2M0

Dear Sir:

RE: Sample assay expenditures submitted on Mining Claims
KRL 526522 et al in the Area of Shabumeni Lake

A sample location map is not included with the enclosed duplicate set of plans for the above-mentioned survey, since only one copy of this map was submitted. This map was placed with the original set of plans at the assessment library in Toronto. The exploration company which conducted the survey is now out of business and is not in a position to supply us with an additional map.

Yours very truly,

E.F. Anderson
Director
Land Management Branch

Whitney Block, Room 6450
Queen's Park
Toronto, Ontario
M7A 1W3
Phone: (416)965-1380

D. Kinvig:mc

Encl.

1983 06 27

2.4834

Mr. Albert Scott Rivett
Mining Recorder
Ministry of Natural Resources
Ontario Government Building
Box 324
Red Lake, Ontario
POV 2M0

Dear Sir:

RE: Assaying submitted under Section 77(19) of the
Mining Act R.S.O. 1980, on Mining Claims KRL 526522
et al in the Area of Shabumeni Lake

The enclosed statement of assessment work credits for assaying
expenditures has been approved as of the above date.

Please inform the recorded holder of these mining claims and
so indicate on your records.

Yours very truly,

E.F. Anderson
Director
Land Management Branch

Whitney Block, Room 6540
Queen's Park
Toronto, Ontario
M7A 1W3
Phone: (416) 965-1380

D. Kinvig:mc

Encl.

cc: Andrew Hager
Red Lake, Ontario

cc: Resident Geologist
Red Lake, Ontario

Action Memo

Time

Date

83,03,03

Order

To: F. W. Matthews

From: Scott Rieft

Telephone No. 1234

Message Taken By

- Phone Call
- On Hold
- Face to Face
- Your Call
- W. I. Call Back
- Was Approached
- Waiting or Present
- Was There
- Will Return

- File
- Draft Reply for Mr. Anderson
- Provide More Details
- For Your Information

- Type Draft
- For Your Approval and Signature
- Keep Me Informed
- For Discussion

- Type First
- Copy of this to Mr. Jones
- For Your Request

- Make Copies
- Refer With Comments
- Follow Up With Thanks

- Please Advise
- Respond and Reply

Comments

RECORDED

Land Management Dept.

COMMUNICATIONS SECTION

BY

MAR 11 1963

E. E. ANDERSON

J. C. STEVENSON

G. SHEPHERD

E. M. SMITH



Ministry of
Natural
Resources

Ontario

OUT OF BUSINESS

Your file:

1983 03 02

Our file: 2.4675

83.03.02

Minorex Limited
P.O. Box 7
Thetford Mines, Quebec
G6G 5R9

14 of these 17 claims
transferred to Mr.

Attention: Mr. Denis Bray

Andy Hager P9209

Dear Sir:

*Mr. Hager is not in a position
to answer these questions*

RE: Geological Survey submitted on Mining Claims
KRL 560858 et al in the Area of Shabumeni Lake

*Print
Mining Recorder*

Enclosed are the plans and final page of the report
in duplicate, for the above mentioned survey. In
order to complete your submission we require the
following:

- a) final page of the report, signed;
- b) colour plans;
- c) show key map on plans;
- d) provide a brief resume of Dominique
Doucet's qualifications for our records.

For further information, please contact Mr. F.W.
Matthews at 416/965-1380.

Yours very truly,

E.F. Anderson
Director
Land Management Branch

Whitney Block, Room 6450
Queen's Park
Toronto, Ontario
M7A 1W3
Phone 416/965-1380

A. Barr:jh
Encls.

cc: Mining Recorder
Red Lake, Ontario

RED LAKE
MINING DIV.
RECEIVED
MAR 3 1983 P.M.
A.M. 7|8|9|10|11|12|1|2|3|4|5|6

A



Ministry of Natural Resources

GEOLOGICAL #29

SHABUMENI LAKE M.2665

A separate form is required for each type of work to be recorded.

THE MINING ACT REPORT OF WORK

To the Recorder of RED LAKE Mining Division

I, MINOREX LIMITED T-828 name of Recorded Holder Prospector's Licence

P.O. Box 7 - Thetford-Mines, Quebec G6G 5R9

do hereby report the performance of 285 340 days of Geological Mapping type of work

not before reported to be applied on the following contiguous claims TRANSFERRED 82:06:02 to A. HAGER (P.9290)

Table with 3 columns: Claim No., Days, Claim No., Days, Claim No., Days. Lists various claim numbers and their durations, some circled in red.

All the work was performed on Mining Claim (s) ALL THE CLAIMS (In the case of geological and/or geophysical survey (s) where more than 18 claims are involved attach a schedule)

READ CAREFULLY: THE FOLLOWING INFORMATION IS REQUIRED BY THE MINING RECORDER.

- For Manual Work, Stripping or Opening up of Mines, Sinking Shafts or Other Actual Mining Operations - Names and addresses of the men who performed the work and the dates and hours of their employment.
For Diamond and other Core Drilling - Footage, No. and angle of holes and diameter of core. Name and address of owner or operator of drill. Dates when drilling was done. Signed core log and sketch in duplicate.
For Compressed Air or Other Power Driven or Mechanical Equipment Type of drill or equipment. Names and addresses of men engaged in operating equipment and the dates and hours of their employment.
For Power Stripping - Type of equipment. Name and address of owner or operator. Amount expended. Dates on which work was done. Proof of actual cost must be submitted within 30 days of recording.
With each of the above types of work sketches are required to show the location and extent of the work in relation to the nearest claim post. In the case of diamond or other core drilling the sketch must be submitted in duplicate.
For Geophysical, Geological, Geochemical Surveys and Expenditure Credits - the name of author of report. Covering dates of survey (linecutting & office). Type of instrument used. Total amount of expenditure. Technical reports, maps, expenditure breakdown, receipts must be filed in duplicate with the Minister within 60 days of recording.
For Land Survey - the name and address of Ontario Land surveyor.

The Required Information is as Follows: (Attach a list if this space is insufficient) RECEIVED APR 2 1982

Special Provisions Credits Requested

Report written by Denis Bray and Dominique Doucet Geology survey and office work were performed between May-September 1981. Total amount of expenditures: (see attached report)

Included in duplicate: Geology Map 2317-Ont-61 and Technical Report

Date March 26, 1982 Signature of Recorded Holder or Agent

The Mining Act Certificate Verifying Report of Work

I, Denis Bray of 87 Smith Street, Thetford-Mines, Province of Quebec G6G 3M3 (Post Office Address)

hereby certify: 1. That I have a personal and intimate knowledge of the facts set forth in the report of work annexed hereto, having performed the work or witnessed same during and/or after its completion. 2. That the annexed report is true. Dated March 26, 1982 Signature

KRL 526522

THE PENALTY FOR MAKING A FALSE STATEMENT IN THIS REPORT AND/OR CERTIFICATE IS \$500. OR SIX MONTHS IMPRISONMENT OR BOTH

To F. W. Matthews
 From (Name) Scott Rivett

TCN No. 887 Area Code 727 Telephone No. 727-2250 Message Taken By _____
 Office Management Branch

<input type="checkbox"/> Phoned On Hold	<input type="checkbox"/> Please Call Returned Your Call	<input type="checkbox"/> Will Call Back	<input type="checkbox"/> Waiting in Person	<input type="checkbox"/> Will Return
<input type="checkbox"/>	<input type="checkbox"/>	<input type="checkbox"/>	<input type="checkbox"/>	<input type="checkbox"/>

<input type="checkbox"/> File	<input type="checkbox"/> Draft Reply For My Signature	<input type="checkbox"/> Provide More Details	<input type="checkbox"/> For Your Information
<input type="checkbox"/> Type Draft	<input type="checkbox"/> For Your Approval and Signature	<input checked="" type="checkbox"/> Keep Me Informed	<input checked="" type="checkbox"/> Per Discussion
<input type="checkbox"/> Type Final	<input type="checkbox"/> Circulate Initial and Return	<input type="checkbox"/> Take Action	<input type="checkbox"/> Per Your Request
<input type="checkbox"/> Make Copies	<input type="checkbox"/> Return With Comments	<input type="checkbox"/> See Me	<input checked="" type="checkbox"/> Returned With Thanks
<input type="checkbox"/> Please Answer	<input type="checkbox"/> Investigate and Report	<input type="checkbox"/> Note and Return	<input type="checkbox"/>

Comments _____

Mr. A. Hagen Redlake, Ont.
 does hold to of these claims as noted, and is not in a position to provide information requested. Mr. Minner does not respond, will you ask O.G.S. to

approve these with
the information now
available.

Thank you,
Lett.



Ontario

30 - 02

Ministry of
Natural
Resources

Notification of recording
of assessment work credits

RECEIVED

MAR 21 1983

MINING LANDS SECTION

RECEIVED

JAN - 4 1983

MINING LANDS SECTION

Lands Administration Branch
Mining Lands Section
Ministry of Natural Resources
Room 1617, Whitney Block
Queen's Park, Toronto
M7A 1W3

Date of recording of work: April 2, 1982
Recorded holder: Minorex Limited
Address: P.O. Box 7, Thetford Mines, P.Q. G6G 5R9
Township or Area: M-2665 Shabumeni Lake

Type of survey and number of Assessment days credit per claim	Mining claims
Geophysical	KRL. 560857 - 29 days
Electromagnetic _____ days	" 560858 - 21 days
Magnetometer _____ days	" 560859 - 20 days
Radiometric _____ days	" 526522 - 36 days
Induced polarization _____ days	" 526526 - 27 days
	" 526527 - 14 days
	" 526528 - 60 days
	" 541163 - 24 days
Section 86 (18) Total Days 231 _____ days	
Geological _____ days	
Geochemical _____ days	
Man days <input type="checkbox"/>	
Airborne <input type="checkbox"/>	
Special provision <input checked="" type="checkbox"/>	
Ground <input type="checkbox"/>	

A. HAGAR
MINOREX
ANDREW
HAGER

\$ 3,465.00

Notice to recorded holder:

- Survey reports and maps in duplicate be submitted to the Lands Administration Branch, Toronto within 60 days from the date of recording of this work.
- Reports and maps are being forwarded to the Lands Administration Branch with this letter.

[Signature]
Mining recorder

c.c. Minorex Limited
P.O. Box 7
Thetford Mines, P.Q.



11-1-83

Mining Lands Comments

Modern Concept

To: Geophysics

Comments

Approved Wish to see again with corrections

Date

Signature

To: Geology - Expenditures

Mr Kustra

Comments

Approved Wish to see again with corrections

Date

Signature

Jan 7/83

C Kustra

To: Geochemistry

Comments

LD

Approved Wish to see again with corrections

Date

Signature

To: Mining Lands Section, Room 6462, Whitney Block.

(Tel: 5-1380)

1982 06 09

2.4834

Mining Recorder
Ministry of Natural Resources
Ontario Government Building
Box 324
RED LAKE, Ontario
POV 2M0

Dear Sir:

We have received data for assaying submitted under Section 77(19) of the Mining Act R.S.O. 1980 on Mining Claims KRL 560857 et al in the Area of Shabumeni Lake.

However, we have not received duplicate reports and maps. Please submit these to this office. Upon receipt of the above mentioned information a statement of assessment work credits will be issued.

Yours very truly,

E.F. Anderson
Director
Land Management Branch

Whitney Block, Room 6450
Queen's Park
Toronto, Ontario
M 7A 1W3
Phone: 416/965-1316

J. Skura/amc

cc Minorex Limited
Quebec
Attn: Denis Bray



Ministry of Natural Resources

SHABOMENI LAKE

M-2665

THE MINING ACT REPORT OF WORK

A separate form is required for each type of work to be recorded.

To the Recorder of RED LAKE Mining Division

I, MINOREX LIMITED name of Recorded Holder T-828

P.O. Box 7 - Thetford Mines, Province of Quebec G6G 5R9 Prospector's Licence

do hereby report the performance of 231 days of ASSAYS type of work

not before reported to be applied on the following contiguous claims

Table with 6 columns: Claim No., Days, Claim No., Days, Claim No., Days. Rows include KRL560857 (29), KRL560858 (21), KRL560859 (20), KRL526522 (36), KRL526526 (27), KRL526527 (14).

All the work was performed on Mining Claim (s) ALL LAND CLAIMS (In the case of geological and/or geophysical survey (s) where more than 18 claims are involved attach a schedule)

READ CAREFULLY: THE FOLLOWING INFORMATION IS REQUIRED BY THE MINING RECORDER.

- For Manual Work, Stripping or Opening up of Mines, Sinking Shafts or Other Actual Mining Operations - Names and addresses of the men who performed the work and the dates and hours of their employment.
For Diamond and other Core Drilling - Footage, No. and angle of holes and diameter of core. Name and address of operator or operator of drill. Dates when drilling was done. Signed core log and sketch in duplicate.
For Compressed Air or Other Power Driven or Mechanical Equipment
Type of drill or equipment. Names and addresses of men engaged in operating equipment and the dates and hours of their employment.
For Power Stripping - Type of equipment. Name and address of owner or operator. Amount expended. Dates on which work was done. Proof of actual cost must be submitted within 30 days of recording.
With each of the above types of work sketches are required to show the location and extent of the work in relation to the nearest claim post. In the case of diamond or other core drilling the sketch must be submitted in duplicate.
For Geophysical, Geological, Geochemical Surveys and Expenditure Credits - the name of author of report. Covering dates of survey (linecutting & office). Type of instrument used. Total amount of expenditure. Technical reports, maps, expenditure breakdown, receipts must be filed in duplicate with the Minister within 60 days of recording.
For Land Survey - the name and address of Ontario Land surveyor.

The Required Information is as Follows: (Attach a list if this space is insufficient)

(See attached list)

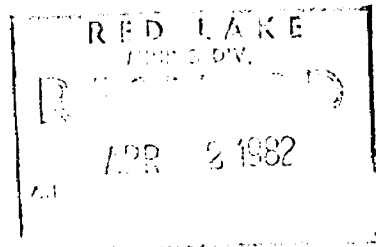

Date March 26, 1982

Signature of Recorded Holder or Agent

The Mining Act Certificate Verifying Report of Work

I, Denis BRAY

87 Smith Street - Thetford Mines, Province of Quebec G6G 3M3 (Post Office Address)

hereby certify:

- 1. That I have a personal and intimate knowledge of the facts set forth in the report of work annexed hereto, having performed the work or witnessed same during and/or after its completion.
2. That the annexed report is true.

Dated March 26, 1982

Signature

THE PENALTY FOR MAKING A FALSE STATEMENT IN THIS REPORT AND/OR CERTIFICATE IS \$500. OR SIX MONTHS IMPRISONMENT OR BOTH

KRL 526522

REQUIRED INFORMATION

Expenses for laboratory assays on samples from the Shabumeni Lake Property.

<u>Lab. Report #</u>	<u># of Assays</u>	<u>Cost</u>
111-0971	32	\$289.05
A-11-538	9	\$ 64.80
111-1161	20	\$171.00
111-1487	2	\$ 17.10
111-1278	9	\$ 76.95
111-1881	4	\$ 34.20
111-1738	13	\$111.16
111-1989	12	\$102.60
111-2621	127	\$1,085.86
111-2128	157	\$1,329.08
J.W. Beck	20	\$180.00
	405	\$3,461.80

Assays, as a type of assessment work, is worth 1 day of work for each \$15 expended; therefore:-

$$\$3,461.80 / \$15.00 = 231 \text{ days}$$

Sample locations are shown on the two geology maps submitted in other assessment work (maps 2317-Ont-61a and 61c-1).

Lab reports and invoices are attached, in duplicate. Samples not pertaining to this property have been inked out on the lab report for the sake of clarity.

Denis Bray
Senior Exploration Geologist

MINOREX LIMITED



Ontario



52N07SE0038 2.4834 SHABUMENI LAKE

010

30 -- 02

Ministry of
Natural
Resources

Notification of recording
of assessment work credits

RECEIVED

JAN - 4 1983

MINING LANDS SECTION

Lands Administration Branch
Mining Lands Section
Ministry of Natural Resources
Room 1617, Whitney Block
Queen's Park, Toronto
M7A 1W3

Date of recording of work: April 2, 1982
Recorded holder: Minorex Limited
Address: P.O. Box 7, Thetford Mines, P.Q. G6G 5R9
Township or Area: M-2665 Shabumeni Lake

Type of survey and number of Assessment days credit per claim	Mining claims
Geophysical	KRL. 560857 - 29 days
Electromagnetic _____ days	" 560858 - 21 days
Magnetometer _____ days	" 560859 - 20 days
Radiometric _____ days	" 526522 - 36 days
Induced polarization _____ days	" 526526 - 27 days
	" 526527 - 14 days
	" 526528 - 60 days
	" 541163 - 24 days
Section 86 (18) <u>Total Days 231</u> _____ days	
Geological _____ days	
Geochemical _____ days	
Man days <input type="checkbox"/>	Airborne <input type="checkbox"/>
Special provision <input checked="" type="checkbox"/>	Ground <input type="checkbox"/>

Notice to recorded holder:

- Survey reports and maps in duplicate be submitted to the Lands Administration Branch, Toronto within 60 days from the date of recording of this work.
- Reports and maps are being forwarded to the Lands Administration Branch with this letter.

Mining recorder

c.c. Minorex Limited
P.O. Box 7
Thetford Mines, P.Q.

MINOREX LIMITED

F.W.M.

(WHOLLY OWNED SUBSIDIARY OF ASBESTOS CORPORATION LIMITED)

P.O. BOX 7
THETFORD MINES, QUE.
CANADA
G6G 5R9

Thetford-Mines, Que.
March 29, 1982

RECEIVED

APR 14 1982

Ministry of Natural Resources
P.O. Box 324
Red Lake, Ontario
P0V 2M0

MINING LANDS SECTION

ATT: Mr. Scott Rivett - Mining Recorder

Dear Sir:

Enclosed are reports of work for three (3) properties held by Minorex Limited in the Red Lake Mining Division.

These properties are:-

(1) SHABUMENI LAKE PROPERTY (Claim map M-2665)

Claims #: KRL560850 to 858 incl. ✓
KRL560522, KRL560524 to 529 incl.
KRL541162 to 164 incl. ✓
KRL563597 to 599 incl. ✓
526524 - 527 incl. , 526522.

to which three reports of work are filed in for work credits:-

- (a) Channel sampling and manual stripping
- (b) ~~Assays~~ → TORONTO
- (c) ~~Geological mapping (reports and maps are sent to your Toronto office)~~

...../2

RED LAKE
MINING DIV.
RECEIVED
APR 2 1982
A.M.
7|8|9|10|11|12

2.467
2.467

1

To: Mr. Scott Rivett
March 29, 1982
Page 2

(2) PARA CREEK PROPERTY (Fairlie Township)

Claims #: KRL526153 ✓
KRL526158 to 160 incl. ✓
KRL526163 ✓
KRL526166 ✓
KRL526169 and 170 ✓
KRL560830 ✓
KRL526174

to which one report of work is filed in for work credits:-

(a) Diamond Drilling

(3) WOMAN LAKE PROPERTY (Goodall Township)

Claims #: KRL509730 to 739 incl. ✓
KRL526681 to 687 incl. ✓
KRL540813 to 818 incl.
KRL541219 to 239 incl.
KRL541241 and 242
KRL541244 to 255 incl.

to which two reports of work are filed in for work credits:-

(a) VLF Electromagnetic survey (reports and maps are sent to your Toronto Office)
(b) Diamond drilling

I hope that everything will be to your entire satisfaction.

Yours truly,



Denis Bray

Senior Exploration Geologist

RED CLARK	MINOREX LIMITED
RECEIVED	
APR 2 1982	
A.M.	P.M.
7	8 9 10 11 12 1 2 3 4 5 6

DB/lt
Encls

A

REQUIRED INFORMATION

Expenses for laboratory assays on samples from the Shabumeni Lake Property.

<u>Lab. Report #</u>	<u># of Assays</u>	<u>Cost</u>
111-0971	32	\$289.05
A-11-538	9	\$ 64.80
111-1161	20	\$171.00
111-1487	2	\$ 17.10
111-1278	9	\$ 76.95
111-1881	4	\$ 34.20
111-1738	13	\$111.16
111-1989	12	\$102.60
111-2621	127	\$1,085.86
111-2128	157	\$1,329.08
J.W. Beck	20	\$180.00
	<u>405</u>	<u>\$3,461.80</u>

Assays, as a type of assessment work, is worth 1 day of work for each \$15 expended; therefore:-

$$\$3,461.80 / \$15.00 = 231 \text{ days}$$

Sample locations are shown on the two geology maps submitted in other assessment work (maps 2317-Ont-61a and 61c-1).

Lab reports and invoices are attached, in duplicate. Samples not pertaining to this property have been inked out on the lab report for the sake of clarity.

RECEIVED

APR 14 1982

MINING LANDS SECTION

Denis Bray
Senior Exploration Geologist

MINOREX LIMITED

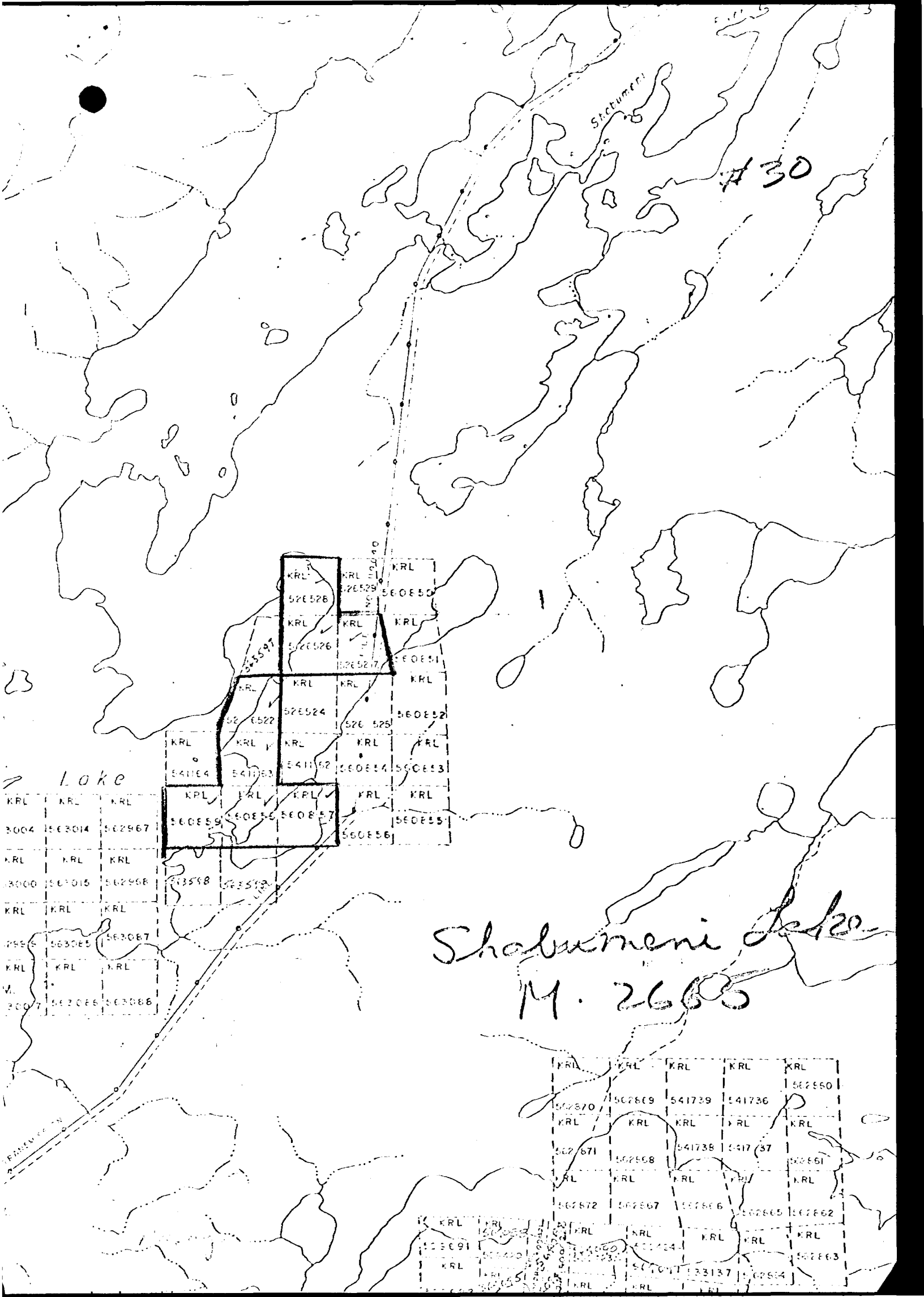

SACUMENI

#30

Lake

Shabumeni Lake
M. 2665

KRL	KRL	KRL
5004	563014	562967
KRL	KRL	KRL
5000	563015	562968
KRL	KRL	KRL
5595	563065	563087
KRL	KRL	KRL
5007	562065	563086

KRL	KRL	KRL
52E528	52E529	560E50
KRL	KRL	KRL
52E526	52E527	560E51
KRL	KRL	KRL
52E522	52E524	560E52
KRL	KRL	KRL
5411E4	5411E3	5411E2
KRL	KRL	KRL
560E59	560E56	560E57
KRL	KRL	KRL
560E55	560E56	

KRL	KRL	KRL	KRL	KRL
562E70	562E69	541739	541736	562E50
KRL	KRL	KRL	KRL	KRL
562E71	562E68	541738	541737	562E51
KRL	KRL	KRL	KRL	KRL
562E72	562E67	562E66	562E65	562E62
KRL	KRL	KRL	KRL	KRL
560E91	560E90	560E89	560E88	560E83
KRL	KRL	KRL	KRL	KRL
560E85	560E84	560E83	560E82	560E81
KRL	KRL	KRL	KRL	KRL
560E80	560E79	560E78	560E77	560E76



BONDAR-CLEGG & COMPANY LTD.

764 BELFAST ROAD, OTTAWA, ONTARIO, K1G 0Z5 PHONE: (613) 237-3110 TELEX: 053-4455

Geochemical Lab Report

REPORT: 111-0971

PAGE 1

SAMPLE NUMBER	ELEMENT UNITS	As PPM	Au PPB	wt/Au GM	<u>SAMPLE LOCATION</u> NOTES	SAMPLE NUMBER	ELEMENT UNITS	As PPM	Au PPB	wt/Au GM	<u>SAMPLE LOCATION</u> NOTES
SLT-1	(.16)	5.5	2705	(.08)	<u>GRID COORDINATE</u> 0+05E - 9+15 W	SL-27	(.45)	15.5	11840	(.35)	<u>GRID COORDINATE</u> 0+40E - 8+50 W
SL-1		ND	30		6+20E - 12+30 W	SL-28	(.04)	1.5	8340	(.24)	0+20N - 8+25 W
SL-2		0.8	ND		" "						
SL-3		ND	30		10+40E - 11+80 W						
SL-4		ND	ND		" "						
SL-5		ND	ND		6+40E - 10+30 W						
SL-6		ND	ND		6+60E - 9+40 W						
SL-7		ND	ND		6+60E - 9+40 W						
SL-8		ND	ND		6+60E - 9+40 W						
SL-9		0.3	95		8+70E - 3+85 W						
SL-10		ND	ND								
SL-11		0.5	395		9+90E - 4+80 W						
SL-11A		ND	10		" "						
SL-12		ND	ND		9+90E - 4+90 W						
SL-13		1.4	310		10+45E - 4+95 W						
SL-14		0.4	10		15+70E - 3+30 W						
SL-15		ND	ND		12+10E - 5+15 W						
SL-16		0.8	595		13+50E - 12+10 W						
SL-17	(.14)	4.9	2580	(.08)	15+20E - 11+00 W						
SL-18	(.12)	4.0	1605	(.05)	15+85E - 10+90 W						
SL-19		1.5	195		15+70E - 11+00 W						
SL-20		ND	ND		13+70E - 12+20 W						
SL-21		ND	70		13+35E - 12+15 W						
SL-22		0.4	155		13+70E - 11+65 W						
SL-23A	(.76)	26.0	>15000	(7.44)	7+30E - 1+85 W						
SL-23B	(.25)	8.6	6040	(.18)	7+50E - 1+90 W						
SL-23C	(.11)	3.6	2870	(.08)	7+60E - 1+90 W						
SL-24	(.15)	5.2	3730	(.11)	7+65E - 2+70 W						
SL-25		0.5	35		1+05N - 12+45 W						
					8+60E - 8+85 W						

46.0-47.5	G-80-2
75.4-77.5	G-80-2
94.0-95.4	G-80-2
96.7-97.9	G-80-2
105.6-107.6	G-80-2
108.7-109.8	G-80-2
119.0-120.2	G-80-2
125.0-127.0	G-80-2
138.1-139.8	G-80-2
150.3-152.3	G-80-2
66.2-67.8	G-80-3
74.5-76.7	G-80-3
21.0-23.0	G-80-4
25.5-27.0	G-80-4
51.7-53.0	G-80-4
53.0-55.0	G-80-4
71.1-72.0	G-80-4
73.3-74.5	G-80-4
74.5-76.0	G-80-4
105.0-107.0	G-80-12
107.0-109.0	G-80-12
109.0-111.2	G-80-12



BONDA R-CLEGG & CO. INC.

J.

764 BELFAST ROAD, OTTAWA, ONTARIO, K1G 0Z5 PHONE: 237-3110 TELEX: 053-4455

Minorex Limited
c/o Mr. Denis Bray
P.O. Box 7
Thetford Mines, Quebec
G6G 5R9

INVOICE: **E 8043**
DATE: July 10, 1981
REPORT NO: 111-9971
PROJECT:

115	Analyses of Gold	@ \$5.25	\$603.75
115	Analyses of Silver	@ 1.75	201.25
115	Sample Preparation	@ 2.50	<u>287.50</u>
		<u>9.50</u>	1,092.50
	Less 10% Contract Discount		<u>109.25</u>
			983.25
	Shipping Charge		<u>6.90</u>
		Total	<u><u>\$990.15</u></u>

Shabumeni (32) 282.15 + 6.90 = 289.05
 Womani (63) 538.65
 Altava (Para) (19) 162.45

dr

Wm

THIS IS A PROFESSIONAL SERVICE
ACCOUNTS DUE WHEN RENDERED



BONDAR-CLEGG & COMPANY LTD.

764 BELFAST ROAD, OTTAWA, ONTARIO, K1G 0Z5

PHONE: 237-3110

Handwritten notes:
2211
A-11-538

Certificate of Analysis

TO Minorex Limited
P.O. Box 7
Thetford Mines, Quebec

REPORT NO. A-11-538
 DATE July 15, 1981

I hereby certify that the following are the results of analyses made by us upon the herein described pulp samples

MARKED	oz/ton	SAMPLE LOCATION	MARKED	oz/ton	SAMPLE LOCATION
	Au	GRID COORDINATE		Au	GRID COORDINATE
[REDACTED]	[REDACTED]	.09 .11 .06 .12 .01	SL-11	0.030	9+90S - 4+80W.
ST-L-1	0.080	0+05N - 9+65W			
SL-17	0.070	15+20S - 11+10W			
SL-23-A	0.73	7+30S - 1+85W			
SL-23-B	0.35	7+50S - 1+90W			
SL-23-C	0.080	7+60S - 1+90W			
SL-24	0.100	7+65S - 2+70W			
SL-27	0.33	0+40S - 8+50W			
SL-28	0.050	0+20S - 8+25W			

BONDAR-CLEGG & COMPANY LTD.

NOTE:

Rejects retained two weeks
 Pulps retained three months
 unless otherwise arranged.

Handwritten signature: M. C. Clegg



BONDAR-CLEGG & CO COMPANY LTD.

764 BELFAST ROAD, OTTAWA, ONTARIO, K1G 0Z5 PHONE: 237-3110 TELEX: 053-4455

Minorex Limited
P.O. Box 7
Thetford Mines, Quebec
G6G 5K9

Attention: Mr. Denis Bray

INVOICE: **E 8099**
DATE: **July 15, 1981**
REPORT NO: **A-11-538**
PROJECT:

17	Analyses of Gold	@ \$8.00	\$136.00
	Less 10% Contract Discount		<u>13.60</u>
		Total	<u><u>\$122.40</u></u>

<i>Womas (6)</i>	<i>43.20</i>
<i>Pera-Attura (2)</i>	<i>14.40</i>
<i>Shabumeni (9)</i>	<u><i>64.80</i></u>

dr



Geochemical Lab Report

REPORT: 111-1161

PAGE 1

Page 1 of 2
237.10

SAMPLE NUMBER	ELEMENT UNITS	As PPM	Au PPB	wt/Au GM	NOTES
W-202		[REDACTED]	[REDACTED]		
W-203		[REDACTED]	[REDACTED]		
W-204		[REDACTED]	[REDACTED]		
W-205		[REDACTED]	[REDACTED]		
W-206		[REDACTED]	[REDACTED]		
W-208		[REDACTED] (.04)	[REDACTED] (.03)		
SL-41		ND	ND	4+30N 13+65W	
SL-42		ND	30	" "	
SL-43		ND	45	5+25N 13+60W	
SL-44		ND	ND	5+20N 13+20W	
SL-45		ND	ND	5+40N 14+65W	
SL-46		ND	5	5+60N 11+80W	
SL-47		1.0	320	" "	
SL-48		0.4	20	8+00N 5+20W	
SL-49		0.3	25	8+40N 5+20W	
SL-50		1.2	560	8+65N 5+20W	
SL-51		ND	ND	8+75N 5+20W	
SL-52		4.0	1710	" "	
SL-53		0.6	100	9+10N 5+30W	
SL-54		5.2	3110	" "	
SL-55		0.4	85	9+35N 5+30W	
SL-56		36.0	>15000	" "	
SL-57		17.0	12200	9+65N 5+15W	
SL-58		3.8	1615	9+60N 5+10W	
SL-59		5.8	4335	9+30N 5+10W	
SL-60		1.0	520	7+50N 4+70W	

SAMPLE LOCATION
GRID COORDINATE.

MB 12
" 13

[REDACTED] NO
[REDACTED] NO

[REDACTED] 25
[REDACTED] 10



BONDAR-CLEGG & CO COMPANY LTD.

764 BELFAST ROAD, OTTAWA, ONTARIO, K1G 0Z5 PHONE: 237-3110 TELEX: 053-4455

INVOICE: **E 8216**

DATE: July 20, 1981

REPORT NO: 111-1161

PROJECT:

Mr. Denis Bray
Minorex Limited
P.O. Box 7
Thetford Mines, Quebec
G6G 5R9

28	Analyses of Gold	@ \$5.25	<u>\$147.00</u>
		10%	- 14.70
			<u>\$132.30</u>

<i>Weman (6)</i>	<i>28.35</i>
<i>Shabuneri (20)</i>	<i>94.50</i>
<i>Martin Bay (2)</i>	<u><i>9.45</i></u>

dr

Wm



BONDAR-CLEGG & CO COMPANY LTD.

4 BELFAST ROAD, OTTAWA, ONTARIO, K1G 0Z5 PHONE: 237-3110 TELEX: 053-4455

INVOICE: **E 8105**

DATE: **July 15, 1981**

REPORT NO: **111-1161**

PROJECT:

**Minorex Limited
c/o Mr. Denis Bray
P.O. Box 7
Thetford Mines, Quebec
G6G 1R9**

28	Analyses of Silver	@ \$1.75	\$49.00
28	Sample Preparation	@ 2.50	<u>70.00</u>
		<u>4.25</u>	119.00
	Less 10% Contract Discount		<u>11.90</u>
		Total	<u><u>\$107.10</u></u>

Wemas (6) 22.95
Shabumeni (20) 76.50
Martin Bay (2) 7.65

dr

Wm

**THIS IS A PROFESSIONAL SERVICE
ACCOUNTS DUE WHEN RENDERED**



Geochemical Lab Report

REPORT: 111-1487

PAGE 1

SAMPLE NUMBER	ELEMENT UNITS	As PPM	Au PPB	wt/Au GM	NOTES	SAMPLE NUMBER	ELEMENT UNITS	As PPM	Au PPB	wt/Au GM	NOTES
SL-3038		0.4	310	13+00N 3+40W		2225		.2		85	
SL-3039		0.3	5	13+40N 3+10W		26		1.0		600	
01	G-91-6	20-27.4	420			3105	G-91-10	44.4-45.9 (1.01)		85	
02	"	61.5-63.5	15			3106	"	119.8-120.0 (1.03)		5000?	
03	"	66.9-67.6	10			3107		1.4		80	
04	"	80.7-81.7	5					2		15	
05	"	121.8-122.8	5			08		.1		15	
06	G-91-6	127-130.7	1800			09		.2		85	
07	"	133.2-134.2	230			10		.2		5	
08	"	136.5-140.0	5			11		.1		15	
09	"	140-143.1	5			12		NO		5	
10	"	146.6-150.0	5			13		NO		5	
11	"	150.-153	5			14		.2		10	
12	"	154.5-155.1	5			15		NO		5	
13	G-91-7	21.4-22.8	NO			16		.2		235	
14	"	24.0-26.1	10			17		NO		5	
15	"	37.3-37.6	10			18		NO		75	
16	"	38.4-39.0	5			19		.1		5	
17	"	43.8-44.2	5			3120		.3		5	
18	"	57.7-58.2	NO								
19	"	61.3-62.9	10								
20	"	79.7-80.4	10								
21	"	90.1-91.1	10								
22	"	92.7-93.7	10								
23	"	135.5-136.5	5								
24	G-91-10	43.5-44.5	10								

SAMPLE LOCATION
GRID COORDINATE



BONDAR-CLEGG & CO. COMPANY LTD.

4 BELFAST ROAD, OTTAWA, ONTARIO, K1G 0Z5 PHONE: 237-3110 TELEX: 053-4455

Minorex Limited
c/o Mr. Denis Bray
P.O. Box 7
Thetford Mines, Quebec
G6G 5R9

INVOICE: E 8378

DATE: August 5, 1981

REPORT NO: 111-1487

PROJECT:

48	Analyses of Silver	@ \$1.75	\$84.00
	Less 10% Contract Discount		<u>8.40</u>
		Total	<u><u>\$75.60</u></u>

Para - Alteral (1) 6.30 -
Shabumeni (2) 3.15
Womers. (12) 66.15

dr

BONDAR-CLEGG & COMPANY LTD.

764 BELFAST ROAD, OTTAWA, ONTARIO, K1G 0Z5 PHONE: 237-3110 TELEX: 053-3548

Minorex Limited
 c/o Mr. Denis Bray
 P.O. Box 7
 Thetford Mines, Quebec
 G6G 5R9

INVOICE: **C 9840**
 DATE: **July 29, 1981**
 REPORT NO: **111-1487**
 PROJECT:

48	Analyses of Gold	@ \$5.25	\$252.00
48	Sample Preparation	@ 2.50	<u>120.00</u>
		<u>7.75</u>	
		Total	<u>\$372.00</u>

107, - 37.20
334.80

Paw Altman (4) 27.90⁴
Shakumeni (2) 13.95
Women (42) 292.95

dr

Wm



Geochemical Lab Report

REPORT: 111-1278

PAGE 1

SAMPLE NUMBER	ELEMENT UNITS	As PPM	AU PPB	wt/AU GM	NOTES
SL-3029		2.0	1050	(.06, .03)	SAMPLE LOCATION GRID COORDINATE 12+15N 4+10W
SL-3030		ND	10	(Nil, Tr)	0+95E 6+70E
SL-3031		4.9	5000	(.14, .14)	8+75E 0+90W
-3032		ND	15	(Nil, Tr)	11+35E 1+70W
SL-3033		2.8	11750	(.08, .34)	8+15E 1+10W
SL-3034		ND	15	(Nil, Tr)	" "
SL-3035		0.6	100	(.02, .003)	8+30E 1+20W
SL-3036		1.0	550	(.03, .02)	10+70E 1+50W
SL-3037		ND	40	(Nil, Tr)	12+15E 0+30E

 m3 14
 15
 16
 17
 AC 24
 ND
 ND
 15
 10
 10



BONDAR-CLEGG & COMPANY LTD.

764 BELFAST ROAD, OTTAWA, ONTARIO, K1G 0Z5 PHONE: 237-3110 TELEX: 053-3548

Minorex Limited
c/o Mr. Denis Bray
P.O. Box 7
Thetford Mines, Quebec
G6G 5R9

INVOICE: **C 9854**
DATE: **July 29, 1981**
REPORT NO: **111-1278**
PROJECT:

14 ✓	Analyses of Silver	@ \$1.75	\$24.50
14	Analyses of Gold	@ 5.25	73.50
14	Sample Preparation	@ <u>2.50</u>	<u>35.00</u>
		9.50	
			<u>Total \$133.00</u>

Analysis 10%

Toll

13.30

119.70

<i>Shubmeni (9)</i>	<i>76.95</i>
<i>Martin Bay (4)</i>	<i>34.20</i>
<i>Para-Altura (1)</i>	<u><i>8.55</i></u>

dr

Wm



Geochemical Lab Report

REPORT: 111-1881

PAGE 1

SAMPLE NUMBER	ELEMENT UNITS	As PPM	Au PPB	wt/Au GM	NOTES
---------------	---------------	--------	--------	----------	-------

TT-1	H2227 2028	ND	10		
[REDACTED]	Q.O. 4 - 16S	ND	ND	ND	
"	44E - 200A	ND	ND	ND	
[REDACTED]	AL27	ND	ND	ND	
SL-3053		2.1	1200	(.040 ₂ /1)	

SAMPLE LOCATION (GRID COORDINATE)

8+75N 5+20W
 12+70S 28+00E
 8+50N 15+40W

SL-3054		ND	75		
SL-3055		0.4	10		
[REDACTED]	PA 2001	ND	ND	ND	
[REDACTED]	2002	ND	ND	ND	
[REDACTED]	2003	ND	ND	ND	
[REDACTED]	2004	ND	ND	ND	
[REDACTED]	2005	ND	ND	ND	



BON J & CLEGG & COMPANY LTD.

4 BELFAST ROAD, OTTAWA, ONTARIO, K1G 0Z5 PHONE: 237-3110 TELEX: 053-4455

Minorex Limited
c/o Mr. Denis Bray
P.O. Box 7
Thetford Mines, Quebec
G6G 5R9

INVOICE: **E 9022**
DATE: **September 3, 1981**
REPORT NO: **111-1881**
PROJECT:

12	Analyses of Silver	@ \$1.75	\$21.00
12	Sample Preparation	@ 2.50	<u>30.00</u>
			51.00
	Less 10% Contract Discount		<u>5.10</u>
		Total	<u><u>\$45.90</u></u>

	<i>Alterra (Para C.)</i>	<i>6</i>	<i>22.95</i>
<i>Cape</i>	<i>Hammell</i>	<i>2</i>	<i>7.65</i>
	<i>Shabuneri</i>	<i>4</i>	<u><i>15.30</i></u>

dr

Wm

THIS IS A PROFESSIONAL SERVICE
ACCOUNTS DUE WHEN RENDERED



BONDAR-CLEGG & COMPANY LTD.

BELFAST ROAD, OTTAWA, ONTARIO, K1G 0Z5 PHONE: 237-3110 TELEX: 053-4455

INVOICE: E 9248

DATE: September 14, 1981

REPORT NO: 111-1881

PROJECT:

Minorex Limited,
c/o Mr. Denis Bray,
P.O. Box 7,
Thetford Mines, Quebec.
G6G 5R9

12 ✓	Analyses of Gold	@ \$5.25	\$63.00
	Less 10% Contract Discount		<u>6.30</u>

	TOTAL	<u><u>\$56.70</u></u>
--	-------	-----------------------

Hammill L (2)	9.45
Para-Altura (6)	28.35
Shabuneni (4)	<u>18.90</u>

THIS IS A PROFESSIONAL SERVICE
ACCOUNTS DUE WHEN RENDERED



Geochemical Lab Report

REPORT: 111-1738

PAGE 1

SAMPLE NUMBER	ELEMENT UNITS	As PPM	Au PPB	wt/Au GM	NOTES
AL 26 NP-5 NP-6 NP-7	5.6 NA NA NA			15000 5 25 5	SAMPLE LOCATION GRID LOCATION
S.L.-3040		0.4	150	(.004 g/T)	14+00E 1+40W
S.L.-3041		0.4	185	(.005 g/T)	" "
S.L.-3042		0.2	120		" "
S.L.-3043	(.46 g/T)	5.7	7750	(.23 g/T)	13+20E 2+30W
S.L.-3044		0.4	135	(.004 g/T)	" "
S.L.-3045	(.19 g/T)	6.4	2735	(.08 g/T)	" "
S.L.-3046		ND	ND		13+50E 2+00E
S.L.-3047		2.4	80		18+00E 2+60W
S.L.-3048	(.88 g/T)	30.2	6750	(.20 g/T)	20+00E 2+00E
S.L.-3049		0.2	5		19+95E - 16+15W
S.L.-3050		1.2	5		22+15E 6+35W
S.L.-3051		1.5	235	(.007 g/T)	4+70E 10+65W
S.L.-3052	(.09 g/T)	3.1	1500	(.04 g/T)	13+45E 12+15W



BONDAR-CLEGG & CO. COMPANY LTD.

4 BELFAST ROAD, OTTAWA, ONTARIO, K1G 0Z5 PHONE: 237-3110 TELEX: 053-4455

INVOICE: E 19253

DATE: September 14, 1981

REPORT NO: 111-1738

PROJECT:

Minorex Limited,
c/O Mr. Denis Bray,
P.O. Box 7,
Thetford Mines, Quebec.
G6G 5R9

17	Analyses of Gold	@ \$5.25	\$89.25
	Less 10% Contract Discount		<u>8.92</u>
		TOTAL	<u><u>\$80.33</u></u>

Para - Altera (4) 18.90
Shubumeni (13) 61.43

THIS IS A PROFESSIONAL SERVICE
ACCOUNTS DUE WHEN RENDERED



BOND R-CLEGG & COMPANY LTD.

64 BELFAST ROAD, OTTAWA, ONTARIO, K1G 0Z5 PHONE: 237-3110 TELEX: 053-4455

Minorex Limited
c/o Mr. Denis Bray
P.O. Box 7
Thetford Mines, Quebec
G6G 5R9

INVOICE: **E 78716**
DATE: August 19, 1981
REPORT NO: 111-1738
PROJECT:

17	Analyses of Silver	@ \$1.75	\$29.75
17	Sample Preparation	@ 2.50	<u>42.50</u>
			72.25
	Less 10% Contract Discount		<u>7.22</u>
		Total	<u><u>\$65.03</u></u>

Para - Altera (4) 15.30
Shabumeni (13) 49.72

dr



Geochemical Lab Report

REPORT: 111-1989

PAGE 1

SAMPLE NUMBER	ELEMENT UNITS	Ag PPM	Au PPB	wt/Au GM	SAMPLE LOCATION GRID COORDINATE	NOTES
SL-3056		ND	ND		Area (log 16) 41505 81500	Au: Ag
SL-3057		ND	125	.003	" "	
SL-3058	Ag 90/6	ND	5		" "	
SL-3059	.15	5.1	2400	.07	" "	1 : 2.14
SL-3060	.13	4.3	2100	.06	" "	1 : 2.2
SL-3061		ND	5		" "	
SL-3062	.25	8.5	5500	.16	" "	1 : 1.56
SL-3063	.04	1.4	700	.02	" "	1 : 2.05
SL-3064	.035	1.2	500	.015	" "	1 : 2.33
SL-3065		0.6	ND		" "	
SL-3066	.06	2.0	700	.02	" "	1 : 2.9
SL-3067	.17	5.8	2900	.08	" "	1 : 2.0



BONDAR-CLEGG & CO. COMPANY LTD.

764 BELFAST ROAD, OTTAWA, ONTARIO, K1G 0Z5 PHONE: 237-3110 TELEX: 053-4455

Minorex Limited
c/o Mr. Denis Bray
P.O. Box 7
Thetford Mines, Quebec
G6G 5R9

INVOICE: E 19533
DATE: September 24, 1981
REPORT NO: 111-1989
PROJECT:

12	Analyses of Silver m	@ \$1.75	\$21.00
12	Analyses of Gold	@ 5.25	63.00
12	Sample Preparation	@ 2.50	<u>30.00</u>
		Sub-Total	114.00
		Less 10% Contract Discount	<u>11.40</u>
		Total	<u>\$102.60</u>

Shabunish

dr

Wm
THIS IS A PROFESSIONAL SERVICE
ACCOUNTS DUE WHEN RENDERED



Geochemical Lab Report

PAGE 1

SAMPLE NUMBER	ELEMENT UNITS	AS PPM	AU PPS	WT/AU GM	NOTES	SAMPLE NUMBER	ELEMENT UNITS	AS PPM	AU PPS	WT/AU GM	NOTES
SL-2401	.02	0.6	320	(.009)	MAIN VEIN ↓	SL-2431		ND	25	(.005)	MAIN VEIN
SL-2402	.05	1.7	805	(.025)		SL-2432		ND	45	(.005)	
SL-2403	.06	2.0	445	(.013)		SL-2433	.02	0.6	170	(.005)	
SL-2404		ND	15			SL-2434	.01	0.4	155	(.005)	
SL-2405		ND	45			SL-2435		ND	5		
SL-2406	.01	0.6	145	(.004)		SL-2436	.04	1.6	515	(.015)	
SL-2407	.46	15.6	6500	(.190)		SL-2437	.02	0.8	215	(.006)	
SL-2408	.23	8.0	3450	(.101)		SL-2438		ND	15		
SL-2409	.02	0.8	285	(.008)		SL-2439	.35	12.0	5250	(.154)	
SL-2410	.51	17.6	5750	(.169)		SL-2440	.02	0.8	315	(.009)	
SL-2411	.15	5.0	1445	(.042)		SL-2441	.02	0.6	130	(.004)	
SL-2412	.20	6.8	2600	(.076)		SL-2442	.11	3.8	1300	(.038)	
SL-2413	.13	4.4	1800	(.053)		SL-2443		ND	15		
SL-2414	.19	6.4	2600	(.076)		SL-2444		ND	25		
SL-2415	.04	1.6	405	(.018)		SL-2445		0.5	175	(.005)	
SL-2416	.18	6.2	1900	(.056)		SL-2446		ND	10		
SL-2417	.15	5.0	1650	(.048)		SL-2447	.10	3.5	1950	(.057)	
SL-2418		ND	15			SL-2448		ND	15		
SL-2419		0.2	30			SL-2449		ND	5		
SL-2420	.06	2.2	995	(.029)		SL-2450	.22	7.6	2850	(.083)	
SL-2421	.03	0.9	285	(.009)	SL-2451	.23	7.8	2400	(.070)		
SL-2422		0.2	205	(.006)	SL-2452		0.2	55			
SL-2423	.02	0.6	50		SL-2453	.04	1.3	435	(.013)		
SL-2424		ND	15		SL-2454		ND	5			
SL-2425	.03	0.9	270	(.008)	SL-2455	.06	2.2	1145	(.033)		
SL-2426		ND	ND		SL-2456	.12	4.0	1950	(.057)		
SL-2427		ND	25		SL-2457	.23	7.8	2950	(.089)		
SL-2428		ND	65		SL-2458		ND	50			
SL-2429		ND	205	(.006)	SL-2459	.02	0.6	230	(.007)		
SL-2430	.27	9.3	5000	(.146)	SL-2460	.08	2.7	845	(.025)		



Geochemical Lab Report

111-2621

PAGE 2

SAMPLE NUMBER	ELEMENT UNITS	Ag PPM	Au PPS	wt/Au GM	NOTES	SAMPLE NUMBER	ELEMENT UNITS	Ag PPM	Au PPS	wt/Au GM	NOTES
SL-2461	.23	7.8	2400	(.070)	MAIN VEIN	SL-2491		3.2	1850	(.054)	MAIN VEIN
SL-2462		0.4	40	(.016)		SL-2492	72.92	>0100.0	>15000	(+.43)	
SL-2463		1.4	545			SL-2493	.42	14.5	13750	(.402)	
SL-2464	.12	4.2	1700	(0.05)		SL-2494	.80	27.5	>15000	(+.43)	
SL-2465	.25	8.6	2500	(0.073)		SL-2495		2.6	1250	(.037)	
SL-2466		0.4	75			SL-2496	.15	5.0	1400	(.041)	
SL-2467		0.6	180	(.055)		SL-2497	.25	8.6	6000	(.175)	
SL-2468		2.1	1400	(.041)		SL-2498	.12	4.0	2150	(.063)	
SL-2469		0.4	75			SL-2499		0.4	185	(.005)	
SL-2470		0.4	125	(.003)		SL-2500	.53	18.0	11750	(.344)	
SL-2471		0.4	150	(.004)		SL-2501	.58	20.0	11000	(.322)	
SL-2472		ND	15			SL-2502	.32	11.0	6000	(.175)	
SL-2473		0.3	20			SL-2503	.14	4.8	2050	.06	
SL-2474		1.2	1100	(.032)		SL-2504		2.6	715	.021	
SL-2475		1.8	1250	(0.37)		SL-2505		0.5	235	.007	
SL-2476		0.4	110	(.003)		SL-2506	.16	5.6	2400	.070	
SL-2477		0.2	35			SL-2507		0.2	305	.009	
SL-2478	.16	5.4	2720	(.08)		SL-2508		ND	65		
SL-2479		1.1	1100	(.032)		SL-2509		ND	30		
SL-2480		ND	15			SL-2510		2.6	1100	0.032	
SL-2481		2.8	1650	(.048)	SL-2511		1.8	495	.014		
SL-2482		0.4	115	(.003)	SL-2512		ND	25			
SL-2483		ND	50		SL-2513		ND	30			
SL-2484		0.6	190	(.006)	SL-2514		2.8	1650	.048		
SL-2485		ND	5		SL-2515		1.4	525	.015		
SL-2486		ND	10		SL-2516	.13	0.6	165	.005		
SL-2487		0.8	495	(.014)	SL-2517		4.4	2500	.073		
SL-2488		ND	10		SL-2518	.14	4.7	2400	.070		
SL-2489		ND	15		SL-2519	.13	4.4	1750	.051		
SL-2490	.22	7.4	5900	(0.173)	SL-2520	.03	1.0	445	.013		



Geochemical Lab Report

111-2621

PAGE 3

ANALYSIS NUMBER	ELEMENT UNITS	AG PPM	AU PPS	WT/AU GM	NOTES
SL-2521		1.5	645	.019	<i>Main Vein</i> ↓
SL-2522		1.5	805	.023	
SL-2523		1.1	610	.618	
SL-2524		0.1	25		
SL-2525		0.5	135	.004	
SL-2526		1.1	365	.011	
SL-2527		2.0	1000	.029	



BONDAR-CLEGG & CO. COMPANY LTD.

64 BELFAST ROAD, OTTAWA, ONTARIO, K1G 0Z5 PHONE: 237-3110 TELEX: 053-4455

Minorex Limited
c/o Mr. Denis Bray
P.O. Box 7
Thetford Mines, Quebec
G6G 5R9

INVOICE: **F 11261**
DATE: November 4, 1981
REPORT NO: 111-2621
PROJECT:

127

Analyses of Gold

@\$5.25

\$666.75

~~600.08~~

1070

Shabuneri

PH

mk



BONDAF -CLEGG & COMPANY LTD.

64 BELFAST ROAD, OTTAWA, ONTARIO, K1G 0Z5 PHONE: 237-3110 TELEX: 053-4455

Minorex Limited
c/o Mr. Denis Bray
P.O. Box 7
Thetford Mines, Quebec
G6G 5R9

INVOICE: **E 10000**

DATE: October 21, 1981

REPORT NO: 111-2621

PROJECT:

127	Analyses of Silver	@ \$1.75	\$222.25
127	Sample Preparation	@ 2.50	<u>317.50</u>
			539.75
	Less 10% Contract Discount		<u>53.97</u>
		Total	<u><u>\$485.78</u></u>

Shubert

dr



Geochemical Lab Report

REPORT: 111-2128

PAGE 1

SAMPLE NUMBER	ELEMENT UNITS	Ag PPM	Au PPB	wt/Au GM	NOTES	SAMPLE NUMBER	ELEMENT UNITS	Ag PPM	Au PPB	wt/Au GM	NOTES
SL-2101		33.5	>15000	>.44	MAIN ZONE	SL-2131		15.2	11140	.3302/t.	MAIN ZONE
SL-2102		12.8	4495	.13		SL-2132		0.7	240	.01 "	
SL-2103		0.8	750	.02		SL-2133		3.9	1810	.05 "	
SL-2104		0.7	175	—		SL-2134		0.3	55	.062	
SL-2105		13.0	8140	.24		SL-2135		9.0	1740	.05 "	
SL-2106		17.0	>15000	>.44		SL-2136		0.7	200	.006 "	
SL-2107		1.3	600	.02		SL-2137		ND	10	—	
SL-2108		2.6	890	.03		SL-2138		2.4	1060	.03 "	
SL-2109		1.7	680	.02		SL-2139		ND	15	—	
SL-2110		4.1	1910	.06		SL-2140		0.7	110	.003 "	
SL-2111		1.4	460	.01		SL-2141		3.5	1590	.05 "	
SL-2112		4.3	12490	.37		SL-2142		0.3	10	—	
SL-2113		21.0	9740	.28		SL-2143		0.8	240	.007 "	
SL-2114		7.9	4490	.13		SL-2144		1.3	330	.010 "	
SL-2115		3.9	1540	.05		SL-2145		0.8	210	.006 "	
SL-2116		0.3	50	—		SL-2146		0.4	20	—	
SL-2117		3.2	1290	.04	SL-2147		6.2	2390	.07		
SL-2118		0.3	30	—	SL-2148		20.0	>15000	>.44		
SL-2119		8.0	7240	.21	SL-2149		1.0	360	.01		
SL-2120		0.4	85	—	SL-2150		29.0	>15000	>.44		
SL-2121		0.6	230	—	SL-2151		13.0	6490	.19		
SL-2122		1.0	590	.02	SL-2152		13.6	8740	.26		
SL-2123		1.6	690	.02	SL-2153		1.9	1090	.03		
SL-2124		1.8	940	.03	SL-2154		ND	30	—		
SL-2125		20.5	9740	.28	SL-2155		ND	10	—		
SL-2126		64.0	>15000	>.44	SL-2156		ND	5	—		
SL-2127		1.2	540	.02	SL-2157		ND	15	—		
SL-2128		18.0	7140	.21	SL-2158		ND	15	—		
SL-2129		9.0	7140	.21	SL-2159		0.7	230	.007		
SL-2130		3.8	2010	.06	SL-2160		1.0	230	.007		



Geochemical Lab Report

REPORT: 111-2128

PAGE 2

SAMPLE NUMBER	ELEMENT UNITS	As PPM	Au PPB	wt/Au GM oz/ton	NOTES	SAMPLE NUMBER	ELEMENT UNITS	As PPM	Au PPB	wt/Au GM oz/ton	NOTES
SL-2161		ND	15	—	MAIN ZONE	SL-2191		16.0	9495	0.280	MAIN ZONE
SL-2162		ND	30	—		SL-2192		11.0	6995	0.200	
SL-2163		ND	40	—		SL-2193		5.2	2295	0.070	
SL-2164		ND	5	—		SL-2194		23.0	>15000	> 0.440	
SL-2165		ND	30	—		SL-2195		7.3	4495	0.130	
SL-2166		20.0	>15000	>.44		SL-2196		4.9	3145	0.090	
SL-2167		13.6	4245	.12		SL-2197		60.0	>15000	>0.440	
SL-2168		19.9	12495	.37		SL-2198		3.5	1495	0.040	
SL-2169		12.0	14495	.42		SL-2199		1.4	515	0.020	
SL-2170		0.9	435	.01		SL-2200		0.3	115	0.003	
SL-2171		21.0	>15000	>.44		SL-2301		3.2	1215	0.04	
SL-2172		10.0	4495	.13		SL-2302		>0100.0	>15000	>0.44	
SL-2173		25.0	>15000	>.44		SL-2303		3.6	1715	0.05	
SL-2174		0.6	270	—		SL-2304		2.2	1095	0.03	
SL-2175		0.6	155	—		SL-2305		2.2	1115	0.03	
SL-2176		9.4	2995	.09		SL-2306		2.8	1045	0.03	
SL-2177		3.8	1715	.05		SL-2307		ND	40	—	
SL-2178		2.8	995	.03		SL-2308		0.5	85	—	
SL-2179		2.5	150	—	SL-2309		1.6	945	0.03		
SL-2180		ND	1450	.04	SL-2310		0.1	75	—		
SL-2181		ND	35	—	SL-2311		10.3	6495	0.19		
SL-2182		0.3	125	—	SL-2312		5.2	2895	0.08		
SL-2183		ND	45	—	SL-2313		1.4	545	0.02		
SL-2184		0.3	145	—	SL-2314		3.3	1525	0.04		
SL-2185		ND	25	—	SL-2315		0.7	265	0.01		
SL-2186		2.0	1455	.04	SL-2316		ND	30	—		
SL-2187		0.5	485	—	SL-2317		11.4	7245	0.21		
SL-2188		18.0	>15000	>.44	SL-2318		2.0	845	0.02		
SL-2189		0.6	465	.01	SL-2319		2.4	1295	0.04		
SL-2190		0.6	345	.01	SL-2320		6.2	2895	0.08		

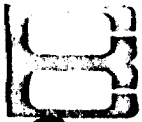

BOND, R-CLEGG & CO COMPANY LTD.

4 BELFAST ROAD, OTTAWA, ONTARIO, K1G 0Z5 PHONE: 237-3110 TELEX: 053-4455

Minorex Limited,
c/o Mr. Denis Bray,
P.O. Box 7,
Thetford Mines, Quebec.
G6G 5R9

INVOICE: F 77180

DATE: October 14, 1981

REPORT NO: 111-2128

PROJECT:

156 ✓	Analyses of Gold	@ \$5.25	\$819.00 ✓
	Less 10% Contract Discount		<u>81.90</u>
		TOTAL	<u><u>\$737.10 ✓</u></u>

Shabunee L. 155 x 5.25 = 732.38

Winnipeg Lake 1 x 5.25 = 4.72
737.10

10-



BONDAR-CLEGG & CO' 1PANY LTD.

4 BELFAST ROAD, OTTAWA, ONTARIO, K1G 0Z5 PHONE: 237-3110 TELEX: 053-4455

Minorex Limited
c/o Mr. Denis Bray
P/O. Box 7
Thetford Mines, Quebec
G6G 5R9

INVOICE: **E 09451**
DATE: **September 21, 1981**
REPORT NO: **111-2128**
PROJECT:

157	Analyses of Silver	@ \$1.75	\$274.75
157	Sample Preparation	@ 2.50	<u>392.50</u>
			667.25
	Less 10% Contract Discount		<u>66.72</u>
		Total	<u><u>\$600.53</u></u>

Shabunovich 596.70
W. mar L. 3.23

dr



Geochemical Lab Report

REPORT: 111-2128

PAGE 3

SAMPLE NUMBER	ELEMENT UNITS	Ag PPM	Au PFB	wt/Au GM	NOTES	SAMPLE NUMBER	ELEMENT UNITS	Ag PPM	Au PFB	wt/Au GM	NOTES	
SL-2321		16.5	8245	.24	MAIN ZONE ↓	SL-3094		32.5	2165	0.06	MAIN ZONE ↓	
SL-2322		3.1	1795	.05		SL-3095		2.0	350	0.01		
SL-2323		16.8	4745	.14		SL-3096		37.5	1950	0.06		
SL-2324		1.5	645	.02		SL-3097		2.9	550	0.02		
SL-3068						SL-3098		0.9	65	7		
SL-3069						SL-3099		5.5	2390	0.06		
SL-3070		26.0	1475	.04		SL-3100		0.3	20	-		
SL-3071		2.0	455	.01								
SL-3072		0.2	55	-								
SL-3073		ND	85	-								
SL-3074		0.8	590	.02								
SL-3075		0.3	40	-								
SL-3076		6.2	1850	.05								
SL-3077		2.6	110	-								
SL-3078		0.5	255	-								
SL-3079		0.3	130	-								
SL-3080		1.8	550	.02								
SL-3081		4.0	890	.02								
SL-3082		0.7	190	-								
SL-3083		ND	5	-								
SL-3084		5.6	550	.02								
SL-3085		0.3	10	-								
SL-3086		1.5	35	-								
SL-3087		3.6	1000	.03								
SL-3088		1.2	130	-								
SL-3089		2.8	6590	.19								
SL-3090		4.1	1590	.05								
SL-3091		0.6	20	-								
SL-3092		2.4	990	.03								
SL-3093		20.0	9790	.29								

COCHENOUR FIRE ASSAYING

Phone: Bus. 756-352
Res. 756-334

J.W. Beck, Assayer,
Box 43, Cochenour, Ont.

ASSAY CERTIFICATE

Date: June 18-81

"Assaying over 30 Years"



Sample No.	To Minorex Ltd, Box 1111, Red Lake, Ont. Description	oz/ton Au	oz/ton Ag
SL 16-A	Chip samples. Shalumeni Lake. 13+50 ϕ - 12+10W	Trace	Nil
16-B	13+50 ϕ - 12+10W	"	"
17A	15+20 ϕ - 11+80W	.30	.87
17-B	" - " (roche encaissante)	.01	.25
SL 00 (22)	4+75 ϕ - 8+50W (9+3 3' large roche à côté de camp)	.04	Nil
100	7+40N - 4+70W. (9+3 (6'±) grosse zone de tranché)	1.75	2.72
19-A	15+70 ϕ - 11+00W. (Felsic zone)	.03	Nil
27-A	8+50W - 0+40 ϕ	.65	1.28
29	1+35E 1+95S	.01	Nil
30	6+30 ϕ - 1+55E	Trace	"
31	6+60 ϕ - 1+75E	"	"
32	3+60 ϕ - 10+25E	"	"
33	3+70N 0+60E	"	"
34	2+05N 6+75W	"	"
35	2+05N 6+75W	.02	"
36	0+85N 15+65W	Trace	"
37	LAKESHORE, between 68 ϕ + 12 ϕ	"	"
38	~ 13+50W - 4+30 ϕ	.01	"
39	4+20N 13+40W	.02	"
40	" "	Trace	"
[REDACTED]	" "	[REDACTED]	[REDACTED]
[REDACTED]	" "	[REDACTED]	[REDACTED]
[REDACTED]	" "	[REDACTED]	[REDACTED]
[REDACTED]	" "	[REDACTED]	[REDACTED]

Shalumeni (20) \$180
(remains) 3 27

Assayer: J.W. Beck

STATEMENT / ÉTAT DE COMPTES

RE ACCOUNT / EN COMPTES

J.W. Beck, Cochenour Fire Assaying,
Box 43, Cochenour, Ont.

POV 120

10/A

Minorex Ltd., Box 7,
Thetford Mines, P.Q.

Terms / Conditions

Date June 19-61 19

23 assays for Au & Ag @ \$9.00 ea \$207.00

*Payé le 25 juillet, 61
E. Brass*

Chèque # 233.

OK R. H. ...

20 Shabemni Lake. \$100.⁰⁰

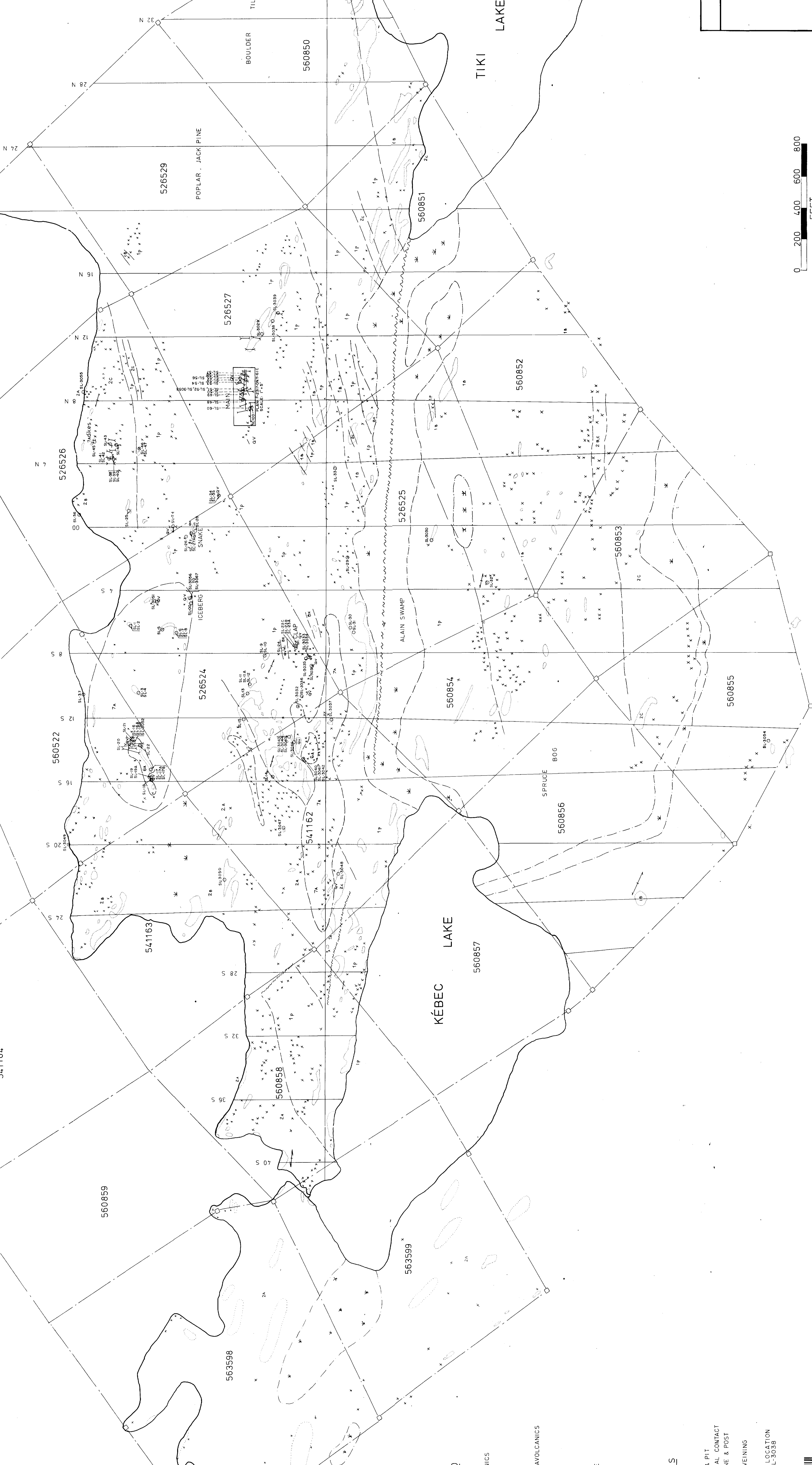
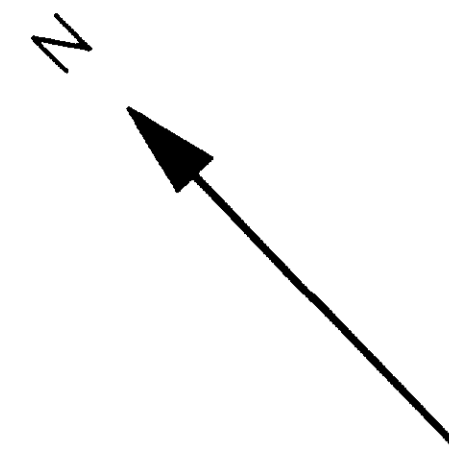

LEGEND

- 1. MAFIC METAVOLCANICS
 - A FLOWS
 - B AGGLOMERATE
 - P PILLOWED FLOWS
- 2. INTERMEDIATE METAVOLCANICS
 - A TUFF
 - B LAPILLI TUFF
 - C AGGLOMERATE
- 6. FELSIC INTRUSIVE
 - A QUARTZ MONZONITE
- 7. MAFIC INTRUSIVE
 - A GABBRO

SYMBOLS

- x OUTCROP
- SWAMP
- TRENCH & PIT
- GEOLOGICAL CONTACT
- CLAIM LINE & POST
- FAULT
- QUARTZ VEINING
- BRECCIA
- SAMPLE LOCATION
- SL-59, SL-3038

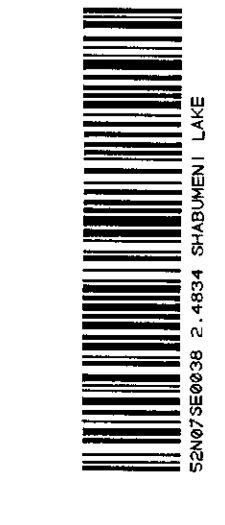

0 200 400 600 800
FEET

24834

MINOREX LIMITED
SHABUMENI CLAIM GROUP
RED LAKE, ONTARIO

GEOLOGY
BY D. DOUCET



2317-ONT-61.G
1:1=200
RKM AUG. 1981

MINOREX LIMITED

MAIN SHOWING : SHABUMENI
RED LAKE, ONTARIO

ASSAY PLAN

: GOLD
IN PPB

2317 Ont 61c-1

KP NOV 1981

David G. Johnson
John E. Johnson
Minorex Ltd.



E10



MINOREX LIMITED
 MAIN SHOWING : SHABUMENI
 RED LAKE, ONTARIO

ASSAY PLAN
 : SILVER
 IN PPM

2317-Ont-61c-2
 11-5

*John P. ...
 Sr. Geologist
 Minorex Ltd.*



280