



52N075E0051

010

Diamond Drilling

Area of SHABUMENI LAKE

Report N^o 17

Work performed by: Gunnex Limited

Claim N ^o	Hole N ^o	Footage	Date	Note
KRL 50233	1	446.0'	Apr/63	
	2	350.0'	Apr/63	
KRL 50232	3	399.5'	Mar/63	
	4	306.0'	Mar/63	
KRL 50244	5	549.0'	Mar/63	

Notes:

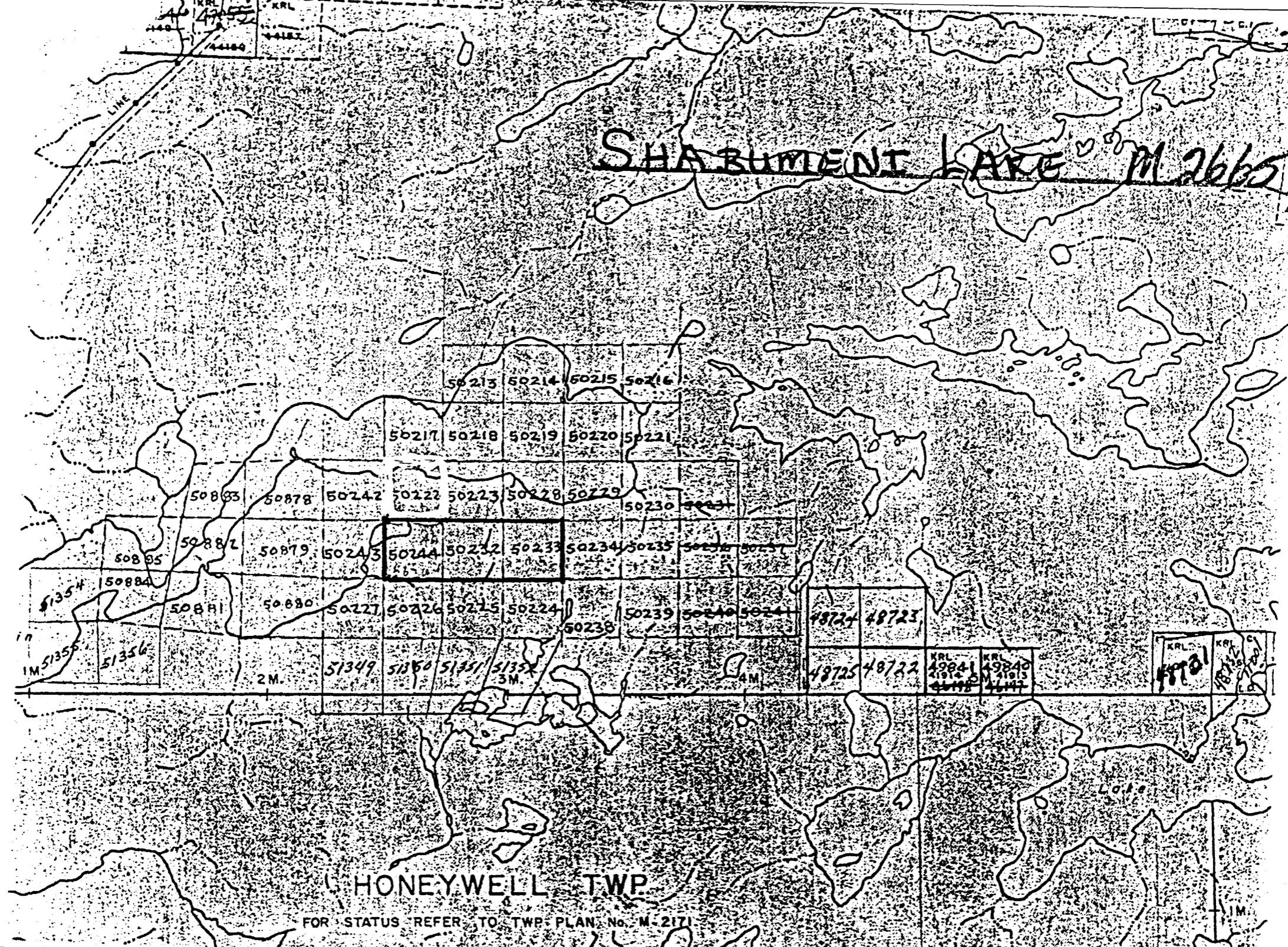

SHARBUMENT LAKE M 2665

HONEYWELL TWP

FOR STATUS REFER TO TWP PLAN No. M-2171

50213 50214 50215 50216

50217 50218 50219 50220 50221

50883 50878 50242 50222 50223 50228 50229 50230

50895 50882 50879 50243 50244 50232 50233 50234 50235 50236 50237

51354 50884 50881 50880 50227 50226 50225 50224 50238 50239 50240 50241

51355 51356 2M 51349 51350 51351 51352 3M 48724 48723

48725 48722

KRL 49841 49840
49842 49843

KRL
M 2660
M 2661

DIAMOND DRILLING

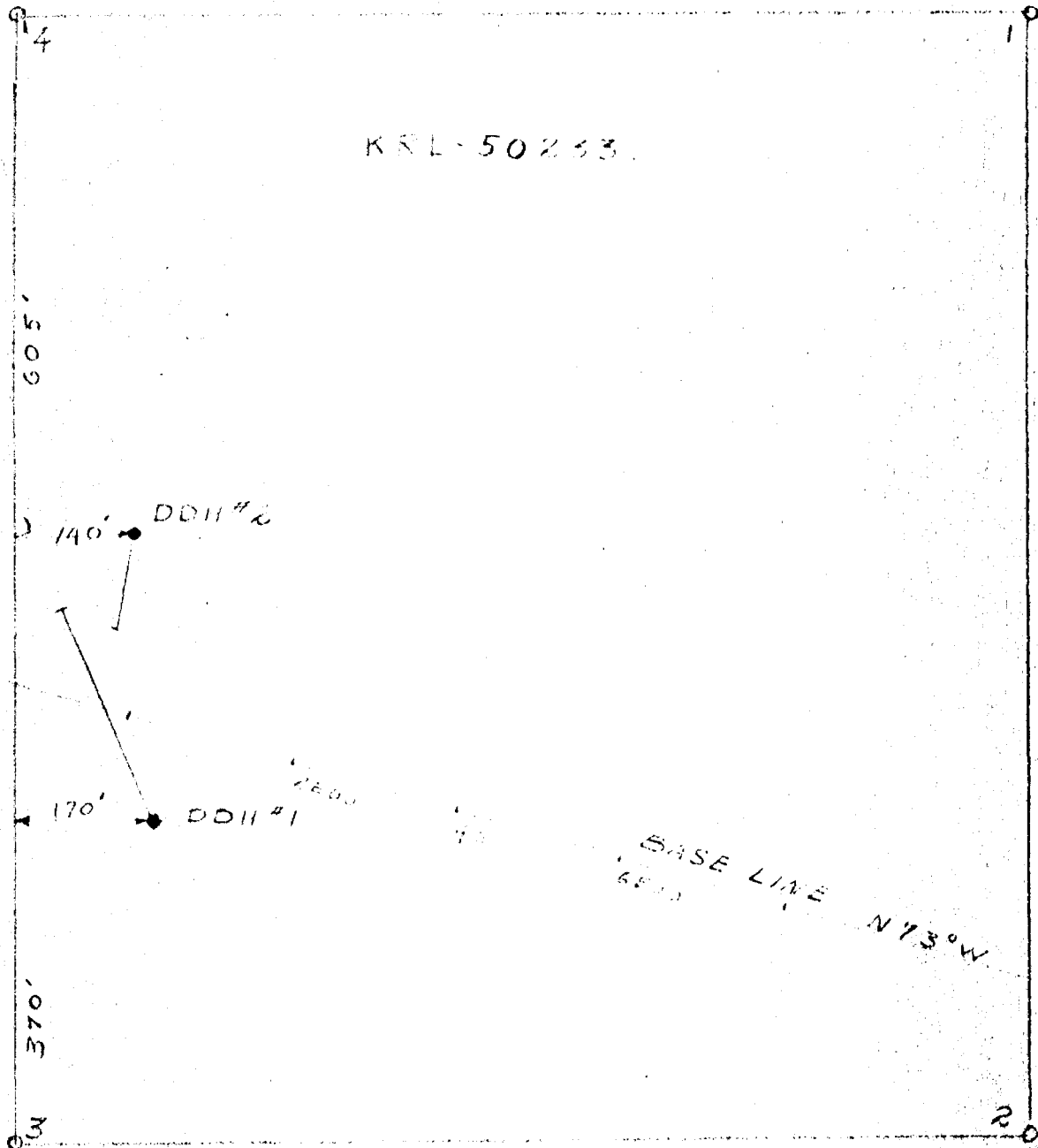

DDH #1
BEARING - 330°
DIP - 45°
DEPTH - 446'

DDH #2
189°
45°
350'5

1" = 200'
RED LAKE MINING DIVISION
MAY 9 1963
RED LAKE, DNT.

DDH # 3
BEARING - 333°
DIP - 45°
DEPTH - 399.5'

DDH # 4
330°
45°
306'

KRL-50232

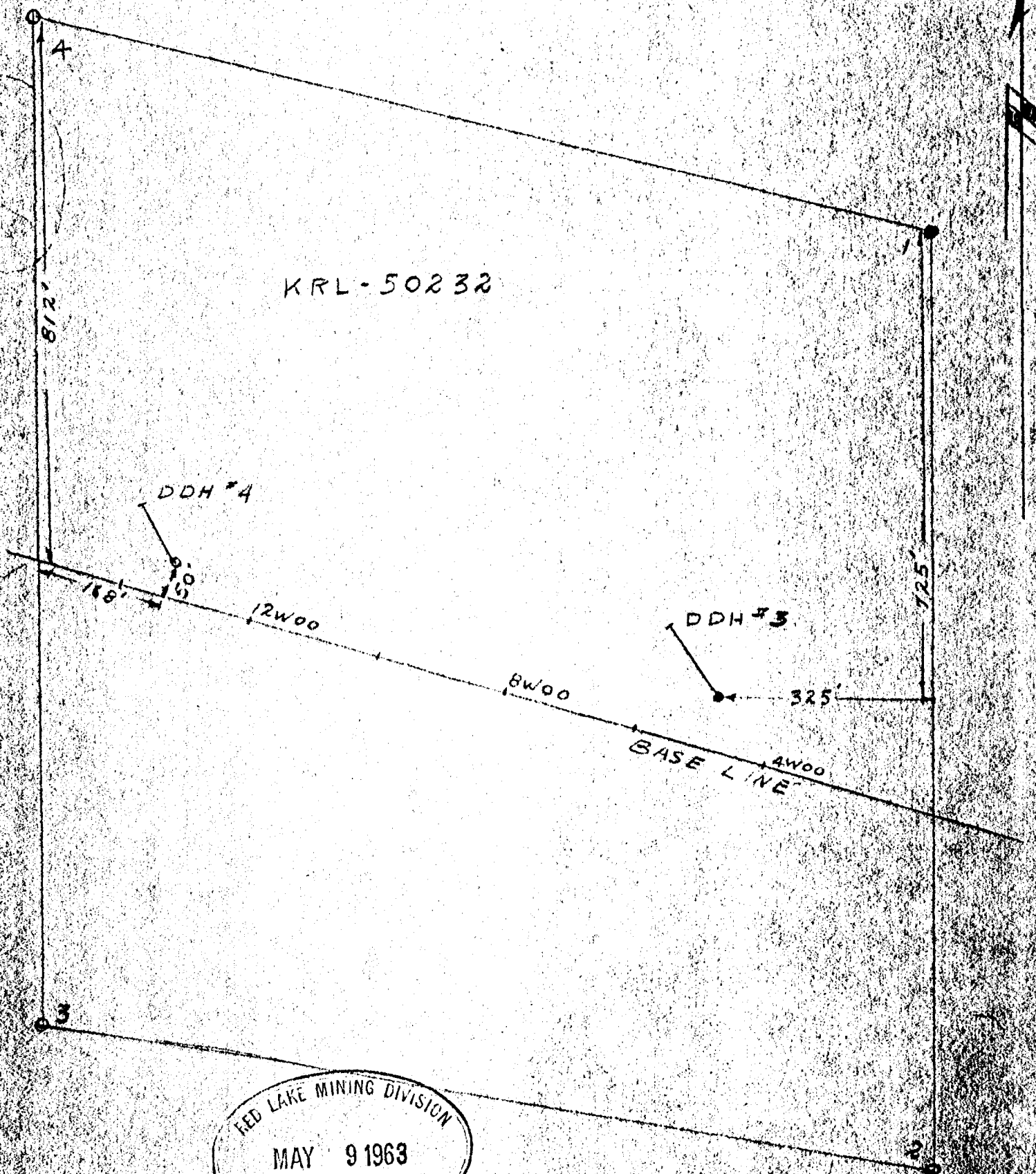

RED LAKE MINING DIVISION
MAY 9 1963
RED LAKE, ONT.

1" = 200'

DDH. #5
BEARING - 330°
DIP - 45°
DEPTH - 549'

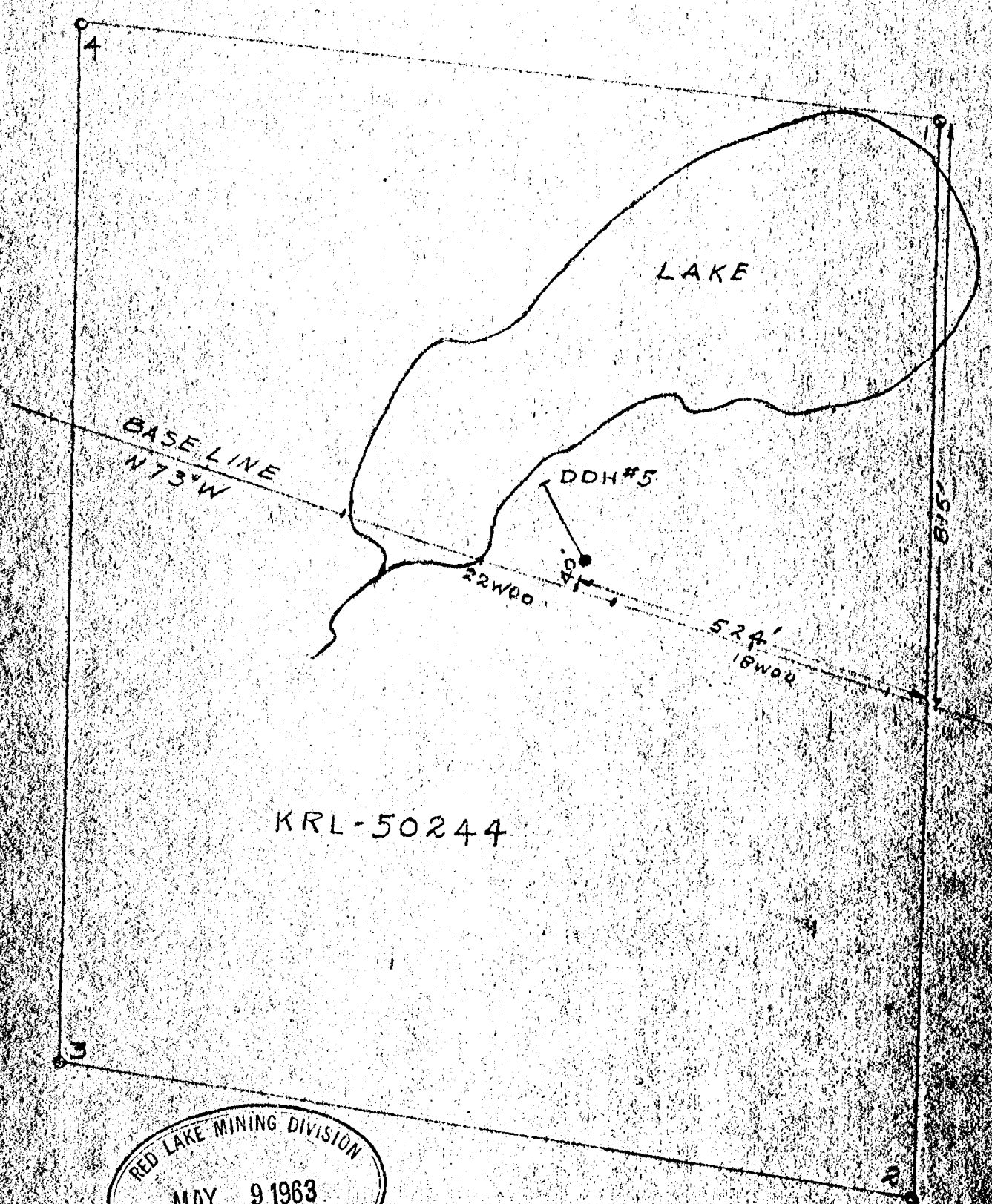

KRL-50244

RED LAKE MINING DIVISION
MAY 9 1963
RED LAKE, ONT.

1" = 200'

FOOTAGE		DESCRIPTION	SAMPLING								
FROM	TO		NO.	FROM	TO	FEET					
339	380	307' Erratic pyrr-chalco streak along core for 6"									
380	446	320-339 20-30% epidote as breccia in medium grained lava Epidote as criss-cross fractures									
		331 - 1' epidote (Massive)									
		327 - 335' Split #3742-8' sparse chalco-pyrr min. in epidotic diorite									
		Lava? Medium grained material, 20% epidote, no min. (Massive)									
		Brecciated lava, 20-30% epidote as fracture fillings and breccia									
		434-439 Dark flecked dike									
		446' END OF HOLE									

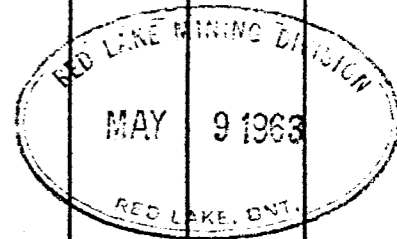

GUNNEX LIMITED.

D. D-Hole No. 2

PROJECT SWAIN LAKE, ONTARIO

Sheet No. 1

LOCATION Red Lake
Mining Division

HOLE STARTED Apr. 2/63

HOLE COMPLETED Apr. 6/63

CORE RECOVERY 98% %

DRILLED BY J. Edwards

LOGGED BY A.O. Zeemel

SURVEY		
DEPTH	DIP	AZIMUTH

COLLAR. LAT. 0/25N

DEP. 3/25N

ELEV. _____

AZIMUTH 189°

DIP -45°

LENGTH 350

HOR. PROJ. _____ VERT. PROJ. _____

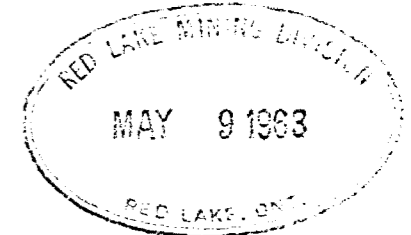

FOOTAGE		DESCRIPTION.	SAMPLING							
FROM	TO		NO	FROM	TO	FEET				
0	2	Casing								
2	5	Dioritic dike, fine grained								
5	36	Dense fine grained lava-flow structure; no mineralisation								
36	81	Dioritic syenite dike. Odd volcanic fragments at 46', 48', 56', 59', 62' and 69' 2" purple quartz at 81'								
81	116'	Fragmental pillow lava: sparse erratic pyrr. and chalco min.								
116'	124'	Partly sheared volc. tuff band in contact with massive epidote at 124' 116-119 Split #3743 - 3" sheared volc. tuffs. 3-8% pyrr 123.5' 3" purple quartz. veinlet								
124	254	70-80% massive epidote with 20-30% dirty grey volc. flow material Some qtz. and calcite stringers and fractures Sparse blotchy globe of chalco-pyrr usually within qtz. strgs. calcite streaks and inclusions, sparse dissemination of cobalt								

FOOTAGE		DESCRIPTION	SAMPLING								
FROM	TO		NO.	FROM	TO	FEET					
		124-134 Split #3745 Massive epidote with splashes and erratic disseminations of chalco pyrr. with touch of cobalt as crystals. Altogether 2-3% mineral									
		134-144 Split 3746 # Massive epidote with some radiating 10-20% qtz. and carb. strgs. Sp.Diss. of cobalt									
		144-154 Same as above, not splite									
		154-164 Split #3747 - 10' Same as 3746 only less mineral									
		169-180 Rhyolitic lava, Fine dense mottled appearance 40% epidote. Sl. diss. of pyrr & Chalco 1% or less									
		191-192, 200-201, 210-211, 216-218, 22-224 - Dark dense lava.									
		231-234 Split #3748 - 3' massive blotchy epidote, 2-5% diss of chalco and pyrr. Massive chalco at 232-232.5									
234	235	Dark dense lava									
235	242	Split #3749 - 7' massive epidote. Light diss. of chalco & Pyrr Odd sec. blotchy material. Light cobalt diss. 2-5% min. 239' 1' of dark lava									
242	245	Dark dense lava									
245	254	Split #3750 Same as previous 250-254' Dark lava									
254	273	Dark Dense basic lava, No mineralization									
273	281	70% epidote, dense lava, no min.									
281	287	Rhyolitic lava flow									
287	294	Massive fine gr'd epidote. Sample # AA 7' 2-5% min. pyrr. and chalco 288-289' & 291-292' Purple qtz.									
294	304	Rhyolitic lava, light grey									
304	307	Dark tuffs, Volcanics									
307	310	Dark flecked lava									
310	315	Fragmental pillow lava									
315	350.5	Dioritic lava with narrow sections of fragmentals.									
		END OF HOLE									

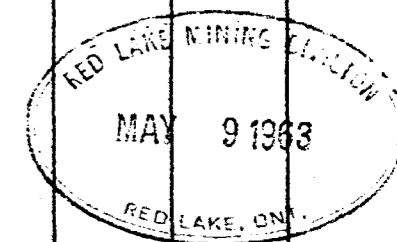

FOOTAGE		DESCRIPTION	SAMPLING				Au	Ag			
FROM	TO		NO.	FROM	TO	FEET					
114.9	124.9	in small grains.									
	114.9-124.9	Quartz stringers and increased brecciation with 2% pyrrhotite	3250	114.9	124.9	10.0	TR	TR			
	135.1-146.7	50% epidote with increased brecciation, scattered fine quartz threads and pyrrhotite	A1	135.1	146.7	11.6	TR	TR			
	152.5-202.0	30% epidote with quartz stringers and scattered pyrrhotite and visible chalco	A2	152.5	166.3	13.8	TR	TR			
	191.5	visible sphalerite blebs.	A3	166.3	179.2	12.9	TR	TR			
	202.0-230	scattered pyrrhotite and occasional speck of chalco. Should be split if samples A4 & A5 run	A4	179.2	190.5		TR	TR			
			A5	190.5	202.0		TR	TR			
230	260	Rhyolite - massive, fractured. Occasional narrow quartz veinlet and scattered specks pyrrhotite. Few blotches of radiating ^{no an} reasblende crystals some of which carry pyrrhotite and chalco grains.									
260	276	Dacite - fine to medium grained, massive contact with above gradational									
276	396.5	Dacite - parts brecciated with slight epidote. More acidic than above. Occasional bleb of pyrrhotite and visible chalco. 308 - 1/2" quartz vein with chalco and sphalerite 350 to end - more flow structure with a few quartz stringers up to 2" wide carrying minor sulphide									
		Purpose: This hole was drilled to test a broad area mineralized with pyrite, pyrrhotite and chalcopyrite with minor cobalt.									
		Results: No economic mineralization intersected.									

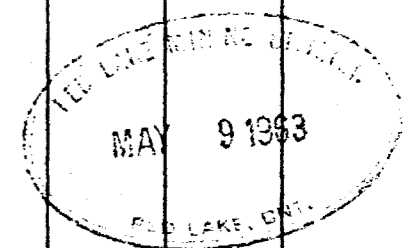

GUNNEX LIMITED.

PROJECT Swain Lake, Ontario

D. D-Hole No. 4
Sheet No. _____

LOCATION Red Lake

Mining Division

HOLE STARTED March 24, 1963

HOLE COMPLETED March 28, 1963

CORE RECOVERY 98 %

DRILLED BY J. Edwards

LOGGED BY W.P. Dix

SURVEY		
DEPTH	DIP	AZIMUTH

COLLAR. LAT. 0 / 50N

DEP. 13 / 36W

ELEV. _____

AZIMUTH 330°T

DIP -45°

LENGTH 306'

HOR. PROJ. _____ VERT. PROJ. _____

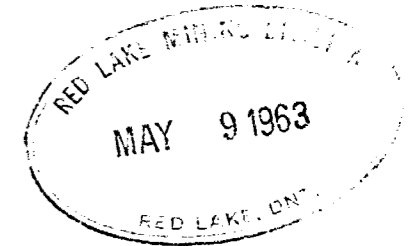

FOOTAGE		DESCRIPTION.	SAMPLING				Au.	Ag		
FROM	TO		NO	FROM	TO	FEET				
0	5	Casing								
5	56	Dacite - fractured several directions and short sections brecciated. Numerous veinlets epidote and occasional quartz veinlet. No visible sulphide.								
56	59	Rhyolite - brecciated to slightly fractured.								
59	63	Syenite (?) dike - n.g. xlines rock with feldspar laths - 3" vuggy quartz @ 63'								
63	75	Rhyolite - brecciated slightly sericitic occasional speck of sulphide								
75	104	Rhyolite tuff - fractured and slightly sheared with lineation @ 45° to core Occasional narrow veinlet of quartz- and development of sericite in streaks 85-93 30% white quartz-carbonate stringers with 1/4" solid quartz @ 88' but no mineralization. Some scattered pyrite.	3241	85.7	87.3	1.6	Trace	Trace		
			3242	87.3	91.0	3.7	Trace	Trace		

FOOTAGE		DESCRIPTION	SAMPLING				Au	Ag
FROM	TO		NO.	FROM	TO	FEET		
104	151.5	Dacite - darker than normal and possibly andesite. Slightly fractured with occasional narrow quartz veinlets. Scattered pyrite cubes. 111.5 2 nd white quartz. no mineral						
151.5	154	123.0 - 125.4 25% quartz carbonate with minor sulphide Syenitic dike - fine grained with feldspar laths - scattered grains pyrite and pyrrhotite	3243	123.0	125.4	2.4	TRACE	TRACE
154	155	Quartz - no sulphides						
155	306	Dacite - darker and possibly andesite. Massive, unfractured. This rock may be intrusive 197 - trachytic texture and resembles diabase 224.5-232 30% quartz in veins nearly parallel the core. Scattered fine pyrite and chalco.	3244	224.5	232.0	7.5	Trace	Trace
END		Purpose: This hole was drilled to test mineralized rhyolite float (?) associated with weak I.P. anomaly. Results: No economic mineralization found. The I.P. anomaly is unexplained except for the possibility of the tuff band acting as a conductor.						

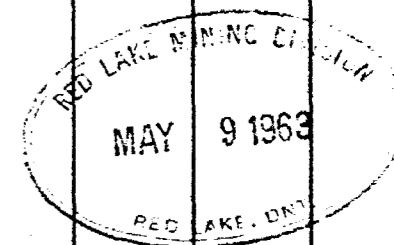

GUNNEX LIMITED.

PROJECT SWAIN LAKE, ONTARIO

D. D-Hole No. 5

Sheet No. 1

LOCATION Red Lake

Mining Division

HOLE STARTED MAR 17 1963

HOLE COMPLETED MAR 23 1963

CORE RECOVERY 98 %

DRILLED BY J. EDWARDS

LOGGED BY L.O. Zemel

SURVEY		
DEPTH	DIP	AZIMUTH

COLLAR. LAT. 0/40N

DEP. 20/33W

ELEV. _____

AZIMUTH 330°T

DIP -45°

LENGTH 549

HOR. PROJ. _____ VERT. PROJ. _____

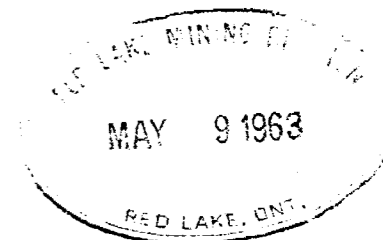

FOOTAGE		DESCRIPTION.	SAMPLING				Au	Ag	Cu	Ni
FROM	TO		NO	FROM	TO	FEET				
0	12.0		Casing							
12.0	22.0	Rhyolite - ropey with up to 50% epidote. In places carries 10% quartz in stringers and some carbonate carries 2 to 5% pyrite, pyrrhotite and chalco in disseminations and blebs.	3228	12.0	17.0	5.0	NIL	TR	0.10	—
			3229	17.0	22.0	5.0	NIL	0.04	0.07	—
22.0	27.0	Rhyolite tuff - fractured with 10% epidote and 2 to 3% disseminated pyrite, pyrrhotite and scattered fine chalco.	3230	22.0	27.0	5.0	NIL	0.20	—	—
27.0	49.0	Rhyolite - fractured and showing pillow selvages 27-31 1 to 2% scattered pyrite and 10% epidote 40 to 49 20% purplish quartz stringers and 10% epidote	3231	27.0	31.0	4.0	NIL	0.27	—	—
49.0	85.6	Dacite - massive, dark, epitotized minor sulphide 80-83 60% epidote and 2 to 5% pyrite, pyrrhotite and visible chalco	3232	40.0	49.0	9.0	NIL	TR		
85.6	102.0	Rhyolite lava - fractured and showing flow structures, scattered epidote and narrow quartz stringers 85.6 -92.0 70% epidote and 1 to 2% pyrite, pyrrhotite and minor chalco 93 purplish quartz stringer	3233	80.0	83.0	3.0	NIL	NIL		
			3234	85.6	92.0	6.4	NIL	NIL	0.02	—

FOOTAGE		DESCRIPTION	SAMPLING								
FROM	TO		NO.	FROM	TO	FEET					
102	133	Massive lava, partially epidote flecked									
133	140	Dense dark py. flecked lava (appears as dike) 136-140 4' sample #3236									
140	150	Flow structure lava with light color epid & qtz flow streaked									
150	203	Dense light-flecked lava with odd spl. or frac. of epidote No min. At 162' 1' fluoritic qtz. at 62 degrees to core. Some sections 20-30% epidote									
203	208	Epidotic lava in contact with med.gr. andesite. 5-10% py. as diss. and thread-like frac. Lightly min. sulphide zone 5' Sample #3237									
208	231.6	Med Grnd lava. Diss. py at 222 231.6 contact with fine grained flow-structure lava									
231.6	248	Light rhyolitic (grey) flow structure lava									
248	278	Rhyolitic, light 15-30% epidote flow breccia, very light py. diss in sections 253-254 Fluoritic flow structure									
278	344	Med. to light lava. Frag. at pillow edges									
344	356	Dike. 344-351' Contact with frag lava. Sample taken of med grnd dike material 5-15% py. diss. #3238									
356	357	In contact with epidote									
357	475	Dense fine lava with epidote frs. Frag. in sections & creamy-flecked lavas. Some very slight min.									
475	481	Light grey, med grnd material (dike?) with diss of vesicules of epidote and chalco, mottled in appearance. 30% chalco, pyrr. and py combined #3239									
481	487	#3240									
487	549	Dense (in odd spot frag) lean xs. or vesicule flecked lava									
		END OF HOLE									

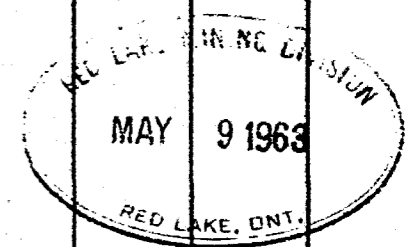



- LEGEND**
- Q QUARTZ PORPHYRY
 - QDP QUARTZ-FELSOPHRE PORPHYRY
 - T TRENCHING (INTENSIVE)
 - DO DORITE - POSSIBLY d or a
 - S SEDIMENTS - HF + chert
 - E ERYCITE
 - D DACITE
 - A ANDESITE
 - cpi EPIDOTIZED
 - F FELDSPATHIC
 - chl CHLORITIC
 - mass MASSIVE
 - P FLOWED
 - Py PYRITE
 - Pyz PYRROPHITE
 - Cu CHALCOPYRITE
 - Zn SPHALERITE
 - B BEDDING
 - S SURFACING
 - PL PLUNY TIPS
 - J JOINTING OR FRACTURING
 - C CONTACT
 - O OUTCROP
 - OB OVERBORDEN
 - A ALLEGATED FLOW TOP
 - T TRENCHING
 - F FAULT (ASSUMED)



200

GUNNEX LIMITED
 SWAIN LAKE GROUP ONT.
 GEOLOGY OF COPPER SHOWINGS
 TRENCHING
 SCALE 1" = 100'



SHABUMENI LK. D.D. #17

W.F.D. SEPT 1962