



52011SW0034 52011SW0027 MCVICAR LAKE

010

NORANDA EXPLORATION COMPANY, LIMITED  
(no personal liability)

GEOLOGICAL REPORT

SHONIA LAKE PROPERTY

N.T.S 52 0/11

RED LAKE DISTRICT  
NORTHWESTERN ONTARIO DIVISION

**RECEIVED**

SEP 25 1984

MINING LANDS SECTION

THUNDER BAY, ONTARIO  
JULY 1984

IAN PERRY  
PROJECT GEOLOGIST



52011SW0034 52011SW0027 MCVICAR LAKE

010C

(i)

Table of Contents

|                                     | Page |
|-------------------------------------|------|
| 1.0 INTRODUCTION                    | 1    |
| 2.0 LOCATION, ACCESS AND TOPOGRAPHY | 1    |
| 3.0 CLAIMS STATUS                   | 1    |
| 4.0 PREVIOUS WORK                   | 2    |
| 5.0 REGIONAL GEOLOGY                | 2    |
| 6.0 PROPERTY GEOLOGY                |      |
| 6.1 Table of Formations             | 3    |
| 6.2 Description of Units            | 3    |
| 6.3 Property Geology                | 4    |
| 6.4 Mineralization                  | 4    |
| 7.0 CONCLUSIONS                     | 5    |
| 8.0 RECOMMENDATIONS                 | 6    |

List of Figures

Figure 1            Location Map

Figure 2            Claim Sketch

1" = 1/2 mile

## 1.0 INTRODUCTION

The Shonia Lake property, consisting of twenty-nine (29) claims, was staked by Noranda Exploration Company, Limited personnel in 1983. Geological mapping along the claim lines indicated only 9 claims to be of primary interest.

In July 1984, an exploration program consisting of detailed geological mapping and a VLF-EM survey was carried out over the 9 claims on a pace and compass grid with 100-meter line spacing. In addition, a small humus sampling program (approximately 90 samples total) was carried out over the two showings.

## 2.0 LOCATION, ACCESS AND TOPOGRAPHY (Figure 1)

The property is located approximately 54 miles WNW of Pickle Lake, and approximately 106 miles north of Sioux Lookout, Ontario. It is situated between McVicar and Lang Lakes and entirely covers Shonia Lake. The 9 claims over which the 1984 field work was carried out cover the peninsula which separates McVicar Lake from Shonia Lake.

Access to the property is by float- or ski-equipped aircraft from Pickle Lake (Austin Airways and Central Air Transport).

Topographically the property is generally fairly flat although several east/west trending ridges from 1-3 meters in height occur in the northern half. Forest cover ranges from open poplar groves to open spruce forest with minor swamp and alder cover.

## 3.0 CLAIMS STATUS (Figure 2)

The following 29 unpatented claims in the Red Lake Mining Division comprise the Shonia Lake Property:

| CLAIM NUMBERS    | NO. OF CLAIMS | RECORDING DATE  |
|------------------|---------------|-----------------|
| KRL 732455-456   | 2             | August 31, 1983 |
| 745710-717, inc. | 8             | August 9, 1983  |
| 745719           | 1             | August 31, 1983 |
| 745720-727, inc. | 8             | August 9, 1983  |
| 745728-729, inc. | 2             | August 31, 1983 |
| 768957-960, inc. | 4             | August 31, 1983 |
| 768967-968, inc. | 2             | August 31, 1983 |
| 768971-972, inc. | 2             | August 31, 1983 |

Claims 745710-716, inclusive, 745725 and 745727 have been covered by geological mapping and VLF-EM surveys which are being filed for assessment purposes. These surveys were carried out from July 9-23, 1984, by Noranda Exploration personnel.

Claims are held by Noranda Exploration Company, Limited.

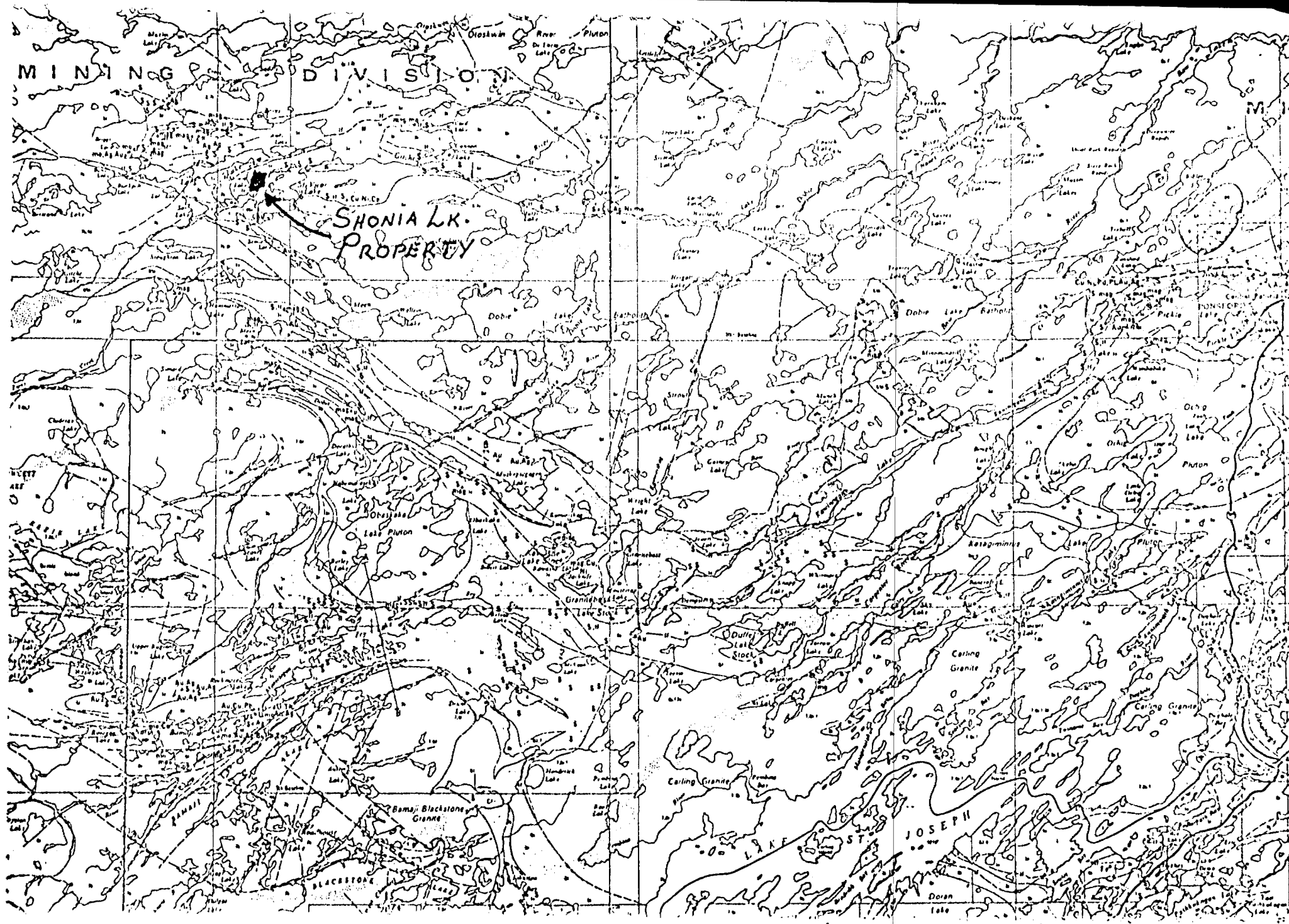

# LOCATION MAP

0 4 8 12 16 MILES

FIGURE 1

#### 4.0 PREVIOUS WORK

Very little information on the Shonia Lake area is available from the Red Lake assessment files.

- 1) 1928 - Initial discovery of the quartz vein system between Shonia and McVicar Lakes by Bill Smith and Stanley Watson, setting off a staking rush in the area.
- 2) 1928-1929 - Property optioned by Northern Aerial Mineral Exploration Limited. Considerable trenching, clearing and channel sampling was carried out. Results were disappointing and the option was dropped.
- 3) 1970-1971 - Hanna Mines Limited covered the Shonia Lake area as part of a large exploration program looking for base metals. Magnetometer, EM and geological mapping surveys were carried out on a cut grid with 100-meter line spacings. No detailed work was done on the main showings.
- 4) 1983 - Property staked by Noranda Exploration.

#### 5.0 REGIONAL GEOLOGY

The Shonia Lake property lies within the Lang Lake belt of Keewatin age metavolcanic and metasedimentary rocks.

The major structural feature in the belt is a N70°E trending syncline (40-60°E plunge) the axis of which runs between Boyes and Lang Lakes. A second syncline with a parallel fold axis, has been interpreted south of the main syncline, running through the top of Shonia Lake.

The Shonia Lake property and the mineralized granitic plug therein are interpreted to lie just south of the axis and east of the core of the south syncline.

Considerable igneous activity, mainly gabbroic to dioritic intrusions, has taken place along the southern side of the belt.

\* (In part from OGS Report #207 "Geology of the Cat Lake-Pickle Lake Area", 1982.)

## 6.0 PROPERTY GEOLOGY

### 6.1 Table of Formations

|       |                        |
|-------|------------------------|
| [ 6 ] | Granite - Trondhjemite |
| [ 5 ] | Diorite - Gabbro       |
| [ 4 ] | Sediments              |
| [ 3 ] | Felsic Volcanics       |
| [ 2 ] | Intermediate Volcanics |
| [ 1 ] | Mafic Volcanics        |

### 6.2 Description of Units:

#### [1] Mafic Volcanics

This unit outcrops in the north and central portions of the property. It is typically dark green, extremely fine grained and non-foliated. Compositionally it is classified as a Basalt. Carbonate and pyrite are accessory minerals.

#### [2] Intermediate Volcanics

This unit outcrops in the north central part of the property between the two bands of mafic volcanics. It is olive-green, fine grained and normally poorly foliated. Carbonate and pyrite are accessory minerals.

#### [3] Felsic Volcanics

This unit outcrops along the eastern edge of the property and is also found in one outcrop on claim 745710. It ranges from light grey to buff to black in colour, is extremely fine grained, and breaks with a conchoidal fracture. Weak carbonate is a frequent accessory.

#### [4] Sediments

None found on property.

#### [5] Diorite-Gabbro

This unit outcrops over much of the southeastern quarter of the property. It is extremely variable in both grain size and composition, ranging from a coarse-grained anorthosite to a fine-grained quartz diorite, and is occasionally feldspar-porphyrific. It appears most frequently as a medium-grained gabbro. Pyrite occurs occasionally, as does carbonate, normally along fracture planes in trace amounts.

#### [6] Granite (Trondhjemite)

This unit outcrops along the eastern shore of Shonia Lake, south of line 4+00S, and probably represents a small plug or an apophysis from a larger intrusion to the south. The rock is buff in

colour, equigranular, fine grained, and consists of approximately 40% quartz and 60% feldspar. No mafic minerals were observed in any of the outcrops. On fresh surfaces the rock frequently has reddish to greenish flecks of saussurite from alteration of the feldspars. Weak carbonate and pyrite are ubiquitous.

### 6.3 Property Geology

The Shonia Lake property can be divided into two geological environments: South of Line 3+00S the property is underlain primarily by intrusive rocks ranging from gabbro to trondhjemite; North of Line 3+00S it is underlain by volcanic rocks ranging from basalt to rhyolite. The contact between these two areas (L2+25S - L3S) is marked by a steep sided valley (1-3 meters) with some evidence of shearing (i.e. slickensides and strong carbonatization) in both the north and south valley walls. Towards the western end of the valley, in the area between the base line and Shonia Lake, a narrow dyke or plug of sheared, altered granitic rock outcrops within the valley. This intrusive is host to the North zone of mineralization.

A second intrusion of altered granitic rock extends from the East-West step on the eastern shore of Shonia Lake (at line 4S) to the southern property boundary and east from the lakeshore for approximately 1/4 mile. This intrusive hosts the south zone of mineralization.

The remainder of the southern portion of the property is underlain by a mafic-intermediate intrusive complex, consisting of quartz diorite, diorite, gabbro, anorthosite and feldspar porphyritic gabbro.

The north half of the property is underlain by massive volcanic rocks making structural interpretations difficult. However, strikes and dips from several outcrops seem to indicate a northeasterly trend in the west and a more easterly trend along the east side giving some evidence of the property lying near the nose of a ENE trending syncline with the younger, felsic volcanics occupying the central portion of the fold.

Two outcrops of basic volcanics found at LON,1+75W and L2E,5+75N and showing an extremely contorted foliation and some silicification, are interpreted as being related to a fault represented by a ridge trending approximately 65° along which both outcrops are located.

### 6.4 Mineralization

Two zones of quartz-pyrite-gold mineralization have been found on the Shonia Lake property. Both are hosted by the altered (saussuritized, carbonatized, pyritiferous) granitic intrusives.

The largest zone, the "South Zone", is located on Line 5+50S, between 0+50W and 1+50W, and consists of two crosscutting sets of quartz veining. One set is oriented at 60° azimuth dipping 70°S, the other runs 0-10° and dips 75°E. Both veins and wallrock contain weak pyrite mineralization, but mineralization is best at the intersections of the two vein systems. Approximately 20 veins, ranging from 2" to 4' in width, were exposed along the side of the hill at the showing by the pits and trenches blasted out in the 1920's.

Although none of the veins can be traced for any distance greater than 30' along strike, it is thought they might be fillings of tension fractures running across strike of the actual zone of weakness (approximately 85° azimuth).

The north zone of mineralization is located on Line 2+75S, between 0+10E and 0+75W. It consists of a single quartz vein approximately 2-4' in width, trending 82-96° azimuth and dipping 70-75°S. The vein itself consists of coarse quartz with numerous small, rusty fractures. The wall rock surrounding the vein consists of sheared, altered granitic rock with up to 10% pyrite locally and minor carbonate. The strongest mineralization is found in the footwall with only minor pyrite in the hanging wall. The vein can be followed on surface for about 100 feet, extending under heavy underbrush to the east and west. Nine trenches were blasted in the vicinity of the vein in the 1920's, but are now filled in with dirt or water. No assay values from the 1984 sampling are available to date, but one value of .34 opt/3.0' was obtained from this zone in the 1920's. The remainder of the values were "negligible".

No other zones of interest were observed on the property although most outcrops do contain traces of pyrite and carbonate.

## 7.0 CONCLUSIONS

- 1) Gold mineralization is related to fracture zones within saussuritized, carbonatized, pyritiferous granitic intrusives.
- 2) "South Zone" mineralization is not cut off by the narrow basaltic dyke trending 5° across the main showing. Quartz veins bearing pyrite and gold occur both to the north and south of the dyke.
- 3) The Diorite-Gabbro unit which occurs in the southern portion of the property is assumed to be older than the granitic intrusive since the granite cuts the mafic unit into two parts and therefore should not cut off the "South Zone" mineralization to the east.
- 4) The apparent trend of both zones is between 82° and 90° Azimuth, indicating structural breaks in this direction.



## 8.0 RECOMMENDATIONS

- 1) An attempt should be made to follow out the zones along strike using geophysics, specifically I.P. since the VLF results appeared somewhat inconclusive.
- 2) If the zones prove traceable, a small drill program of approximately 1000 feet, should be considered.

Respectfully submitted

NORANDA EXPLORATION COMPANY, LIMITED  
(no personal liability)

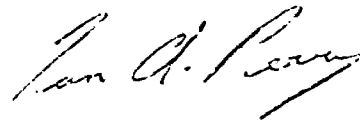

Thunder Bay, Ontario  
July 31, 1984

Ian Perry  
Project Geologist - Red Lake  
Northwestern Ontario Division



52011SW0034 52011SW0027 MCVICAR LAKE

020

NORANDA EXPLORATION COMPANY, LIMITED  
(no personal liability)

REPORT OF WORK

VLF-EM SURVEYS  
SHONIA PROPERTY  
JARROW LAKE PROJECT

N.T.S 52/0/11

**RECEIVED**

SEP 25 1984

MINING LANDS SECTION

THUNDER BAY, ONTARIO  
SEPTEMBER 17, 1984

D. R. CARRIERE  
DIVISION GEOPHYSICIST  
NORTHWESTERN ONTARIO DIVISION



52011SW0034 52011SW0027 MCVICAR LAKE

0200C

(1)

## TABLE OF CONTENTS

|                               | Page |
|-------------------------------|------|
| 1.0 INTRODUCTION              | 1    |
| 2.0 LOCATION, ACCESS AND GRID | 1    |
| 3.0 PERSONNEL                 | 1    |
| 4.0 INSTRUMENTATION           | 1    |
| 4.1 VLF-EM System             | 1    |
| 5.0 GEOLOGY                   | 1    |
| 6.0 DISCUSSION OF RESULTS     | 2    |
| 7.0 CONCLUSIONS               | 2    |

## LIST OF FIGURES

|                       | Scale       |
|-----------------------|-------------|
| FIGURE 1 LOCATION MAP |             |
| FIGURE 2 CLAIM SKETCH |             |
|                       | 1"=1/2 mile |

## LIST OF MAPS

|       |                                     |        |
|-------|-------------------------------------|--------|
| MAP 1 | VLF RESULTS OF THE NORTH/SOUTH GRID | 1:1250 |
| MAP 2 | VLF RESULTS OF THE EAST/WEST GRID   | 1:1250 |

## 1.0 INTRODUCTION

During the month of August, 1984, ground VLF-EM surveys were carried out on the ten (10) claims of the Shonia Lake Property in an attempt to locate any anomalous conductive responses.

## 2.0 LOCATION, ACCESS AND GRID

The property consists of 10 claims (numbered 745710 to 17, 745725 and 745727, in the Patricia Mining Division) located 54 miles WNW of Pickle Lake. Access to the property is by float or ski plane.

The surveys were carried out on a pace and compass grid using a line separation of 100 meters and a station separation of 25 meters. The property was surveyed in two directions as the structures of interest crosscut the strike.

## 3.0 PERSONNEL

The survey was carried out by L. Manson, an employee of Noranda Exploration Company, Limited.

## 4.0 INSTRUMENTATION

### 4.1 VLF-EM System

The VLF-EM system employed on this survey was the EM-16 unit manufactured by Geonics Limited of Toronto, Ontario. The survey parameters used were as follows:

|                  |  |
|------------------|--|
| Transmitter      | : Annapolis, Md; Seattle, Wa.                      |
| Frequencies      | : 21.4 KHz; 24.8 KHz                               |
| Reading Interval | : 12.5 meters                                      |
| Measurements     | : In-Phase and Quadrature<br>components in percent |

The plan map presented is the Fraser Filtered in-phase data at a scale of 1:1250.

## 5.0 GEOLOGY

The property lies within the Lang Lake Belt of the Keewatin Age metavolcanic and metasedimentary rocks. The southern part of the property is underlain by intrusive rocks while the northern portion is underlain by volcanics which appear to trend northeast to east.

## 6.0 DISCUSSION OF RESULTS

The results of the survey done in a north/south direction located three anomalous responses labelled A to C:

Zone A is closely related to a topographic swampy low which may be causing the response. Near the baseline it is associated with rusty carbonate rocks which may be indicating another source.

Zone B, to the west of the baseline, is to the south of a group of mafic volcanics which contain up to 4% pyrite. This response may be caused by sulphides.

Zone C is associated with a topographic swampy low that is felt to be the source of the response.

The results of the east/west survey also located three responses labelled A to C:

Zone A is open to the north but the response is in a topographic low covered by alders. The response is probably due to these conditions.

Zone B is also in a topographic low and is probably produced by these conditions.

Zone C appears to be related to the contact between the granite and the gabbro over a distance of 400 meters. Iron staining and pyrite was located in the area.

## 7.0 CONCLUSIONS

The results of the VLF survey have indicated two areas of possible interest, Zone B of the north/south grid and Zone C of the east/west grid. If these areas are of geological interest, it would be worthwhile carrying out some IP to better evaluate their sources.

Respectfully submitted

NORANDA EXPLORATION COMPANY, LIMITED  
(no personal liability)

*D. R. Carriere*

D. R. Carriere  
Division Geophysicist  
Northwestern Ontario Division

Thunder Bay, Ontario  
September 17, 1984



52011SW0034 52011SW0027 MCVICAR LAKE

900



## Ministry of Natural Resources

File \_\_\_\_\_

GEOPHYSICAL - GEOLOGICAL - GEOCHEMICAL  
TECHNICAL DATA STATEMENT

TO BE ATTACHED AS AN APPENDIX TO TECHNICAL REPORT  
FACTS SHOWN HERE NEED NOT BE REPEATED IN REPORT  
TECHNICAL REPORT MUST CONTAIN INTERPRETATION, CONCLUSIONS ETC.

Type of Survey(s) GeologyTownship or Area McVicar Lake AreaClaim Holder(s) Noranda Exploration Company, LimitedSurvey Company Noranda Exploration Company, LimitedAuthor of Report I. PerryAddress of Author P. O. Box 2656, Thunder Bay, Ont. P7B 5G2Covering Dates of Survey July 9 - 23, 1984  
(linecutting to office)

Total Miles of Line Cut \_\_\_\_\_

**SPECIAL PROVISIONS  
CREDITS REQUESTED**ENTER 40 days (includes  
line cutting) for first  
survey.ENTER 20 days for each  
additional survey using  
same grid.

## Geophysical

- Electromagnetic \_\_\_\_\_

- Magnetometer \_\_\_\_\_

- Radiometric \_\_\_\_\_

- Other \_\_\_\_\_

Geological 20

Geochemical \_\_\_\_\_

DAYS  
per claim**AIRBORNE CREDITS** (Special provision credits do not apply to airborne surveys)Magnetometer \_\_\_\_\_ Electromagnetic \_\_\_\_\_ Radiometric \_\_\_\_\_  
(enter days per claim)DATE Sept. 24, 1984 SIGNATURE: I. Perry  
Author of Report or Agent

Res. Geol. \_\_\_\_\_ Qualifications \_\_\_\_\_

## Previous Surveys

File No. Type Date Claim Holder

|  |  |  |  |
|--|--|--|--|
|  |  |  |  |
|  |  |  |  |
|  |  |  |  |
|  |  |  |  |
|  |  |  |  |
|  |  |  |  |
|  |  |  |  |
|  |  |  |  |
|  |  |  |  |
|  |  |  |  |

## MINING CLAIMS TRAVERSED

List numerically

.....KRL745710.....  
(prefix) (number)

.....745711.....

.....745712.....

.....745713.....

.....745714.....

.....745715.....

.....745716.....

.....745725.....

.....745727.....

If space insufficient, attach list

RECEIVED

SEP 25 1984

MINING LANDS SECTION

TOTAL CLAIMS 09

OFFICE USE ONLY



Ministry of Natural Resources

File \_\_\_\_\_

GEOPHYSICAL - GEOLOGICAL - GEOCHEMICAL  
TECHNICAL DATA STATEMENT

TO BE ATTACHED AS AN APPENDIX TO TECHNICAL REPORT  
FACTS SHOWN HERE NEED NOT BE REPEATED IN REPORT  
TECHNICAL REPORT MUST CONTAIN INTERPRETATION, CONCLUSIONS ETC.

Type of Survey(s) VLF-EM  
Township or Area McVicar Lake Area  
Claim Holder(s) Noranda Exploration Company, Limited  
P. O. Box 2656 Thunder Bay, Ont. P7B 5G2  
Survey Company Noranda Exploration Company, Limited  
Author of Report D. R. Carriere  
Address of Author P. O. Box 2656, Thunder Bay, Ont. P7B 5G2  
Covering Dates of Survey July 9 - 23, 1984  
(linecutting to office)  
Total Miles of Line Cut \_\_\_\_\_

SPECIAL PROVISIONS  
CREDITS REQUESTED

ENTER 40 days (includes  
line cutting) for first  
survey.

ENTER 20 days for each  
additional survey using  
same grid.

Geophysical

DAYS  
per claim.

-Electromagnetic 20

-Magnetometer \_\_\_\_\_

-Radiometric \_\_\_\_\_

-Other \_\_\_\_\_

Geological \_\_\_\_\_

Geochemical \_\_\_\_\_

AIRBORNE CREDITS (Special provision credits do not apply to airborne surveys)

Magnetometer \_\_\_\_\_ Electromagnetic \_\_\_\_\_ Radiometric \_\_\_\_\_  
(enter days per claim)

DATE: Sept. 18, 1984 SIGNATURE: D. R. Carriere  
Author of Report or Agent

Res. Geol. \_\_\_\_\_ Qualifications \_\_\_\_\_

Previous Surveys

File No. Type Date Claim Holder

|  |  |  |  |
|--|--|--|--|
|  |  |  |  |
|  |  |  |  |
|  |  |  |  |
|  |  |  |  |
|  |  |  |  |
|  |  |  |  |
|  |  |  |  |
|  |  |  |  |
|  |  |  |  |
|  |  |  |  |

**MINING CLAIMS TRAVERSED**  
List numerically

KRL745710

(prefix)

(number)

745711

745712

745713

745714

745715

745716

745725

745727

If space insufficient, attach list

TOTAL CLAIMS 09

# GEOPHYSICAL TECHNICAL DATA

GROUND SURVEYS – If more than one survey, specify data for each type of survey

Number of Stations 703 Number of Readings 703

Station interval 25m Line spacing 100m

Profile scale \_\_\_\_\_

Contour interval 10, 20, 40, 50, 60, 70, 80%

## MAGNETIC

Instrument \_\_\_\_\_

Accuracy – Scale constant \_\_\_\_\_

Diurnal correction method \_\_\_\_\_

Base Station check-in interval (hours) \_\_\_\_\_

Base Station location and value \_\_\_\_\_

## ELECTROMAGNETIC

Instrument Geonics EM-16

Coil configuration Tilt angle

Coil separation \_\_\_\_\_

Accuracy 1%

Method: ☒ Fixed transmitter ☐ Shoot back ☐ In line ☐ Parallel line

Frequency 21.4 & 24.8 (specify V.L.F. station)

Parameters measured Inphase component

## GRAVITY

Instrument \_\_\_\_\_

Scale constant \_\_\_\_\_

Corrections made \_\_\_\_\_

Base station value and location \_\_\_\_\_

Elevation accuracy \_\_\_\_\_

## INDUCED POLARIZATION RESISTIVITY

Instrument \_\_\_\_\_

Method ☐ Time Domain ☐ Frequency Domain

Parameters – On time \_\_\_\_\_ Frequency \_\_\_\_\_

– Off time \_\_\_\_\_ Range \_\_\_\_\_

– Delay time \_\_\_\_\_

– Integration time \_\_\_\_\_

Power \_\_\_\_\_

Electrode array \_\_\_\_\_

Electrode spacing \_\_\_\_\_

Type of electrode \_\_\_\_\_



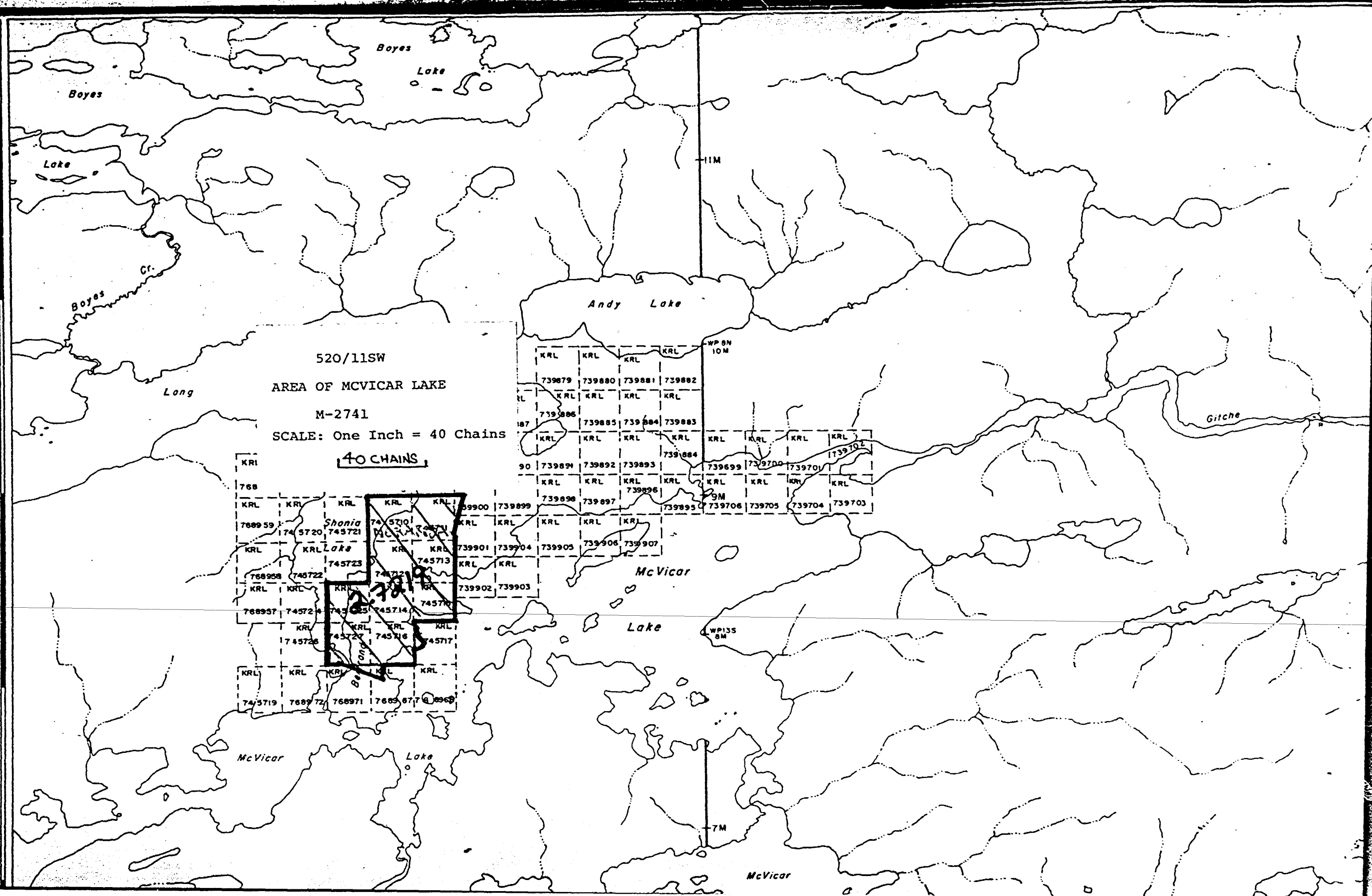

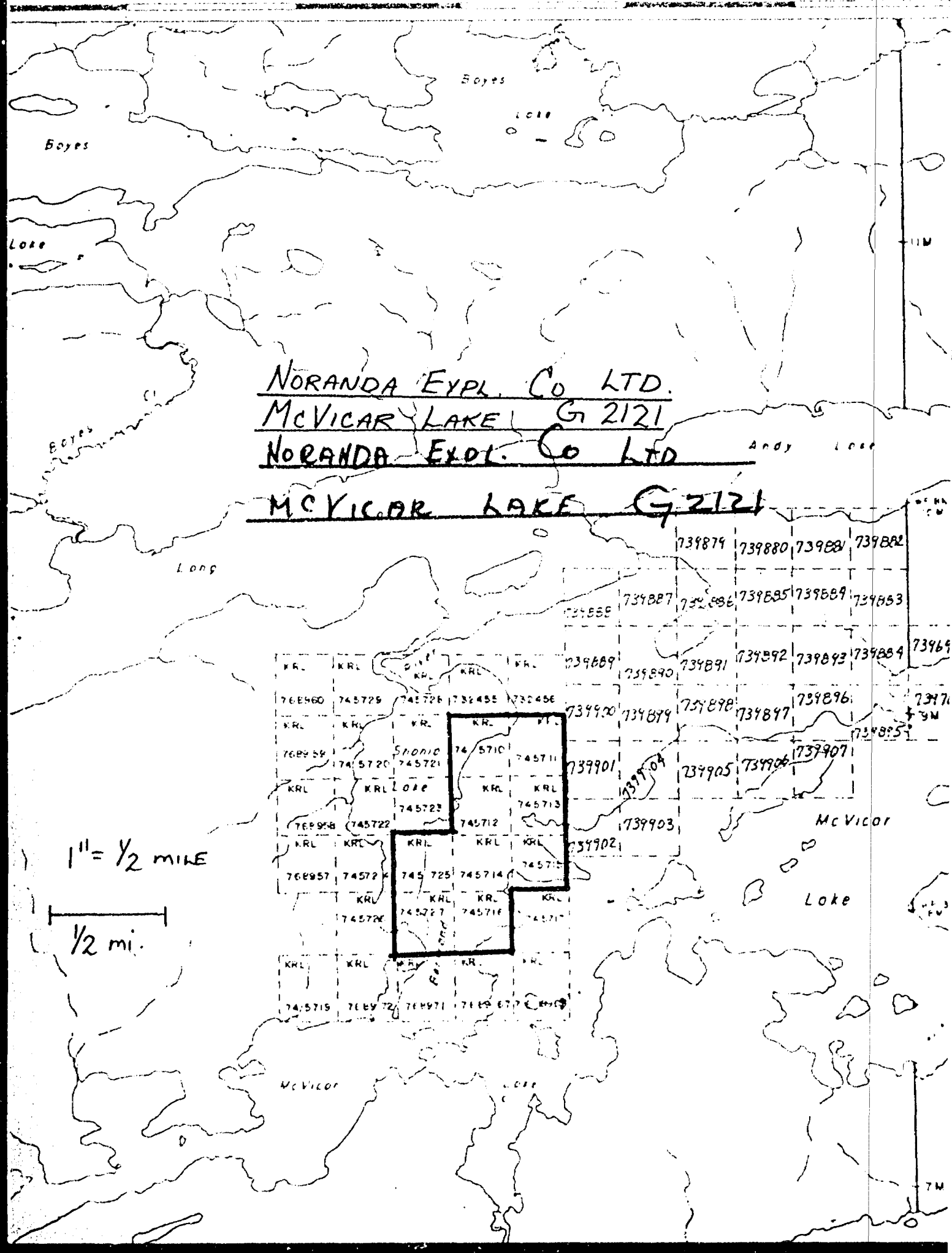

NORANDA EXPL. CO. LTD.  
McVICAR LAKE G 2121  
NORANDA EXPL. CO. LTD.

McVICAR LAKE G 2121

1" = 1/2 mile

1/2 mi.

|        |        |        |        |        |        |        |        |        |
|--------|--------|--------|--------|--------|--------|--------|--------|--------|
| KRL    | KRL    | KRL    | KRL    | KRL    | 739879 | 739880 | 739881 | 739882 |
| 768460 | 745725 | 745726 | 732455 | 732456 | 739887 | 739888 | 739889 | 739890 |
| KRL    | KRL    | KRL    | KRL    | KRL    | 739891 | 739892 | 739893 | 739894 |
| 768459 | 745720 | 745721 | 745710 | 745711 | 739895 | 739896 | 739897 | 739898 |
| KRL    | KRL    | KRL    | KRL    | KRL    | 739899 | 739900 | 739901 | 739902 |
| 768458 | 745722 | 745723 | 745712 | 745713 | 739903 | 739904 | 739905 | 739906 |
| KRL    | KRL    | KRL    | KRL    | KRL    | 739907 | 739908 | 739909 | 739910 |
| 768457 | 745724 | 745725 | 745714 | 745715 | 739911 | 739912 | 739913 | 739914 |
| KRL    | KRL    | KRL    | KRL    | KRL    | 739915 | 739916 | 739917 | 739918 |
| 745719 | 768472 | 768471 | 768470 | 768469 | 739919 | 739920 | 739921 | 739922 |



Ministry of  
Natural  
Resources

# Report of Work

(Geophysical, Geological,  
Geochemical and Expenditures)

The Mining Act

Instructions:

- Please type or print
- If number of mining claims covered exceeds space in this form attach a separate sheet.
- Only days credits calculated in the "Expenditure Days Credits" section may be entered in the "Expenditure Days Credits" column.
- Do not use shaded areas below.

Oct. 2nd.

#84-52

27219

F. MATTHEWS

|  |   |                            |                   |
|--|---|----------------------------|-------------------|
| Type of Survey                                       | Geological Mapping  | Township of Area           | McVicar Lake Area |
| Claim Holder(s)                                      | Noranda Exploration Company, Limited                      | Prospector's Licence No.   | A34387            |
| Address  | P.O. Box 2656, THUNDER BAY, Ontario P7B 5G2               |                            |                   |
| Survey Company                                       | Noranda Exploration Company, Limited                      | Date of Survey (from & to) | 09 07 84 23 07 84 |
| Name and Address of Author (of Geo-Technical report) | Ian A. Perry, P.O. Box 2656, THUNDER BAY, Ontario P7B 5G2 |                            |                   |

Credits Requested per Each Claim in Columns at right

Mining Claims Traversed (List in numerical sequence)

| Special Provisions  | Geophysical     | Days per Claim |
|---|-----------------|----------------|
| For first survey:<br>Enter 40 days. (This includes line cutting)                | Electromagnetic |                |
|   | Magnetometer    |                |
|   | Radiometric     |                |
|   | Other           |                |
| For each additional survey:<br>using the same grid:<br>Enter 20 days (for each) | Geological      | 20             |
|   | Geochemical     |                |
| Man Days  | Geophysical     | Days per Claim |
| Complete reverse side and enter total(s) here                                   | Electromagnetic |                |
|   | Magnetometer    |                |
|   | Radiometric     |                |
|   | Other           |                |
|   | Geological      |                |
|   | Geochemical     |                |
| Airborne Credits  | Geophysical     | Days per Claim |
| Note: Special provisions credits do not apply to Airborne Surveys.              | Electromagnetic |                |
|   | Magnetometer    |                |
|   | Radiometric     |                |

| Mining Claim | Expend. Days Cr. | Mining Claim | Expend. Days Cr. |
|--------------|------------------|--------------|------------------|
| Prefix       | Number           | Prefix       | Number           |
| KRL.         | 745710           |              |                  |
|              | 745711           |              |                  |
|              | 745712           |              |                  |
|              | 745713           |              |                  |
|              | 745714           |              |                  |
|              | 745715           |              |                  |
|              | 745716           |              |                  |
|              | 745725           |              |                  |
|              | 745727           |              |                  |

RECEIVED  
OCT 11 1984

RED LAKE  
MINING DIV.  
RECEIVED  
AUG - 3 1984  
A.M. 7-8 9-10-11-12 1-2-3 4-5-6

Expenditures (excludes power stripping)

Type of Work Performed

Performed on Claim(s)

Calculation of Expenditure Days Credits

Total Expenditures  + 15 =

Total Days Credits

Instructions:  
Total Days Credits may be apportioned at the claim holder's choice. Enter number of days credits per claim selected in columns at right.

Total number of mining claims covered by this report of work.

9

Date August 2, 1984

Recorded Holder or Agent's Signature: Ian A. Perry

For Office Use Only

Total Days Cr. Crs. Recorded 180

Received Aug 3/84

Miner's Record

Signature: Ian A. Perry

Certification Verifying Report of Work

I hereby certify that I have a personal and intimate knowledge of the facts set forth in the Report of Work annexed hereto, having performed the work or witnessed same during and/or after its completion and the annexed report is true.

Name and Postal Address of Person Certifying: Ian A. Perry, P.O. Box 2656, Thunder Bay, Ontario P7B 5G2

Date Certified August 2, 1984

Certified by (Signature): Ian A. Perry

REPORT OF WORK

Report of Work

84-55

GEOLOGICAL

Geophysical I.M. (V.M.)

Noranda Exploration Company, Limited

P.O. Box 2656, THUNDER BAY, Ontario P7E 5G2

Noranda Exploration Company, Limited

Don Carriere, P.O. Box 2656, Thunder Bay, Ontario P7E 5G2

Don Carriere, P.O. Box 2656, Thunder Bay, Ontario P7E 5G2

Don Carriere, P.O. Box 2656, Thunder Bay, Ontario P7E 5G2

Don Carriere, P.O. Box 2656, Thunder Bay, Ontario P7E 5G2

Don Carriere, P.O. Box 2656, Thunder Bay, Ontario P7E 5G2

Don Carriere, P.O. Box 2656, Thunder Bay, Ontario P7E 5G2

Don Carriere, P.O. Box 2656, Thunder Bay, Ontario P7E 5G2

Don Carriere, P.O. Box 2656, Thunder Bay, Ontario P7E 5G2

Don Carriere, P.O. Box 2656, Thunder Bay, Ontario P7E 5G2

Don Carriere, P.O. Box 2656, Thunder Bay, Ontario P7E 5G2

Don Carriere, P.O. Box 2656, Thunder Bay, Ontario P7E 5G2

Don Carriere, P.O. Box 2656, Thunder Bay, Ontario P7E 5G2

Don Carriere, P.O. Box 2656, Thunder Bay, Ontario P7E 5G2

Don Carriere, P.O. Box 2656, Thunder Bay, Ontario P7E 5G2

Don Carriere, P.O. Box 2656, Thunder Bay, Ontario P7E 5G2

Don Carriere, P.O. Box 2656, Thunder Bay, Ontario P7E 5G2

Don Carriere, P.O. Box 2656, Thunder Bay, Ontario P7E 5G2

Don Carriere, P.O. Box 2656, Thunder Bay, Ontario P7E 5G2

Don Carriere, P.O. Box 2656, Thunder Bay, Ontario P7E 5G2

Don Carriere, P.O. Box 2656, Thunder Bay, Ontario P7E 5G2

Don Carriere, P.O. Box 2656, Thunder Bay, Ontario P7E 5G2

Don Carriere, P.O. Box 2656, Thunder Bay, Ontario P7E 5G2

Don Carriere, P.O. Box 2656, Thunder Bay, Ontario P7E 5G2

Don Carriere, P.O. Box 2656, Thunder Bay, Ontario P7E 5G2

Don Carriere, P.O. Box 2656, Thunder Bay, Ontario P7E 5G2

Don Carriere, P.O. Box 2656, Thunder Bay, Ontario P7E 5G2

Don Carriere, P.O. Box 2656, Thunder Bay, Ontario P7E 5G2

Don Carriere, P.O. Box 2656, Thunder Bay, Ontario P7E 5G2

Don Carriere, P.O. Box 2656, Thunder Bay, Ontario P7E 5G2

Don Carriere, P.O. Box 2656, Thunder Bay, Ontario P7E 5G2

Don Carriere, P.O. Box 2656, Thunder Bay, Ontario P7E 5G2

Don Carriere, P.O. Box 2656, Thunder Bay, Ontario P7E 5G2

Don Carriere, P.O. Box 2656, Thunder Bay, Ontario P7E 5G2

Don Carriere, P.O. Box 2656, Thunder Bay, Ontario P7E 5G2

Don Carriere, P.O. Box 2656, Thunder Bay, Ontario P7E 5G2

Don Carriere, P.O. Box 2656, Thunder Bay, Ontario P7E 5G2

Don Carriere, P.O. Box 2656, Thunder Bay, Ontario P7E 5G2

Don Carriere, P.O. Box 2656, Thunder Bay, Ontario P7E 5G2

Don Carriere, P.O. Box 2656, Thunder Bay, Ontario P7E 5G2

Don Carriere, P.O. Box 2656, Thunder Bay, Ontario P7E 5G2

Don Carriere, P.O. Box 2656, Thunder Bay, Ontario P7E 5G2

Don Carriere, P.O. Box 2656, Thunder Bay, Ontario P7E 5G2

MINISTRY OF NATURAL RESOURCES  
RECEIVED

OCT 02 1984

RESIDENT GEOLOGIST, RED LAKE

180

AUG 3/84

KRL 745710

AUGUST 2, 1984

August 2, 1984

Certification Verifies Report of Work

I hereby certify that I have a personal and intimate knowledge of the work reported in the Report of Work and that the work was done during and/or after the period of time stated in the Report of Work.

Signature of Person Certifying

Don Carriere, P.O. Box 2656, Thunder Bay, Ontario P7E 5G2

DON CARRIERE, P.O. BOX 2656, THUNDER BAY  
P7E 5G2

August 2, 1984



Ministry of  
Natural  
Resources  
Ontario

Technical Assessment  
Work Credits

File  
2.7219

Date  
1984 11 15

Mining Recorder's Report of  
Work No. 84-52, 84-55

Recorded Holder

NORANDA EXPLORATION COMPANY, LIMITED

Township or Area

McVICAR LAKE AREA

| Type of survey and number of<br>Assessment days credit per claim  | Mining Claims Assessed               |
|---|--------------------------------------|
| <b>Geophysical</b><br>Electromagnetic _____ 20 _____ days<br>Magnetometer _____ days<br>Radiometric _____ days<br>Induced polarization _____ days<br>Other _____ days<br><br>Section 77 (19) See "Mining Claims Assessed" column<br><br>Geological _____ 20 _____ days<br>Geochemical _____ days<br><br>Man days <input type="checkbox"/> Airborne <input type="checkbox"/><br>Special provision <input checked="" type="checkbox"/> Ground <input checked="" type="checkbox"/><br><br><input type="checkbox"/> Credits have been reduced because of partial<br>coverage of claims.<br><br><input type="checkbox"/> Credits have been reduced because of corrections<br>to work dates and figures of applicant. | KRL 745711 to 16 inclusive<br>745727 |

Special credits under section 77 (16) for the following mining claims

10 DAYS ELECTROMAGNETIC  
10 DAYS GEOLOGICAL  
KRL 747510  
745725

No credits have been allowed for the following mining claims

☐ not sufficiently covered by the survey ☐ Insufficient technical data filed

The Mining Recorder may reduce the above credits if necessary in order that the total number of approved assessment days recorded on each claim does not exceed the maximum allowed as follows: Geophysical — 80; Geological — 40; Geochemical — 40; Section 77(19) — 60;



Ministry of  
Natural  
Resources

*Not 30/84*

1984 11 15

Your File: 84-52, 84-55  
Our File: 2.7219

Mining Recorder  
Ministry of Natural Resources  
Ontario Government Building  
Box 324  
Red Lake, Ontario  
POV 2M0

Dear Sir:

Enclosed are two copies of a Notice of Intent with statements listing a reduced rate of assessment work credits to be allowed for a technical survey. Please forward one copy to the recorded holder of the claims and retain the other. In approximately fifteen days from the above date, a final letter of approval of these credits will be sent to you. On receipt of the approval letter, you may then change the work entries on the claim record sheets.

For further information, if required, please contact  
Mr. R.J. Pichette at 416/965-4888.

Yours sincerely,

*S.E. Yundt*  
S.E. Yundt  
Director  
Land Management Branch

Ministry Bldg., Room 1013  
Queen's Park  
Toronto, Ontario  
M7A 1W3

D. Isherwood:mc

Encls.

cc: Noranda Exploration Company, Limited  
P.O. Box 2656  
Thunder Bay, Ontario  
P7B 5G2  
Attention: Don Carriere

cc: Mr. G.H. Ferguson  
Mining & Lands Commissioner  
Toronto, Ontario

cc: Noranda Exploration Company, Limited  
Suite 400  
55 Yonge Street  
Toronto, Ontario  
M5E 1J4

845



Ministry of  
Natural  
Resources

Notice of Intent  
for Technical Reports

1984 11 15

2.7219/84-52, 84-55

An examination of your survey report indicates that the requirements of The Ontario Mining Act have not been fully met to warrant maximum assessment work credits. This notice is merely a warning that you will not be allowed the number of assessment work days credits that you expected and also that in approximately 15 days from the above date, the mining recorder will be authorized to change the entries on his record sheets to agree with the enclosed statement. Please note that until such time as the recorder actually changes the entry on the record sheet, the status of the claim remains unchanged.

If you are of the opinion that these changes by the mining recorder will jeopardize your claims, you may during the next fifteen days apply to the Mining and Lands Commissioner for an extension of time. Abstracts should be sent with your application.

If the reduced rate of credits does not jeopardize the status of the claims then you need not seek relief from the Mining and Lands Commissioner and this Notice of Intent may be disregarded.

If your survey was submitted and assessed under the "Special Provision-Performance and Coverage" method and you are of the opinion that a re-appraisal under the "Man-days" method would result in the approval of a greater number of days credit per claim, you may, within the said fifteen day period, submit assessment work breakdowns listing the employees names, addresses and the dates and hours they worked. The new work breakdowns should be submitted direct to the Land Management Branch, Toronto. The report will be re-assessed and a new statement of credits based on actual days worked will be issued.

2.7219

[illegible]



Noranda Exploration Company, Limited  
(no personal liability)  
P.O. Box 2658  
Thunder Bay, Ontario P7B 5G2

**noranda**

Telephone (807) 623-4339  
Telex 073-4659

September 24, 1984

Lands Administration Branch  
Ministry of Natural Resources  
Room 6450, Whitney Block  
Queen's Park  
Toronto, Ontario  
M5A 1W3

Attention: Mr. E. F. Anderson

Dear Mr. Anderson:

Please find enclosed Report of Work and Pink  
Technical Data Statement in duplicate for the Geological  
survey which was done on the Shonia Lake Property covering  
claims KRL745710 et al.

Yours truly,

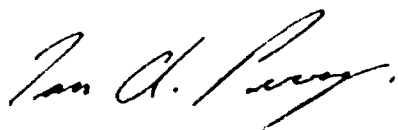

I. D. Perry  
Project Geologist-Red Lake  
Northwestern Ontario Division

RECEIVED

SEP 27 1984  
MINING LANDS SECTION

IP:js

c. c. F. Tergie  
C. S. Wallis  
File 1332

Enclosure

Noranda Exploration Company, Limited

(no personal liability)

P.O. Box 2658

Thunder Bay, Ontario P7B 5G2

**noranda**

Telephone (807) 623-4339

Telex 073-4659

September 24, 1984

Lands Administration Branch  
Ministry of Natural Resources  
Room 6450, Whitney Block  
Queen's Park  
Toronto, Ontario  
M5A 1H7

MSA /W3

Attention: Mr. E. F. Anderson

Dear Mr. Anderson:

Please find enclosed Report of Work and Pink Technical Data Statement in duplicate for the VLF-EM surveys which were done on the Shonia Property and Jarrow Lake Project covering claims KRL745710 et al.

Yours truly,

*D. R. Carriere*

D. R. Carriere  
Division Geophysicist  
Northwestern Ontario Division

DRC:js

c. c. F. Tergie  
C. S. Wallis  
File 1332

ENCLOSURE

RECEIVED

SEP 25 1984

MINING LANDS SECTION

1984 10 10

Your File:  
Our File : 2.7219

Mining Recorder  
Ministry of Natural Resources  
Ontario Government Building  
Box 5003  
Red Lake, Ontario  
POV 2M0

Dear Sir:

We received reports and maps on September 25, 1984 submitted for a Geophysical (Electromagnetic) and Geological Survey submitted under Special Provisions (credit for Performance and Coverage) on Mining Claims KRL 745710 et al in the Area of McVicar Lake.

This material will be examined and assessed and a statement of assessment work credits will be issued.

We do not have a copy of the report of work which is normally filed with you prior to the submission of this submitted data. Please forward a copy as soon as possible.

Yours sincerely,

S.E. Yundt  
Director  
Land Management Branch

Whitney Block, Room 6643  
Queen's Park  
Toronto, Ontario  
M7A 1W3  
Phone:(416)965-6918

A. Barr:sc

cc: Noranda Exploration Company, Limited  
P.O. Box 2656  
Thunder Bay, Ontario  
P7B 5G2  
Attn: J. Perry  
D.R. Carriere

Noranda Exploration Company, Limited  
Suite 400  
55 Yonge Street  
Toronto, Ontario  
M5E 1J4

Your File: 84-621

Our File: 2.7219

October 30, 1984

Noranda Exploration Company, Limited  
P.O. Box 2656  
Thunder Bay, Ontario  
P7B 5G2

Attention: Don Carriere

Dear Sir:

RE: Geophysical (Electromagnetic) Survey on Mining  
Claims KRL-745710 et al in the Area of  
McVicar Lake

---

Enclosed are the V.L.F. plans, in duplicate, for the  
above-mentioned survey. Please indicate the actual  
readings on the plans and return them to this office.

Sincerely yours,

S.E. Yundt  
Director  
Land Management Branch

Whitney Block, Room 6643  
Queen's Park  
Toronto, Ontario  
M7A 1W3

D. Kinvig:lg

cc: Noranda Exploration Company, Limited  
Suite 400  
55 Yonge Street  
Toronto, Ontario  
M5E 1J4

cc: Mining Recorder  
Red Lake, Ontario  
File #84-55

Noranda Exploration Company, Limited  
(no personal liability)  
P.O. Box 2658  
Thunder Bay, Ontario P7B 5G2

**noranda**

Telephone (807) 623-4339  
Telex 073-4659

NOV 1 1984

PURULATOR

Land Management Branch  
Ministry of Natural Resources  
Whitney Block, Room 6643  
Queen's Park  
Toronto, Ontario  
M7A 1W3

Attention: S. E. Yundt

Dear Miss Yundt:

RE: Your file 2.7219

With respect to your letter of October 30, 1984  
please find enclosed two copies of the VLF plans with the  
raw data plotted on them as requested.

Yours truly,

NORANDA EXPLORATION COMPANY, LIMITED  
(no personal liability)



D. R. Carriere  
Division Geophysicist  
Northwestern Ontario Division

DRC:js

c.c. F. Tergie  
C. S. Wallis  
File 1332

Enclosures



Ministry of  
Natural  
Resources

1984 12 14

Your File: 84-52, 84-55  
Our File: 2.7219

Mining Recorder  
Ministry of Natural Resources  
Ontario Government Building  
Box 5003  
Red Lake, Ontario  
POV 2M0

Dear Sir:

RE: Notice of Intent dated November 15, 1984.  
Geophysical (Electromagnetic) and Geological  
Surveys on Mining Claims KRL 745710 et al in  
the Area of McVicar Lake.

The assessment work credits, as listed with the  
above-mentioned Notice of Intent, have been approved  
as of the above date.

Please inform the recorded holder of these mining  
claims and so indicate on your records.

Yours sincerely,

A handwritten signature in dark ink, appearing to read "S.E. Yundt".

S.E. Yundt  
Director  
Land Management Branch

Whitney Block, Room 6643  
Queen's Park  
Toronto, Ontario  
M7A 1W3  
Phone: (416) 965-6918

*RD* D. Isherwood:sc

cc: Noranda Exploration Company, Limited  
Suite 400  
55 Yonge Street  
Toronto, Ontario  
M5E 1J4

cc: Mr. G.H. Ferguson  
Mining & Lands Commissioner  
Toronto, Ontario

Noranda Exploration Company, Limited  
P.O. Box 2656  
Thunder Bay, Ontario  
P7B 5G2

cc: Resident Geologist  
Red Lake, Ontario

SEE ACCOMPANYING  
MAP(S) IDENTIFIED AS

52φ/11SW-0027 # 1-3

LOCATED IN THE MAP  
CHANNEL IN THE  
FOLLOWING SEQUENCE

(X)

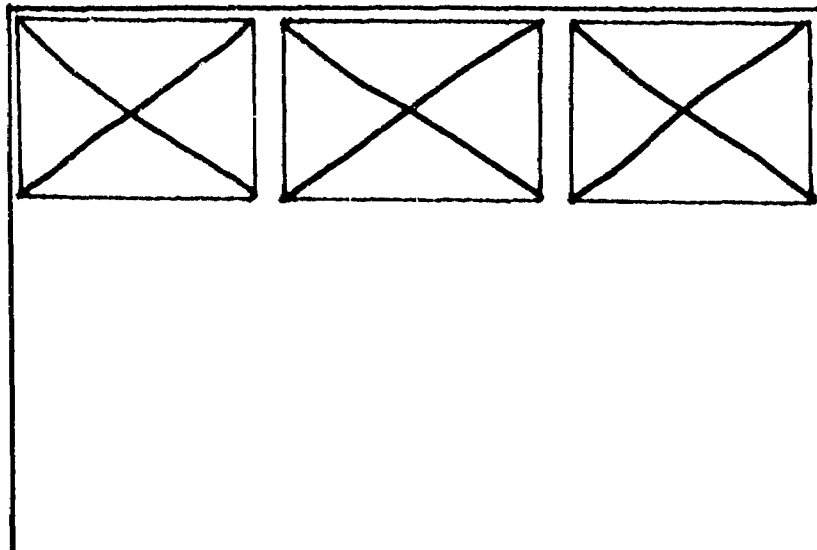





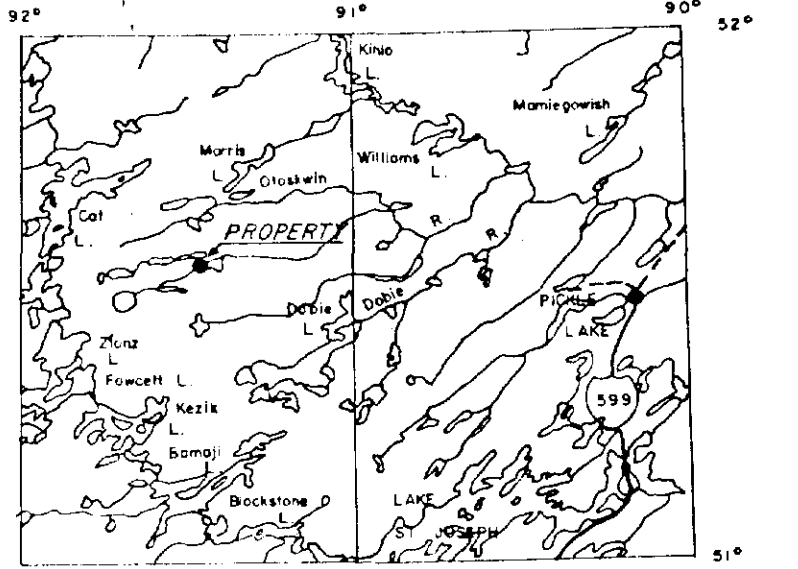

LOCATION MAP  
1:1,600,000

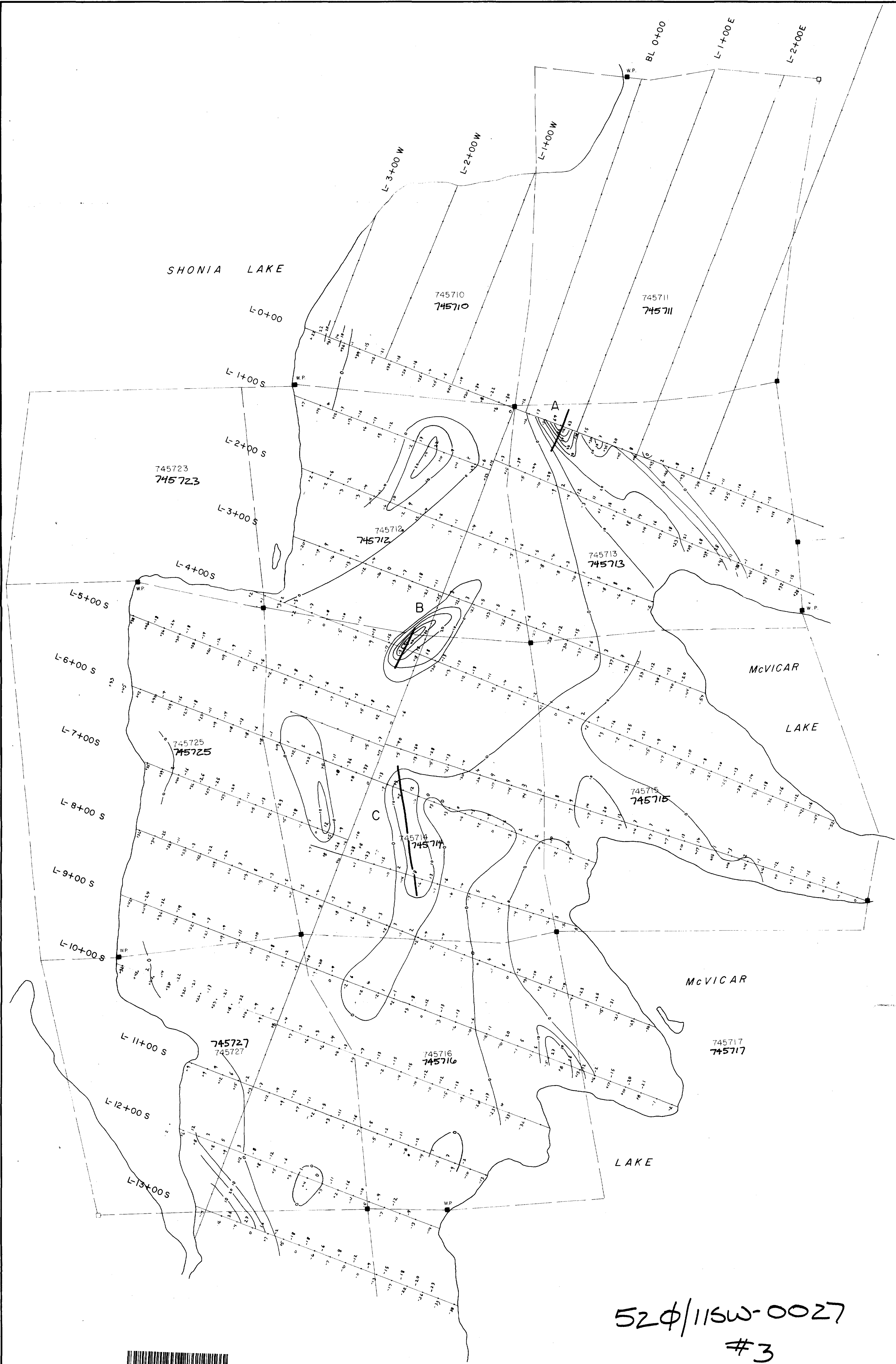

LEGEND

INSTRUMENT: GEONICS  
TRANSMITTER: ANNAPOLIS  
FRASER RIVER CONTOUR INTERVAL  
10, 20, 30, 40, 50, 60

1 cm = 25 m

REVISED

27219  
D. R. Carrere 2.7219  
EAST, WEST GRID dup

VLF SURVEY  
FRAZER FILTER

|                              |          |
|------------------------------|----------|
| PROJECT                      | SHONIA   |
| PROJ#                        | 1332     |
| NTS                          | 520/11   |
| DWG#                         | NE       |
| Surveyed by                  | Date     |
| Drawn by                     | R. KRUSE |
| Scale                        | 1:2500   |
| <b>noranda</b>               |          |
| NORANDA EXPLORATION CO. LTD. |          |

520/11SW-0027  
#3



52011SW0027 52011SW0027 MCVICAR LAKE

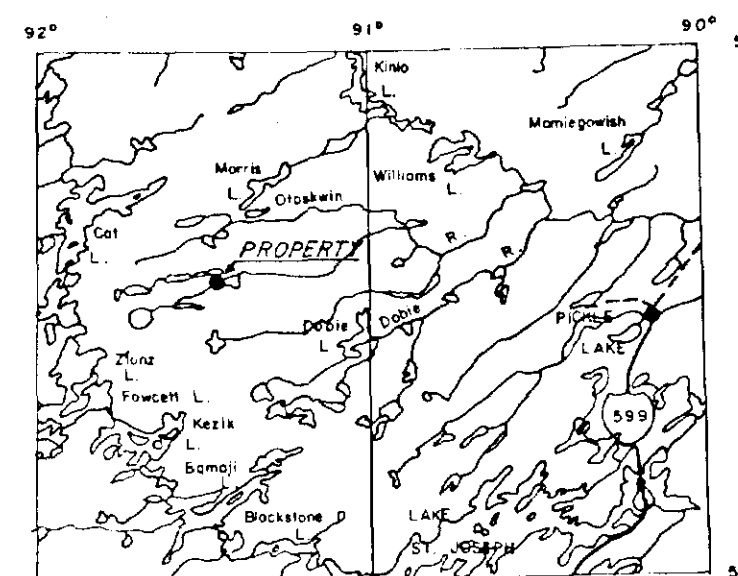

LOCATION MAP  
1:1,000,000



LEGEND

INSTRUMENT: GEONICS  
TRANSMITTER: SEATTLE WASH.  
FRAZER RIVER CONTOUR INTERVAL  
10, 20, 30, 40, 50, 60, 70, 80

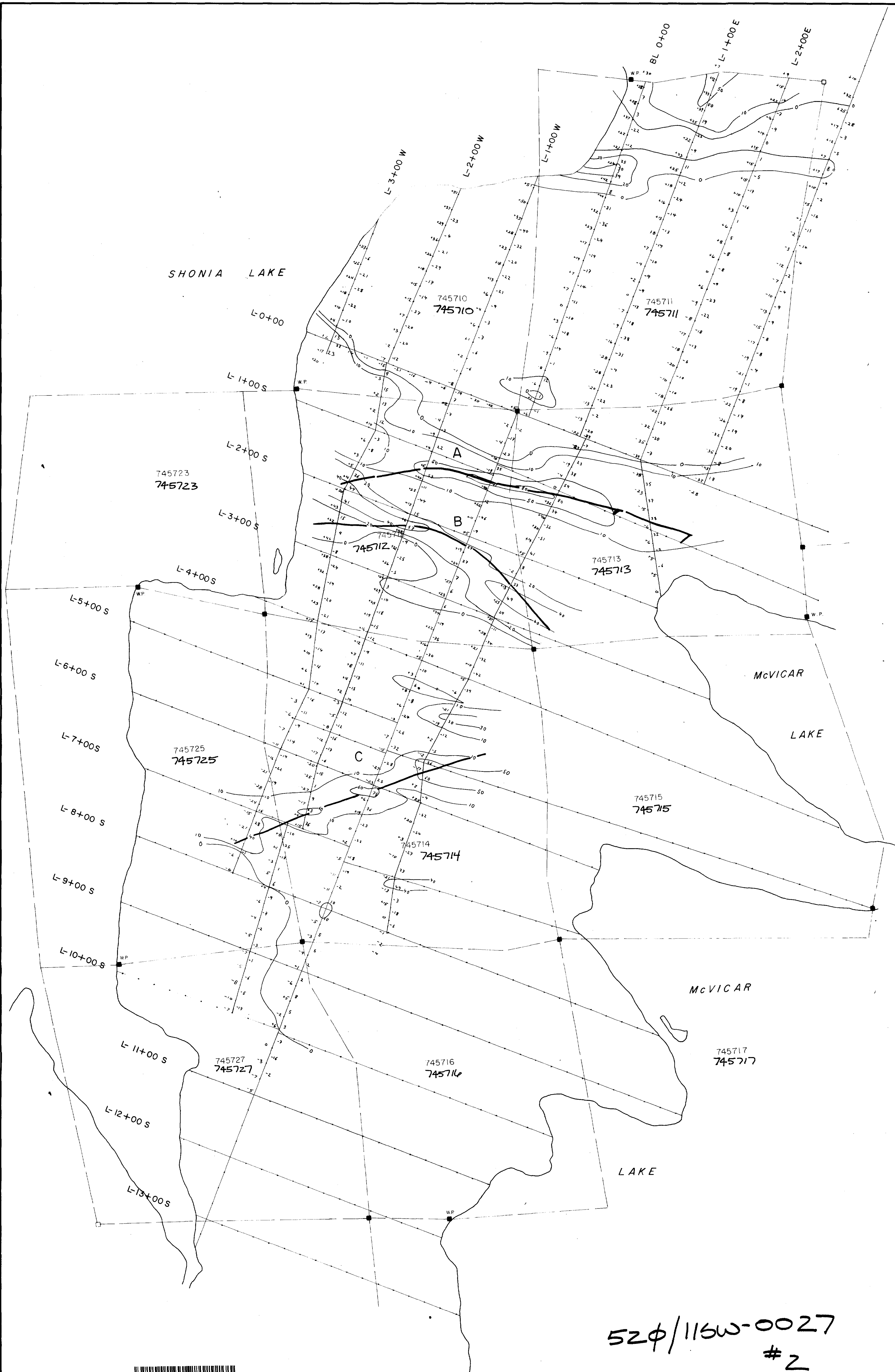

27219  
27219  
1cm = 25m  
NORTH, SOUTH GRID

|                              |                                   |
|------------------------------|-----------------------------------|
| REVISED                      | VLF SURVEY<br>FRAZER FILTER       |
| PROJECT SHONIA               |                                   |
| PROJ. 1332                   | Date                              |
| NTS 520/11                   | Surveyed by R. KRUSE Scale 1:2500 |
| DWG. 11                      |                                   |
| noranda                      |                                   |
| NORANDA EXPLORATION CO. LTD. |                                   |

