



53B09NW0014 2 15732 SKINNER LAKE

010

2. 15732

PANGEA GOLDFIELDS INC.

**GEOLOGICAL AND SAMPLING PROGRAM
JULY, 1994**

**OPAPIMISKAN LAKE PROPERTY
LAT: 52° 41', LONG: 00° 26'**

NORTHWESTERN ONTARIO

**Thunder Bay, Ontario
NOVEMBER 14, 1994**

**SUBMITTED BY:
M. P. LEWIS GEOLOGICAL SERVICES**



53B09NW0014 2 15732 SKINNER LAKE

010C

TABLE OF CONTENTS

	Page
1.0 INTRODUCTION	1
2.0 LOCATION, SIZE AND ACCESS	1
3.0 PROPERTY SUMMARY AND CLAIM DISPOSITION	4
4.0 PREVIOUS WORK	4
5.0 REGIONAL GEOLOGY AND METALLOGENY	4
6.0 PROPERTY GEOLOGY AND MINERALIZATION	3
7.0 1995 PROGRAM	7
8.0 PROPOSED 1995 EXPLORATION PROGRAM	9
REFERENCES	10

LIST OF FIGURES

FIGURE 1	PROPERTY LOCATION	2
FIGURE 2	CLAIM SKETCH	3
FIGURE 3	GOLD DEPOSITS: OPAP LAKE AREA	6
FIGURE 4	SAMPLE LOCATION	8

LIST OF TABLES

TABLE 1	SCHEDULE OF CLAIMS	2
----------------	---------------------------	----------

LIST OF APPENDIX

APPENDIX 1	STATEMENT OF QUALIFICATIONS	11
APPENDIX 2	CERTIFICATES OF ANALYSIS	12

1.0 INTRODUCTION

The Opapimiskan Lake property is 100% wholly owned by Pangea Goldfields Inc. and is located some 0.25 miles north of the northshore of Opapimiskan Lake and 75 miles north of the community of Pickle Lake in Northwestern Ontario. The 55 claim unit property adjoins Placer Dome's Mussellwhite property to the north. The latter property is currently being subjected to an in-depth feasibility study in an attempt to define a mineable gold reserve.

During the period July 28th-31st, 1994 a short reconnaissance geological and sampling program was carried out on Pangea's Opapimiskan Lake property. The purpose of the survey was to familiarize Pangea's personal with the geology of the property and its style of mineralization. A total of 5 samples were collected from a number of different rock lithologies and analyzed for gold by Spectrolab Inc. of Rouyn-Noranda, Quebec. The highest gold value was 0.042 ppm from the main banded iron formation. All remaining samples contained <0.005 ppm gold.

A program of HLEM geophysics and diamond drilling is expected to be carried out during the winter of 1995.

2.0 LOCATION, SIZE AND ACCESS

The Opapimiskan Lake property is situated 75 miles north-northwest of the community of Pickle Lake in Northwestern Ontario (Lat. 52° 41' N, Long. 00° 26' W) Figure 1.

The property is comprised of 55 contiguous mining claims located in the Patricia Mining Division Figure 2.

Summer and winter access is best gained by float or ski-equipped fixed-wing aircraft to the northend of Opapimiskan Lake from Pickle Lake or Weagamow Lake. Winter access is also obtainable via a 30 km winter road from Highway 908 to Placer's Mussellwhite deposits.

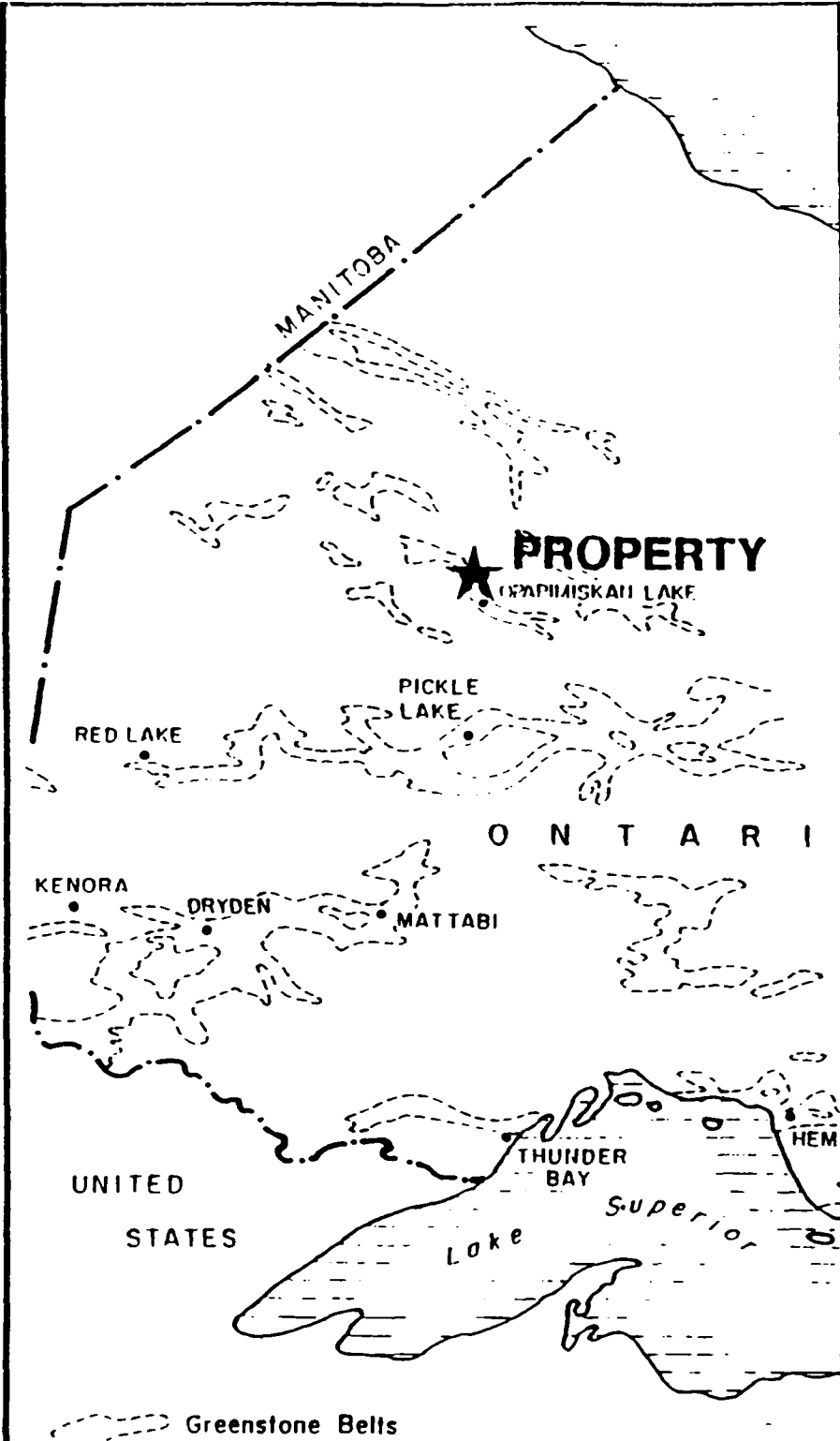
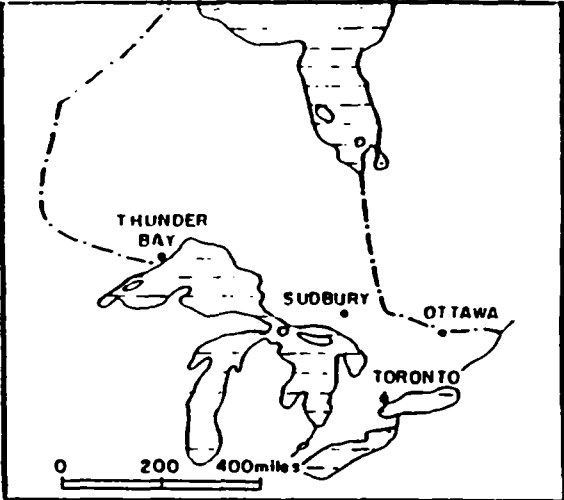

PANGEA GOLDFIELDS INC.

**OPAPIMISKAN LAKE PROPERTY
LOCATION MAP**

SCALE 1" = 100Mi DATE: DEC/94

FIGURE 1

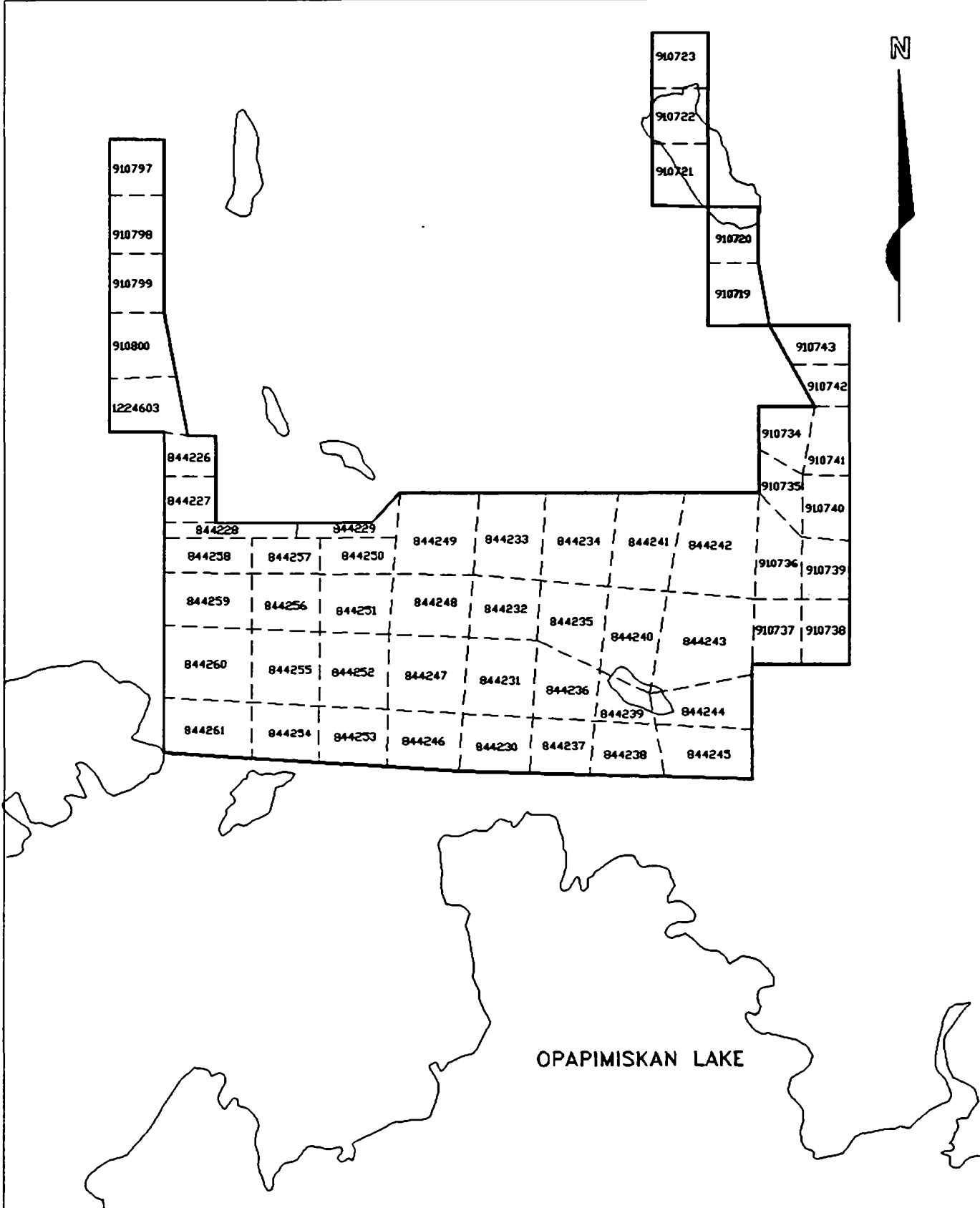

PANGEA GOLDFIELDS INC.
OPAPIMISKAN LAKE PROPERTY
CLAIM SKETCH



FIG 2

The mining claims that make up Pangea's 100% wholly owned Opapimiskan lake property are recorded on claim map G-2210 (Skinner lake). Claim numbers and recording dates are listed as Table 1.

TABLE I: SCHEDULE OF CLAIMS

CLAIM #	NO. OF UNITS	RECORDING DATE
844226-844229	4	July 16, 1985
844230-844261	32	August 22, 1985
910719-910723	5	November 27, 1986
910734-910743	10	November 27, 1986
910797-910800	4	November 27, 1986
1224603	1	August 30, 1994
TOTAL	55	

4.0 PREVIOUS WORK

All previous work has been well documented in earlier assessment submissions which are references at the back of this report. The most recent work include geological mapping, prospecting, stripping and channel sampling by Power Explorations Inc. in 1987 and a 28,819 foot diamond drill program (59 drill holes) also by Power Exploration during the period August, 1987 to January, 1988.

5.0 REGIONAL GEOLOGY AND MINERALIZATION

The property is situated in the southeastern portion of the North Caribou Lake Greenstone Belt of the Sachigo Subprovince. Previous workers have described the North Caribou Lake belt as an arcuate, hornshaped assemblage of metavolcanic and metasedimentary rocks extending from Weagamow Lake in the northwest to Opapimiskan Lake in the southwest. The metavolcanic-metasedimentary complex has been folded into a synclinal or basinal structure, with dominantly clastic metasedimentary rocks occupying the core of the syncline (Thurston, 1971). The metasediments are underlain by older mafic volcanics rocks. Two fairly continuous bands of iron formation and chemical sediments occupy the contact between the sediments and the volcanics throughout the belt.

Gold mineralization is spacially associated with and occur as stratigraphic zones within highly folded iron formation. Placer Dome and partner TVX are presently completing a \$12 million feasibility study. Confidence is high that this study will define a mineable inventory of at least 1,000,000 ounces of gold.

6.0 PROPERTY GEOLOGY AND MINERALIZATION

On a regional scale the Opapimiskan Lake property is underlain by a large northwest trending syncline which defines the axis of the North Caribou Lake Belt. A smaller northwest trending anticline is located on the west limb of the syncline near the southeast corner of the claim block. This anticline is outlined by bands of oxide facies iron formation which has been traced south where it plays host to the numerous gold deposits of Placer's Mussellwhite property Figure 3. The fold axis of this anticline trends 320° and plunges 28-31° to the north-northeast. The east limb dips steeply to northeast at 60-65° where as the west limb dips at a shallow angle of 25-30° to the southwest.

The anticline is cored by mafic volcanics and is successively overlain by a thin lower banded iron formation, mafic to ultramafic volcanics and the main iron formation which grades upward into pelitic sediments, followed by a sequence of intercalated mafic flows, pelitic sediments, wackes, and arenites. All units are intruded by numerous narrow lamprophyre dykes and several ultramafic sills (D.J. Corkery, 1989).

Significant gold intersections, which exist in a number of zones, have been encountered from previous drill programs. The most significant gold mineralization is contained in the Axis Zone, which is located in the Upper Iron Formation in the area of the axis of the main anticline. Highest gold intersections consists of 10.26 opt/3.0', 0.71 opt/5.0', 0.50 opt/4.0', and 0.36 opt/ 4.7'. Gold mineralization is normally associated with disseminated pyrrhotite, pyrite and quartz +/- sulphide veins.

PANGEA GOLDFIELDS INC.

GOLD DEPOSITS OPAPIMISKAN LAKE AREA

SCALE : 1:100,000

DATE: DEC/94
FIGURE 3

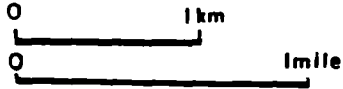

PANGEA'S OPAPIMISKA LAKE PROJECT

LEGEND

- Iron formation.....
- Zone of Au Mineralization.....
- Antiformal axis... +
- Synformal axis.... -
- Shoreline.....

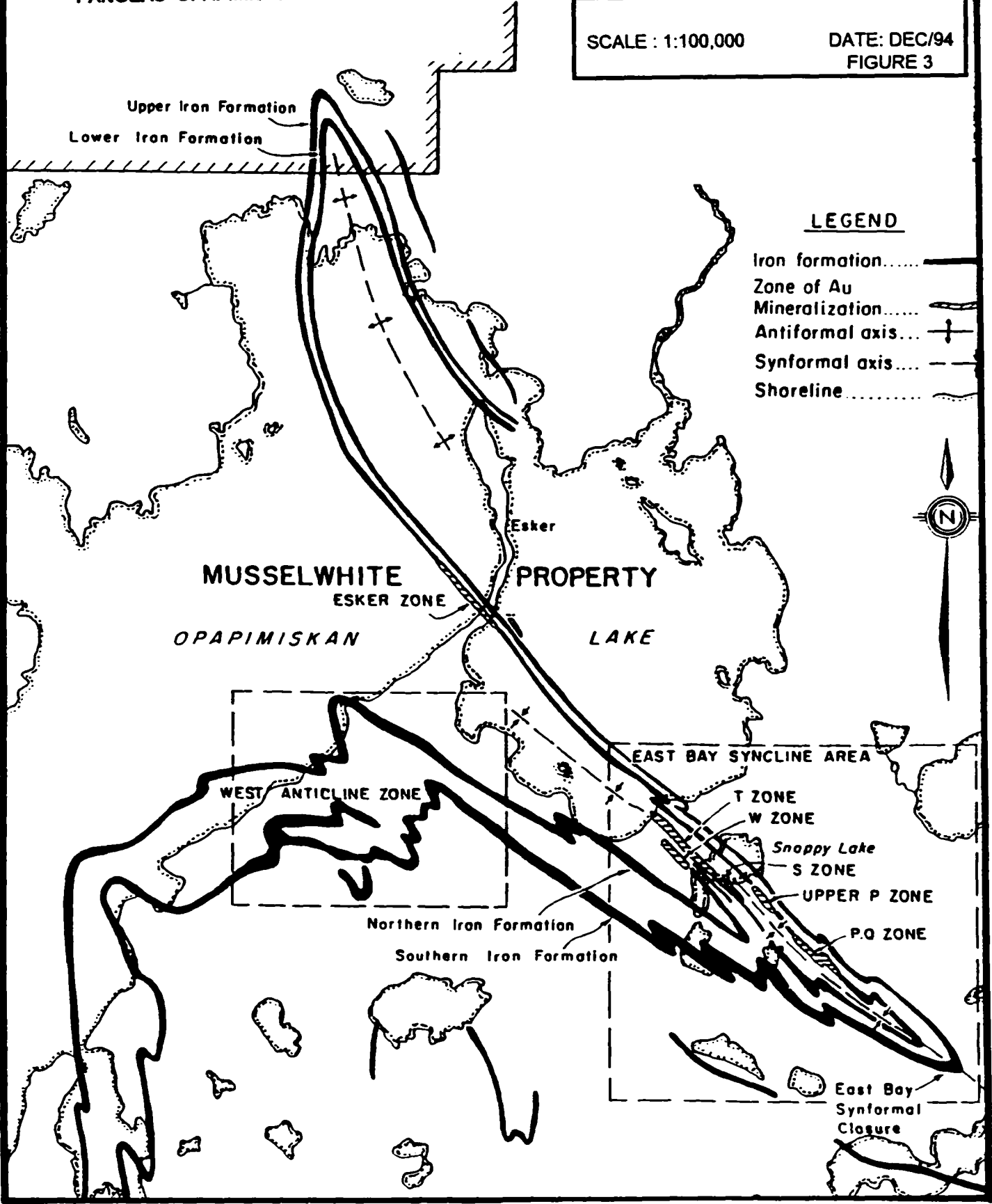

7.0 1994 PROGRAM

During the period July 28th - 31st, 1994 Pangea Goldfields Inc. carried out a short reconnaissance mapping and sampling program on its Opapimiskan Lake property Figure 4. The purpose of this work was to familiarize Pangea's personnel with the geology of the property and its style of mineralization. A total of 5 samples were collected and analyzed for Au by Spectrolab Inc. of Rouyn-Noranda, Quebec. Sample descriptions and analytical results are as follows:

SAMPLE #	TYPE	LOCATION	DESCRIPTION	AU(PPM)
OP94-256	GRAB	980-N, 3375-E	- UNMINERALIZED - GREY TO BLACK - BEDDED PELITE - 10% GARNET	<.005
OP94-257	GRAB	950-N, 3300-E	- MASSIVE - MED GRAINED - GREY GREEN - WACKE - TRACE PYRITE - GRUNERITE?	<.005
OP94-258	GRAB	850-N, 3350-E	- BANDED I.F. - CHERT - MAGNETITE - 10% PO, PY	<.005
OP94-259	GRAB	850-N, 3385-E	- BANDED I.F. - CHERT - MAGNETITE - 10% PO, PY	.042
OP94-260	GRAB	180-N, 4100-E	- ULTRAMAFIC - MASSIVE FLOW OR SILL?	<.005

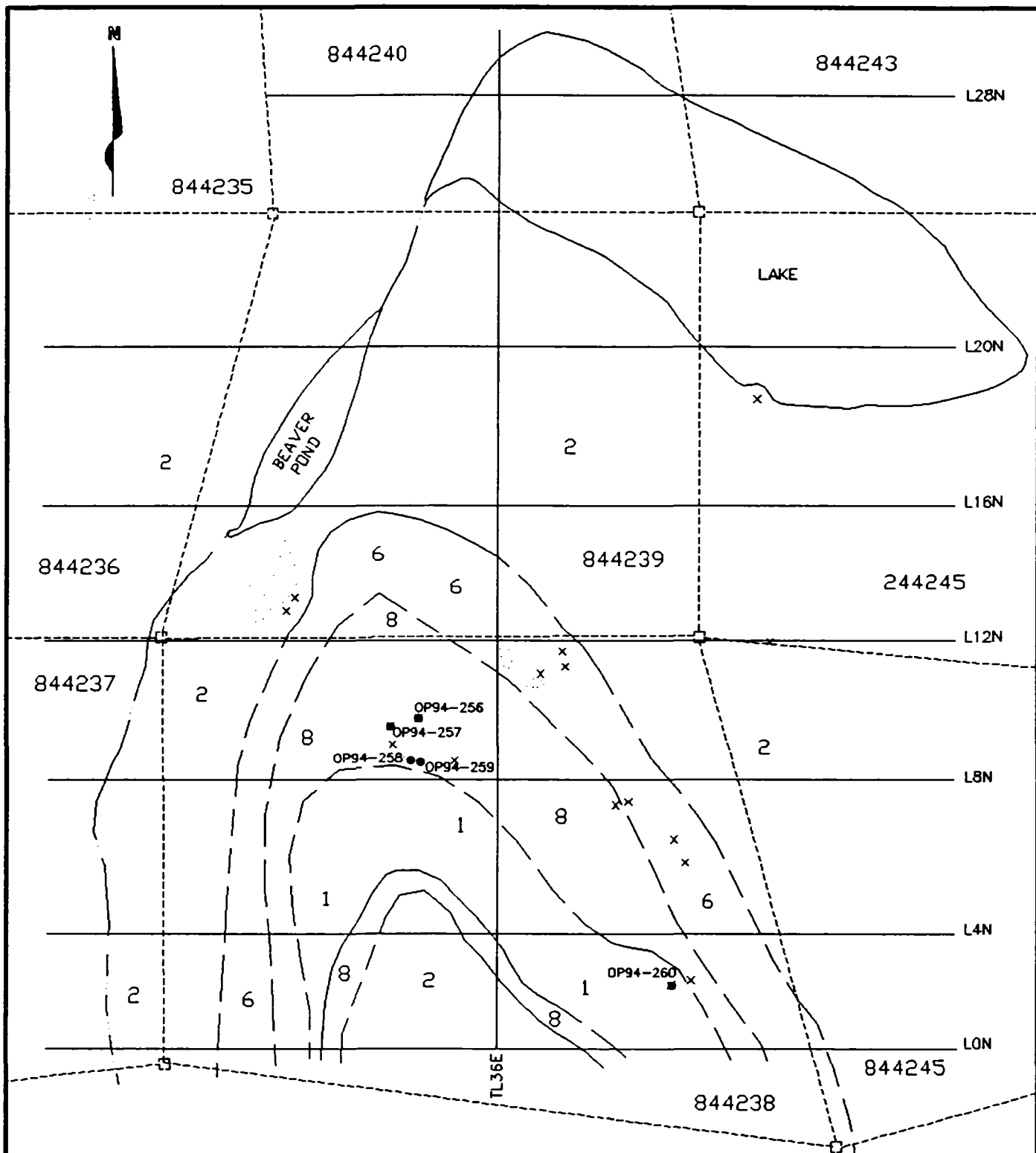

LEGEND

ROCK LITHOLOGIES

- 1 ULTRAMAFIC FLOW/SILL
- 2 MAFIC VOLC
- 6 PELITIC SEDS
- 8 BANDED IF

FEET 1 : 4800

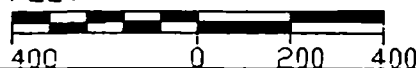

PANGEA GOLDFIELDS INC.
OPAPIMISKAN LAKE PROPERTY

SAMPLE LOCATION

FIGURE 4

8.0 PROPOSED 1995 EXPLORATION PROGRAM

Gold mineralization in the Opapimiskan Lake area occur in stratabound zones that are intimately associated with banded iron formation and in particular pyrrhotite and pyrite replacement zones. Bulk mineable gold mineralization and associated pyrrhotite, pyrite mineralization is susceptible to detection by HLEM or other deeper penetrating geophysical techniques. Such a survey should be carried out over the shallow plunging fold axis, and the east and west limbs of the main anticline.

Diamond drilling should be extended to test the depth extension of the anticlinal fold axis and in particular the dip extension of the east limb of the anticline.

Respectively submitted,



Patrick Lewis

REFERENCES

**Elliott, B.E.
Corkery, D.J., 1998**

**Report on Geological Mapping,
Prospecting and Geochemical Sampling.
Opapimiskan Lake Property**

Corkery, D.J, 1989

**Report on Diamond Drilling.
Opapimiskan Lake Property**

APPENDIX 1

STATEMENT OF QUALIFICATIONS

STATEMENT OF QUALIFICATIONS

I, M. Patrick Lewis, of 269 Chercover Drive, Thunder Bay, Ontario hereby certify that:

1. I am a graduate of Memorial University of Newfoundland (1976), and hold a BSc. degree in geology
2. I am presently employed as a consulting geologist with M.P. Lewis Geological Services, Thunder Bay, Ontario
3. I have been employed in my profession continuously for the past 17 years.
4. The information contained in this report was acquired from been employed by Pandea to assist in the field work that is the subject of this report and from reviewing reports on the work history of the property.
5. Neither M.P Lewis Geological Services nor myself have or expect to receive direct or indirect interest in the property that is the subject of this report.

Date: NOV 14/94

Pat Lewis
M.P. Lewis

APPENDIX 2

CERTIFICATE OF ANALYSIS

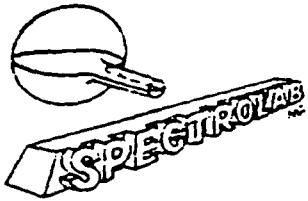

Certificat/Certificate

4R-1066-RA1

Comp: PANGEA GOLDFIELDS INC.
Proj: PICKLE LAKE
Atta: MR. A. LICHTBLAU

Date: AOUT/AUG-17-94

Nombre D'Echantillons/No. of Samples:
Soumis le/Submitted: AOUT/AUG-15-94

No. D'Echantillon Sample Number	Au ppm	Au Cks ppm
KZ94-1	0.053	
OP94-256	<0.005	
OP94-257	<0.005	
OP94-258	<0.005	
OP94-259	0.042	
OP94-260	<0.005	<0.005

Certifie par/Certified by Roger Tunnell B.Sc.

Report of Work Conducted After Recording Claim

Transaction Number
W9430.00012

Mining Act

24

Personal information collected on this form is obtained under the authority of the M
this collection should be directed to the Provincial Manager, Mining Lands, Min
Sudbury, Ontario, P3E 6A5, telephone (705) 670-7264.



900

- Instructions:**
- Please type or print and submit in duplicate.
 - Refer to the Mining Act and Regulations for req. Recorder.
 - A separate copy of this form must be completed for each Work Group.
 - Technical reports and maps must accompany this form in duplicate.
 - A sketch, showing the claims the work is assigned to, must accompany this form.

53809NW0014 2 15732 SKINNER LAKE

2010632

Recorded Holder(s) PANGER GOLDFIELDS INC.		Client No. 2033EE
Address 1 TORONTO ST, SUITE 709, BOX 22 TORONTO, ONT M5C 2V6		Telephone No. 416-350-3778
Mining Division PATRICIA	Township/Area SKINNER LAKE	M or G Plan No. G-2210
Date Work Performed	From: JULY 28, 1994	To: JULY 31, 1994

Work Performed (Check One Work Group Only)

Work Group	Type
Geotechnical Survey	
Physical Work, Including Drilling	
Rehabilitation	
Other Authorized Work	(W10) GEOL / ASSAY
Assays	GEOLOGY + ASSAY RESULTS
Assignment from Reserve	

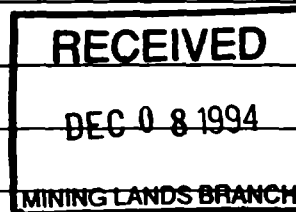

Total Assessment Work Claimed on the Attached Statement of Costs \$ **3000**

Note: The Minister may reject for assessment work credit all or part of the assessment work submitted if the recorded holder cannot verify expenditures claimed in the statement of costs within 30 days of a request for verification.

Persons and Survey Company Who Performed the Work (Give Name and Address of Author of Report)

Name	Address
PAT LEWIS	M.P. LEWIS GEOLOGICAL SERVICES
	269 CHERCOVER DRIVE
	THUNDER BAY, ONTARIO P7G 1A2
	807-767-0259

(attach a schedule if necessary)

Certification of Beneficial Interest * See Note No. 1 on reverse side

I certify that at the time the work was performed, the claims covered in this work report were recorded in the current holder's name or held under a beneficial interest by the current recorded holder.	Date	Recorded Holder or Agent (Signature)
--	------	--------------------------------------

Certification of Work Report

I certify that I have a personal knowledge of the facts set forth in this Work report, having performed the work or witnessed same during and/or after its completion and annexed report is true.
Name and Address of Person Certifying



Personal information collected on this form is obtained under the authority of the Mining Act. This information will be used to maintain a record and going status of the mining claim(s). Questions about this collection should be directed to the Provincial Manager, Minings Lands, Ministry of Northern Development and Mines, 4th Floor, 159 Cedar Street, Sudbury, Ontario E 6A5, telephone (705) 670-7264.

Les renseignements personnels contenus dans la présente formule sont recueillis en vertu de la Loi sur les mines et serviront à tenir à jour un registre des concessions minières. Adresser toute question sur la collecte de ces renseignements au chef provincial des terrains miniers, ministère du Développement du Nord et des Mines, 159, rue Cedar, 4^e étage, Sudbury (Ontario) P3E 6A5, téléphone (705) 670-7264.

Direct Costs/Coûts directs

Type	Description	Amount Montant	Totals Total global
Wages Salaires	Labour Main-d'oeuvre		
	Field Supervision Supervision sur le terrain	\$ 1000	\$ 1000
Contractor's and Consultant's Fees Frais de l'entrepreneur de l'expert- conseil	Type FIELD WORK & REPORT WRITING	\$ 1500	
			\$ 1500
Supplies Used Fournitures utilisées	Type		
Equipment Rental Location de matériel	Type		
Total Direct Costs Total des coûts directs		\$ 2500	

2. Indirect Costs/Coûts indirects

** Note: When claiming Rehabilitation work Indirect costs are not allowable as assessment work.
Pour le remboursement des travaux de réhabilitation, les coûts indirects ne sont pas admissibles en tant que travaux d'évaluation.

Type	Description	Amount Montant	Totals Total global
Transportation Transport	Type AIR + GROUND	\$ 508	
			\$ 508
Food and Lodging Nourriture et hébergement		\$ 125	\$ 125
Mobilization and Demobilization Mobilisation et démobilisation			
Sub Total of Indirect Costs Total partiel des coûts indirects			\$ 633
Amount Allowable (not greater than 20% of Direct Costs) Montant admissible (n'excedant pas 20 % des coûts directs)			\$ 500
Total Value of Assessment Credit (Total of Direct and Allowable Indirect costs)		 Valeur totale du crédit d'évaluation (Total des coûts directs et indirects admissibles)	\$ 3000

Note: The recorded holder will be required to verify expenditures claimed in this statement of costs within 30 days of a request for verification. If verification is not made, the Minister may reject for assessment work all or part of the assessment work submitted.

Note: Le titulaire enregistré sera tenu de vérifier les dépenses demandées dans le présent état des coûts dans les 30 jours suivant une demande à cet effet. Si la vérification n'est pas effectuée, le ministre peut rejeter tout ou une partie des travaux d'évaluation présentés.

Working Discounts

Work filed within two years of completion is claimed at 100% of the above Total Value of Assessment Credit.

Work filed three, four or five years after completion is claimed at 50% of the above Total Value of Assessment Credit. See calculations below:

Total Value of Assessment Credit	Total Assessment Claimed
	× 0.50 =

Remises pour dépôt

1. Les travaux déposés dans les deux ans suivant leur achèvement sont remboursés à 100 % de la valeur totale susmentionnée du crédit d'évaluation.

2. Les travaux déposés trois, quatre ou cinq ans après leur achèvement sont remboursés à 50 % de la valeur totale du crédit d'évaluation susmentionné. Voir les calculs ci-dessous.

Valeur totale du crédit d'évaluation	Evaluation totale demandée
	× 0.50 =



Ministry of
Northern Development
and Mines

Ministère du
Développement du Nord
et des Mines

Geoscience Approvals Office
933 Ramsey Lake Road
6th Floor
Sudbury, Ontario
P3E 6B5

Telephone: (705) 670-5853
Fax: (705) 670-5863

Our File: 2.15732
Transaction: #W9430.00072

March 08, 1995

Mining Recorder
Ministry of Northern Development
and Mines
Queen and Fourth
P.O. Box 3000
Sioux Lookout, Ontario
P8T 1C6

Dear Ms. Majcher:

**RE: APPROVAL OF NOTICE OF REDUCTION ISSUED ON MINING CLAIM 844238 IN
SKINNER LAKE AREA.**

The assessment work credits as outlined in the notice of reduction dated January 18, 1995 have been approved as of March 08, 1995. The credits have been approved under Section 17, Assays, Mining Act Regulations.

Please redistribute the allowable assessment credits as requested by the record holder.

If you require any additional assistance please contact Bruce Gates at (705) 670-5856.

ORIGINAL SIGNED BY:

A handwritten signature in cursive script that reads "Ron C. Gashinski".

Ron C. Gashinski
Senior Manager, Mining Lands Section
Mining and Land Management Branch
Mines and Minerals Division

BIG/jl

cc, Assessment Files Office
Sudbury, Ontario

Resident Geologist
Sioux Lookout, Ontario

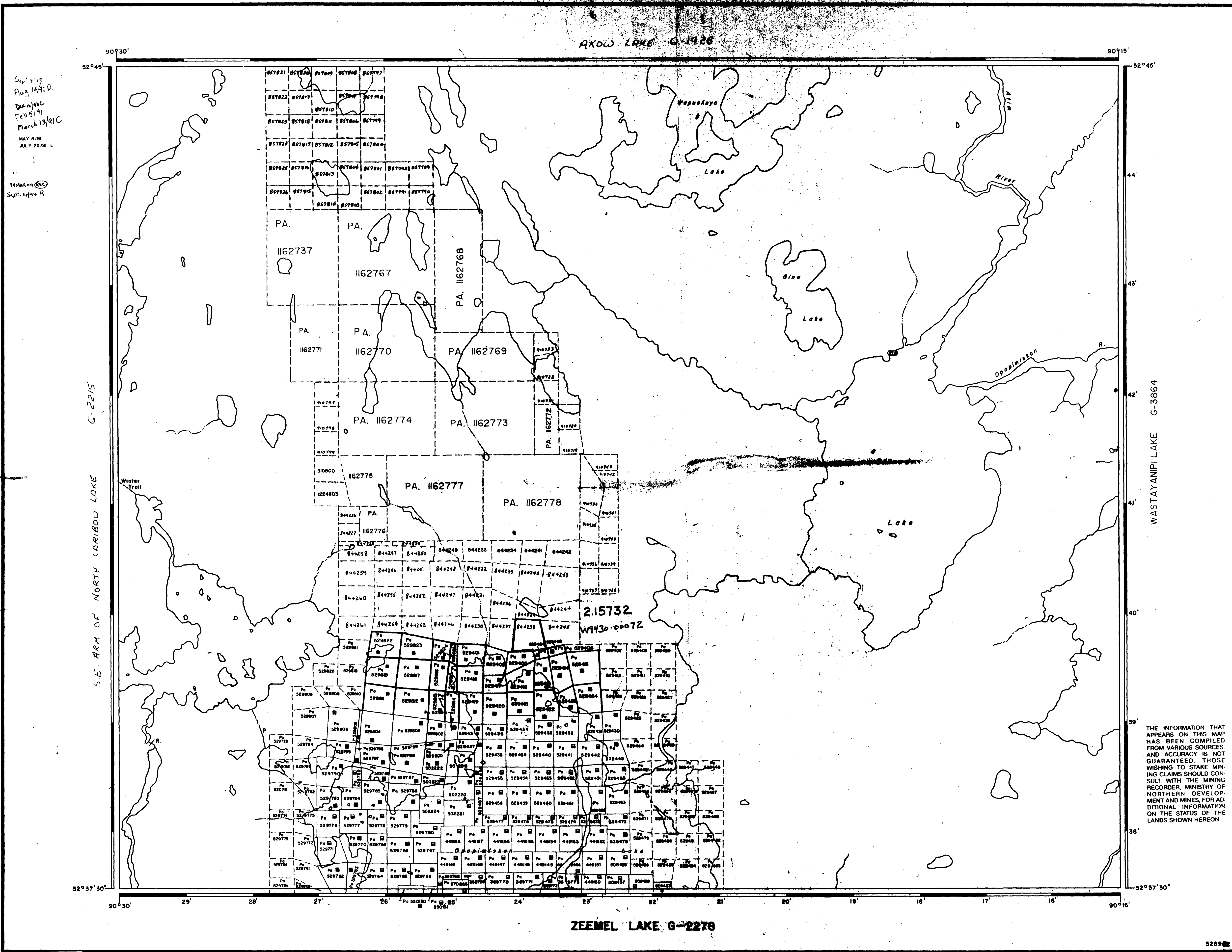

Sep 19
 Aug 14/90
 Dec 1/00
 Feb 5/91
 March 13/91C
 MAY 8/91
 JULY 25/91 L
 94 MAR 04 REC
 Sept. 14/94 R

S.E. ARM OF NORTH CARIBOU LAKE G-2215

WASTAYANPI LAKE G-3864

REFERENCES

AREAS WITHDRAWN FROM DISPOSITION
 M.R.O. - MINING RIGHTS ONLY
 S.R.O. - SURFACE RIGHTS ONLY
 M+S. - MINING AND SURFACE RIGHTS

Description	Order No.	Date	Disposition	File

LEGEND

HIGHWAY AND ROUTE No.	
OTHER ROADS	
TRAILS	
SURVEYED LINES:	
TOWNSHIPS, BASE LINES, ETC.	
LOTS, MINING CLAIMS, PARCELS, ETC.	
UNSURVEYED LINES:	
LOT LINES	
PARCEL BOUNDARY:	
MINING CLAIMS ETC.	
RAILWAY AND RIGHT OF WAY	
UTILITY LINES	
NON-PERENNIAL STREAM	
FLOODING OR FLOODING RIGHTS	
SUBDIVISION OR COMPOSITE PLAN	
RESERVATIONS	
ORIGINAL SHORELINE	
MARSH OR MUSKIEG	
MINES	
TRAVERSE MONUMENT	
REMOTE TOURIST SET-UP	

DISPOSITION OF CROWN LANDS

TYPE OF DOCUMENT	SYMBOL
PATENT, SURFACE & MINING RIGHTS	
" SURFACE RIGHTS ONLY	
" MINING RIGHTS ONLY	
LEASE, SURFACE & MINING RIGHTS	
" SURFACE RIGHTS ONLY	
" MINING RIGHTS ONLY	
LICENCE OF OCCUPATION	
ORDER-IN-COUNCIL	
RESERVATION	
CANCELLED	
SAND & GRAVEL	

NOTE: MINING RIGHTS IN PARCELS PATENTED PRIOR TO MAY 6, 1912, VESTED IN ORIGINAL PATENTEE BY THE PUBLIC LANDS ACT, R.S.O. 1970, CHAP. 360, SEC. 63, SUBSEC. 1.

SCALE: 1 INCH = 40 CHAINS

FEET	0	1000	2000	4000	6000	8000
METRES	0	200	1000	2000	3000	4000

THE INFORMATION THAT APPEARS ON THIS MAP HAS BEEN COMPILED FROM VARIOUS SOURCES, AND ACCURACY IS NOT GUARANTEED. THOSE WISHING TO STAKE MINING CLAIMS SHOULD CONSULT WITH THE MINING RECORDER, MINISTRY OF NORTHERN DEVELOPMENT AND MINES, FOR ADDITIONAL INFORMATION ON THE STATUS OF THE LANDS SHOWN HEREON.

AREA

SKINNER LAKE

M.N.R. ADMINISTRATIVE DISTRICT
 SIOUX LOOKOUT
 MINING DIVISION
 PATRICIA
 LAND TITLES / REGISTRY DIVISION
 KENORA / PATRICIA PORTION

Ministry of Natural Resources
 Land Management Branch

Date: JANUARY, 1988
 Sheet: G-2210

