



Diamond Drilling

53K16SE000100

010

Township of CARB LAKE

Report No: 10

Work performed by: BIG NAMA CREEK MINES LIMITED

Claim No	Hole No	Footage	Date	Note
K 59382	6742-1	410'	Feb/68	
K 59378	6742-2	495'	Feb/68	
K 59383	6742-3	454'	Mar/68	
K 59388	6742-4	490'	Mar/68	

Notes:

PROPERTY

BIG NAMA CREEK MINES LIMITED

LARANDONA MINES LIMITED

Carb Lake, N.W.Ontario

Project 6742

PAGE 1

LOCATION 38+00S; 12+00 W

BEARING N 10°E (Ast.) HOLE NO. 6742-1

LOGGED BY B. B. Brown

ELEVATION

DIP -50°

FINAL DEPTH 410'

STARTED February 9, 1968

TESTS (CORRECTED)

FINISHED February 18, 1968

CASING 22' Pulled

CORE SIZE EXT

FROM	TO	DESCRIPTION
0.0	22.0	OVERBURDEN - Clay, sand and scattered boulders up to 2'.
22.0	49.3	CARBONATITE - 80% carbonatite, remainder darker colored mafic fragments 1/2-6", sharp irregular contacts, carbonatite is nearly pure calcite - 90%, fine grained, grey-brownish grey, 10% combined disseminated magnetite, dark green-blue green mica and hornblende, traces fine fibrous actinolite and pyrite, disseminated fine brownish crystals, some occurring as cubes, resinous lustre, possibly pyrochlore (?), scattered graphite slips as at 33', mafic fragments are highly carbonatized.
49.3	51.0	MAGNETITE CALCITE APATITE ZONE - Fine to medium grained, 80% magnetite, 20% combined calcite and apatite, minor actinolite, traces pyrite, chalcopyrite and pyrochlore(?).
51.0	56.0	CARBONATITE, As from 22-49.3'.
56.0	61.4	MAFIC ROCK - Fine to medium grained, 60% magnetite in coarse blebs up to 1/4", 30% hornblende and fine fibrous actinolite, 10% apatite, several graphite slips, disseminated specks pyrochlore (?), sharp lower contact at 50° to core axis.
61.4	167.5	CARBONATITE - 85% brownish grey-pink calcite, 15% apatite, magnetite, dark green mica, pyrochlore (?) and pyrite in that order of abundance, traces bronze mica, 10% of section consists of mafic fragments as from 56.0-61.4' with sharp irregular contacts. 138.0 - 148.0 - Higher than average pyrochlore (?) content, very fine specks difficult to distinguish from bronze colored mica. 156.5 - 167.5 - As above
167.5	174.5	MAFIC ROCK - Medium to coarse grained, 30% magnetite in blebs up to 1/2", 30% fine fibrous actinolite and hornblende, 20% apatite, 20% fine irregular dykelets and lenses calcite, minor pyrite and pyrochlore (?) disseminated throughout section.

HOLE NO. 6742-1
Page 1

PROPERTY

BIG NAMA CREEK MINES LIMITED
 LARANDONA MINES LIMITED - Project 6742
 Carb Lake, N.W.Ontario

PAGE 2

LOCATION _____ BEARING _____ HOLE NO. 6742-1

LOGGED BY _____ ELEVATION _____ DIP _____ FINAL DEPTH 410'

STARTED _____ TESTS (CORRECTED) _____

FINISHED _____

CASING _____

CORE SIZE _____

FROM	TO	DESCRIPTION
174.5	214.4	CARBONATITE - As from 61.4 to 167.5'.
214.4	219.4	MAGNETITE APATITE ZONE - Medium to coarse grained and massive, 60% magnetite in blebs averaging 1/4", 30% apatite, 10% actinolite and fine irregular dykelets calcite, minor pyrite and fine disseminated specks pyrochlore (?).
219.4	225.8	CARBONATITE - Fine grained and massive, 75% grey-brownish grey calcite, 15% apatite, 10% fine coarse magnetite, minor pyrite, fine specks pyrochlore (?) disseminated throughout section, several fragments mafic rock.
225.8	249.0	MIXED ZONE - Evenly distributed between sections of carbonatite as above and magnetite-apatite rock as from 214.4-219.4, sharp irregular contacts, sections vary in length from 6" to 2'.
249.0	254.5	MAFIC ROCK - Fine to medium grained and massive, 50% magnetite, 20% apatite, 20% combined hornblende and actinolite, carbonatized, minor pyrite and dark green mica, disseminated specks pyrochlore(?).
254.5	263.0	CARBONATITE - Fine grained and massive, 75% calcite, 20% combined magnetite and apatite, remainder dark green mica, actinolite and pyrochlore(?), scattered carbonatized fragments mafic rock.
263.0	269.4	MAFIC ROCK - As from 249-254.5', carbonatized.
269.4	408.0	CARBONATITE - As from 254.5-263', magnetite and apatite content decreased to 10% combined, disseminated pyrochlore(?) and traces bronze mica, 1-2% disseminated pyrite.
		330.0 - 362.0 - Minor localized layering between carbonatite and light colored highly carbonatized sections, layering fairly regular at 40-50° to core axis.
		362.0 - 408.0 - Highly carbonatized mafic sections, contacts fairly sharp and regular at 30-40° to core axis.
		336.0 - 4" section 40% pyrite, 40% magnetite, remainder apatite and green and bronze mica

HOLE NO. 6742-1
 Page 2

PROPERTY

BIG NAMA CREEK MINES LIMITED
LARANDONA MINES LIMITED - Project 6742

PAGE 3

LOCATION _____ BEARING _____ HOLE NO. 6742-1

LOGGED BY _____ ELEVATION _____ DIP _____ FINAL DEPTH 410'

STARTED _____ TESTS (CORRECTED) _____

FINISHED _____

CASING _____

CORE SIZE _____

FROM	TO	DESCRIPTION
408.0	410.0	MAFIC ROCK - 60% calcite and apatite, remainder magnetite, biotite, actinolite and hornblende in that order of abundance.
	410.0	END OF HOLE

Ben B. Brown

RED LAKE
MINING DIV.
RECEIVED
MAY 31 1968
AM 7 8 9 10 11 12 1 2 3 4 5 6 PM

HOLE NO. 6742-1
Page 3

PROPERTY

BIG NAMA CREEK MINES LIMITED
 LARANDONA MINES LIMITED, Project 6742
 Carb Lake, N.W.Ontario

PAGE 1

LOCATION 4+00 E; 47+00 S BEARING N 10° E (Ast) HOLE NO. 6742-2

LOGGED BY B.B.Brown ELEVATION _____ DIP -50° FINAL DEPTH 495'

STARTED Feb. 24, 1968 TESTS (CORRECTED) _____

FINISHED March 1, 1968

GASING 40.0' (Pulled)

CORE SIZE EXT

FROM	TO	DESCRIPTION
0.0	40.0	CASING - Clay, sand and boulders up to 2'.
40.0	94.0	CARBONATITE - Fine grained and massive, 85% pale pinkish brown calcite, 5% white-green apatite, 3-4% finely disseminated magnetite, remainder consists of dark green and bronze mica, pyrite, pyrochlore (?) and fine flecks rusty red material in that order of abundance, scattered actinolite slips, 20% of section consists of darker colored highly carbonatized mafic fragments which are higher in magnetite, apatite and mica content, contacts vary from gradational to sharp at 30-40° to core axis. 64 - 71 - Ground core.
94.0	104.5	MAFIC ROCK - 30% magnetite, 20% apatite, 20% combined hornblende and actinolite, 20% irregular dykelets and lenses calcite, remainder dark green and bronze mica with minor pyrochlore(?).
104.5	152.0	CARBONATITE - As from 40-94', magnetite content increased to 7-8%, locally vuggy, scattered 6"-1' mafic fragments.
152.0	161.7	MAFIC ROCK - 35% fine to coarse blebs magnetite, 60% combined apatite, calcite, actinolite and hornblende, remainder dark green and bronze mica with minor pyrochlore(?), traces pyrite, sharp contacts, upper at 25° and lower at 35° to core axis.
161.7	183.0	CARBONATITE - Fine grained and massive, pale-dark grey, 80% calcite, 6-7% finely disseminated magnetite, remainder actinolite and apatite, scattered very fine specks rusty red mineral, traces bronze mica and pyrochlore (?), scattered fragments mafic rock as from 152-161.7'. 169.5 - 183 - Apatite, actinolite and mica content increased to 25%, increasing number of mafic fragments, weak and irregular foliation.

HOLE NO. Page 1
 6742-2

PROPERTY

BIG NAMA CREEK MINES LIMITED
 LARANDONA MINES LIMITED - Project 6742
 Carb Lake, N.W. Ontario

PAGE 2

LOCATION _____ BEARING _____ HOLE NO. 6742-2

LOGGED BY _____ ELEVATION _____ DIP _____ FINAL DEPTH 495'

STARTED _____ TESTS (CORRECTED) _____

FINISHED _____

CASING _____

CORE SIZE _____

FROM	TO	DESCRIPTION
183.0	246.8	MAFIC ROCK - 40% magnetite in fine to coarse blebs up to 1/2", remainder apatite, actinolite, calcite and dark green and bronze mica in that order of abundance, traces pyrite, scattered fine irregular dykelets and lenses pink calcite.
246.8	302.6	CARBONATITE - Fine grained, mainly massive with local weak foliation at 40° to core axis, 85% grey-pink calcite, 6-7% finely disseminated magnetite, 5% apatite, green and bronze mica and pyrochlore(?), traces pyrite and fine specks rusty red mineral, scattered fragments mafic rock as from 183 to 246.8'with sharp irregular contacts. 257 - 260 - Ground core.
302.6	352.0	MAFIC ROCK - 35% magnetite, mainly in coarse blebs averaging 1/4" and up to 1/2", matrix is fine grained and carbonatized, and consists of actinolite, apatite and hornblende in that order of abundance, 5% combined green and bronze mica, pyrite and fine specks rusty red mineral, scattered narrow dykelets carbonatite with sharp contacts.
352.0	378.0	CARBONATITE - 75% pink calcite, 15% apatite, 5% disseminated magnetite, remainder green and bronze mica, pyrochlore (?) and fine specks rusty red mineral, some obscure banding between darker colored apatite rich sections and calcite at 40° to core axis, scattered fragments mafic material, locally vuggy. 356 - 358 - Ground core.
378.0	416.5	MAFIC ROCK - As from 302.6-352', increased apatite content with comparatively minor actinolite. 416 - 416.5 - Graphitic shear.
416.5	440.0	MIXED ZONE - Evenly distributed between carbonatite and darker colored highly carbonatized mafic fragments, obscure alignment of mafic fragments at 45° to core axis.

HOLE NO. 6742-2
 Page 2

PROPERTY BIG NAMA CREEK MINES LIMITED
 LARANDONA MINES LIMITED - Project 6742
 Carb Lake, N.W.Ontario

PAGE 3

LOCATION _____ BEARING _____ HOLE NO. 6742-2

LOGGED BY _____ ELEVATION _____ DIP _____ FINAL DEPTH 495'

STARTED _____ TESTS (CORRECTED) _____

FINISHED _____

CASING _____

CORE SIZE _____

FROM	TO	DESCRIPTION
440.0	450.0	CARBONATITE - As from 352-378'.
450.0	468.0	MIXED ZONE - As from 416-440'.
468.0	472.3	MAGNETITE, MICA, APATITE ROCK, 70% magnetite, remainder dark green-bronze mica and apatite.
472.3	495.0	CARBONATITE - Fine grained and massive, 75% pink-dark grey calcite, 15% apatite, 3-4% finely disseminated magnetite, remainder fine specks mica and rusty red earthy mineral, traces pyrite and pyrochlore(?), locally vuggy with cavities stained with rusty red mineral, 15% of section highly carbonatized, mafic fragments.
	495.0	END OF HOLE

Ben B. Brown

RED LAKE
 MINING DIV.
RECEIVED
 MAY 31 1968
 AM 7 8 9 10 11 12 1 2 3 4 5 6 PM

HOLE NO. 6742-2
 Page 3

92°02'

Camp Lake

92°00'

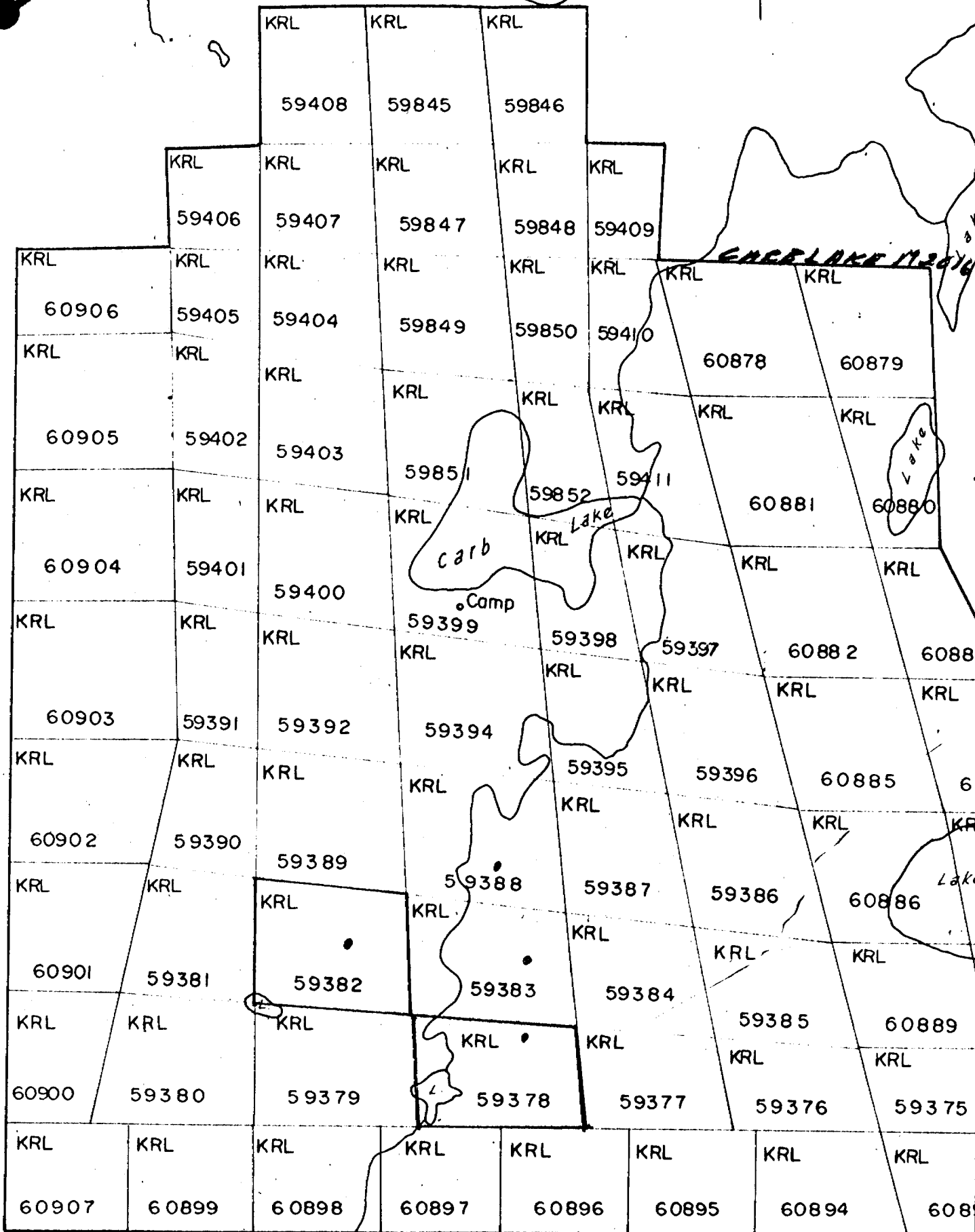

92°02'

92°00'

PROPERTY BIG NAMA CREEK MINES LIMITED - Project 6742
 Carb Lake, N.W. Ontario

PAGE 1

LOCATION 4 + 00 E, 40 + 25 S BEARING N 10° E (Ast.) HOLE NO. 6742-3

LOGGED BY B.B. Brown ELEVATION _____ DIP -50° FINAL DEPTH 454'

STARTED March 2, 1968 TESTS (CORRECTED) _____

FINISHED March 7, 1968

CASING 30.0' (Pulled)

CORE SIZE EXT

FROM	TO	DESCRIPTION
0	30.0'	OVERBURDEN, clay and sand, numerous boulders up to 2'.
30.0	38.0	CARBONATITE, 90% pink calcite, fine grained and massive, 5% apatite, 2-3% finely disseminated magnetite, remainder bronze mica, pyrite and pyrochlore.
38.0	40.0	GROUND CORE
40.0	46.7	MAFIC ROCK, 55% fine magnetite, 15% biotite, 15% combined apatite and actinolite, 10% calcite, several fragments sedimentary gneiss, remainder consists of pyrite and pyrochlore.
46.7	61.3	CARBONATITE, 80% fine grained pink calcite, 10% apatite, minor disseminated magnetite, several irregular veinlets and lenses yellow apatite rich carbonate, remainder bronze mica, pyrite and pyrochlore, locally weakly foliated at 50° to C.A. 50 - 52, ground core.
61.3	111.7	MAFIC ROCK, 60% fine grained magnetite, 25% combined apatite and actinolite, 10% brown and dark green mica, remainder calcite, pyrite and pyrochlore, 20% of section composed of dykelets carbonatite with sharp irregular contacts.
111.7	176.0	CARBONATITE, 75% fine grained gray and pink calcite with greenish yellow apatite rich carbonate, 10% biotite and bronze mica, 10% apatite, 4-5% disseminated magnetite, traces pyrite, pyrochlore and specks rusty red mineral, remainder of section highly carbonatized mafic fragments rough alignment between apatite rich carbonate and mafic fragments with calcite at 45° to C.A.
176.0	187.7	CALCITE, MAGNETITE APATITE ROCK, 50% pink calcite, 30% magnetite, 15% apatite, 3% pyrite, remainder mica with traces pyrochlore.

HOLE NO. 6742-3
 Page 1

PROPERTY BIG NAMA CREEK MINES LIMITED - Project 6742
 Carb Lake, N.W. Ontario

PAGE 2

LOCATION _____ BEARING _____ HOLE NO. 6742-3
 LOGGED BY _____ ELEVATION _____ DIP _____ FINAL DEPTH 454'
 STARTED _____ TESTS (CORRECTED) _____
 FINISHED _____
 CASING _____
 CORE SIZE _____

FROM	TO	DESCRIPTION
187.7	337.5	CARBONATITE, 65% fine grained and massive pinkish gray calcite, 25% apatite, 2-3% magnetite, remainder bronze mica, pyrite and pyrochlore, scattered mafic fragments, locally vuggy 202-204, rich in rusty red carbonate. 212-337.5, scattered pale green apatite rich carbonate, disseminated specks rusty red mineral, rough alignment between mafic fragments and apatite rich carbonate with calcite at 45° to C.A.
337.5	341.5	BIOTITE CALCITE ROCK, 65% biotite, 15% calcite, remainder apatite and actinolite, traces pyrite and pyrochlore, no magnetite.
341.5	353.6	CARBONATITE, as from 187.7-337.5
353.6	366.0	BIOTITE CALCITE APATITE ROCK, as from 337.5-341.5 with addition of apatite, calcite and apatite occurs as network fine stringers and lenses, scattered narrow sections carbonatite, no magnetite.
366.0	417.5	CARBONATITE, 60% fine grained and massive pink and gray calcite, 20% apatite, 15% fragments dark biotite rich rock as from 353.6-366, minor dark green mica, pyrite magnetite and pyrochlore, fine specks rusty red mineral, rough alignment between fragments and apatite rich sections with calcite at 45-50° to C.A. 388-391, ground core.
417.5	425.2	MAGNETITE CALCITE APATITE PYRITE ROCK, 70% dense fine grained magnetite, 20% combined calcite apatite, 5% pyrite with erratic distribution, remainder dark green and bronze mica and actinolite.
425.2	454.0	CARBONATITE, as from 366-417.5, minor mafic fragments and biotite rich fragments as from 337.5-341.5
	454.0	END OF HOLE

Ben B. Brown

HOLE NO. 6742-3
 Page 2

92°02'

Camp Lake

92°00'

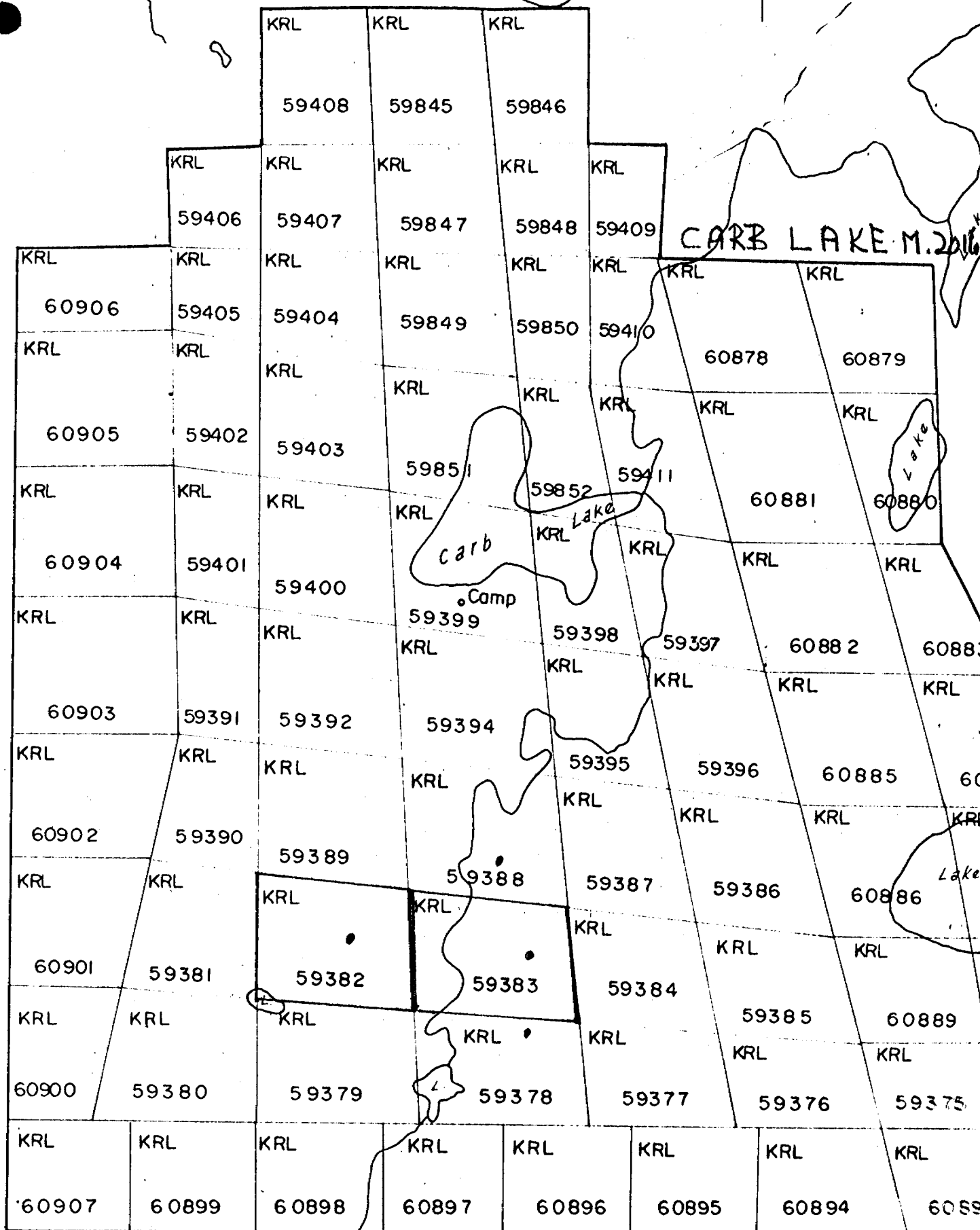

CARB LAKE M. 2016

Lake

Carb Lake

Camp

Lake

92°02'

92°00'

PROPERTY BIG NAMA CREEK MINES LIMITED, Project 6742
 Carb Lake, N. W. Ontario

PAGE 1

LOCATION 34 + 50 S, 00 + 00 E BEARING N 10° E (Ast.) HOLE NO. 6742-4

LOGGED BY B. B. Brown ELEVATION _____ DIP -50° FINAL DEPTH 490'

STARTED March 12, 1968 TESTS (CORRECTED) _____

FINISHED March 17, 1968

CASING 44' (drilled 5' into bedrock)

CORE SIZE EXT

FROM	TO	DESCRIPTION
0	39.0	OVERBURDEN, Numerous granite and granite gneiss boulders up to 3'.
39.0	132.0	CARBONATITE, 70% fine grained pink calcite, 20% combined apatite and actinolite, 5% disseminated magnetite, remainder green and bronze mica, pyrite, pyrrohite, pyrochlore and fine specks rusty red mineral, minor local weak, foliation at 40-45° to C.A. 69.4-70.2, fracture zone with replacement by fine pyrite, siderite and magnetite. 97-104, nearly pure pink calcite, fine specks rusty red mineral.
132.0	135.5	BIOTITE CALCITE APATITE ROCK, 60% biotite remainder apatite and calcite, traces pyrite, no magnetite.
135.5	446.5	CARBONATITE, 135.5-196, as from 39-132, 25% of section composed of biotite rich mafic fragments; minor magnetite scattered coarse blebs hematite and siderite, locally vuggy, ground core - 160-162, 175-181, 188-192, 205-212, 196-344, 85% apatite and calcite, 5% dark green and bronze mica, 5% disseminated magnetite, remainder actinolite, pyrite and pyrrohite, specks rusty red mineral, pyrochlore, scattered dykelets nearly pure pink calcite generally in at 30-35° to C.A. scattered biotite rich mafic fragments minor magnetite and actinolite rich mafic fragments, 344-376, localized layering between calcite and darker apatite rich sections at 45-55° to C.A., 350-354, ground core, 376-387, pale greenish gray fine grained massive rock, predominately apatite with calcite, disseminated specks magnetite, pyrite, pyrrohite and rusty red mineral. 387-402, as from 196-344 402-446.5, localized layering between pale green apatite rich sections and darker green apatite actinolite rich sections with pink calcite at 45-50° to C.A., blebs pyrrohite up to 1/2" with traces chalcopyrite at 445'.

HOLE NO. 6742-4
 Page 1

PROPERTY BIG NAMA CREEK MINES LIMITED, Project 6742
Carb Lake, N. W. Ontario

PAGE 2

LOCATION _____ BEARING _____ HOLE NO. 6742-4

LOGGED BY _____ ELEVATION _____ DIP _____ FINAL DEPTH 490'

STARTED _____ TESTS (CORRECTED) _____

FINISHED _____

CASING _____

CORE SIZE _____

FROM	TO	DESCRIPTION
446.5	453.9	MAFIC ROCK, 50% biotite, remainder apatite and calcite in network of fine seams, minor actinolite and green mafic mineral, no magnetite, minor pyrrhite, some injected carbonatite.
453.9	490.0	CARBONATITE, as from 196-344, 20% of section dark green mafic fragments.
End of Hole		
<i>Ben B. Brown</i>		

RED LAKE
MINING DIV.
RECEIVED
MAY 11 1968
AM 7 8 9 10 11 12 1 2 3 4 5 6 PM

92°02'

Camp Lake

92°00'

CARB LAKE M.2016

	KRL	KRL	KRL			
		59408	59845	59846		
	KRL	KRL	KRL	KRL	KRL	
	59406	59407	59847	59848	59409	
KRL	KRL	KRL	KRL	KRL	KRL	KRL
60906	59405	59404	59849	59850	59410	60878
KRL	KRL	KRL	KRL	KRL	KRL	60879
60905	59402	59403	59851	59852	59411	KRL
KRL	KRL	KRL	KRL	KRL	KRL	60881
60904	59401	59400	59399	59398	59397	60882
KRL	KRL	KRL	KRL	KRL	KRL	KRL
60903	59391	59392	59394	59395	59396	60885
KRL	KRL	KRL	KRL	KRL	KRL	KRL
60902	59390	59389	59388	59387	59386	60886
KRL	KRL	KRL	KRL	KRL	KRL	KRL
60901	59381	59382	59383	59384	59385	60889
KRL	KRL	KRL	KRL	KRL	KRL	KRL
60900	59380	59379	59378	59377	59376	59375
KRL	KRL	KRL	KRL	KRL	KRL	KRL
60907	60899	60898	60897	60896	60895	60894

92°02'

92°00'



53K16SE000100

900

CARB LARC

REPORT No: 10

Carb Lake

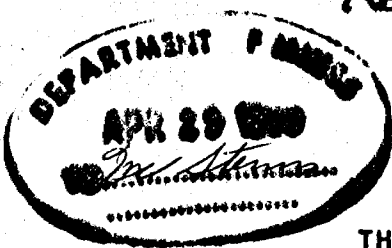

A separate form is required for each type of work to be recorded.

THE MINING ACT REPORT OF WORK

To the Recorder of RED LAKE Big Nama Creek Mines Limited Mining Division
I, Laradona Mines Limited T-87) undivided - 50% interest each
name of Recorded Holder Miner's Licence
Suite 908 - 330 Bay Street, TORONTO 1, Ontario
Post Office Address

do hereby report the performance of 410 days of Diamond Drilling type of work
not before reported to be applied on the following contiguous claims

Table with 6 columns: Claim No., Days, Claim No., Days, Claim No., Days. Content: See attached sheet

All the work was performed on Mining Claim (s) KRI-59382
(In the case of geological and/or geophysical survey (s) where more than 18 claims are involved attach a schedule)

READ CAREFULLY: THE FOLLOWING INFORMATION IS REQUIRED BY THE MINING RECORDER.

- For Manual Work, Stripping or Opening up of Mines, Sinking Shafts or Other Actual Mining Operations - Names and addresses of the men who performed the work and the dates and hours of their employment.
For Diamond and other Core Drilling - Footage, No. and angle of holes and diameter of core. Name and address of owner or operator of drill. Dates when drilling was done. Signed core log and sketch in duplicate.
For Compressed Air or Other Power Driven or Mechanical Equipment
Type of drill or equipment. Names and addresses of men engaged in operating equipment and the dates and hours of their employment.
For Power Stripping - Type of equipment. Name and address of owner or operator. Amount expended. Dates on which work was done. Proof of actual cost must be submitted within 30 days of recording.
With each of the above types of work sketches are required to show the location and extent of the work in relation to the nearest claim post. In the case of diamond or other core drilling the sketch must be submitted in duplicate.
For Geological and Geophysical Survey - The names and addresses of men employed as well as dates. Type of instrument used in the case of geophysical survey. Reports and maps in duplicate must be filed with the Minister within 60 days of recording.
For Land Survey - the name and address of Ontario Land surveyor.

The Required Information is as Follows: (Attach a list if this space is insufficient)

Hole 6742-1 - 410 feet; -50° - 7/8"
D.D.Owner: Vaughan Thompson
290 Kerrybrook Drive
RICHMOND HILL, Ontario
Drilled from February 9 - February 18, 1968

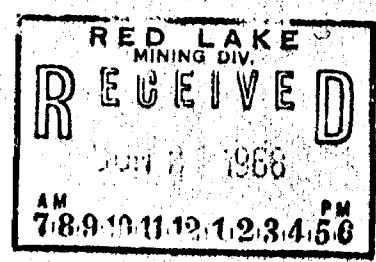

Date June 10, 1968

Signature of Recorded Holder or Agent

The Mining Act Certificate Verifying Report of Work

I, Orville Alexander Seiber
Suite 908 - 330 Bay Street, TORONTO 1, Ontario
(Post Office Address)

hereby certify:

- 1. That I have a personal and intimate knowledge of the facts set forth in the report of work annexed here-to, having performed the work or witnessed same during and/or after its completion.
2. That the annexed report is true.

Dated June 10 19 68

Signature

THE PENALTY FOR MAKING A FALSE STATEMENT IN THIS REPORT AND/OR CERTIFICATE IS \$500. OR SIX MONTHS IMPRISONMENT OR BOTH

CARB LAKE

LIST OF CLAIMS WITH NUMBER OF DAYS TO BE APPLIED TO EACH

<u>Claim No.</u>	<u>Days</u>	<u>Claim No.</u>	<u>Days</u>	<u>Claim No.</u>	<u>Days</u>
KRL-60906	<u>5</u>	KRL-60886	<u>5</u>	KRL-59398	<u>6</u>
60905	<u>5</u>	60889	<u>5</u>	59397	<u>6</u>
60904	<u>5</u>			59402	<u>6</u>
60903	<u>5</u>	59380	<u>6</u>	59403	<u>6</u>
60902	<u>5</u>	59379	<u>6</u>	59851	<u>6</u>
60901	<u>5</u>	59378	<u>6</u>	59852	<u>6</u>
60900	<u>5</u>	59377	<u>6</u>	59411	<u>6</u>
60907	<u>5</u>	59376	<u>6</u>	59405	<u>6</u>
60899	<u>5</u>	59375	<u>6</u>	59404	<u>6</u>
60898	<u>5</u>	59381	<u>6</u>	59849	<u>6</u>
60897	<u>5</u>	59382	<u>6</u>	59850	<u>6</u>
60896	<u>5</u>	59383	<u>6</u>	59410	<u>6</u>
60895	<u>5</u>	59384	<u>6</u>	59406	<u>6</u>
60894	<u>5</u>	59385	<u>6</u>		
60893	<u>5</u>	59390	<u>6</u>	59407	<u>7</u>
60892	<u>5</u>	59389	<u>6</u>	59847	<u>6</u>
60891	<u>5</u>	59388	<u>6</u>	59848	<u>6</u>
60888	<u>5</u>	59387	<u>6</u>	59409	<u>6</u>
60887	<u>5</u>	59386	<u>6</u>	59408	<u>6</u>
60884	<u>5</u>	59391	<u>6</u>	59845	<u>6</u>
60883	<u>5</u>	59392	<u>6</u>	59846	<u>6</u>
60880	<u>5</u>	59394	<u>6</u>		
60879 60897	<u>5</u>	59395	<u>6</u>	TOTAL	410
60878	<u>5</u>	59396	<u>6</u>		
60881	<u>5</u>	59401	<u>6</u>		
60882	<u>5</u>	59400	<u>6</u>		
60885	<u>5</u>	59399	<u>6</u>		

RED LAKE
MINING DIV.
RECEIVED
JUN 2 1968
AM 7 8 9 10 11 12 1 2 3 4 5 6 PM



ONTARIO

THE MINING ACT REPORT OF WORK

A separate form is required for each type of work to be recorded.

To the Recorder of RED LAKE Big Nama Creek Mines Limited T-86 undivided Mining Division
I, Laradona Mines Limited T-87 50% interest each Miner's Licence
name of Recorded Holder Suite 908 - 330 Bay St., Toronto 1, Ontario Post Office Address

do hereby report the performance of 495 days of Diamond Drilling type of work
not before reported to be applied on the following contiguous claims

Table with 6 columns: Claim No., Days, Claim No., Days, Claim No., Days. Content includes 'See attached list'.

All the work was performed on Mining Claim (s) KRL-59388
(In the case of geological and/or geophysical survey (s) where more than 18 claims are involved attach a schedule)

READ CAREFULLY: THE FOLLOWING INFORMATION IS REQUIRED BY THE MINING RECORDER.

- For Manual Work, Stripping or Opening up of Mines, Sinking Shafts or Other Actual Mining Operations - Names and addresses of the men who performed the work and the dates and hours of their employment.
For Diamond and other Core Drilling - Footage, No. and angle of holes and diameter of core. Name and address of owner or operator of drill. Dates when drilling was done. Signed core log and sketch in duplicate.
For Compressed Air or Other Power Driven or Mechanical Equipment
Type of drill or equipment. Names and addresses of men engaged in operating equipment and the dates and hours of their employment.
For Power Stripping - Type of equipment. Name and address of owner or operator. Amount expended. Dates on which work was done. Proof of actual cost must be submitted within 30 days of recording.
With each of the above types of work sketches are required to show the location and extent of the work in relation to the nearest claim post. In the case of diamond or other core drilling the sketch must be submitted in duplicate.
For Geological and Geophysical Survey - The names and addresses of men employed as well as dates. Type of instrument used in the case of geophysical survey. Reports and maps in duplicate must be filed with the Minister within 60 days of recording.
For Land Survey - the name and address of Ontario Land surveyor.

The Required Information is as Follows: (Attach a list if this space is insufficient)

Hole 6742-2 - 495 feet; -50°, 7/8"
D.D.Owner: Vaughan Thompson
290 Kerrybrook Drive
RICHMOND HILL, Ontario
Drilled from
February 24 - March 1, 1968



Date June 10, 1968 Signature of Recorded Holder or Agent

The Mining Act Certificate Verifying Report of Work

I, Orville Alexander Seeber Suite 908 - 330 Bay St., Toronto 1, Ontario (Post Office Address)

- hereby certify:
1. That I have a personal and intimate knowledge of the facts set forth in the report of work annexed hereto, having performed the work or witnessed same during and/or after its completion.
2. That the annexed report is true.

Dated June 10 19 68 Signature

THE PENALTY FOR MAKING A FALSE STATEMENT IN THIS REPORT AND/OR CERTIFICATE IS \$500. OR SIX MONTHS IMPRISONMENT OR BOTH

CARR LAKE.

LIST OF CLAIMS WITH NUMBER OF DAYS TO BE APPLIED TO EACH

<u>Claim No.</u>	<u>Days</u>	<u>Claim No.</u>	<u>Days</u>	<u>Claim No.</u>	<u>Days</u>
KRL-60906	<u>6</u>	KRL-60886	<u>6</u>	KRL-59398	<u>6</u>
60905	<u>6</u>	60889	<u>6</u>	59397	<u>6</u>
60904	<u>6</u>			59402	<u>6</u>
60903	<u>6</u>	59380	<u>6</u>	59403	<u>6</u>
60902	<u>6</u>	59379	<u>6</u>	59851	<u>6</u>
60901	<u>6</u>	59378	<u>6</u>	59852	<u>6</u>
60900	<u>6</u>	59377	<u>6</u>	59411	<u>6</u>
60907	<u>6</u>	59376	<u>6</u>	59405	<u>6</u>
60899	<u>6</u>	59375	<u>6</u>	59404	<u>6</u>
60898	<u>6</u>	59381	<u>6</u>	59849	<u>6</u>
60897	<u>6</u>	59382	<u>6</u>	59850	<u>6</u>
60896	<u>6</u>	59383	<u>6</u>	59410	<u>6</u>
60895	<u>6</u>	59384	<u>6</u>	59406	<u>6</u>
60894	<u>6</u>	59385	<u>6</u>		
60893	<u>6</u>	59390	<u>6</u>	59407	<u>13</u>
60892	<u>6</u>	59389	<u>6</u>	59847	<u>14</u>
60891	<u>6</u>	59388	<u>6</u>	59848	<u>14</u>
60888	<u>6</u>	59387	<u>6</u>	59409	<u>14</u>
60887	<u>6</u>	59386	<u>6</u>	59408	<u>14</u>
60884	<u>6</u>	59391	<u>6</u>	59845	<u>15</u>
60883	<u>6</u>	59392	<u>6</u>	59846	<u>15</u>
60880	<u>6</u>	59394	<u>6</u>		
60879	<u>6</u>	59395	<u>6</u>		
60878	<u>6</u>	59396	<u>6</u>		
60881	<u>6</u>	59401	<u>6</u>		
60882	<u>6</u>	59400	<u>6</u>		
60885	<u>6</u>	59399	<u>6</u>		

TOTAL 495





ONTARIO

THE MINING ACT REPORT OF WORK

A separate form is required for each type of work to be recorded.

To the Recorder of... RED LAKE Mining Division
Big Nama Creek Mines Limited) T-86 Undivided
I, ... Larandona Mines Limited) T-87 50% interest each
name of Recorded Holder) Miner's Licence
Suite 908 - 330 Bay Street, Toronto 1, Ontario
Post Office Address

do hereby report the performance of ... 454 ... days of Diamond Drilling
type of work

not before reported to be applied on the following contiguous claims

Table with 6 columns: Claim No., Days, Claim No., Days, Claim No., Days. Content: See attached list.

All the work was performed on Mining Claim (s) ... KRL-59383
(In the case of geological and/or geophysical survey (s) where more than 18 claims are involved attach a schedule)

READ CAREFULLY: THE FOLLOWING INFORMATION IS REQUIRED BY THE MINING RECORDER.

- For Manual Work, Stripping or Opening up of Mines, Sinking Shafts or Other Actual Mining Operations - Names and addresses of the men who performed the work and the dates and hours of their employment.
For Diamond and other Core Drilling - Footage, No. and angle of holes and diameter of core. Name and address of owner or operator of drill. Dates when drilling was done. Signed core log and sketch in duplicate.
For Compressed Air or Other Power Driven or Mechanical Equipment
Type of drill or equipment. Names and addresses of men engaged in operating equipment and the dates and hours of their employment.
For Power Stripping - Type of equipment. Name and address of owner or operator. Amount expended. Dates on which work was done. Proof of actual cost must be submitted within 30 days of recording.
With each of the above types of work sketches are required to show the location and extent of the work in relation to the nearest claim post. In the case of diamond or other core drilling the sketch must be submitted in duplicate.
For Geological and Geophysical Survey - The names and addresses of men employed as well as dates. Type of instrument used in the case of geophysical survey. Reports and maps in duplicate must be filed with the Minister within 60 days of recording.
For Land Survey - the name and address of Ontario Land surveyor.

The Required Information is as Follows: (Attach a list if this space is insufficient)

Hole 6742-3 - 454 feet; -50°; 7/8"
D.D. Owner: Vaughan Thompson
290 Kerrybrook Drive,
Richmond Hill, Ontario
Drilled from March 2 - March 7, 1968

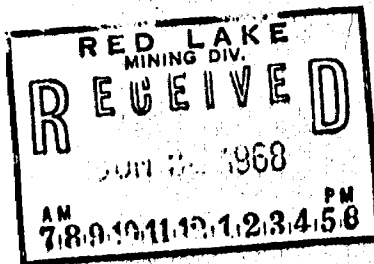

Date ... June 10, 1968

Signature of Recorded Holder or Agent

The Mining Act Certificate Verifying Report of Work

I, Orville Alexander Seeber
Suite 908 - 330 Bay St., Toronto 1, Ontario
(Post Office Address)

hereby certify:

- 1. That I have a personal and intimate knowledge of the facts set forth in the report of work annexed hereto, having performed the work or witnessed same during and/or after its completion.
2. That the annexed report is true.

Dated ... June 10, 1968

Signature

THE PENALTY FOR MAKING A FALSE STATEMENT IN THIS REPORT AND/OR CERTIFICATE IS \$500. OR SIX MONTHS IMPRISONMENT OR BOTH

CARR LAKE.

LIST OF CLAIMS WITH NUMBER OF DAYS TO BE APPLIED TO EACH

<u>Claim No.</u>	<u>Days</u>	<u>Claim No.</u>	<u>Days</u>	<u>Claim No.</u>	<u>Days</u>
KRL-60906	<u>6</u>	KRL-60886	<u>6</u>	KRL-59398	<u>7</u>
60905	<u>6</u>	60889	<u>6</u>	59397	<u>7</u>
60904	<u>6</u>			59402	<u>7</u>
60903	<u>6</u>	59380	<u>7</u>	59403	<u>7</u>
60902	<u>6</u>	59379	<u>7</u>	59851	<u>7</u>
60901	<u>6</u>	59378	<u>7</u>	59852	<u>7</u>
60900	<u>6</u>	59377	<u>7</u>	59411	<u>7</u>
60907	<u>6</u>	59376	<u>7</u>	59405	<u>7</u>
60899	<u>6</u>	59375	<u>7</u>	59404	<u>7</u>
60898	<u>6</u>	59381	<u>7</u>	59849	<u>7</u>
60897	<u>6</u>	59382	<u>7</u>	59850	<u>7</u>
60896	<u>6</u>	59383	<u>7</u>	59410	<u>7</u>
60895	<u>6</u>	59384	<u>7</u>	59406	<u>7</u>
60894	<u>6</u>	59385	<u>7</u>		
60893	<u>6</u>	59390	<u>7</u>	59407	<u>3</u>
60892	<u>6</u>	59389	<u>7</u>	59847	<u>3</u>
60891	<u>6</u>	59388	<u>7</u>	59848	<u>3</u>
60888	<u>6</u>	59387	<u>7</u>	59409	<u>3</u>
60887	<u>6</u>	59386	<u>7</u>	59408	<u>3</u>
60884	<u>6</u>	59391	<u>7</u>	59845	<u>3</u>
60883	<u>6</u>	59392	<u>7</u>	59846	<u>3</u>
60880	<u>6</u>	59394	<u>7</u>		
⁶⁰⁸⁷⁹ 60897	<u>6</u>	59395	<u>7</u>		
60878	<u>6</u>	59396	<u>7</u>		
60881	<u>6</u>	59401	<u>7</u>		
60882	<u>6</u>	59400	<u>7</u>		
60885	<u>6</u>	59399	<u>7</u>		

TOTAL

454'





ONTARIO

THE MINING ACT REPORT OF WORK

A separate form is required for each type of work to be recorded.

To the Recorder of RED LAKE Mining Division
Big Nama Creek Mines Limited - T-86 undivided
Laradona Mines Limited - T-87 50% interest each
name of Recorded Holder Miner's Licence
Suite 908 - 330 Bay St., Toronto 1, Ontario
Post Office Address

do hereby report the performance of 490 days of Diamond Drilling type of work
not before reported to be applied on the following contiguous claims

Table with 6 columns: Claim No., Days, Claim No., Days, Claim No., Days. Content: See attached list

All the work was performed on Mining Claim (s) KRL-59378
(In the case of geological and/or geophysical survey (s) where more than 18 claims are involved attach a schedule)

READ CAREFULLY: THE FOLLOWING INFORMATION IS REQUIRED BY THE MINING RECORDER.

- For Manual Work, Stripping or Opening up of Mines, Sinking Shafts or Other Actual Mining Operations - Names and addresses of the men who performed the work and the dates and hours of their employment.
For Diamond and other Core Drilling - Footage, No. and angle of holes and diameter of core. Name and address of owner or operator of drill. Dates when drilling was done. Signed core log and sketch in duplicate.
For Compressed Air or Other Power Driven or Mechanical Equipment
Type of drill or equipment. Names and addresses of men engaged in operating equipment and the dates and hours of their employment.
For Power Stripping - Type of equipment. Name and address of owner or operator. Amount expended. Dates on which work was done. Proof of actual cost must be submitted within 30 days of recording.
With each of the above types of work sketches are required to show the location and extent of the work in relation to the nearest claim post. In the case of diamond or other core drilling the sketch must be submitted in duplicate.
For Geological and Geophysical Survey - The names and addresses of men employed as well as dates. Type of instrument used in the case of geophysical survey. Reports and maps in duplicate must be filed with the Minister within 60 days of recording.
For Land Survey - the name and address of Ontario Land surveyor.

The Required Information is as Follows: (Attach a list if this space is insufficient)

Hole 6742-4- 490 feet; -50°; 7/8"

D.D.Owner - Vaughan Thompson
290 Kerrybrook Drive
Richmond Hill, Ontario

Drilled from March 12 - March 17, 1968

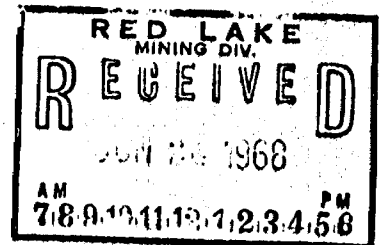

Date June 10, 1968

Signature of Recorded Holder or Agent

The Mining Act Certificate Verifying Report of Work

Orville Alexander Seeber
Suite 908 - 330 Bay St., Toronto 1, Ontario
(Post Office Address)

hereby certify:

- 1. That I have a personal and intimate knowledge of the facts set forth in the report of work annexed hereto, having performed the work or witnessed same during and/or after its completion.
2. That the annexed report is true.

Dated June 10 19 68

Signature

THE PENALTY FOR MAKING A FALSE STATEMENT IN THIS REPORT AND/OR CERTIFICATE IS \$500. OR SIX MONTHS IMPRISONMENT OR BOTH

CARBONATE.

LIST OF CLAIMS WITH NUMBER OF DAYS TO BE APPLIED TO EACH

<u>Claim No.</u>	<u>Days</u>	<u>Claim No.</u>	<u>Days</u>	<u>Claim No.</u>	<u>Days</u>
KRL-60906	<u>3</u>	KRL-60886	<u>3</u>	KRL-59398	<u>10</u>
60905	<u>3</u>	60889	<u>3</u>	59397	<u>10</u>
60904	<u>3</u>			59402	<u>10</u>
60903	<u>3</u>	59380	<u>10</u>	59403	<u>10</u>
60902	<u>3</u>	59379	<u>10</u>	59851	<u>10</u>
60901	<u>3</u>	59378	<u>10</u>	59852	<u>10</u>
60900	<u>3</u>	59377	<u>10</u>	59411	<u>10</u>
60907	<u>3</u>	59376	<u>10</u>	59405	<u>10</u>
60899	<u>3</u>	59375	<u>10</u>	59404	<u>10</u>
60898	<u>3</u>	59381	<u>10</u>	59849	<u>10</u>
60897	<u>3</u>	59382	<u>10</u>	59850	<u>10</u>
60896	<u>3</u>	59383	<u>10</u>	59410	<u>10</u>
60895	<u>3</u>	59384	<u>10</u>	59406	<u>10</u>
60894	<u>3</u>	59385	<u>10</u>		
60893	<u>3</u>	59390	<u>10</u>	59407	<u>5</u>
60892	<u>3</u>	59389	<u>10</u>	59847	<u>5</u>
60891	<u>3</u>	59388	<u>10</u>	59848	<u>5</u>
60888	<u>3</u>	59387	<u>10</u>	59409	<u>5</u>
60887	<u>3</u>	59386	<u>10</u>	59408	<u>5</u>
60884	<u>3</u>	59391	<u>10</u>	59845	<u>4</u>
60883	<u>3</u>	59392	<u>10</u>	59846	<u>4</u>
60880	<u>3</u>	59394	<u>10</u>		
60879	<u>3</u>	59395	<u>10</u>		
60878	<u>3</u>	59396	<u>10</u>		
60881	<u>3</u>	59401	<u>10</u>		
60882	<u>3</u>	59400	<u>10</u>		
60885	<u>3</u>	59399	<u>10</u>		

TOTAL

490'



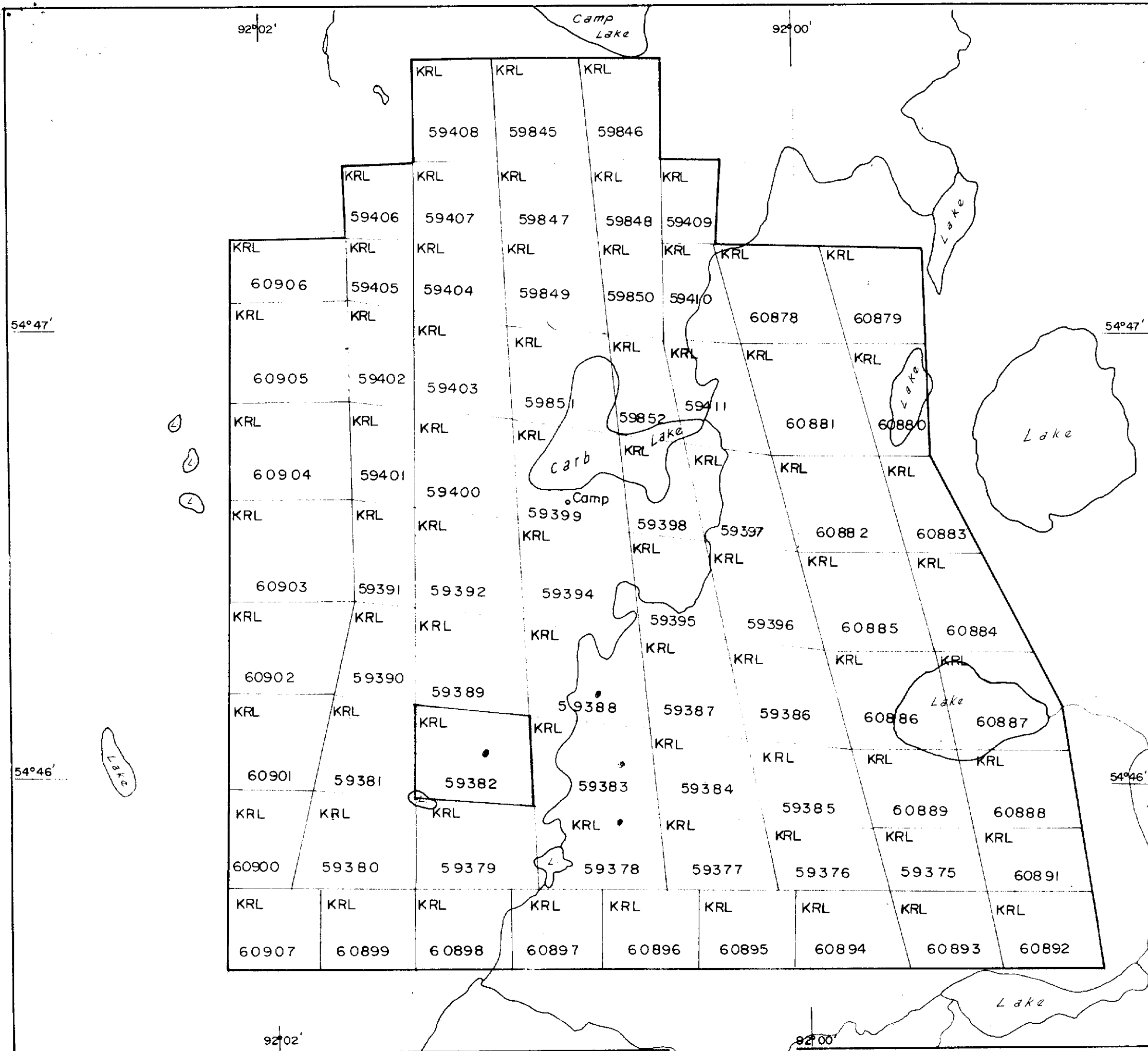

53K16SE000100

200

Ben B. Brown

**BIG NAMA CREEK MINES LIMITED
& LARANDONA MINES LIMITED**
 DISTRICT of KENORA, (Patricia portion), RED LAKE Mng. Div.
CARB LAKE AREA M.2016

CLAIM MAP

Drawn cah	Checked OAS	Scale 1" = 1/4 ml.	Date Dec. 1967	Project 6742
--------------	----------------	-----------------------	-------------------	-----------------

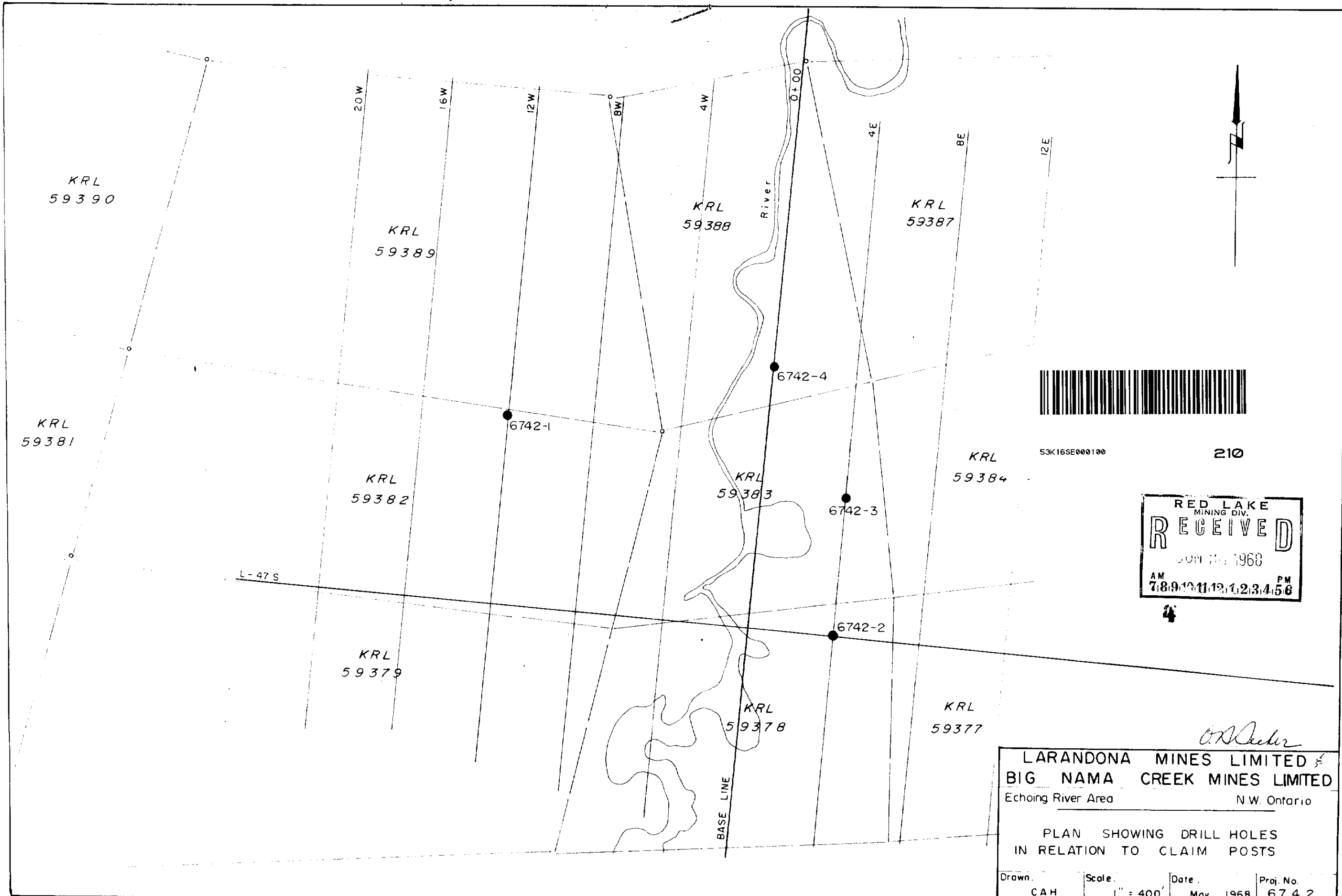

KRL
59390

KRL
59389

KRL
59388

KRL
59387

KRL
59381

6742-1

6742-4



53K16SE000100

210

KRL
59382

KRL
59383

KRL
59384

6742-3

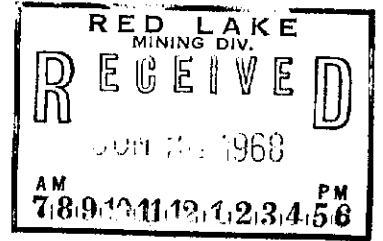

L-47 S

KRL
59379

6742-2

KRL
59378

KRL
59377

O. A. Becker

LARANDONA MINES LIMITED &
BIG NAMA CREEK MINES LIMITED
Echoing River Area N.W. Ontario
PLAN SHOWING DRILL HOLES
IN RELATION TO CLAIM POSTS
Drawn: CAH Scale: 1" = 400' Date: May 1968 Proj. No. 6742