

Terms of Use: NOTICE: This is a dated, archived document that does not represent current mining claim activity in Ontario. This archived document is provided for information purposes only and MNDM and the Government of Ontario accept no liability and make no warranty or any representation regarding the use, accuracy, applicability, completeness, performance, availability, security or reliability of the information. *This archive "Historical Claim Map" does not meet provincial accessibility standards. If you need accessible formats, communication support or would like information about this map please contact the Provincial Recording Office @ 1-888-415-9845 Ext 5784. For current mining claim status, please use the MNDM online claim maps website at: <http://www.mndm.gov.on.ca/en/mines-and-minerals/applications/claimaps>

817

MINISTRY OF NATURAL RESOURCES
SURVEYS AND MAPPING BRANCH

April, 1984

DISTRICT OF SUDBURY

Scale - 40 Chains - 1 Inch

AREAS WITHDRAWN FROM DISPOSITION

Description	Order No.	Date	Disposition	File
SEC. 34/80	W. 2/83	7/4/83	M.R.O.	188539
SEC. 34/80	W. 2/84	16/3/84	M.S.S.	188540

SELBY

NOTE

400' Surface Rights Reservation
around all Lakes and Rivers.

Township closed to staking effective May 8/1978,
Sec. 38(f) of the Mining Act.

② TOWNSHIP CLOSED TO STAKING EFFECTIVE
MARCH 16, 1984, SEC. 34 OF THE
MINING ACT

DUNDEE

SHELBURNE

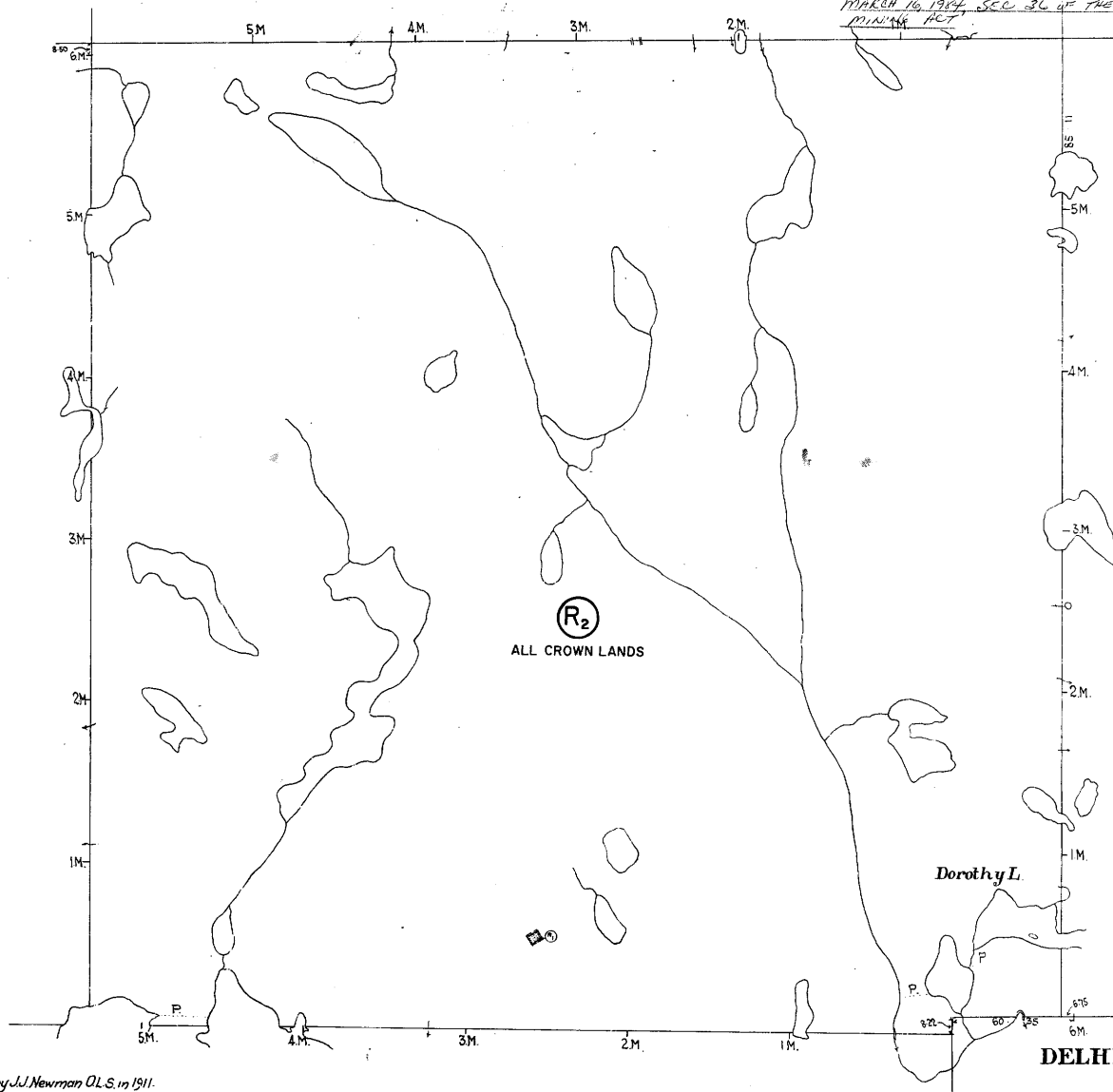

North boundary run by J.J. Newman O.L.S. in 1911.
South boundary, East part of run by J.J. Newman O.L.S. 1911.
West - J.J. Newman O.L.S. 1910.
East boundary run by J.J. Newman O.L.S. in 1911.
West boundary run by R.S. Code O.L.S. in 1912.
Lakes and Rivers from Published Map 21° 1928.

SEAGRAM

ACADIA

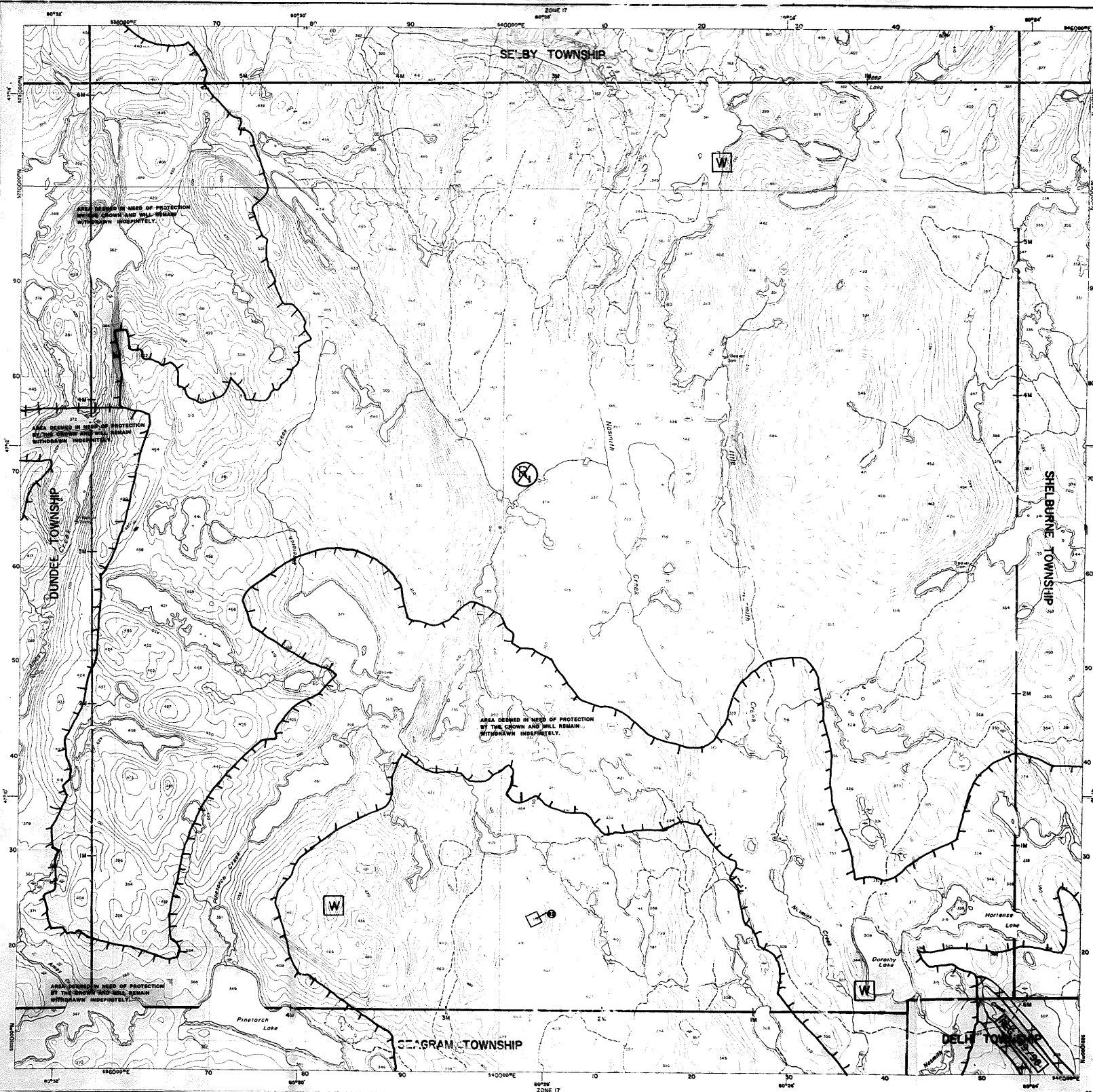

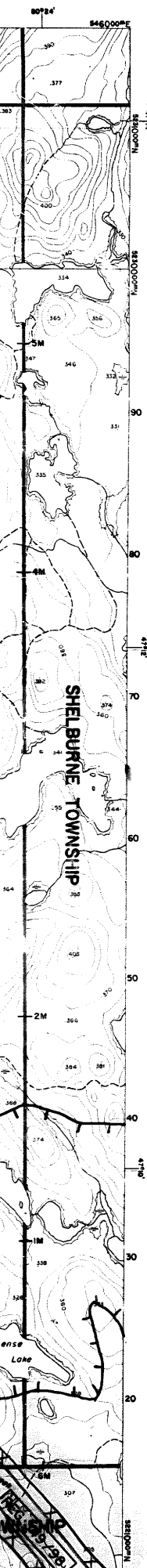

INDEX TO LAND DISPOSITION

PLAN

G-4002

TOWNSHIP

ACADIA

M.N.R. ADMINISTRATIVE DISTRICT

SUDBURY

MINING DIVISION

SUDBURY

LAND TITLES/REGISTRY DIVISION

SUDBURY

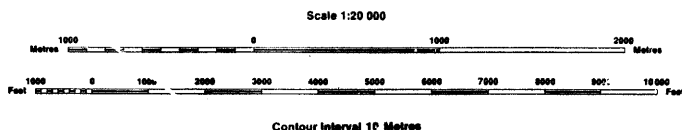

SYMBOLS

Boundary	
Township, Meridian, Baseline	
Road allowance; surveyed	
shoreline	
Lot/Concession; surveyed	
unsurveyed	
Parcel; surveyed	
unsurveyed	
Right-of-way; road	
railway	
utility	
Reservation	
Cliff, Pit, Pile	
Contour	
Interpolated	
Approximate	
Depression	
Control point (horizontal)	
Flooded land	
Mine head frame	
Pipeline (above ground)	
Railway; single track	
double track	
abandoned	
Road; highway, county, township	
access	
trail, bush	
Shoreline (original)	
Transmission line	
Wooded area	

AREAS WITHDRAWN FROM DISPOSITION

MRO - Mining Rights Only

SRO - Surface Rights Only

M + S - Mining and Surface Rights

Description	Order No.	Date	Disposition	File
SEC.35/90	W-3-22-90	09/10/90	M & S	195150
SEC.35/90 W-5-71-90	W-5-71-90	09/10/90	M & S	195150
SEC.35/90	W-3-21-90	09/13/90	M & S	195150
SEC.35/90	W-3-20-90	09/13/90	M & S	195150
SEC.35/90	W-3-23-90	09/13/90	M & S	195150

NOTES

23 **W** AREA DEEMED IN NEED OF PROTECTION BY THE CROWN AND WILL REMAIN WITHDRAWN INDEFINITELY.

24 **TTT** AREA DEEMED IN NEED OF PROTECTION BY THE CROWN AND WILL REMAIN WITHDRAWN INDEFINITELY.

**THIS TOWNSHIP FALLS WITHIN THE TEMAGAMI
COMPREHENSIVE PLANNING AREA. SPECIAL WORKING
CONDITIONS MAY APPLY TO EXPLORATION ACTIVITIES.
FOR MORE DETAILS PLEASE CONTACT:**

**DISTRICT MANAGER,
NORTH BAY DISTRICT
MINISTRY, NATURAL RESOURCES**

DISPOSITION OF CROWN LANDS

Patent	Ⓒ
Surface & Mining Rights	Ⓒ
Surface Rights Only	Ⓒ
Mining Rights Only	Ⓒ
Lease	Ⓒ
Surface & Mining Rights	Ⓒ
Surface Rights Only	Ⓒ
Mining Rights Only	Ⓒ
Licence of Occupation	Ⓒ
Order-in-Council	Ⓒ
Cancelled	Ⓒ
Reservation	Ⓒ
Sand & Gravel	Ⓒ

THE INFORMATION THAT APPEARS ON THIS MAP HAS BEEN COMPILED FROM VARIOUS SOURCES, AND ACCURACY IS NOT GUARANTEED. THOSE WISHING TO STAKE MINING CLAIMS SHOULD CONSULT WITH THE MINING RECORDER, MINISTRY OF NORTHERN DEVELOPMENT AND MINES, FOR ADDITIONAL INFORMATION ON THE STATUS OF THE LANDS SHOWN HEREON.

NOTICE

REG 349/98

WORK PERMITS FOR MINERAL EXPLORATION ACTIVITY
EFFECTIVE September 15th 1998
 The area outlined as "X" on this map will be subject to Ontario Regulation 349/98 made under the Public Lands Act. Depending on the type and timing of your exploration work you may require a Work Permit. For further information please contact Gerhard Meyer, Regional Resident Geologist at (705) 567-5242 or Jim Ireland, Regional Manager at (705) 235-1612

DATE OF ISSUE

MAR 30 1988

SUDBURY
MINING RECORDER'S OFFICE

ACADIA TOWNSHIP