

Terms of Use: NOTICE: This is a dated, archived document that does not represent current mining claim activity in Ontario. This archived document is provided for information purposes only and MNDM and the Government of Ontario accept no liability and make no warranty or any representation regarding the use, accuracy, applicability, completeness, performance, availability, security or reliability of the information. *This archive "Historical Claim Map" does not meet provincial accessibility standards. If you need accessible formats, communication support or would like information about this map please contact the Provincial Recording Office @ 1-888-415-9845 Ext 5784. For current mining claim status, please use the MNDM online claim maps website at: <http://www.mndm.gov.on.ca/en/mines-and-minerals/applications/claimaps>

REFERENCES

LEASE WITHDRAWN FROM DISPOSITION

M.R.O. - MINING RIGHTS ONLY
 S.R.O. - SURFACE RIGHTS ONLY
 M.S. - MINING AND SURFACE RIGHTS

FLOODING
 Filing reservation on Matigami River to contour
 over 700 feet to Ontario Hydro for development at
 Les Falls.

THE INFORMATION THAT
 APPEARS ON THIS MAP
 HAS BEEN COMPILED
 FROM VARIOUS SOURCES
 AND ACCURACY IS NOT
 GUARANTEED. THOSE
 WISHING TO STAKE MIN-
 ING CLAIMS SHOULD CON-
 SULT WITH THE MINING
 RECORDER, MINISTRY OF
 NORTHERN DEVELOP-
 MENT AND MINES, FOR AD-
 DITIONAL INFORMATION
 ON THE STATUS OF THE
 LANDS SHOWN HEREON.

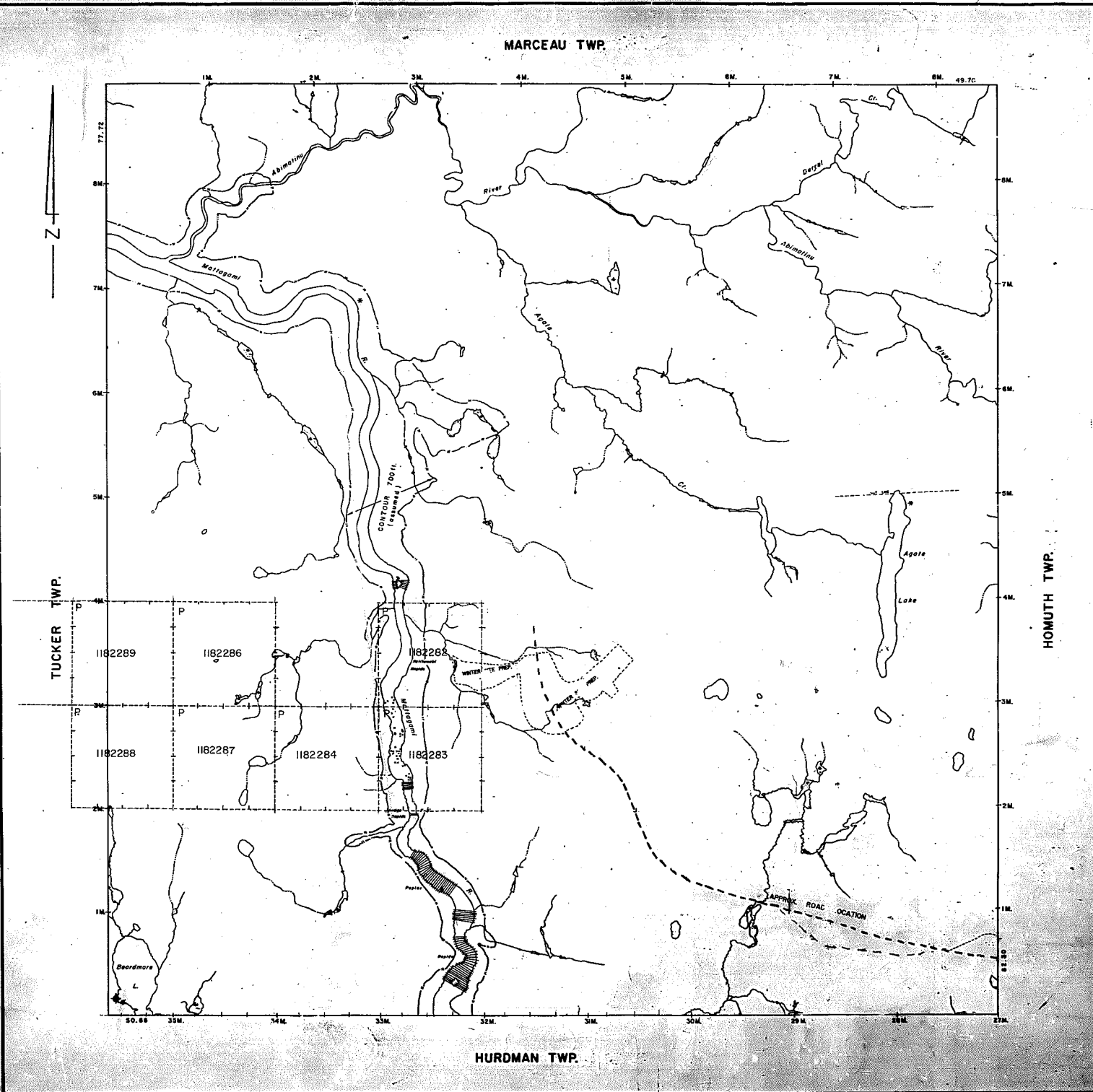

LEGEND

- HIGHWAY AND ROUTE No.
- OTHER ROAD
- TRAIL
- SURVEYED LINES:
 - TOWNSHIP, BASE LINES, ETC.
 - LOTS, MINING CLAIMS, PARCELS, ETC.
- UNSURVEYED LINES:
 - LOT LINES
 - PARCEL BOUNDARY
 - MINING CLAIMS ETC.
- RAILWAY AND RIGHT OF WAY
- UTILITY LINES
- NON-PERMANENT STREAM
- FLOODING OR FLOODING RIGHTS
- SUBDIVISION OR COMPOSITE PLAN
- RESERVATION
- ORIGINAL SHORELINE
- MARSH OR MUCKS
- IMPER
- TRAVERSE MONUMENT

DISPOSITION OF CROWN LANDS

TYPE OF DOCUMENT	SYMBOL
PATENT, SURFACE & MINING RIGHTS	
SURFACE RIGHTS ONLY	
MINING RIGHTS ONLY	
LEASE, SURFACE & MINING RIGHTS	
SURFACE RIGHTS ONLY	
MINING RIGHTS ONLY	
LICENSE OF OCCUPATION	
ORDER-IN-COUNCIL	
RESERVATION	
CANCELLED	
SAND & GRAVEL	
LAND USE FORE...	

NOTE: MINING RIGHTS IN PARCELS PATENTED PRIOR TO MAY 4, 1978, VESTED IN ORIGINAL PATENTEES BY THE PUBLIC LANDS ACT, P.L.A. 1974, CHAP. 20, SEC. 43, SUBSEC. 7, UNLESS CANCELLED.

★ REMOTE TOURIST CAMP



TERRITORY
AGATE
 B.C.S. ADMINISTRATIVE DISTRICT
COCHRANE
 MINING DIVISION
PONCEPINE
 LAND TITLES & REGISTRY DIVISION
COCHRANE

Ministry of Northern Development and Mines
 Ministry of Natural Resources and Forestry

G-3466

1686

Marceau Twp.

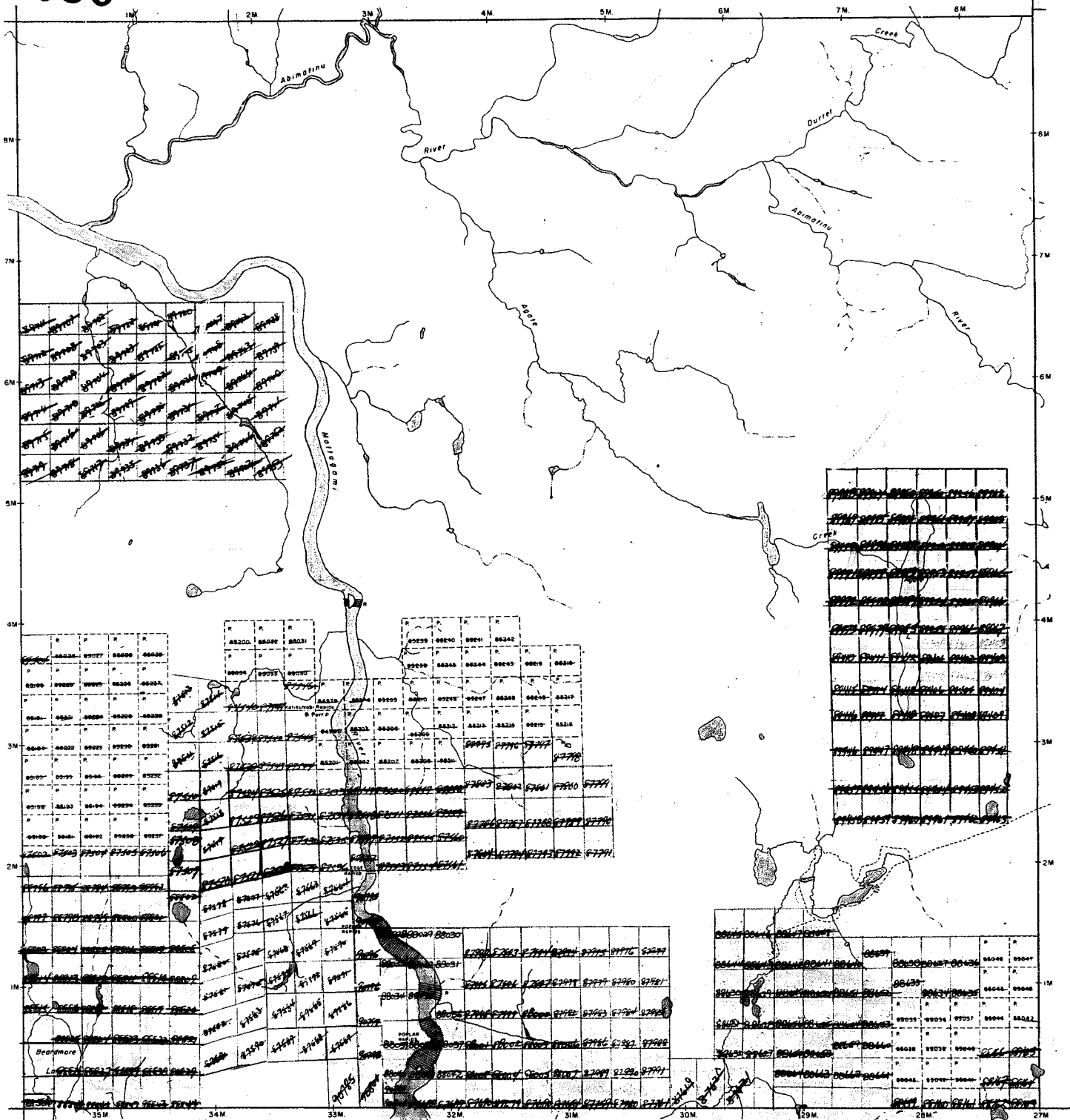

THE TOWNSHIP OF

AGATE

DISTRICT OF COCHRANE

PORCUPINE MINING DIVISION

SCALE: 1-INCH = 40 CHAINS

LEGEND

- PATENTED LAND ⊙
- CROWN LAND SALE ⊙
- LEASES ⊙
- LOCATED LAND ⊙
- LICENSE OF OCCUPATION ⊙
- MINING RIGHTS ONLY MRJ
- SURFACE RIGHTS ONLY SRO
- ROADS —
- IMPROVED ROADS —
- KING'S HIGHWAYS —
- RAILWAYS —
- POWER LINES —
- MARSH OR MUSKES —
- MINES ⊙
- CANCELLED C

NOTES

400' Surface Rights Reservation around all lakes and rivers



PLAN NO. M1686

DEPARTMENT OF MINES - ONTARIO -

Tucker Twp. - M.1165

Homuth Twp. - M.505

Hurdman Twp. - M.509

1686

Marceau Twp.

THE TOWNSHIP OF

AGATE

DISTRICT OF COCHRANE

PORCUPINE MINING DIVISION

SCALE: 1-INCH = 40 CHAINS

LEGEND

- PATENTED LAND ⊙
- CROWN LAND SALE ⊙
- LEASES ⊙
- LOCATED LAND ⊙
- LICENSE OF OCCUPATION ⊙
- MINING RIGHTS ONLY M.R.O.
- SURFACE RIGHTS ONLY S.R.O.
- ROADS —
- IMPROVED ROADS —
- KING'S HIGHWAYS —
- RAILWAYS —
- POWER LINES —
- MARSH OR MUSKIEG —
- MINES ⊙
- CANCELLED ⊙

NOTES

400' Surface Rights Reservation around all lakes and rivers

Tucker Twp. - M.1165

Homuth Twp. - M.505

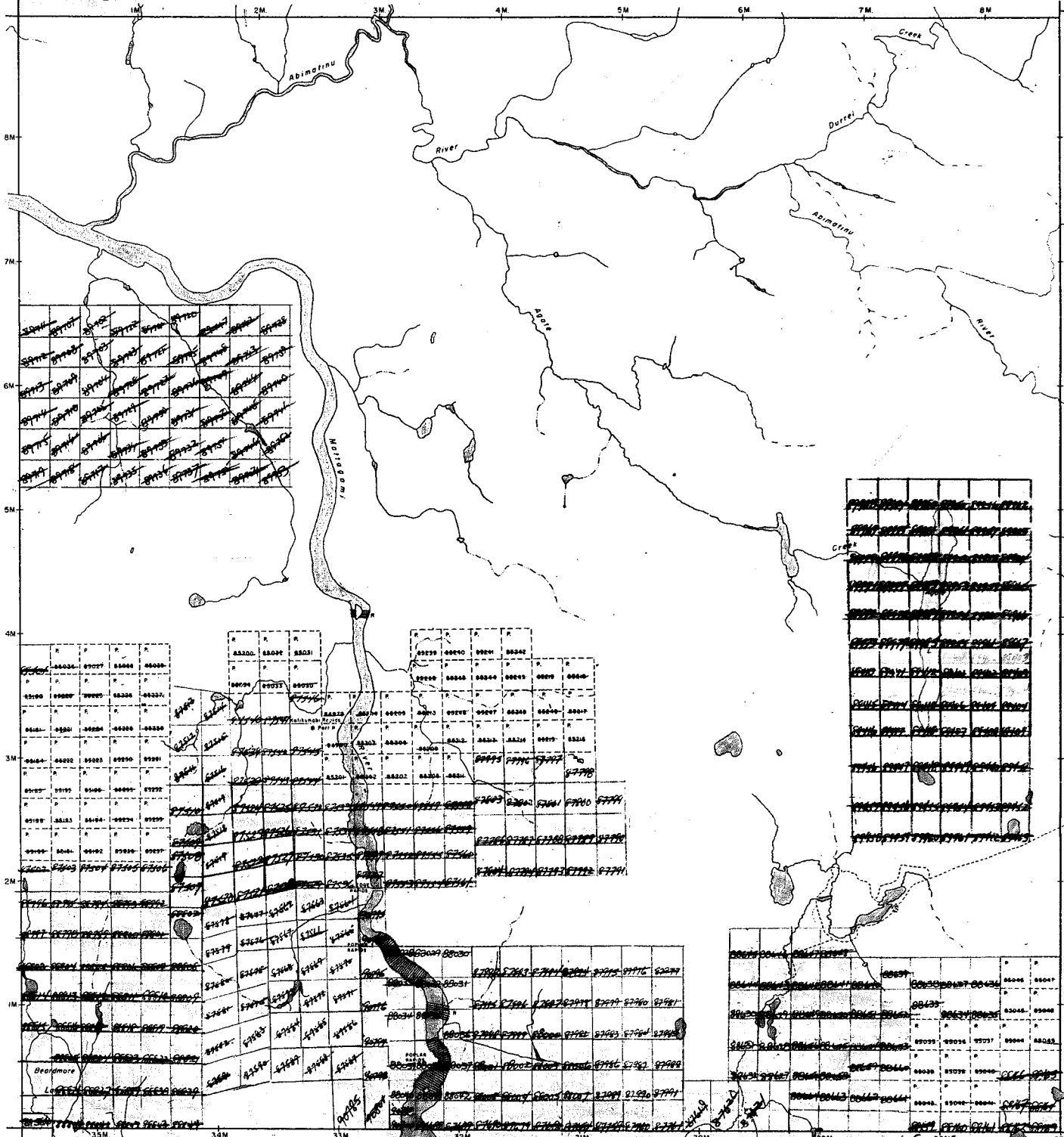

PLAN NO. - M1686

DEPARTMENT OF MINES
- ONTARIO -

Hurdman Twp. - M.509

Marceau Twp.

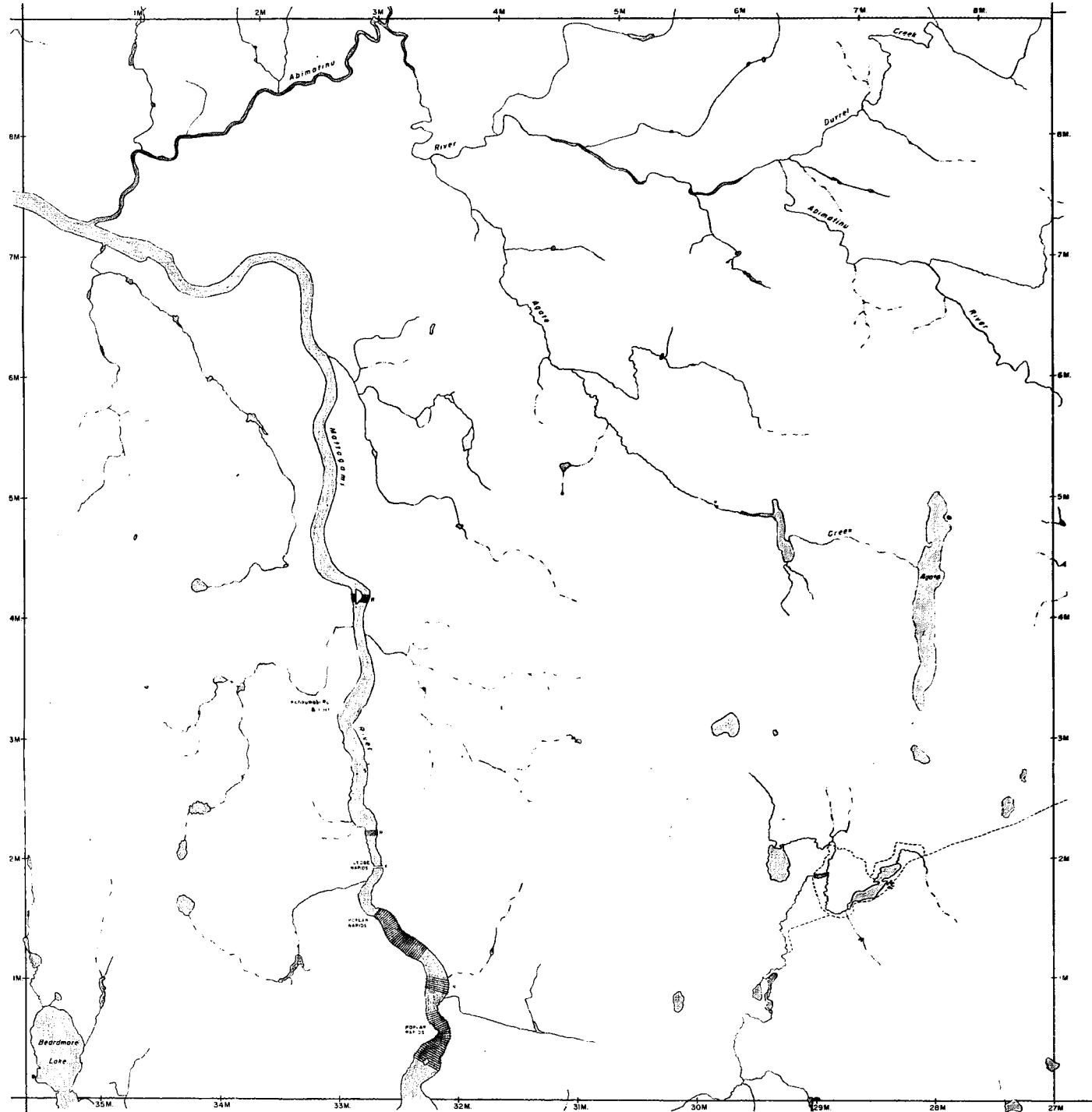

Tucker Twp. - M.1165

Homuth Twp. - M.505

Hurdman Twp. - M.509

THE TOWNSHIP
OF

AGATE

DISTRICT OF
COCHRANE

**PORCUPINE
MINING DIVISION**

SCALE: 1-INCH = 40 CHAINS

LEGEND

PATENTED LAND	⊙
CROWN LAND SALE	⊙
LEASES	⊙
LOCATED LAND	⊙
LICENSE OF OCCUPATION	⊙
MINING RIGHTS ONLY	⊙
SURFACE RIGHTS ONLY	⊙
ROADS	—
IMPROVED ROADS	—
KING'S HIGHWAYS	—
RAILWAYS	—
POWER LINES	—
MARSH OR MUDS	—
MINES	—
CANCELLED	—

NOTES

400' Surface Rights Reservation around all lakes and rivers.

R.P.

PORCUPINE MINING DIVISION
RECEIVED
 MAR 10 1972
 AM 7 18 19 10 11 12 13 14 15 16 PM

PLAN NO. **M.1686**

**ONTARIO
DEPARTMENT OF MINES
AND NORTHERN AFFAIRS**

Marceau Twp.

Tucker Twp. - M.1165

Homuth Twp. - M.505

Hurdman Twp. - M.509

THE TOWNSHIP OF

AGATE

DISTRICT OF COCHRANE

PORCUPINE MINING DIVISION

SCALE: 1-INCH = 40 CHAINS

LEGEND

PATENTED LAND	⊙
CROWN LAND SALE	⊙
LEASES	⊙
LOCATED LAND	⊙
LICENSE OF OCCUPATION	⊙
MINING RIGHTS ONLY	⊙
SURFACE RIGHTS ONLY	⊙
ROADS	—
IMPROVED ROADS	—
KANSAS HIGHWAYS	—
RAILWAYS	—
POWER LINES	—
MARSH OR BARKS	—
WEEKS	—
CANCELLED	—

NOTES

400' Surface Rights Reservation around all lakes and rivers.

• L.U.P.
Fluvial Reservations on Mattagami River to Contour Elevation 700-Ft Reserved to Ontario Hydro

Received Feb. 1965

PLAN NO. M1686

ONTARIO

MINISTRY OF NATURAL RESOURCES
SURVEYS AND MAPPING BRANCH

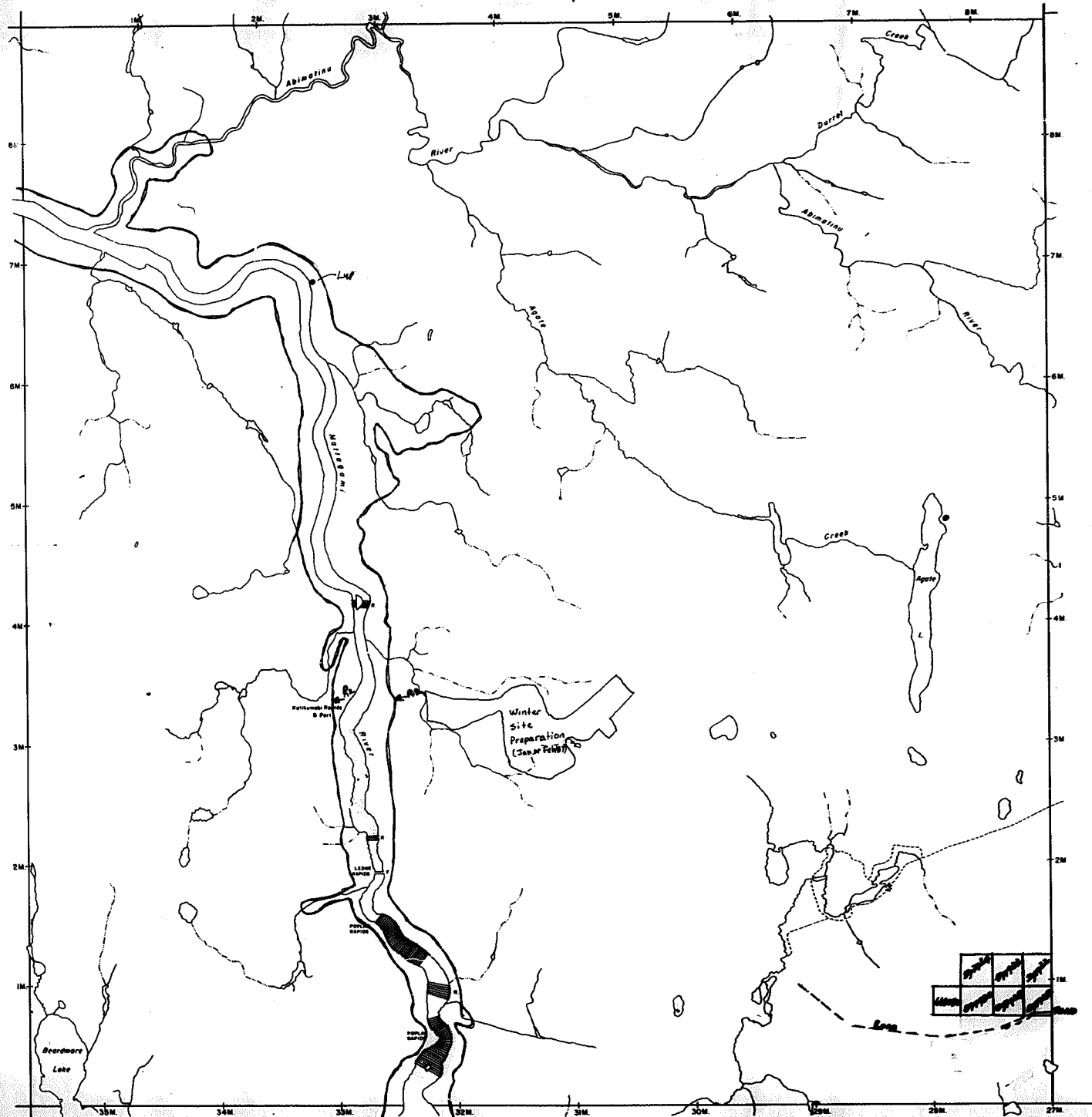

REFERENCES

LEAS WITHDRAWN FROM DISPOSITION
 M.R.O. - MINING RIGHTS ONLY
 S.R.O. - SURFACE RIGHTS ONLY
 M+S. - MINING AND SURFACE RIGHTS

Description Order No. Date Disposition File

MARCEAU TWP.

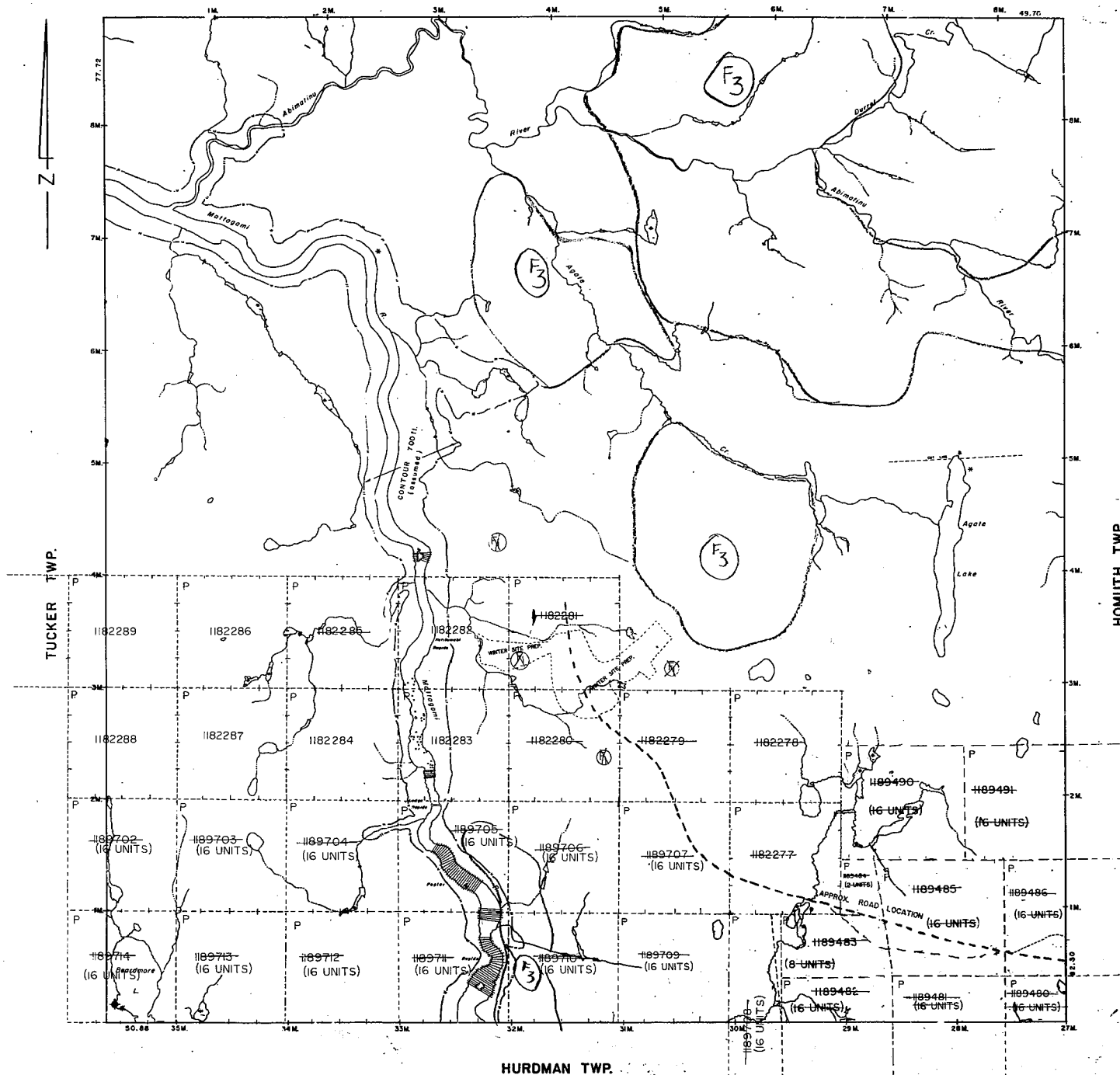

FLOODING
 Calling reservation on Mattagami River to contour section 70011 for Ontario Hydro for development of Press Falls.

THE INFORMATION THAT APPEARS ON THIS MAP HAS BEEN COMPILED FROM VARIOUS SOURCES, AND ACCURACY IS NOT GUARANTEED. THOSE WISHING TO STAKE MINING CLAIMS SHOULD CONSULT WITH THE MINING RECORDER, MINISTRY OF NORTHERN DEVELOPMENT AND MINES, FOR ADDITIONAL INFORMATION ON THE STATUS OF THE LANDS SHOWN HEREON.

LEGEND

- ROADWAY AND ROUTE No.
- OTHER ROADS
- TRAILS
- SURVEYED LINES:
 - TOWNSHIP, BASE LINES, ETC.
 - LOTS, MINING CLAIMS, PARCELS, ETC.
- UNSURVEYED LINES:
 - LOT LINES
 - PARCEL BOUNDARY
 - MINING CLAIMS ETC.
- RAILWAY AND RIGHT OF WAY
- UTILITY LINES
- NON-PERMANENT STREAM
- FLOODING OR FLOODING RISKS
- SUBDIVISION OR COMPOSITE PLAN
- RESERVATIONS
- ORIGINAL SHORELINE
- MARSH OR MUSKEL
- MINES
- TRAVERSE MONUMENT

DISPOSITION OF CROWN LANDS

TYPE OF DOCUMENT	SYMBOL
PATENT, SURFACE & MINING RIGHTS	
" SURFACE RIGHTS ONLY	
" MINING RIGHTS ONLY	
LEASE, SURFACE & MINING RIGHTS	
" SURFACE RIGHTS ONLY	
" MINING RIGHTS ONLY	
LICENCE OF OCCUPATION	
ORDER-IN-COUNCIL	
RESERVATION	
CANCELLED	
SAND & GRAVEL LAND USE RIGHT	

REMOTE TOURIST CAMP

THIS TWP. IS SUBJECT TO FORESTRY ACTIVITY IN 1993-94. FURTHER INFORMATION AVAILABLE ON FILE. (NOTICE REGD. MAY 25, 1993)

THIS TWP. IS SUBJECT TO FOREST ACTIVITY IN 1994-95. FURTHER INFORMATION AVAILABLE ON FILE.

THIS TWP. IS SUBJECT TO FOREST ACTIVITY IN 1995-96. FURTHER INFORMATION AVAILABLE ON FILE.

DATE OF ISSUE

JAN 19 1999

PROVINCIAL RECORDS OFFICE - SUDBURY



TOWNSHIP
AGATE
 N.E.S. ADMINISTRATIVE DISTRICT
COCHRANE
 MINING DIVISION
PORCUPINE
 LAND TITLES / REGISTRY DIVISION
COCHRANE

Ministry of Northern Resources
 Ministry of Northern Development and Mines
 Ontario

Date: OCTOBER, 1990
 Number: **G-3466**