

MCFARLAN TWP.

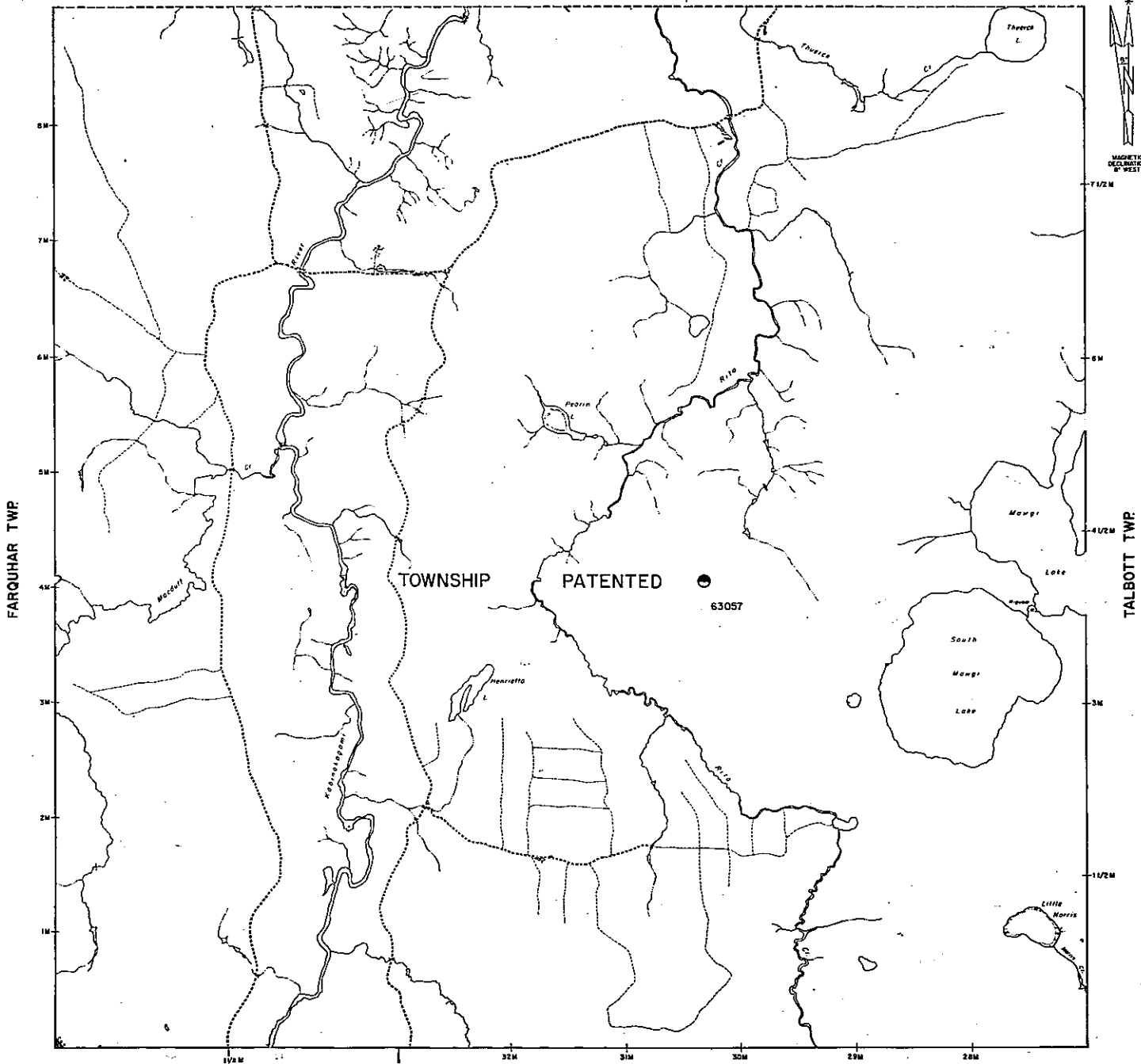

MAGNETIC DECLINATION 8° WEST

**LEGEND**

HIGHWAY AND ROUTE No.	
OTHER ROADS	
TRAILS	
SURVEYED LINES:	
TOWNSHIPS, BASE LINES, ETC.	
-LOTS, MINING CLAIMS, PARCELS, ETC.	
UNSURVEYED LINES:	
LOT LINES	
PARCEL BOUNDARY	
MINING CLAIMS ETC.	
RAILWAY AND RIGHT OF WAY	
UTILITY LINES	
NON-PERENNIAL STREAM	
FLOODING OR FLOODING RIGHTS	
SUBDIVISION OR COMPOSITE PLAN	
RESERVATIONS	
ORIGINAL SHORELINE	
MARSH OR MUSKEG	
MINES	
TRAVERSE MONUMENT	

**DISPOSITION OF CROWN LANDS**

TYPE OF DOCUMENT	SYMBOL
PATENT, SURFACE & MINING RIGHTS	
SURFACE RIGHTS ONLY	
MINING RIGHTS ONLY	
LEASE, SURFACE & MINING RIGHTS	
SURFACE RIGHTS ONLY	
MINING RIGHTS ONLY	
LICENSE OF OCCUPATION	
ORDER-IN-COUNCIL	
RESERVATION	
CANCELLED	
SAND & GRAVEL	

NOTE: MINING RIGHTS IN PARCELS PATENTED PRIOR TO MAY 4, 1912, VESTED IN ORIGINAL PATENTEE BY THE PUBLIC LANDS ACT, R.S.O. 1914, CHAP. 286, SEC. 63, SUBSEC. 1

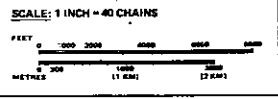

THE INFORMATION THAT APPEARS ON THIS MAP HAS BEEN COMPILED FROM VARIOUS SOURCES, AND ACCURACY IS NOT GUARANTEED. THOSE WISHING TO STAKE MINING CLAIMS SHOULD CONSULT WITH THE MINING RECORDER, MINISTRY OF RECOVERER, MINISTRY OF NORTHERN DEVELOPMENT AND MINES, FOR ADDITIONAL INFORMATION ON THE STATUS OF THE LANDS SHOWN HEREON.

TOWNSHIP  
**ALDERSON**  
M.M.R. ADMINISTRATIVE DISTRICT  
**HEARST**  
MINING DIVISION  
**PORCUPINE**  
LAND TITLES / REGISTRY DIVISION  
**ALGOMA**

Ontario Ministry of Natural Resources Ministry of Northern Development and Mines

DATE: JULY, 1986. Number  
G-1548

A-21-9  
ALDERSON TWP  
G-1248

1135

# PLAN OF ALDERSON TWP.

SAULT STE. MARIE MINING DIVISION.  
DISTRICT OF ALGOMA.

Scale, 40 chains to an inch.

MCFARLAN TWP.

M-1135

MINERAL RIGHTS  
OPEN FOR STAKING  
June 29/64 7AM. EST  
of Act 5 ch. 5, June 1/64

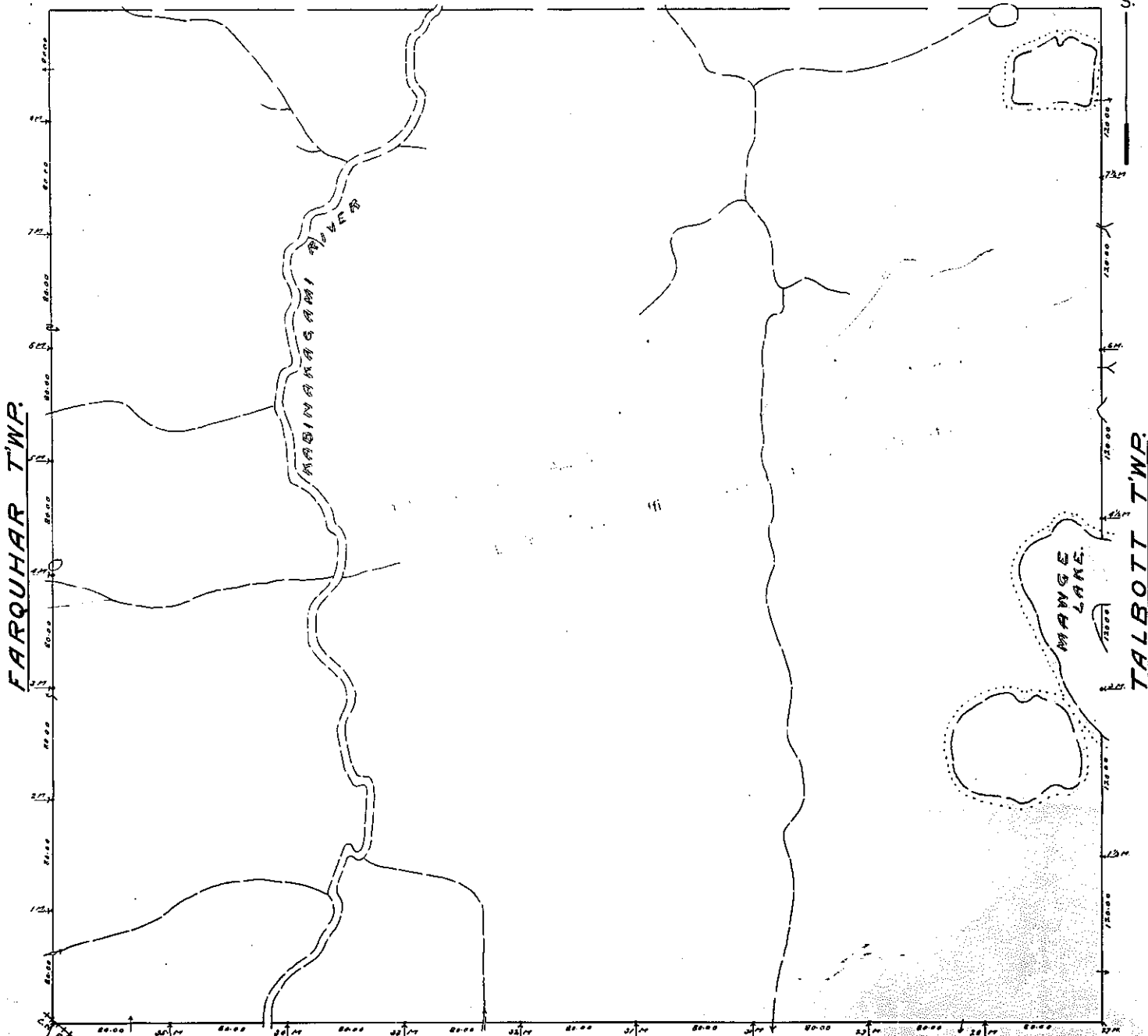
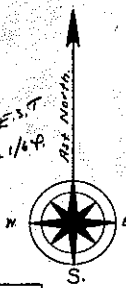

FARQUHAR TWP.

TALBOTT TWP.

FRANZ TWP.

Surface reservations 400' wide by Dept of L. & C. shown hereon thus

NOTE The course of the Kabinakagami River, & a few streams & Lakes shown hereon is approximate, only excepting on the main river & Lake Superior, where they are located by actual survey.

# PLAN OF ALDERSON TWP.

SAULT STE. MARIE MINING DIVISION.  
DISTRICT OF ALGOMA.

NOTE  
Surface Rights Only of  
This Township, Patented.

— Scale, 40 chains to an inch. —

McFARLAN TWP.

10

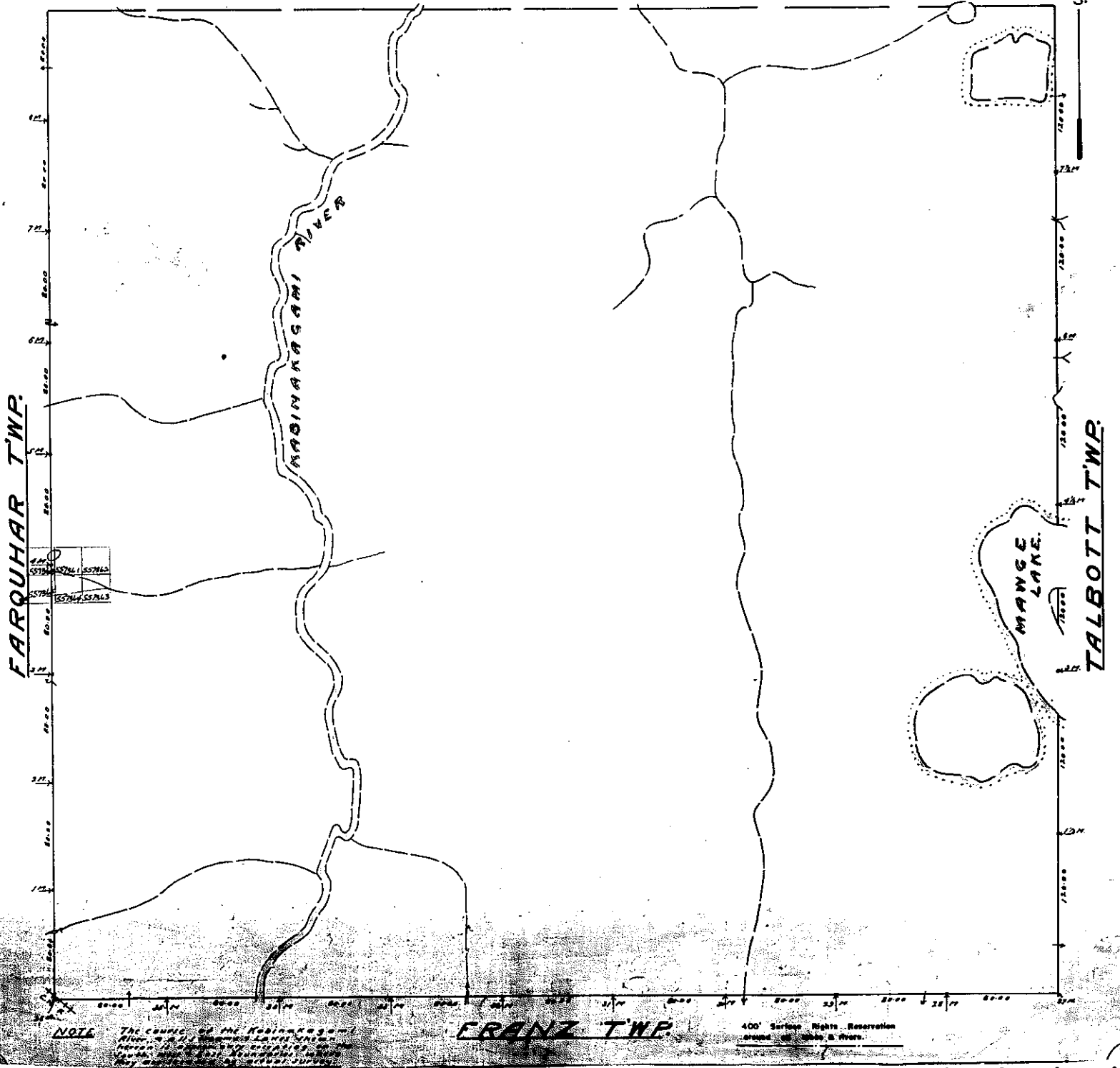

1135

# PLAN OF ALDERSON TWP.

SAULT STE. MARIE MINING DIVISION  
DISTRICT OF ALGOMA.

Scale, 40 chains to an inch.

McFARLAN TWP.

M. 1135

MINERAL RIGHTS  
OPEN FOR STAKING  
June 29/64 7AM. EST  
of Mass. 25. June 1/64



FARQUHAR TWP.

TALBOTT TWP.

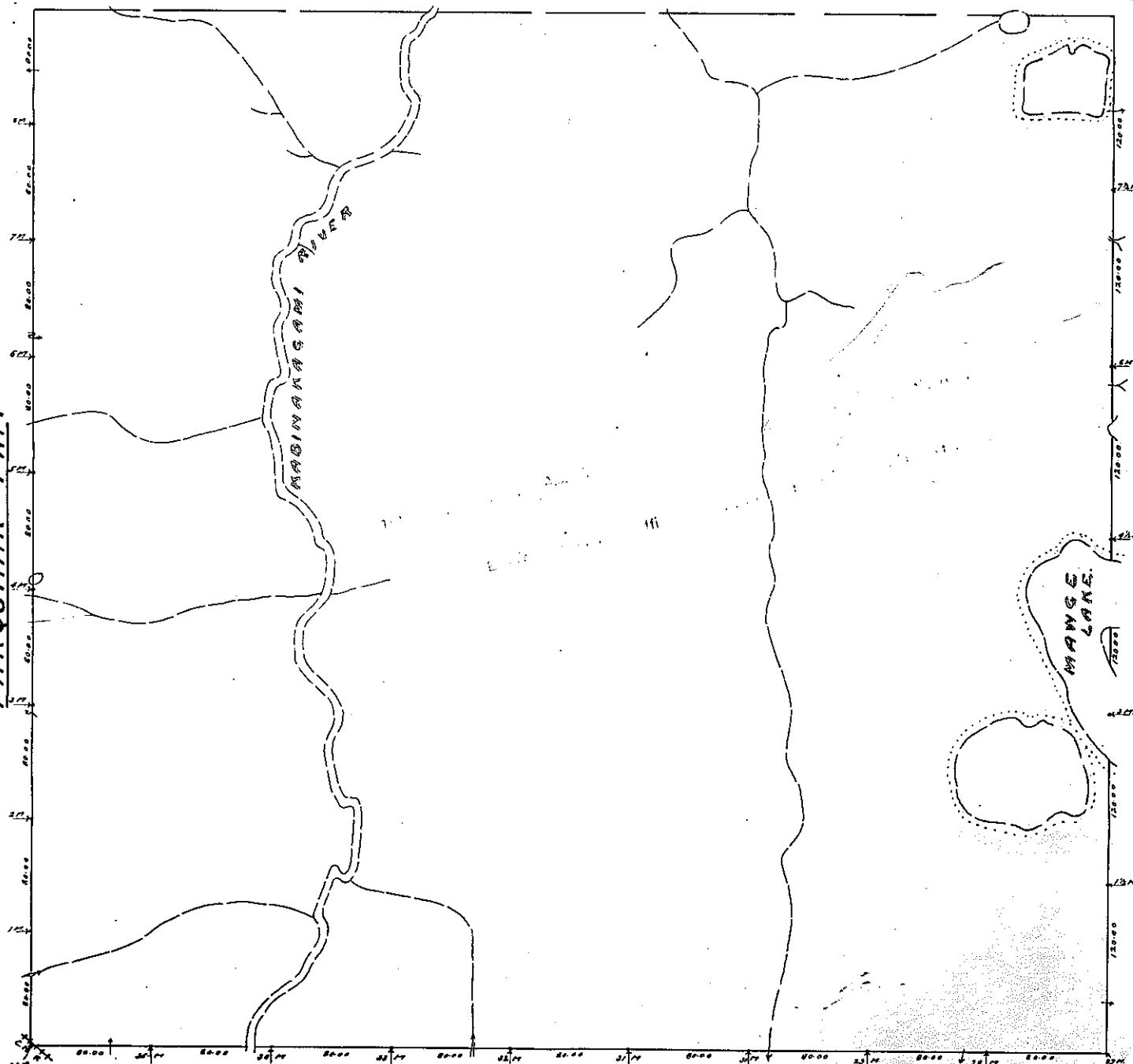

**NOTE** The course of the Robinson River, a stream of water hereon is shown, only excepting on the South, West & East boundaries where they are located by actual survey.

FRANZ TWP. Surface reservations 100' wide by Dept of L. & S. shown hereon thus: [dotted line symbol]

McFARLAN TWP G-2333

FARQUHAR TWP G-2307

TALBOTT TWP G-2357

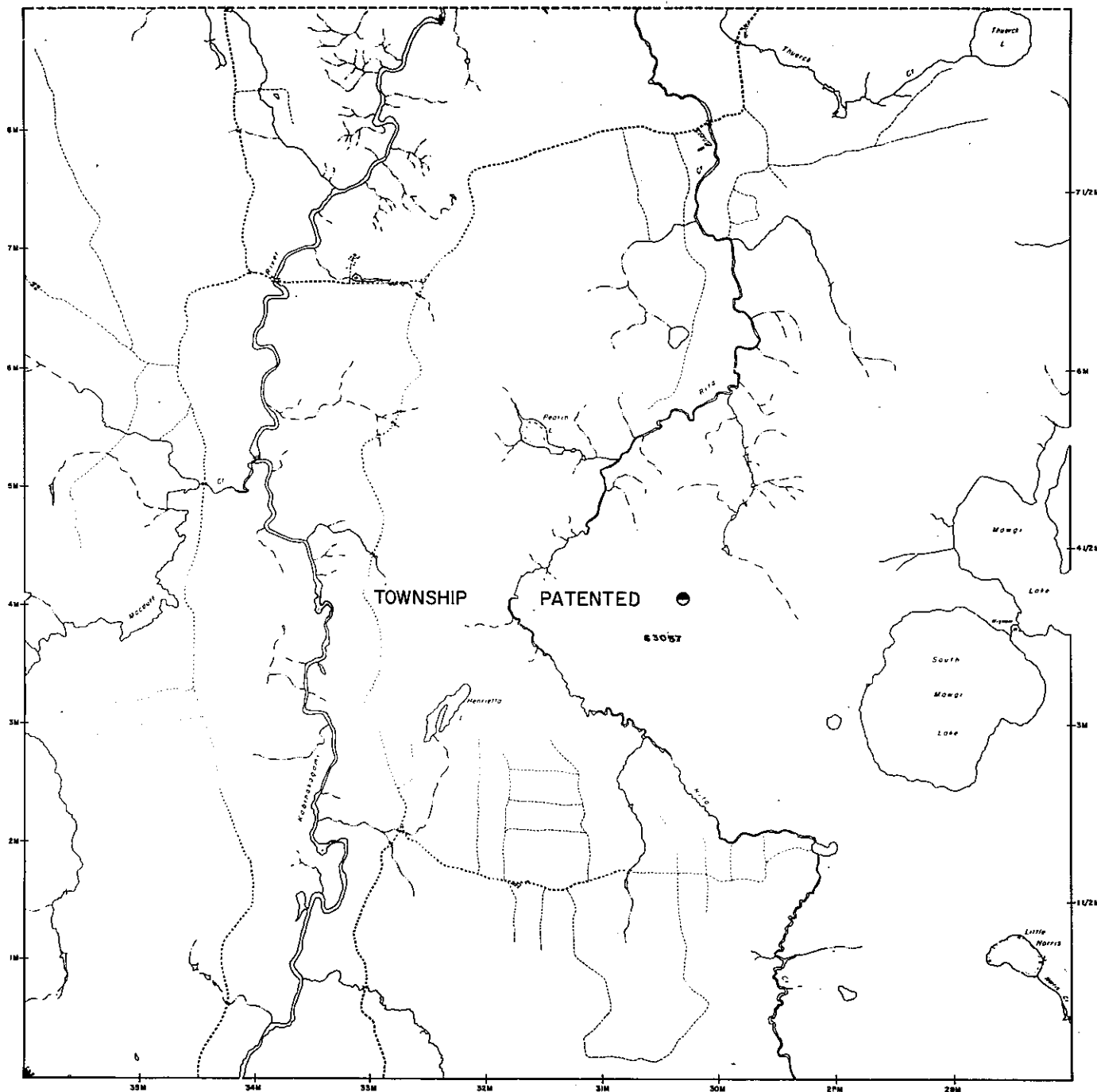

FRANZ TWP G-1005

**LEGEND**

- HIGHWAY AND ROUTE No.
- OTHER ROADS
- TRAILS
- SURVEYED LINES:
  - TOWNSHIP, BARE LINES, ETC.
  - LOTS, MINING CLAIMS, PARCELS, ETC.
- UNSURVEYED LINES:
- LOT LINES
- PARCEL BOUNDARY
- MINING CLAIMS ETC.
- RAILWAY AND RIGHT OF WAY
- UTILITY LINES
- NON-PERSONAL STREAM
- FLOODING OR FLOODING RIGHTS
- SUBSIDY OR COMPORTE PLAN
- RESERVATIONS
- ORIGINAL SHORELINE
- MARSH OR MURLEG
- MINES
- TRAVERSE MONUMENT

**DISPOSITION OF CROWN LANDS**

TYPE OF DOCUMENT	SYMBOL
PATENT, SURFACE & MINING RIGHTS	
"    SURFACE RIGHTS ONLY	
"    MINING RIGHTS ONLY	
LEASE, SURFACE & MINING RIGHTS	
"    SURFACE RIGHTS ONLY	
"    MINING RIGHTS ONLY	
LICENCE OF OCCUPATION	
ORDER-IN-COUNCIL	
RESERVATION	
CANCELLED	
SAND & GRAVEL	

NOTE: MINING RIGHTS IN PARCELS PATENTED PRIOR TO MAY 6, 1911, VESTED IN ORIGINAL PATENTERS BY THE PUBLIC LANDS ACT, R.S.O. 1970, CHAP. 286, SEC. 68, SUBSEC. 1.

SCALE: 1 INCH = 40 CHAINS



TOWNSHIP

**ALDERSON**  
 N.B.S. ADMINISTRATIVE DISTRICT  
**HEARST**  
 MINING DIVISION  
**PORCUPINE**  
 LAND TITLES / REGISTRY DIVISION  
**ALGOA**



Date: MARCH, 1984.

Number

June 22, 1984 **G-1548**

B-21-C

ALDERSON TWP

G-1248

PLAN OF  
**ALDERSON TWP.**

M.1135

PORCUPINE MINING DIVISION.

DISTRICT OF ALGOMA.

NOTE

Surface Rights Only of  
This Township, Patented.  
Revised June 28/74.

ONTARIO  
MINISTRY OF NATURAL RESOURCES  
SURVEYS AND MAPPING BRANCH

— Scale, 40 chains to an inch. —

McFARLAN TWP.

