

# PLAN OF AMYOT TWP.

MONTREAL RIVER MINING DIVISION

## DISTRICT OF SUDBURY.

— Scale 40 chains to an inch. —

### SHEARD TWP.

M-629



MOFFAT TWP.

BROWNING TWP.

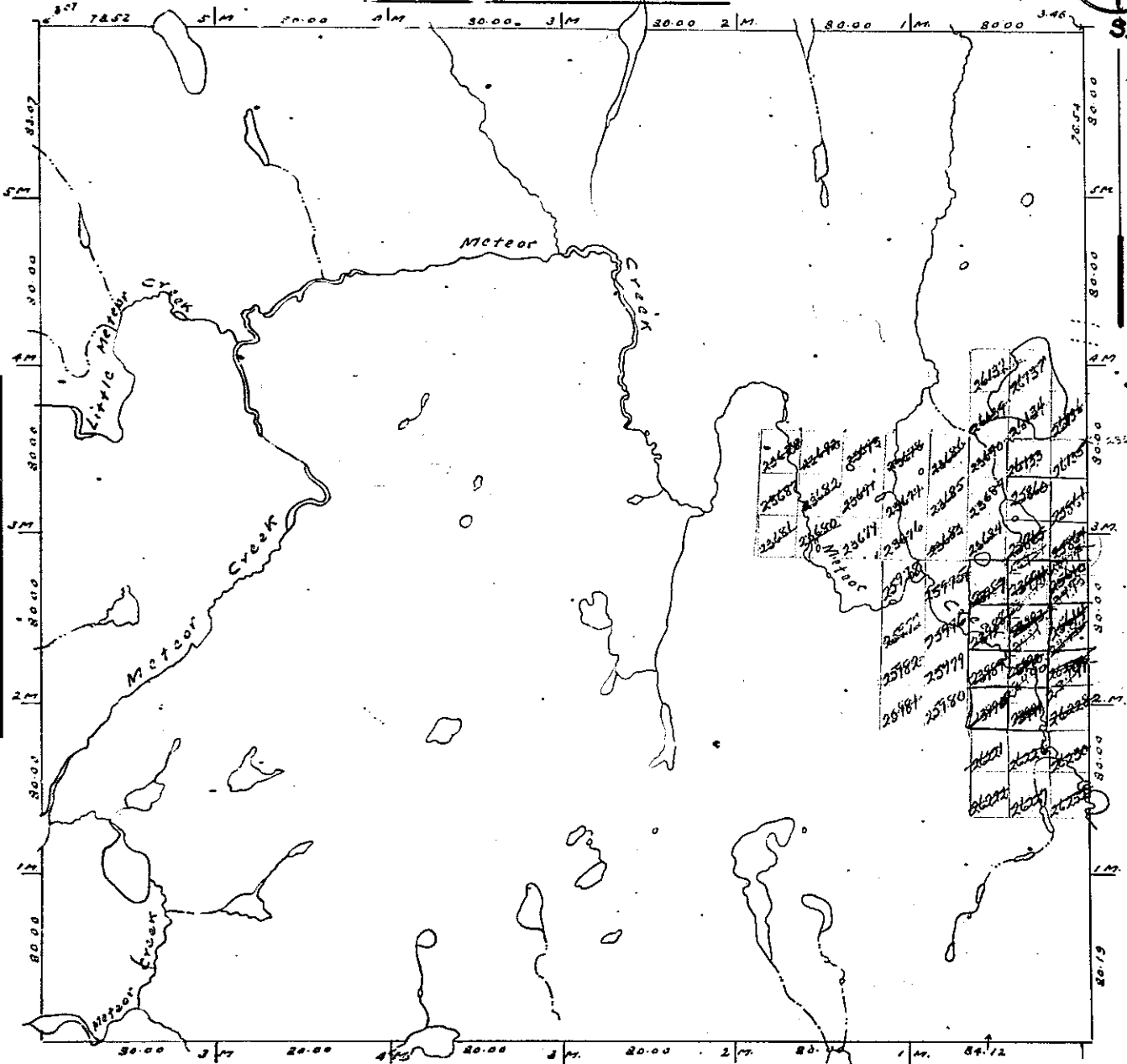

### HODGETTS TWP.

**Notes**

- Railways Shewn
- Paved Highways
- Gravel
- Highway Route No.
- Other Roads
- Trails & Paths
- Telephone & Telegraph Lines
- Electric Power Lines

- Non-perennial streams
- Bridges
- Buildings
- Swamps
- Areas marked (P) are Patented
- (L) Leased
- (L.O.) held under Licence of Occupation

# PLAN OF AMYOT TWP.

MONTREAL RIVER MINING DIVISION

## DISTRICT OF SUBURRY. M 629

Scale, 40 chains to an inch.

### SHEARD TWP.

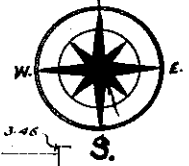

MOFFAT TWP.

BROWNING TWP.

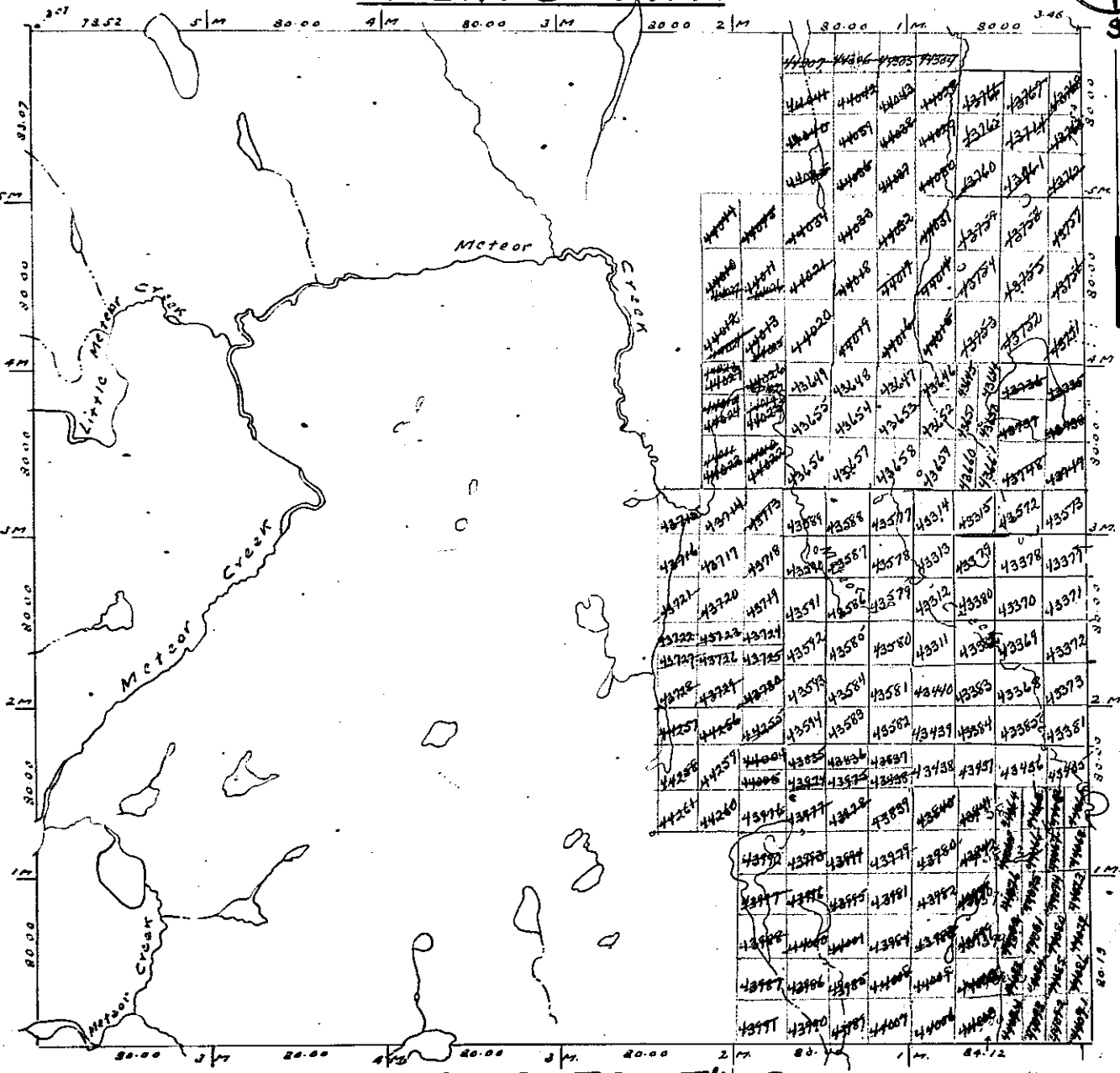

#### Notes

- Railways shown - - - - -
- Paved Highways - - - - -
- Gravel - - - - -
- Highway Route No. - - - - -
- Other Roads - - - - -
- Trails - - - - -
- Telephone Telegraph Lines - - - - -
- Electric Power Lines - - - - -
- Non-perennial streams - - - - -
- Bridges - - - - -
- Buildings - - - - -
- Swamps - - - - -
- Flags marked ⊗ are Patented
- ⓪ " " Ledges
- Ⓛ " " held under Licence of Occupation

Sheard Twp. M.1107

THE TOWNSHIP  
OF

AMYOT

DISTRICT OF  
SUDBURYMONTREAL RIVER  
MINING DIVISION

SCALE: 1-INCH 40 CHAINS

## LEGEND

PATENTED LAND	⊙
CROWN LAND SALE	C.S.
LEASES	⊖
LOCATED LAND	Loc.
LICENSE OF OCCUPATION	L.O.
MINING RIGHTS ONLY	M.R.O.
SURFACE RIGHTS ONLY	S.R.O.
ROADS	—
IMPROVED ROADS	—
KING'S HIGHWAYS	—
RAILWAYS	—
POWER LINES	—
MARSH OR MUSKEG	—
MINES	⋆
CANCELLED	C.

## NOTES

400' Surface Rights Reservation around  
all lakes and rivers.

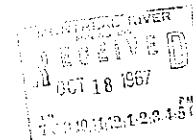
PLAN NO. **M.629**

DEPARTMENT OF MINES

— ONTARIO —

Moffat Twp. - M.867

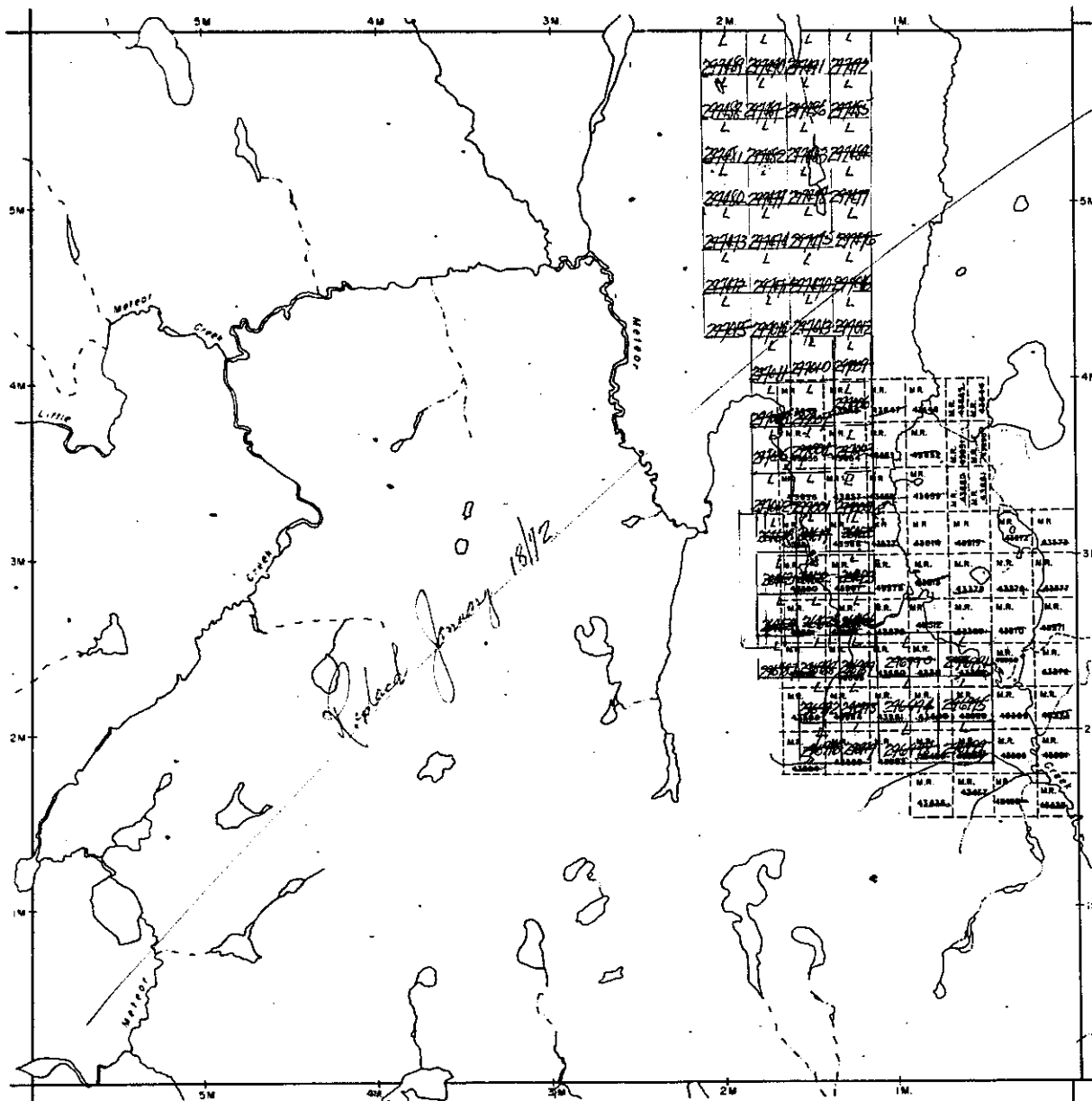

Browning Twp. - M.683

Hodgetts Twp. - M.933

THE TOWNSHIP  
OF

# AMYOT

DISTRICT OF  
SUDBURY

LARDER LAKE  
MINING DIVISION

SCALE: 1-INCH = 40 CHAINS

### LEGEND

PATENTED LAND	⊙
CROWN LAND SALE	C.S.
LEASES	⊕
LOCATED LAND	Loc.
LICENSE OF OCCUPATION	L.O.
MINING RIGHTS ONLY	M.R.O.
SURFACE RIGHTS ONLY	S.R.O.
ROADS	— — — — —
IMPROVED ROADS	— — — — —
KING'S HIGHWAYS	— — — — —
RAILWAYS	— — — — —
POWER LINES	— — — — —
MARSH OR MUSKEG	— — — — —
MINES	⋈
CANCELLED	C.

### NOTES

400' Surface Rights Reservation around  
all lakes and rivers.

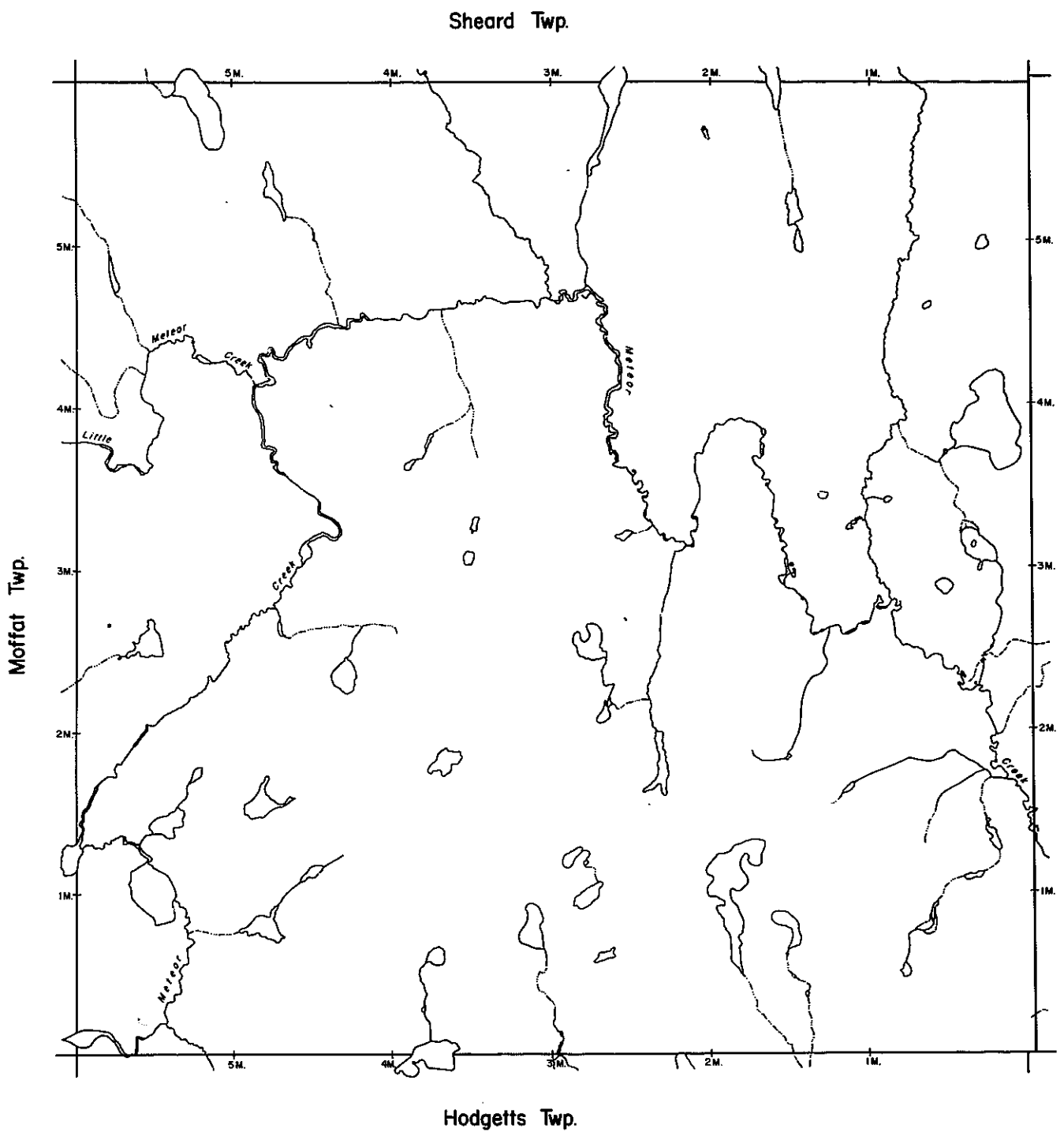

PLAN NO. **G-948**

DEPARTMENT OF MINES  
— ONTARIO —

# AMYOT

DISTRICT OF  
SUDBURY

LARDER LAKE  
MINING DIVISION

SCALE: 1-INCH = 40 CHAINS

### LEGEND

PATENTED LAND	Ⓟ
CROWN LAND SALE	C.S.
LEASES	Ⓞ
LOCATED LAND	L.C.
LICENSE OF OCCUPATION	L.O.
MINING RIGHTS ONLY	M.R.O.
SURFACE RIGHTS ONLY	S.R.O.
ROADS	— — — — —
IMPROVED ROADS	— — — — —
KING'S HIGHWAYS	— — — — —
RAILWAYS	— — — — —
POWER LINES	— — — — —
MARSH OR MUSKEG	Ⓜ
MINES	Ⓜ
CANCELLED	C.

### NOTES

400' Surface Rights Reservation around  
all lakes and rivers.

THE INFORMATION THAT  
APPEARS ON THIS MAP  
HAS BEEN COMPILED  
FROM VARIOUS SOURCES,  
AND ACCURACY IS NOT  
GUARANTEED. THOSE  
WISHING TO STAKE MIN-  
ING CLAIMS SHOULD CON-  
SULT WITH THE MINING  
RECORDER, MINISTRY OF  
NORTHERN DEVELOP-  
MENT AND MINES, FOR AD-  
DITIONAL INFORMATION  
ON THE STATUS OF THE  
LANDS SHOWN HEREON.

CIRCULATED  
DEC. 21, 1993.

PLAN NO. **G-948**

DEPARTMENT OF MINES

— ONTARIO —

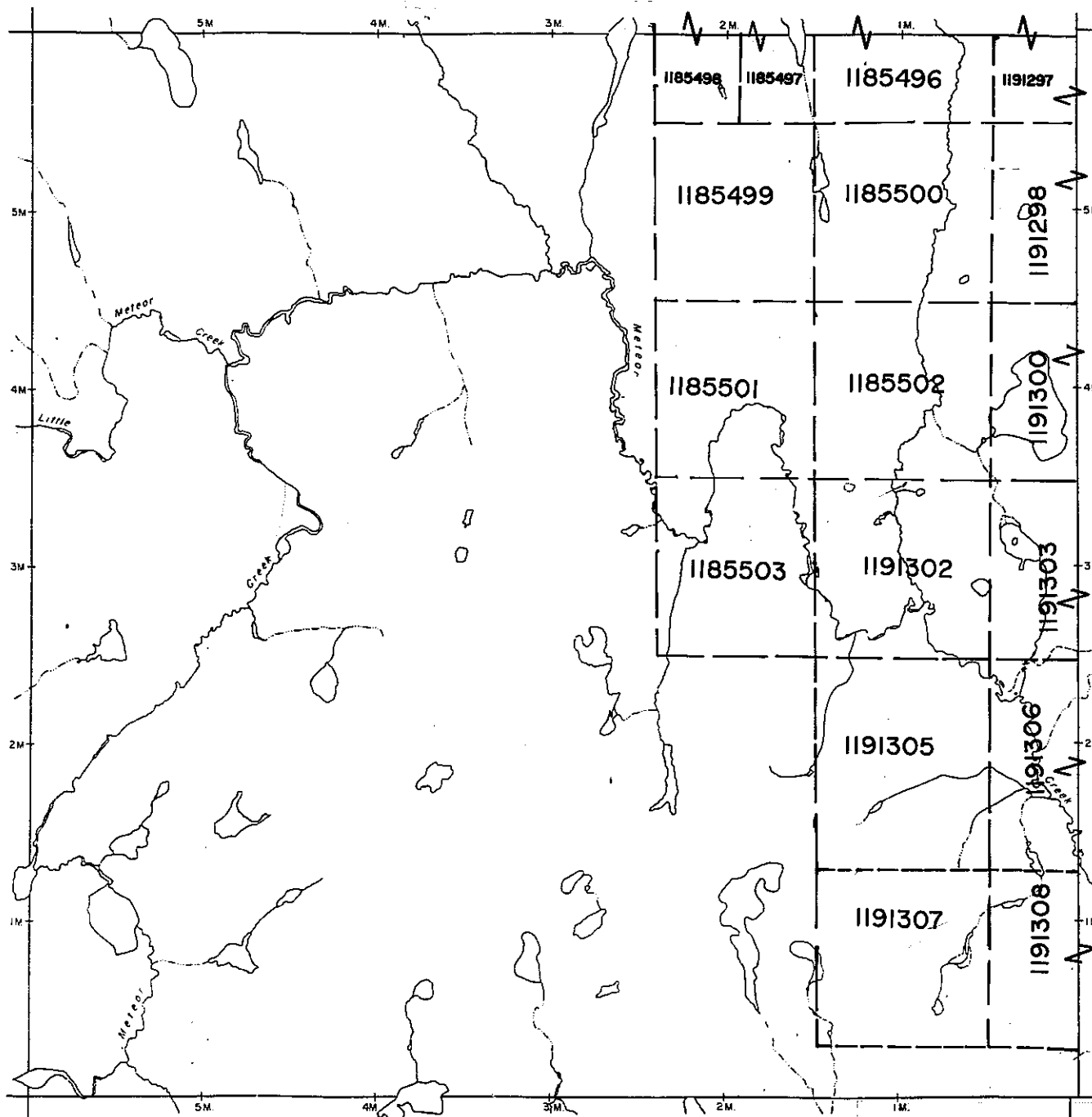

Hodgetts Twp.

### NOTICE OF FORESTRY ACTIVITY

THIS TOWNSHIP / AREA FALLS WITHIN THE  
SHINGTREE MANAGEMENT UNIT  
AND MAY BE SUBJECT TO FORESTRY OPERATIONS.  
THE MNR UNIT FORESTER FOR THIS AREA CAN BE  
CONTACTED AT: P.O. BOX 129

LOW AVENUE  
60680C, ONT.  
POM 110  
705-894-2000

Sheard Twp. M.1107

Moffat Twp. - M.867

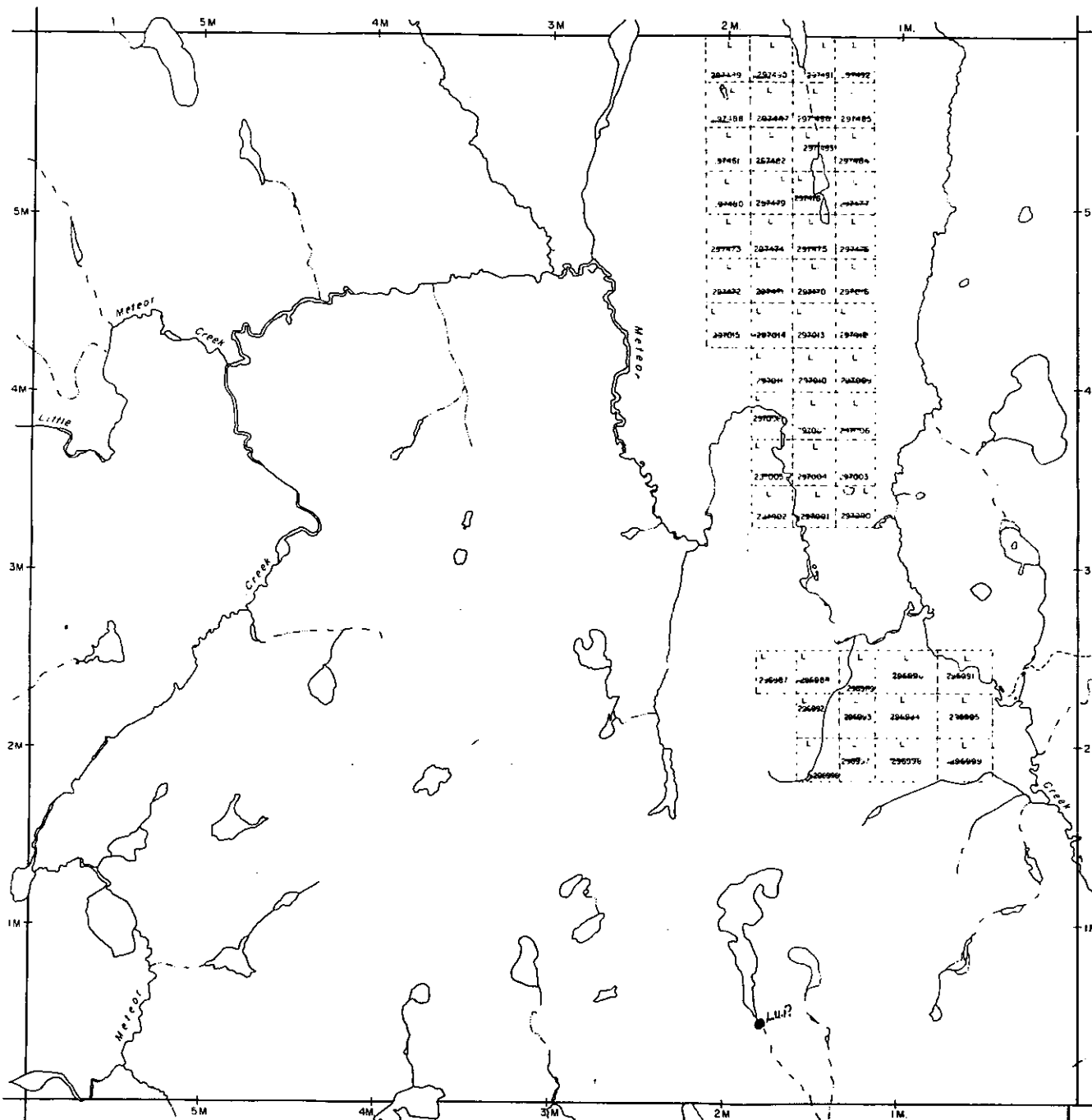

Hodgetts Twp. - M.933

Browning Twp. - M.683

THE TOWNSHIP  
OF

# AMYOT

DISTRICT OF  
SUDBURY

LARDER LAKE  
MINING DIVISION

SCALE: 1-INCH 40 CHAINS

### LEGEND

PATENTED LAND	⊙
CROWN LAND SALE	C.S
LEASES	L
LOCATED LAND	Loc.
LICENSE OF OCCUPATION	L.O.
MINING RIGHTS ONLY	M.R.O.
SURFACE RIGHTS ONLY	S.R.O.
ROADS	— — — — —
IMPROVED ROADS	— — — — —
KING'S HIGHWAYS	— — — — —
RAILWAYS	— — — — —
POWER LINES	— — — — —
MARSH OR MUSKOG	— — — — —
MINES	⊗
CANCELLED	⊘

### NOTES

400' Surface Rights Reservation around  
all lakes and rivers.

*Replaced Feb 6/80*

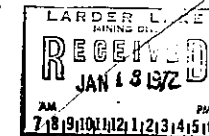

PLAN NO. **M.629**

ONTARIO  
DEPARTMENT OF MINES  
AND NORTHERN AFFAIRS

Sheard Twp. M.1107

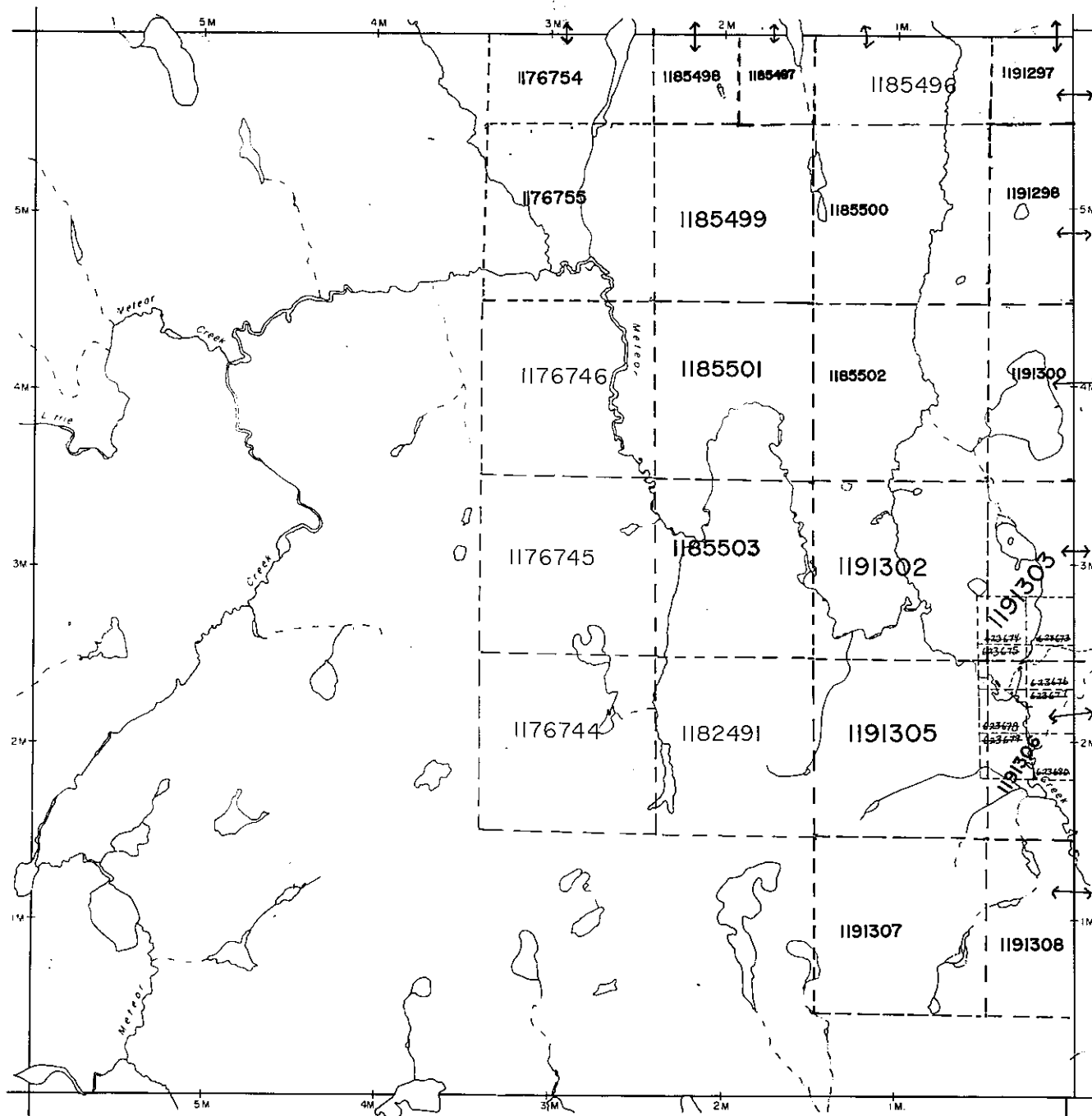

Hodgetts Twp. - M.933

REMOVED FROM CIRCULATION  
DECEMBER 21, 1993

THE TOWNSHIP  
OF

AMYOT

DISTRICT OF  
SUDBURY

LARDER LAKE  
MINING DIVISION

SCALE: 1-INCH 40 CHAINS

LEGEND

PATENTED LAND	Ⓟ
CROWN LAND SALE	C.S.
LEASES	Ⓛ
LOCATED LAND	Loc
LICENSE OF OCCUPATION	L.O.
MINING RIGHTS ONLY	M.R.D.
SURFACE RIGHTS ONLY	S.R.D.
ROADS	—
IMPROVED ROADS	—
KING'S HIGHWAYS	—
RAILWAYS	—
POWER LINES	—
MARSH OR MUSKEG	—
MINES	—
CANCELLED	C.

NOTES

400' Surface Rights Reservation around  
all lakes and rivers.

THE INFORMATION THAT  
APPEARS ON THIS MAP  
HAS BEEN COMPILED  
FROM VARIOUS SOURCES,  
AND ACCURACY IS NOT  
GUARANTEED. THOSE  
WISHING TO STAKE MIN-  
ING CLAIMS SHOULD CON-  
SULT WITH THE MINING  
RECORDER, MINISTRY OF  
NORTHERN DEVELOP-  
MENT AND MINES, FOR AD-  
DITIONAL INFORMATION  
ON THE STATUS OF THE  
LANDS SHOWN HEREON.

NOTICE OF FORESTRY ACTIVITY

THIS TOWNSHIP / AREA FALLS WITHIN THE \_\_\_\_\_

SHININGTREE MANAGEMENT UNIT  
AND MAY BE SUBJECT TO FORESTRY OPERATIONS.  
THE MNR UNIT FORESTER FOR THIS AREA CAN BE  
CONTACTED AT: P.O. BOX 129  
LOW AVENUE  
GOGAMA, ONT.  
POM TWO  
705-894-2000

PLAN NO. **G.0948**

ONTARIO

MINISTRY OF NATURAL RESOURCES

SURVEYS AND MAPPING BRANCH

Moffat Twp. - M.867

Browning Twp. - M.683