



Ministry of
Natural
Resources

Ministry of
Northern Development
and Mines

INDEX TO LAND DISPOSITION

PLAN
G-3087
TOWNSHIP

ANDERSON

M.N.R. ADMINISTRATIVE DISTRICT
SAULT STE. MARIE
MINING DIVISION
SAULT STE. MARIE
LAND TITLES REGISTRY DIVISION
ALGOMA

SCALE 1:25 000

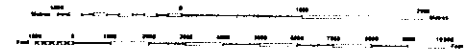

Contour Interval 10 Metres

AREAS WITHDRAWN FROM DISPOSITION

MRD - Mining Rights Only
SRD - Surface Rights Only
M + S - Mining and Surface Rights

Order No. Date Disposition File
RI SEC. 43, 44, 45, 46, 47, 48, 49, 50, 51, 52, 53, 54, 55, 56, 57, 58, 59, 60, 61, 62, 63, 64, 65, 66, 67, 68, 69, 70, 71, 72, 73, 74, 75, 76, 77, 78, 79, 80, 81, 82, 83, 84, 85, 86, 87, 88, 89, 90, 91, 92, 93, 94, 95, 96, 97, 98, 99, 100

SYMBOLS

Boundary
Township, Meridian, Baseline
Road allowance, surveyed
Road allowance, unsurveyed
Lot/Concession, surveyed
Lot/Concession, unsurveyed
Parcel, surveyed
Parcel, unsurveyed
Right-of-way, road
Right-of-way, railway
Right-of-way, utility
Reservation
Cutt. Pt. Pile
Contour
Interpolated
Approximate
Depression
Control point (horizontal)
Flooded land
Mine head frame
Pipeline (above ground)
Railway, single track
Railway, double track
Railway, abandoned
Road, highway, county township
access
Island, bush
Shoreline vegetation
Transmission line
Wooded area

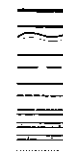

NOTES

SURFACE AND MINING RIGHTS ARE WITHDRAWN FROM STAKES WHEN SEC. 43 OF THE BOUNDARY ACT, R.S.O. 1990, APPLIES.

ALL CLAIMS ARE GUARANTEED BY POSTER AND MAY LIE AND MUST BE SUSTAINED PRIOR TO GRANTING OF THIS MAP (SEC. 71).

MINING CLAIMS STAKED IN THIS TOWNSHIP ARE SUBJECT TO SEC. 43 OF THE BOUNDARY ACT (R.S.O. 1990).

DISPOSITION OF CROWN LANDS

Patent:
Surface & Mining Rights
Surface Rights Only
Mining Rights Only
Lease:
Surface & Mining Rights
Surface Rights Only
Mining Rights Only
License of Occupation
Order-in-Council
Cancelled
Reservation
Sale & Grant

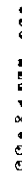

The 1905 Magnetic Bearing
Reference is to the Annual Chart
"CELESTIAL" 1905.

THE INFORMATION THAT
APPEARS ON THIS MAP
HAS BEEN COMPILED
FROM VARIOUS SOURCES
AND ACCURACY IS NOT
GUARANTEED. THOSE
INTERESTED TO STAKE
MINING CLAIMS SHOULD
CONSULT WITH THE
REGISTRAR, MINISTRY OF
NORTHERN DEVELOPMENT
AND MINES FOR AD-
DITIONAL INFORMATION
ON THE STATUS OF THE
LANDS SHOWN HEREON.

Map base and land disposition obtained by Surveys and Mapping
Branch, Ministry of Natural Resources.

The disposition of land, location of lot, line, and parcel boundaries on
this index was compiled for administrative purposes only.

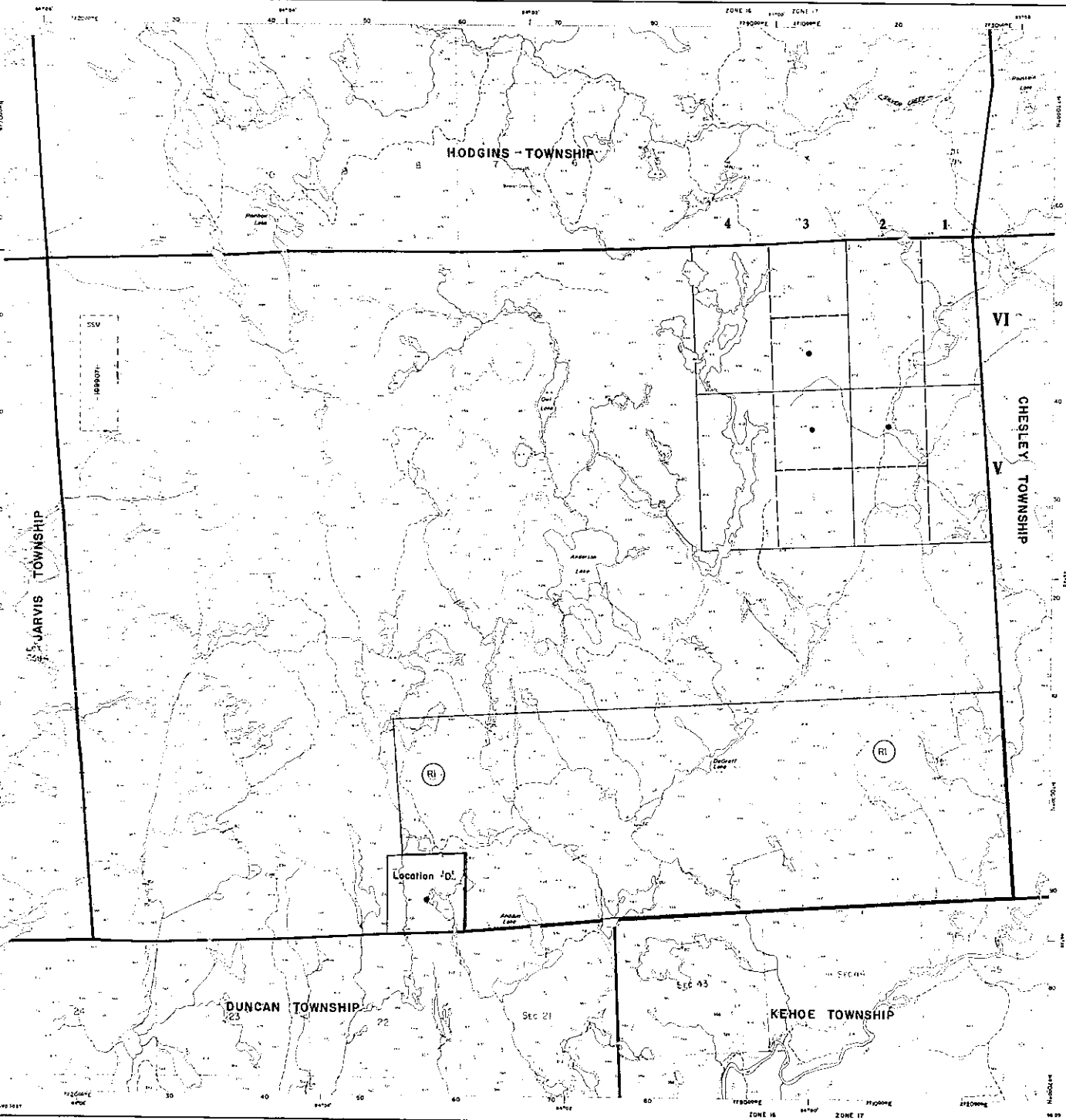

OFFICE MAP

HODGINS TWP.

THE TOWNSHIP
OF
ANDERSON

DISTRICT OF
ALGOMA

SAULT STE. MARIE
MINING DIVISION

SCALE: 1-INCH=40 CHAINS

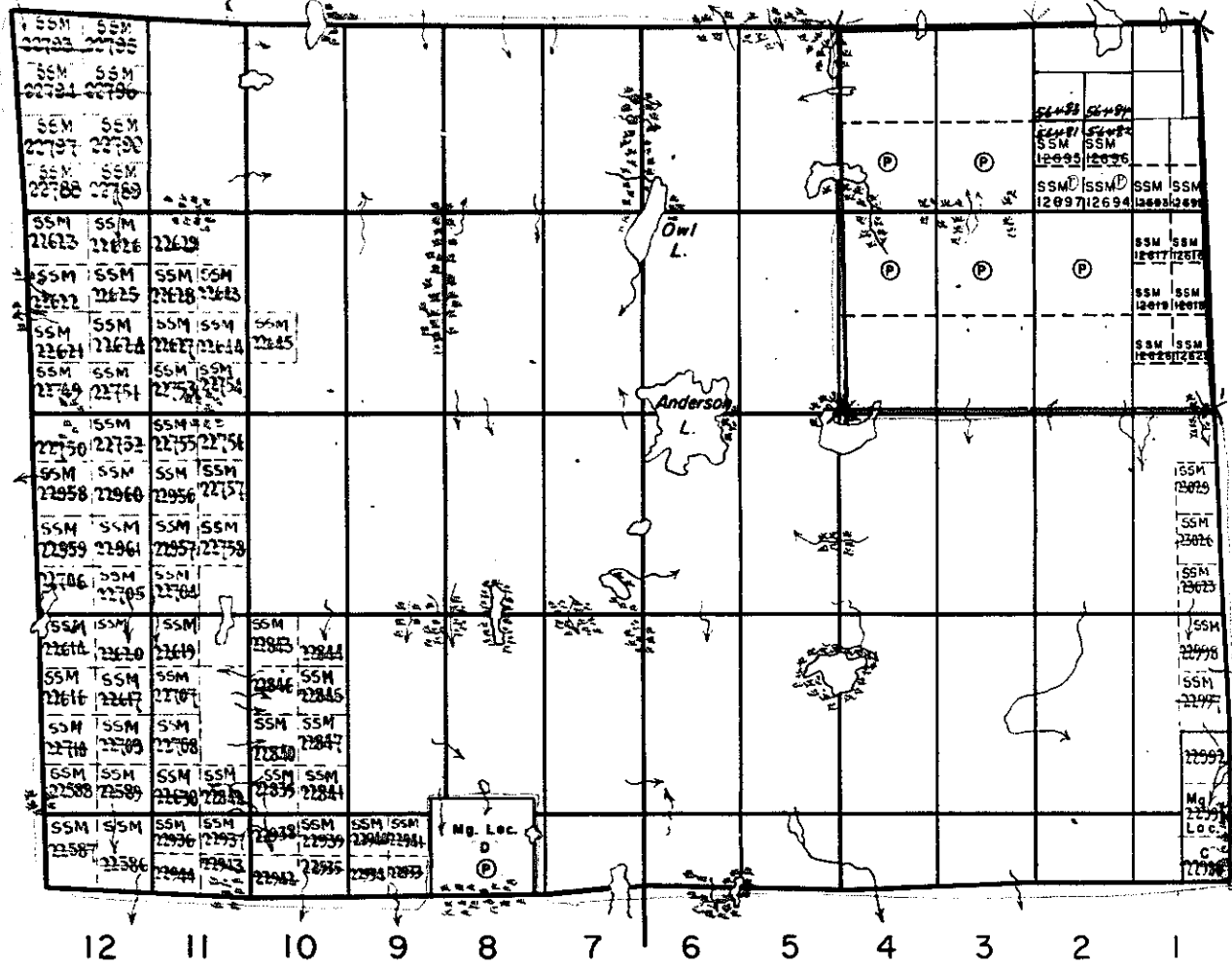

VI
V
IV
III
II

JARVIS TWP.
CHESLEY TWP.

DUNCAN TWP.

KEHOE TWP.

LEGEND

- PATENTED LAND (P)
- CROWN LAND SALE (S)
- LEASES (L)
- LOCATED LAND Loc.
- LICENSE OF OCCUPATION L.O.
- ROADS [Symbol]
- IMPROVED ROADS [Symbol]
- RAILWAYS [Symbol]
- POWER LINES [Symbol]
- MARSH OR MUSKEG [Symbol]

NOTES

m. 1137

PLAN NO.- S.S.M. 5

DEPARTMENT OF MINES

-ONTARIO-

HODGINS TWP.

THE TOWNSHIP
OF
ANDERSON

DISTRICT OF
ALGOMA

SAULT STE. MARIE
MINING DIVISION

SCALE: 1-INCH=40 CHAINS

LEGEND

PATENTED LAND	(P)
CROWN LAND SALE	(C)
LEASES	(L)
LOCATED LAND	Loc.
LICENSE OF OCCUPATION	L.O.
ROADS	— — — — —
IMPROVED ROADS	— — — — —
RAILWAYS	— — — — —
POWER LINES	— — — — —
MARSH OR MUSKEG	— — — — —

NOTES

M. 1137

PLAN NO.— S.S.M. 4

DEPARTMENT OF MINES
— ONTARIO —

VI

V

IV

III

II

CHESLEY TWP.

DUNCAN TWP

KEHOE TWP.

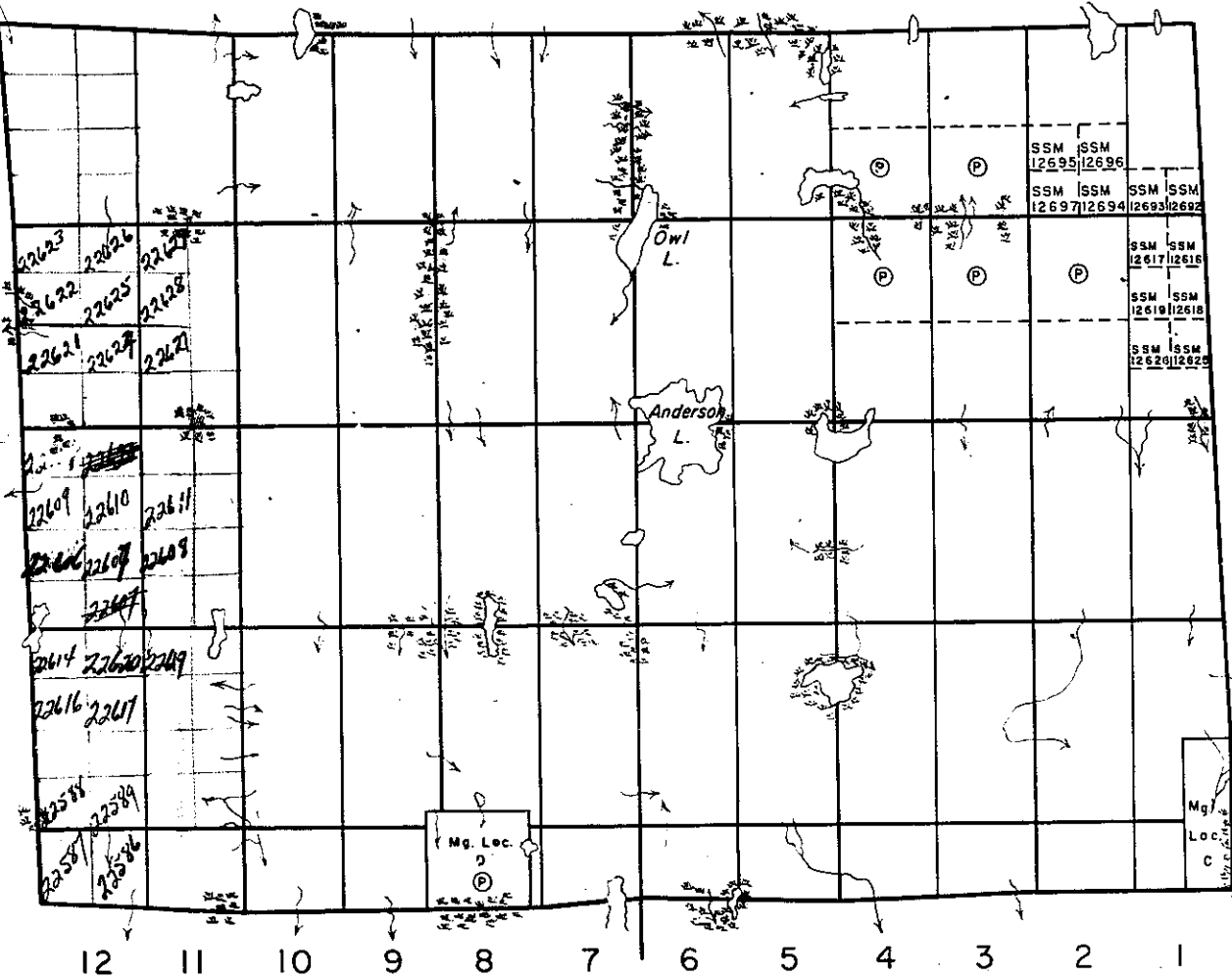

HODGINS TWP.

THE TOWNSHIP OF
OF
ANDERSON

DISTRICT OF
ALGOMA

SAULT STE. MARIE
MINING DIVISION

SCALE: 1-INCH=40 CHAINS

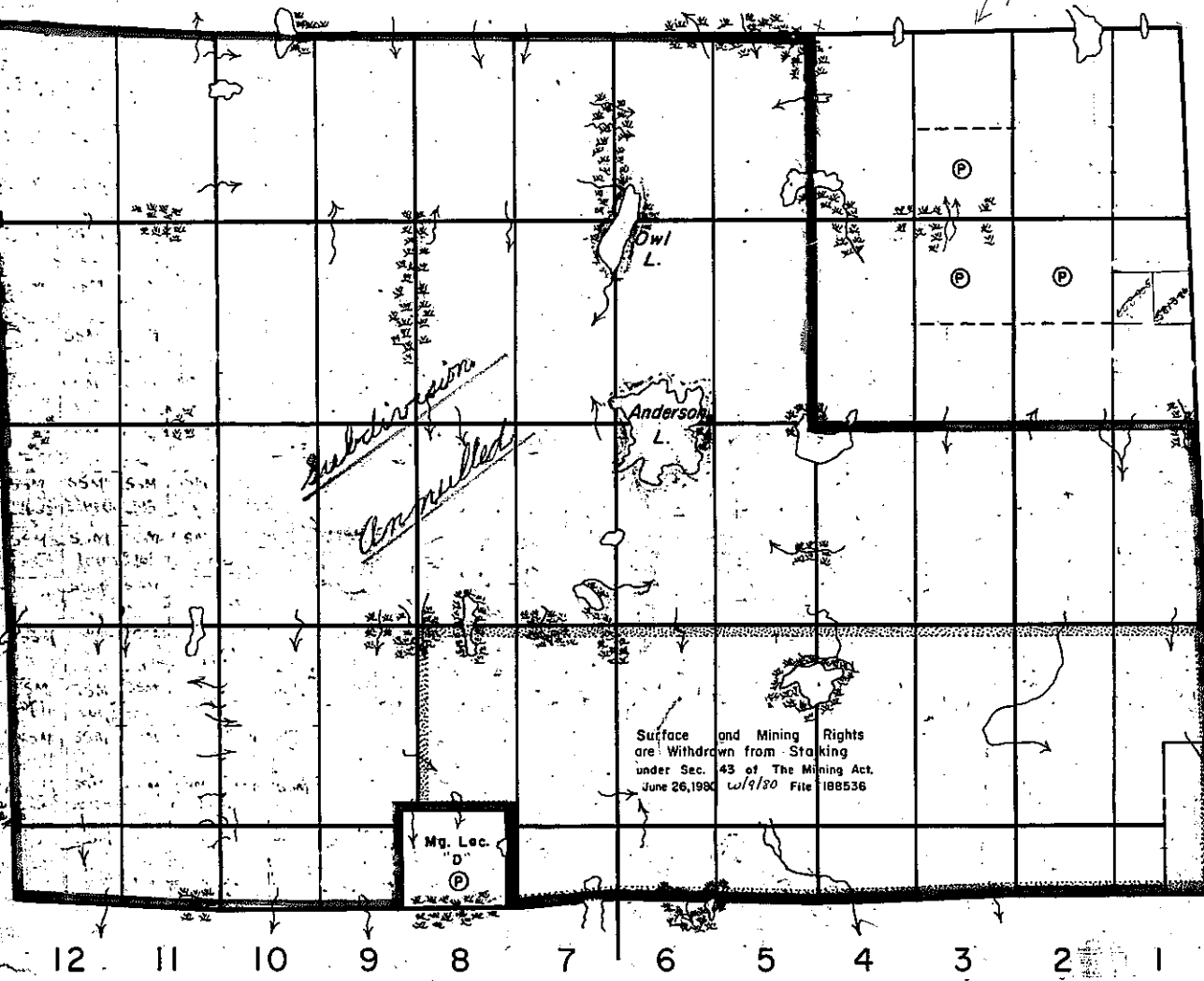

VI
V
IV
III
II

CHESLEY TWP.

DUNCAN TWP

KEHOE TWP.

LEGEND

- PATENTED LAND
- CROWN LAND SALE
- LEASES
- LOCATED LAND
- LICENSE OF OCCUPATION
- ROADS
- IMPROVED ROADS
- RAILWAYS
- POWER LINES
- MARSH OR MUSKEG

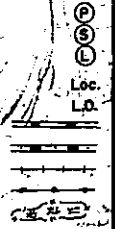

NOTES

400' Surface Rights Reservation around all lakes & rivers.

Mining claims staked in this township are subject to Sec. 54 of the Mining Act (R.S.O.-1970).

G.3087
map replaced
Oct 2/84

PLAN NO. - ~~1137~~

HODGINS TWP.

THE TOWNSHIP
OF
ANDERSON

DISTRICT OF
ALGOMA

SAULT STE. MARIE
MINING DIVISION

SCALE: 1-INCH=40 CHAINS

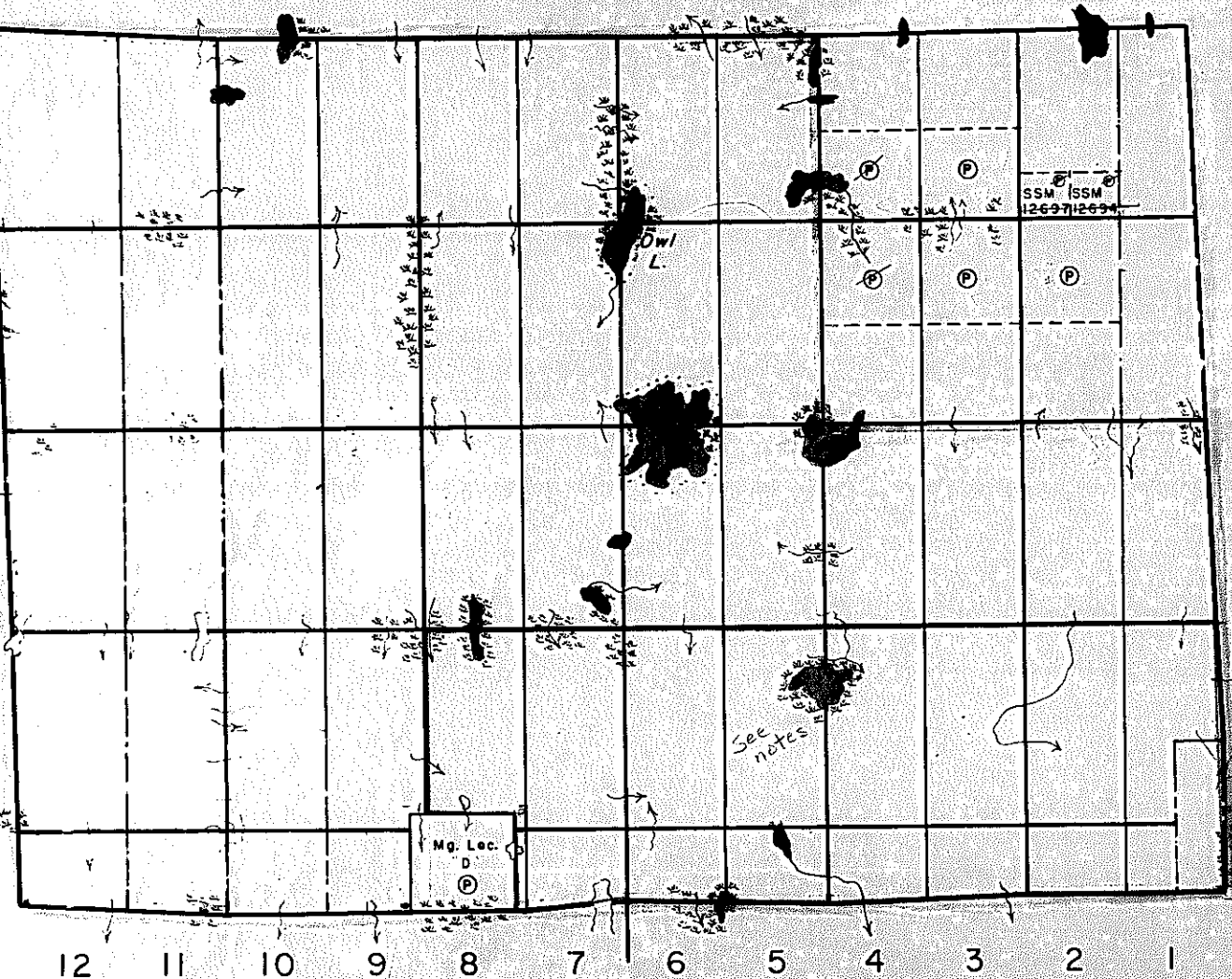

VI

V

IV

III

II

CHESLEY TWP.

LEGEND

- PATENTED LAND (P)
- CROWN LAND SALE (C)
- LEASES (L)
- LOCATED LAND (Loc.)
- LICENSE OF OCCUPATION (L.O.)
- ROADS (— — — — —)
- IMPROVED ROADS (— — — — —)
- RAILWAYS (— — — — —)
- POWER LINES (— — — — —)
- MARSH OR MUSKEG (— — — — —)

NOTES

All claims are governed by rules not for lines and must be surveyed prior to staking of title
Sub (11) Sect 42

100' Road Dept. of C.P. shown
line

Part of Anderson Twp
subdivision annulled see
let dated Jan 13/53 in
last annulled Twp file

Note

Part of This Twp. is covered by "Unspec. P.O.P. #5858 (Weyburnian Canada Ltd.)
see file #8455
10657

NOTE: SURFACE and MINING RIGHT OF AREA OUTLINED IN RED ARE WITHDRAWN FROM PROSPECTING, STAKING OUT, SALE OR LEASE UNDER SECTION 43 - OROER No. W 9/30. dated JUNE 26/30.

G.3087

PLAN NO. - ~~437~~

DEPARTMENT OF MINES
— ONTARIO —

DUNCAN TWP.

KEHOE TWP.

DATE OF ISSUE

JUL 25 1960

SAULT STE. MARIE
MINING RECORDER'S OFFICE

Replaced by mylar Mar. 14/84

RECEIVED
OCT 2 - 1984

HODGINS TWP.

THE TOWNSHIP
OF
ANDERSON

DISTRICT OF
ALGOMA

SAULT STE. MARIE
MINING DIVISION

SCALE: 1-INCH=40 CHAINS

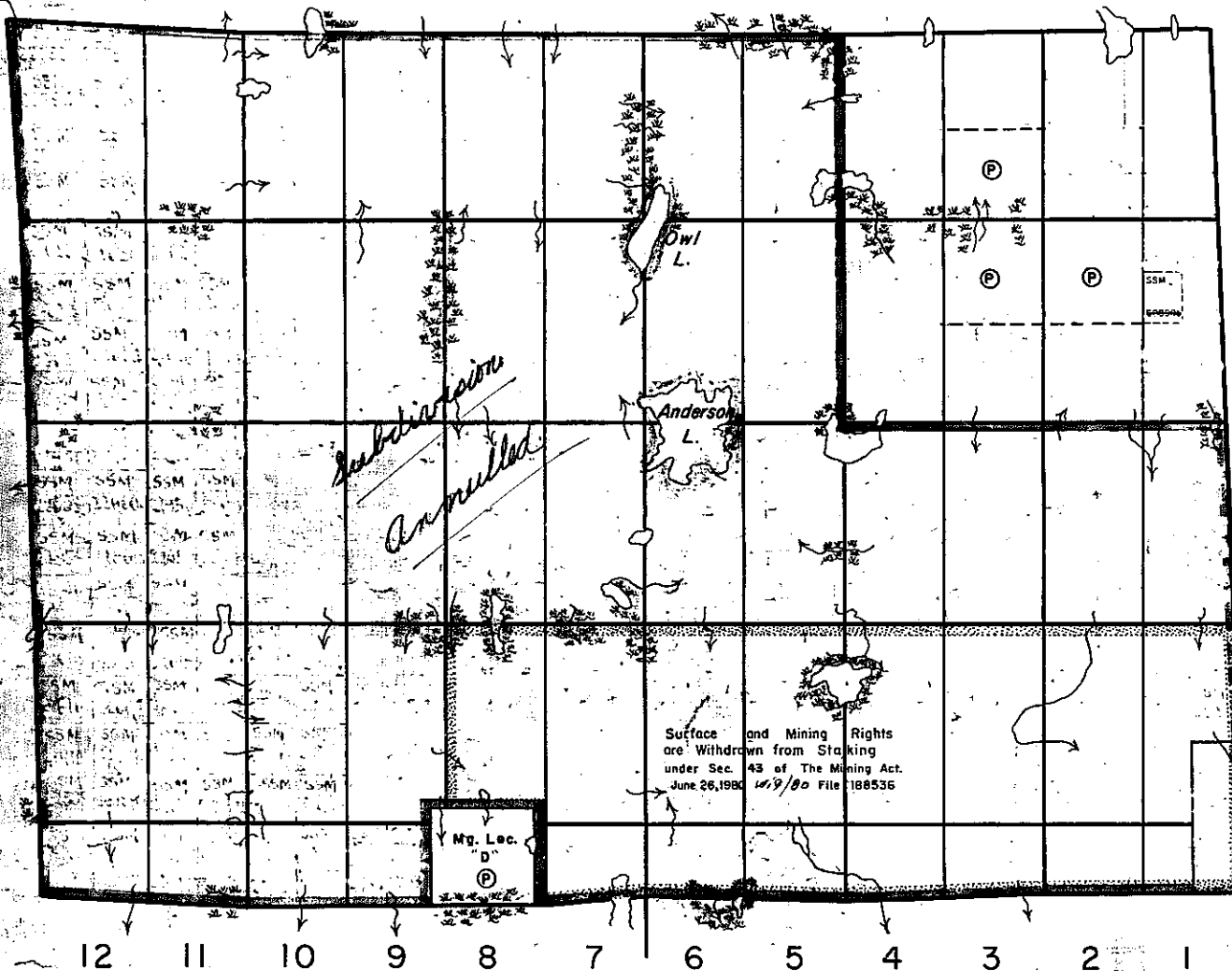

VI

V

IV

III

II

CHESLEY TWP.

12 11 10 9 8 7 6 5 4 3 2 1

DUNCAN TWP.

KEHOE TWP.

LEGEND

- PATENTED LAND
- CROWN LAND SALE
- LEASES
- LOCATED LAND
- LICENSE OF OCCUPATION
- ROADS
- IMPROVED ROADS
- RAILWAYS
- POWER LINES
- MARSH OR MUSKEG

NOTES

400' Surface Rights Reservation around all lakes & rivers.

Mining claims staked in this township are subject to Sec. 54 of the Mining Act (R.S.O.-1970).

G.3087

PLAN NO. - ~~1151~~

OFFICE MAP

HODGINS TWP











THE TOWNSHIP OF
OF
ANDERSON

DISTRICT OF
ALGOMA

SAULT STE. MARIE
MINING DIVISION

SCALE 1-INCH=40 CHAINS

LEGEND

- PATENTED LAND 
- CROWN LAND SALE 
- LEASES 
- LOCATED LAND  Loc.
- LICENSE OF OCCUPATION  L.O.
- ROADS 
- IMPROVED ROADS 
- RAILWAYS 
- POWER LINES 
- MARSH OR MUSKEG 

NOTES

JARVIS TWP

CHESLEY TWP

VI

V

IV

III

II

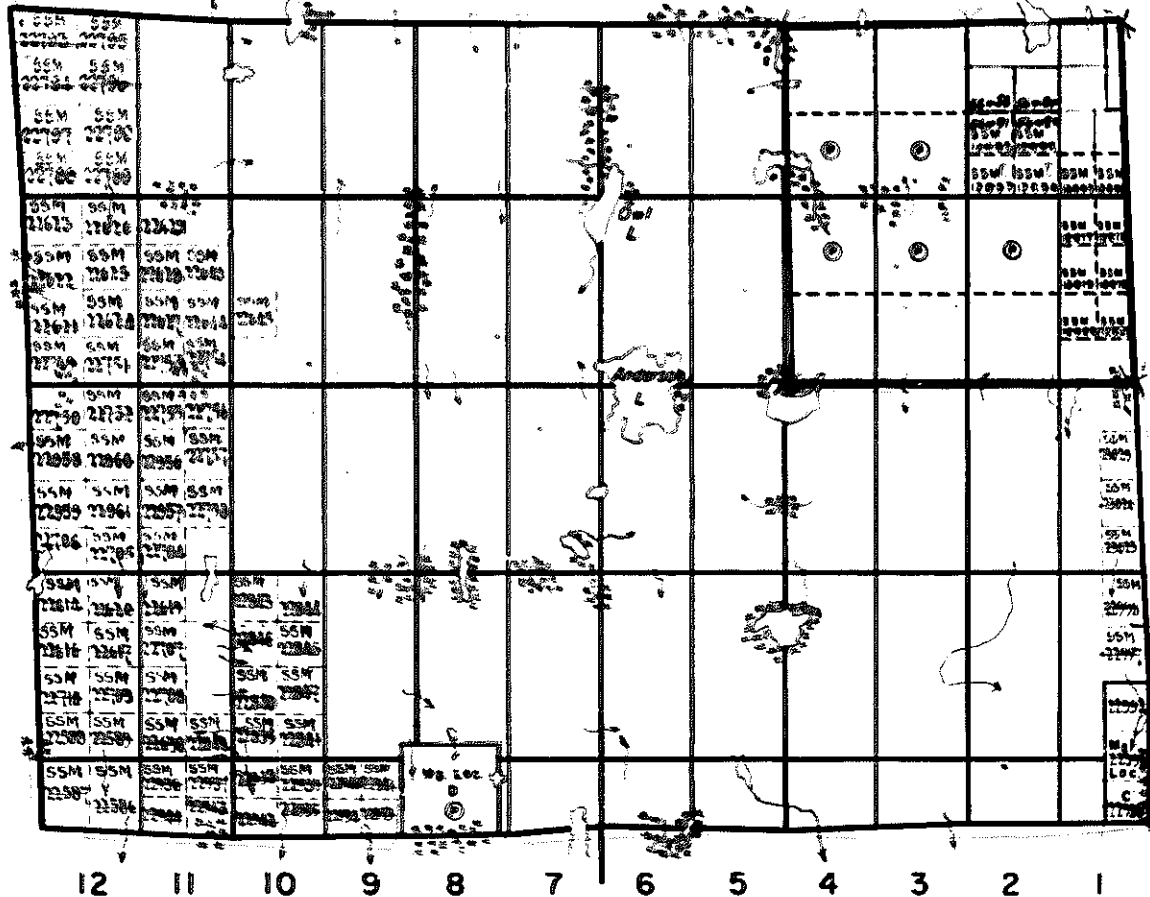

DUNCAN TWP

KEHOE TWP

M.1137

PLAN NO.- S.S.M. 5

DEPARTMENT OF MINES
—ONTARIO—

HODGINS TWP.

JARVIS TWP

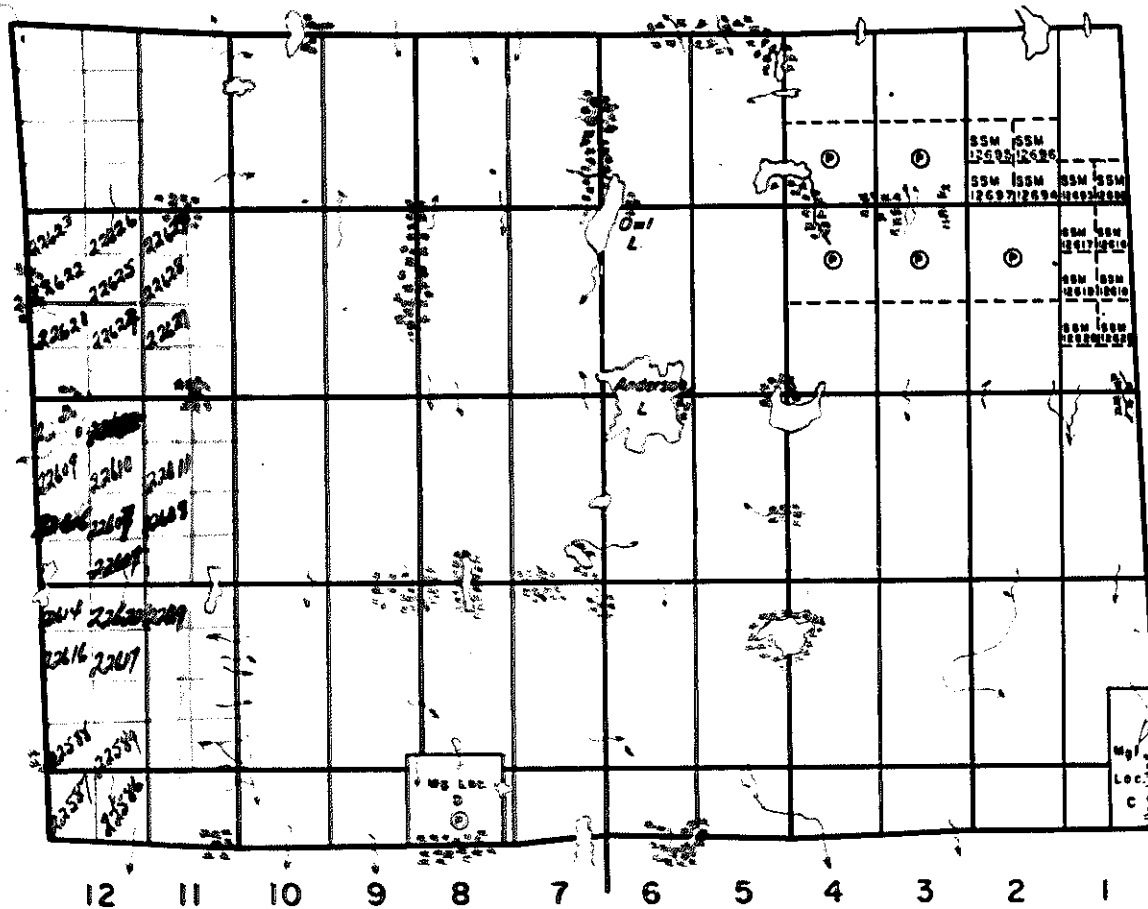

DUNCAN TWP

KEHOE TWP

THE TOWNSHIP
OF
ANDERSON

DISTRICT OF
ALGOMA

SAULT STE. MARIE
MINING DIVISION

SCALE: 1-INCH=40 CHAINS

LEGEND

- PATENTED LAND ⊙
- CROWN LAND SALE ⊙
- LEASES ⊙
- LOCATED LAND ⊙
- LICENSE OF OCCUPATION Loc.
- ROADS L.O.
- IMPROVED ROADS |||
- RAILWAYS =
- POWER LINES ---
- MARSH OR MUSKEG ~

NOTES

M.1137

PLAN NO.- S.S.M. 4

DEPARTMENT OF MINES
—ONTARIO—