

LEGEND

- HIGHWAY AND ROUTE No.
- OTHER ROADS
- TRAILS
- SURVEYED LINES:
 - TOWNSHIPS, BASE LINES, ETC.
 - LOTS MINING CLAIMS, PARCELS, ETC.
- UNSURVEYED LINES:
 - LOT LINES
 - PARCEL BOUNDARY
 - MINING CLAIMS ETC
- RAILWAY AND RIGHT OF WAY
- UTILITY LINES
- NON-PERENNIAL STREAM
- FLOODING OR FLOODING RIGHTS
- SUBDIVISION OR COMPOSITE PLAN
- RESERVATIONS
- ORIGINAL SHORELINE
- MARSH OR MUSKEG
- MINES
- TRAVERSE MONUMENT

DISPOSITION OF CROWN LANDS

TYPE OF DOCUMENT	SYMBOL
PATENT, SURFACE & MINING RIGHTS	●
" SURFACE RIGHTS ONLY	○
" MINING RIGHTS ONLY	◐
LEASE, SURFACE & MINING RIGHTS	■
" SURFACE RIGHTS ONLY	◼
" MINING RIGHTS ONLY	◻
LICENCE OF OCCUPATION	▼
ORDER-IN-COUNCIL	OC
RESERVATION	⊙
CANCELLED	⊖
SAND & GRAVEL	⊕

AREAS WITHDRAWN FROM DISPOSITION

- M.R.O. - MINING RIGHTS ONLY
- S.R.O. - SURFACE RIGHTS ONLY
- M+S - MINING AND SURFACE RIGHTS

Description	Order No.	Date	Disposition	File

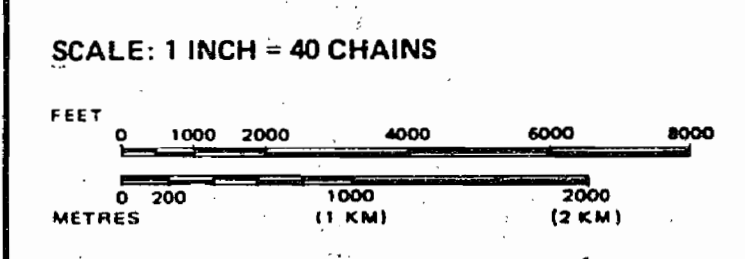

AREA
525843
 M.N.R. ADMINISTRATIVE DISTRICT
COCHRANE
 MINING DIVISION
PORCUPINE
 LAND TITLES / REGISTRY DIVISION
KENORA/PATRICIA PORTION

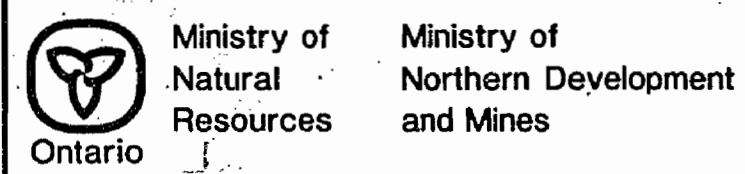

Date: NOVEMBER, 1994
 ACTIVATED BY: D.C. SEPT. 28/95
 CHECKED BY: D.K.

Number
G-4212

THE INFORMATION THAT APPEARS ON THIS MAP HAS BEEN COMPILED FROM VARIOUS SOURCES, AND ACCURACY IS NOT GUARANTEED. THOSE WISHING TO STAKE MINING CLAIMS SHOULD CONSULT WITH THE MINING RECORDER, MINISTRY OF NORTHERN DEVELOPMENT AND MINES, FOR ADDITIONAL INFORMATION ON THE STATUS OF THE LANDS SHOWN HEREON.

525844 G-3855

525842 G-4201

526843 G-4222

1204970
16 UNITS

524843 G-4202

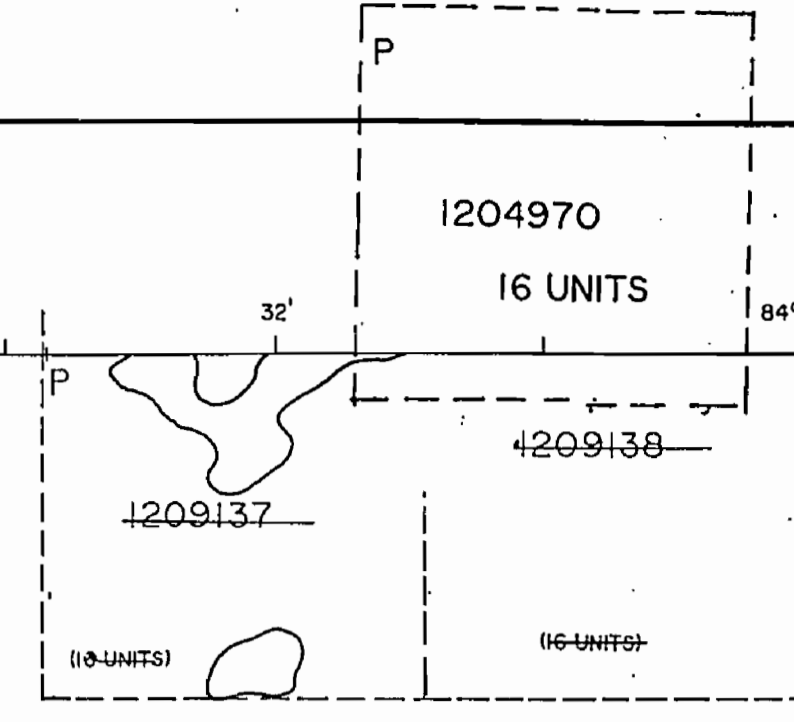
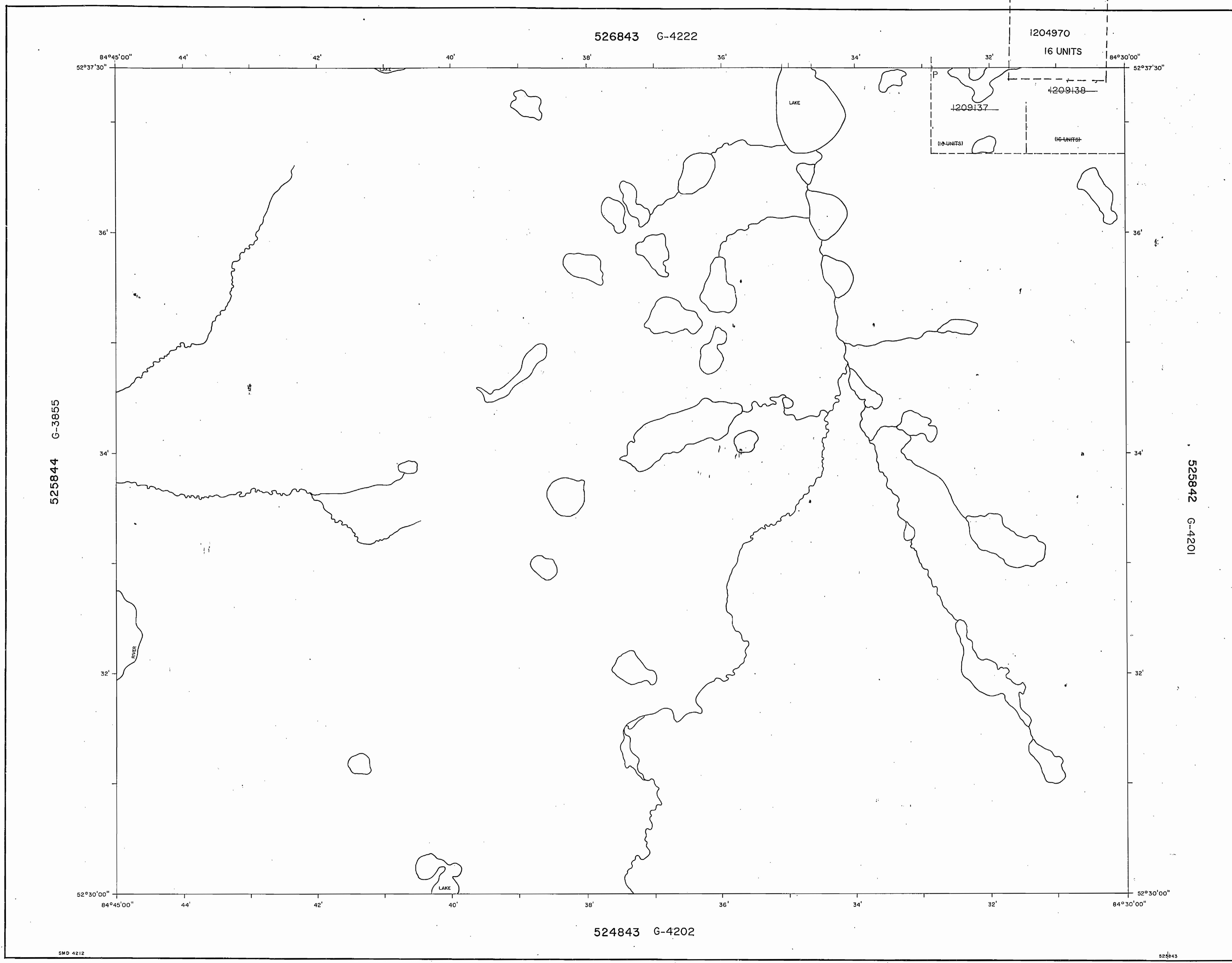

LEGEND

- HIGHWAY AND ROUTE No.
- OTHER ROADS
- TRAILS
- SURVEYED LINES:
 - TOWNSHIPS, BASE LINES, ETC.
 - LOTS, MINING CLAIMS, PARCELS, ETC.
- UNSURVEYED LINES:
 - LOT LINES
 - PARCEL BOUNDARY
 - MINING CLAIMS ETC
- RAILWAY AND RIGHT OF WAY
- UTILITY LINES
- NON-PERENNIAL STREAM
- FLOODING OR FLOODING RIGHTS
- SUBDIVISION OR COMPOSITE PLAN RESERVATIONS
- ORIGINAL SHORELINE
- MARSH OR MUSKEG
- MINES
- TRAVERSE MONUMENT

DISPOSITION OF CROWN LANDS

TYPE OF DOCUMENT	SYMBOL
PATENT, SURFACE & MINING RIGHTS	
" SURFACE RIGHTS ONLY	
" MINING RIGHTS ONLY	
LEASE, SURFACE & MINING RIGHTS	
" SURFACE RIGHTS ONLY	
" MINING RIGHTS ONLY	
LICENCE OF OCCUPATION	
ORDER-IN-COUNCIL	
RESERVATION	
CANCELLED	
SAND & GRAVEL	

AREAS WITHDRAWN FROM DISPOSITION

- M.R.O. - MINING RIGHTS ONLY
 - S.R.O. - SURFACE RIGHTS ONLY
 - M.+S. - MINING AND SURFACE RIGHTS
- | Description | Order No. | Date | Disposition | File |
|-------------|-----------|------|-------------|------|
| | | | | |

DATE OF ISSUE

JUN 0 1 1998

PROVINCIAL RECORDING
OFFICE - SUDBURY

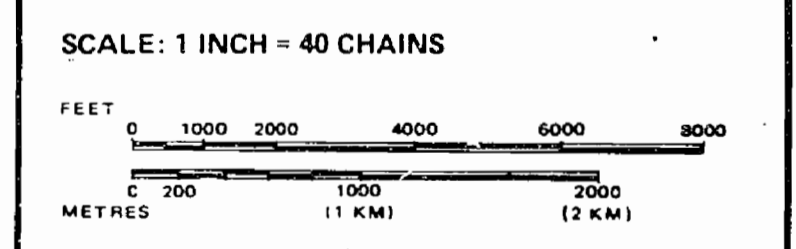

AREA
525843
M.N.R. ADMINISTRATIVE DISTRICT
COCHRANE
MINING DIVISION
PORCUPINE
LAND TITLES / REGISTRY DIVISION
KENORA/PATRICIA PORTION

Ministry of Natural Resources
 Ministry of Northern Development and Mines

Date	NOVEMBER, 1994	Number	G-4212
ACTIVATED BY: D.C.	SEPT. 28 / 95	CHECKED BY: D.C.	

INFORMATION THAT APPEARS IN THIS MAP IS UNRELIABLE. THE MAP IS NOT TO BE USED FOR LEGAL PURPOSES. THE USER SHOULD CONSULT THE ORIGINAL RECORDS FOR THE STATUS OF THE LAND HEREON.

525844 G-3855

525842 G-4201

526843 G-4222

524843 G-4202