

CS
Loc
LO
MRO
SRO

X
C

400'

Flooding Rights in Devils Lake Reserved
To Gananoque Electric Light & Water Supply
Co Ltd To Elevation 6 0'
File: 11237 Vol 3

South Crosby T

Loughborough Twp.





th Crosby Twp.

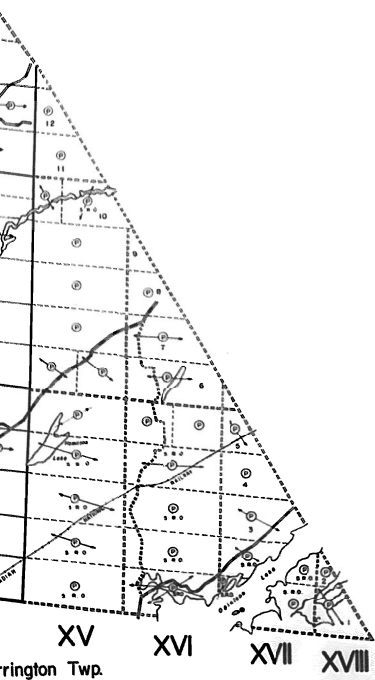

rrington Twp.

THE TOWNSHIP
OF
BEDFORD
COUNTY OF
FRONTENAC
SOUTHERN ONTARIO
MINING DIVISION
SCALE: 1-INCH= 40 CHAINS

LEGEND

PATENTED LAND	● = ○
CROWN LAND SALE	C.S.
LEASES	○
LOCATED LAND	LOC.
LICENSE OF OCCUPATION	L.O.
MINING RIGHTS ONLY	M.R.O.
SURFACE RIGHTS ONLY	S.R.O.
ROADS	—
IMPROVED ROADS	—
KINGS HIGHWAYS	—
RAILWAYS	—
POWER LINES	—
MARSH OR MUSKEG	—
MINES	—
CANCELLED	—
PATENTED for S.R.O.	—

NOTES

This Map Is Not To Be Used
—FOR SURVEY PURPOSES—

400' Surface Rights Reservation along the shores of all Lakes & Rivers.

L.O. 6123 Covers Dam in E 1/2 Lot 5 Con IV and Flooding Rights on Canoe Lake & Eel Lake to elevation 464'00. File: 125488.

Flooding Rights on Bob's Lake controlled by the Dept of Railways & Canals-Ottawa-File: 56014

Area shown thus INDIAN LAND.

For Status Of Islands In This Township Please Contact Dept of Lands & Forests.

L.O. 6098 Covers Dam in Lot 5 Con XIV And Flooding Rights in Buck Lake to Elevation 434'80. File: 11237

L.O. 6099 Covers Dam in Lots 6 & 7 Con VIII And Flooding Rights in Kingsford Lake, Birch Lake & Desert Lake To Elevation 446.6' File: 11237.

Flooding Rights in Devils Lake Reserved To Ganouque Electric Light & Water Supply Co. Ltd. To Elevation 6'8". File: 11237 Vol. 3.

AREAS WITHDRAWN FROM STAKING

S.R. - SURFACE RIGHTS			M.R. - MINING RIGHTS		
Sec.	Order No.	Date	Order No.	Date	File
3	4219301903	—	S.R.	04781	
3	4219301903	—	S.R.	04637	
3	4219301903	—	S.R.	176566	
3	4219301903	—	S.R.	01781	
3	S.R.O. Reserved for Public Use P. 01710				

THE INFORMATION THAT APPEARS ON THIS MAP HAS BEEN COMPILED FROM VARIOUS SOURCES AND ACCURACY IS NOT GUARANTEED. THOSE DESIRING TO STAKE MINING CLAIMS SHOULD CONSULT WITH THE MINING RECORDER, MINISTRY OF NORTHERN DEVELOPMENT AND MINES, FOR ADDITIONAL INFORMATION ON THE STATUS OF THE LANDS SHOWN HEREON.

PLAN NO. - M.52
ONTARIO
MINISTRY OF NATURAL RESOURCES
SURVEYS AND MAPPING BRANCH

RES. GEO. TWEED
M.N.R. DIST. NAPANEE



Loughborough Twp.

BEDFORD

COUNTY OF FRONTENAC

EASTERN ONTARIO
MINING DIVISION

SCALE 1 INCH = 40 CHAINS

LEGEND

PATENTED LAND
CROWN LAND SALE
LEASES
LOCATED LAND
LICENSE OF OCCUPATION
MINING RIGHTS ONLY
SURFACE RIGHTS ONLY
ROADS
IMPROVED ROADS
RIVERS HIGHWAYS
RAILWAYS
POWER LINES
MARSH OR MURKED
NAVES
CANCELLED

NOTES

This Map is Not To Be Used
—FOR SURVEY PURPOSES—

400'

L.D. 6123 Covers Dam in E 1/2 Lot 5 Con. IV
and Flooding Rights in Cane Lake & Est. Lake
to elevation 404.00. File 125488.

Flooding Rights on Bob's Lake controlled
by the Dept of Railways & Canals, Ottawa.
File 5804.

Area shown thus INDIAN LAND

For Status of Islands in This Township
Please Contact Dept of Lands & Forests.

L.D. 6098 Covers Dam in Lot 5 Con. IV
And Flooding Rights in Buck Lake to
Elevation 434.80. File 11237.

L.D. 6099 Covers Dam in Lots 6 & 7
Con VII And Flooding Rights in
Kingsford Lake, Birch Lake & Devil
Lake to Elevation 446.0'.
File 11237.

Flooding Rights in Devils Lake Reserved
to Generous Electric Light & Water Supply
Co. Ltd. To Elevation 6'.
File 11237 Vol. 3.

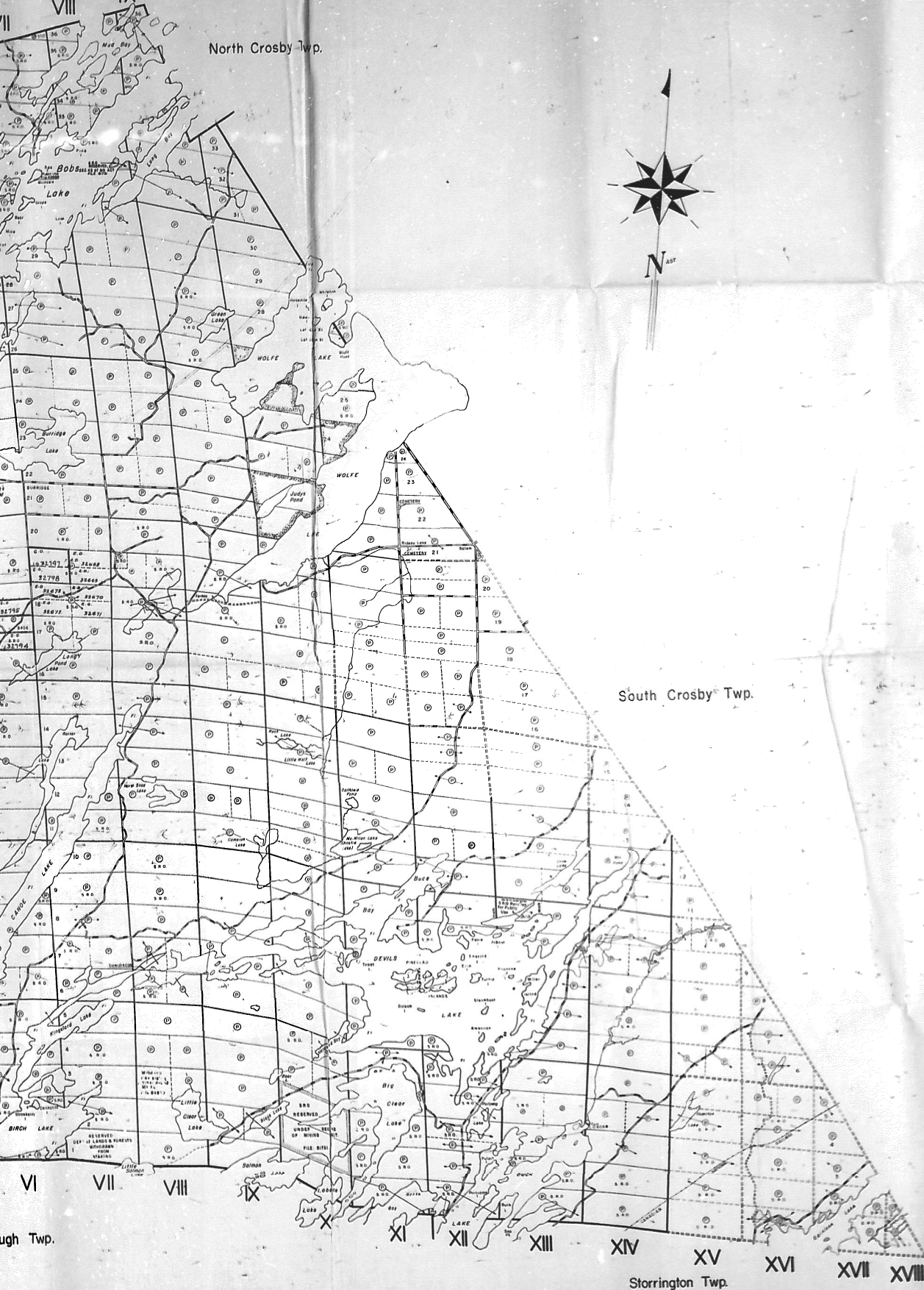
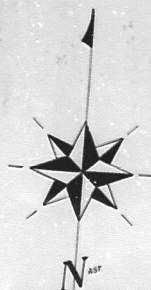

PLAN NO.-M-52

DEPARTMENT OF MINES
—ONTARIO—



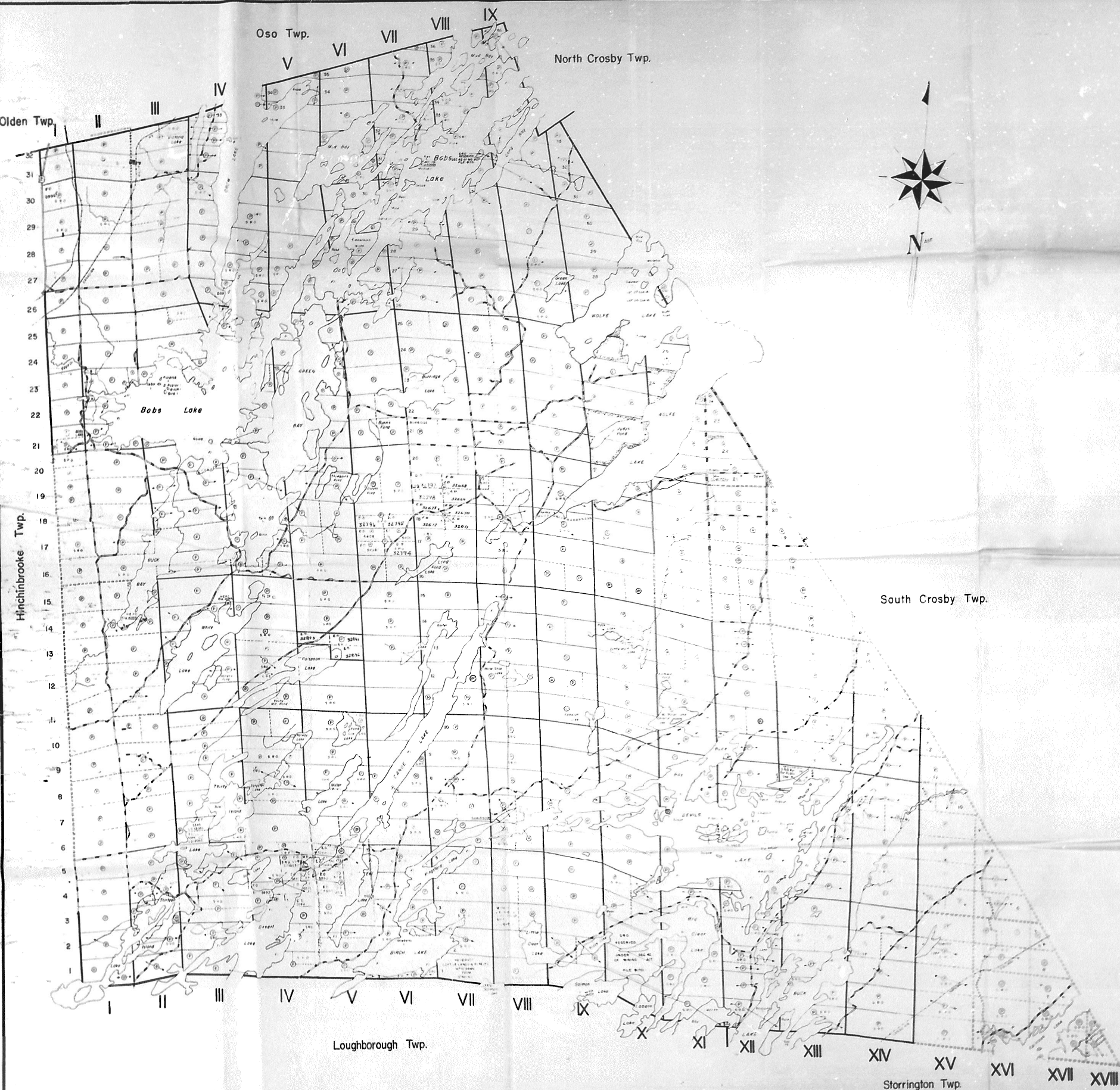

THE TOWNSHIP
OF
BEDFORD
COUNTY OF
FRONTENAC

EASTERN ONTARIO
MINING DIVISION

SCALE 1-INCH= 40 CHAINS

LEGEND

UNPATENTED LAND	CS
GRANT AND SALE	CS
LEASES	CS
LOCATED LAND	CS
LICENSE OF OCCUPATION	CS
MINING RIGHTS ONLY	WRO
SURFACE RIGHTS ONLY	WRO
ROADS	WRO
IMPROVED HIGHWAYS	WRO
RAILROADS	WRO
POWER LINES	WRO
WATER OR OTHER	WRO
OTHER	WRO

NOTES

This Map Is Not To Be Used
FOR SURVEY PURPOSES

LO 4125 Covers Dam in E 1/2 Lot 5 Can 14
and Flooding Rights on Canoe Lake & Gravel
to elevation 444.00. File 125488.

Flooding Rights on Bob's Lake conferred
by the Dept of Highways & Conservation
File 5804.

Only shown this 1/200000 LAND

For Status of Islands in this 1/200000
Please Contact Dept of Lands & Forests.

LO 4098 Covers Dam in Lot 5 Can 4 & 1/2
and Flooding Rights in Duck Lake to
elevation 444.00. File 11237.

LO 4099 Covers Dam in Lots 6 & 7
Can 11 and Flooding Rights in
Kingford Lake, Birch Lake & Deer
Lake to elevation 444.00.
File 11237.

Flooding Rights in Duck Lake referred
to Ontario Hydro, Light & Power Dept.
File 11237. Vol 3.

DATE OF ISSUE

NOV 14 1965

ONTARIO DEPT. OF MINES

ONT. DEPT. OF MINES
MINING LANDS BR.
THIS MAP FOR CHECKING
PURPOSES ONLY - MUST
NOT BE SOLD.

PLAN NO-M.52

DEPARTMENT OF MINES
-ONTARIO-

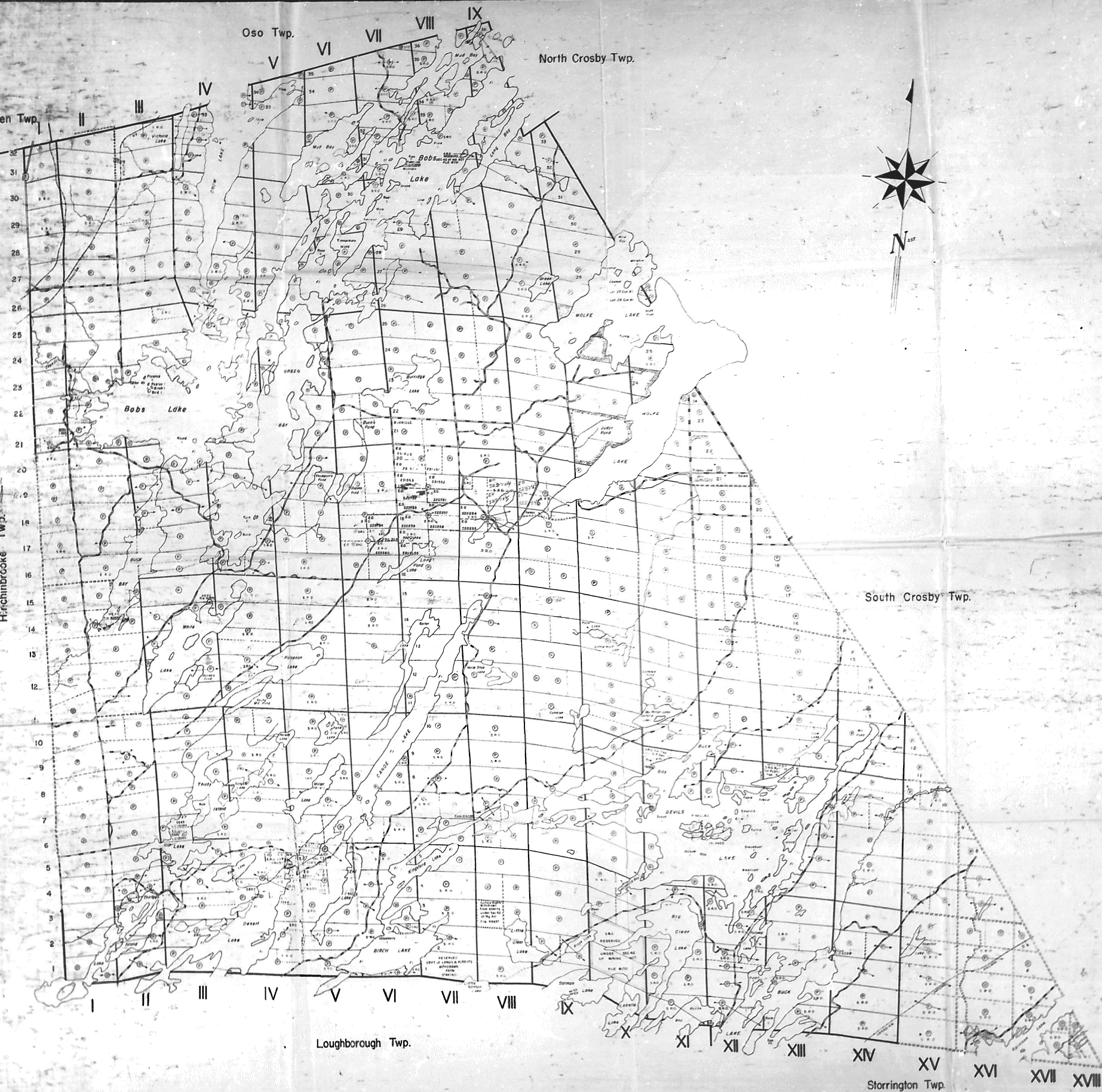

THE TOWNSHIP
OF
BEDFORD
COUNTY OF
FRONTENAC

EASTERN ONTARIO
MINING DIVISION

SCALE 1-INCH = 40 CHAINS

LEGEND

- | | |
|---|--|
| <ul style="list-style-type: none"> PAVED LAND CRUMpled LAND SALE LEASES LICENSE OF OCCUPATION MINING RIGHTS ONLY SURFACE RIGHTS ONLY ROADS IMPROVED ROADS RIVERS RAILWAYS POWER LINES WATER OR MUDS MINES CANCELLED | <ul style="list-style-type: none"> P C L O M S R I R R P W M C |
|---|--|

NOTES

This Map Is Not To Be Used
—FOR SURVEY PURPOSES—

- L.O. 6123 Covers Dam in E. of Lake Huron and Flooding Rights on Lake Huron & Belong to elevation 454.00. File 1125-488.
- Flooding Rights on Lake Huron controlled by the Dept. of Railways & Communications. File 580-4.
- Area shown and reserved (RESERVED LAND).
- For Status of Lands in This Township Please Contact Dept. of Lands & Forests.
- L.O. 6078 Covers Dam in E. of Lake Huron and Flooding Rights on Lake Huron & Belong to elevation 454.00. File 1125-488.
- L.O. 6079 Covers Dam in E. of Lake Huron and Flooding Rights on Lake Huron & Belong to elevation 454.00. File 1125-488.
- L.O. 6080 Covers Dam in E. of Lake Huron and Flooding Rights on Lake Huron & Belong to elevation 454.00. File 1125-488.
- Flooding Rights in Davis Lake Reserved to Government. Elevation 454.00. File 1125-488.

DATE OF ISSUE
JULY 1971

PLAN NO. M-52

ONTARIO
DEPARTMENT OF MINES
AND NORTHERN AFFAIRS



THE TOWNSHIP
OF
BEDFORD
COUNTY OF
FRONTENAC

EASTERN ONTARIO
MINING DIVISION

SCALE 1:1-INCH = 40 CHAINS

LEGEND

PATENTED LAND
CROWN LAND SALE
LEASES
LOCATED LAND
LICENSE OF OCCUPATION
MINING RIGHTS ONLY
SURFACE RIGHTS ONLY
ROADS
IMPROVED ROADS
MINES HIGHWAYS
RAILWAYS
POWER LINES
WATERS OF COURSE
MINES
CANCELLED

NOTES

This Map is Not To Be Used
FOR SURVEY PURPOSES

L.O. 6123 Covers Gorm in E.V.C. Lake & Bobs Lake
and Flooding Rights on Gorm Lake & Bobs Lake
to elevation 454.00. File 125-688

Flooding Rights on Bobs Lake controlled
by the Dept. of Highways & Comm. (Hwy.)
File 580-4

Area shown this TOWNSHIP LAND
For status of Bobs Lake see Section
Place Contact Dept. of Lands & Forests

L.O. 6098 Covers Gorm in Lot 5 Gorm & V
and Flooding Rights in Gorm Lake to
Elevation 454.00. File 112-57

L.O. 6299 Covers Gorm in Lots 6 & 7
and Flooding Rights in
Kingsford Lake, Birch Lake & Gorm
Lake to Elevation 454.00
File 112-57

Flooding Rights in Devils Lake reserved
to Government & not to be alienated
Controlled To Elevation 454.00
File 112-57 Vol. 5

DATE OF ISSUE
SEP 21 1972
ONE COPY OF MAP
AND EXPLANATION

PLAN NO.-M.52

ONTARIO
DEPARTMENT OF MINES
AND NORTHERN AFFAIRS



THE TOWNSHIP
OF
BEDFORD
COUNTY OF
FRONTENAC
EASTERN ONTARIO
MINING DIVISION

SCALE 1 INCH = 40 CHAINS

LEGEND

- PATENTED LAND
- CROWN LAND SALE
- LEASES
- LOCATED LAND
- LICENSE OF OCCUPATION
- MINING RIGHTS ONLY
- SURFACE RIGHTS ONLY
- ROADS
- IMPROVED ROADS
- RIVERS, HIGHWAYS
- RAILWAYS
- POWER LINES
- MARSH OR MUSKES
- WATER
- CANCELLED

NOTES

This Map is Not To Be Used
FOR SURVEY PURPOSES

L.O. 6123 Covers Devils Lake and
Floods Rights on Devils Lake & extends
to elevation 554.00. File 734488.
Floods Rights on Bobs Lake controlled
by the Dept. of Railways & Roads. File
71474804.
Also shown just north of Bobs Lake.
For Status of lands in this Township
Please Contact Dept. of Lands & Forests
L.O. 6094 Covers Devils Lake & extends
to elevation 554.00. File 734488.
L.O. 6093 Covers Devils Lake & extends
to elevation 554.00. File 734488.
Floods Rights in Devils Lake Reserved
to Government & Electric Light & Power Co.
Ontario. File 734488.

MINING LANDS
DATE OF ISSUE
JAN 30 1973
MINISTRY
OF NATURAL RESOURCES

THE TOWNSHIP

OF

BEDFORD

COUNTY OF
FRONTENAC

EASTERN ONTARIO
MINING DIVISION

SCALE 1 INCH = 40 CHAINS

LEGEND

- PATENTED LAND
- CROWN LAND SALE
- LEASES
- LOCATED LAND
- LICENSE OF OCCUPATION
- MINING RIGHTS ONLY
- SURFACE RIGHTS ONLY
- ROADS
- IMPROVED ROADS
- RIVERS
- POWER LINES
- MARSH OR MUSKES
- CANCELLED

NOTES

This Map Is Not To Be Used
FOR SURVEY PURPOSES

L.O. 6123 Covers Dam in Lake Huron
and Flooding Rights in Conne Lake & Lake
to elevation 464.00. File 125488.

Flooding Rights in Bob's Lake controlled
by the Dept. of Railways & Canals. Original
File 58014.

Area shown this map INDIAN LAND.

For Status of Islands in this Township
Please Contact Dept. of Lands & Forests.

L.O. 6098 Covers Dam in Lake Huron
and Flooding Rights in Buck Lake to
Elevation 454.60. File 12537.

L.O. 6099 Covers Dam in Lake Huron
and Flooding Rights in
Kingsford Lake, Birch Lake & Conne
Lake to Elevation 436.6.
File 11237.

Flooding Rights in Devils Lake Reserved
to Government Electric Light & Power Corp.
Control to Elevation 424.
File 11237, Vol. 3.

MINING LANDS -
DATE OF ISSUE
MAY 9 1973
MINISTRY
OF NATURAL RESOURCES

PLAN NO. M-52
ONTARIO
MINISTRY OF NATURAL RESOURCES
SURVEY AND MAPPING BRANCH



THE TOWNSHIP
OF
BEDFORD
COUNTY OF
FRONTENAC
EASTERN ONTARIO
MINING DIVISION

SCALE 1 INCH = 40 CHAINS

LEGEND

PATENTED LAND
CROWN LAND SALE
LEASES
LOCATED LAND
LICENSE OF OCCUPATION
MINING RIGHTS ONLY
SURFACE RIGHTS ONLY
ROADS
IMPROVED ROADS
KINGS - HIGHWAYS
RAILWAYS
DRAINAGE CANALS
MATERIAL OR MUSKES
MINES
CANCELLED

NOTES

This Map Is Not To Be Used
FOR SURVEY PURPOSES

4005
L.O. 8123 Covers Dominion 8 1/2 Lands in V and Flooding Rights on Carle Lake B.E. Lake to elevation 454.00. File 125488.
Flooding Rights on Bob's Lake controlled by the Dept. of Railways & Canada Ottawa. File 58014.
Also shown are the INDIAN LANDS.
For Status Of Lands in this Township Please Contact Dept. of Lands & Forests.
L.O. 6098 Covers Dominion 15 Con. V and Flooding Rights in Buck Lake. Elevation 454.00. File 11237.
L.O. 6099 Covers Dominion 15 Con. V and Flooding Rights in Kingsford Lake, Buck Lake B. Desert Lake to Elevation 426.61. File 11237.
Flooding Rights in Devils Lake Reserved to Ontario Electric Light & Water Supply Co. Ltd. to Elevation 426.61. File 11237 - Vol. 3.

MINING LANDS
DATE OF ISSUE
JUL 13 1973
MINISTRY
OF NATURAL RESOURCES

PLAN NO. M-52
MINISTRY OF NATURAL RESOURCES
SURVEYS AND MAPPING BRANCH



THE TOWNSHIP
OF
BEDFORD
COUNTY OF
FRONTENAC
EASTERN ONTARIO
MINING DIVISION

SCALE: 1-INCH= 40 CHAINS

LEGEND

PATENTED LAND	⊙
CROWN LAND SALE	⊙
LEASES	⊙
LOCATED LAND	⊙
LICENSE OF OCCUPATION	⊙
MINING RIGHTS ONLY	⊙
SURFACE RIGHTS ONLY	⊙
ROADS	—
IMPROVED ROADS	—
KINGS HIGHWAYS	—
RAILWAYS	—
POWER LINES	—
MARSH OR MUSKES	—
MINES	—
CANCELLED	—

NOTES

This Map Is Not To Be Used
—FOR SURVEY PURPOSES—

400' Surface Rights Reservation along the
shores of all Lakes & Rivers.

L.O. 5123 Covers Dam in E 1/2 Lot 5 Con. IV
and Flooding Rights on Canoe Lake & Ed. Lake
to elevation 464'00. File: 125-468.

Flooding Rights on Bob's Lake controlled
by the Dept. of Railways & Canals—Ottawa
File: 58014.

Area shown thus: INDIAN LAND.

For Status Of Islands In This Township
Please Contact Dept. of Lands & Forests.

L.O. 6098 Covers Dam in Lot 5 Con. XIV
And Flooding Rights in Buck Lake to
Elevation 434'80. File: 11237.

L.O. 6099 Covers Dam in Lots 6 & 7
Con. VIII And Flooding Rights in
Kingsford Lake, Birch Lake & Desert
Lake. To Elevation 446.6'
File: 11237.

Flooding Rights in Davis Lake Reserved
To Ganapani Electric Light & Water Supply
Co. Ltd. To Elevation 6' 0"
File: 11237 Vol. 3.

MINING LANDS
DATE OF ISSUE
AUG 29 1973
MINISTRY
OF NATURAL RESOURCES

PLAN NO.-M.52

ONTARIO



THE TOWNSHIP
OF
BEDFORD
COUNTY OF
FRONTENAC

EASTERN ONTARIO
MINING DIVISION

SCALE: 1 INCH = 40 CHAINS

LEGEND

PATENTED LAND	②
CROWN LAND SALE	C.S.
LEASES	③
LOCATED LAND	Loc.
LICENSE OF OCCUPATION	L.O.
MINING RIGHTS ONLY	M.R.O.
SURFACE RIGHTS ONLY	S.R.O.
ROADS	—
IMPROVED ROADS	—
KINGS HIGHWAYS	—
RAILWAYS	—
POWER LINES	—
MARSH OR MUSKES	—
MINES	—
CANCELLED	—

NOTES

This Map Is Not To Be Used
—FOR SURVEY PURPOSES—

400' Surface Rights Reservation along the shores of all Lakes & Rivers.

L.O. 6123 Covers Dam in E 1/2 Lot 5 Con. IV and Flooding Rights on Conoe Lake & Ed Lake to elevation 464'00. File: 125-488.

Flooding Rights on Bob's Lake controlled by the Dept. of Railways & Canals-Ottawa-File: 58014.

Area shown thus: INDIAN LAND.

For Status of Islands in this Township Please Contact Dept. of Lands & Forest.

L.O. 6098 Covers Dam in Lot 5 Con. XIV And Flooding Rights in Buck Lake to Elevation 434.80'. File: 11237.

L.O. 6099 Covers Dam in Lots 6 & 7 Con. VIII And Flooding Rights in Kingsford Lake, Birch Lake & Desert Lake. To Elevation 446.6' File: 11237.

Flooding Rights in Devils Lake Reserved To Gannaque Electric Light & Water Supply Co. Ltd. To Elevation 6' 8". File: 11237 Vol. 3.

AREAS WITHDRAWN FROM STAKING

S.R. - SURFACE RIGHTS	M.R. - MINING RIGHTS
42(R.S.O.1960) —	S.R. 81751
42(R.S.O.1960) —	S.R. 84637
42(R.S.O.1960) —	S.R. 176586
42(R.S.O.1960) —	S.R. 81751
S.R.O. Reserved for Public Use F.81719	

MINING LANDS -
DATE OF ISSUE
JUL - 2 1974
MINISTRY
OF NATURAL RESOURCES

South Crosby Twp.

Loughborough Twp.

PLAN NO. - M.52



THE TOWNSHIP
OF
BEDFORD
COUNTY OF
FRONTENAC
EASTERN ONTARIO
MINING DIVISION

SCALE: 1-INCH= 40 CHAINS

LEGEND

- | | |
|-----------------------|---|
| PATENTED LAND | ⊙ |
| CROWN LAND SALE | ⊙ |
| LEASES | ⊙ |
| LOCATED LAND | ⊙ |
| LICENSE OF OCCUPATION | ⊙ |
| MINING RIGHTS ONLY | ⊙ |
| SURFACE RIGHTS ONLY | ⊙ |
| ROADS | — |
| IMPROVED ROADS | — |
| KINGS HIGHWAYS | — |
| RAILWAYS | — |
| POWER LINES | — |
| MARSH OR MUSKES | — |
| MINES | — |
| CANCELLED | — |

NOTES

This Map Is Not To Be Used
—FOR SURVEY PURPOSES—

400' Surface Rights Reservation along the shores of all Lakes & Rivers.

L.O. 6123 Covers Dam in E 1/2 Lot 5 Con. IV and Flooding Rights on Canoe Lake & El. Lake to elevation 464'00. File: 125-488.

Flooding Rights on Bob's Lake controlled by the Dept. of Railways & Canals-Ottawa-File: 58014.

Area shown thus: INDIAN LAND.

For Status Of Islands In This Township Please Contact Dept. of Lands & Forests.

L.O. 6098 Covers Dam in Lot 5 Con. XIV And Flooding Rights in Buck Lake to Elevation 434'80. File: 11237.

L.O. 6099 Covers Dam in Lots 6 & 7 Con. VIII And Flooding Rights in Kingsford Lake, Birch Lake & Desert Lake. To Elevation 446.6' File: 11237.

Flooding Rights in Devils Lake Reserved To Ganoque Electric Light & Water Supply Co. Ltd. To Elevation 6'8" File: 11237 Vol. 3.

AREAS WITHDRAWN FROM STAKING

S.E.	DATE	FILE
42(R)SO1960	—	S.R. 81751
42(R)SO1960	—	S.R. 84637
42(R)SO1960	—	S.R. 176586
42(R)SO1960	—	S.R. 81751
S.R.O. Reserved for Public Use F.81719		

MINING LANDS
DATE OF ISSUE
JUL 19 1974
MINISTRY
OF NATURAL RESOURCES

PLAN NO.-M.52

ONTARIO

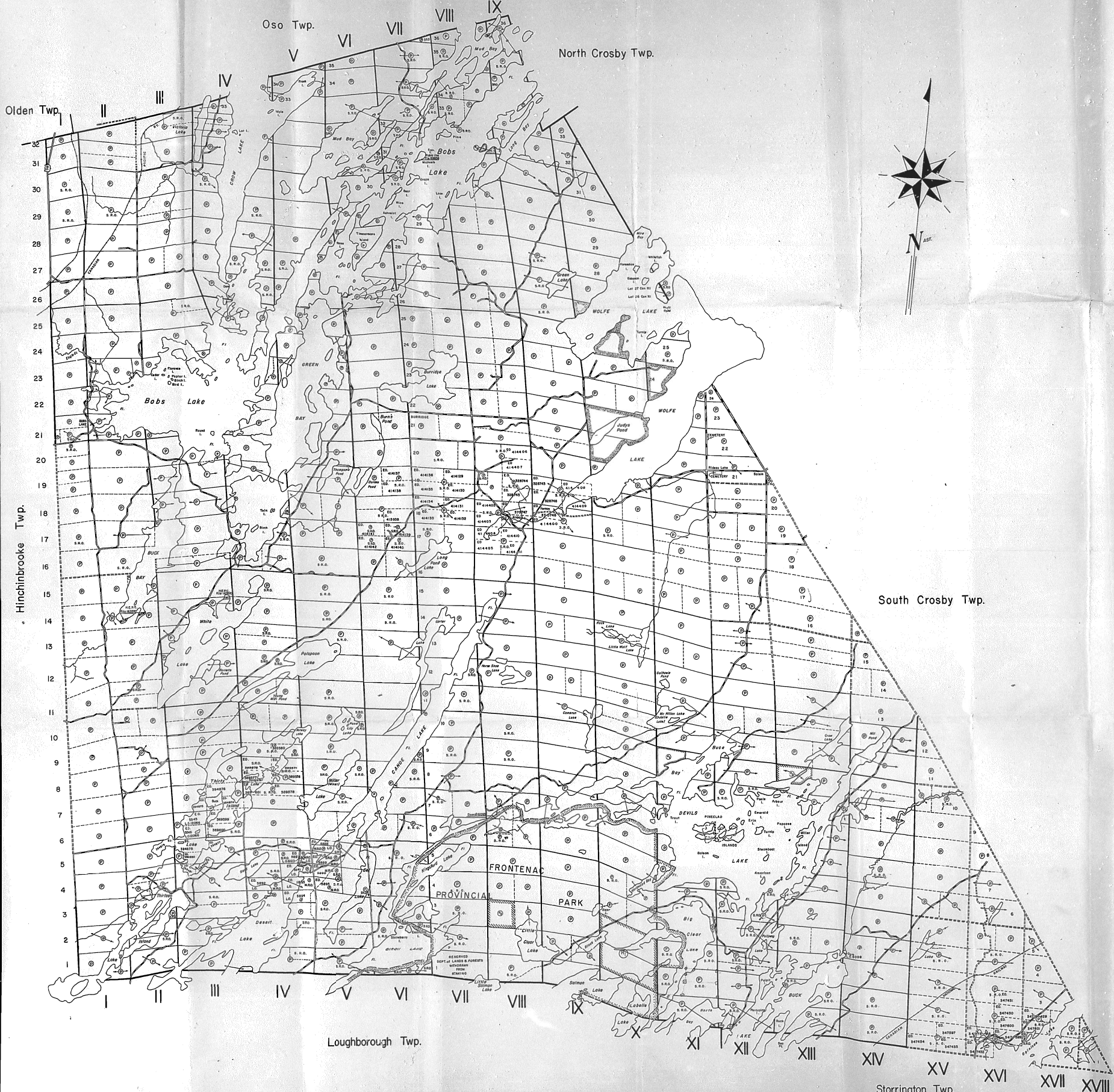

THE TOWNSHIP
OF
BEDFORD
COUNTY OF
FRONTENAC
EASTERN ONTARIO
MINING DIVISION

SCALE: 1-INCH = 40 CHAINS

LEGEND

- | | |
|-----------------------|---|
| PATENTED LAND | ⊙ |
| CROWN LAND SALE | ⊙ |
| LEASES | ⊙ |
| LOCATED LAND | ⊙ |
| LICENSE OF OCCUPATION | ⊙ |
| MINING RIGHTS ONLY | ⊙ |
| SURFACE RIGHTS ONLY | ⊙ |
| ROADS | — |
| IMPROVED ROADS | — |
| KINGS HIGHWAYS | — |
| RAILWAYS | — |
| POWER LINES | — |
| MARSH OR MUSKES | — |
| MINES | — |
| CANCELLED | — |

NOTES

This Map Is Not To Be Used
—FOR SURVEY PURPOSES—

400' Surface Rights Reservation along the shores of all Lakes & Rivers.

L.O. 6123 Covers Dam in E V2 Lot 5 Con. IV and Flooding Rights on Canoe Lake & Est. Lake to elevation 464'00. File: 125488.

Flooding Rights on Bob's Lake controlled by the Dept. of Railways & Canals-Ottawa-File: 58014.

Area shown thus: INDIAN LAND.

For Status Of Islands In This Township Please Contact Dept. of Lands & Forests.

L.O. 6098 Covers Dam in Lot 5 Con. XIV And Flooding Rights in Buck Lake to Elevation 434.80'. File: 11237.

L.O. 6099 Covers Dam in Lots 6 & 7 Con. VIII And Flooding Rights in Kingsford Lake, Birch Lake & Desert Lake. To Elevation 446.6' File: 11237.

Flooding Rights in Devils Lake Reserved To Ganouque Electric Light & Water Supply Co. Ltd. To Elevation 6' 8' File: 11237 Vol. 3.

AREAS WITHDRAWN FROM STAKING

S.R.	Order No.	Date	Area	File
⊙	4218.0.0.0.0.0	—	S.R.	6775
⊙	4218.0.0.0.0.0	—	S.R.	64637
⊙	4218.0.0.0.0.0	—	S.R.	176586
⊙	4218.0.0.0.0.0	—	S.R.	61721
⊙	S.R.O.	Reserved for Public Use	F.61719	

MINING LANDS
DATE OF ISSUE
FEB 12 1975
MINISTRY
OF NATURAL RESOURCES

PLAN NO.-M.52

ONTARIO
MINISTRY OF NATURAL RESOURCES
SURVEYS AND MAPPING BRANCH



THE TOWNSHIP
OF
BEDFORD
COUNTY OF
FRONTENAC

EASTERN ONTARIO
MINING DIVISION

SCALE: 1-INCH = 40 CHAINS

LEGEND

- PATENTED LAND
- CROWN LAND SALE
- LEASES
- LOCATED LAND
- LICENSE OF OCCUPATION
- MINING RIGHTS ONLY
- SURFACE RIGHTS ONLY
- ROADS
- IMPROVED ROADS
- KINGS HIGHWAYS
- RAILWAYS
- POWER LINES
- MARSH OR MUSKES
- MINES
- CANCELLED

NOTES

This Map Is Not To Be Used
—FOR SURVEY PURPOSES—

400' Surface Rights Reservation along the shores of all Lakes & Rivers.

L.O. 6123 Covers Dam in E 1/2 Lot 5 Con. IV and Flooding Rights on Canoe Lake & Ed Lake to elevation 454.00. File: 125-488.

Flooding Rights on Bob's Lake controlled by the Dept. of Railways & Canals-Ottawa. File: 58014.

Area shown thus INDIAN LAND.

For Status Of Islands In This Township Please Contact Dept. of Lands & Forests.

L.O. 6098 Covers Dam in Lot 5 Con. XIV And Flooding Rights in Buck Lake to Elevation 434.60'. File: 11237.

L.O. 6099 Covers Dam in Lots 6 & 7 Con. VIII And Flooding Rights in Kingsford Lake, Birch Lake & Desert Lake. To Elevation 446.6' File: 11237.

Flooding Rights in Devils Lake Reserved to Ganouque Electric Light & Water Supply Co. Ltd. To Elevation 6' File: 11237 Vol. 3.

AREAS WITHDRAWN FROM STAKING

S.S.	Order No.	Date	Order File
42 (R.S.O. 1960)	—	—	S.R. 81751
42 (R.S.O. 1960)	—	—	S.R. 84637
42 (R.S.O. 1960)	—	—	S.R. 176586
42 (R.S.O. 1960)	—	—	S.R. 81751
S.R.O. Reserved for Public Use 1-9179			

MINING LANDS
DATE OF ISSUE
FEB 12 1976
MINISTRY OF NATURAL RESOURCES

PLAN NO.-M.52

ONTARIO
MINISTRY OF NATURAL RESOURCES

THE TOWNSHIP
OF
BEDFORD
COUNTY OF
FRONTENAC
EASTERN ONTARIO
MINING DIVISION

SCALE 1-INCH = 40 CHAINS

LEGEND

- PATENTED LAND
- CROWN LAND SALE
- LEASES
- LOCATED LAND
- LICENSE OF OCCUPATION
- MINING RIGHTS ONLY
- SURFACE RIGHTS ONLY
- ROADS
- IMPROVED ROADS
- KINGS HIGHWAYS
- RAILWAYS
- POWER LINES
- MARSH OR MUSKOG
- MINES
- CANCELLED

NOTES

This Map Is Not To Be Used
—FOR SURVEY PURPOSES—

400' Surface Rights Reservation along the shores of all Lakes & Rivers.

L.O. 6123 Covers Dam in E 1/2 Lot 5 Con. IV and Flooding Rights on Canal Lake & Ed Lake to elevation 464'0.0. File 125488.

Flooding Rights on Bob's Lake controlled by the Dept. of Railways & Canals-Ottawa-File: 58014.

Area shown thus: INDIAN LAND.

For Status Of Islands in This Township Please Contact Dept. of Lands & Forests.

L.O. 6098 Covers Dam in Lot 5 Con. XIV And Flooding Rights in Buck Lake to Elevation 434.80'. File: 11237.

L.O. 6099 Covers Dam in Lots 6 & 7 Con. VIII And Flooding Rights in Kingsford Lake, Birch Lake & Desert Lake To Elevation 446.6'. File: 11237.

Flooding Rights in Devils Lake Reserved To Ganouque Electric Light & Water Supply Co. Ltd. To Elevation 6'8". File: 11237 Vol. 3.

AREAS WITHDRAWN FROM STAKING

S.R.	Order No.	Date	Page	File
42	19.50.1960	—	S.R.	81751
42	19.50.1960	—	S.R.	84637
42	19.50.1960	—	S.R.	176596
42	19.50.1960	—	S.R.	81751
42	19.50.1960	—	S.R.	81751

MINING LANDS
DATE OF ISSUE
SEP - 8 1975

MINISTRY OF NATURAL RESOURCES

PLAN NO.-M.52

ONTARIO
MINISTRY OF NATURAL RESOURCES

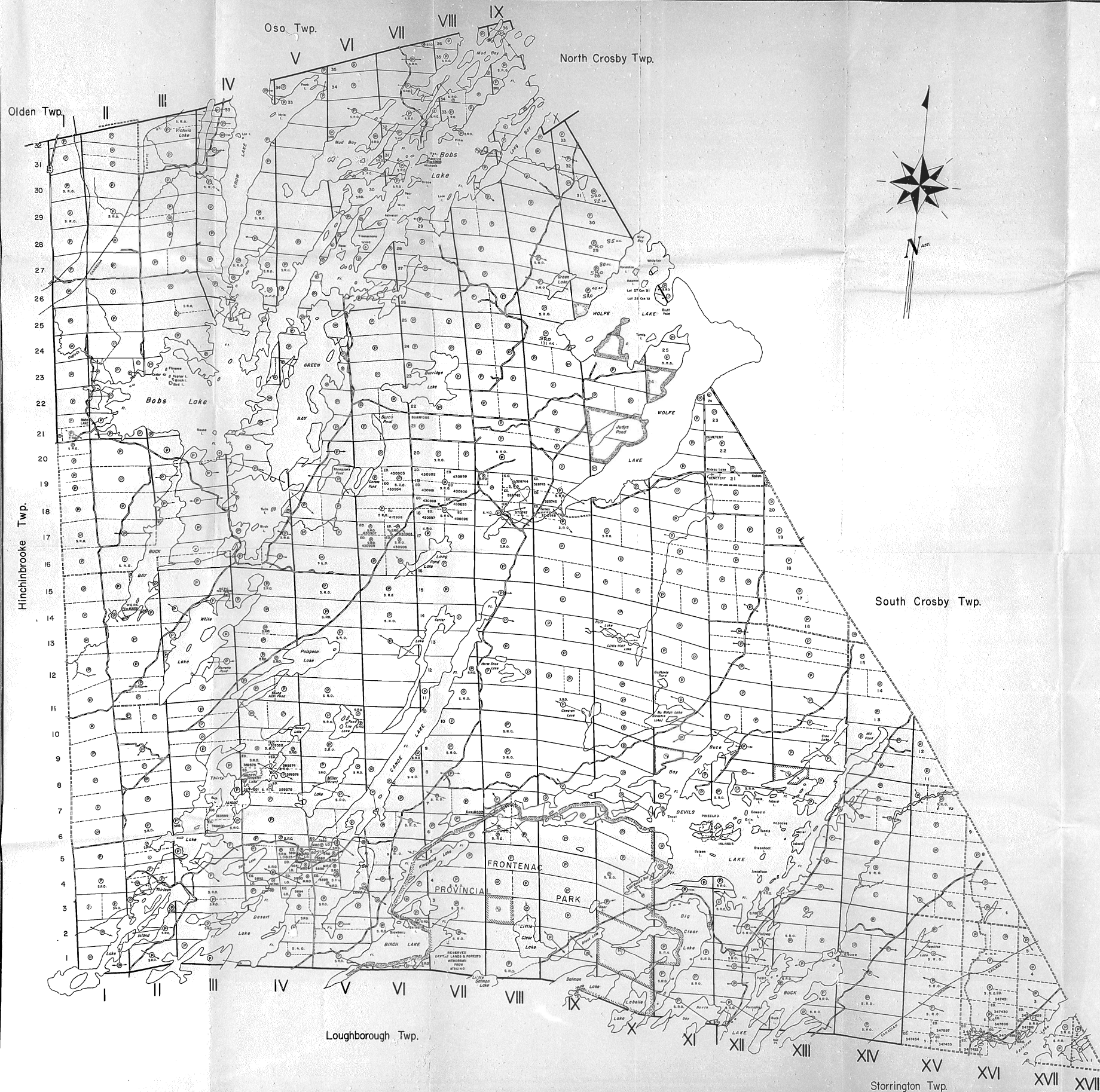

THE TOWNSHIP
OF
BEDFORD
COUNTY OF
FRONTENAC
EASTERN ONTARIO
MINING DIVISION

SCALE 1-1/2 INCH = 40 CHAINS

LEGEND

PATENTED LAND	CS.
CROWN LAND SALE	CS.
LEASES	CS.
LOCATED LAND	Loc.
LICENSE OF OCCUPATION	L.O.
MINING RIGHTS ONLY	M.R.O.
SURFACE RIGHTS ONLY	S.R.O.
ROADS	
IMPROVED ROADS	
KINGS HIGHWAYS	
RAILWAYS	
POWER LINES	
NATURAL OR MUSKOG	
MINES	
CANCELLED	

NOTES

This Map Is Not To Be Used
—FOR SURVEY PURPOSES—

400' Surface Rights Reservation along the
shores of all Lakes & Rivers.

L.O. 6123 Covers Dam in E 1/2 Lot 5 Con. IV
and Flooding Rights on Canoe Lake & Est. Lake
to elevation 464'00. File: 125-488.

Flooding Rights on Bob's Lake controlled
by the Dept. of Railways & Canals-Ottawa-
File: 56014.

Area shown thus: INDIAN LAND.

For Status Of Islands In This Township
Please Contact Dept. of Lands & Forests.

L.O. 6098 Covers Dam in Lot 5 Con. XIV
And Flooding Rights in Buck Lake to
Elevation 434.80'. File: 11237.

L.O. 6099 Covers Dam in Lots 6 & 7
Con. VIII And Flooding Rights in
Kingsford Lake, Birch Lake & Desert
Lake. To Elevation 446.6'.
File: 11237.

Flooding Rights in Devils Lake Reserved
To Ganouque Electric Light & Water Supply
Co. Ltd. To Elevation 6'8".
File: 11237 Vol. 3.

AREAS WITHDRAWN FROM STAKING

S.R. - SURFACE RIGHTS	M.R. - MINING RIGHTS
42R.S.O.1960 -	S.R. 61751
42R.S.O.1960 -	S.R. 64637
42R.S.O.1960 -	S.R. 176586
42R.S.O.1960 -	S.R. 61751
S.R.O. Reserved for Public Use F.6719	

DATE OF ISSUE:

JUN 10 1976

SURVEYS AND MAPPING
BRANCH

PLAN NO.-M.52

ONTARIO
MINISTRY OF NATURAL RESOURCES
SURVEYS AND MAPPING BRANCH

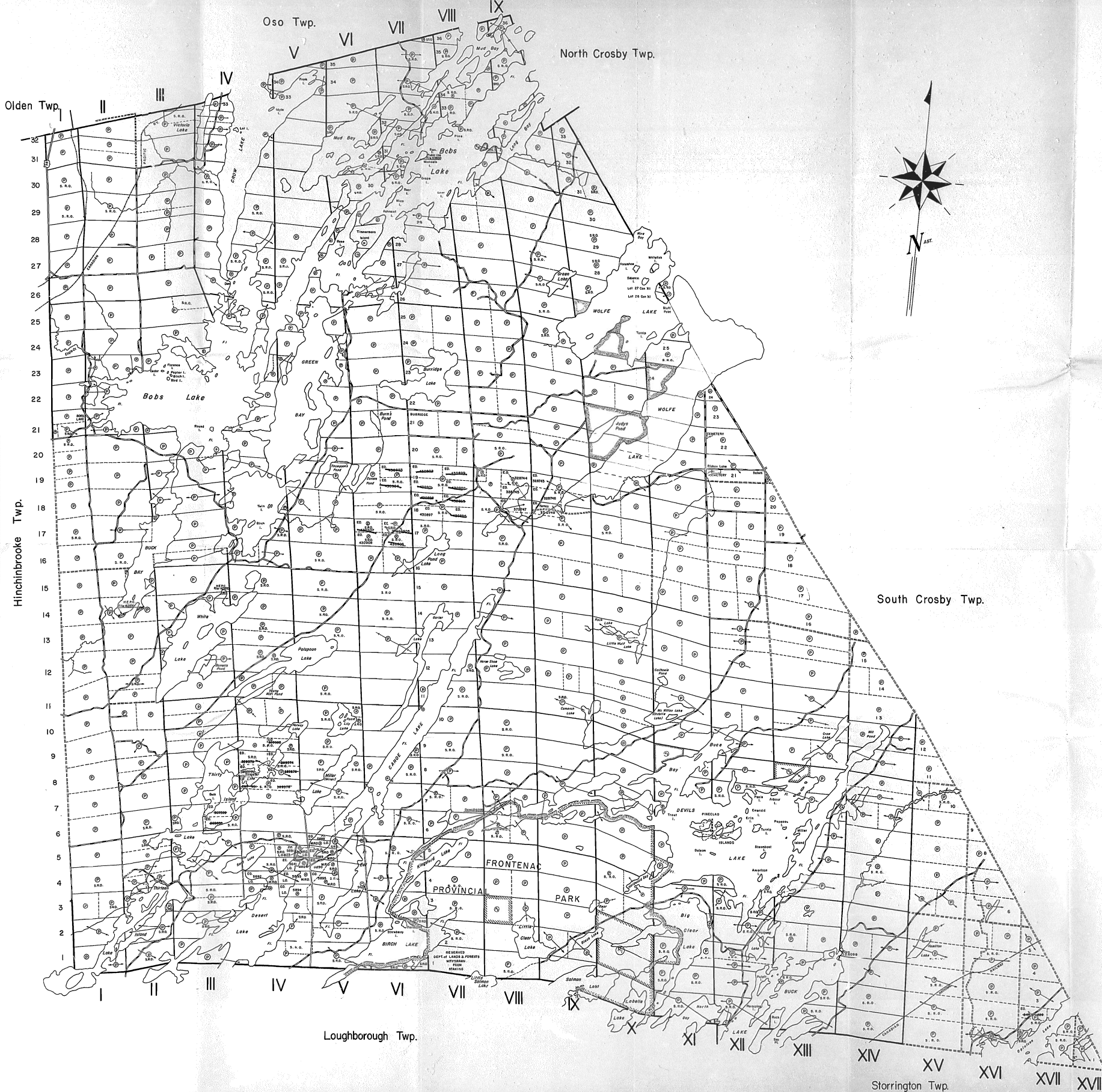



THE TOWNSHIP ^E
OF M-52

BEDFORD

COUNTY OF
FRONTENAC

EASTERN ONTARIO
MINING DIVISION

SCALE: 1-INCH= 40 CHAINS

LEGEND

- | | |
|-----------------------|---|
| PATENTED LAND | ① |
| CROWN LAND SALE | ② |
| LEASES | ③ |
| LOCATED LAND | ④ |
| LICENSE OF OCCUPATION | ⑤ |
| MINING RIGHTS ONLY | ⑥ |
| SURFACE RIGHTS ONLY | ⑦ |
| ROADS | ⑧ |
| IMPROVED ROADS | ⑨ |
| KINGS HIGHWAYS | ⑩ |
| RAILWAYS | ⑪ |
| POWER LINES | ⑫ |
| MARSH OR MUSKIEG | ⑬ |
| MINES | ⑭ |
| CANCELLED | ⑮ |

NOTES

This Map Is Not To Be Used
FOR SURVEY PURPOSES

400' Surface Rights Reservation along the shores of all Lakes & Rivers.

L.O. 6123 Covers Dam in E 1/2 Lot 5 Con. IV and Flooding Rights on Canoe Lake & Ed Lake to elevation 464.00'. File 125468.

Flooding Rights on Bob's Lake controlled by the Dept. of Railways & Canals - Ottawa - File 58014.

Area shown thus INDIAN LAND.

For Status Of Islands In This Township Please Contact Dept. of Lands & Forests.

L.O. 8098 Covers Dam in Lot 5 Con. XIV And Flooding Rights in Buck Lake to Elevation 434.80'. File 11237.

L.O. 6099 Covers Dam in Lots 6 & 7 Con. VIII And Flooding Rights in Kingsford Lake, Birch Lake & Desert Lake. To Elevation 446.6' File 11237.

Flooding Rights in Devil's Lake Reserved To Genesee Electric Light & Water Supply Co. Ltd. To Elevation 6' 8" File 11237 Vol. 3.

AREAS WITHDRAWN FROM STAKING

S.R.	Order No.	Date	Order No.	File
①	42 (R.S.O. 1960)	—	S.R.	61751
②	42 (R.S.O. 1960)	—	S.R.	64637
③	42 (R.S.O. 1960)	—	S.R.	176586
④	42 (R.S.O. 1960)	—	S.R.	61751
⑤	S.R.O. Reserved for Public Use R. 670			

DATE OF ISSUE
JUL 24 1978
SURVEYS AND MAPPING
DEPT. M

PLAN NO.-M.52

ONTARIO
MINISTRY OF NATURAL RESOURCES

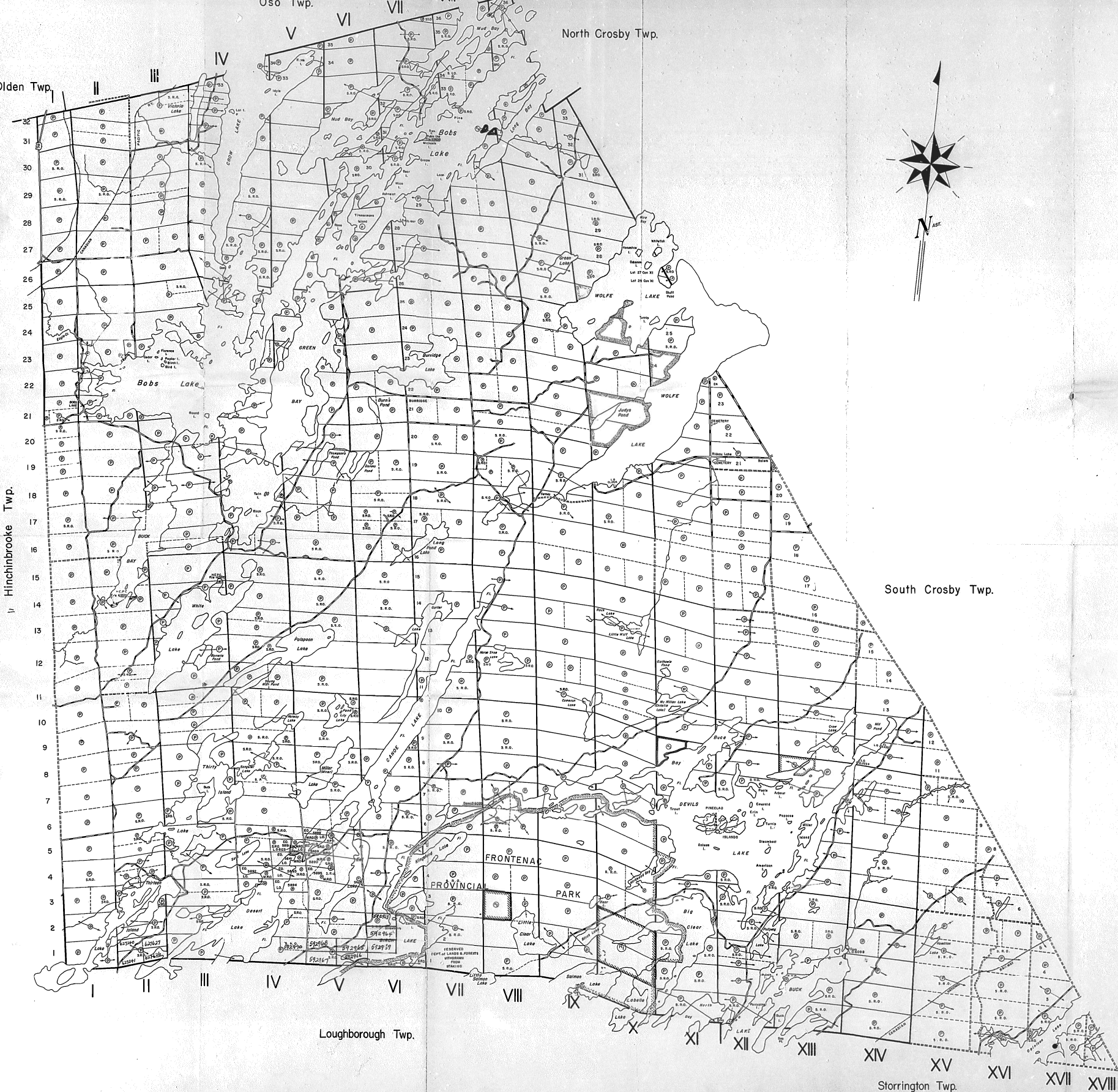

OF *M-52*
BEDFORD
COUNTY OF FRONTENAC
Dist. N.W. NAMEE
EASTERN ONTARIO MINING DIVISION
SCALE: 1 INCH = 40 CHAINS

LEGEND

PATENTED LAND	⊙
CROWN LAND SALE	⊙
LEASES	⊙
LOCATED LAND	⊙
LICENSE OF OCCUPATION	⊙
MINING RIGHTS ONLY	⊙
SURFACE RIGHTS ONLY	⊙
ROADS	⊙
IMPROVED ROADS	⊙
KINGS HIGHWAYS	⊙
RAILWAYS	⊙
POWER LINES	⊙
MINES OR MUSKES	⊙
MINES	⊙
CANCELLED	⊙

NOTES

This Map Is Not To Be Used
—FOR SURVEY PURPOSES—

400' Surface Rights Reservation along the shores of all Lakes & Rivers.

L.O. 6123 Covers Dam in E/2 Lot 5 Con. IV and Flooding Rights on Canoe Lake & Eel Lake to elevation 464.00. File #125488.

Flooding Rights on Bob's Lake controlled by the Dept. of Railways & Canals-Ottawa. File #58014.

Area shown thus: INDIAN LAND.

For Status of Islands in This Township Please Contact Dept. of Lands & Forests.

L.O. 6098 Covers Dam in Lot 5 Con. XIV And Flooding Rights in Buck Lake to Elevation 434.80'. File #11237.

L.O. 6099 Covers Dam in Lots 6 & 7 Con. VIII And Flooding Rights in Kingsford Lake, Birch Lake & Desert Lake. To Elevation 446.6'. File #11237.

Flooding Rights in Davis Lake Reserved to Ganarquo Electric Light & Water Supply Co. Ltd. To Elevation 6' 4". File #11237 Vol. 3.

AREAS WITHDRAWN FROM STAKING

Order No.	Date	Page	File
42 N.S.O. (1960)	—	1 R.	8751
42 N.S.O. (1960)	—	1 R.	84537
42 N.S.O. (1960)	—	1 R.	176586
42 N.S.O. (1960)	—	1 R.	8751
S.R.D. Reserved for Public Use	—	—	—

DATE OF ISSUE
SEP 24 1980
SURVEYS AND MAPPING

PLAN NO. - **M.52**
ONTARIO
MINISTRY OF NATURAL RESOURCES
SURVEYS AND MAPPING BRANCH



THE TOWNSHIP
OF
BEDFORD
D.M.
FRONTENAC COUNTY OF
EASTERN ONTARIO
MINING DIVISION
SCALE 1 INCH = 40 CHAINS

- LEGEND**
- PATENTED LAND
 - CROWN LAND SALE
 - LEASES
 - LOCATED LAND
 - LICENSE OF OCCUPATION
 - MINING RIGHTS ONLY
 - SURFACE RIGHTS ONLY
 - ROADS
 - IMPROVED ROADS
 - KINGS HIGHWAYS
 - RAILWAYS
 - POWER LINES
 - MARSH OR MUSKOG
 - MINES
 - CANCELLED

NOTES
This Map is Not To Be Used
—FOR SURVEY PURPOSES—

400' Surface Rights Reservation along the shores of all Lakes & Rivers.

L.O. 6123 Covers Dam in E 1/2 Lot 5 Con. IV and Flooding Rights on Caisse Lake & El Lake to elevation 454'00. File 123-468.

Flooding Rights on Bob's Lake controlled by the Dept. of Railways & Canals-Ottawa File: 58014.

Area shown thus: INDIAN LAND.

For Status Of Islands In This Township Please Contact Dept. of Lands & Forests.

L.O. 6098 Covers Dam in Lot 5 Con. XIV and Flooding Rights in Buck Lake to Elevation 434'80. File: 11237.

L.O. 6099 Covers Dam in Lots 6 & 7 Con. VIII And Flooding Rights in Kingsford Lake, Birch Lake & Desert Lake. To Elevation 446'6' File: 11237.

Flooding Rights in Devils Lake Reserved To Gomonque Electric Light & Water Supply Co. Ltd. To Elevation 6'6' File: 11237- Vol. 3.

AREAS WITHDRAWN FROM STAKING

S.S.	DATE	FILE	S.R.	FILE
42 (S.O. 1960)	—	—	S.R.	6751
42 (S.O. 1960)	—	—	S.R.	64637
42 (S.O. 1960)	—	—	S.R.	67555
42 (S.O. 1960)	—	—	S.R.	6759
S.R.O. Reserved For Public Use F. 6759				

DATE OF ISSUE
JUL - 6 1962
Ministry of Natural Resources
TORONTO

PLAN NO. - M.52
ONTARIO
MINISTRY OF NATURAL RESOURCES



THE TOWNSHIP
" E " OF M-52

BEDFORD
D.M. NAPANEE
COUNTY OF
FRONTENAC

EASTERN ONTARIO
MINING DIVISION

SCALE 1:1-INCH = 40 CHAINS

LEGEND

- | | |
|-----------------------|---|
| PATENTED LAND | ⊙ |
| CROWN LAND SALE | ⊙ |
| LEASES | ⊙ |
| LOCATED LAND | ⊙ |
| LICENSE OF OCCUPATION | ⊙ |
| MINING RIGHTS ONLY | ⊙ |
| SURFACE RIGHTS ONLY | ⊙ |
| ROADS | — |
| IMPROVED ROADS | — |
| KINGS HIGHWAYS | — |
| RAILWAYS | — |
| POWER LINES | — |
| MARSH OR MUSKIEG | — |
| MINES | — |
| CANCELLED | — |

NOTES

This Map Is Not To Be Used
—FOR SURVEY PURPOSES—

400' Surface Rights Reservation along the shores of all Lakes & Rivers.

L.O. 6123 Covers Dam in E 1/2 Lot 5 Con. IV and Flooding Rights on Canoe Lake & Ed Lake to elevation 464'00. File 125488.

Flooding Rights on Bob's Lake controlled by the Dept of Railways & Canals-Ottawa. File 58014.

Area shown thus INDIAN LAND.

For Status of Islands in This Township Please Contact Dept. of Lands & Forests.

L.O. 6096 Covers Dam in Lot 5 Con. XIV And Flooding Rights in Buck Lake to Elevation 434.60'. File 11237.

L.O. 6099 Covers Dam in Lots 6 & 7 Con. VIII And Flooding Rights in Kingsford Lake, Birch Lake & Desert Lake to Elevation 446.6' File 11237.

Flooding Rights in Devils Lake Reserved To Gananoque Electric Light & Water Supply Co. Ltd. To Elevation 6' 8". File 11237 Vol. 3.

AREAS WITHDRAWN FROM STAKING

S.R.	Order No.	Date	Area	File
⊙	42 R.S.O.1960	—	S.R.	6751
⊙	42 R.S.O.1960	—	S.R.	6857
⊙	42 R.S.O.1960	—	S.R.	175560
⊙	42 R.S.O.1960	—	S.R.	6751
⊙	S.R.O. Reserved for Public Use	7/1/79		

DATE OF ISSUE
JUN 21 1983
Ministry of Natural Resources
TORONTO

PLAN NO.-M.52

ONTARIO
MINISTRY OF NATURAL RESOURCES
SURVEYS AND MAPPING BRANCH



THE TOWNSHIP
E OF M52
BEDFORD
DISTRICT - NAPPAGE
COUNTY OF
FRONTENAC
SOUTHERN ONTARIO
MINING DIVISION
RESIDENT GEOLOGIST-TWEED
SCALE 1-INCH=40 CHAINS

LEGEND

PATENTED LAND	●
CROWN LAND SALE	○
LEASES	□
LOCATED LAND	△
LICENSE OF OCCUPATION	◇
MINING RIGHTS ONLY	×
SURFACE RIGHTS ONLY	+
ROADS	—
IMPROVED ROADS	—
KINDS HIGHWAYS	—
RAILWAYS	—
POWER LINES	—
MARSH OR MUSKOG	—
MINES	—
CANCELLED	—
PATENTED for S.R.O.	—

NOTES
This Map is Not To Be Used
—FOR SURVEY PURPOSES—

400' Surface Rights Reservation along the shores of all Lakes & Rivers.

L.O. 6123 Covers Dam in E.V.2 Lot 5 Con. IV and Flooding Rights on Canoe Lake & Ed Lake to elevation 464.00. File 125488.

Flooding Rights on Bob's Lake controlled by the Dept. of Railways & Canals-Ottawa. File 58014.

Area shown thus INDIAN LAND.

For Status of Islands in This Township Please Contact Dept. of Lands & Forests.

L.O. 6098 Covers Dam in Lot 5 Con. XIV And Flooding Rights in Buck Lake to Elevation 434.80'. File 11237.

L.O. 6099 Covers Dam in Lots 6 & 7 Con. VIII And Flooding Rights in Kingsford Lake, Birch Lake & Deser Lake to Elevation 446.8'. File 11237.

Flooding Rights in Devils Lake Reserved To Oronoque Electric Light & Water Supply Co. Ltd. To Elevation 618'. File 11237 Vol. 3.

AREAS WITHDRAWN FROM STAKING

S.R.	Order No.	Date	Page	File
4218.50.1900	—	—	—	8771
4218.50.1902	—	—	—	9457
4218.50.1903	—	—	—	17806
4218.50.1903	—	—	—	—
S.R.O. Reserved for Public Use	—	—	—	—

RECEIVED
FEB 20 1985
10-10-10-12-10-1-35

PLAN NO.-M.52
ONTARIO
MINISTRY OF NATURAL RESOURCES
SURVEYS AND MAPPING BRANCH



THE TOWNSHIP
OF
BEDFORD
COUNTY OF
FRONTENAC
SOUTHERN ONTARIO
MINING DIVISION

SCALE: 1-INCH= 40 CHAINS

LEGEND

- PATENTED LAND
- CROWN LAND SALE
- LEASES
- LOCATED LAND
- LICENSE OF OCCUPATION
- MINING RIGHTS ONLY
- SURFACE RIGHTS ONLY
- ROADS
- IMPROVED ROADS
- KINGS HIGHWAYS
- RAILWAYS
- POWER LINES
- MARSH OR MUSKOG
- MINES
- CANCELLED
- PATENTED FOR S.R.O.

NOTES

This Map Is Not To Be Used
—FOR SURVEY PURPOSES—

400' Surface Rights Reservation along the shores of all Lakes & Rivers.

L.O. 6123 Covers Dam in E 1/2 Lot 5 Con. IV and Flooding Rights on Canal Lake & East Lake to elevation 464.00'. File: 125468.

Flooding Rights on Bob's Lake controlled by the Dept. of Railways & Canals—Ottawa—File: 58014.

Area shown thus INDIAN LAND.

For Status of Islands in This Township Please Contact Dept. of Lands & Forests.

L.O. 6098 Covers Dam in Lot 5 Con. XIV And Flooding Rights in Buck Lake to Elevation 434.80'. File: 11237.

L.O. 6099 Covers Dam in Lots 6 & 7 Con. VII And Flooding Rights in Kingsford Lake, Birch Lake & Desert Lake to Elevation 446.6'. File: 11237.

Flooding Rights in Davis Lake Reserved to Gannock Electric Light & Water Supply Co. Ltd. To Elevation 6' 8". File: 11237 Vol. 3.

AREAS WITHDRAWN FROM STAKING

S.R.	SURFACE RIGHTS	M.R.	MINING RIGHTS
42 (R.S.O. 1960)	—	S.R.	61751
42R.S.O. 1960	—	S.R.	84637
42R.S.O. 1960	—	S.R.	176586
42R.S.O. 1960	—	S.R.	81751
S.R.	Reserved for Public Use	F. 61719	

DATE OF ISSUE
MAR 13 1969

PLAN NO.-M.52

ONTARIO
MINISTRY OF NATURAL RESOURCES

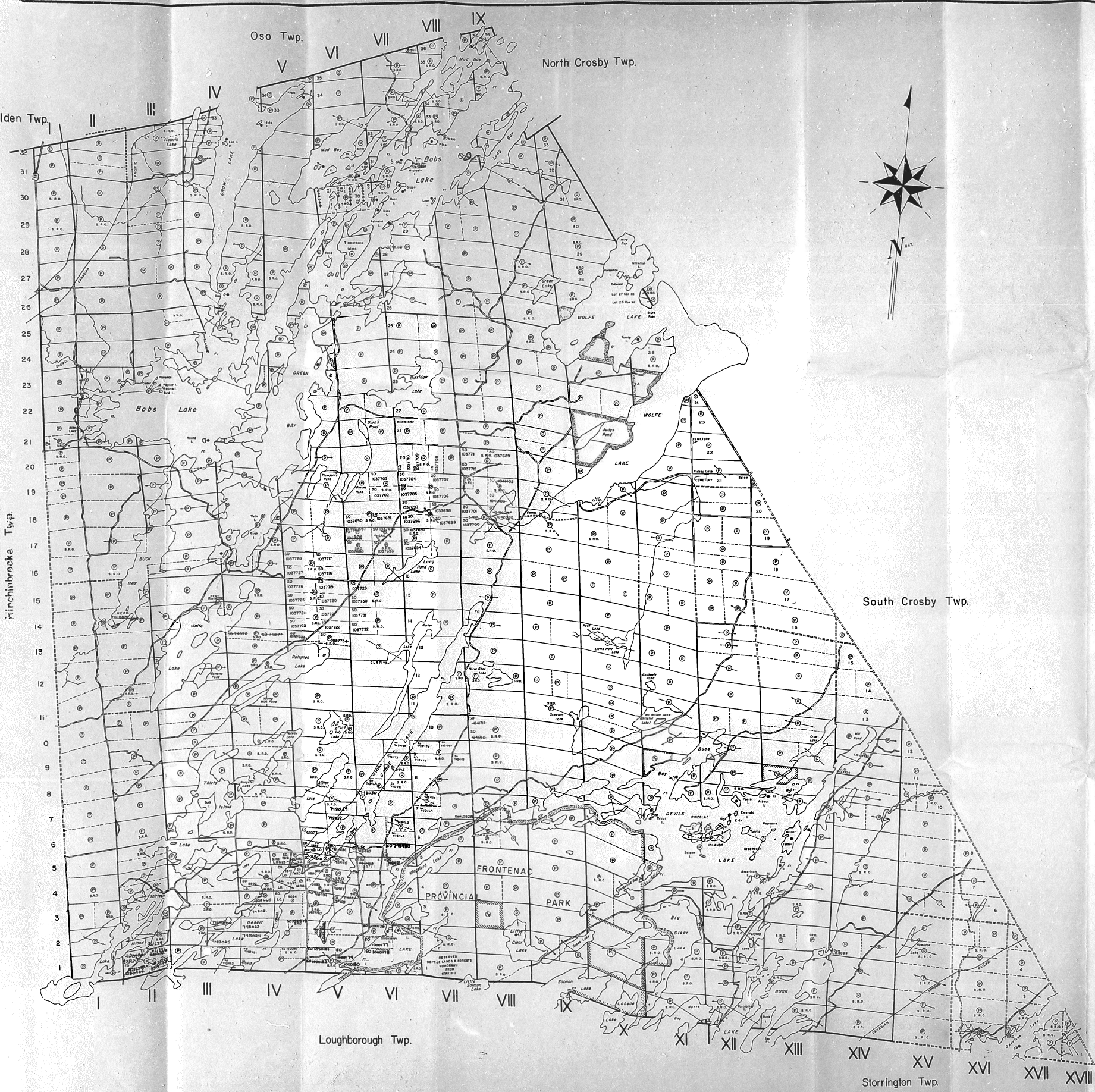

THE TOWNSHIP
OF
BEDFORD
COUNTY OF
FRONTENAC
SOUTHERN ONTARIO
MINING DIVISION

SCALE 1:1-INCH= 40 CHAINS

LEGEND

PATENTED LAND	● = (C)
CROWN LAND SALE	C.S.
LEASES	(C)
LOCATED LAND	LOC.
LICENSE OF OCCUPATION	L.O.
MINING RIGHTS ONLY	M.R.O.
SURFACE RIGHTS ONLY	S.R.O.
IMPROVED ROADS	—
KINGS HIGHWAYS	—
RAILWAYS	—
POWER LINES	—
MARSH OR MUSKOG	—
MINES	—
CANCELLED	—
PATENTED for S.R.O.	—

NOTES

This Map Is Not To Be Used
—FOR SURVEY PURPOSES—

400' Surface Rights Reservation along the
shores of all Lakes & Rivers.

L.O. 6123 Covers Dam in E 1/2 Lot 5 Con. IV
and Flooding Rights on Canal Lake & Col. Lake
to elevation 464' 0.0. File: 125-488.

Flooding Rights on Bob's Lake controlled by
the Dept. of Railways & Canals-Ottawa-
File: 58014.

Area shown thus: INDIAN LAND.

For Status Of Islands In This Township
Please Contact Dept. of Lands & Forests.

L.O. 6098 Covers Dam in Lot 5 Con. XIV
And Flooding Rights in Buck Lake to
Elevation 434' 8.0. File: 11237.

L.O. 6099 Covers Dam in Lots 6 & 7
Con. VIII And Flooding Rights in
Kingsford Lake, Birch Lake & Desert
Lake. To Elevation 446' 6".
File: 11237.

Flooding Rights in Devils Lake Reserved
To Ganouque Electric Light & Water Supply
Co. Ltd. To Elevation 6' 8".
File: 11237 Vol. 3.

AREAS WITHDRAWN FROM STANDING

S.S.	Order No.	Date	Order No.	File
42 (R.S.O. 1960)	—	—	S.R.	81751
42 (R.S.O. 1960)	—	—	S.R.	84637
42 (R.S.O. 1960)	—	—	S.R.	176566
42 (R.S.O. 1960)	—	—	S.R.	8751
S.R.O. Reserved for Public Use	File 87178	—	—	—

DATE OF ISSUE

AUG 14 1990

SOUTHERN ONTARIO
MINING DIVISION

THE INFORMATION THAT
APPEARS ON THIS MAP
HAS BEEN COMPILED
FROM VARIOUS SOURCES
AND ACCURACY IS NOT
GUARANTEED. THOSE
WISHING TO MAKE MIN-
ING CLAIMS SHOULD CON-
SULT WITH THE MINING
RECORDS, MINISTRY OF
NORTHERN DEVELOP-
MENT AND MINES FOR AD-
DITIONAL INFORMATION
ON THE STATUS OF THE
LANDS SHOWN HEREON.

PLAN NO.-M.52

ONTARIO
MINISTRY OF NATURAL RESOURCES
SURVEYS AND MAPPING BRANCH

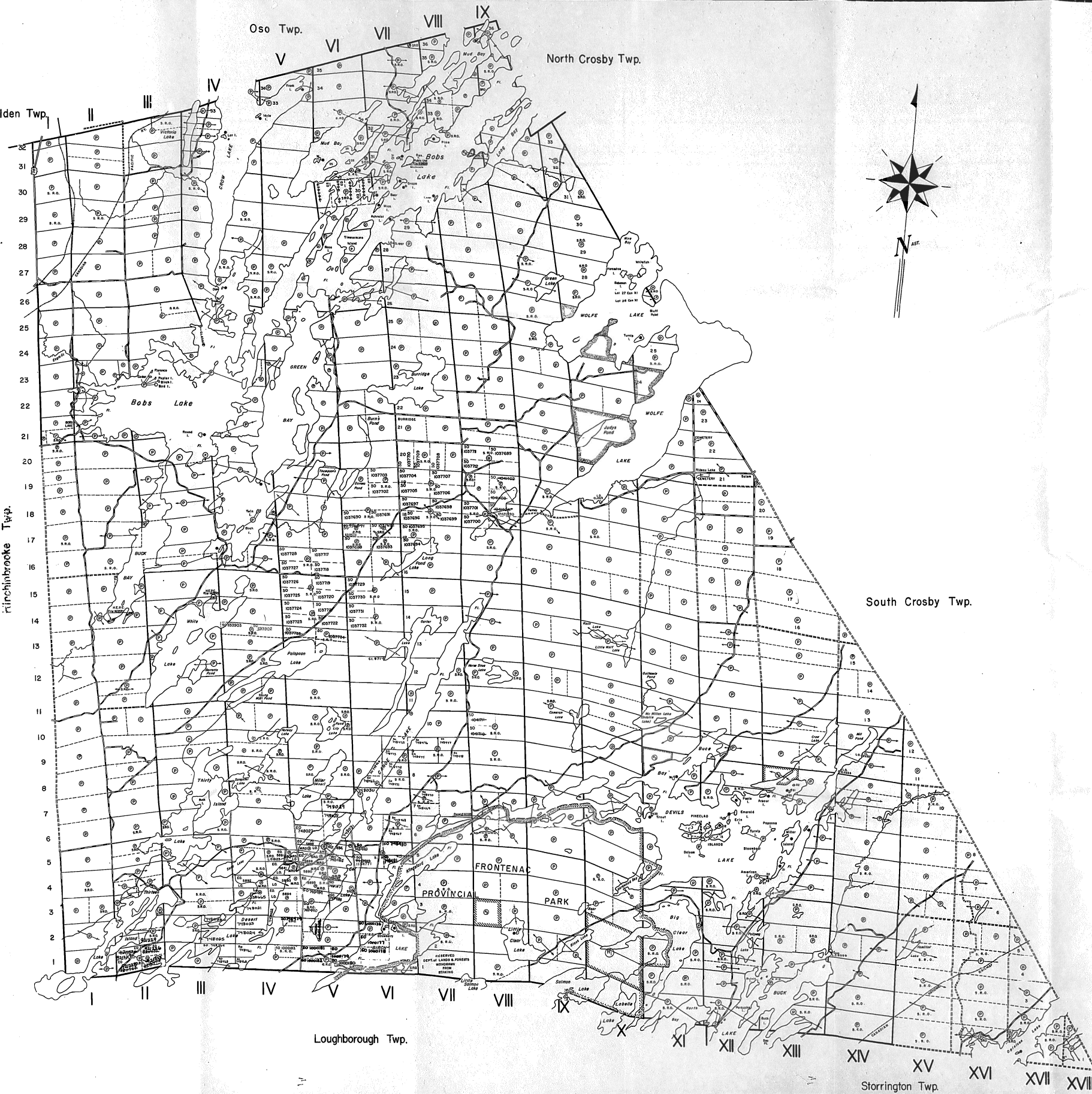

THE TOWNSHIP
OF
BEDFORD
COUNTY OF
FRONTENAC
SOUTHERN ONTARIO
MINING DIVISION

SCALE: 1-INCH = 40 CHAINS

LEGEND

PATENTED LAND	●
CROWN LAND SALE	○
LEASES	○
LOCATED LAND	○
LICENSE OF OCCUPATION	○
MINING RIGHTS ONLY	○
SURFACE RIGHTS ONLY	○
ROADS	—
IMPROVED ROADS	—
KINGS HIGHWAYS	—
RAILWAYS	—
POWER LINES	—
MARSH OR MUSKES	—
MINES	—
CANCELLED	—
PATENTED for S.R.O.	—

NOTES

This Map Is Not To Be Used
—FOR SURVEY PURPOSES—

400' Surface Rights Reservation along the shores of all Lakes & Rivers.

L.O. 5123 Covers Dam in E 1/2 Lot 5 Con. IV and Flooding Rights on Canoe Lake & El. Lake to elevation 464'00". File: 125498.

Flooding Rights on Bob's Lake controlled by the Dept. of Railways & Canals-Ottawa-File: 58014.

Area shown thus: INDIAN LAND.

For Status of Islands in This Township Please Contact Dept. of Lands & Forests.

L.O. 6098 Covers Dam in Lot 5 Con. XIV and Flooding Rights in Buck Lake to Elevation 434.80'. File: 11237.

L.O. 6099 Covers Dam in Lots 6 & 7 Con. VIII and Flooding Rights in Kingsford Lake, Birch Lake & Devil Lake. To Elevation 446.6'. File: 11237.

Flooding Rights in Devils Lake Reserved To Ganoque Electric Light & Water Supply Co. Ltd. To Elevation 6' 8". File: 11237 Vol. 3.

SESS.	Order No.	Date	Area	File
42	U.S.O. 19400	—	S.R.	81751
42	U.S.O. 19401	—	S.R.	84637
42	U.S.O. 19402	—	S.R.	176996
42	U.S.O. 19403	—	S.R.	81751
42	U.S.O. 19404	—	S.R.	81751

THE INFORMATION THAT APPEARS ON THIS MAP HAS BEEN COMPILED FROM VARIOUS SOURCES AND ACCURACY IS NOT GUARANTEED. THOSE WISHING TO STAKE MINING CLAIMS SHOULD CONSULT WITH THE MINING RECORDER, MINISTRY OF NORTHERN DEVELOPMENT AND MINES FOR ADDITIONAL INFORMATION ON THE STATUS OF THE LANDS SHOWN HEREON.

DATE OF ISSUE
OCT 1 1960

PLAN NO.-M.52
ONTARIO
MINISTRY OF NATURAL RESOURCES
SURVEYS AND MAPPING BRANCH



THE TOWNSHIP
OF
BEDFORD
COUNTY OF
FRONTENAC
SOUTHERN ONTARIO
MINING DIVISION
SCALE: 1-INCH= 40 CHAINS

- LEGEND**
- PREPARED LAND
 - CROWN LAND SALE
 - LEASE
 - LOCATED LAND
 - LICENSE OF OCCUPATION
 - MINING RIGHTS ONLY
 - SURFACE RIGHTS ONLY
 - ROADS
 - IMPROVED ROADS
 - KINGS HIGHWAYS
 - RAILWAYS
 - POWER LINES
 - MARSH OR MUSKOG
 - MINES
 - CANCELLED
 - PATENTED FOR S.R.O.

NOTES
This Map Is Not To Be Used
—FOR SURVEY PURPOSES—

400' Surface Rights Reservation along the shores of all Lakes & Rivers.

L.O. 6123 Covers Dam in E. 1/2 Lot 5 Con. IV and Flooding Rights on Canoe Lake & El. Lake to elevation 464'0". File: 125-488.

Flooding Rights on Bob's Lake controlled by the Dept. of Railways & Canals-Ottawa-File: 58014.

Area shown thus: INDIAN LAND.
For Status of Lands in This Township Please Contact Dept. of Lands & Forests.

L.O. 6098 Covers Dam in Lot 5 Con. XIV and Flooding Rights in Buck Lake to Elevation 434.60'. File: 11237.

L.O. 6099 Covers Dam in Lots 6 & 7 Con. VIII and Flooding Rights in Kingsford Lake, Birch Lake & Desert Lake to Elevation 446.6'. File: 11237.

Flooding Rights in Devils Lake Reserved to Georgian Electric Light & Water Supply Co. Ltd. to Elevation 5'0". File: 11237 Vol. 3.

AREAS WITHDRAWN FROM STAKING

S.R.	SURFACE RIGHTS	S.R.	MINING RIGHTS
42	(S.O. 1960)	—	S.R. 0751
42	(S.O. 1960)	—	S.R. 04637
42	(S.O. 1960)	—	S.R. 176586
42	(S.O. 1960)	—	S.R. 0751
42	(S.O. 1960)	—	S.R. 0751

DATE OF ISSUE
SEP - 1 1992
SOUTHERN ONTARIO
MINING DIVISION

DATE OF ISSUE
JULY 1 1992
SOUTHERN ONTARIO
MINING DIVISION

THE INFORMATION THAT APPEARS ON THIS MAP HAS BEEN COMPILED FROM VARIOUS SOURCES AND ACCURACY IS NOT GUARANTEED. THOSE DESIRING TO STAKE MINING CLAIMS SHOULD CONSULT WITH THE MINING RECORDER, MINISTRY OF NORTHERN DEVELOPMENT AND MINES FOR ADDITIONAL INFORMATION ON THE STATUS OF THE LANDS SHOWN HEREON.

PLAN NO.-M.52
ONTARIO
MINISTRY OF NATURAL RESOURCES

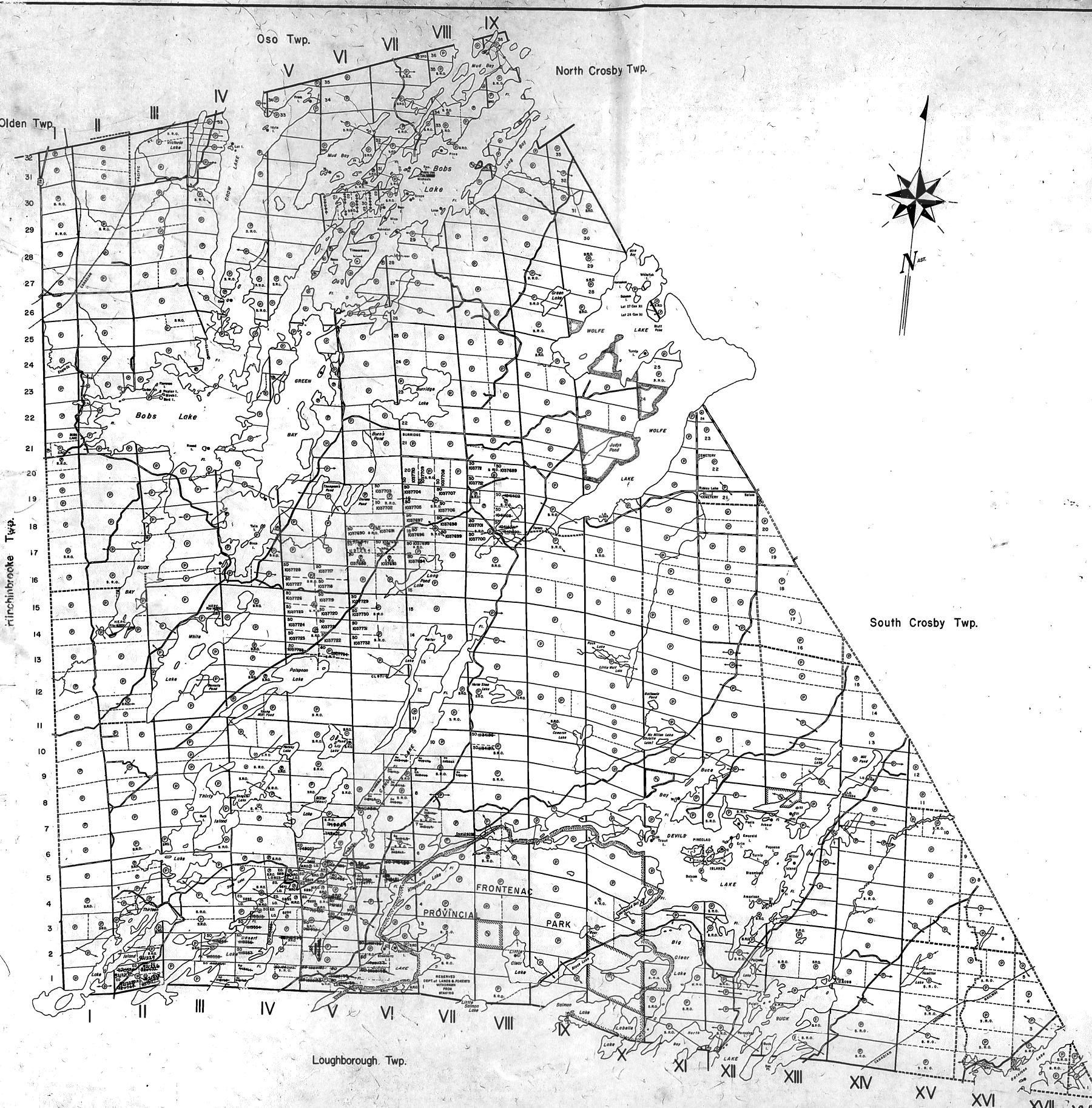

THE TOWNSHIP
OF
BEDFORD
COUNTY OF
FRONTENAC

SOUTHERN ONTARIO
MINING DIVISION

SCALE 1-INCH = 40 CHAINS

LEGEND

- PATENTED LAND ●
CROWN LAND SALE ○
LEASES ○
LOCATED LAND ○
LICENSE OF OCCUPATION ○
MINING RIGHTS ONLY ○
SURFACE RIGHTS ONLY ○
ROADS —
IMPROVED ROADS —
KINGS HIGHWAYS —
RAILWAYS —
POWER LINES —
MARSH OR MUSKEG —
MINES —
CANCELLED —
PATENTED BY S.R.O. —

NOTES

This Map Is Not To Be Used
—FOR SURVEY PURPOSES—

400' Surface Rights Reservation along the
shores of all Lakes & Rivers.

L.O. 6123 Covers Dam 16 E 1/2 Lot 5 Con IV
and Flooding Rights on Canoe Lake S. of Lake
to Elevation 464'0.0. File 1125488.

Flooding Rights on Bob's Lake controlled by
the Dept. of Railways & Canals-Ottawa.
File 58014.

Area shown thus INDIAN LAND.

For Status of Islands in This Township
Please Contact Dept. of Lands & Forests.

L.O. 6098 Covers Dam in Lot 5 Con. XIV
And Flooding Rights in Buck Lake to
Elevation 434.80'. File 11237.

L.O. 6099 Covers Dam in Lots 6 & 7
Con. VIII And Flooding Rights in
Kingsford Lake, Birch Lake & Desert
Lake. To Elevation 446.6'
File 11237.

Flooding Rights in Devils Lake Reserved
To Georgian Electric Light & Water Supply
Co. Ltd. To Elevation 6' 9".
File 11237 Vol. 3.

AREAS WITHDRAWN FROM STAKING				
S.R.	Order No.	Date	Order No.	File
42(R.S.O.1900)	—	—	S.R.	6751
42(R.S.O.1900)	—	—	S.R.	6437
42(R.S.O.1900)	—	—	S.R.	17656
42(R.S.O.1900)	—	—	S.R.	6721
S.R.O. Reserved for Public Use 1/27/79				

DATE OF ISSUE

JUN 23 1999

PROVINCIAL RECORDING
OFFICE - SUDBURY

THE INFORMATION THAT
APPEARS ON THIS MAP
HAS BEEN COMPILED
FROM VARIOUS SOURCES
AND ACCURACY IS NOT
GUARANTEED. THOSE
WISHING TO STAKE
MINING CLAIMS SHOULD
CONSULT WITH THE MINING
RECORDS, MINISTRY OF
NORTHERN DEVELOPMENT
AND MINES FOR ADDI-
TIONAL INFORMATION
ON THE STATUS OF THE
LANDS SHOWN HEREIN.

PLAN NO.-M.52

ONTARIO