

CANTIN LAKE - G-

86° 30'

54° 00'

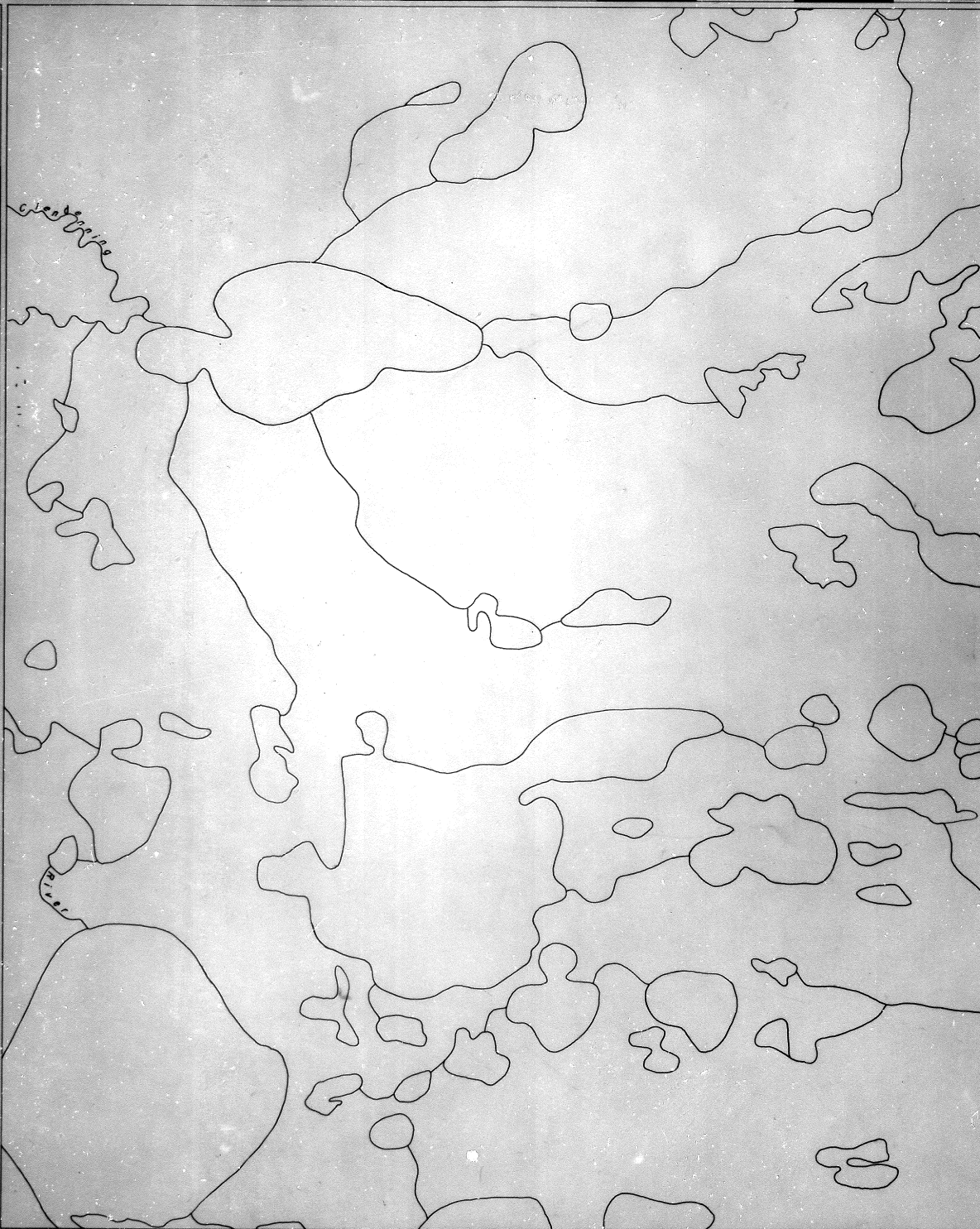

53° 52' 30"

86° 30'

29

28

27

26

25

24

23

22

21

BERNATH LAKE

**DISTRICT OF
KENORA
PATRICIA PORTION**

**PATRICIA
MINING DIVISION**

SCALE: 1-INCH=40 CHAINS

LEGEND

PATENTED LAND
PATENTED FOR SURFACE RIGHTS ONLY
LEASES
LICENSE OF OCCUPATION
CROWN LAND SALE
LOCATED LAND
CANCELLED
MINING RIGHTS ONLY
SURFACE RIGHTS ONLY
HIGHWAY & ROUTE No.
ROADS
TRAILS
RAILWAYS
POWER LINES
MARSH OR MUSKEG
MINES

^aused only with summer resort locations or when space is limited

NOTES

400' Surface Rights Reservation Around the Shores of All Lakes and Rivers

Boundary of L.O.14842 not yet defined by survey. All claims apparently oversteaking this L.O. are subject to the definition of Exploratory Licence boundary and the mining recorder will issue an order allowing posts and tags to be moved after the boundary has been defined by an O.L.S.

1972

① GER.
NATIONAL TOPOGRAPHIC SERIES 43E16

PLAN NO. M-3254

**ONTARIO
DEPARTMENT OF MINES
AND NORTHERN AFFAIRS**

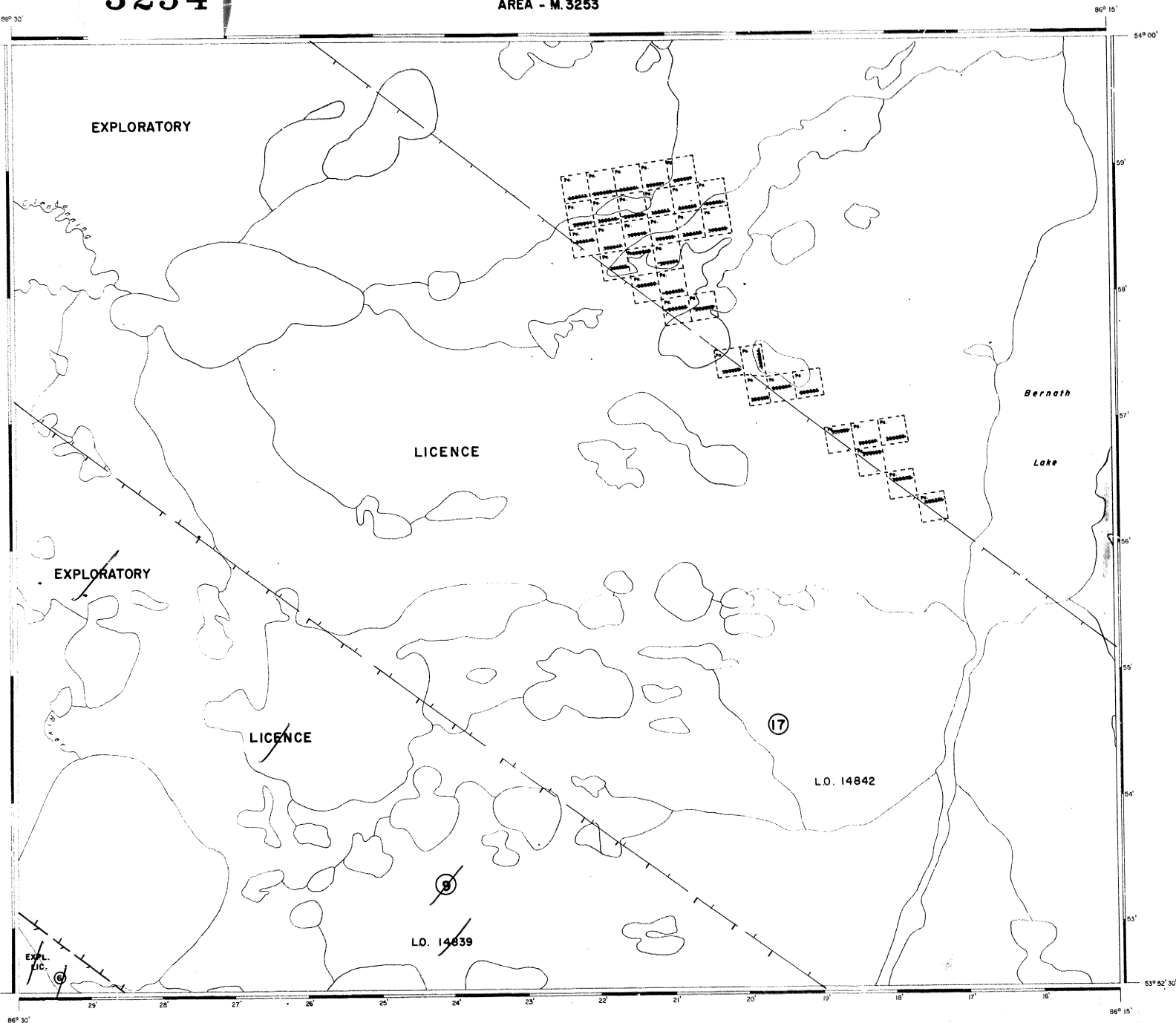

3254

AREA - M. 3253

AREA OF

BERNATH LAKE

DISTRICT OF
KENORA
PATRICIA PORTIONPATRICIA
MINING DIVISION

SCALE: 1-INCH = 40 CHAINS

LEGEND

PATENTED LAND
 PATENTED FOR SURFACE RIGHTS ONLY
 LEASES
 LICENSE OF OCCUPATION
 CROWN LAND SALE
 LOCATED LAND
 CANCELLED
 MINING RIGHTS ONLY
 SURFACE RIGHTS ONLY
 HIGHWAY & ROUTE No.
 ROADS
 TRAILS
 RAILWAYS
 POWER LINES
 MARSH OR MUSKEG
 MINES

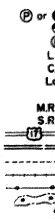

*used only with summer resort locations or when
 space is limited

NOTES

400' Surface Rights Reservation Around the Shores of All Lakes
 and Rivers

Boundary of L.O. 14842 not yet defined by survey.
 All claims apparently oversteering this L.O. are subject
 to the definition of Exploratory Licence boundary
 and the mining recorder will issue an order allowing
 posts and logs to be moved after the boundary has
 been defined by an O.L.S.

1972

GER.

NATIONAL TOPOGRAPHIC SERIES 43E16

PLAN NO. M-3254

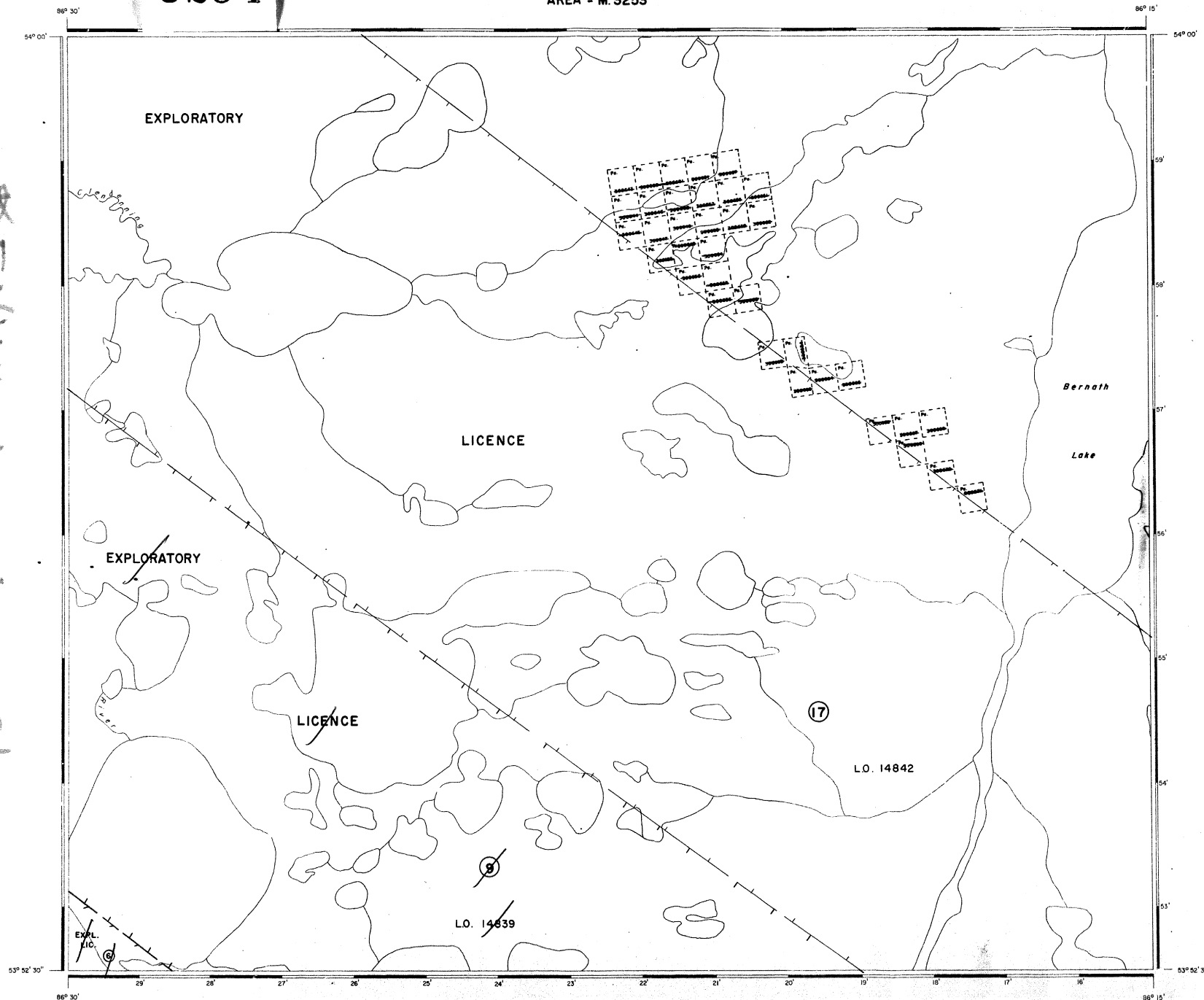
ONTARIO
DEPARTMENT OF MINES
AND NORTHERN AFFAIRS

MARTEL LAKE

LEGEND	
HIGHWAY AND ROUTE NO.	
OTHER ROADS	
TRAILS	
SURVEYED LINES:	
TOWNSHIPS, BASE LINES, ETC.	
LOTS, MINING CLAIMS, PARCELS, ETC.	
UNSURVEYED LINES:	
LOT LINES	
PARCEL BOUNDARY	
MINING CLAIMS ETC.	
RAILWAY AND RIGHT OF WAY	
UTILITY LINES	
NON-PERENNIAL STREAM	
FLOODING OR FLOODING FIGHTS	
SUBDIVISION OR COMPOSITE PLAN	
RESERVATIONS	
ORIGINAL SHORELINE	
MARSH OR MUSKEG	
MINES	
TRAVERSE MONUMENT	

DISPOSITION OF CROWN LANDS

TYPE OF DOCUMENT	SYMBOL
PATENT, SURFACE & MINING RIGHTS	
" SURFACE RIGHTS ONLY	
" MINING RIGHTS ONLY	
LEASE, SURFACE & MINING RIGHTS	
" SURFACE RIGHTS ONLY	
" MINING RIGHTS ONLY	
LICENCE OF OCCUPATION	
ORDER-IN-COUNCIL	
RESERVATION	
CANCELLED	
SAND & GRAVEL	
LAND USE PERMITTED FOR COMMERCIAL TOURISM/OUTPOST CAMP	

NOTE: MINING RIGHTS IN PARCELS PATENTED PRIOR TO MAY 2, 1912, VESTED IN ORIGINAL PATENTEES BY THE PUBLIC LANDS ACT, R.S.O. 1978, CHAP. 186, SEC. 24, SUBSEC. 1.

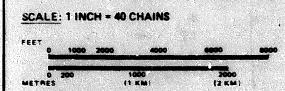

AREAS WITHDRAWN FROM DISPOSITION				
M.R.O. - MINING RIGHTS ONLY				
S.R.O. - SURFACE RIGHTS ONLY				
M. & S. - MINING AND SURFACE RIGHTS				
Description	Order No.	Date	Disposition	File

THE INFORMATION THAT APPEARS ON THIS MAP HAS BEEN COMPILED FROM VARIOUS SOURCES, AND ACCURACY IS NOT GUARANTEED. THOSE WISHING TO STATE MINING CLAIMS SHOULD CONSULT WITH THE LANDS RECORDS, MINISTRY OF NORTHERN DEVELOPMENT AND MINES, FOR ADDITIONAL INFORMATION ON THE STATUS OF THE LANDS SHOWN HEREON.

AREA
WEST OF BERNATH LAKE
 M.N.R. ADMINISTRATIVE DISTRICT
 GERALDTON
 MINING DIVISION
PORCUPINE/THUNDER BAY
 LAND TITLES / REGISTRY DIVISION
KENORA/PATRICIA PORTION

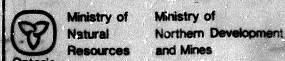

Date NOVEMBER / 1987 Number

G-1235

BERNATH LAKE

GLADENING RIVER

PORCUPINE MINING DIVISION

THUNDER BAY MINING DIVISION

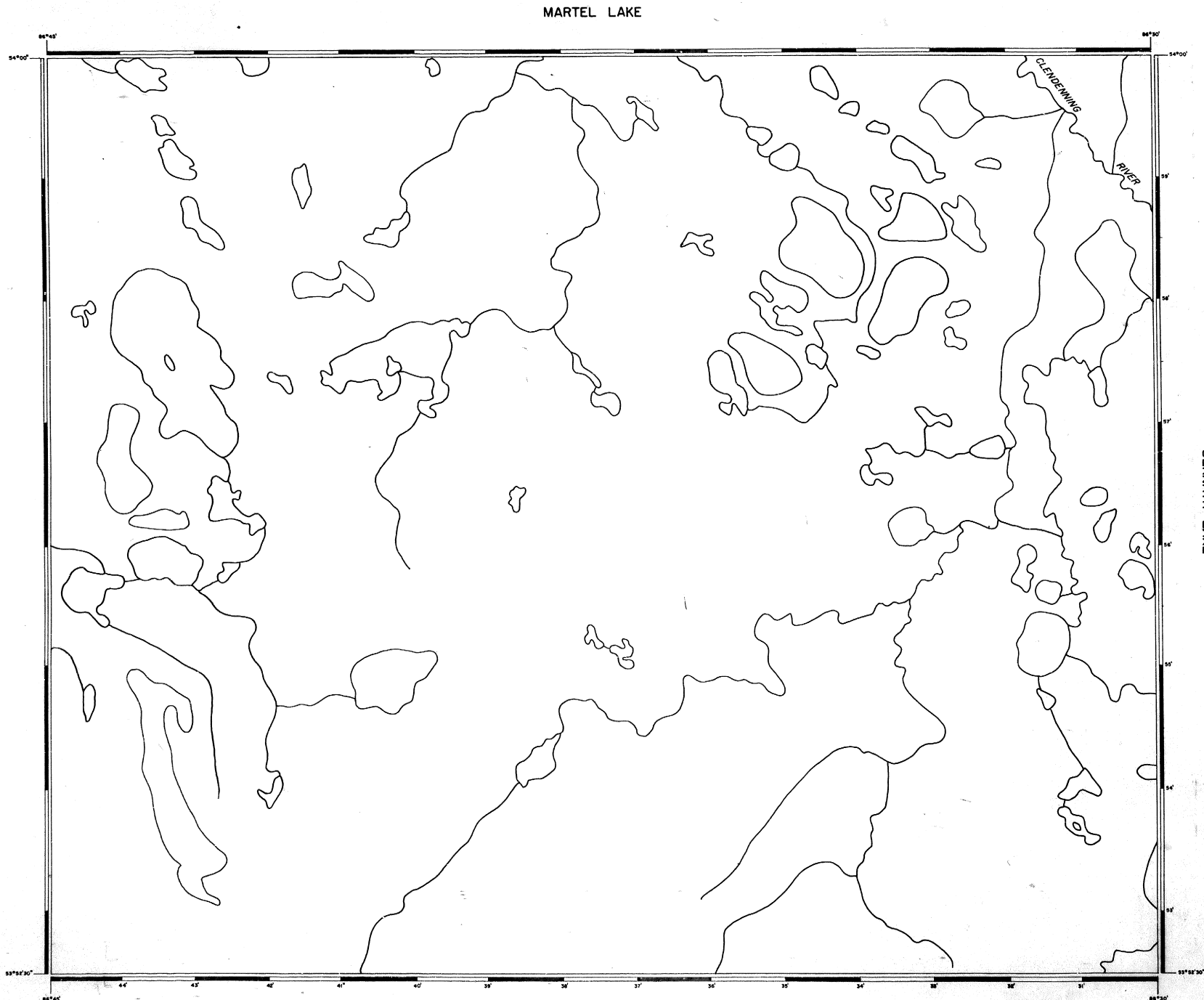

LEGEND

HIGHWAY AND ROUTE No.	
OTHER ROADS	
TRAILS	
SURVEYED LINES:	
TOWNSHIPS, BASE LINES, ETC.	
LOTS, MINING CLAIMS, PARCELS, ETC.	
UNSURVEYED LINES:	
LOT LINES	
PARCEL BOUNDARY	
MINING CLAIMS ETC.	
RAILWAY AND RIGHT OF WAY	
UTILITY LINES	
NON PERENNIAL STREAM	
FLOODING OR FLOODING RIGHTS	
SUBDIVISION OR COMPOSITE PLAN	
RESERVATIONS	
ORIGINAL SHORELINE	
MARSH OR MUSKEG	
MINES	
TRAVERSE MONUMENT	

DISPOSITION OF CROWN LANDS

TYPE OF DOCUMENT	SYMBOL
PATENT, SURFACE & MINING RIGHTS	
" SURFACE RIGHTS ONLY	
" MINING RIGHTS ONLY	
LEASE, SURFACE & MINING RIGHTS	
" SURFACE RIGHTS ONLY	
" MINING RIGHTS ONLY	
LICENCE OF OCCUPATION	
ORDER-IN-COUNCIL	
RESERVATION	
CANCELLED	
SAND & GRAVEL	

NOTE: MINING RIGHTS IN PARCELS PATENTED PRIOR TO MAY 6, 1915, VESTED IN ORIGINAL PATENTEE BY THE PUBLIC LANDS ACT, R.S.O. 1970, CHAP. 200, SEC. 59, SUBSEC. 1.

SCALE: 1 INCH = 40 CHAINS

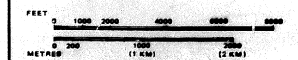

AREAS WITHDRAWN FROM DISPOSITION

M.R.O. - MINING RIGHTS ONLY
S.R.O. - SURFACE RIGHTS ONLY
M.F.S. - MINING AND SURFACE RIGHTS

Description Order No. Date Disposition File

THE INFORMATION THAT APPEARS ON THIS MAP HAS BEEN COMPILED FROM VARIOUS SOURCES AND ACCURACY IS NOT GUARANTEED. THOSE DESIRING TO OBTAIN MINING CLAIMS SHOULD CONSULT WITH THE MINING RECORDS, MINISTRY OF NORTHERN DEVELOPMENT AND MINES, FOR ADDITIONAL INFORMATION ON THE STATUS OF THE LANDS SHOWN HEREON.

RECEIVED DECEMBER 1, 1987.

AREA
WEST OF BERNATH LAKE
M.N.R. ADMINISTRATIVE DISTRICT
GERALDTON
MINING DIVISION
PORCUPINE/THUNDER BAY
LAND TITLES / REGISTRY DIVISION
KENORA/PATRICIA PORTION

Ministry of Natural Resources
Ministry of Northern Development and Mines

Date NOVEMBER / 1987
Number
G-1235

AREA - M.3253

AREA OF

BERNATH LAKE

DISTRICT OF
KENORA
PATRICIA PORTION

PATRICIA
MINING DIVISION

SCALE: 1-INCH = 40 CHAINS

LEGEND

PATENTED LAND
PATENTED FOR SURFACE RIGHTS ONLY
LEASES
LICENSE OF OCCUPATION
CROWN LAND SALE
LOCATED LAND
CANCELLED
MINING RIGHTS ONLY
SURFACE RIGHTS ONLY
HIGHWAY & ROUTE No.
ROADS
TRAILS
RAILWAYS
POWER LINES
MARSH OR MUSKEG
MINES

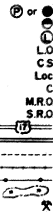

*used only with summer resort locations or when space is limited

NOTES

400' Surface Rights Reservation Around the Shores of All Lakes and Rivers

Boundary of L.O. 14842 not yet defined by survey.
All claims apparently overlapping this L.O. are subject to the definition of Exploratory Licence boundary and the mining recorder will issue an order allowing posts and tags to be moved after the boundary has been defined by an O.L.S.

1972

GER.

NATIONAL TOPOGRAPHIC SERIES 43E16

PLAN NO. M-3254

ONTARIO
DEPARTMENT OF MINES
AND NORTHERN AFFAIRS

EXPLORATORY

LICENCE

EXPLORATORY

LICENCE

(17)

L.O. 14842

L.O. 14839

EXPL.
LIC.

(8)

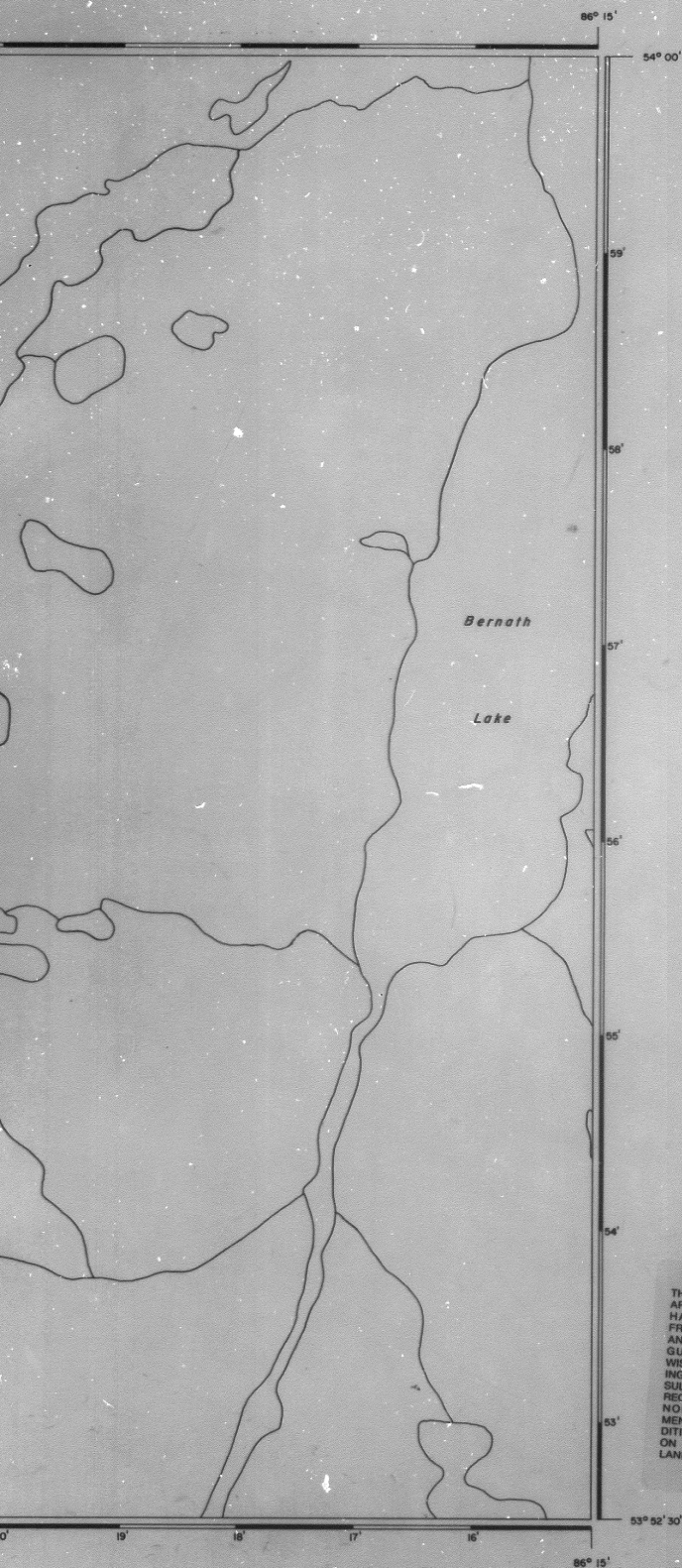

THE INFORMATION THAT APPEARS ON THIS MAP HAS BEEN COMPILED FROM VARIOUS SOURCES, AND ACCURACY IS NOT GUARANTEED. THOSE WISHING TO STAKE MINING CLAIMS SHOULD CONSULT WITH THE MINING RECORDER, MINISTRY OF NORTHERN DEVELOPMENT AND MINES, FOR ADDITIONAL INFORMATION ON THE STATUS OF THE LANDS SHOWN HEREON.

LEGEND

HIGHWAY AND ROUTE No.	
OTHER ROADS	
TRAILS	
SURVEYED LINES:	
TOWNSHIPS, BASE LINES, ETC.	
LOTS, MINING CLAIMS, PARCELS, ETC.	
UNSURVEYED LINES:	
LOT LINES	
PARCEL BOUNDARY	
MINING CLAIMS ETC.	
RAILWAY AND RIGHT OF WAY	
UTILITY LINES	
NON-PERENNIAL STREAM	
FLOODING OR FLOODING RIGHTS	
SUBDIVISION OR COMPOSITE PLAN	
RESERVATIONS	
ORIGINAL SHORELINE	
MARSH OR MUSKEG	
MINES	
TRAVERSE MONUMENT	

DISPOSITION OF CROWN LANDS

TYPE OF DOCUMENT	SYMBOL
PATENT, SURFACE & MINING RIGHTS	
" SURFACE RIGHTS ONLY	
" MINING RIGHTS ONLY	
LEASE, SURFACE & MINING RIGHTS	
" SURFACE RIGHTS ONLY	
" MINING RIGHTS ONLY	
LICENCE OF OCCUPATION	
ORDER-IN-COUNCIL	
RESERVATION	
CANCELLED	
SAND & GRAVEL	

NOTE: MINING RIGHTS IN PARCELS PATENTED PRIOR TO MAY 8, 1912, VESTED IN ORIGINAL PATENTEE BY THE PUBLIC LANDS ACT, R.S.O. 1979, CHAP. 360, SEC. 63, SUBSEC. 1

SCALE: 1 INCH = 40 CHAINS

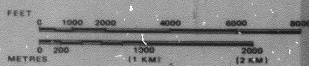

AREA

BERNATH LAKE

M.N.R. ADMINISTRATIVE DISTRICT

GERALDTON

MINING DIVISION

PORCUPINE

LAND TITLES / REGISTRY DIVISION

KENORA PATRICIA PORTION



Ministry of Natural Resources
Land Management Branch

Date JUNE 10th 1981

Number

G-204