

AREA OF
CAMP LAKE
 DISTRICT OF THUNDER BAY
 SAULT STE. MARIE MINING DIVISION
 SCALE: 1-INCH = 40 CHAINS

- LEGEND**
- PATENTED LAND (Symbol)
 - CROWN LAND SALE (Symbol)
 - LEASES (Symbol)
 - LOCATED LAND (Symbol)
 - LICENSE OF OCCUPATION (Symbol)
 - MINING RIGHTS ONLY (Symbol)
 - SURFACE RIGHTS ONLY (Symbol)
 - ROADS (Symbol)
 - IMPROVED ROADS (Symbol)
 - KING'S HIGHWAYS (Symbol)
 - RAILWAYS (Symbol)
 - POWER LINES (Symbol)
 - MARSH OR MUSKEG (Symbol)
 - MINES (Symbol)

NOTES

400' Surface Rights Reservation around all lakes & rivers.

Land under Lake Superior, withdrawn from staking by Order in Council dated April 30, 1912.

ALL ISLANDS WITHIN 2 MILE LIMIT FORM PART OF NAT. PARK

RECEIVED
 FEB 11 1983
 7:09:10:11:55:1:3:3:4:5

Replaced May 25/81
 M.P.L.R.
 NATIONAL TOPOGRAPHIC SER
 42D1 B 42C4

PLAN NO. **42D1 B 42C4**
 ONTARIO
 MINISTRY OF NATURAL RESOURCES
 SURVEYS AND MAPPING BRANCH

G.3764

AREA OF
CAMP LAKE

DISTRICT OF
THUNDER BAY

SAULT STE. MARIE
MINING DIVISION

SCALE: 1-INCH = 40 CHAINS

LEGEND

- PATENTED LAND Ⓢ
- CROWN LAND SALE C.S.
- LEASES Ⓛ
- LOCATED LAND Loc.
- LICENSE OF OCCUPATION L.O.
- MINING RIGHTS ONLY M.R.O.
- SURFACE RIGHTS ONLY S.R.O.
- ROADS —
- IMPROVED ROADS —
- KING'S HIGHWAYS —
- RAILWAYS —
- POWER LINES —
- MARSH OR MUSKEG —
- MINES —

NOTES

400' Surface Rights Reservoir around all lakes & rivers.

Land under Lake Superior withdrawn from staking by Order in Council dated April 30, 1912

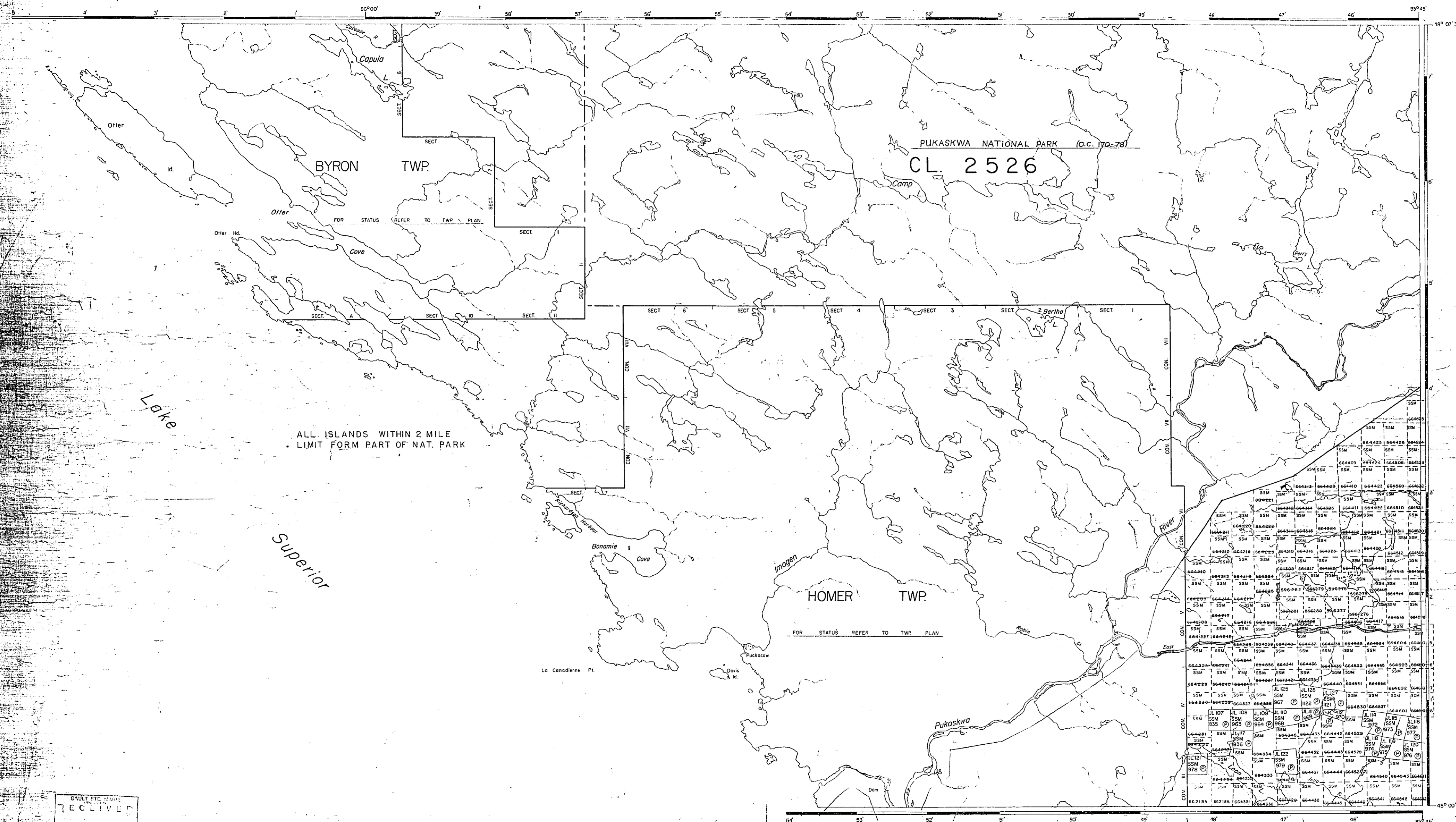

SAULT STE. MARIE
RECEIVED
MAY 10 1934
A.M. 10 11 12 1 2 3 4 5 6 P.M.

SAULT STE. MARIE
RECEIVED
MAY 10 1934
A.M. 10 11 12 1 2 3 4 5 6 P.M.

G.3764

NATIONAL TOPOGRAPHIC SERIES
42DI 8 42C4

PLAN NO. **11-21**

ONTARIO
MINISTRY OF NATURAL RESOURCES
SURVEYS AND MAPPING BRANCH

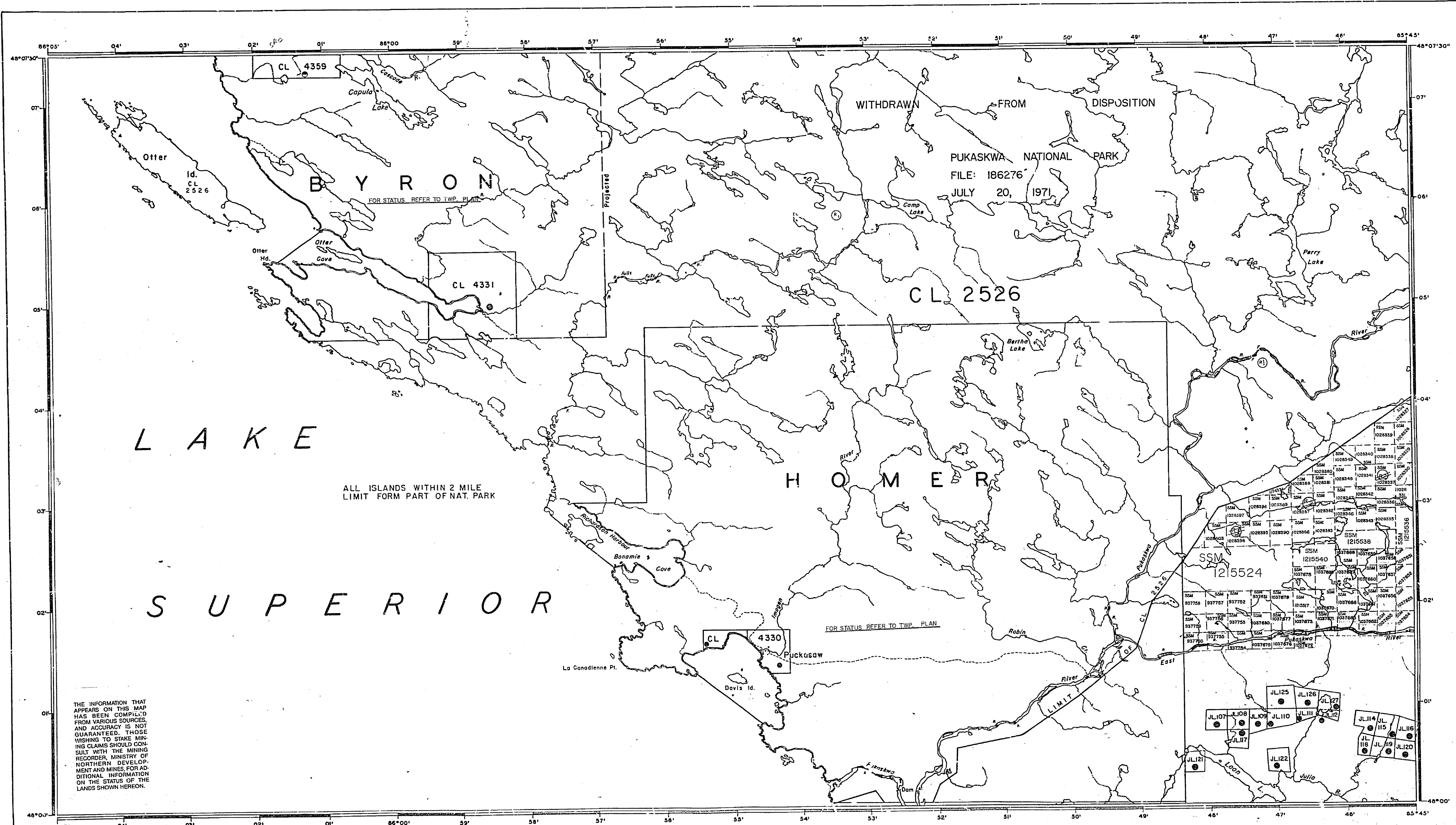

REFERENCES

AREAS WITHDRAWN FROM DISPOSITION
 M.R.O. - MINING RIGHTS ONLY
 S.R.O. - SURFACE RIGHTS ONLY
 M.S.S. - MINING AND SURFACE RIGHTS

The 1922 Magnetic Bearing
 Approx. 1.5 Gals. Annual Change
 Increasing 10.230

DATE OF ISSUE
 1997 JUL 20
 SAULT STE MARIE
 MINING RECORDER'S OFFICE

LEGEND

- HIGHWAY AND ROUTE NO. [Symbol]
- OTHER ROADS [Symbol]
- TRAILS [Symbol]
- SURVEYED LINES [Symbol]
- TOWNSHIPS, BASE LINES, ETC. [Symbol]
- LOTS, MINING CLAIMS, PARCELS, ETC. [Symbol]
- UNSURVEYED LINES [Symbol]
- LOT LINES [Symbol]
- PARCEL BOUNDARY [Symbol]
- MINING CLAIMS ETC. [Symbol]
- RAILWAY AND RIGHT OF WAY [Symbol]
- UTILITY LINES [Symbol]
- NON PERENNIAL STREAM [Symbol]
- FLOODING OR FLOODING RIGHTS [Symbol]
- SUBDIVISION OR COMPOSITE PLAN [Symbol]
- RESERVATIONS [Symbol]
- ORIGINAL SHORELINE [Symbol]
- MARSH OR MUSKEG [Symbol]
- MINES [Symbol]
- TRAVERSE MONUMENT [Symbol]

DISPOSITION OF CROWN LANDS

TYPE OF DOCUMENT	SYMBOL
PATENT, SURFACE & MINING RIGHTS	●
" SURFACE RIGHTS ONLY	○
" MINING RIGHTS ONLY	◐
LEASE, SURFACE & MINING RIGHTS	◑
" SURFACE RIGHTS ONLY	◒
" MINING RIGHTS ONLY	◓
LICENCE OF OCCUPATION	◔
ORDER-IN COUNCIL	OC
RESERVATION	○
CANCELLED	○
SAND & GRAVEL	○

NOTE: MINING RIGHTS IN PARCELS PATENTED PRIOR TO MAY 6, 1913, VESTED IN ORIGINAL PATENTEE BY THE PUBLIC LANDS ACT, R.S.O. 1970, CHAP. 380, SEC. 43, SUBSEC. 1

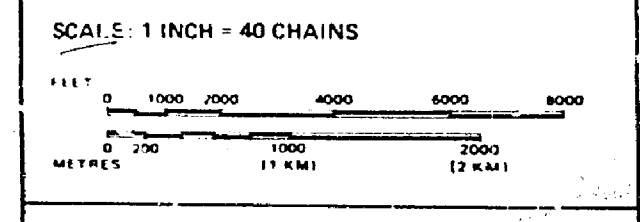

CAMP LAKE
 M.N.R. ADMINISTRATIVE DISTRICT
WAWA
 MINING DIVISION
 SAULT STE. MARIE
 LAND TITLES / REGISTRY DIVISION
 THUNDER BAY

Ministry of Natural Resources Ontario
 Ministry of Northern Development and Mines

Date: FEBRUARY, 1987
 Number: **G-3764**

THE INFORMATION THAT APPEARS ON THIS MAP HAS BEEN COMPILED FROM VARIOUS SOURCES AND ACCURACY IS NOT GUARANTEED. THOSE WISHING TO STAKE MINING CLAIMS SHOULD CONSULT WITH THE MINING RECORDER, MINISTRY OF NORTHERN DEVELOPMENT AND MINES, FOR ADDITIONAL INFORMATION ON THE STATUS OF THE LANDS SHOWN HEREON.

ALL ISLANDS WITHIN 2 MILE LIMIT FORM PART OF NAT. PARK

FOR STATUS REFER TO TWP. PLAN

48° 07' 30" N
 86° 05' W
 48° 07' 30" N
 86° 05' W
 48° 07' 30" N
 86° 05' W
 48° 07' 30" N
 86° 05' W

4375-0

CAMB LAKE

4375-0

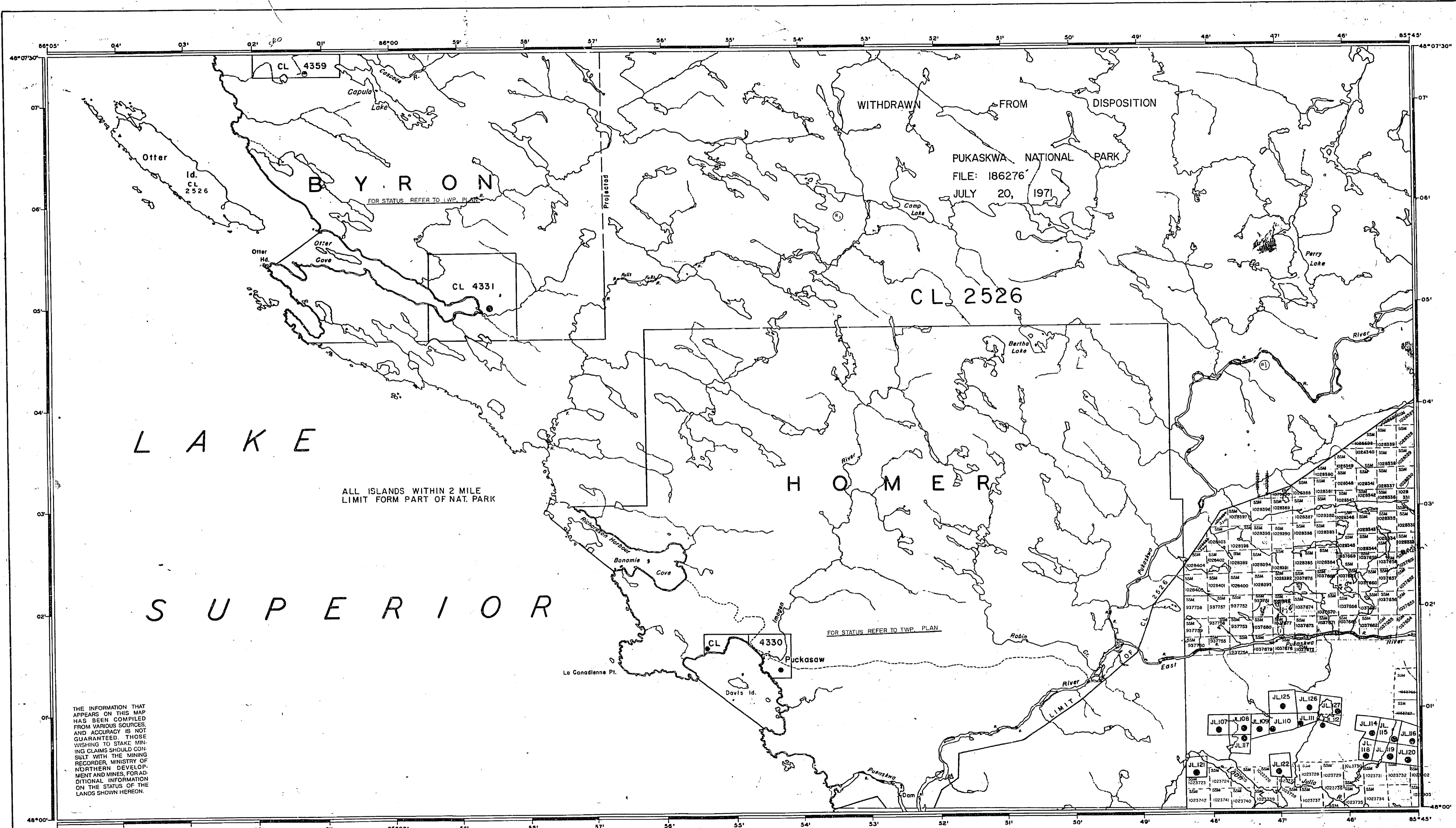

THE INFORMATION THAT APPEARS ON THIS MAP HAS BEEN COMPILED FROM VARIOUS SOURCES AND ACCURACY IS NOT GUARANTEED. THOSE WISHING TO STAKE MINING CLAIMS SHOULD CONSULT WITH THE MINING RECORDER, MINISTRY OF NORTHERN DEVELOPMENT AND MINES FOR ADDITIONAL INFORMATION ON THE STATUS OF THE LANDS SHOWN HEREON.

ALL ISLANDS WITHIN 2 MILE LIMIT FORM PART OF NAT. PARK

WITHDRAWN FROM DISPOSITION

PUKASKWA NATIONAL PARK
FILE: 186276
JULY 20, 1971

REFERENCES

AREAS WITHDRAWN FROM DISPOSITION
M.R.O. - MINING RIGHTS ONLY
S.R.O. - SURFACE RIGHTS ONLY
M.S. - MINING AND SURFACE RIGHTS

The 1925 Magnetic Bearing
Approx. 2.50% Annual Change
Decreasing 1970

DATE OF ISSUE
APR 14 1987
SAULT STE MARIE
MINING RECORDER'S OFFICE

LEGEND

- HIGHWAY AND ROUTE
- OTHER ROADS
- TRAILS
- SURVEYED LINES: TOWNSHIPS, BASE LINES, ETC.
- LOTS, MINING CLAIMS, PARCELS, ETC.
- UNSURVEYED LINES: LOT LINES, PARCEL BOUNDARY, MINING CLAIMS ETC.
- RAILWAY AND RIGHT OF WAY
- UTILITY LINES
- NON PERENNIAL STREAM
- FLOODING OR FLOODING RIGHTS
- SUBDIVISION OR COMPOSITE PLAN
- RESERVATIONS
- ORIGINAL SHORELINE
- MARSH OR MUSKEG
- MINES
- TRAVERSE MONUMENT

DISPOSITION OF CROWN LANDS

TYPE OF DOCUMENT	SYMBOL
PATENT, SURFACE & MINING RIGHTS	●
- SURFACE RIGHTS ONLY	○
- MINING RIGHTS ONLY	◐
LEASE, SURFACE & MINING RIGHTS	■
- SURFACE RIGHTS ONLY	◼
- MINING RIGHTS ONLY	◑
LICENCE OF OCCUPATION	▽
ORDER-IN-COUNCIL	OC
RESERVATION	○
CANCELLED	◊
SAND & GRAVEL	◊

NOTE: MINING RIGHTS IN PARCELS PATENTED PRIOR TO MAY 8, 1912, VESTED IN ORIGINAL PATENTEE BY THE PUBLIC LANDS ACT, R.S.O. 1970, CHAP. 380, SEC. 42, SUBSEC. 1.

SCALE: 1 INCH = 40 CHAINS

0 1000 2000 4000 8000
METRES (1 KM) (2 KM)

AREA
CAMP LAKE
M.N.R. ADMINISTRATIVE DISTRICT
WAWA
MINING DIVISION
SAULT STE. MARIE
LAND TITLES / REGISTRY DIVISION
THUNDER BAY

Ministry of Natural Resources Ontario
Ministry of Northern Development and Mines

Date: FEBRUARY, 1987
Number: **G-3764**

OFFICE MAP

AREA OF
CAMP LAKE
 DISTRICT OF
 THUNDER BAY
 SAULT STE. MARIE
 MINING DIVISION
 SCALE: 1-INCH = 40 CHAINS

LEGEND

PATENTED LAND	Ⓢ
CROWN LAND SALE	C.S.
LEASES	Ⓛ
LOCATED LAND	Loc.
LICENSE OF OCCUPATION	L.O.
MINING RIGHTS ONLY	M.R.O.
SURFACE RIGHTS ONLY	S.R.O.
ROADS	—
IMPROVED ROADS	—
KING'S HIGHWAYS	—
RAILWAYS	—
POWER LINES	—
MARSH OR MUSKEG	—
MINES	—

NOTES

400' Reserve to Dept. of Lands & Forests shown thus: —

This area lies within Pukaskwa Wilderness Area after for staking D.V.S. 28 Apr. 73 DNT. REGULATION 25/63

LAND UNDER LAKE SUPERIOR WITHDRAWN FROM STAKING O/C APR 30, 1912

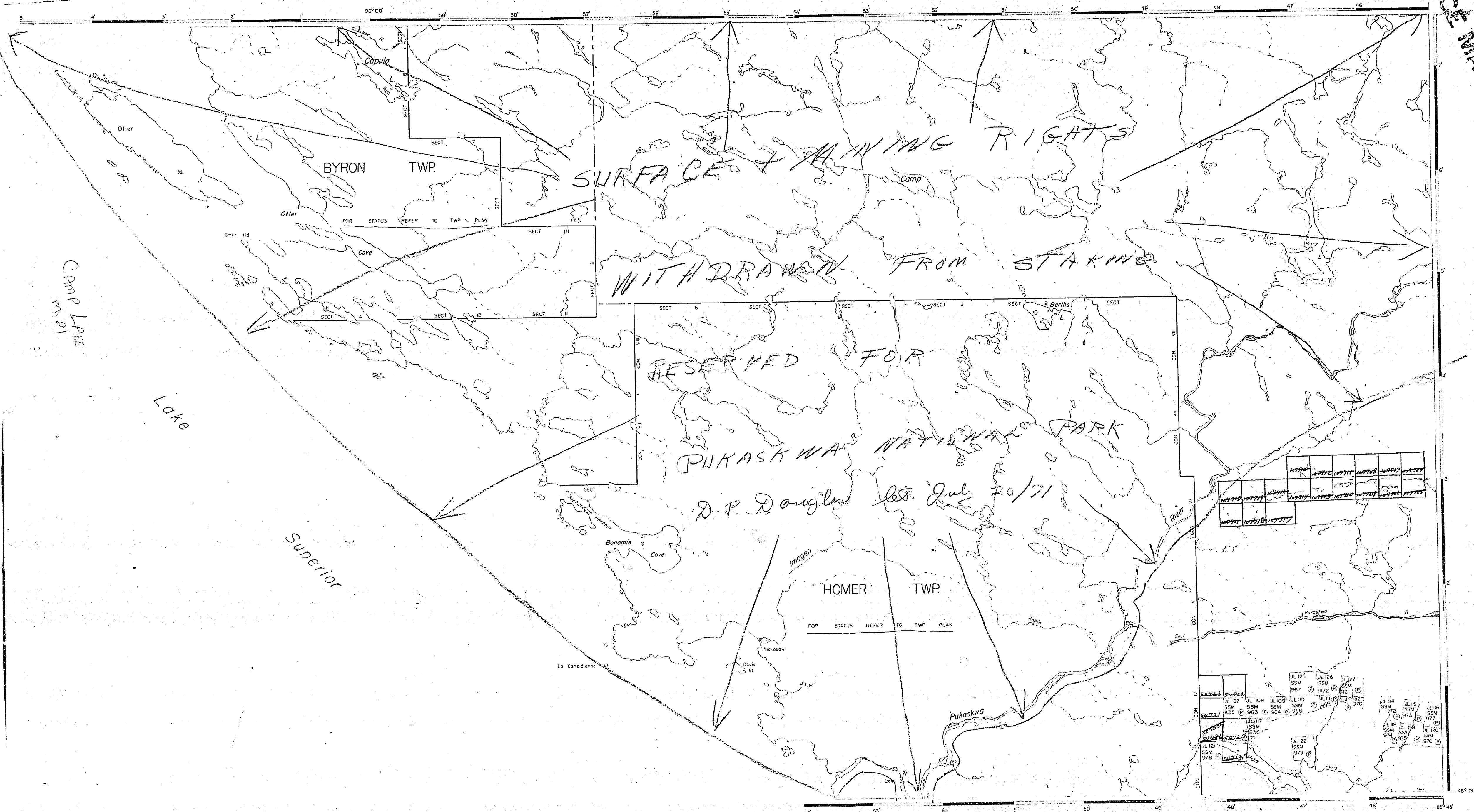

510 Camp Lake M. 21

M-21
 PLAN NO. SSM-15-A
 DEPARTMENT OF MINES
 —ONTARIO—

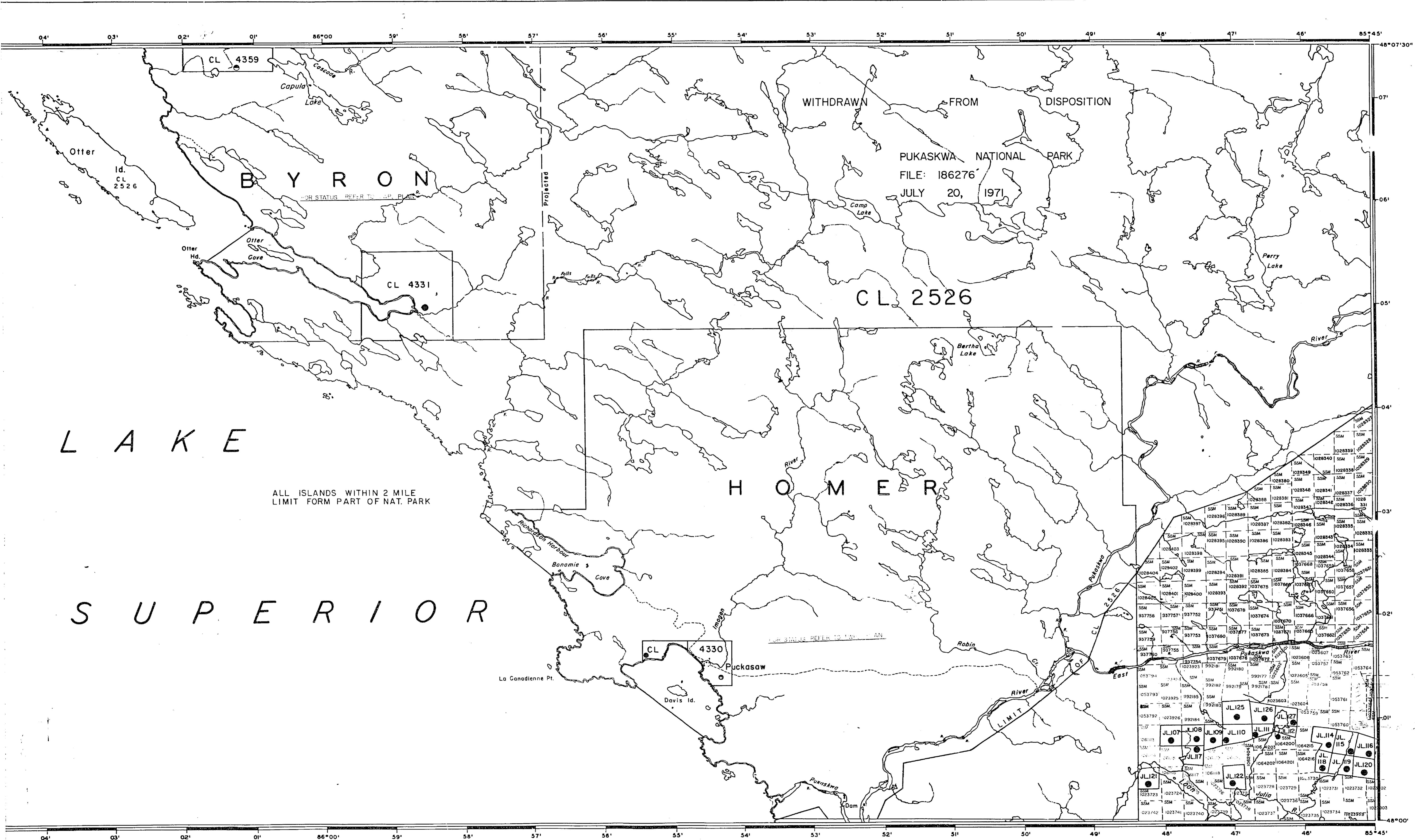

REFERENCES

AREAS WITHDRAWN FROM DISPOSITION
 M.R.O. - MINING RIGHTS ONLY
 S.R.O. - SURFACE RIGHTS ONLY
 M.S. - MINING AND SURFACE RIGHTS

Description	Order No.	Date	Disposition	File
DATE OF ISSUE				
JUL 14 1987				
SAULT STE MARIE MINING RECORDER'S OFFICE				

LEGEND

HIGHWAY AND ROUTE No	
OTHER ROADS	
TRAILS	
SURVEYED LINES	
TOWNSHIPS, BASE LINES, ETC.	
LOTS, MINING CLAIMS, PARCELS, ETC	
UNSURVEYED LINES	
LOT LINES	
PARCEL BOUNDARY	
MINING CLAIMS ETC	
RAILWAY AND RIGHT OF WAY	
UTILITY LINES	
NON PERENNIAL STREAM	
FLOODING OR FLOODING RIGHTS	
SUBDIVISION OR COMPOSITE PLAN	
RESERVATIONS	
ORIGINAL SHORELINE	
MARSH OR MUSKEG	
MINES	
TRAVERSE MONUMENT	

DISPOSITION OF CROWN LANDS

TYPE OF DOCUMENT	SYMBOL
PATENT, SURFACE & MINING RIGHTS	
" SURFACE RIGHTS ONLY	
" MINING RIGHTS ONLY	
LEASE, SURFACE & MINING RIGHTS	
" SURFACE RIGHTS ONLY	
" MINING RIGHTS ONLY	
LICENCE OF OCCUPATION	
ORDER-IN-COUNCIL	
RESERVATION	
CANCELLED	
SAND & GRAVEL	

NOTE: MINING RIGHTS IN PARCELS PATENTED PRIOR TO MAY 6, 1913, VESTED IN ORIGINAL PATENTEE BY THE PUBLIC LANDS ACT R.S.O. 1970, CHAP 380, SEC. 63, SUBSEC 1

SCALE: 1 INCH = 40 CHAINS

0 1000 2000 4000 6000 8000
 METRES 0 200 400 800 1200 1600 2000

AREA
CAMP LAKE
 M.N.R. ADMINISTRATIVE DISTRICT
 WAWA
 MINING DIVISION
 SAULT STE. MARIE
 LAND TITLES / REGISTRY DIVISION
 THUNDER BAY

Ministry of Natural Resources Ontario
 Ministry of Northern Development and Mines

Date: FEBRUARY, 1987
 Number: **G-3764**

2731

40458	40465	40466	40470
40469	40474	40477	40477
40470	40473	40468	40465
40467	40460	40469	40476

Campfire Lake

3

North Ast

M-2207

Scale - 40 Chains = 1 Inch

SOUTHARX LAKE AREA R.L.J.I

57M 56M 55M 54M 53M 52M 51 50M 49M 48M

Por.

Por.

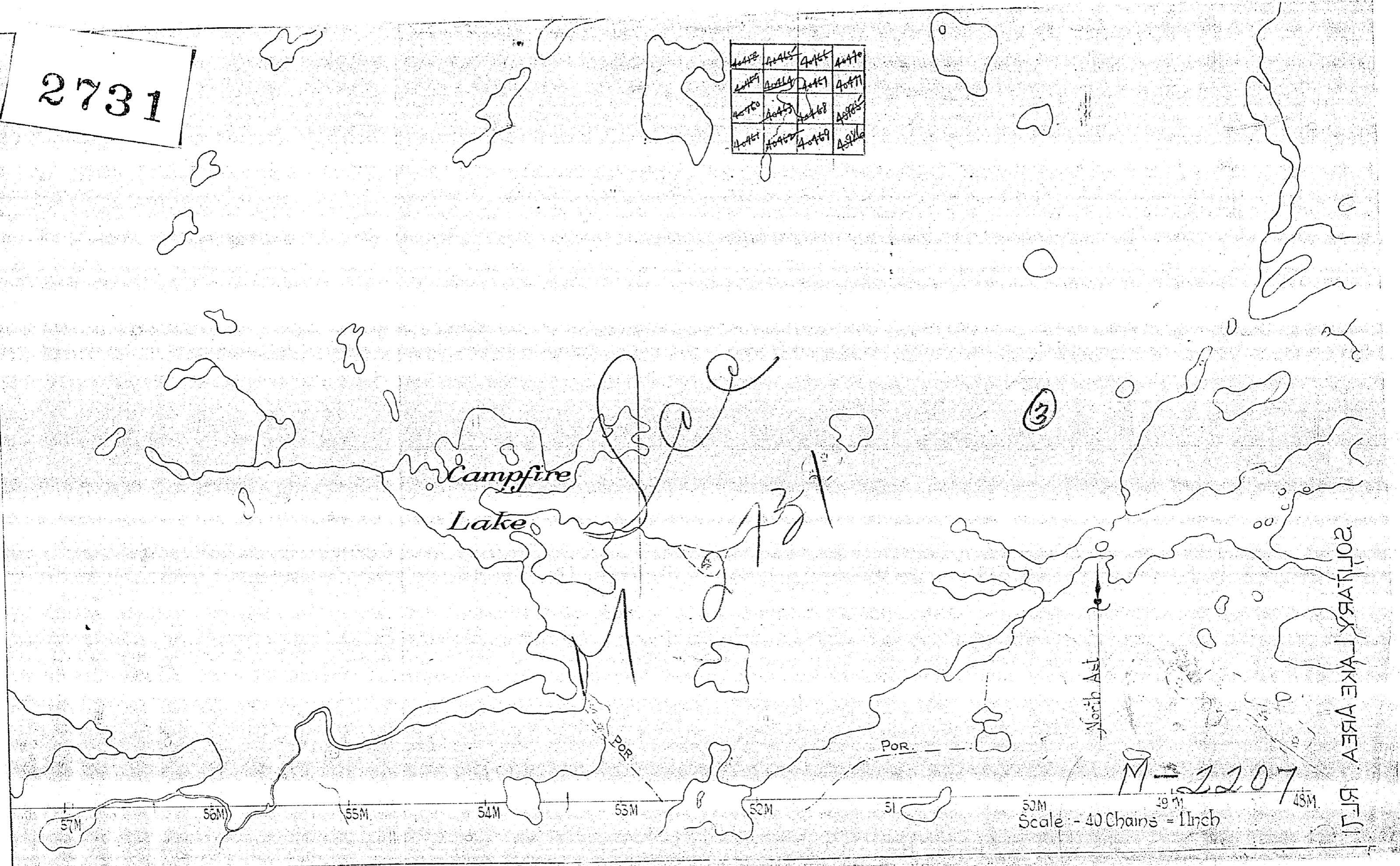

G-376

CAMP LAKE

G-376

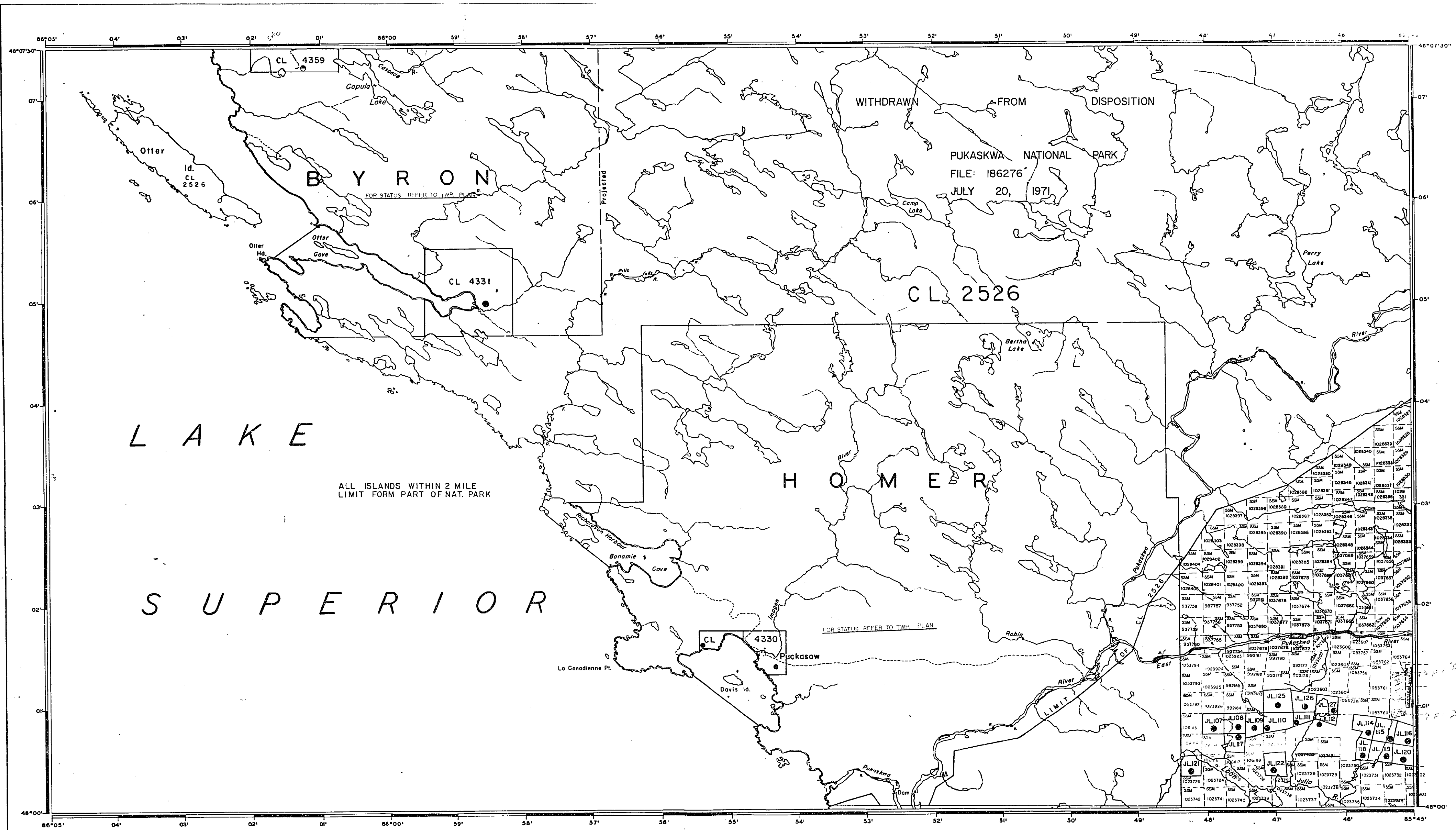

M.N.R. - MINING RIGHTS ONLY
 S.R.O. - SURFACE RIGHTS ONLY
 M.+S. - MINING AND SURFACE RIGHTS

Description	Order No.	Date	Disposition	File

DATE OF ISSUE
 1987
 SAULT STE MARIE
 MINING RECORDER'S OFFICE

LEGEND

- HIGHWAY AND ROUTE No.
- OTHER ROADS
- TRAILS
- SURVEYED LINES: TOWNSHIPS, BASE LINES, ETC; LOTS, MINING CLAIMS, PARCELS, ETC
- UNSURVEYED LINES: LOT LINES; PARCEL BOUNDARY; MINING CLAIMS ETC
- RAILWAY AND RIGHT OF WAY
- UTILITY LINES
- NON PERENNIAL STREAM
- FLOODING OR FLOODING RIGHTS
- SUBDIVISION OR COMPOSITE PLAN
- RESERVATIONS
- ORIGINAL SHORELINE
- MARSH OR MUSKEG
- MINES
- TRAVERSE MONUMENT

DISPOSITION OF CROWN LANDS

TYPE OF DOCUMENT	SYMBOL
PATENT, SURFACE & MINING RIGHTS	○
SURFACE RIGHTS ONLY	○
MINING RIGHTS ONLY	○
LEASE, SURFACE & MINING RIGHTS	□
SURFACE RIGHTS ONLY	□
MINING RIGHTS ONLY	□
LICENCE OF OCCUPATION	△
ORDER-IN-COUNCIL	○
RESERVATION	○
CANCELLED	○
SAND & GRAVEL	○

NOTE: MINING RIGHTS IN PARCELS PATENTED PRIOR TO MAY 4, 1913, VESTED IN ORIGINAL PATENTEE BY THE PUBLIC LANDS ACT, R.S.O. 1970, CHAP. 380, SEC. 63, SUBSEC. 1

SCALE: 1 INCH = 40 CHAINS

0 1000 2000 4000 6000 8000
 METRES

0 200 1000 2000
 METRES

AREA
CAMP LAKE
 M.N.R. ADMINISTRATIVE DISTRICT
WAWA
 MINING DIVISION
SAULT STE. MARIE
 LAND TITLES / REGISTRY DIVISION
THUNDER BAY

Ministry of Natural Resources
 Ministry of Northern Development and Mines

Date: FEBRUARY, 1987
 Number: G-3764

AREA OF

CAMP LAKE

DISTRICT OF THUNDER BAY

SAULT STE. MARIE MINING DIVISION

SCALE: 1-INCH = 40 CHAINS

LEGEND

- PATENTED LAND (P)
- CROWN LAND SALE C.S.
- LEASES (L)
- LOCATED LAND Loc
- LICENSE OF OCCUPATION L.O.
- MINING RIGHTS ONLY M.R.O.
- SURFACE RIGHTS ONLY S.R.O.
- ROADS [Symbol]
- IMPROVED ROADS [Symbol]
- KING'S HIGHWAYS [Symbol]
- RAILWAYS [Symbol]
- POWER LINES [Symbol]
- MARSH OR MUSKEG [Symbol]
- MINES [Symbol]

NOTES

- 400' Surface Rights Reservation around all lakes & rivers.
- Land under Lake Superior withdrawn from staking by Order in Council dated April 30, 1912.

DATE OF ISSUE

SEP 21 1992

Ministry of Natural Resources
TORONTO

G. 3764

NAWA DISTRICT
REGIONAL TOPOGRAPHIC SERIES
42DT 8 42C4

PLAN NO. M-21

ONTARIO
MINISTRY OF NATURAL RESOURCES
SURVEYS AND MAPPING BRANCH

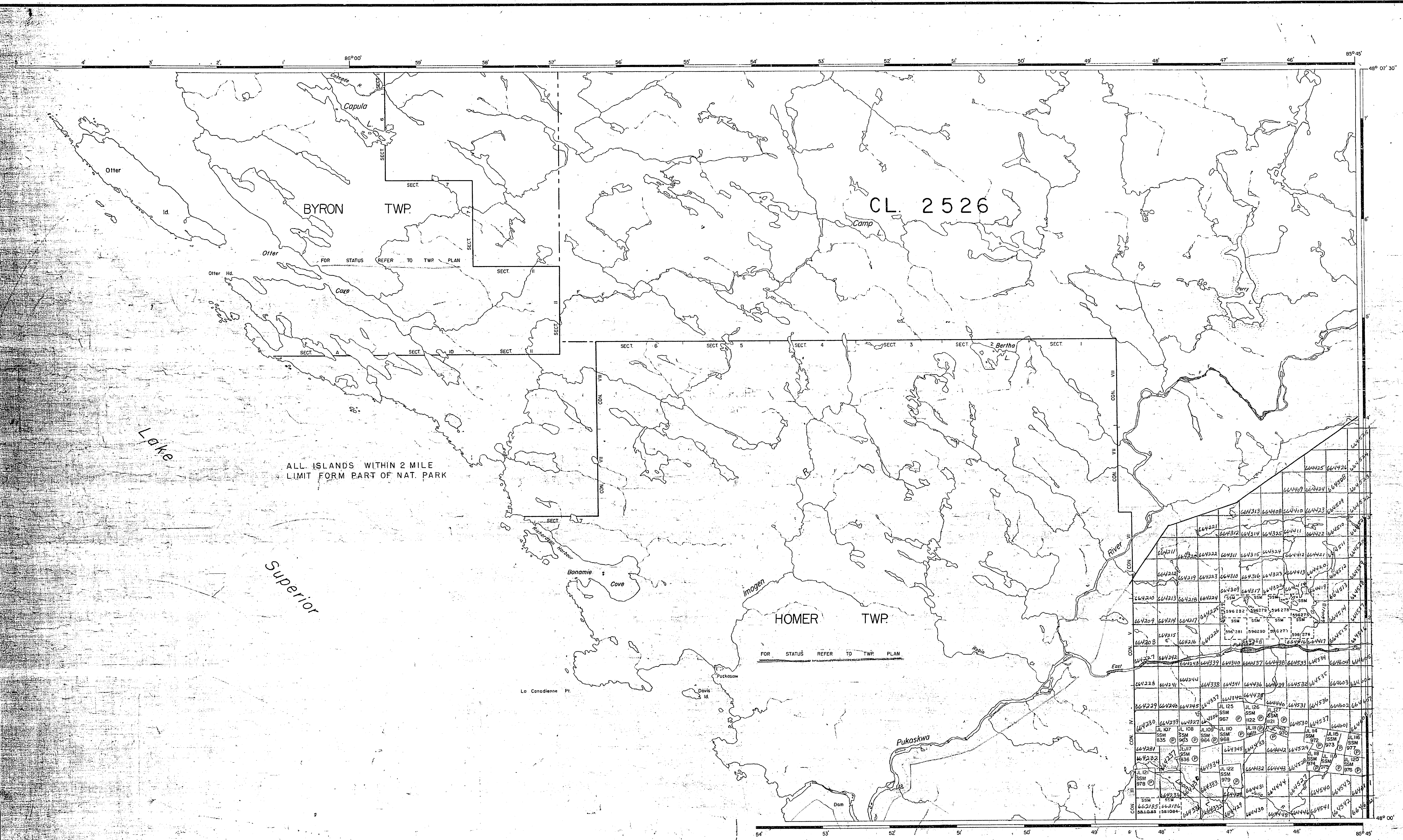

AREA OF

CAMP LAKE

DISTRICT OF
THUNDER BAY &
SAULT STE MARIE
MINING DIVISION

SCALE: 1-INCH = 40 CHAINS

LEGEND

- | | |
|-----------------------|----------|
| PATENTED LAND | Ⓞ |
| CROWN LAND SALE | C.S. |
| LEASES | Ⓛ |
| LOCATED LAND | Loc |
| LICENSE OF OCCUPATION | L.O. |
| MINING RIGHTS ONLY | M.R.O. |
| SURFACE RIGHTS ONLY | S.S.R.O. |
| ROADS | — |
| IMPROVED ROADS | — |
| KING'S HIGHWAYS | — |
| RAILWAYS | — |
| POWER LINES | — |
| MARSH OR MUSKEG | — |
| MINES | — |

NOTES

400' Surface Rights Reservation around all lakes & rivers.

Land under Lake Superior withdrawn from staking by Order in Council dated April 30, 1912

G.3764

ONTARIO DISTRICT
NATIONAL TOPOGRAPHIC SERIES June 1980
42D1 & 42C4

PLAN NO. 11-21

ONTARIO
MINISTRY OF NATURAL RESOURCES
SURVEY AND MAPPING BRANCH

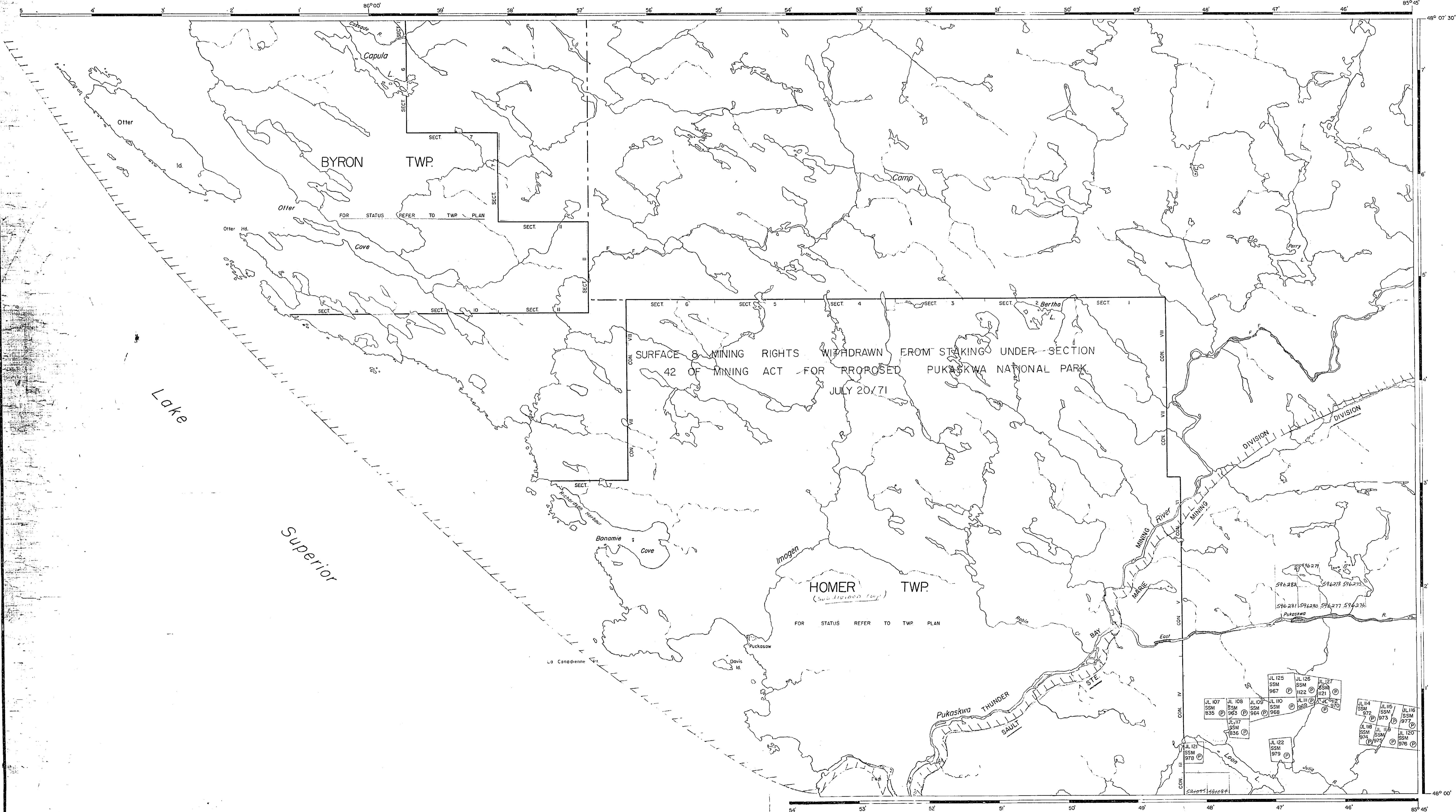

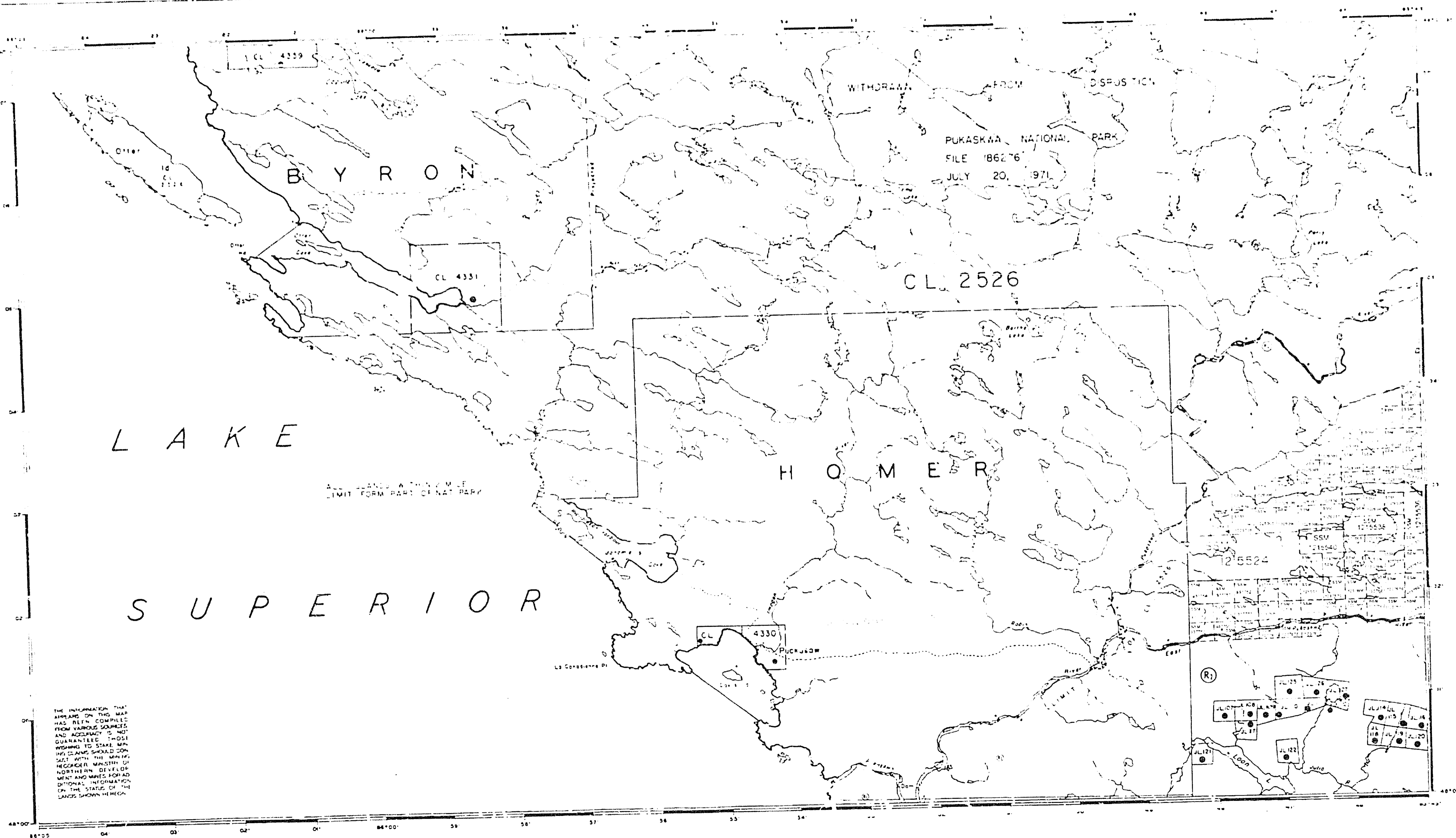

THE INFORMATION THAT APPEARS ON THIS MAP HAS BEEN COMPILED FROM VARIOUS SOURCES AND ACCURACY IS NOT GUARANTEED. THOSE WHO WISH TO STAKE MINING CLAIMS SHOULD CONSULT WITH THE MINING RECORDER, MINISTRY OF NORTHERN DEVELOPMENT AND MINES FOR ADDITIONAL INFORMATION ON THE STATUS OF THE LANDS SHOWN HEREON.

ALL ISLANDS WITHIN 1 MILE LIMIT FORM PART OF NAT. PARK

WITHDRAWN FROM DISPOSITION

PUKASKWA NATIONAL PARK
FILE 186276
JULY 20, 1971

REFERENCES

- AREA, MINISTRY OF NAT. DEVELOPMENT AND MINES
- MAP OF THE CAMP LAKE AREA
- FILE 186276
- FILE 186276
- FILE 186276
- FILE 186276

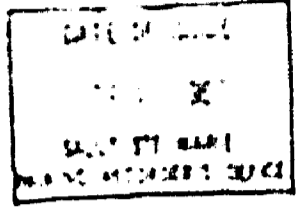

LEGEND

- ROADWAY AND ROUTE NO. OF HIGHWAYS
- OTHER ROADS
- TRAIL
- UNIMPROVED LINES
- TERMINUS, BASE LINES, ETC.
- LOTS, MINING CLAIMS, PARCELS, ETC.
- UNDEVELOPED LINES
- LOT LINES
- PARCEL BOUNDARY
- MINING CLAIMS, ETC.
- RAILWAY AND RIGHT OF WAY
- UTILITY LINES
- NON-PERMANENT STREAM
- FLOODING OR FLOODING RIGHTS
- SUBDIVISION OR CONVEYANCE PLAN
- RESERVATIONS
- ORIGINAL SHOOTING
- MARCH OR MUSEUM
- MINES
- TRAVERSE MONUMENT

DISPOSITION OF CROWN LANDS

TYPE OF DOCUMENT	SYMBOL
PATENT SURFACE & MINING RIGHTS	●
SURFACE RIGHTS ONLY	○
MINING RIGHTS ONLY	◐
LEASE SURFACE & MINING RIGHTS	◑
SURFACE RIGHTS ONLY	◒
MINING RIGHTS ONLY	◓
LICENSE OF OCCUPATION	◔
ORDER IN COUNCIL	◕
RESERVATION	◖
CANCELLED	◗
SAND & GRAVEL	◘

NOTE: MINING RIGHTS IN PARCELS WITHIN THE CAMP LAKE AREA ARE NOT VALID UNLESS THEY ARE REGISTERED WITHIN THE CAMP LAKE AREA.

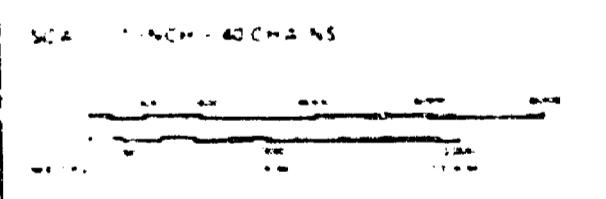

AREA
CAMP LAKE
MNR ADMINISTRATIVE DISTRICT
WAWA
MINING DIVISION
SAULT STE. MARIE
LAND TITLES / REGISTRY DIVISION
THUNDER BAY

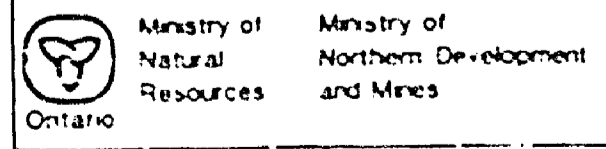

OFFICE MAP

AREA OF
CAMP LAKE

DISTRICT OF
THUNDER BAY

SAULT STE MARIE
MINING DIVISION

SCALE: 1-INCH = 40 CHAINS

LEGEND

- PATENTED LAND Ⓢ
- CROWN LAND SALE C.S.
- LEASES Ⓛ
- LOCATED LAND L.C.
- LICENSE OF OCCUPATION L.O.
- MINING RIGHTS ONLY M.R.O.
- SURFACE RIGHTS ONLY S.R.O.
- ROADS —
- IMPROVED ROADS —
- KING'S HIGHWAYS —
- RAILWAYS —
- POWER LINES —
- MARSH OR MUSKEG —
- MINES *

NOTES

400' Reserve to Dept of Lands & Forests shown thus:
This area lies within Pukaskwa Wilderness Area open for staking only, see Reg. 25/63 ONT. REGULATION 25/63

LAND UNDER LAKE SUPERIOR WITHDRAWN FROM STAKING o/c APR 30, 1912

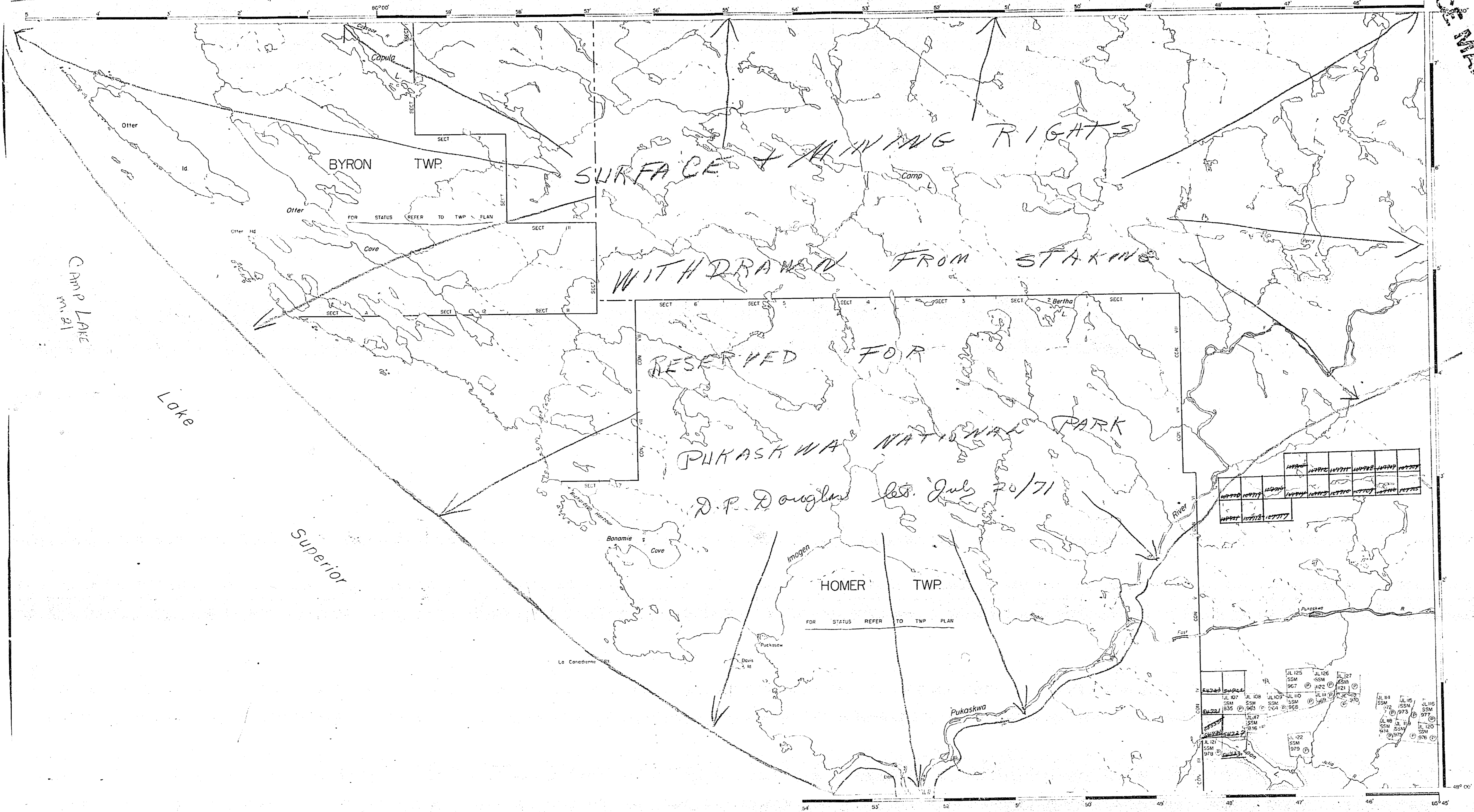

CAMP LAKE M.21

Lake

Superior

510 Camp Lake M.21

M-21

PLAN NO.—SSM—15—A.

DEPARTMENT OF MINES
—ONTARIO—

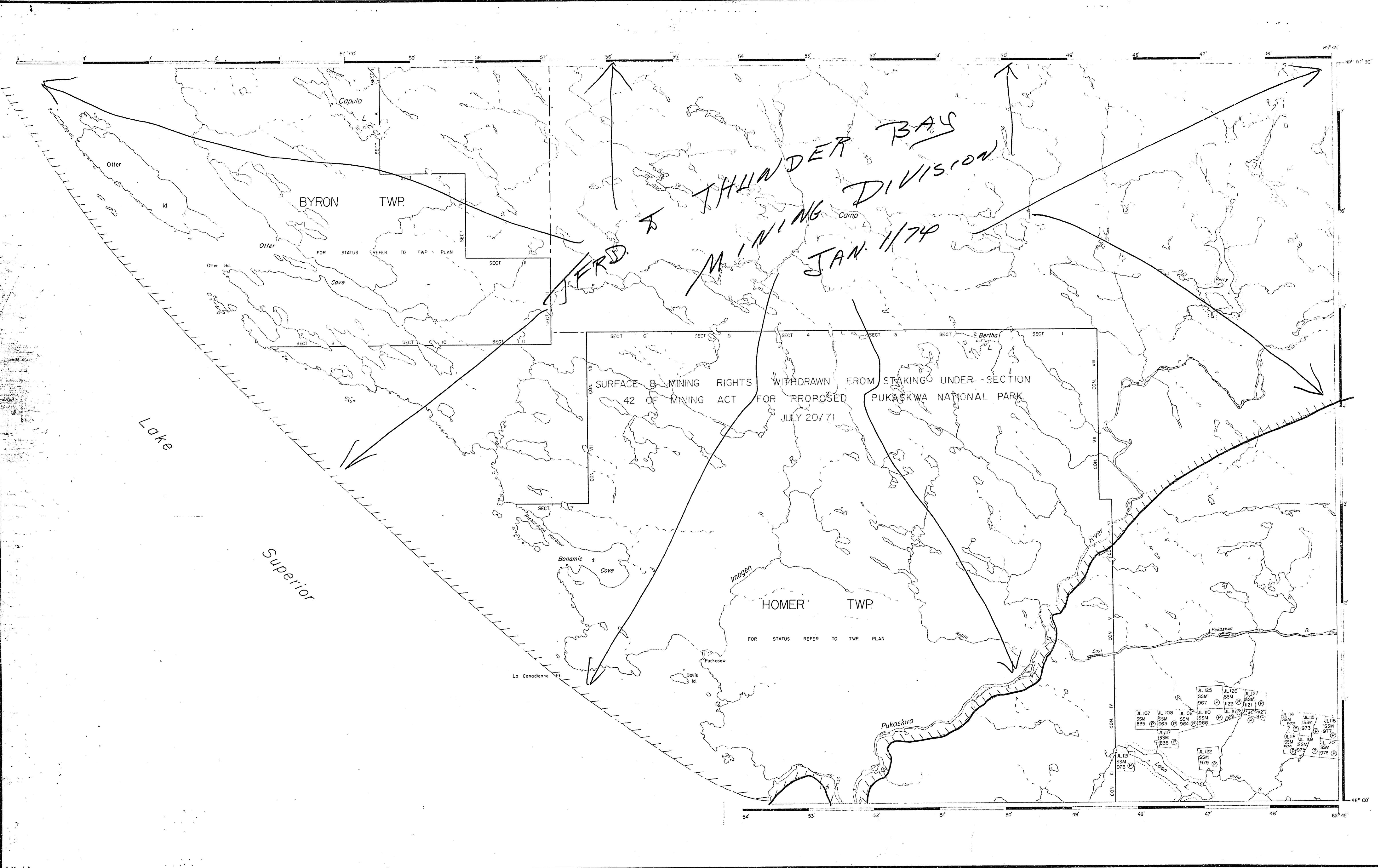

AREA OF
CAMP LAKE

DISTRICT OF THUNDER BAY
SAULT STE MARIE MINING DIVISION
SCALE: 1-INCH = 40 CHAINS

LEGEND

PATENTED LAND	⊙
CROWN LAND SALE	C.S.
LEASES	⊖
LOCATED LAND	Loc
LICENSE OF OCCUPATION	L.O.
MINING RIGHTS ONLY	M.R.O.
SURFACE RIGHTS ONLY	S.R.O.
ROADS	—
IMPROVED ROADS	—
KING'S HIGHWAYS	—
RAILWAYS	—
POWER LINES	—
MARSH OR MUSKEG	—
MINES	⋈

NOTES

400' Surface Rights Reservation around all lakes & rivers.

Land under Lake Superior withdrawn from staking by Order in Council dated April 30, 1912.

DATE OF ISSUE
OCT 11 1973

SAULT STE MARIE MINING RECORDERS OFFICE
G.3764

NATIONAL TOPOGRAPHIC SERIES
42DI & 42C4

PLAN NO. **121**

ONTARIO
MINISTRY OF NATURAL RESOURCES
SURVEYS AND MAPPING BRANCH