

OFFICE USE ONLY

THE TOWNSHIP OF CAMERON DISTRICT OF NIPISSING SUDBURY & EASTERN ONTARIO MINING DIVISION SCALE: 1 INCH=40 CHAINS

Province Of Quebec

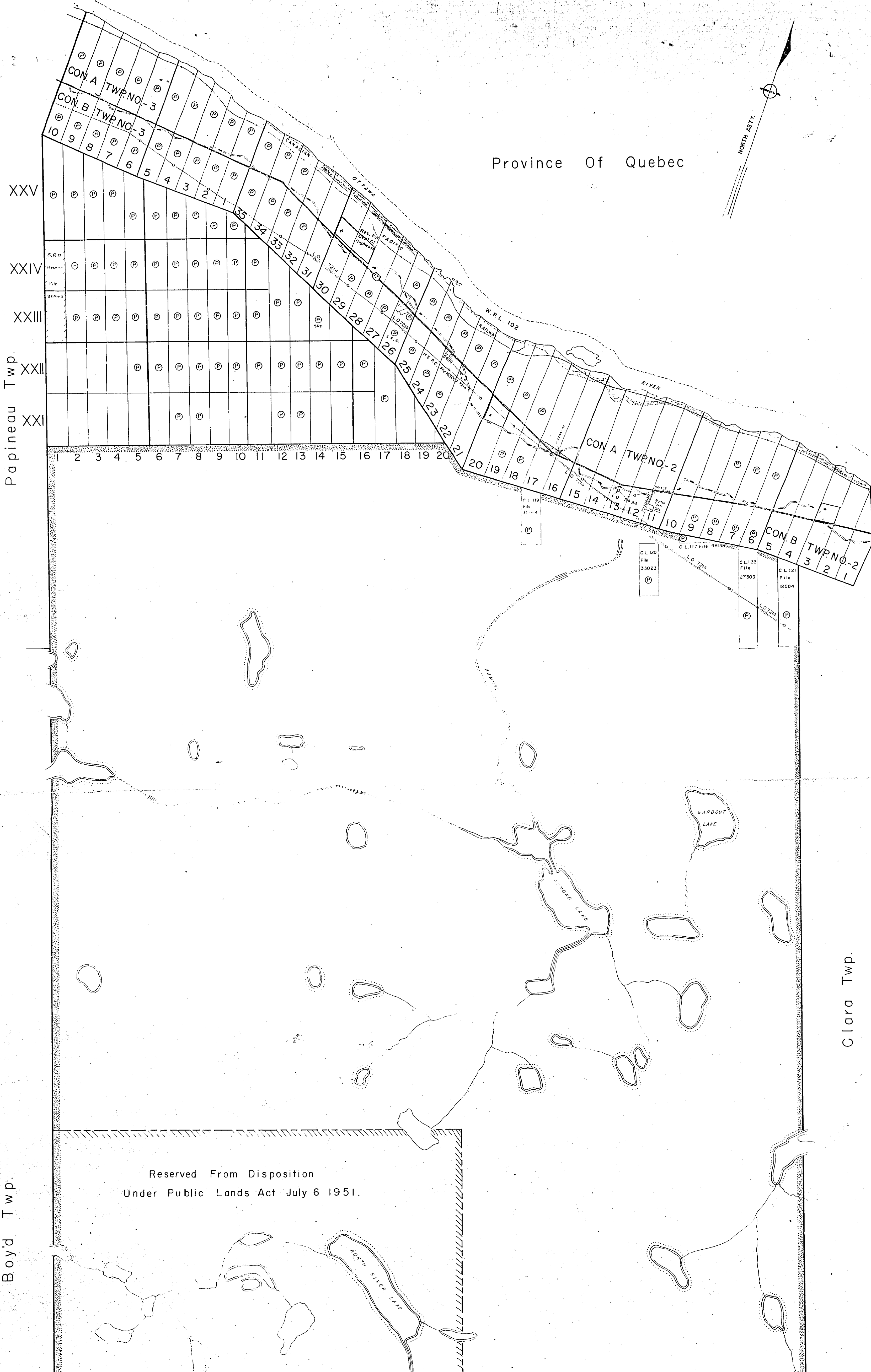
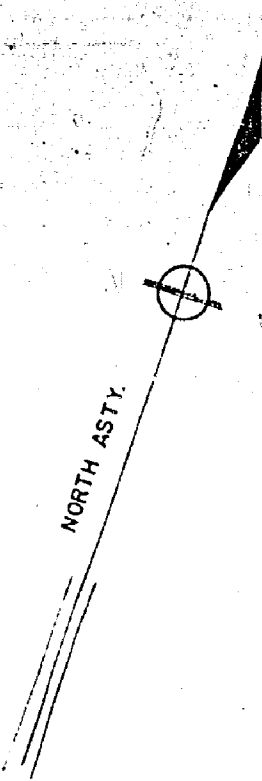

LEGEND

- PATENTED LAND C.S.
- CROWN LAND SALE C.S.
- LEASES Loc.
- LOCATED LAND Loc.
- LICENSE OF OCCUPATION L.O.
- MINING RIGHTS ONLY M.R.O.
- SURFACE RIGHTS ONLY S.R.O.
- ROADS
- IMPROVED ROADS
- KINGS HIGHWAYS
- RAILWAYS
- POWER LINES
- MARSH OR MUSKEG
- MINES

NOTES

THIS MAP IS NOT TO BE USED FOR SURVEY PURPOSES.

400' Surface Rights Reservation around all lakes and rivers.

SUBDIVISION ANNULLED IN PORTION SHOWN THUS: [Symbol]

509-512 Contour Shown Thus: [Symbol]

Water Power Lease No. 102. All The Unalienated Part Of The Bed Of The Ottawa River (Ontario Side) Including Unalienated Islands Therein. File: 53660.

* See Land Roll File - M.T.C. Gravel Reserve 1982-0125-46

CAMERON



Clara Twp.

Boyd Twp.

Reserved From Disposition Under Public Lands Act July 6 1951.