

INDEX TO LAND DISPOSITION

PLAN
G-4026
 TOWNSHIP

M.N.R. ADMINISTRATIVE DISTRICT
SUDBURY
 MINING DIVISION
SUDBURY
 LAND TITLES/REGISTRY DIVISION
SUDBURY

CLELAND

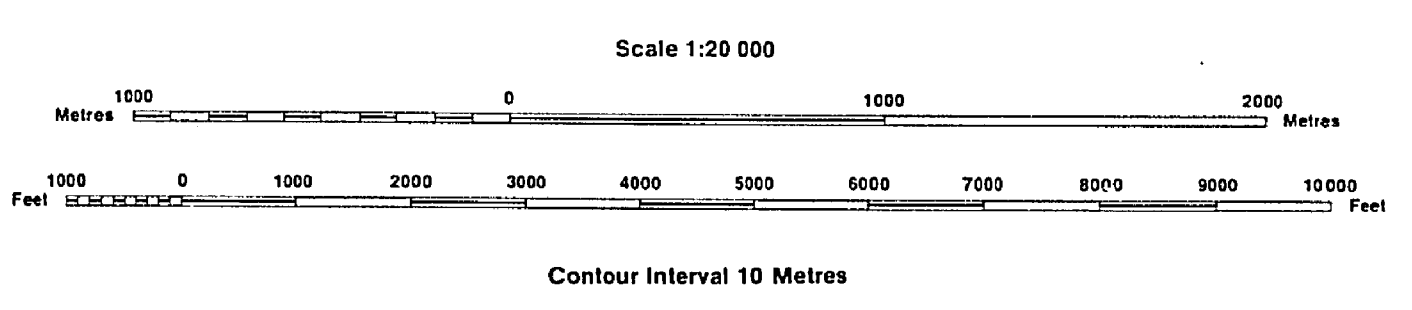

AREAS WITHDRAWN FROM DISPOSITION

MRO - Mining Rights Only
 SRO - Surface Rights Only
 M+S - Mining and Surface Rights

SYMBOLS

- Boundary
- Township, Meridian, Baseline
- Road allowance; surveyed
- shoreline
- Lot/Concession; surveyed
- unsurveyed
- Parcel; surveyed
- unsurveyed
- Right-of-way; road
- railway
- utility
- Reservation
- Cliff, Pit, Pile
- Contour
- Interpolated
- Approximate
- Depression
- Control point (horizontal)
- Flooded land
- Mine head frame
- Pipeline (above ground)
- Railway; single track
- double track
- abandoned
- Road; highway, county, township
- access
- trail, bush
- Shoreline (original)
- Transmission line
- Wooded area

Description	Order No.	Date	Disposition	File
 PUBLIC ACCESS		Mar./82	S.R.O.	

DISPOSITION OF CROWN LANDS

- Patent
- Surface & Mining Rights
- Surface Rights Only
- Mining Rights Only
- Lease
- Surface & Mining Rights
- Surface Rights Only
- Mining Rights Only
- Licence of Occupation
- Order-in-Council
- Cancelled
- Reservation
- Sand & Gravel

THE INFORMATION THAT APPEARS ON THIS MAP HAS BEEN COMPILED FROM VARIOUS SOURCES, AND ACCURACY IS NOT GUARANTEED. THOSE WISHING TO STAKE MINING CLAIMS SHOULD CONSULT WITH THE MINING RECORDER, MINISTRY OF NORTHERN DEVELOPMENT AND MINES, FOR ADDITIONAL INFORMATION ON THE STATUS OF THE LANDS SHOWN HEREON.

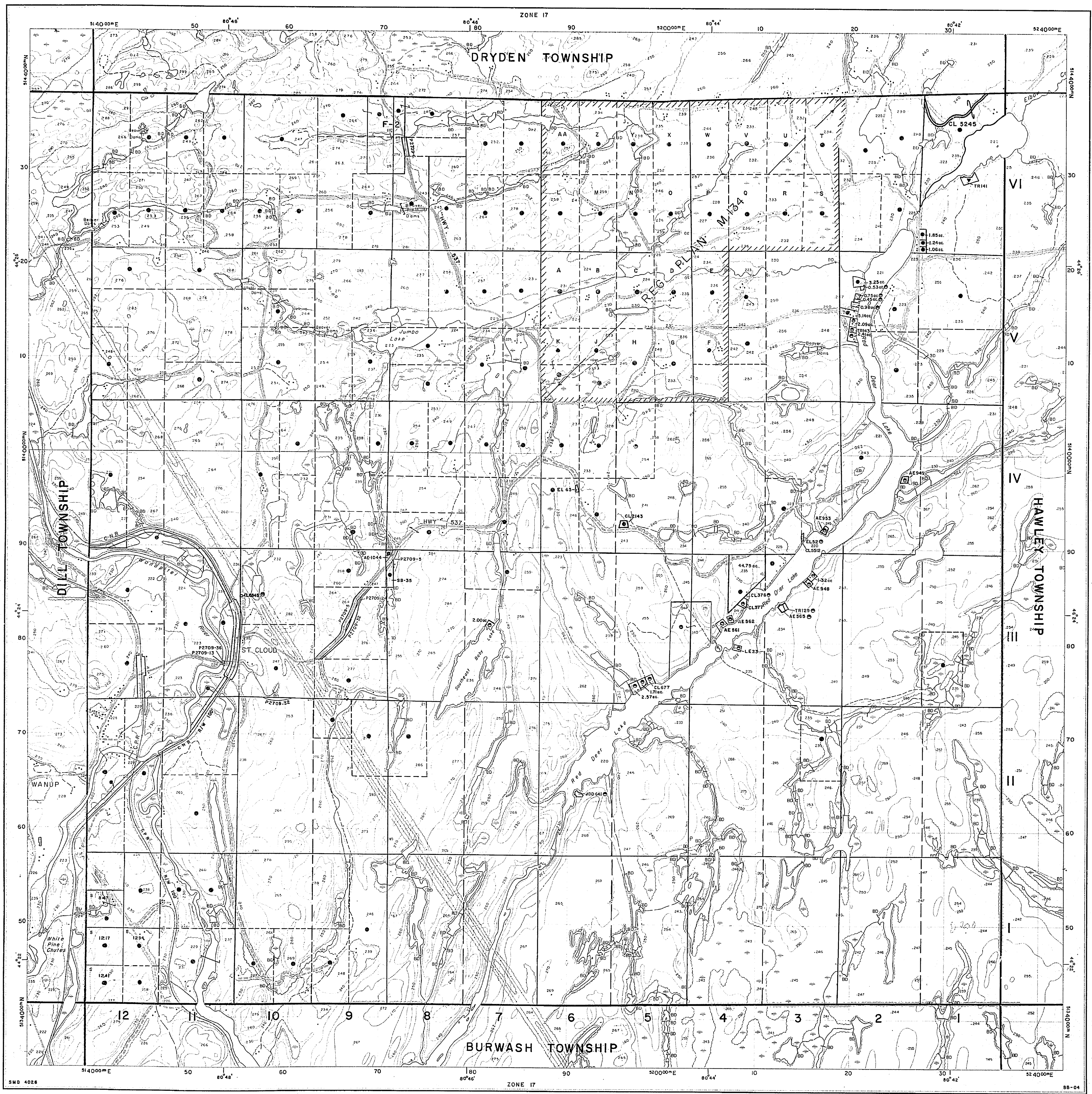

Map base and land disposition drafting by Surveys and Mapping Branch, Ministry of Natural Resources.

The disposition of land, location of lot fabric and parcel boundaries on this index was compiled for administrative purposes only.

THE TOWNSHIP OF
OF
CLELAND
DISTRICT of SUDBURY
SUDBURY MINING
DIVISION

SCALE 1 INCH TO 40 CHAINS

LEGEND

- PATENTED LANDS Ⓟ
- CROWN LAND SALES Ⓢ
- LICENSE OF OCCUPATION L.O.
- LOCATED LANDS Loc.
- IMPROVED ROADS —
- POWER TRANSMISSION LINE —
- RAILWAYS —
- SUBDIVISION ▨

NOTES

WITHDRAWN FROM STAKING SHOWN THUS:

400' Rsvd. to Dept. of L. & F.
shown thus:

M722

DEPARTMENT of MINES
ONTARIO

DRYDEN TWP.

old trap file

VI
V
IV
III
II
I

HAWLEY TWP.

BURWASH TWP.

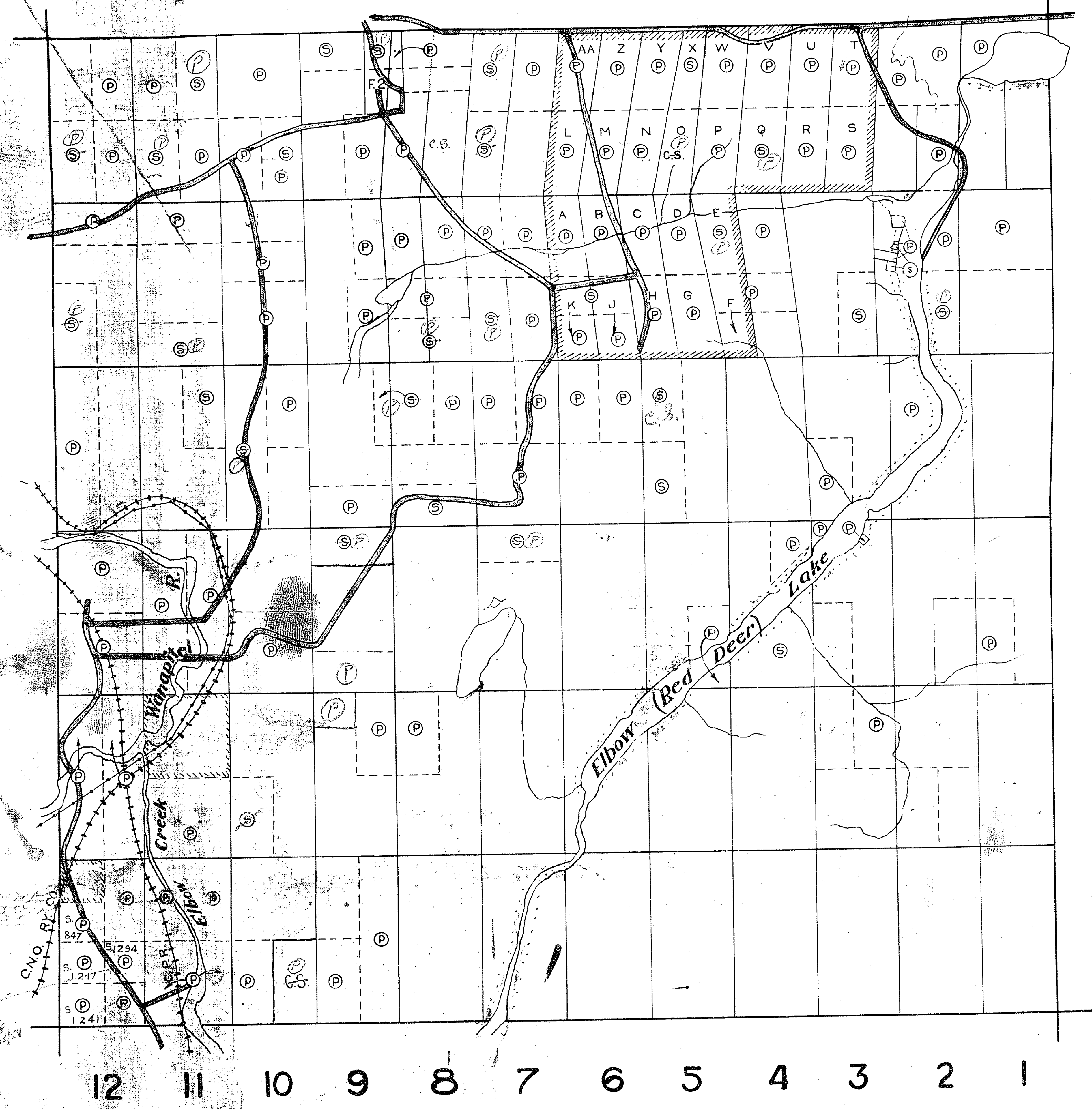

THE TOWNSHIP
OF
CLELAND
DISTRICT of SUDBURY
SUDBURY MINING
DIVISION

SCALE 1 INCH TO 40 CHAINS

LEGEND

PATENTED LANDS	Ⓟ
CROWN LAND SALES	Ⓢ
LICENSE OF OCCUPATION	L.O.
LOCATED LANDS	Loc.
IMPROVED ROADS	—
POWER TRANSMISSION LINE	—
RAILWAYS	—
SUBDIVISION	—

NOTES

WITHDRAWN FROM STRAITS SHOWING THIS:

400' RES. to DEPT. of L. & F.
shows this

N. 1/2 Lot 11 Con 2 &
N.W. 1/4 N. 1/2 Lot 12 Con 2
not open for siting
J. F. M. letter mar. 19/53

M 722

DEPARTMENT of MINES
ONTARIO

DRYDEN TWP.

Traps file

400' res.

Old



DILL TWP.

VI

V

IV

III

II

I

HAWLEY TWP.

12 11 10 9 8 7 6 5 4 3 2 1

BURWASH TWP.

12 10 8 6 4 2 2 4 6 8 10 12

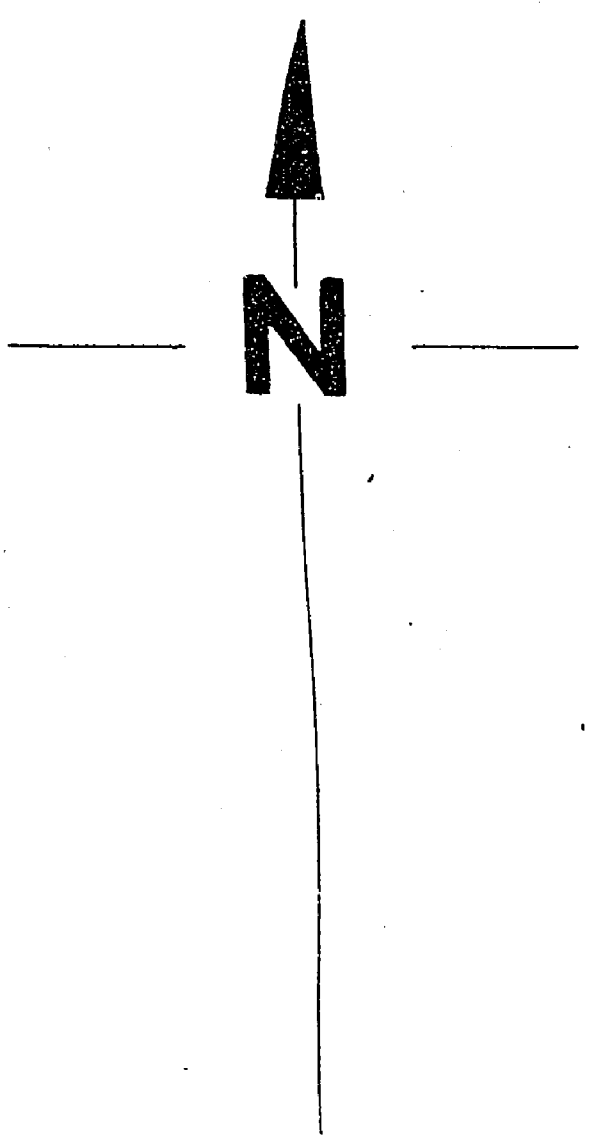

DRYDEN TWP.

*No h.p.
Temp file*

THE TOWNSHIP OF
OF
CLELAND
DISTRICT of SUDBURY
SUDBURY MINING
DIVISION
SCALE 1 INCH TO 40 CHAINS

DILL TWP.

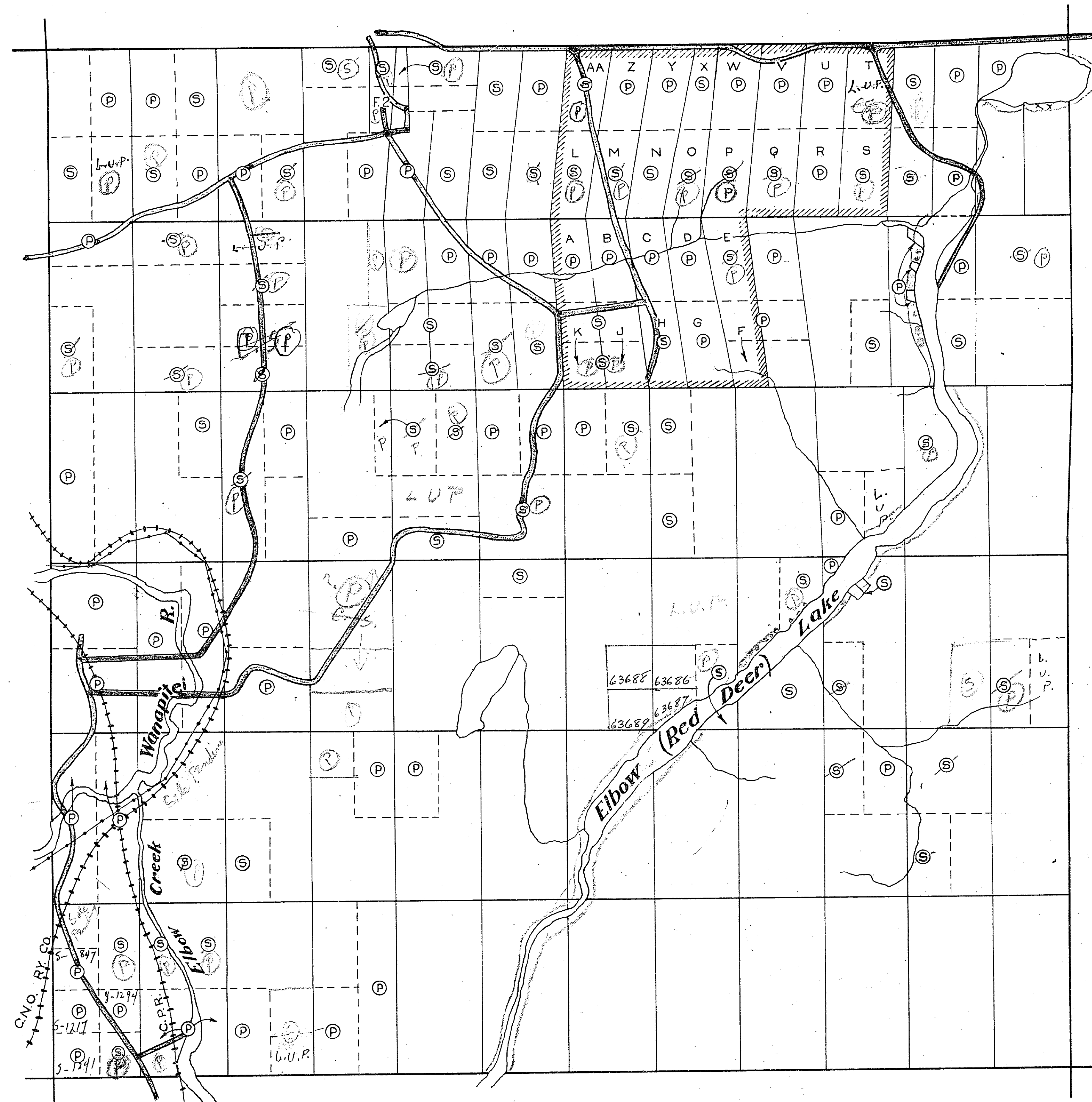

VI
V
IV
III
II
I

HAWLEY TWP.

LEGEND

PATENTED LANDS	(P)
CROWN LAND SALES	(S)
LICENSE OF OCCUPATION	L.O.
LOCATED LANDS	Loc.
IMPROVED ROADS	— — — —
POWER TRANSMISSION LINE	— — — —
RAILWAYS	— — — —
SUBDIVISION	▨

NOTES

*3075
5472*

*N. 1/2 Sec 11 Cont. 2. 4
N. 1/2, N. 1/2 Sec 12 Cont. 2
NOT OPEN for staking
J.P.M. Ltd. Cont. 1/10*

400' Res.

12 11 10 9 8 7 6 5 4 3 2 1

BURWASH TWP.

M722

DEPARTMENT of MINES
ONTARIO

CLELAND

SCALE 40 chains to an inch

Handwritten notes:
D. Results in part of lot 2 Con S
Reserved

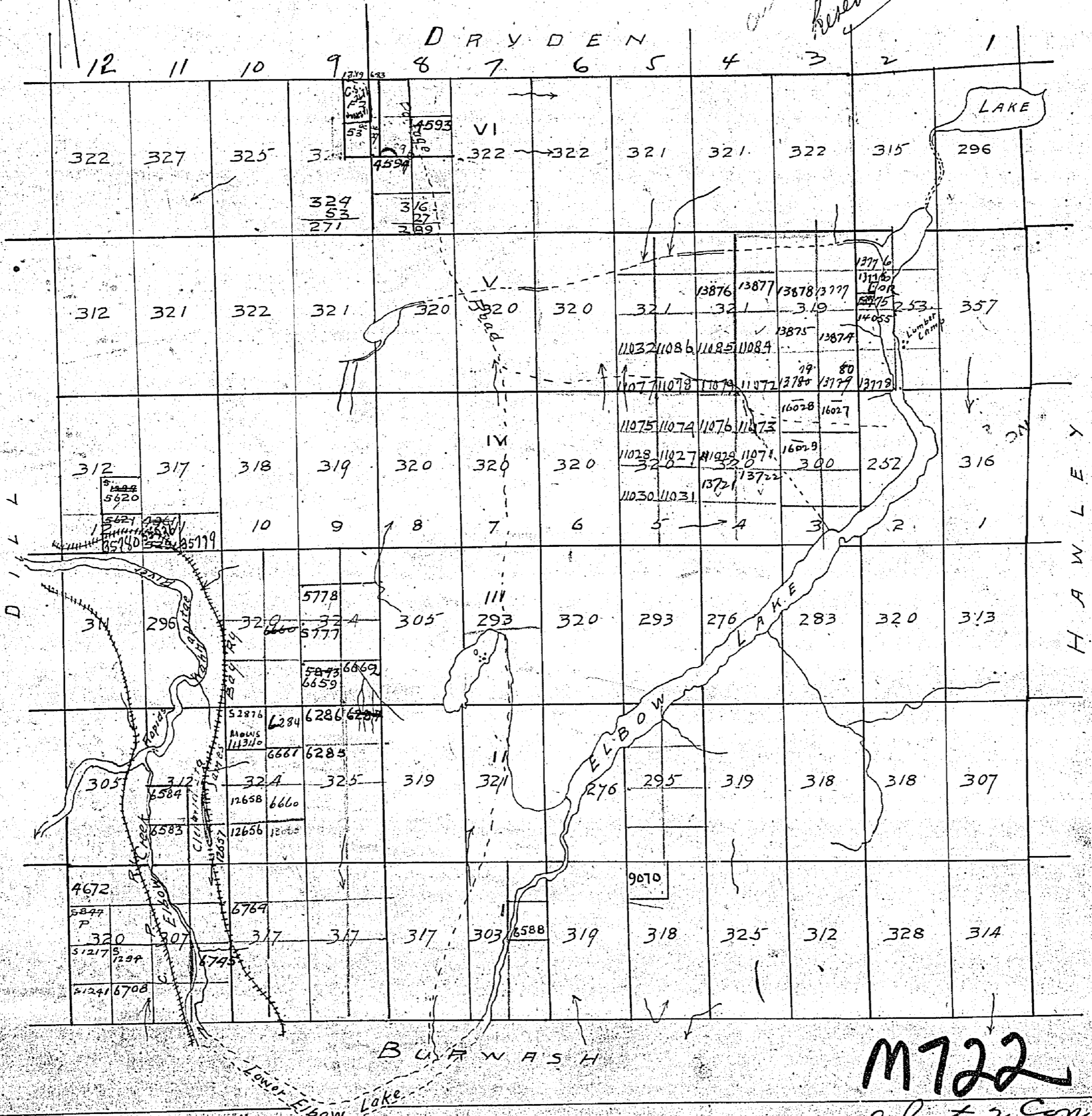

M722

D. Results in part of lot 2 Con S

722

DRYDEN TWP.

old trap file

THE TOWNSHIP OF
CLELAND
DISTRICT of SUDBURY
SUDBURY MINING
DIVISION

SCALE 1 INCH TO 40 CHAINS

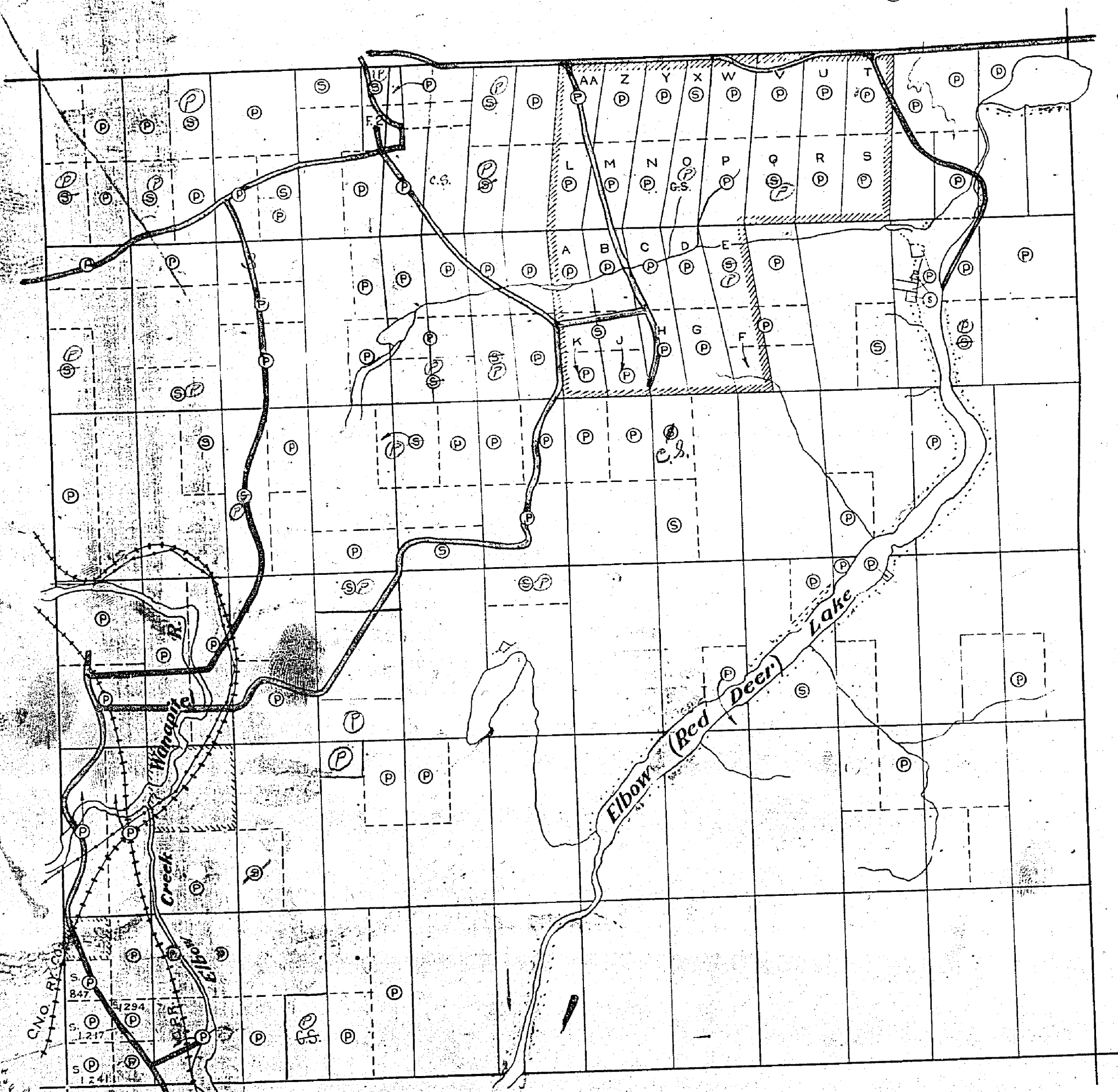

VI

V

IV

III

II

I

HAWLEY TWP.

LEGEND

- PATENTED LANDS (P)
- CROWN LAND SALES (S)
- LICENSE OF OCCUPATION (L.O.)
- LOCATED LANDS (Loc.)
- IMPROVED ROADS (—)
- POWER TRANSMISSION LINE (—)
- RAILWAYS (—)
- SUBDIVISION (—)

NOTES

WITHDRAWN FROM STAKING SHOWN THUS: (Symbol)

400' Rsvd. to Dept. of L. & F. shown thus: (Symbol)

M722

DEPARTMENT of MINES
ONTARIO

722



DILL TWP

DRYDEN TWP

Twp file

400' res.

Old

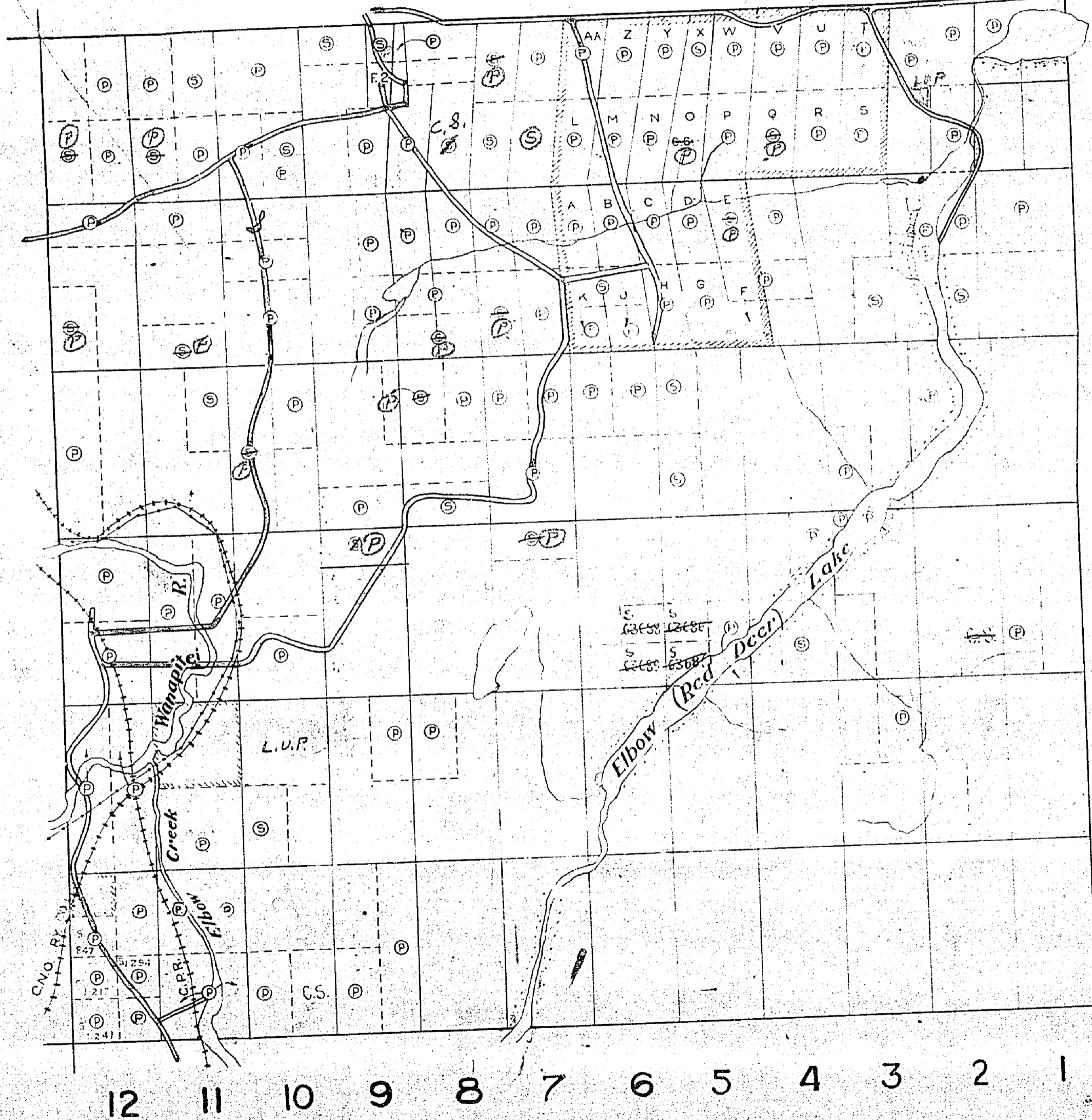

VI

V

IV

III

II

I

HAWLEY TWP

THE TOWNSHIP
OF
CLELAND
DISTRICT of SUDBURY
SUDBURY MINING
DIVISION
SCALE 1 INCH TO 40 CHAINS

LEGEND

- PATENTED LANDS
- CROWN LAND SALES
- LICENSE OF OCCUPATION L.O.
- LOCATED LANDS
- IMPROVED ROADS
- POWER TRANSMISSION LINE
- RAILWAYS
- SUBDIVISION

NOTES

WITHDRAWN FROM SEPARATE SHEETS THUS:

400' Res. to Decr. Lake

*N. 1/2 Lot 11 Con 2 &
N.W. 1/4 N. 1/2 Lot 12 Con 2
not open for staking
J. F. M. letter mar. 19/53*

BURWASH TWP

M 722

DEPARTMENT of MINES
ONTARIO

722



DRYDEN TWP.

Handwritten: L.P.
Twp file

THE TOWNSHIP
OF
CLELAND
DISTRICT OF SUDBURY
SUDBURY MINING
DIVISION

SCALE 1 INCH TO 40 CHAINS

LEGEND

- PATENTED LANDS
- CROWN LAND SALES
- LICENSE OF OCCUPATION L.O.
- LOCATED LANDS Loc.
- IMPROVED ROADS
- POWER TRANSMISSION LINE
- RAILWAYS
- SUBDIVISION

NOTES

30752
5473

Handwritten: N 1/2 lot 11 Conn. 2, 4
N 1/4 lot 12 Conn. 2
NOT OPEN for 20 to 30 years
J.F.M. letter Nov 19/58

Handwritten: 400' Res.

DILL TWP.

HAWLEY TWP.

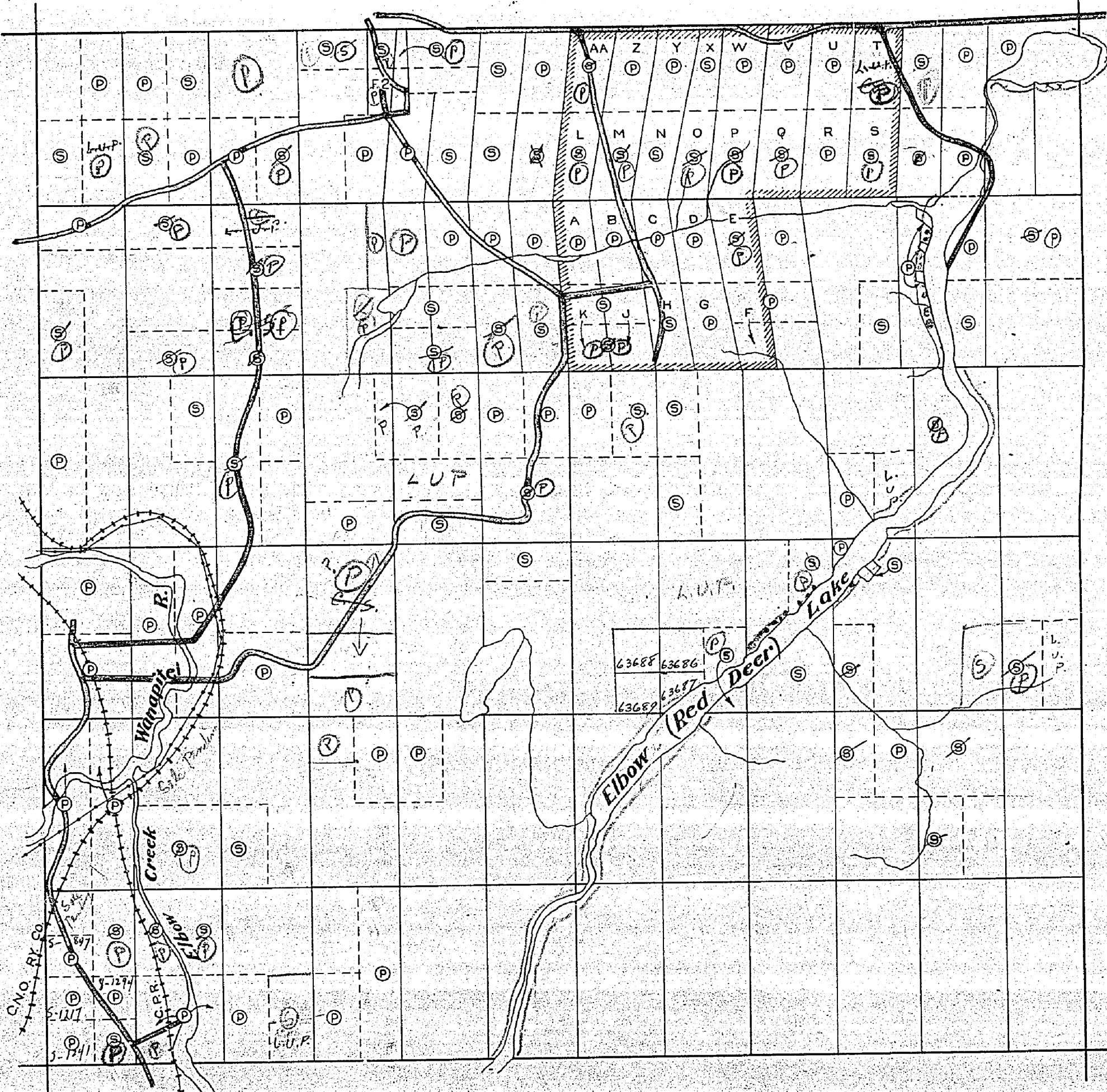

12 11 10 9 8 7 6 5 4 3 2 1

BURWASH TWP.

M722

DEPARTMENT OF MINES
ONTARIO

Handwritten: Cleland
Twp
722



June, 1984

Out of Service November 2, 1995

THE TOWNSHIP OF
 OF
CLELAND
 DISTRICT of SUDBURY
 SUDBURY MINING
 DIVISION
 SCALE 1 INCH TO 40 CHAINS

LEGEND

PATENTED LANDS ⊕
 CROWN LAND SALES ⊙
 LICENSE OF OCCUPATION L.O.
 LOCATED LANDS Loc.
 IMPROVED ROADS ———
 POWER TRANSMISSION LINE ———
 RAILWAYS ———
 SUBDIVISION [Hatched Box]

NOTES

WITHDRAWN FROM STAKING SHOWN THUS:

400' Surface Rights Reservation around all Lakes and Rivers.

AREAS WITHDRAWN FROM DISPOSITION

M.R.O. — MINING RIGHTS ONLY
 S.R.O. — SURFACE RIGHTS ONLY
 M+S. — MINING AND SURFACE RIGHTS

Description	Order No.	Date	Disposition	File
Ⓜ PUBLIC ACCESS		MAR./82	S.R.O.	

THE INFORMATION THAT APPEARS ON THIS MAP HAS BEEN COMPILED FROM VARIOUS SOURCES, AND ACCURACY IS NOT GUARANTEED. THOSE WISHING TO STAKE MINING CLAIMS SHOULD CONSULT WITH THE MINING RECORDER, MINISTRY OF NORTHERN DEVELOPMENT AND MINES, FOR ADDITIONAL INFORMATION ON THE STATUS OF THE LANDS SHOWN HEREON.

M.722 CLELAND
 ONTARIO
 MINISTRY OF NATURAL RESOURCES
 SURVEYS AND MAPPING BRANCH

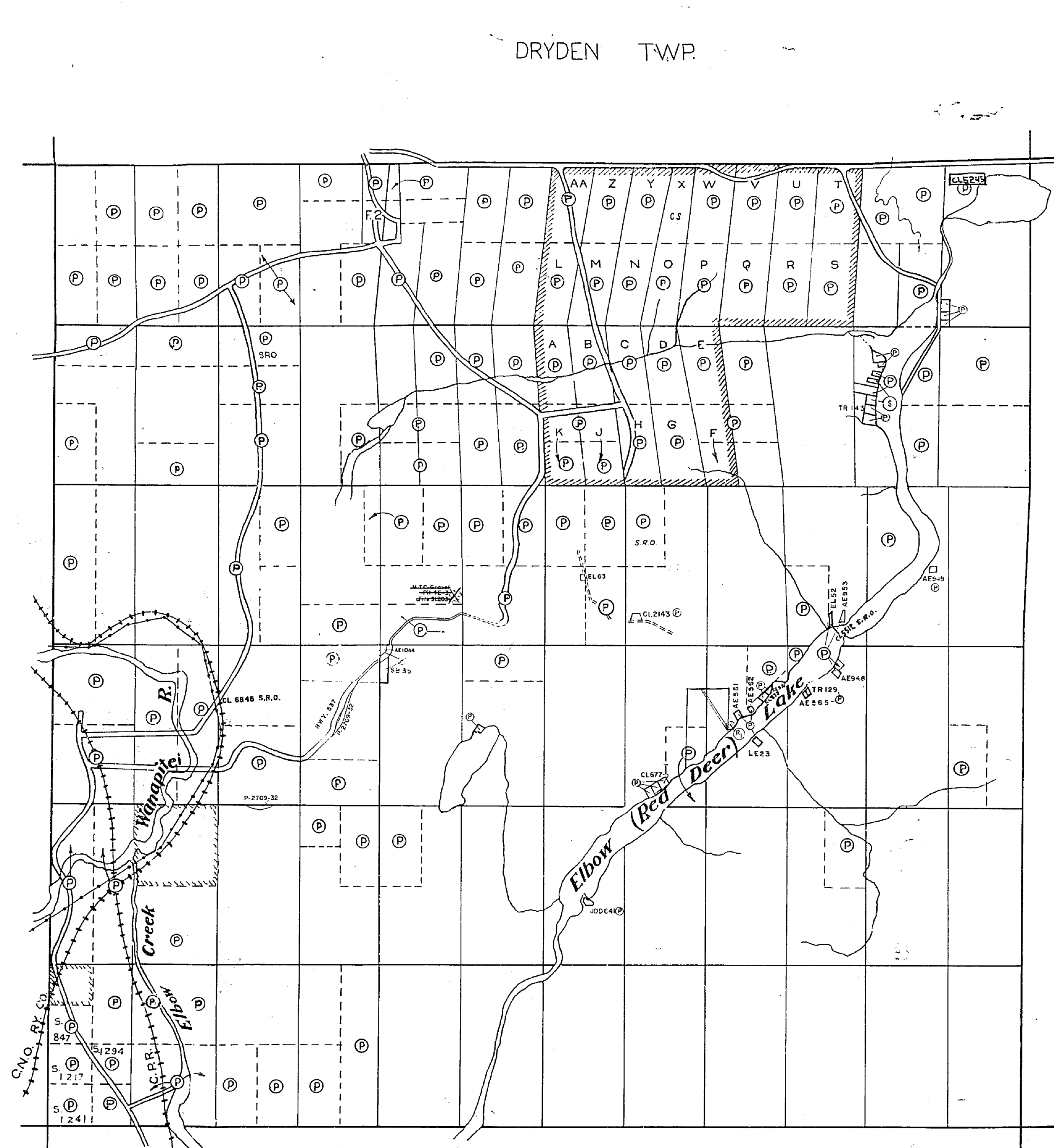

VI
 V
 IV
 III
 II
 I

DILL TWP
 HAWLEY TWP

DRYDEN TWP.

BURWASH TWP.

12 11 10 9 8 7 6 5 4 3 2 1



CLELAND

SCALE 40 chains to an inch

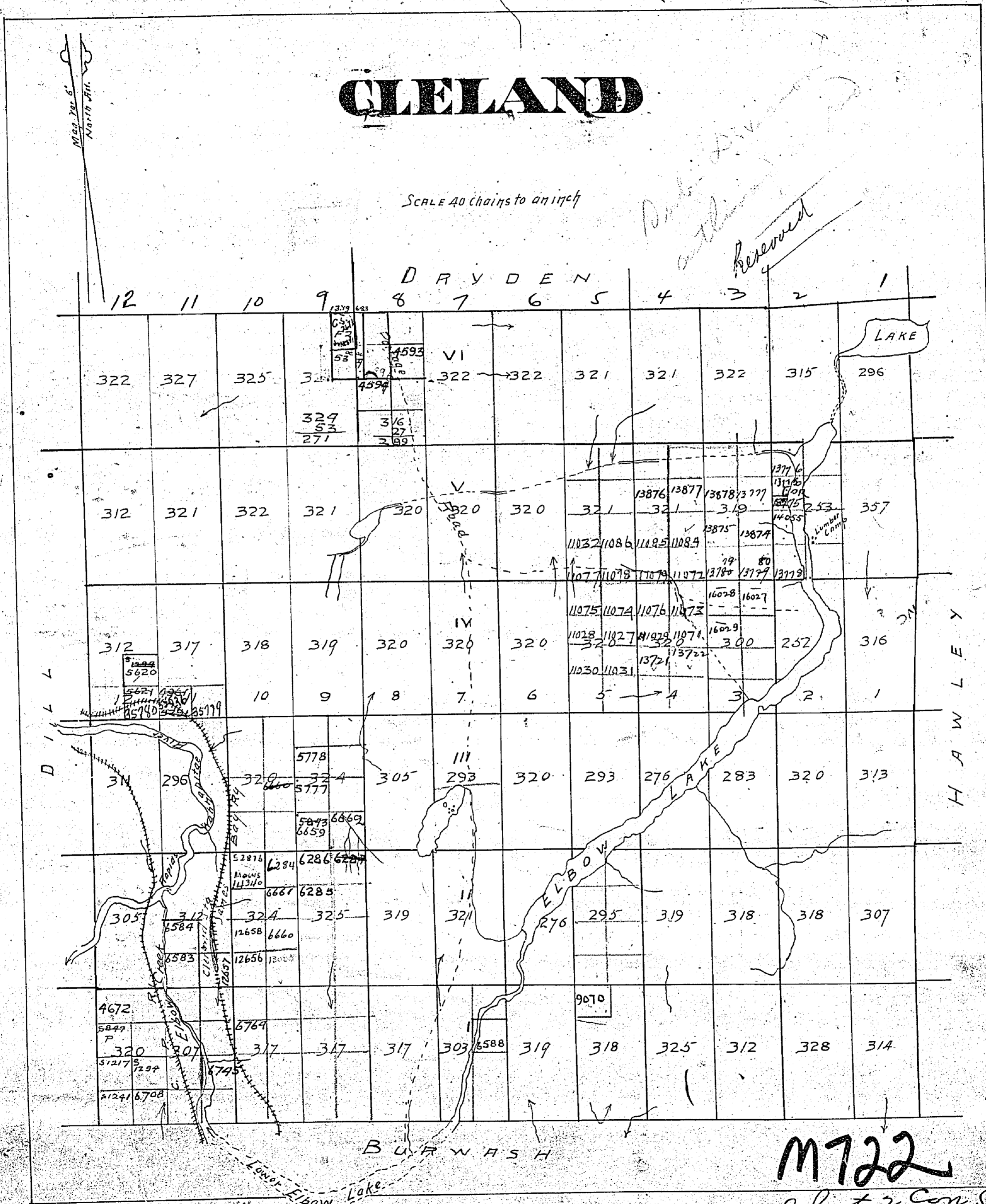

D. Resorts in part of lot 2 Con 5

M722

722

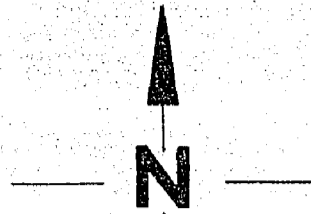

DRYDEN TWP.

*h.p.
Troy's file*

THE TOWNSHIP OF
OF
CLELAND
DISTRICT OF SUDBURY
SUDBURY MINING
DIVISION
SCALE 1 INCH TO 40 CHAINS

DILL TWP.

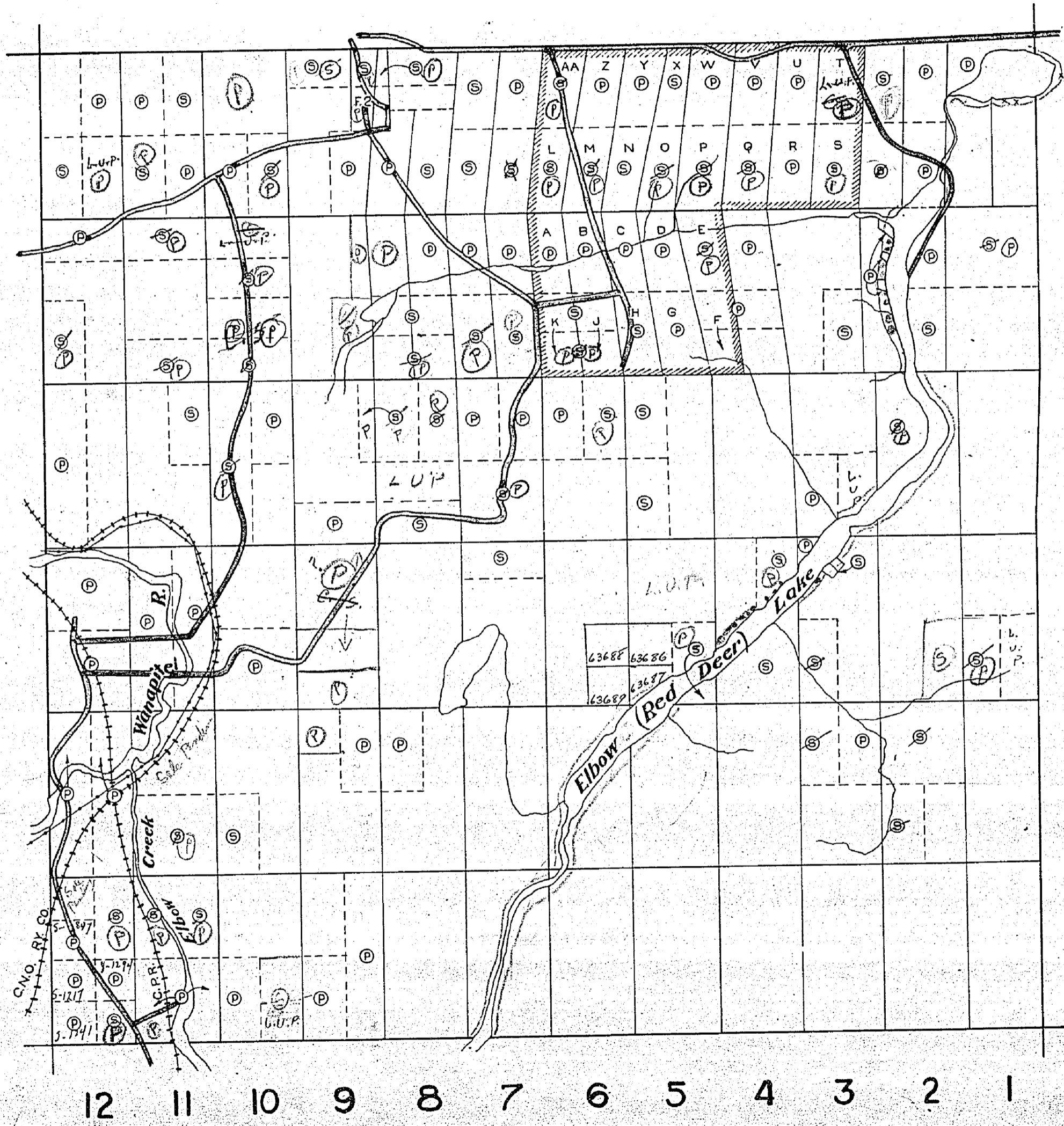

VI

V

IV

III

II

I

HAWLEY TWP.

BURWASH TWP.

LEGEND

- PATENTED LANDS (P)
- CROWN LAND SALES (S)
- LICENSE OF OCCUPATION (L.O.)
- LOCATED LANDS (Loc.)
- IMPROVED ROADS (—)
- POWER TRANSMISSION LINE (—)
- RAILWAYS (—)
- SUBDIVISION (—)

3075^W 5473 **NOTES**
 N¹/₂ Sec 11 Con. 2. 4
 N¹/₂ Sec 12 Con. 2
 NOT OPEN for 20 years
 J.F.M. letter June 1953

400' R.R.

M722

DEPARTMENT OF MINES
ONTARIO

*236
Dryden
8/17/53*

Twp file

Old

DRYDEN TWP

400' res.

THE TOWNSHIP OF

CLELAND

DISTRICT OF SUDBURY

SUDBURY MINING

DIVISION

SCALE 1 INCH TO 40 CHAINS

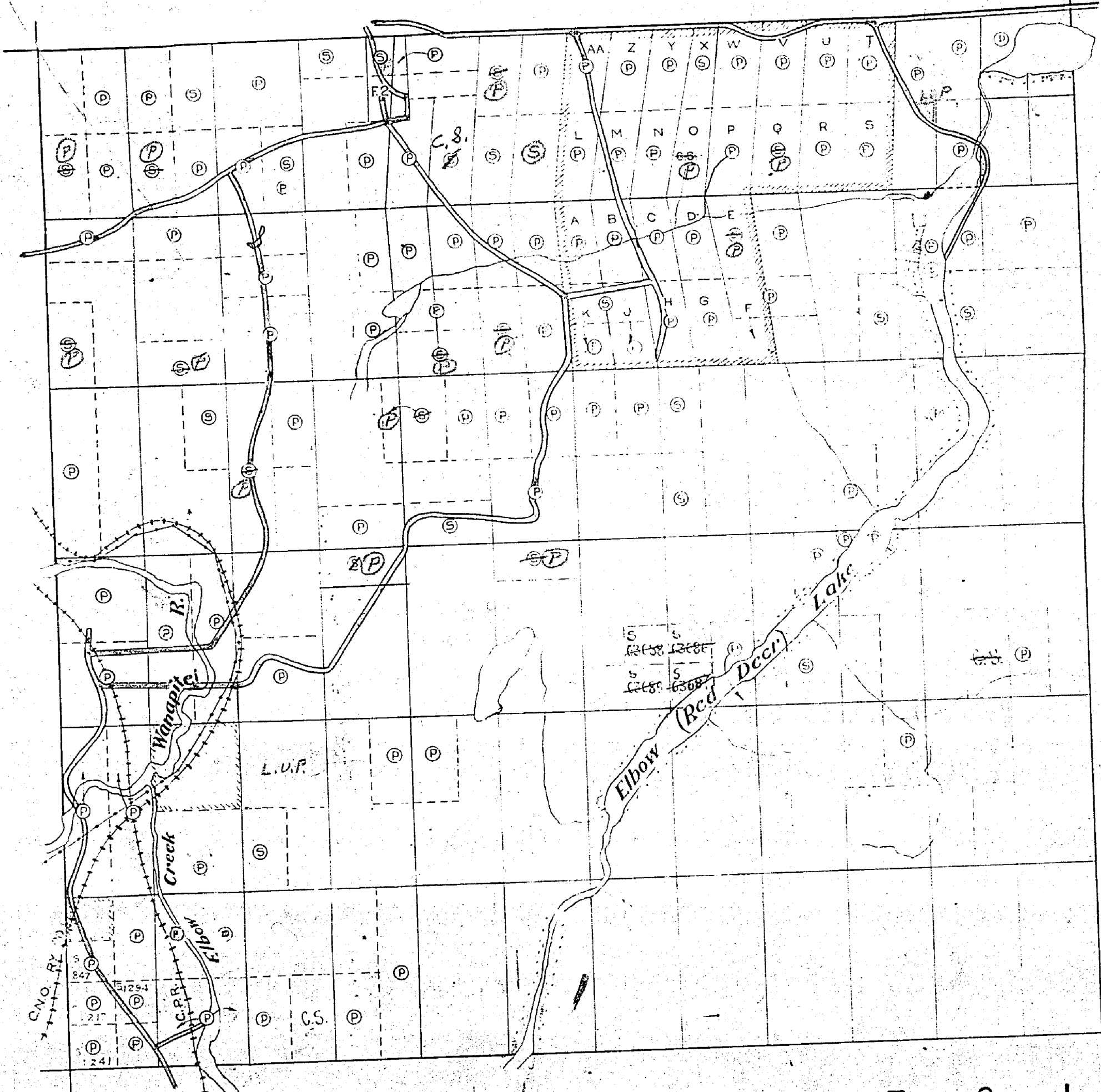

DILL TWP

VI

V

IV

III

II

I

HAWLEY TWP

12 11 10 9 8 7 6 5 4 3 2 1

BURWASH TWP

LEGEND

- PATENTED LANDS
- CROWN LAND SALES
- LICENSE OF OCCUPATION
- LOCATED LANDS
- IMPROVED ROADS
- POWER TRANSMISSION LINE
- RAILWAYS
- SUBDIVISION

NOTES

WITHDRAWN FROM SEVERAL LOTS AND THIS:

400' Res. to Decr. L. & F. 1905

*N. 1/2 Lot 11 Con 2 &
N.W. 1/4 N. 1/2 Lot 12 Con 2
not open for siting
J. F. M. letter mar. 17/53*

M 722

DEPARTMENT OF MINES
ONTARIO

722

DRYDEN TWP.

old trap file







THE TOWNSHIP OF
OF
CLELAND

DISTRICT of SUDBURY

SUDBURY MINING
DIVISION

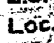
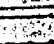
SCALE 1 INCH TO 40 CHAIN

LEGEND

- PATENTED LANDS 
- CROWN LAND SALES 
- LICENSE OF OCCUPATION 
- LOCATED LANDS 
- IMPROVED ROADS 
- POWER TRANSMISSION LINE 
- RAILWAYS 
- SUBDIVISION 

NOTES

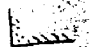
WITHDRAWN FROM STAKING SHOWN THUS: 

400' Rsvd. to Dept. of L.F.
shown thus: 

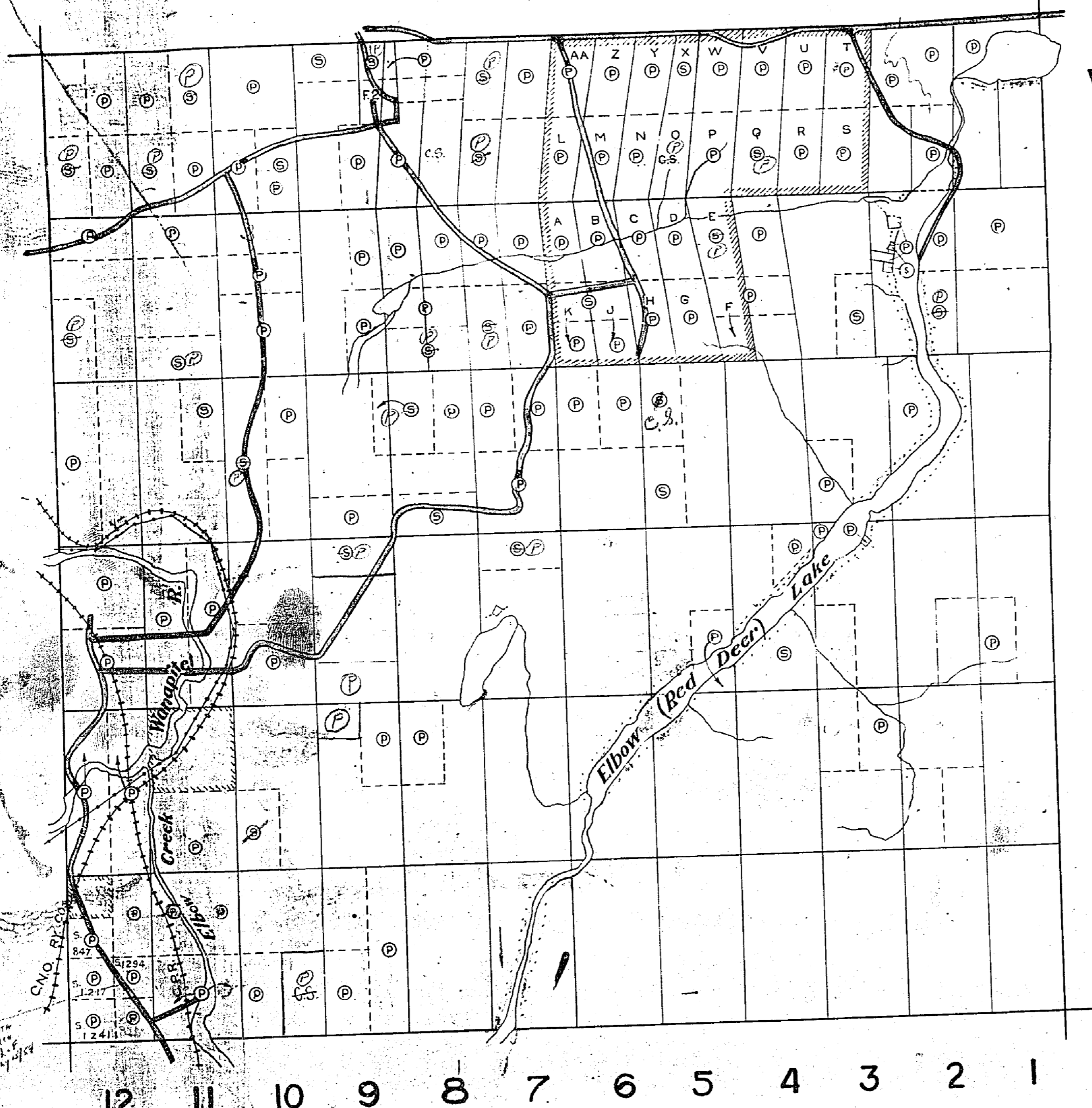

VI

V

IV

III

II

I

HAWLEY TWP.

12

11

10

9

8

7

6

5

4

3

2

1

BURWASH TWP.

M722

DEPARTMENT of MINES
ONTARIO

OFFICE USE ONLY

DRYDEN TWP.

THE TOWNSHIP OF
OF
CLELAND
DISTRICT of SUDBURY
SUDBURY MINING
DIVISION

SCALE 1 INCH TO 40 CHAINS

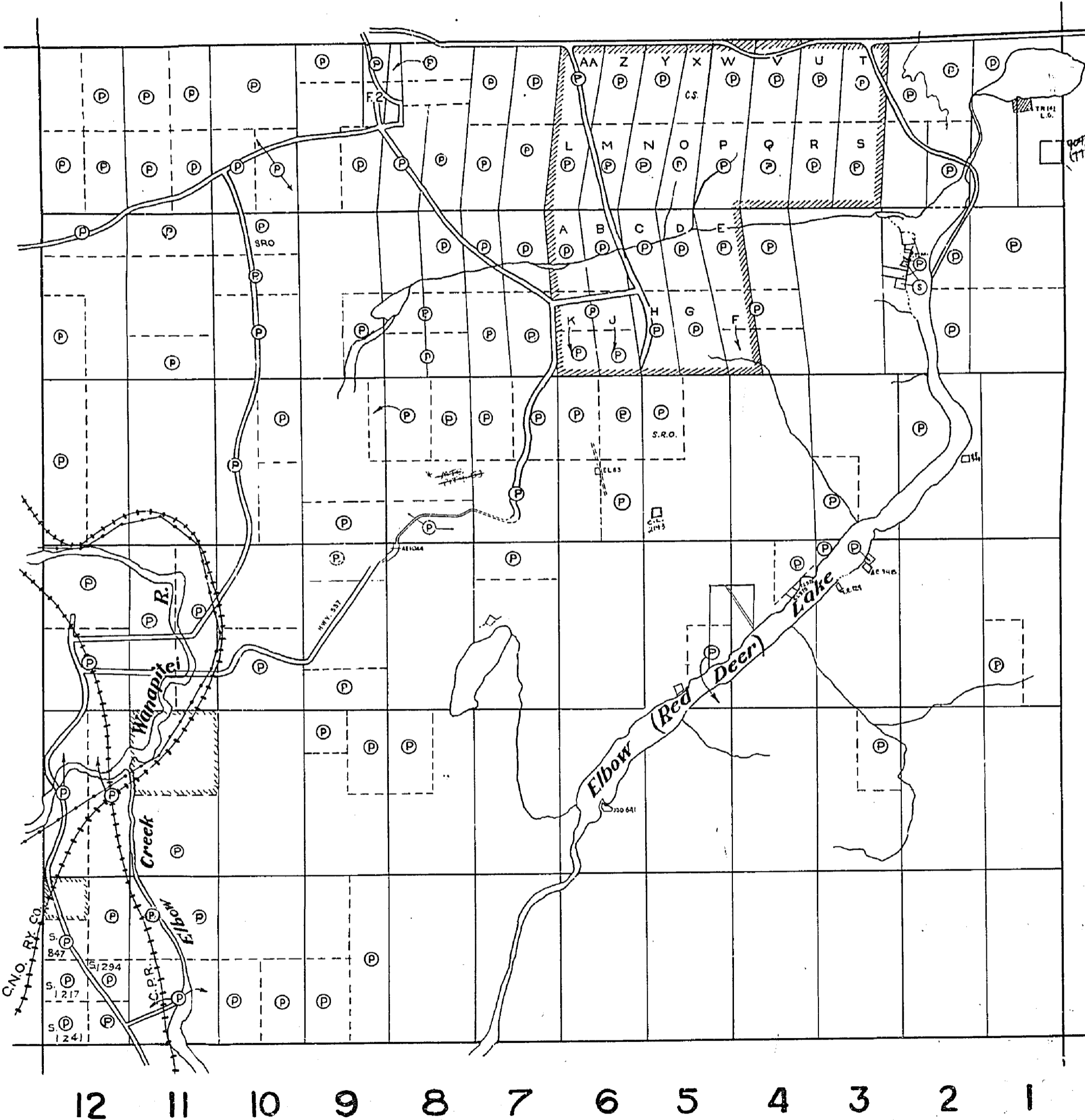
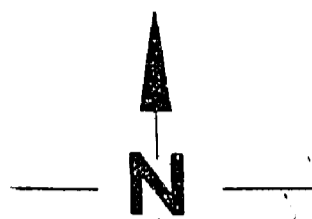

VI

V

IV

III

II

I

HAWLEY TWP.

DILL TWP.

12 11 10 9 8 7 6 5 4 3 2 1

BURWASH TWP.

LEGEND

- PATENTED LANDS (P)
- CROWN LAND SALES (S)
- LICENSE OF OCCUPATION (L.O.)
- LOCATED LANDS (Loc.)
- IMPROVED ROADS (---)
- POWER TRANSMISSION LINE (—)
- RAILWAYS (—)
- SUBDIVISION (---)

NOTES

WITHDRAWN FROM STAKING SHOWN THUS:

400' Surface Rights Reservation around all Lakes and Rivers.

* See Cleland Land Roll File.

CLELAND
M.722

ONTARIO
MINISTRY OF NATURAL RESOURCES
SURVEYS AND MAPPING BRANCH

