

2026

REDDITT

KENORA MINING DIVISION

REC'D. AUG 7 1967

Sept 11/69

RECEIPT No.
MINING DIVISION

Forgotten Lake Area - M.3005 (approx. boundary)

Scale 40 chains to an inch

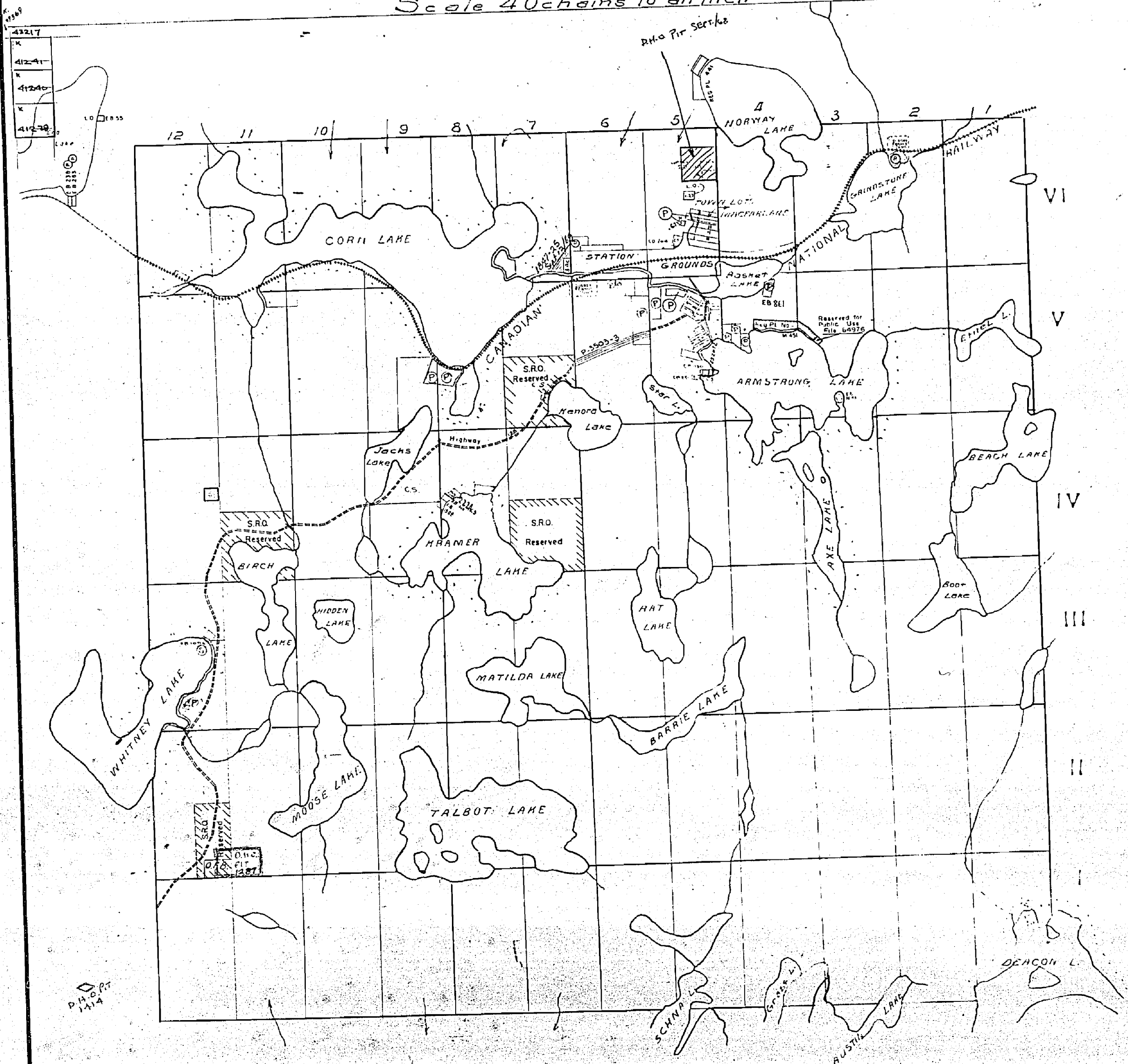

400 Reserve to the Dept of Lands & Forests
shown thus

MILICK

REDDITT 2026

DEACON LAKE
AND
REDDITT TWP.

DISTRICT OF
KENORA

KENORA
MINING DIVISION

SCALE: 1-INCH = 40 CHAINS

LEGEND

- PATENTED LAND
PATENTED FOR SURFACE RIGHTS ONLY
LEASES
LICENSE OF OCCUPATION
CROWN LAND SALE
LOCATED LAND
CANCELLED
MINING RIGHTS ONLY
SURFACE RIGHTS ONLY
HIGHWAY & ROUTE No.
ROADS
TRAILS
RAILWAYS
POWER LINES
MARSH OR MUSKEG
MINES
- Ⓟ or Ⓢ
Ⓛ
Ⓢ
C.S.
Loc.
C.
M.R.O.
S.R.O.
17

*used only with summer resort locations or when
space is limited

NOTES

400' Surface Rights Reservation Around the Shores of All Lakes
and Rivers

AREAS WITHDRAWN FROM DISPOSITION

S.R. - SURFACE RIGHTS M.R. - MINING RIGHTS

Description	Order No.	Date	Disposition	File
Ⓢ		22/3/71	S.R.O.	163473
Ⓢ		29/3/71	S.R.O.	84978
Ⓢ		20/7/71	S.R. & M.R.	163473
Ⓢ				163473
Ⓢ				84976

Effective as
Amended
Aug. 22/84

SAND & GRAVEL

- Ⓢ QUARRY PERMIT
Ⓢ M.T.C. PIT No. 10-26
Ⓢ M.T.C. Gravel PIT No. 10-22
Ⓢ " " " " 10-37
Ⓢ Gravel File 163473
Ⓢ Gravel File 7569
Ⓢ M.T.C. PIT No. 1378
Ⓢ Quarry File 7664
Ⓢ Gravel File 44610
Ⓢ Gravel File 181377
Ⓢ Gravel File 64925
Ⓢ M.T.C. PIT No. 1287
Ⓢ Gravel File 84926
Ⓢ M.T.C. Gravel PIT No. 1414 File 84925
Ⓢ Gravel File 84925
Ⓢ M.T.C. Gravel PIT No. 10-38
Ⓢ MNR GRAVEL RESERVE 10-23

RECEIVED
JUN 1 1984
7501011 1212 1456

NATIONAL TOPOGRAPHIC SERIES 52E

PLAN NO. M.2026

ONTARIO
MINISTRY OF NATURAL RESOURCES

SURVEYS AND MAPPING BRANCH

MINAKI - M.1916

MELICK TWP.
FOR STATUS REFER TO TWP. PLAN - M.2012

PETTYPIECE TWP.
FOR STATUS REFER TO TWP. PLAN - M.2022

MINAKI - M.1916

FORGOTTEN LAKE - M.3005

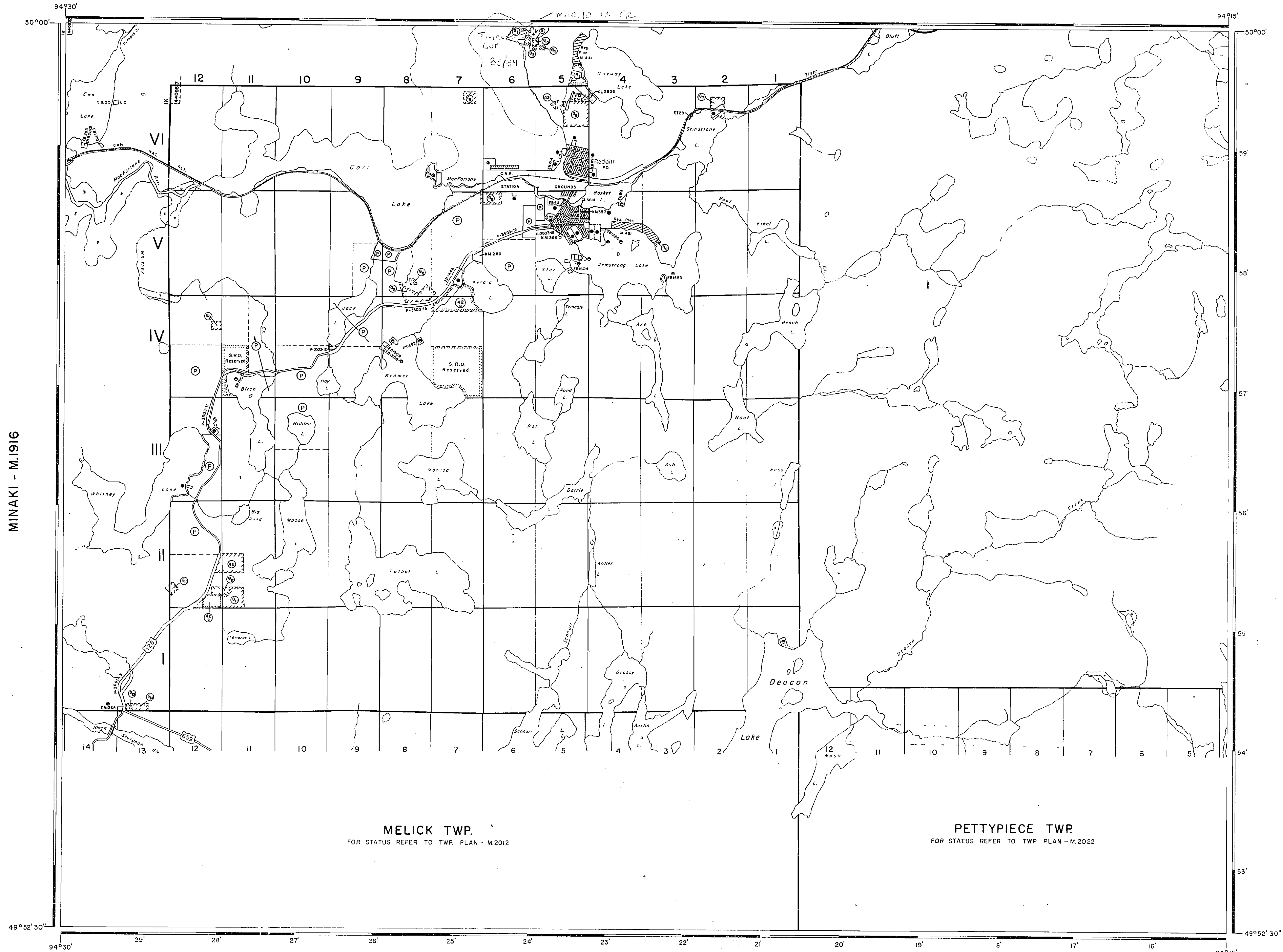

MELICK TWP.
FOR STATUS REFER TO TWP. PLAN - M.2012

PETTYPIECE TWP.
FOR STATUS REFER TO TWP. PLAN - M.2022

AREA OF
DEACON LAKE
AND
REDDITT TWP.

DISTRICT OF
KENORA

KENORA
MINING DIVISION

SCALE: 1-INCH = 40 CHAINS

LEGEND

PATENTED LAND
PATENTED FOR SURFACE RIGHTS ONLY
LEASES
LICENSE OF OCCUPATION
CROWN LAND SALE
LOCATED LAND
CANCELLED
MINING RIGHTS ONLY
SURFACE RIGHTS ONLY
HIGHWAY & ROUTE No.
ROADS
TRAILS
RAILWAYS
POWER LINES
MARSH OR MUSKEG
MINES

P or
L.O.
C.S.
Loc.
C.
M.R.O.
S.R.O.
17
X

Used only with summer resort locations or when
space is limited

NOTES

400' Surface Rights Reservation Around the Shores of All Lakes
and Rivers

AREAS WITHDRAWN FROM DISPOSITION

S.R. - SURFACE RIGHTS M.R. - MINING RIGHTS

Description	Order No.	Date	Disposition	File
12		22/3/71	S.R.O.	163473
13		29/3/71	S.R.O.	84978
14		20/7/71	S.R. & M.R.	163473
15			CROWN Res.	163473
16			RESERVE for Public Use	84976

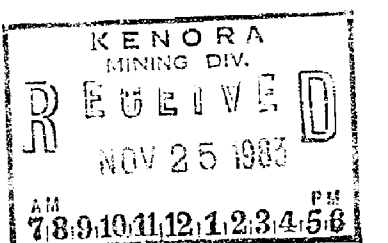

SAND & GRAVEL

17	M.T.C. PIT No. 1D-20	
18	M.T.C. Gravel PIT No. 1D-22	
19	" " " " 1D-37	
20	Gravel	File 163473
21	Gravel	File 7569
22	M.T.C. PIT No. 1378	
23	Quarry	File 7664
24	Gravel	File 44610
25	Gravel	File 181377
26	Gravel	File 64925
27	M.T.C. PIT No. 1287	
28	Gravel	File 84926
29	M.T.C. Gravel PIT No. 1414	File 84925
30	Gravel	File 84925
31	M.T.C. Gravel PIT No. 1D-38	
32	QUARRY PERMIT	

NATIONAL TOPOGRAPHIC SERIES 52E

PLAN NO. M.2026

ONTARIO
MINISTRY OF NATURAL RESOURCES
SURVEYS AND MAPPING BRANCH

FORGOTTEN LAKE AREA

LEGEND

DISPOSITION OF CROWN LANDS

TYPE OF DOCUMENT	SYMBOL
PATENT - SURFACE & MINING RIGHTS	●
PATENT - MINING RIGHTS ONLY	○
PATENT - SURFACE RIGHTS ONLY	◐
PATENT - MINING & SURFACE RIGHTS	◑
RESERVE FOR PUBLIC USE	■
RESERVE FOR COUNCIL	□
RESERVATION	○
CANCELLED	○
CAN. & RAIL	○

NOTE: RIGHTS IN LANDS PATENTED PRIOR TO MAY 1, 1917, ARE NOT VALID UNLESS THEY WERE CONFIRMED BY THE PUBLIC LANDS ACT, 1917, CHAP. 380, SEC. 63 SUBSEC. 1.

AREAS WITHDRAWN FROM DISPOSITION

M.R.O. - MINING RIGHTS ONLY
S.R.O. - SURFACE RIGHTS ONLY
M.S.R. - MINING AND SURFACE RIGHTS

Description	Date	Disposition	File
CROWN RESERVE FOR PUBLIC USE	30/03/71		163473 Vol. 3
			163473
			84976
	29/03/71	S.R.O.	84978
	22/03/71	S.R.O.	163473
	20/07/71	S.R. & M.R.	163473

SCALE: 1 INCH = 40 CHAINS

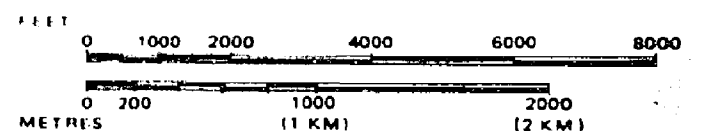

AREA DEACON LAKE
AND
REDDITT TWP.
M.N.R. ADMINISTRATIVE DISTRICT
KENORA
MINING DIVISION
KENORA
LAND TITLES / REGISTRY DIVISION
KENORA

Ministry of Natural Resources
Ontario
Ministry of Northern Development and Mines

Date: DECEMBER / 1986
Number

G-2611

MINAKI AREA

MELICK TWP.
FOR STATUS REFER TO TWP. PLAN

PETTYPIECE TWP.
FOR STATUS REFER TO TWP. PLAN

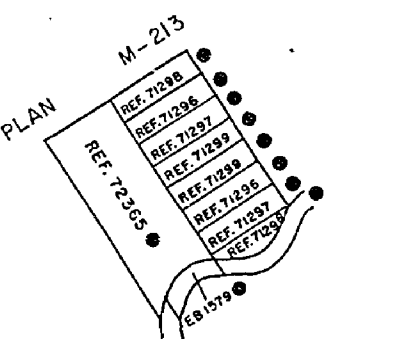

DETAIL 'A' (Scale: 1" = 10 Chains)

FORGOTTEN LAKE AREA G2618

MINAKI AREA G2631

G2629 MARK LAKE

LEGEND

- HIGHWAY AND ROUTE No.
- OTHER ROADS
- TRAILS
- SURVEYED LINES:
 - TOWNSHIPS, BASE LINES, ETC.
 - LOTS, MINING CLAIMS, PARCELS, ETC.
- UNSURVEYED LINES:
 - LOT LINES
 - PARCEL BOUNDARY
 - MINING CLAIMS ETC.
- RAILWAY AND RIGHT OF WAY
- UTILITY LINES
- NON-PERENNIAL STREAM
- FLOODING OR FLOODING RIGHTS
- SUBDIVISION OR COMPOSITE PLAN
- RESERVATIONS
- ORIGINAL SHORELINE
- MARSH OR MUSKEG
- MINES
- TRAVERSE MONUMENT

DISPOSITION OF CROWN LANDS

TYPE OF DOCUMENT	SYMBOL
PATENT, SURFACE & MINING RIGHTS	
" SURFACE RIGHTS ONLY	
" MINING RIGHTS ONLY	
LEASE, SURFACE & MINING RIGHTS	
" SURFACE RIGHTS ONLY	
" MINING RIGHTS ONLY	
LICENCE OF OCCUPATION	
ORDER-IN-COUNCIL	
RESERVATION	
CANCELLED	
SAND & GRAVEL	

NOTE: MINING RIGHTS IN PARCELS PATENTED PRIOR TO MAY 1912, VESTED IN ORIGINAL PATENTEE BY THE PUBLIC LANDS ACT, R.S.O. 1970, CHAP. 380, SEC. 63, SUBSEC.

AREAS WITHDRAWN FROM DISPOSITION

- M.R.O. - MINING RIGHTS ONLY
- S.R.O. - SURFACE RIGHTS ONLY
- M. + S. - MINING AND SURFACE RIGHTS

Description Order No. Date Disposition F.B.

30/03/71	163473
CROWN RES.	163473
RESERVE FOR PUBLIC USE	84976
29/03/71	S.R.O. 84976
22/03/71	S.R.O. 163473
20/07/71	S.R. & M.R. 163473

THE INFORMATION THAT APPEARS ON THIS MAP HAS BEEN COMPILED FROM VARIOUS SOURCES AND ACCURACY IS NOT GUARANTEED. THOSE WISHING TO STAKE MINING CLAIMS SHOULD CONSULT WITH THE MINING RECORDER, MINISTRY OF NORTHERN DEVELOPMENT AND MINES FOR ADDITIONAL INFORMATION ON THE STATUS OF THE LANDS SHOWN HEREON.

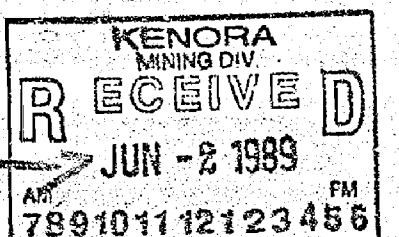

SCALE: 1 INCH = 40 CHAINS

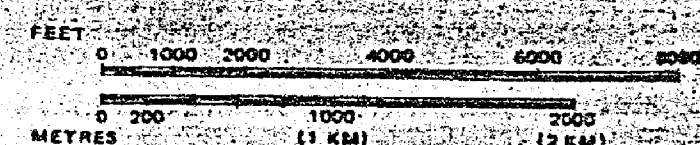

AREA DEACON LAKE AND REDDITT TWP.
M.N.R. ADMINISTRATIVE DISTRICT
KENORA
MINING DIVISION
KENORA
LAND TITLES / REGISTRY DIVISION
KENORA

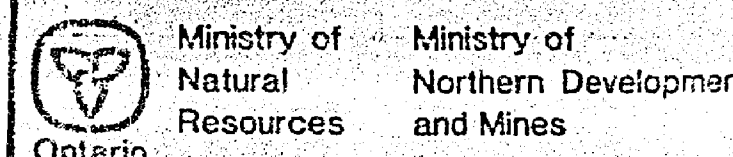

Date: DECEMBER/1986

Number

M-2026

G-2611

MELICK TWP.
FOR STATUS REFER TO TWP. PLAN G1348

PETTYPIECE TWP.
FOR STATUS REFER TO TWP. PLAN G1352

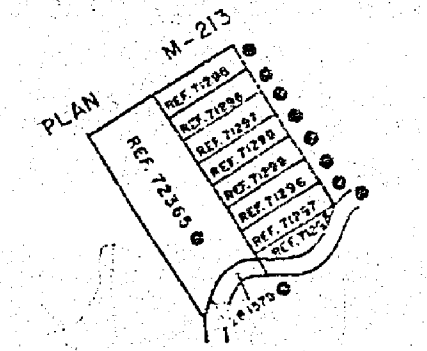

DETAIL 'A' (Scale: 1" = 10 Chains)

2026

REDDITT

KENORA MINING DIVISION

REC'D. AUG 7 1961
RECEIPT No.
MINING DIVISION

Sept 11/69

Scale 40 chains to an inch

Forgotten Lake Area - M.3005 (approx boundary)

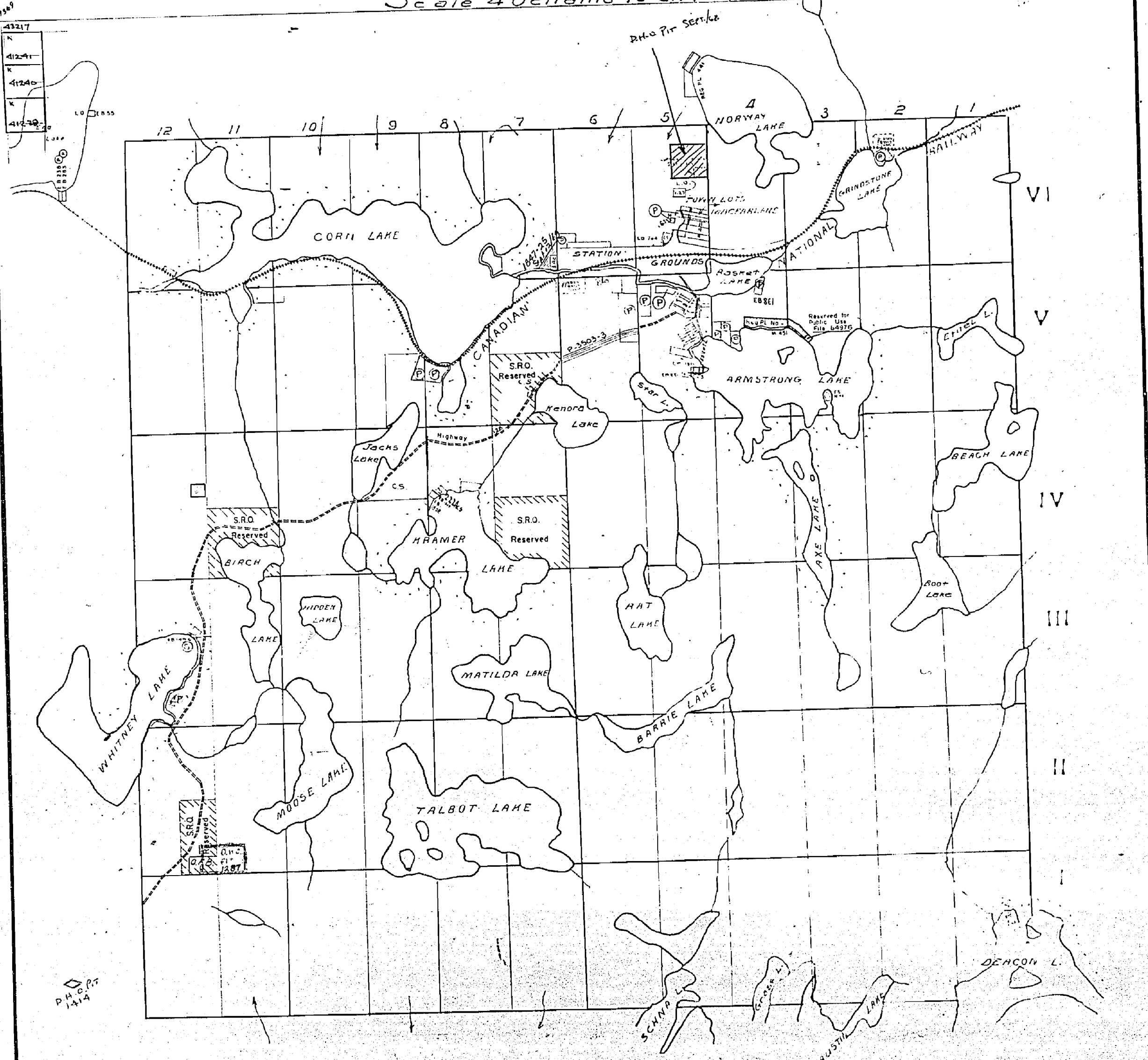

400' Reserve to the Dept of Lands & Forests shown thus:

MILICK

REDDITT 2026

AREA OF
**DEACON LAKE
AND
REDDITT TWP.**

DISTRICT OF
KENORA

2026
KENORA
MINING DIVISION

SCALE: 1-INCH = 40 CHAINS

LEGEND

- PATENTED LAND
- PATENTED FOR SURFACE RIGHTS ONLY
- LEASES
- LICENSE OF OCCUPATION
- CROWN LAND SALE
- LOCATED LAND
- CANCELLED
- MINING RIGHTS ONLY
- SURFACE RIGHTS ONLY
- HIGHWAY & ROUTE No.
- ROADS
- TRAILS
- RAILWAYS
- POWER LINES
- MARSH OR MUSKEG
- MINES

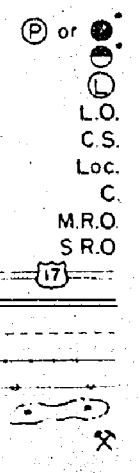

*used only with summer resort locations or when space is limited

NOTES

100' Surface Rights Reservation Around the Shores of All Lakes and Rivers

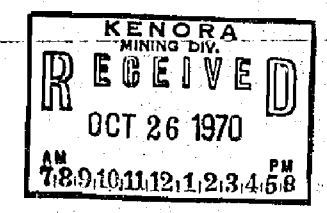

MINAKI - M.1916

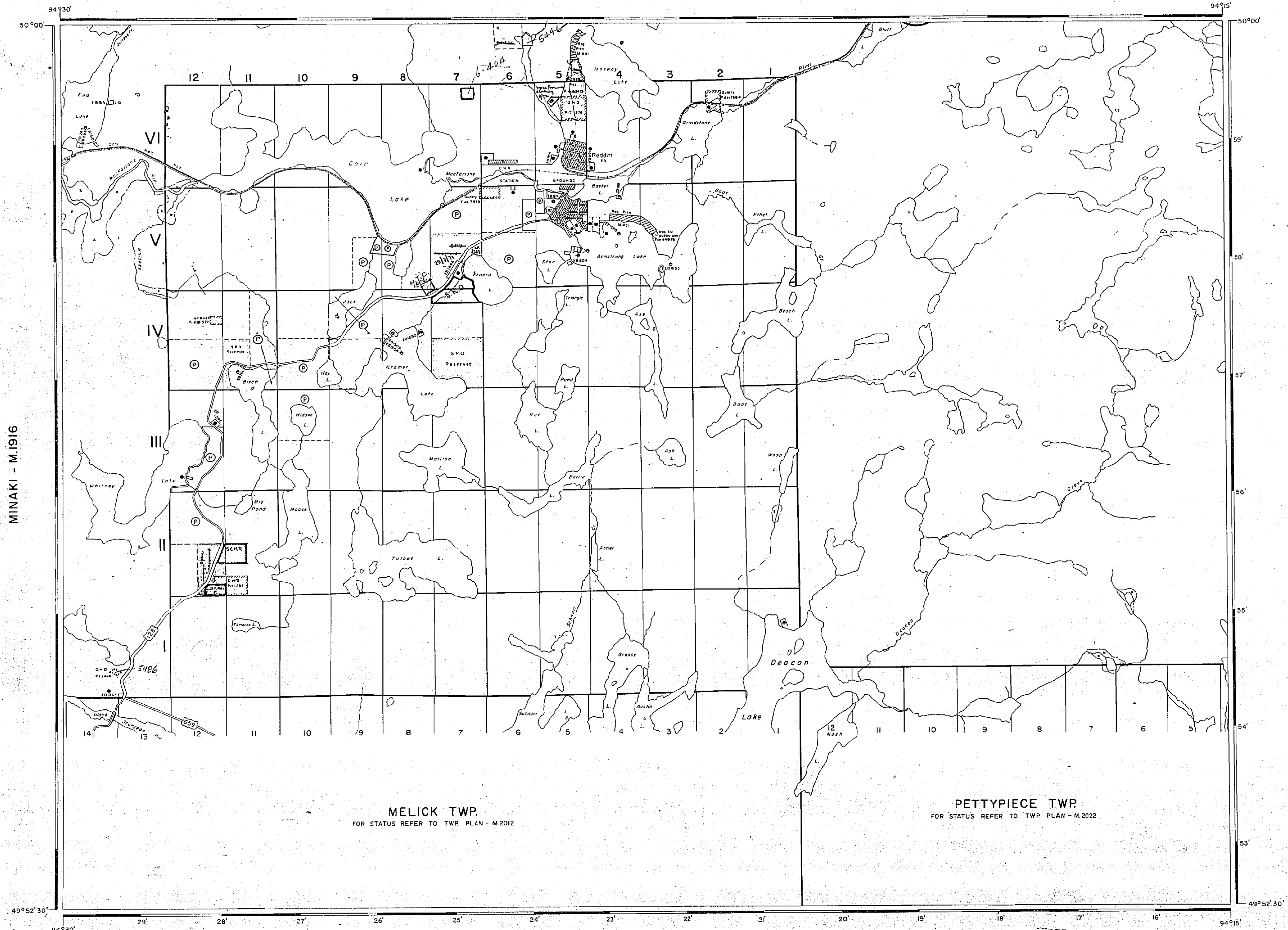

MELICK TWP.
FOR STATUS REFER TO TWP. PLAN - M.2012

PETTYPIECE TWP.
FOR STATUS REFER TO TWP. PLAN - M.2022

NATIONAL TOPOGRAPHIC SERIES 52 E

PLAN NO. **M.2026**

ONTARIO
DEPARTMENT OF MINES
AND NORTHERN AFFAIRS

FORGOTTEN LAKE - M.3005

MINAKI - M.1916

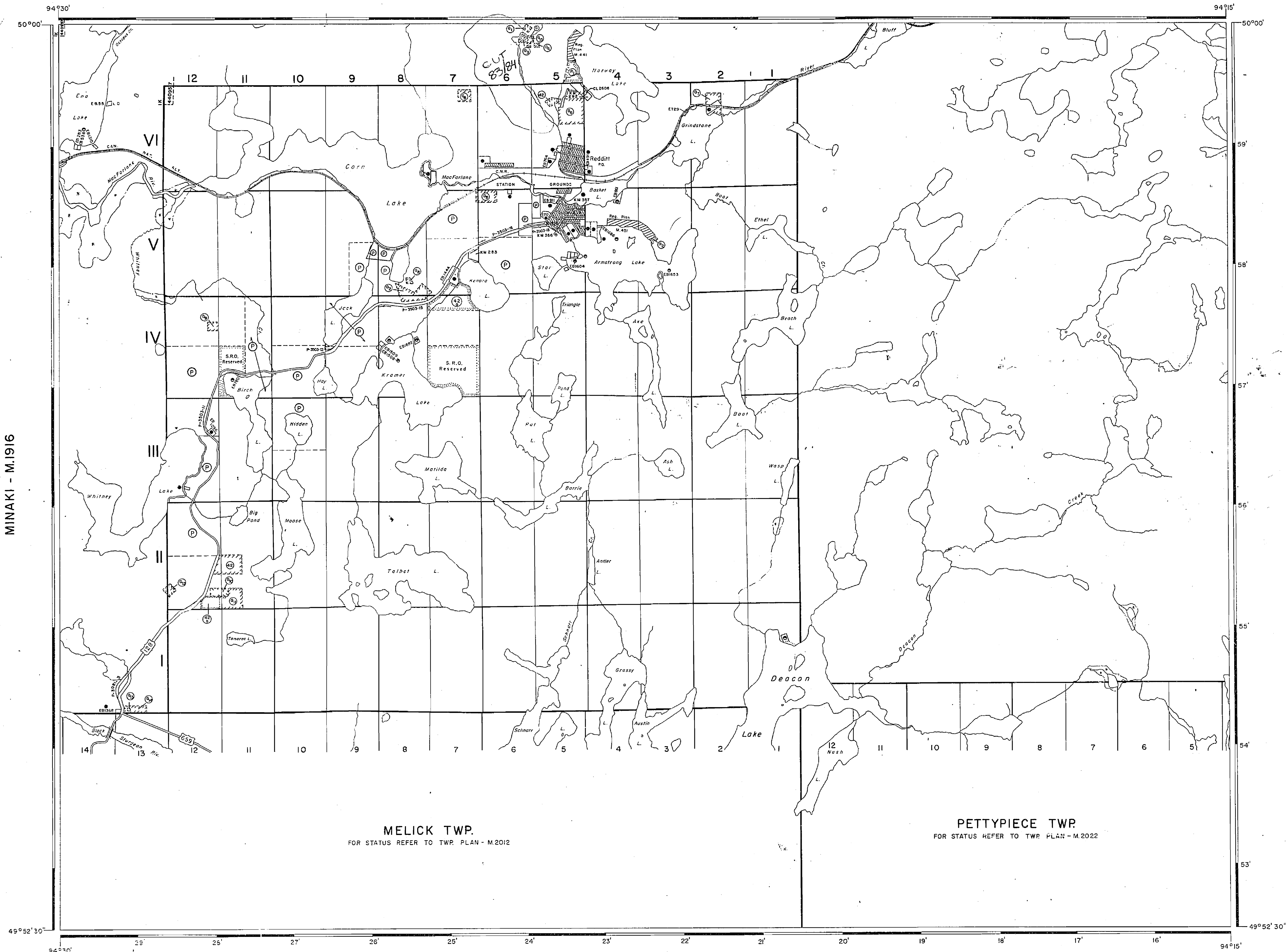

MELICK TWP.
FOR STATUS REFER TO TWP. PLAN - M.2012

PETTYPIECE TWP.
FOR STATUS REFER TO TWP. PLAN - M.2022

AREA OF
**DEACON LAKE
AND
REDDITT TWP.**
DISTRICT OF
KENORA
KENORA
MINING DIVISION
SCALE: 1-INCH = 40 CHAINS

LEGEND

PATENTED LAND PATENTED FOR SURFACE RIGHTS ONLY (P) or (C)
LEASES (L)
LICENSE OF OCCUPATION (L.O.)
CROWN LAND SALE (C.S.)
LOCATED LAND (Loc.)
CANCELLED (C.)
MINING RIGHTS ONLY (M.R.O.)
SURFACE RIGHTS ONLY (S.R.O.)
HIGHWAY & ROUTE No. (Hwy. & Rte. No.)
ROADS (Rd.)
TRAILS (Tr.)
RAILWAYS (Rly.)
POWER LINES (P.L.)
MARSH OR MUSKEG (M.)
MINES (Mn.)

*used only with summer resort locations or when space is limited

NOTES

400' Surface Rights Reservation Around the Shores of All Lakes and Rivers

AREAS WITHDRAWN FROM DISPOSITION

S.R. - SURFACE RIGHTS		M.R. - MINING RIGHTS	
Description	Order No.	Date	Disposition
(15)		22/3/71	S.R.O. 163473
(16)		29/3/71	S.R.O. 84978
(17)		20/7/71	S.R. & M.R. 163473
(18) CROWN RES.			163473
(19) RESERVE for Public Use			84976

DATE OF ISSUE

JUL - 6 1983

Ministry of Natural Resources
TORONTO
SAND & GRAVEL

- (1) M.T.C. PIT No. 10-20
- (2) M.T.C. Gravel PIT No. 10-22
- (3) " " " " 10-37
- (4) Gravel File 163473
- (5) Gravel File 7569
- (6) M.T.C. PIT No. 1378
- (7) Quarry File 7664
- (8) Gravel File 44610
- (9) Gravel File 181377
- (10) Gravel File 64925
- (11) M.T.C. PIT No. 1287
- (12) Gravel File 84925
- (13) M.T.C. Gravel PIT No. 1414 File 84925
- (14) Gravel File 84925
- (15) M.T.C. Gravel PIT No. 10-22
- (16) QUARRY PERMIT

RECEIVED
OCT 7 1983

NATIONAL TOPOGRAPHIC SERIES 52E

PLAN NO. **M.2026**

ONTARIO
MINISTRY OF NATURAL RESOURCES
SURVEYS AND MAPPING BRANCH

AREA OF
**DEACON LAKE
AND
REDDITT TWP.**

DISTRICT OF
KENORA

2026
KENORA
MINING DIVISION

SCALE: 1-INCH = 40 CHAINS

LEGEND

- PATENTED LAND
- PATENTED FOR SURFACE RIGHTS ONLY
- LEASES
- VENUE OF OCCUPATION
- CROWN LAND SALE
- LOCATED LAND
- CANCELLED
- MINING RIGHTS ONLY
- SURFACE RIGHTS ONLY
- HIGHWAY & ROUTE NO.
- ROADS
- TRAILS
- RAILWAYS
- POWER LINES
- TRANSIT OR SUSPENSION
- MINES

NOTES

USE Surface Rights Notation Around the Shores of All Lakes and Rivers

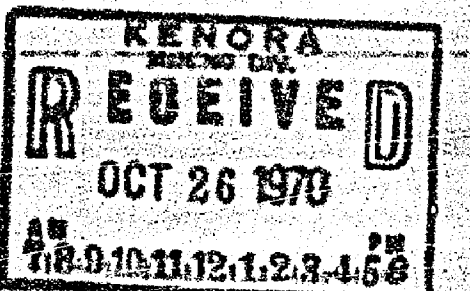

MINAKI - M.1916

MELICK TWP.

FOR STATUS REFER TO TWP. PLAN - M.2012

PETTYPIECE TWP.

FOR STATUS REFER TO TWP. PLAN - M.2022

NATIONAL TOPOGRAPHIC SERIES 52 E

PLAN NO. **M.2026**

ONTARIO
DEPARTMENT OF MINES
AND NORTHERN AFFAIRS

M-202

DISTRICT OF
KENORA

SCALE: 1-INCH = 40 CHAINS

1. 1997年12月，在江蘇省江浦縣江浦鎮，發現一具古屍，經DNA鑑定，確認為秦代古屍。這具古屍被命名為「秦女屍」，其死因至今尚未確定。

This material contains neither recommendations nor conclusions of the FBI. It is the property of the FBI and is loaned to your agency; it and its contents are not to be distributed outside your agency.

File	Date	Disposition
62-1473	2/23/71	4-0
62-1473	29/3/71	5-0
62-1473	29/7/71	5-0 4-0

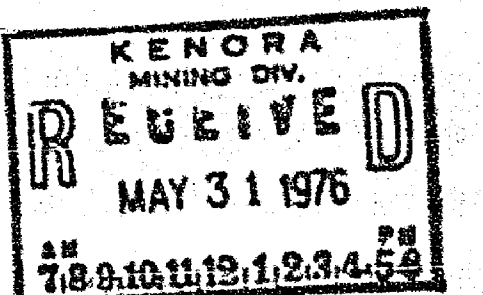

PLAN NO. M.2026

SURVEY AND MAPPING BRANCH

✓ *propheta*
Lafayette



SR + MR
WITHDRAWN.

FOR STATUS REFER TO TWR PLAN - M2012

FOR STATUS REFER TO TWP PLAN - M 2022

2026

FORGOTTEN LAKE - M.3005

AREA OF

DEACON LAKE
AND
REDDITT TWP.DISTRICT OF
KENORA

2026

KENORA
MINING DIVISION

SCALE: 1-INCH = 40 CHAINS

LEGEND

PATENTED LAND (P) or (•)
PATENTED FOR SURFACE RIGHTS ONLY (P) or (•)
LEASES (L)
LICENSE OF OCCUPATION (L.O.)
CROWN LAND SALE (C.S.)
LOCATED LAND (Loc.)
CANCELLED (C)
MINING RIGHTS ONLY (M.R.O.)
SURFACE RIGHTS ONLY (S.R.O.)
HIGHWAY & ROUTE No. (17)
ROADS (—)
TRAILS (---)
RAILWAYS (—+—)
POWER LINES (—+—+—)
MARSH OR MUSKEG (---+---)
MINES (X)

*Used only with summer resort locations or when
space is limited

NOTES

100' Surface Rights Reservation Around the Shores of All Lakes
and Rivers.

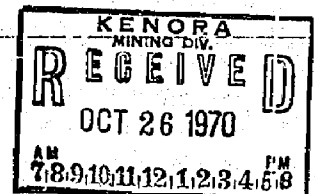

MELICK TWP.

FOR STATUS REFER TO TWP PLAN - M.2012

PETTYPIECE TWP.

FOR STATUS REFER TO TWP PLAN - M.2022

NATIONAL TOPOGRAPHIC SERIES 52 E

PLAN NO. M.2026

ONTARIO
DEPARTMENT OF MINES
AND NORTHERN AFFAIRS

498942