

REFERENCES

SURVEYS

BASE LINE SURVEYED BY SPEIGHT AND VAN NOSTRAND O.L.S. 1908. FIELD NOTE BOOK No. 2539

BOUNDARY LINE BETWEEN DISTRICT OF COCHRANE AND DISTRICT OF THUNDER BAY SURVEYED BY A. NIVEN O.L.S. 1907. FIELD NOTE BOOK No. 2450.

HIGHWAYS

HIGHWAY No. 11 - DEPARTMENT OF HIGHWAYS PLANS NOS. P-2544-63, P-2544-64 AND P-2653-1.

THE SURFACE RIGHTS LYING WITHIN 40.25 m. OF THE CENTER-LINE OF THE TRANS CANADA PIPELINE RIGHT-OF-WAY ARE WITHDRAWN FROM STAKING OUT, PROSPECTING, SALE OR LEASE BY ORDER W-019/1/ONT, DATED SEPT. 20, 1991. SECTION 112 OF THE NATIONAL ENERGY ACT APPLIES TO THIS AREA.

THE INFORMATION THAT APPEARS ON THIS MAP HAS BEEN COMPILED FROM VARIOUS SOURCES AND ACCURACY IS NOT GUARANTEED. THOSE WISHING TO STAKE MINING CLAIMS SHOULD CONSULT WITH THE MINING RECORDER, MINISTRY OF NORTHERN DEVELOPMENT AND MINES, FOR ADDITIONAL INFORMATION ON THE STATUS OF THE LANDS SHOWN HEREON.

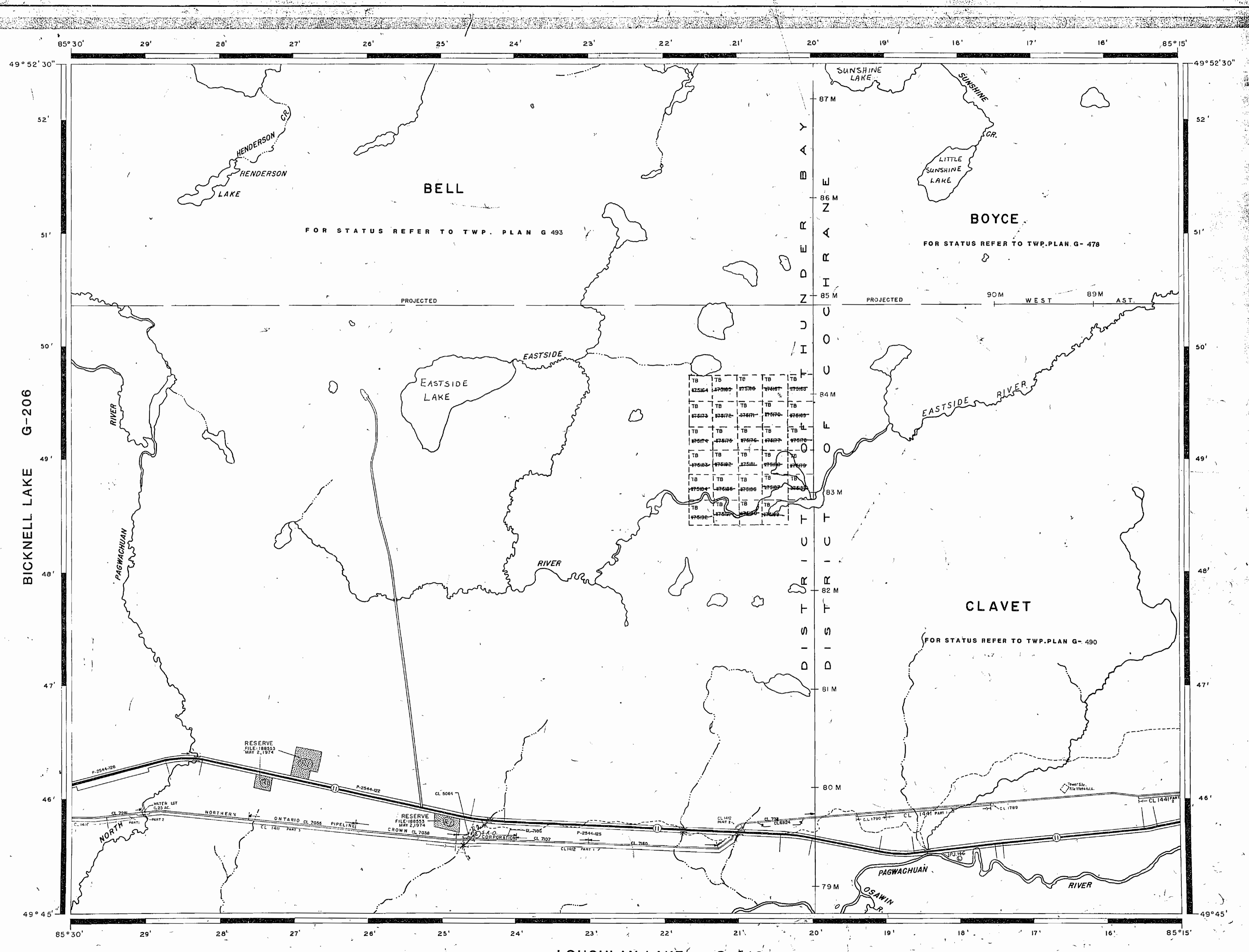

REFERENCES

AREAS WITHDRAWN FROM DISPOSITION

Description	Order No.	Date	Disposition	File
(21) S.R. - SURFACE RIGHTS	W2574	May 14	SR/MAR	
(22) M.R. - MINING RIGHTS	W2187	Aug 11/81	580. See Bell	Sup. Cont'd.

LEGEND

- HIGHWAY AND ROUTE No.
- OTHER ROADS
- TRAILS
- SURVEYED LINES: TOWNSHIPS, BASE LINES, ETC.
- LOTS, MINING CLAIMS, PARCELS, ETC.
- UNSURVEYED LINES: LOT LINES
- PARCEL BOUNDARY
- MINING CLAIMS ETC.
- RAILWAY AND RIGHT OF WAY
- UTILITY LINES
- NON-PERENNIAL STREAM
- FLOODING OR FLOODING RIGHTS
- SUBDIVISION OR COMPOSITE PLAN
- RESERVATIONS
- ORIGINAL SHORELINE
- MARSH OR MUSKEG
- MINES
- TRAVERSE MONUMENT

DISPOSITION OF CROWN LANDS

TYPE OF DOCUMENT	SYMBOL
PATENT, SURFACE & MINING RIGHTS	
" SURFACE RIGHTS ONLY	
" MINING RIGHTS ONLY	
LEASE, SURFACE & MINING RIGHTS	
" SURFACE RIGHTS ONLY	
" MINING RIGHTS ONLY	
LICENCE OF OCCUPATION	
ORDER-IN-COUNCIL	
RESERVATION	
CANCELLED	
SAND & GRAVEL	
LAND USE PERMITS FOR COMMERCIAL TOURISM/OUTPOST CAMPS	

NOTE: MINING RIGHTS IN PARCELS PATENTED PRIOR TO MAY 6, 1913, VESTED IN ORIGINAL PATENTEES BY THE PUBLIC LANDS ACT, R.S.O. 1970, CHAP. 280, SEC. 63, SUBSEC. 1.

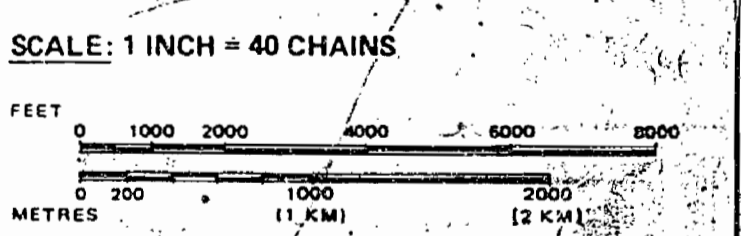

AREA

EASTSIDE LAKE

M.N.R. ADMINISTRATIVE DISTRICT

GERALDTON

MINING DIVISION

THUNDER BAY

LAND TITLES / REGISTRY DIVISION

THUNDER BAY/COCHRANE

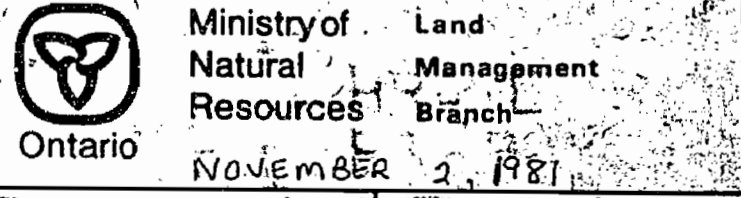

Date: SEPT. 23, 1991

Number: 2, 1981

G-241

REFERENCES

SURVEYS:

BASE LINE SURVEYED BY SPEIGHT AND VAN NOSTRAND O.L.S. 1908. FIELD NOTE BOOK No. 2539

BOUNDARY LINE BETWEEN DISTRICT OF COCHRANE AND DISTRICT OF THUNDER BAY SURVEYED BY A. NIVEN O.L.S. 1907. FIELD NOTE BOOK No. 2450.

HIGHWAYS

HIGHWAY No. 11 -
DEPARTMENT OF HIGHWAYS PLANS NOS. P-2544-63, P-2544-64 AND P-2653-1.

THE SURFACE RIGHTS LYING WITHIN 40.25 m. OF THE CENTER-LINE OF THE TRANS CANADA PIPELINE RIGHT-OF-WAY ARE WITHDRAWN FROM STAKING OUT, PROSPECTING, SALE OR LEASE BY ORDER W-019/10NT, DATED SEPT. 20, 1991, SECTION 112 OF THE NATIONAL ENERGY ACT APPLIES TO THIS AREA

THE INFORMATION THAT APPEARS ON THIS MAP HAS BEEN COMPILED FROM VARIOUS SOURCES, AND ACCURACY IS NOT GUARANTEED. THOSE WISHING TO STAKE MINING CLAIMS SHOULD CONSULT WITH THE MINING RECORDER, MINISTRY OF NORTHERN DEVELOPMENT AND MINES, FOR ADDITIONAL INFORMATION ON THE STATUS OF THE LANDS SHOWN HEREON.

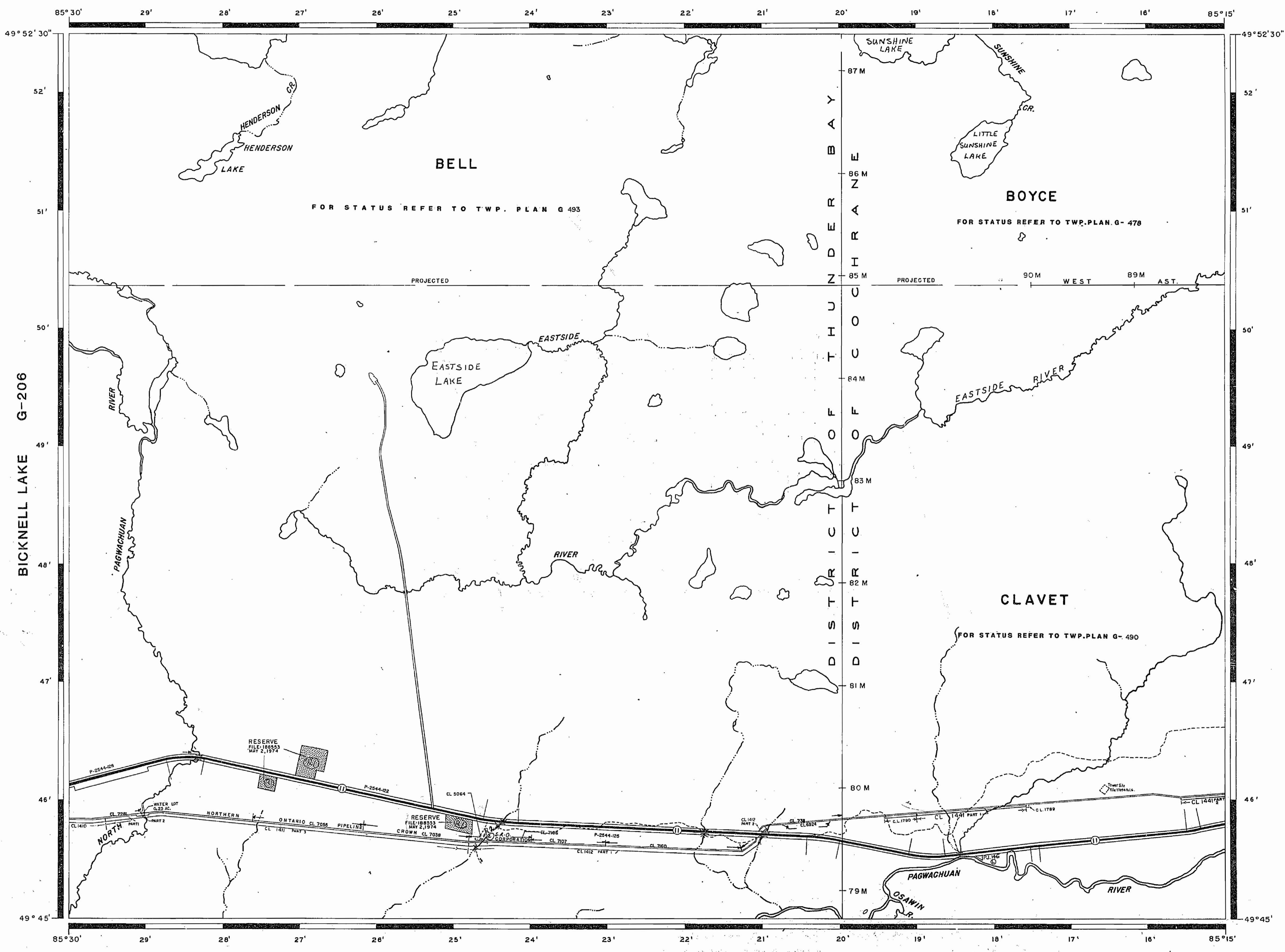

REFERENCES

AREAS WITHDRAWN FROM DISPOSITION-

Description	Order No.	Date	Disposition	File
(C1)	W2574	Nov 14	SRM.R.	
(C2)	W2781	May 11/81	S.R.O. see Bell	Sup. Control

LEGEND

HIGHWAY AND ROUTE No.	
OTHER ROADS	
TRAILS	
SURVEYED LINES:	
TOWNSHIPS, BASE LINES, ETC.	
LOTS, MINING CLAIMS, PARCELS, ETC.	
UNSURVEYED LINES:	
LOT LINES	
PARCEL BOUNDARY	
MINING CLAIMS ETC.	
RAILWAY AND RIGHT OF WAY	
UTILITY LINES	
NON-PERENNIAL STREAM	
FLOODING OR FLOODING RIGHTS	
SUBDIVISION OR COMPOSITE PLAN	
RESERVATIONS	
ORIGINAL SHORELINE	
MARSH OR MUSKEG	
MINES	
TRAVERSE MONUMENT	

DISPOSITION OF CROWN LANDS

TYPE OF DOCUMENT	SYMBOL
PATENT, SURFACE & MINING RIGHTS	
" SURFACE RIGHTS ONLY	
" MINING RIGHTS ONLY	
LEASE, SURFACE & MINING RIGHTS	
" SURFACE RIGHTS ONLY	
" MINING RIGHTS ONLY	
LICENCE OF OCCUPATION	
ORDER-IN-COUNCIL	
RESERVATION	
CANCELLED	
SAND & GRAVEL	
LAND USE PERMITS FOR COMMERCIAL TOURISM/OUTPOST CAMPS	

NOTE: MINING RIGHTS IN PARCELS PATENTED PRIOR TO MAY 9, 1912, SET OUT IN ORIGINAL PATENTS BY THE PUBLIC LANDS ACT, R.S.O. 1970, CHAP. 380, SEC. 43, SUBSEC. 1.

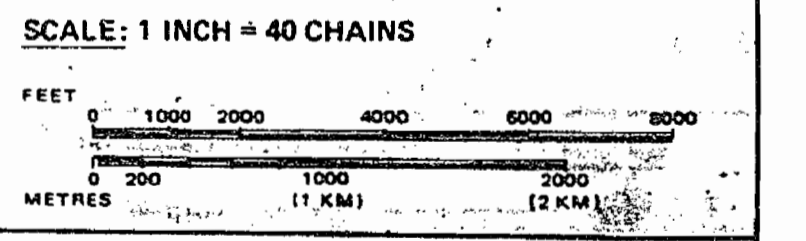

AREA

EASTSIDE LAKE

M.N.R. ADMINISTRATIVE DISTRICT
GERALDTON

MINING DIVISION
THUNDER BAY

LAND TITLES / REGISTRY DIVISION
THUNDER BAY/COCHRANE

Ministry of Natural Resources
Land Management Branch
Ontario
November 2, 1981

DATE: SEPT. 23, 1981
G-241

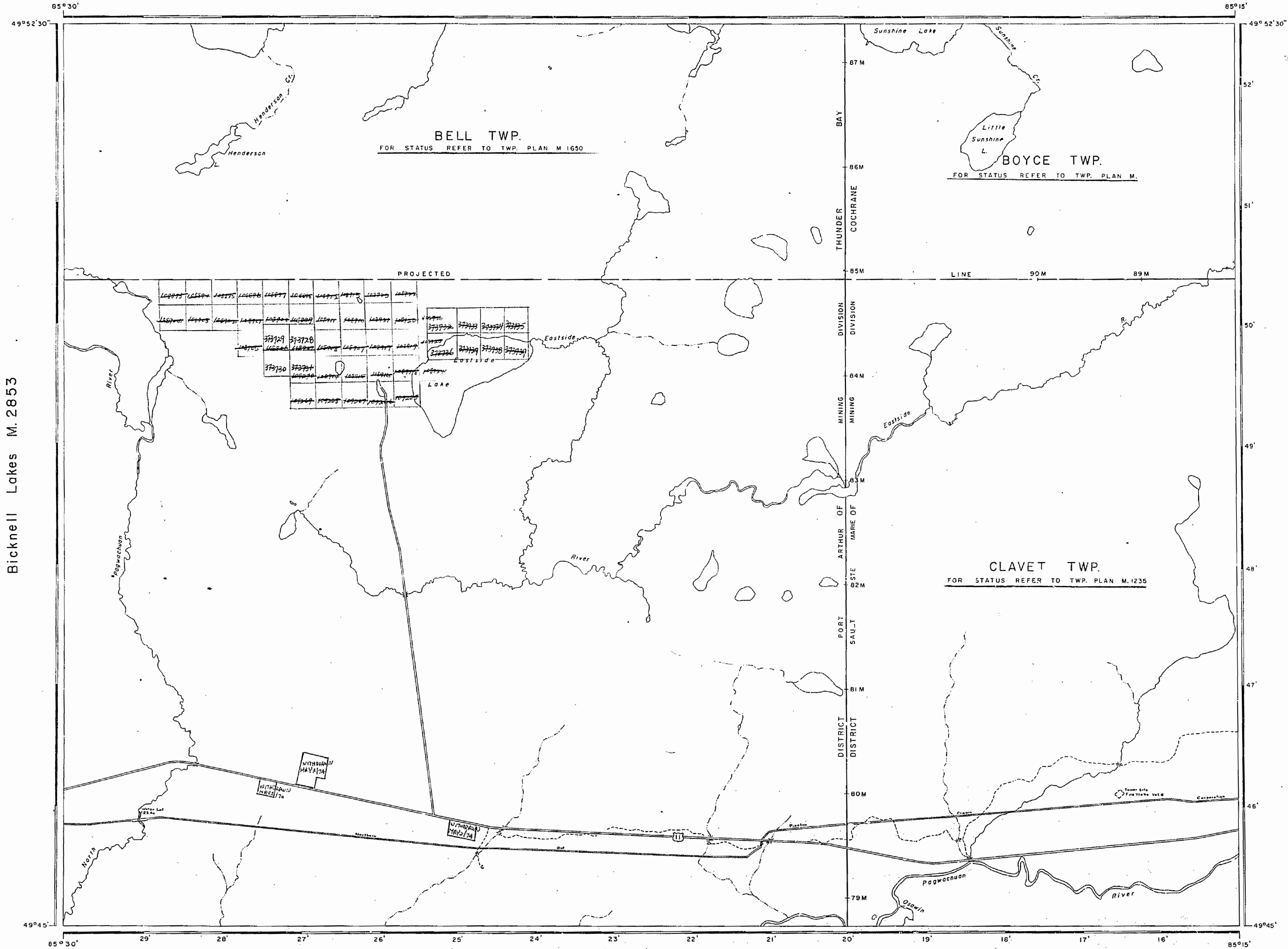

Bicknell Lakes M.2853

Loughlan Lake M.2857

AREA OF
EASTSIDE LAKE

DISTRICT OF
THUNDER BAY - COCHRANE

PORT ARTHUR
SAULT STE. MARIE
MINING DIVISION

SCALE: 1-INCH = 40 CHAINS

LEGEND

- PATENTED LAND Ⓟ
- CROWN LAND SALE C.S.
- LEASES Ⓛ
- LOCATED LAND L.O.
- LICENSE OF OCCUPATION M.O.
- MINING RIGHTS ONLY M.R.O.
- SURFACE RIGHTS ONLY S.R.O.
- ROADS —
- IMPROVED ROADS —
- KING'S HIGHWAYS —
- RAILWAYS —
- POWER LINES —
- MARSH OR MUSKEG —
- MINES Ⓧ
- CANCELLED C.

NOTES

400' Surface Rights reservation around all
Lakes & Rivers
WITHDRAWN AREAS - SEE LANDROLL EASTSIDE LAKE

1962



GER.

PLAN NO. **M.2859**

DEPARTMENT OF MINES

— ONTARIO —

2859

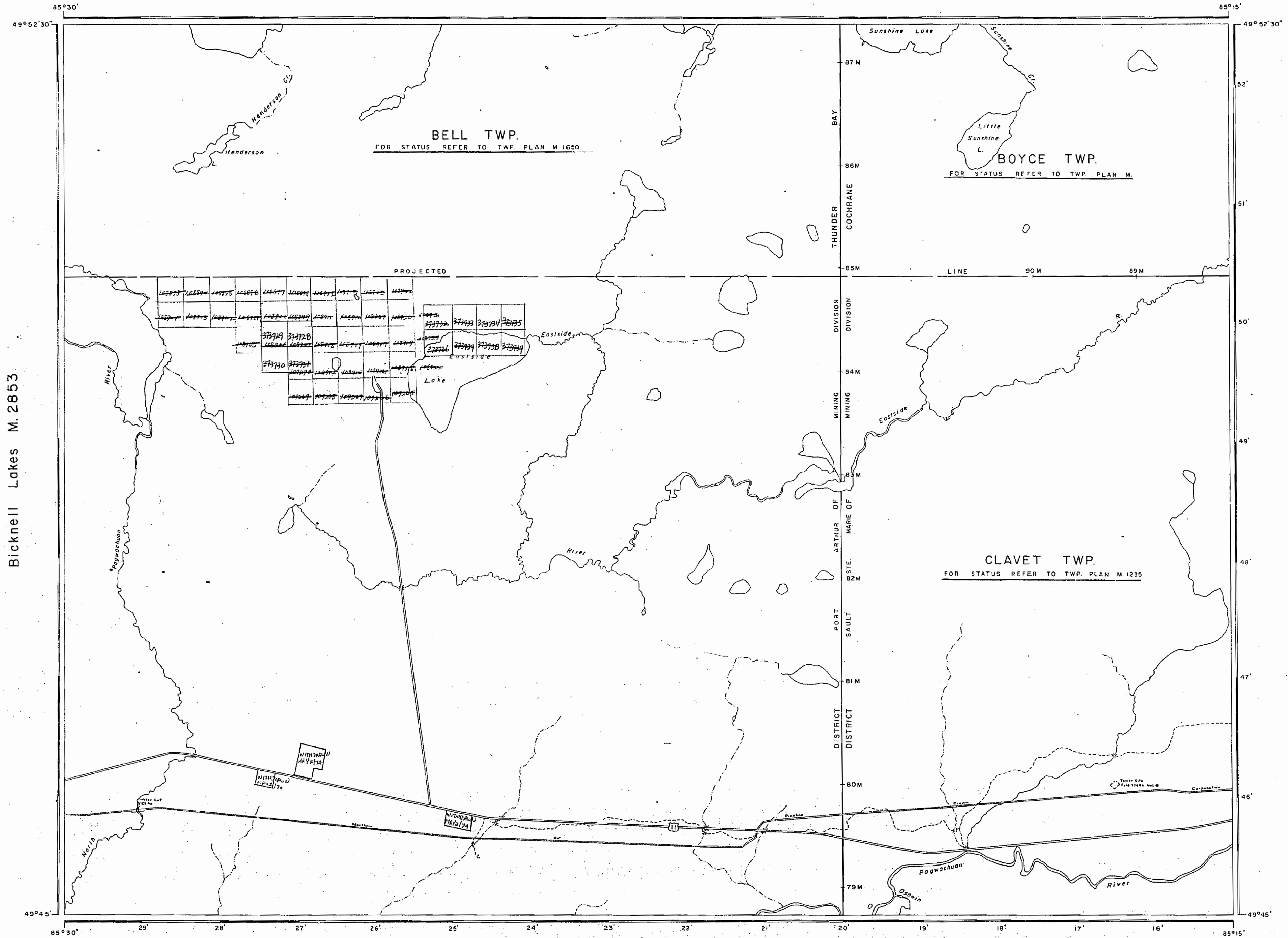

Bicknell Lakes M. 2853

Loughlan Lake M. 2857

AREA OF
EASTSIDE LAKE

DISTRICT OF
THUNDER BAY - COCHRANE

PORT ARTHUR
SAULT STE. MARIE
MINING DIVISION

SCALE: 1-INCH = 40 CHAINS

LEGEND

- | | |
|-----------------------|--------|
| PATENTED LAND | Ⓟ |
| CROWN LAND SALE | C.S. |
| LEASES | Ⓛ |
| LOCATED LAND | Loc |
| LICENSE OF OCCUPATION | L.O. |
| MINING RIGHTS ONLY | M.R.O. |
| SURFACE RIGHTS ONLY | S.R.O. |
| ROADS | — |
| IMPROVED ROADS | — |
| KING'S HIGHWAYS | — |
| RAILWAYS | — |
| POWER LINES | — |
| MARSH OR MUSKEG | — |
| MINES | Ⓧ |
| CANCELLED | C. |

NOTES

400' Surface Rights reservation around all Lakes & Rivers
WITHDRAWN AREAS - SEE LANDROLL EASTSIDE LAKE

1962

PORT ARTHUR
RECEIVED
DEC 11 1962
MINING DIVISION

PLAN NO. **M. 2859**

DEPARTMENT OF MINES
— ONTARIO —