

GOLDER LAKE AREA M-3234

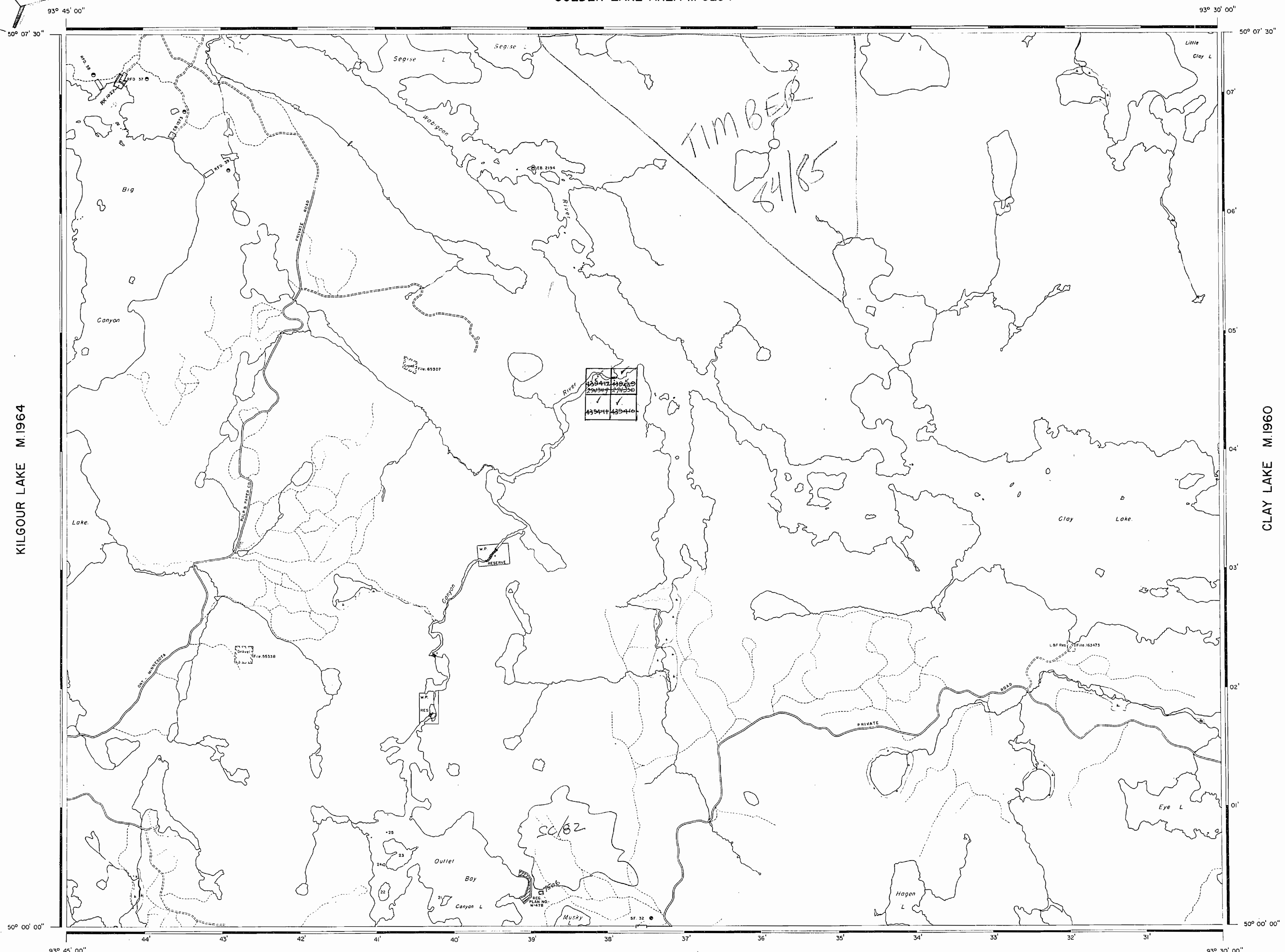

AREA OF
EYE LAKE
 DISTRICT OF
KENORA
 KENORA
 MINING DIVISION
 SCALE: 1-INCH = 40 CHAINS

LEGEND

PATENTED LAND	Ⓟ or Ⓢ
PATENTED FOR SURFACE RIGHTS ONLY	Ⓟ
LEASES	Ⓢ
LICENSE OF OCCUPATION	L.O.
CROWN LAND SALE	C.S.
LOCATED LAND	Loc.
CANCELLED	C.
MINING RIGHTS ONLY	M.R.O.
SURFACE RIGHTS ONLY	S.R.O.
HIGHWAY & ROUTE No.	Ⓜ
ROADS	—
TRAILS	- - -
RAILWAYS	Ⓜ
POWER LINES	Ⓜ
MARSH OR MUSKEG	Ⓜ
MINES	Ⓜ

*used only with summer resort locations or when space is limited

NOTES

400' Surface Rights Reservation Around the Shores of All Lakes and Rivers

KENORA
 FILED:
 REC'D. MAR - 3 1971
 RECEIPT No.
MINING DIVISION
 Oct 6/72
 Nov. 10/72
 Sep. 17/76

Abolished May 29/84

NATIONAL TOPOGRAPHIC SERIES 52K
 PLAN NO. **M-3236**
 ONTARIO
 DEPARTMENT OF MINES
 AND NORTHERN AFFAIRS

KILGOUR LAKE M.1964

CLAY LAKE M.1960

GOLDER LAKE AREA G-2582

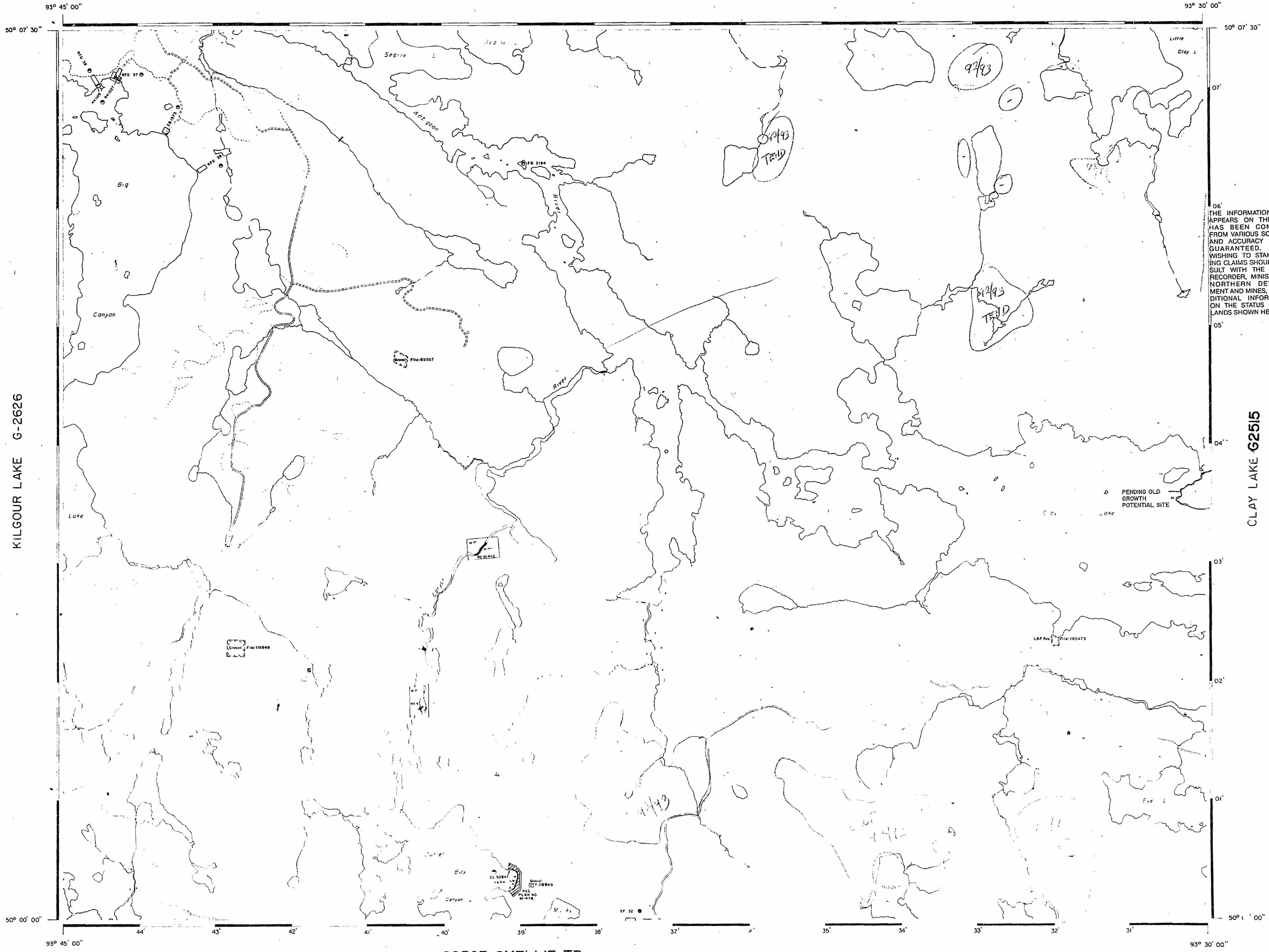

LEGEND

- HIGHWAY AND ROUTE No.
- OTHER ROADS
- TRAILS
- SURVEYED LINES:
 - TOWNSHIPS, BASE LINES, ETC.
 - LOTS, MINING CLAIMS, PARCELS, ETC.
- UNSURVEYED LINES:
 - LOT LINES
 - PARCEL BOUNDARY
 - MINING CLAIMS ETC.
- RAILWAY AND RIGHT OF WAY
- UTILITY LINES
- NON-PERENNIAL STREAM
- FLOODING OR FLOODING RIGHTS
- SUBDIVISION OR COMPOSITE PLAN RESERVATIONS
- ORIGINAL SHORELINE
- MARSH OR MUSKEG
- MINES
- TRAVERSE MONUMENT
- TOURIST CAMPS

DISPOSITION OF CROWN LANDS

TYPE OF DOCUMENT	SYMBOL
PATENT, SURFACE & MINING RIGHTS	
" SURFACE RIGHTS ONLY	
" MINING RIGHTS ONLY	
LEASE, SURFACE & MINING RIGHTS	
" SURFACE RIGHTS ONLY	
" MINING RIGHTS ONLY	
LICENCE OF OCCUPATION	
ORDER-IN-COUNCIL	
RESERVATION	
CANCELLED	
SAND & GRAVEL	

NOTE: MINING RIGHTS IN PARCELS PATENTED PRIOR TO MAY 6, 1912, VESTED IN ORIGINAL PATENTEE BY THE PUBLIC LANDS ACT, R.S.O. 1970, CHAP. 380, SEC. 63, SUBSEC. 1.

REFERENCES

AREAS WITHDRAWN FROM DISPOSITION

- M.R.O. - MINING RIGHTS ONLY
- S.R.O. - SURFACE RIGHTS ONLY
- M.+S. - MINING AND SURFACE RIGHTS

Description	Order No.	Date	Disposition	File
Province of Ontario	100	1912	Order	100

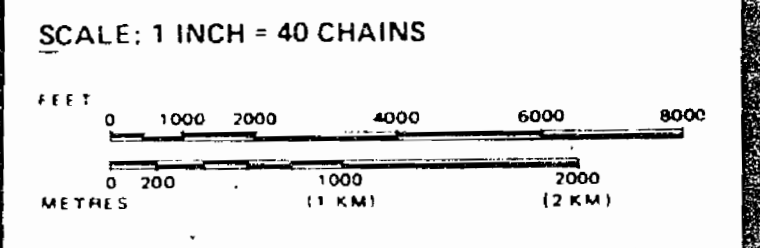
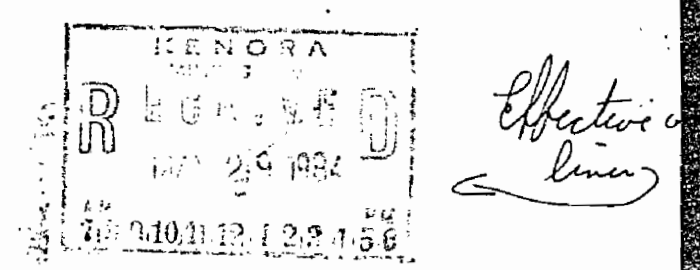

AREA
EYE LAKE

M.N.R. ADMINISTRATIVE DISTRICT
DRYDEN
MINING DIVISION
KENORA
LAND TITLES / REGISTRY DIVISION
KENORA

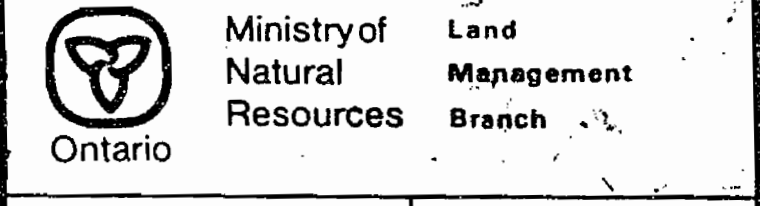

Date: JANUARY, 1984
Number: **G-2580**
M-3236

G2583 SMELLIE TP.

GOLDER LAKE AREA G-2582

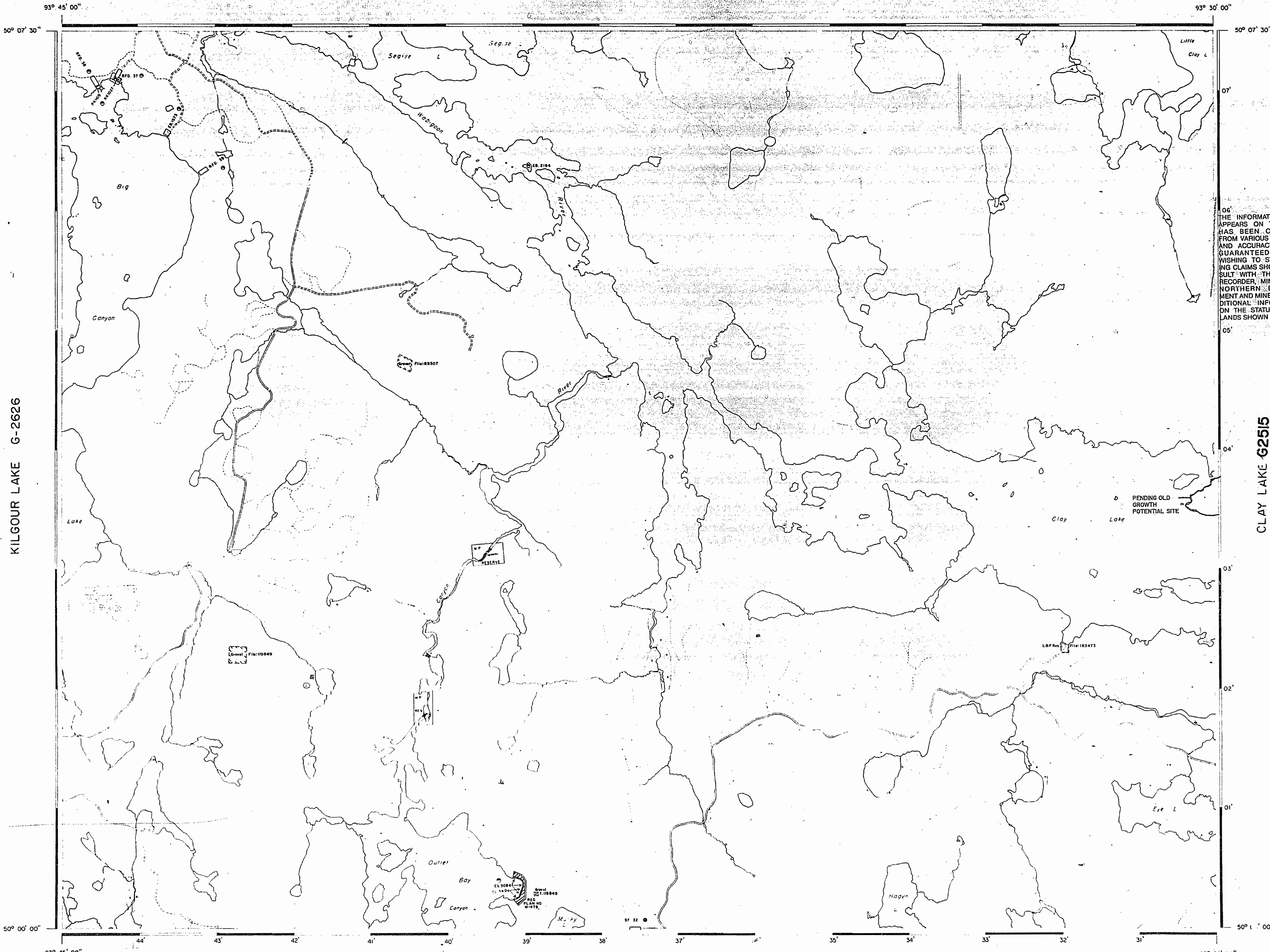

KILGOUR LAKE G-2626

CLAY LAKE G2515

G2583 SMELLIE TP.

LEGEND

- HIGHWAY AND ROUTE No.
- OTHER ROADS
- TRAILS
- SURVEYED LINES:
 - TOWNSHIPS, BASE LINES, ETC.
 - LOTS, MINING CLAIMS, PARCELS, ETC.
- UNSURVEYED LINES:
 - LOT LINES
 - PARCEL BOUNDARY
 - MINING CLAIMS ETC.
- RAILWAY AND RIGHT OF WAY
- UTILITY LINES
- NON-PERENNIAL STREAM
- FLOODING OR FLOODING RIGHTS
- SUBDIVISION OR COMPOSITE PLAN RESERVATIONS
- ORIGINAL SHORELINE
- MARSH OR MUSKEG
- MINES
- TRAVERSE MONUMENT
- TOURIST CAMPS

DISPOSITION OF CROWN LANDS

TYPE OF DOCUMENT	SYMBOL
PATENT, SURFACE & MINING RIGHTS	
" SURFACE RIGHTS ONLY	
" MINING RIGHTS ONLY	
LEASE, SURFACE & MINING RIGHTS	
" SURFACE RIGHTS ONLY	
" MINING RIGHTS ONLY	
LICENCE OF OCCUPATION	
ORDER-IN-COUNCIL	
RESERVATION	
CANCELLED	
SAND & GRAVEL	

NOTE: MINING RIGHTS IN PARCELS PATENTED PRIOR TO MAY 6, 1913, VESTED IN ORIGINAL PATENTEE BY THE PUBLIC LANDS ACT, R.S.O. 1970, CHAP. 380, SEC. 63, SUBSEC. 1.

REFERENCES

AREAS WITHDRAWN FROM DISPOSITION

- M.R.O. - MINING RIGHTS ONLY
- S.R.O. - SURFACE RIGHTS ONLY
- M.+S. - MINING AND SURFACE RIGHTS

Description	Order No.	Date	Disposition	File
Phosphates	3097	1984	RESERVED	FDL/45

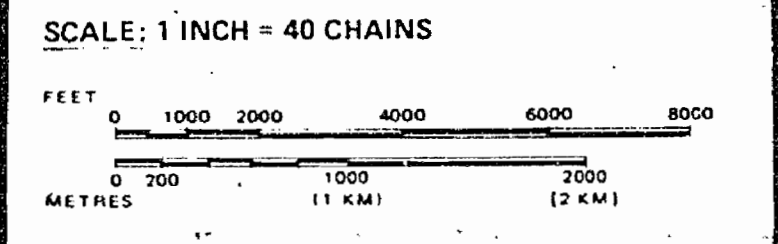
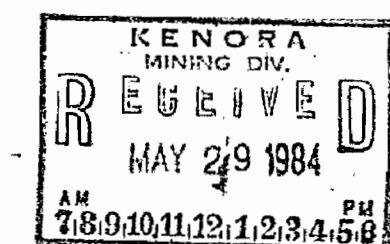

AREA
EYE LAKE
M.N.R. ADMINISTRATIVE DISTRICT
DRYDEN
MINING DIVISION
KENORA
LAND TITLES / REGISTRY DIVISION
KENORA

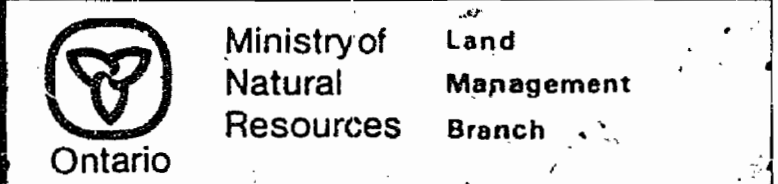

Date JANUARY, 1984
Number
M-3236
G-2580

EYE LAKE AREA G 2580