

1712

1712

M-1712

EXTON TWP.

NAKINA TWP

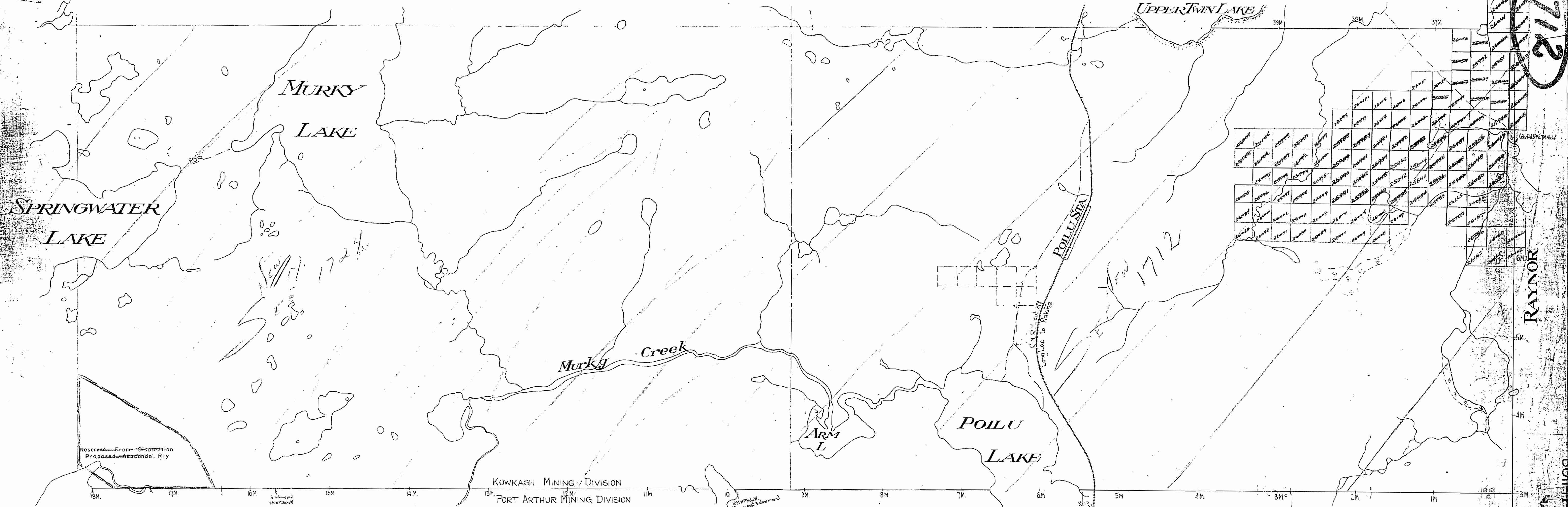

Reserved From Disposition Proposed Anaconda Rly

SURFACE RIGHTS ONLY reserved on land indicated, thus to the Anaconda Iron Ore (Ontario) Ltd. L.B.F. File 165414

RESERVATIONS REMOVED FROM LANDS WITHIN THE AREA OUTLINED IN GREEN

KOWKASH MINING DIVISION
PORT ARTHUR MINING DIVISION

Surface reservations 200' wide by Dept of L & R shown hereon thus

1961
SCALE - 40 CHAINS = 1 INCH.

Poilu Area M-1712

POILU AREA

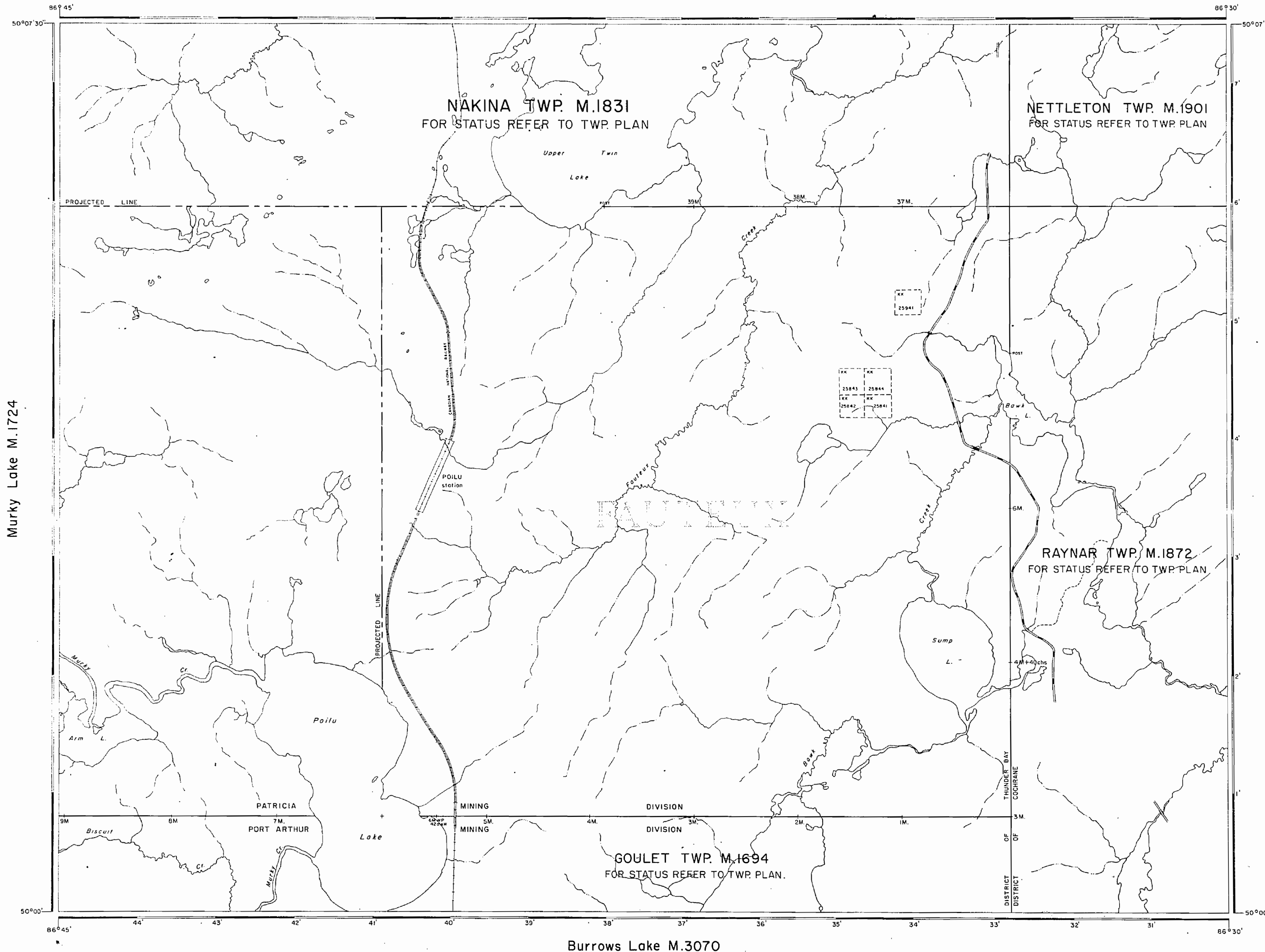

FAUTEUX TWP.
and
POILU L. AREA

DISTRICT OF
THUNDER BAY

PATRICIA-PORT ARTHUR
MINING DIVISION

SCALE: 1-INCH = 40 CHAINS

LEGEND

PATENTED LAND	Ⓢ
CROWN LAND SALE	C.S.
LEASES	Ⓛ
LOCATED LAND	Loc.
LICENSE OF OCCUPATION	L.O.
MINING RIGHTS ONLY	M.R.O.
SURFACE RIGHTS ONLY	S.R.O.
ROADS	—
IMPROVED ROADS	—
KING'S HIGHWAYS	—
RAILWAYS	—
POWER LINES	—
MARSH OR MUSKOGEE	—
MINES	X
CANCELLED	C.

NOTES

400' surface rights reservation around all lakes
and rivers.

1967

PLAN NO. M.1712

DEPARTMENT OF MINES

— ONTARIO —

1712

EXTON TWP.

NAKINA TWP.

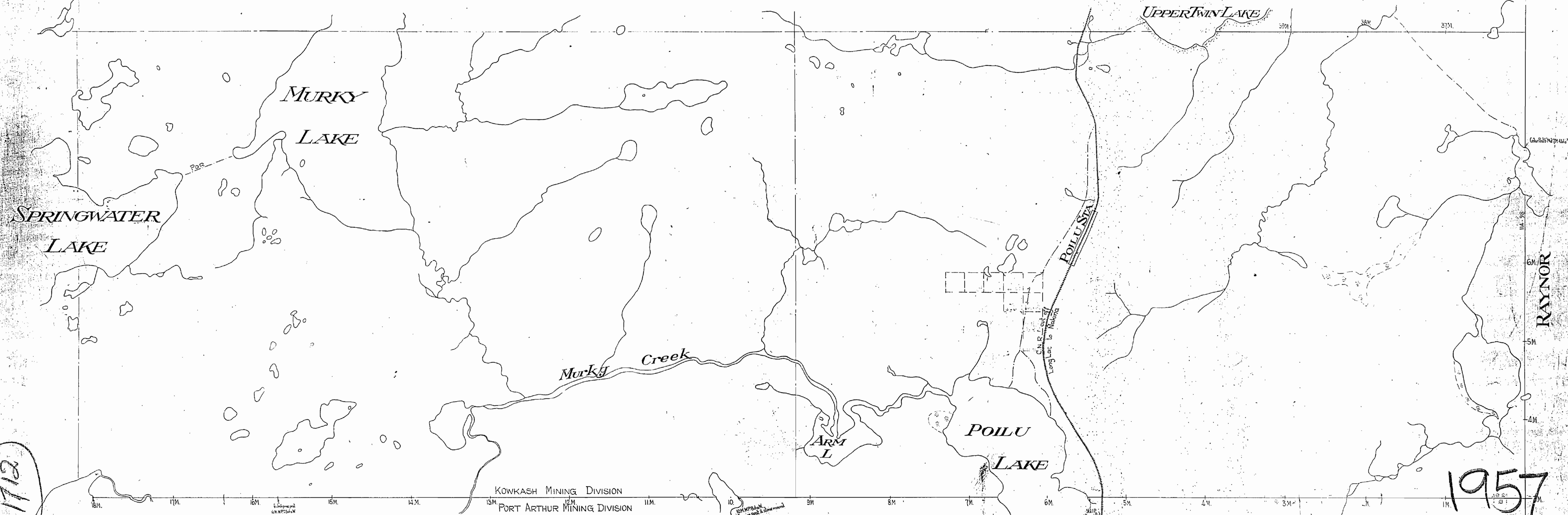

1712

1957

KOWKASH MINING DIVISION
PORT ARTHUR MINING DIVISION

Surface reservations 200' wide by Dept of L & R
Shown hereon thus ~~-----~~

SCALE - 40 CHAINS = 1 INCH.



POILU AREA - M. 1515