

Bastedo Twp. OFFICE USE ONLY

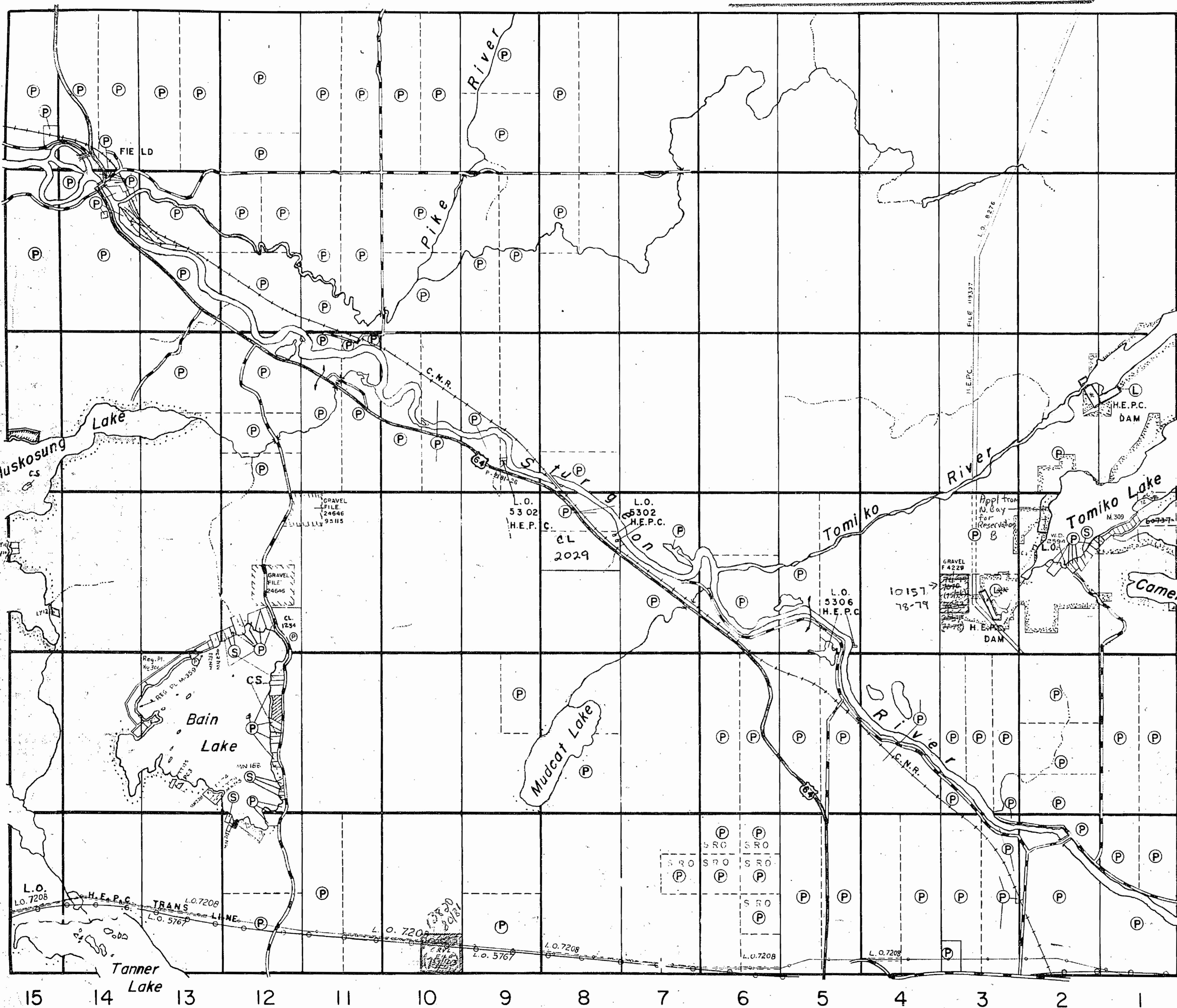

VI

V

IV

III

II

I

Grant Twp.

THE TOWNSHIP
OF

FIELD

DISTRICT OF
NIPISSING

SUBURBAN
MINING DIVISION

SCALE: 1-INCH= 40 CHAINS

LEGEND

PATENTED LAND	(P)
CROWN LAND SALE	C.S.
LEASES	(L)
LOCATED LAND	Loc.
LICENSE OF OCCUPATION	L.O.
MINING RIGHTS ONLY	M.R.O.
SURFACE RIGHTS ONLY	S.R.O.
ROADS	—
IMPROVED ROADS	—
KINGS HIGHWAYS	—
RAILWAYS	—
POWER LINES	—
MARSH OR MUSKEG	—
MINES	—

NOTES

400' Surface Rights Reservation around all Lakes and Rivers.

Flooding rights to contour 104.50' (C.L. 2445) to H.E.P.C. shown thus

* HY 152 Parts 1 & 2 Ontario Hydro Plan 36R-5945 (See Land Rell)
** HY 153 Part 1 Ontario Hydro Plan 36R-5946 (See Land Rell)

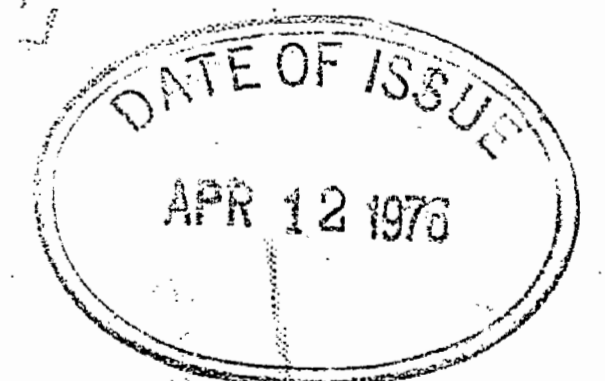

FIELD

PLAN NO.- M 808

MINISTRY OF NATURAL RESOURCES
SURVEYS AND MAPPING BRANCH

Springer Twp.

Bastedo Twp.

THE TOWNSHIP
OF

FIELD

DISTRICT OF
NIPISSING

LARDER LAKE
MINING DIVISION

SCALE: 1-INCH=40 CHAINS

LEGEND

PATENTED LAND	(P)
CROWN LAND SALE	C.S.
LEASES	(L)
LOCATED LAND	Loc.
LICENSE OF OCCUPATION	L.O.
MINING RIGHTS ONLY	M.R.O.
SURFACE RIGHTS ONLY	S.R.O.
ROADS	—
IMPROVED ROADS	—
KINGS HIGHWAYS	—
RAILWAYS	—
POWER LINES	—
MARSH OR MUSKEG	—
MINES	—

NOTES

400' Surface Rights Reservation around
all Lakes and Rivers.

Flooding rights to contour 104.50' (C.L. 2445) to
H.E.P.C. shown thus

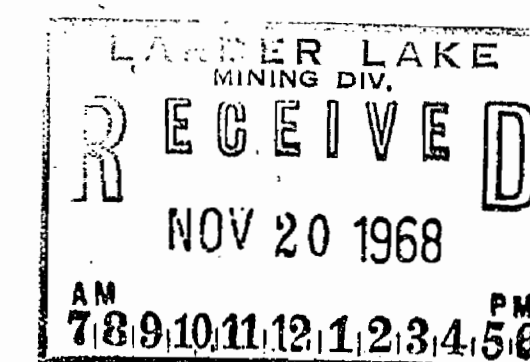

FIELD

PLAN NO.- M 808

DEPARTMENT OF MINES
— ONTARIO —

VI

V

IV

III

II

I

Grant Twp.

Badgerow Twp.

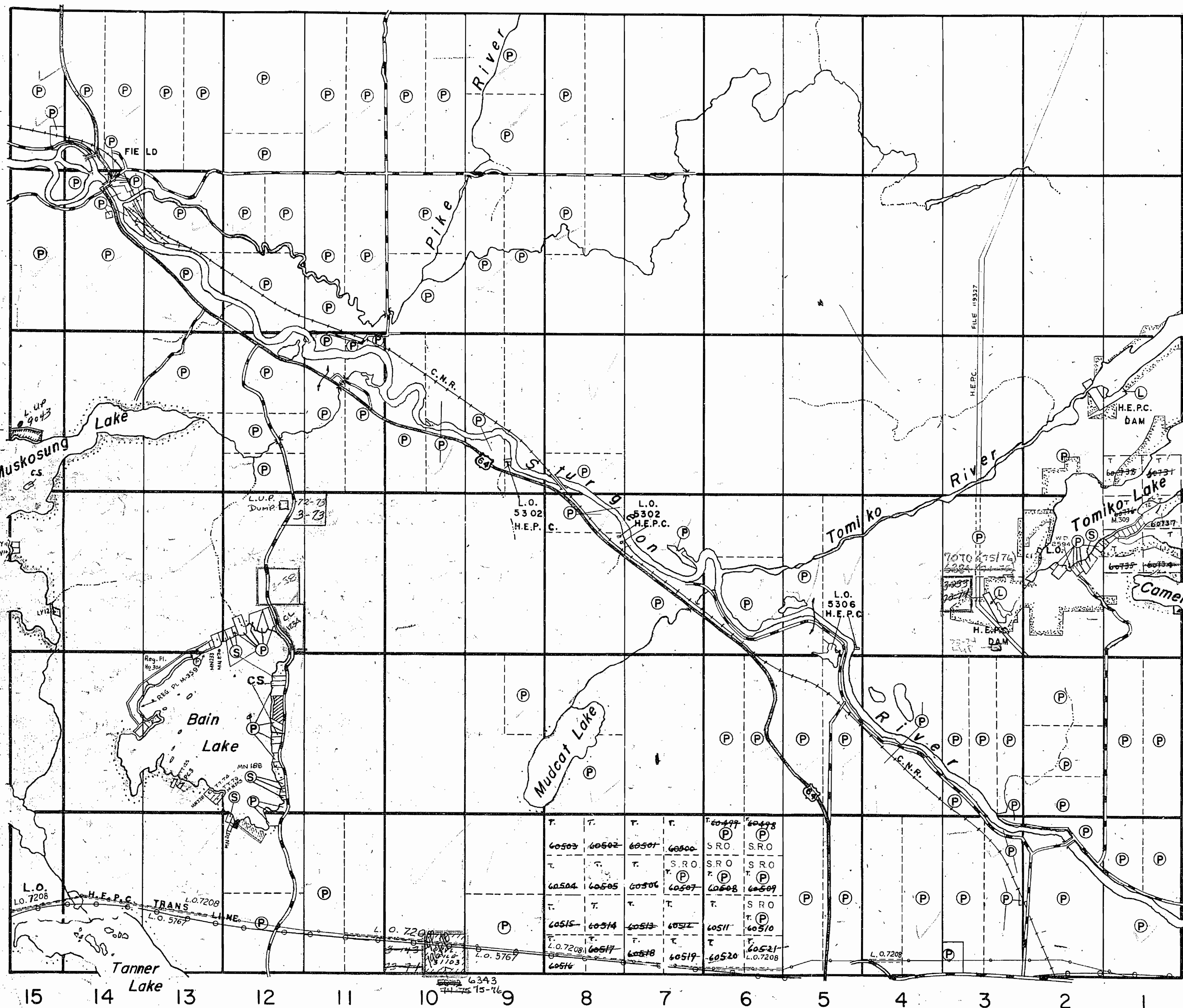

Springer Twp.

10

8

6

4

2

2

4

6

8

10

MAP SYMBOLLOGY

Aerial Cowlway	Pipeline
Boundary	(above ground)
International	Railroad
Interprovincial	Single Track
Distict, Township	Double Track
Indian Reserve	Abandonment
Approach	Turntable
Lat. Concession	Road
Approach	Highway, County
Park Boundary	Township
Bridge	Trail, Beach Head
Road, Railroad	(portage, city?)
Building	Rapids
Chimney	Double line river
Cut, Pit, Pile	with multiple rapids
Contours	Interpretation
Interpretation	Approach
Approach	Depression
Depression	Control Points
Control Points	Horizontal
Horizontal	Vertical
Vertical	Culvert
Culvert	Falls
Falls	Double line river
Double line river	Fence, Hedge,
Fence, Hedge,	Wall
Wall	Feature Outline
Feature Outline	(construction features,
(construction features,	etc.)
etc.)	Flooded Land
Flooded Land	Lock
Lock	Marsh or Swamp
Marsh or Swamp	Moss
Moss	Mine Head Frame
Mine Head Frame	Outcrop

AREAS WITHDRAWN FROM DISPOSITION

M.R.O. - MINING RIGHTS ONLY				
S.R.O. - SURFACE RIGHTS ONLY				
M.+ S. - MINING AND SURFACE RIGHTS				
Description	Order No.	Date	Disposition	File
(R)		25/09/69	S.R.O.	5654

NOTE:
FLOODING RIGHTS UP TO CONTOUR ELEVATION
104.50' TO ONTARIO HYDRO SHOWN THUS
CROWN LEASE 2445.

Licence of Occupation No. 9836
(Flooded Purpose as necessary for the
generation of Water Power) in Lots 1 & 2
Cons. III & IV and Lot 1 Cons. V
"Cheboganog Lake" - See Fall Township
Land Roll File for Plan.

BASTEDO TWP.

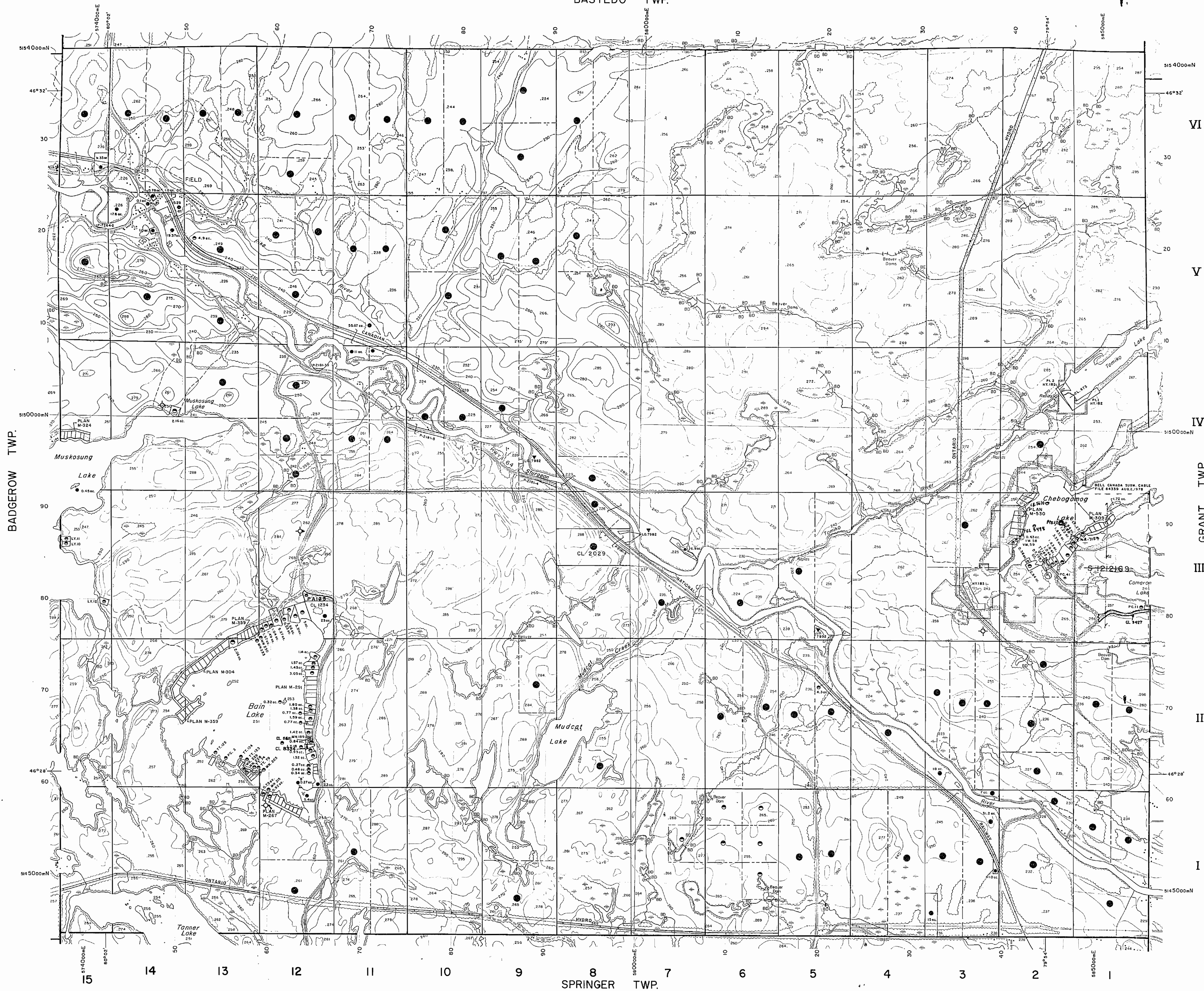

LEGEND

HIGHWAY AND ROUTE No.	
OTHER ROADS	
TRAILS	
SURVEYED LINES:	
TOWNSHIPS, BASE LINES, ETC.	
LOTS, MINING CLAIMS, PARCELS, ETC.	
UNSURVEYED LINES:	
LOT LINES	
PARCEL BOUNDARY	
MINING CLAIMS ETC.	
RAILWAY AND RIGHT OF WAY	
UTILITY LINES	
NON PERENNIAL STREAM	
FLOODING OR FLOODING RIGHTS	
SUBDIVISION OR COMPOSITE PLAN	
RESERVATIONS	
ORIGINAL SHORELINE	
MARSH OR MUSKEG	
MINES	
TRAVERSE MONUMENT	

DISPOSITION OF CROWN LANDS

TYPE OF DOCUMENT	SYMBOL
PATENT, SURFACE & MINING RIGHTS	
" SURFACE RIGHTS ONLY	
" MINING RIGHTS ONLY	
LEASE, SURFACE & MINING RIGHTS	
" SURFACE RIGHTS ONLY	
" MINING RIGHTS ONLY	
LICENCE OF OCCUPATION	
ORDER-IN-COUNCIL	
RESERVATION	
CANCELLED	
SAND & GRAVEL	
LAND USE PERMIT	

NOTE: MINING RIGHTS IN PARCELS PATENTED PRIOR TO MAY 1, 1913 VESTED IN ORIGINAL PATENTEE BY THE PUBLIC LANDS ACT, R.S.O. 1970, CHAP. 380, SEC. 63, SUBSEC. 1.

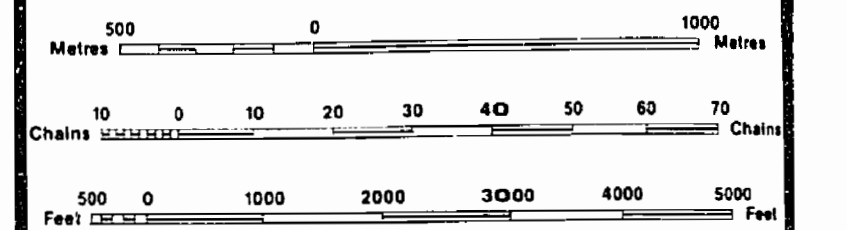

SCALE 1:20 000

GRID ZONE 17

DATE OF ISSUE

JUN 16 1998

PROVINCIAL RECORDING
OFFICE - SUDBURY

THE INFORMATION THAT
APPEARS ON THIS MAP
HAS BEEN COMPILED
FROM VARIOUS SOURCES,
AND ACCURACY IS NOT
GUARANTEED. THOSE
WISHING TO STAKE
MINING CLAIMS SHOULD
CONSULT WITH THE MINING
RECORDER, MINISTRY OF
NORTHERN DEVELOP-
MENT AND MINES, FOR AD-
DITIONAL INFORMATION
ON THE STATUS OF THE
LANDS SHOWN HEREON.

TOWNSHIP

FIELD

M.N.R. ADMINISTRATIVE DISTRICT

NORTH BAY

MINING DIVISION

SUDBURY

LAND TITLES / REGISTRY DIVISION

NIPISSING



Original
Compilation: JULY, 1985.

Revised:

Land
Management
Branch

Number

G-2840

* June 1984

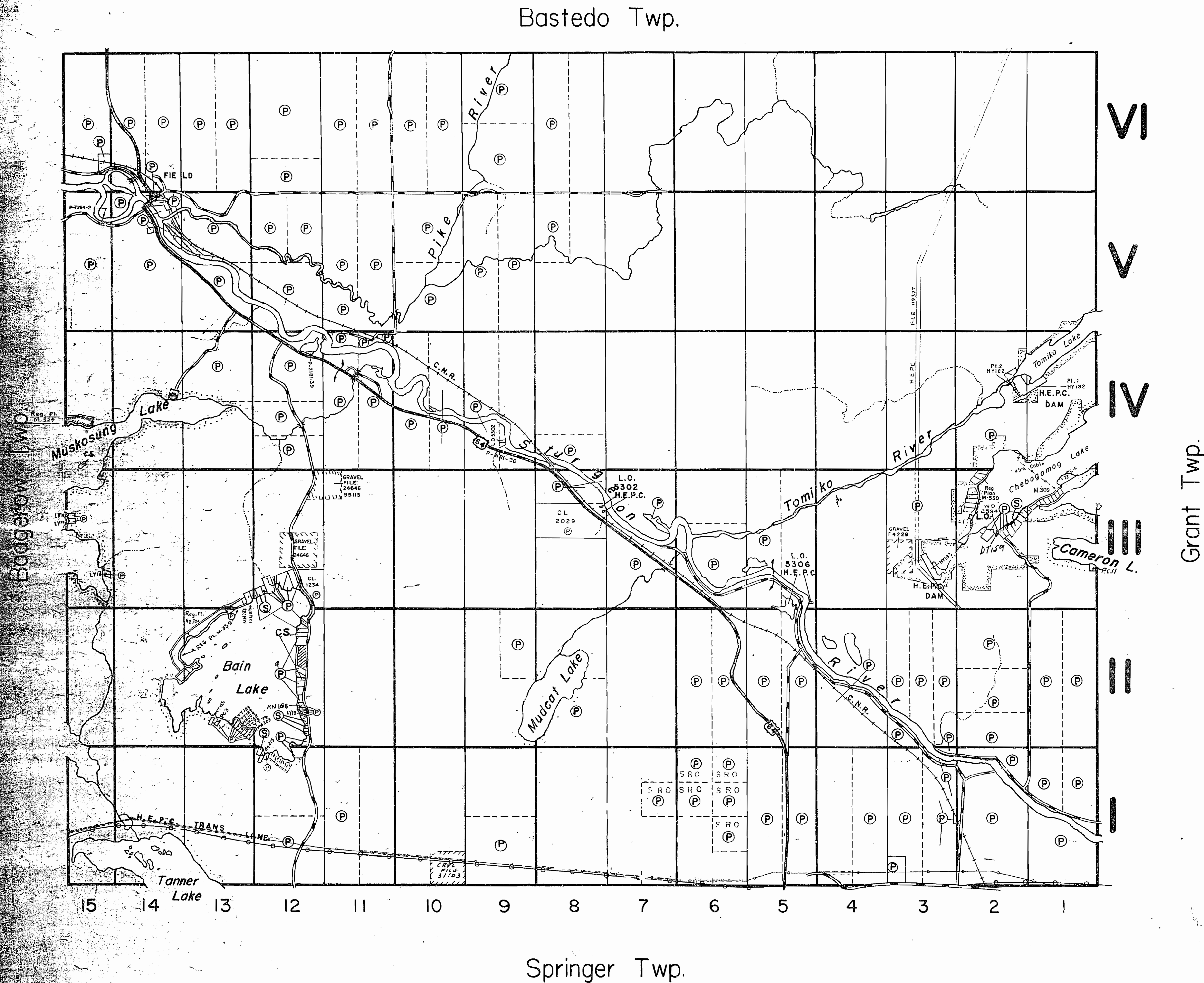

THE TOWNSHIP
OF
FIELD
DISTRICT OF
NIPISSING
SUDOUR
MINING DIVISION
SCALE: 1-INCH=40 CHAINS

LEGEND

PATENTED LAND	(P)
CROWN LAND SALE	C.S.
LEASES	(L)
LOCATED LAND	L.O.
LICENSE OF OCCUPATION	L.O.
MINING RIGHTS ONLY	M.R.O.
SURFACE RIGHTS ONLY	S.R.O.
ROADS	—
IMPROVED ROADS	—
KINGS HIGHWAYS	—
RAILWAYS	—
POWER LINES	—
MARSH OR MUSKEG	—
MINES	*

NOTES

400' Surface Rights Reservation around all Lakes and Rivers.

Flooding rights to contour 104.50' (C.L. 2445) to H.E.P.C. shown thus: —

PLAN 36R-6730
DT 159

* IN SERVICE 1984-06 - UN

FIELD
PLAN NO.- M 808
ONTARIO
MINISTRY OF NATURAL RESOURCES
SURVEY AND MAPPING BRANCH

* June 1984

Bastedo Twp.

THE TOWNSHIP OF
OF

FIELD

DISTRICT OF
NIPISSING

SUBDIVISION
MINING DIVISION

SCALE: 1-INCH=40 CHAINS

LEGEND

PATENTED LAND	P
CROWN LAND SALE	C.S.
LEASES	L
LOCATED LAND	L.O.
LICENSE OF OCCUPATION	L.O.
MINING RIGHTS ONLY	M.R.O.
SURFACE RIGHTS ONLY	S.R.O.
ROADS	—
IMPROVED ROADS	—
KINGS HIGHWAYS	—
RAILWAYS	—
POWER LINES	—
MARSH OR MUSKEG	—
MINES	—

NOTES

400' Surface Rights Reservation around
all Lakes and Rivers.

Flooding rights to contour 104.50' (C.L. 2445) to
H.E.P.C. shown thus —

PLAN 36R-6730,
DT.159

* IN SERVICE R8406 - W

FIELD

PLAN NO.- M 808

ONTARIO
MINISTRY OF NATURAL RESOURCES
SURVEYING AND MAPPING BRANCH

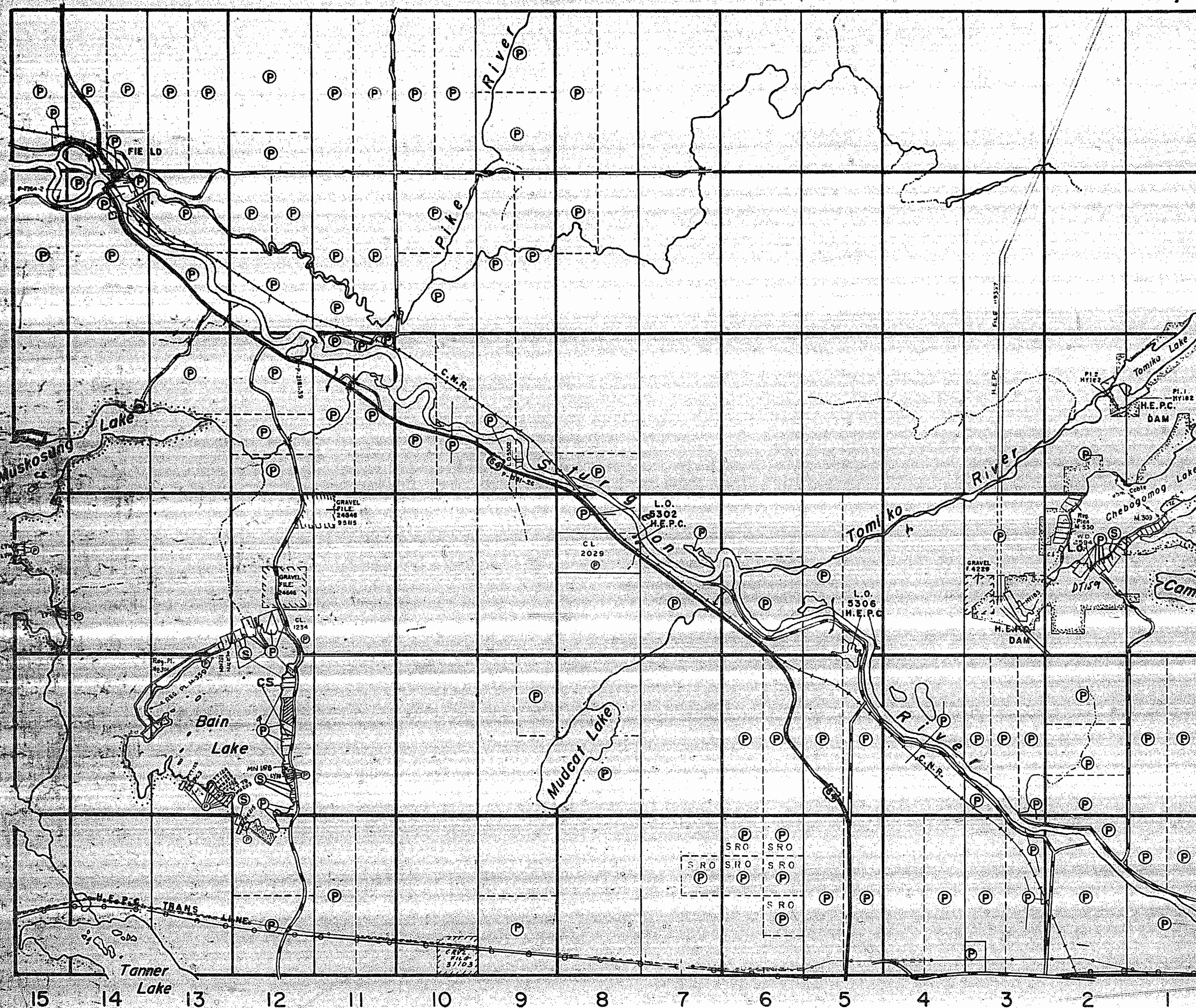

MAP SYMBOLS

Aerial Cableway	Pipeline
Boundary	Railroad
Intersecting	Single Track
Double Track	Double Track
Distance, Township	Abandonment
Indian Reserve	Turbine
Approximate	Road
Left, Concession	Highway, County
Approximate	Township
Park Boundary	Access Road of doubtful maintenance or significant movement
Bridge	Road, Beach Road (portage, strip)
Road, Railroad	Rapids
Building	Double line river with multiple rapids
Chimney	Shoal
Cliff, Pit, Pile	Reservoir
Contours	River, Stream, Canal
Intersecting	Approximate seasonal direction of flow
Approximate	Rock
Depression	Shoal
Control Points	Spot Elevation
Horizontal	Tower
Vertical	Transmission Line
Culvert	Pole
Falls	Feature Outline
Double line river	Flooded Land
Fence, Hedge, Wall	Lock
Marsh or Swamp	Marsh or Swamp
Most	Most
Mine Head Frame	Mine Head Frame
Outcrop	Outcrop

AREAS WITHDRAWN FROM DISPOSITION

M.R.O. - MINING RIGHTS ONLY
S.R.O. - SURFACE RIGHTS ONLY
M+S. - MINING AND SURFACE RIGHTS

Description Order No. Date Disposition File
25/09/69 S.R.O. 56543

NOTE:
FLOODING RIGHTS UP TO CONTOUR ELEVATION 104.50' TO ONTARIO HYDRO SHOWN THUS
CROWN LEASE 2445.

License of Occupation No. 9836
(Flooded Purpose as necessary for the generation of Water Power) in Lots 1 & 2
Cone. III & IV and Lot 1, Cone. V
"Chebogomog Lake" - See Fall Township Land Roll File for Plan.

BASTEDO TWP.

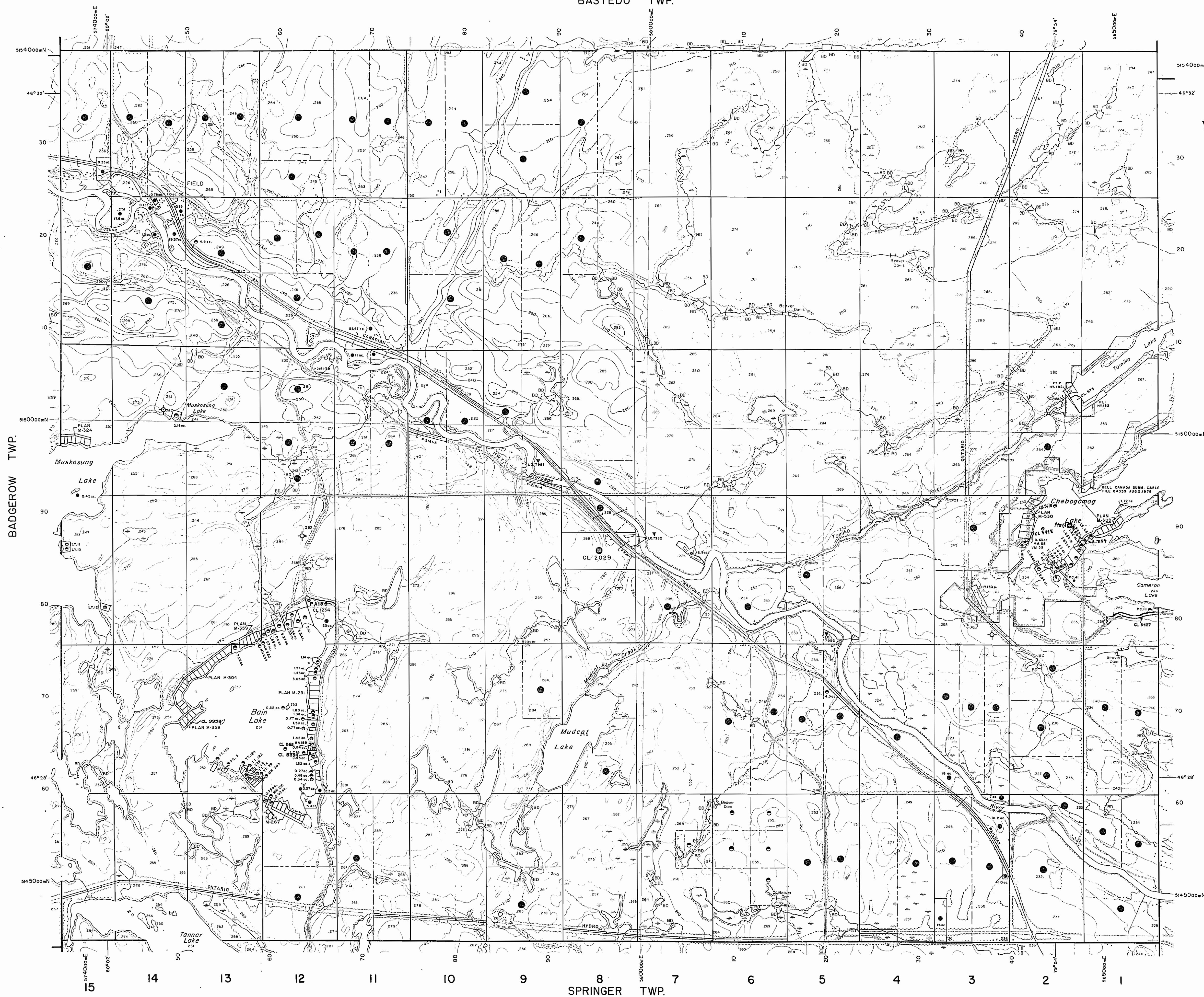

LEGEND

HIGHWAY AND ROUTE No.	
OTHER ROADS	
TRAILS	
SURVEYED LINES:	
TOWNSHIPS, BASE LINES, ETC.	
LOTS, MINING CLAIMS, PARCELS, ETC.	
UNSURVEYED LINES:	
LOT LINES	
PARCEL BOUNDARY	
MINING CLAIMS ETC.	
RAILWAY AND RIGHT OF WAY	
UTILITY LINES	
NON-PERENNIAL STREAM	
FLOODING OR FLOODING RIGHTS	
SUBDIVISION OR COMPOSITE PLAN	
RESERVATIONS	
ORIGINAL SHORELINE	
MARSH OR MUSKEG	
MINES	
TRAVERSE MONUMENT	

DISPOSITION OF CROWN LANDS

TYPE OF DOCUMENT	SYMBOL
PATENT, SURFACE & MINING RIGHTS	●
" SURFACE RIGHTS ONLY	○
" MINING RIGHTS ONLY	○
LEASE, SURFACE & MINING RIGHTS	○
" SURFACE RIGHTS ONLY	○
" MINING RIGHTS ONLY	○
LICENCE OF OCCUPATION	○
ORDER-IN-COUNCIL	○
RESERVATION	○
CANCELLED	○
SAND & GRAVEL	○
LAND USE PERMIT	○

NOTE: MINING RIGHTS IN PARCELS PATENTED PRIOR TO MAY 1, 1913, VESTED IN ORIGINAL PATENTEES BY THE PUBLIC LANDS ACT, R.S.O. 1970, CHAP. 380, SEC. 43, SUBSEC. 1.

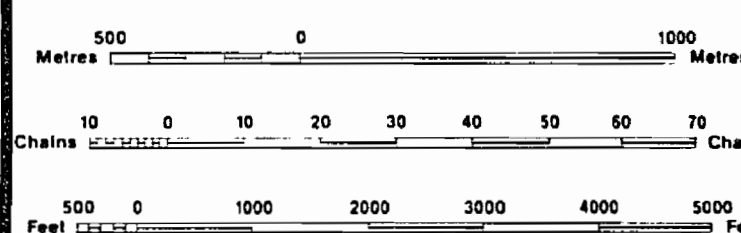

SCALE 1:20 000

GRID ZONE: 17

THE INFORMATION THAT APPEARS ON THIS MAP HAS BEEN COMPILED FROM VARIOUS SOURCES, AND ACCURACY IS NOT GUARANTEED. THOSE WISHING TO STAKE MINING CLAIMS SHOULD CONSULT WITH THE MINING RECORDER, MINISTRY OF NORTHERN DEVELOPMENT AND MINES, FOR ADDITIONAL INFORMATION ON THE STATUS OF THE LANDS SHOWN HEREON.

TOWNSHIP

FIELD

M.N.R. ADMINISTRATIVE DISTRICT

NORTH BAY

MINING DIVISION

SUDBURY

LAND TITLES / REGISTRY DIVISION

NIPISSING



Ministry of Natural Resources

Land Management Branch

Original Completion: JULY, 1985

Number

Revised:

G-2840

* June 1984

Bastedo Twp.

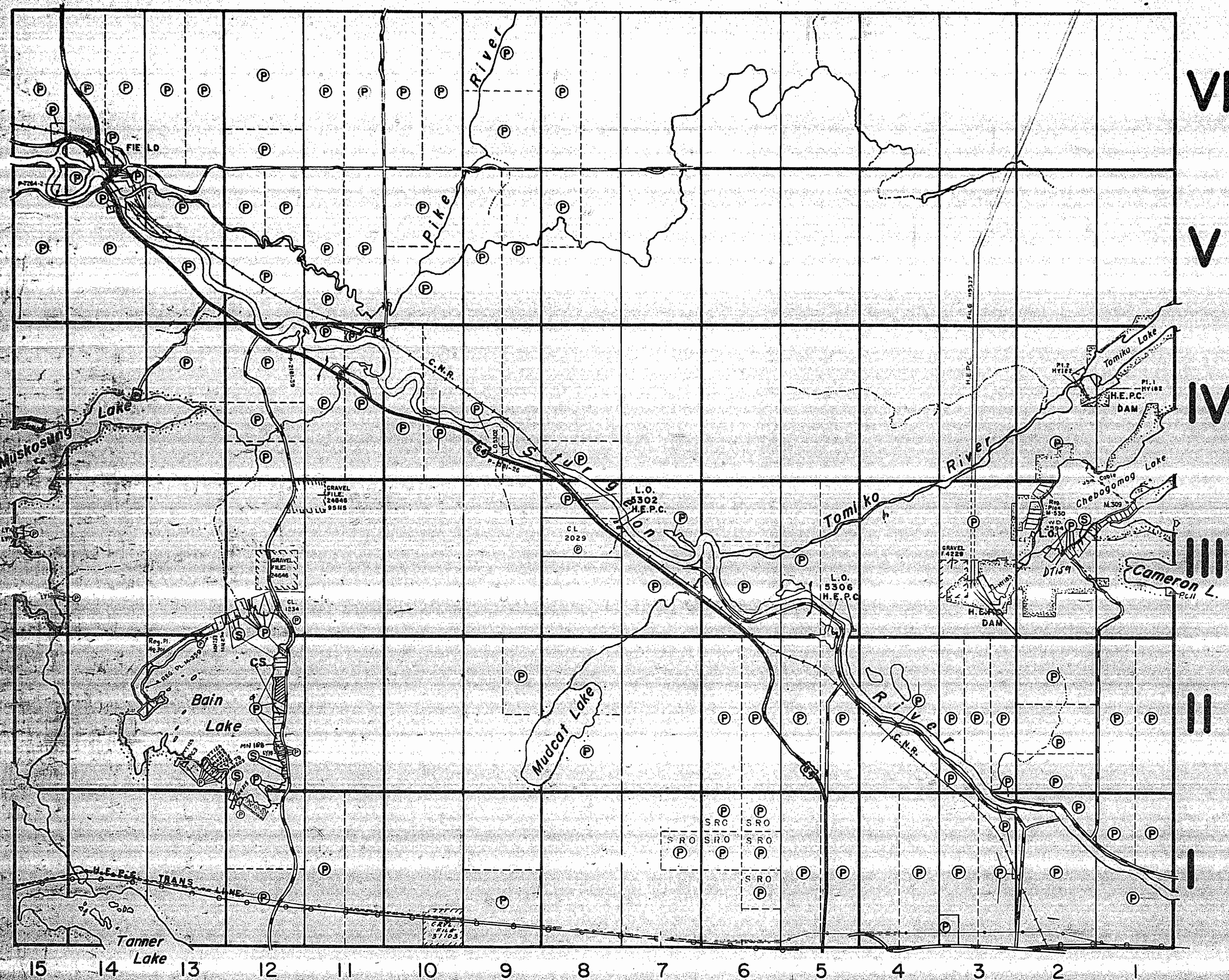

Springer Twp.

THE TOWNSHIP
OF

FIELD

DISTRICT OF
NIPISSING

SUBDIVISION
MINING DIVISION

SCALE: 1-INCH=40 CHAINS

LEGEND

PATENTED LAND	P
CROWN LAND SALE	C.S.
LEASES	L
LOCATED LAND	L.O.
LICENSE OF OCCUPATION	L.O.
MINING RIGHTS ONLY	M.S.O.
SURFACE RIGHTS ONLY	S.R.O.
ROADS	—
IMPROVED ROADS	—
KINGS HIGHWAYS	—
RAILWAYS	—
POWER LINES	—
MARSH OR MUSKEG	—
MINES	—

NOTES

400' Surface Rights Reservation Grounds
all Lakes and Rivers.

Flooding rights to contour 104.50' (C.L. 2445) to
H.E.P.C. shown thus

PLAN 36R-6730
D.T. 159

* IN SERVICE 78406 - J

FIELD

PLAN NO-M 808

ONTARIO
MINISTRY OF NATURAL RESOURCES
SURVEY AND MAPPING BRANCH

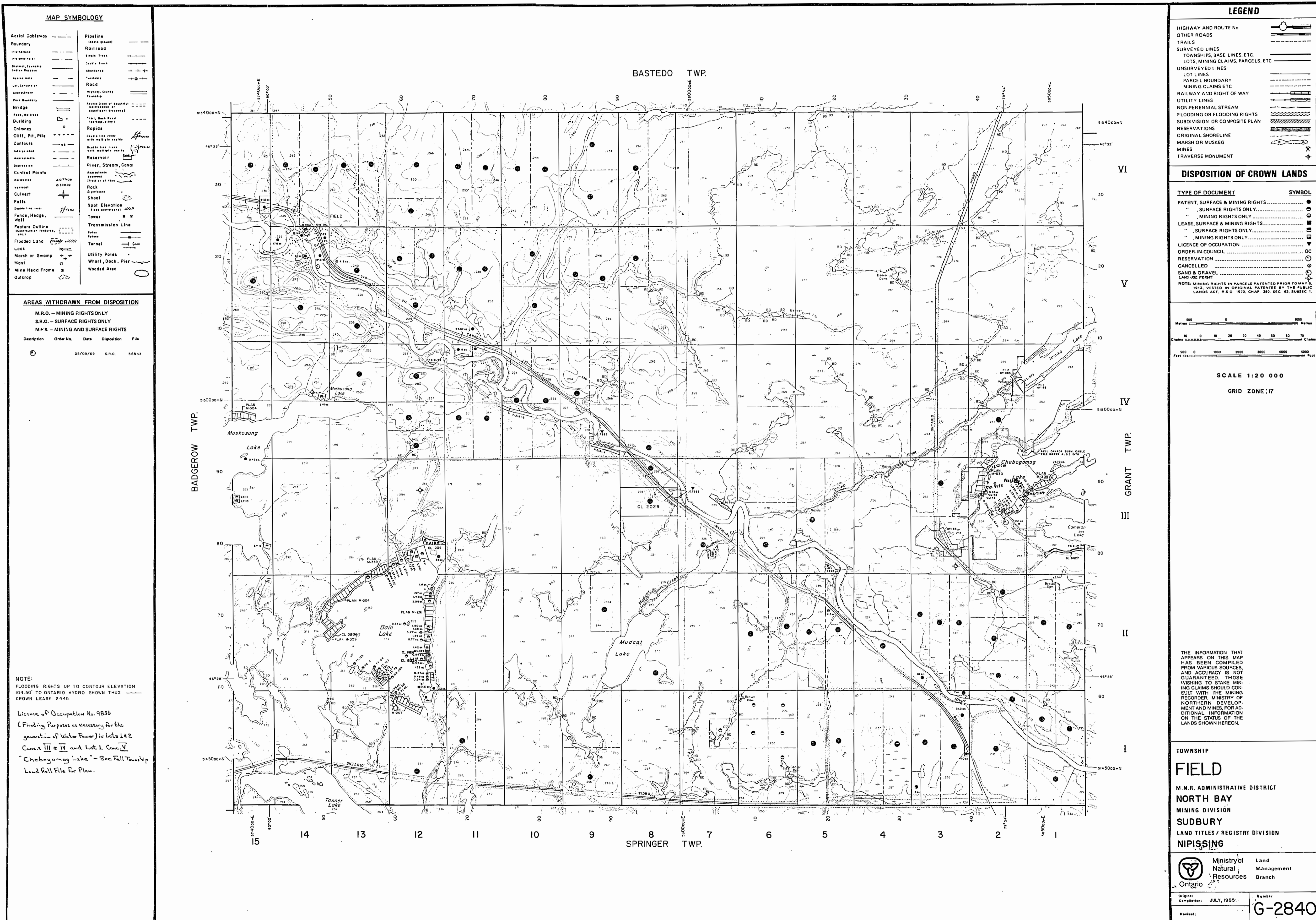

Bastedo Twp. OFFICE USE ONLY

THE TOWNSHIP
OF

FIELD

DISTRICT OF
NIPISSING

SUBDIVISION
MINING DIVISION

SCALE: 1-INCH=40 CHAINS

LEGEND

PATENTED LAND	(P)
CROWN LAND SALE	C.S.
LEASES	(L)
LOCATED LAND	Loc.
LICENSE OF OCCUPATION	L.O.
MINING RIGHTS ONLY	M.R.O.
SURFACE RIGHTS ONLY	S.R.O.
ROADS	
IMPROVED ROADS	
KINGS HIGHWAYS	
RAILWAYS	
POWER LINES	
MARSH OR MUSKEG	
MINES	

NOTES

400' Surface Rights Reservation around
all Lakes and Rivers.

Flooding rights to contour 104.50' (C.L. 2445) to
H.E.P.C. shown thus

* NY 152 Part 1 & 2 Ontario Hydro Plan 36R-5465 (See Land R.O.)
** NY 153 Part 1 Ontario Hydro Plan 36R-5466 (See Land R.O.)

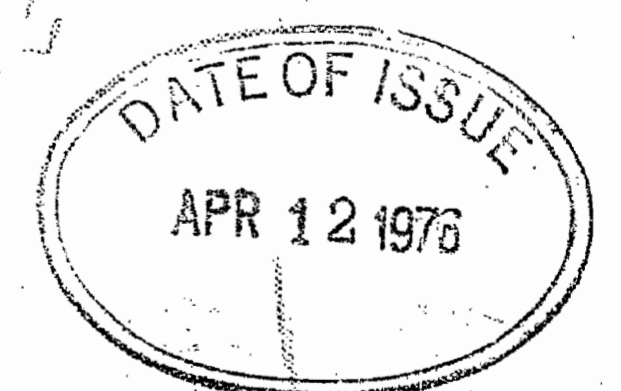

FIELD

PLAN NO.- M 808

ONTARIO
MINISTRY OF NATURAL RESOURCES
SURVEYS AND MAPPING BRANCH

Badgerow Twp.

Grant Twp.

Springer Twp.

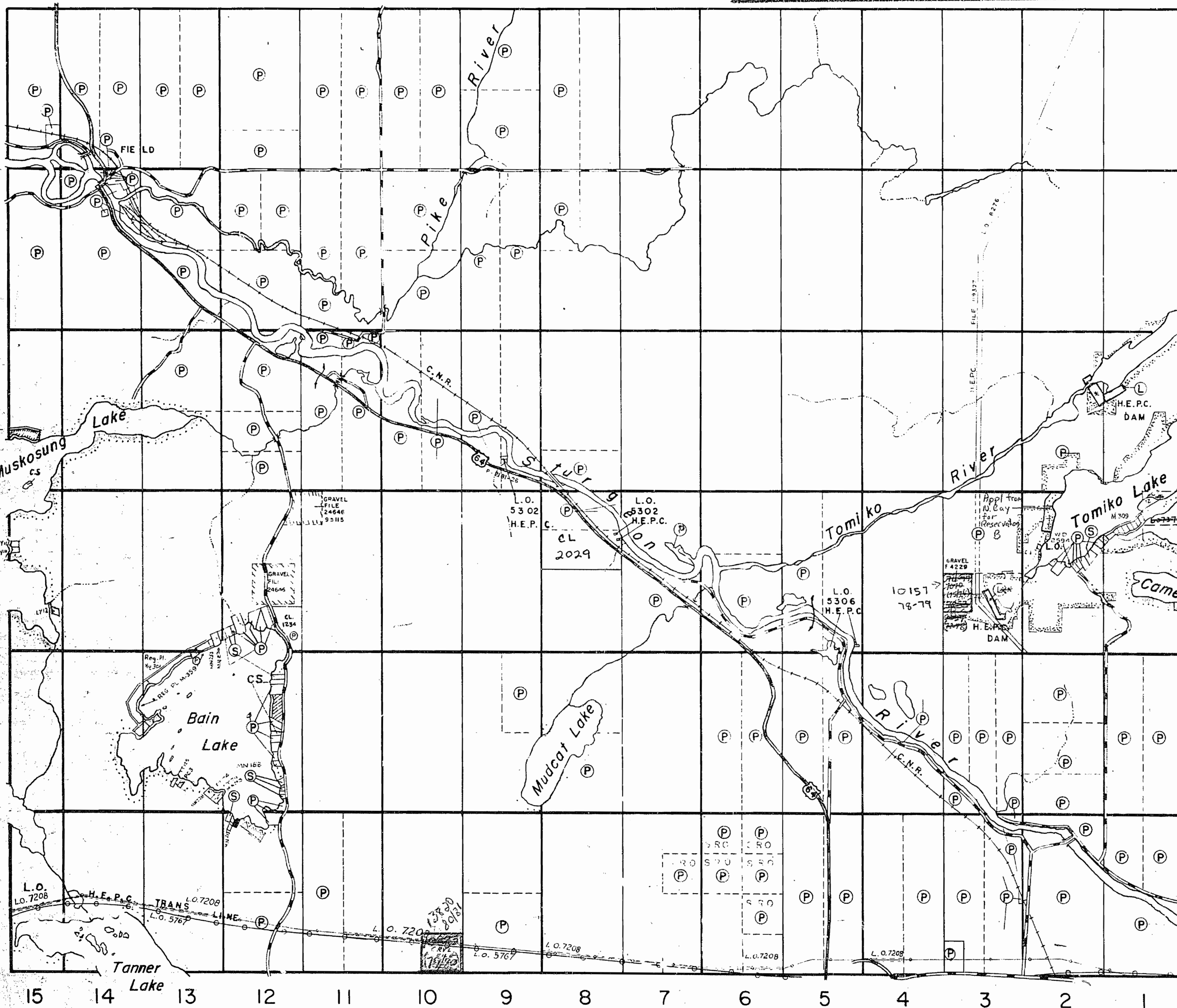

808

Bastedo Twp.

Badgerow Twp.

Springer Twp.

THE TOWNSHIP
OF #1

FIELD

DISTRICT OF
NIPISSING

SUDBURY
MINING DIVISION

SCALE: 1-INCH=40 CHAINS

LEGEND

PATENTED LAND	Ⓟ
CROWN LAND SALE	C.S.
LEASES	Ⓛ
LOCATED LAND	Loc.
LICENSE OF OCCUPATION	L.O.
MINING RIGHTS ONLY	M.R.O.
SURFACE RIGHTS ONLY	S.R.O.
ROADS	—
IMPROVED ROADS	—
KINGS HIGHWAYS	—
RAILWAYS	—
POWER LINES	—
MARSH OR MUSKEG	—
MINES	—

NOTES

200' Reservation to Dept. of Lands and Forests shown thus
Flooding rights to contour 104.50' (C.L. 2445) to H.E.P.C. shown thus

M-808

PLAN NO. S.179

DEPARTMENT OF MINES
— ONTARIO —

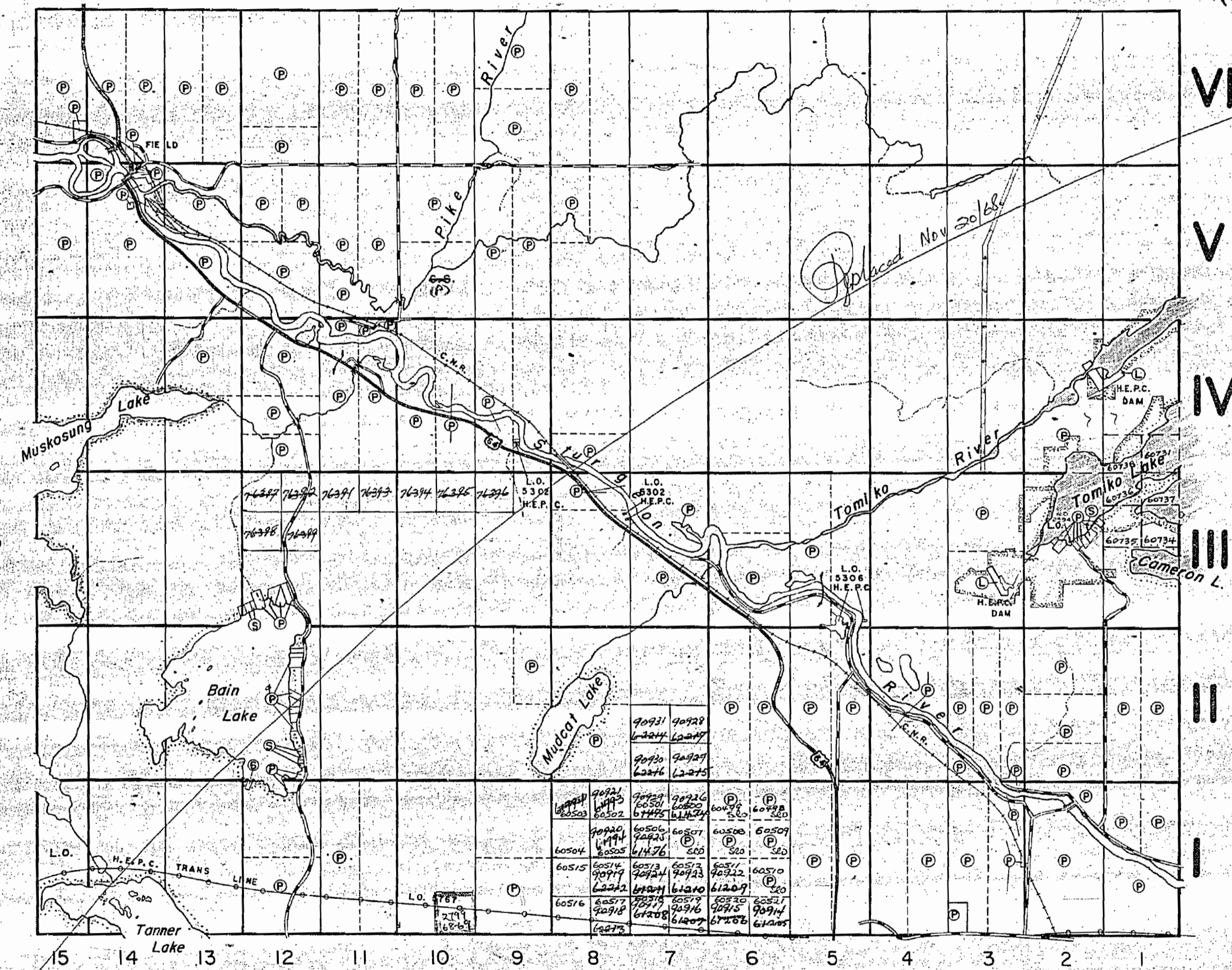

FIELDDISTRICT OF
NIPISSINGLARDER LAKE
MINING DIVISION

SCALE: 1-INCH=40 CHAINS

LEGEND

PATENTED LAND	Ⓟ
CROWN LAND SALE	C.S.
LEASES	Ⓛ
LOCATED LAND	Loc
LICENSE OF OCCUPATION	L.O.
MINING RIGHTS ONLY	M.R.O.
SURFACE RIGHTS ONLY	S.R.O.
ROADS	—
IMPROVED ROADS	—
KINGS HIGHWAYS	—
RAILWAYS	—
POWER LINES	—
MARSH OR MUSKEG	—
MINES	✕

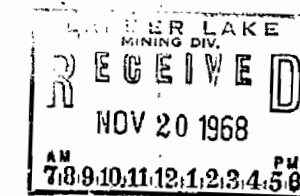
NOTES400' Surface Rights Reservation around
all Lakes and Rivers.Flooding rights to contour 104.50' (C.L. 2445) to
H.E.P.C. shown thus**FIELD**

PLAN NO.- M 808

DEPARTMENT OF MINES
—ONTARIO—

Badgerow Twp.

Grant Twp.

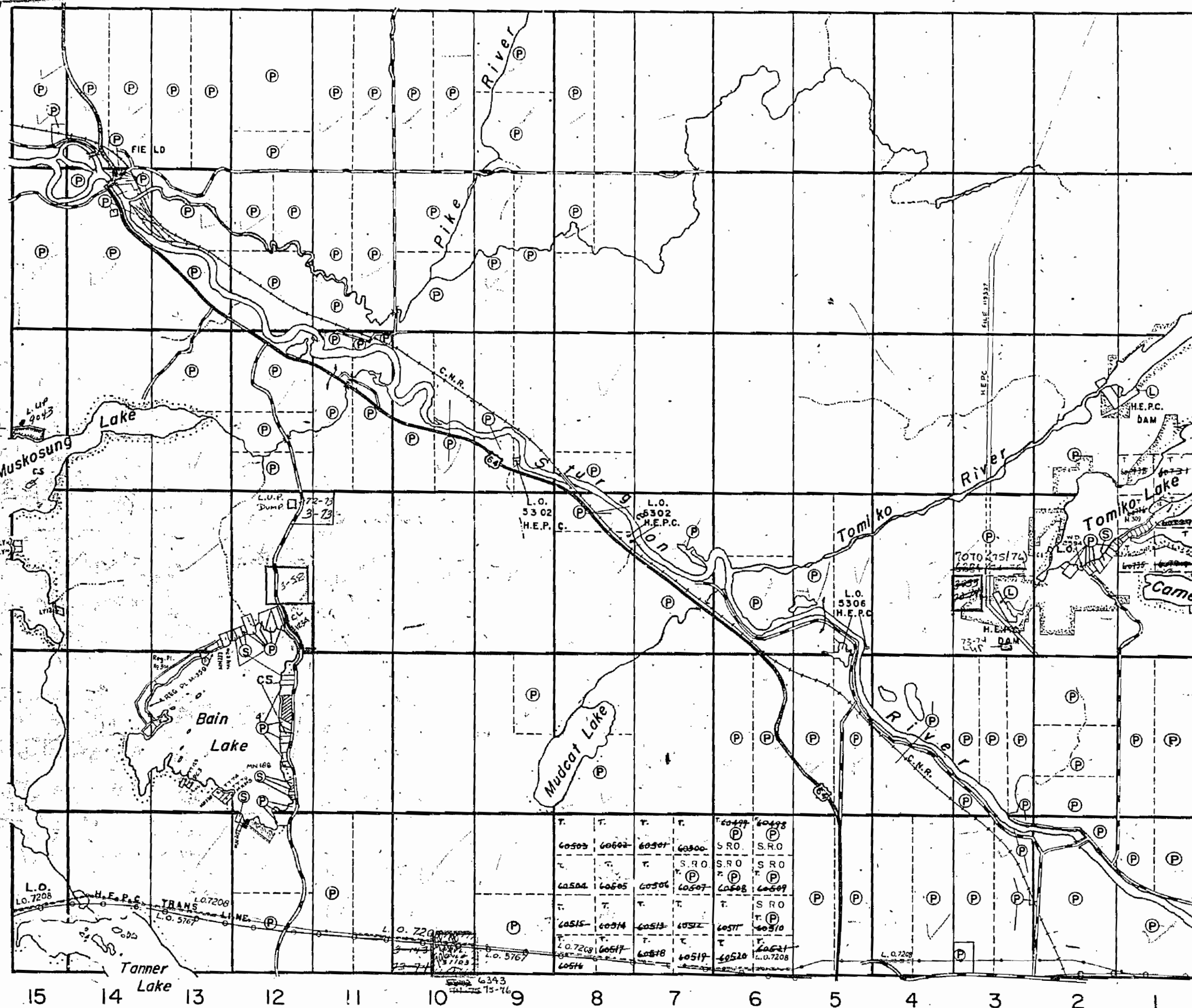

Springer Twp.

Bastedo Twp.

THE TOWNSHIP
OF

FIELD

DISTRICT OF
NIPISSING

SUDBURY
MINING DIVISION

SCALE: 1-INCH = 40 CHAINS

LEGEND

PATENTED LAND	Ⓟ
CROWN LAND SALE	C.S.
LEASES	Ⓛ
LOCATED LAND	Loc.
LICENSE OF OCCUPATION	L.O.
MINING RIGHTS ONLY	M.R.O.
SURFACE RIGHTS ONLY	S.R.O.
ROADS	—
IMPROVED ROADS	—
KINGS HIGHWAYS	—
RAILWAYS	—
POWER LINES	—
MARSH OR MUSKEG	—
MINES	✱

NOTES

200' Reservation to Dept. of Lands and Forests
shown thus

Flooding rights to contour 104.50' (C.L. 2445) to
H.E.P.C. shown thus

M-808

PLAN NO. - S.179

DEPARTMENT OF MINES
— ONTARIO —

Badgerow Twp.

Grant Twp.

Springer Twp.

808

FIELDDISTRICT OF
NIPISSINGLARDER LAKE
MINING DIVISION

SCALE: 1-INCH=40 CHAINS

LEGEND

PATENTED LAND	(P)
CROWN LAND SALE	C.S.
LEASES	(L)
LOCATED LAND	Loc.
LICENSE OF OCCUPATION	L.O.
MINING RIGHTS ONLY	M.R.O.
SURFACE RIGHTS ONLY	S.R.O.
ROADS	—
IMPROVED ROADS	—
KINGS HIGHWAYS	—
RAILWAYS	—
POWER LINES	—
MARSH OR MUSKEG	—
MINES	—

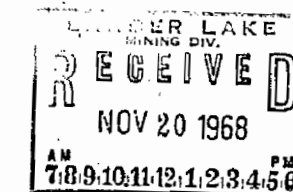
NOTES400' Surface Rights Reservation around
all Lakes and Rivers.Flooding rights to contour 104.50' (C.L. 2445) to
H.E.P.C. shown thus**FIELD**

PLAN NO.- M 808

DEPARTMENT OF MINES
— ONTARIO —

VI

V

IV

III

II

I

Grant Twp.

Badgerow Twp.

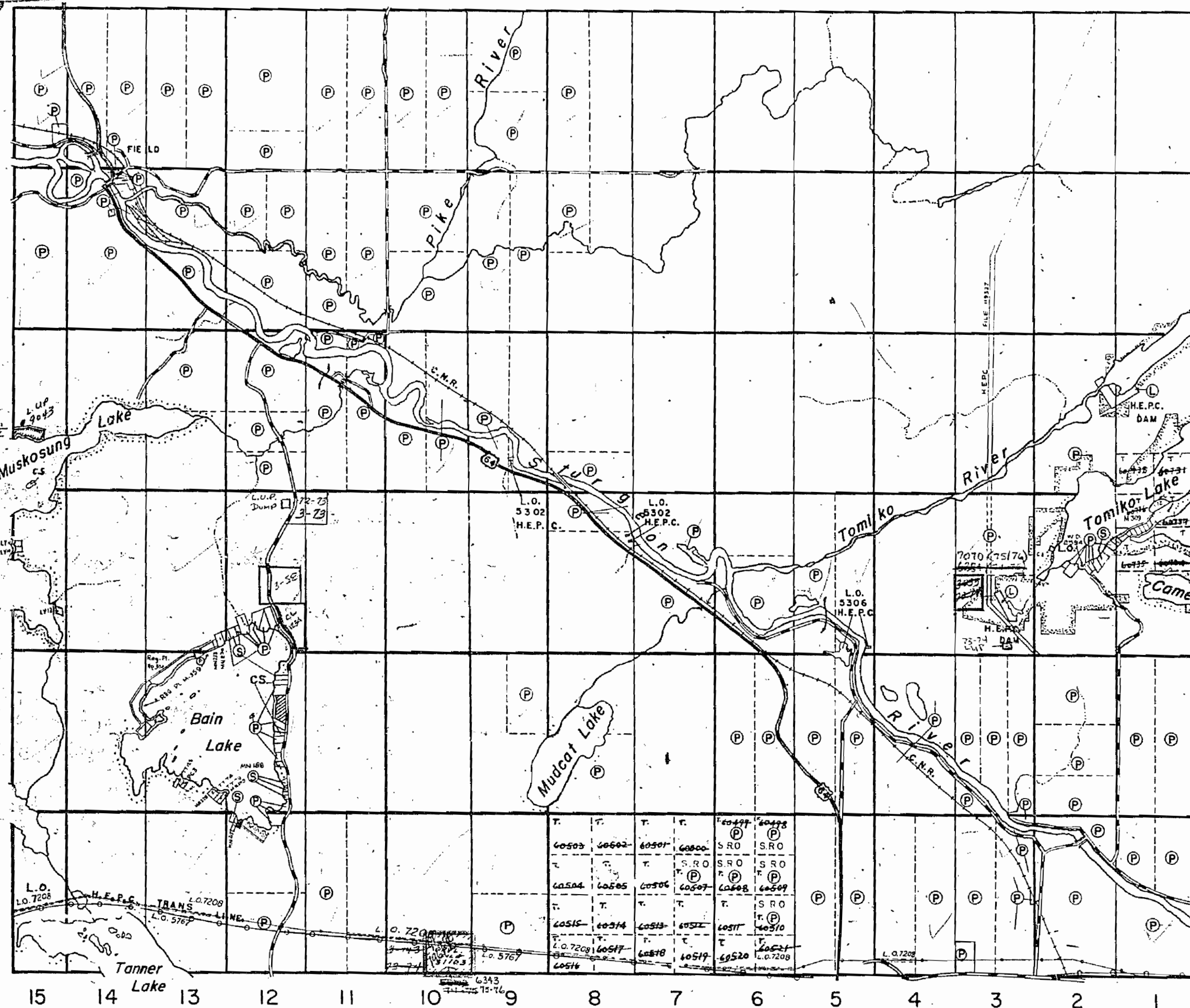

Springer Twp.