

W.5030

FLINCH LAKE

W.5030

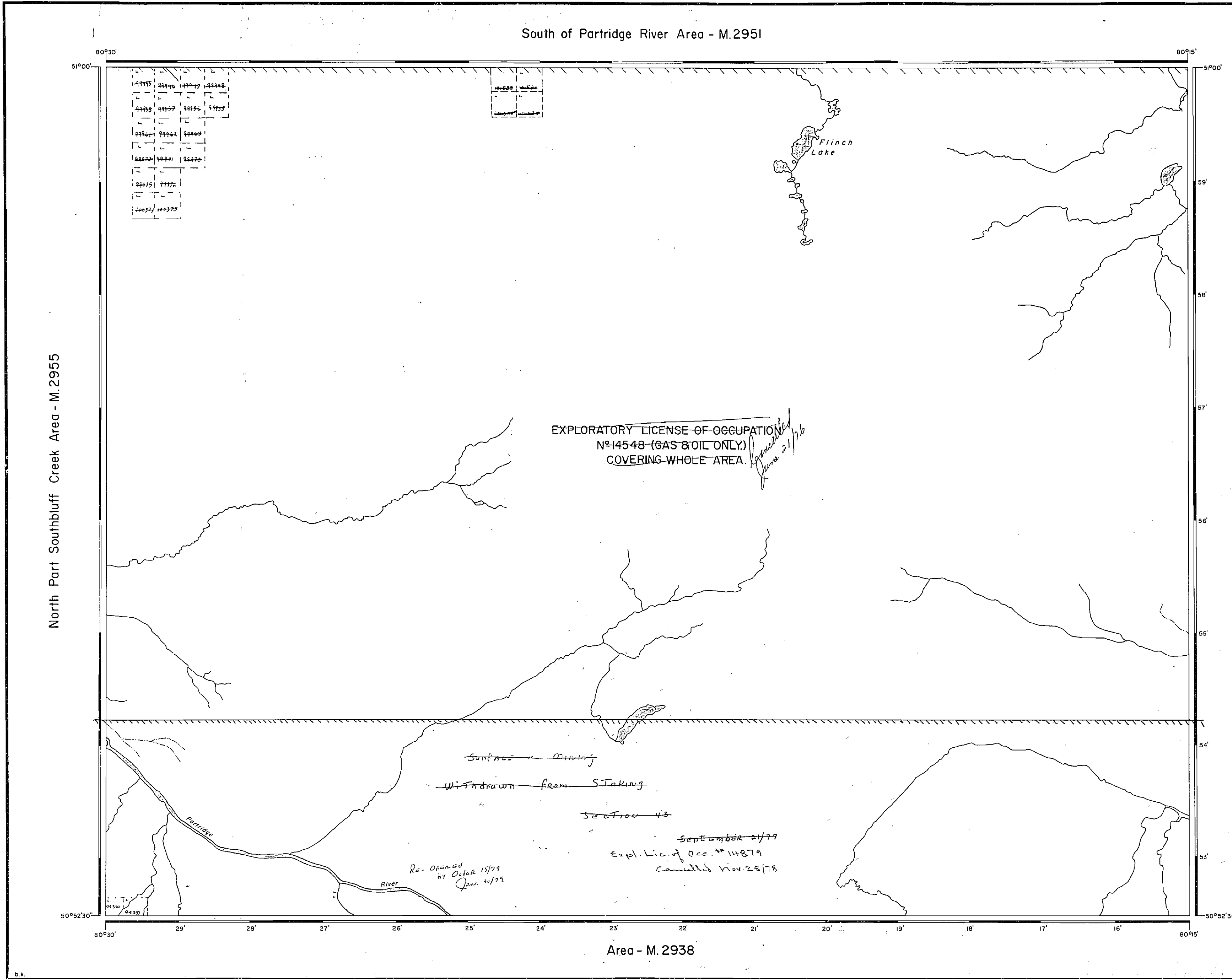

AREA OF
FLINCH LAKE
 DISTRICT OF
 COCHRANE
 PORCUPINE
 MINING DIVISION
 SCALE: 1-INCH = 40 CHAINS

LEGEND

PATENTED LAND	⊙
CROWN LAND SALE	C.S.
LEASES	⊙
LOCATED LAND	Loc.
LICENSE OF OCCUPATION	L.O.
MINING RIGHTS ONLY	M.R.O.
SURFACE RIGHTS ONLY	S.R.O.
ROADS	—
IMPROVED ROADS	—
KING'S HIGHWAYS	—
RAILWAYS	—
POWER LINES	—
MARSH OR MUSKEG	—
MINES	⋈
CANCELLED	C.

NOTES

This area represents north-west part of AEROMAGNETIC MAP 2363 G.

400' Surface Rights Reservation around all lakes and rivers.

MICROFILM
 01 JAN 1984

RECEIVED
 OCT 20 1969
 78.0.10.11.12.1.2.3.4.5.6

PLAN NO. **M.2936**
 DEPARTMENT OF MINES
 — ONTARIO —

W.5030

FLINCH LAKE

W.5030

TRIM LINE

508802

W5030

FLINCH LAKE

0205M

W5030

FLINCH LAKE

0205M

TRIM LINE

South of Partridge River Area - M.2951

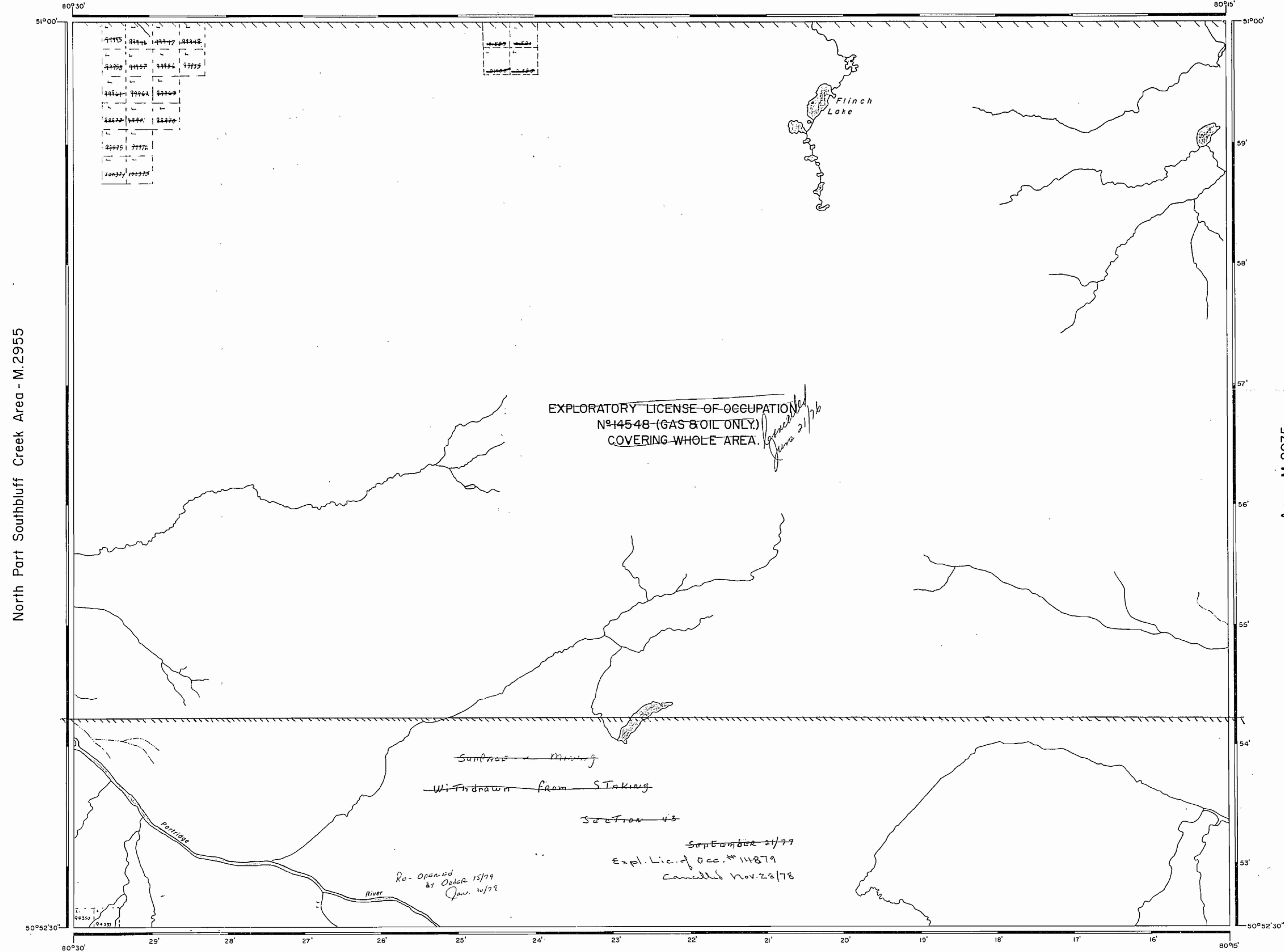

North Part Southbluff Creek Area - M.2955

Area - M. 2935

Area - M. 2938

AREA OF
FLINCH LAKE

DISTRICT OF
COCHRANE

PORCUPINE
MINING DIVISION

SCALE: 1-INCH = 40 CHAINS

LEGEND

PATENTED LAND	⊙
CROWN LAND SALE	⊙
LEASES	⊙
LOCATED LAND	⊙
LICENSE OF OCCUPATION	⊙
MINING RIGHTS ONLY	M.R.O.
SURFACE RIGHTS ONLY	S.R.O.
ROADS	—
IMPROVED ROADS	—
KING'S HIGHWAYS	—
RAILWAYS	—
POWER LINES	—
MARSH OR MUSKEG	—
MINES	⊙
CANCELLED	C.

NOTES

This area represents north-west part of AEROMAGNETIC MAP 2363 G.

400' Surface Rights Reservation around all lakes and rivers.

MICROFILM
01 JAN 1984

RECEIVED
OCT 20 1969
AM 10:11:12 PM 123458

PLAN NO. **M.2936**

DEPARTMENT OF MINES
— ONTARIO —

508802

TRIM LINE



Area - G-1515

REFERENCES

AREAS WITHDRAWN FROM DISPOSITION

M.R.O. - MINING RIGHTS ONLY
 S.R.O. - SURFACE RIGHTS ONLY
 M.+S. - MINING AND SURFACE RIGHTS

Description	Order No.	Date	Disposition	File

LEGEND

HIGHWAY AND ROUTE No.	
OTHER ROADS	
TRAILS	
SURVEYED LINES:	
TOWNSHIPS, BASE LINES, ETC.	
LOTS, MINING CLAIMS, PARCELS, ETC.	
UNSURVEYED LINES:	
LOT LINES	
PARCEL BOUNDARY	
MINING CLAIMS ETC.	
RAILWAY AND RIGHT OF WAY	
UTILITY LINES	
NON-PERENNIAL STREAM	
FLOODING OR FLOODING RIGHTS	
SUBDIVISION OR COMPOSITE PLAN	
RESERVATIONS	
ORIGINAL SHORELINE	
MARSH OR MUSKEG	
MINES	
TRAVERSE MONUMENT	

DISPOSITION OF CROWN LANDS

TYPE OF DOCUMENT	SYMBOL
PATENT, SURFACE & MINING RIGHTS	
" SURFACE RIGHTS ONLY	
" MINING RIGHTS ONLY	
LEASE, SURFACE & MINING RIGHTS	
" SURFACE RIGHTS ONLY	
" MINING RIGHTS ONLY	
LICENCE OF OCCUPATION	
ORDER-IN-COUNCIL	
RESERVATION	
CANCELLED	
SAND & GRAVEL	

NOTE: MINING RIGHTS IN PARCELS PATENTED PRIOR TO MAY 6, 1913, VESTED IN ORIGINAL PATENTEE BY THE PUBLIC LANDS ACT, R.S.O. 1970, CHAP. 280, SEC. 63, SUBSEC. 1.

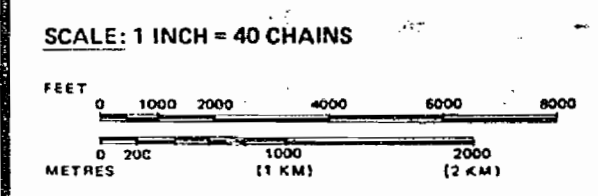

THE INFORMATION THAT APPEARS ON THIS MAP HAS BEEN COMPILED FROM VARIOUS SOURCES, AND ACCURACY IS NOT GUARANTEED. THOSE WISHING TO STAKE MINING CLAIMS SHOULD CONSULT WITH THE MINING RECORDER, MINISTRY OF NORTHERN DEVELOPMENT AND MINES, FOR ADDITIONAL INFORMATION ON THE STATUS OF THE LANDS SHOWN HEREON.

TOWNSHIP

AREA
FLINCH LAKE
 M.N.R. ADMINISTRATIVE DISTRICT
MOOSENEE
 MINING DIVISION
PORCUPINE
 LAND TITLES / REGISTRY DIVISION
COCHRANE

Ministry of Land Management
 Natural Resources Branch
 Ontario
David *7/83*

Date: NOVEMBER, 1982
 Number: **G-1490**

2936

W.S.232E

2936.M

TRIM LINE

W.S.232E

2936.M

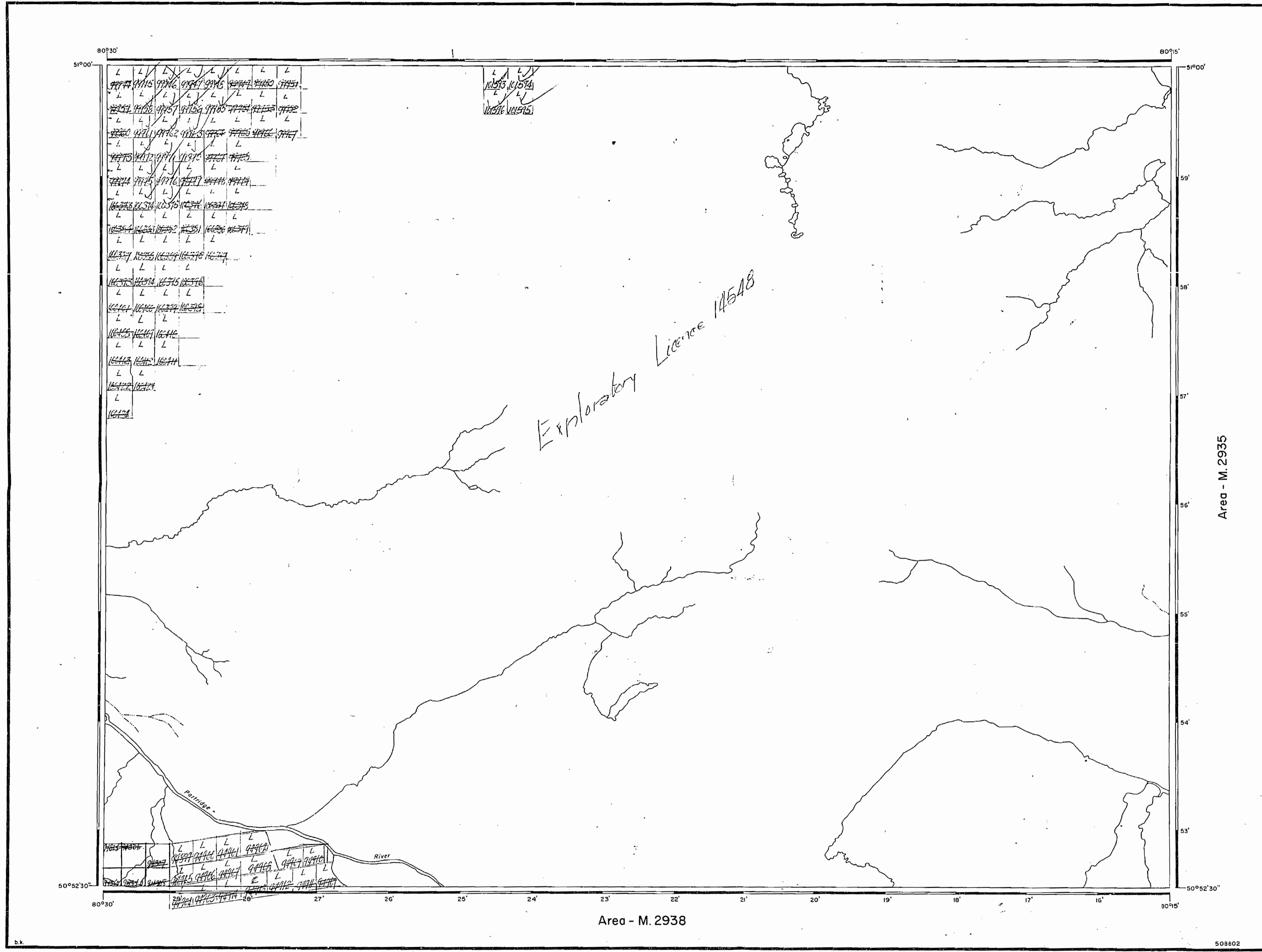

AREA OF
~~East Wpt of Southbluff Creek~~
 FLINCH LAKE

DISTRICT OF COCHRANE
 PORCUPINE
 LARDER LAKE
 MINING DIVISION

SCALE: 1-INCH = 40 CHAINS

LEGEND

PATENTED LAND	⊙
CROWN LAND SALE	⊙
LEASES	⊙
LOCATED LAND	⊙
LICENSE OF OCCUPATION	⊙
MINING RIGHTS ONLY	M.R.O.
SURFACE RIGHTS ONLY	S.R.O.
ROADS	—
IMPROVED ROADS	—
KING'S HIGHWAYS	—
RAILWAYS	—
POWER LINES	—
MARSH OR MUSKEG	—
MINES	⊙
CANCELLED	⊙

NOTES

This area represents north-west part of AEROMAGNETIC MAP 2363 G.

400' Surface Rights Reservation around all lakes and rivers.

PLAN NO. M.2936

DEPARTMENT OF MINES
 — ONTARIO —

Area - M. 2935

Area - M. 2938

508602

TRIM LINE

2936

TRIM LINE

W.S.232E

W.S.232E



Exploratory Licence 14548

AREA OF
~~E of Npt of South Hill Creek~~
 FLINCH LAKE

DISTRICT OF COCHRANE
 PORCUPINE
 LARDER LAKE
 MINING DIVISION

SCALE: 1-INCH = 40 CHAINS

LEGEND

PATENTED LAND	Ⓟ
CROWN LAND SALE	C.S.
LEASES	Ⓛ
LOCATED LAND	Loc.
LICENSE OF OCCUPATION	L.O.
MINING RIGHTS ONLY	M.R.O.
SURFACE RIGHTS ONLY	S.R.O.
ROADS	—
IMPROVED ROADS	—
KING'S HIGHWAYS	—
RAILWAYS	—
POWER LINES	—
MARSH OR MUSKEG	—
MINES	Ⓜ
CANCELLED	C.

NOTES

This area represents north-west part of AEROMAGNETIC MAP 2363 G.

40' Surface Rights Reservation around all lakes and rivers.

Area - M. 2935

Area - M. 2938

PLAN NO. M.2936

DEPARTMENT OF MINES
— ONTARIO —

02ES.M

02ES.M

TRIM LINE

508802