

GARDEN RIVER
INDIAN RESERVE
No. 14
DISTRICT OF
ALGOMA
SAULT STE. MARIE
MINING DIVISION
SCALE 1-INCH=40 CHAINS

LEGEND

PATENTED LAND	(P)
CROWN LAND SALE	(C or CS)
LEASES	(L)
LOCATED LAND	(Loc)
LICENSE OF OCCUPATION	(L.O.)
MINING RIGHTS ONLY	(M.R.O.)
SURFACE RIGHTS ONLY	(S.R.O.)
ROADS	(—)
IMPROVED ROADS	(—)
QUEEN'S HIGHWAYS	(—)
RAILWAYS	(—)
POWER LINES	(—)
MARSH OR MUSKIE	(—)
MINES	(—)

NOTES

Areas withdrawn from staking under Sec. 35 of the Mining Act, 1970.

File	Date	Disposition
7598-2	20/8/73	S.R.O. & M.R.O.
130400		
130401		
121734		

Whole township withdrawn from staking (M.R. and S.R.) under Section 43 of Mining Act (R.S.O. 1970) Order No. W12/80 File 188536 August 26, 1980

NOTE
LOT 12 AND OTHER LOTS IN SQUIRREL ISLAND, AND BLOCKS 214 TO 264, IN THE DISTRICT OF ALGOMA TRANSFERRED TO THE FEDERAL GOVERNMENT SEE G. SHIRMAN LETTER DATED DECEMBER 16, 1951

Note #1
AREA REOPENED TO STAKING UNDER SEC. 35 OF THE MINING ACT

File	Date	Disposition	Order
93 a	195150	24/10/1993	S.R.O. & M.R.O. O-SSM-26193 MER

PLAN NO. ~~188536~~
ONTARIO
MINISTRY OF NATURAL RESOURCES
SURVEYS AND MAPPING BRANCH

6-3153

OFFICE MAP

Duncan Twp.

OFFICE MAP

Kehoe Twp.

GARDEN RIVER INDIAN RESERVE No. 14

DISTRICT OF
ALGOMASAULT STE. MARIE
MINING DIVISION

SCALE: 1-INCH=40 CHAINS

LEGEND

PATENTED LAND	Ⓟ
CROWN LAND SALE	Ⓢ or Ⓞ S.
LEASES	Ⓛ
LOCATED LAND	Loc.
LICENSE OF OCCUPATION	L.O.
MINING RIGHTS ONLY	M.R.O.
SURFACE RIGHTS ONLY	S.R.O.
ROADS	—
IMPROVED ROADS	—
QUEEN'S HIGHWAYS	—
RAILWAYS	—
POWER LINES	—
MARSH OR MUSKEG	—
MINES	—

NOTES

MG. Loc. 1A withdrawn from staking under Sec. 136 (D) J.R.M. letter Aug. 27/58 NOW INDIAN RESERVE.

MG. Loc. 21 H to 26 H are Crown land & open for staking. J.R.M. letter Aug. 16/58 in Standard.

ATTENTION: SURFACE RIGHTS FOR MG. Loc. 21 H to 26 H parts of Block 2A WITHDRAWN FROM PROSPECTING, STAKING OUT, SALE OR LEASE.

Letter dated Aug. 20/73 - W. Macnee, 1973. (See 43)

6-3153

PLAN NO. - M-1260

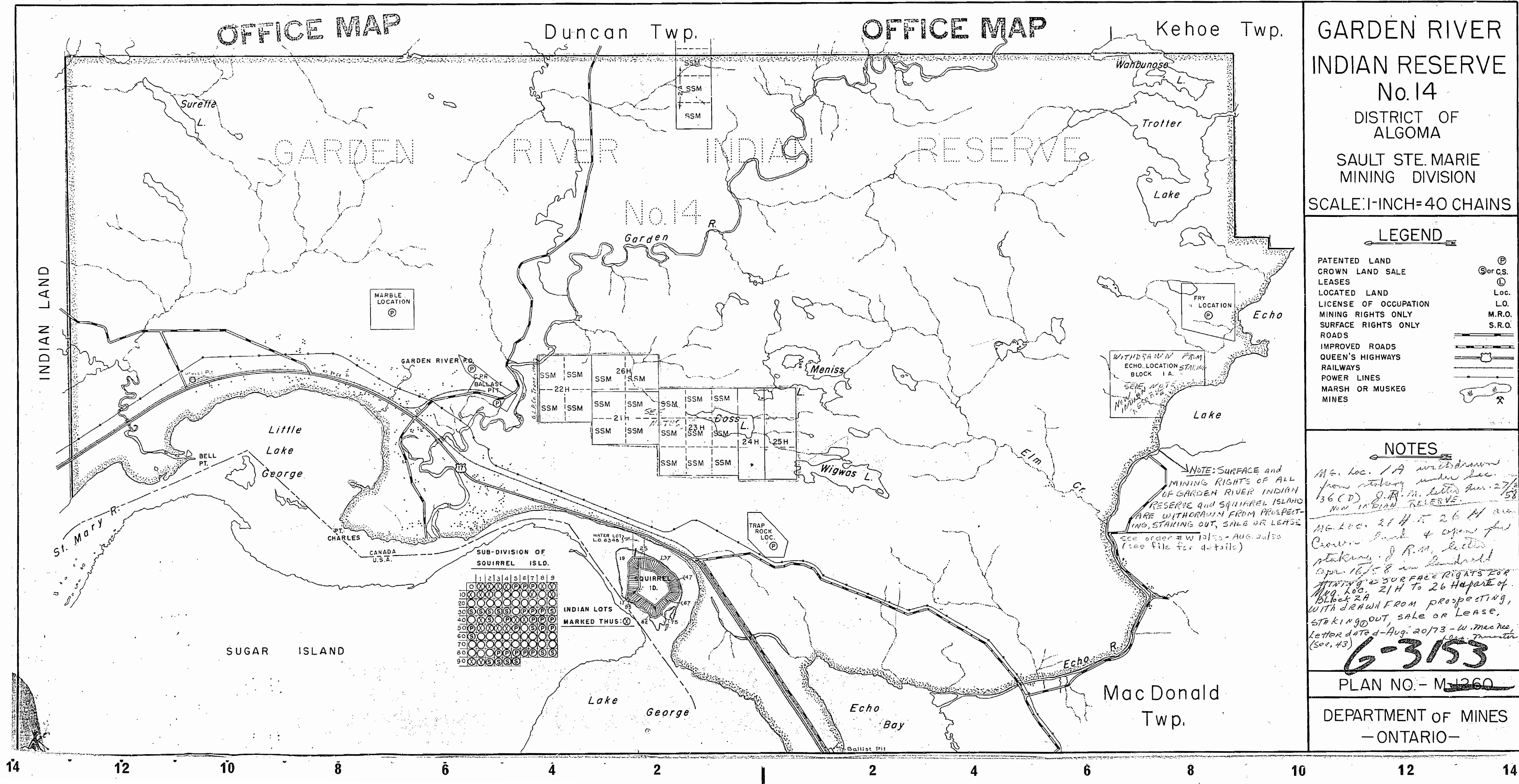
DEPARTMENT OF MINES
—ONTARIO—

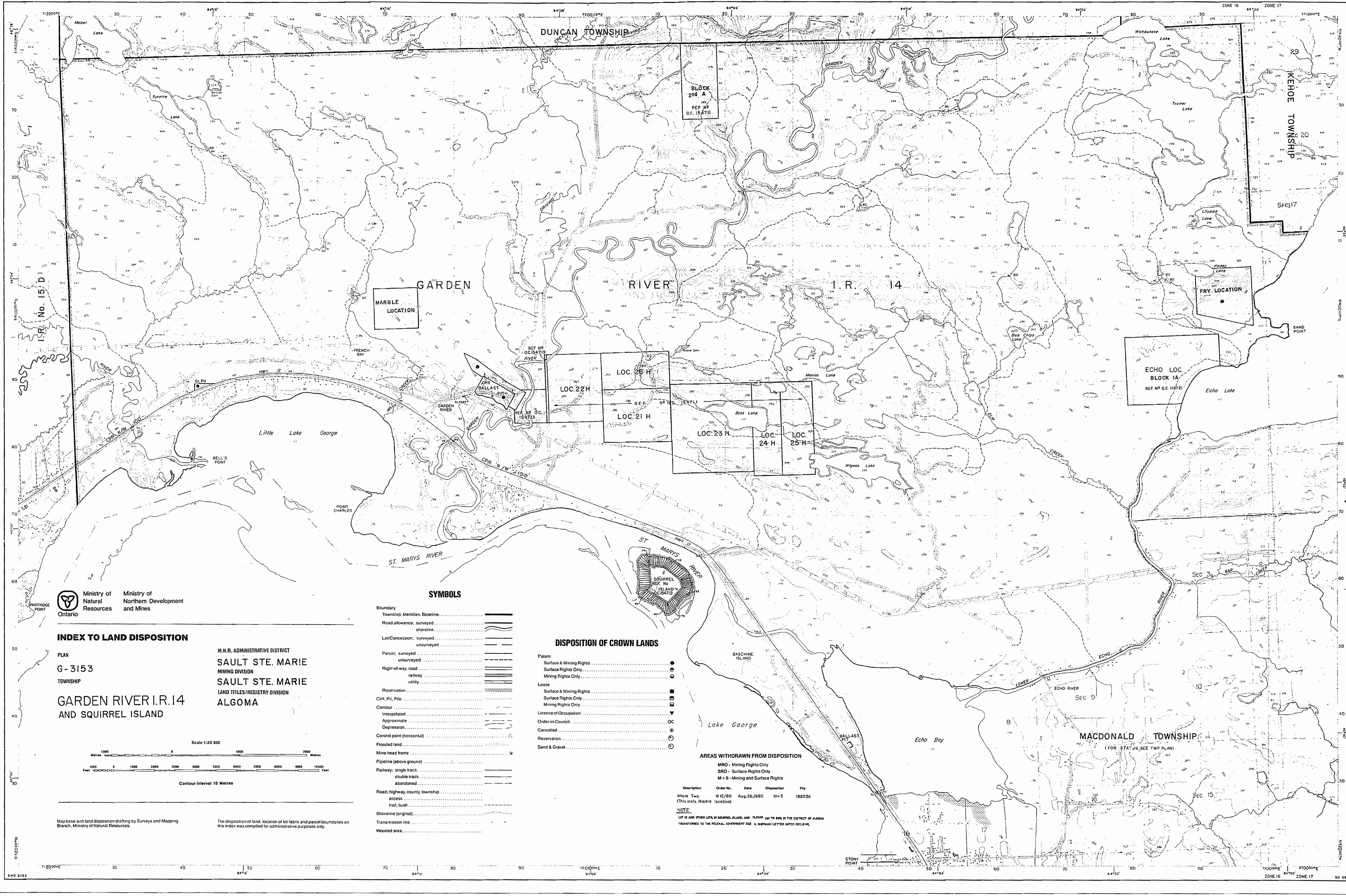

Ministry of Natural Resources
Ontario

Ministry of Northern Development and Mines

INDEX TO LAND DISPOSITION

PLAN
G-3153
TOWNSHIP
GARDEN RIVER I.R. 14
AND SQUIRREL ISLAND

M.N.R. ADMINISTRATIVE DISTRICT
SAULT STE. MARIE
MINING DIVISION
SAULT STE. MARIE
LAND TITLES/REGISTRY DIVISION
ALGOMA

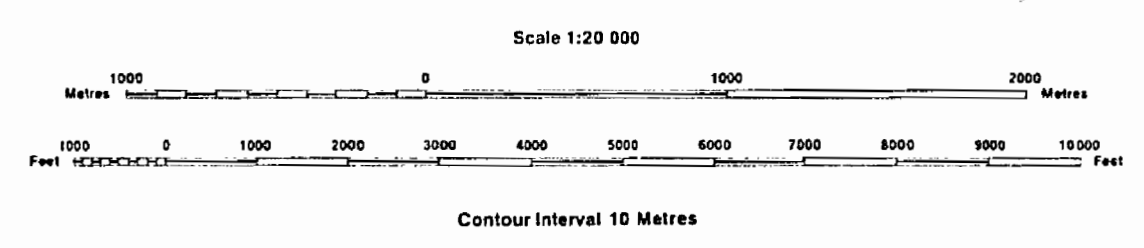

Map base and land disposition drafted by Surveys and Mapping Branch, Ministry of Natural Resources.

The disposition of land, location of lot fabric and parcel boundaries on this index was compiled for administrative purposes only.

SYMBOLS

- Boundary
- Township, Meridian, Baseline
- Road allowance: surveyed
- shoreline
- Lot/Concession: surveyed
- unsurveyed
- Parcel: surveyed
- unsurveyed
- Right-of-way: road
- railway
- utility
- Reservation
- Cliff, Pit, Pile
- Contour
- Interpolated
- Approximate
- Depression
- Control point (horizontal)
- Flooded land
- Mine head frame
- Pipeline (above ground)
- Railway: single track
- double track
- abandoned
- Road: highway, county, township
- access
- trail, bush
- Shoreline (original)
- Transmission line
- Wooded area

DISPOSITION OF CROWN LANDS

- Patent
- Surface & Mining Rights
- Surface Rights Only
- Mining Rights Only
- Lease
- Surface & Mining Rights
- Surface Rights Only
- Mining Rights Only
- Licence of Occupation
- Order-in-Council
- Cancelled
- Reservation
- Sand & Gravel

AREAS WITHDRAWN FROM DISPOSITION

Description	Order No.	Date	Disposition	File
Whole Twp. (This incl. Marble location)	W 12/80	Aug. 26, 1980	M+S	188536

NOTE
LOT 12 AND OTHER LOTS IN SQUIRREL ISLAND, AND FLOOR 234 TO 236 IN THE DISTRICT OF ALGOMA TRANSFERRED TO THE FEDERAL GOVERNMENT SEE G. SHUPMAN LETTER DATED DECEMBER

CYRILIAN SEISMIC INDICATOR

OFFICE MAP

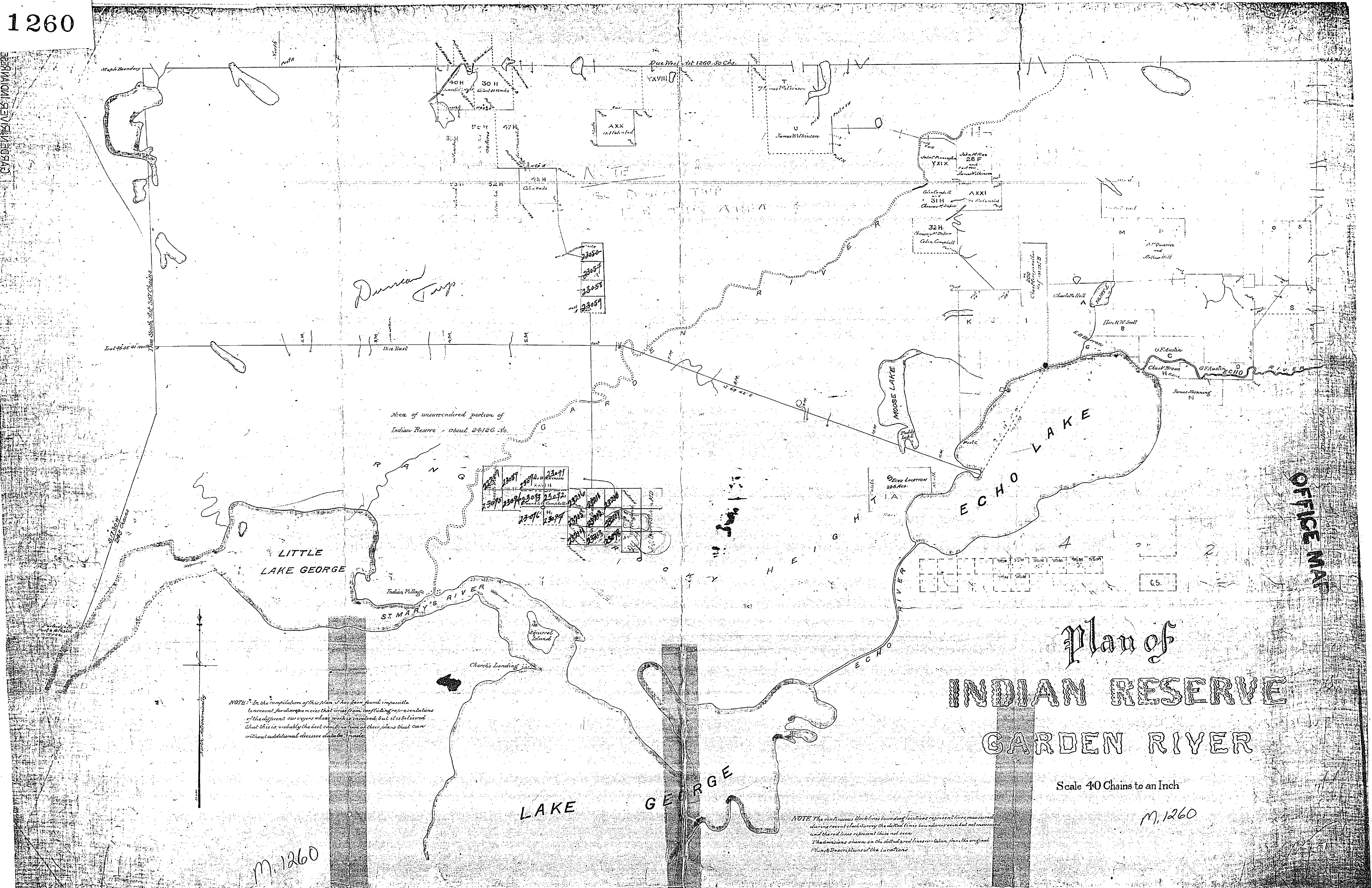

Plan of INDIAN RESERVE GARDEN RIVER

Scale 40 Chains to an Inch

M. 1260

NOTE: In the compilation of this plan it has been found impossible to account for discrepancies that arise from conflicting representations of the different surveys whose works are involved, but it is believed that this is probably the best combination of their plans that can be made without additional decisive data to be made.

NOTE The continuous black lines bounding locations represent lines measured during recent check survey the dotted lines boundaries seen but not measured and the red lines represent those not seen. The dimensions shown on the dotted lines are taken from the original Planché descriptions of the locations.

GARDEN RIVER INDIAN RESERVE

OFFICE MAP

