

REFERENCES

AREAS WITHDRAWN FROM DISPOSITION

M.R.O. - MINING RIGHTS ONLY  
 S.R.O. - SURFACE RIGHTS ONLY  
 M.+S. - MINING AND SURFACE RIGHTS

Description	Order No.	Date	Disposition	File

SAND and GRAVEL

- ① M.T.C. PIT 1267
- ② GRAVEL FILE 171727

THE INFORMATION THAT APPEARS ON THIS MAP HAS BEEN COMPILED FROM VARIOUS SOURCES, AND ACCURACY IS NOT GUARANTEED. THOSE WISHING TO STAKE MINING CLAIMS SHOULD CONSULT WITH THE MINING RECORDER, MINISTRY OF NORTHERN DEVELOPMENT AND MINES, FOR ADDITIONAL INFORMATION ON THE STATUS OF THE LANDS SHOWN HEREON.

AVON TWP.

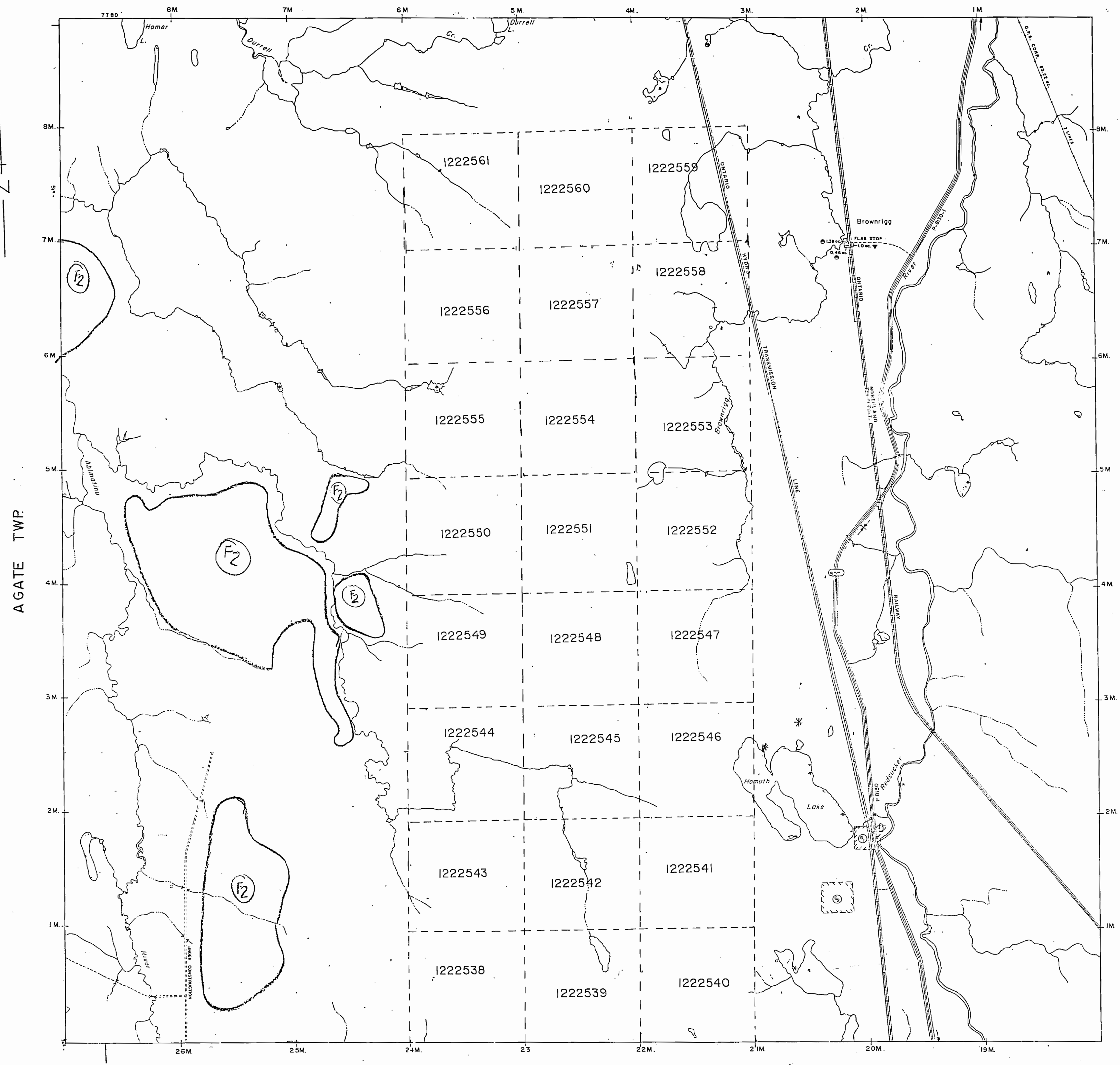

ADANAC TWP.

LEGEND

- HIGHWAY AND ROUTE No.
- OTHER ROADS
- TRAILS
- SURVEYED LINES: TOWNSHIPS, BASE LINES, ETC. LOTS, MINING CLAIMS, PARCELS, ETC.
- UNSURVEYED LINES: LOT LINES PARCEL BOUNDARY MINING CLAIMS ETC.
- RAILWAY AND RIGHT OF WAY
- UTILITY LINES
- NON-PERENNIAL STREAM
- FLOODING OR FLOODING RIGHTS
- SUBDIVISION OR COMPOSITE PLAN
- RESERVATIONS - ORIGINAL SHORELINE MARSH OR MUSKEG
- MINES
- TRAVERSE MONUMENT
- L.U.P.

DISPOSITION OF CROWN LANDS

TYPE OF DOCUMENT	SYMBOL
TRAPLINE CABINS	•
PATENT, SURFACE & MINING RIGHTS	○
" SURFACE RIGHTS ONLY	○
" MINING RIGHTS ONLY	○
LEASE, SURFACE & MINING RIGHTS	○
" SURFACE RIGHTS ONLY	○
" MINING RIGHTS ONLY	○
LICENCE OF OCCUPATION	○
ORDER-IN-COUNCIL	○
RESERVATION	○
CANCELLED	○
SAND & GRAVEL	○

NOTE: MINING RIGHTS IN PARCELS PATENTED PRIOR TO MAY 6, 1913, VESTED IN ORIGINAL PATENTEE BY THE PUBLIC LANDS ACT, R.S.O. 1970, CHAP. 380, SEC. 63, SUBSEC. 1

THIS TWP. SUBJECT TO FOREST ACTIVITY IN 1991/92 - FURTHER INFORMATION ON FILE

THIS TWP. IS SUBJECT TO FOREST ACTIVITY IN 1995/96 - FURTHER INFORMATION AVAILABLE ON FILE

DATE OF ISSUE

MAY 14 1986

PROVINCIAL RECORDING  
 OFFICE - SUDBURY

SCALE: 1 INCH = 40 CHAINS

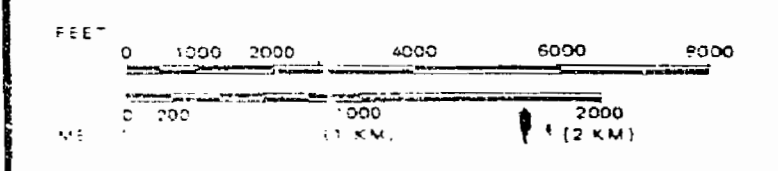

TOWNSHIP  
**HOMUTH**  
 M.N.R. ADMINISTRATIVE DISTRICT  
**COCHRANE**  
 MINING DIVISION  
**PORCUPINE**  
 LAND TITLES / REGISTRY DIVISION  
**COCHRANE**

Ministry of Natural Resources  
 Ministry of Northern Development and Mines

Date NOVEMBER 1986  
 Number  
 Checked Feb 9/87 JPA  
**G-3516**

C-3210

HOMUTH TWP

C-3210

REFERENCES

AREAS WITHDRAWN FROM DISPOSITION

M.R.O. - MINING RIGHTS ONLY  
 S.R.O. - SURFACE RIGHTS ONLY  
 M.+S. - MINING AND SURFACE RIGHTS

Description	Order No.	Date	Disposition	File

SAND and GRAVEL

- Ⓜ M.T.C. PIT 1267
- Ⓜ GRAVEL FILE 171727

THE INFORMATION THAT APPEARS ON THIS MAP HAS BEEN COMPILED FROM VARIOUS SOURCES, AND ACCURACY IS NOT GUARANTEED. THOSE WISHING TO STAKE MINING CLAIMS SHOULD CONSULT WITH THE MINING RECORDER, MINISTRY OF NORTHERN DEVELOPMENT AND MINES, FOR ADDITIONAL INFORMATION ON THE STATUS OF THE LANDS SHOWN HEREON.

AVON TWP.

ADANAC TWP

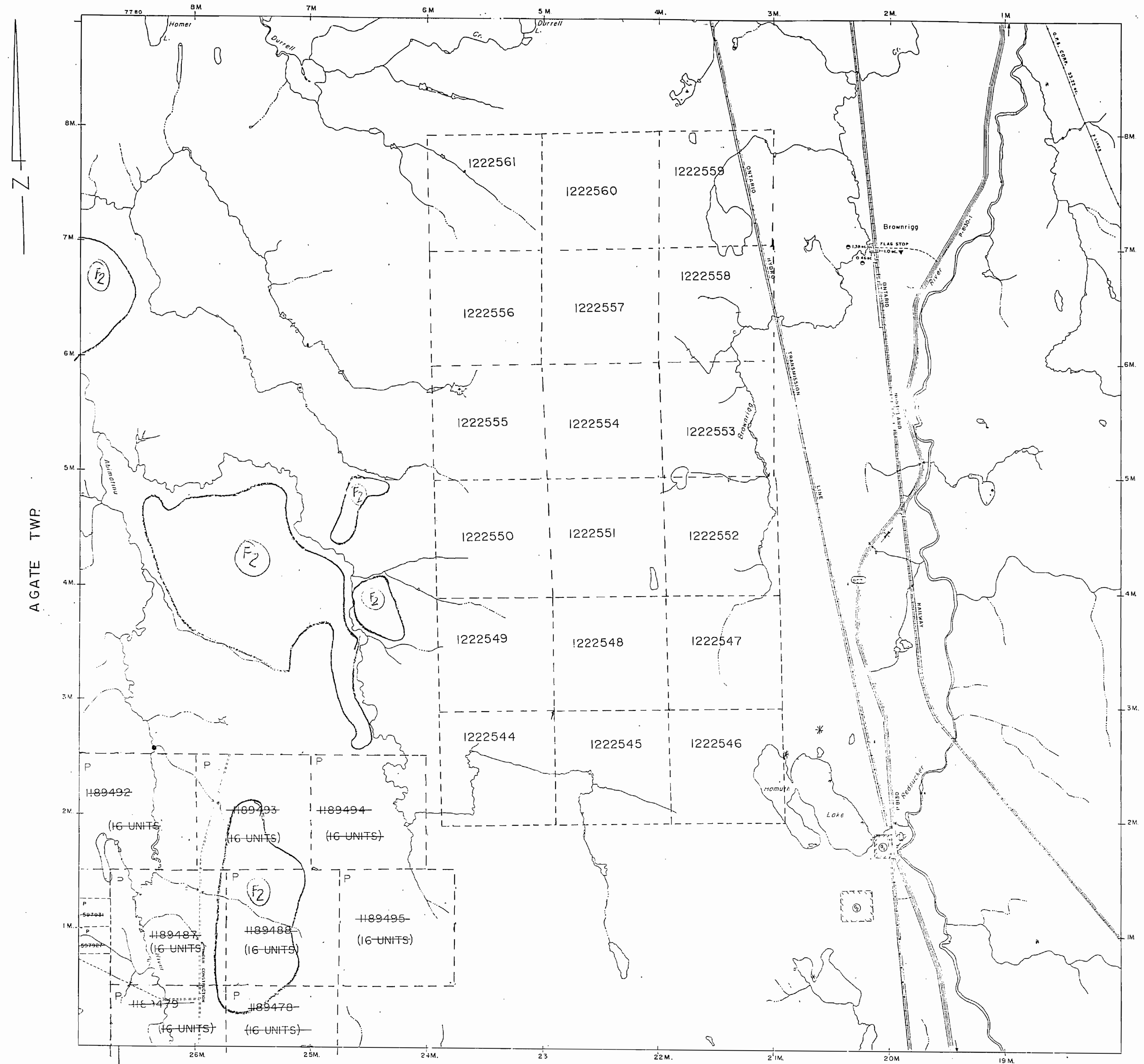

LEGEND

- HIGHWAY AND ROUTE No.
- OTHER ROADS
- TRAILS
- SURVEYED LINES: TOWNSHIPS, BASE LINES, ETC.
- LOTS, MINING CLAIMS, PARCELS, ETC.
- UNSURVEYED LINES: LOT LINES
- PARCEL BOUNDARY
- MINING CLAIMS ETC.
- RAILWAY AND RIGHT OF WAY
- UTILITY LINES
- NON-PERENNIAL STREAM
- FLOODING OR FLOODING RIGHTS
- SUBDIVISION OR COMPOSITE PLAN RESERVATIONS
- ORIGINAL SHORELINE
- MARSH OR MUSKEG
- MINES
- TRAVERSE MONUMENT

DISPOSITION OF CROWN LANDS

TYPE OF DOCUMENT	SYMBOL
TRAPLINE CABINS	•
PATENT, SURFACE & MINING RIGHTS	○
" SURFACE RIGHTS ONLY	○
" MINING RIGHTS ONLY	○
LEASE, SURFACE & MINING RIGHTS	□
" SURFACE RIGHTS ONLY	□
" MINING RIGHTS ONLY	□
LICENCE OF OCCUPATION	□
ORDER-IN-COUNCIL	□
RESERVATION	□
CANCELLED	□
SAND & GRAVEL	□

NOTE: MINING RIGHTS IN PARCELS PATENTED PRIOR TO MAY 5 1913, VESTED IN ORIGINAL PATENTEE BY THE PUBLIC LANDS ACT R.S.O. 1910, CHAP 380, SEC 63 SUBJECT 1

THIS TWP. SUBJECT TO FOREST ACTIVITY IN 1991/92 - FURTHER INFORMATION ON FILE.

THIS TWP. IS SUBJECT TO FOREST ACTIVITY IN 1995/96 FURTHER INFORMATION AVAILABLE ON FILE.

DATE OF ISSUE

MAR 26 1986

PROVINCIAL RECORDING OFFICE - SUDBURY

SCALE: 1 INCH = 40 CHAINS

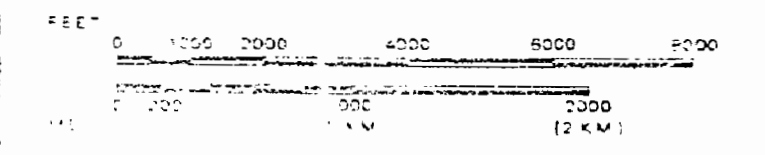

TOWNSHIP  
**HOMUTH**  
 M.N.R. ADMINISTRATIVE DISTRICT  
**COCHRANE**  
 MINING DIVISION  
**PORCUPINE**  
 LAND TITLES / REGISTRY DIVISION  
**COCHRANE**

Ministry of Natural Resources Ontario  
 Ministry of Northern Development and Mines

Date NOVEMBER 1986  
 Checked Feb 9/87 J.P.  
 Number  
**G-3516**

C-3210

C-3210



C-321E

HOMUTH TWP

C-321E

REFERENCES

AREAS WITHDRAWN FROM DISPOSITION

M.R.O. - MINING RIGHTS ONLY  
 S.R.O. - SURFACE RIGHTS ONLY  
 M.+S. - MINING AND SURFACE RIGHTS

Description	Order No.	Date	Disposition	File

SAND and GRAVEL

④ M.T.C. PIT 1267  
 ⑤ GRAVEL FILE 171727

THE INFORMATION THAT APPEARS ON THIS MAP HAS BEEN COMPILED FROM VARIOUS SOURCES, AND ACCURACY IS NOT GUARANTEED. THOSE WISHING TO STAKE MINING CLAIMS SHOULD CONSULT WITH THE MINING RECORDER, MINISTRY OF NORTHERN DEVELOPMENT AND MINES, FOR ADDITIONAL INFORMATION ON THE STATUS OF THE LANDS SHOWN HEREON.

AVON TWP.

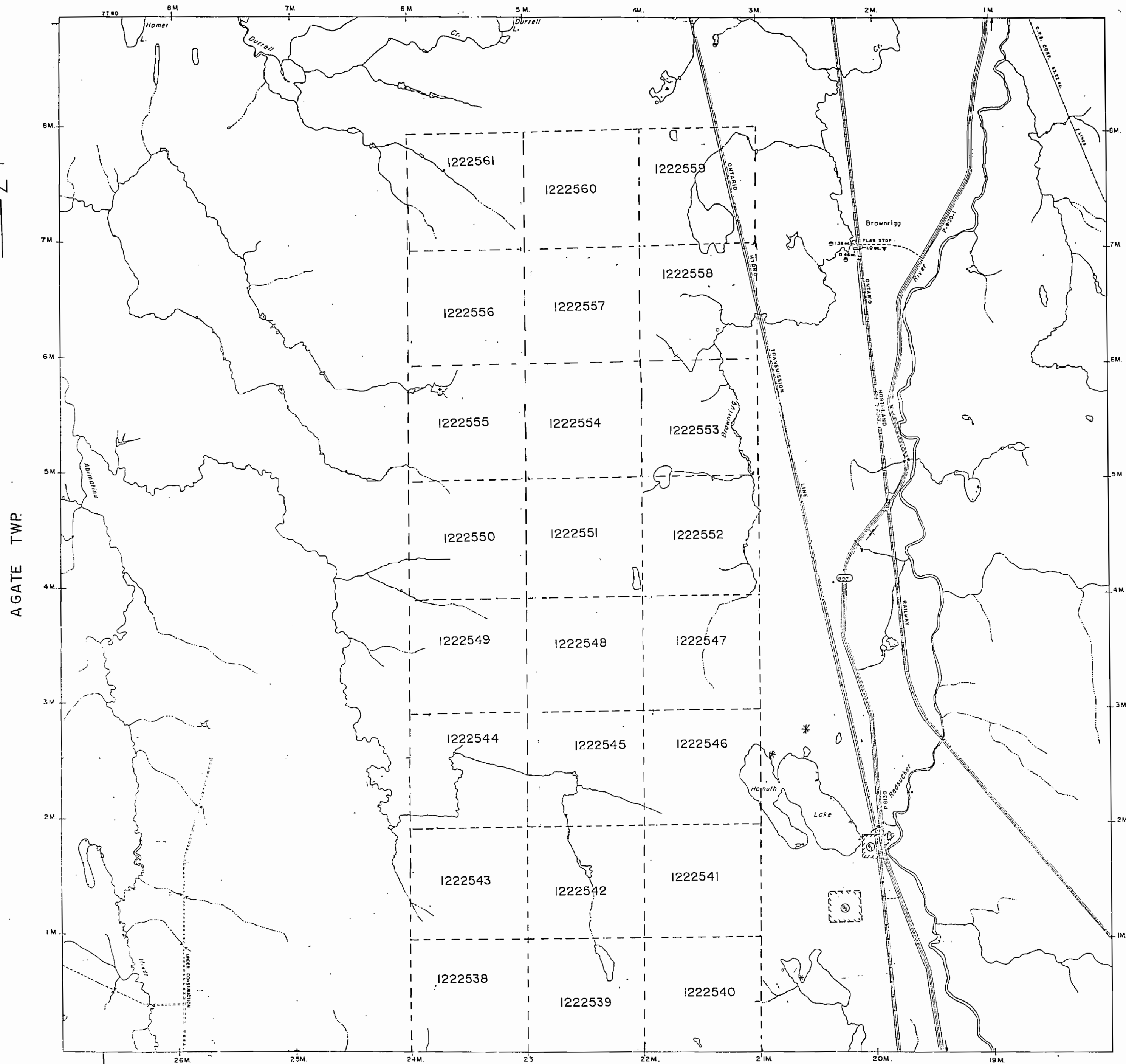

ADANAC TWP

LEGEND

- HIGHWAY AND ROUTE No.
- OTHER ROADS
- TRAILS
- SURVEYED LINES:
  - TOWNSHIPS, BASE LINES, ETC.
  - LOTS, MINING CLAIMS, PARCELS, ETC.
- UNSURVEYED LINES:
  - LOT LINES
  - PARCEL BOUNDARY
  - MINING CLAIMS ETC.
- RAILWAY AND RIGHT OF WAY
- UTILITY LINES
- NON-PERENNIAL STREAM
- FLOODING OR FLOODING RIGHTS
- SUBDIVISION OR COMPOSITE PLAN
- RESERVATIONS
- ORIGINAL SHORELINE
- MARSH OR MUSKEG
- MINES
- TRAVERSE MONUMENT
- L.U.P.

DISPOSITION OF CROWN LANDS

TYPE OF DOCUMENT	SYMBOL
TRAPLINE CABINS	
PATENT, SURFACE & MINING RIGHTS	
SURFACE RIGHTS ONLY	
MINING RIGHTS ONLY	
LEASE, SURFACE & MINING RIGHTS	
SURFACE RIGHTS ONLY	
MINING RIGHTS ONLY	
LICENCE OF OCCUPATION	
ORDER-IN-COUNCIL	
RESERVATION	
CANCELLED	
SAND & GRAVEL	

NOTE: MINING RIGHTS IN PARCELS PATENTED PRIOR TO MAY 6 1913, VESTED IN ORIGINAL PATENTEE BY THE PUBLIC LANDS ACT, R.S.O. 1970, CHAP. 380, SEC. 63, SUBSEC. 1

THIS TWP. SUBJECT TO FOREST ACTIVITY IN 1991/92 - FURTHER INFORMATION ON FILE.

THIS TWP. IS SUBJECT TO FOREST ACTIVITY IN 1995/96 FURTHER INFORMATION AVAILABLE ON FILE.

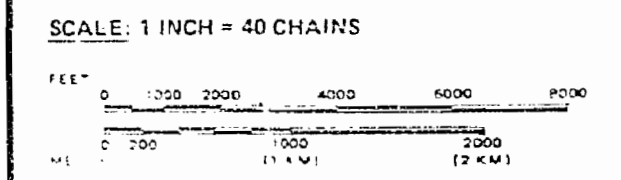

TOWNSHIP  
**HOMUTH**  
 M.N.R. ADMINISTRATIVE DISTRICT  
**COCHRANE**  
 MINING DIVISION  
**PORCUPINE**  
 LAND TITLES / REGISTRY DIVISION  
**COCHRANE**

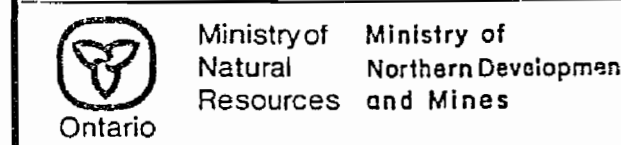

Date NOVEMBER 1986 Number  
 Checked Feb 9/87 J.R. **G-3516**

# PLAN OF HOMUTH TWP.

PORCUPINE MINING DIVISION

## DISTRICT OF COCHRANE.

Scale, 40 chains to an inch.

AVON TWP.

Received  
June 25, 1965

WITHDRAWN FROM STAKING  
Sec. 42 of the Mining Act.  
FILE 271787  
NOLS CP64

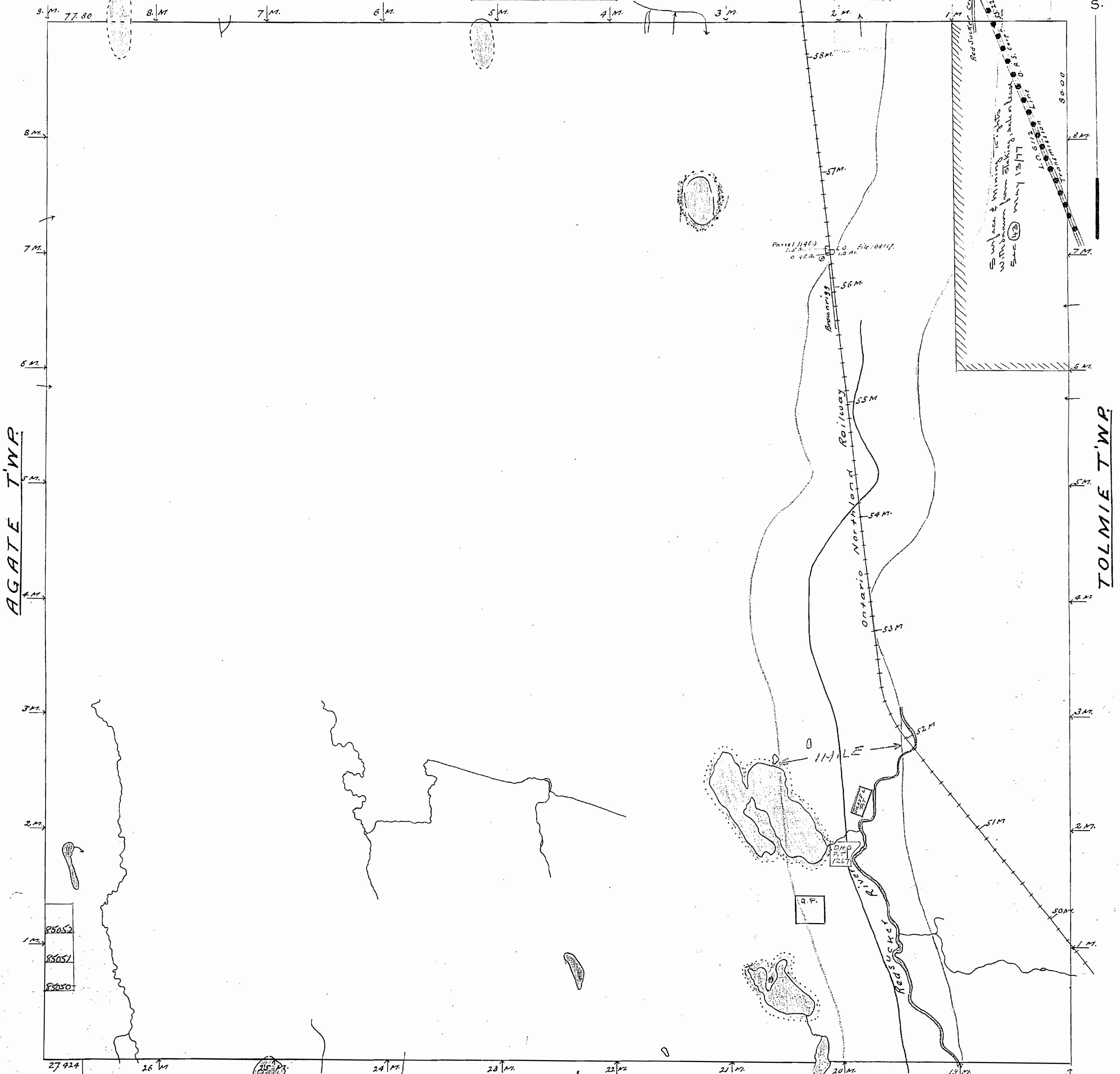
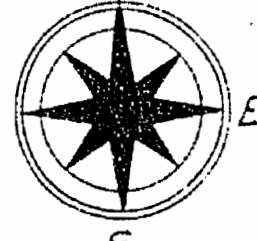





AVON TWP. (M. 409)

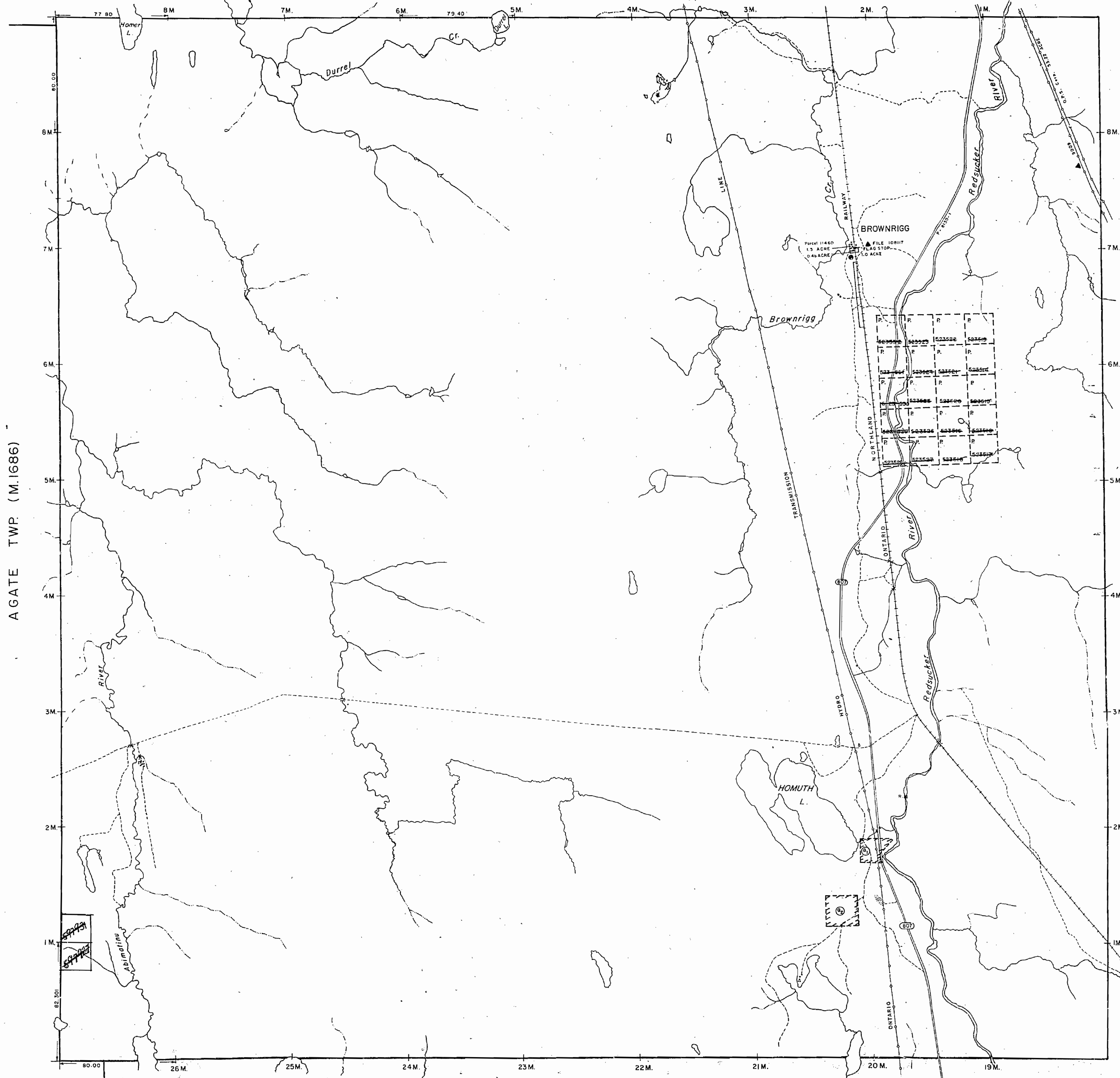

ADANAC TWP. (M. 402)

LEGEND

HIGHWAY AND ROUTE No.	
OTHER ROADS	
TRAILS	
SURVEYED LINES:	
TOWNSHIPS, BASE LINES, ETC.	
LOTS, MINING CLAIMS, PARCELS, ETC.	
UNSURVEYED LINES:	
LOT LINES	
PARCEL BOUNDARY	
MINING CLAIMS ETC.	
RAILWAY AND RIGHT OF WAY	
UTILITY LINES	
NON-PERENNIAL STREAM	
FLOODING OR FLOODING RIGHTS	
SUBDIVISION OR COMPOSITE PLAN	
RESERVATIONS	
ORIGINAL SHORELINE	
MARSH OR MUSKEG	
MINES	
TRAVERSE MONUMENT	

DISPOSITION OF CROWN LANDS

TYPE OF DOCUMENT	SYMBOL
PATENT, SURFACE & MINING RIGHTS	
" SURFACE RIGHTS ONLY	
" MINING RIGHTS ONLY	
LEASE, SURFACE & MINING RIGHTS	
" SURFACE RIGHTS ONLY	
" MINING RIGHTS ONLY	
LICENCE OF OCCUPATION	
ORDER-IN-COUNCIL	
RESERVATION	
CANCELLED	
SAND & GRAVEL	

NOTE: MINING RIGHTS IN PARCELS PATENTED PRIOR TO MAY 6, 1912, VESTED IN ORIGINAL PATENTEES BY THE PUBLIC LANDS ACT, R.S.O. 1970, CHAP. 380, SEC. 63, SUBSEC. 1.

NOTES

400' Surface Rights Reservation along the shores of all lakes and rivers.

SAND & GRAVEL

- ① M.T.C. PIT 1267
- ② GRAVEL FILE 171727

SCALE: 1 INCH = 40 CHAINS

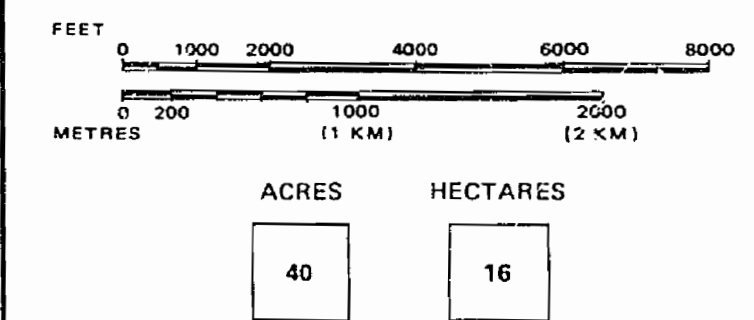

TOWNSHIP OF  
**HOMUTH**  
 DISTRICT OF  
 COCHRANE  
 MINING DIVISION

Received Aug 25/80



Date 29/04/1980 National Topographic Series

Plan No. M. 505