

M 950
ONTARIO

Areas withdrawn from staking under Section 42 of the Mining Act.

File Date Disposition

MINISTRY OF NATURAL RESOURCES

SURVEYS AND MAPPING BRANCH

PLAN OF IRIS TWP.

Sault Ste. Marie - MINING DIVISION.

DISTRICT OF SUDBURY.

Scale, 40 chains to an inch.

NOTE

400' Surface Rights Reservation

around all Lakes and Rivers.

Sec. 35 W-LL P238/99 May 17/99 M+S

HUBBARD TWP.

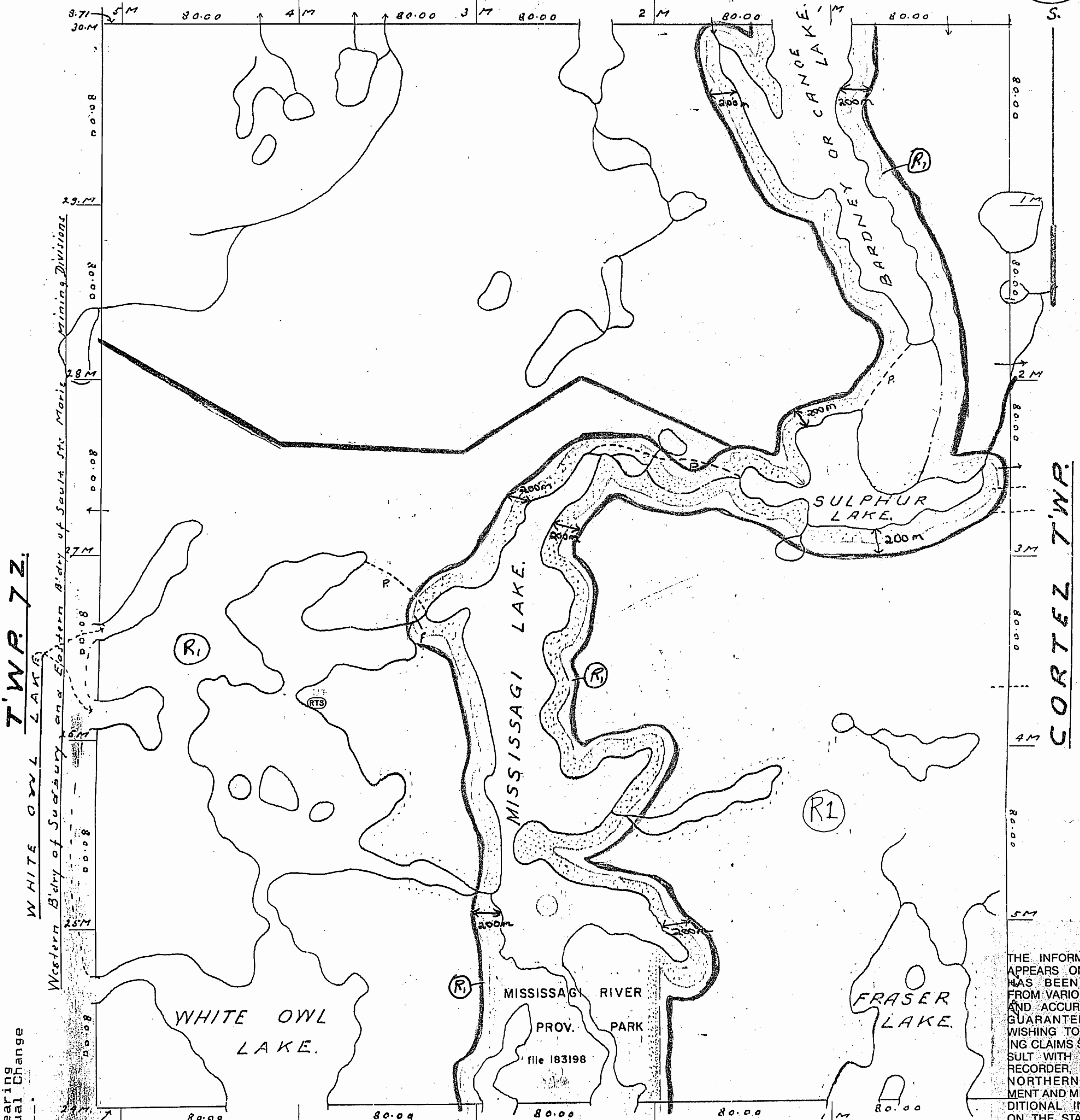
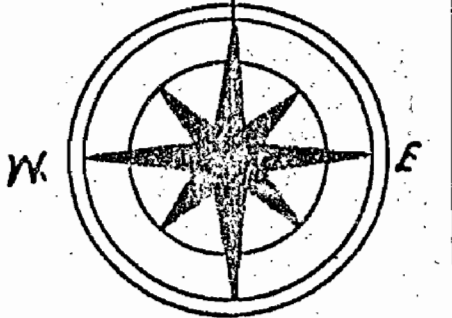

TWP. 7 Z.

CORTEZ TWP.

THE INFORMATION THAT APPEARS ON THIS MAP HAS BEEN COMPILED FROM VARIOUS SOURCES, AND ACCURACY IS NOT GUARANTEED. THOSE WISHING TO STAKE MINING CLAIMS SHOULD CONSULT WITH THE MINING RECORDER, MINISTRY OF NORTHERN DEVELOPMENT AND MINES, FOR ADDITIONAL INFORMATION ON THE STATUS OF THE LANDS SHOWN HEREON.

NOTES:

- Railways shown thus
- Paved Highways
- Gravel
- Other Roads
- Highway Route No.
- Trails & Paths
- Telephone & Telegraph Lines
- Electric Power Lines
- Non-perennial streams
- Bridges
- Buildings
- Areas marked are Patented
- Areas marked are Leased
- Areas marked are held under License of Occupation
- LUP

DATE OF ISSUE

FEB 5 1900

Sault Ste. Marie
Mining Division Office

The 1975 Magnetic Bearing
Approx. 6.30W Annual Change
Increasing

M.950
ONTARIO

Areas withdrawn from staking under Section 42 of the Mining Act.

File	Date	Disposition
163198	SEP. 29, 1970	S.R. & M.R.
	JAN. 25, 1971	SR & MR

DATE OF ISSUE
JUL 4 1975

PLAN OF IRIS TWP.

MINISTRY OF NATURAL RESOURCES
SURVEYS AND MAPPING BRANCH

PORCUPINE-MINING DIVISION
DISTRICT OF SUDBURY.

— Scale, 40 chains to an inch. —

NOTE
400' Surface Rights Reservation
around all Lakes and Rivers.

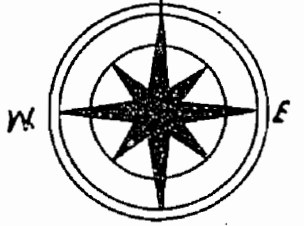

HUBBARD TWP.

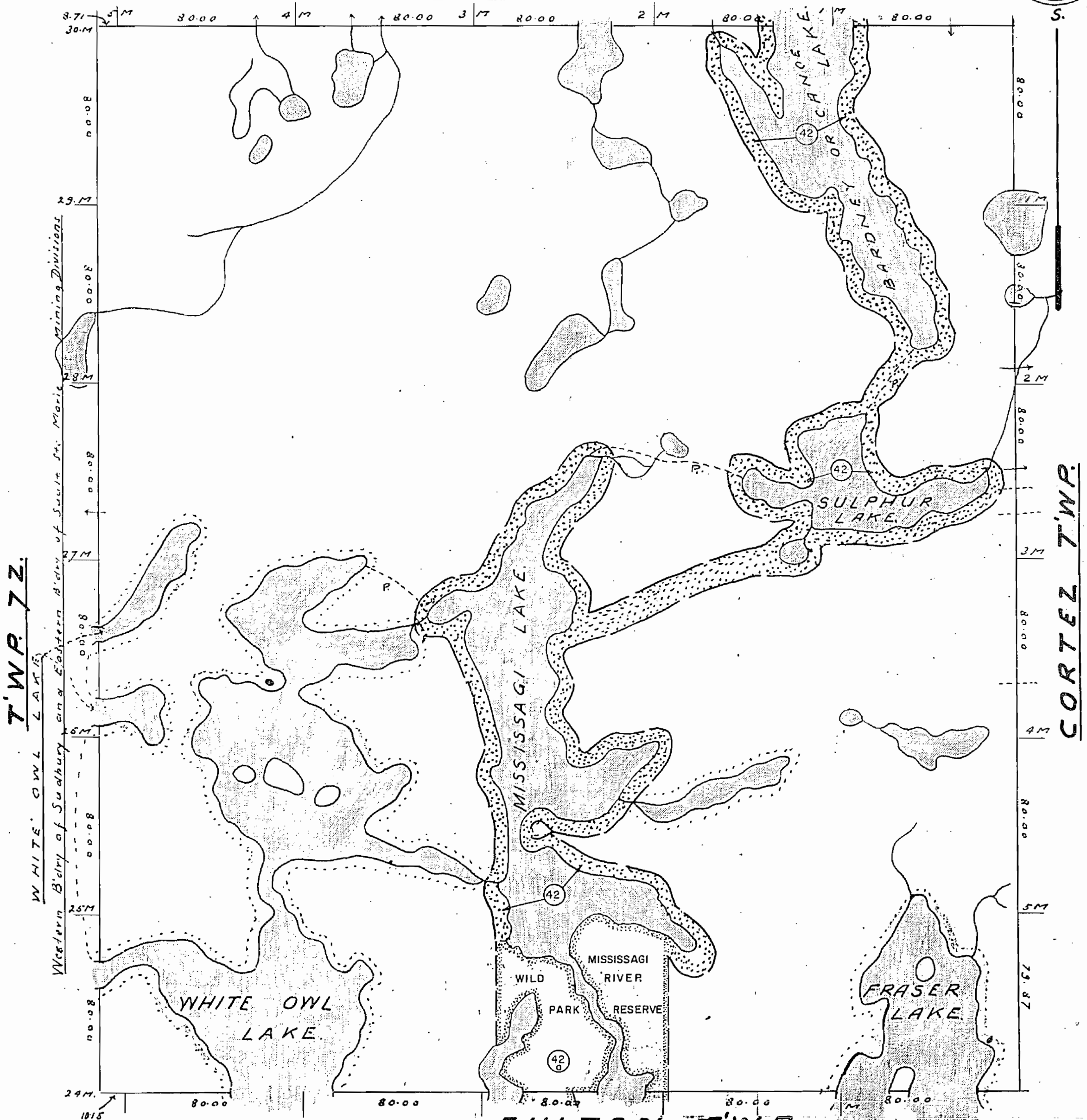

NOTES:

- | | |
|-----------------------------|-------------------------------|
| Railways Shown thus | Non-perennial streams |
| Paved Highways | Bridges |
| Gravel | Buildings |
| Other Roads | Areas marked (P) are Patented |
| Highway Route No. | (L) are Leased |
| Trails & Paths | (L.O.) are held under |
| Telephone & Telegraph Lines | License of Occupation |
| Electric Power Lines | |

RECEIVED
JUL 14 1975
7 8 9 10 11 12 1 2 3 4 5 6