

1697

LATREILLE LAKE (M. 2689)

AREA OF
JUBILEE LAKE

DISTRICT OF
KENORA
(PATRICIA PORTION)

RED LAKE
MINING DIVISION

SCALE: 1-INCH = 40 CHAINS

LEGEND

- PATENTED LAND Ⓟ
- CROWN LAND SALE C.S.
- LEASES Ⓞ
- LOCATED LAND Loc.
- LICENSE OF OCCUPATION L.O.
- MINING RIGHTS ONLY M.R.G.
- SURFACE RIGHTS ONLY S.R.O.
- ROADS —
- IMPROVED ROADS —
- KING'S HIGHWAYS —
- RAILWAYS —
- POWER LINES —
- MARSH OR MUSKEG —
- MINES *
- CANCELLED C.

NOTES

400' Reserve around all Lakes & Rivers
to Dept. of Lands & Forests.

July 27, 1960



PLAN NO. **M. 1697**

DEPARTMENT OF MINES
— ONTARIO —

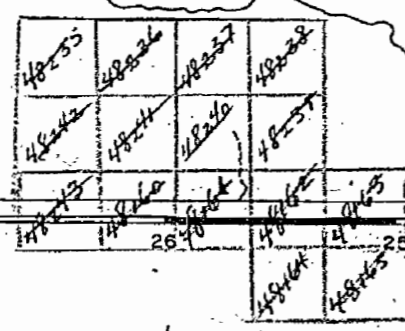
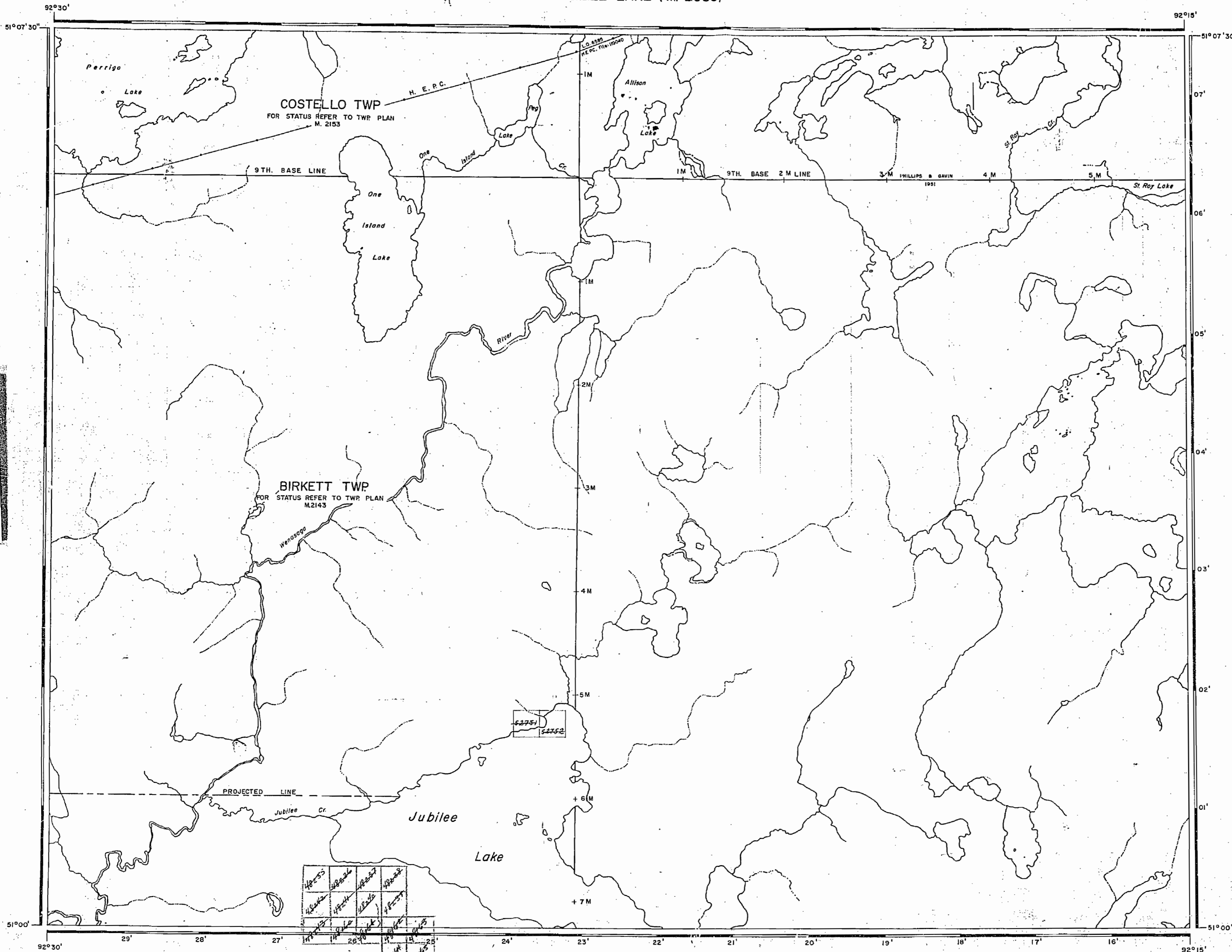

AVIS LAKE (M. 2410)

JEANETTE LAKE (M. 1654)

JUBILEE LAKE (M. 1697)
UCHI LA (57)

51°00' 92°30' 29' 28' 27' 26' 25' 24' 23' 22' 21' 20' 19' 18' 17' 16' 51°00' 92°15'

LATREILLE LAKE G-1806

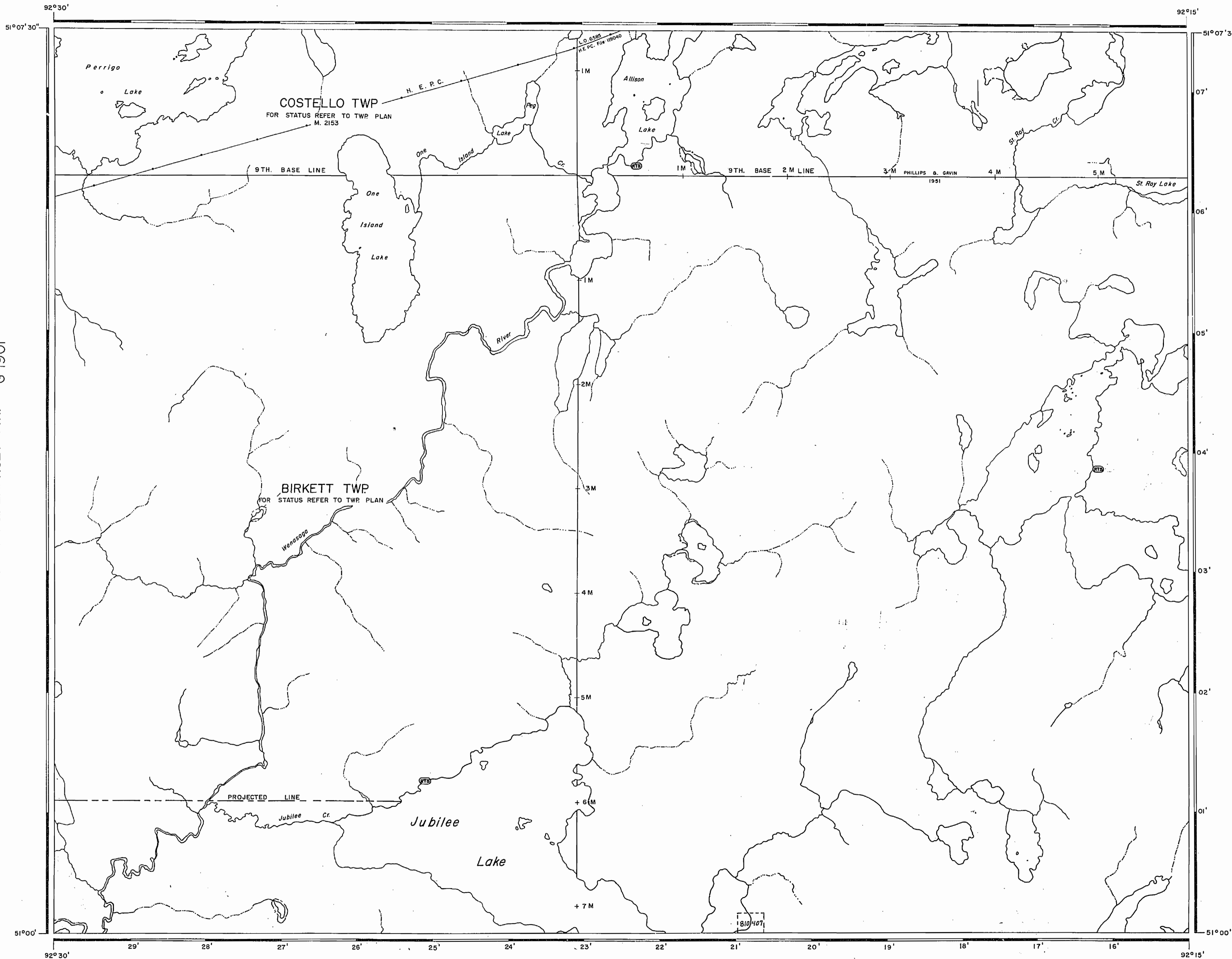

UCHI LAKE & EARNGEY TWP. G 1901

JEANETTE LAKE G 2076

AVIS LAKE G 1734

REFERENCES

AREAS WITHDRAWN FROM DISPOSITION

- M.R.O. - MINING RIGHTS ONLY
- S.R.O. - SURFACE RIGHTS ONLY
- M.+S. - MINING AND SURFACE RIGHTS

Description	Order No.	Date	Disposition	File

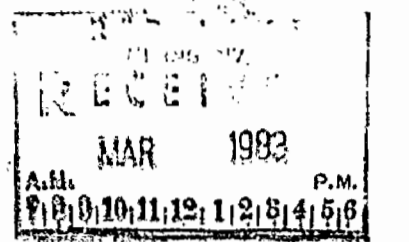

LEGEND

- HIGHWAY AND ROUTE No.
- OTHER ROADS
- TRAILS
- SURVEYED LINES:
 - TOWNSHIPS, BASE LINES, ETC.
 - LOTS, MINING CLAIMS, PARCELS, ETC.
- UNSURVEYED LINES:
 - LOT LINES
 - PARCEL BOUNDARY
 - MINING CLAIMS ETC.
- RAILWAY AND RIGHT OF WAY
- UTILITY LINES
- NON-PERENNIAL STREAM
- FLOODING OR FLOODING RIGHTS
- SUBDIVISION OR COMPOSITE PLAN
- RESERVATIONS
- ORIGINAL SHORELINE
- MARSH OR MUSKEG
- MINES
- TRAVERSE MONUMENT
- REMOTE TOURISM SITE

DISPOSITION OF CROWN LANDS

TYPE OF DOCUMENT	SYMBOL
PATENT, SURFACE & MINING RIGHTS	
" SURFACE RIGHTS ONLY	
" MINING RIGHTS ONLY	
LEASE, SURFACE & MINING RIGHTS	
" SURFACE RIGHTS ONLY	
" MINING RIGHTS ONLY	
LICENCE OF OCCUPATION	
ORDER-IN-COUNCIL	
RESERVATION	
CANCELLED	
SAND & GRAVEL	

NOTE: MINING RIGHTS IN PARCELS PATENTED PRIOR TO MAY 6, 1913, VESTED IN ORIGINAL PATENTEES BY THE PUBLIC LANDS ACT, R.S.O. 1970, CHAP. 380, SEC. 63, SUBSEC. 1.

SCALE: 1 INCH = 40 CHAINS

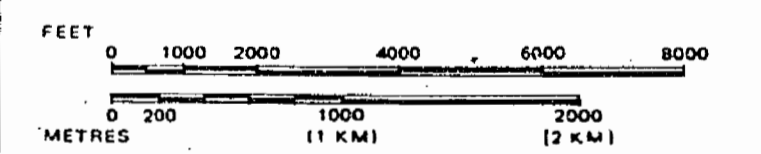

AREA
JUBILEE LAKE
 M.N.R. ADMINISTRATIVE DISTRICT
 RED LAKE/SIOUX LOOKOUT
 MINING DIVISION
 RED LAKE
 LAND TITLES / REGISTRY DIVISION
 KENORA/PATRICIA

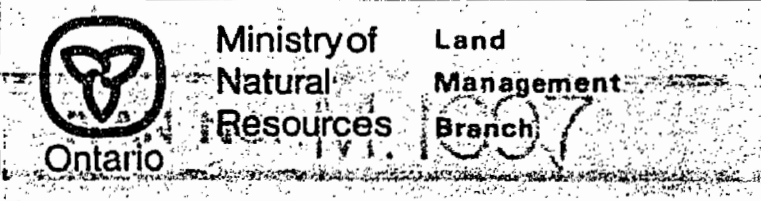

Date FEBRUARY 14, 1983
 Number of MINES
G-1798

1697

LATREILLE LAKE (M. 2689)

AREA OF
JUBILEE LAKE

DISTRICT OF
KENORA
(PATRICIA PORTION)

RED LAKE
MINING DIVISION

SCALE: 1-INCH = 40 CHAINS

LEGEND

- PATENTED LAND Ⓟ
- CROWN LAND SALE C.S.
- LEASES Ⓛ
- LOCATED LAND Loc.
- LICENSE OF OCCUPATION L.O.
- MINING RIGHTS ONLY M.R.O.
- SURFACE RIGHTS ONLY S.R.O.
- ROADS —
- IMPROVED ROADS —
- KING'S HIGHWAYS —
- RAILWAYS —
- POWER LINES —
- MARSH OR MUSKEG —
- MINES —
- CANCELLED —

NOTES

400' Reserve around all Lakes & Rivers
to Dept. of Lands & Forests:

July 27, 1960



PLAN NO. M. 1697

DEPARTMENT OF MINES
— ONTARIO —

JUBILEE LAKE (M. 1697)
UCHI LA

JEANETTE LAKE (M. 1654)

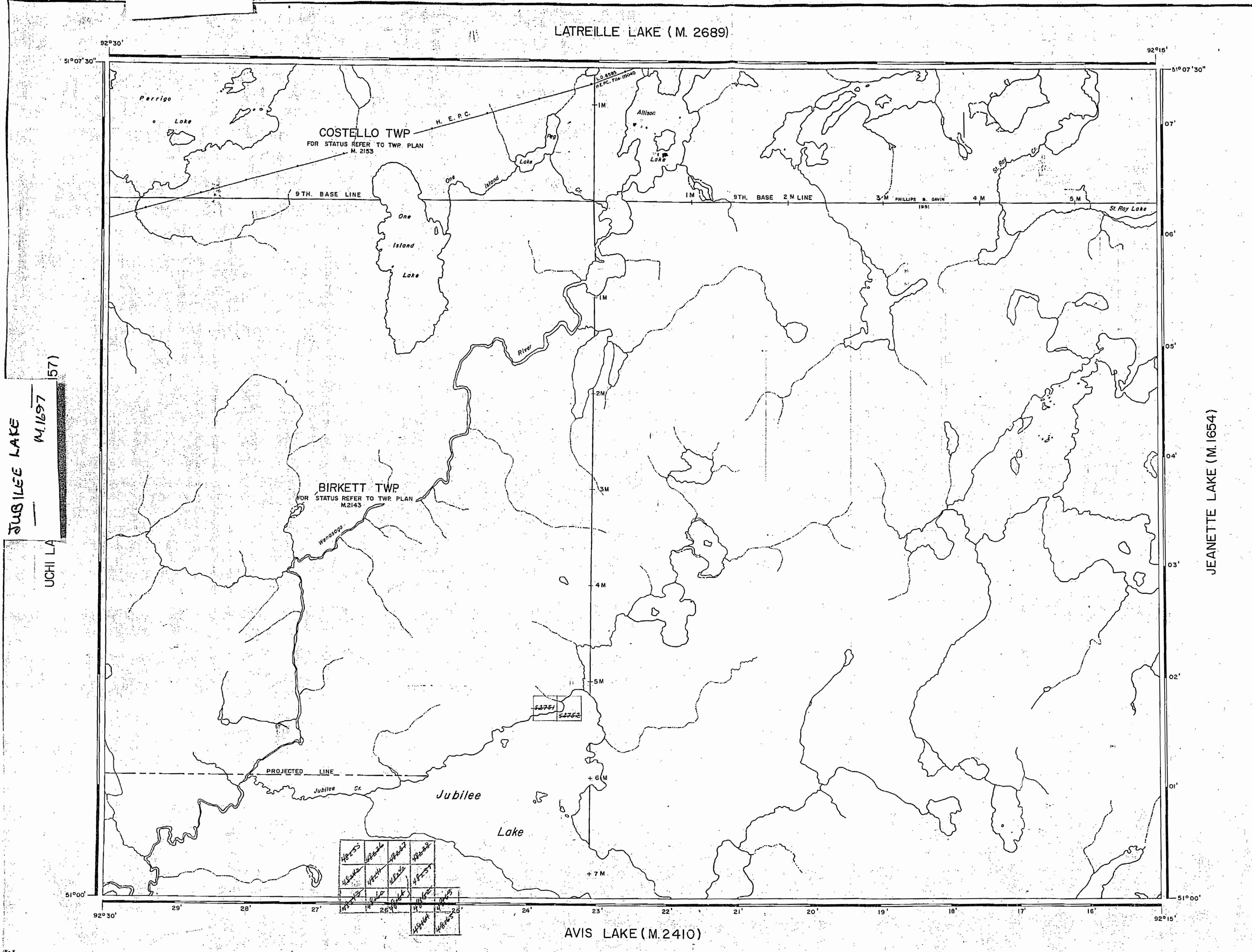

48255	48256	48257	48258
48259	48260	48261	48262
48263	48264	48265	48266
48267	48268	48269	48270