

NOTES

400' surface rights reservation along the shores of all lakes and rivers.

Sections 4, 9, 16, 20, 21, 29 & 31 do not exist but form parts of lots 1-48 Rainy River Range.

KENORA MINING DIV.
 RECEIVED
 NOV 4 1975
 AM 7 8 9 10 11 12 1 2 3 4 5 6 PM

DATE OF ISSUE
 OCT 28 1975

CARPENTER TP. M.2070

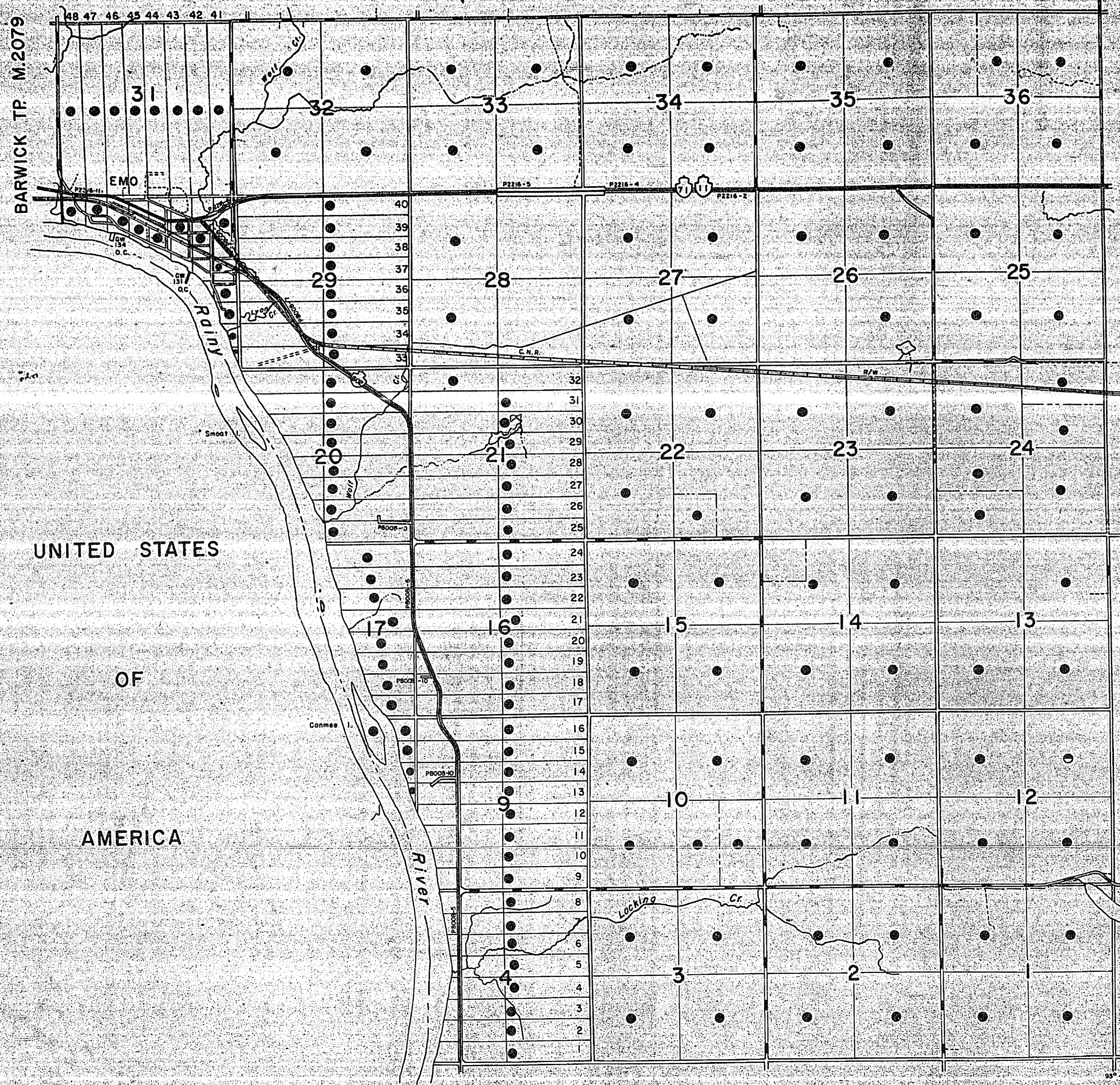

LEGEND

- (HIGHWAY AND ROUTE No. OTHER ROADS)
- TRAILS
- SURVEYED LINES: TOWNSHIPS, BASE LINES, ETC. LOTS, MINING CLAIMS, PARCELS, ETC.
- UNSURVEYED LINES: LOT LINES PARCEL BOUNDARY MINING CLAIMS ETC.
- RAILWAY AND RIGHT OF WAY
- UTILITY LINES
- NON-PERENNIAL STREAM
- FLOODING OR FLOODING RIGHTS
- SUBDIVISION
- ORIGINAL SHORELINE
- MARSH OR MUSKEG
- MINES

DISPOSITION OF CROWN LANDS

TYPE OF DOCUMENT	SYMBOL
PATENT SURFACE & MINING RIGHTS	●
SURFACE RIGHTS ONLY	○
MINING RIGHTS ONLY	◐
LEASE SURFACE & MINING RIGHTS	■
SURFACE RIGHTS ONLY	□
MINING RIGHTS ONLY	◑
LICENCE OF OCCUPATION	▼
CROWN LAND SALE	CS
ORDER-IN-COUNCIL	OC
RESERVATION	⊙
CANCELLED	⊖
SAND & GRAVEL	⊕

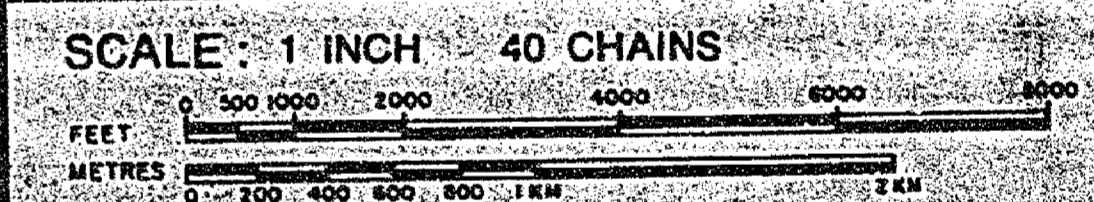

ACRES	HECTARES
40	16

TOWNSHIP
LASH
 DISTRICT
 RAINY RIVER
 MINING DIVISION
 KENORA

Ministry of Natural Resources
 Ontario Surveys and Mapping Branch

Date AUG 75 Plan No. M. 2091
 Whitney Block Queen's Park, Toronto

AYLSWORTH TP. M.1637

NOTES

400' surface rights reservation along the shores of all lakes and rivers.

Sections 4, 9, 16, 20, 21, 29 & 31 do not exist but form parts of lots 1-48 Rainy River Range.

Retired from Service 97.05.16 SR

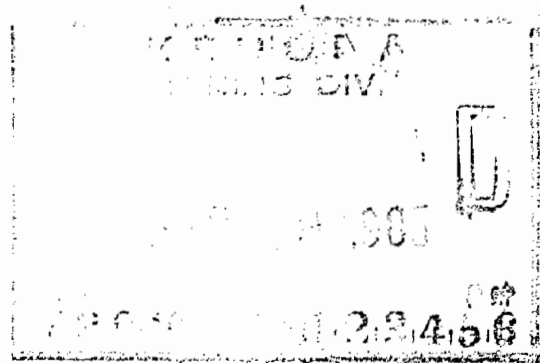

*Whitney Block
Queen's Park*

G3798
CARPENTER TP. M.2070

ORSOLETE

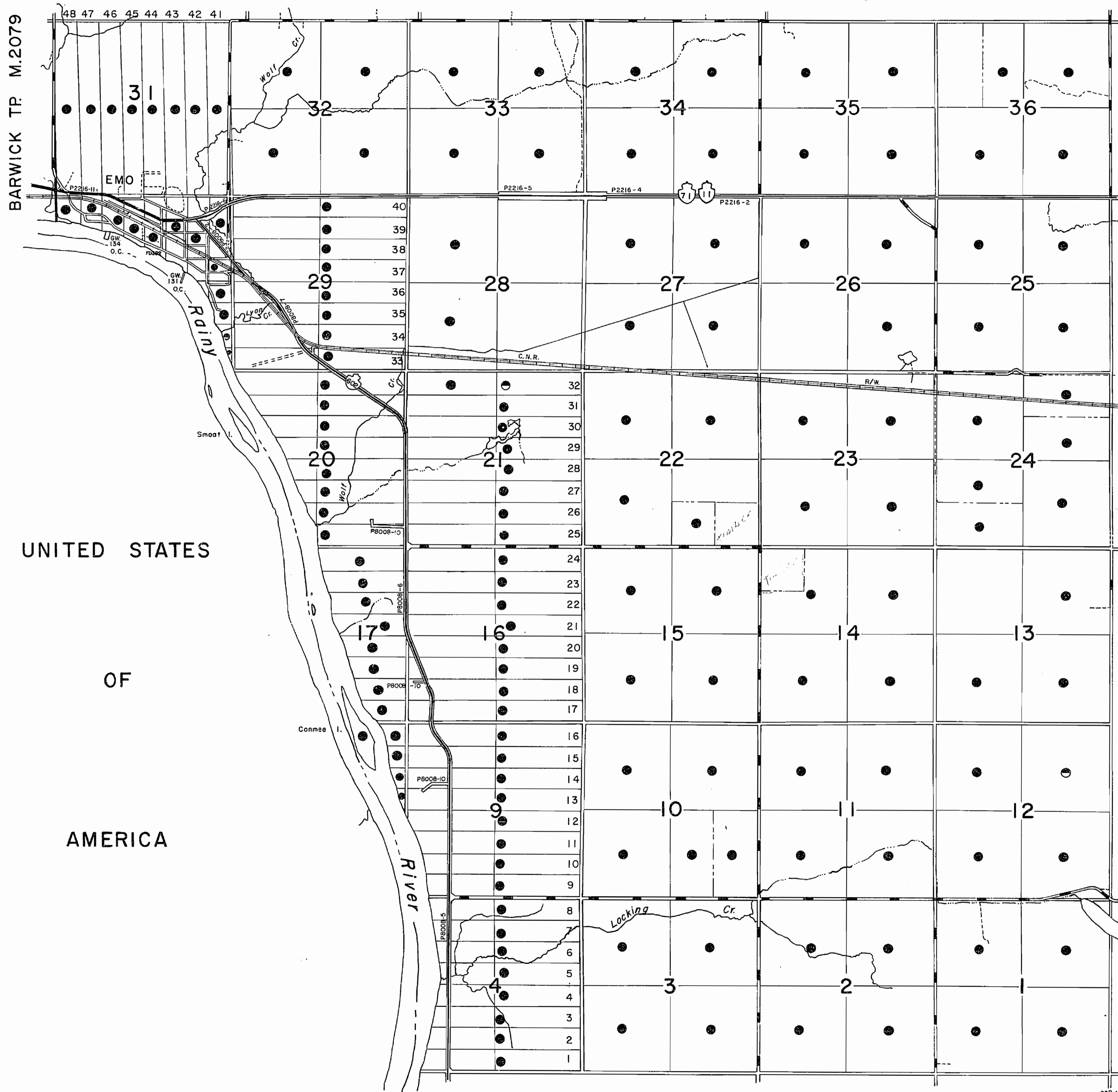

LEGEND

- HIGHWAY AND ROUTE No.
- OTHER ROADS
- TRAILS
- SURVEYED LINES:
 - TOWNSHIPS, BASE LINES, ETC.
 - LOTS, MINING CLAIMS, PARCELS, ETC.
- UNSURVEYED LINES:
 - LOT LINES
 - PARCEL BOUNDARY
 - MINING CLAIMS ETC.
- RAILWAY AND RIGHT OF WAY
- UTILITY LINES
- NON-PERENNIAL STREAM
- FLOODING OR FLOODING RIGHTS
- SUBDIVISION
- ORIGINAL SHORELINE
- MARSH OR MUSKEG
- MINES

DISPOSITION OF CROWN LANDS

TYPE OF DOCUMENT	SYMBOL
PATENT, SURFACE & MINING RIGHTS	
" SURFACE RIGHTS ONLY	
" MINING RIGHTS ONLY	
LEASE, SURFACE & MINING RIGHTS	
" SURFACE RIGHTS ONLY	
" MINING RIGHTS ONLY	
LICENCE OF OCCUPATION	
CROWN LAND SALE	
ORDER-IN-COUNCIL	
RESERVATION	
CANCELLED	
SAND & GRAVEL	

THE INFORMATION THAT APPEARS ON THIS MAP HAS BEEN COMPILED FROM VARIOUS SOURCES AND ACCURACY IS NOT GUARANTEED. THOSE WISHING TO STAKE MINING CLAIMS SHOULD CONSULT WITH THE MINING RECORDER, MINISTRY OF NORTHERN DEVELOPMENT AND MINES, FOR ADDITIONAL INFORMATION ON THE STATUS OF THE LANDS SHOWN HEREON.

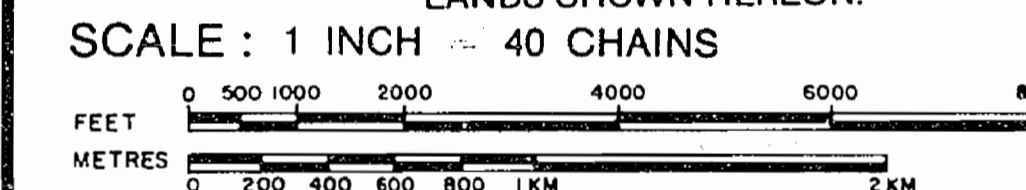

ACRES	HECTARES
40	16

TOWNSHIP

LASH

DISTRICT

RAINY RIVER

MINING DIVISION

KENORA

Ministry of Natural Resources

Ontario Surveys and Mapping Branch

Date AUG. '75

Plan No.

Whitney Block
Queen's Park, Toronto

M. 2091

AYLSWORTH TP. M.1637

48°33'37"
93°43'02" Approx.

LASH

RAINY RIVER DISTRICT

Scale: 40 Chs = 1 in

CARPENTER



NOTES

100' surface rights reservation along the shores of all lakes and rivers.

Sections 4, 9, 15, 20, 21, 29 & 31 do not exist but form parts of lots 1-48 Rainy River Range.

KENORA MINING DIV.
EXCISE D
 NOV 4 1975
 AM 7 8 9 10 11 12 1 2 3 4 5 6 PM

DATE OF ISSUE
 OCT 28 1975

CARPENTER TP. M.2070

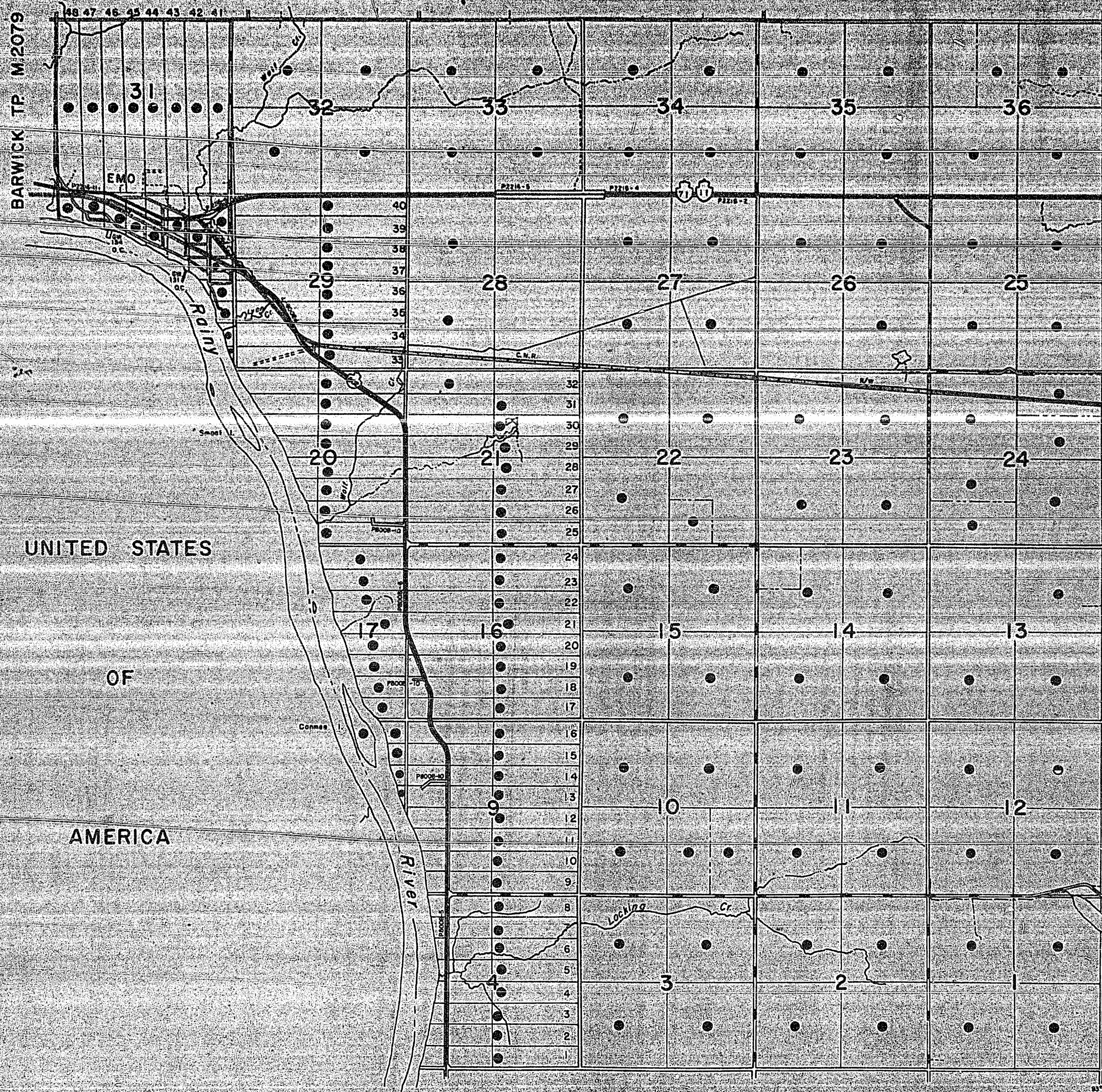

UNITED STATES
 OF
 AMERICA

LEGEND

- HIGHWAY AND ROUTE NO.
- OTHER ROADS
- TRAILS
- SURVEYED LINES:
 - TOWNSHIP'S BASE LINES, ETC.
 - LOTS, MINING CLAIMS, PARCELS, ETC.
- UNSURVEYED LINES:
 - LOT LINES
 - PARCEL BOUNDARY
 - MINING CLAIMS ETC.
- RAILWAY AND RIGHT OF WAY
- UTILITY LINES
- NON-PERENNIAL STREAM
- FLOODING OR FLOODING RIGHTS
- SUBDIVISION
- ORIGINAL SHORELINE
- MARSH OR MUSKEG
- MINES

DISPOSITION OF CROWN LANDS

- | TYPE OF DOCUMENT | SYMBOL |
|--------------------------------|--------|
| PATENT SURFACE & MINING RIGHTS | |
| SURFACE RIGHTS ONLY | |
| MINING RIGHTS ONLY | |
| LEASE SURFACE & MINING RIGHTS | |
| SURFACE RIGHTS ONLY | |
| MINING RIGHTS ONLY | |
| LICENCE OF OCCUPATION | |
| CROWN LAND SALE | |
| ORDER-IN-COUNCIL | |
| RESERVATION | |
| CANCELLED | |
| SAND & GRAVEL | |

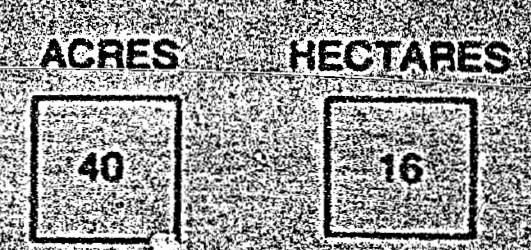
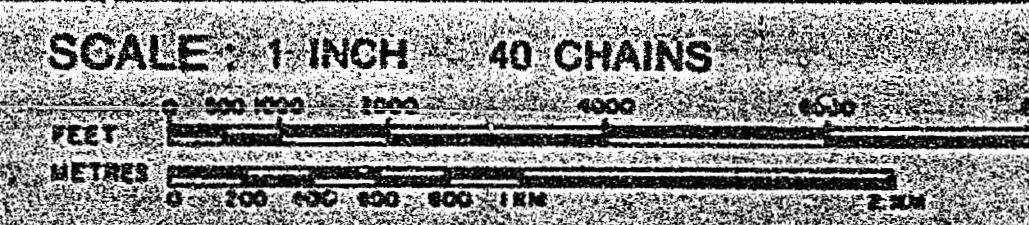

TOWNSHIP
LASH
 DISTRICT
RAINY RIVER
 MINING DIVISION
KENORA

Ministry of Natural Resources
 Ontario Surveys and Mapping Branch

AYLSWORTH TP. M.1637

Date: Aug 75
 Plan No. M.2091
 Whitney Block, Queen's Park, Toronto

NOTES

400' surface rights reservation along the shores of all lakes and rivers.

Sections 4, 9, 16, 20, 21, 29 & 31 do not exist but form parts of lots 1-48 Rainy River Range.

Effective as from

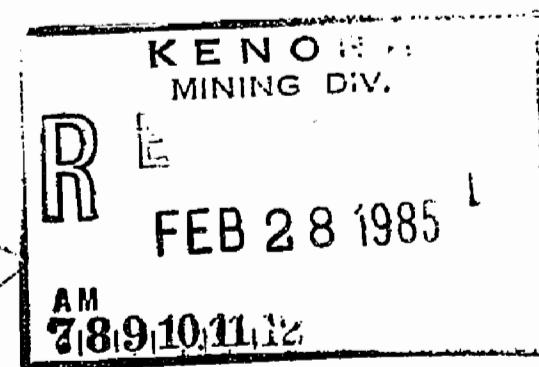
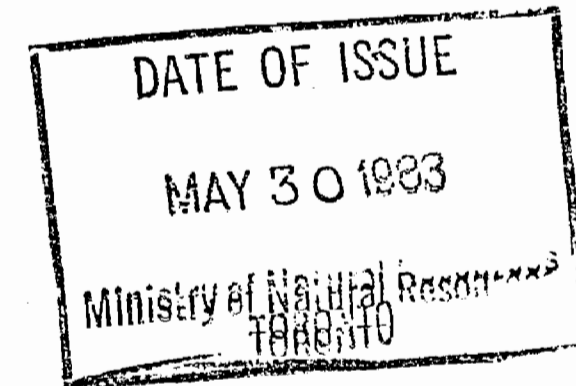
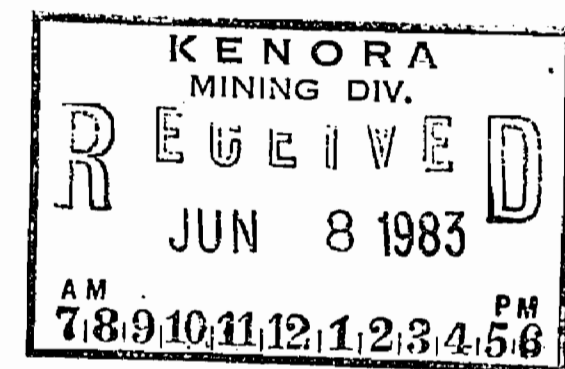

Obsolete

CARPENTER TP. M.2070

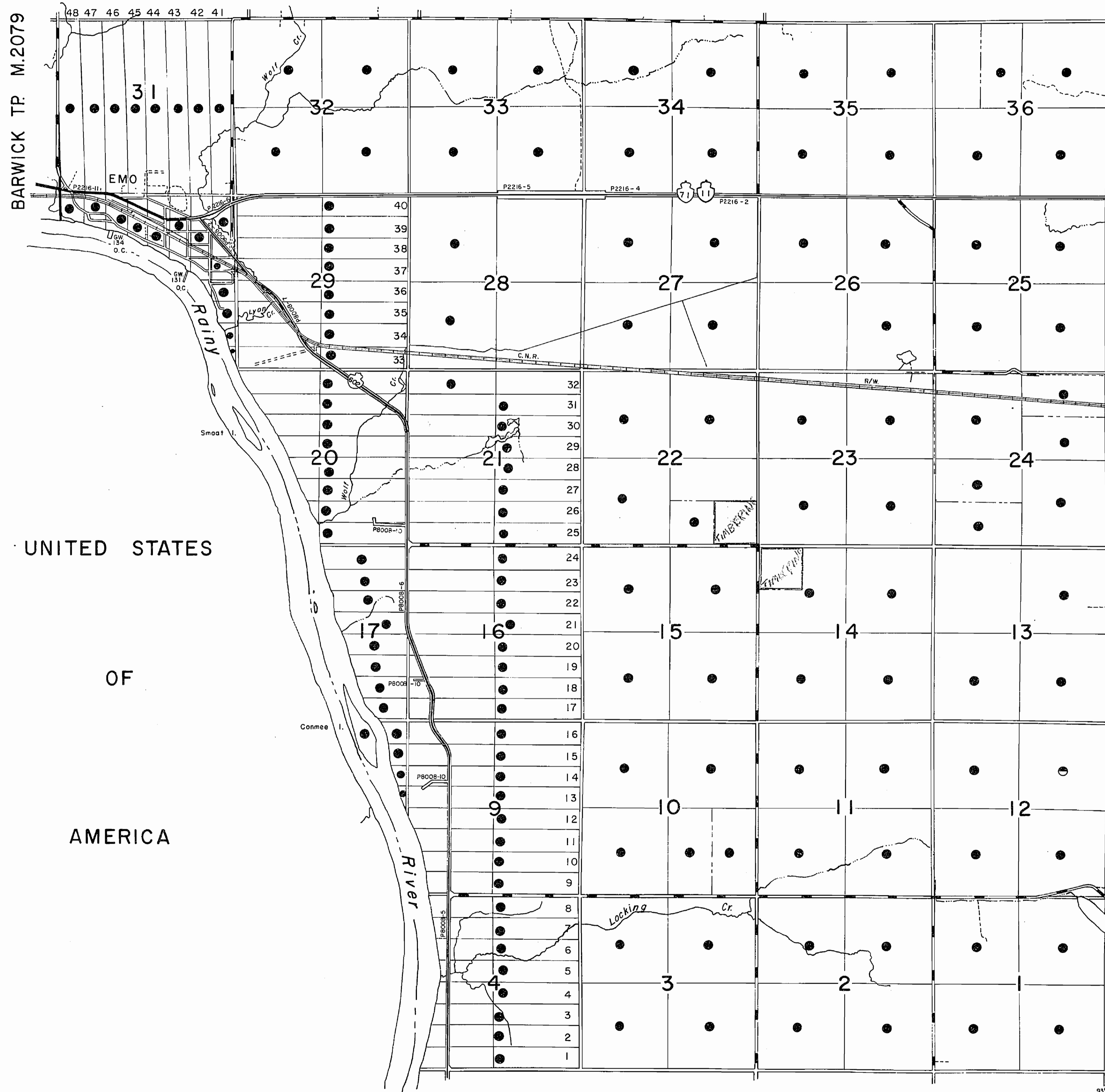

LEGEND

- HIGHWAY AND ROUTE No.
- OTHER ROADS
- TRAILS
- SURVEYED LINES:
 - TOWNSHIPS, BASE LINES, ETC.
 - LOTS, MINING CLAIMS, PARCELS, ETC.
- UNSURVEYED LINES:
 - LOT LINES
 - PARCEL BOUNDARY
 - MINING CLAIMS ETC.
- RAILWAY AND RIGHT OF WAY
- UTILITY LINES
- NON-PERENNIAL STREAM
- FLOODING OR FLOODING RIGHTS
- SUBDIVISION
- ORIGINAL SHORELINE
- MARSH OR MUSKEG
- MINES

DISPOSITION OF CROWN LANDS

- | TYPE OF DOCUMENT | SYMBOL |
|---------------------------------|--------|
| PATENT, SURFACE & MINING RIGHTS | ● |
| " SURFACE RIGHTS ONLY | ○ |
| " MINING RIGHTS ONLY | ◐ |
| LEASE, SURFACE & MINING RIGHTS | ■ |
| " SURFACE RIGHTS ONLY | ◼ |
| " MINING RIGHTS ONLY | ◻ |
| LICENCE OF OCCUPATION | ▼ |
| CROWN LAND SALE | C.S. |
| ORDER-IN-COUNCIL | OC |
| RESERVATION | ⊙ |
| CANCELLED | ⊗ |
| SAND & GRAVEL | ⊕ |

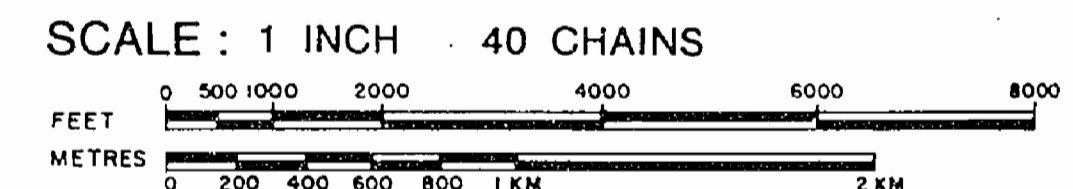

ACRES	HECTARES
40	16

TOWNSHIP
LASH
DISTRICT
RAINY RIVER
MINING DIVISION
KENORA



Date AUG '75 Plan No. M. 2091
Whitney Block Queen's Park, Toronto

AYLSWORTH TP. M.1637



2091

RAINY RIVER DISTRICT

Scale: 4000 ft = 1 in

CARPENTER

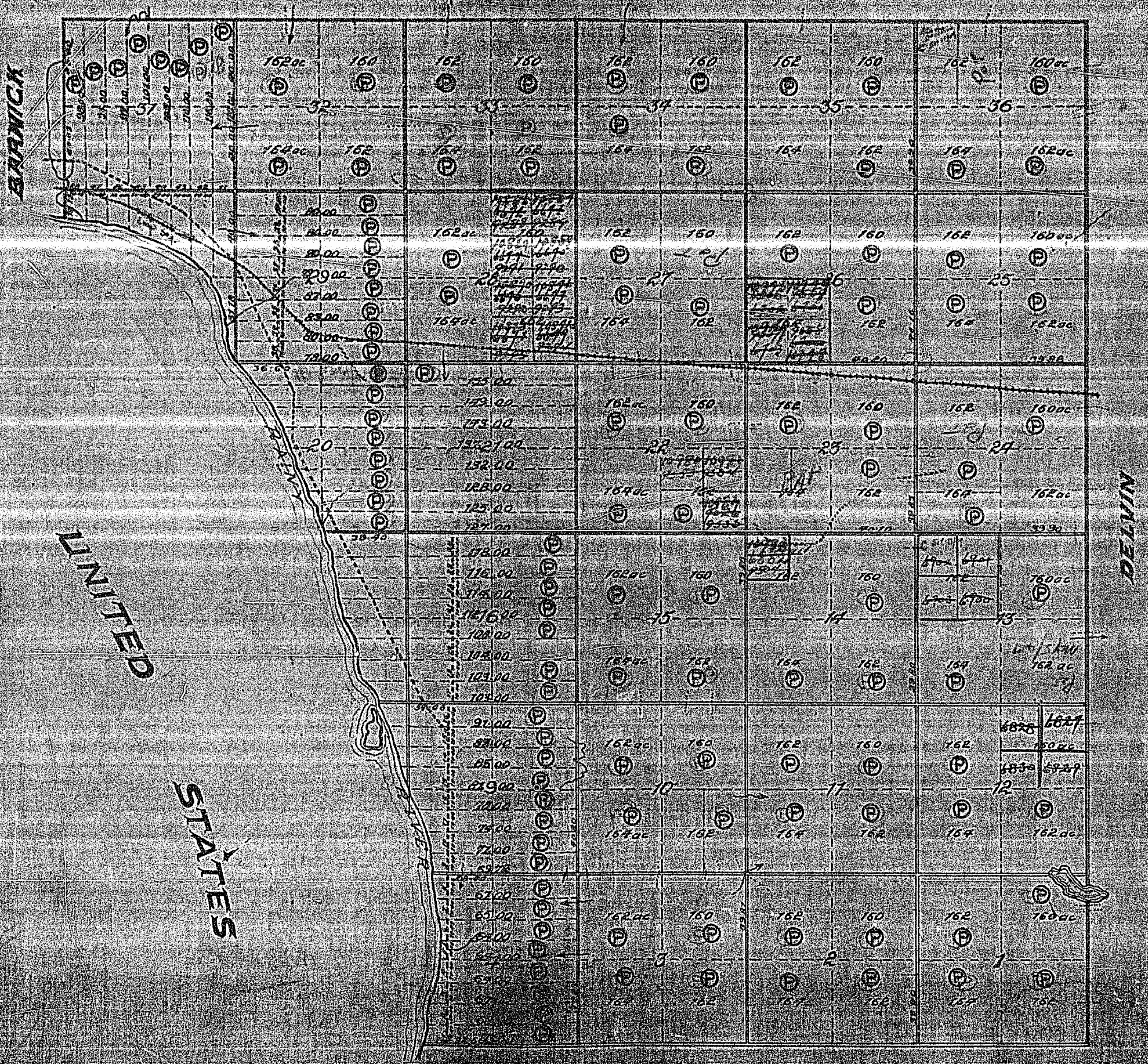

Ed E. ...
Map ...
August

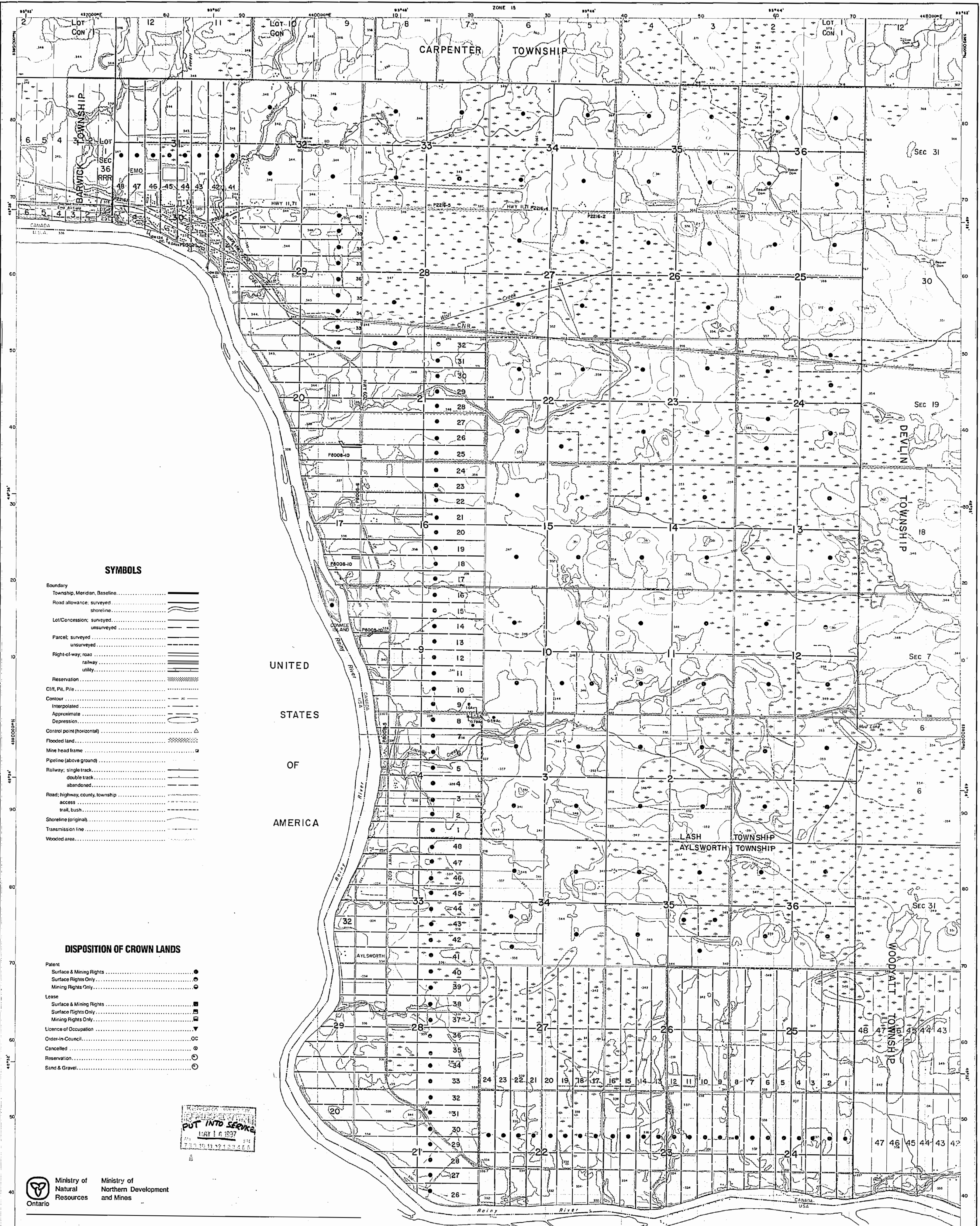

- SYMBOLS**
- Boundary
 - Township, Meridian, Baseline
 - Road allowance, surveyed
 - shoreline
 - Lot/Concession, surveyed
 - unsurveyed
 - Parcel: surveyed
 - unsurveyed
 - Right-of-way, road
 - railway
 - utility
 - Reservation
 - Cltf, Pa, Pile
 - Contour
 - Interpolated
 - Approximate
 - Depression
 - Control point (horizontal)
 - Flooded land
 - Mine head frame
 - Pipeline (above ground)
 - Railway: single track
 - double track
 - abandoned
 - Road: highway, county, township
 - access
 - trail, bush
 - Shoreline (original)
 - Transmission line
 - Wooded area

- DISPOSITION OF CROWN LANDS**
- Patent
 - Surface & Mining Rights
 - Surface Rights Only
 - Mining Rights Only
 - Lease
 - Surface & Mining Rights
 - Surface Rights Only
 - Mining Rights Only
 - Licence of Occupation
 - Order-in-Council
 - Cancelled
 - Reservation
 - Sand & Gravel

PUT INTO SERVICE
MAY 1 6 1937

Ministry of Natural Resources
Ontario

Ministry of Northern Development and Mines

INDEX TO LAND DISPOSITION

PLAN
G-3813

TOWNSHIPS
LASH and AYLSWORTH

M.N.R. ADMINISTRATIVE DISTRICT
FORT FRANCES
MINING DIVISION
KENORA
LAND TITLES/REGISTRY DIVISION
RAINY RIVER

AREAS WITHDRAWN FROM DISPOSITION

MRO - Mining Rights Only
SRO - Surface Rights Only
M+S - Mining and Surface Rights

AREAS WITHDRAWN FROM DISPOSITION

MRO - Mining Rights Only
SRO - Surface Rights Only
M+S - Mining and Surface Rights

Description	Order No.	Date	Disposition	File
-------------	-----------	------	-------------	------

Description	Order No.	Date	Disposition	File
-------------	-----------	------	-------------	------

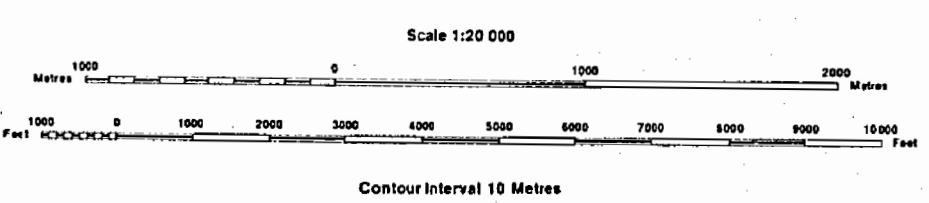

Map base a 1d land disposition drafting by Surveys and Mapping Branch, Ministry of Natural Resources.

The disposition of land, location of lot fabric and parcel boundaries on this index was compiled for administrative purposes only.