

AREA OF

MARTEL LAKE

DISTRICT OF
KENORA
PATRICIA PORTION

PATRICIA
MINING DIVISION

SCALE: 1-INCH = 40 CHAINS

LEGEND

PATENTED LAND	⊙ or ⊗
PATENTED FOR SURFACE RIGHTS ONLY	⊙ or ⊗
LEASES	⊙
LICENSE OF OCCUPATION	L.O.
CROWN LAND SALE	C.S.
LOCATED LAND	Loc.
CANCELLED	C.
MINING RIGHTS ONLY	M.R.O.
SURFACE RIGHTS ONLY	S.R.O.
HIGHWAY & ROUTE No.	17
ROADS	—
TRAILS	—
RAILWAYS	—
POWER LINES	—
MARSH OR MUSKEG	—
MINES	✕

*used only with summer resort locations or when space is limited

NOTES

400' Surface Rights Reservation Around the Shores of All Lakes and Rivers

Boundary of L.O. 14842 not yet defined by survey. All claims apparently oversteaking this L.O. are "subject to the definition of Exploratory Licence boundary", and the mining recorder will issue an order allowing posts and tags to be moved after the boundary has been defined by an O.L.S.

AREA - M. 3253

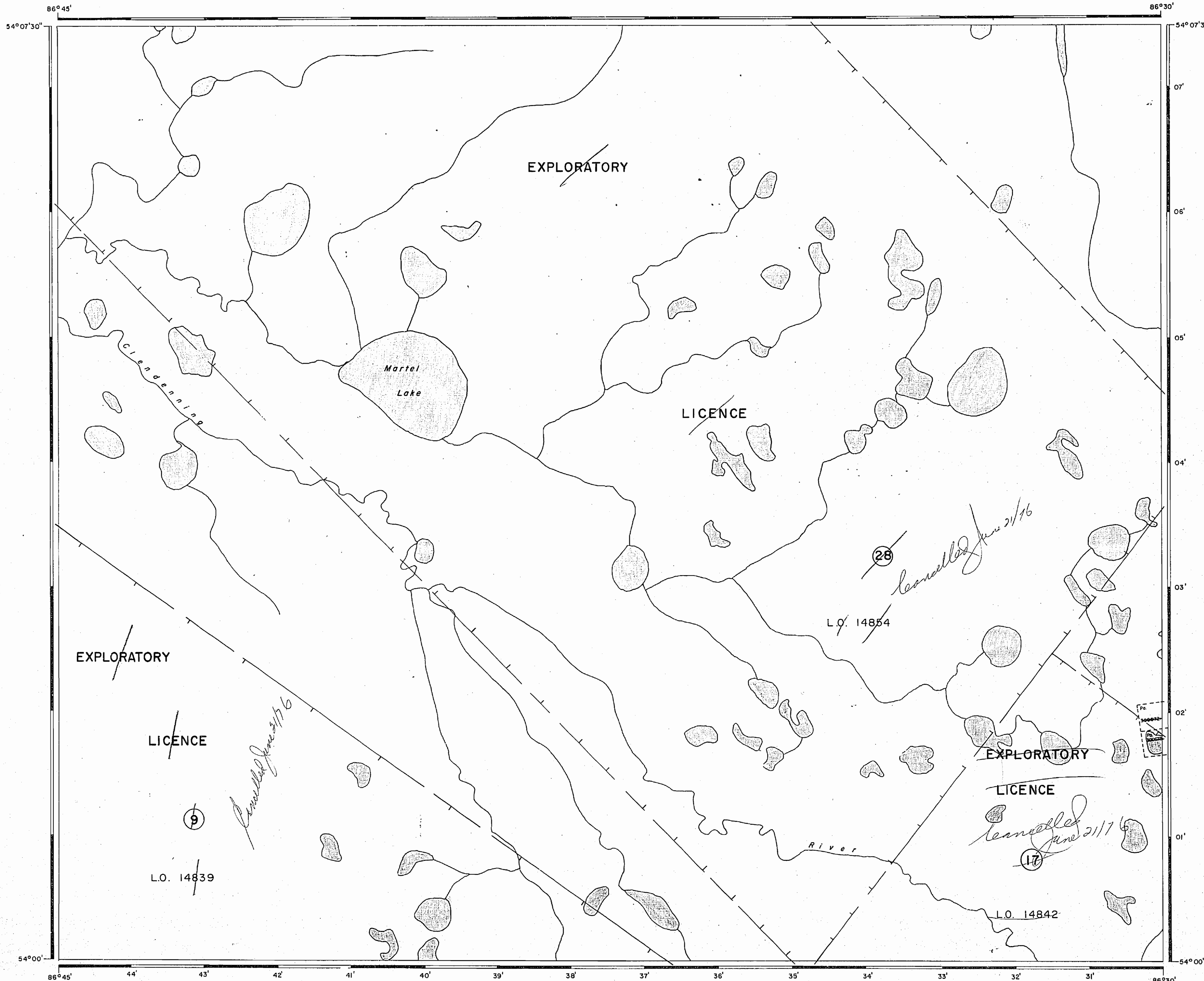

NATIONAL TOPOGRAPHIC SERIES 43L2

PLAN NO. **M. 3255**

ONTARIO *G/15/16*
DEPARTMENT OF MINES
AND NORTHERN AFFAIRS

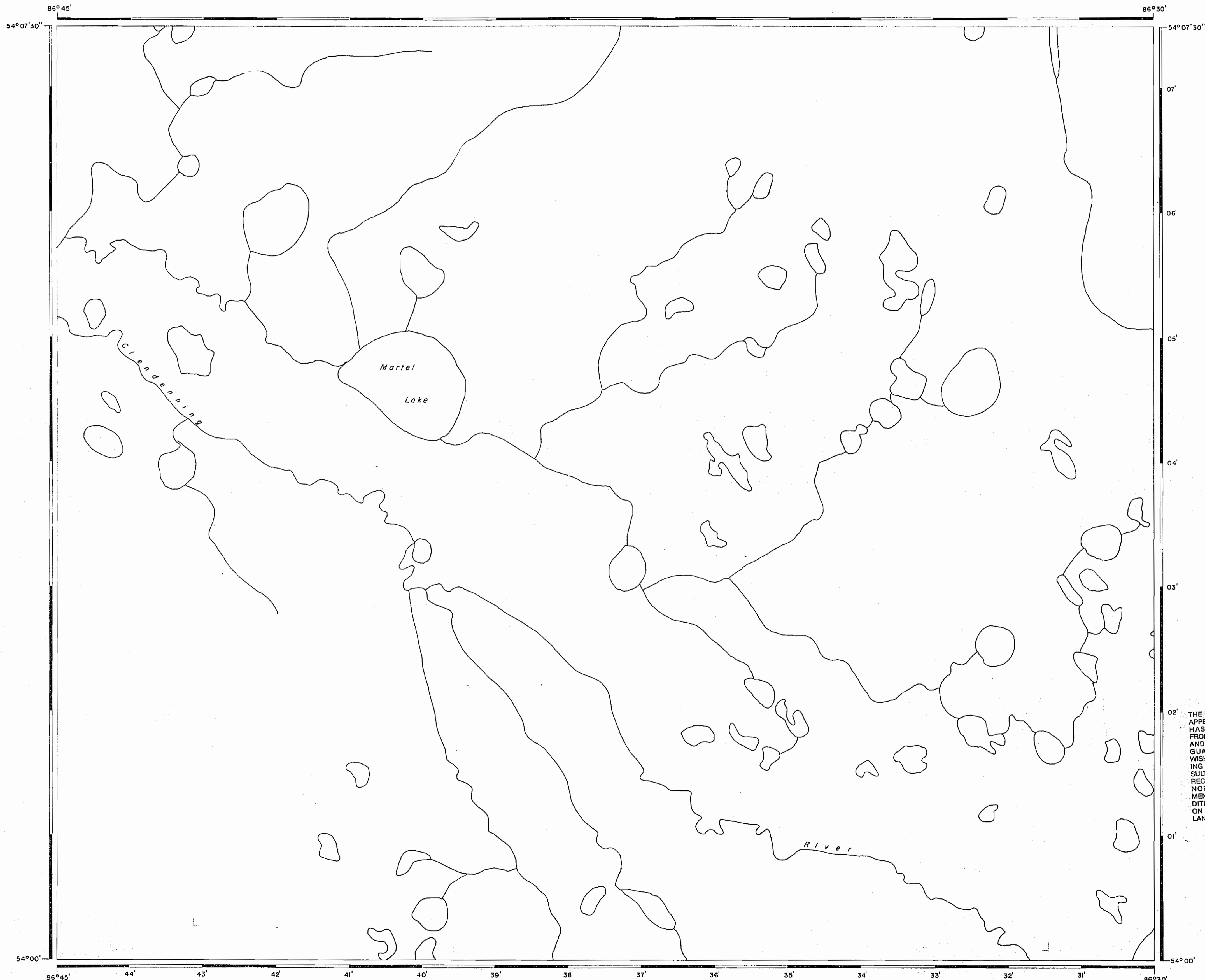

CANTIN LAKE - G-1453

THE INFORMATION THAT APPEARS ON THIS MAP HAS BEEN COMPILED FROM VARIOUS SOURCES, AND ACCURACY IS NOT GUARANTEED. THOSE WISHING TO STAKE MINING CLAIMS SHOULD CONSULT WITH THE MINING RECORDER, MINISTRY OF NORTHERN DEVELOPMENT AND MINES, FOR ADDITIONAL INFORMATION ON THE STATUS OF THE LANDS SHOWN HEREON.

REFERENCES

AREAS WITHDRAWN FROM DISPOSITION

M.R.O. - MINING RIGHTS ONLY
 S.R.O. - SURFACE RIGHTS ONLY
 M.+ S. - MINING AND SURFACE RIGHTS

Description	Order No.	Date	Disposition	File

LEGEND

HIGHWAY AND ROUTE No.	
OTHER ROADS	
TRAILS	
SURVEYED LINES:	
TOWNSHIPS, BASE LINES, ETC.	
LOTS, MINING CLAIMS, PARCELS, ETC.	
UNSURVEYED LINES:	
LOT LINES	
PARCEL BOUNDARY	
MINING CLAIMS ETC.	
RAILWAY AND RIGHT OF WAY	
UTILITY LINES	
NON-PERENNIAL STREAM	
FLOODING OR FLOODING RIGHTS	
SUBDIVISION OR COMPOSITE PLAN	
RESERVATIONS	
ORIGINAL SHORELINE	
MARSH OR MUSKEG	
MINES	
TRAVERSE MONUMENT	

DISPOSITION OF CROWN LANDS

TYPE OF DOCUMENT	SYMBOL
PATENT, SURFACE & MINING RIGHTS	
" SURFACE RIGHTS ONLY	
" MINING RIGHTS ONLY	
LEASE, SURFACE & MINING RIGHTS	
" SURFACE RIGHTS ONLY	
" MINING RIGHTS ONLY	
LICENCE OF OCCUPATION	
ORDER-IN-COUNCIL	
RESERVATION	
CANCELLED	
SAND & GRAVEL	

NOTE: MINING RIGHTS IN PARCELS PATENTED PRIOR TO MAY 6, 1913, VESTED IN ORIGINAL PATENTEE BY THE PUBLIC LANDS ACT, R.S.O. 1970, CHAP. 380, SEC. 63, SUBSEC. 1.

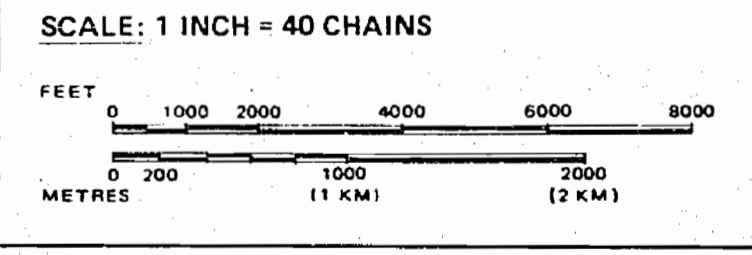

AREA

MARTEL LAKE

M.N.R. ADMINISTRATIVE DISTRICT
MOOSONEE

MINING DIVISION
PORCUPINE

LAND TITLES / REGISTRY DIVISION
KENORA

PATRICIA PORTION

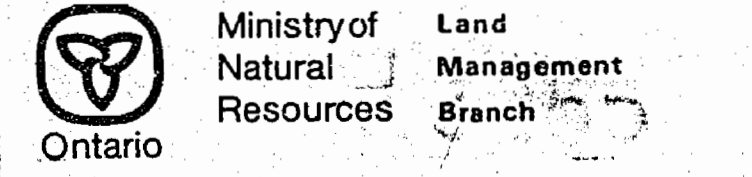

Date JANUARY, 1983 Number **G-1516**