

Unsurveyed Lands (Lower Abitibi Lake M-399)

THE TOWNSHIP OF
OF

MILLIGAN

DISTRICT OF
COCHRANE

LARDER LAKE
MINING DIVISION

SCALE: 1-INCH=40 CHAINS

LEGEND

- | | |
|-----------------------|---------------|
| PATENTED LAND | (P) |
| CROWN LAND SALE | (S) or (C.S.) |
| LEASES | (L) |
| LOCATED LAND | Loc. |
| LICENSE OF OCCUPATION | L.O. |
| MINING RIGHTS ONLY | M.R.O. |
| SURFACE RIGHTS ONLY | S.R.O. |
| ROADS | (—) |
| IMPROVED ROADS | (=) |
| KING'S HIGHWAYS | (=) |
| RAILWAYS | (=) |
| POWER LINES | (=) |
| MARSH OR MUSKEG | (*) |
| MINES | (X) |

NOTES

400' Surface rights reservation around all lakes and rivers.

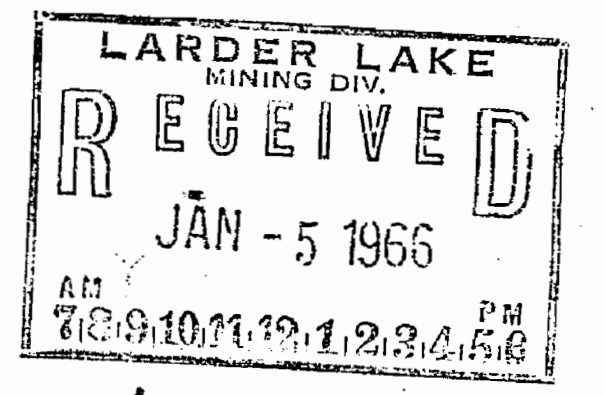

PLAN NO.- M-375 # d

DEPARTMENT OF MINES
— ONTARIO —

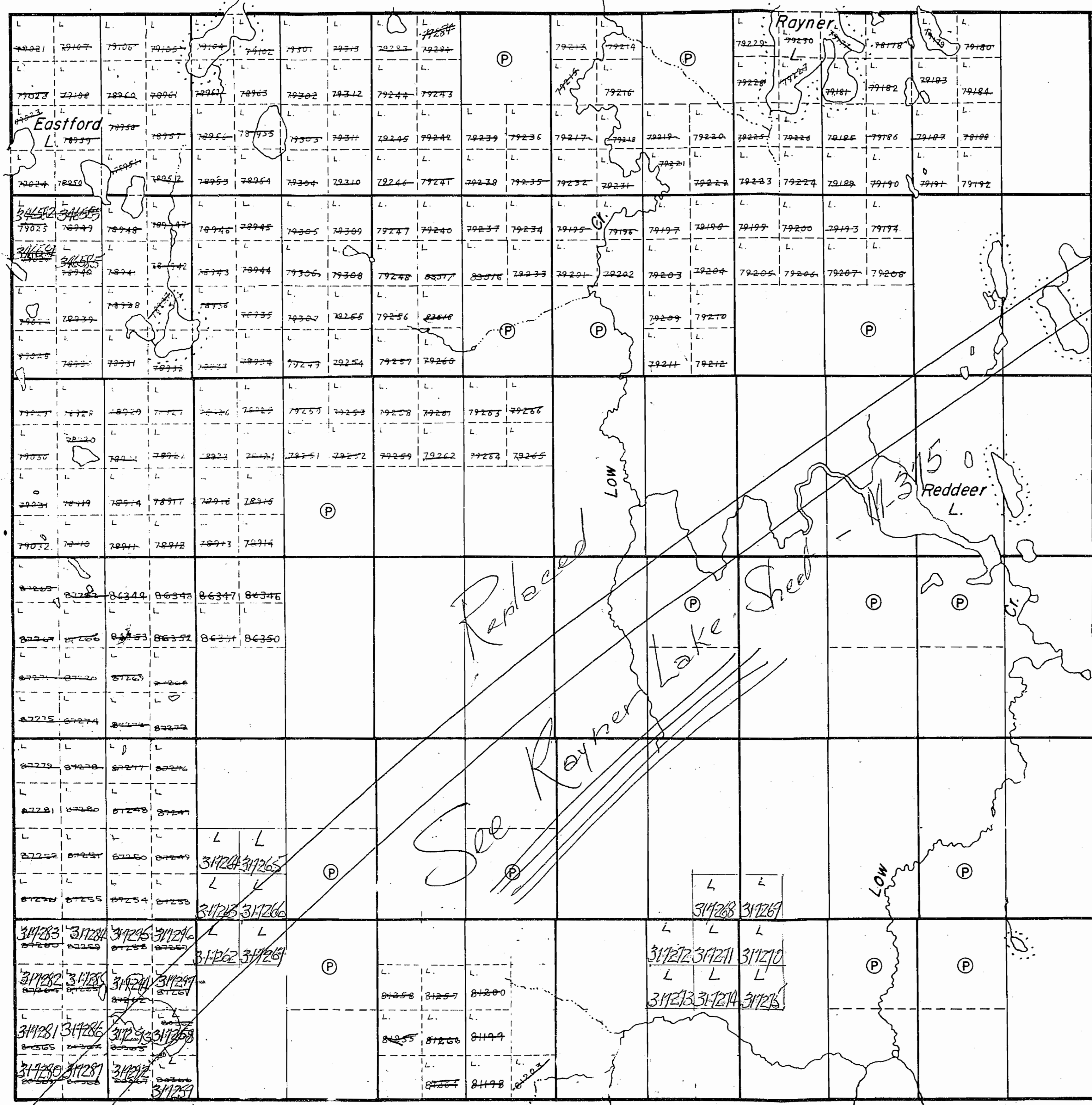

VI

V

IV

III

II

I

Indian Reserve

Warden Twp.

McCool Twp.

12 11 10 9 8 7 6 5 4 3 2 1

Unsurveyed Lands

Warden Twp.

12	11	10	9	8	7	6	5	4	3	2	1
19021 19022 19023 19024 19025 19026 19027 19028 19029 19030 19031 19032	19033 19034 19035 19036 19037 19038 19039 19040 19041 19042 19043 19044	19045 19046 19047 19048 19049 19050 19051 19052 19053 19054 19055 19056	19057 19058 19059 19060 19061 19062 19063 19064 19065 19066 19067 19068	19069 19070 19071 19072 19073 19074 19075 19076 19077 19078 19079 19080	19081 19082 19083 19084 19085 19086 19087 19088 19089 19090 19091 19092	19093 19094 19095 19096 19097 19098 19099 19100 19101 19102 19103 19104 19105	19106 19107 19108 19109 19110 19111 19112 19113 19114 19115 19116 19117	19118 19119 19120 19121 19122 19123 19124 19125 19126 19127 19128 19129	19130 19131 19132 19133 19134 19135 19136 19137 19138 19139 19140 19141	19142 19143 19144 19145 19146 19147 19148 19149 19150 19151 19152	19153 19154 19155 19156 19157 19158 19159 19160 19161 19162 19163

Replaced

VI

V

IV

III

II

I

Indian Reserve

THE TOWNSHIP OF

MILLIGAN

DISTRICT OF COCHRANE

LARDER LAKE MINING DIVISION

SCALE: 1-INCH=40 CHAINS

LEGEND

- PATENTED LAND (P)
- CROWN LAND SALE (S or C.S)
- LEASES (L)
- LOCATED LAND (Loc.)
- LICENSE OF OCCUPATION (L.O.)
- MINING RIGHTS ONLY (M.R.O.)
- SURFACE RIGHTS ONLY (S.R.O.)
- ROADS
- IMPROVED ROADS
- KING'S HIGHWAYS
- RAILWAYS
- POWER LINES
- MARSH OR MUSKEG
- MINES

NOTES

400' Reserve to Dept. of Lands & Forests Shown Thus: [Symbol]

MINING RECORDER RECEIVED
MAY 10 1957
SWASTIKA - ONT.

PLAN NO.- M-375

DEPARTMENT OF MINES - ONTARIO -

McCool Twp.

375

MILLIGAN TOWNSHIP

LARDER LAKE MINING DIVISION
DISTRICT OF COCHRANE

SCALE 40 CHAINS TO 1 INCH

M-375

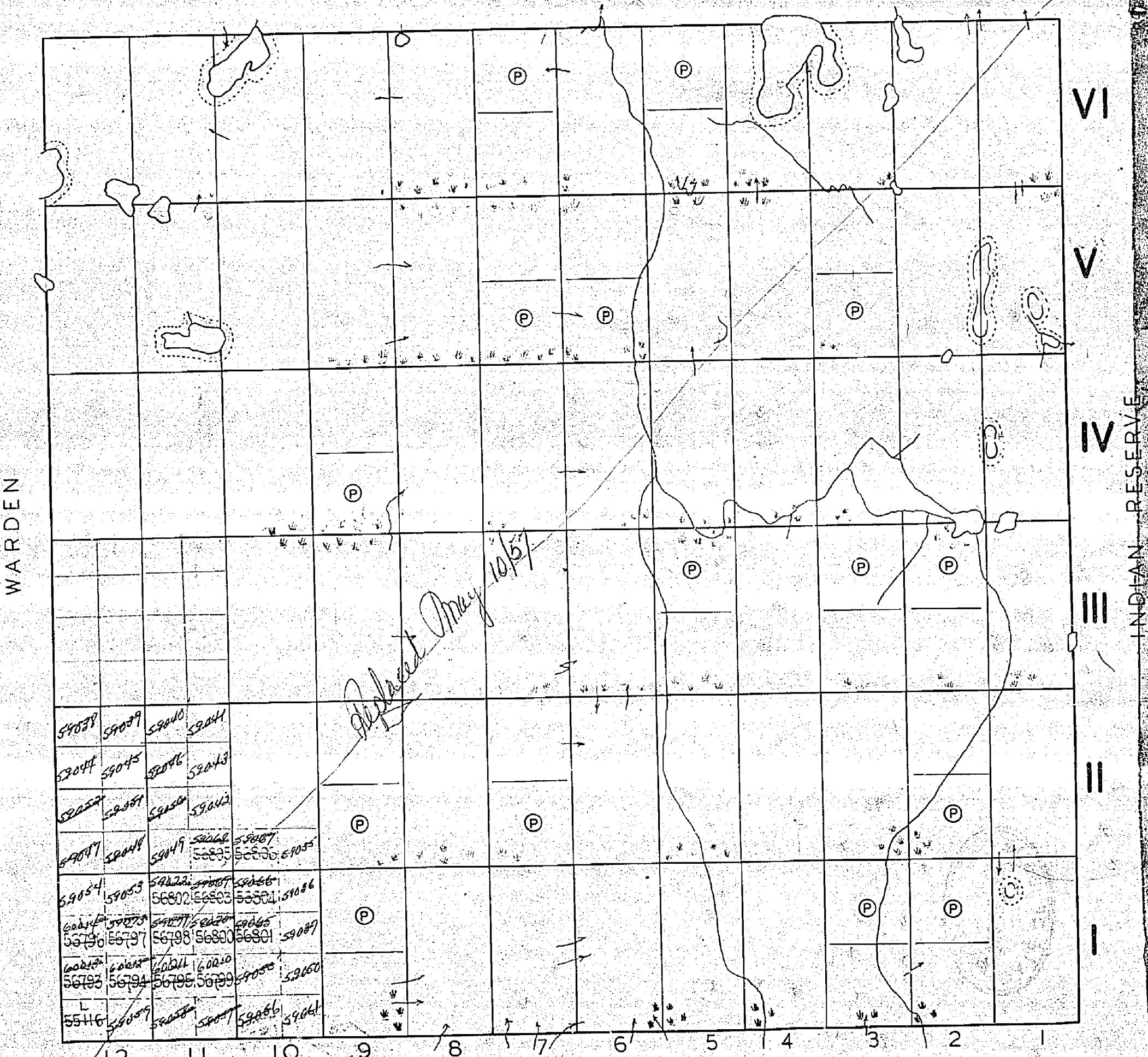

LEGEND

PATENTED LANDS (P)

CROWN LAND SALES (S)

SWAMPS (swamp symbol)

McCOOL

Note. 200' on surface round certain lakes reserved for Dept. of Lands & Forests shown coloured yellow hereon.