

AREA OF

MISAMIKWASH LAKE

DISTRICT OF
KENORA
PATRICIA PORTION

PATRICIA
MINING DIVISION

SCALE: 1-INCH = 40 CHAINS

LEGEND

PATENTED LAND	Ⓟ
CROWN LAND SALE	C.S.
LEASES	Ⓢ
LOCATED LAND	Loc.
LICENSE OF OCCUPATION	L.O.
MINING RIGHTS ONLY	M.R.O.
SURFACE RIGHTS ONLY	S.R.O.
ROADS	—
IMPROVED ROADS	—
KING'S HIGHWAYS	—
RAILWAYS	—
POWER LINES	—
MARSH OR MUSKEG	—
MINES	⚡
CANCELLED	C.

NOTES

400' Reserve around all Lakes & Rivers
to Dept. of Lands & Forests.

NOT TO BE USED FOR SURVEY PURPOSES

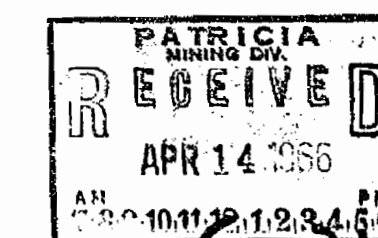

PLAN NO. **M.2749**

DEPARTMENT OF MINES

— ONTARIO —

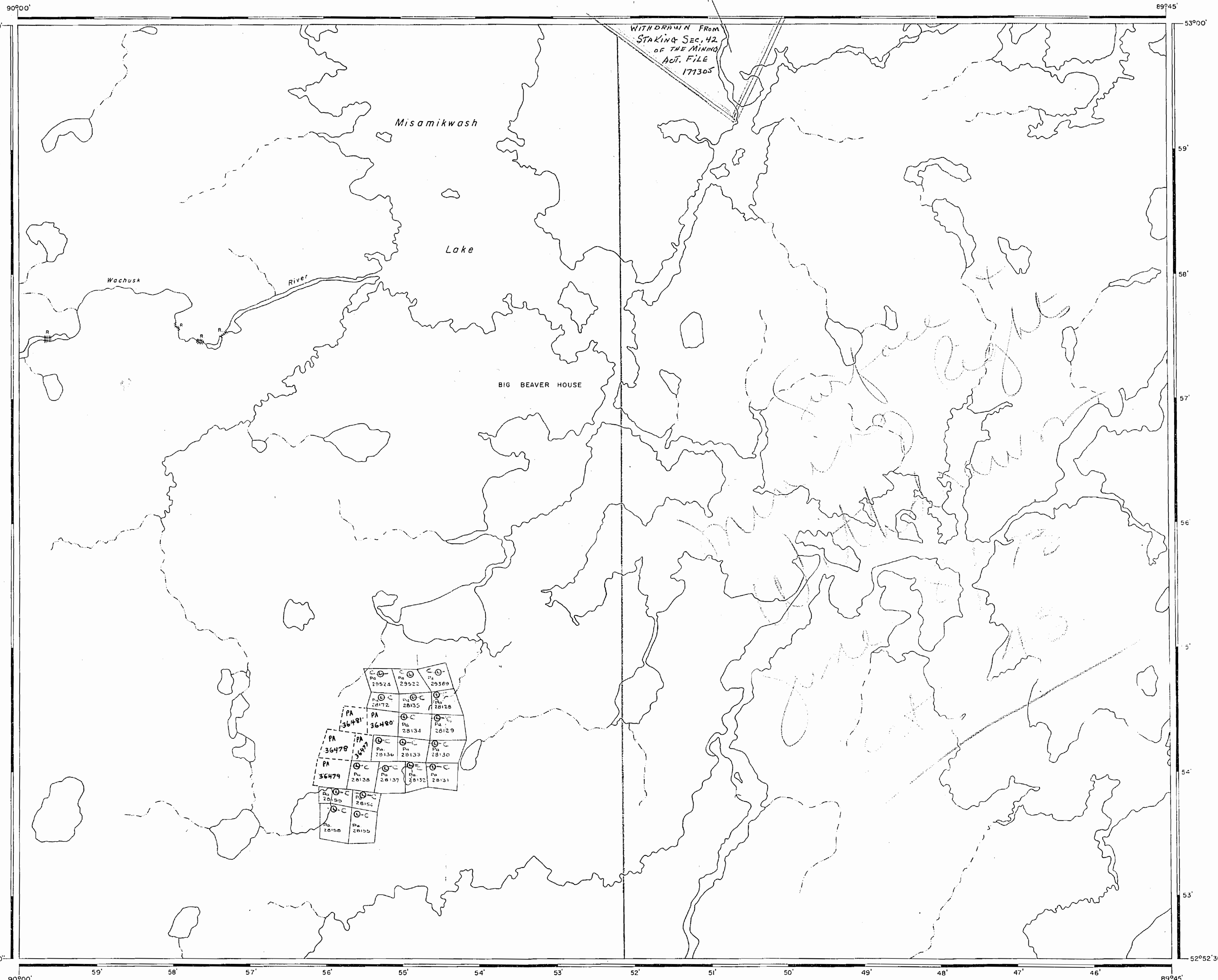

Asinne Lake Area - M.2750

AREA OF

MISAMIKWASH LAKE

DISTRICT OF
KENORA
PATRICIA PORTION

PATRICIA
MINING DIVISION

SCALE: 1-INCH = 40 CHAINS

LEGEND

PATENTED LAND	Ⓟ
CROWN LAND SALE	C.S.
LEASES	Ⓛ
LOCATED LAND	Loc.
LICENSE OF OCCUPATION	L.O.
MINING RIGHTS ONLY	M.R.O.
SURFACE RIGHTS ONLY	S.R.O.
ROADS	—
IMPROVED ROADS	—
KING'S HIGHWAYS	—
RAILWAYS	—
POWER LINES	—
MARSH OR MUSKEG	—
MINES	Ⓧ
CANCELLED	C.

NOTES

400' Reserve around all Lakes & Rivers
to Dept. of Lands & Forests.

NOT TO BE USED FOR SURVEY PURPOSES



#3

6-2128

NATIONAL TOPOGRAPHIC SERIES 53A

PLAN NO. M.2749

ON PARO

MINISTRY OF NATURAL RESOURCES

SURVEYS AND MAPPING BRANCH

Surface and Mining Rights in this portion withdrawn
from staking under Section 43 of the Mining Act.
Order No W26/73
Date: June 8, 1973
File: 187662

WITHDRAWN FROM
STAKING SEC. 42
OF THE MINING
ACT FILE-
177305

Misamikwash

Lake

Wachusk River

BIG BEAVER HOUSE

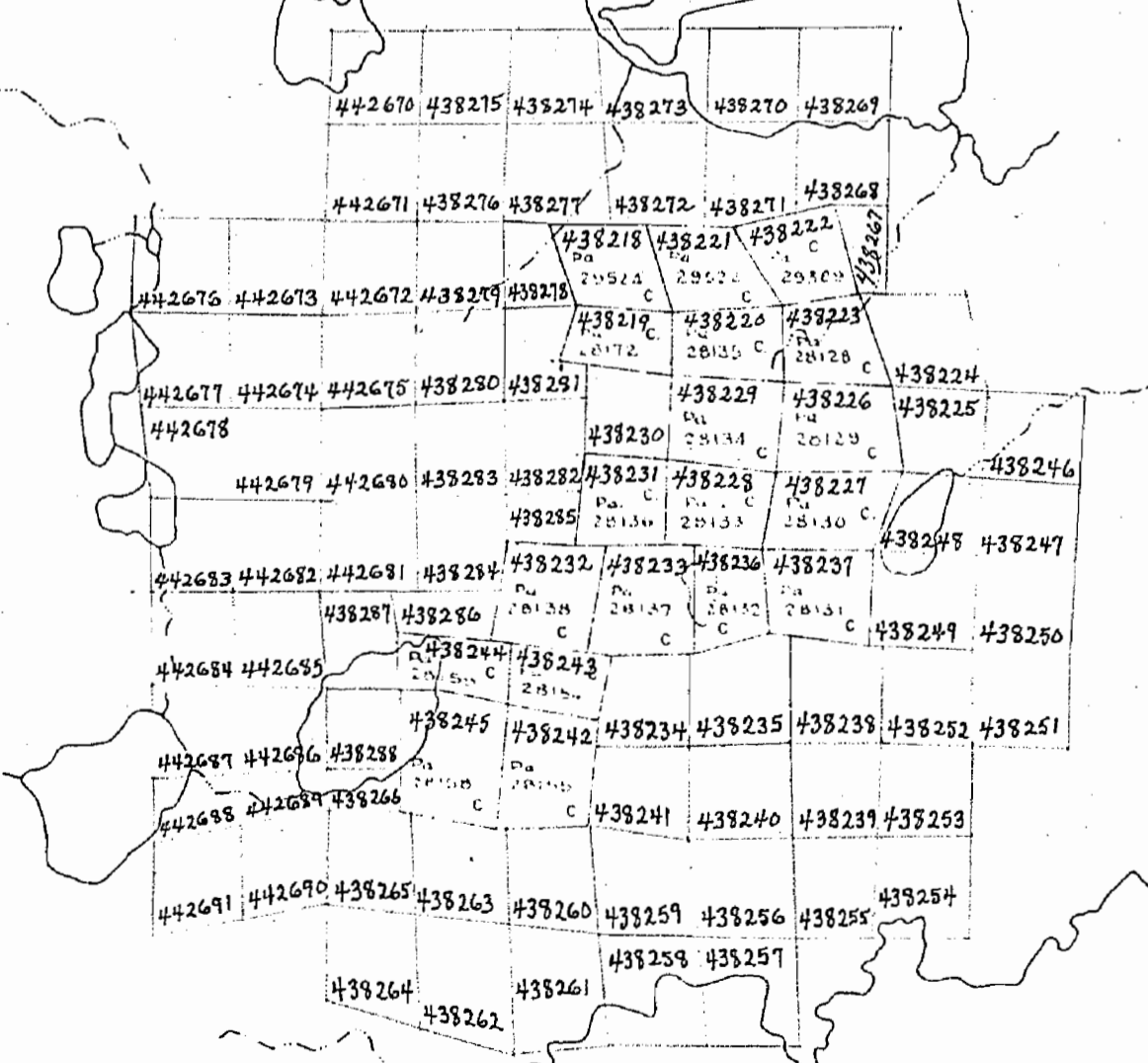

Asinne Lake Area - M.2750

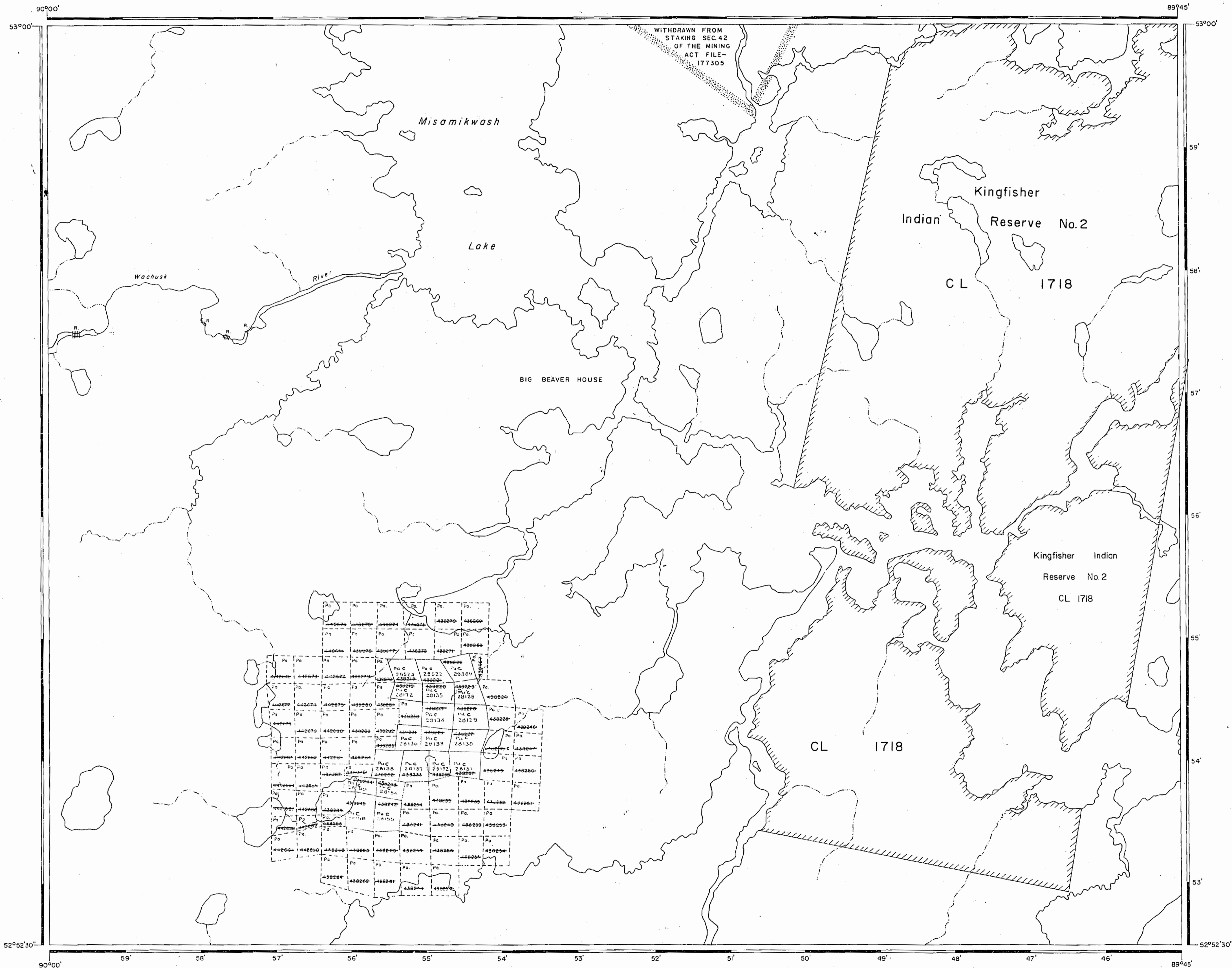

AREA OF
MISAMIKWASH LAKE

DISTRICT OF
KENORA
PATRICIA PORTION

PATRICIA
MINING DIVISION

SCALE: 1-INCH = 40 CHAINS

LEGEND

PATENTED LAND	Ⓢ
CROWN LAND SALE	C.S.
LEASES	Ⓛ
LOCATED LAND	Loc.
LICENSE OF OCCUPATION	L.O.
MINING RIGHTS ONLY	M.R.O.
SURFACE RIGHTS ONLY	S.R.O.
ROADS	—
IMPROVED ROADS	—
KING'S HIGHWAYS	—
RAILWAYS	—
POWER LINES	—
MARSH OR MUSKEG	—
MINES	Ⓜ
CANCELLED	C.

NOTES

400' Reserve around all Lakes & Rivers
to Dept. of Lands & Forests.

NOT TO BE USED FOR SURVEY PURPOSES

November 23, 1977

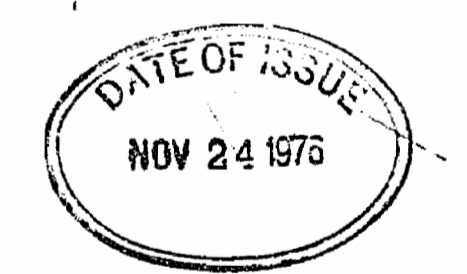



G-2128

NATIONAL TOPOGRAPHIC SERIES 53 A

PLAN NO. **M.2749**

ONTARIO
MINISTRY OF NATURAL RESOURCES
SURVEYS AND MAPPING BRANCH

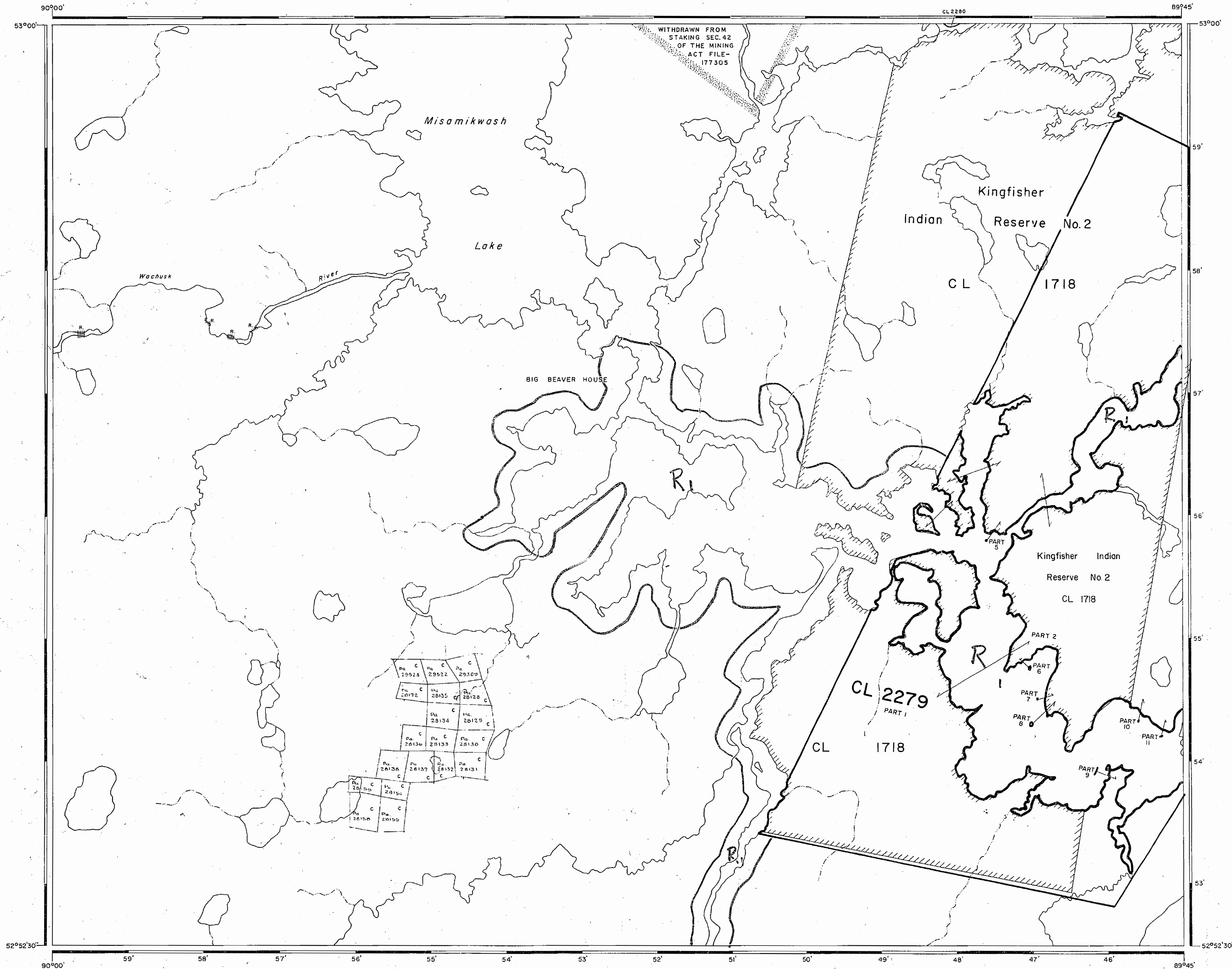
Asinne Lake Area - M.2750



AREA OF
MISAMIKWASH LAKE
 DISTRICT OF
 KENORA
 PATRICIA PORTION
 PATRICIA
 MINING DIVISION
 SCALE: 1-INCH = 40 CHAINS

LEGEND

PATENTED LAND	⊕
CROWN LAND SALE	C.S.
LEASES	⊙
LOCATED LAND	Loc.
LICENSE OF OCCUPATION	L.O.
MINING RIGHTS ONLY	M.R.O.
SURFACE RIGHTS ONLY	S.R.O.
ROADS	—
IMPROVED ROADS	—
KING'S HIGHWAYS	—
RAILWAYS	—
POWER LINES	—
MARSH OR MUSKEG	—
MINES	⋈
CANCELLED	C.

NOTES
 400' Reserve around all Lakes & Rivers
 to Dept. of Lands & Forests.
 NOT TO BE USED FOR SURVEY PURPOSES

R₁
 W42/83, Aug 23/83 withdraws
 surface & mining rights
 F.L. 7598 V. 17.
 * Mineral Exploration allowed under
 Exploratory License of Occupation

DATE OF ISSUE
 SEP 28 1982
 Ministry of Natural Resources
 TORONTO

#5

6-2128
 NATIONAL TOPOGRAPHIC SERIES 53 A
 PLAN NO. **M.2749**
 ONTARIO
 MINISTRY OF NATURAL RESOURCES
 SURVEY AND MAPPING BRANCH

Asinne Lake Area - M.2750

AREA OF

MISAMIKWASH LAKE

DISTRICT OF
KENORA
PATRICIA PORTION

PATRICIA
MINING DIVISION

SCALE: 1-INCH = 40 CHAINS

LEGEND

PATENTED LAND	Ⓢ
CROWN LAND SALE	C.S.
LEASES	Ⓛ
LOCATED LAND	Loc.
LICENSE OF OCCUPATION	L.O.
MINING RIGHTS ONLY	M.R.O.
SURFACE RIGHTS ONLY	S.R.O.
ROADS	— — — — —
IMPROVED ROADS	— — — — —
KING'S HIGHWAYS	— — — — —
RAILWAYS	— — — — —
POWER LINES	— — — — —
MARSH OR MUSKEG	— — — — —
MINES	⚡
CANCELLED	C.

NOTES

400' Reserve around all Lakes & Rivers
to Dept. of Lands & Forests.

NOT TO BE USED FOR SURVEY PURPOSES

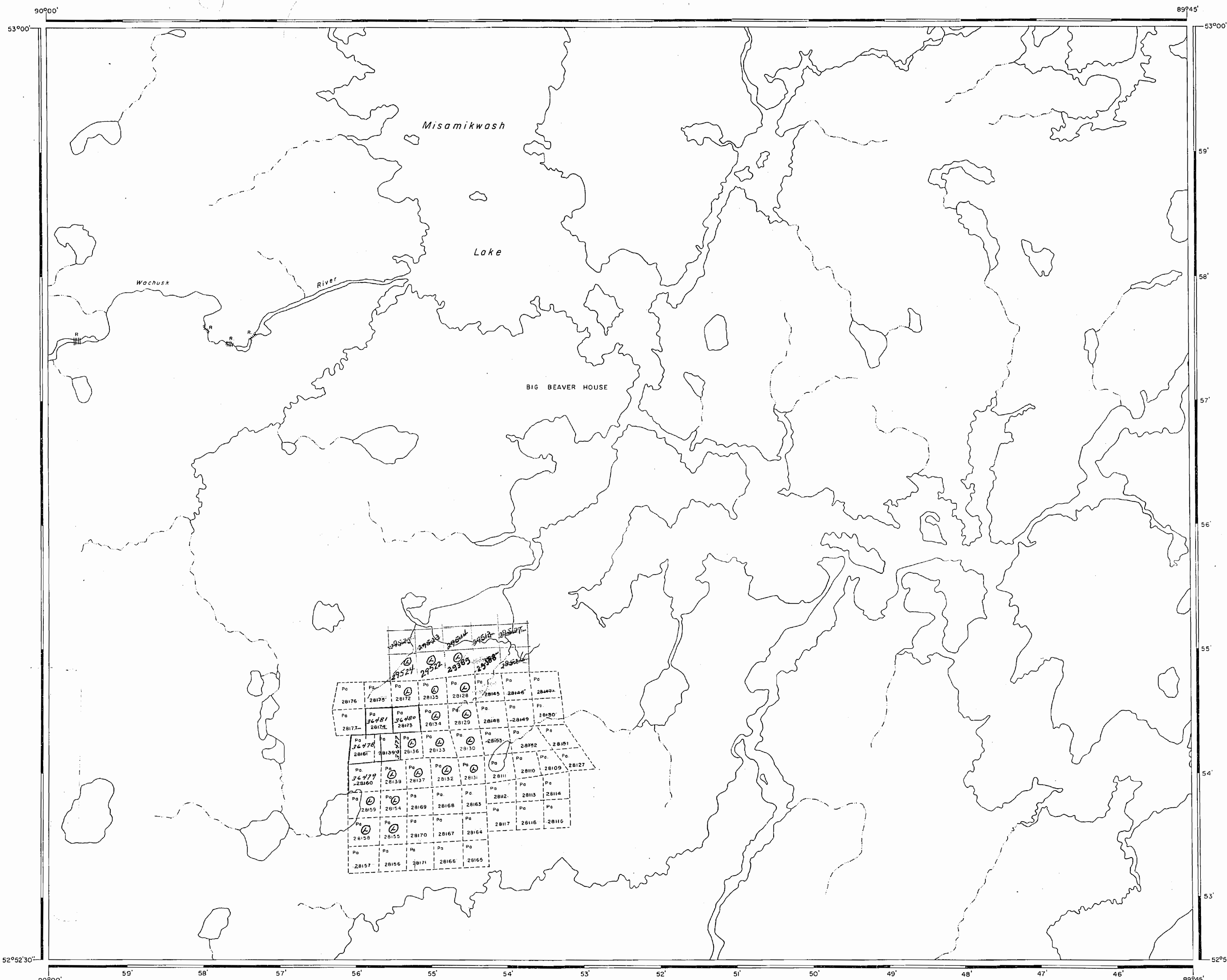

Asinne Lake Area - M.2750

6-2128

PLAN NO. M.2749

DEPARTMENT OF MINES
— ONTARIO —

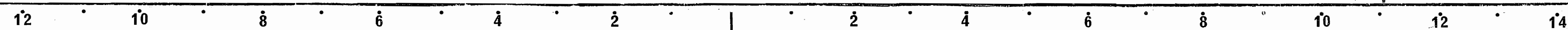

KINGFISHER LAKE AREA G-2505

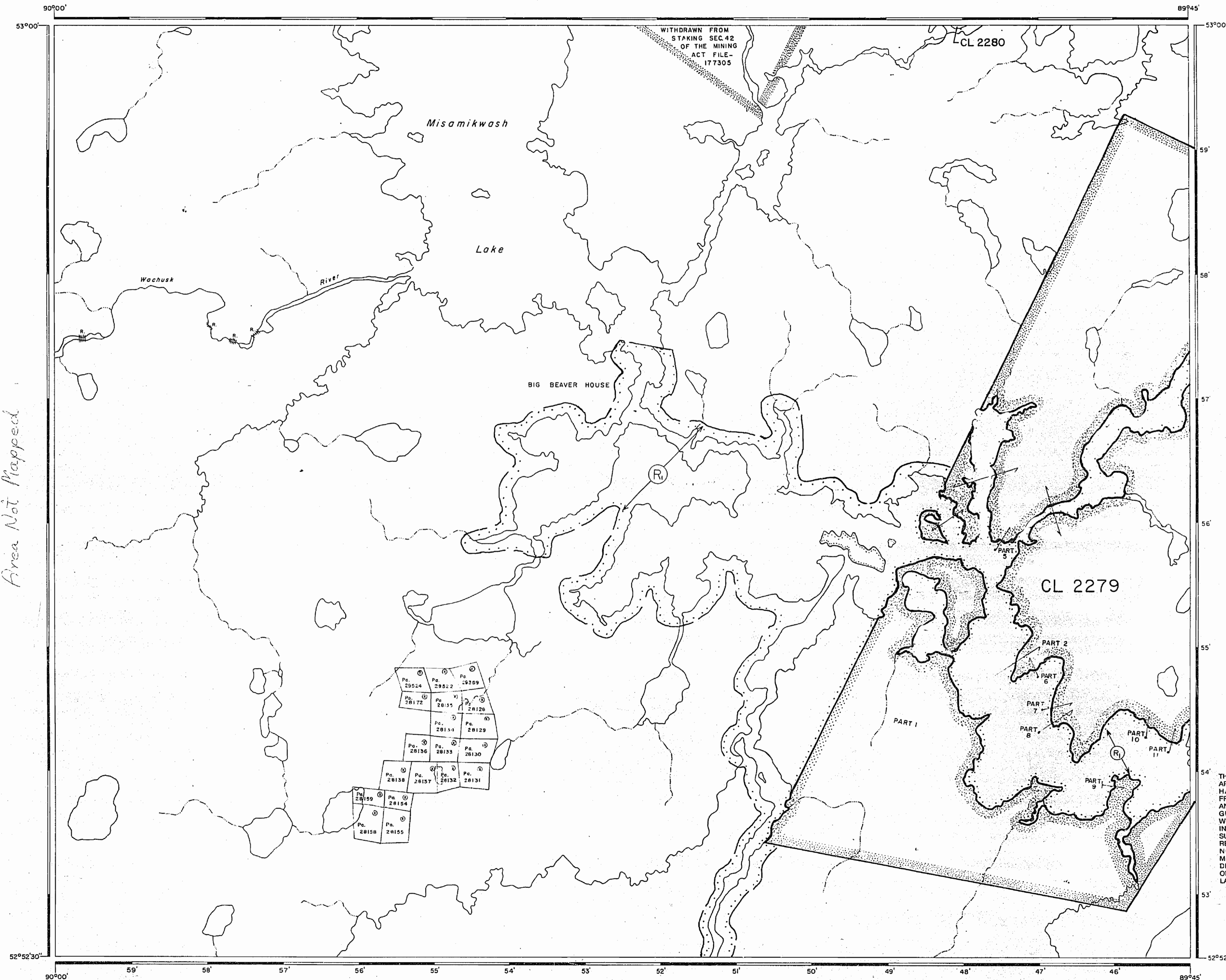

Area Not Mapped

Area Not Mapped

LEGEND

HIGHWAY AND ROUTE No	
OTHER ROADS	
TRAILS	
SURVEYED LINES:	
TOWNSHIPS, BASE LINES, ETC	
LOTS, MINING CLAIMS, PARCELS, ETC	
UNSURVEYED LINES	
LOT LINES	
PARCEL BOUNDARY	
MINING CLAIMS ETC	
RAILWAY AND RIGHT OF WAY	
UTILITY LINES	
NON-PERENNIAL STREAM	
FLOODING OR FLOODING RIGHTS	
SUBDIVISION OR COMPOSITE PLAN	
RESERVATIONS	
ORIGINAL SHORELINE	
MARSH OR MUSKEG	
MINES	
TRAVERSE MONUMENT	

DISPOSITION OF CROWN LANDS

TYPE OF DOCUMENT	SYMBOL
PATENT, SURFACE & MINING RIGHTS	
" SURFACE RIGHTS ONLY	
" MINING RIGHTS ONLY	
LEASE, SURFACE & MINING RIGHTS	
" SURFACE RIGHTS ONLY	
" MINING RIGHTS ONLY	
LICENCE OF OCCUPATION	
ORDER-IN-COUNCIL	
RESERVATION	
CANCELLED	
SAND & GRAVEL	

NOTE: MINING RIGHTS IN PARCELS PATENTED PRIOR TO MAY 6, 1913, VESTED IN ORIGINAL PATENTEE BY THE PUBLIC LANDS ACT, R.S.O. 1970, CHAP. 380, SEC. 63, SUBSEC. 1.

REFERENCES

AREAS WITHDRAWN FROM DISPOSITION

M.R.O. - MINING RIGHTS ONLY
 S.R.O. - SURFACE RIGHTS ONLY
 M + S. - MINING AND SURFACE RIGHTS

Description	Order No.	Date	Disposition	File
PARK RESERVE	12/2/71	27.04.77	M & S	188516

AREA IN SHIBOGAMA INTERIM PLANNING BOARD CALL FOR DETAILS 737-2662

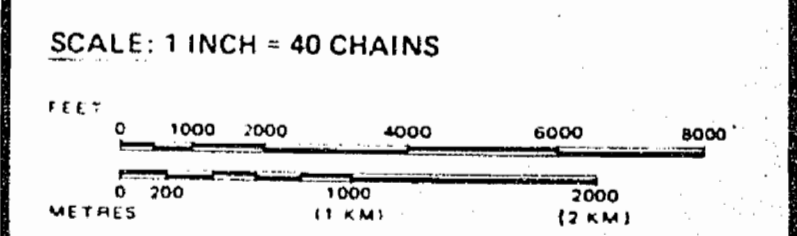

THE INFORMATION THAT APPEARS ON THIS MAP HAS BEEN COMPILED FROM VARIOUS SOURCES, AND ACCURACY IS NOT GUARANTEED. THOSE WISHING TO STAKE MINING CLAIMS SHOULD CONSULT WITH THE MINING RECORDER, MINISTRY OF NORTHERN DEVELOPMENT AND MINES, FOR ADDITIONAL INFORMATION ON THE STATUS OF THE LANDS SHOWN HEREON.

AREA MISAMIKWASH LAKE

M.N.R. ADMINISTRATIVE DISTRICT
STIUX LOOKOUT
 MINING DIVISION
PATRICIA
 LAND TITLES / REGISTRY DIVISION
KENORA (PATRICIA PORTION)

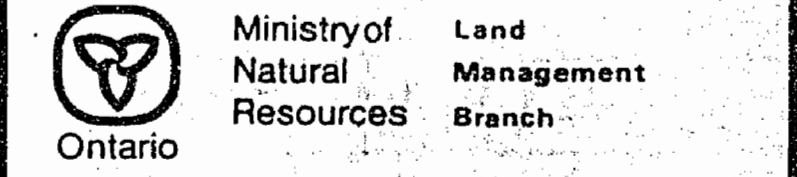

DATE: FEBRUARY, 1984. Number: **G-2128**

Asinne Lake Area G-1935