

PORTAGE LAKE AREA M.1734

NORTH OF SANDYBANK LAKE AREA M.2206

PATRICIA
MINING DIV.
RECEIVED
MAY 14 1973
AM 7:09:04 12:12:34 PM

LEGEND

HIGHWAY AND ROUTE No.	
OTHER ROADS	
TRAILS	
SURVEYED LINES:	
TOWNSHIPS, BASE LINES, ETC.	
LOTS, MINING CLAIMS, PARCELS, ETC.	
UNSURVEYED LINES:	
LOT LINES	
PARCEL BOUNDARY	
MINING CLAIMS ETC.	
RAILWAY AND RIGHT OF WAY	
UTILITY LINES	
NON-PERENNIAL STREAM	
FLOODING OR FLOODING RIGHTS	
SUBDIVISION	
ORIGINAL SHORELINE	
MARSH OR MUSKEG	
MINES	

DISPOSITION OF CROWN LANDS

TYPE OF DOCUMENT	SYMBOL
PATENT, SURFACE & MINING RIGHTS	
" SURFACE RIGHTS ONLY	
" MINING RIGHTS ONLY	
LEASE, SURFACE & MINING RIGHTS	
" SURFACE RIGHTS ONLY	
" MINING RIGHTS ONLY	
LICENCE OF OCCUPATION	
CROWN LAND SALE	CS
ORDER-IN-COUNCIL	OC
RESERVATION	
CANCELLED	
SAND & GRAVEL	

SCALE : 1 INCH = 40 CHAINS
FEET 0 200 400 600 800 1000
METRES 0 200 400 600 800 1000

ACRES	HECTARES
40	16

AREA
NORTH EAST
OF
BIG TROUT LAKE
DISTRICT
KENORA
PATRICIA PORTION
MINING DIVISION
PATRICIA

#2

Ministry of Natural Resources
Ontario Surveys and Mapping Branch
Date April 5, 73.
National Topographical Series
53H13
Plan No. G-2145
M.2240

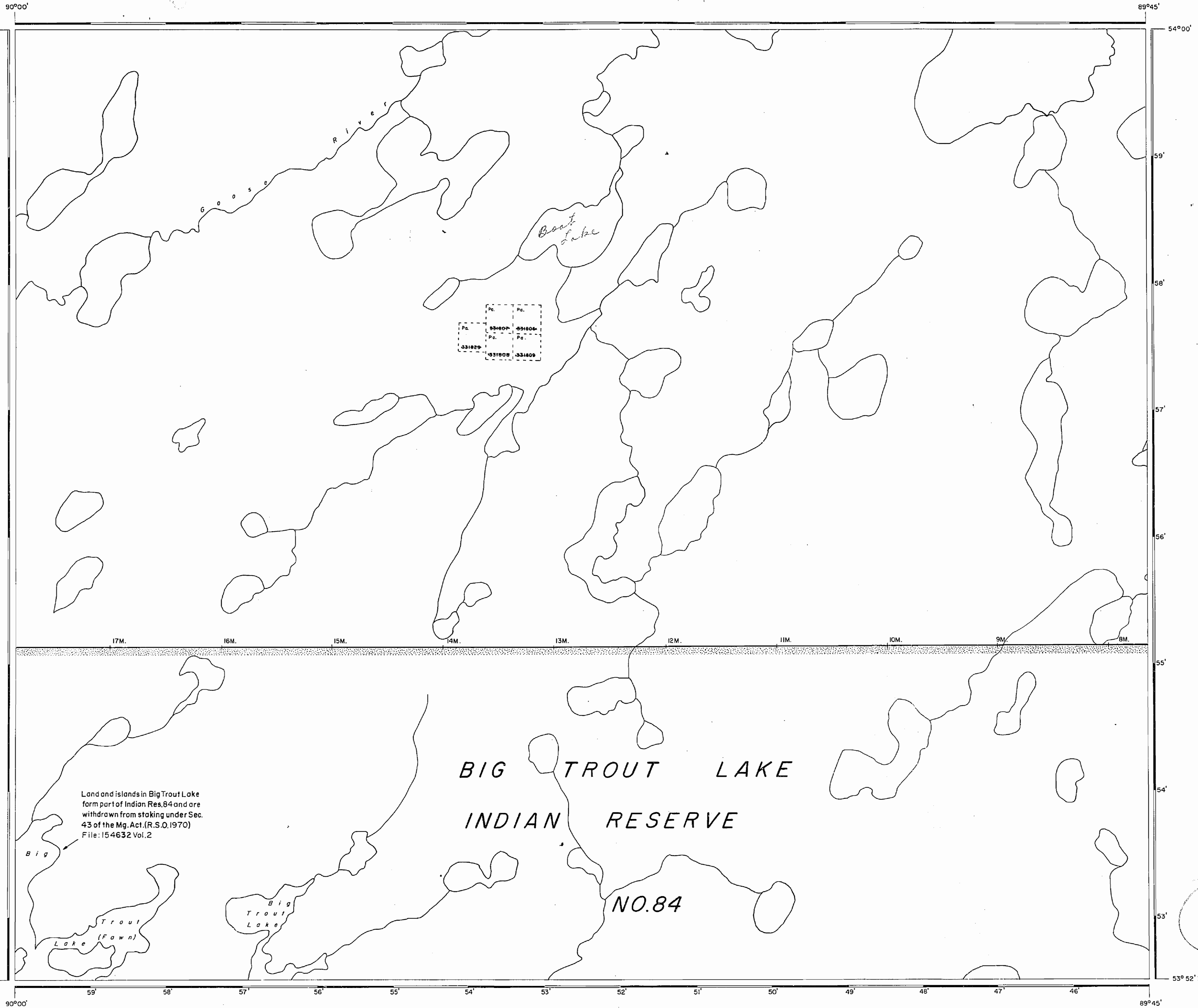

Land and islands in Big Trout Lake form part of Indian Res. 84 and are withdrawn from staking under Sec. 43 of the Mg. Act. (R.S.O. 1970) File: 154632 Vol. 2

BIG TROUT LAKE
INDIAN RESERVE
NO. 84

POST ISLAND of BIG TROUT LAKE AREA M.2215

AREA NOT MAPPED

90°00'

89°45'

54°00'

54°00'

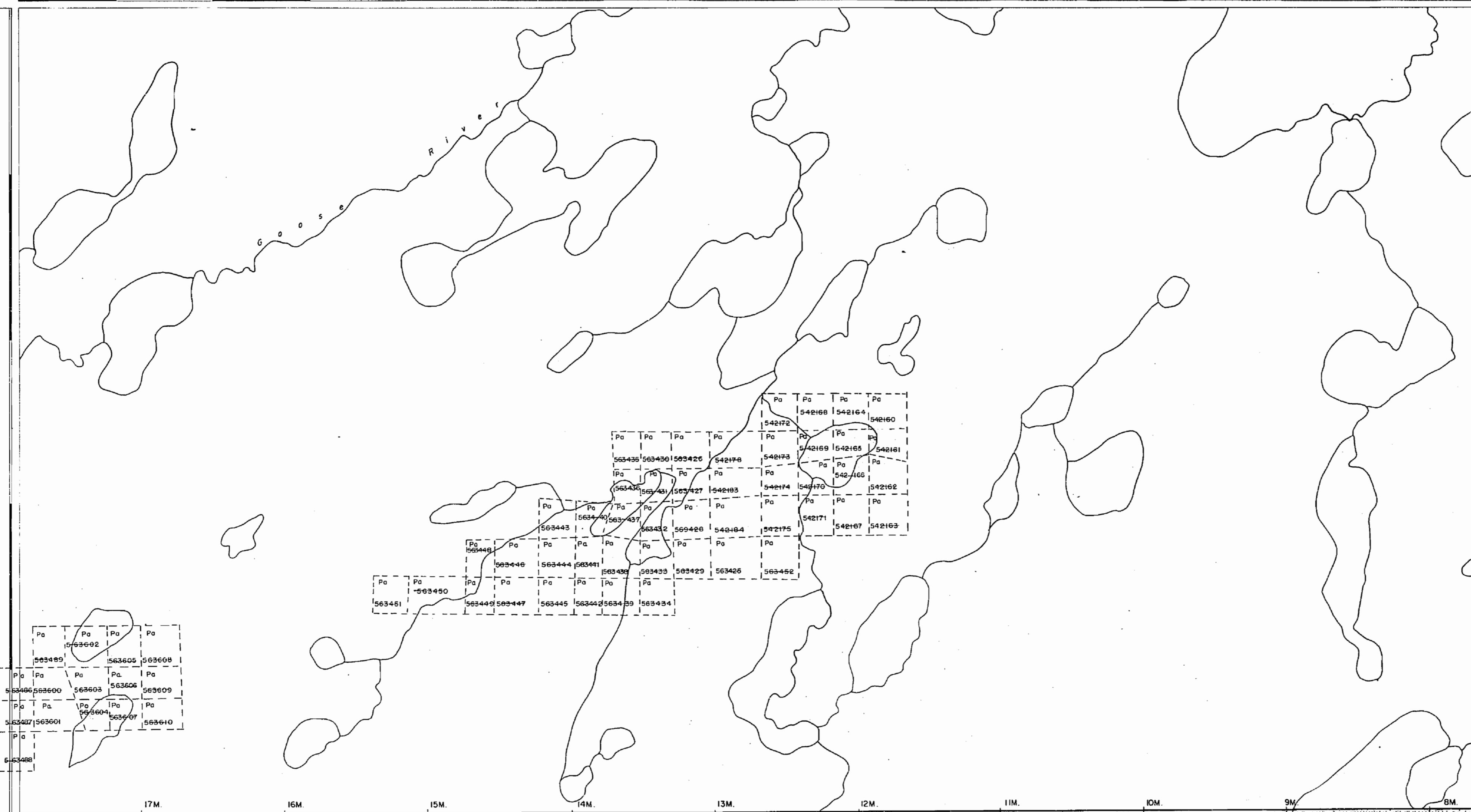

PORTAGE LAKE AREA G-2177

NORTH OF SANDYBANK LAKE AREA G-2151

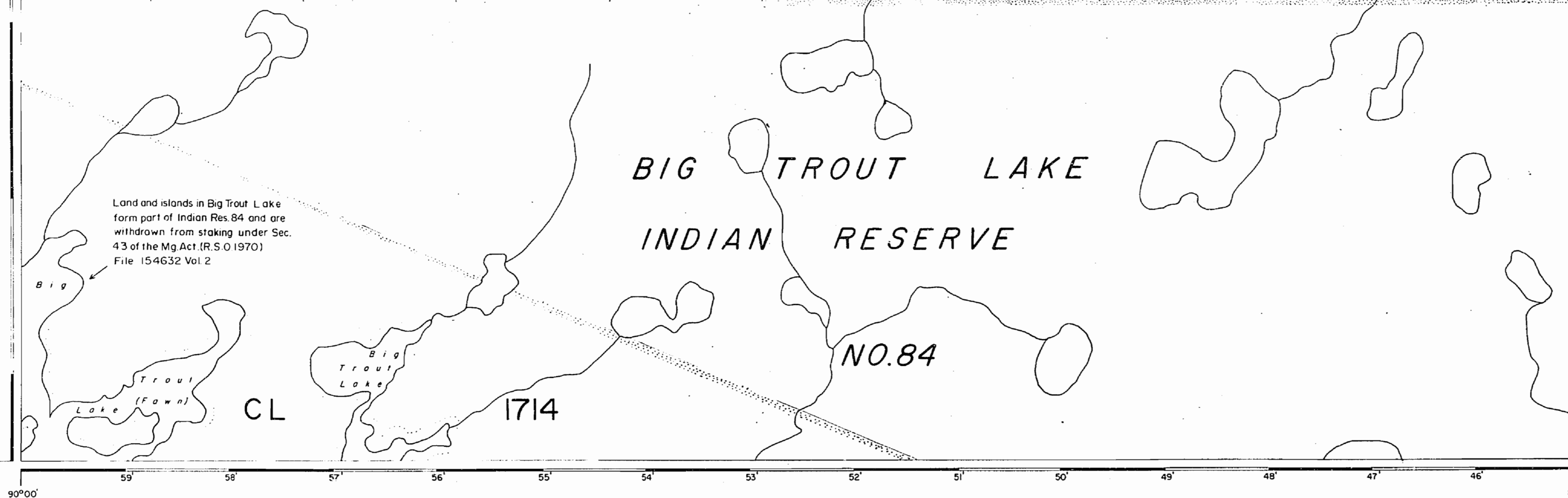

Land and islands in Big Trout Lake form part of Indian Res 84 and are withdrawn from staking under Sec. 43 of the Mg. Act. (R.S.O. 1970) File 154632 Vol 2

POST ISLAND of BIG TROUT LAKE AREA G-2179

LEGEND

- HIGHWAY AND ROUTE No.
- OTHER ROADS
- TRAILS
- SURVEYED LINES:
 - TOWNSHIPS, BASE LINES, ETC.
 - LOTS, MINING CLAIMS, PARCELS, ETC.
- UNSURVEYED LINES:
 - LOT LINES
 - PARCEL BOUNDARY
 - MINING CLAIMS ETC.
- RAILWAY AND RIGHT OF WAY
- UTILITY LINES
- NON-PERENNIAL STREAM
- FLOODING OR FLOODING RIGHTS
- SUBDIVISION OR COMPOSITE PLAN
- RESERVATIONS
- ORIGINAL SHORELINE
- MARSH OR MUSKEG
- MINES
- TRAVERSE MONUMENT

DISPOSITION OF CROWN LANDS

TYPE OF DOCUMENT	SYMBOL
PATENT, SURFACE & MINING RIGHTS	
" SURFACE RIGHTS ONLY	
" MINING RIGHTS ONLY	
LEASE, SURFACE & MINING RIGHTS	
" SURFACE RIGHTS ONLY	
" MINING RIGHTS ONLY	
LICENCE OF OCCUPATION	
ORDER-IN-COUNCIL	
RESERVATION	
CANCELLED	
SAND & GRAVEL	

NOTE: MINING RIGHTS IN PARCELS PATENTED PRIOR TO MAY 6, 1913, VESTED IN ORIGINAL PATENTEE BY THE PUBLIC LANDS ACT, R.S.O. 1970, CHAP. 380, SEC. 63, SUBSEC. 1.

NR 20/84

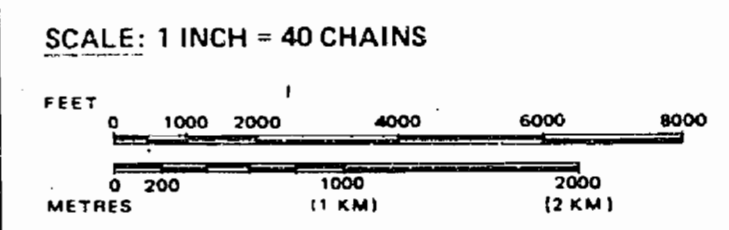
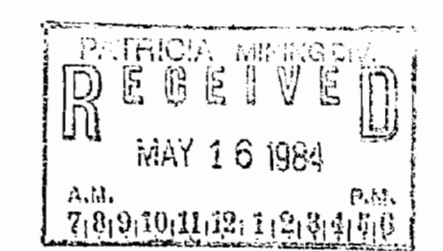

AREA NORTH EAST OF BIG TROUT LAKE
 M.N.R. ADMINISTRATIVE DISTRICT
 SIOUX LOOKOUT MINING DIVISION
 PATRICIA LAND TITLES / REGISTRY DIVISION
 KENORA (PATRICIA PORTION)

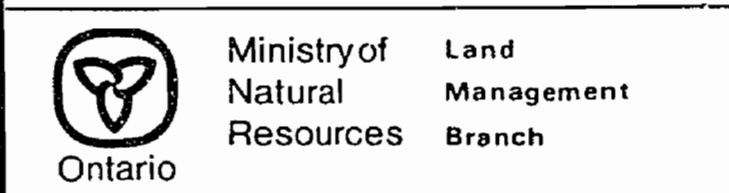

Date: FEBRUARY, 1984. Number: G-2145

PORTAGE LAKE AREA M.1734

NORTH OF SANDYBANK LAKE AREA M.2206

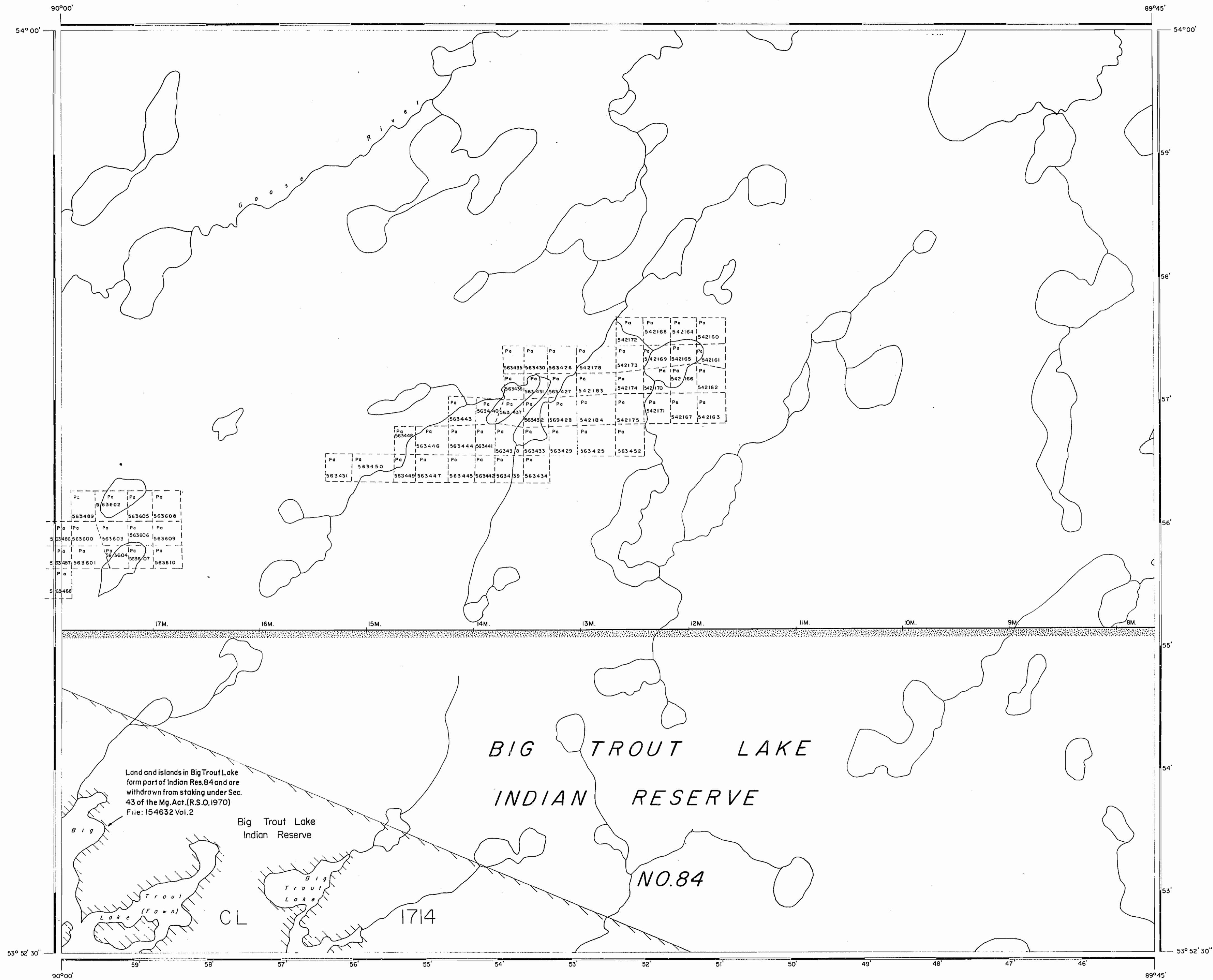

LEGEND

- HIGHWAY AND ROUTE No
- OTHER ROADS
- TRAILS
- SURVEYED LINES
 - TOWNSHIPS, BASE LINES, ETC
 - LOTS, MINING CLAIMS, PARCELS, ETC
- UNSURVEYED LINES
 - LOT LINES
 - PARCEL BOUNDARY
 - MINING CLAIMS ETC
- RAILWAY AND RIGHT OF WAY
- UTILITY LINES
- NON-PERENNIAL STREAM
- FLOODING OR FLOODING RIGHTS
- SUBDIVISION
- ORIGINAL SHORELINE
- MARSH OR MUSKEG
- MINES

DISPOSITION OF CROWN LANDS

- | TYPE OF DOCUMENT | SYMBOL |
|--------------------------------|--------|
| PATENT SURFACE & MINING RIGHTS | |
| SURFACE RIGHTS ONLY | |
| MINING RIGHTS ONLY | |
| LEASE SURFACE & MINING RIGHTS | |
| SURFACE RIGHTS ONLY | |
| MINING RIGHTS ONLY | |
| LICENCE OF OCCUPATION | |
| CROWN LAND SALE | CS |
| ORDER-IN-COUNCIL | OC |
| RESERVATION | |
| CANCELLED | |
| SAND & GRAVEL | |

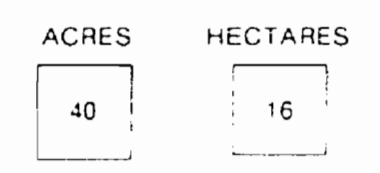
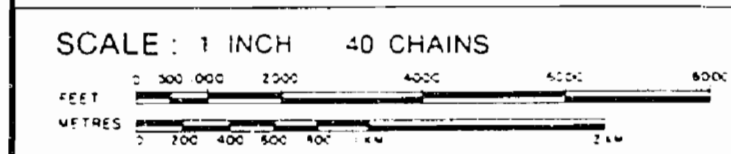

AREA NORTH EAST OF BIG TROUT LAKE DISTRICT

KENORA PATRICIA PORTION

MINING DIVISION PATRICIA

POST ISLAND of BIG TROUT LAKE AREA M.2215

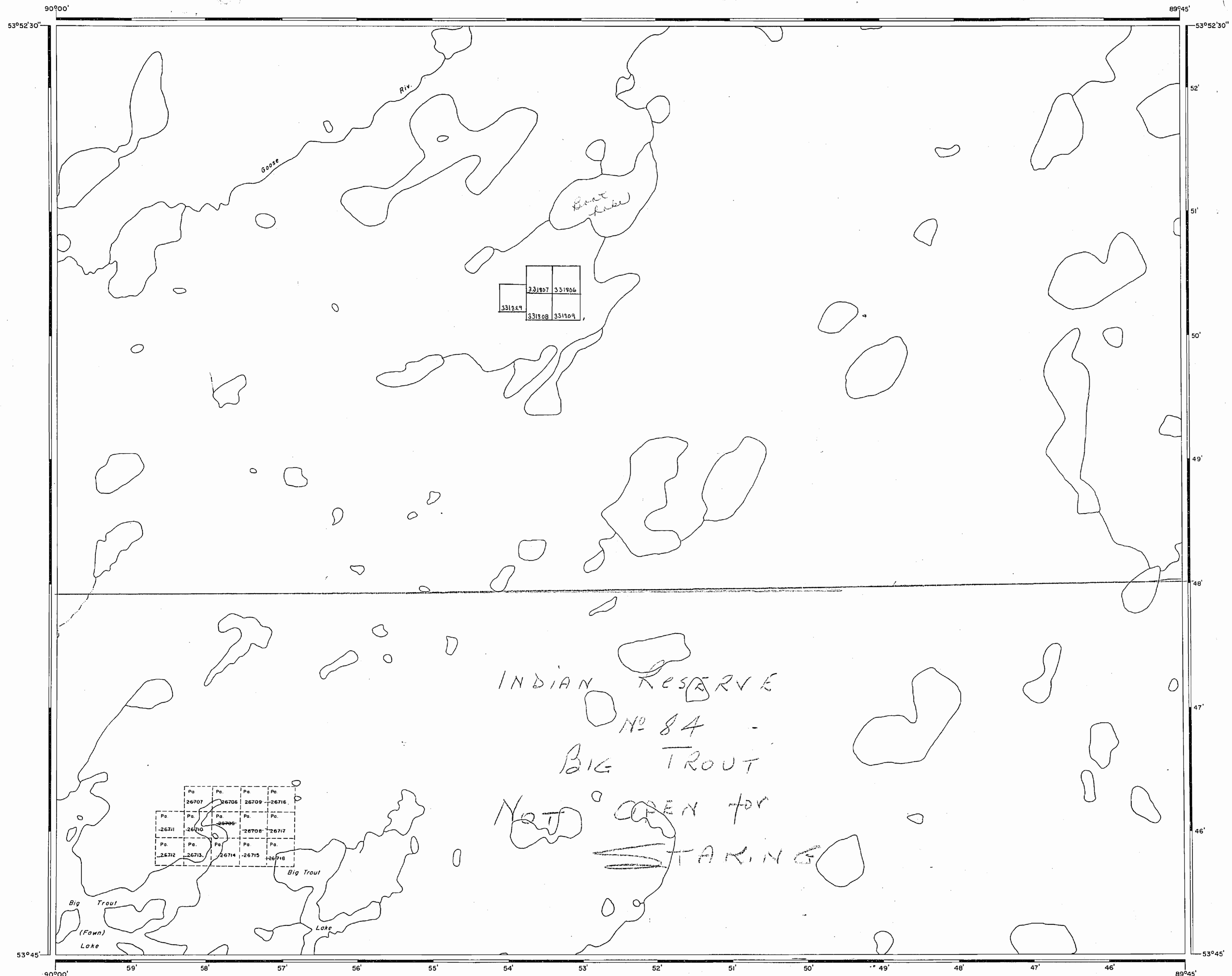

AREA OF
**NORTH-EAST OF
 BIG TROUT LAKE**

DISTRICT OF
KENORA
 PATRICIA PORTION

PATRICIA
 MINING DIVISION

SCALE: 1-INCH = 40 CHAINS

LEGEND

- | | |
|-----------------------|--------|
| PATENTED LAND | Ⓟ |
| CROWN LAND SALE | C.S. |
| LEASES | Ⓛ |
| LOCATED LAND | Loc. |
| LICENSE OF OCCUPATION | L.O. |
| MINING RIGHTS ONLY | M.R.O. |
| SURFACE RIGHTS ONLY | S.R.O. |
| ROADS | — |
| IMPROVED ROADS | — |
| KING'S HIGHWAYS | — |
| RAILWAYS | — |
| POWER LINES | — |
| MARSH OR MUSKEG | — |
| MINES | Ⓜ |
| CANCELLED | C. |

NOTES

400' Reserve around all Lakes & Rivers
 to Dept. of Lands & Forests.

NOT TO BE USED FOR SURVEY PURPOSES

North of Sandybank Lake Area - M.2206

#1

G-2145
 PLAN NO. M.2240

DEPARTMENT OF MINES
 — ONTARIO —

Trout Lake Area - M.2215

Blow-up

Bob K.

REFERENCES

AREAS WITHDRAWN FROM DISPOSITION

M.R.O. - MINING RIGHTS ONLY
S.R.O. - SURFACE RIGHTS ONLY
M.+S. - MINING AND SURFACE RIGHTS
Description Order No. Date Disposition File

All lands within the Reserve are controlled by the Dept. of Indian Affairs in Ottawa.

PORTAGE LAKE AREA G-2177

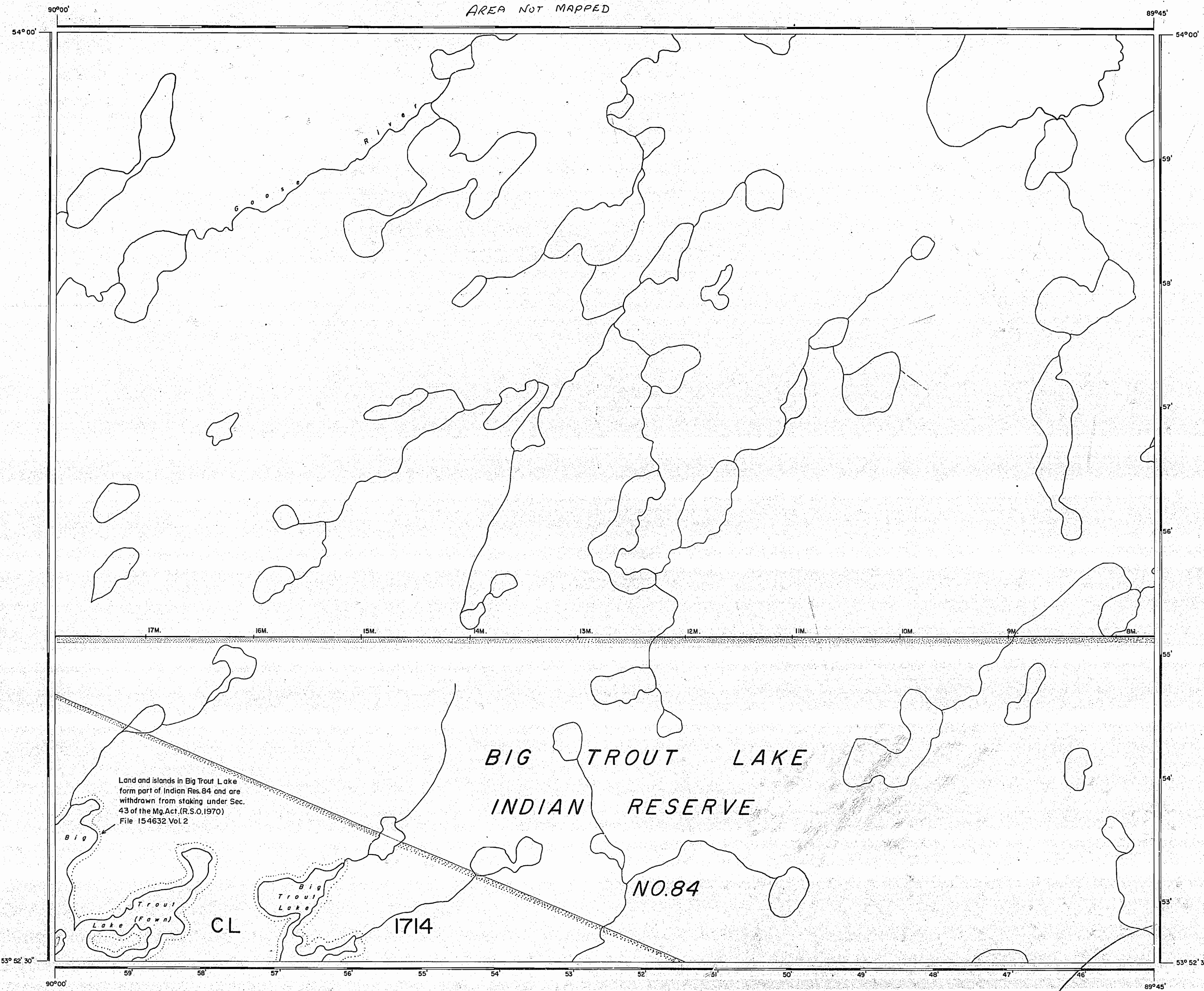

POST ISLAND of BIG TROUT LAKE AREA G-2179

LEGEND

- HIGHWAY AND ROUTE No.
- OTHER ROADS
- TRAILS
- SURVEYED LINES:
 - TOWNSHIPS, BASE LINES, ETC.
 - LOTS, MINING CLAIMS, PARCELS, ETC.
- UNSURVEYED LINES:
 - LOT LINES
 - PARCEL BOUNDARY
 - MINING CLAIMS ETC.
- RAILWAY AND RIGHT OF WAY
- UTILITY LINES
- NON-PERENNIAL STREAM
- FLOODING OR FLOODING RIGHTS
- SUBDIVISION OR COMPOSITE PLAN
- RESERVATIONS
- ORIGINAL SHORELINE
- MARSH OR MUSKEG
- MINES
- TRAVERSE MONUMENT

DISPOSITION OF CROWN LANDS

TYPE OF DOCUMENT	SYMBOL
PATENT, SURFACE & MINING RIGHTS	
" SURFACE RIGHTS ONLY	
" MINING RIGHTS ONLY	
LEASE, SURFACE & MINING RIGHTS	
" SURFACE RIGHTS ONLY	
" MINING RIGHTS ONLY	
LICENCE OF OCCUPATION	
ORDER-IN-COUNCIL	
RESERVATION	
CANCELLED	
SAND & GRAVEL	

NOTE: MINING RIGHTS IN PARCELS PATENTED PRIOR TO MAY 6 1915, VESTED IN ORIGINAL PATENTEES BY THE PUBLIC LANDS ACT, R.S.O. 1970, CHAP. 380, SEC. 63, SUBSEC. 1.

THE INFORMATION THAT APPEARS ON THIS MAP HAS BEEN COMPILED FROM VARIOUS SOURCES, AND ACCURACY IS NOT GUARANTEED. THOSE WISHING TO STAKE MINING CLAIMS SHOULD CONSULT WITH THE MINING RECORDER, MINISTRY OF NORTHERN DEVELOPMENT AND MINES, FOR ADDITIONAL INFORMATION ON THE STATUS OF THE LANDS SHOWN HEREON.

SCALE: 1 INCH = 40 CHAINS

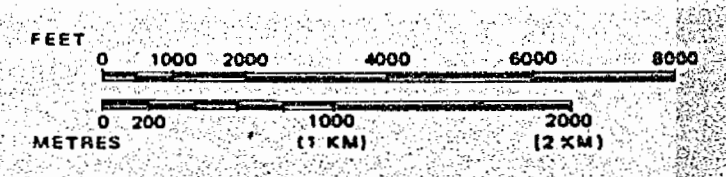

AREA NORTH EAST OF
OF
BIG TROUT LAKE
M.N.R. ADMINISTRATIVE DISTRICT
SIOUX LOOKOUT
MINING DIVISION
PATRICIA
LAND TITLES / REGISTRY DIVISION
KENORA (PATRICIA PORTION)

Ministry of Natural Resources
Land Management Branch
Ontario

Date: FEBRUARY, 1984. Number: G-2145

NORTH OF SANDYBANK LAKE AREA G-2151