

**INDEX TO LAND DISPOSITION**

PLAN  
**G-2943**  
 TOWNSHIP  
**PRINGLE (North Portion)**

M.N.R. ADMINISTRATIVE DISTRICT  
**NORTH BAY**  
 MINING DIVISION  
**SOUTHERN ONTARIO**  
 LAND TITLES/REGISTRY DIVISION  
**PARRY SOUND**

**DISPOSITION OF CROWN LANDS**

- Patent  
 Surface & Mining Rights ..... ●  
 Surface Rights Only ..... ○  
 Mining Rights Only ..... ○
- Lease  
 Surface & Mining Rights ..... ■  
 Surface Rights Only ..... □  
 Mining Rights Only ..... □
- Licence of Occupation ..... ▽  
 Order-in-Council ..... OC  
 Cancelled ..... ⊖  
 Reservation ..... ⊕  
 Sand & Gravel ..... ⊙

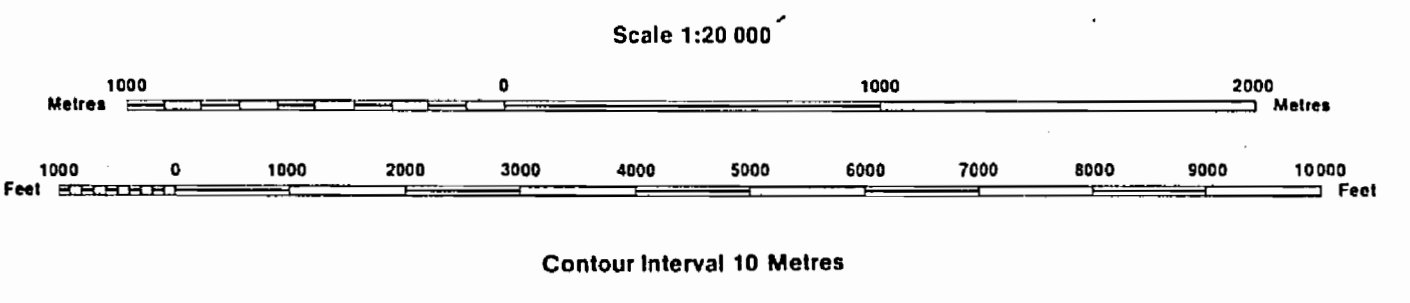

Map base and land disposition drafting by Surveys and Mapping Branch, Ministry of Natural Resources.  
 The disposition of land, location of lot fabric and parcel boundaries on this index was compiled for administrative purposes only.

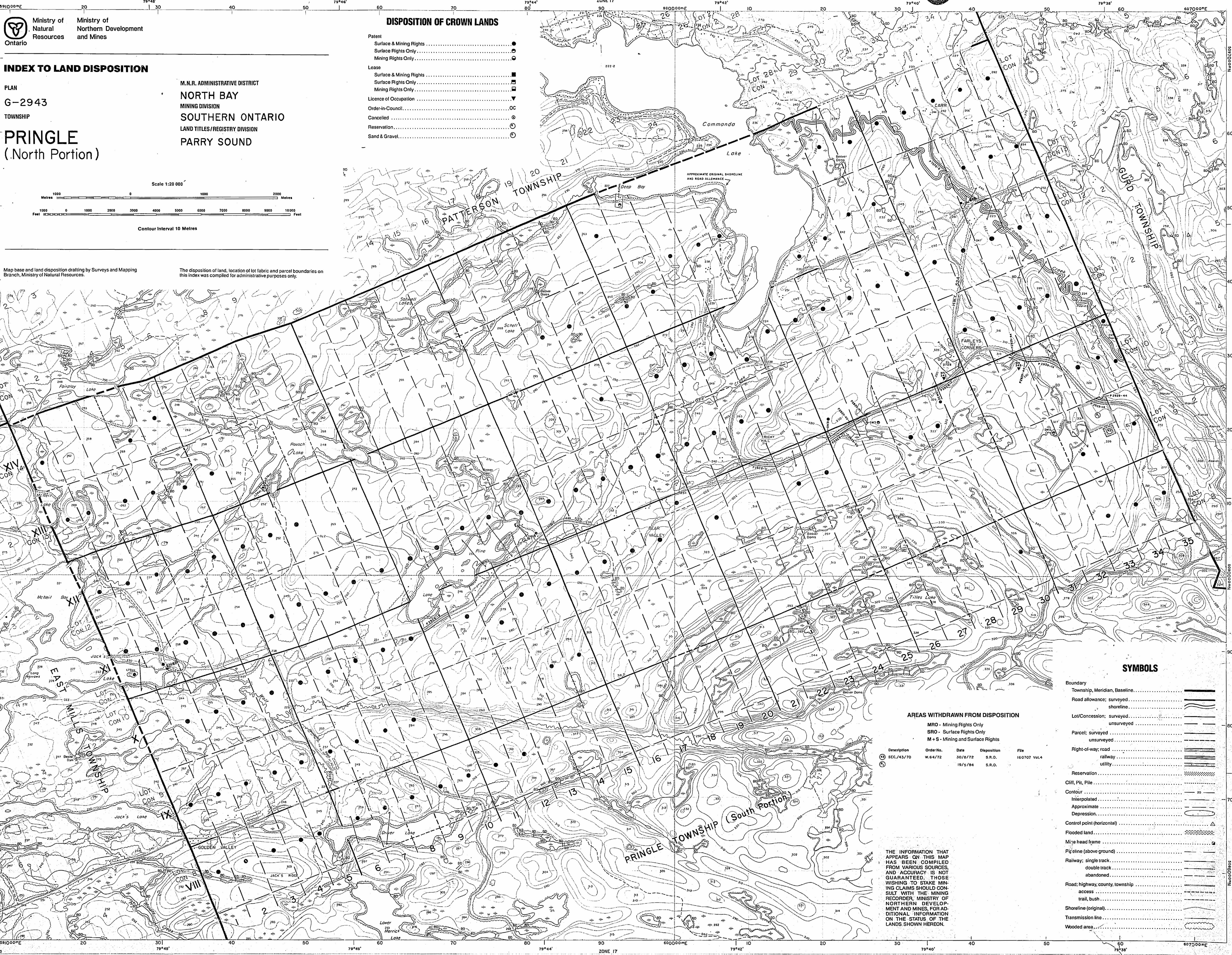

**AREAS WITHDRAWN FROM DISPOSITION**

MRO - Mining Rights Only  
 SRO - Surface Rights Only  
 M+S - Mining and Surface Rights

Description	Order No.	Date	Disposition	File
① SEC. 743/70	W. 64/72	30/8/72	S.R.O.	160707 Vol.4
②		19/9/84	S.R.O.	

- SYMBOLS**
- Boundary Township, Meridian, Baseline.....
  - Road allowance; surveyed shoreline.....
  - Lot/Concession; surveyed.....
  - Parcel; surveyed.....
  - Right-of-way; road.....
  - Reservation.....
  - Cliff, Pit, Pile.....
  - Contour.....
  - Interpolated.....
  - Approximate.....
  - Depression.....
  - Control point (horizontal).....
  - Flooded land.....
  - Misc head frame.....
  - Pipeline (above ground).....
  - Railway; single track.....
  - Road; highway, county, township.....
  - Shoreline (original).....
  - Transmission line.....
  - Wooded area.....

THE INFORMATION THAT APPEARS ON THIS MAP HAS BEEN COMPILED FROM VARIOUS SOURCES AND ACCURACY IS NOT GUARANTEED. THOSE WISHING TO STAKE MINING CLAIMS SHOULD CONSULT WITH THE MINING RECORDER, MINISTRY OF NORTHERN DEVELOPMENT AND MINES, FOR ADDITIONAL INFORMATION ON THE STATUS OF THE LANDS SHOWN HEREON.

**DISPOSITION OF CROWN LANDS**

- Patent**
- Surface & Mining Rights .....
  - Surface Rights Only .....
  - Mining Rights Only .....
- Lease**
- Surface & Mining Rights .....
  - Surface Rights Only .....
  - Mining Rights Only .....
- Licence of Occupation** .....
- Order-in-Council** .....
- Cancelled** .....
- Reservation** .....
- Sand & Gravel** .....

**INDEX TO LAND DISPOSITION**

PLAN  
**G-4133**  
 TOWNSHIP  
**PRINGLE**  
 (South Portion)

M.N.R. ADMINISTRATIVE DISTRICT  
**NORTH BAY**  
 MINING DIVISION  
**SOUTHERN ONTARIO**  
 LAND TITLES/REGISTRY DIVISION  
**PARRY SOUND**

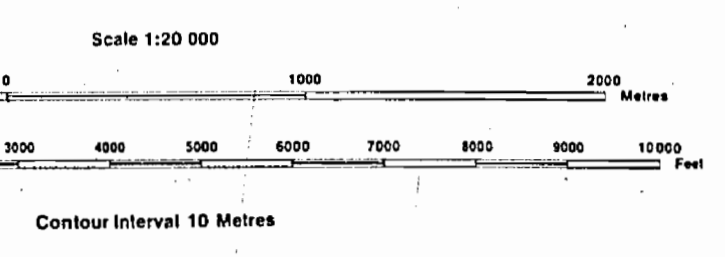

Map base and land disposition drafting by Surveys and Mapping Branch, Ministry of Natural Resources.

The disposition of land, location of lot fabric and parcel boundaries on this index was compiled for administrative purposes only.



**AREAS WITHDRAWN FROM DISPOSITION**

Description	Order No.	Date	Disposition	File
SEC 43/70	W13/74	3/4/74	S.R.O.	160707 Vol.4, 65476

**SYMBOLS**

- Boundary
- Township, Meridian, Baseline .....
- Road allowance; surveyed
- shoreline .....
- Lot/Concession; surveyed
- unsurveyed .....
- Parcel; surveyed
- unsurveyed .....
- Right-of-way; road
- railway
- utility .....
- Reservation .....
- Cleft, Pit, Pile .....
- Contour .....
- Interpolated .....
- Approximate .....
- Depression .....
- Control point (horizontal) .....
- Flooded land .....
- Mine head frame .....
- Pipeline (above ground) .....
- Railway; single track
- double track
- abandoned .....
- Road; highway, county, township
- access
- trail, bush
- Shoreline (original) .....
- Transmission line .....
- Wooded area .....

THE INFORMATION THAT APPEARS ON THIS MAP HAS BEEN COMPILED FROM VARIOUS SOURCES, AND ACCURACY IS NOT GUARANTEED. THOSE WISHING TO STAKE MINING CLAIMS SHOULD CONSULT WITH THE MINING RECORDER, MINISTRY OF NORTHERN DEVELOPMENT AND MINES, FOR ADDITIONAL INFORMATION ON THE STATUS OF THE LANDS SHOWN HEREON.

OFFICE USE ONLY

Patterson Twp.

THE TOWNSHIP OF

# PRINGLE

DISTRICT OF PARRY SOUND

SUDBURY MINING DIVISION

SCALE: 1-INCH=40 CHAINS

### LEGEND

PATENTED LAND	Ⓟ
CROWN LAND SALE	C.S.
LEASES	Ⓛ
LOCATED LAND	Loc.
LICENSE OF OCCUPATION	L.O.
MINING RIGHTS ONLY	M.R.O.
SURFACE RIGHTS ONLY	S.R.O.
ROADS	—
IMPROVED ROADS	—
KING'S HIGHWAYS	—
RAILWAYS	—
POWER LINES	—
MARSH OR MUSKEG	—
MINES	—
CANCELLED	—

### NOTES

This Twp. Is Not To Be Used For Survey Purposes

400' Surface rights reservation around all lakes and rivers.

Areas withdrawn from staking under Section 43 of the Mining Act, R.S.O. 1970

File	Date	Disposition
160707	31/9/77	SRO

Re-Opened by Order No. O.8/81 Section 36(1) R.S.O. 1980 Chap. 268 by North Bay District Nov. 24 1981 PA 42 (Part 1 Plan 42-7312) See Pringle Landfill

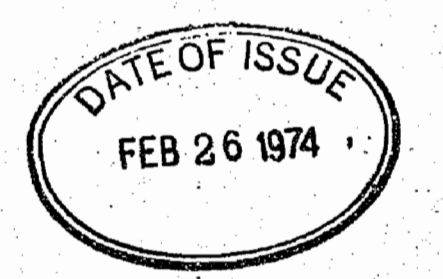

# PRINGLE

PLAN NO. -M-195

MINISTRY OF NATURAL RESOURCES

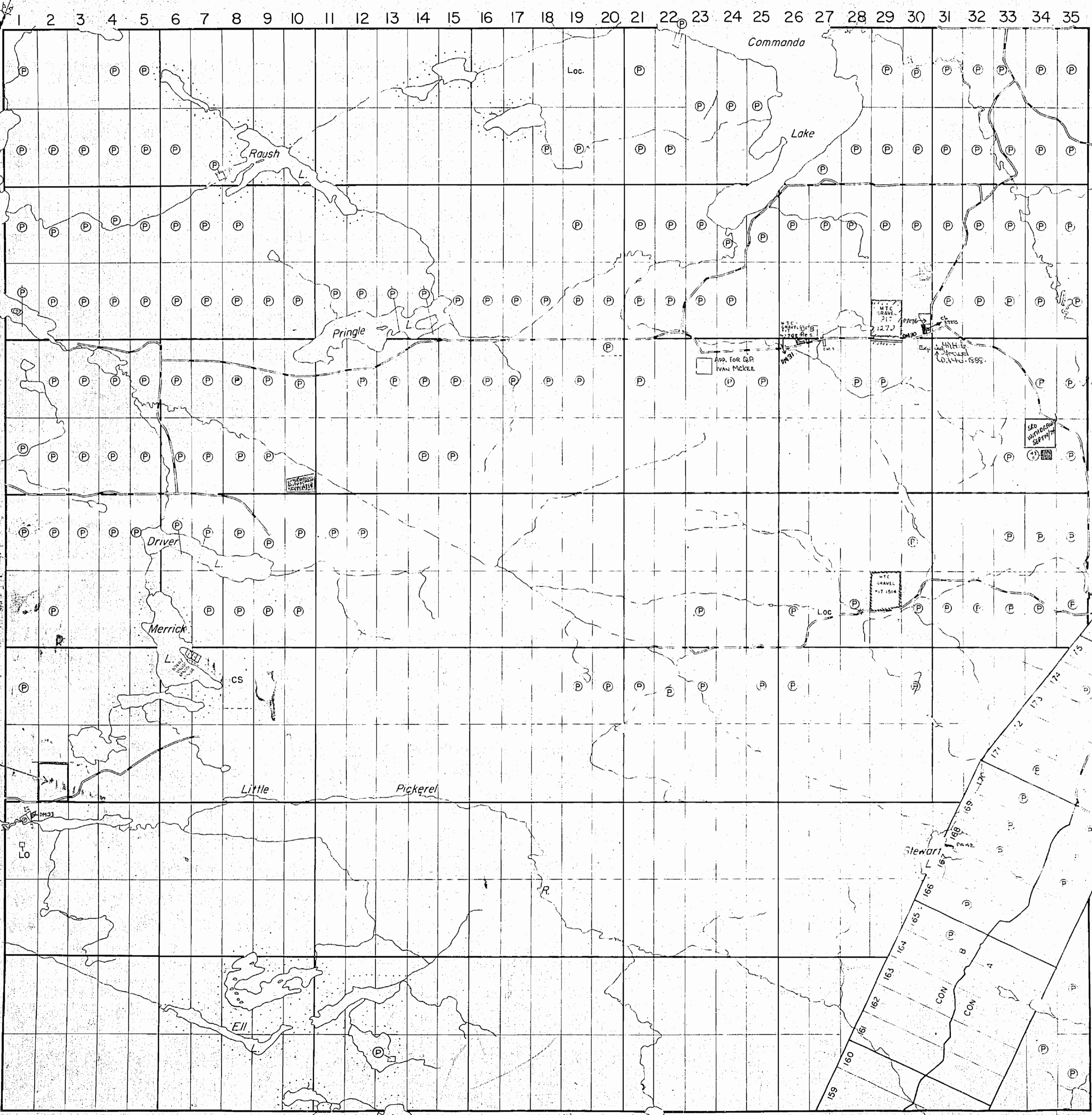

XIV  
XIII  
XII  
XI  
X  
IX  
VIII  
VII  
VI  
V  
IV  
III  
II  
I

Gurd Twp.

East Millb. Twp.

Lount Twp.

SURFACE RIGHTS WITHDRAWN UNDER SECTION 43 (M.A.) LETTER DATED APRIL 3, 1974

Patterson Twp.

THE TOWNSHIP OF

# PRINGLE

DISTRICT OF  
PARRY SOUND

SOUTHERN ONTARIO  
MINING DIVISION

SCALE: 1-INCH=40 CHAINS

### LEGEND

PATENTED LAND	● or ⊙
CROWN LAND SALE	C.S.
LEASES	⊙
LOCATED LAND	Loc.
LICENSE OF OCCUPATION	L.O.
MINING RIGHTS ONLY	M.R.O.
SURFACE RIGHTS ONLY	S.R.O.
ROADS	—
IMPROVED ROADS	—
KING'S HIGHWAYS	—
RAILWAYS	—
POWER LINES	—
MARSH OR MUSKEG	—
MINES	X
CANCELLED	C

### NOTES

This Map is Not To Be Used  
For Survey Purposes

400' Surface rights reservation around obelisks and river.

Areas withdrawn from staking under Section 48 of the Mining Act (R.S.O. 1970)

Order No.	File	Date	Disposition
①	160707	31/8/72	S.R.O.
②	161577	5/1/75	S.R.O.
③		SEPT. 1974	S.R.O.

Location R1 29 (Plan 42R-1245 Part 1)  
Part of Lot 20, Conc. I  
CL 2725 (Part 1) s/c 2700/01 to M.G.S. Admin  
PA 42 (Part 1) Plan 42R-7812 ②

### DATE OF ISSUE

OCT - 4 1994

SOUTHERN ONTARIO  
MINING DIVISION

THE INFORMATION THAT APPEARS ON THIS MAP HAS BEEN COMPILED FROM VARIOUS SOURCES, AND ACCURACY IS NOT GUARANTEED. THOSE WISHING TO STAKE MINING CLAIMS SHOULD CONSULT WITH THE MINING RECORDER, MINISTRY OF NORTHERN DEVELOPMENT AND MINES, FOR ADDITIONAL INFORMATION ON THE STATUS OF THE LANDS SHOWN HEREON.

# PRINGLE

PLAN NO.-M-195

MINISTRY OF NATURAL RESOURCES  
SURVEYS AND MAPPING BRANCH

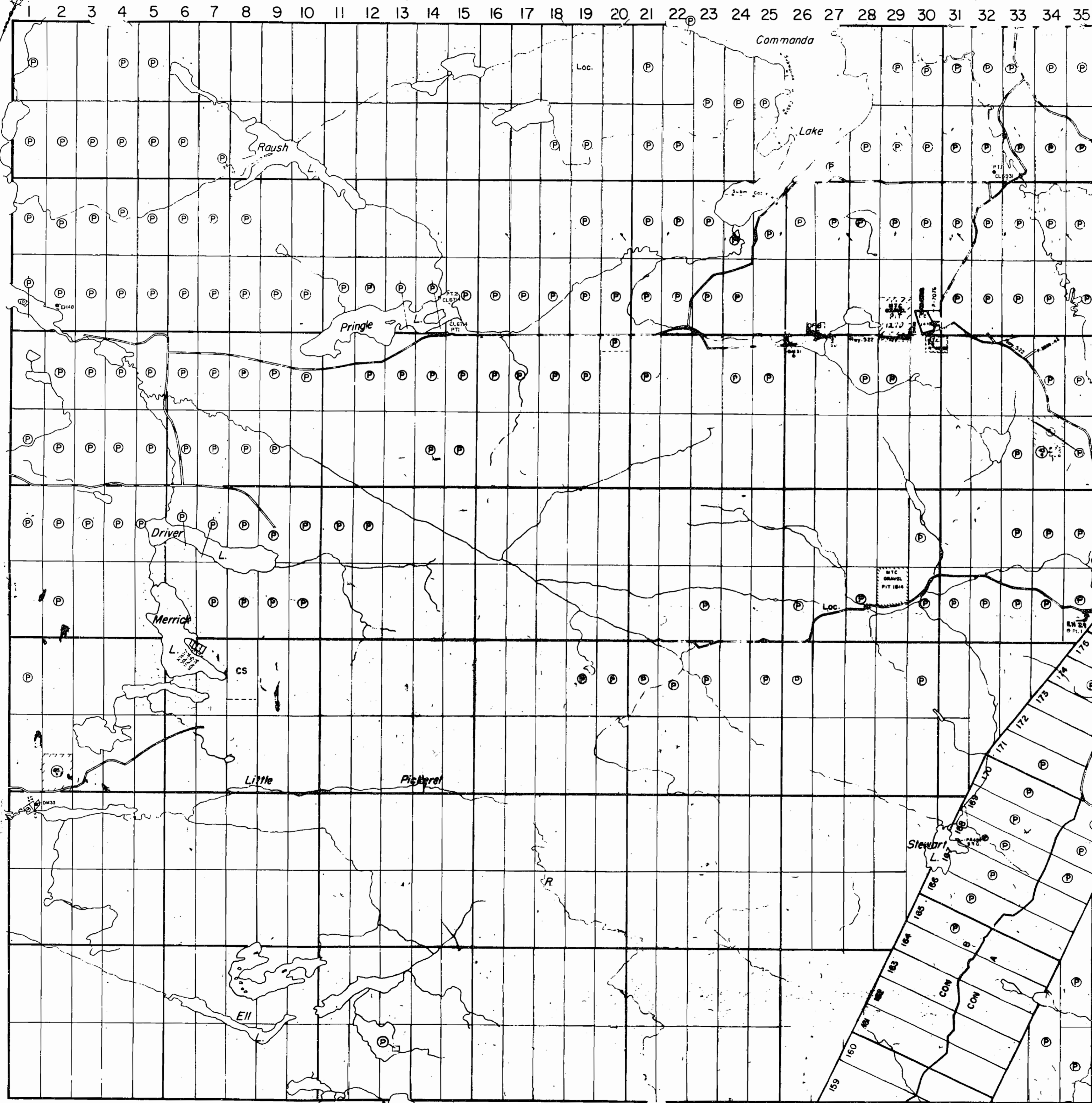

East Minto Twp.

Gurd Twp.

Lount Twp.

Patterson Twp.

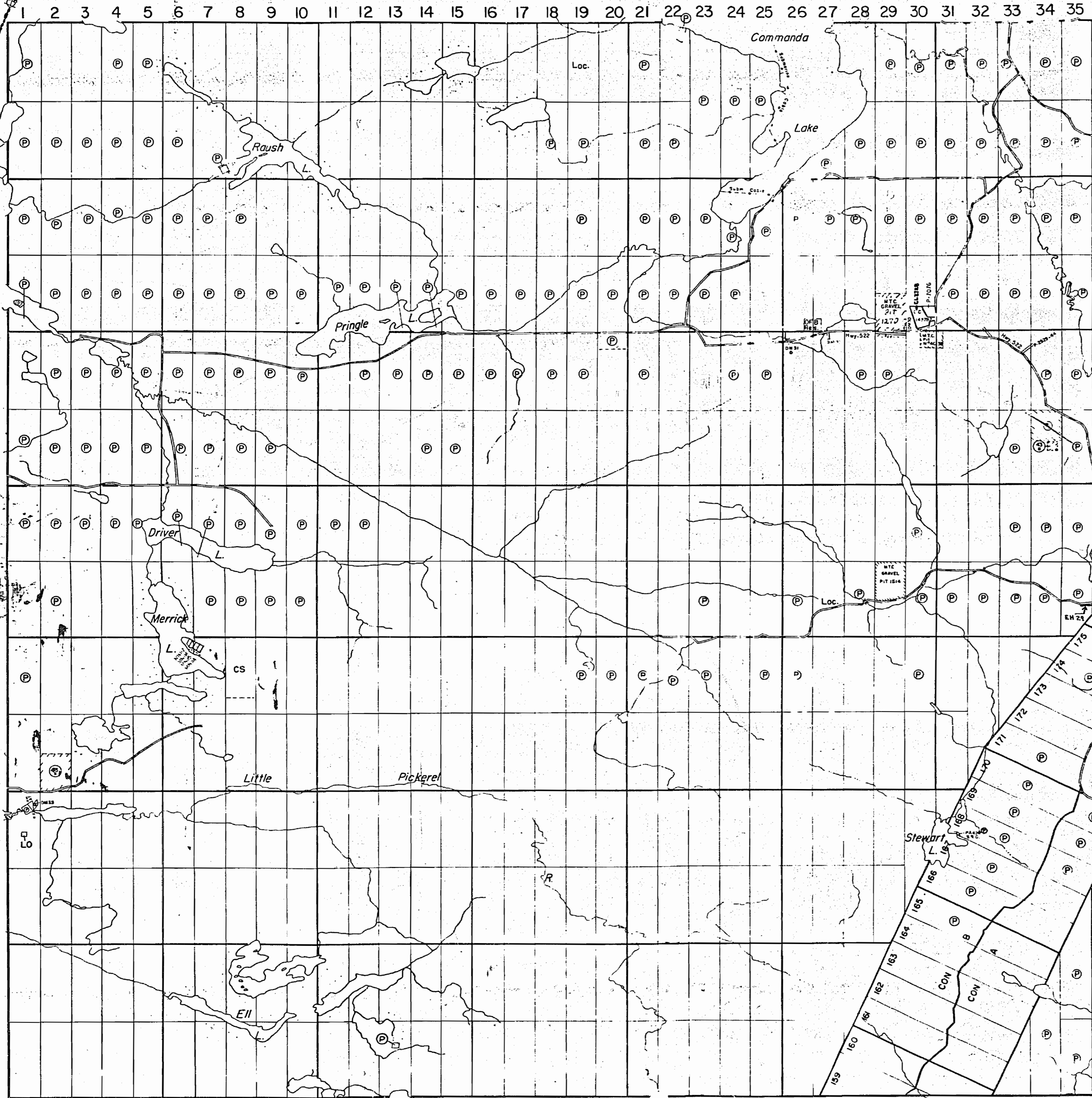

THE TOWNSHIP OF

# PRINGLE

RESIDENT GEOLOGIST - Dorset

DISTRICT OF  
PARRY SOUND

SOUTHERN ONTARIO  
MINING DIVISION  
DISTRICT MANAGER - NORTH BAY N.E. REGION  
SCALE: 1-INCH=40 CHAINS

### LEGEND

PATENTED LAND	⊙ or ⊕
CROWN LAND SALE	C.S.
LEASES	⊙
LOCATED LAND	Loc.
LICENSE OF OCCUPATION	L.O.
MINING RIGHTS ONLY	M.R.O.
SURFACE RIGHTS ONLY	S.R.O.
ROADS	—
IMPROVED ROADS	—
KING'S HIGHWAYS	—
RAILWAYS	—
POWER LINES	—
MARSH OR MUSKEG	—
MINES	—
CANCELLED	—

### NOTES

This Map Is Not To Be Used  
For Survey Purposes

400' Surface rights easement around all lakes and rivers.

Areas withdrawn from staking under Section 43 of the Mining Act (R.S.O. 1970)

Order No.	File	Date	Disposition
①	160707	31/8/72	S.R.O.
②	161374	3/77	S.R.O.
③		SEPT. 1974	S.R.O.

Location EH 29 (Plan 42R-9363 Part 1)

Part of Lot 35, Conc. I

CL 2728 (Part 1) O/C 2900/81 to M.G.S. Ontario

PA 42 (Part 1) Plan 42R-7812 ②

EASTERN ONTARIO  
**RECEIVED**

FEB 16 1987

# PRINGLE

PLAN NO.-M-195

MINISTRY OF NATURAL RESOURCES  
SURVEYS AND MAPPING BRANCH

East Mill Twp.

Gurd Twp.

Lount Twp.

OFFICE USE ONLY

Patterson Twp.

THE TOWNSHIP OF  
**PRINGLE**  
 DISTRICT OF PARRY SOUND  
 SUDBURY MINING DIVISION  
 SCALE: 1-INCH = 40 CHAINS

LEGEND

PATENTED LAND	Ⓟ
CROWN LAND SALE	C.S.
LEASES	Ⓛ
LOCATED LAND	Loc.
LICENSE OF OCCUPATION	L.O.
MINING RIGHTS ONLY	M.R.O.
SURFACE RIGHTS ONLY	S.R.O.
ROADS	—
IMPROVED ROADS	—
KING'S HIGHWAYS	—
RAILWAYS	—
POWER LINES	—
MARSH OR MUSKEG	—
MINES	Ⓧ
CANCELLED	C.

NOTES

This Twp. Is Not To Be Used For Survey Purposes

400' Surface rights reservation around all lakes and rivers.

Areas withdrawn from staking under Section 43 of the Mining Act, R.S.O. 1970

File	Date	Disposition
160707	31/9/77	S.R.O.
	(w. 64/72)	

Re-Opened by Order No. O.B. 81  
 Section 36(1) R.S.O. 1980 Chap. 268  
 by North Bay District Nov. 24 1981  
 PA 42 (Part 1 Plus 4247312) See Pringle Land Cell

DATE OF ISSUE  
 FEB 26 1974

**PRINGLE**  
 PLAN NO. -M-195

MINISTRY OF NATURAL RESOURCES  
 SUDBURY MINING DIVISION

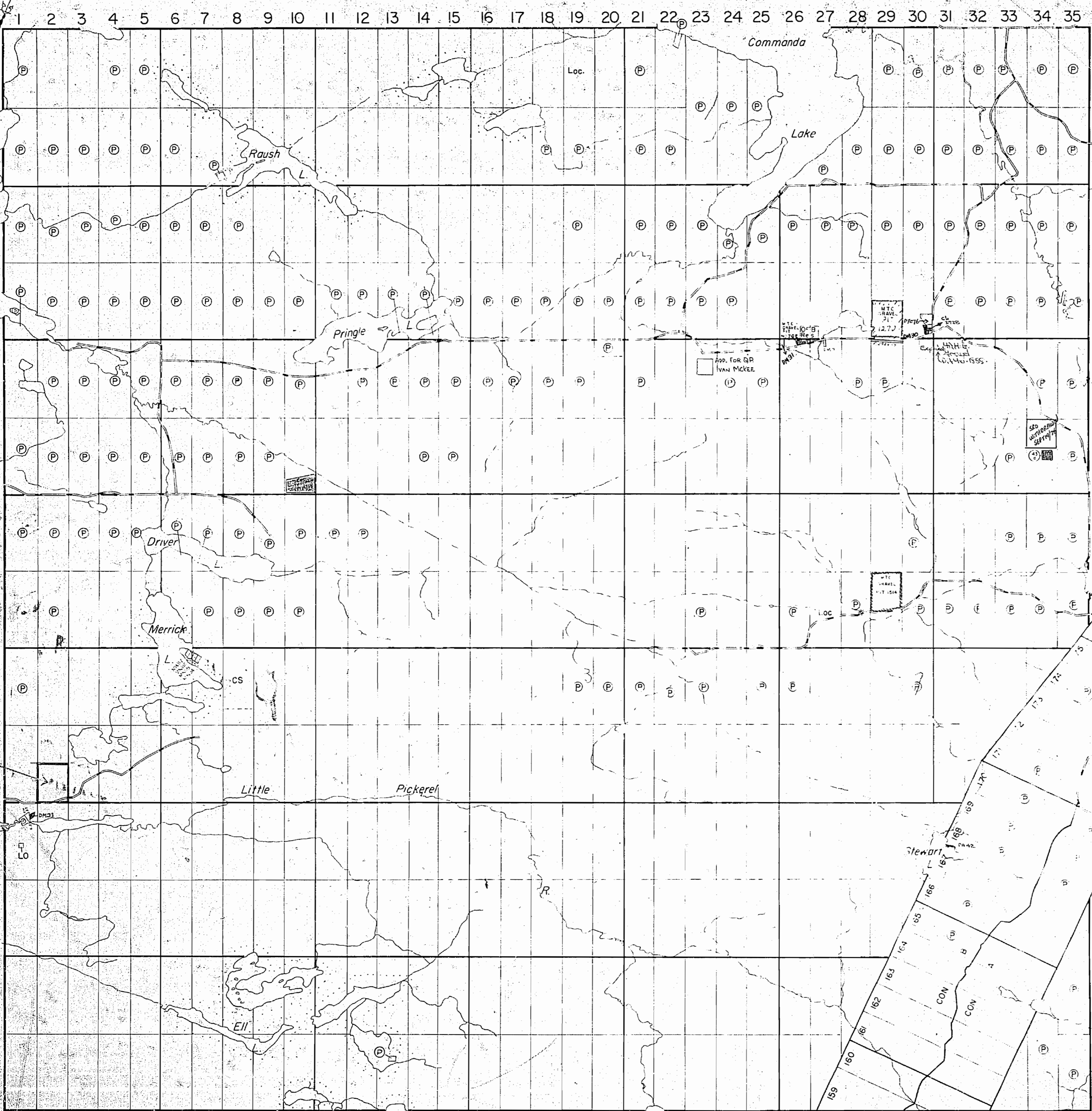

SURFACE RIGHTS WITHDRAWN UNDER SECTION 43 (MINE'S LETTER DATED APRIL 3, 1974)

East Mills Twp.

Gurd Twp.

Lount Twp.

Patterson Twp.

1 2 3 4 5 6 7 8 9 10 11 12 13 14 15 16 17 18 19 20 21 22 23 24 25 26 27 28 29 30 31 32 33 34 35

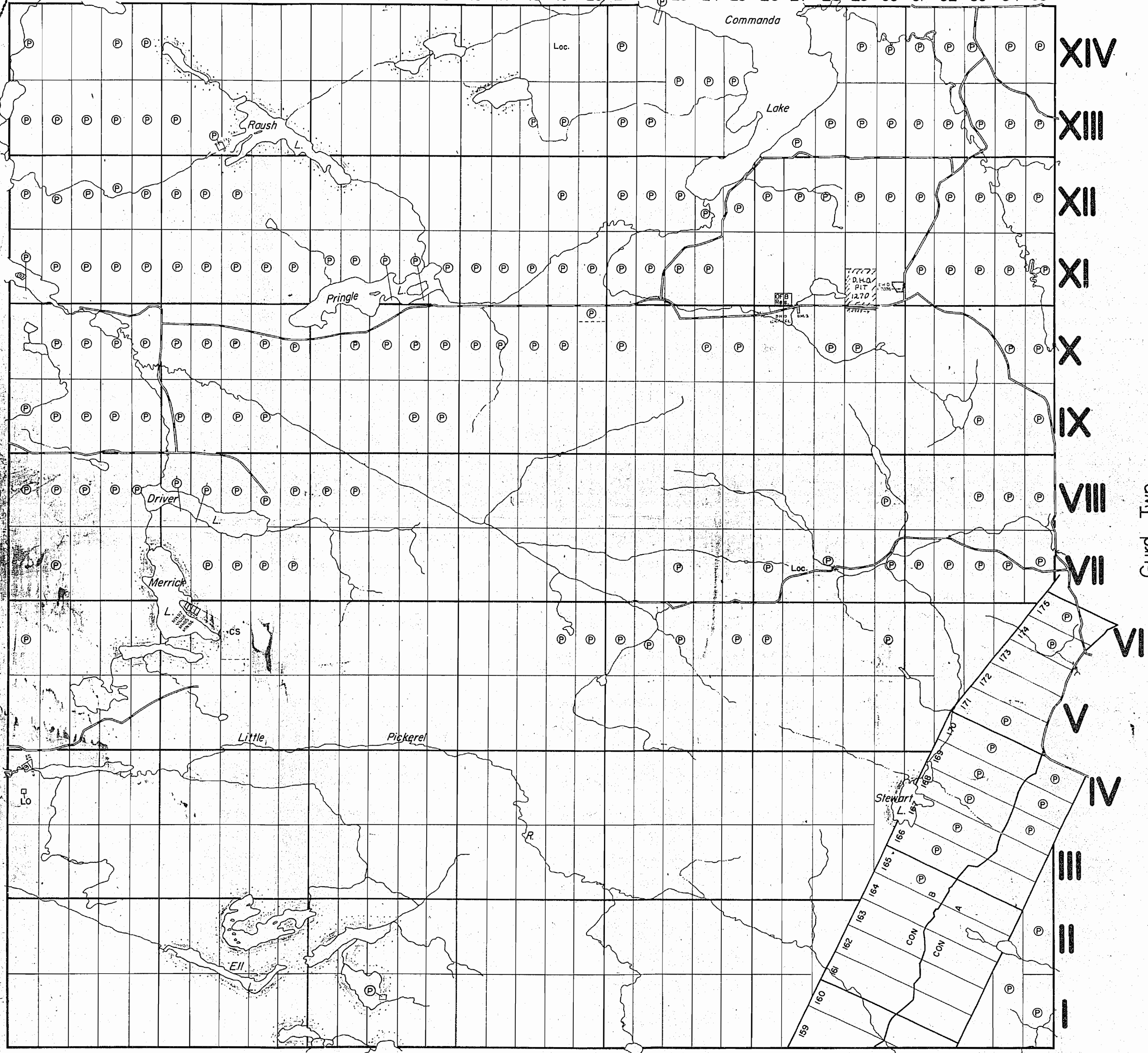

THE TOWNSHIP OF

**PRINGLE**

DISTRICT OF PARRY SOUND

EASTERN ONTARIO MINING DIVISION

SCALE: 1-INCH=40 CHAINS

**LEGEND**

PATENTED LAND	Ⓟ
CROWN LAND SALE	C.S.
LEASES	Ⓛ
LOCATED LAND	Loc.
LICENSE OF OCCUPATION	L.O.
MINING RIGHTS ONLY	M.R.O.
SURFACE RIGHTS ONLY	S.R.O.
ROADS	—
IMPROVED ROADS	—
KING'S HIGHWAYS	—
RAILWAYS	—
POWER LINES	—
MARSH OR MUSKEG	—
MINES	—
CANCELLED	—

**NOTES**

This Twp. Is Not To Be Used For Survey Purposes

400' Surface rights reservation around all lakes and rivers.

DATE OF ISSUE  
FEB 13 1970  
ONTARIO DEPT. OF MINES

PLAN NO.-M-195

DEPARTMENT OF MINES

— ONTARIO —

Lount Twp.

Gurd Twp.