

NOTES

AREAS WITHDRAWN FROM DISPOSITION

- M.R.O. — MINING RIGHTS ONLY
- S.R.O. — SURFACE RIGHTS ONLY
- M.+S. — MINING AND SURFACE RIGHTS

Description Order No. Date Disposition File

(RI) MINING AND SURFACE RIGHTS WITHDRAWN
UNDER SECTION 35 OF THE MINING ACT, R.S.O. 1990
ORDER NO. W-P-73/94 NER DATED MAY 20, 1994

SAND AND GRAVEL

(G) GRAVEL FILE 161137

DATE OF ISSUE

MAY 22 1998

PROVINCIAL RECORDING
OFFICE - SUDBURY

THE INFORMATION THAT
APPEARS ON THIS MAP
HAS BEEN COMPILED
FROM VARIOUS SOURCES,
AND ACCURACY IS NOT
GUARANTEED. THOSE
WISHING TO STAKE MIN-
ING CLAIMS SHOULD CON-
SULT WITH THE MINING
RECORDER, MINISTRY OF
NORTHERN DEVELOP-
MENT AND MINES, FOR AD-
DITIONAL INFORMATION
ON THE STATUS OF THE
LANDS SHOWN HEREON.

NIMITZ TWP.

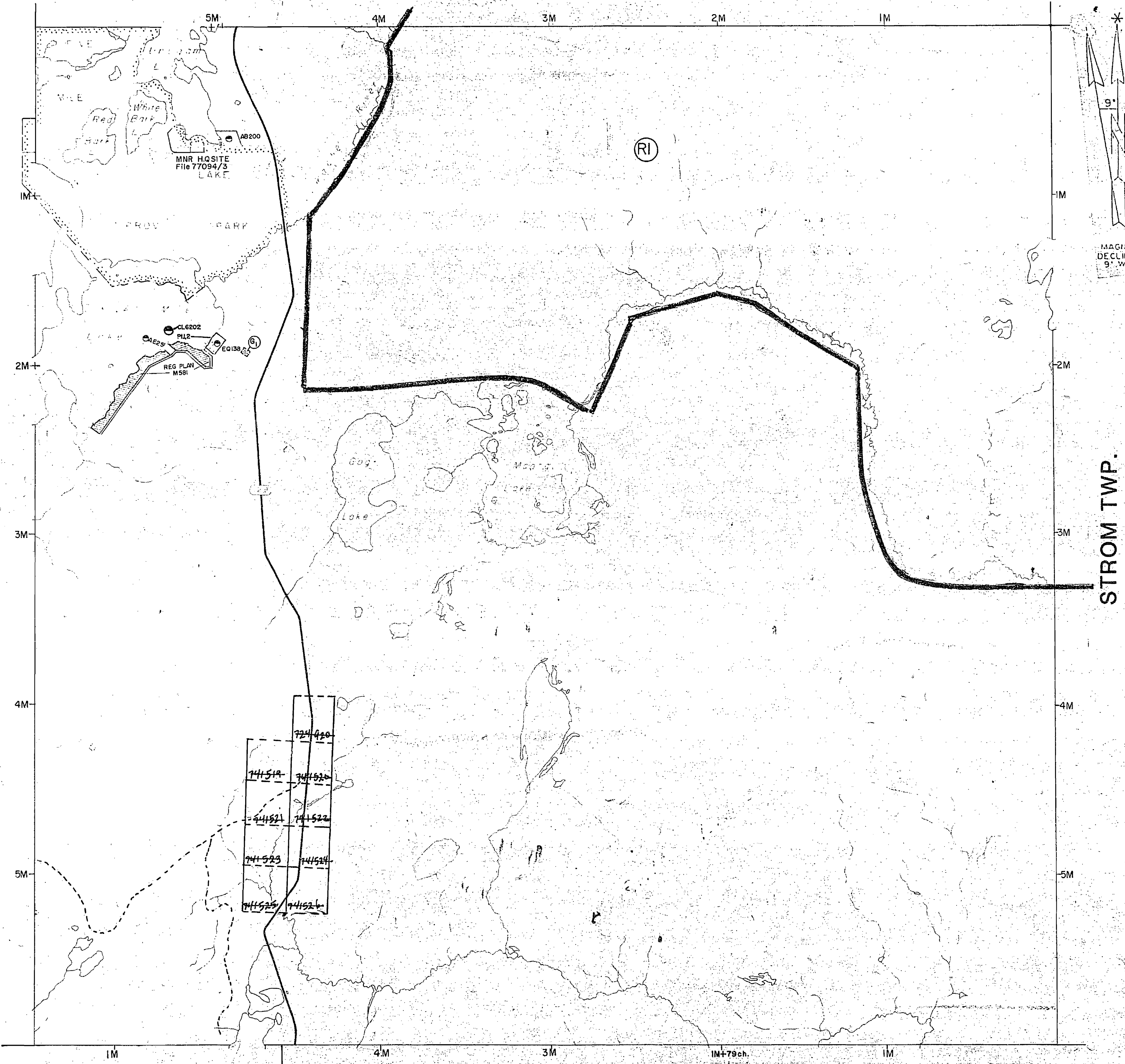

LEGEND

- HIGHWAY AND ROUTE No.
- OTHER ROADS
- TRAILS
- SURVEYED LINES:
 - TOWNSHIPS, BASE LINES, ETC.
 - LOTS, MINING CLAIMS, PARCELS, ETC.
- UNSURVEYED LINES:
 - LOT LINES
 - PARCEL BOUNDARY
 - MINING CLAIMS ETC.
- RAILWAY AND RIGHT OF WAY
- UTILITY LINES
- NON-PERENNIAL STREAM
- FLOODING OR FLOODING RIGHTS
- SUBDIVISION OR COMPOSITE PLAN
- RESERVATIONS
- ORIGINAL SHORELINE
- MARSH OR MUSKEG
- MINES
- TRAVERSE MONUMENT

DISPOSITION OF CROWN LANDS

TYPE OF DOCUMENT	SYMBOL
PATENT, SURFACE & MINING RIGHTS	
" SURFACE RIGHTS ONLY	
" MINING RIGHTS ONLY	
LEASE, SURFACE & MINING RIGHTS	
" SURFACE RIGHTS ONLY	
" MINING RIGHTS ONLY	
LICENCE OF OCCUPATION	
ORDER-IN-COUNCIL	
RESERVATION	
CANCELLED	
SAND & GRAVEL	

NOTE: MINING RIGHTS IN PARCELS PATENTED PRIOR TO MAY 6, 1913, VESTED IN ORIGINAL PATENTEE BY THE PUBLIC LANDS ACT, R.S.O. 1970, CHAP. 380, SEC. 63, SUBSEC. 1.

SCALE: 1 INCH = 40 CHAINS

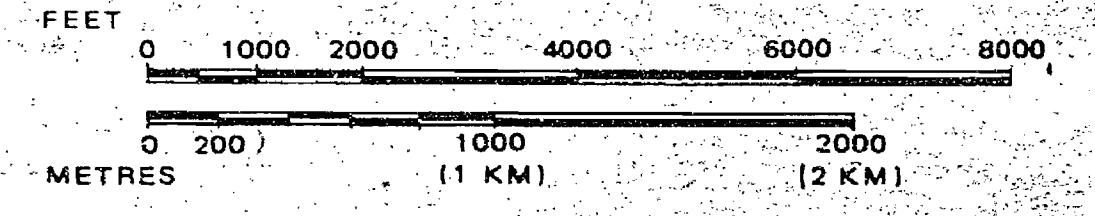

AREA

REANEY

M.N.R. ADMINISTRATIVE DISTRICT

CHAPLEAU

MINING DIVISION

PORCUPINE

LAND TITLES / REGISTRY DIVISION

SUDBURY

Ministry of Natural Resources Land Management Branch

Date: NOVEMBER 1983
November 17, 1983

Number: **G-2484**

NOTES

AREAS WITHDRAWN FROM DISPOSITION

M.R.O. - MINING RIGHTS ONLY

S.R.O. - SURFACE RIGHTS ONLY

M.+S. - MINING AND SURFACE RIGHTS

Description	Order No.	Date	Disposition	File
(R1) MINING AND SURFACE RIGHTS WITHDRAWN UNDER SECTION 35 OF THE MINING ACT, R.S.O. 1990 ORDER NO. W-P-73/94 NER DATED MAY 20, 1994				
(R2) Sec 35 W-LL-P274/99 ONT MAY 17/99 M+S				

(R1) MINING AND SURFACE RIGHTS WITHDRAWN UNDER SECTION 35 OF THE MINING ACT, R.S.O. 1990 ORDER NO. W-P-73/94 NER DATED MAY 20, 1994

(R2) Sec 35 W-LL-P274/99 ONT MAY 17/99 M+S

SAND AND GRAVEL

(R1) GRAVEL FILE 161137

THE INFORMATION THAT APPEARS ON THIS MAP HAS BEEN COMPILED FROM VARIOUS SOURCES, AND ACCURACY IS NOT GUARANTEED. THOSE WISHING TO STAKE MINING CLAIMS SHOULD CONSULT WITH THE MINING RECORDER, MINISTRY OF NORTHERN DEVELOPMENT AND MINES, FOR ADDITIONAL INFORMATION ON THE STATUS OF THE LANDS SHOWN HEREON.

NIMITZ TWP.

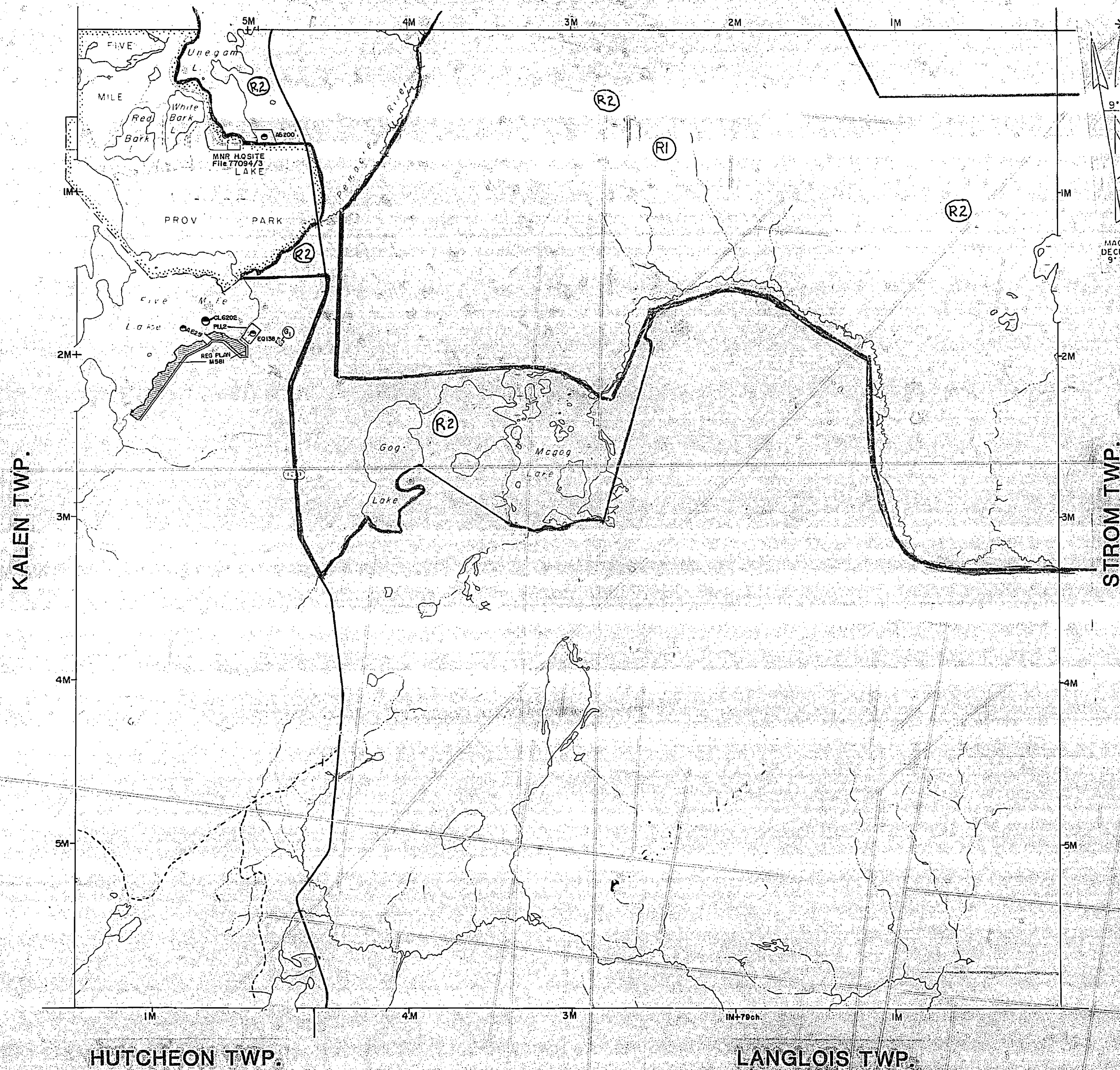

LEGEND

HIGHWAY AND ROUTE No.	
OTHER ROADS	
TRAILS	
SURVEYED LINES:	
TOWNSHIPS, BASE LINES, ETC.	
LOTS, MINING CLAIMS, PARCELS, ETC.	
UNSURVEYED LINES:	
LOT LINES	
PARCEL BOUNDARY	
MINING CLAIMS ETC.	
RAILWAY AND RIGHT OF WAY	
UTILITY LINES	
NON-PERENNIAL STREAM	
FLOODING OR FLOODING RIGHTS	
SUBDIVISION OR COMPOSITE PLAN	
RESERVATIONS	
ORIGINAL SHORELINE	
MARSH OR MUSKEG	
MINES	
TRAVERSE MONUMENT	

DISPOSITION OF CROWN LANDS

TYPE OF DOCUMENT	SYMBOL
PATENT, SURFACE & MINING RIGHTS	
SURFACE RIGHTS ONLY	
MINING RIGHTS ONLY	
LEASE, SURFACE & MINING RIGHTS	
SURFACE RIGHTS ONLY	
MINING RIGHTS ONLY	
LICENCE OF OCCUPATION	
ORDER-IN-COUNCIL	
RESERVATION	
CANCELLED	
SAND & GRAVEL	

NOTE: MINING RIGHTS IN PARCELS PATENTED PRIOR TO MAY 6, 1913, VESTED IN ORIGINAL PATENTEE BY THE PUBLIC LANDS ACT, R.S.O. 1970, CHAP. 380, SEC. 63, SUBSEC. 1.

SCALE: 1 INCH = 40 CHAINS

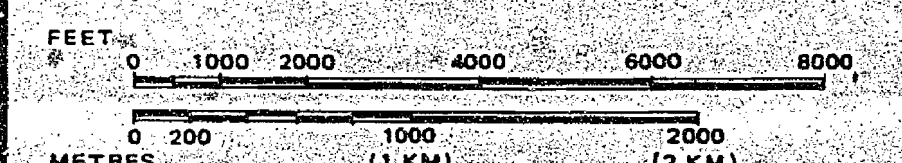

AREA

REANEY

M.N.R. ADMINISTRATIVE DISTRICT

CHAPLEAU

MINING DIVISION

PORCUPINE

LAND TITLES / REGISTRY DIVISION

SUDBURY

Ministry of Natural Resources
Land Management Branch

Date: NOVEMBER 1999
Number: G-2484

M.1452
ONTARIO

MINISTRY OF NATURAL RESOURCES
SURVEYS AND MAPPING BRANCH

REANEY

(TP. IID)

MISSISSAGI PROVINCIAL FOREST

PORCUPINE MINING DIVISION

DISTRICT OF ALGOMA

Scale:- 40 Chains = 1 inch.

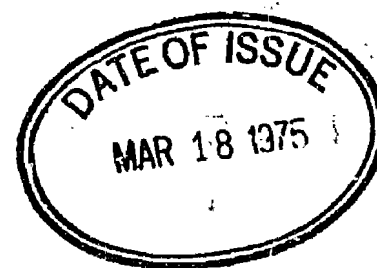

L.W.P.

Nimitz Twp. (M-1323)

NORTH AST

318

KALEN TP. M.1453

STROM TP. M.1451

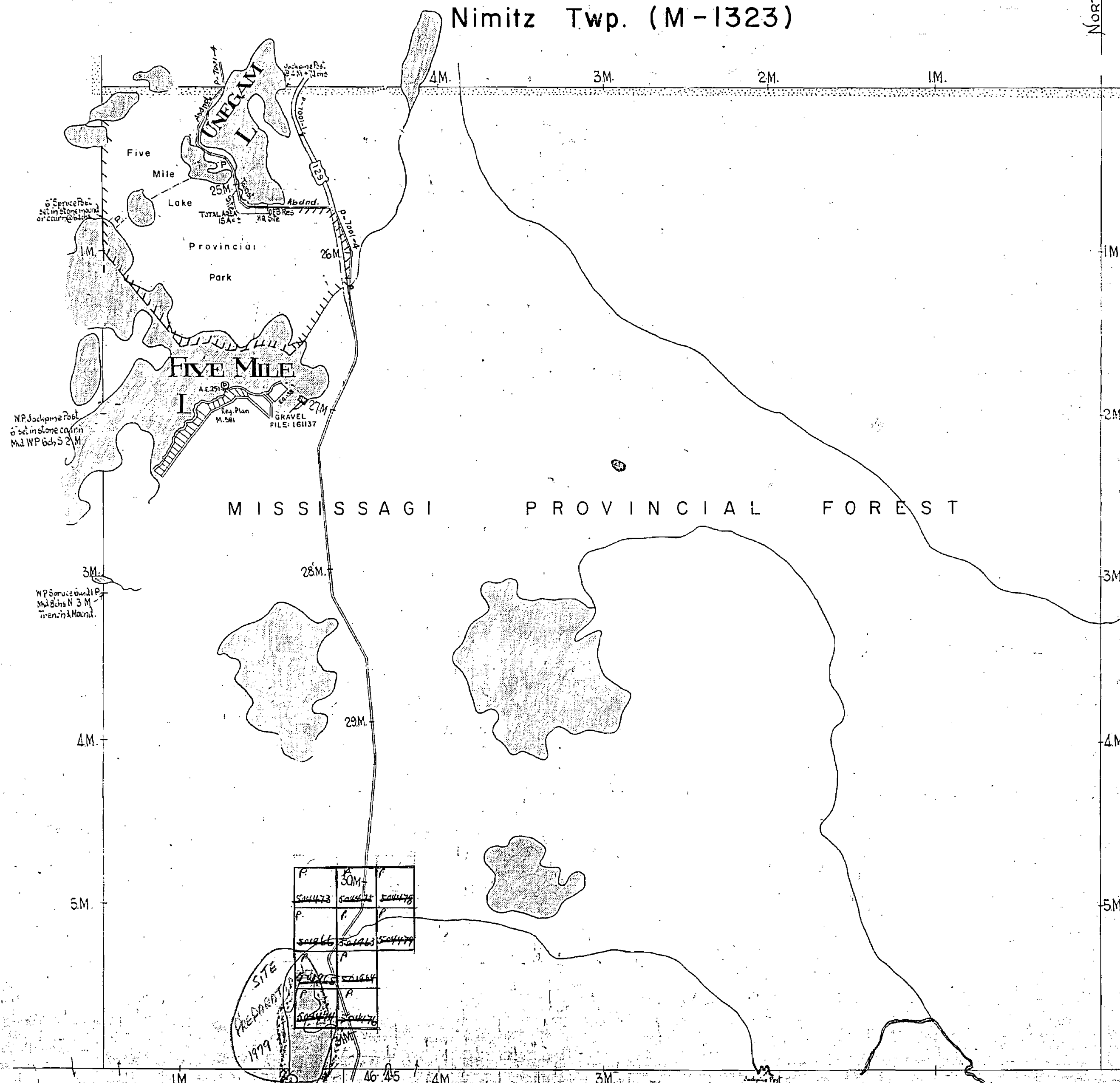

HUTCHEON TP. M.1447

LANGLOIS TP. M.1446

NORTH, EAST and SOUTH BOUNDARIES RUN BY: McCUSLAN, ANDERSON & MOORE: OLS 1923
WEST BOUNDARY RUN BY: C.V. Gallagher: OLS 1923
CHAPLEAU: IRON BRIDGE HIGHWAY FROM DEPT. HIGHWAYS PLAN 1932
NORTHERLY BOUNDARY OF THE MISSISSAGI PROVINCIAL FOREST: SHOWN WITH
400' SURFACE RIGHTS RESERVATION AROUND ALL LAKES & RIVERS

MISSISSAGI PROVINCIAL FOREST

M.1452
ONTARIO

MINISTRY OF NATURAL RESOURCES
SURVEYS AND MAPPING BRANCH

Date Recd: Sept. 30/63

REANEY

(TP. 11D)

MISSISSAGI PROVINCIAL FOREST
PORCUPINE MINING DIVISION
DISTRICT OF ALGOMA
Scale: 40 Chains = 1 inch.

Nimitz Twp. (M-1323)

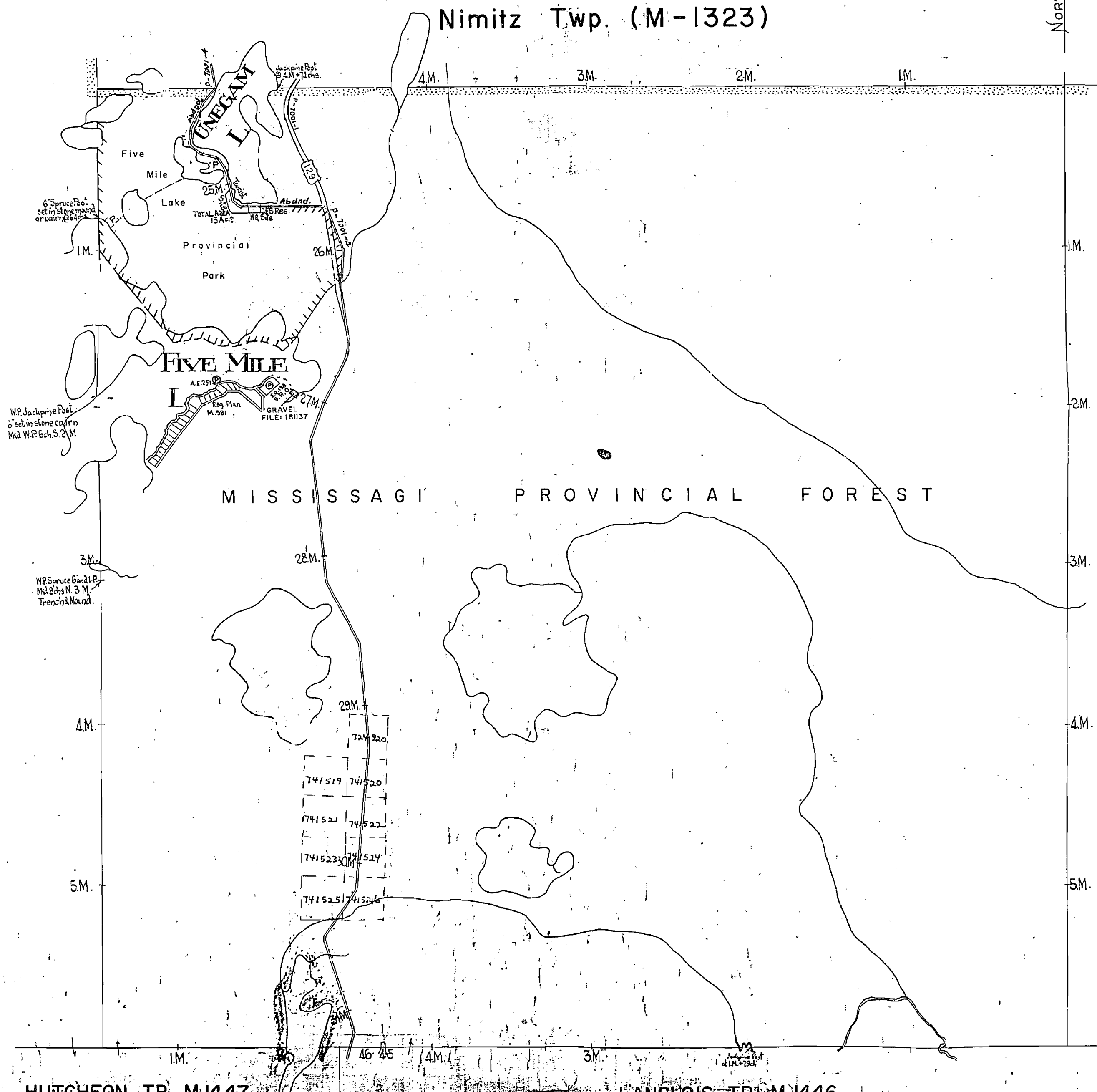

HUTCHEON TP. M.1447

LANGLOIS TP. M.1446

NORTH EAST and SOUTH BOUNDARIES RUN BY: MCAUSLAN, ANDERSON & MOORE ULS 1923
WEST BOUNDARY RUN BY: C.V. GALLAGHER ULS 1923
CHAPLEAU-IRON BRIDGE HIGHWAY FROM DEPT. HIGHWAYS PLAN 1932
NORTHERLY BOUNDARY OF THE MISSISSAGI PROVINCIAL FOREST SHOWN IN US
400' SURFACE ELEVATION AROUND ALL LAKES & RIVERS

1452

TWP. 11.D.

Raney
m-1452

MISSISSAGI PROVINCIAL FOREST
SUDBURY MINING DIVISION
DISTRICT OF ALGOMA
Scale - 40 Chains = 1 inch.

SUDBURY
RECEIVED
JUL 15 1970
A.M. 7,8,9,10,11,12,3,4,5,6 P.M.

Twp 25.

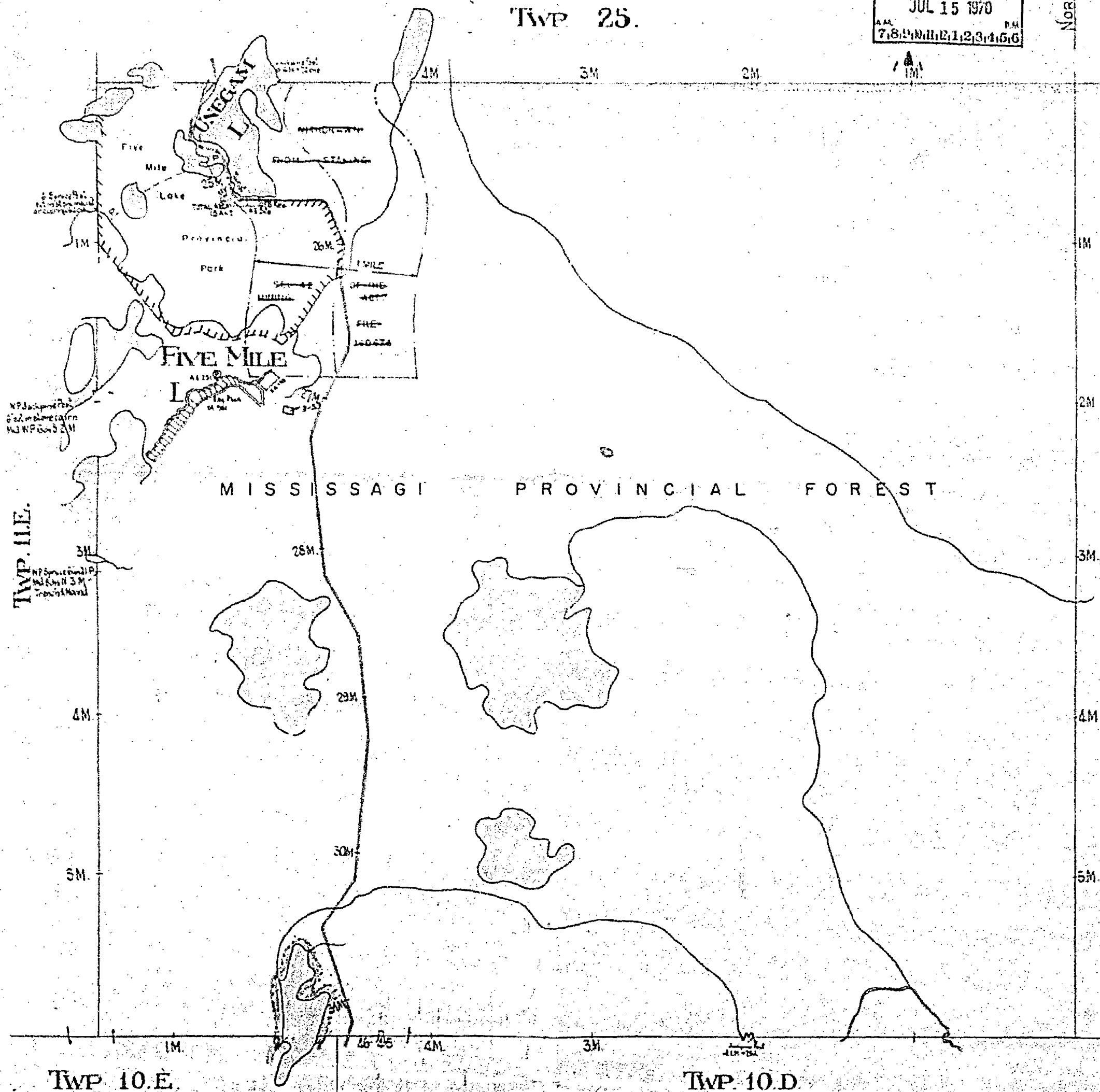

NORTH EAST and SOUTH BOUNDARIES RUN BY McCAUSLAN, ANDERSON & MOORE: OLS 1923.
WEST BOUNDARY RUN BY C.V. GALLAGHER: OLS 1923.
CHAPLEAU - IRON BRIDGE HIGHWAY FROM DEPT. HIGHWAYS PLAN 1932.
NORTHERLY BOUNDARY OF THE MISSISSAGI PROVINCIAL FOREST SHOWN THUS
400' SURFACE RIGHTS RESERVATION AROUND ALL LAKES & RIVERS.

MISSISSAGI PROVINCIAL FOREST

1452

TWP. 11.D. m-1452

MISSISSAGI PROVINCIAL FOREST
SAULT STE MARIE MINING DIVISION

DISTRICT OF ALGOMA

Scale:- 40 Chains = 1 inch.

Twp. 25.

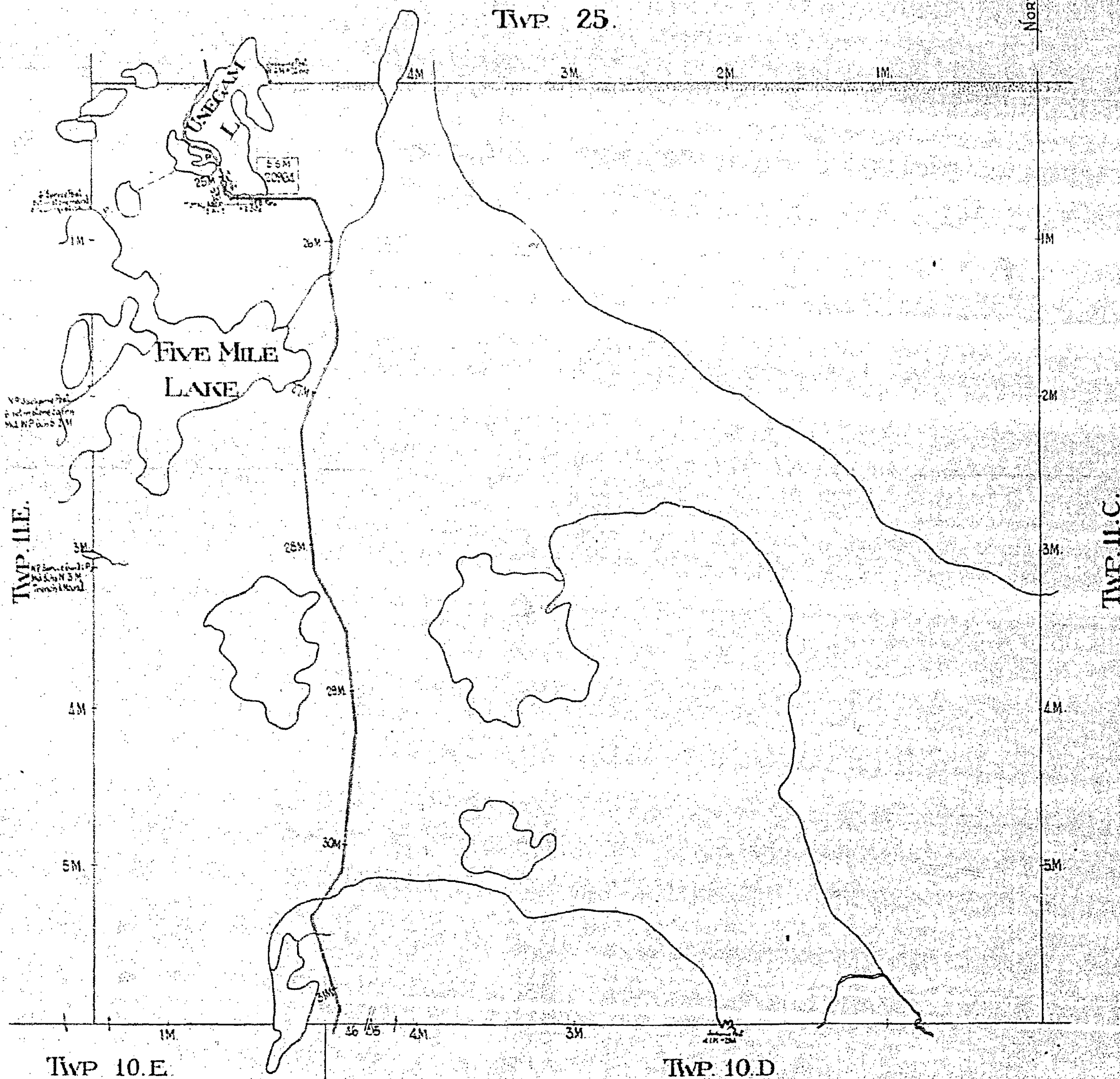

NORTH EAST and SOUTH BOUNDARIES RUN BY McFARLAN, ANDERSON & MOORE OLS 1923.

WEST BOUNDARY RUN BY C.V. Gallagher OLS 1923.

CHAPLEAU - IRON BRIDGE HIGHWAY FROM DEPT. HIGHWAYS PLAN 1932

NORTHERLY BOUNDARY OF THE MISSISSAGI PROVINCIAL FOREST. SHOWN THIS

1452

TWP. 11.D.

Raney
m-1452

MISSISSAGI PROVINCIAL FOREST

SUDBURY

MINING DIVISION

DISTRICT OF ALGOMA

Scale:- 40 Chains = 1 inch.

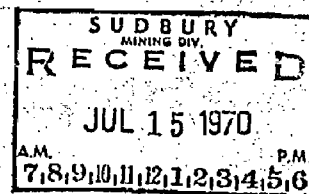

Twp 25.

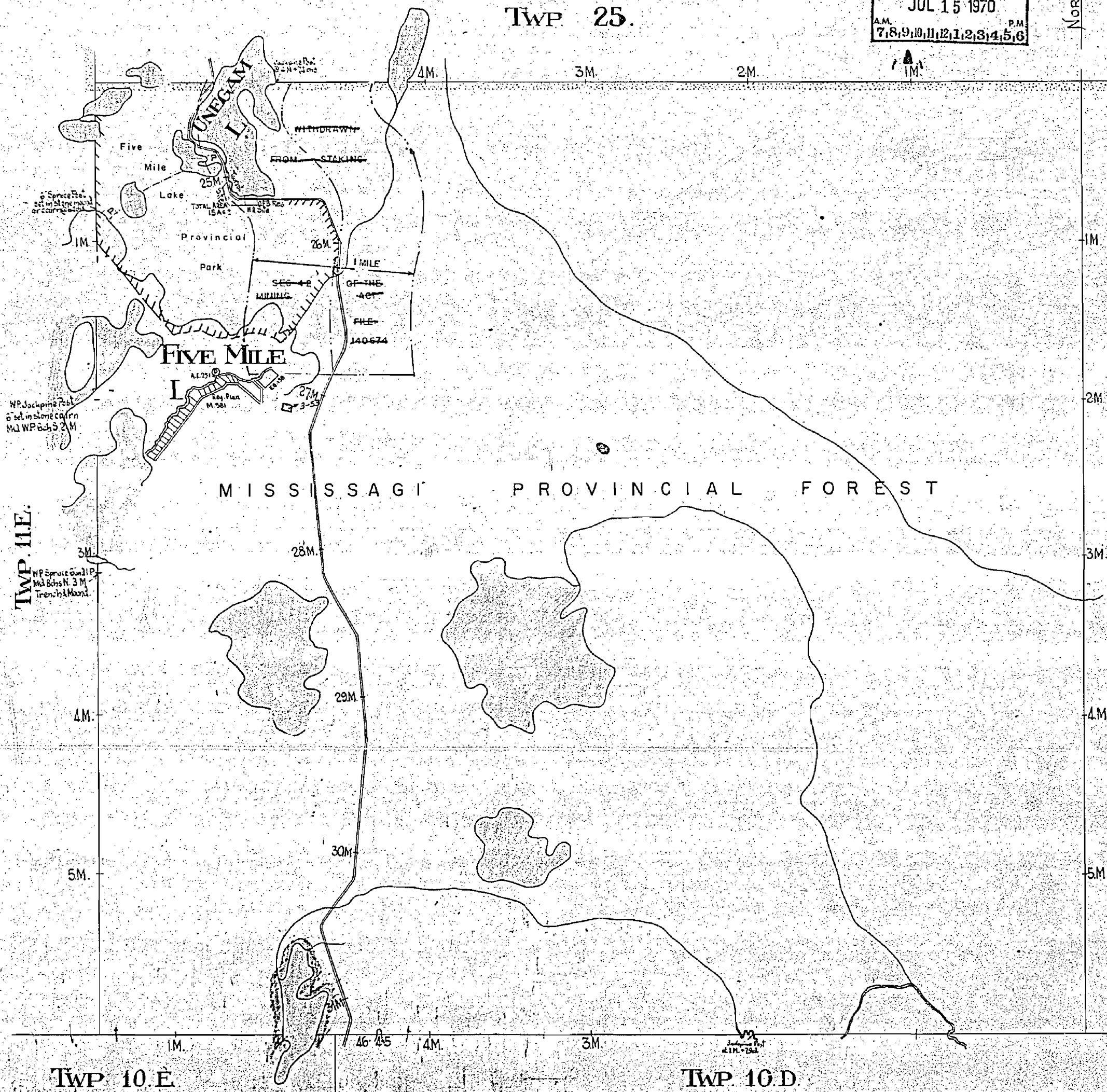

NORTH EAST and SOUTH BOUNDARIES RUN BY McCAUSLAN, ANDERSON & MOORE 01511923

WEST BOUNDARY RUN BY C.V. GALLAGHER 01511923

CHAPLEAU - IRON BRIDGE HIGHWAY FROM DEPT. HIGHWAYS PLAN 1932

NORTHERLY BOUNDARY OF THE MISSISSAGI PROVINCIAL FOREST SHOWN THUS

400' SURFACE RIGHTS RESERVATION AROUND ALL LAKES & RIVERS

TOWNSHIP 11.D MISSISSAGI M.D.

1452

TWP. 11.D.

Reaney
m-1452

MISSISSAGI PROVINCIAL FOREST
SUDBURY MINING DIVISION
DISTRICT OF ALGOMA
Scale - 40 Chains = 1 inch.

SUDBURY
RECEIVED
JUL 15 1970
A.M. 7,8,9,10,11,12,1,2,3,4,5,6 P.M.

NORTH AST.

TWP. 25.

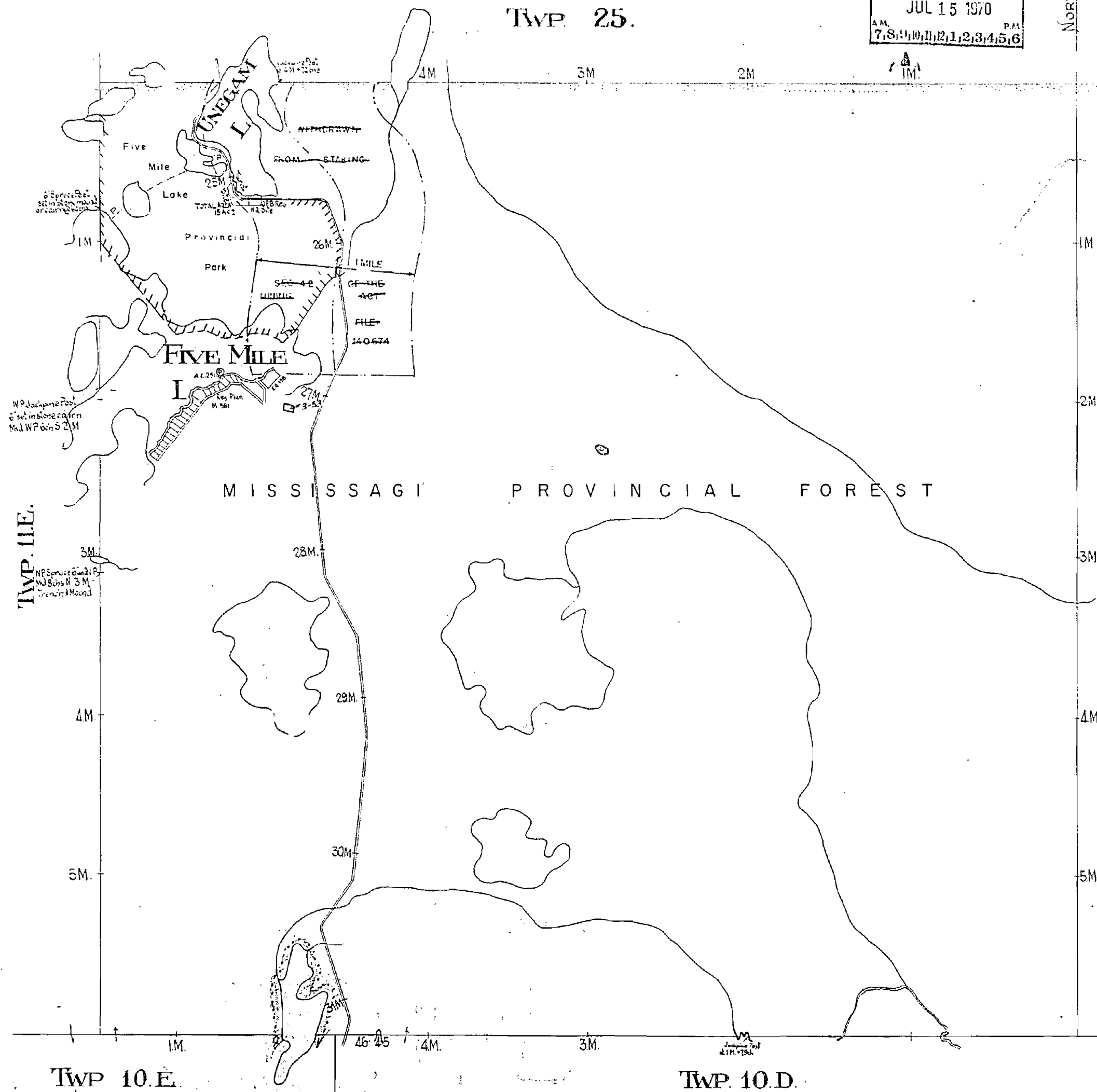

NORTH EAST and SOUTH BOUNDARIES RUN BY McAUSLAN, ANDERSON & MOORE OLS 11923.
WEST BOUNDARY RUN BY C.V. GALLAGHER OLS 1923.
CHAPLEAU - IRON BRIDGE HIGHWAY FROM DEPT. HIGHWAYS PLAN 1932.
NORTHERLY BOUNDARY OF THE MISSISSAGI PROVINCIAL FOREST SHOWN THUS
400' SURFACE RIGHTS RESERVATION AROUND ALL LAKES & RIVERS.

TOWNSHIP 11 D M 1452

1452

MISSISSAGI FOREST RESERVE

TWP. 11.D.

m-1452

DISTRICT OF SUDBURY

Scale 40 Chains = 1 Inch

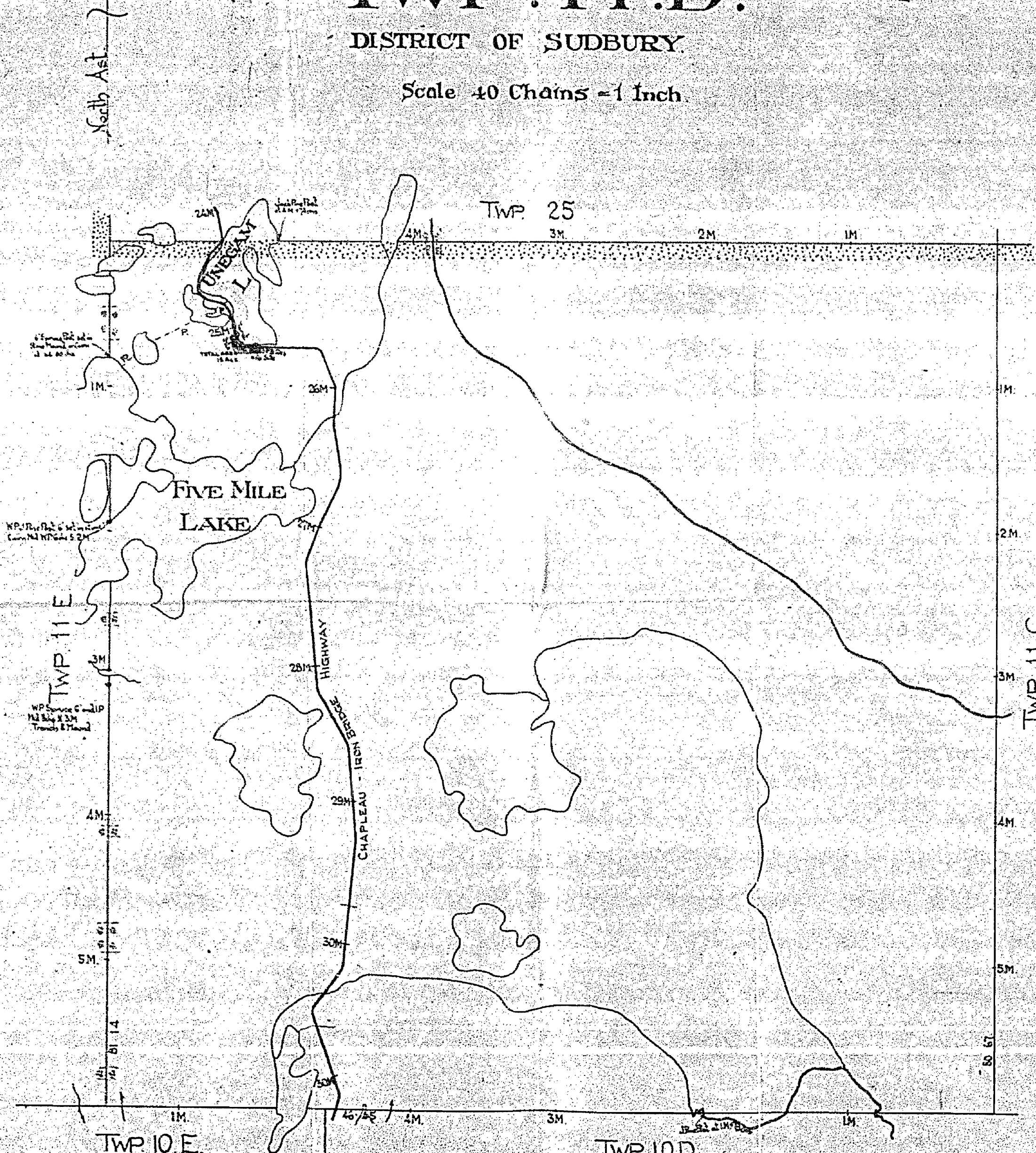

North, East and South Boundaries Run by McAuslan, Anderson & Moore O.L.S. 1923
West Boundary Run by C.V. Gallagher O.L.S. 1923

CHAPLEAU-IRISH BRIDGE HIGHWAY FROM DEPT. OF HGR. DEV. PLAN 1932

NORTHERLY BOUNDARY OF THE MISSISSAGI PROVINCIAL FOREST SHOWN TRUS

DEPARTMENT OF SURVEYS
PARLIAMENT BUILDINGS
TORONTO ONTARIO CANADA

Received 1935

1452

TWP. 11.D.

m-1452

MISSISSAGI PROVINCIAL FOREST
SAULT STE MARIE MINING DIVISION

DISTRICT OF ALGOMA

Scale:- 40 Chains = 1 Inch.

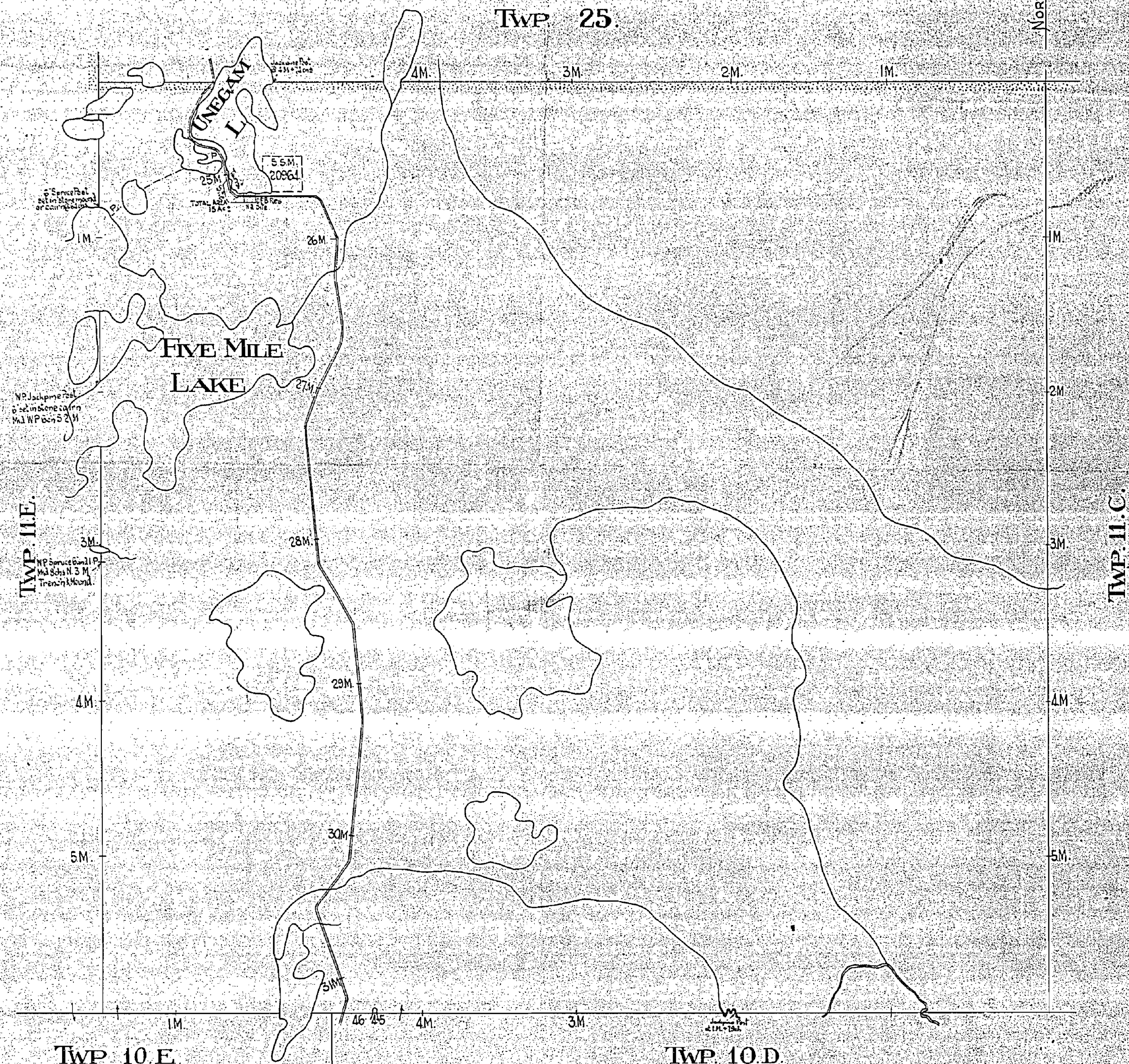

NORTH EAST and SOUTH BOUNDARIES RUN BY McAUSLAN, ANDERSON & MOORE OLS 1923.

WEST BOUNDARY RUN BY C.V. GALLAGHER OLS 1923.

CHAPLEAU - IRON BRIDGE HIGHWAY FROM DEPT. HIGHWAYS PLAN 1932

NORTHERLY BOUNDARY OF THE MISSISSAGI PROVINCIAL FOREST SHOWN THUS

1452

MISSISSAGI FOREST RESERVE
TWP. 11.D.
 DISTRICT OF SUDBURY

m-1452

Scale 40 Chains = 1 Inch

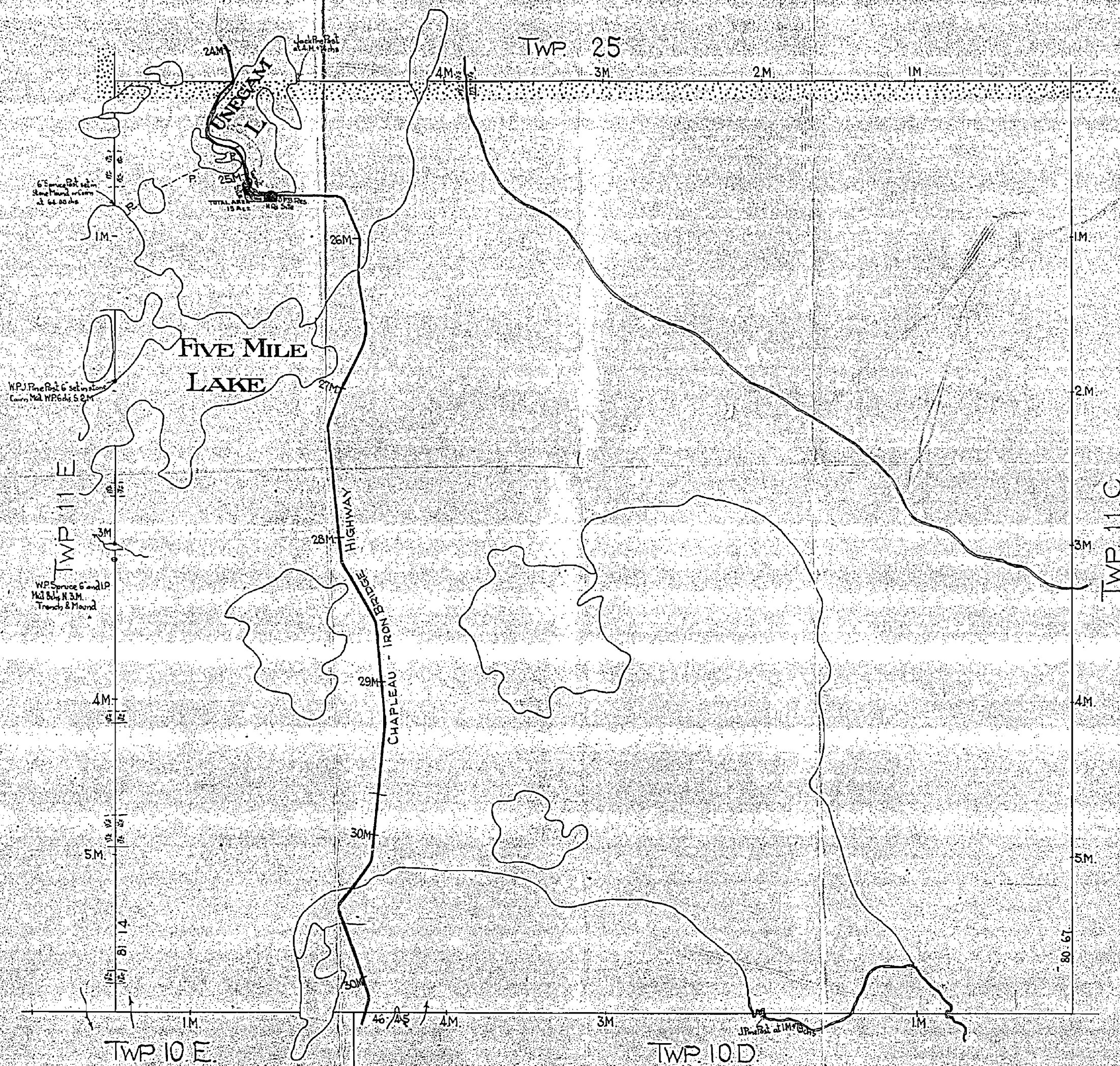

North East and South Boundaries Run by McAuslan, Anderson & Moore O.L.S. 1923
 West Boundary Run by CV Gallagher O.L.S. 1923
 CHAPLEAU-IRON BRIDGE HIGHWAY FROM DEPT. OF NOR. DEV. PLAN 1932
 NORTHERLY BOUNDARY OF THE MISSISSAGI PROVINCIAL FOREST SHOWN THUS

DEPARTMENT OF SURVEYS
 PARLIAMENT BUILDINGS
 TORONTO, ONTARIO, CANADA

Received 1935

1452

MISSISSAGI FOREST RESERVE

TWP. 11.D.

DISTRICT OF SUDBURY

Scale 40 Chains = 1 Inch

m-1452

North Ast.

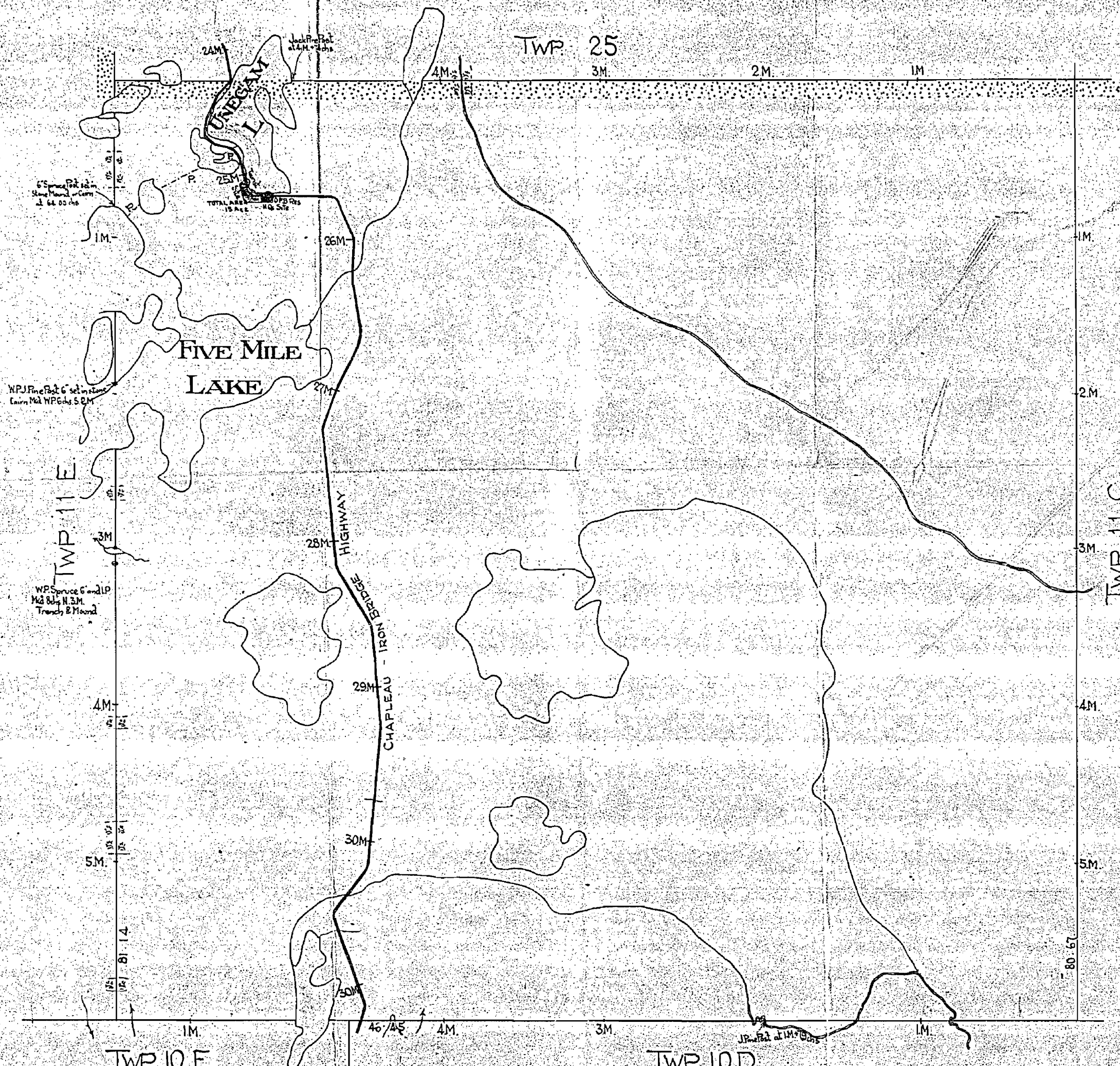

North, East and South Boundaries Run by McAuslan, Anderson & Moore O.L.S. 1923
West Boundary Run by C.V. Gallagher O.L.S. 1923
CHAPLEAU-IRON BRIDGE HIGHWAY FROM DEPT OF NOR. DEV. PLAN 1932
NORTHERLY BOUNDARY OF THE MISSISSAGI PROVINCIAL FOREST SHOWN THUS

DEPARTMENT OF SURVEYS
PARLIAMENT BUILDINGS
TORONTO ONTARIO CANADA
Received 1935

1452

TWP. 11.D.

m-1452

MISSISSAGI PROVINCIAL FOREST
SAULT STE MARIE MINING DIVISION

DISTRICT OF ALGOMA

Scale:- 40 Chains = 1 Inch.

TWP 25.

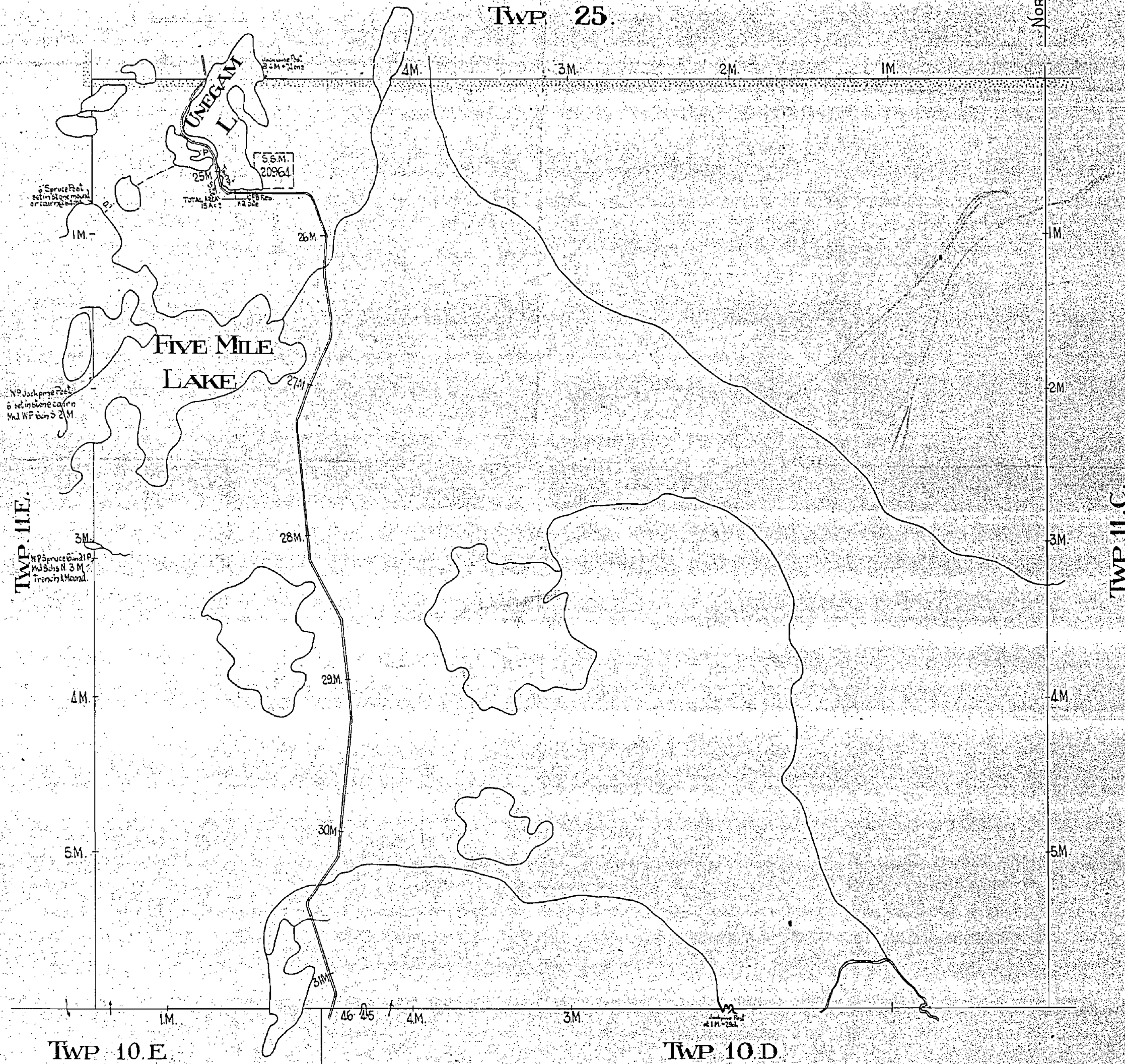

NORTH, EAST and SOUTH BOUNDARIES RUN BY McAUSLAN, ANDERSON & MOORE OLS 1923.

WEST BOUNDARY RUN BY C.V. GALLAGHER OLS 1923.

CHAPLEAU - IRON BRIDGE HIGHWAY FROM DEPT. HIGHWAYS PLAN 1932

NORTHERLY BOUNDARY OF THE MISSISSAGI PROVINCIAL FOREST SHOWN THUS

1452

TWP. 11.D.

m-1452

MISSISSAGI PROVINCIAL FOREST
SAULT STE MARIE MINING DIVISION

DISTRICT OF ALGOMA

Scale - 40 Chains - 1 inch

TWP. 25.

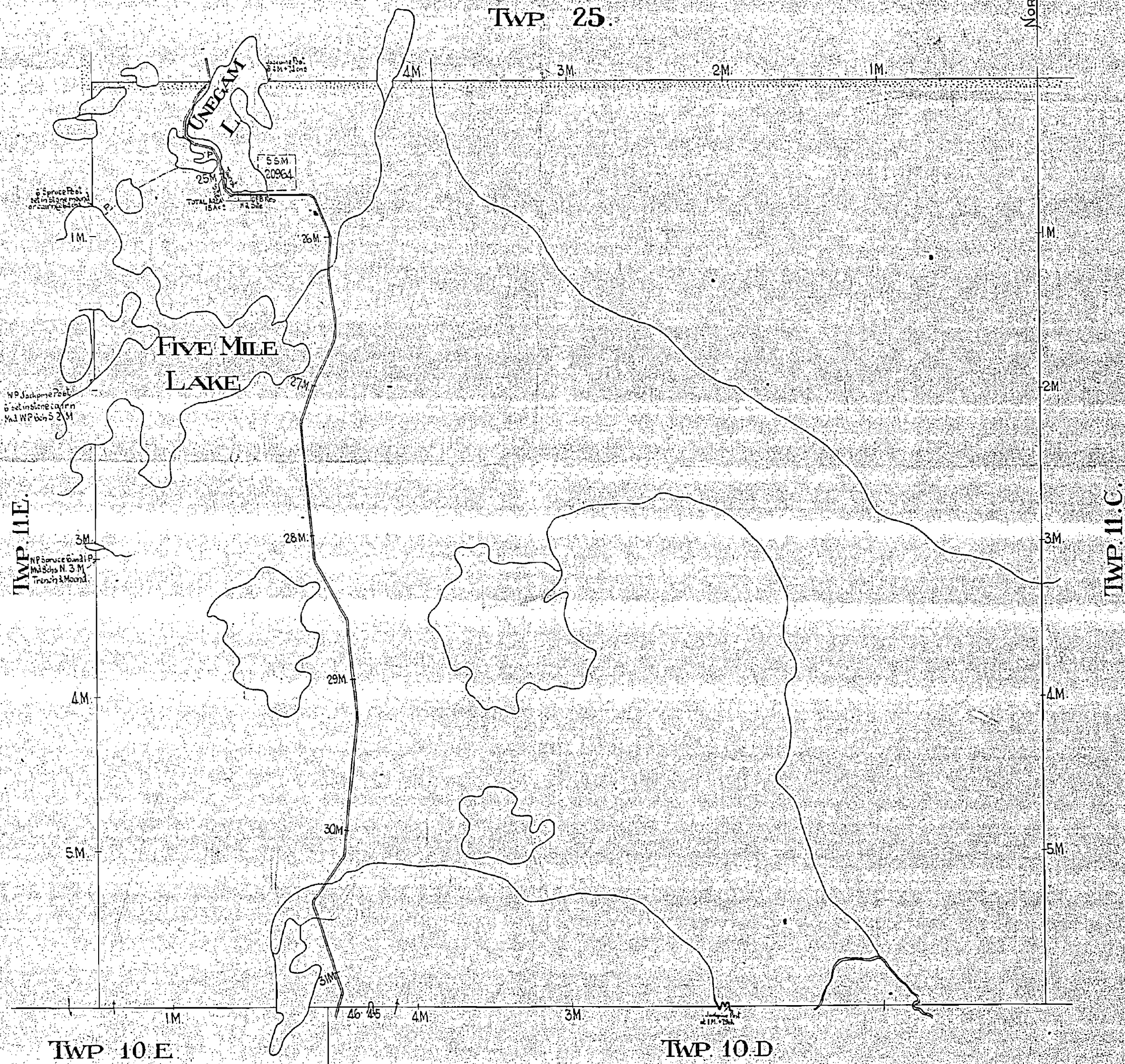

NORTH EAST and SOUTH BOUNDARIES RUN BY McAuslan, Anderson & Moore OLS 1923

WEST BOUNDARY RUN BY C.V. Gallagher OLS 1923

CHAPLEAU - IRON BRIDGE HIGHWAY FROM DEPT. HIGHWAYS PLAN 1932

NORTHERLY BOUNDARY OF THE MISSISSAGI PROVINCIAL FOREST SHOWN WITHUS

1452

MISSISSAGI FOREST RESERVE

TWP. 11.D.

m-1452

DISTRICT OF SUDBURY

Scale 40 Chains = 1 Inch

North Ast

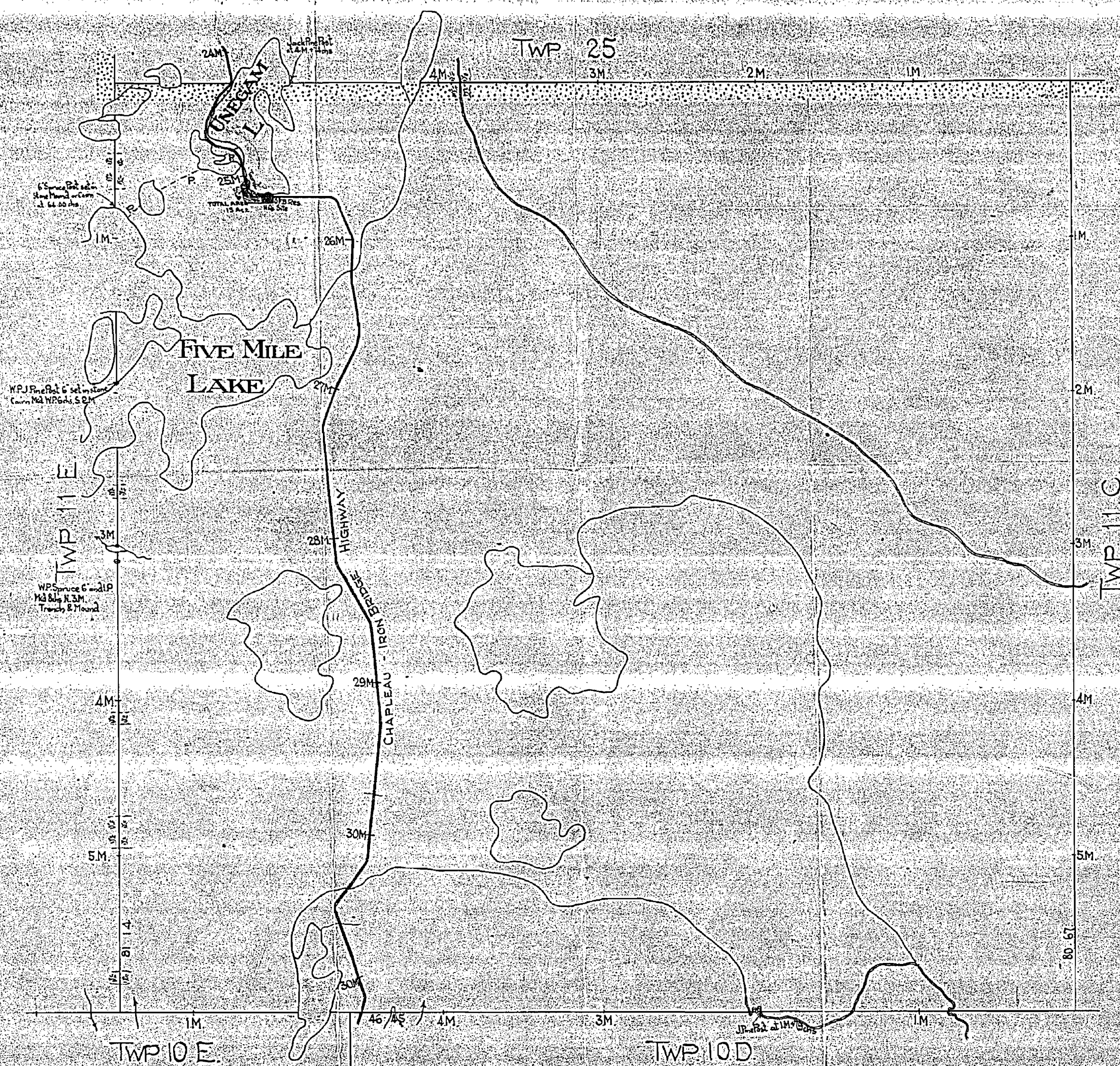

North East and South Boundaries Run by McAuslan, Anderson & Moore O.L.S. 1923
West Boundary Run by C.V. Gallagher O.L.S. 1923
CHAPLEAU-IRON BRIDGE HIGHWAY FROM DEPT. OF NOR. DEV. PLAN 1932
NORTHERLY BOUNDARY OF THE MISSISSAGI PROVINCIAL FOREST SHOWN THUS

DEPARTMENT OF SURVEYS
PARLIAMENT BUILDINGS
TORONTO ONTARIO CANADA

Received 1935