

SAMPSON G.2819

PLAN OF

TWP. 26. R 21

SAULT STE. MARIE MINING DIVISION.

DISTRICT OF ALGOMA.

— Scale: 40 chains to an inch —

TWP. 26. R. 22.

DATE OF ISSUE
 OCT 21 1958
 SAULT STE. MARIE
 MINING DIVISION'S OFFICE

Part of this Twp. is covered W.
 by Q.P. # 8399 - ABITIBI PAPER COMPANY
 LTD. (See file for details 1977-78)

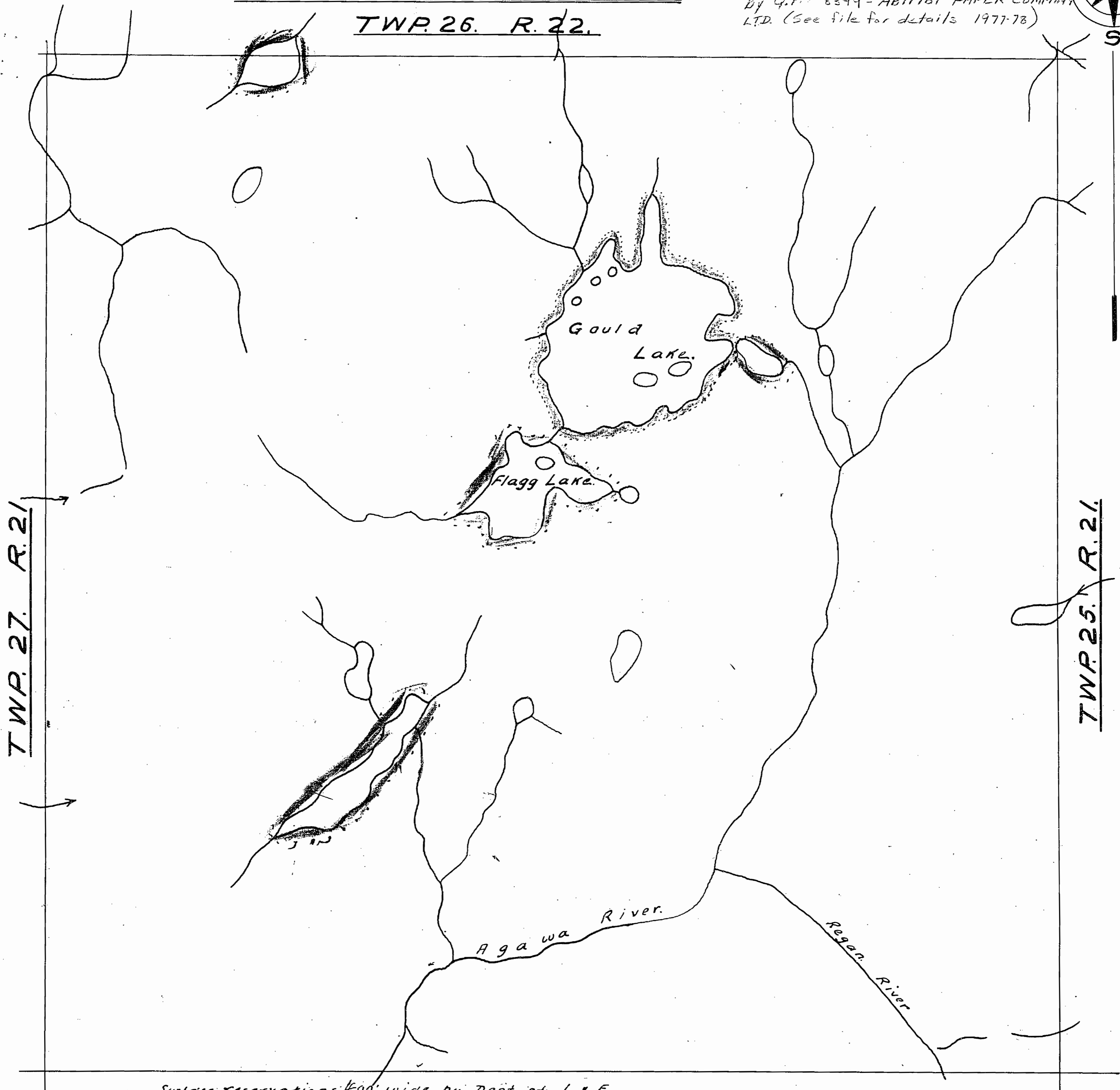
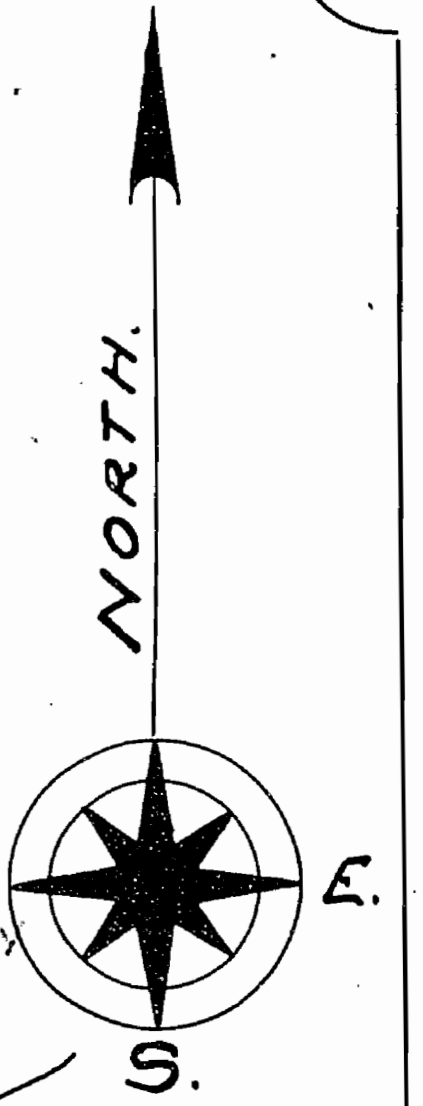

Surface reservations 400' wide by Dept. of L & F
 shown hereon thus

Replaced by mylar Oct. 27/83

TWP. 26 S. R. 21 W. 12 E.

TOWNSHIP OF

G.2819 ~~M.1512~~

ONTARIO

MINISTRY OF NATURAL RESOURCES

SURVEYS AND MAPPING BRANCH

SAMPSON

(TP.26 R.21)

SAULT STE. MARIE MINING DIVISION.

DISTRICT OF ALGOMA.

— Scale: 40 chains to an inch —

PAWIS TP. M.1513

SAULT STE. MARIE
MINING DIV.
RECEIVED
OCT 27 1983
A.M. 7:00 8:00 9:00 10:00 11:00 12:00 1:00 2:00 3:00 4:00 P.M.

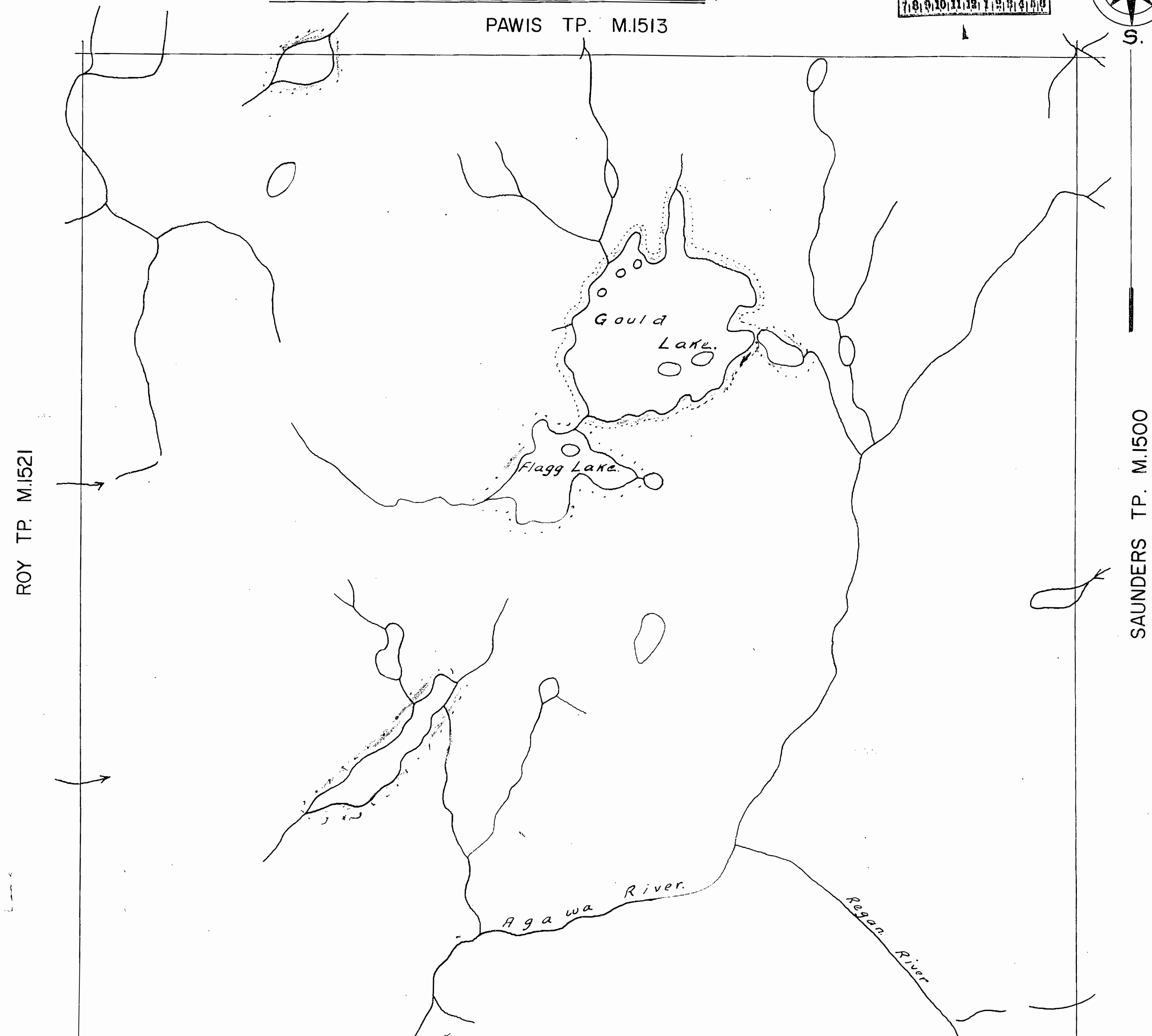
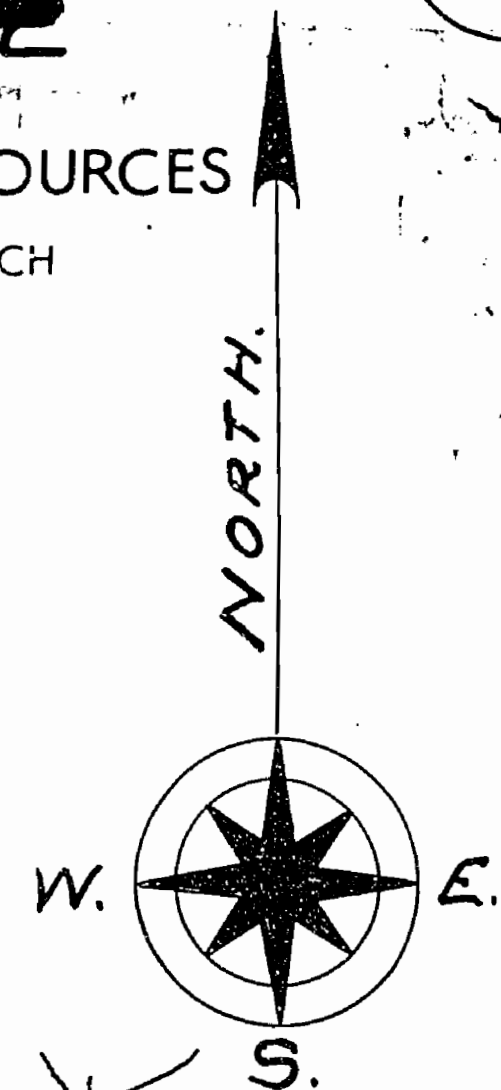

ROY TP. M.1521

SAUNDERS TP. M.1500

400' SURFACE RIGHTS RESERVATION AROUND ALL LAKES & RIVERS.

Replaced by G.2819 - Jan 26/85 ml

M.2.2 TWP. 26 R. 21

REFERENCES

AREAS WITHDRAWN FROM DISPOSITION

- M.R.O. - MINING RIGHTS ONLY
- S.R.O. - SURFACE RIGHTS ONLY
- M.+S. - MINING AND SURFACE RIGHTS

Description	Order No.	Date	Disposition	File

The 1985 Magnetic Bearing
 Approx. 4° 30' W. Annual Change
 Increasing 10'

THE INFORMATION THAT APPEARS ON THIS MAP HAS BEEN COMPILED FROM VARIOUS SOURCES, AND ACCURACY IS NOT GUARANTEED. THOSE WISHING TO STAKE MINING CLAIMS SHOULD CONSULT WITH THE MINING RECORDER, MINISTRY OF NORTHERN DEVELOPMENT AND MINES, FOR ADDITIONAL INFORMATION ON THE STATUS OF THE LANDS SHOWN HEREON.

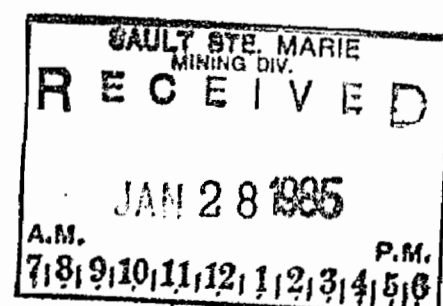

PAWIS TWP.

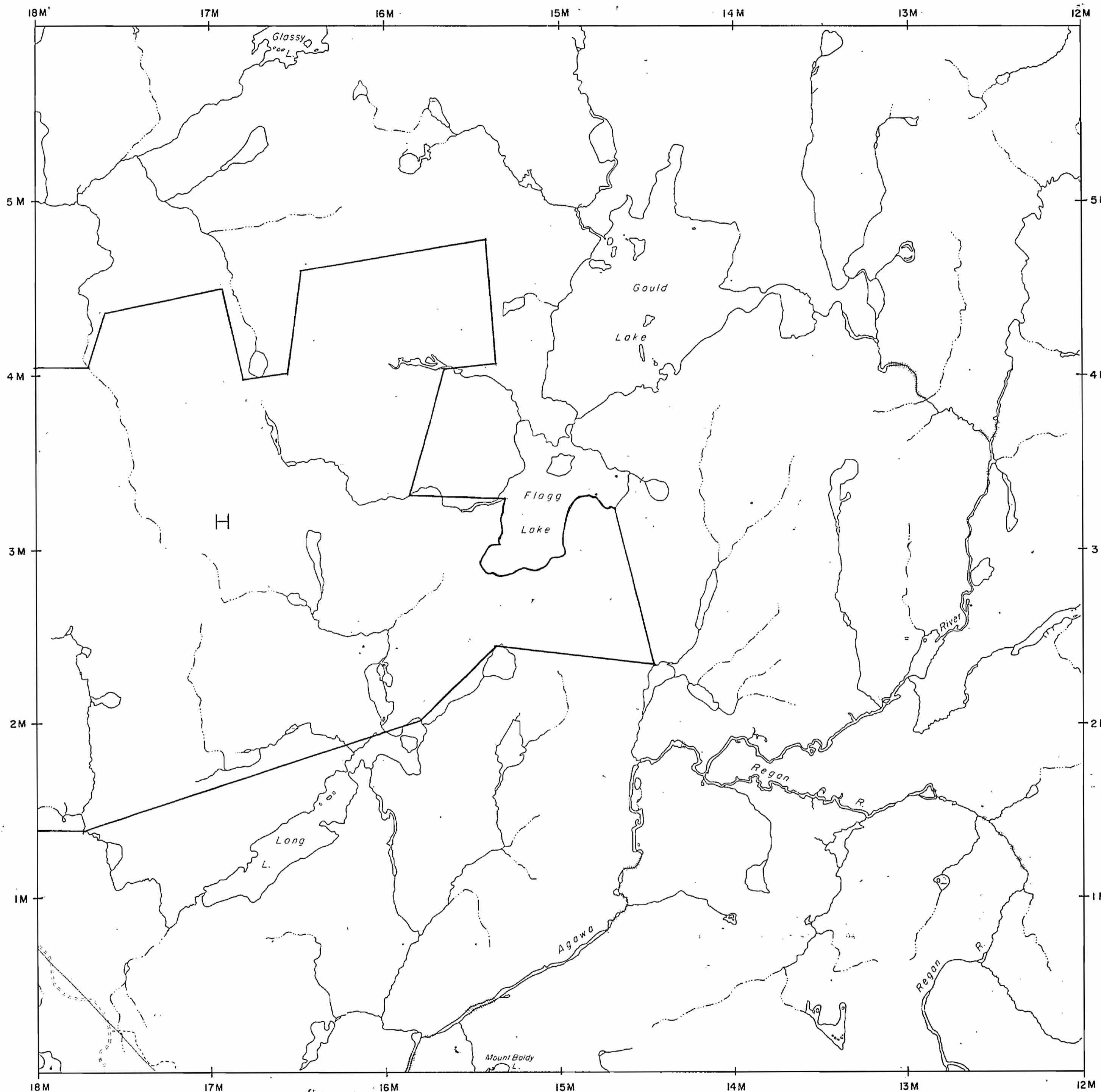

TABOBONDUNG TWP.

LEGEND

- HIGHWAY AND ROUTE No.
- OTHER ROADS
- TRAILS
- SURVEYED LINES:
 - TOWNSHIPS, BASE LINES, ETC.
 - LOTS, MINING CLAIMS, PARCELS, ETC.
- UNSURVEYED LINES:
 - LOT LINES
 - PARCEL BOUNDARY
 - MINING CLAIMS ETC.
- RAILWAY AND RIGHT OF WAY
- UTILITY LINES
- NON-PERENNIAL STREAM
- FLOODING OR FLOODING RIGHTS
- SUBDIVISION OR COMPOSITE PLAN
- RESERVATIONS
- ORIGINAL SHORELINE
- MARSH OR MUSKEG
- MINES
- TRAVERSE MONUMENT

DISPOSITION OF CROWN LANDS

TYPE OF DOCUMENT	SYMBOL
PATENT, SURFACE & MINING RIGHTS	
" SURFACE RIGHTS ONLY	
" MINING RIGHTS ONLY	
LEASE, SURFACE & MINING RIGHTS	
" SURFACE RIGHTS ONLY	
" MINING RIGHTS ONLY	
LICENCE OF OCCUPANCY	
ORDER-IN-COUNCIL	
RESERVATION	
CANCELLED	
SAND & GRAVEL	

NOTE: MINING RIGHTS IN PARCELS PATENTED PRIOR TO MAY 6, 1913, VESTED IN ORIGINAL PATENTEE BY THE PUBLIC LANDS ACT, R.S.O. 1970, CHAP. 380, SEC. 63, SUBSEC 1.

SCALE: 1 INCH = 40 CHAINS

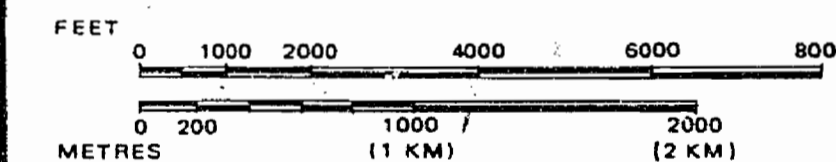

H - TIMBER HARVESTING AREA

TOWNSHIP

SAMPSON

M.N.R. ADMINISTRATIVE DISTRICT

WAWA

MINING DIVISION

SAULT STE. MARIE

LAND TITLES / REGISTRY DIVISION

ALGOMA



Ministry of Natural Resources
 Land Management Branch

Date OCTOBER 1984

Number

G-2819