

# NOTES

400' surface rights reservation along the shores of all lakes and rivers.

The subdivision of the south part of Sargeant TP. by A.Bell(O.L.S.) as shown on plan dated Oct.3,1912 signed by N.J.Slater(O.L.S.) has been wholly annulled under sec'n II subsec'n I of the Public Lands Act. Jan.4,1963

HEPBURN TP. M.500

NORTHEAST BAY (Lake Abitibi) M.421

TP. OF BONIS  
TP. OF BERRY

OKIKODOSIK BAY (Lake Abitibi) M.583

PROVINCE OF QUEBEC

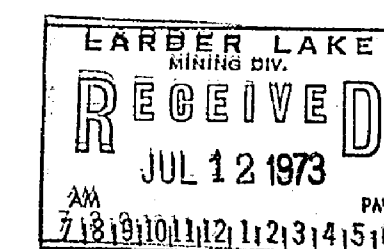

## LEGEND

HIGHWAY AND ROUTE No.	
OTHER ROADS	
TRAILS	
SURVEYED LINES:	
TOWNSHIPS, BASE LINES, ETC.	
LOTS, MINING CLAIMS, PARCELS, ETC.	
UNSURVEYED LINES:	
LOT LINES	
PARCEL BOUNDARY	
MINING CLAIMS ETC.	
RAILWAY AND RIGHT OF WAY	
UTILITY LINES	
NON-PERENNIAL STREAM	
FLOODING OR FLOODING RIGHTS	
SUBDIVISION	
ORIGINAL SHORELINE	
MARSH OR MUSKEG	
MINES	

## DISPOSITION OF CROWN LANDS

TYPE OF DOCUMENT	SYMBOL
PATENT, SURFACE & MINING RIGHTS	
" SURFACE RIGHTS ONLY	
" MINING RIGHTS ONLY	
LEASE, SURFACE & MINING RIGHTS	
" SURFACE RIGHTS ONLY	
" MINING RIGHTS ONLY	
LICENCE OF OCCUPATION	
CROWN LAND SALE	
ORDER-IN-COUNCIL	
RESERVATION	
CANCELLED	
SAND & GRAVEL	

SCALE: 1 INCH = 40 CHAINS

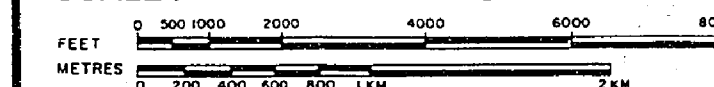

ACRES HECTARES



TOWNSHIP

**SARGEANT**

DISTRICT

**COCHRANE**

MINING DIVISION

**LARDE LAKE**

#3

Ministry of Natural Resources  
Ontario Surveys and Mapping Branch

Date MAY, 1973 Plan No.

WHITNEY BLOCK QUEEN'S PARK, TORONTO

**M.582**

Revised by 26/80

NOTES

400' surface rights reservation along the shores of all lakes and rivers.

The subdivision of the south part of Sargeant TP by A.Bell(OLS) as shown on plan dated Oct.3,1912 signed by N.J.Slater(OLS.) has been wholly annulled under sec'n II subsec'n I of the Public Lands Act. Jan.4,1963

NORTHEAST BAY (Lake Abitibi)

TP OF BONIS  
TP OF BERRY

OKIKODOSIK BAY (Lake Abitibi)

HEPBURN TP.

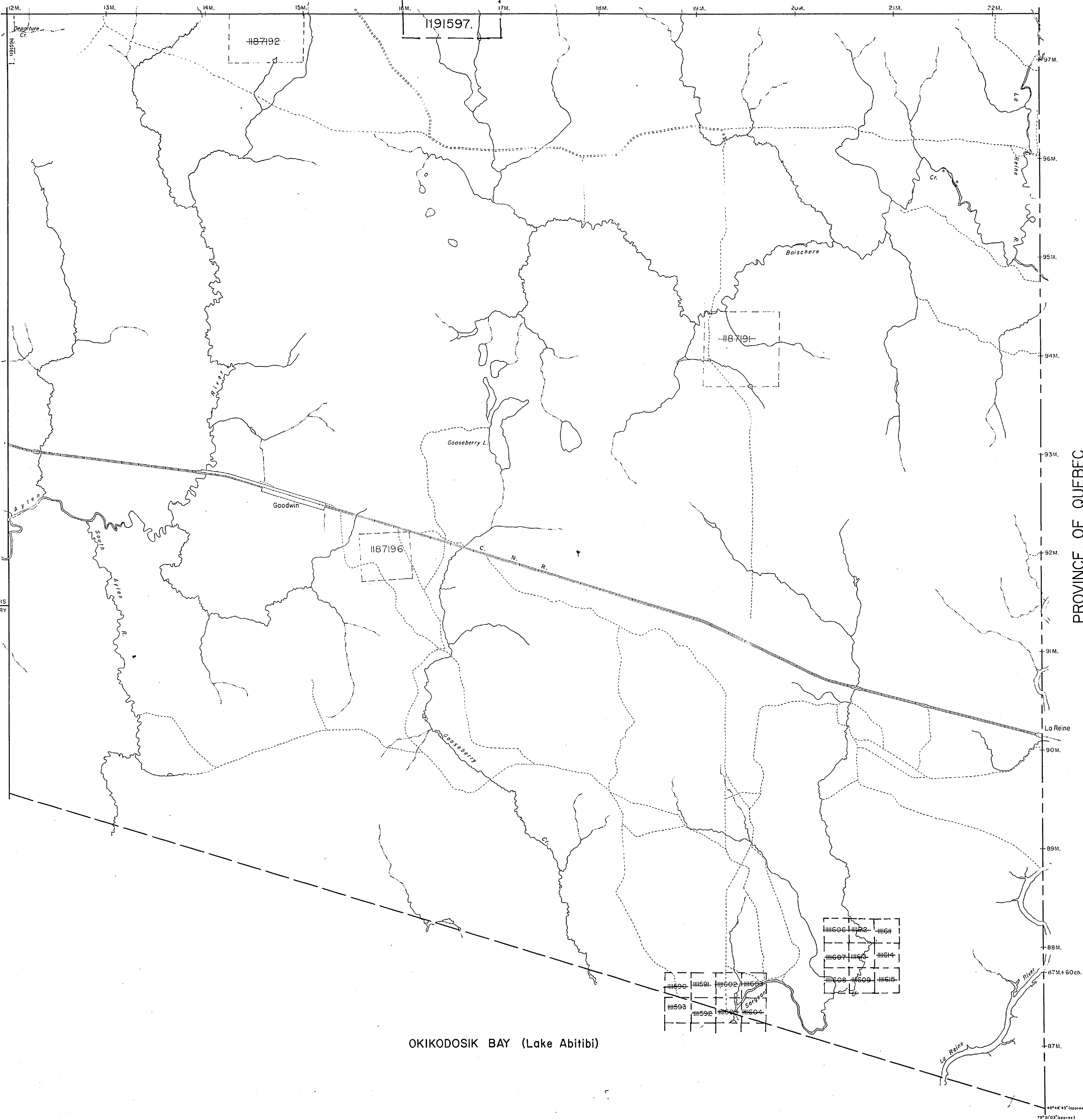

LEGEND

- HIGHWAY AND ROUTE No.
- OTHER ROADS
- TRAILS
- SURVEYED LINES:  
TOWNSHIPS, BASE LINES, ETC.
- LOTS, MINING CLAIMS, PARCELS, ETC.
- UNSURVEYED LINES:  
LOT LINES
- PARCEL BOUNDARY
- MINING CLAIMS ETC.
- RAILWAY AND RIGHT OF WAY
- UTILITY LINES
- PERENNIAL STREAM
- FLOODING OR FLOODING RIGHTS
- SUBDIVISION OR COMPOSITE PLAN
- RESERVATIONS
- ORIGINAL SHORELINE
- MARSH OR MUSKEG
- MINES
- TRAVERSE MONUMENT

DISPOSITION OF CROWN LANDS

TYPE OF DOCUMENT	SYMBOL
PATENT, SURFACE & MINING RIGHTS	
SURFACE RIGHTS ONLY	
MINING RIGHTS ONLY	
LEASE, SURFACE & MINING RIGHTS	
SURFACE RIGHTS ONLY	
MINING RIGHTS ONLY	
LICENCE OF OCCUPATION	
ORDER-IN COUNCIL	
RESERVATION	
CANCELLED	
SAND & GRAVEL	

SCALE 1 INCH = 40 CHAINS

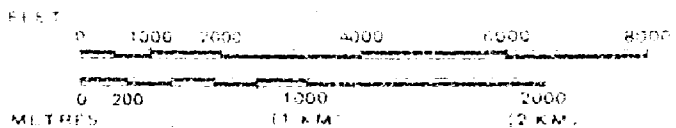

PROVINCE OF QUEBEC

TOWNSHIP

**SARGEANT**

M.N.R. ADMINISTRATIVE DISTRICT  
COCHRANE

MINING DIVISION  
LARDER LAKE

LAND TITLES / REGISTRY DIVISION  
COCHRANE

Ministry of Natural Resources  
Ministry of Northern Development and Mines

Date MAY, 1973

Number

**G-3565**

THE IN  
APPEAR  
HAS E  
FROM  
AND A  
GUARAN  
WISHIN  
ING CL  
SULT V  
RECOR  
NORT  
MENT  
DITION  
ON TH  
LANDS

THE INFORMATION THAT APPEARS ON THIS MAP HAS BEEN COMPILED FROM VARIOUS SOURCES, AND ACCURACY IS NOT GUARANTEED. THOSE WISHING TO STAKE MINING CLAIMS SHOULD CONSULT WITH THE MINING RECORDER, MINISTRY OF NORTHERN DEVELOPMENT AND MINES, FOR ADDITIONAL INFORMATION ON THE STATUS OF THE LANDS SHOWN HEREON.

## LEGEND

HIGHWAY AND ROUTE No.	
OTHER ROADS	
TRAILS	
SURVEYED LINES:	
TOWNSHIPS, BASE LINES, ETC.	
LOTS, MINING CLAIMS, PARCELS, ETC.	
UNSURVEYED LINES:	
LOT LINES	
PARCEL BOUNDARY	
MINING CLAIMS ETC.	
RAILWAY AND RIGHT OF WAY	
UTILITY LINES	
NON-PERENNIAL STREAM	
FLOODING OR FLOODING RIGHTS	
SUBDIVISION OR COMPOSITE PLAN	
RESERVATIONS	
ORIGINAL SHORELINE	
MARSH OR MUSKEG	
MINES	
TRAVERSE MONUMENT	

## DISPOSITION OF CROWN LANDS

TYPE OF DOCUMENT	SYMBOL
PATENT, SURFACE & MINING RIGHTS	
" SURFACE RIGHTS ONLY	
" MINING RIGHTS ONLY	
LEASE, SURFACE & MINING RIGHTS	
" SURFACE RIGHTS ONLY	
" MINING RIGHTS ONLY	
LICENCE OF OCCUPATION	
ORDER-IN-COUNCIL	
RESERVATION	
CANCELLED	
SAND & GRAVEL	

SCALE: 1 INCH = 40 CHAINS

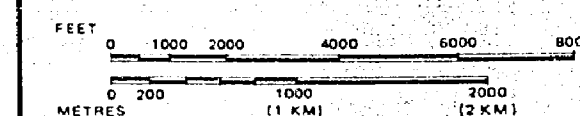

DATE OF ISSUE

APR 30 1998

PROVINCIAL RECORDING  
OFFICE - SUDBURY

TOWNSHIP

SARGEANT

M.N.R. ADMINISTRATIVE DISTRICT  
COCHRANEMINING DIVISION  
LARDER LAKELAND TITLES / REGISTRY DIVISION  
COCHRANEMinistry of  
Natural  
Resources  
OntarioMinistry of  
Northern Development  
and Mines

Date MAY, 1973

Number

G-3565

## NOTES

400' surface rights reservation along the shores of all lakes and rivers.

The subdivision of the south part of Sargeant TP. by A. Ball (O.L.S.) as shown on plan dated Oct. 3, 1912 signed by N. J. Slater (O.L.S.) has been wholly annulled under sec'n II subsec'n I of the Public Lands Act, Jan. 4, 1963.

NORTHEAST BAY (Lake Abitibi)

TP OF BONIS  
TP OF BERRY

HEPBURN TP.

OKIKODOSIK BAY (Lake Abitibi)

PROVINCE OF QUEBEC



50-2488V11-555

South of  
M. 583  
New Okikodasik R.

SARCEANT

BERRY

CON

OKIKODASIK BAY

ABITIBI LAKE

MINING RECORDER  
RECEIVED  
SWASTIKA - ONT.

Scale 40 Chains = 1 Inch.

W 283 SOUTH OF SARCEANT & BERRY



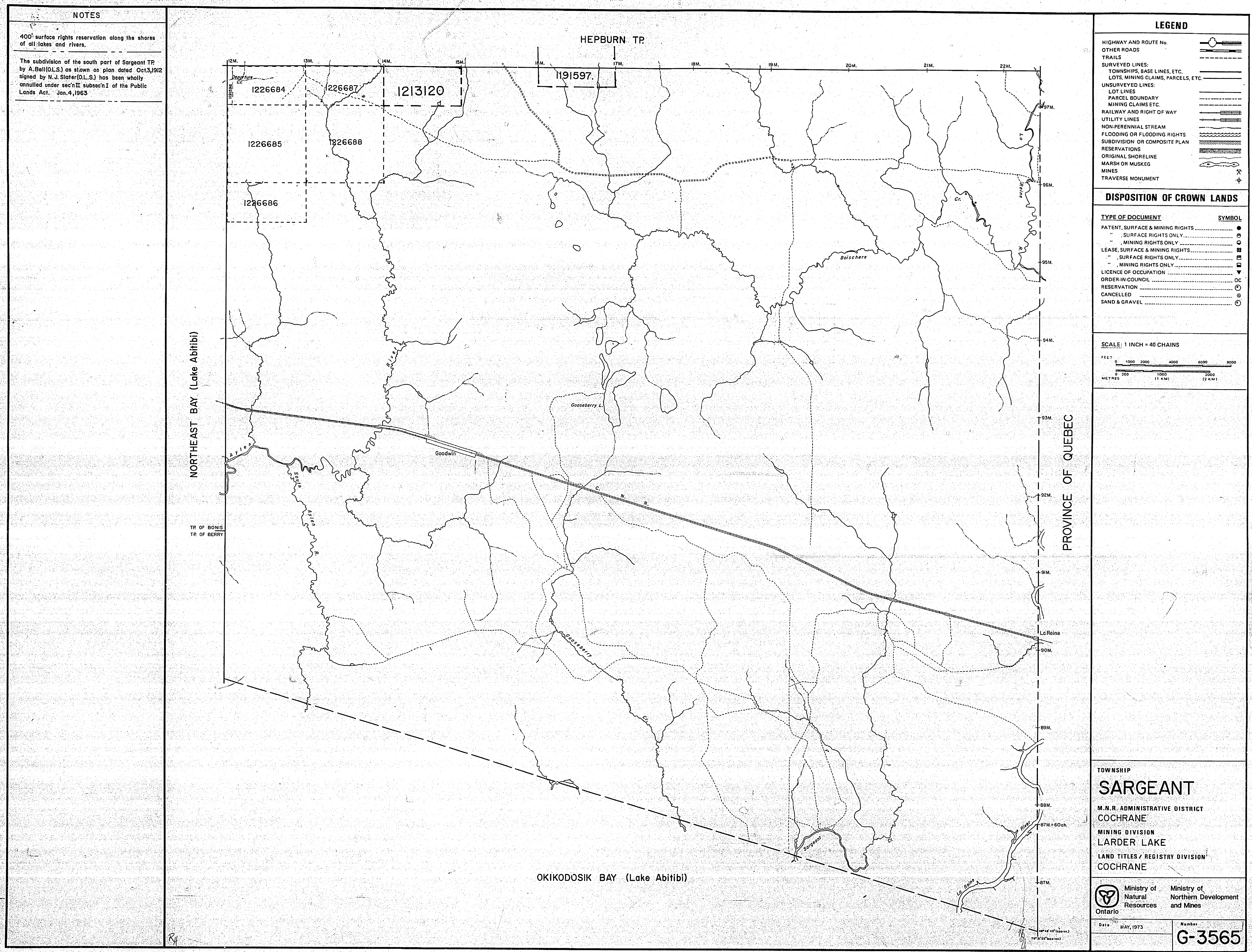

THE INFORMATION THAT APPEARS ON THIS MAP HAS BEEN COMPILED FROM VARIOUS SOURCES, AND ACCURACY IS NOT GUARANTEED. THOSE WISHING TO STAKE MINING CLAIMS SHOULD CONSULT WITH THE MINING RECORDER, MINISTRY OF NORTHERN DEVELOPMENT AND MINES, FOR ADDITIONAL INFORMATION ON THE STATUS OF THE LANDS SHOWN HEREON.



# SARGEANT

SCALE 40 CHAINS = 1 INCH

M-582

1102



NORTH

PROVINCE OF QUEBEC

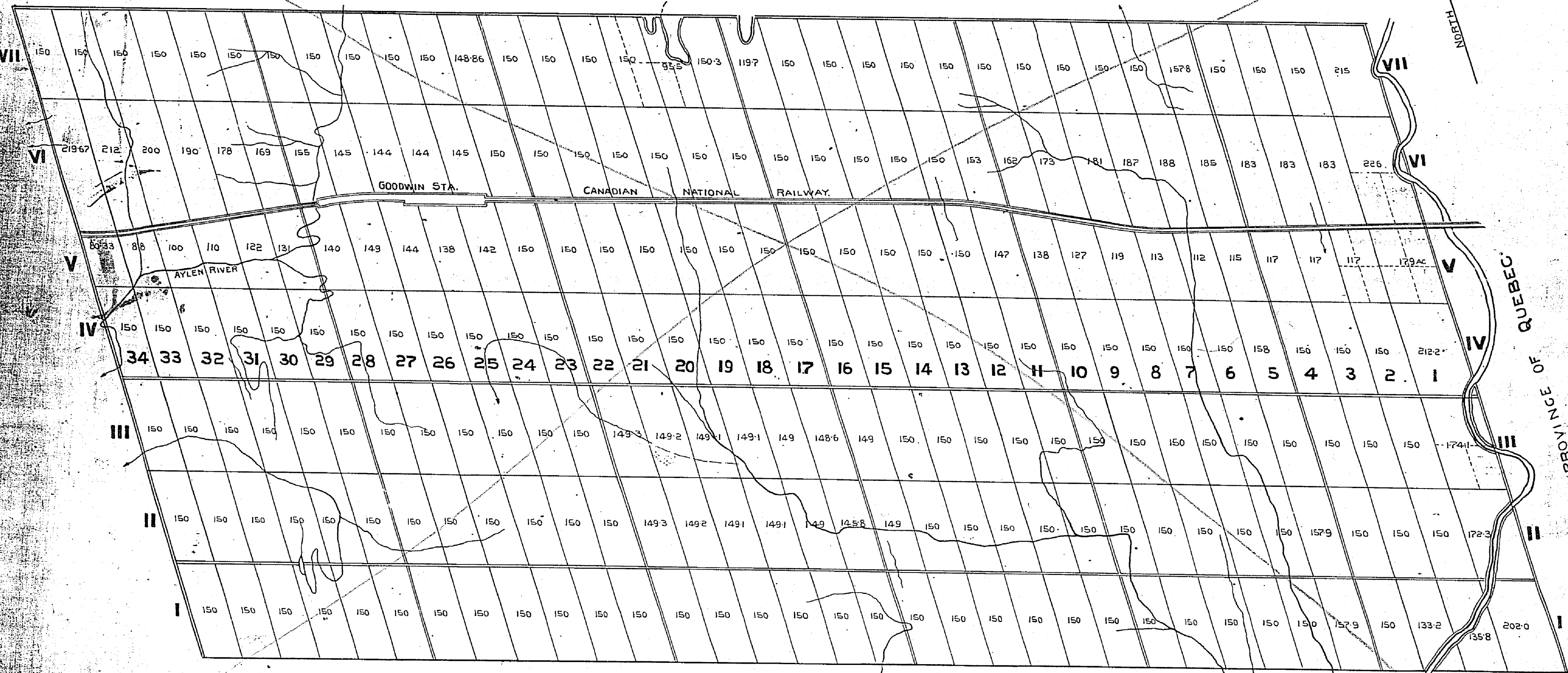

New sheet 22 Jan 51

PRICE 25 CENTS

SARGEANT JWP

6817



582

COPY  
— PLAN —  
— OF —  
— PART OF THE TOWNSHIP OF SARGEANT — M-582  
— DISTRICT OF TIMISKAMING —  
— SURVEYED BY ANDREW BELL, O.L.S. —  
— SCALE 40 CHAINS-TO-INCH —

DATED OCT 3<sup>rd</sup> 1912  
SIGNED BY *N. J. Sutor O.L.S.*

AREAS

LOTS	35880.1 ac
WATER	130.3 "
ROADS	660.5 "
NTC.RY	180.5 "
TOTAL	<u>36851.7 ac</u>





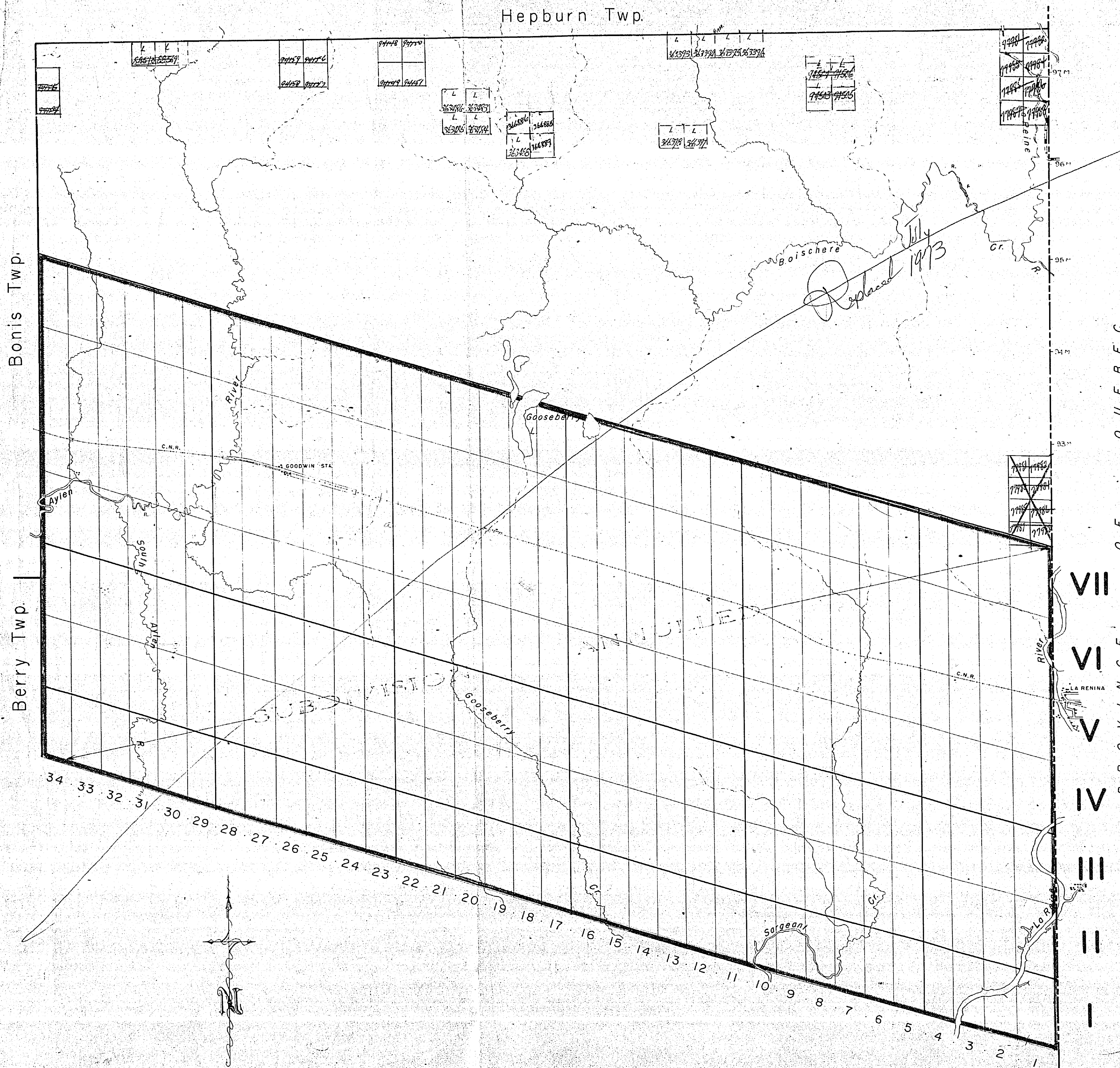

15





THE TOWNSHIP  
OF  
**SARGEANT**  
DISTRICT OF  
COCHRANE  
LARDER LAKE  
MINING DIVISION  
SCALE: 1-INCH=40 CHAINS

# LEGEND

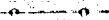
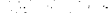
PATENTED LAND	(P)
CROWN LAND SALE	C.S.
LEASES	(L)
LOCATED LAND	Loc.
LICENSE OF OCCUPATION	L.O.
ROADS	
IMPROVED ROADS	
KING'S HIGHWAY	
POWER LINES	
RAILWAYS	
MINES	
MARSH OR MUSKEG	

## NOTES

400 Surface Rights Reservation around all Lakes and Rivers.

MINING RECORDER  
RECEIVED  
FEB 18 1963  
NORFOLK LAKES - ONT.

PLAN NO. — M-582  
DEPARTMENT OF MINES  
— ONTARIO



582

SARGEANT TWP

Hepburn Twp.

Boniss Twp.

Berry Twp.

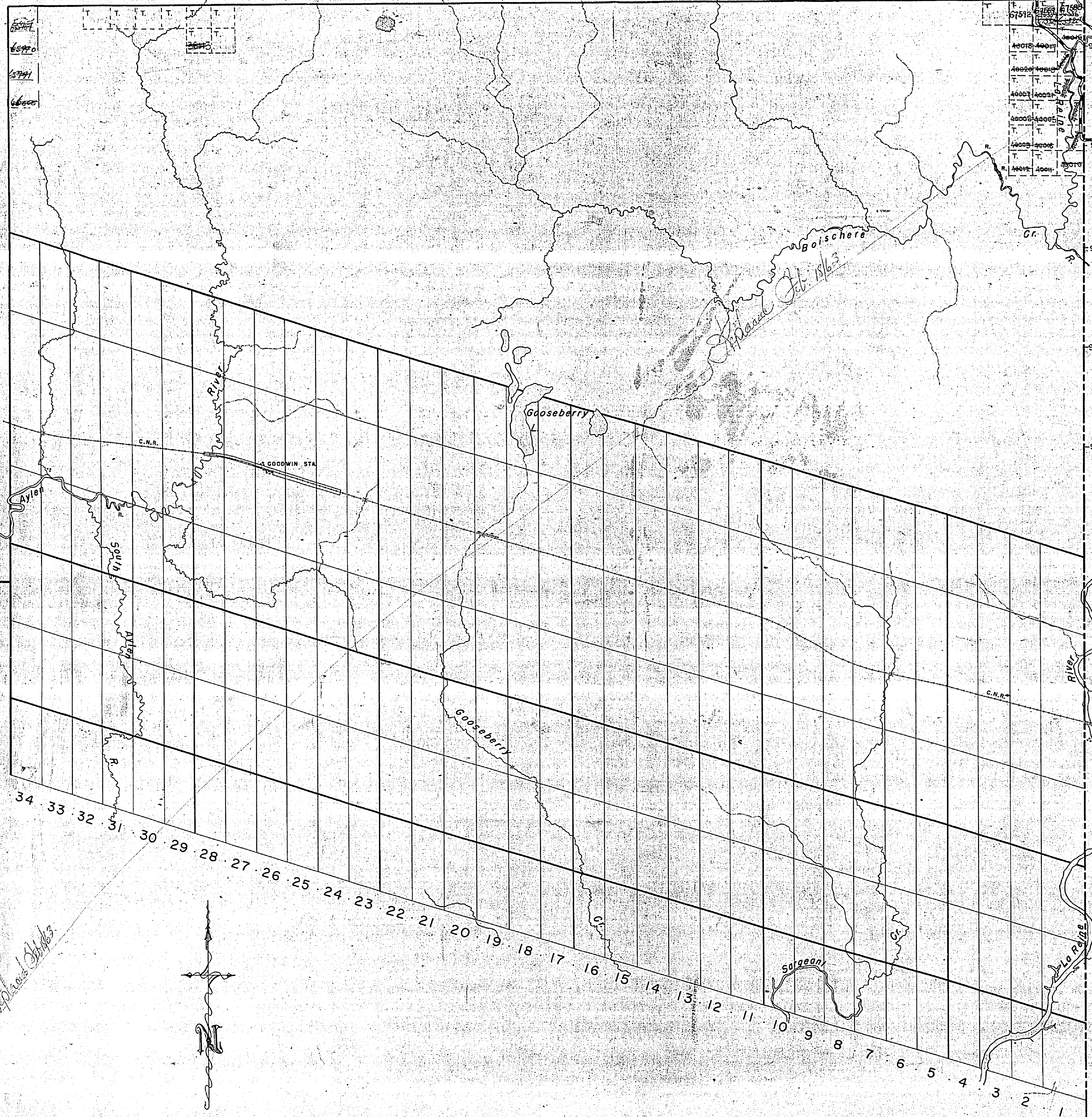

THE TOWNSHIP  
OF  
**SARGEANT**  
DISTRICT OF  
COCHRANE  
LARDER LAKE  
MINING DIVISION  
SCALE: 1 INCH = 40 CHAINS

LEGEND

- |                       |   |
|-----------------------|---|
| PATENTED LAND         | ⊙ |
| CROWN LAND SALE       | ⊙ |
| LEASES                | ⊙ |
| LOCATED LAND          | ⊙ |
| LICENSE OF OCCUPATION | ⊙ |
| ROADS                 | — |
| IMPROVED ROADS        | — |
| KING'S HIGHWAY        | — |
| POWER LINES           | — |
| RAILWAYS              | — |
| MINES                 | — |
| MARSH OR MUSKEG       | — |

NOTES

PLAN NO. — M-582  
DEPARTMENT OF MINES  
— ONTARIO —