

PLAN OF SHABUSKWIA LAKE AREA.

KOWKASH MINING DIVISION.
DISTRICT OF THUNDER BAY.

— Scale, 40 chains to an inch. —

PRINGLE LAKE AREA.

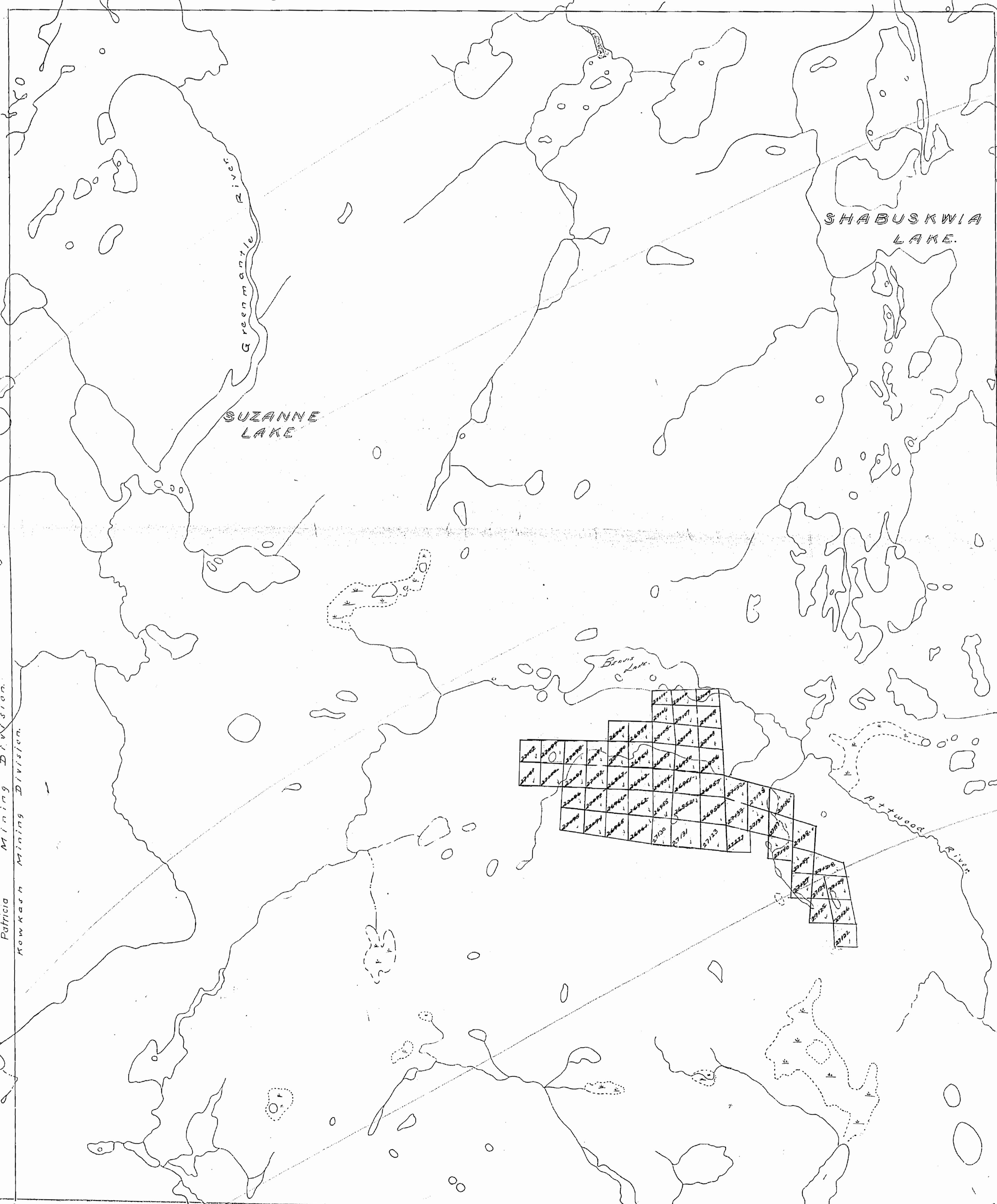
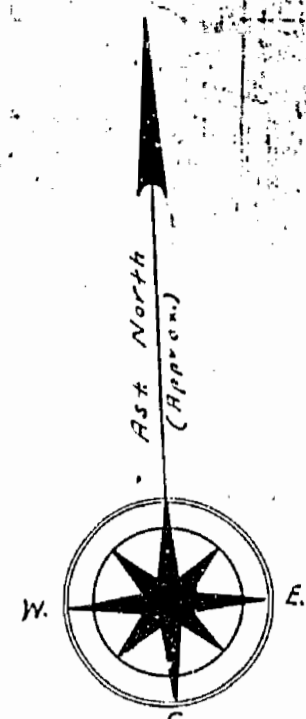

1887

GREENMANTLE LAKE AREA.

Patricia Mining Division.
Kowkash Mining Division.

6-1952
1887

MUSGRAVE LAKE AREA.

GREENMANTLE LAKE AREA.

6-1952
1887

MUSGRAVE LAKE AREA.

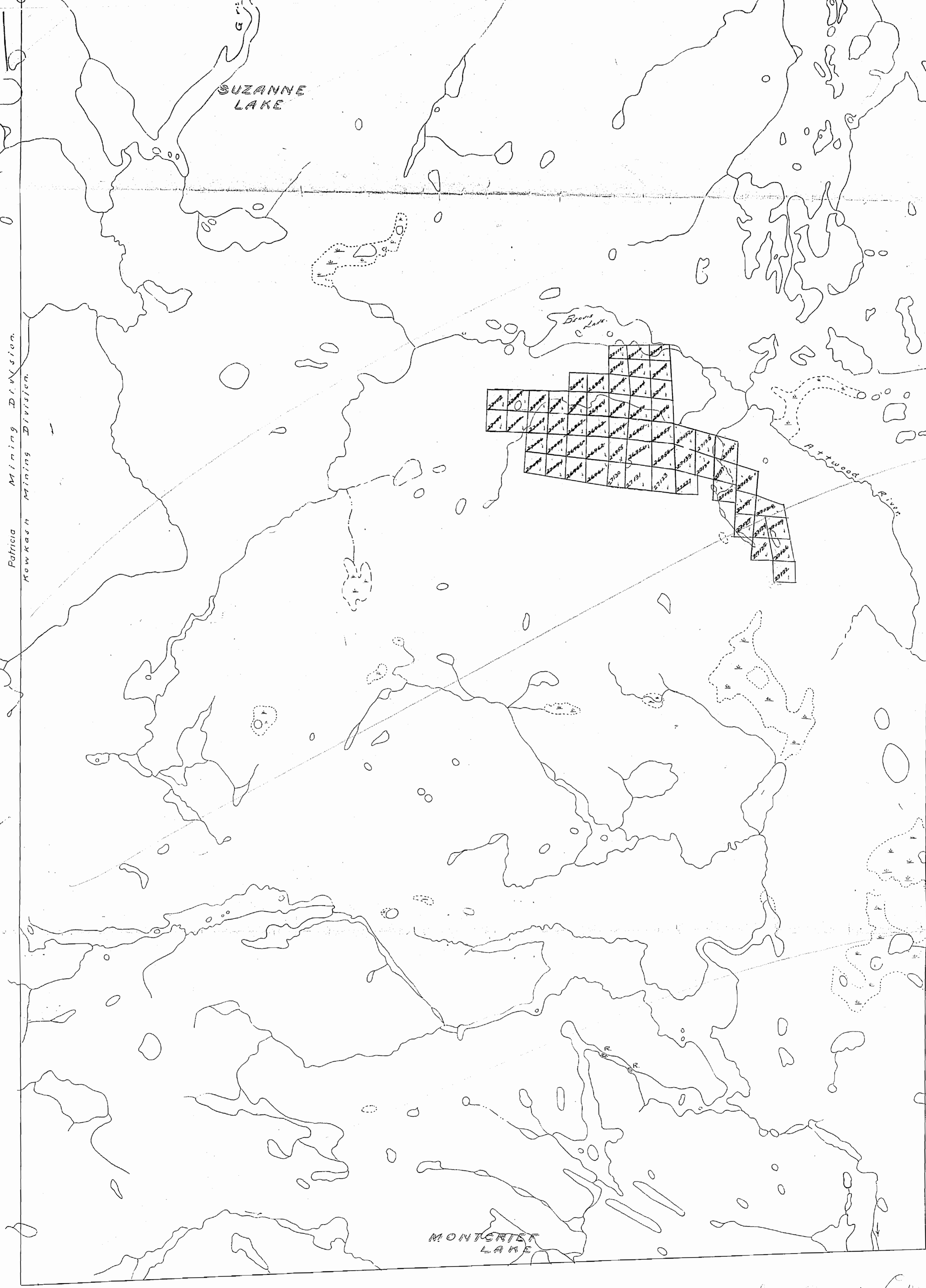

NOTES.

- | | |
|-----------------------------|--|
| Railways shown | Non-perennial streams |
| Paved Highways | Bridges |
| Gravel " " | Buildings |
| Highway Route No. | Swamps |
| Other Roads | Areas marked (P) are Potential |
| Trails & Paths | " (L) " Lost |
| Telephone & Telegraph Lines | " (L.O) " Area under License of Occupation |
| Electric Power Lines | |

Replaced by British M-1887
Greenmantle M-3357

M-1887

PLAN OF SHABUSKWIA LAKE AREA.

KOWKASH MINING DIVISION.
DISTRICT OF THUNDER BAY.

Scale, 40 chains to an inch.

PRINGLE LAKE AREA.

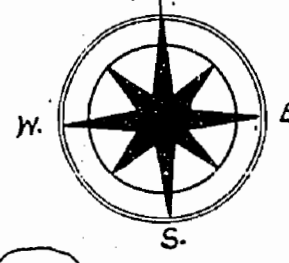

GREENMANTLE LAKE AREA.

MUSGRAVE LAKE AREA.

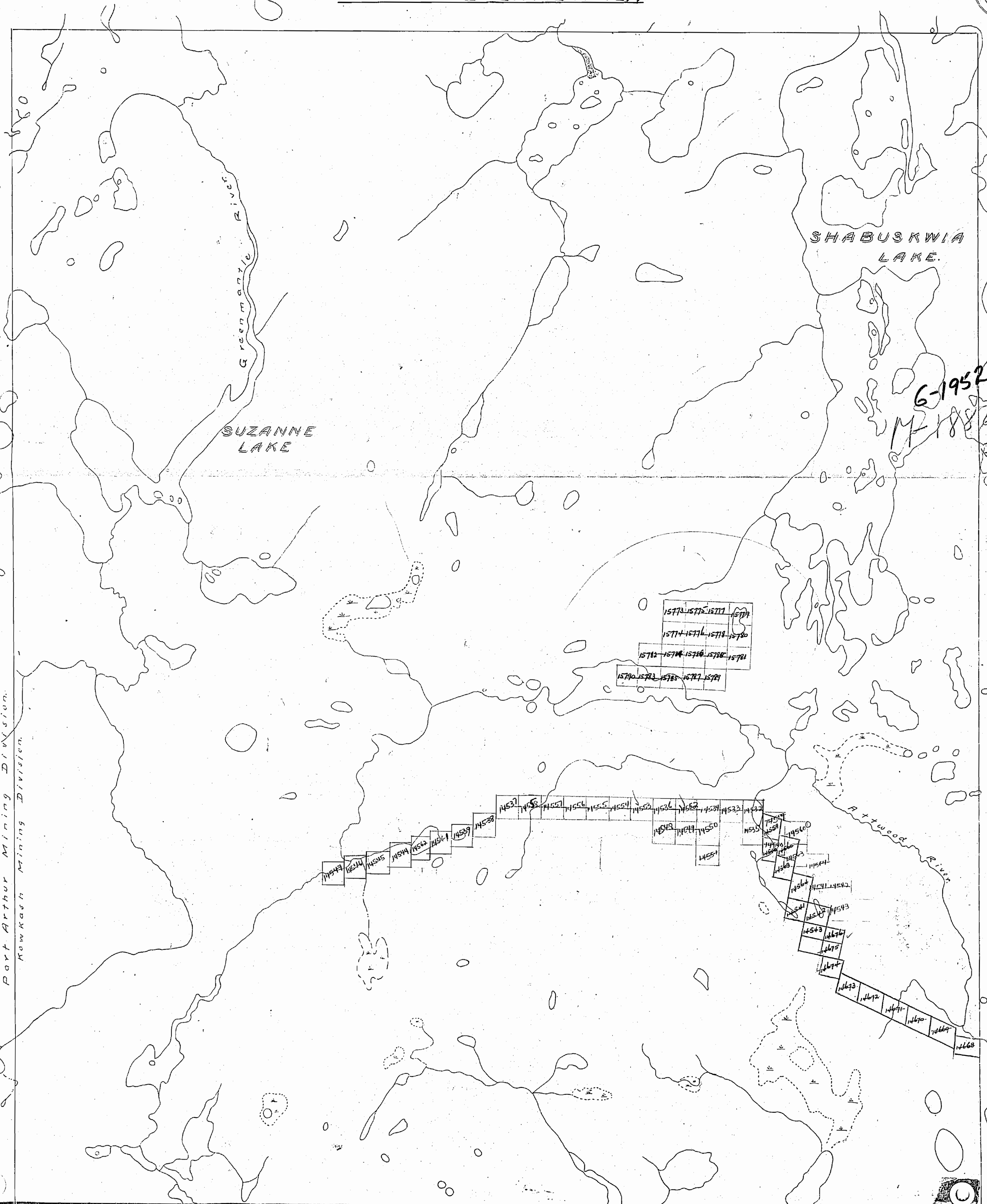

G-1952

M-1887

H-1

Part Arthur Mining Division.
Kowkash Mining Division.

6-1951
M-1887
#1

GREENMANTLE LAKE AREA.

MUSGRAVE LAKE AREA.

Port Arthur Mining Division
Kowkash Mining Division

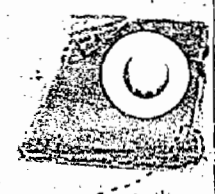
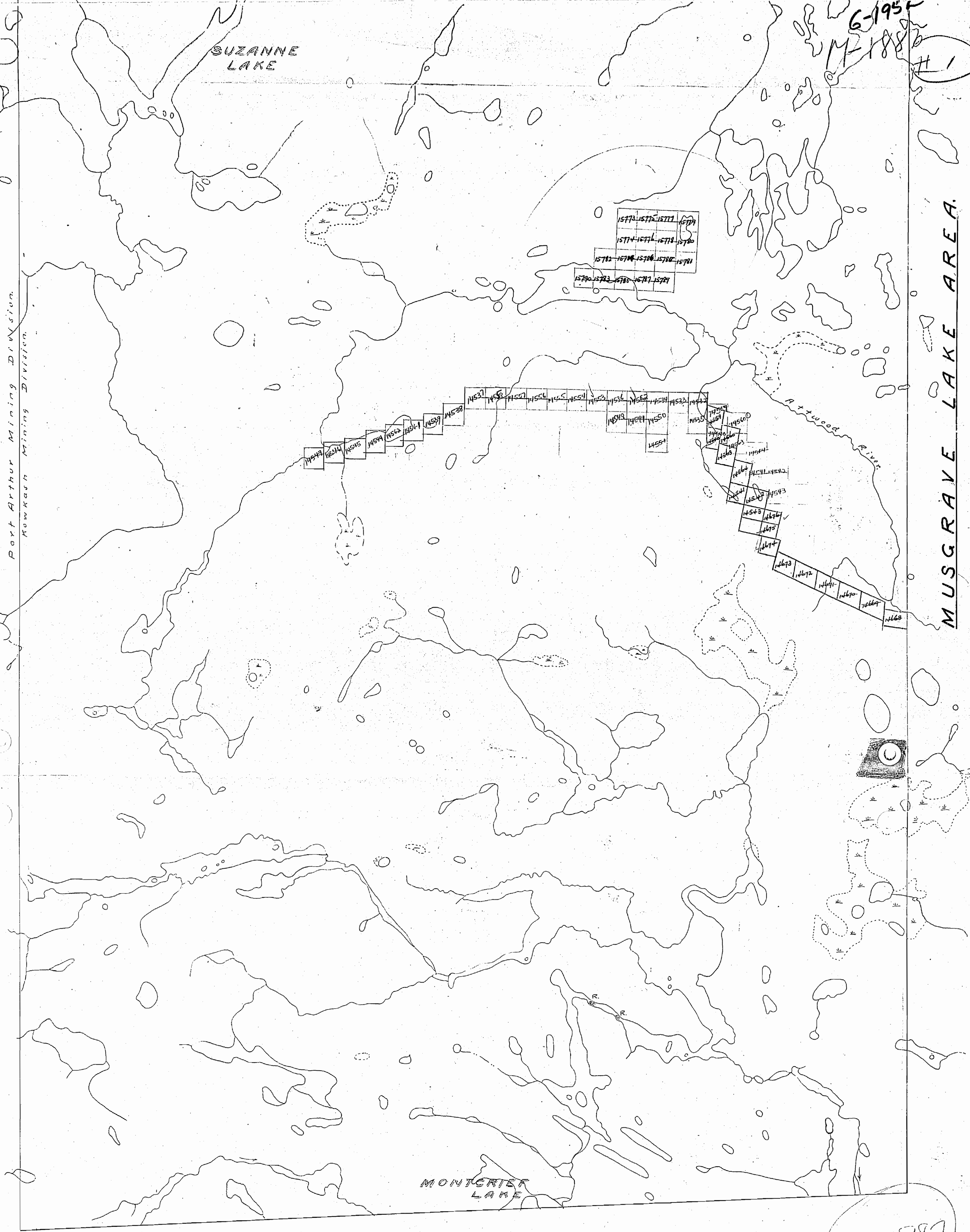

M1887
~~264~~

NOTES

- Railways Shown
- Paved Highways
- Gravel
- Highway Route No. ①
- Other Roads
- Trails & Paths
- Telephone Telegraph Lines
- Electric Power Lines
- Non-perennial streams
- Bridges
- Buildings
- Swamps
- Areas marked ② are Potential L.O. ③ held under License of Occupation