

3044

Columbus Pt.

Cooke Pt.

Pipestone Bay

1940

SOUTH BAY  
LAKE NIPIGON

(M3044)

229099 229097 229098 229096 229095 229094 229093 229092 229091 229090 229089 229088 229087 229086 229085 229084 229083 229082 229081 229080 229079 229078 229077 229076 229075 229074 229073 229072 229071 229070 229069 229068 229067 229066 229065 229064 229063 229062 229061 229060 229059 229058 229057 229056 229055 229054 229053 229052 229051 229050 229049 229048 229047 229046 229045 229044 229043 229042 229041 229040 229039 229038 229037 229036 229035 229034 229033 229032 229031 229030 229029 229028 229027 229026 229025 229024 229023 229022 229021 229020 229019 229018 229017 229016 229015 229014 229013 229012 229011 229010 229009 229008 229007 229006 229005 229004 229003 229002 229001 229000 228999 228998 228997 228996 228995 228994 228993 228992 228991 228990 228989 228988 228987 228986 228985 228984 228983 228982 228981 228980 228979 228978 228977 228976 228975 228974 228973 228972 228971 228970 228969 228968 228967 228966 228965 228964 228963 228962 228961 228960 228959 228958 228957 228956 228955 228954 228953 228952 228951 228950 228949 228948 228947 228946 228945 228944 228943 228942 228941 228940 228939 228938 228937 228936 228935 228934 228933 228932 228931 228930 228929 228928 228927 228926 228925 228924 228923 228922 228921 228920 228919 228918 228917 228916 228915 228914 228913 228912 228911 228910 228909 228908 228907 228906 228905 228904 228903 228902 228901 228900 228899 228898 228897 228896 228895 228894 228893 228892 228891 228890 228889 228888 228887 228886 228885 228884 228883 228882 228881 228880 228879 228878 228877 228876 228875 228874 228873 228872 228871 228870 228869 228868 228867 228866 228865 228864 228863 228862 228861 228860 228859 228858 228857 228856 228855 228854 228853 228852 228851 228850 228849 228848 228847 228846 228845 228844 228843 228842 228841 228840 228839 228838 228837 228836 228835 228834 228833 228832 228831 228830 228829 228828 228827 228826 228825 228824 228823 228822 228821 228820 228819 228818 228817 228816 228815 228814 228813 228812 228811 228810 228809 228808 228807 228806 228805 228804 228803 228802 228801 228800 228799 228798 228797 228796 228795 228794 228793 228792 228791 228790 228789 228788 228787 228786 228785 228784 228783 228782 228781 228780 228779 228778 228777 228776 228775 228774 228773 228772 228771 228770 228769 228768 228767 228766 228765 228764 228763 228762 228761 228760 228759 228758 228757 228756 228755 228754 228753 228752 228751 228750 228749 228748 228747 228746 228745 228744 228743 228742 228741 228740 228739 228738 228737 228736 228735 228734 228733 228732 228731 228730 228729 228728 228727 228726 228725 228724 228723 228722 228721 228720 228719 228718 228717 228716 228715 228714 228713 228712 228711 228710 228709 228708 228707 228706 228705 228704 228703 228702 228701 228700 228699 228698 228697 228696 228695 228694 228693 228692 228691 228690 228689 228688 228687 228686 228685 228684 228683 228682 228681 228680 228679 228678 228677 228676 228675 228674 228673 228672 228671 228670 228669 228668 228667 228666 228665 228664 228663 228662 228661 228660 228659 228658 228657 228656 228655 228654 228653 228652 228651 228650 228649 228648 228647 228646 228645 228644 228643 228642 228641 228640 228639 228638 228637 228636 228635 228634 228633 228632 228631 228630 228629 228628 228627 228626 228625 228624 228623 228622 228621 228620 228619 228618 228617 228616 228615 228614 228613 228612 228611 228610 228609 228608 228607 228606 228605 228604 228603 228602 228601 228600 228599 228598 228597 228596 228595 228594 228593 228592 228591 228590 228589 228588 228587 228586 228585 228584 228583 228582 228581 228580 228579 228578 228577 228576 228575 228574 228573 228572 228571 228570 228569 228568 228567 228566 228565 228564 228563 228562 228561 228560 228559 228558 228557 228556 228555 228554 228553 228552 228551 228550 228549 228548 228547 228546 228545 228544 228543 228542 228541 228540 228539 228538 228537 228536 228535 228534 228533 228532 228531 228530 228529 228528 228527 228526 228525 228524 228523 228522 228521 228520 228519 228518 228517 228516 228515

32308  
T SAYZIE-LAKE

YIRE

**VIRGIN**

3044

20114 B. 16161 (M. 3044) McIntyre Bay (Lake Nipigon) - M. 3040

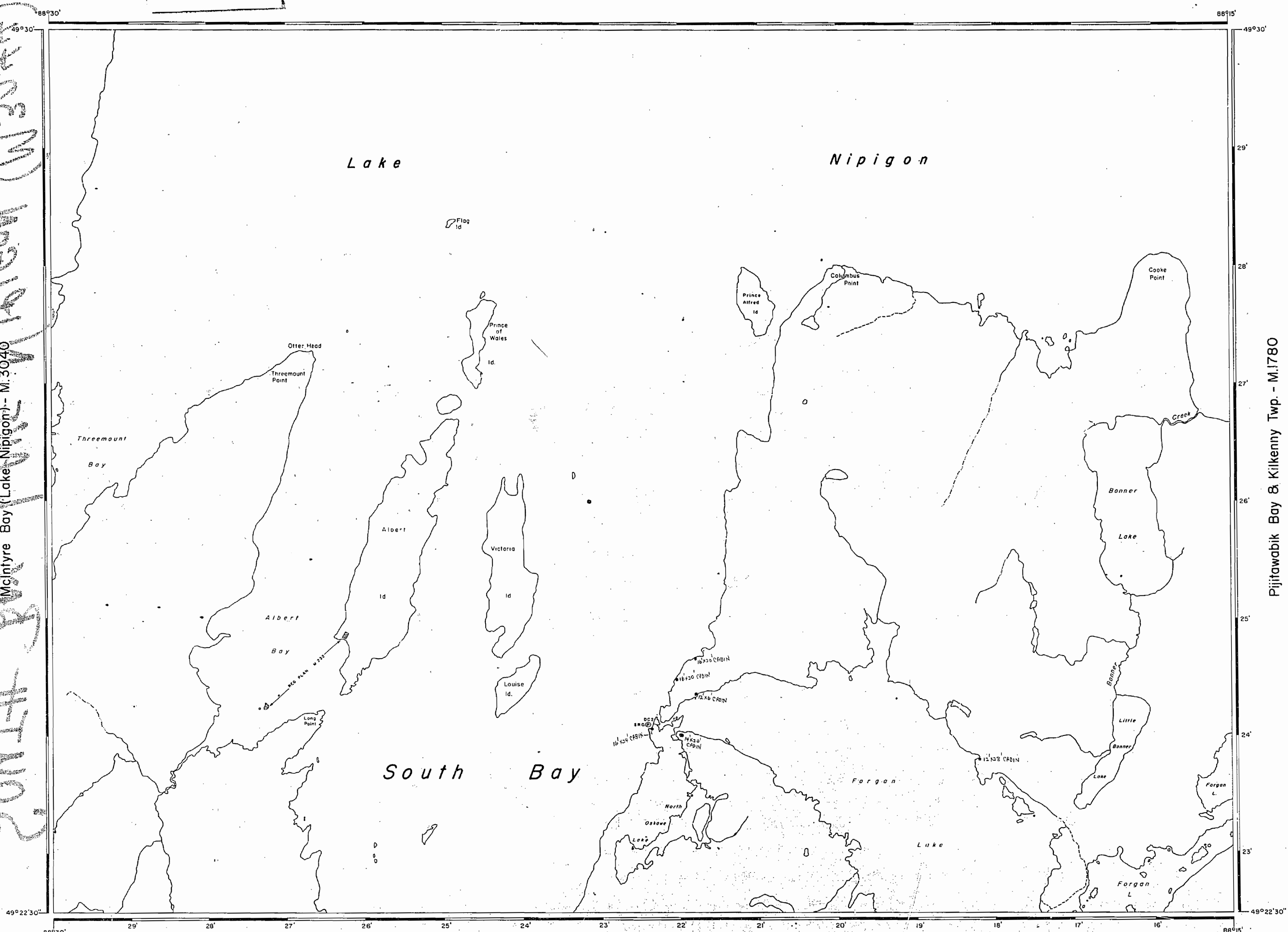

Oskawe Lake - M.3045

AREA OF  
**SOUTH BAY  
LAKE NIPIGON**

DISTRICT OF  
THUNDER BAY

PORT ARTHUR  
MINING DIVISION

SCALE: 1-INCH = 40 CHAINS

**LEGEND**

PATENTED LAND	Ⓟ
CROWN LAND SALE	C.S.
LEASES	Ⓛ
LOCATED LAND	Loc
LICENSE OF OCCUPATION	L.O.
MINING RIGHTS ONLY	M.R.O.
SURFACE RIGHTS ONLY	S.R.O.
ROADS	—
IMPROVED ROADS	—
KING'S HIGHWAYS	—
RAILWAYS	—
POWER LINES	—
MARSH OR MUSKEG	—
MINES	✕
CANCELLED	C.

**NOTES**

400' Surface Rights Reservation around all lakes and rivers.

Flooding rights on Lake Nipigon reserved to contour 855' to H.E.P.C. (Virgin Falls Project). File: 12198.

Flooding rights on Forgan Lake reserved to contour 860' - W.P.L.A. 36. File: 129479.

1966

NIP.

PLAN NO. **M.3044**

DEPARTMENT OF MINES  
— ONTARIO —

Pijitawabik Bay & Kilkenny Twp. - M.1780

494882

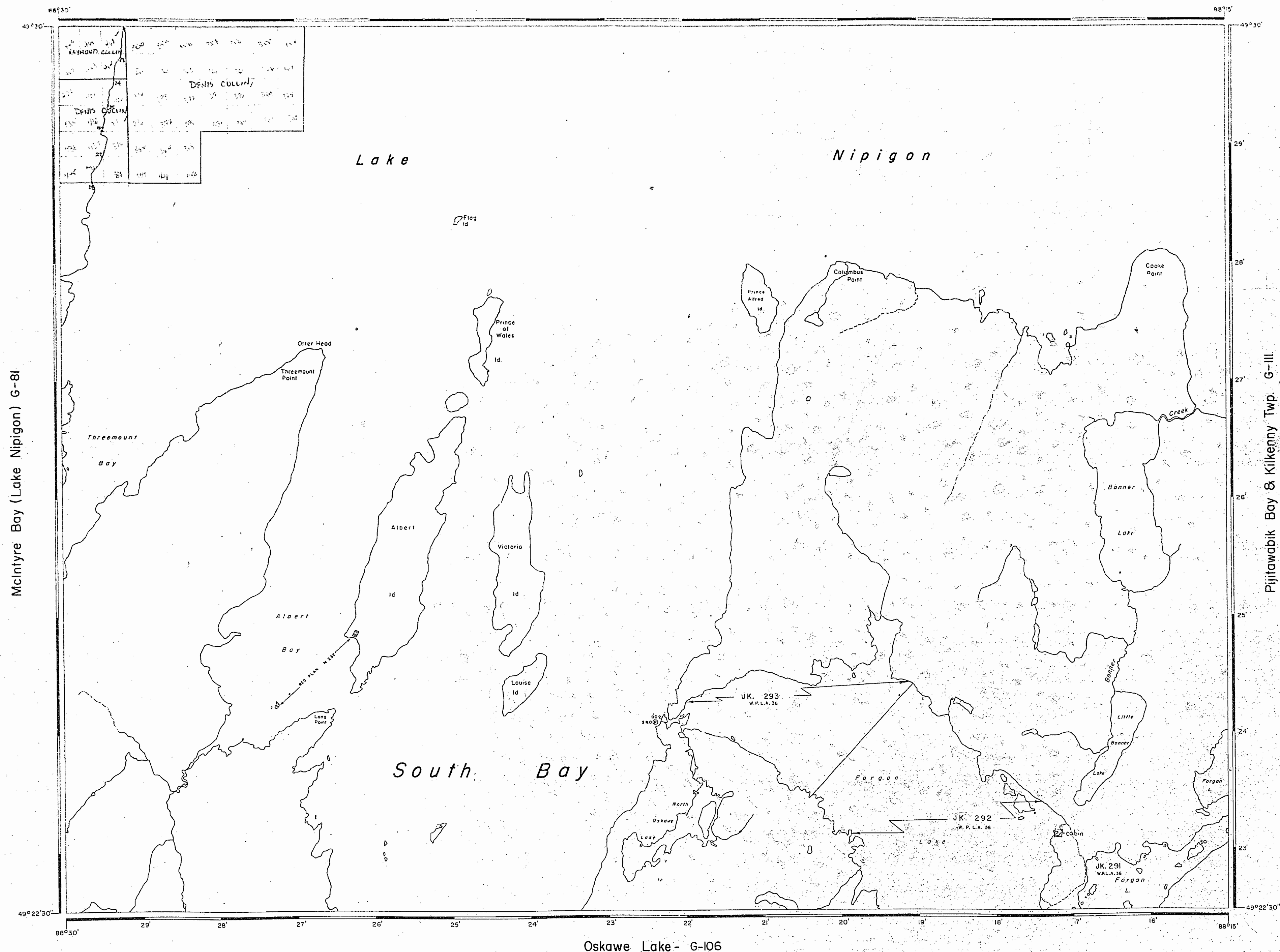

## LEGEND

PATENTED LAND	⊙
CROWN LAND SALE	C.S.
LEASES	⊙
LOCATED LAND	Loc.
LICENSE OF OCCUPATION	L.O.
MINING RIGHTS ONLY	M.R.O.
SURFACE RIGHTS ONLY	S.R.O.
ROADS	—
IMPROVED ROADS	—
KING'S HIGHWAYS	—
RAILWAYS	—
POWER LINES	—
MARSH OR MUSKEG	—
MINES	⋈
CANCELLED	C.

## NOTES

Flooding rights on Lake Nipigon reserved to contour 855' to HEPC (Virgin Falls Project). File: 12198.

Flooding rights on Forgan Lake reserved to contour 860' - W.P.L.A. 36. File: 129 479.

## DISPOSITION OF CROWN LANDS

TYPE OF DOCUMENT	SYMBOL
PATENT, SURFACE & MINING RIGHTS	⊙
" SURFACE RIGHTS ONLY	⊙
" MINING RIGHTS ONLY	⊙
LEASE SURFACE & MINING RIGHTS	⊙
" SURFACE RIGHTS ONLY	⊙
" MINING RIGHTS ONLY	⊙
LICENCE OF OCCUPATION	⊙
ORDER-IN-COUNCIL	OC
RESERVATION	⊙
CANCELLED	⊙
SAND & GRAVEL	⊙

NOTE: MINING RIGHTS IN PARCELS PATENTED PRIOR TO MAY 6, 1913, VESTED IN ORIGINAL PATENTEE BY THE PUBLIC LANDS ACT, R.S.O. 1970, CHAP. 380, SEC. 63, SUBSEC. 1.

SCALE: 1 INCH = 40 CHAINS

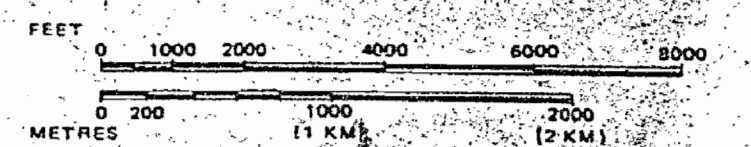

AREA  
**SOUTH BAY**  
 (LAKE NIPIGON)  
 M.N.R. ADMINISTRATIVE DISTRICT  
**NIPIGON**  
 MINING DIVISION  
**THUNDER BAY**  
 LAND TITLES / REGISTRY DIVISION  
**THUNDER BAY**

Ontario Ministry of Natural Resources Land Management Branch

Date: APRIL 1981 Number: May 25/81

G-129



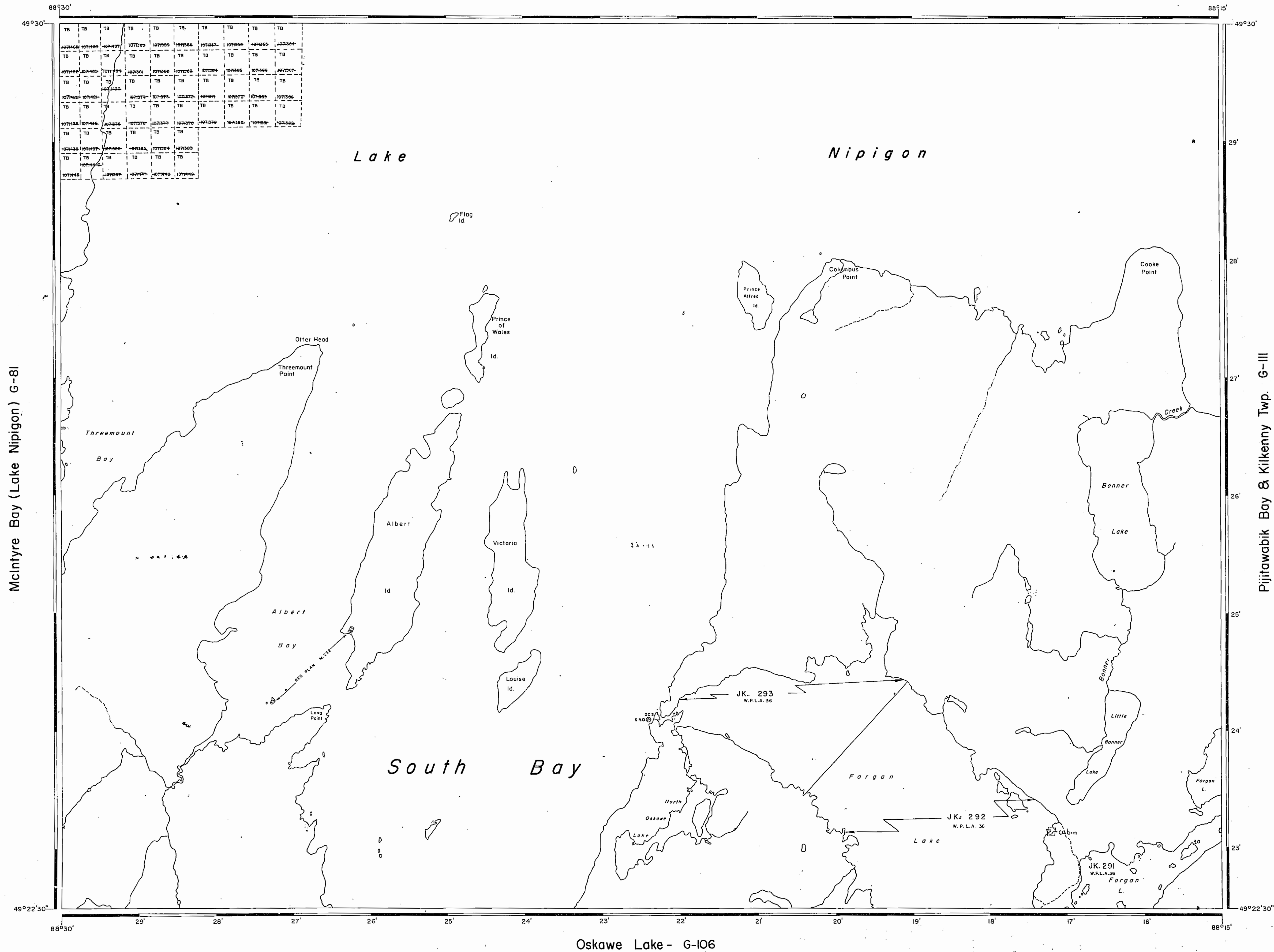

THE INFORMATION THAT APPEARS ON THIS MAP HAS BEEN COMPILED FROM VARIOUS SOURCES, AND ACCURACY IS NOT GUARANTEED. THOSE WISHING TO STAKE MINING CLAIMS SHOULD CONSULT WITH THE MINING RECORDER, MINISTRY OF NORTHERN DEVELOPMENT AND MINES, FOR ADDITIONAL INFORMATION ON THE STATUS OF THE LANDS SHOWN HEREON.

**LEGEND**

PATENTED LAND	Ⓟ
CROWN LAND SALE	C.S.
LEASES	Ⓛ
LOCATED LAND	Loc.
LICENSE OF OCCUPATION	L.O.
MINING RIGHTS ONLY	M.R.O.
SURFACE RIGHTS ONLY	S.R.O.
ROADS	—
IMPROVED ROADS	—
KING'S HIGHWAYS	—
RAILWAYS	—
POWER LINES	—
MARSH OR MUSKEG	—
MINES	✕
CANCELLED	C.

**NOTES**

Flooding rights on Lake Nipigon reserved to contour 855' to HEPC (Virgin Falls Project). File: 12198.

Flooding rights on Forgan Lake reserved to contour 860' - W.P.L.A. 36. File: 129479.

**DISPOSITION OF CROWN LANDS**

TYPE OF DOCUMENT	SYMBOL
PATENT, SURFACE & MINING RIGHTS	●
" SURFACE RIGHTS ONLY	○
" MINING RIGHTS ONLY	○
LEASE, SURFACE & MINING RIGHTS	■
" SURFACE RIGHTS ONLY	■
" MINING RIGHTS ONLY	■
LICENCE OF OCCUPATION	▼
ORDER-IN-COUNCIL	OC
RESERVATION	Ⓢ
CANCELLED	Ⓢ
SAND & GRAVEL	Ⓢ

LAND USE PERMITS FOR COMMERCIAL TOURISM/OUTPOST CAMPS  
NOTE: MINING RIGHTS IN PARCELS PATENTED PRIOR TO MAY 6, 1913, VESTED IN ORIGINAL PATENTEE BY THE PUBLIC LANDS ACT, R.S.O. 1970, CHAP. 380, SEC. 63, SUBSEC. 1.

SCALE: 1 INCH = 40 CHAINS

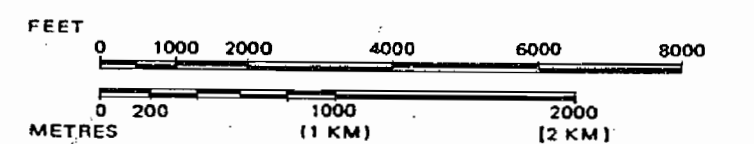
**AREA SOUTH BAY (LAKE NIPIGON)**

M.N.R. ADMINISTRATIVE DISTRICT  
**NIPIGON**  
MINING DIVISION  
**THUNDER BAY**  
LAND TITLES / REGISTRY DIVISION  
**THUNDER BAY**

Ministry of Natural Resources  
Land Management Branch  
Ontario

Date: APRIL 1981  
Number: May 25/81

**G-129**



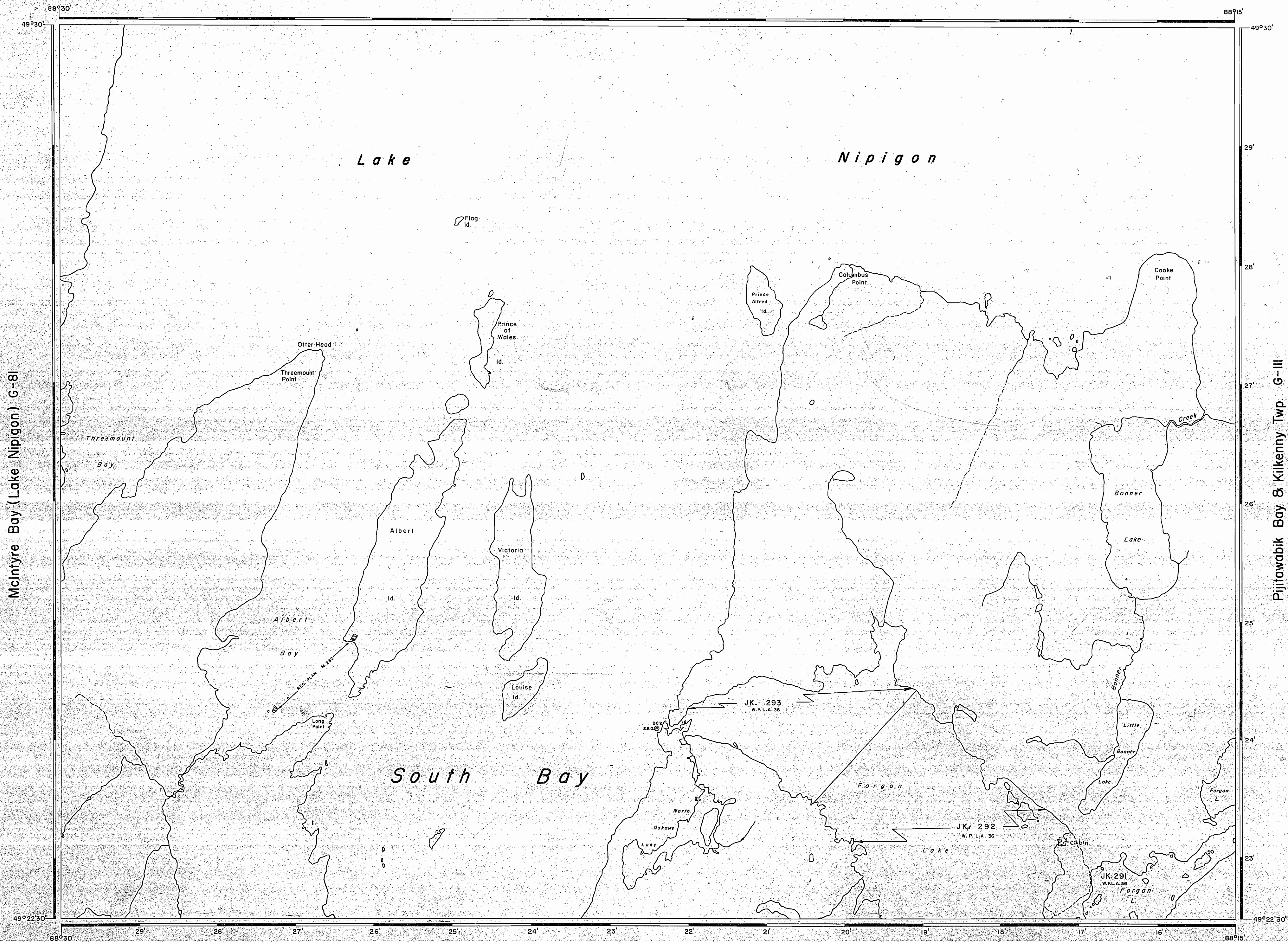

THE INFORMATION THAT APPEARS ON THIS MAP HAS BEEN COMPILED FROM VARIOUS SOURCES AND ACCURACY IS NOT GUARANTEED. THOSE WISHING TO STAKE MINING CLAIMS SHOULD CONSULT WITH THE MINING RECORDER, MINISTRY OF NORTHERN DEVELOPMENT AND MINES, FOR ADDITIONAL INFORMATION ON THE STATUS OF THE LANDS SHOWN HEREON.

**LEGEND**

PATENTED LAND	Ⓟ
CROWN LAND SALE	C.S.
LEASES	Ⓛ
LOCATED LAND	Loc.
LICENSE OF OCCUPATION	L.O.
MINING RIGHTS ONLY	M.R.O.
SURFACE RIGHTS ONLY	S.R.O.
ROADS	—
IMPROVED ROADS	—
KING'S HIGHWAYS	—
RAILWAYS	—
POWER LINES	—
MARSH OR MUSKEG	—
MINES	Ⓜ
CANCELLED	C.

**NOTES**

Flooding rights on Lake Nipigon reserved to contour 855' to HEPC (Virgin Falls Project). File: 12198.

Flooding rights on Forgan Lake reserved to contour 860' - W.P.L.A. 36. File: 129479.

**DISPOSITION OF CROWN LANDS**

TYPE OF DOCUMENT	SYMBOL
PATENT, SURFACE & MINING RIGHTS	Ⓟ
" SURFACE RIGHTS ONLY	Ⓛ
" MINING RIGHTS ONLY	Ⓜ
LEASE, SURFACE & MINING RIGHTS	Ⓛ
" SURFACE RIGHTS ONLY	Ⓛ
" MINING RIGHTS ONLY	Ⓜ
LICENSE OF OCCUPATION	Ⓛ
ORDER-IN-COUNCIL	OC
RESERVATION	Ⓟ
CANCELLED	C.
SAND & GRAVEL	Ⓜ
LAND USE PERMITS FOR COMMERCIAL TOURISM/OUTPOST CAMPS.	Ⓜ

NOTE: MINING RIGHTS IN PARCELS PATENTED PRIOR TO MAY 6, 1913, VESTED IN ORIGINAL PATENTEE BY THE PUBLIC LANDS ACT, R.S.O. 1970, CHAP. 380, SEC. 63, SUBSEC. 1.

SCALE: 1 INCH = 40 CHAINS

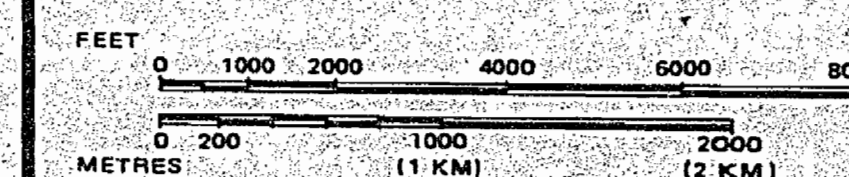

AREA  
**SOUTH BAY**  
(LAKE NIPIGON)  
M.N.R. ADMINISTRATIVE DISTRICT  
**NIPIGON**  
MINING DIVISION  
**THUNDER BAY**  
LAND TITLES / REGISTRY DIVISION  
**THUNDER BAY**

Ministry of Natural Resources  
Land Management Branch  
Ontario

Date  
APRIL 1981

Number  
May 15/81  
**G-129**



152

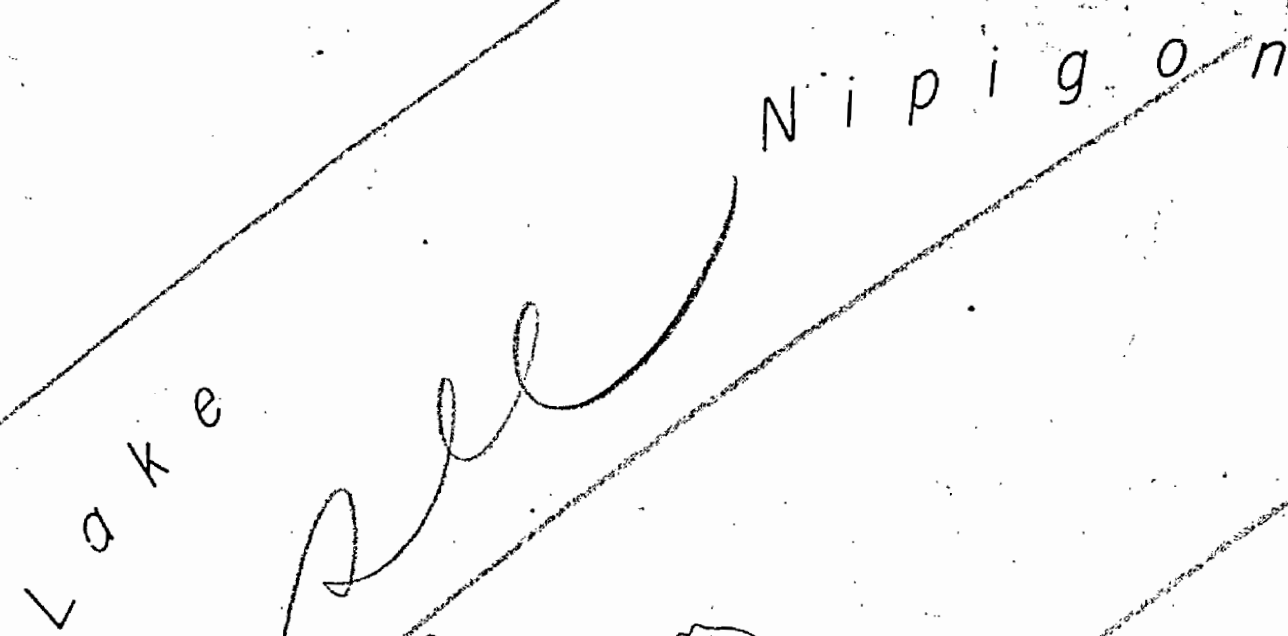

Nipigon

L a k e

PRINCE  
ALFRED  
ID.

COLUMBUS PT.

VICTORIA

DUISE  
ID. 2

SOUTH

DC2  
(P)

J.K. 293  
W.P.L. 36

Hannah

North  
Oskawe  
L.

J.K. 292  
W.P.L. 36

*Bonner*

*Lake*

Little  
Bonner  
L.

*Lakè*

Evo

COOKE

P.L.

T.B.

12307

T.B.

12307

T.B.

12307

T.B.

1844

T.B.

1845

T.B.

12307

T.B.

T.B.

12307

12307

South Bay  
BAY. Bay  
Nipigon 183044

1-3-2

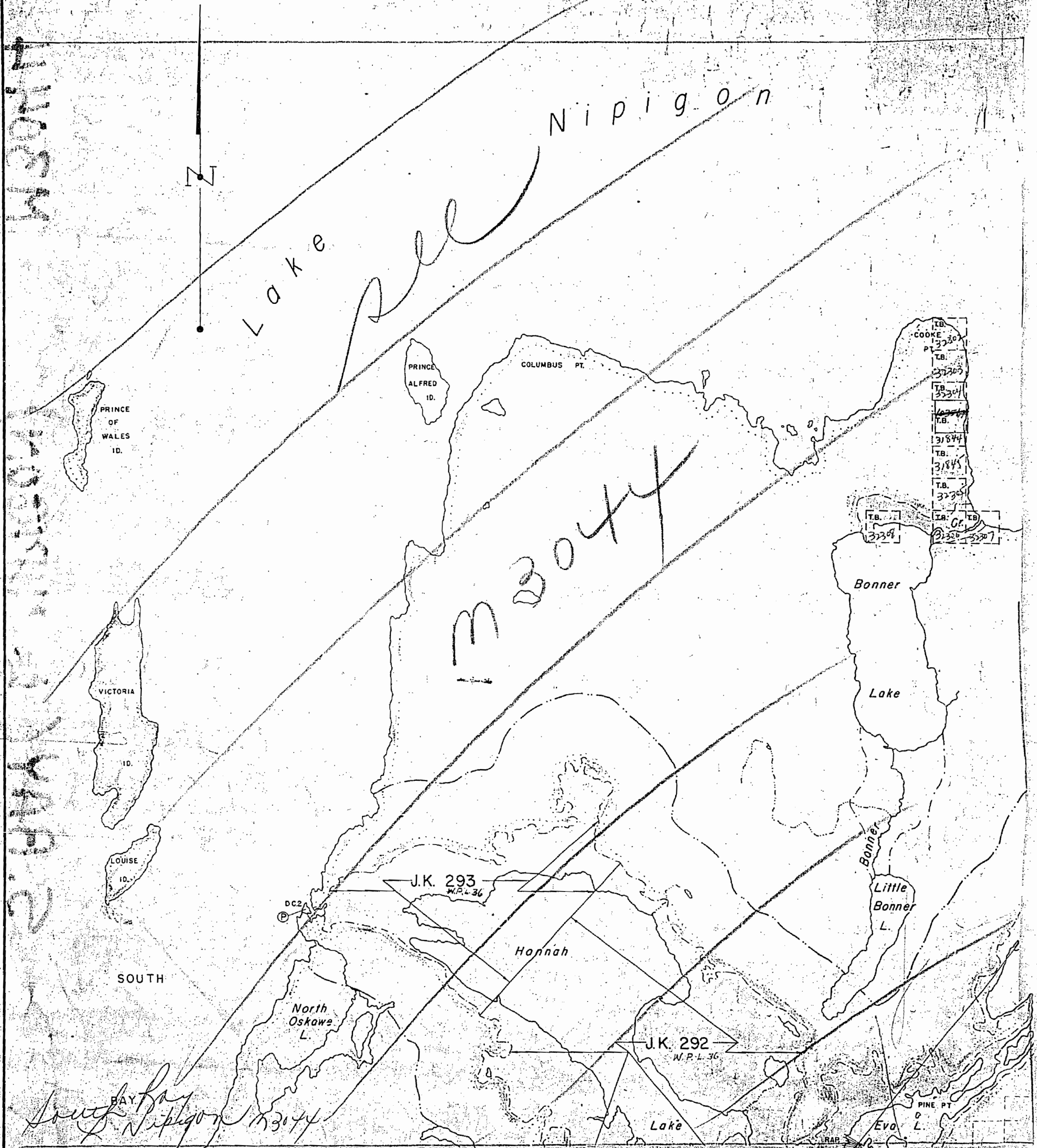

3044

Columbus Pt.

Cooke Pt.

Pipestone Bay

1940

SOUTH BAY  
LAKE NIPIGON

(M3044)

29099	29100
29097	29101
29098	29102
29096	29103
29095	29104
29094	29105
29093	29106
29092	29107
29091	29108
29090	29109
29089	29110
29088	29111
29087	29112
29086	29113
29085	29114
29084	29115
29083	29116
29082	29117
29081	29118
29080	29119
29079	29120
29078	29121
29077	29122
29076	29123
29075	29124
29074	29125
29073	29126
29072	29127
29071	29128
29070	29129
29069	29130
29068	29131
29067	29132
29066	29133
29065	29134
29064	29135
29063	29136
29062	29137
29061	29138
29060	29139
29059	29140
29058	29141
29057	29142
29056	29143
29055	29144
29054	29145
29053	29146
29052	29147
29051	29148
29050	29149
29049	29150
29048	29151
29047	29152
29046	29153
29045	29154
29044	29155
29043	29156
29042	29157
29041	29158
29040	29159
29039	29160
29038	29161
29037	29162
29036	29163
29035	29164
29034	29165
29033	29166
29032	29167
29031	29168
29030	29169
29029	29170
29028	29171
29027	29172
29026	29173
29025	29174
29024	29175
29023	29176
29022	29177
29021	29178
29020	29179
29019	29180
29018	29181
29017	29182
29016	29183
29015	29184
29014	29185
29013	29186
29012	29187
29011	29188
29010	29189
29009	29190
29008	29191
29007	29192
29006	29193
29005	29194
29004	29195
29003	29196
29002	29197
29001	29198
29000	29199

32308

32306

32307

SMYLLIE LAKE

VIRG.

VIRGIN



3044

3044  
McIntyre Bay (Lake Nipigon) - M.3040  
Pijitawabik Bay & Kilkenny Twp. - M.1780

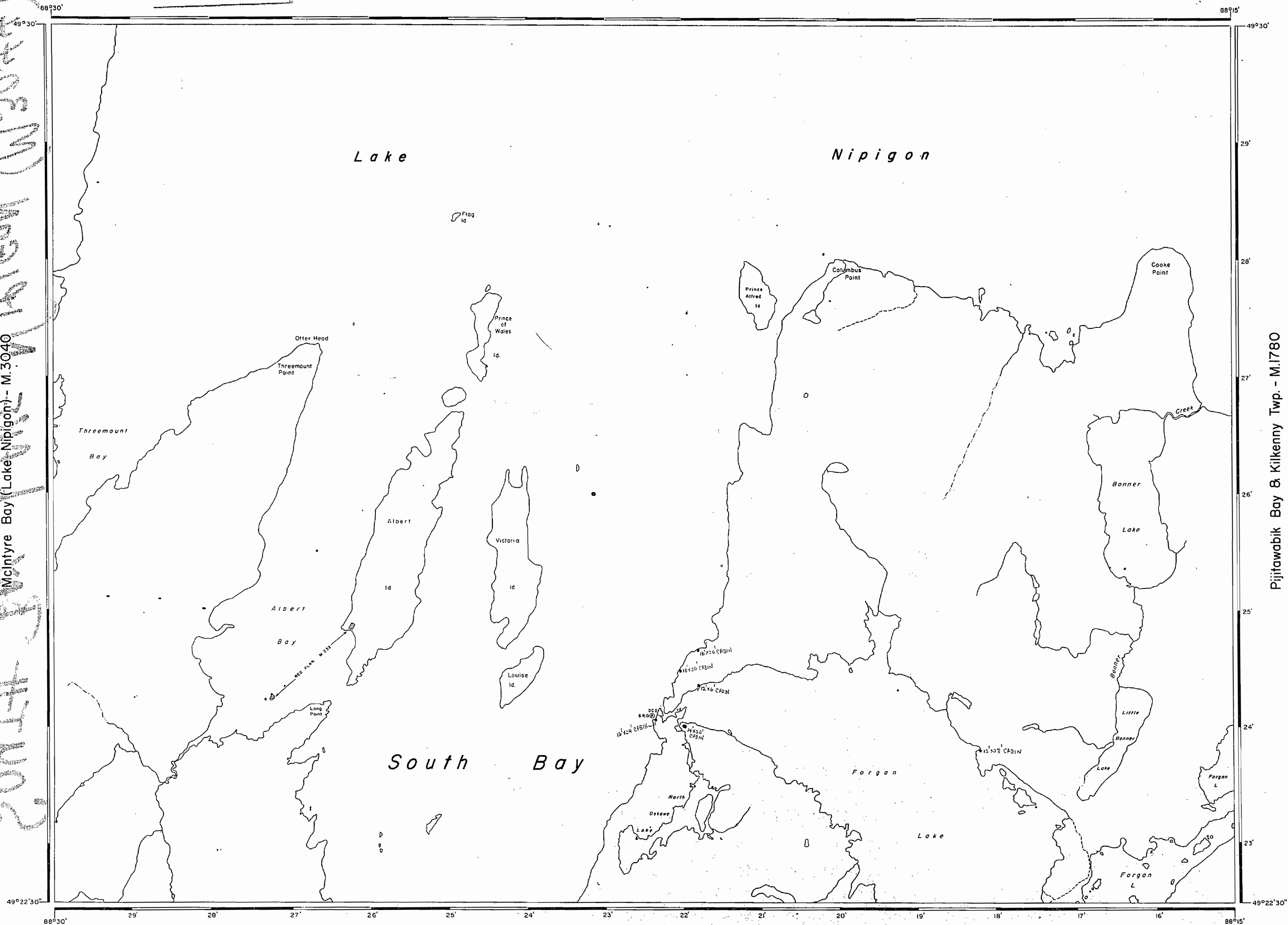

Oskawe Lake - M.3045

AREA OF  
**SOUTH BAY  
LAKE NIPIGON**

DISTRICT OF  
THUNDER BAY

PORT ARTHUR  
MINING DIVISION

SCALE: 1-INCH = 40 CHAINS

**LEGEND**

PATENTED LAND	Ⓟ
CROWN LAND SALE	C.S.
LEASES	Ⓛ
LOCATED LAND	Loc
LICENSE OF OCCUPATION	L.O.
MINING RIGHTS ONLY	M.R.O.
SURFACE RIGHTS ONLY	S.R.O.
ROADS	—
IMPROVED ROADS	—
KING'S HIGHWAYS	—
RAILWAYS	—
POWER LINES	—
MARSH OR MUSKEG	—
MINES	Ⓜ
CANCELLED	C.

**NOTES**

400' Surface Rights Reservation around  
all lakes and rivers.

Flooding rights on Lake Nipigon reserved  
to contour 855' to H.E.P.C. (Virgin Falls  
Project). File: 12198.

Flooding rights on Forgan Lake reserved  
to contour 860' - W.P.L.A. 36.  
File: 129479.

1966

NIP.

PLAN NO. **M.3044**

DEPARTMENT OF MINES  
— ONTARIO —