

T O G O

DISTRICT OF SUDBURY

SUDBURY MINING DIVISION

scale 40 chains = 1 inch

MATTAGAMI

SUDBURY
MINING DIV.
RECEIVED
JUN 26 1970
A.M. P.M.
7,8,9,10,11,12,1,2,3,4,5,6

Handwritten: M-1158

NOBLE

CABOT

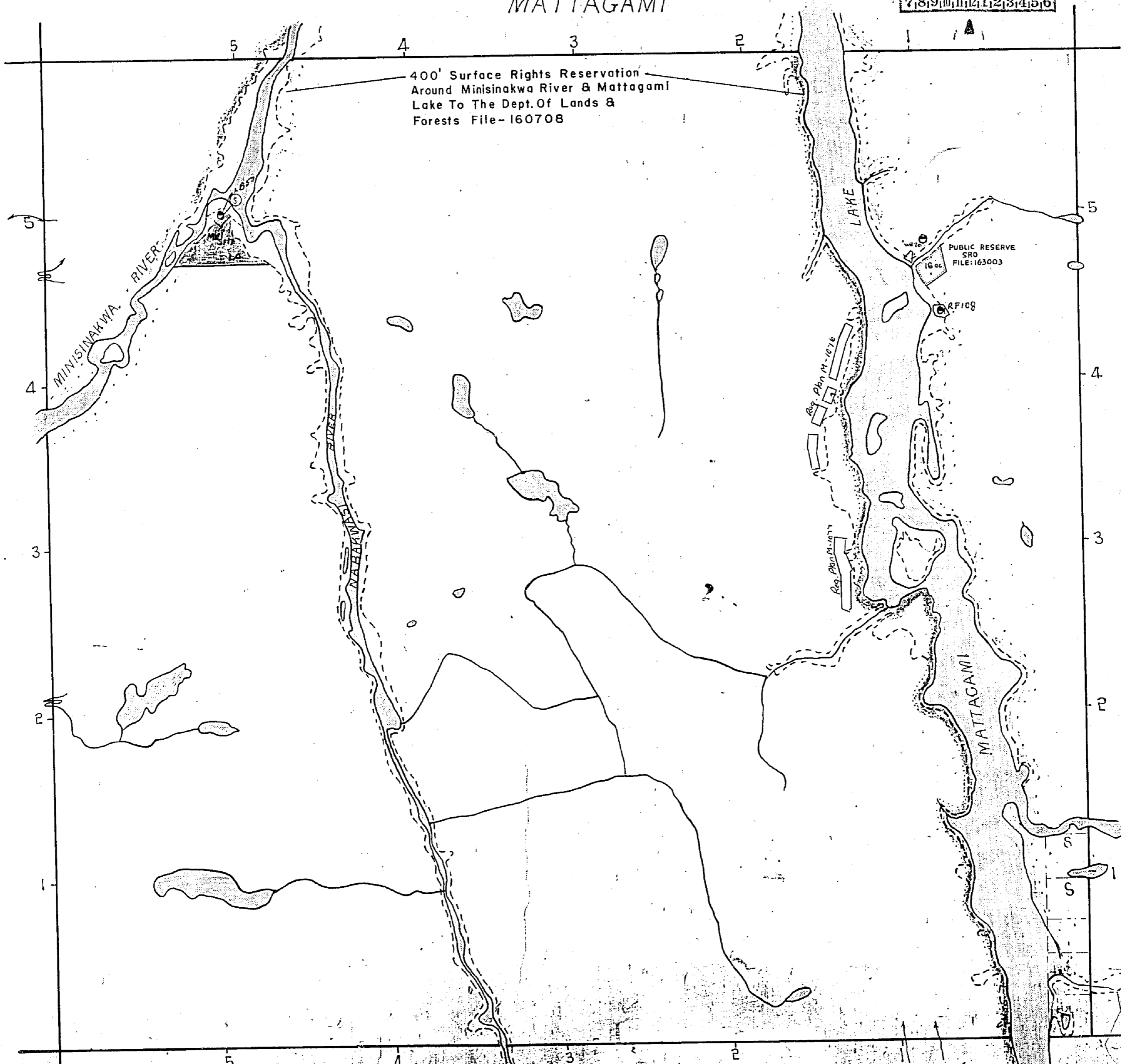

Note. 400' in depth on surface along shoreline of certain lakes reserved for Dept. of Lands & Forests. Shown hereon colored yellow.

BRUNSWICK

Flooding Rights between elev. 1070' & natural high water mark L.O. 7199
Northern Ontario Power Co. Ltd. File: 36881.

THE INFORMATION THAT APPEARS ON THIS MAP HAS BEEN COMPILED FROM VARIOUS SOURCES, AND ACCURACY IS NOT GUARANTEED. THOSE WISHING TO STAKE MINING CLAIMS SHOULD CONSULT WITH THE MINING RECORDER, MINISTRY OF NORTHERN DEVELOPMENT AND MINES, FOR ADDITIONAL INFORMATION ON THE STATUS OF THE LANDS SHOWN HEREON.

T O O O

DISTRICT OF SUDBURY
 PORCUPINE MINING DIVISION

scale 40 chains = 1 inch

M 1158
 MINISTRY OF NATURAL RESOURCES
 SURVEYS AND MAPPING

NOTES
 PATENTED for SURFACE RIGHTS ONLY ●
 Δ Trapline Camp

Areas withdrawn from staking under Section 43 of the Mining Act (R.S.O. 1970).
 Orde. No. File Date Disposition
 Waste Disposal Site Buffer Zone 2/9/81
 R2 - NRW 49183 - SR & MR withdrawn from staking

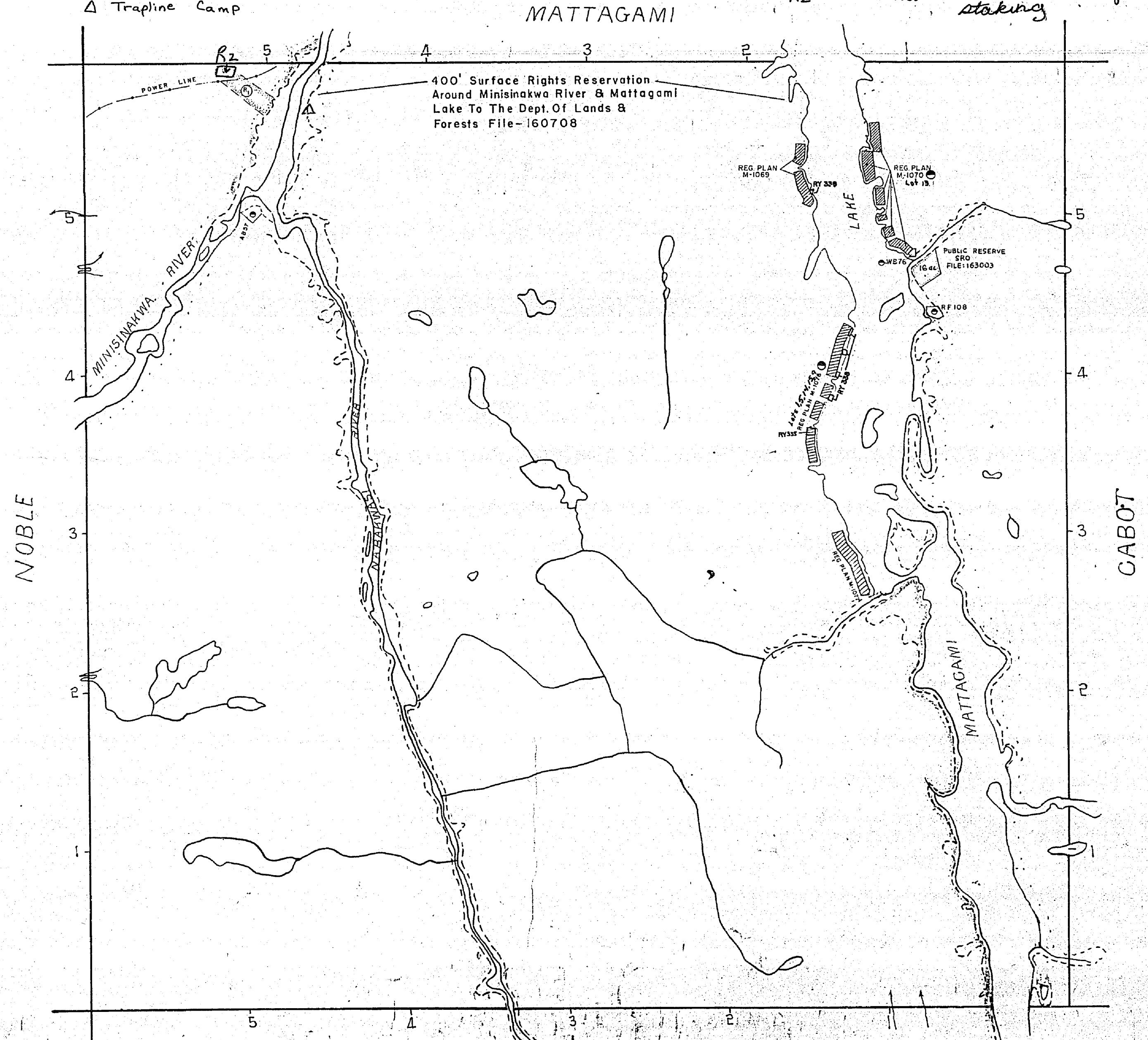

Note. 400' in depth on surface along shoreline of certain lakes reserved for Dept. of Lands & Forests. Shown hereon coloured yellow.

BRUNSWICK
 Flooding Rights between elev. 1070' & natural high water mark. L.O. 7199
 Northern Ontario Power Co Ltd File: 36881