

VERMILION ADDITIONAL.

DISTRICT OF KENORA.

Scale: 40 Chains = 1 Inch.

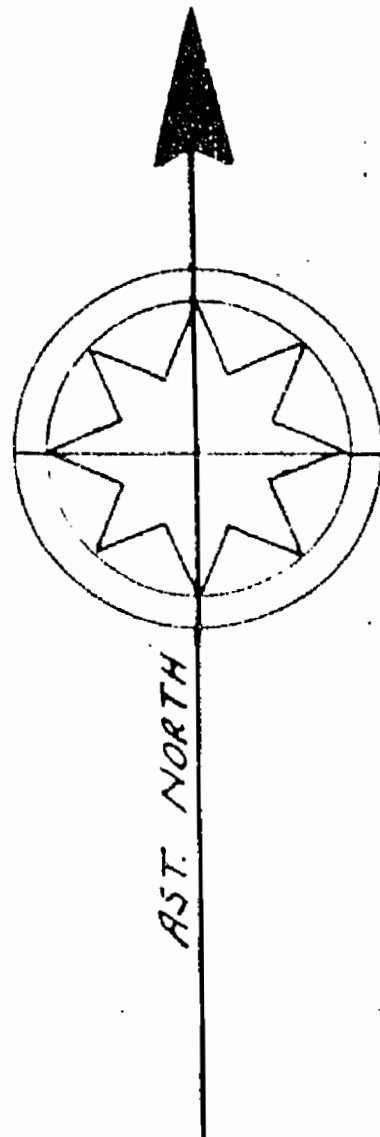

THE WEST BOUNDARY OF LAC SEUL INDIAN RESERVE No 28 RE ESTABLISHED BY H. KLINKENBERG, D AND O.L.S., 1952. DEPARTMENT OF LANDS AND FORESTS FILE 78039.

PATRICIA MINING DIV. RECEIVED JUN 16 1966 AN 78010,11,12,123,4,6,8 PH

INDIAN RESERVE No. 28.

LOST LAKE.

G.T.P. BLOCK 10.

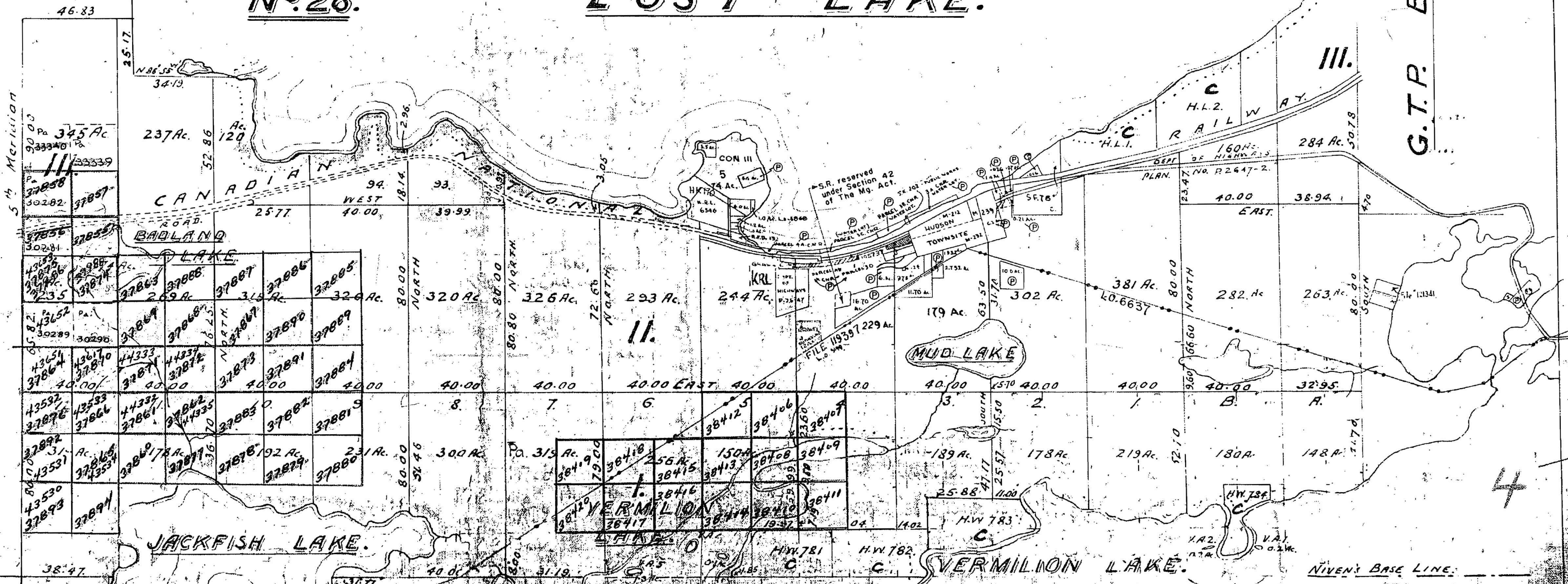

PATRICIA MINING DIV. RECEIVED JUN 16 1966 AN 78010,11,12,123,4,6,8 PH

LOMOND T.P.

VERMILION T.P.

2273

Dept. of Survey, Provincial Government, Toronto, Ontario, Canada

January 1965

02886

VERMILION ADDITIONAL.

DISTRICT OF KENORA.

Scale: 40 Chains = 1 Inch.

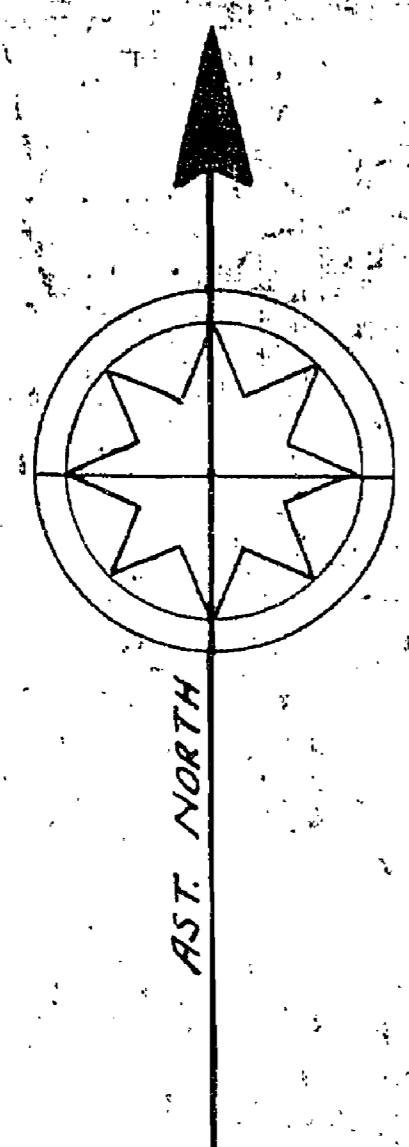

THE WEST BOUNDARY OF LAC SEUL INDIAN RESERVE No 28 RE-ESTABLISHED BY H. KLINKENBERG, D. AND O.L.S., 1952. DEPARTMENT OF LANDS AND FORESTS FILE 78039.

INDIAN RESERVE No 28.

LOST LAKE.

G.T.P. BLOCK 10.

PATRICIA MINING DIV. RECEIVED JUL 12 1968 AM 7 8 9 10 11 12 1 2 3 4 5 6 PM



LOMOND T.P.

VERMILION T.P.

M-2273

Dept. of Survey, Provincial Government, Toronto, Ontario, Canada

January 1955

62886

5

NOTES

400' surface rights reservation along the shores of all lakes and rivers.

AREAS WITHDRAWN FROM STAKING

Sec.	Order No.	Date	Disp.	File
43 (R.S.O. 1970)	W.14/72	16/2/72	S.R.	163474Vol3
42 (RSO 1960)	—	27/9/65	S.R.	116529
43 (R.S.O. 1970)	W.51/73	7/11/73	S.R.	105737 v.2
43 (R.S.O. 1970)	W.57	11/12/73	S.R.B.M.R.	105737 v.2
43 (R.S.O. 1970)	W.39/77	23/3/77	S.R.	136595

- M.N.R. GRAVEL PIT No.59 File 128770
- M.T.C. GRAVEL PIT No.1518
- GRAVEL FILE: 121543

- M.N.R. GRAVEL PIT NO. 190 FILE: 73361 Vol.4
- GRAVEL FILE: 73361
- GRAVEL FILE: 105469

July 16, 1980
 Sept 15, 1980
 Feb. 9, 1981
 Dec. 21, 1981

DATE OF ISSUE
 MAY 30 1978

DATE OF ISSUE
 1978

PATRICIA MINING DIV.
RECEIVED
 JUN 14 1978
 AM 7:30 PM 4:56

LEGEND

- HIGHWAY AND ROUTE No.
- OTHER ROADS
- TRAILS
- SURVEYED LINES:
 - TOWNSHIPS, BASE LINES, ETC.
 - LOTS, MINING CLAIMS, PARCELS, ETC.
- UNSURVEYED LINES:
 - LOT LINES
 - PARCEL BOUNDARY
 - MINING CLAIMS ETC.
- RAILWAY AND RIGHT OF WAY
- UTILITY LINES
- NON-PERENNIAL STREAM
- FLOODING OR FLOODING RIGHTS
- SUBDIVISION
- ORIGINAL SHORELINE
- MARSH OR MUSKEG
- MINES

DISPOSITION OF CROWN LANDS

TYPE OF DOCUMENT	SYMBOL
PATENT, SURFACE & MINING RIGHTS	●
" SURFACE RIGHTS ONLY	○
" MINING RIGHTS ONLY	◐
LEASE, SURFACE & MINING RIGHTS	■
" SURFACE RIGHTS ONLY	□
" MINING RIGHTS ONLY	◻
LICENCE OF OCCUPATION	▼
CROWN LAND SALE	CS.
ORDER-IN-COUNCIL	OC
RESERVATION	⊙
CANCELLED	⊖
SAND & GRAVEL	⊕

SCALE: 1 INCH = 40 CHAINS

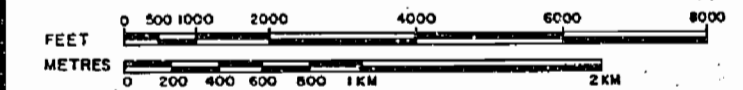

ACRES	HECTARES
40	16

TOWNSHIP
VERMILION ADDITIONAL
 DISTRICT
 KENORA #8
 MINING DIVISION
 PATRICIA

Ministry of Natural Resources
 Ontario Surveys and Mapping Branch

Date FEB 2, 73 Plan No. M.2273
 Whitney Block Queen's Park, Toronto

WHIPPER LAKE AREA M.2574

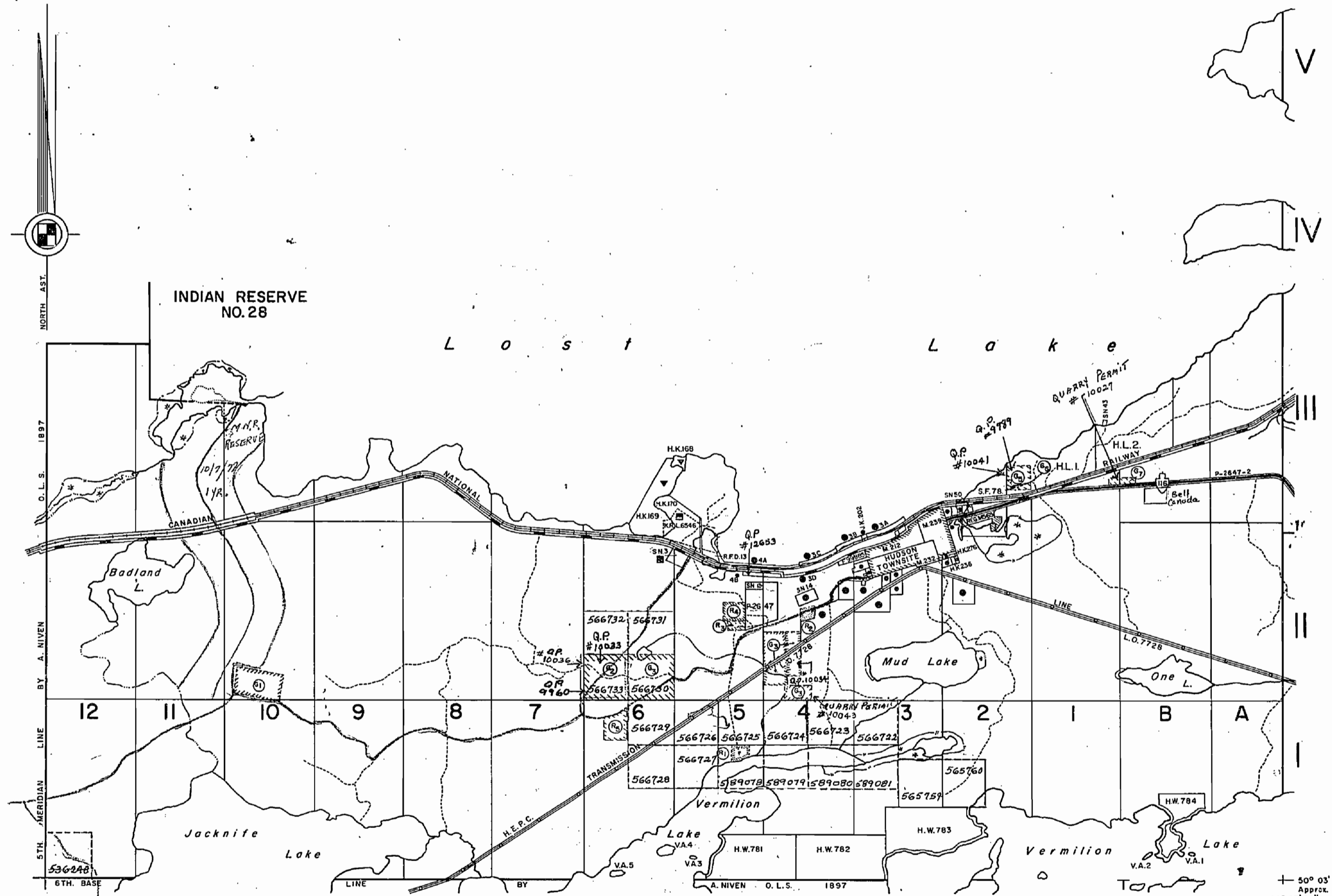

DRAYTON TP. M.2233 GTP BLOCK 10.

VERMILION TP. M.2272

JORDAN TP. M.2245

6-2886

NOTES

400' surface rights reservation along the shores of all lakes and rivers.

AREAS WITHDRAWN FROM STAKING

S.R. - Surface Rights		M.R. - Mining Rights		
Sec.	Order No.	Date	Disp.	File
43	(R.S.O. 1970) W.14/72	16/2/72	S.R.	163474 Vol.3
42	(R.S.O. 1960) -	27/9/65	S.R.	116529
43	(R.S.O. 1970) W.51/73	7/11/73	S.R.	105737 v.2
43	(R.S.O. 1970) W.57	11/12/73	S.R.&M.R.	105737 v.2
43	(R.S.O. 1970) W.39/77	23/3/77	S.R.	136595

- ① M.N.R. GRAVEL PIT No 59 File 128770
- ② M.T.C. GRAVEL PIT No 1518
- ③ GRAVEL FILE: 121543
- ④ M.T.C. GRAVEL PIT No IF-36
- ⑤ M.N.R. GRAVEL PIT NO. 190 FILE: 73361 Vol.4
- ⑥ GRAVEL FILE: 73361
- ⑦ GRAVEL FILE: 105469
- ⑧ QUARRY PERMIT
- ⑨ M.T.C. PIT No IF-37

#9

Ministry of Natural Resources
TORONTO
JAN 25 1982
DATE OF ISSUE

LEGEND

- HIGHWAY AND ROUTE No.
- OTHER ROADS
- TRAILS
- SURVEYED LINES:
TOWNSHIPS, BASE LINES, ETC.
- LOTS, MINING CLAIMS, PARCELS, ETC.
- UNSURVEYED LINES:
LOT LINES
- PARCEL BOUNDARY
- MINING CLAIMS ETC.
- RAILWAY AND RIGHT OF WAY
- UTILITY LINES
- NON-PERENNIAL STREAM
- FLOODING OR FLOODING RIGHTS
- SUBDIVISION
- ORIGINAL SHORELINE
- MARSH OR MUSKEG
- MINES

DISPOSITION OF CROWN LANDS

TYPE OF DOCUMENT	SYMBOL
PATENT, SURFACE & MINING RIGHTS	●
" SURFACE RIGHTS ONLY	○
" MINING RIGHTS ONLY	◐
LEASE, SURFACE & MINING RIGHTS	■
" SURFACE RIGHTS ONLY	◼
" MINING RIGHTS ONLY	◻
LICENCE OF OCCUPATION	▼
CROWN LAND SALE	C.S.
ORDER-IN-COUNCIL	OC
RESERVATION	⊙
CANCELLED	⊗
SAND & GRAVEL	⊕

SCALE: 1 INCH = 40 CHAINS

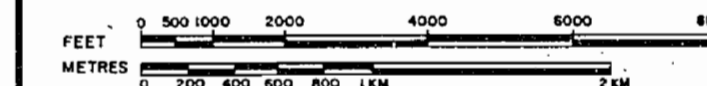

ACRES	HECTARES
40	16

TOWNSHIP
**VERMILION
ADDITIONAL**
DISTRICT
KENORA
MINING DIVISION
PATRICIA

Ministry of Natural Resources
Ontario Surveys and Mapping Branch
Date FEB 2, 73 Plan No.
Whitney Block Queen's Park, Toronto
M.2273

WHIPPER LAKE AREA M.2574

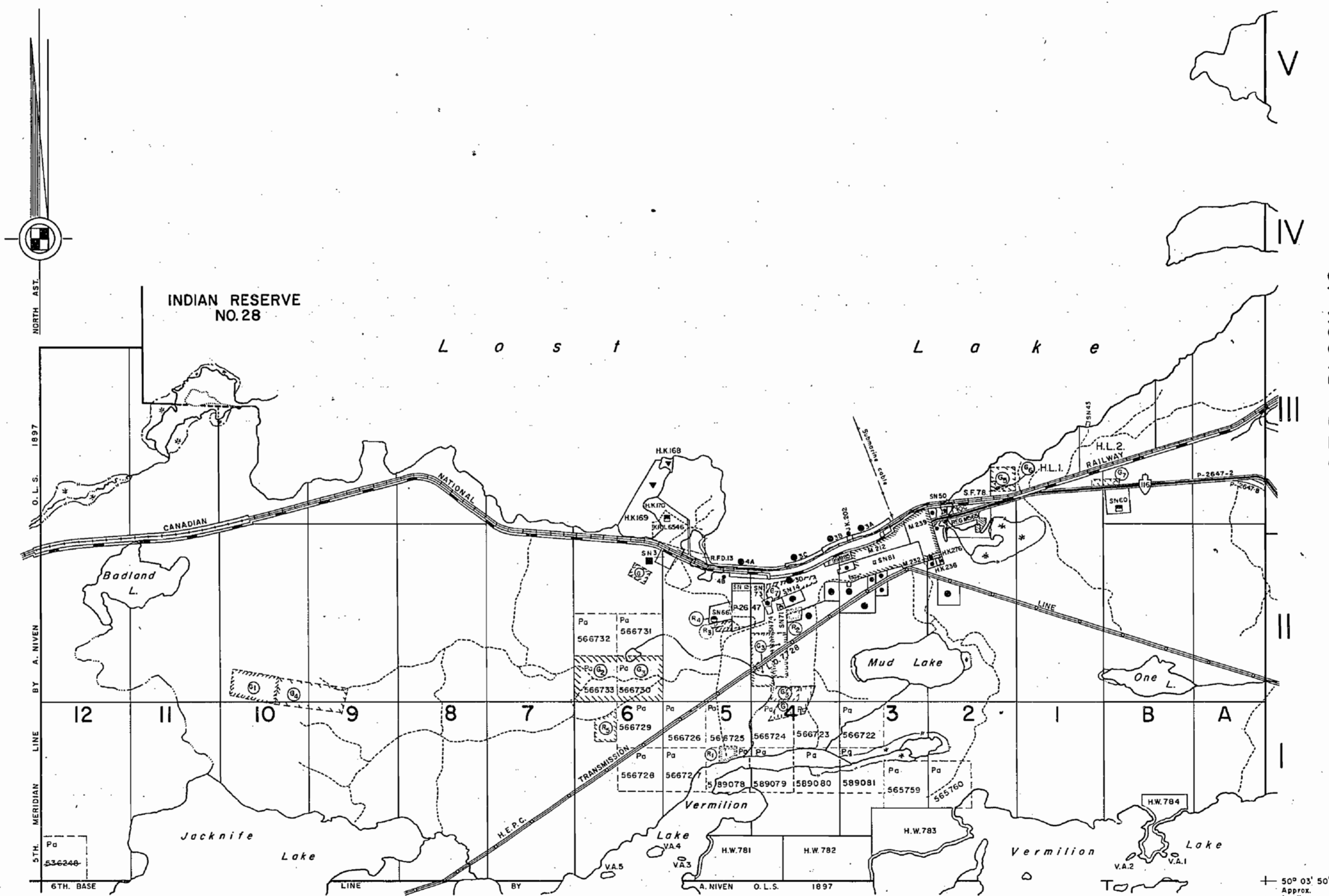

VERMILION TP. M.2272

JORDAN TP. M.2245

DRAYTON TP. M.2233 GTP BLOCK 10.

G-2886

NOTES

10' surface rights reservation along the shores of all lakes and rivers.

AREAS WITHDRAWN FROM STAKING

Surface Rights	M.R. - Mining Rights
Sec.	Order No. Date Disp. File
RSO 1970)	W.14/72 16/2/72 S.R. 163474 Vol.3
RSO 1970)	W.39/77 23/3/77 S.R. 136595

M.N.R. GRAVEL PIT No 59 File 128770
 I.T.C. GRAVEL PIT No 1518
 GRAVEL FILE: 121543
 I.T.C. GRAVEL PIT No 1F-36
 M.N.R. GRAVEL PIT NO. 190 FILE: 73361 Vol.4
 GRAVEL FILE: 73361

UARRY PERMIT
 I.T.C. PIT No 1F-37
 28, 1983
 31184

LEGEND

- HIGHWAY AND ROUTE No.
- OTHER ROADS
- TRAILS
- SURVEYED LINES:
 - TOWNSHIPS, BASE LINES, ETC.
 - LOTS, MINING CLAIMS, PARCELS, ETC.
- UNSURVEYED LINES:
 - LOT LINES
 - PARCEL BOUNDARY
 - MINING CLAIMS ETC.
- RAILWAY AND RIGHT OF WAY
- UTILITY LINES
- NON-PERENNIAL STREAM
- FLOODING OR FLOODING RIGHTS
- SUBDIVISION
- ORIGINAL SHORELINE
- MARSH OR MUSKEG
- MINES

DISPOSITION OF CROWN LANDS

TYPE OF DOCUMENT	SYMBOL
PATENT, SURFACE & MINING RIGHTS	
" SURFACE RIGHTS ONLY	
" MINING RIGHTS ONLY	
LEASE, SURFACE & MINING RIGHTS	
" SURFACE RIGHTS ONLY	
" MINING RIGHTS ONLY	
LICENCE OF OCCUPATION	
CROWN LAND SALE	C.S.
ORDER-IN-COUNCIL	OC
RESERVATION	
CANCELLED	
SAND & GRAVEL	

SCALE: 1 INCH = 40 CHAINS

ACRES	HECTARES
40	16

TOWNSHIP
VERMILION ADDITIONAL
 DISTRICT
 KENORA
 MINING DIVISION
 PATRICIA

Ministry of Natural Resources
 Ontario Surveys and Mapping Branch
 Date FEB 2, 73 Plan No. M.2273
 Whitney Block Queen's Park, Toronto

LOST LAKE G-2106

WHIPPER LAKE AREA M.2271A

DRAYTON TP. M.2233 G.T.P. BLOCK 10.

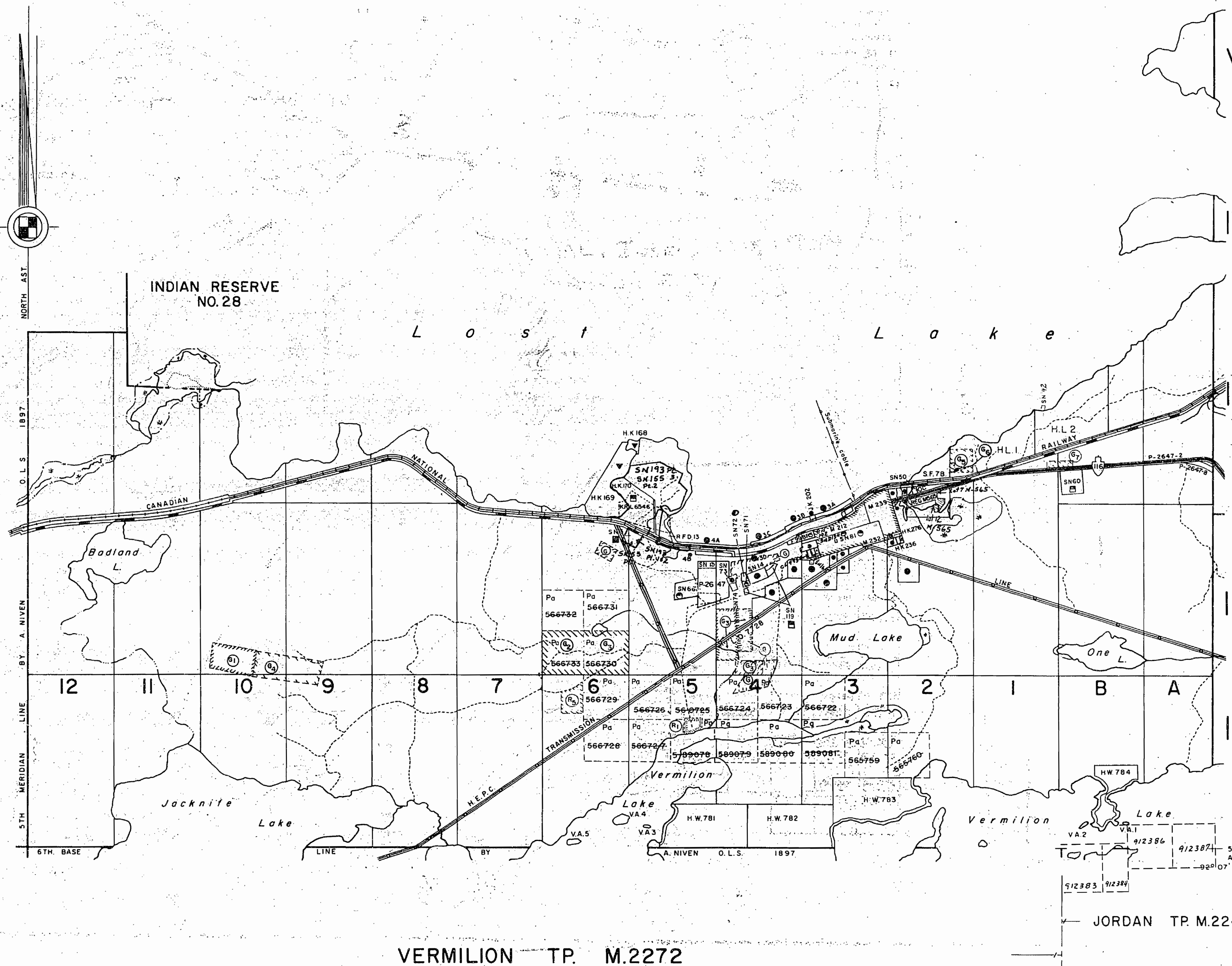

VERMILION TP. M.2272

JORDAN TP. M.2245

G-2886

NOTES

400' surface rights reservation along the shores of all lakes and rivers.

AREAS WITHDRAWN FROM STAKING

S.R. - Surface Rights M.R. - Mining Rights

Sec.	Order No.	Date	Disp.	File
43 (R.S.O. 1970)	W.14/72	16/2/72	S.R.	163474 Vol.3
43 (R.S.O. 1970)	W.39/77	23/3/77	S.R.	136595

- ① M.N.R. GRAVEL PIT No.59 File 128770
- ② M.T.C. GRAVEL PIT No.1518
- ③ GRAVEL FILE: 121543
- ④ M.T.C. GRAVEL PIT No. 1F-36
- ⑤ M.N.R. GRAVEL PIT NO. 190 FILE: 73361 Vol.4
- ⑥ GRAVEL FILE: 73361

- ⑦ QUARRY PERMIT
- ⑧ M.T.C. PIT No. 1F-37

Oct 28, 1983
Dec. 31/84
Jan 14/90
Aug 14/90
April 4/93

*New map received
94 SEP 80*

FOREST ACTIVITY INFORMATION
THIS TOWNSHIP/AREA FALLS WITHIN THE

CROWN FOREST MGT. UNIT

AND MAY BE SUBJECT TO FORESTRY OPERATIONS. THE M.N.R. UNIT FORESTER FOR THIS AREA CAN BE CONTACTED AT:

P.O. BOX 309
SIOUX LOOKOUT, ONTARIO P0V 2T0
(807) 737-1140

LEGEND

THE INFORMATION THAT APPEARS ON THIS MAP HAS BEEN COMPILED FROM VARIOUS SOURCES AND ACCURACY IS NOT GUARANTEED. THOSE WISHING TO STAKE MINING CLAIMS SHOULD CONSULT WITH THE MINING RECORDER, MINISTRY OF NORTHERN DEVELOPMENT AND MINES, FOR ADDITIONAL INFORMATION ON THE STATUS OF THE LANDS SHOWN HEREON.

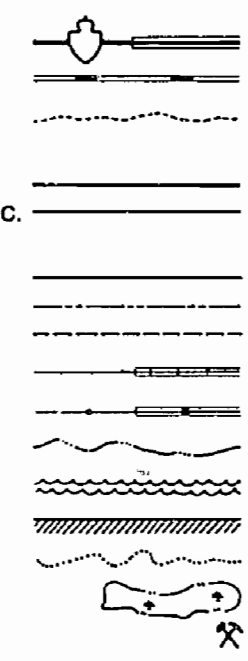

DISPOSITION OF CROWN LANDS

TYPE OF DOCUMENT	SYMBOL
PATENT, SURFACE & MINING RIGHTS	●
" SURFACE RIGHTS ONLY	○
" MINING RIGHTS ONLY	⊙
LEASE, SURFACE & MINING RIGHTS	■
" SURFACE RIGHTS ONLY	□
" MINING RIGHTS ONLY	⊠
LICENCE OF OCCUPATION	▽
CROWN LAND SALE	C.S.
ORDER-IN-COUNCIL	OC
RESERVATION	⊕
CANCELLED	⊖
SAND & GRAVEL	⊗

March 1984
March 1970

LAND USE PERMIT # SEWAGE DISPOSAL

SCALE: 1 INCH = 40 CHAINS

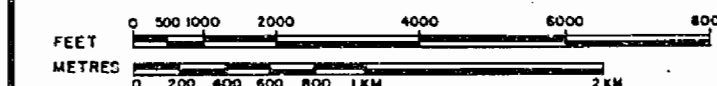

ACRES	HECTARES
40	16

TOWNSHIP
**VERMILION
ADDITIONAL**

DISTRICT
KENORA

MINING DIVISION

PATRICIA

PLAN NO. **G-2886**

Ministry of Natural Resources

Ontario Surveys and Mapping Branch

Date **FEB 2, 73**

Plan No.

Whitney Block
Queen's Park, Toronto

M.2273

LOST LAKE G-2106

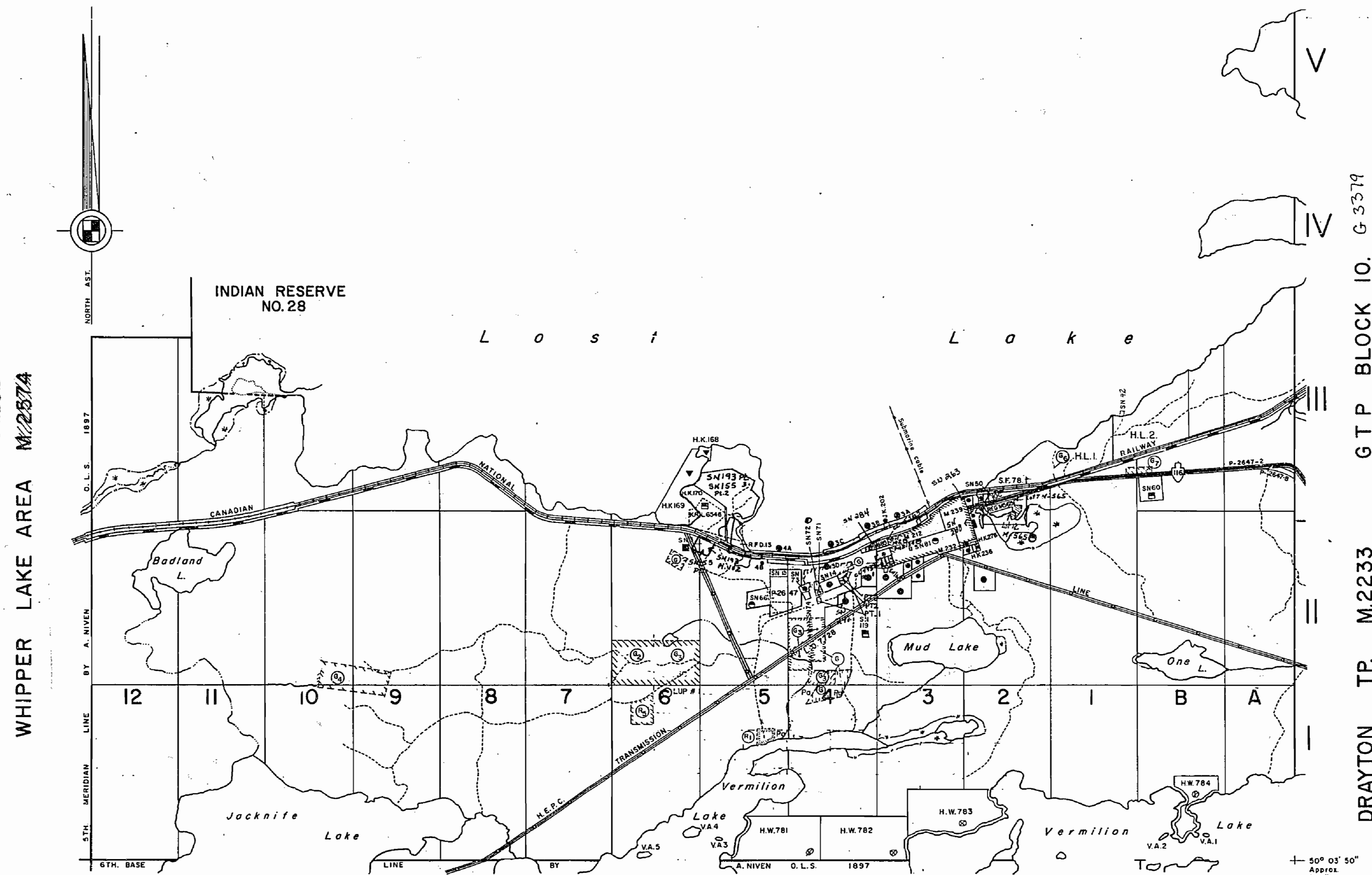

VERMILION TP. (M.2272) G-2887

DRAYTON TP. M.2233 GTP BLOCK 10. G-3379

WHIPPER LAKE AREA M.2874 G-2262

NOTES

400' surface rights reservation along the shores of all lakes and rivers.

AREAS WITHDRAWN FROM DISPOSITION

- M.R.O. - MINING RIGHTS ONLY
- S.R.O. - SURFACE RIGHTS ONLY
- M.+S. - MINING AND SURFACE RIGHTS

Description	Order No.	Date	Disposition	File
43(R.S.O.1970)	W.14/72	16/2/72	S.R.O.	163474 Vol.3
43(R.S.O.1960)	W.14/72	27/5/65	S.R.O.	118522
43(R.S.O.1970)	W.51/73	7/11/73	S.R.O.	105737 Vol.2
43(R.S.O.1970)	W.57	11/12/73	S.R.O.	105737 Vol.2
43(R.S.O.1970)	W.39/77	23/3/77	S.R.O.	136595

LEGEND

- HIGHWAY AND ROUTE No.
- OTHER ROADS
- TRAILS
- SURVEYED LINES:
 - TOWNSHIPS, BASE LINES, ETC
 - LOTS, MINING CLAIMS, PARCELS, ETC
- UNSURVEYED LINES:
 - LOT LINES
 - PARCEL BOUNDARY
 - MINING CLAIMS ETC
- RAILWAY AND RIGHT OF WAY
- UTILITY LINES
- NON-PERENNIAL STREAM
- FLOODING OR FLOODING RIGHTS
- SUBDIVISION
- ORIGINAL SHORELINE
- MARSH OR MUSKEG
- MINES

DISPOSITION OF CROWN LANDS

TYPE OF DOCUMENT	SYMBOL
PATENT, SURFACE & MINING RIGHTS	
" SURFACE RIGHTS ONLY	
" MINING RIGHTS ONLY	
LEASE, SURFACE & MINING RIGHTS	
" SURFACE RIGHTS ONLY	
" MINING RIGHTS ONLY	
LICENCE OF OCCUPATION	
CROWN LAND SALE	CS
ORDER-IN-COUNCIL	OC
RESERVATION	
CANCELLED	
SAND & GRAVEL	

SCALE: 1 INCH = 40 CHAINS

FEET 0 500 1000 2000 4000 6000 8000

METRES 0 200 400 600 800 1000 2000

ACRES	HECTARES
40	16

TOWNSHIP
VERMILION
 ADDITIONAL
 DISTRICT
 KENORA
 MINING DIVISION
 PATRICIA

Ministry of Natural Resources
 Ontario Surveys and Mapping Branch
 Date FEB 2, 73 Plan No. Whitney Block Queen's Park, Toronto
G-2886

LOST LAKE AREA

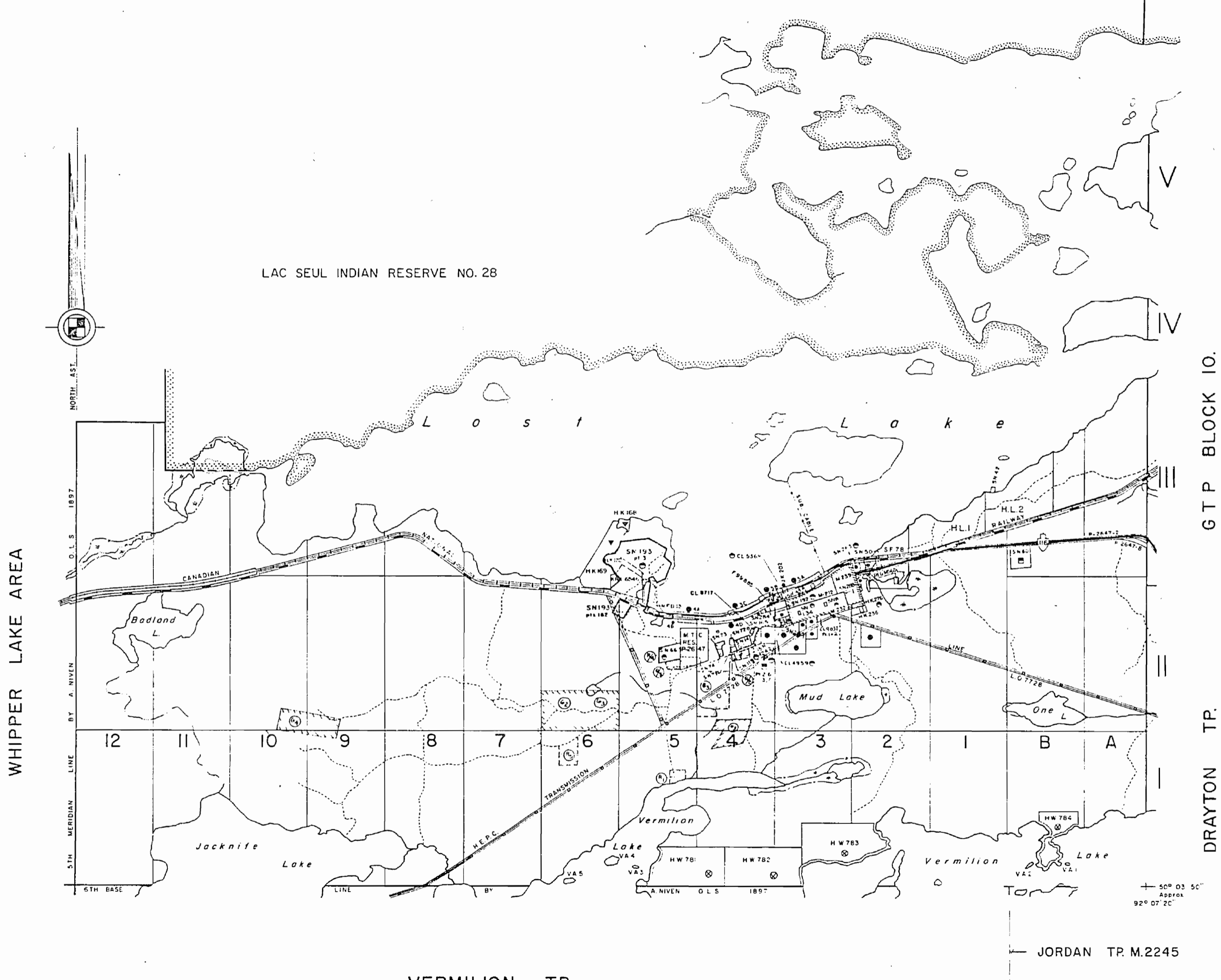

NOTES

400' surface rights reservation along the shores of all lakes and rivers.

AREAS WITHDRAWN FROM STAKING

S.R. - Surface Rights M.R. - Mining Rights

Sec.	Order No.	Date	Disp.	File
43 (RSO 1970)	W.14/72	16/2/72	S.R.	163474 Vol.3
43 (RSO 1970)	W.39/77	23/3/77	S.R.	136595

LOST LAKE G-2106

WHIPPER LAKE AREA M.2274
G-2262

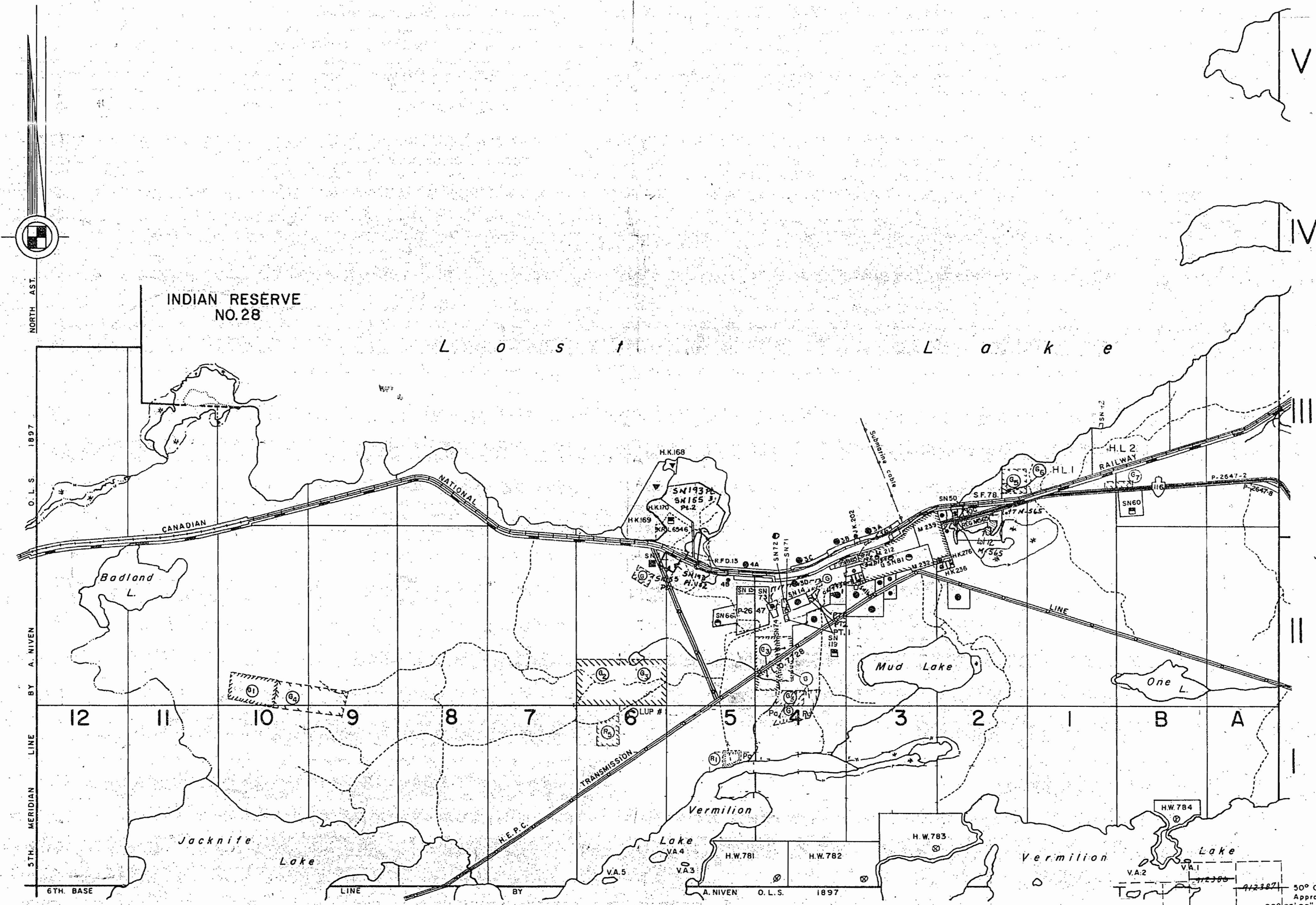

VERMILION TP. M.2272

JORDAN TP. M.2245

DRAYTON TP. M.2233
GTP BLOCK 10.

LEGEND

THE INFORMATION THAT APPEARS ON THIS MAP HAS BEEN COMPILED FROM VARIOUS SOURCES AND ACCURACY IS NOT GUARANTEED. THOSE WISHING TO STAKE MINING CLAIMS SHOULD CONSULT WITH THE MINING RECORDER, MINISTRY OF NORTHERN DEVELOPMENT AND MINES, FOR ADDITIONAL INFORMATION ON THE STATUS OF THE LANDS SHOWN HEREON.

- HIGHWAY AND ROUTE No.
- OTHER ROADS
- TRAILS
- SURVEYED LINES: TOWNSHIPS, BASE LINES, ETC.
- UNSURVEYED LINES: LOT LINES
- PARCEL BOUNDARY
- MINING CLAIMS ETC.
- RAILWAY AND RIGHT OF WAY
- UTILITY LINES
- NON-PERENNIAL STREAM
- FLOODING OR FLOODING RIGHTS
- SUBDIVISION
- ORIGINAL SHORELINE
- MARSH OR MUSKEG
- MINES

DISPOSITION OF CROWN LANDS

TYPE OF DOCUMENT	SYMBOL
PATENT, SURFACE & MINING RIGHTS	
" SURFACE RIGHTS ONLY	
" MINING RIGHTS ONLY	
LEASE, SURFACE & MINING RIGHTS	
" SURFACE RIGHTS ONLY	
" MINING RIGHTS ONLY	
LICENCE OF OCCUPATION	
CROWN LAND SALE	CS
ORDER-IN-COUNCIL	OC
RESERVATION	
CANCELLED	
SAND & GRAVEL	
LAND USE PERMIT # SEWAGE DISPOSAL	

SCALE: 1 INCH = 40 CHAINS

FEET: 0 500 1000 2000 4000 6000 8000

METRES: 0 200 400 600 800 1000 2000

ACRES	HECTARES
40	16

TOWNSHIP
VERMILION ADDITIONAL

DISTRICT
KENORA

MINING DIVISION
PATRICIA

PLAN NO. G-2886

Ministry of Natural Resources
Ontario Surveys and Mapping Branch

Date FEB 2, 73
Whitney Block
Queen's Park, Toronto

Plan No. **M.2273**

VERMILION ADDITIONAL.

DISTRICT OF KENORA.

Scale: 40 Chains = 1 Inch.

M.2273

ONTARIO

DEPARTMENT OF MINES
AND NORTHWESTERN DEVELOPMENT

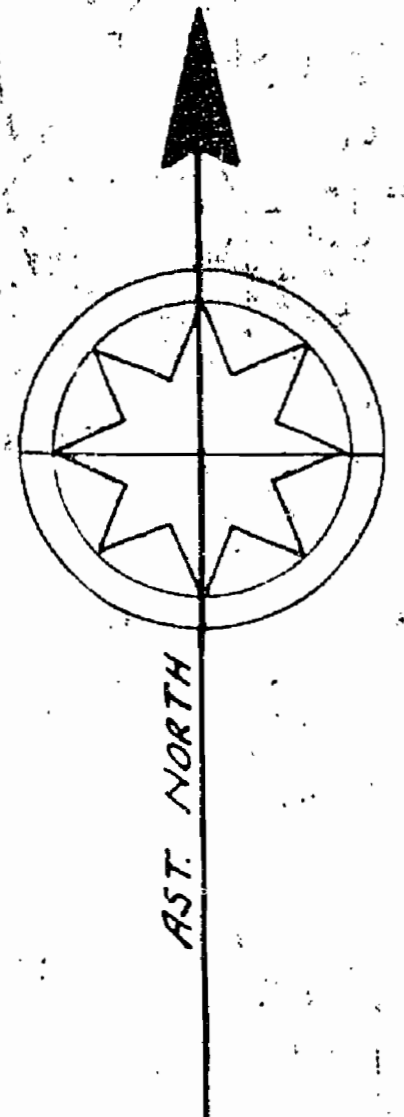

THE WEST BOUNDARY OF LAC SEUL INDIAN RESERVE No 28
RE-ESTABLISHED BY H. KLINKENBERG, D AND O.L.S. 1952.
DEPARTMENT OF LANDS AND FORESTS FILE 78039.

INDIAN RESERVE

No. 28.

LOST LAKE.

G.T.P. BLOCK 10.



Areas withdrawn from staking under Section 43 of the Mining Act, R.S.O. 1970

File	Date	Disposition
10547	1971	S.R.O.

Dept. of Survey
Provincial Government
Toronto, Ontario, Canada

January 1935

Surveyed by R. E. Dymos O.L.S. 1934.

G2886 #6

NOTES

400' surface rights reservation along the shores of all lakes and rivers.

AREAS WITHDRAWN FROM STAKING

S.R. - Surface Rights M.R. - Mining Rights

Sec.	Order No.	Date	Disp.	File
43 (RSO 1970)	W.14/72	16/2/72	S.R.	163474 Vol.3
42 (RSO 1960)	—	27/9/65	S.R.	116529
43 (RSO 1970)	W.5/73	7/11/73	S.R.	7598.2
43 (RSO 1970)	W.5/73	12/11/73	S.R.	105737 Vol.2
43 (RSO 1970)	W.5/73	23/1/77	S.R.	103737 Vol.2
43 (RSO 1970)	W.5/73	23/1/77	S.R.	134595

- ① M.N.R. GRAVEL PIT No 59 File 128770
- ② M.T.C. GRAVEL PIT No 1518
- ③ GRAVEL FILE 121543
- ④ GRAVEL FILE 121543
- ⑤ M.N.R. GRAVEL PIT NO 190 FILE 73361 VOL 4
- ⑥ GRAVEL FILE 73361
- ⑦ GRAVEL FILE 105469

LEGEND

HIGHWAY AND ROUTE No.	
OTHER ROADS	
TRAILS	
SURVEYED LINES:	
TOWNSHIPS, BASE LINES, ETC.	
LOTS, MINING CLAIMS, PARCELS, ETC.	
UNSURVEYED LINES:	
LOT LINES	
PARCEL BOUNDARY	
MINING CLAIMS ETC.	
RAILWAY AND RIGHT OF WAY	
UTILITY LINES	
NON-PERENNIAL STREAM	
FLOODING OR FLOODING RIGHTS	
SUBDIVISION	
ORIGINAL SHORELINE	
MARSH OR MUSKEG	
MINES	

DISPOSITION OF CROWN LANDS

TYPE OF DOCUMENT	SYMBOL
PATENT, SURFACE & MINING RIGHTS	
" SURFACE RIGHTS ONLY	
" MINING RIGHTS ONLY	
LEASE, SURFACE & MINING RIGHTS	
" SURFACE RIGHTS ONLY	
" MINING RIGHTS ONLY	
LICENCE OF OCCUPATION	
CROWN LAND SALE	
ORDER-IN-COUNCIL	
RESERVATION	
CANCELLED	
SAND & GRAVEL	

SCALE: 1 INCH = 40 CHAINS

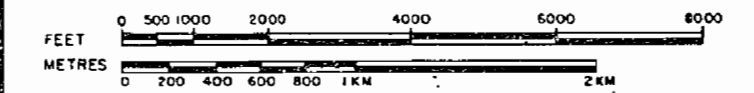

ACRES	HECTARES
40	16

TOWNSHIP
VERMILION ADDITIONAL
DISTRICT
KENORA
MINING DIVISION
PATRICIA

Ontario Ministry of Natural Resources
Surveys and Mapping Branch
Date FEB 2, 73
Plan No. M.2273
Whitney Block
Queen's Park, Toronto

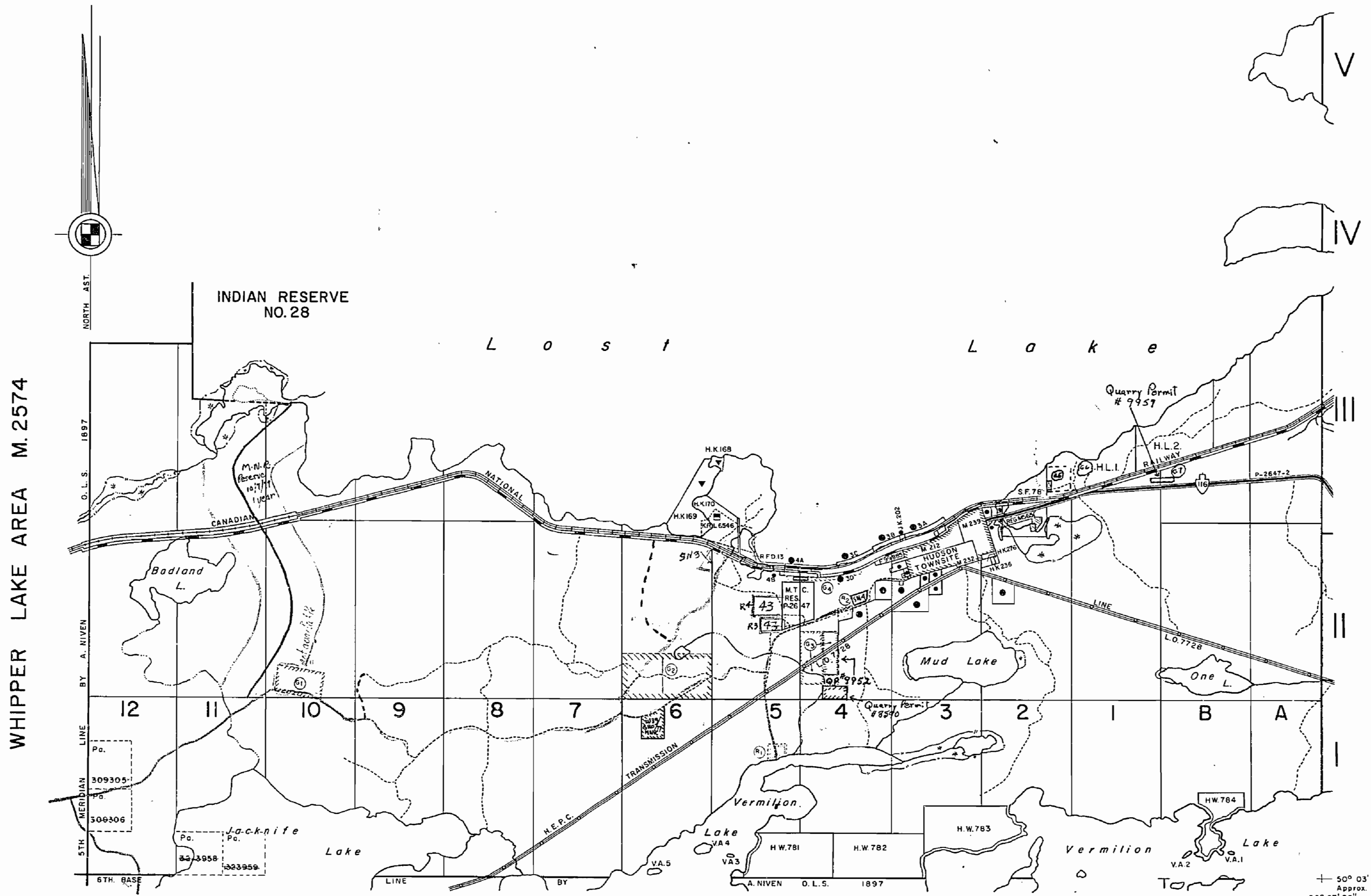

WHIPPER LAKE AREA M.2574

DRAYTON TP. M.2233 G.T.P. BLOCK 10.

VERMILION TP. M.2272

JORDAN TP. M.2245

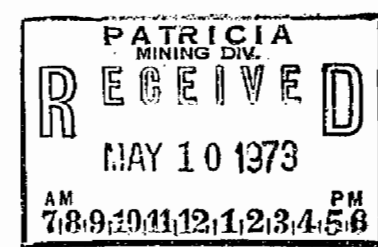

G2886

NOTES

rights reservation along the shores of rivers.

WITHDRAWN FROM STAKING

rights M.R. - Mining Rights

Order No.	Date	Disp.	File
1/72	16/2/72	S.R.	163474 Vol.3

3/77	23/3/77	S.R.	136595
------	---------	------	--------

PIT No.59 File 128770

PIT No.1518

21543

IT N° IF-36

T NO. 190 FILE: 73361 Vol.4

1361

11T

F-37

WHIPPER LAKE AREA M.2262
M.257A

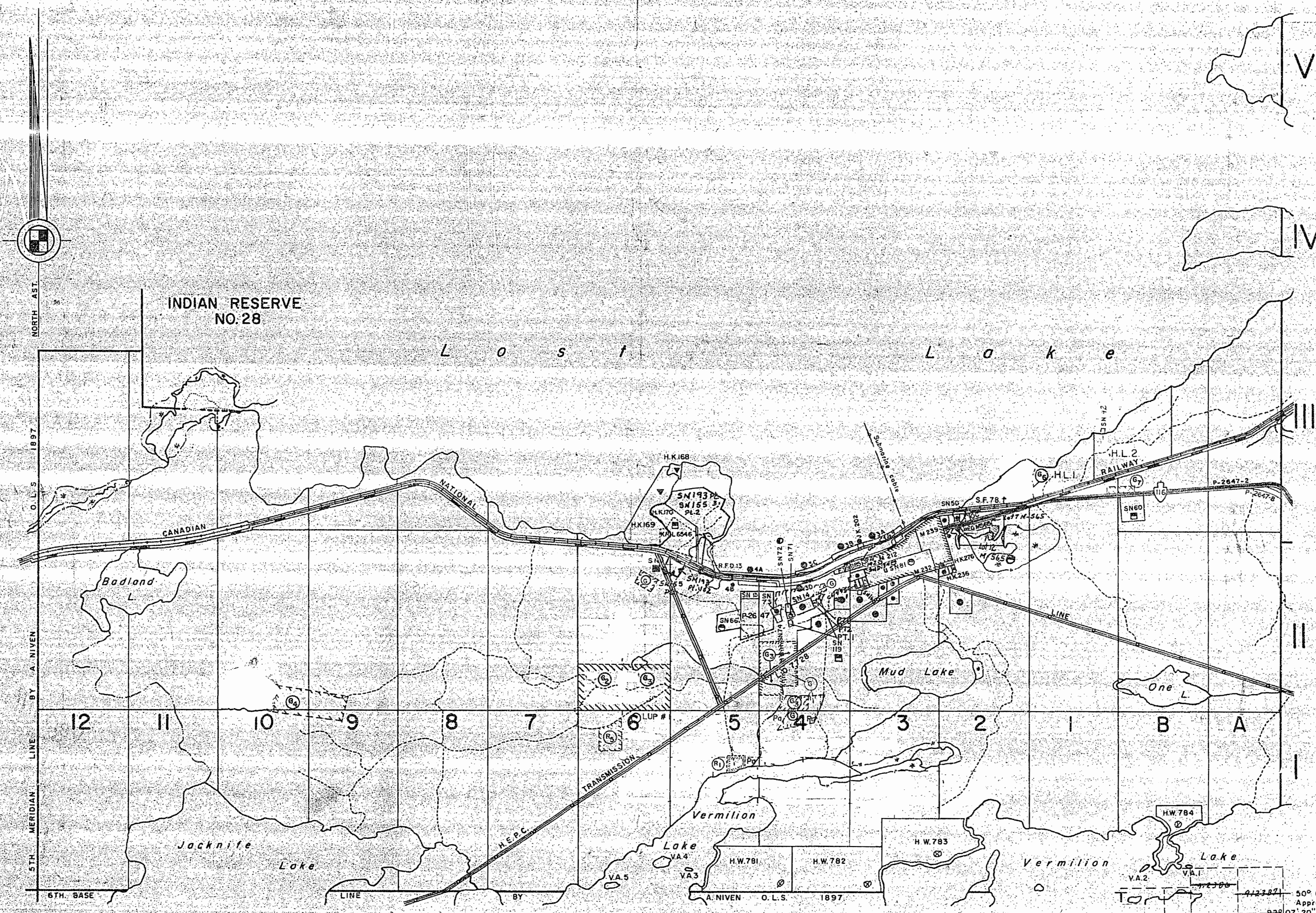

LOST LAKE G-2106



LEGEND

- THE INFORMATION THAT APPEARS ON THIS MAP HAS BEEN COMPILED FROM VARIOUS SOURCES AND ACCURACY IS NOT GUARANTEED. THOSE WISHING TO STAKE MINING CLAIMS SHOULD CONSULT WITH THE MINING RECORDER, MINISTRY OF NORTHERN DEVELOPMENT AND MINES, FOR ADDITIONAL INFORMATION ON THE STATUS OF THE LANDS SHOWN HEREON.
- HIGHWAY AND ROUTE No.
 - OTHER ROADS
 - TRAILS
 - SURVEYED LINES:
 - TOWNSHIPS, BASE LINES, ETC.
 - LOTS, MINING CLAIMS, PARCELS, ETC.
 - UNSURVEYED LINES:
 - LOT LINES
 - PARCEL BOUNDARY
 - MINING CLAIMS ETC.
 - RAILWAY AND RIGHT OF WAY
 - UTILITY LINES
 - NON-PERENNIAL STREAM
 - FLOODING OR FLOODING RIGHTS
 - SUBDIVISION
 - ORIGINAL SHORELINE
 - MARSH OR MUSKEG
 - MINES

DISPOSITION OF CROWN LANDS

TYPE OF DOCUMENT	SYMBOL
PATENT, SURFACE & MINING RIGHTS	
" SURFACE RIGHTS ONLY	
" MINING RIGHTS ONLY	
LEASE, SURFACE & MINING RIGHTS	
" SURFACE RIGHTS ONLY	
" MINING RIGHTS ONLY	
LICENCE OF OCCUPATION	
CROWN LAND SALE	C.S.
ORDER-IN-COUNCIL	OC
RESERVATION	
CANCELLED	
SAND & GRAVEL	

March 1970

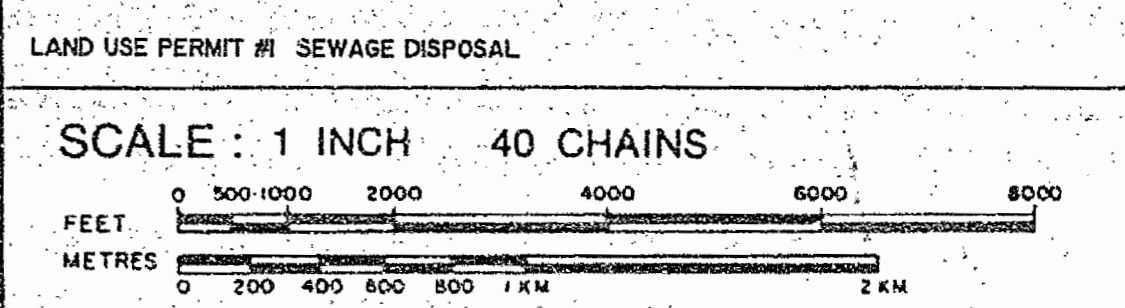

ACRES	HECTARES
40	16

TOWNSHIP
VERMILION ADDITIONAL

DISTRICT
KENORA

MINING DIVISION
PATRICIA

PLAN NO. G-2886

Ministry of Natural Resources
Ontario Surveys and Mapping Branch

Date FEB 2, 73 Plan No. M.2273

Whitney Block
Queen's Park, Toronto

JORDAN TP. M.2245

DRAYTON TP. M.2233
G.T.P. BLOCK 10.

VERMILION ADDITIONAL.

DISTRICT OF KENORA.

— Scale: 40 Chains = 1 Inch. —

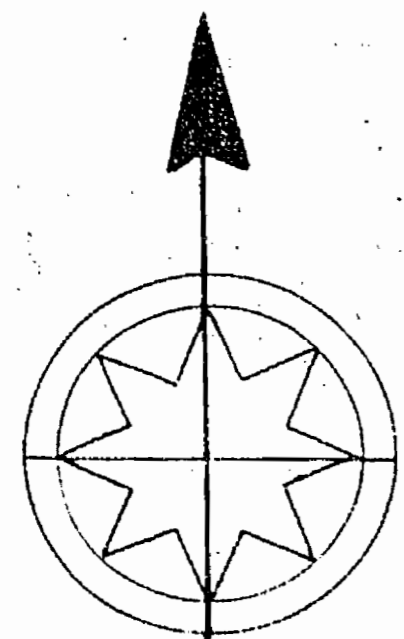

AST. NORTH

THE WEST BOUNDARY OF LAC SEUL INDIAN RESERVE No 28 RE-ESTABLISHED BY H. KLINCKENBERG, D. AND O.L.S. 1952. DEPARTMENT OF LANDS AND FORESTS FILE 78039.

INDIAN RESERVE No. 28.

OPEN FOR STAKING
7:00 AM. June 1-1966
SEE GAZETTE PAGES 1030-

K.R.L. 15806
15807
K. 7757
K. 7758
K.R.L. 31258
" 31259

A V.
30 Ac.

A IV
38 Ac.

G.T.P. BLOCK 10.



LOMOND T.P.

VERMILION T.P.

Dept. of Survey
Provincial Government
Toronto, Ontario, Canada

January 1935

62866

VERMILION ADDITIONAL.

DISTRICT OF KENORA.

Scale: 40 Chains = 1 Inch.

M-2273

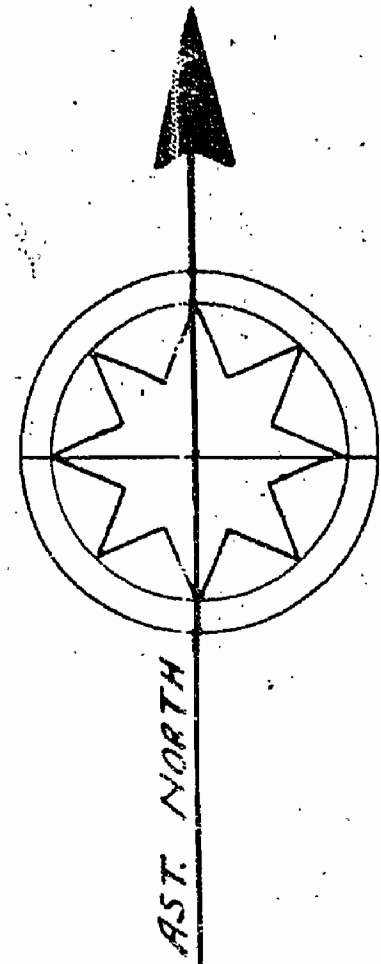

THE WEST BOUNDARY OF LAC SEUL INDIAN RESERVE No 28 RE-ESTABLISHED BY H. KLINKENBERG, D. AND O.L.S., 1952. DEPARTMENT OF LANDS AND FORESTS FILE 78039.

INDIAN RESERVE No. 28.

LOST LAKE.

G.T.P. BLOCK 10.



LOMOND TR.

VERMILION TR.

G2006

Dept. of Surveys
Provincial Government
Toronto, Ontario, Canada
January 1953

2273

Power Transmission Line from Eau Claire to St. Louis Lookout for the Hydro Electric Power Commission, 1942, O.L.S. File 115397. 100 Feet Surveyed by Harry D. Sewell, O.L.S., 1942. File 115397.

VERMILION ADDITIONAL.

DISTRICT OF KENORA.

Scale: 40 Chains = 1 Inch.

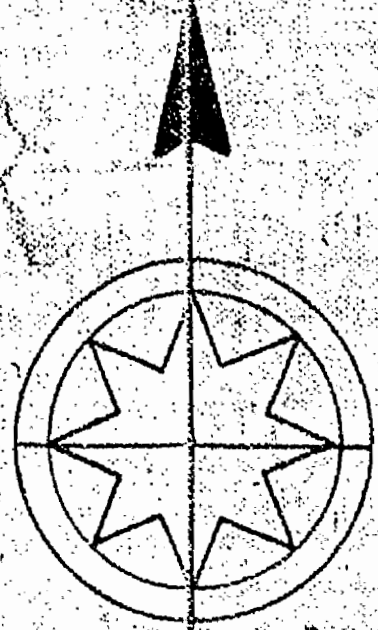

AST. NORTH

THE WEST BOUNDARY OF LAC SEUL INDIAN RESERVE No. 28
RE-ESTABLISHED BY H. KLINKENBERG, D. AND O.L.S., 1952.
DEPARTMENT OF LANDS AND FORESTS FILE 78039.

INDIAN RESERVE

No. 28.

LOST LAKE.

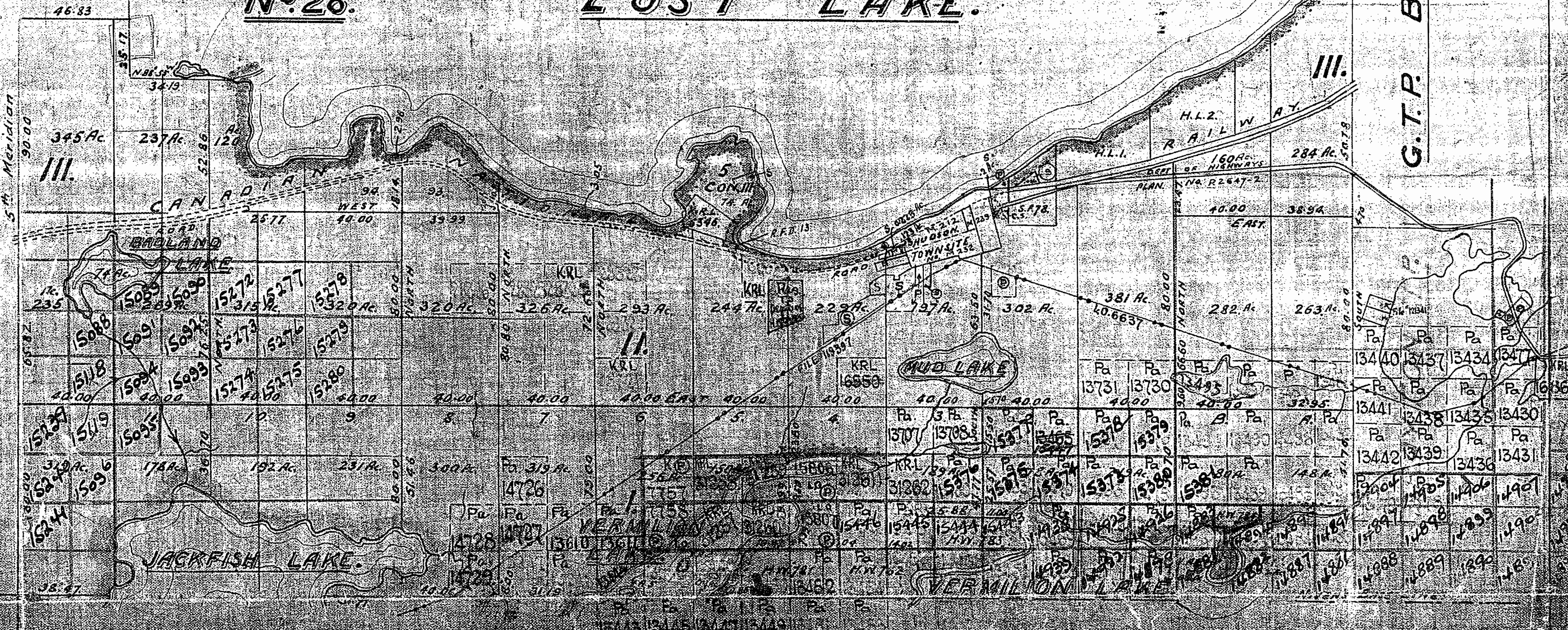

LOMOND T.P.

VERMILION T.P.

G.T.P. BLOCK 10.

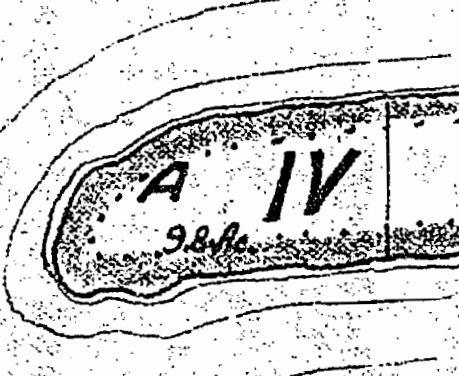
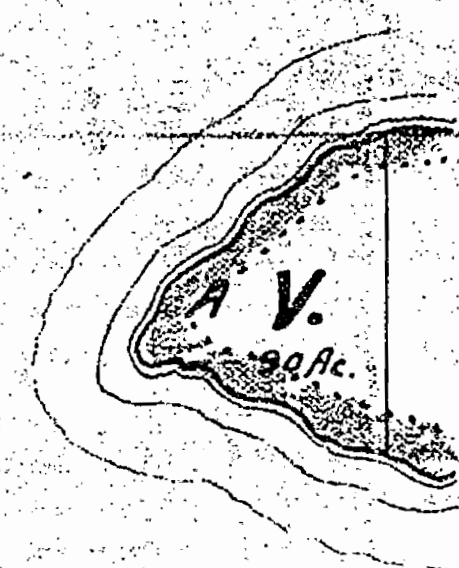

62000

NOTES

400' surface rights reservation along the shores of all lakes and rivers.

AREAS WITHDRAWN FROM DISPOSITION

M.R.O. - MINING RIGHTS ONLY
S.R.O. - SURFACE RIGHTS ONLY
M.+S. - MINING AND SURFACE RIGHTS

Description	Order No.	Date	Disposition	File
431R.S.O. 1970	W.14/72	16/2/72	S.R.O.	163474 Vol.3
431R.S.O. 1960	W.51/72	23/9/65	S.R.O.	110229
431R.S.O. 1970	W.51/72	7/11/73	S.R.O.	105737 Vol.2
431R.S.O. 1970	W.51	17/12/75	S.R.O.	105737 Vol.2
431R.S.O. 1970	W.35/77	23/3/77	S.R.O.	136595

LOST LAKE AREA

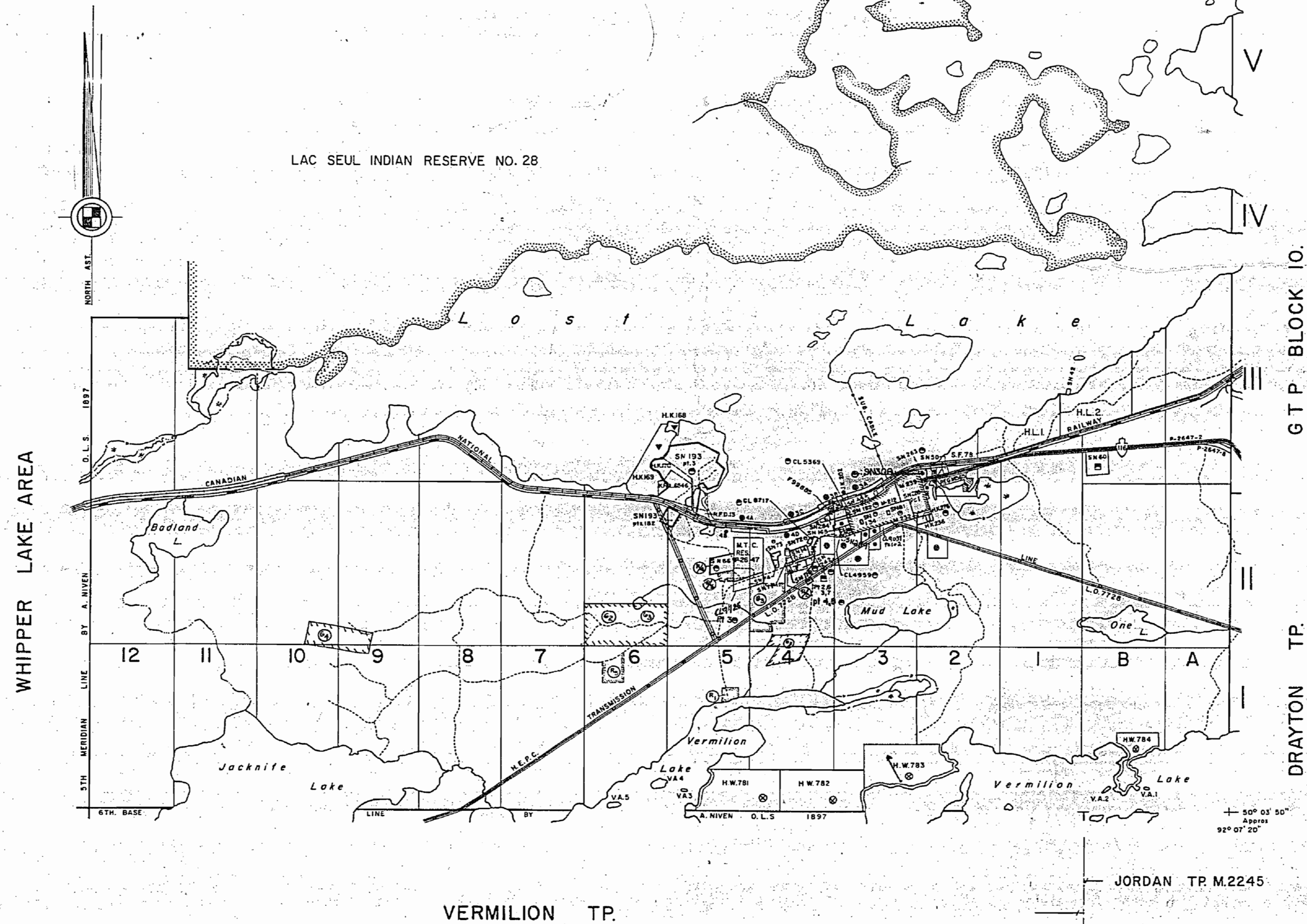

LAC SEUL INDIAN RESERVE NO. 28

LEGEND

- HIGHWAY AND ROUTE No.
- OTHER ROADS
- TRAILS
- SURVEYED LINES:
 - TOWNSHIPS, BASE LINES, ETC.
 - LOTS, MINING CLAIMS, PARCELS, ETC.
- UNSURVEYED LINES:
 - LOT LINES
 - PARCEL BOUNDARY
 - MINING CLAIMS ETC.
- RAILWAY AND RIGHT OF WAY
- UTILITY LINES
- NON-PERENNIAL STREAM
- FLOODING OR FLOODING RIGHTS SUBDIVISION
- ORIGINAL SHORELINE
- MARSH OR MUSKEG
- MINES

DISPOSITION OF CROWN LANDS

TYPE OF DOCUMENT	SYMBOL
PATENT, SURFACE & MINING RIGHTS	
" SURFACE RIGHTS ONLY	
" MINING RIGHTS ONLY	
LEASE, SURFACE & MINING RIGHTS	
" SURFACE RIGHTS ONLY	
" MINING RIGHTS ONLY	
LICENCE OF OCCUPATION	
CROWN LAND SALE	C.S.
ORDER-IN-COUNCIL	O.C.
RESERVATION	
CANCELLED	
SAND & GRAVEL	

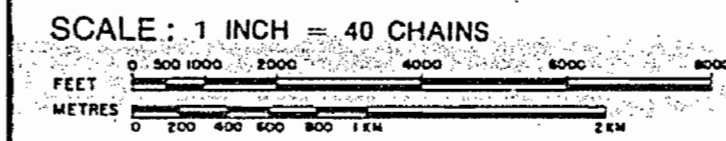

ACRES	HECTARES
40	16

TOWNSHIP
**VERMILION
ADDITIONAL**
DISTRICT
KENORA
MINING DIVISION
PATRICIA

Ministry of Natural Resources
Ontario Surveys and Mapping Branch
Date FEB 2, 73 Plan No. G-2886
Whitney Block, Queen's Park, Toronto

G-2886