

SURVEYS AND MAPPING BRANCH

Stephenson Twp.

Medora Twp.

Monck Twp.

J. P. v. K.

12

10

8

6

4

2



2

4

6

8

10

12



Cardwell Twp.

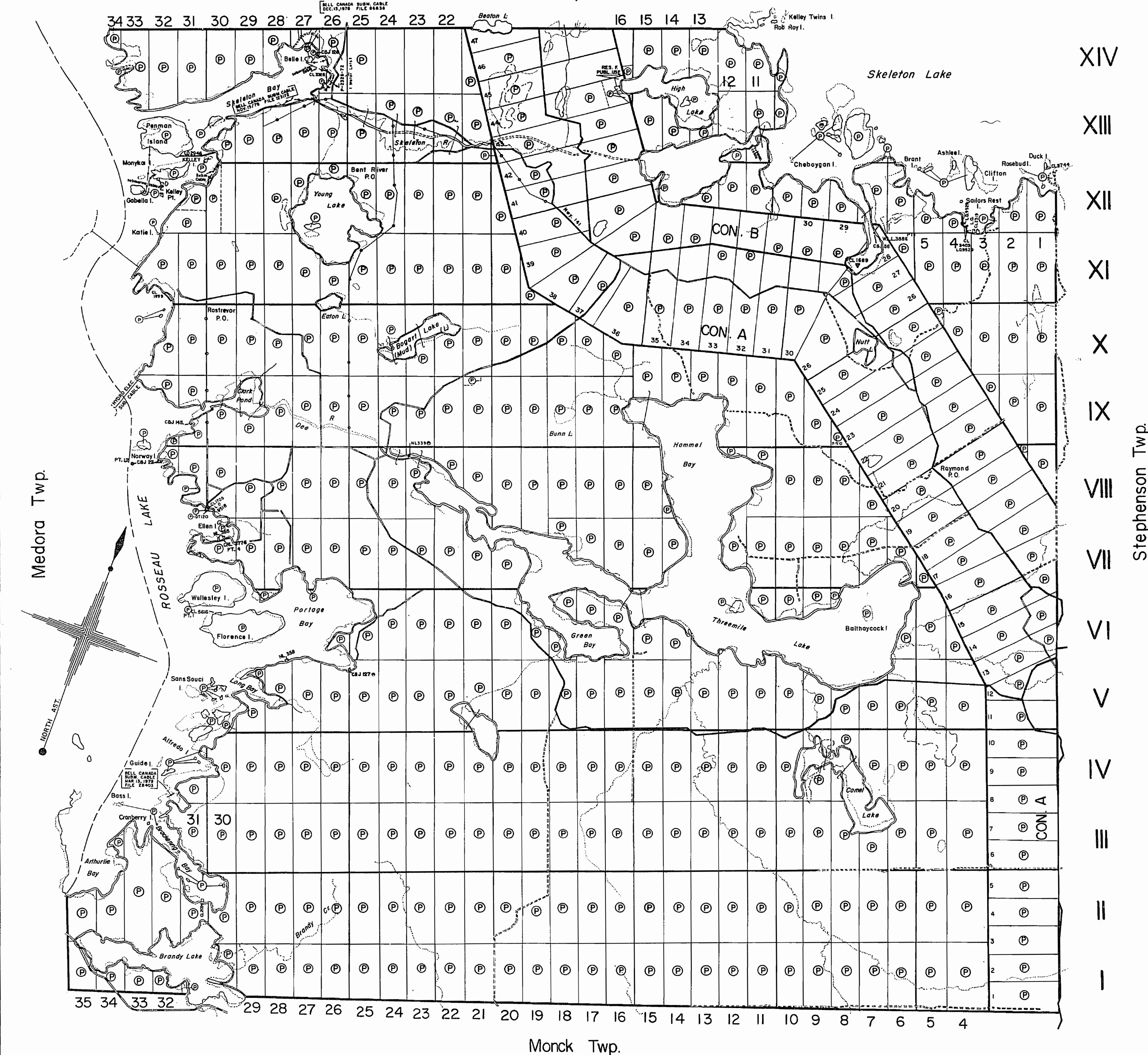

J.P.V.K.

THE TOWNSHIP  
OF**WATT**DISTRICT OF  
MUSKOKASOUTHERN ONTARIO  
MINING DIVISION

SCALE: 1-INCH = 40 CHAINS

**LEGEND**

PATENTED LAND	⊙
CROWN LAND SALE	C.S.
LEASES	⊖
LOCATED LAND	Loc.
LICENSE OF OCCUPATION	L.O.
MINING RIGHTS ONLY	M.R.O.
SURFACE RIGHTS ONLY	S.R.O.
ROADS	—
IMPROVED ROADS	—
KING'S HIGHWAYS	—
RAILWAYS	—
POWER LINES	—
MARSH OR MUSKEG	—
MINES	—
CANCELLED	—

**NOTES**

This Map Is Not To Be Used  
—FOR SURVEY PURPOSES—

Original shoreline shown thus: —  
F.R.I. shoreline shown thus: —

400' SURFACE RIGHTS RESERVATION  
AROUND ALL LAKES & RIVERS FOR L.F.

THE INFORMATION THAT  
APPEARS ON THIS MAP  
HAS BEEN COMPILED  
FROM VARIOUS SOURCES,  
AND ACCURACY IS NOT  
GUARANTEED. THOSE  
WISHING TO STAKE MIN-  
ING CLAIMS SHOULD CON-  
SULT WITH THE MINING  
RECORDER, MINISTRY OF  
NORTHERN DEVELOP-  
MENT AND MINES, FOR AD-  
DITIONAL INFORMATION  
ON THE STATUS OF THE  
LANDS SHOWN HEREON.

PLAN NO.- **M. 1670**

ONTARIO  
MINISTRY OF NATURAL RESOURCES  
SURVEYS AND MAPPING BRANCH



Cardwell Twp.

THE TOWNSHIP OF

WATT

DISTRICT OF MUSKOKA

EASTERN ONTARIO  
MINING DIVISION

SCALE: 1-INCH = 40 CHAINS

LEGEND

PATENTED LAND	Ⓟ
CROWN LAND SALE	C.S.
LEASES	Ⓛ
LOCATED LAND	Loc.
LICENSE OF OCCUPATION	L.O.
MINING RIGHTS ONLY	M.R.O.
SURFACE RIGHTS ONLY	S.R.O.
ROADS	—
IMPROVED ROADS	—
KING'S HIGHWAYS	—
RAILWAYS	—
POWER LINES	—
MARSH OR MUSKEG	—
MINES	—
CANCELLED	—

NOTES

This Map Is Not To Be Used  
—FOR SURVEY PURPOSES—

Original shoreline shown thus:  
F.R.I. shoreline shown thus:

400' SURFACE RIGHTS RESERVATION  
AROUND ALL LAKES & RIVERS FOR L.F.

DATE OF ISSUE  
FEB 1 1970  
ONTARIO DEPT. OF MINES

PLAN NO. M. 1670

DEPARTMENT OF MINES  
— ONTARIO —

XIV

XIII

XII

XI

X

IX

VIII

VII

VI

V

IV

III

II

I

Stephenson Twp.

Monck Twp.

Medora Twp.

34 33 32 31 30 29 28 27 26 25 24 23 22 16 15 14 13

35 34 33 32 29 28 27 26 25 24 23 22 21 20 19 18 17 16 15 14 13 12 11 10 9 8 7 6 5 4



Cardwell Twp.

THE TOWNSHIP OF

WATT

DISTRICT OF MUSKOKA

EASTERN ONTARIO MINING DIVISION

SCALE: 1-INCH = 40 CHAINS

LEGEND

PATENTED LAND	Ⓟ
CROWN LAND SALE	C.S.
LEASES	Ⓛ
LOCATED LAND	Loc.
LICENSE OF OCCUPATION	L.O.
MINING RIGHTS ONLY	M.R.O.
SURFACE RIGHTS ONLY	S.R.O.
ROADS	—
IMPROVED ROADS	—
KING'S HIGHWAYS	—
RAILWAYS	—
POWER LINES	—
MARSH OR MUSKEG	—
MINES	—
CANCELLED	—

NOTES

This Map Is Not To Be Used  
—FOR SURVEY PURPOSES—

Original shoreline shown thus:  
F.R.I. shoreline shown thus:

400' SURFACE RIGHTS RESERVATION  
AROUND ALL LAKES & RIVERS FOR L.F.

MINING LANDS -  
DATE OF ISSUE  
FEB 13 1973  
MINISTRY  
OF NATURAL RESOURCES

PLAN NO. M. 1670

ONTARIO  
DEPARTMENT OF MINES  
AND NORTHERN AFFAIRS

XIV

XIII

XII

XI

X

IX

VIII

VII

VI

V

IV

III

II

I

Stephenson Twp.

Monck Twp.

Medora Twp.

42 43 44 45 46 47 48 49 50 51 52 53 54 55 56 57 58 59 60 61 62 63 64 65 66 67 68 69 70 71 72 73 74 75 76 77 78 79 80 81 82 83 84 85 86 87 88 89 90 91 92 93 94 95 96 97 98 99 100 101 102 103 104 105 106 107 108



Cardwell Twp.

THE TOWNSHIP OF

**WATT**

DISTRICT OF MUSKOKA

EASTERN ONTARIO  
MINING DIVISION

SCALE: 1-INCH = 40 CHAINS

LEGEND

PATENTED LAND	Ⓟ
CROWN LAND SALE	C.S.
LEASES	Ⓛ
LOCATED LAND	Loc.
LICENSE OF OCCUPATION	L.O.
MINING RIGHTS ONLY	M.R.O.
SURFACE RIGHTS ONLY	S.R.O.
ROADS	—
IMPROVED ROADS	—
KING'S HIGHWAYS	—
RAILWAYS	—
POWER LINES	—
MARSH OR MUSKEG	—
MINES	⚡
CANCELLED	—

NOTES

This Map Is Not To Be Used  
—FOR SURVEY PURPOSES—

Original shoreline shown thus:  
F.R.I. shoreline shown thus:

400' SURFACE RIGHTS RESERVATION  
AROUND ALL LAKES & RIVERS FOR L.E.F.

MINING LANDS  
DATE OF ISSUE  
NOV 20 1975  
MINISTRY OF NATURAL RESOURCES

PLAN NO.- M. 1670

ONTARIO  
MINISTRY OF NATURAL RESOURCES  
SURVEYS AND MAPPING BRANCH

XIV

XIII

XII

XI

X

IX

VIII

VII

VI

V

IV

III

II

I

Stephenson Twp.

Medora Twp.

Monck Twp.



Cardwell Twp.

THE TOWNSHIP  
OF  
**WATT**

DISTRICT OF  
MUSKOKA

EASTERN ONTARIO  
MINING DIVISION



SCALE: 1-INCH = 40 CHAINS

LEGEND

PATENTED LAND	Ⓟ
CROWN LAND SALE	C.S.
LEASES	Ⓛ
LOCATED LAND	Loc.
LICENSE OF OCCUPATION	L.O.
MINING RIGHTS ONLY	M.R.O.
SURFACE RIGHTS ONLY	S.R.O.
ROADS	
IMPROVED ROADS	
KING'S HIGHWAYS	
RAILWAYS	
POWER LINES	
MARSH OR MUSKES	
MINES	
CANCELLED	

NOTES

This Map Is Not To Be Used  
—FOR SURVEY PURPOSES—

Original shoreline shown thus:   
F.R.I. shoreline shown thus: 

400' SURFACE RIGHTS RESERVATION  
AROUND ALL LAKES & RIVERS FOR L.F.

DATE OF ISSUE  
MAY 25 1980  
SURVEYS AND MAPPING  
BRANCH

PLAN NO. M. 1670

ONTARIO  
MINISTRY OF NATURAL RESOURCES  
SURVEYS AND MAPPING BRANCH

XIV

XIII

XII

XI

X

IX

VIII

VII

VI

V

IV

III

II

I

Stephenson Twp.

Monck Twp.

Medora Twp.



Cardwell Twp.

THE TOWNSHIP  
OF 'A'  
Bracebridge M-1670  
**WATT**

DISTRICT OF  
MUSKOKA

EASTERN ONTARIO  
MINING DIVISION

SCALE: 1-INCH = 40 CHAINS

**LEGEND**

PATENTED LAND	Ⓟ
CROWN LAND SALE	C.S.
LEASES	Ⓛ
LOCATED LAND	Loc.
LICENSE OF OCCUPATION	L.O.
MINING RIGHTS ONLY	M.R.O.
SURFACE RIGHTS ONLY	S.R.O.
ROADS	—
IMPROVED ROADS	—
KING'S HIGHWAYS	—
RAILWAYS	—
POWER LINES	—
MARSH OR MUSKEG	—
MINES	—
CANCELLED	—

**NOTES**

This Map Is Not To Be Used  
—FOR SURVEY PURPOSES—

Original shoreline shown thus: —  
F.R.I. shoreline shown thus: —

400' SURFACE RIGHTS RESERVATION  
AROUND ALL LAKES & RIVERS FOR L.F.

DATE OF ISSUE  
JUL 26 1982  
Ministry of Natural Resources  
TORONTO

PLAN NO. M. 1670

ONTARIO  
MINISTRY OF NATURAL RESOURCES  
SURVEYS AND MAPPING BRANCH

XIV

XIII

XII

XI

X

IX

VIII

VII

VI

V

IV

III

II

I

Stephenson Twp.

Monck Twp.

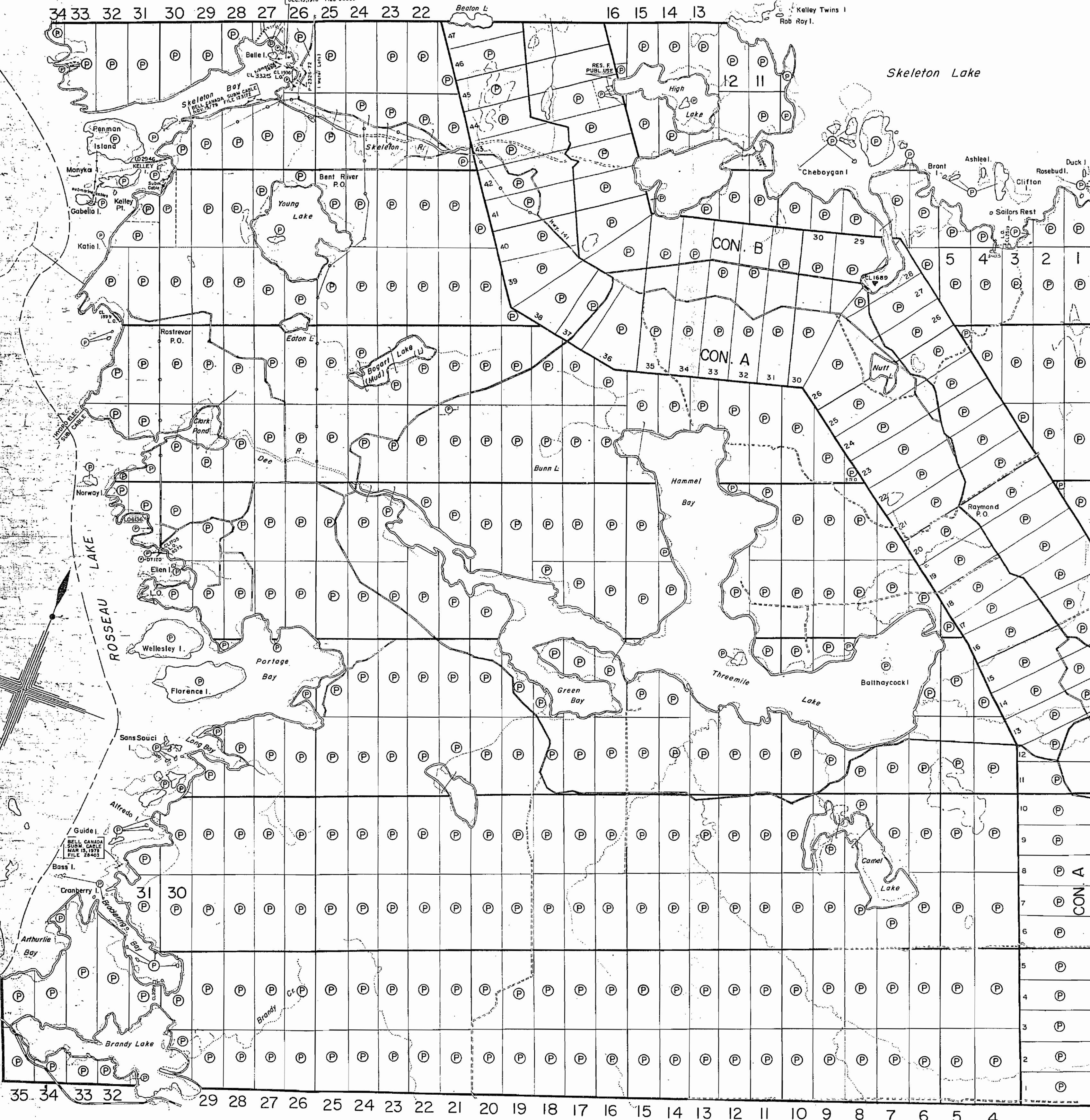



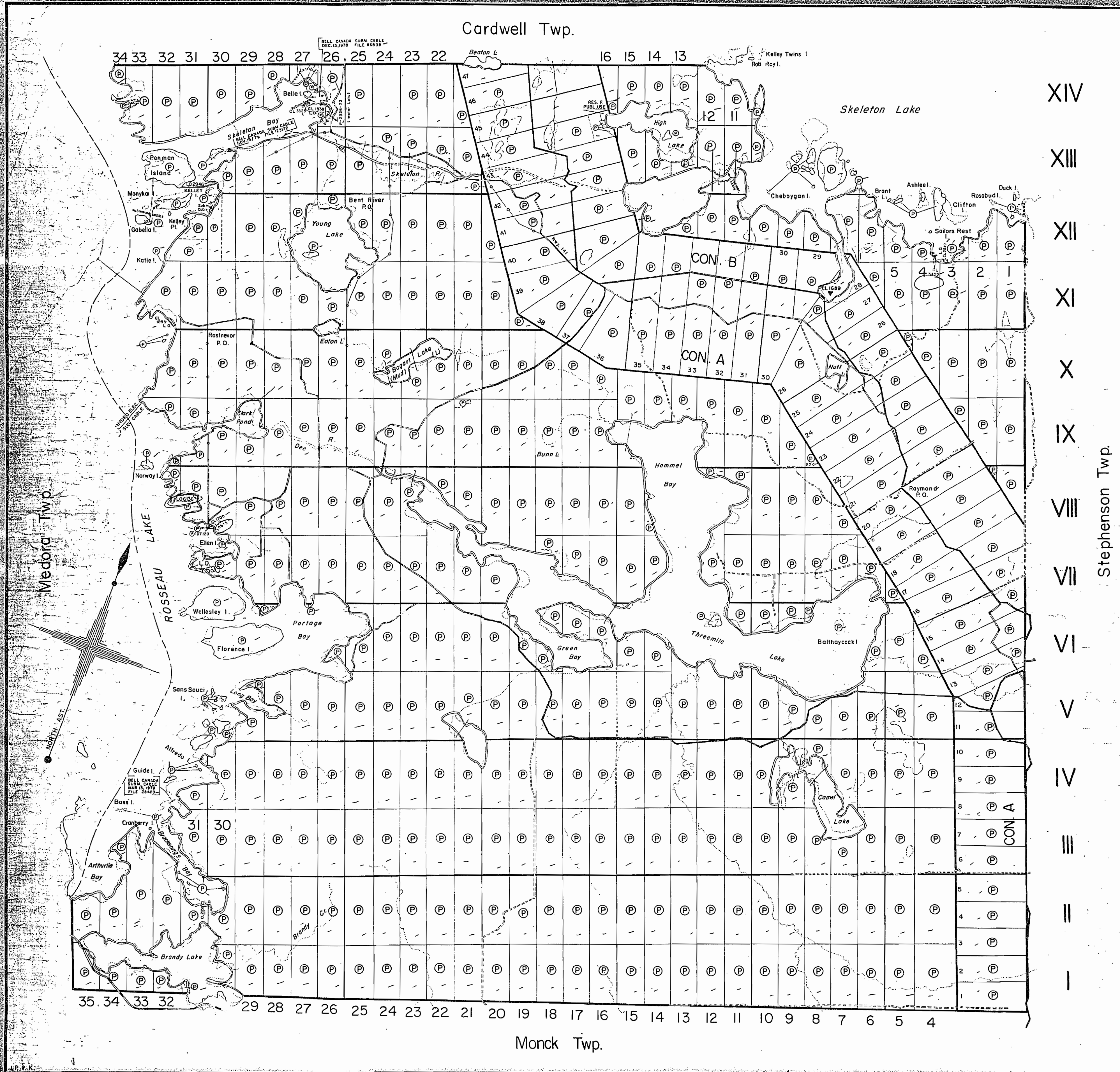

THE TOWNSHIP OF  
"A" M-1670

**WATT**  
D.M. BRACEBRIDGE  
DISTRICT OF MUSKOKA

EASTERN ONTARIO  
MINING DIVISION

SCALE: 1-INCH = 40 CHAINS

**LEGEND**

PATENTED LAND	Ⓟ
CROWN LAND SALE	C.S.
LEASES	L.
LOCATED LAND	Loc.
LICENSE OF OCCUPATION	L.O.
MINING RIGHTS ONLY	M.R.O.
SURFACE RIGHTS ONLY	S.R.O.
ROADS	—
IMPROVED ROADS	—
KING'S HIGHWAYS	—
RAILWAYS	—
POWER LINES	—
MARSH. OR MUSKEG	—
MINES	—
CANCELLED	—

**NOTES**

This Map Is Not To Be Used  
—FOR SURVEY PURPOSES—

Original shoreline shown thus: —  
F.R.I. shoreline shown thus: —

400' SURFACE RIGHTS RESERVATION  
AROUND ALL LAKES & RIVERS FOR L.F.

DATE OF ISSUE  
JUL 26 1983  
Ministry of Natural Resources  
TORONTO

PLAN NO. M. 1670

ONTARIO  
MINISTRY OF NATURAL RESOURCES  
SURVEYS AND MAPPING BRANCH



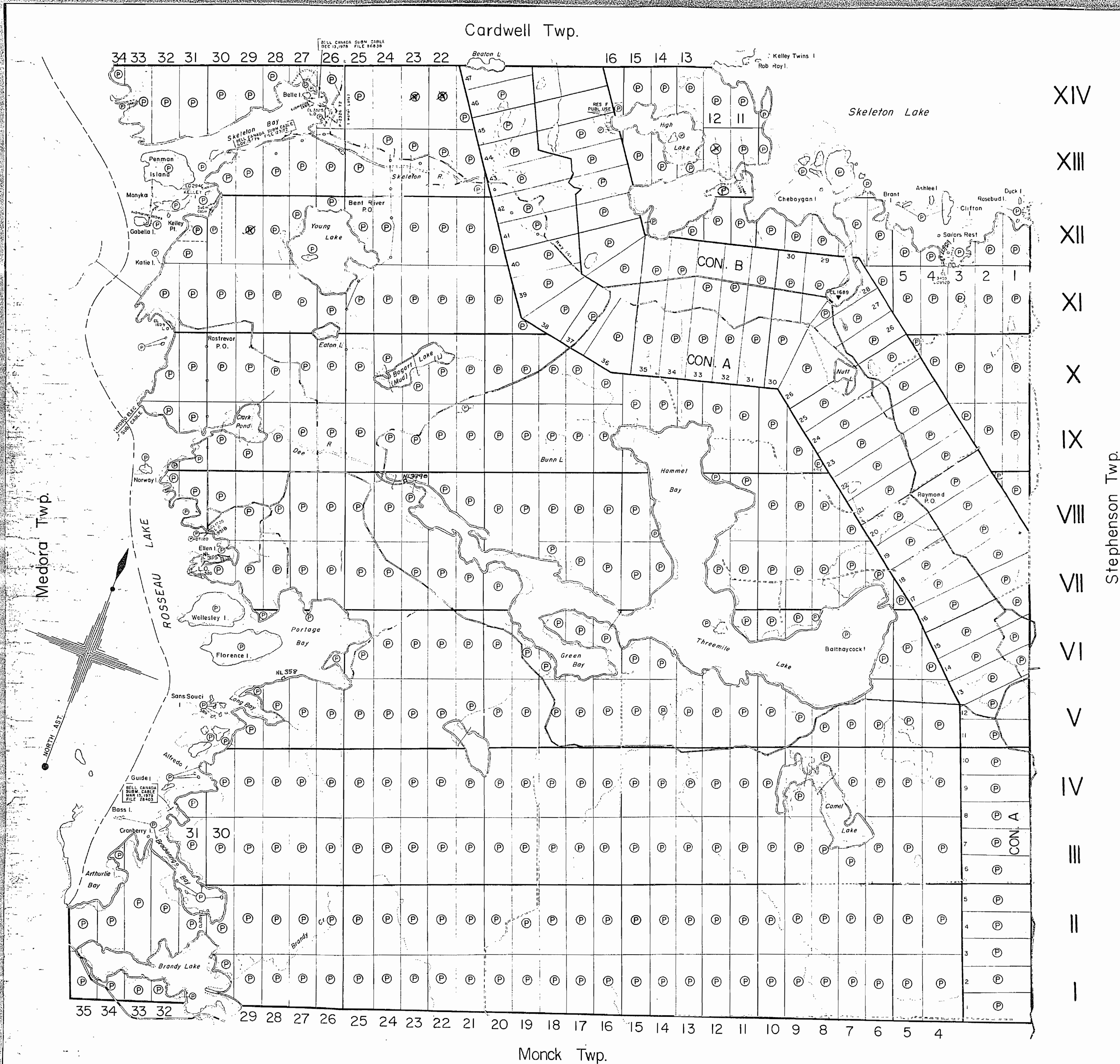

THE TOWNSHIP  
OF  
**WATT**  
BRACEBRIDGE DISTRICT  
DISTRICT OF  
MUSKOKA  
RESIDENT GEOLOGIST-DORSET  
**SOUTHERN ONTARIO**  
MINING DIVISION

SCALE: 1-INCH = 40 CHAINS

**LEGEND**

PATENTED LAND	Ⓟ
CROWN LAND SALE	C.S.
LEASES	Ⓛ
LOCATED LAND	Loc.
LICENSE OF OCCUPATION	L.O.
MINING RIGHTS ONLY	M.R.O.
SURFACE RIGHTS ONLY	S.R.O.
ROADS	—
IMPROVED ROADS	—
KING'S HIGHWAYS	—
RAILWAYS	—
POWER LINES	—
MARSH OR MUSKEG	—
MINES	—
CANCELLED	—

**NOTES**

This Map Is Not To Be Used  
—FOR SURVEY PURPOSES—

Original shoreline shown thus: —  
F.R.I. shoreline shown thus: —  
400' SURFACE RIGHTS PRESERVATION  
AROUND ALL LAKES & RIVERS FOR 40'

MINING RECORDS OFFICE - TORONTO  
**RECEIVED**  
AUG 13 1985  
AM 7:00 10:11 12:12 1:13 2:14 3:15 PM

NATURAL RESOURCES  
AUG 13 1985  
TITLES SECTION

PLAN NO.- **M. 1670**

ONTARIO  
MINISTRY OF NATURAL RESOURCES  
SURVEYS AND MAPPING BRANCH



Cardwell Twp.

THE TOWNSHIP OF

**WATT**

DISTRICT OF MUSKOKA

SOUTHERN ONTARIO  
MINING DIVISION

SCALE: 1-INCH = 40 CHAINS

**LEGEND**

PATENTED LAND	(P)
CROWN LAND SALE	(C.S.)
LEASES	(L)
LOCATED LAND	(Loc.)
LICENSE OF OCCUPATION	(L.O.)
MINING RIGHTS ONLY	(M.R.O.)
SURFACE RIGHTS ONLY	(S.R.O.)
ROADS	
IMPROVED ROADS	
KING'S HIGHWAYS	
RAILWAYS	
POWER LINES	
MARSH OR MUSKEG	
MINES	
CANCELLED	

**NOTES**

This Map Is Not To Be Used  
—FOR SURVEY PURPOSES—

Original shoreline shown thus: ~~~~~  
F.R.L. shoreline shown thus: ~~~~~  
400' SURFACE RIGHTS RESERVATION  
AROUND ALL LAKES & RIVERS FOR L.F.

DATE OF ISSUE

JUN 01 1988

SOUTHERN ONTARIO  
MINING DIVISION

PLAN NO.- **M. 1670**

ONTARIO  
MINISTRY OF NATURAL RESOURCES  
SURVEYS AND MAPPING BRANCH

XIV

XIII

XII

XI

X

IX

VIII

VII

VI

V

IV

III

II

I

Stephenson Twp.

Skeleton Lake

CON. B

CON. A

CON. A

Monck Twp.

Medora Twp.

ROSEAU LAKE

Monck Twp.