

REFERENCES

| AREAS WITHDRAWN FROM DISPOSITION | | | | |
|----------------------------------|-----------|------|-------------|------|
| M.R.O. - MINING RIGHTS ONLY | | | | |
| S.R.O. - SURFACE RIGHTS ONLY | | | | |
| M.S. - MINING AND SURFACE RIGHTS | | | | |
| Description | Order No. | Date | Disposition | File |
| W-30-69/94 | 2015/94 | NBS | 19550 | |
| W-30-79/96 | 18/09/96 | SMR | 19550 | |

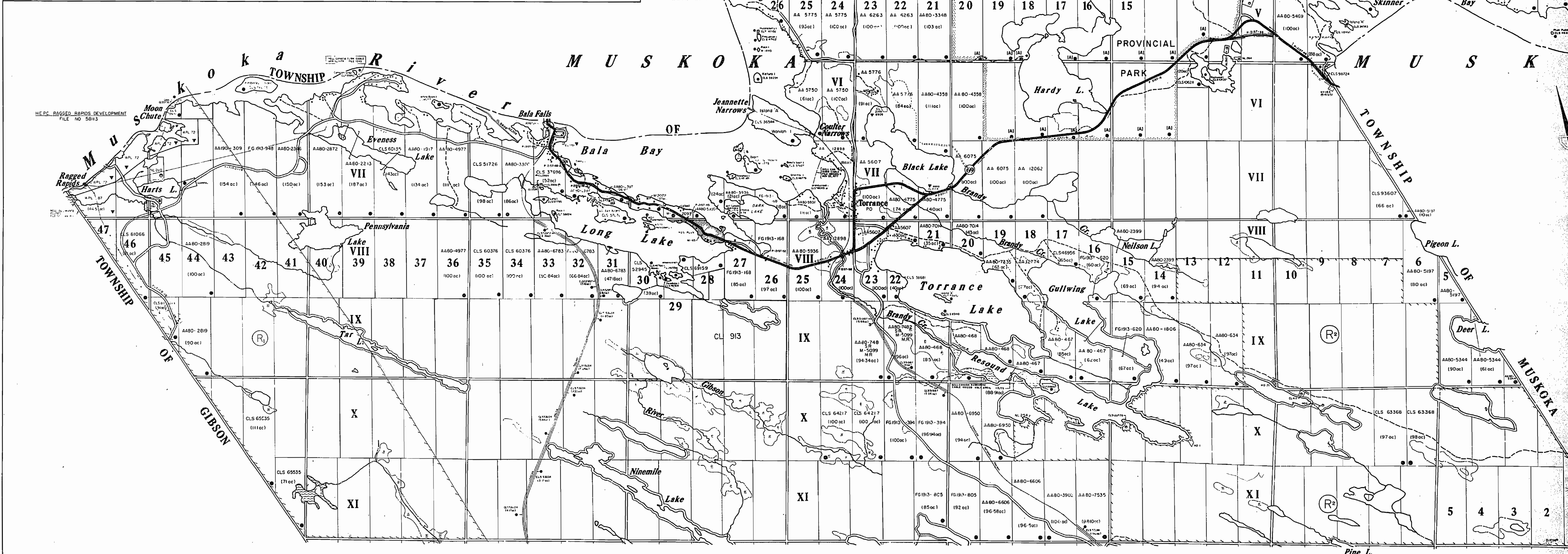

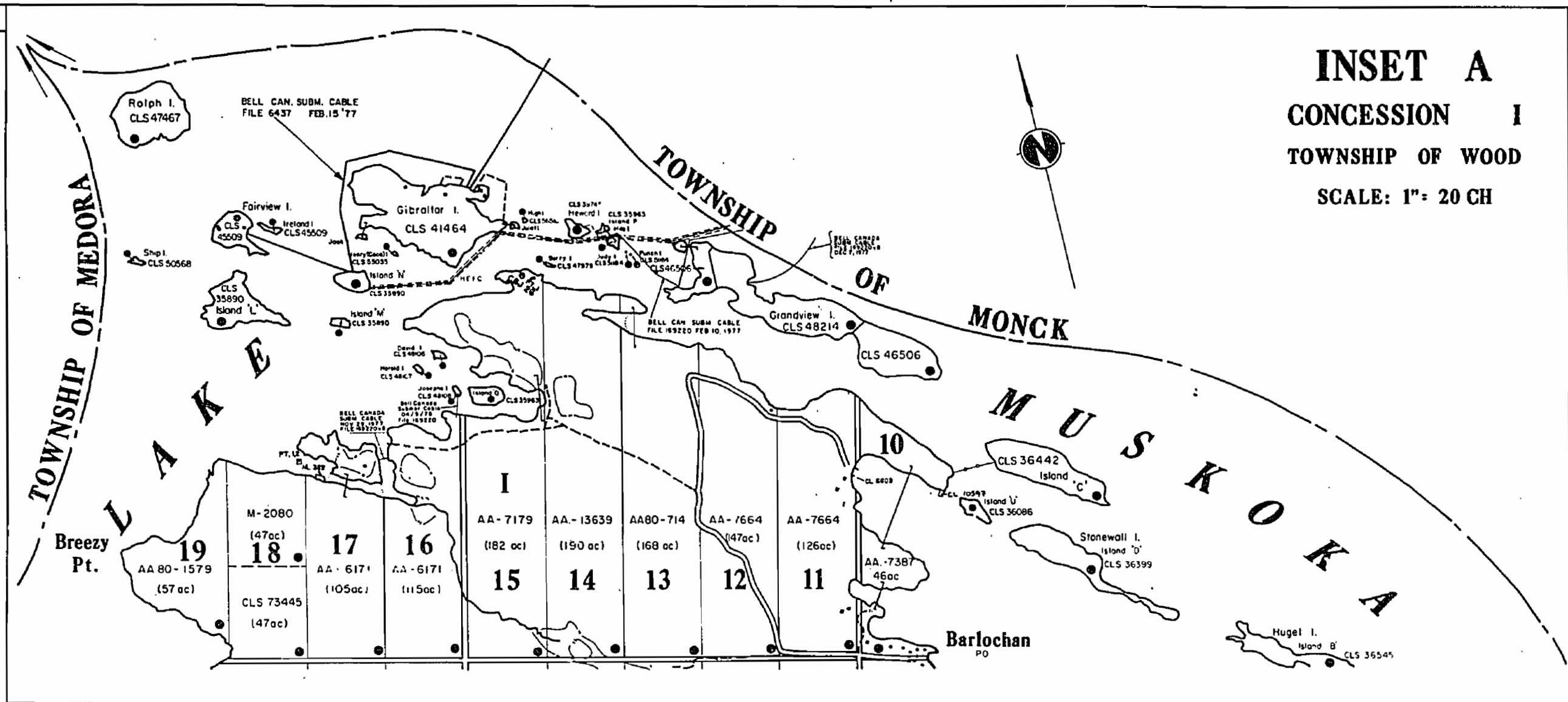
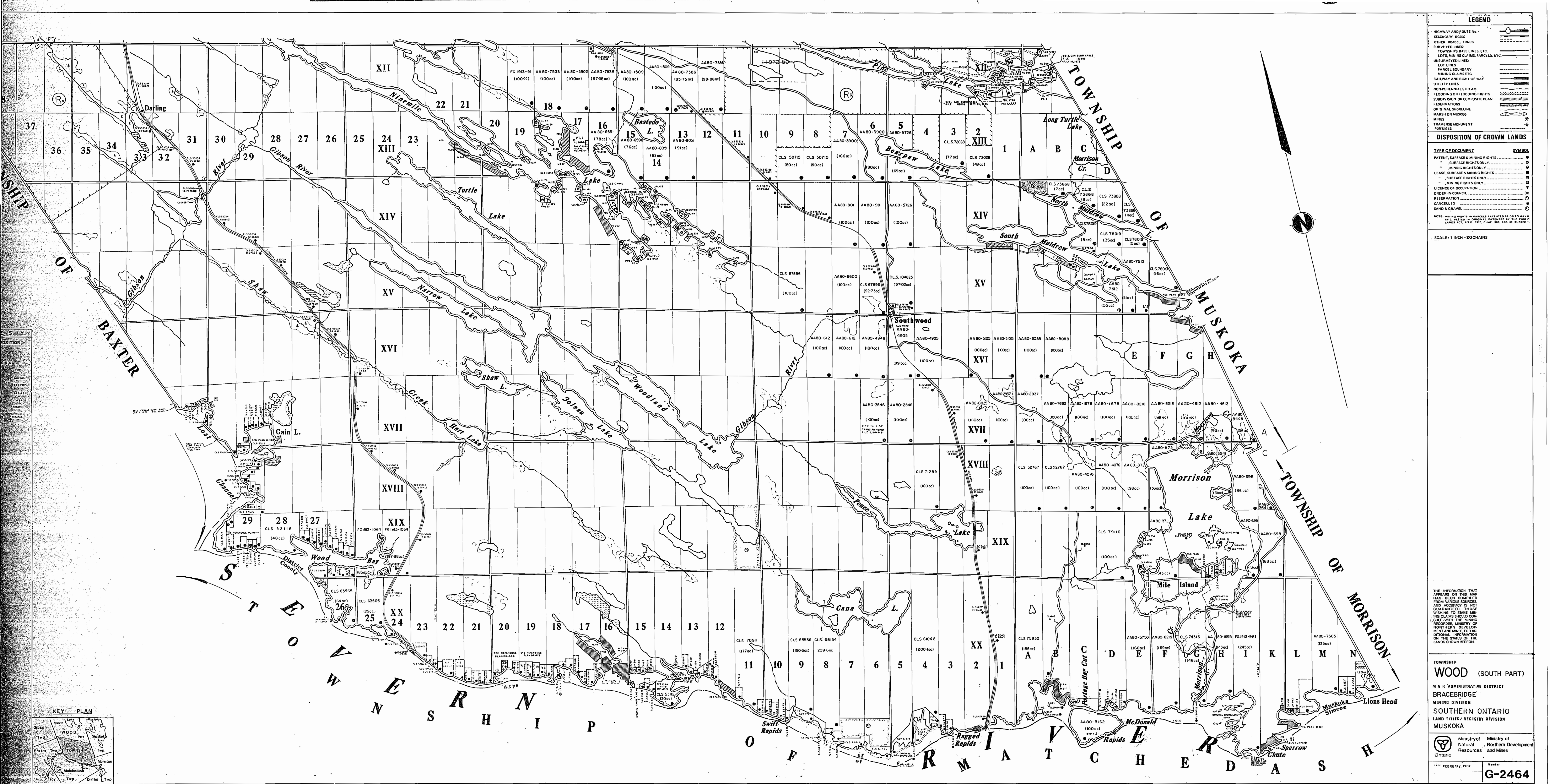

LEGEND

Highway and Route No.
Secondary Roads
Other Roads, Trails
Surveyed Lines
Townships, Base Lines, Etc.
Lots, Mining Claims, Parcels, Etc.
Lot Lines
Unsurveyed Lines
Parcel Boundary
Mining Claims Etc.
Railway and Right of Way
Utility Lines
Non Perennial Stream
Flooded or Flooding Rights
Subdivision or Composite Plan
Reservations
Original Shoreline
Marsh or Mudflats
Mines
Traverse Monument
Postages

DISPOSITION OF CROWN LANDS

| TYPE OF DOCUMENT | SYMBOL |
|---------------------------------|--------|
| PATENT, SURFACE & MINING RIGHTS | |
| " SURFACE RIGHTS ONLY | |
| " MINING RIGHTS ONLY | |
| LEASE, SURFACE & MINING RIGHTS | |
| " SURFACE RIGHTS ONLY | |
| " MINING RIGHTS ONLY | |
| LICENSE OF OCCUPATION | |
| ORDER IN COUNCIL | |
| RESERVATION | |
| CANCELLED | |
| SAND & GRAVEL | |

NOTE: MINING RIGHTS IN PARCELS PATENTED PRIOR TO MAY 1, 1915, VESTED IN ORIGINAL PATENTEE BY THE PUBLIC LANDS ACT, R.S.O. 1970, CHAP. 360, SEC. 42, SUBSEC. 1.

SCALE: 1 INCH = 20 CHAINS

THE INFORMATION THAT APPEARS ON THIS MAP HAS BEEN COMPILED FROM VARIOUS SOURCES, AND ACCURACY IS NOT GUARANTEED. THOSE WISHING TO MAKE MINING CLAIMS SHOULD CONSULT WITH THE MINING RECORDS, MINISTRY OF NORTHERN DEVELOPMENT AND MINES, FOR ADDITIONAL INFORMATION ON THE STATUS OF THE LANDS SHOWN HEREON.

TOWNSHIP
WOOD (SOUTH PART)
M.N.R. ADMINISTRATIVE DISTRICT
BRACEBRIDGE
MINING DIVISION
SOUTHERN ONTARIO
LAND TITLES / REGISTRY DIVISION
MUSKOKA

Ministry of Natural Resources
Ministry of Northern Development and Mines
Ontario

FEBRUARY, 1987
G-2464

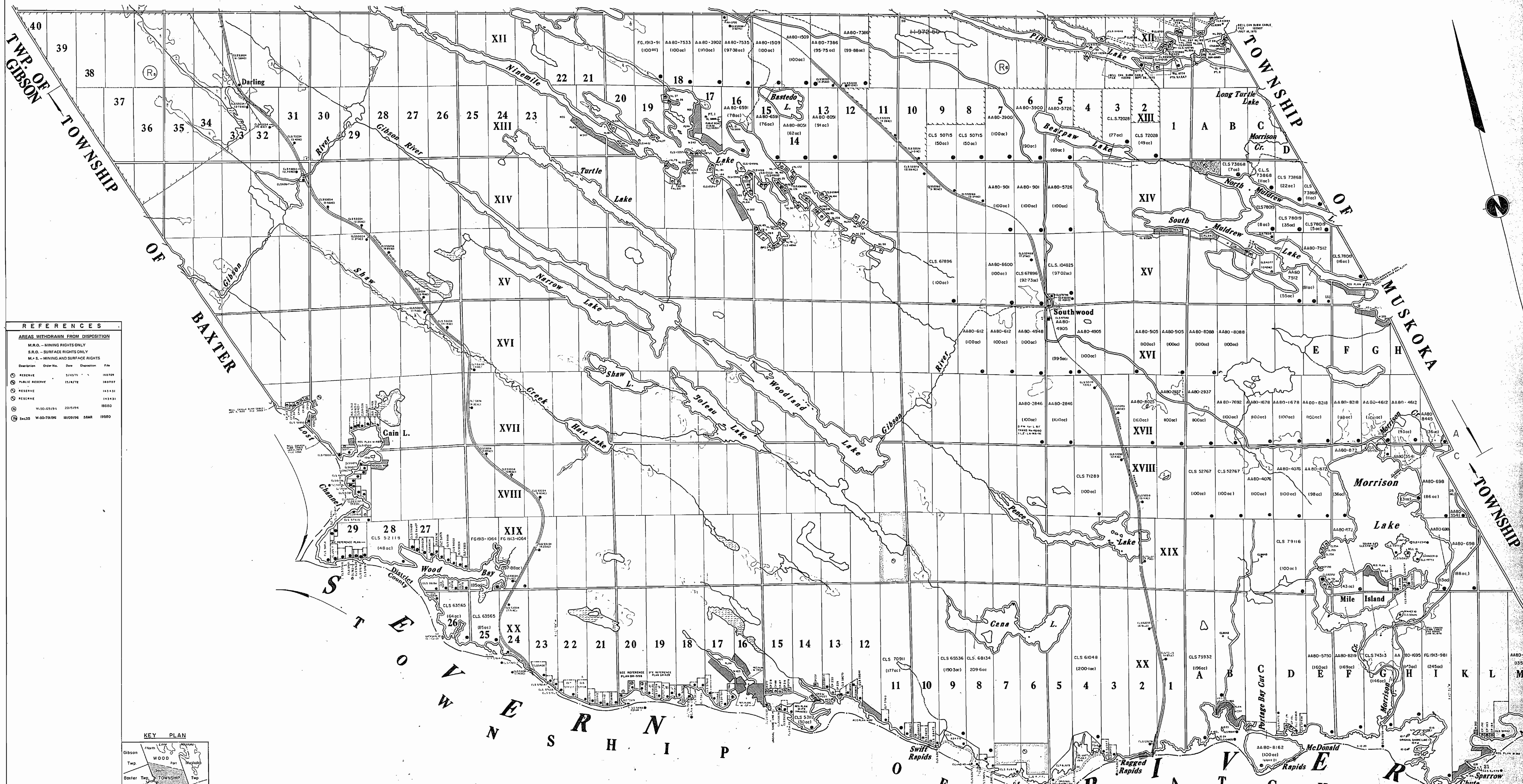

| REFERENCES | | | | |
|-------------------------------------|-----------|-----------|-------------|------|
| AREAS WITHDRAWN FROM DISPOSITION | | | | |
| M.R.O. - MINING RIGHTS ONLY | | | | |
| S.R.O. - SURFACE RIGHTS ONLY | | | | |
| M. & S. - MINING AND SURFACE RIGHTS | | | | |
| Description | Order No. | Date | Disposition | File |
| 1 RESERVE | 3/12/71 | 180709 | | |
| 2 PUBLIC RESERVE | 15/8/72 | 180707 | | |
| 3 RESERVE | 143/31 | 143/31 | | |
| 4 RESERVE | 143/31 | 143/31 | | |
| 5 W-50-65/75 | 20/5/74 | 18550 | | |
| 6 Sec 25 W-50-79/79 | 18/09/76 | SMR 19080 | | |

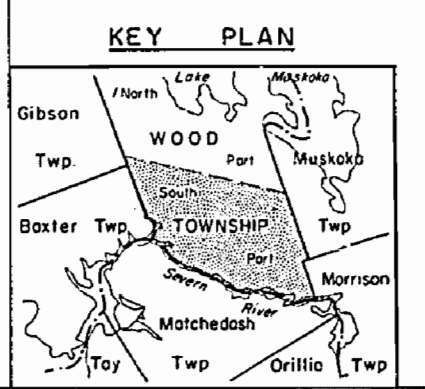

THE TOWNSHIP
OF
WOOD
COUNTY OF
MUSKOKA
EASTERN ONTARIO
MINING DIVISION
SCALE: 1 INCH = 40 CHAINS

LEGEND

| | |
|-----------------------|--------|
| PATENTED LAND | ⊙ |
| CROWN LAND SALE | C.S. |
| LEASES | ⊙ |
| LOCATED LAND | LOC. |
| LICENSE OF OCCUPATION | L.O. |
| MINING RIGHTS ONLY | M.R.O. |
| SURFACE RIGHTS ONLY | S.R.O. |
| ROADS | — |
| IMPROVED ROADS | — |
| KINGS HIGHWAYS | — |
| RAILWAYS | — |
| POWER LINES | — |
| MARSH OR MUSKOG | — |
| MINES | — |

NOTES
This Map Is Not To Be
Used For Survey Purposes.
Summer Resorts Location Shown Thus:

And For Information Regarding Status
Please Write, Dept. Of Lands And
Forests, Toronto, ONTARIO.
400' Surface rights reservation around all lakes &
rivers.

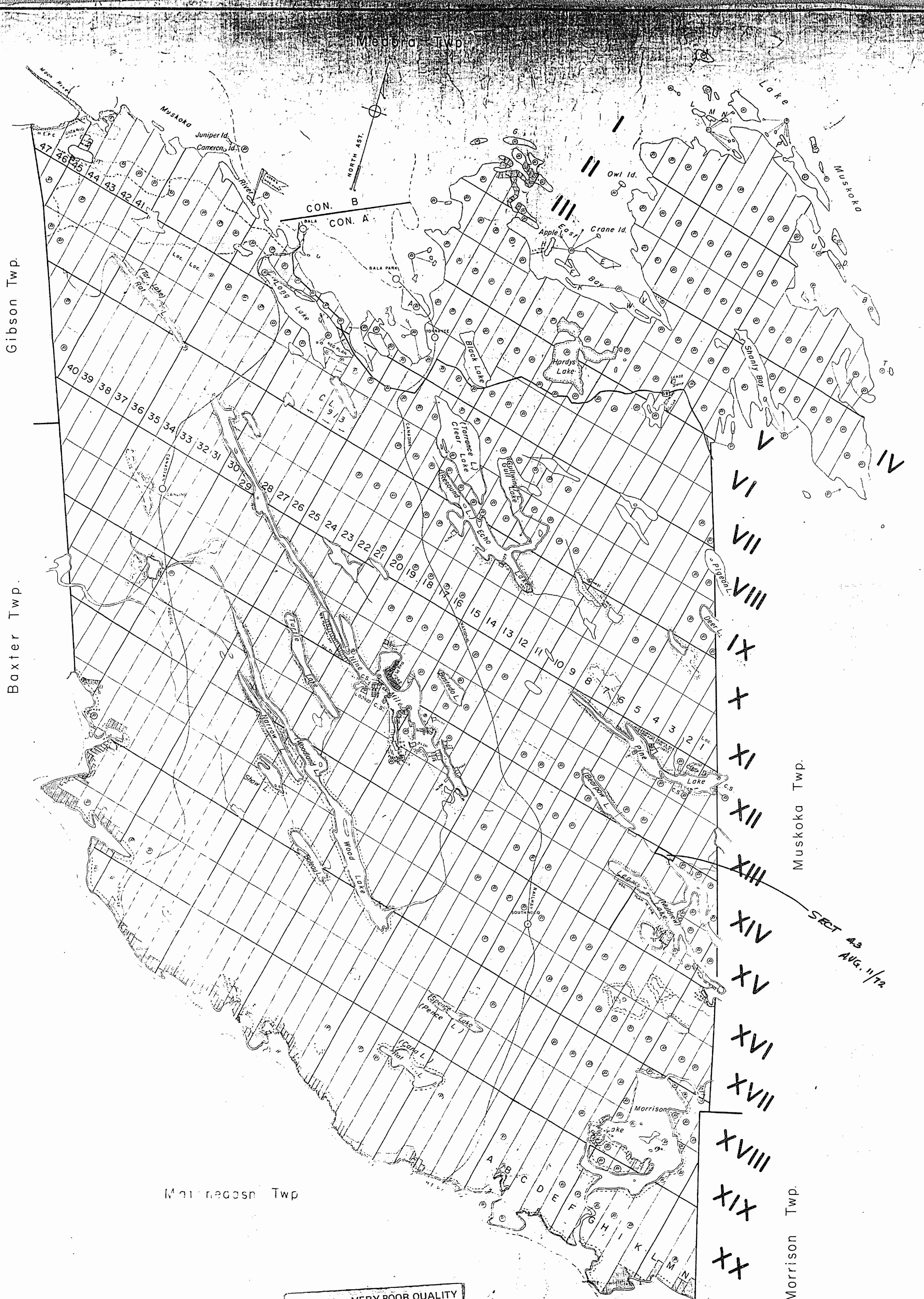
DATE OF ISSUE
FEB 1 1940
ONTARIO DEPT. OF MINES



SECT 43
AUG. 11/72

ORIGINAL - VERY POOR QUALITY

Wood

COUNTY OF MUSKOKA

EASTERN ONTARIO MINING DIVISION

SCALE: 1 INCH = 40 CHAINS

LEGEND

- | | |
|-----------------------|--------|
| PATENTED LAND | CS. |
| CROWN LAND SALE | Loc. |
| LEASES | L.O. |
| LOCATED LAND | N.R.O. |
| LICENSE OF OCCUPATION | S.R.O. |
| MINING RIGHTS ONLY | |
| SURFACE RIGHTS ONLY | |
| ROADS | |
| IMPROVED ROADS | |
| KINGS' HIGHWAYS | |
| RAILWAYS | |
| POWER LINES | |
| MARSH OR MUSKEG | |
| MINES | |

NOTES

This Map Is Not To Be Used For Survey Purposes.

Summer Resorts Location Shown Thus:

And For Information Regarding Status Please Write Dept. Of Lands And Forests, Toronto, ONTARIO.

400' Surface rights reservation around all lakes & rivers.

DATE OF ISSUE

ONT. DEPT. OF MINES AND NORTHERN AFFAIRS

PLAN NO- M.162

ONTARIO

Gibson Twp.

Baxter Twp.

Matchedash Twp.

Muskoka Twp.

Morrison Twp.

ORIGINAL - VERY POOR QUALITY

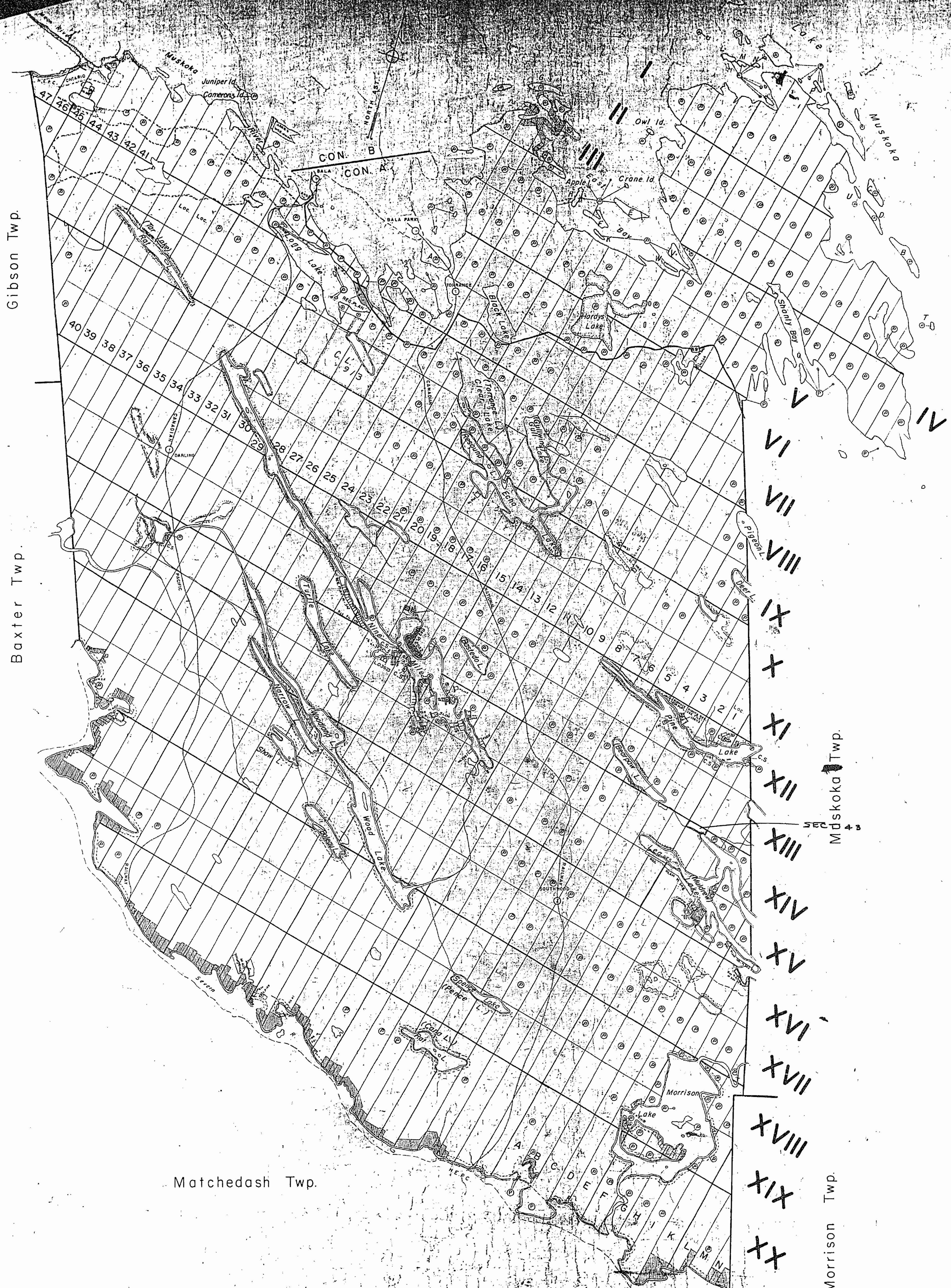

WOOD

COUNTY OF MUSKOKA

EASTERN ONTARIO MINING DIVISION

SCALE 1 INCH = 40 CHAINS

LEGEND

| | |
|-----------------------|--------|
| PATENTED LAND | ⊙ |
| CROWN LAND SALE | CS. |
| LEASES | ⊙ |
| LOCATED LAND | LOC. |
| LICENSE OF OCCUPATION | L.O. |
| MINING RIGHTS ONLY | M.R.O. |
| SURFACE RIGHTS ONLY | S.R.O. |
| ROADS | — |
| IMPROVED ROADS | — |
| KINGS HIGHWAYS | — |
| RAILWAYS | — |
| POWER LINES | — |
| MARSH OR MUSKOG | — |
| MINES | — |

NOTES

This Map Is Not To Be Used For Survey Purposes.

Summer Resorts Location Shown Thus:

And For Information Regarding Status Please Write, Dept. Of Lands And Forests, Toronto, ONTARIO.

400' Surface rights reservation around all lakes & rivers.

Areas withdrawn from staking under Section 43 of the Mining Act, (R.S.O. 1970)

| File | Date | Disposition |
|--------|---------|-------------|
| 160707 | 11/8/72 | SRO |

MINING LANDS
DATE OF ISSUE
FEB 13 1973
MINISTRY
OF NATURAL RESOURCES

PLAN NO.- M.162

MINISTRY OF NATURAL RESOURCES

Gibson Twp.

Baxter Twp.

Muskoka Twp.

Morrison Twp.

Matchedash Twp.

Medora Twp.

Gibson Twp.

Baxter Twp.

Matchedash Twp.

Muskoka Twp.

Morrison Twp.

THE TOWNSHIP
OF
WOOD
COUNTY OF
MUSKOKA
EASTERN ONTARIO
MINING DIVISION
SCALE: 1 INCH = 40 CHAINS

LEGEND

| | |
|-----------------------|--------|
| PATENTED LAND | ① |
| CROWN LAND SALE | C.S. |
| LEASES | ② |
| LOCATED LAND | Loc. |
| LICENSE OF OCCUPATION | L.O. |
| MINING RIGHTS ONLY | M.R.O. |
| SURFACE RIGHTS ONLY | S.H.O. |
| ROADS | — |
| IMPROVED ROADS | — |
| KINGS HIGHWAYS | — |
| RAILWAYS | — |
| POWER LINES | — |
| MARSH OR MUSKEG | — |
| MINES | — |

NOTES

This Map is Not To Be
Used For Survey Purposes.

Summer Resorts Location Shown Thus:

And For Information Regarding Status
Please Write, Dept. Of Lands And
Forests, Toronto, ONTARIO.

400' Surface rights reservation around all lakes &
rivers.

Areas withdrawn from staking under Section
43 of the Mining Act. (R.S.O. 1970)

| File | Date | Disposition |
|--------|---------|-------------|
| 160707 | 11/8/72 | SRO |

MINING LANDS
DATE OF ISSUE
NOV 20 1975
MINISTRY
OF NATURAL RESOURCES

PLAN NO- M.162

ONTARIO
MINISTRY OF NATURAL RESOURCES
SURVEYS AND MAPPING BRANCH

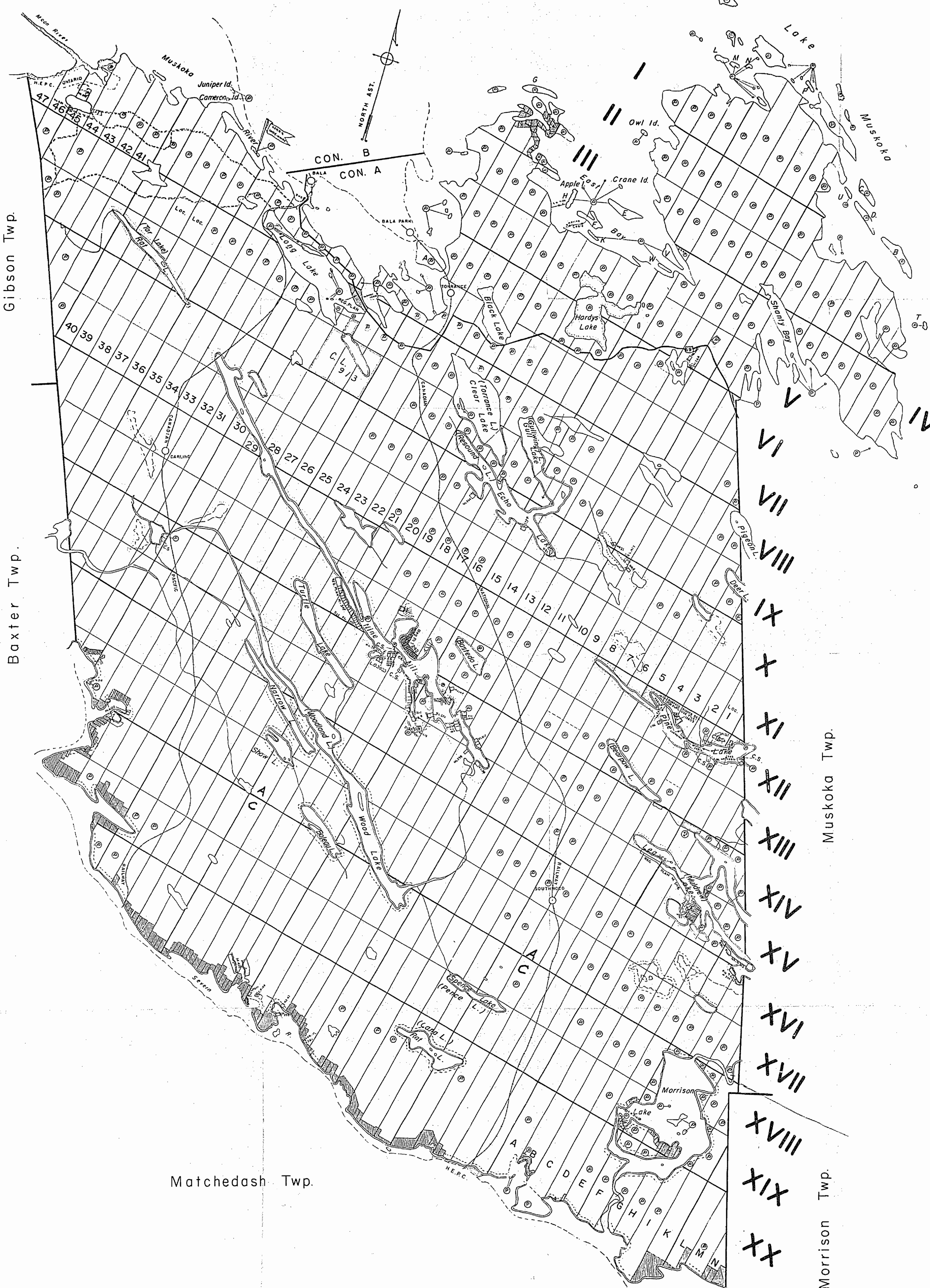

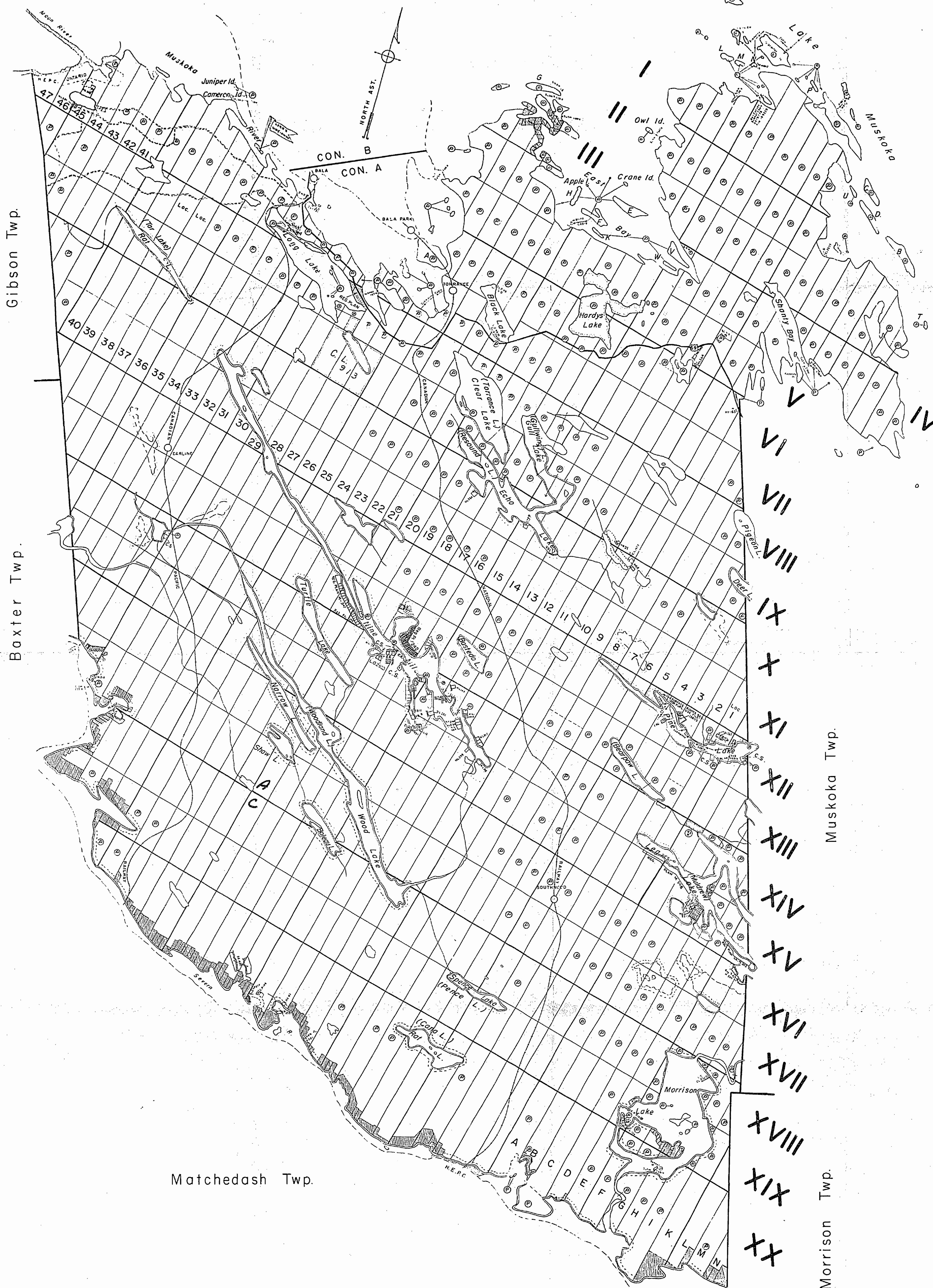
Morrison
Two

Medora Twp.

THE TOWNSHIP
OF m-162
WOOD
COUNTY OF
MUSKOKA
EASTERN ONTARIO
MINING DIVISION.
SCALE: 1-INCH=40 CHAINS

LEGEND

| | |
|-----------------------|--------|
| PATENTED LAND | • or ⊙ |
| CROWN LAND SALE | C.S. |
| LEASES | ⊙ |
| LOCATED LAND | Loc. |
| LICENSE OF OCCUPATION | L.O. |
| MINING RIGHTS ONLY | M.R.O. |
| SURFACE RIGHTS ONLY | S.R.O. |
| ROADS | |
| IMPROVED ROADS | |
| KINGS HIGHWAYS | |
| RAILWAYS | |
| POWER LINES | |
| MARSH OR MUSKEG | |
| MINES | |
| PATENTED for S.R.O. | |

NOTES

This Map is Not To Be
Used For Survey Purposes.

Summer Resorts Location Shown Thus:

And For Information Regarding Status
Please Write, Dept. of Lands And
Forests, Toronto, ONTARIO.

400' Surface rights reservation around all lakes &
rivers.

Areas withdrawn from staking under Section
43 of the Mining Act, (R.S.O. 1970)

| | | |
|--------|---------|-------------|
| File | Date | Disposition |
| 160707 | 11/8/72 | S.R.O. |

Gibson Twp.

Baxter Twp.

Muskoka Twp.

Morrison Twp.

Matchedash Twp.

DATE OF ISSUE
JUL 26 1982
Ministry of Natural Resources
TORONTO

PLAN NO.- M.162

ONTARIO
MINISTRY OF NATURAL RESOURCES

Medora Twp.

THE TOWNSHIP
OF M-162
WOOD
COUNTY OF
MUSKOKA
BRACEBRIDGE / HURONIA
EASTERN ONTARIO
MINING DIVISION
SCALE: 1 INCH = 40 CHAINS

LEGEND

PATENTED LAND
CROWN LAND SALE
LEASES
LOCATED LAND
LICENSE OF OCCUPATION
MINING RIGHTS ONLY
SURFACE RIGHTS ONLY
ROADS
IMPROVED ROADS
KINGS HIGHWAYS
RAILWAYS
POWER LINES
MARSH OR MUSKEG
MINES
PATENTED FOR S.R.O.

NOTES

This Map is Not To Be
Used For Survey Purposes.

Summer Resorts Location Shown Thus:

And For Information Regarding Status
Please Write, Dept. Of Lands And
Forests, Toronto, ONTARIO.

400' Surface rights reservation around all lakes &
rivers.

Areas withdrawn from staking under Section
43 of the Mining Act, (R.S.O. 1970)

| File | Date | Disposition |
|--------|---------|-------------|
| 160707 | 11/8/72 | S.R.O. |
| 160708 | 11/8/72 | S.R.O. |

W.L. 1633
HARDY LAKE COASTLINE PARK
S4 HR WITHDRAWN FROM
STAKING

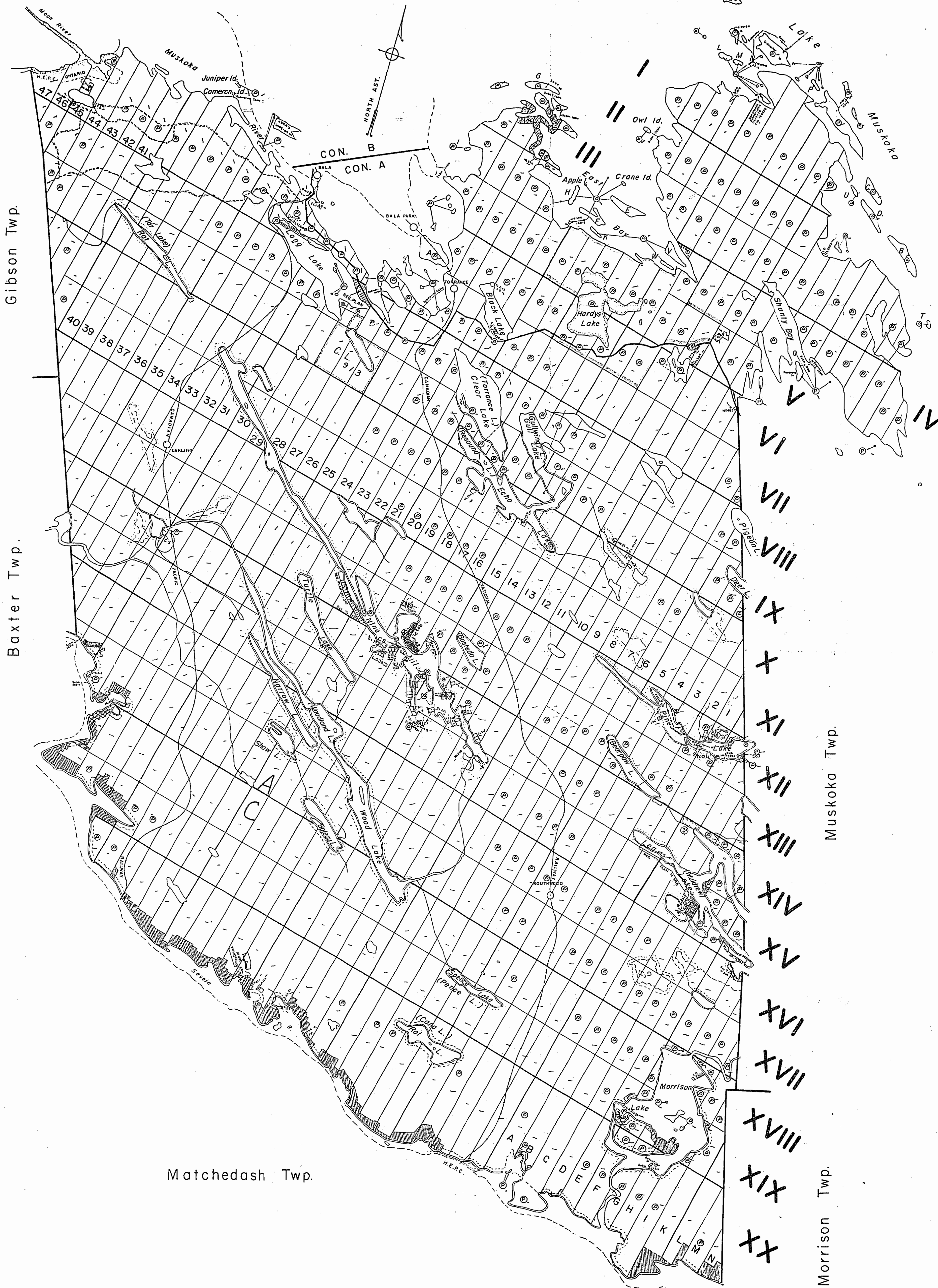

Matchedash Twp.

DATE OF ISSUE
JUL 21 1983
Ministry of Natural Resources
TORONTO

PLAN NO.- M.162

ONTARIO
MINISTRY OF NATURAL RESOURCES

Medora Twp.

THE TOWNSHIP
OF M-162
A+C WOOD
M-162
COUNTY OF DISTRICTS
D.M. MUSKOKA
BRACEBRIDGE / HURONIA
EASTERN ONTARIO
MINING DIVISION.
SCALE: 1-INCH = 40 CHAINS

LEGEND

PATENTED LAND
CROWN LAND SALE
LEASES
LOCATED LAND
LICENSE OF OCCUPATION
MINING RIGHTS ONLY
SURFACE RIGHTS ONLY
ROADS
IMPROVED ROADS
KINGS HIGHWAYS
RAILWAYS
POWER LINES
MARSH OR MUSKEG
LAKES
PATENTED FOR S.R.O.

NOTES

This Map is Not To Be
Used For Survey Purposes

Summer Resorts Location Shown Thus:

And For Information Regarding Status
Please Write, Dept. Of Lands And
Forests, Toronto, ONTARIO.

400' Surface rights reservation around all lakes &
rivers.

Areas withdrawn from staking under Section
43 of the Mining Act. (R.S.O. 1970)

File Date Disposition

160707 11/8/72 SRO

W-162
HARDY LAKE CANDIDATE PARK
S.M. RIGHTS WITHDRAWN FROM
STAKING

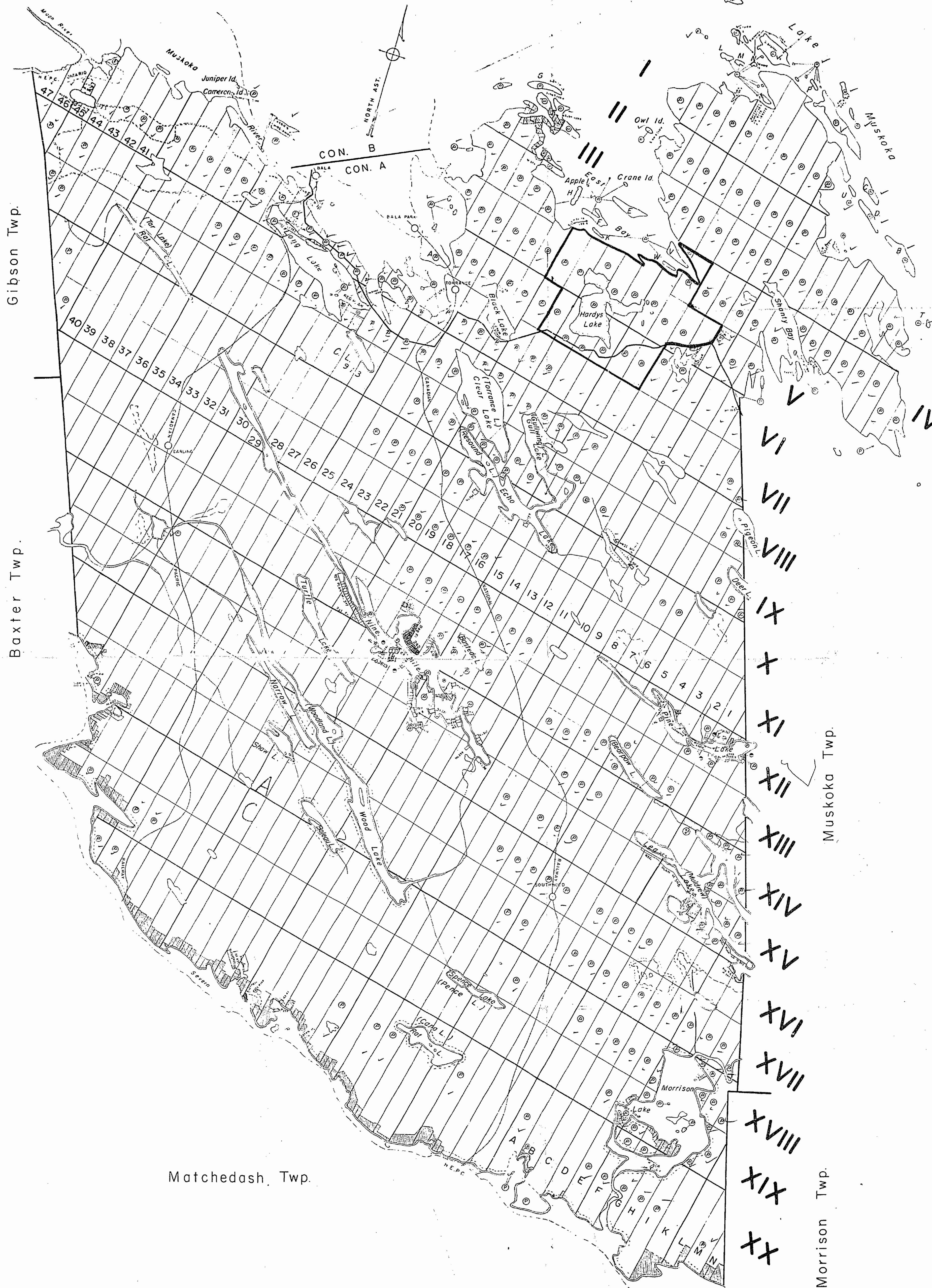

Matchedash Twp.

MINING RECORDS OFFICE - TORONTO
RECEIVED
AUG 22 1985
118, 119, 120, 121, 122, 123, 124, 125

DATE OF ISSUE
JUL 21 1983
NATURAL RESOURCES
AUG 22 1985
TITLES SECTION

PLAN NO.- M-162

ONTARIO
MINISTRY OF NATURAL RESOURCES
DIVISION OF LAND AND FOREST SURVEY

Medora Twp.

Gibson Twp.

Baxter Twp.

Matchedash Twp.

Muskoka Twp.

Morrison Twp.

THE TOWNSHIP
OF M-162
A+C WOOD
BRACEBRIDGE/HURONIA
COUNTY OF DISTRICTS
D.M. MUSKOKA
BRACEBRIDGE/HURONIA
SOUTHERN ONTARIO
MINING DIVISION
RESIDENT GEOLOGIST-DORSET
SCALE: 1 INCH = 40 CHAINS

LEGEND

| | |
|-----------------------|--------|
| PATENTED LAND | ● or ○ |
| CROWN LAND SALE | C.S. |
| LEASES | ○ |
| LOCATED LAND | Loc. |
| LICENSE OF OCCUPATION | L.O. |
| MINING RIGHTS ONLY | M.R.O. |
| SURFACE RIGHTS ONLY | S.R.O. |
| ROADS | — |
| IMPROVED ROADS | — |
| KINGS HIGHWAYS | — |
| RAILWAYS | — |
| POWER LINES | — |
| MARSH OR MUSKOG | — |
| KINGS | — |
| PATENTED FOR S.R.O. | — |

NOTES

This Map is Not To Be
Used For Survey Purposes

Summer Resorts Location Shown Thus:

And For Information Regarding Status
Please Write, Dept. Of Lands And
Forests, Toronto, ONTARIO.

400' Surface rights reservation around all lakes &
rivers.

Areas withdrawn from staking under Section
43 of the Mining Act. (R.S.O. 1970)

| | | |
|--------|---------|-------------|
| File | Date | Disposition |
| 160707 | 11/8/72 | S.R.O. |

W.C. 83
HARDY LAKE CANDIDATE PARK
S.A. RIGHTS WITHDRAWN FROM
STAKING

MINING RECORDS OFFICE - TORONTO
RECEIVED
MAR - 4 1986
710, 810, 11, 12, 13, 14, 15

DATE OF ISSUE
JUL 21 1983
Ministry of Natural Resources
TORONTO

PLAN NO.- M.162

ONTARIO
MINISTRY OF NATURAL RESOURCES